

PLAN NO. 91+0.0~98+0.0

S=1:2000

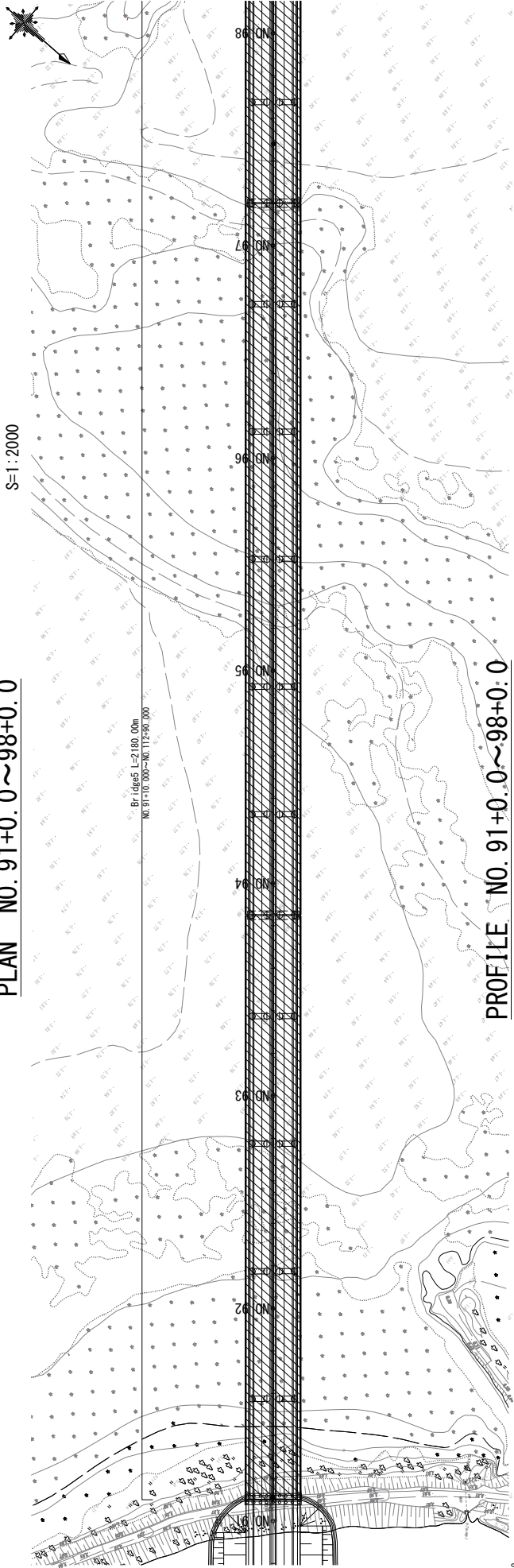

PROFILE NO. 91+0.0~98+0.0

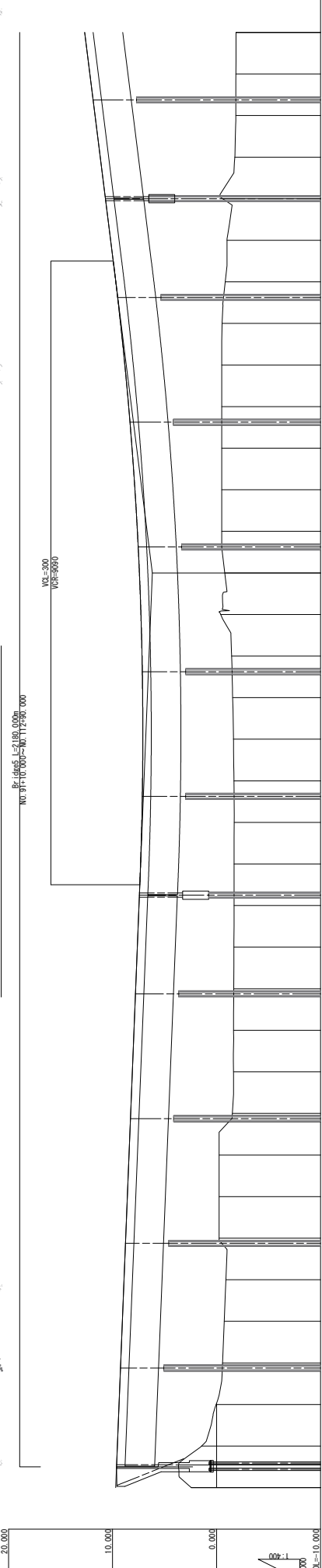

Station	Ground Height	Grade	Fill	Cut
NO. 91	2.437	9.700		
NO. 91	1.442	9.540		
NO. 91	0.035	9.380		
NO. 91	0.570	9.220		
NO. 91	0.731	9.060		
NO. 91	0.891	8.900		
NO. 91	0.240	8.740		
NO. 91	0.240	8.580		
NO. 91	1.523	8.260		
NO. 91	1.625	8.100		
NO. 91	1.636	7.940		
NO. 91	1.637	7.780		
NO. 91	1.637	7.620		
NO. 91	1.673	7.460		
NO. 91	1.680	7.300		
NO. 91	1.697	7.140		
NO. 91	1.697	6.980		
NO. 91	1.697	6.820		
NO. 91	1.697	6.660		
NO. 91	1.697	6.500		
NO. 91	1.697	6.340		
NO. 91	1.697	6.180		
NO. 91	1.697	6.020		
NO. 91	1.697	5.860		
NO. 91	1.697	5.700		
NO. 91	1.697	5.540		
NO. 91	1.697	5.380		
NO. 91	1.697	5.220		
NO. 91	1.697	5.060		
NO. 91	1.697	4.900		
NO. 91	1.697	4.740		
NO. 91	1.697	4.580		
NO. 91	1.697	4.420		
NO. 91	1.697	4.260		
NO. 91	1.697	4.100		
NO. 91	1.697	3.940		
NO. 91	1.697	3.780		
NO. 91	1.697	3.620		
NO. 91	1.697	3.460		
NO. 91	1.697	3.300		
NO. 91	1.697	3.140		
NO. 91	1.697	2.980		
NO. 91	1.697	2.820		
NO. 91	1.697	2.660		
NO. 91	1.697	2.500		
NO. 91	1.697	2.340		
NO. 91	1.697	2.180		
NO. 91	1.697	2.020		
NO. 91	1.697	1.860		
NO. 91	1.697	1.700		
NO. 91	1.697	1.540		
NO. 91	1.697	1.380		
NO. 91	1.697	1.220		
NO. 91	1.697	1.060		
NO. 91	1.697	0.900		
NO. 91	1.697	0.740		
NO. 91	1.697	0.580		
NO. 91	1.697	0.420		
NO. 91	1.697	0.260		
NO. 91	1.697	0.100		
NO. 91	1.697	-0.060		
NO. 91	1.697	-0.220		
NO. 91	1.697	-0.380		
NO. 91	1.697	-0.540		
NO. 91	1.697	-0.700		
NO. 91	1.697	-0.860		
NO. 91	1.697	-1.020		
NO. 91	1.697	-1.180		
NO. 91	1.697	-1.340		
NO. 91	1.697	-1.500		
NO. 91	1.697	-1.660		
NO. 91	1.697	-1.820		
NO. 91	1.697	-1.980		
NO. 91	1.697	-2.140		
NO. 91	1.697	-2.300		
NO. 91	1.697	-2.460		
NO. 91	1.697	-2.620		
NO. 91	1.697	-2.780		
NO. 91	1.697	-2.940		
NO. 91	1.697	-3.100		
NO. 91	1.697	-3.260		
NO. 91	1.697	-3.420		
NO. 91	1.697	-3.580		
NO. 91	1.697	-3.740		
NO. 91	1.697	-3.900		
NO. 91	1.697	-4.060		
NO. 91	1.697	-4.220		
NO. 91	1.697	-4.380		
NO. 91	1.697	-4.540		
NO. 91	1.697	-4.700		
NO. 91	1.697	-4.860		
NO. 91	1.697	-5.020		
NO. 91	1.697	-5.180		
NO. 91	1.697	-5.340		
NO. 91	1.697	-5.500		
NO. 91	1.697	-5.660		
NO. 91	1.697	-5.820		
NO. 91	1.697	-5.980		
NO. 91	1.697	-6.140		
NO. 91	1.697	-6.300		
NO. 91	1.697	-6.460		
NO. 91	1.697	-6.620		
NO. 91	1.697	-6.780		
NO. 91	1.697	-6.940		
NO. 91	1.697	-7.100		
NO. 91	1.697	-7.260		
NO. 91	1.697	-7.420		
NO. 91	1.697	-7.580		
NO. 91	1.697	-7.740		
NO. 91	1.697	-7.900		
NO. 91	1.697	-8.060		
NO. 91	1.697	-8.220		
NO. 91	1.697	-8.380		
NO. 91	1.697	-8.540		
NO. 91	1.697	-8.700		
NO. 91	1.697	-8.860		
NO. 91	1.697	-9.020		
NO. 91	1.697	-9.180		
NO. 91	1.697	-9.340		
NO. 91	1.697	-9.500		
NO. 91	1.697	-9.660		
NO. 91	1.697	-9.820		
NO. 91	1.697	-9.980		
NO. 91	1.697	-10.140		
NO. 91	1.697	-10.300		
NO. 91	1.697	-10.460		
NO. 91	1.697	-10.620		
NO. 91	1.697	-10.780		
NO. 91	1.697	-10.940		
NO. 91	1.697	-11.100		
NO. 91	1.697	-11.260		
NO. 91	1.697	-11.420		
NO. 91	1.697	-11.580		
NO. 91	1.697	-11.740		
NO. 91	1.697	-11.900		
NO. 91	1.697	-12.060		
NO. 91	1.697	-12.220		
NO. 91	1.697	-12.380		
NO. 91	1.697	-12.540		
NO. 91	1.697	-12.700		
NO. 91	1.697	-12.860		
NO. 91	1.697	-13.020		
NO. 91	1.697	-13.180		
NO. 91	1.697	-13.340		
NO. 91	1.697	-13.500		
NO. 91	1.697	-13.660		
NO. 91	1.697	-13.820		
NO. 91	1.697	-13.980		
NO. 91	1.697	-14.140		
NO. 91	1.697	-14.300		
NO. 91	1.697	-14.460		
NO. 91	1.697	-14.620		
NO. 91	1.697	-14.780		
NO. 91	1.697	-14.940		
NO. 91	1.697	-15.100		
NO. 91	1.697	-15.260		
NO. 91	1.697	-15.420		
NO. 91	1.697	-15.580		
NO. 91	1.697	-15.740		
NO. 91	1.697	-15.900		
NO. 91	1.697	-16.060		
NO. 91	1.697	-16.220		
NO. 91	1.697	-16.380		
NO. 91	1.697	-16.540		
NO. 91	1.697	-16.700		
NO. 91	1.697	-16.860		
NO. 91	1.697	-17.020		
NO. 91	1.697	-17.180		
NO. 91	1.697	-17.340		
NO. 91	1.697	-17.500		
NO. 91	1.697	-17.660		
NO. 91	1.697	-17.820		
NO. 91	1.697	-17.980		
NO. 91	1.697	-18.140		
NO. 91	1.697	-18.300		
NO. 91	1.697	-18.460		
NO. 91	1.697	-18.620		
NO. 91	1.697	-18.780		
NO. 91	1.697	-18.940		
NO. 91	1.697	-19.100		
NO. 91	1.697	-19.260		
NO. 91	1.697	-19.420		
NO. 91	1.697	-19.580		
NO. 91	1.697	-19.740		
NO. 91	1.697	-19.900		
NO. 91	1.697	-20.060		
NO. 91	1.697	-20.220		
NO. 91	1.697	-20.380		
NO. 91	1.697	-20.540		
NO. 91	1.697	-20.700		
NO. 91	1.697	-20.860		
NO. 91	1.697	-21.020		
NO. 91	1.697	-21.180		
NO. 91	1.697	-21.340		
NO. 91	1.697	-21.500		
NO. 91	1.697	-21.660		
NO. 91	1.697	-21.820		
NO. 91	1.697	-21.980		
NO. 91	1.697	-22.140		
NO. 91	1.697	-22.300		
NO. 91	1.697	-22.460		
NO. 91	1.697	-22.620		
NO. 91	1.697	-22.780		
NO. 91	1.697	-22.940		
NO. 91	1.697	-23.100		
NO. 91	1.697	-23.260		
NO. 91	1.697	-23.420		
NO. 91	1.697	-23.580		
NO. 91	1.697	-23.740		
NO. 91	1.697	-23.900		
NO. 91	1.697	-24.060		
NO. 91	1.697	-24.220		
NO. 91	1.697	-24.380		
NO. 91	1.697	-24.540		
NO. 91	1.697	-24.700		
NO. 91	1.697	-24.860		
NO. 91	1.697	-25.020		
NO. 91	1.697	-25.180		
NO. 91	1.697	-25.340		
NO. 91	1.697	-25.500		
NO. 91	1.697	-25.660		
NO. 91	1.697	-25.820		
NO. 91	1.697	-25.980		
NO. 91	1.697	-26.140		
NO. 91	1.697	-26.300		
NO. 91	1.697	-26.460		
NO. 91	1.697	-26.620		
NO. 91	1.697	-26.780		
NO. 91	1.697	-26.940		
NO. 91	1.697	-27.100		
NO. 91	1.697	-27.260		
NO. 91	1.697	-27.420		
NO. 91	1.697	-27.580		
NO. 91	1.697	-27.740		
NO. 91	1.697	-27.900		
NO. 91	1.697	-28.060		
NO. 91	1.697	-28.220		
NO. 91	1.697	-28.380		
NO. 91	1.697	-28.540		
NO. 91	1.697	-28.700		
NO. 91	1.697	-28.860		
NO. 91	1.697	-29.020		
NO. 91	1.697	-29.180		
NO. 91	1.697	-29.340		
NO. 91	1.697	-29.500		
NO. 91	1.697	-29.660		
NO. 91	1.697	-29.820		
NO. 91	1.697	-29.980		
NO. 91	1.697	-30.140		
NO. 91	1.697	-30.300		
NO. 91	1.697	-30.460		
NO. 91	1.697	-30.620		
NO. 91	1.697	-30.780		
NO. 91	1.697	-30.940		
NO. 91	1.697	-31.100		
NO. 91	1.697	-31.260		
NO. 91	1.697	-31.420		
NO. 91	1.697	-31.580		
NO. 91	1.697	-31.740		
NO. 91	1.697	-31.900		
NO. 91	1.697	-32.060		
NO. 91	1.697	-32.220		
NO. 91	1.697	-32.380		
NO. 91	1.697	-32.540		
NO. 91	1.697	-32.700		
NO. 91	1.697	-32.860		
NO. 91	1.697	-33.020		
NO. 91	1.697	-33.180		
NO. 91	1.697	-33.340		
NO. 91	1.697	-33.500		
NO. 91	1.697	-33.660		
NO. 91	1.697	-33.820		
NO. 91	1.697	-33.980		

PLAN NO. 105+0.0 ~ 112+0.0

S=1:2000

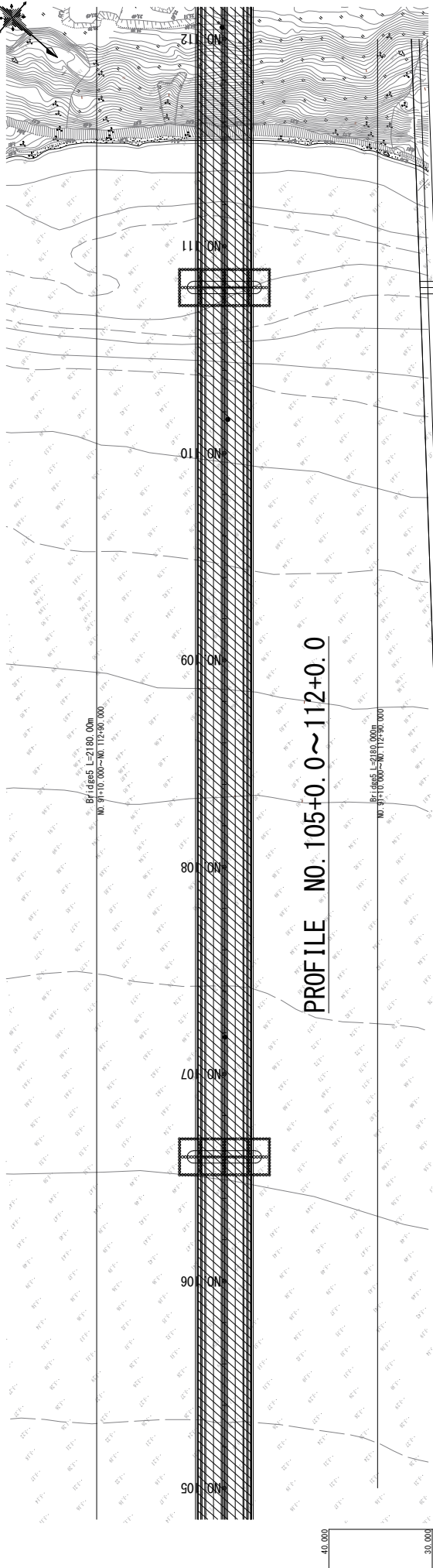

PROFILE NO. 105+0.0 ~ 112+0.0



Station	Ground Height	Fill	Cut	Grade
NO. 105+0.000	26.940			30.100
NO. 105+100.000	26.940			30.100
NO. 105+200.000	27.142			30.335
NO. 105+300.000	27.331			30.602
NO. 105+400.000	27.507			30.796
NO. 105+500.000	27.670			31.008
NO. 105+600.000	27.820			31.207
NO. 105+700.000	27.950			31.430
NO. 105+800.000	28.100			31.575
NO. 105+900.000	28.240			31.774
NO. 106+000.000	28.380			31.989
NO. 106+100.000	28.520			32.151
NO. 106+200.000	28.660			32.322
NO. 106+300.000	28.800			32.534
NO. 106+400.000	28.940			32.724
NO. 106+500.000	29.080			32.906
NO. 106+600.000	29.220			33.109
NO. 106+700.000	29.360			33.252
NO. 106+800.000	29.500			33.586
NO. 106+900.000	29.640			33.703
NO. 107+000.000	29.780			33.813
NO. 107+100.000	29.920			33.891
NO. 107+200.000	30.060			33.948
NO. 107+300.000	30.200			33.991
NO. 107+400.000	30.340			34.053
NO. 107+500.000	30.480			34.078
NO. 107+600.000	30.620			34.091
NO. 107+700.000	30.760			34.172
NO. 107+800.000	30.900			34.022
NO. 107+900.000	31.040			33.254
NO. 108+000.000	31.180			33.153
NO. 108+100.000	31.320			33.182
NO. 108+200.000	31.460			33.013
NO. 108+300.000	31.600			32.465
NO. 108+400.000	31.740			23.095
NO. 108+500.000	31.880			14.009
NO. 108+600.000	32.020			8.705

JAPAN INTERNATIONAL COOPERATION AGENCY (JICA)

CENTRAL CONSULTANT INC. & NIPPON KOEI CO., LTD

M-14 BYPASS Route3
PLAN · PROFILE(16)

SCALE
1/2000

No.
41

ADDITIONAL STUDY ON THE PROJECT FOR
CONSTRUCTION OF MYKOLAIV BRIDGE IN UKRAINE

PLAN NO. 119+0.0 ~ 126+0.0

S=1:2000

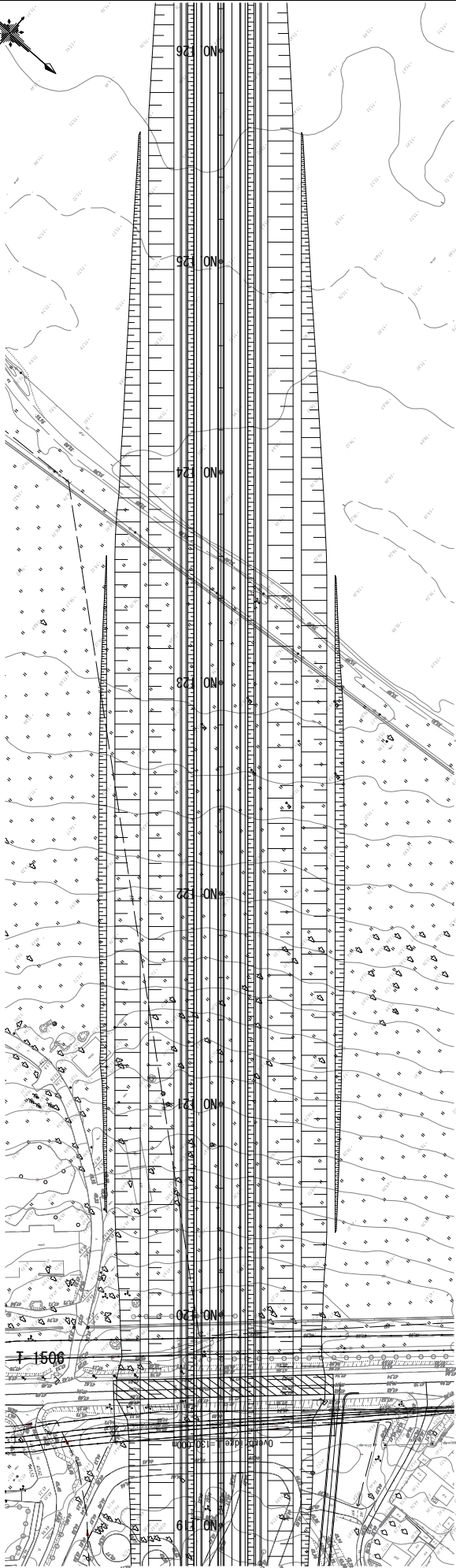

PROFILE NO. 119+0.0 ~ 126+0.0

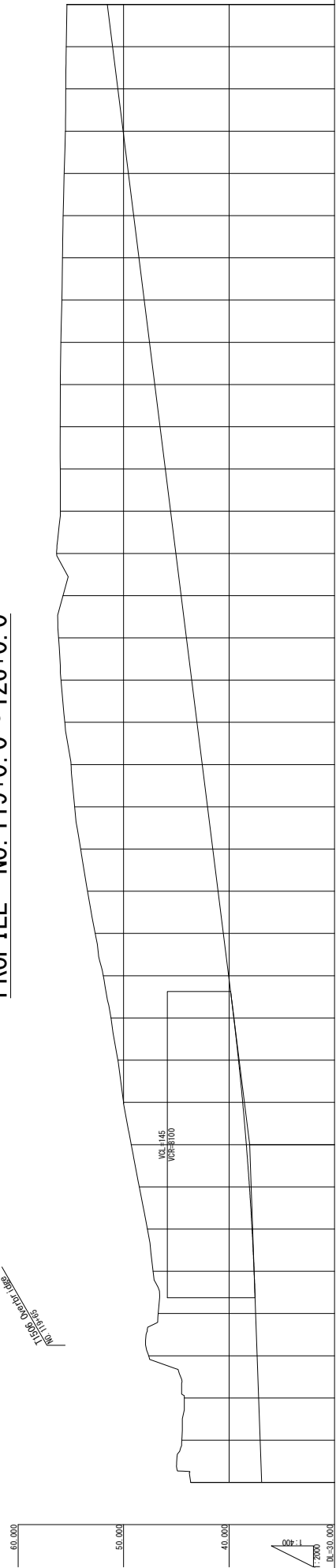

Station	Ground Height	Proposed Height	Cut	Fill	Grade
NO. 119+0.000	43.630	38.920	6.710		
NO. 120+0.000	44.481	37.060	7.421		
NO. 120+0.000	44.250	37.200	7.050		
NO. 120+0.000	47.630	37.240	10.290		
NO. 120+0.000	46.716	37.480	9.236		
NO. 120+0.000	47.202	37.630	9.572		
NO. 120+0.000	47.742	37.826	9.916		
NO. 120+0.000	48.516	38.071	10.445		
NO. 120+0.000	49.285	38.267	10.918		
NO. 120+0.000	50.002	38.711	11.291		
NO. 121+0.000	50.548	39.106	11.442		
NO. 121+0.000	51.209	39.550	11.659		
NO. 121+0.000	51.925	40.040	11.885		
NO. 121+0.000	52.694	40.540	12.154		
NO. 121+0.000	53.411	41.040	12.371		
NO. 121+0.000	54.069	41.540	12.529		
NO. 122+0.000	54.638	42.040	12.598		
NO. 122+0.000	55.319	42.540	12.770		
NO. 122+0.000	55.978	43.040	12.938		
NO. 122+0.000	56.617	43.540	13.071		
NO. 122+0.000	57.236	44.040	13.196		
NO. 122+0.000	57.835	44.540	13.295		
NO. 122+0.000	58.414	45.040	13.370		
NO. 122+0.000	58.973	45.540	13.433		
NO. 122+0.000	59.512	46.040	13.475		
NO. 122+0.000	60.031	46.540	13.496		
NO. 122+0.000	60.530	47.040	13.497		
NO. 122+0.000	61.009	47.540	13.468		
NO. 122+0.000	61.468	48.040	13.419		
NO. 122+0.000	61.907	48.540	13.360		
NO. 122+0.000	62.326	49.040	13.281		
NO. 122+0.000	62.725	49.540	13.182		
NO. 122+0.000	63.104	50.040	13.063		
NO. 122+0.000	63.463	50.540	12.924		
NO. 122+0.000	63.802	51.040	12.765		
NO. 122+0.000	64.121	51.540	12.586		
NO. 122+0.000	64.420	52.040	12.387		
NO. 122+0.000	64.699	52.540	12.168		
NO. 122+0.000	64.958	53.040	11.929		
NO. 122+0.000	65.197	53.540	11.670		
NO. 122+0.000	65.416	54.040	11.391		
NO. 122+0.000	65.615	54.540	11.092		
NO. 122+0.000	65.794	55.040	10.773		
NO. 122+0.000	65.953	55.540	10.434		
NO. 122+0.000	66.092	56.040	10.075		
NO. 122+0.000	66.211	56.540	9.696		
NO. 122+0.000	66.310	57.040	9.297		
NO. 122+0.000	66.389	57.540	8.878		
NO. 122+0.000	66.448	58.040	8.439		
NO. 122+0.000	66.487	58.540	7.980		
NO. 122+0.000	66.506	59.040	7.501		
NO. 122+0.000	66.505	59.540	7.002		
NO. 122+0.000	66.484	60.040	6.483		
NO. 122+0.000	66.443	60.540	5.944		
NO. 122+0.000	66.382	61.040	5.385		
NO. 122+0.000	66.301	61.540	4.806		
NO. 122+0.000	66.200	62.040	4.207		
NO. 122+0.000	66.089	62.540	3.588		
NO. 122+0.000	65.968	63.040	2.949		
NO. 122+0.000	65.837	63.540	2.290		
NO. 122+0.000	65.696	64.040	1.611		
NO. 122+0.000	65.545	64.540	921		
NO. 122+0.000	65.384	65.040	11.309		
NO. 122+0.000	65.213	65.540	13.330		
NO. 122+0.000	65.032	66.040	15.008		
NO. 122+0.000	64.841	66.540	16.349		
NO. 122+0.000	64.640	67.040	17.350		
NO. 122+0.000	64.429	67.540	18.011		
NO. 122+0.000	64.208	68.040	18.332		
NO. 122+0.000	63.977	68.540	18.313		
NO. 122+0.000	63.736	69.040	17.954		
NO. 122+0.000	63.485	69.540	17.265		
NO. 122+0.000	63.224	70.040	16.246		
NO. 122+0.000	62.953	70.540	14.897		
NO. 122+0.000	62.672	71.040	13.218		
NO. 122+0.000	62.381	71.540	11.219		
NO. 122+0.000	62.080	72.040	9.800		
NO. 122+0.000	61.769	72.540	8.061		
NO. 122+0.000	61.448	73.040	5.992		
NO. 122+0.000	61.117	73.540	3.593		
NO. 122+0.000	60.776	74.040	834		
NO. 122+0.000	60.425	74.540	11.143		
NO. 122+0.000	60.064	75.040	22.284		
NO. 122+0.000	59.693	75.540	33.125		
NO. 122+0.000	59.312	76.040	43.666		
NO. 122+0.000	58.921	76.540	53.907		
NO. 122+0.000	58.520	77.040	63.848		
NO. 122+0.000	58.109	77.540	73.489		
NO. 122+0.000	57.688	78.040	82.830		
NO. 122+0.000	57.257	78.540	91.871		
NO. 122+0.000	56.816	79.040	100.612		
NO. 122+0.000	56.365	79.540	109.053		
NO. 122+0.000	55.904	80.040	117.194		
NO. 122+0.000	55.433	80.540	125.035		
NO. 122+0.000	54.952	81.040	132.576		
NO. 122+0.000	54.461	81.540	139.817		
NO. 122+0.000	53.960	82.040	146.758		
NO. 122+0.000	53.449	82.540	153.409		
NO. 122+0.000	52.928	83.040	159.760		
NO. 122+0.000	52.397	83.540	165.811		
NO. 122+0.000	51.856	84.040	171.562		
NO. 122+0.000	51.305	84.540	177.013		
NO. 122+0.000	50.744	85.040	182.164		
NO. 122+0.000	50.173	85.540	187.015		
NO. 122+0.000	49.592	86.040	191.566		
NO. 122+0.000	49.001	86.540	195.817		
NO. 122+0.000	48.390	87.040	199.768		
NO. 122+0.000	47.759	87.540	203.419		
NO. 122+0.000	47.108	88.040	206.770		
NO. 122+0.000	46.437	88.540	209.821		
NO. 122+0.000	45.746	89.040	212.572		
NO. 122+0.000	45.035	89.540	215.023		
NO. 122+0.000	44.304	90.040	217.174		
NO. 122+0.000	43.553	90.540	218.925		
NO. 122+0.000	42.782	91.040	220.276		
NO. 122+0.000	42.001	91.540	221.227		
NO. 122+0.000	41.210	92.040	221.778		
NO. 122+0.000	40.409	92.540	221.929		
NO. 122+0.000	39.598	93.040	221.680		
NO. 122+0.000	38.777	93.540	221.031		
NO. 122+0.000	37.946	94.040	209.982		
NO. 122+0.000	37.105	94.540	198.533		
NO. 122+0.000	36.254	95.040	186.684		
NO. 122+0.000	35.393	95.540	174.435		
NO. 122+0.000	34.522	96.040	161.786		
NO. 122+0.000	33.641	96.540	148.737		
NO. 122+0.000	32.750	97.040	135.288		
NO. 122+0.000	31.849	97.540	121.539		
NO. 122+0.000	30.938	98.040	107.490		
NO. 122+0.000	30.017	98.540	93.141		
NO. 122+0.000	29.086	99.040	78.492		
NO. 122+0.000	28.145	99.540	63.543		
NO. 122+0.000	27.194	100.040	48.294		
NO. 122+0.000	26.233	100.540	32.745		
NO. 122+0.000	25.262	101.040	16.896		
NO. 122+0.000	24.281	101.540	0.747		
NO. 122+0.000	23.290	102.040	-15.802		
NO. 122+0.000	22.289	102.540	-32.053		
NO. 122+0.000	21.278	103.040	-47.954		
NO. 122+0.000	20.257	103.540	-63.505		
NO. 122+0.000	19.226	104.040	-78.706		
NO. 122+0.000	18.185	104.540	-93.557		
NO. 122+0.000	17.134	105.040	-108.058		
NO. 122+0.000	16.073	105.540	-122.209		
NO. 122+0.000	15.002	106.040	-136.010		
NO. 122+0.000	13.921	106.540	-149.461		
NO. 122+0.000	12.830	107.040	-162.562		
NO. 122+0.000	11.729	107.540	-175.313		
NO. 122+0.000	10.618	108.040	-187.714		
NO. 122+0.000	9.507	108.540	-199.765		
NO. 122+0.000	8.386	109.040	-211.466		
NO. 122+0.000	7.255	109.540	-222.817		
NO. 122+0.000	6.114	110.040	-233.818		
NO. 122+0.000	4.963	110.540	-244.469		
NO. 122+0.000	3.802	111.040	-254.770		
NO. 122+0.000	2.631	111.540	-264.721		
NO. 122+0.000	1.450	112.040	-274.322		
NO. 122+0.000	0.269	112.540	-283.573		
NO. 122+0.000	-0.912	113.040	-292.474		
NO. 122+0.000	-2.083	113.540	-301.025		
NO. 122+0.000	-3.254	114.040	-309.226		
NO. 122+0.000	-4.425	114.540	-317.077		
NO. 122+0.000	-5.596	115.040	-324.578		
NO. 122+0.000	-6.767	115.540	-331.729		
NO. 122+0.000	-7.938	116.040	-338.530		
NO. 122+0.000	-9.109	116.540	-345.081		
NO. 122+0.000	-10.280	117.040	-351.382		
NO. 122+0.000	-11.451	117.540	-357.433		
NO. 122+0.000	-12.622	118.040	-363.234		
NO. 122+0.000	-13.793	118.540	-368.785		
NO. 122+0.000	-14.964	119.040	-374.086		
NO. 122+0.000	-16.135	119.540	-379.137		
NO. 122+0.000	-17.306	120.040	-383.938		
NO. 122+0.000	-18.477	120.540	-388.489		
NO. 122+0.000	-19.648	121.040	-392.790		
NO. 122+0.000	-20.819	121.540	-396.841		
NO. 122+0.000	-21.990	122.040	-400.642		
NO. 122+0.000	-23.161	122.540	-404.193		
NO. 122+0.000	-24.332	123.040	-407.494		
NO. 122+0.000	-25.503	123.540	-410.545		
NO. 122+0.000	-26.674	124.040	-413.346		
NO. 122+0.000	-27.845	124.540	-415.897		
NO. 122+0.000	-29.016	125.040	-418.208		
NO. 122+0.000	-30.187	125.540	-420.279		
NO. 122+0.000	-31.358	126.040	-422.110		
NO. 122+0.000	-32.529	126.540	-423.701		
NO. 122+0.000	-33.700	127.040	-425.052		
NO. 122+0.000	-34.871	127.540	-426.163		

PLAN NO. 126+0.0 ~ 133+0.0

S=1:2000

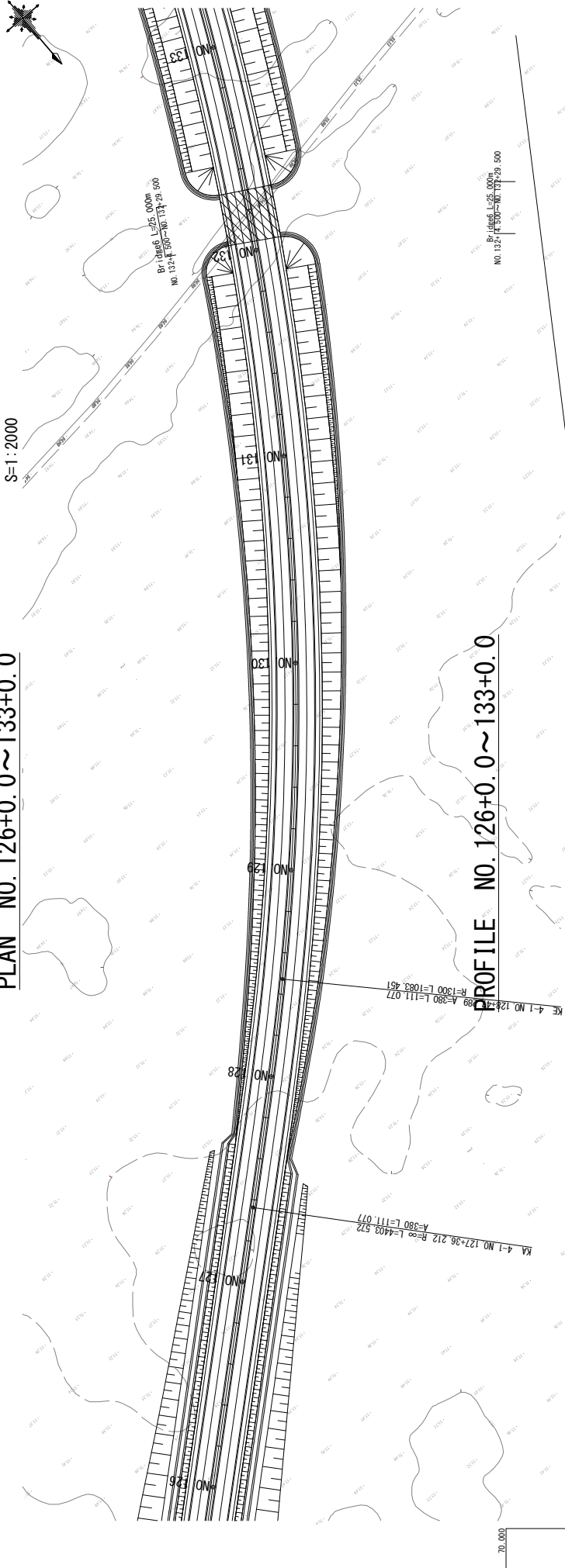

PROFILE NO. 126+0.0 ~ 133+0.0

Br: 14966 L=25.000m
No. 132, H: 300 ~ No. 132+9.500

70.000
60.000
50.000

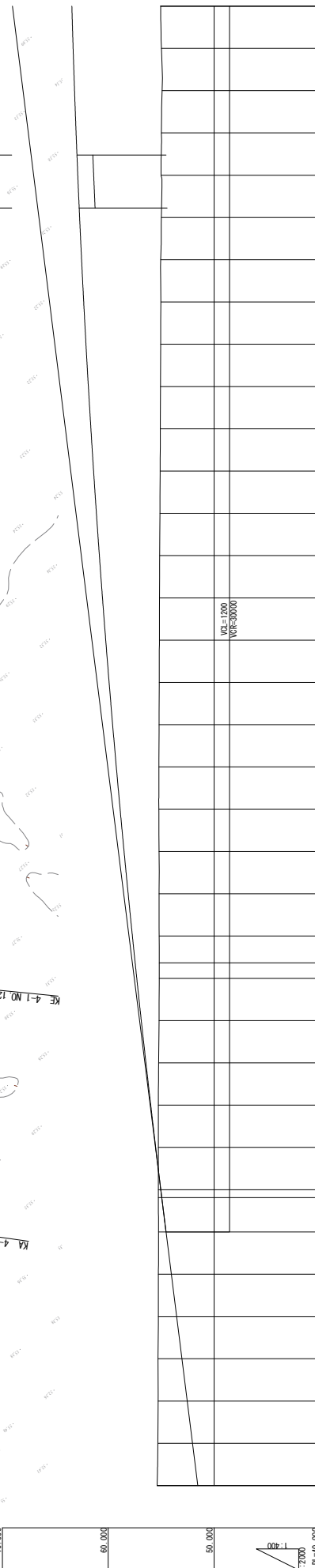

Station	Ground Height	Proposed Height	Cut	Fill	Grade
NO. 126+55.372	51.540	52.040	0.832		
NO. 127+55.256	54.040	54.040		1.216	
NO. 128+55.233	56.434	56.434		1.201	
NO. 129+55.195	58.500	58.500		3.305	
NO. 130+55.166	60.234	60.234		5.068	
NO. 131+55.074	61.634	61.634		6.560	
NO. 132+54.972	62.700	62.700		7.728	
NO. 133+54.914	62.514	62.514		7.470	
NO. 134+54.914	62.314	62.314		7.288	
NO. 135+54.914	62.100	62.100		7.059	
NO. 136+54.914	61.874	61.874		6.816	
NO. 137+54.914	61.634	61.634		6.560	
NO. 138+54.914	61.380	61.380		6.288	
NO. 139+54.914	61.114	61.114		6.001	
NO. 140+54.914	60.834	60.834		5.700	
NO. 141+54.914	60.540	60.540		5.389	
NO. 142+54.914	60.234	60.234		5.068	
NO. 143+54.914	59.914	59.914		4.733	
NO. 144+54.914	59.580	59.580		4.382	
NO. 145+54.914	59.234	59.234		4.023	
NO. 146+54.914	58.874	58.874		3.660	
NO. 147+54.914	58.500	58.500		3.305	
NO. 148+54.914	58.114	58.114		2.927	
NO. 149+54.914	57.714	57.714		2.530	
NO. 150+54.914	57.300	57.300		2.119	
NO. 151+54.914	56.874	56.874		1.680	
NO. 152+54.914	56.434	56.434		1.201	
NO. 153+54.914	55.980	55.980		0.719	
NO. 154+54.914	55.514	55.514		0.251	
NO. 155+54.914	55.040	55.040			
NO. 156+54.914	54.540	54.540			
NO. 157+54.540	54.040	54.040			
NO. 158+54.040	53.540	53.540			
NO. 159+53.040	52.540	52.540			
NO. 160+52.040	52.040	52.040			
NO. 161+51.540	51.540	51.540			
NO. 162+51.040	51.040	51.040			
NO. 163+50.540	50.540	50.540			
NO. 164+50.040	50.040	50.040			
NO. 165+49.540	49.540	49.540			
NO. 166+49.040	49.040	49.040			
NO. 167+48.540	48.540	48.540			
NO. 168+48.040	48.040	48.040			
NO. 169+47.540	47.540	47.540			
NO. 170+47.040	47.040	47.040			
NO. 171+46.540	46.540	46.540			
NO. 172+46.040	46.040	46.040			
NO. 173+45.540	45.540	45.540			
NO. 174+45.040	45.040	45.040			
NO. 175+44.540	44.540	44.540			
NO. 176+44.040	44.040	44.040			
NO. 177+43.540	43.540	43.540			
NO. 178+43.040	43.040	43.040			
NO. 179+42.540	42.540	42.540			
NO. 180+42.040	42.040	42.040			
NO. 181+41.540	41.540	41.540			
NO. 182+41.040	41.040	41.040			
NO. 183+40.540	40.540	40.540			
NO. 184+40.040	40.040	40.040			
NO. 185+39.540	39.540	39.540			
NO. 186+39.040	39.040	39.040			
NO. 187+38.540	38.540	38.540			
NO. 188+38.040	38.040	38.040			
NO. 189+37.540	37.540	37.540			
NO. 190+37.040	37.040	37.040			
NO. 191+36.540	36.540	36.540			
NO. 192+36.040	36.040	36.040			
NO. 193+35.540	35.540	35.540			
NO. 194+35.040	35.040	35.040			
NO. 195+34.540	34.540	34.540			
NO. 196+34.040	34.040	34.040			
NO. 197+33.540	33.540	33.540			
NO. 198+33.040	33.040	33.040			
NO. 199+32.540	32.540	32.540			
NO. 200+32.040	32.040	32.040			
NO. 201+31.540	31.540	31.540			
NO. 202+31.040	31.040	31.040			
NO. 203+30.540	30.540	30.540			
NO. 204+30.040	30.040	30.040			
NO. 205+29.540	29.540	29.540			
NO. 206+29.040	29.040	29.040			
NO. 207+28.540	28.540	28.540			
NO. 208+28.040	28.040	28.040			
NO. 209+27.540	27.540	27.540			
NO. 210+27.040	27.040	27.040			
NO. 211+26.540	26.540	26.540			
NO. 212+26.040	26.040	26.040			
NO. 213+25.540	25.540	25.540			
NO. 214+25.040	25.040	25.040			
NO. 215+24.540	24.540	24.540			
NO. 216+24.040	24.040	24.040			
NO. 217+23.540	23.540	23.540			
NO. 218+23.040	23.040	23.040			
NO. 219+22.540	22.540	22.540			
NO. 220+22.040	22.040	22.040			
NO. 221+21.540	21.540	21.540			
NO. 222+21.040	21.040	21.040			
NO. 223+20.540	20.540	20.540			
NO. 224+20.040	20.040	20.040			
NO. 225+19.540	19.540	19.540			
NO. 226+19.040	19.040	19.040			
NO. 227+18.540	18.540	18.540			
NO. 228+18.040	18.040	18.040			
NO. 229+17.540	17.540	17.540			
NO. 230+17.040	17.040	17.040			
NO. 231+16.540	16.540	16.540			
NO. 232+16.040	16.040	16.040			
NO. 233+15.540	15.540	15.540			
NO. 234+15.040	15.040	15.040			
NO. 235+14.540	14.540	14.540			
NO. 236+14.040	14.040	14.040			
NO. 237+13.540	13.540	13.540			
NO. 238+13.040	13.040	13.040			
NO. 239+12.540	12.540	12.540			
NO. 240+12.040	12.040	12.040			
NO. 241+11.540	11.540	11.540			
NO. 242+11.040	11.040	11.040			
NO. 243+10.540	10.540	10.540			
NO. 244+10.040	10.040	10.040			
NO. 245+9.540	9.540	9.540			
NO. 246+9.040	9.040	9.040			
NO. 247+8.540	8.540	8.540			
NO. 248+8.040	8.040	8.040			
NO. 249+7.540	7.540	7.540			
NO. 250+7.040	7.040	7.040			
NO. 251+6.540	6.540	6.540			
NO. 252+6.040	6.040	6.040			
NO. 253+5.540	5.540	5.540			
NO. 254+5.040	5.040	5.040			
NO. 255+4.540	4.540	4.540			
NO. 256+4.040	4.040	4.040			
NO. 257+3.540	3.540	3.540			
NO. 258+3.040	3.040	3.040			
NO. 259+2.540	2.540	2.540			
NO. 260+2.040	2.040	2.040			
NO. 261+1.540	1.540	1.540			
NO. 262+1.040	1.040	1.040			
NO. 263+0.540	0.540	0.540			
NO. 264+0.040	0.040	0.040			
NO. 265+0.000	0.000	0.000			
NO. 266+0.000	0.000	0.000			
NO. 267+0.000	0.000	0.000			
NO. 268+0.000	0.000	0.000			
NO. 269+0.000	0.000	0.000			
NO. 270+0.000	0.000	0.000			
NO. 271+0.000	0.000	0.000			
NO. 272+0.000	0.000	0.000			
NO. 273+0.000	0.000	0.000			
NO. 274+0.000	0.000	0.000			
NO. 275+0.000	0.000	0.000			
NO. 276+0.000	0.000	0.000			
NO. 277+0.000	0.000	0.000			
NO. 278+0.000	0.000	0.000			
NO. 279+0.000	0.000	0.000			
NO. 280+0.000	0.000	0.000			
NO. 281+0.000	0.000	0.000			
NO. 282+0.000	0.000	0.000			
NO. 283+0.000	0.000	0.000			
NO. 284+0.000	0.000	0.000			
NO. 285+0.000	0.000	0.000			
NO. 286+0.000	0.000	0.000			
NO. 287+0.000	0.000	0.000			
NO. 288+0.000	0.000	0.000			
NO. 289+0.000	0.000	0.000			
NO. 290+0.000	0.000	0.000			
NO. 291+0.000	0.000	0.000			
NO. 292+0.000	0.000	0.000			
NO. 293+0.000	0.000	0.000			
NO. 294+0.000	0.000	0.000			
NO. 295+0.000	0.000	0.000			
NO. 296+0.000	0.000	0.000			
NO. 297+0.000	0.000	0.000			
NO. 298+0.000	0.000	0.000			
NO. 299+0.000	0.000	0.000			
NO. 300+0.000	0.000	0.000			

ADDITIONAL STUDY ON THE PROJECT FOR CONSTRUCTION OF MYKOLAIV BRIDGE IN UKRAINE

JAPAN INTERNATIONAL COOPERATION AGENCY (JICA)
CENTRAL CONSULTANT INC. & NIPPON KOEI CO., LTD

M-14 BYPASS Route3
PLAN · PROFILE(19)

SCALE 1/2000
No. 44

PLAN NO. 140+0.0 ~ 147+0.0

S=1:2000

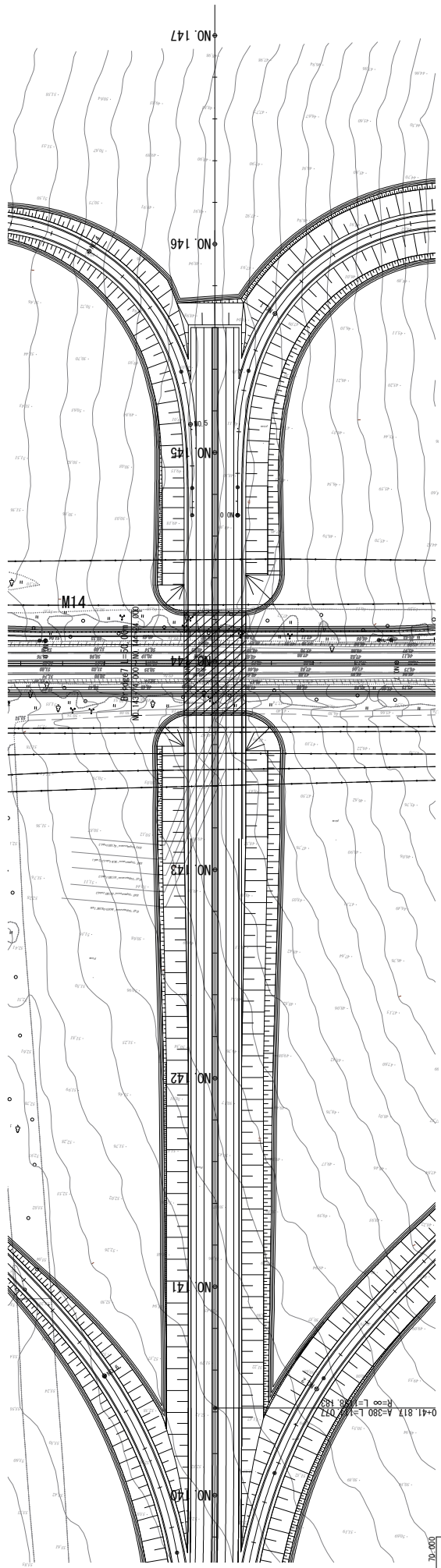

PROFILE NO. 140+0.0 ~ 147+0.0

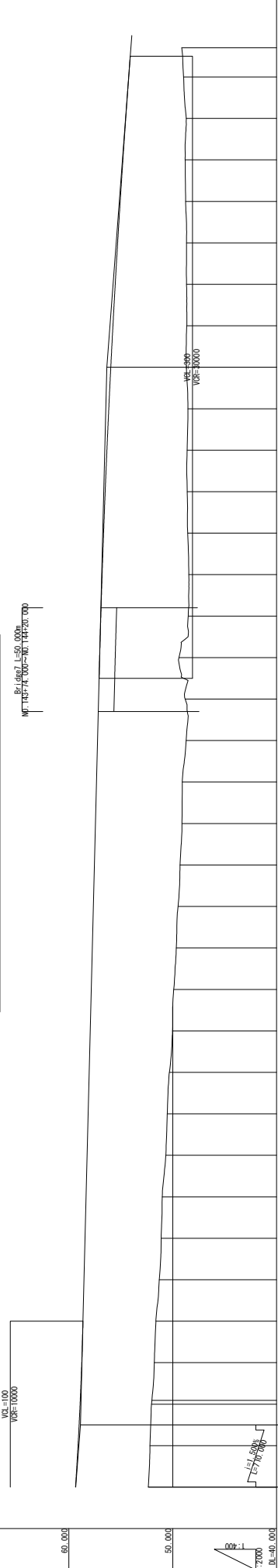

Station	Ground Height	Proposed Height	Fill	Cut
NO. 140	52.352	59.380	7.028	
NO. 140+000	52.194	59.120	6.926	
NO. 140+005	52.125	59.015	6.890	
NO. 140+010	52.048	58.920	6.872	
NO. 140+015	52.015	58.904	6.889	
NO. 140+020	51.909	58.340	7.431	
NO. 140+025	51.618	58.640	7.022	
NO. 141	51.291	58.540	7.249	
NO. 141+000	51.112	58.440	7.328	
NO. 141+005	51.009	58.340	7.331	
NO. 141+010	50.665	58.240	7.575	
NO. 141+015	50.531	58.140	7.609	
NO. 142	50.324	58.040	7.716	
NO. 142+000	49.903	57.840	7.937	
NO. 142+005	49.652	57.740	8.088	
NO. 142+010	49.485	57.640	8.155	
NO. 143	49.297	57.540	8.243	
NO. 143+000	49.118	57.440	8.322	
NO. 143+005	49.081	57.340	8.259	
NO. 143+010	49.705	57.240	8.535	
NO. 143+015	48.806	57.140	8.334	
NO. 144	48.402	57.038	8.637	
NO. 144+000	48.508	56.925	8.417	
NO. 144+005	48.452	56.799	8.347	
NO. 144+010	48.557	56.659	8.102	
NO. 144+015	48.601	56.505	7.904	
NO. 145	48.610	56.339	7.729	
NO. 145+000	48.535	56.159	7.624	
NO. 145+005	48.688	55.965	7.279	
NO. 145+010	48.651	55.759	7.108	
NO. 145+015	48.617	55.538	6.868	
NO. 146	48.617	55.305	6.634	
NO. 146+000	48.760	55.059	6.299	
NO. 146+005	48.802	54.799	5.997	
NO. 146+010	48.702	54.525	5.823	
NO. 146+015	48.954	54.239	5.285	
NO. 147	53.940			

ADDITIONAL STUDY ON THE PROJECT FOR CONSTRUCTION OF MYKOLAIY BRIDGE IN UKRAINE		JAPAN INTERNATIONAL COOPERATION AGENCY(JICA) CENTRAL CONSULTANT INC. & NIPPON KOEI CO., LTD		TITLE M-14 BYPASS Route3 PLAN・PROFILE(21)		SCALE 1/2000 No. 46	
---	--	--	--	---	--	---------------------------	--

PLAN NO. 147+0.0 ~ 151+40.0

S=1:2000

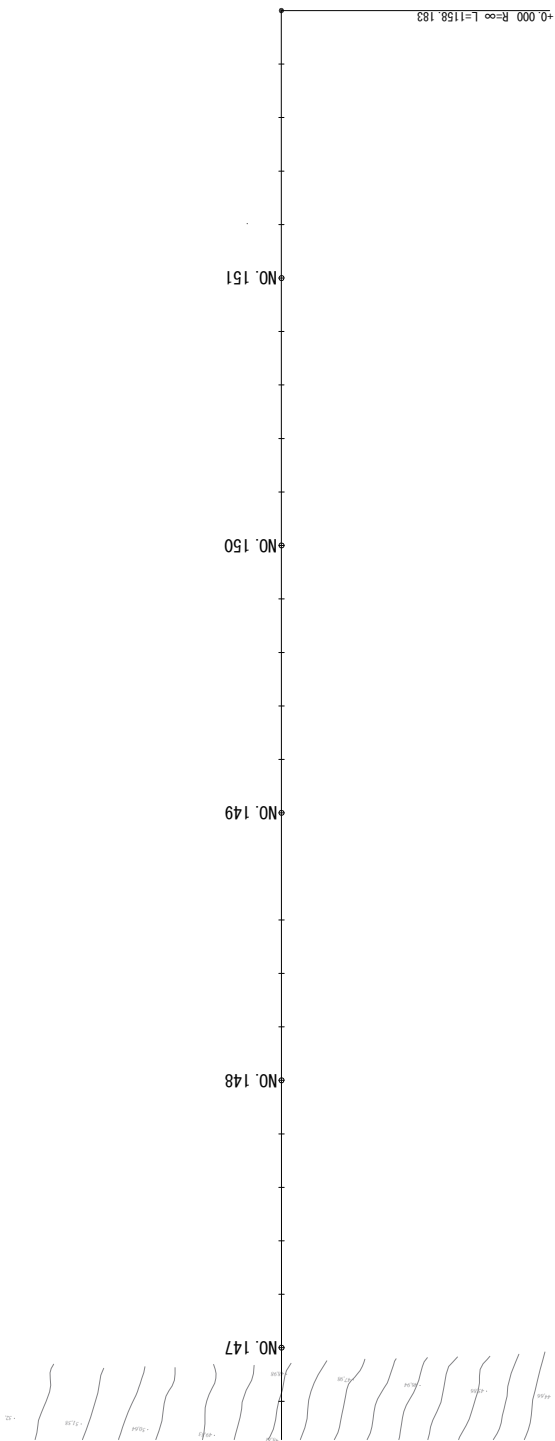

PROFILE NO. 147+0.0 ~ 151+40.0

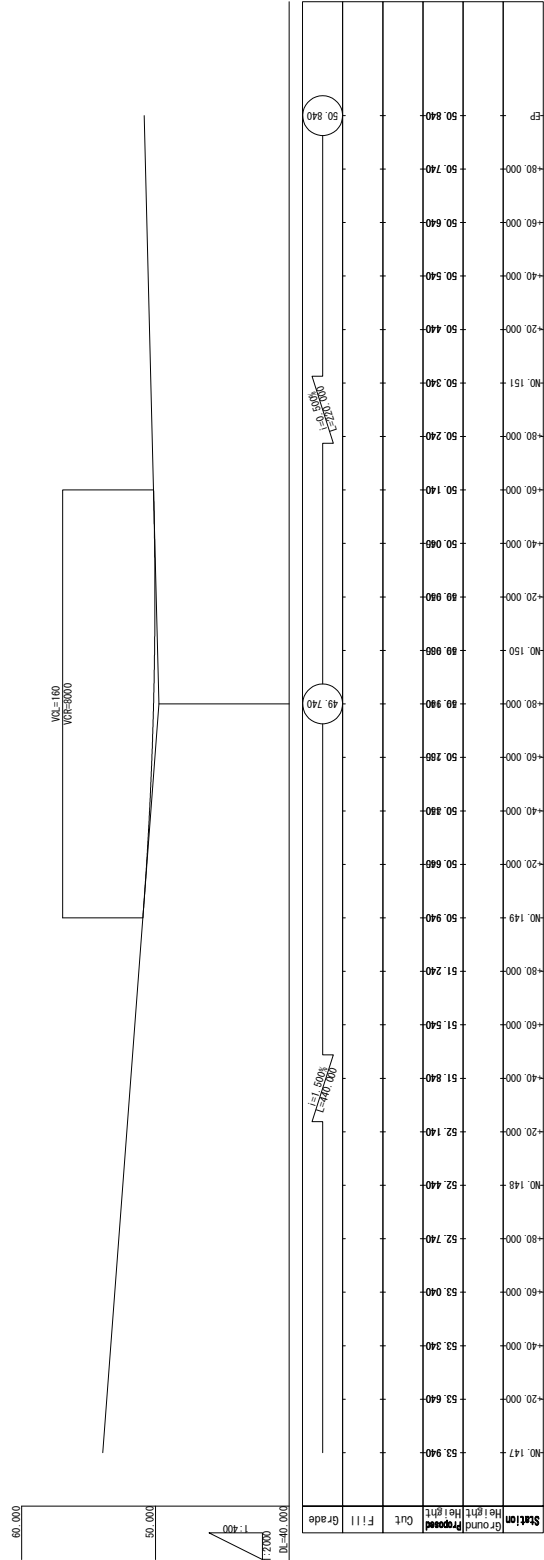

ADDITIONAL STUDY ON THE PROJECT FOR
CONSTRUCTION OF MYKOLAIV BRIDGE IN UKRAINE

JAPAN INTERNATIONAL COOPERATION AGENCY (JICA)

CENTRAL CONSULTANT INC. & NIPPON KOEI CO., LTD

TITLE

M-14 BYPASS Route3
PLAN · PROFILE(22)

SCALE

1/2000

No.

47

INTERCHANGE PLAN (1)

S=1:5000

Interchange at Origin (Route 2, 3)



ADDITIONAL STUDY ON THE PROJECT FOR
CONSTRUCTION OF MYKOLAIV BRIDGE IN UKRAINE

JAPAN INTERNATIONAL COOPERATION AGENCY (JICA)

CENTRAL CONSULTANT INC. & NIPPON KOEI CO., LTD

TITLE
INTERCHANGE PLAN(1) Interchange at Origin (Route 2, 3)

SCALE
1/5000

No.
48

INTERCHANGE PLAN (2)

S=1:5000

Interchange at Terminus (Route 2)

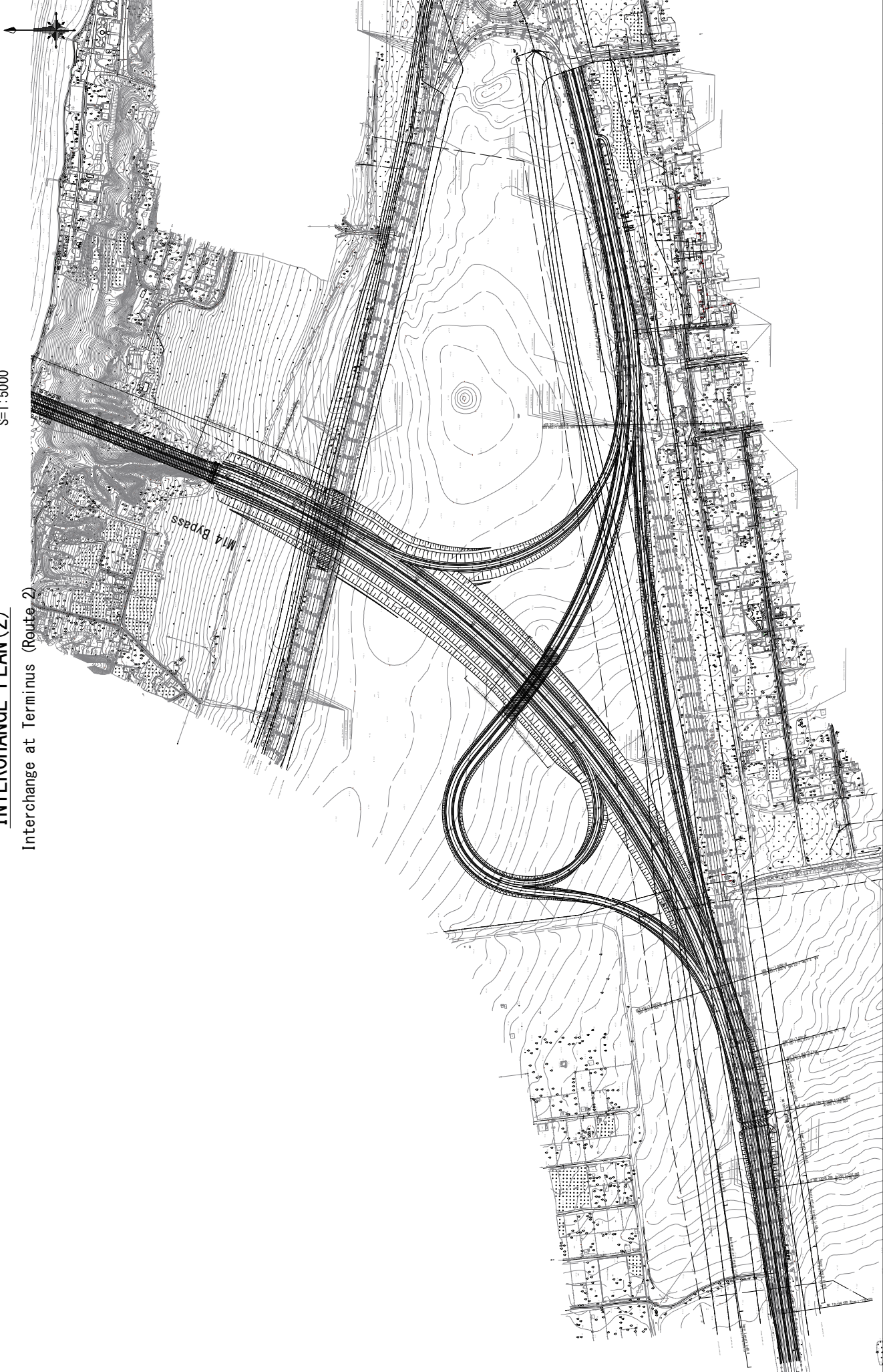

ADDITIONAL STUDY ON THE PROJECT FOR
CONSTRUCTION OF MYKOLAIV BRIDGE IN UKRAINE

JAPAN INTERNATIONAL COOPERATION AGENCY(JICA)

CENTRAL CONSULTANT INC. & NIPPON KOEI CO., LTD

TITLE
INTERCHANGE PLAN(2) Interchange at Terminus (Route 2)

SCALE
1/5000

No.
49

INTERCHANGE PLAN (3)

S=1:5000

Interchange at Terminus (Route 3)

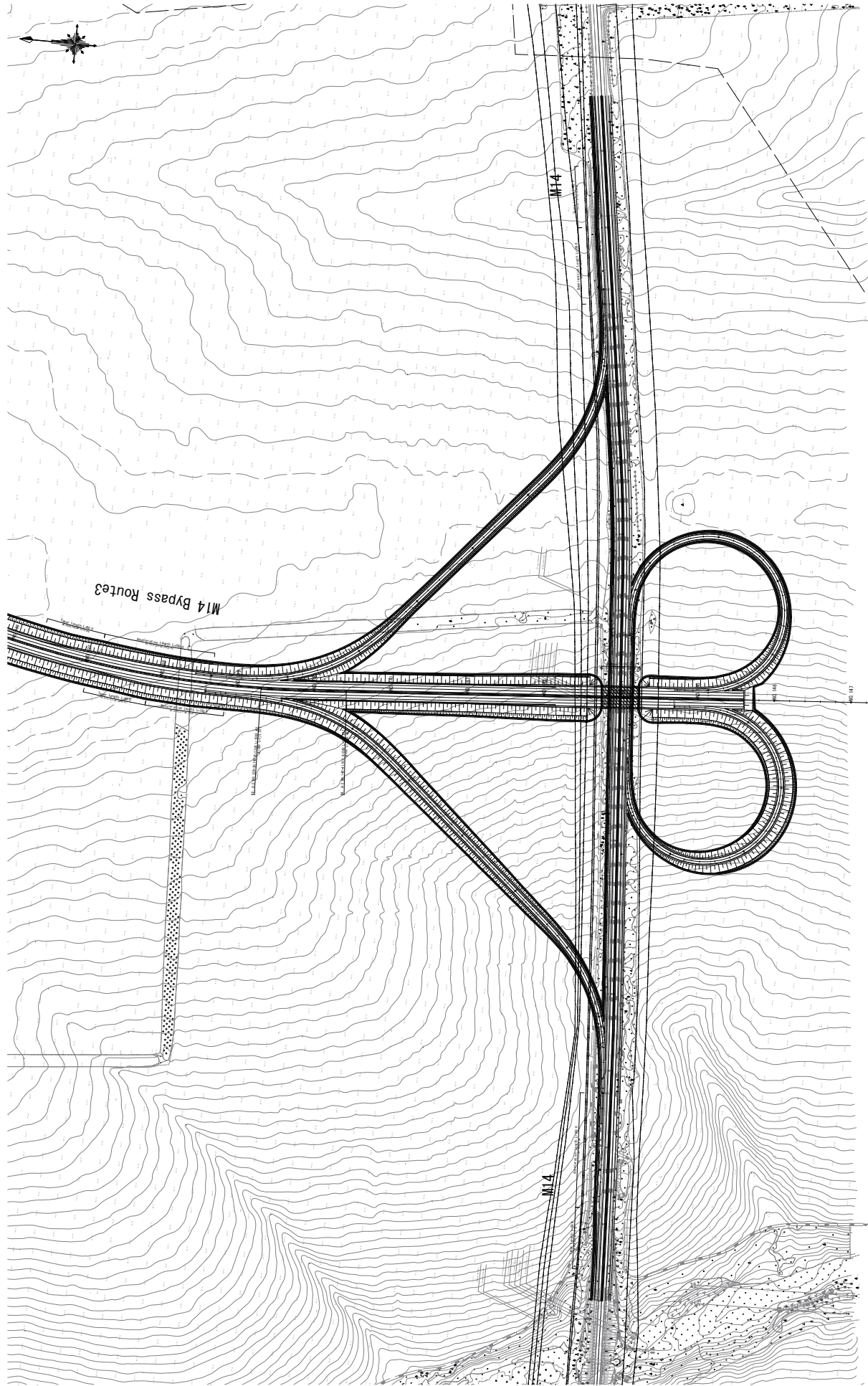

ADDITIONAL STUDY ON THE PROJECT FOR
CONSTRUCTION OF MYKOLAIV BRIDGE IN UKRAINE

JAPAN INTERNATIONAL COOPERATION AGENCY (JICA)

CENTRAL CONSULTANT INC. & NIPPON KOEI CO., LTD

TITLE

INTERCHANGE PLAN(3) Interchange at Terminus (Route 3)

SCALE

1/5000

No.

50

ALIGNMENT (1)

Route 2

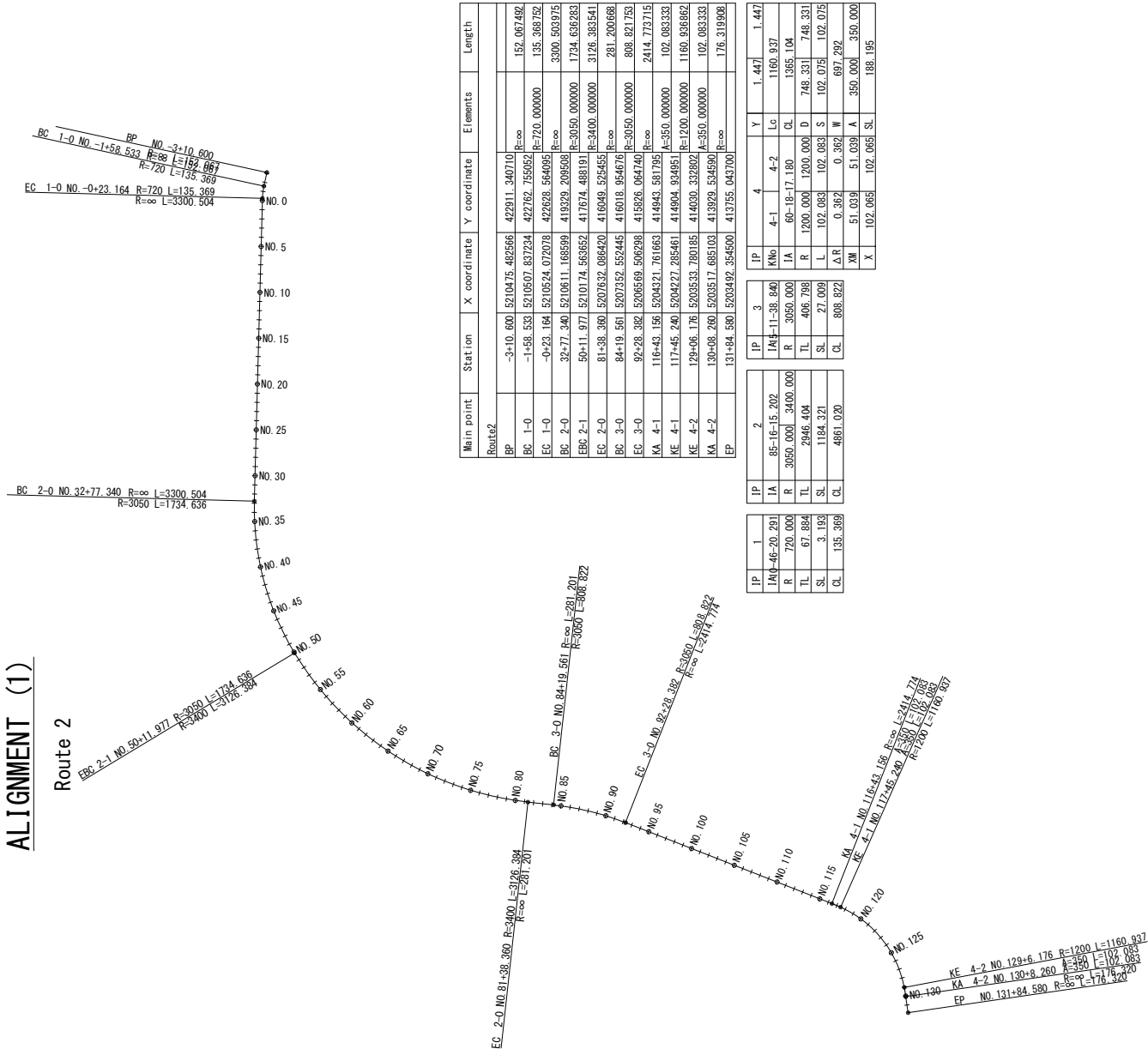

Main point	Station	X coordinate	Y coordinate	Elements	Length
Route2					
BP	-3+10.600	521047.5	482566.4	422911.340710	
BC 1-0	-1+58.538	521050.7	482782.7	755959.2	152.067492
EC 1-0	-0+23.164	521052.4	472078.8	422928.564098	135.369752
BC 2-0	32+77.340	521061.1	419329.2	209508.0	3300.363975
EBC 2-1	50+11.977	521017.4	563652.2	417674.488119	1734.636293
EC 2-0	81+38.380	520763.2	086420.0	416049.525456	3126.383541
BC 3-0	84+19.561	520735.2	552445.4	416018.954676	281.220068
EC 3-0	92+28.392	520656.9	506298.8	415826.064740	808.321753
KA 4-1	117+45.240	520427.1	285461.1	414904.934951	2414.713715
KE 4-1	129+06.176	520353.3	780185.5	414030.332803	102.083333
KA 4-2	130+08.260	520351.7	685103.3	413929.524590	1160.836862
EP	131+84.580	520349.2	354500.0	413755.043700	102.083333

IP	1	2	3	4	Y	1.447
IA	85-16+15.202	85-16+15.202	11-38.840	4-2		1.447
R	720.000	3050.000	3400.000	4-1		1160.937
TL	67.884	2946.404	406.798	IA	60-19+17.180	1385.104
SL	3.193	1184.321	27.009	R	1202.083	748.331
CL	135.369	4861.020	808.822	L	102.083	102.075
				S	0.362	697.292
				ΔM	51.039	350.000
				A	102.065	188.195

JAPAN INTERNATIONAL COOPERATION AGENCY (JICA)
CENTRAL CONSULTANT INC. & NIPPON KOEI CO., LTD

M-14 BYPASS Route2
ALIGNMENT (1)

SCALE
1/50000
No. 51

ADDITIONAL STUDY ON THE PROJECT FOR
CONSTRUCTION OF MYKOLAIV BRIDGE IN UKRAINE

ALIGNMENT (2)

Route 3

Main point	Station	X coordinate	Y coordinate	Elements	Length
Route3					
BP	-3+10.600	521.0475	492566		
BC 1-0	-1+58.533	521.0567	837234	R=∞	152.067492
EC 1-0	-0+23.164	521.0524	072078	R=720	135.368752
BC 2-0	32+77.340	521.0611	168599	R=∞	3300.503975
EC 2-1	50+11.977	521.0174	568651	R=3050	1734.638286
BC 3-0	70+62.318	520.8665	626258	R=3400	2059.341175
EC 3-0	83+32.640	520.7692	147395	R=∞	1270.322323
KA 4-1	127+36.212	520.4742	075673	R=380	4403.571831
KE 4-1	128+47.289	520.4667	497583	R=380	111.076923
KA 4-2	139+30.740	520.3893	923472	R=380	1083.451055
KE 4-2	140+41.817	520.3583	029280	R=380	111.076923
EP	152+00.000	520.2427	682585	R=∞	1158.183149

IP	1	2	3	4	Y	1.582	1.582
KA	4-1	127+36.212	520.4742	075673	411801.715181		
KE	4-1	128+47.289	520.4667	497583	411801.715181		
KA	4-2	139+30.740	520.3893	923472	411801.715181		
KE	4-2	140+41.817	520.3583	029280	411801.715181		
EP							

IP	1	2	3	4	Y	1.582	1.582
KA	4-1	127+36.212	520.4742	075673	411801.715181		
KE	4-1	128+47.289	520.4667	497583	411801.715181		
KA	4-2	139+30.740	520.3893	923472	411801.715181		
KE	4-2	140+41.817	520.3583	029280	411801.715181		
EP							

IP	1	2	3	4	Y	1.582	1.582
KA	4-1	127+36.212	520.4742	075673	411801.715181		
KE	4-1	128+47.289	520.4667	497583	411801.715181		
KA	4-2	139+30.740	520.3893	923472	411801.715181		
KE	4-2	140+41.817	520.3583	029280	411801.715181		
EP							

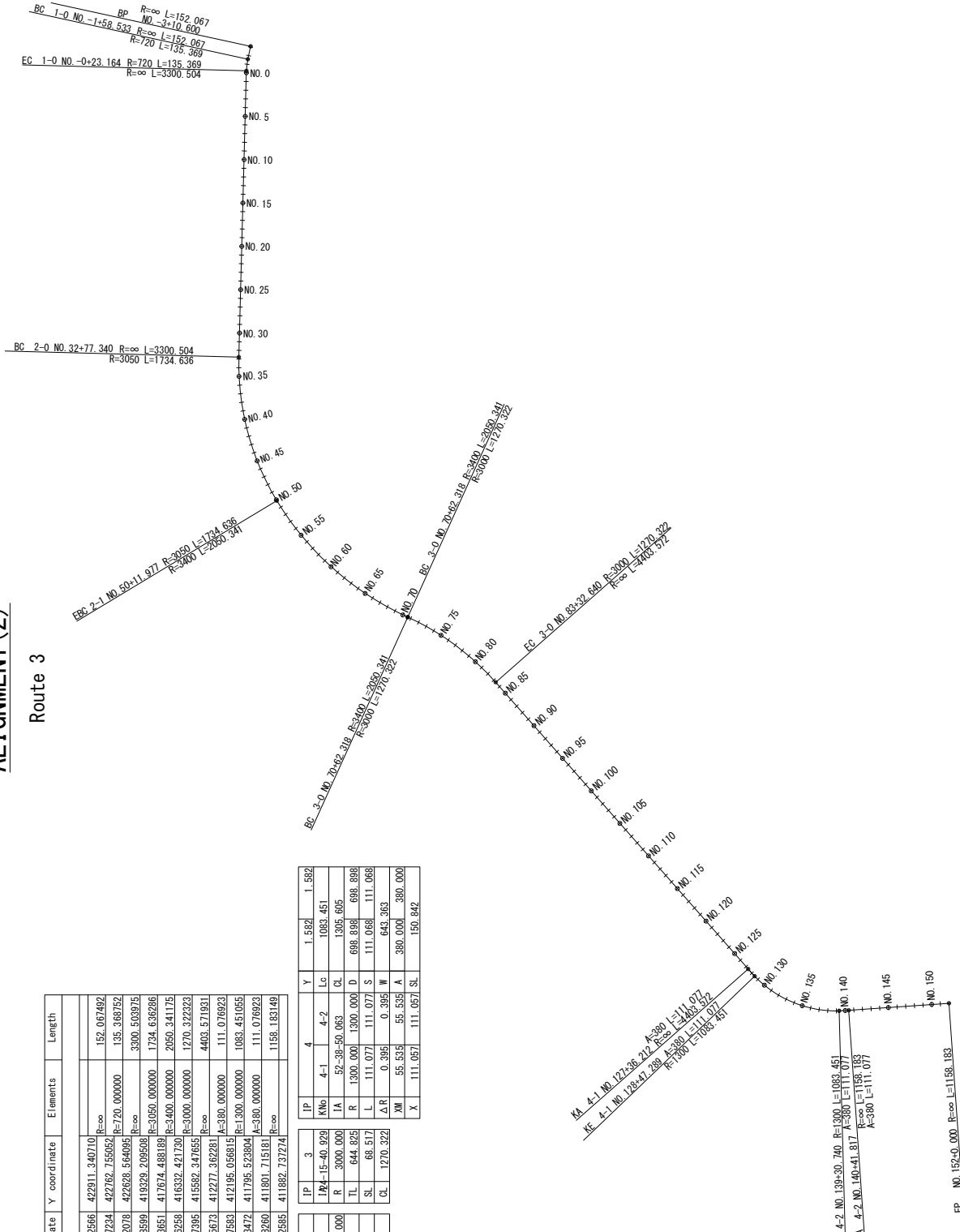

ADDITIONAL STUDY ON THE PROJECT FOR CONSTRUCTION OF MYKOLAIV BRIDGE IN UKRAINE	JAPAN INTERNATIONAL COOPERATION AGENCY (JICA) CENTRAL CONSULTANT INC. & NIPPON KOEI CO., LTD	TITLE	M-14 BYPASS Route3 ALIGNMENT(2)	SCALE 1/50000
			No.	52