

LAO PEOPLE'S DEMOCRATIC REPUBLIC SOCIALIST REPUBLIC OF VIETNAM	JAPAN INTERNATIONAL COOPERATION AGENCY Yachiyo Engineering Co., Ltd. <b>NIPPON KOEI</b> Nippon Koei Co., Ltd. <b>YEO</b> Central Consultant Inc. <b>FPASCO</b> Pasco Corporation		DATA COLLECTION SURVEY FOR ENHANCEMENT OF CONNECTIVITY BETWEEN HANOI AND VIENTIANE IN ASIA		PRE-F/S CORRIDOR	SHEET CONTENTS <b>PROFILE</b> KM275+000 - KM291+000		SCALE 1:25,000
	SECTION C-3		DATE MAR 2018		PAGE NO. 04 / 10			

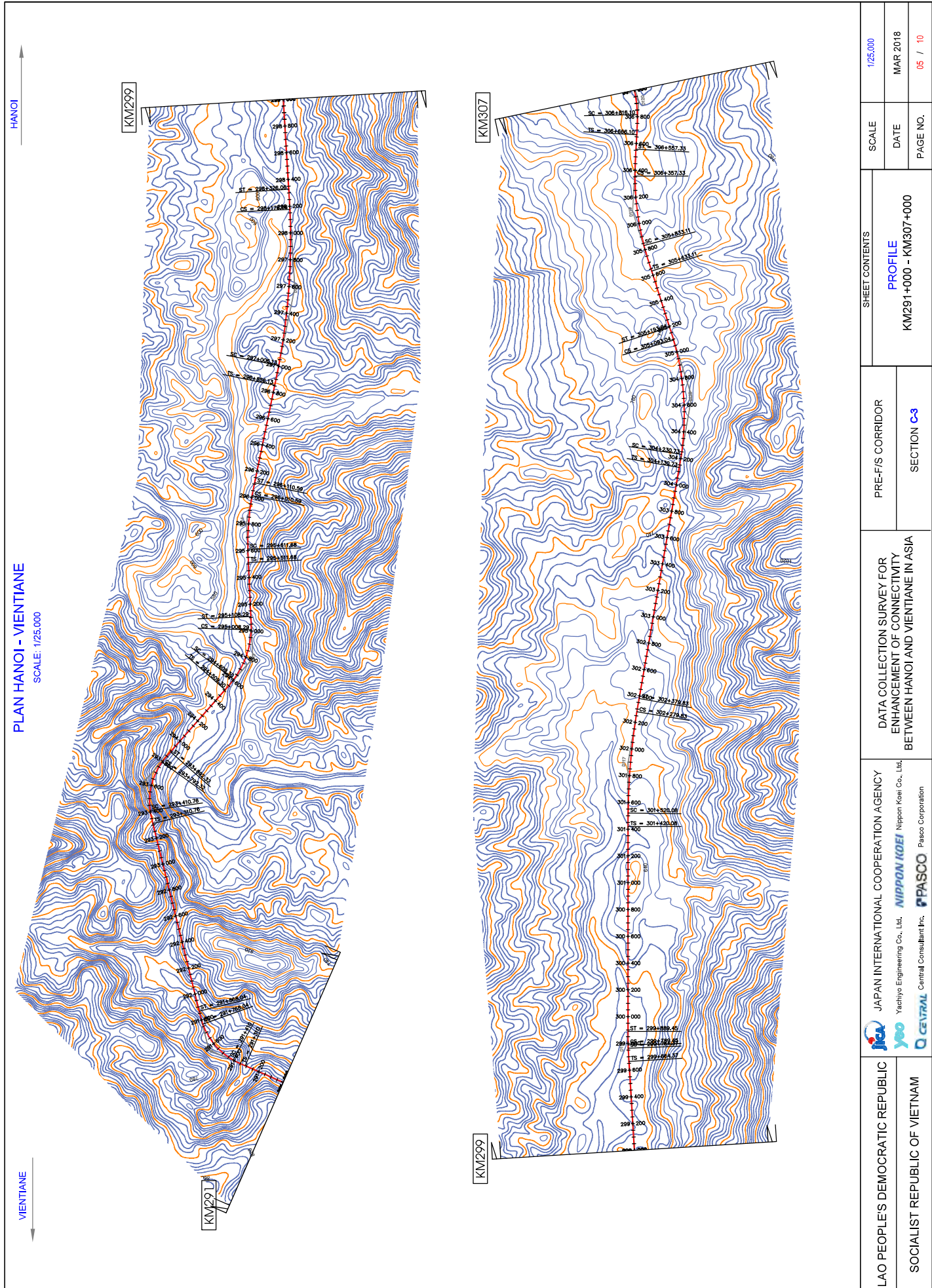

LAO PEOPLE'S DEMOCRATIC REPUBLIC SOCIALIST REPUBLIC OF VIETNAM	JAPAN INTERNATIONAL COOPERATION AGENCY Yachiyo Engineering Co., Ltd. <b>NIPPON KOEI</b> Nippon Koei Co., Ltd.		DATA COLLECTION SURVEY FOR ENHANCEMENT OF CONNECTIVITY BETWEEN HANOI AND VIENTIANE IN ASIA		PRE-F/S CORRIDOR SECTION <b>C-3</b>		SHEET CONTENTS <b>PROFILE</b> KM291+000 - KM307+000		SCALE 1:25,000
	CENTRAL Central Consultant Inc. <b>FPASCO</b> Pasco Corporation								DATE MAR 2018
								PAGE NO. 05 / 10	