





LEGEND		
FIGURE	COUNTER MEASURE	QUANTITY
	CHECK DAM	72
	CHECK DAM PRIORITY	106
	REVENT WORK	268.62 km
	CENOZOIC ZONE	



ARRANGEMENT PLAN OF COUNTERMEASURE  
 PISCO BASIN  
 SCALE 1:400 000

1:400 000 0 8,00 16,00 24,00 32,00 40,00 km

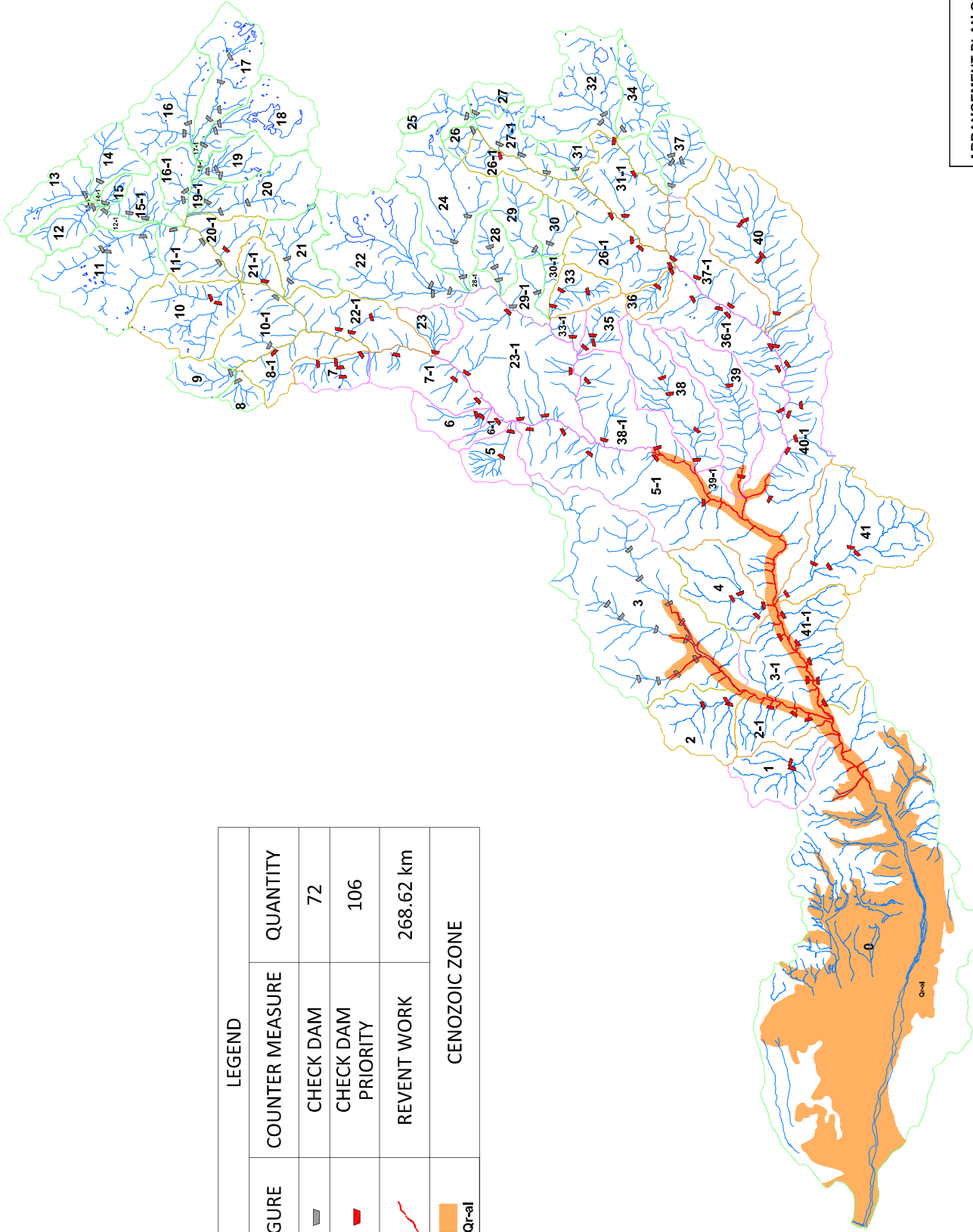
# PISCO RIVER

## SUB BASIN 1

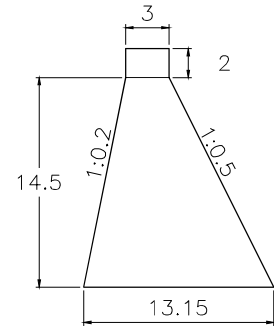
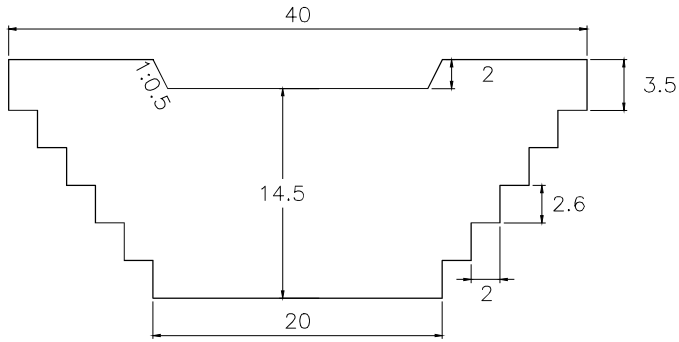

VOLUME: 3,512.70m<sup>3</sup> QUANTITY: 2

## SUB BASIN 2

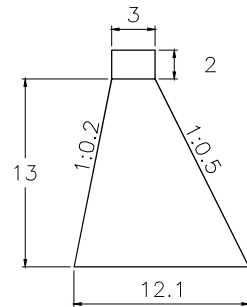
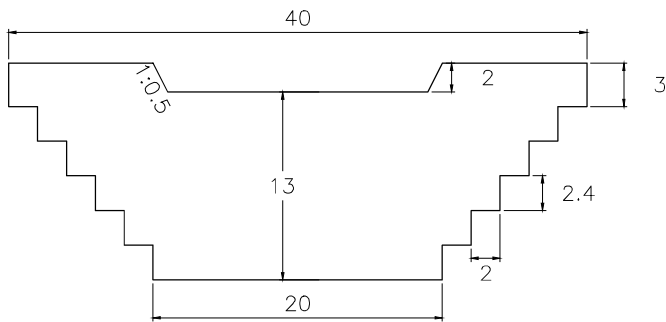

VOLUME: 2,944.50m<sup>3</sup> QUANTITY: 3

## SUB BASIN 3

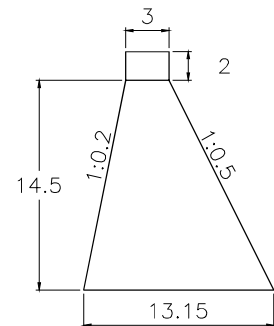
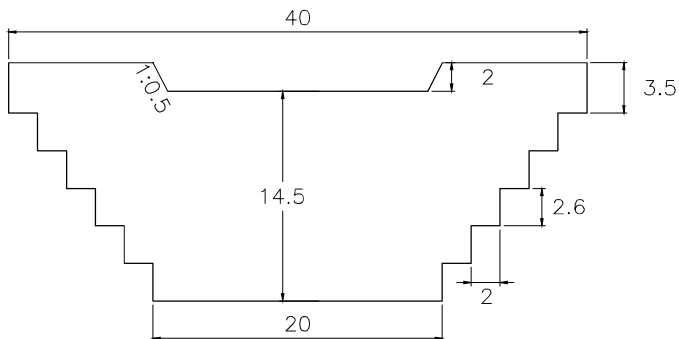

VOLUME: 3,512.70m<sup>3</sup> QUANTITY: 12

## CHECK DAM

SCALE 1:500

# PISCO RIVER

## SUB BASIN 4

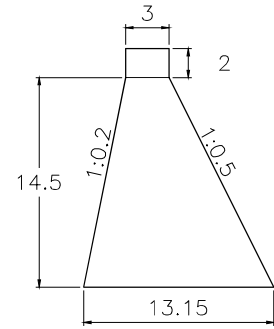
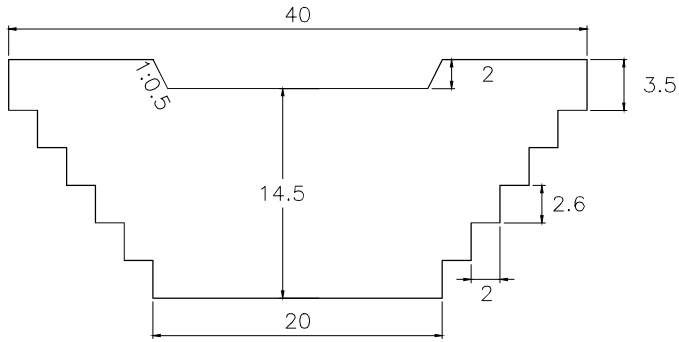

VOLUME: 3,512.70m<sup>3</sup> QUANTITY: 4

## SUB BASIN 5

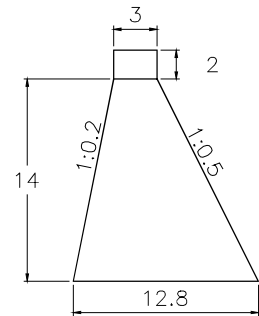
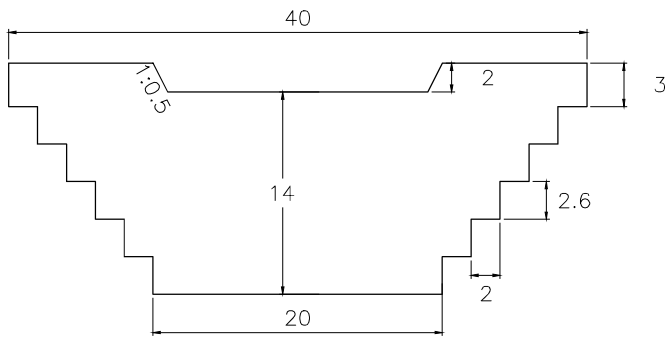

VOLUME: 3,318.00m<sup>3</sup> QUANTITY: 2

## SUB BASIN 6

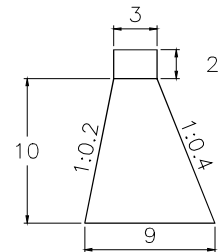
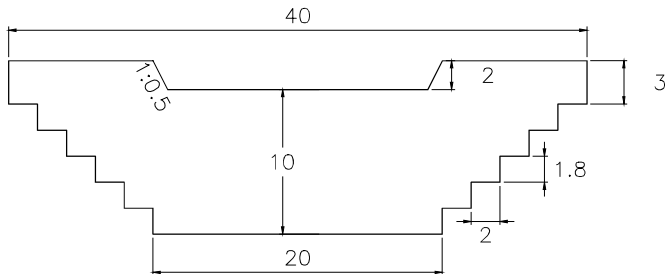

VOLUME: 1,800.00m<sup>3</sup> QUANTITY: 2

### CHECK DAM

SCALE 1:500

# PISCO RIVER

## SUB BASIN 7

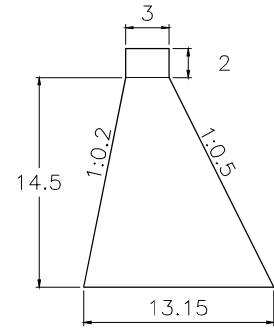
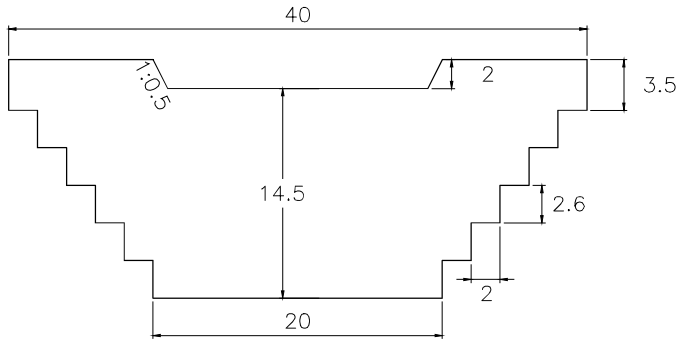

VOLUME: 3,512.70m<sup>3</sup> QUANTITY: 5

## SUB BASIN 8

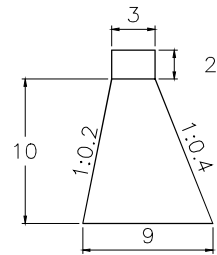
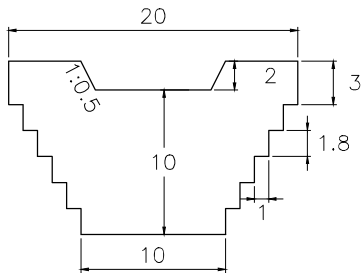

VOLUME: 900.00m<sup>3</sup> QUANTITY: 1

## SUB BASIN 9

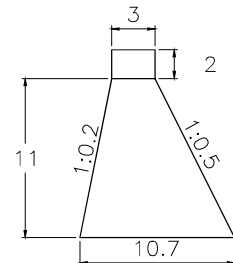
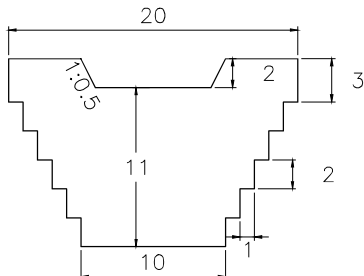

VOLUME: 1,130.25m<sup>3</sup> QUANTITY: 1

**CHECK DAM**

SCALE 1:500

# PISCO RIVER

## SUB BASIN 10

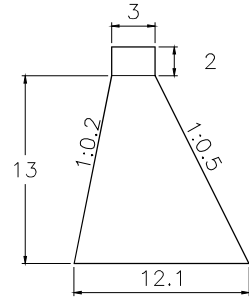
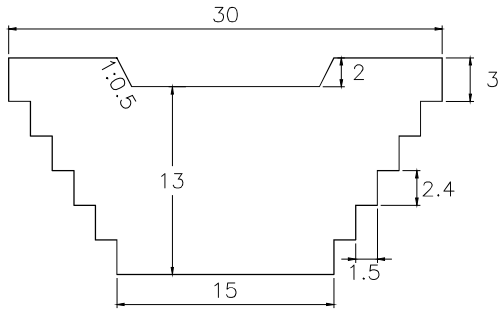

VOLUME: 2,208.38m<sup>3</sup> QUANTITY: 2

## SUB BASIN 11

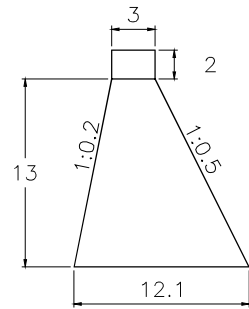
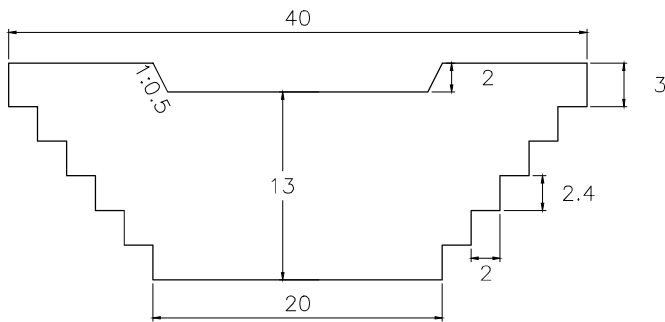

VOLUME: 2,944.50m<sup>3</sup> QUANTITY: 3

## SUB BASIN 12

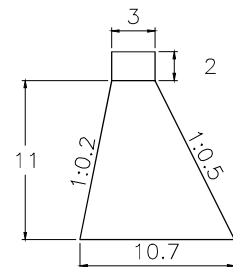
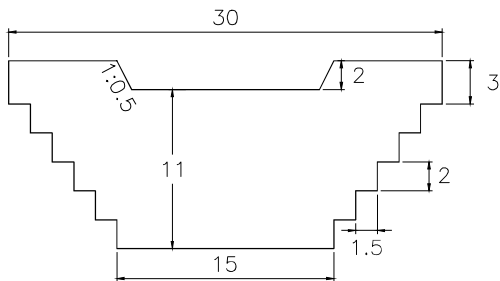

VOLUME: 1,695.38m<sup>3</sup> QUANTITY: 1

**CHECK DAM**

SCALE 1:500

# PISCO RIVER

## SUB BASIN 13

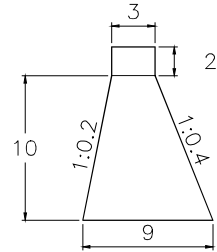
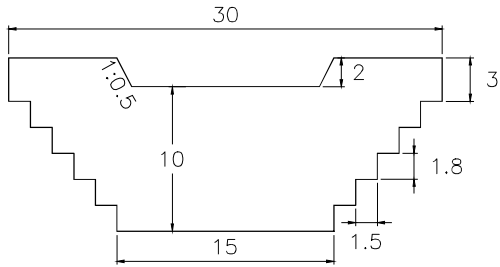

VOLUME: 1,350.00m<sup>3</sup> QUANTITY: 1

## SUB BASIN 14

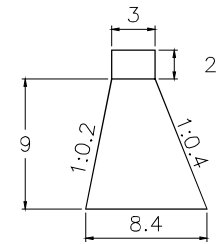
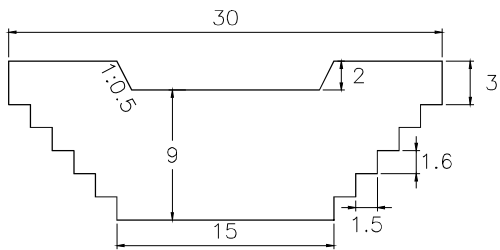

VOLUME: 1,154.25m<sup>3</sup> QUANTITY: 1

## SUB BASIN 15

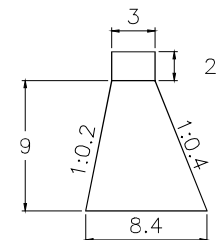
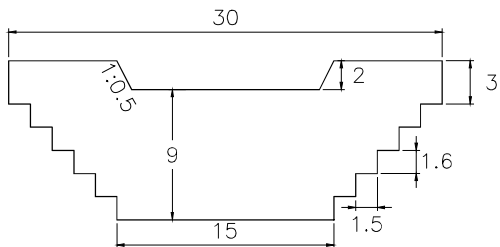

VOLUME: 1,154.25m<sup>3</sup> QUANTITY: 1

# CHECK DAM

SCALE 1:500

# PISCO RIVER

## SUB BASIN 16

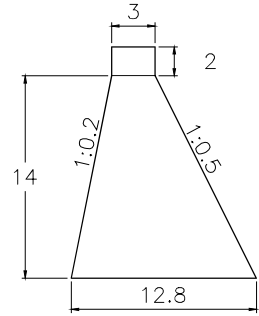
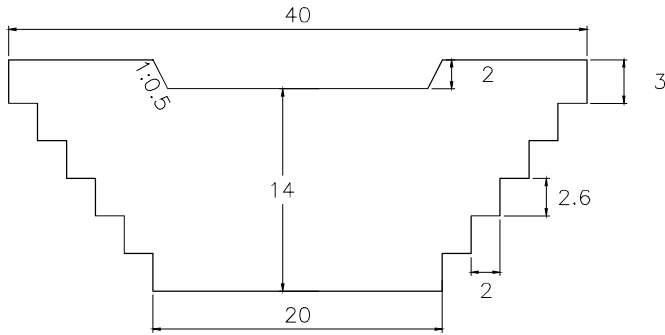

VOLUME: 3,318.00m<sup>3</sup> QUANTITY: 2

## SUB BASIN 17

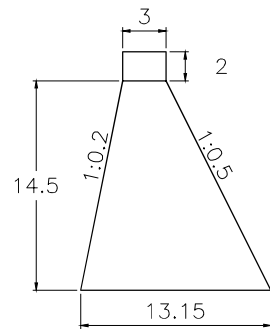
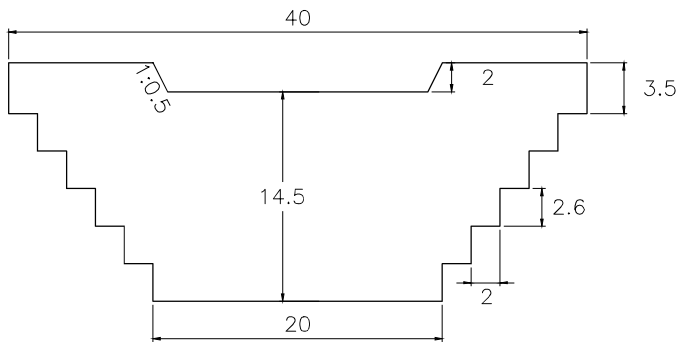

VOLUME: 3,512.70m<sup>3</sup> QUANTITY: 4

## SUB BASIN 18

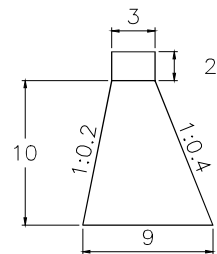
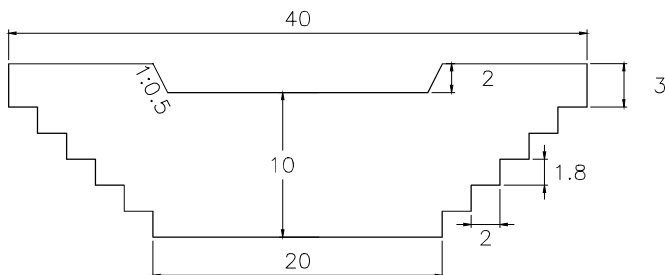

VOLUME: 1,800.00m<sup>3</sup> QUANTITY: 3

CHECK DAM

SCALE 1:500

# PISCO RIVER

## SUB BASIN 19

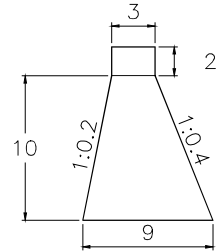
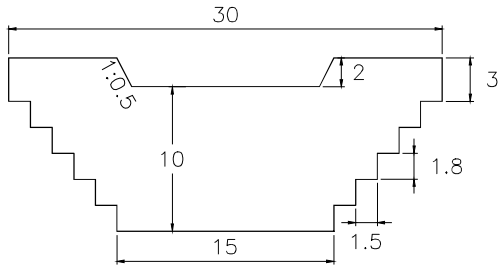

VOLUME: 1,350.00m<sup>3</sup> QUANTITY: 3

## SUB BASIN 20

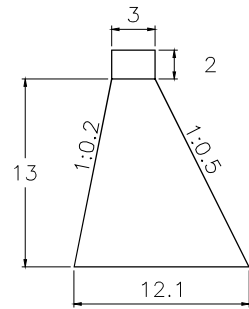
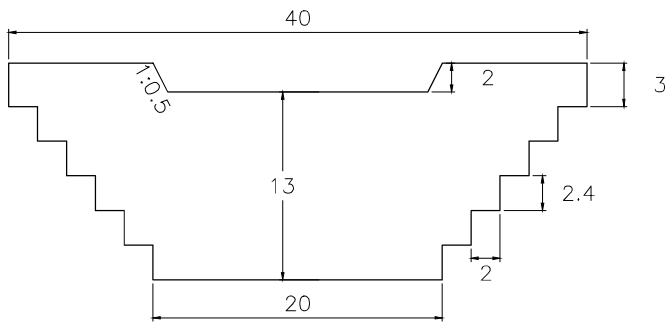

VOLUME: 2,944.50m<sup>3</sup> QUANTITY: 3

## SUB BASIN 21

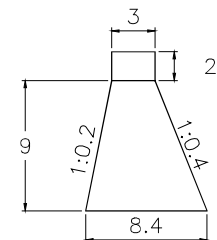
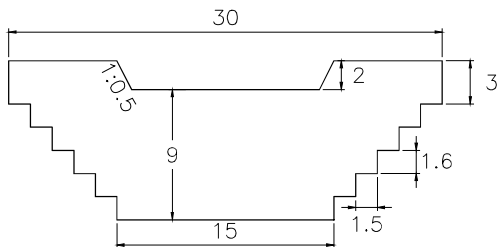

VOLUME: 1,154.25m<sup>3</sup> QUANTITY: 2

**CHECK DAM**

SCALE 1:500



# PISCO RIVER

## SUB BASIN 22

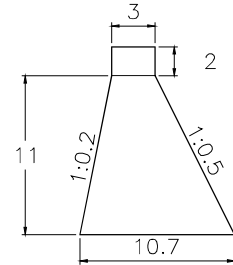
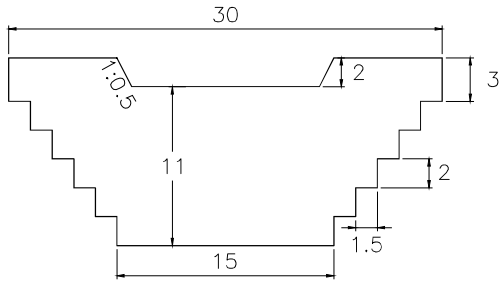

VOLUME: 1,695.38m<sup>3</sup> QUANTITY: 3

## SUB BASIN 23

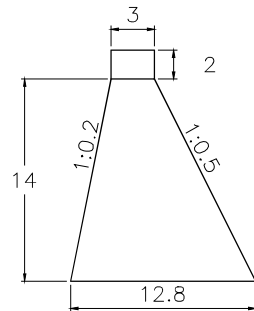
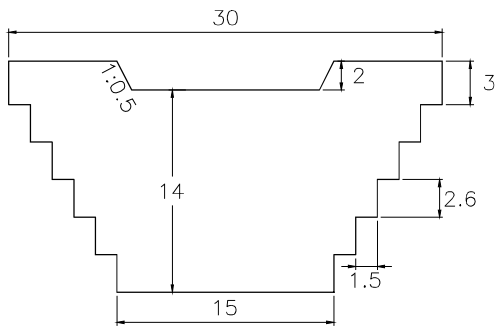

VOLUME: 2,488.50m<sup>3</sup> QUANTITY: 1

## SUB BASIN 24

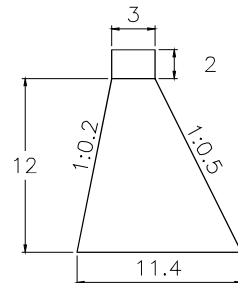
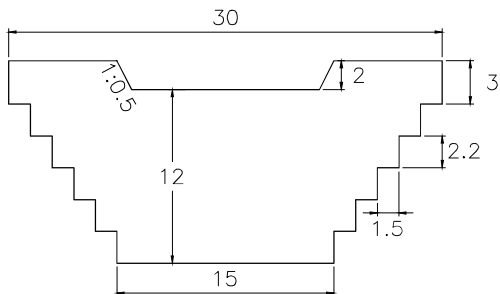

VOLUME: 1,944.00m<sup>3</sup> QUANTITY: 3

**CHECK DAM**

SCALE 1:500

# PISCO RIVER

## SUB BASIN 25

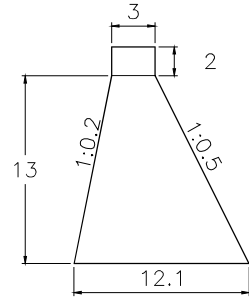
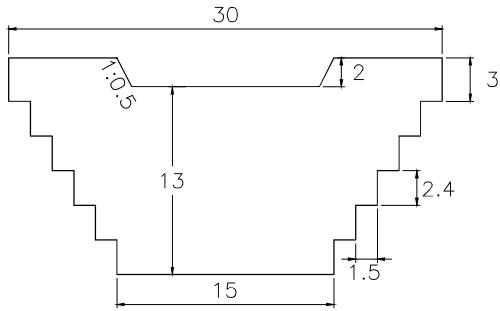

VOLUME: 2,208.38m<sup>3</sup> QUANTITY: 1

## SUB BASIN 26

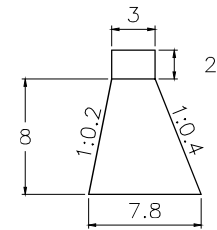
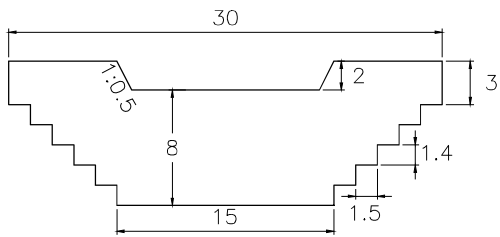

VOLUME: 972.00m<sup>3</sup> QUANTITY: 1

## SUB BASIN 27

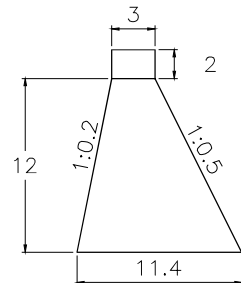
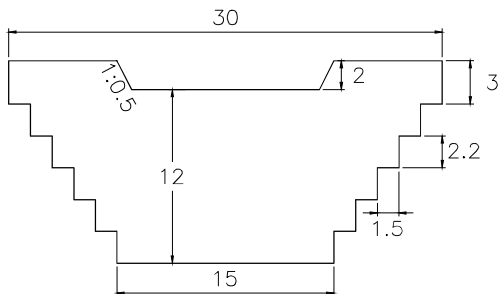

VOLUME: 1,944.00m<sup>3</sup> QUANTITY: 1

**CHECK DAM**

SCALE 1:500

# PISCO RIVER

## SUB BASIN 28

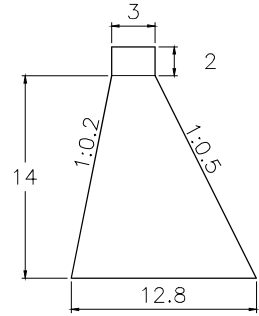
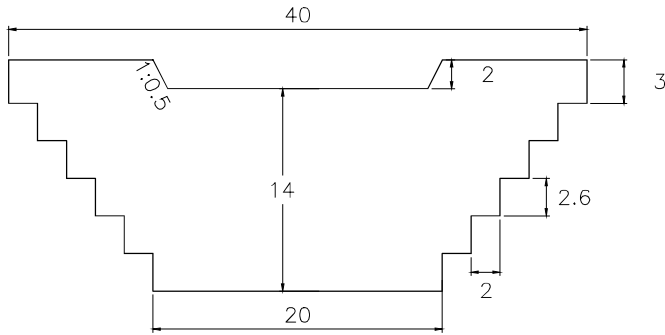

VOLUME: 3,318.00m<sup>3</sup> QUANTITY: 3

## SUB BASIN 29

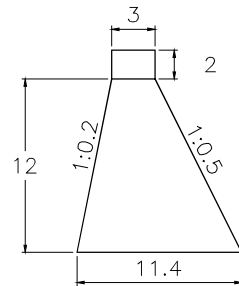
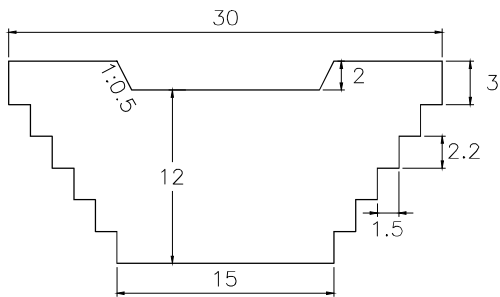

VOLUME: 1,944.00m<sup>3</sup> QUANTITY: 1

## SUB BASIN 30

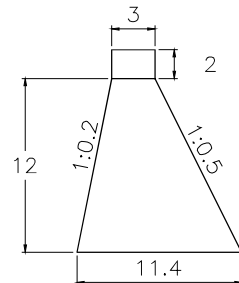
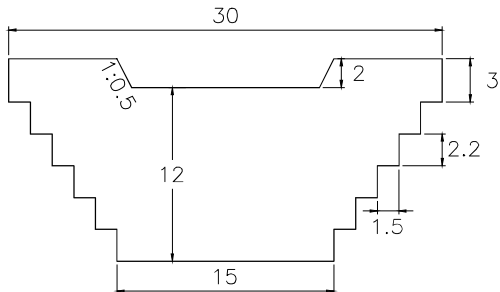

VOLUME: 1,944.00m<sup>3</sup> QUANTITY: 1

**CHECK DAM**

SCALE 1:500

# PISCO RIVER

## SUB BASIN 31

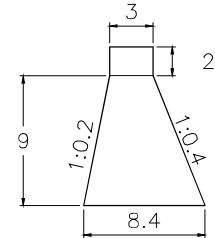
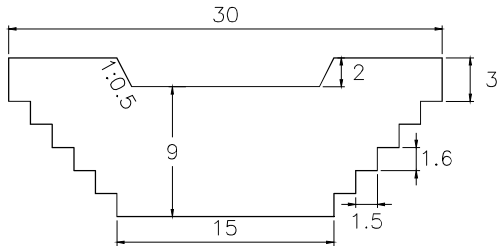

VOLUME: 1,154.25m<sup>3</sup> QUANTITY: 1

## SUB BASIN 32

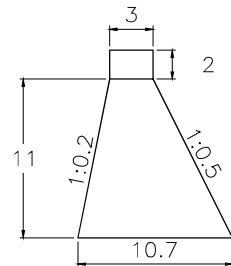
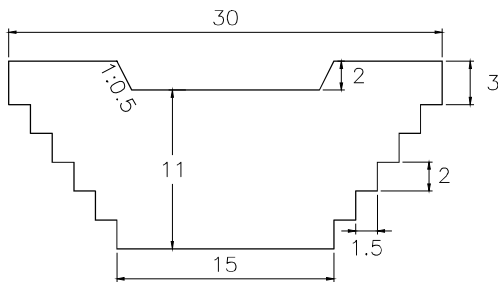

VOLUME: 1,695.38m<sup>3</sup> QUANTITY: 2

## SUB BASIN 33

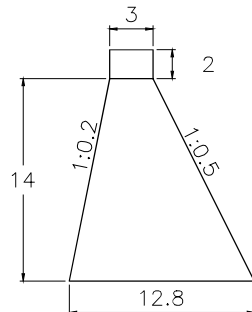
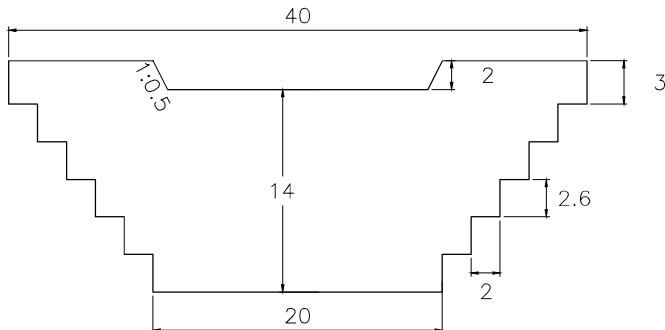

VOLUME: 3,318.00m<sup>3</sup> QUANTITY: 3

### CHECK DAM

SCALE 1:500

# PISCO RIVER

## SUB BASIN 34

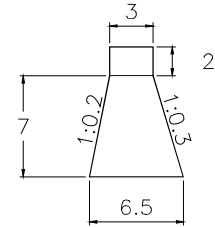
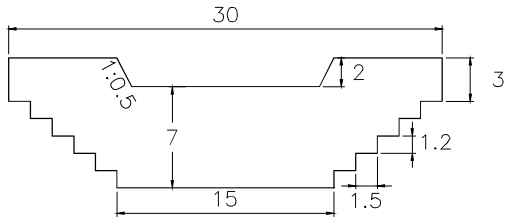

VOLUME: 748.13m<sup>3</sup> QUANTITY: 1

## SUB BASIN 35

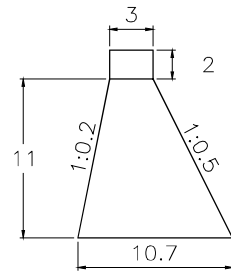
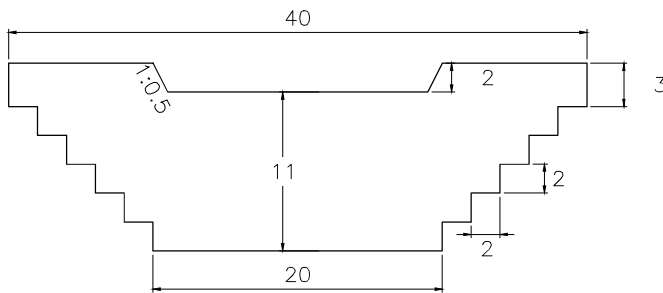

VOLUME: 2,260.50m<sup>3</sup> QUANTITY: 3

## SUB BASIN 36

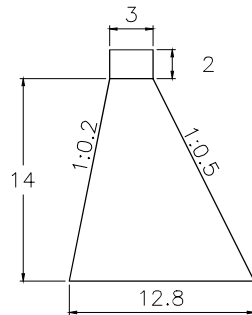
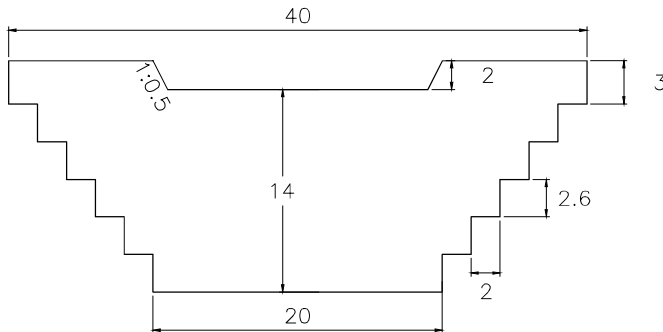

VOLUME: 3,318.00m<sup>3</sup> QUANTITY: 2

**CHECK DAM**

SCALE 1:500

# PISCO RIVER

## SUB BASIN 37

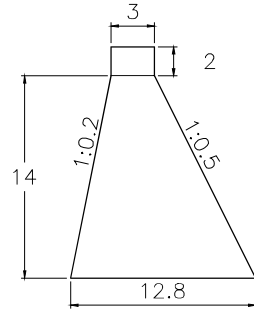
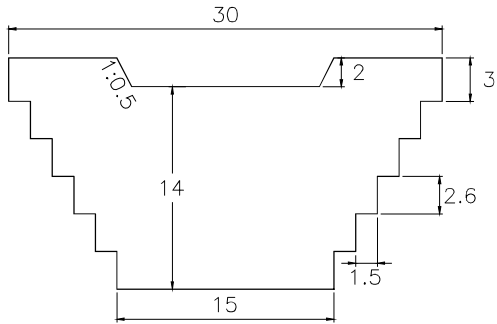

VOLUME: 2,488.50m<sup>3</sup> QUANTITY: 4

## SUB BASIN 38

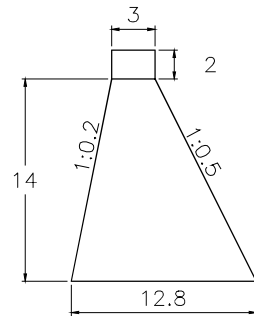
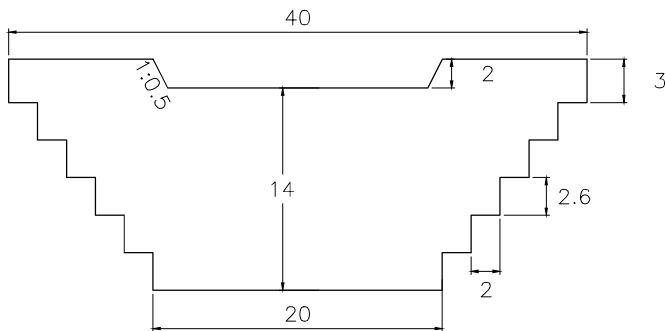

VOLUME: 3,318.00m<sup>3</sup> QUANTITY: 4

## SUB BASIN 39

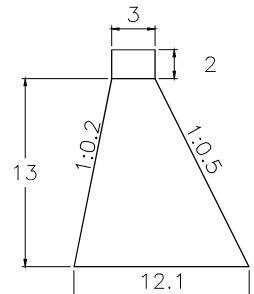
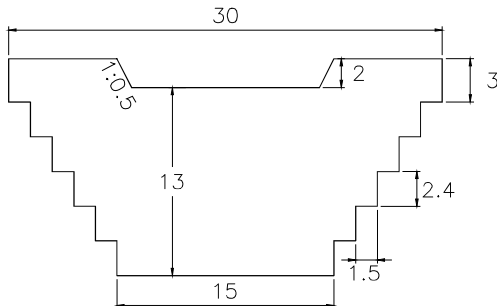

VOLUME: 2,208.38m<sup>3</sup> QUANTITY: 2

### CHECK DAM

SCALE 1:500

# PISCO RIVER

## SUB BASIN 40

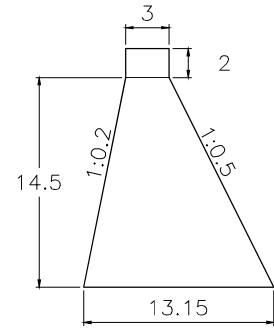
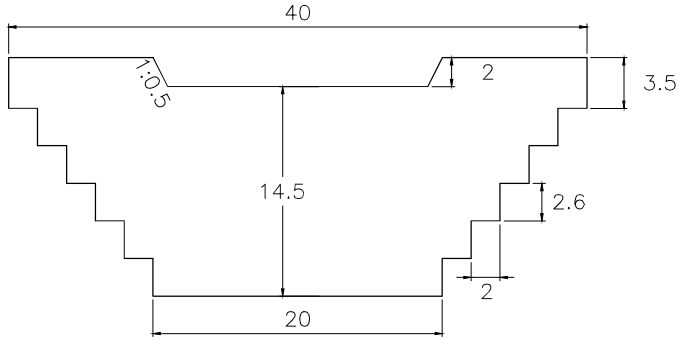

VOLUME: 3,512.70m<sup>3</sup> QUANTITY: 5

## SUB BASIN 41

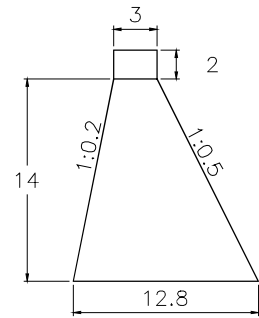
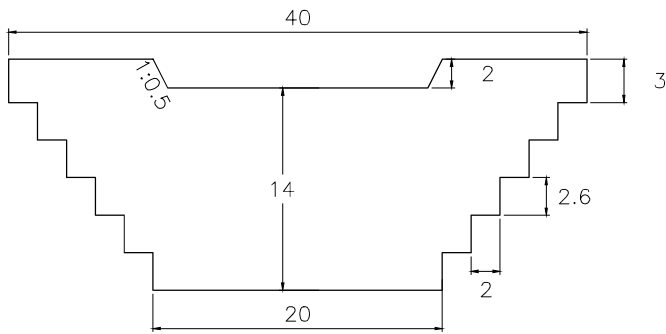

VOLUME: 3,318.00m<sup>3</sup> QUANTITY: 5

## SUB BASIN 2-1

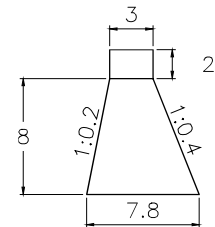
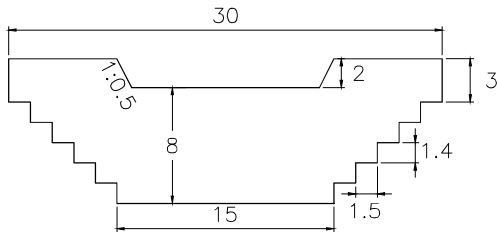

VOLUME: 972.00m<sup>3</sup> QUANTITY: 3

**CHECK DAM**

SCALE 1:500

# PISCO RIVER

## SUB BASIN 3-1

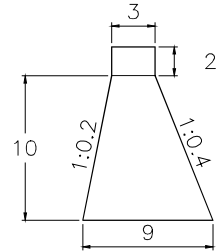
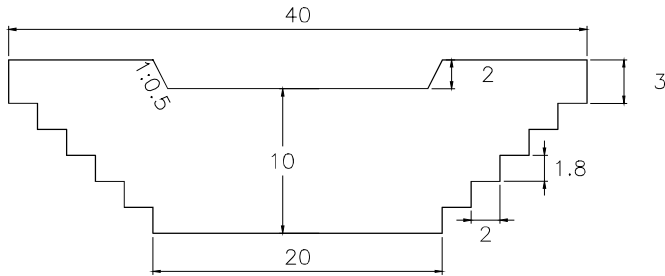

VOLUME: 1,800.00m<sup>3</sup> QUANTITY: 2

## SUB BASIN 5-1

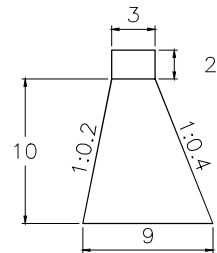
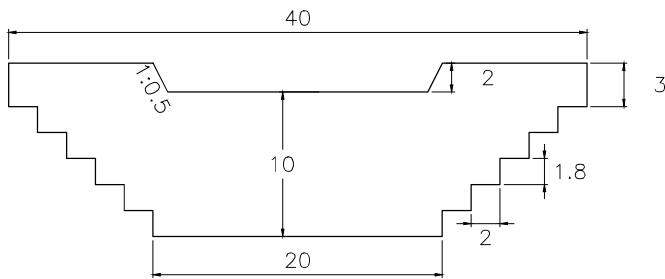

VOLUME: 1,800.00m<sup>3</sup> QUANTITY: 5

## SUB BASIN 6-1

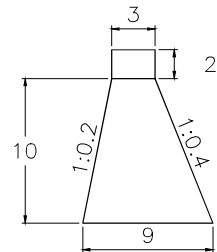
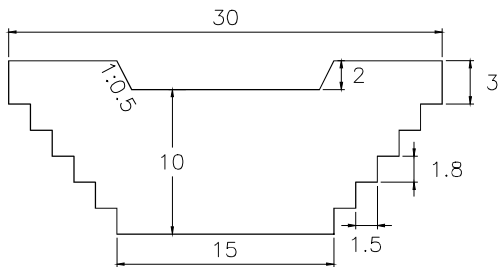

VOLUME: 1,350.00m<sup>3</sup> QUANTITY: 1

### CHECK DAM

SCALE 1:500



# PISCO RIVER

## SUB BASIN 7-1

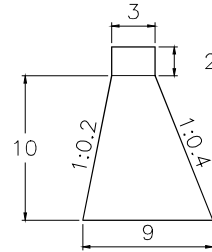
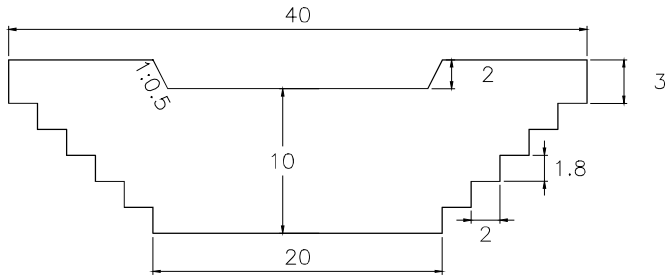

VOLUME: 1,800.00m<sup>3</sup> QUANTITY: 3

## SUB BASIN 8-1

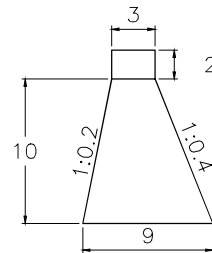
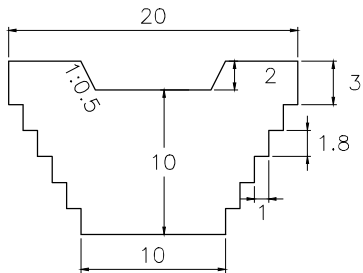

VOLUME: 900.00m<sup>3</sup> QUANTITY: 1

## SUB BASIN 10-1

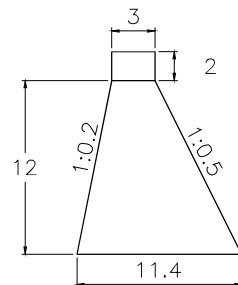
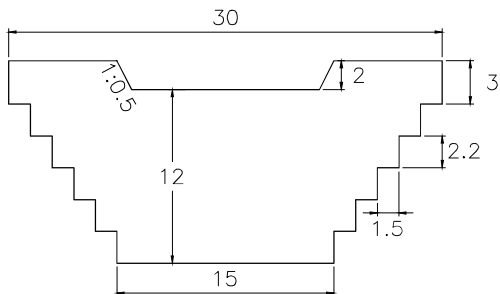

VOLUME: 1,944.00m<sup>3</sup> QUANTITY: 2

**CHECK DAM**

SCALE 1:500

# PISCO RIVER

## SUB BASIN 11-1

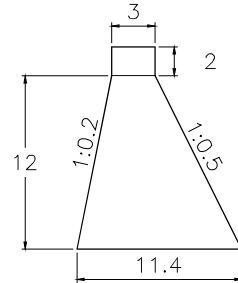
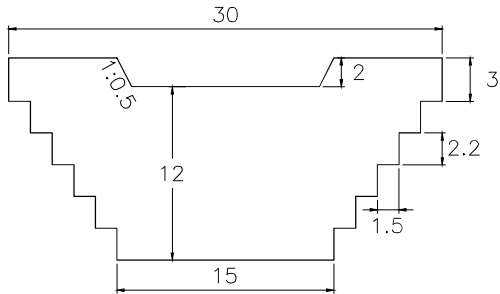

VOLUME: 1,944.00m<sup>3</sup> QUANTITY: 3

## SUB BASIN 12-1

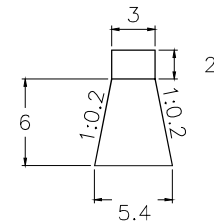
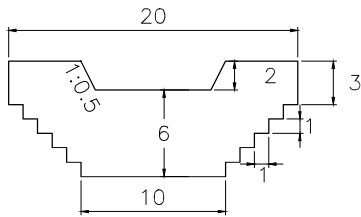

VOLUME: 378.00m<sup>3</sup> QUANTITY: 1

## SUB BASIN 15-1

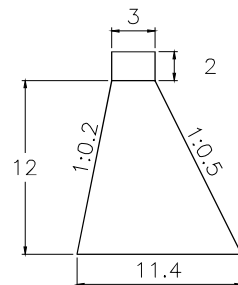
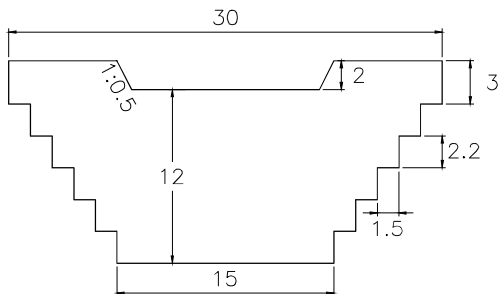

VOLUME: 1,944.00m<sup>3</sup> QUANTITY: 2

### CHECK DAM

SCALE 1:500

# PISCO RIVER

## SUB BASIN 16-1

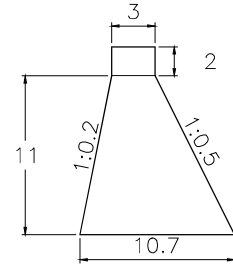
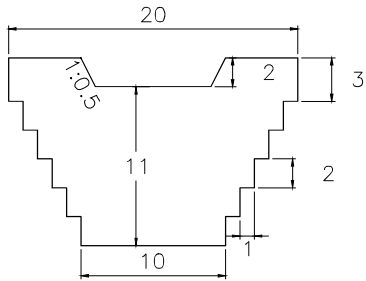

VOLUME: 1,130.25m<sup>3</sup> QUANTITY: 2

## SUB BASIN 20-1

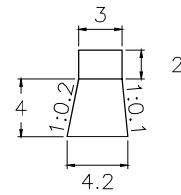
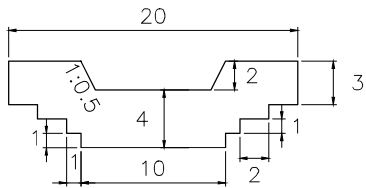

VOLUME: 216.00m<sup>3</sup> QUANTITY: 1

## SUB BASIN 21-1

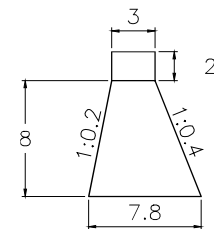
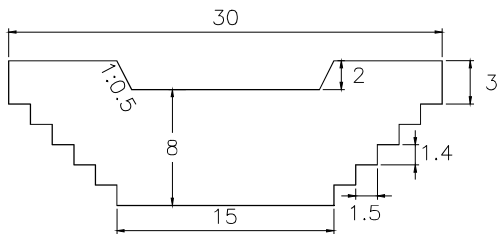

VOLUME: 972.00m<sup>3</sup> QUANTITY: 1

### CHECK DAM

SCALE 1:500

# PISCO RIVER

## SUB BASIN 22-1

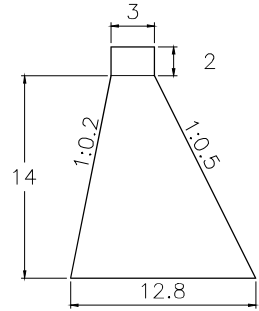
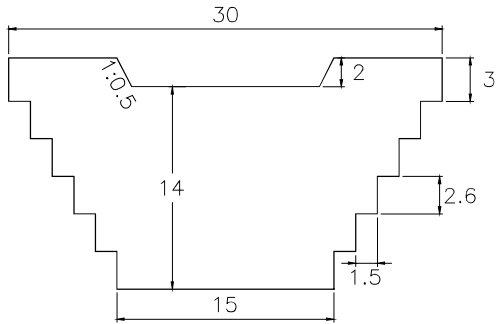

VOLUME: 2,488.50m<sup>3</sup> QUANTITY: 3

## SUB BASIN 23-1

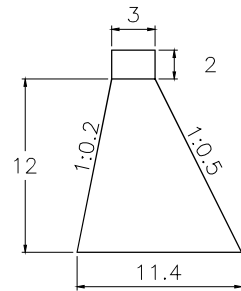
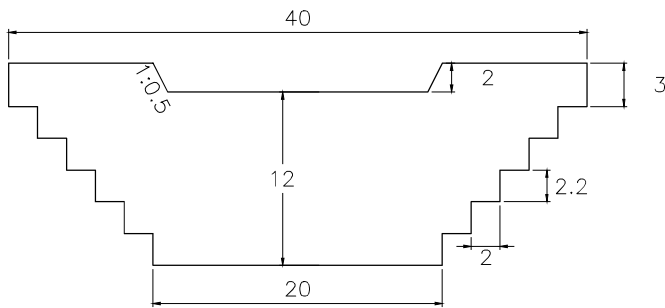

VOLUME: 2,592.00m<sup>3</sup> QUANTITY: 5

## SUB BASIN 26-1

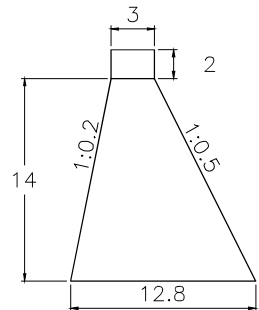
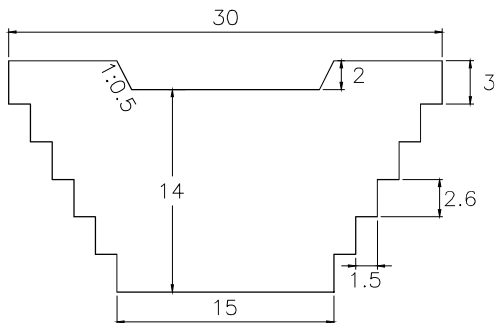

VOLUME: 2,488.50m<sup>3</sup> QUANTITY: 5

**CHECK DAM**

SCALE 1:500

# PISCO RIVER

## SUB BASIN 27-1

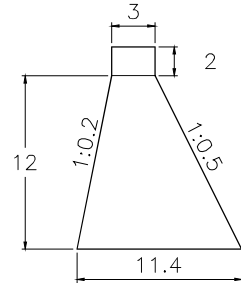
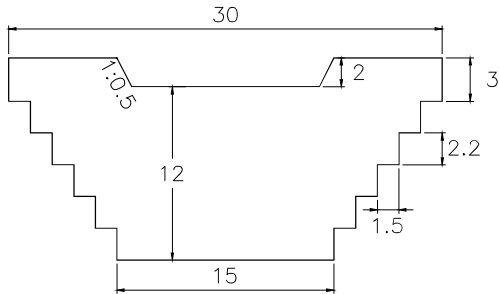

VOLUME: 1,944.00m<sup>3</sup> QUANTITY: 3

## SUB BASIN 29-1

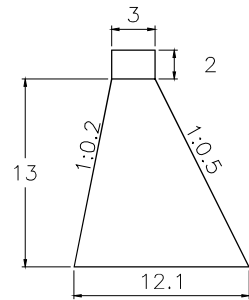
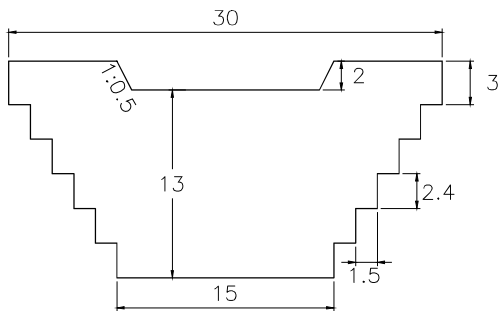

VOLUME: 2,208.38m<sup>3</sup> QUANTITY: 2

## SUB BASIN 31-1

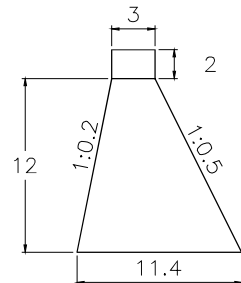
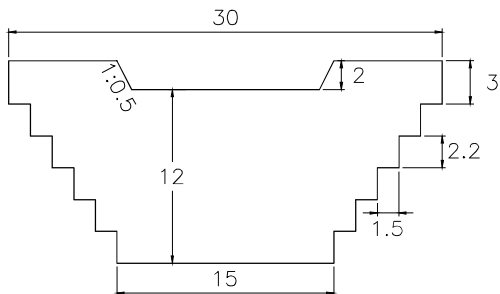

VOLUME: 1,944.00m<sup>3</sup> QUANTITY: 3

### CHECK DAM

SCALE 1:500

# PISCO RIVER

## SUB BASIN 33-1

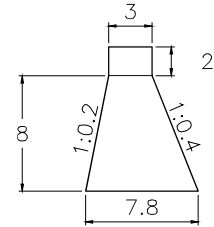
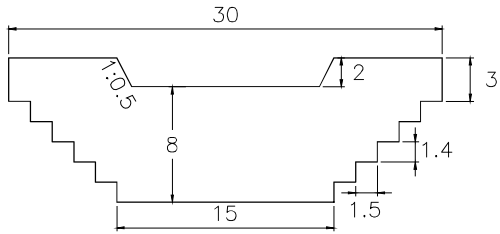

VOLUME: 972.00m<sup>3</sup> QUANTITY: 1

## SUB BASIN 36-1

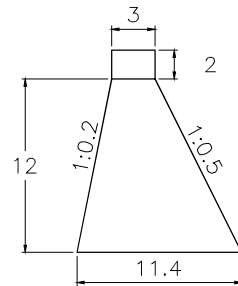
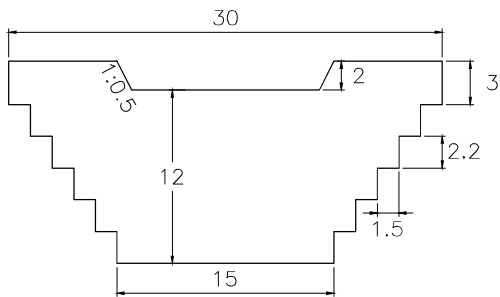

VOLUME: 1,944.00m<sup>3</sup> QUANTITY: 6

## SUB BASIN 37-1

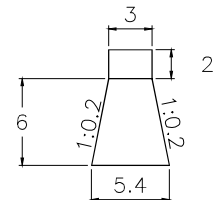
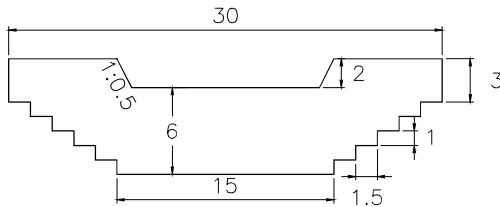

VOLUME: 567.00m<sup>3</sup> QUANTITY: 3

**CHECK DAM**

SCALE 1:500

# PISCO RIVER

## SUB BASIN 38-1

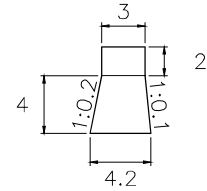
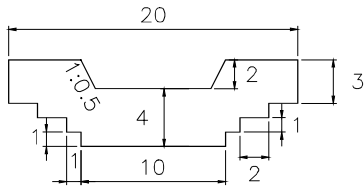

VOLUME: 216.00m<sup>3</sup> QUANTITY: 3

## SUB BASIN 40-1

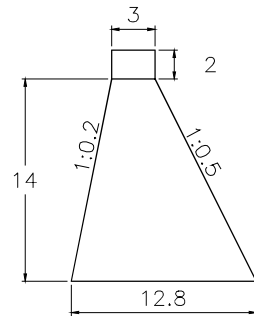
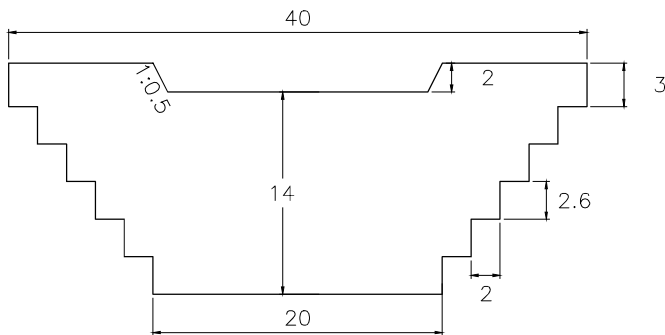

VOLUME: 3,318.00m<sup>3</sup> QUANTITY: 7



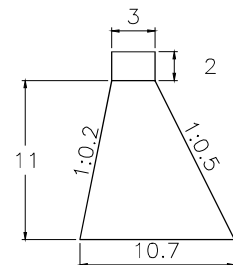
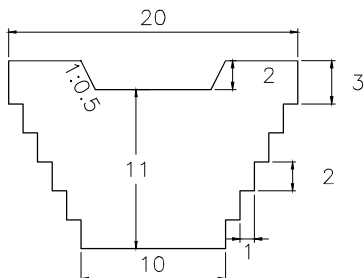

## SUB BASIN 41-1



VOLUME: 1,130.25m<sup>3</sup> QUANTITY: 5

**CHECK DAM**

SCALE 1:500

LEGEND		
FIGURE	COUNTER MEASURE	QUANTITY
	CHECK DAM	60
	CHECK DAM PRIORITY	37
	REVENT WORK	565.48 km
	CENOZOIC ZONE	

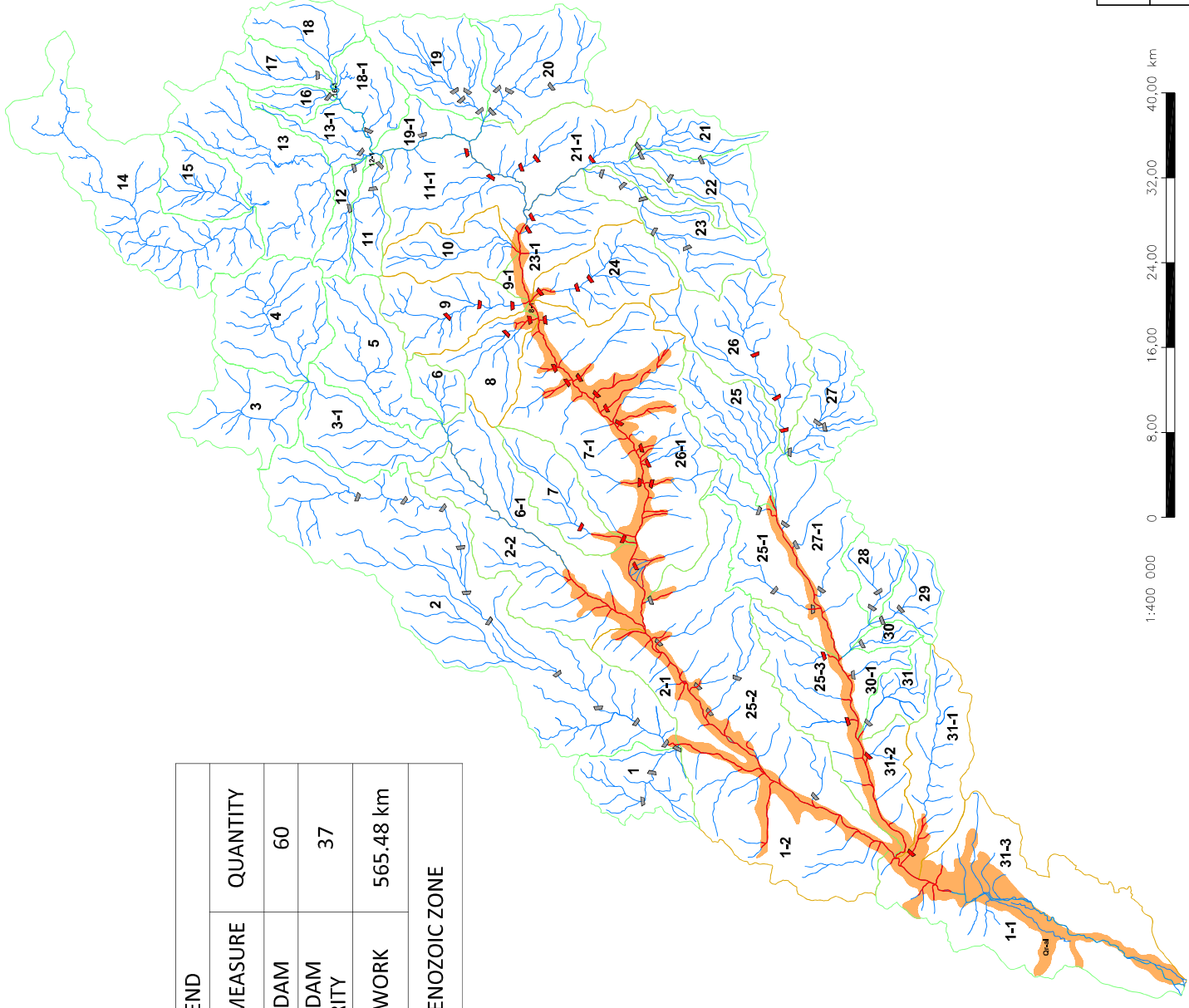

ARRANGEMENT PLAN OF COUNTERMEASURE

YAOUCA BASIN

SCALE 1:400 000

1:400 000 0 8,00 16,00 24,00 32,00 40,00 km



# YAUCA RIVER

## SUB BASIN 1

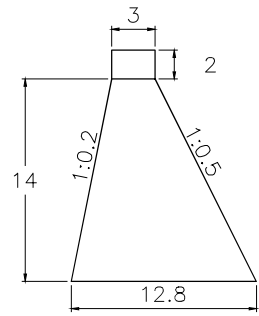
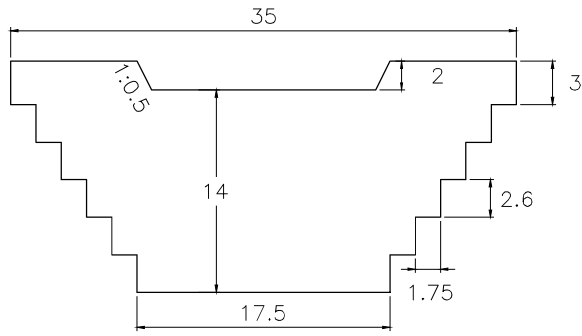

VOLUME: 2,903.25m<sup>3</sup> QUANTITY: 3

## SUB BASIN 2

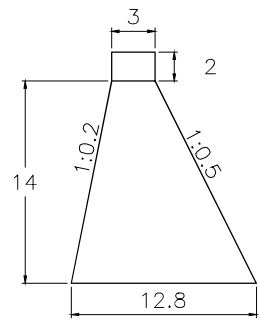
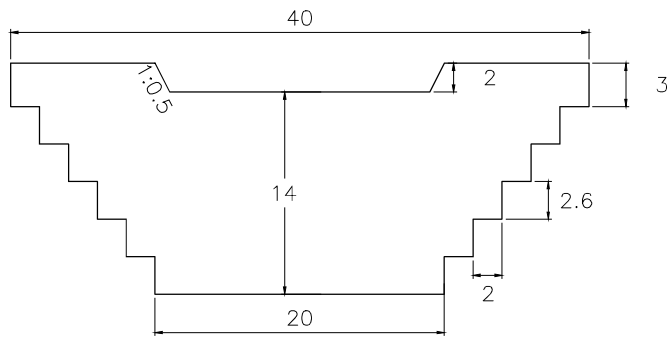

VOLUME: 3,318.00m<sup>3</sup> QUANTITY: 10

## SUB BASIN 7

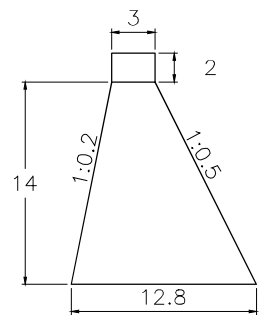
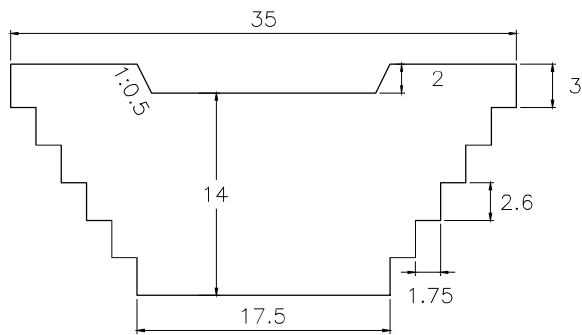

VOLUME: 2,903.25m<sup>3</sup> QUANTITY: 2

### CHECK DAM

SCALE 1:500

# YAUCA RIVER

## SUB BASIN 7-1

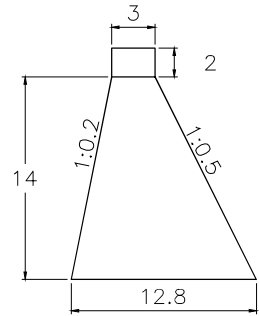
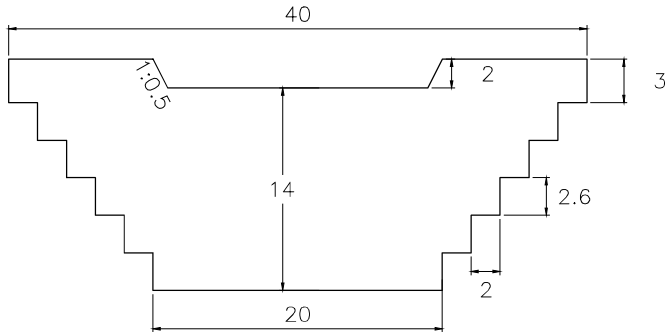

VOLUME: 3,318.00m<sup>3</sup> QUANTITY: 3

## SUB BASIN 8

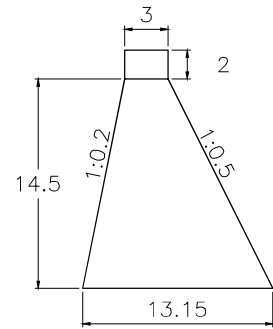
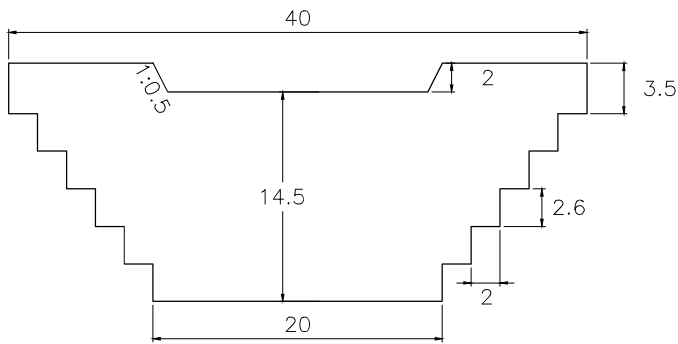

VOLUME: 3,512.70m<sup>3</sup> QUANTITY: 2

## SUB BASIN 9

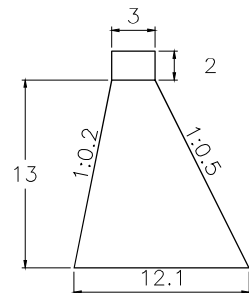
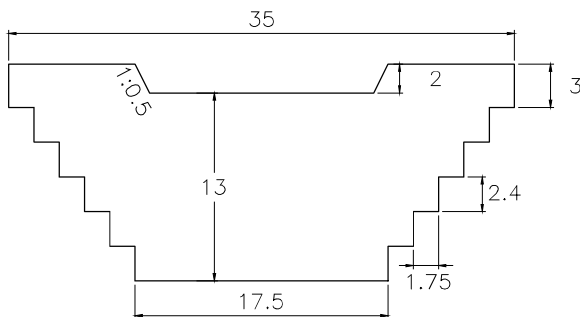

VOLUME: 2,576.44m<sup>3</sup> QUANTITY: 3

**CHECK DAM**

SCALE 1:500

# YAUCA RIVER

## SUB BASIN 11

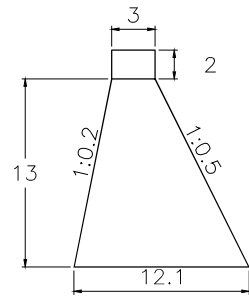
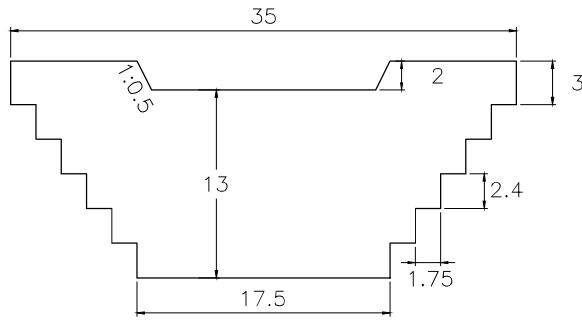

VOLUME: 2,576.44m<sup>3</sup> QUANTITY: 2

## SUB BASIN 11-1

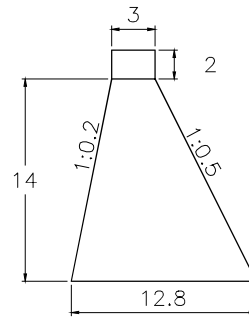
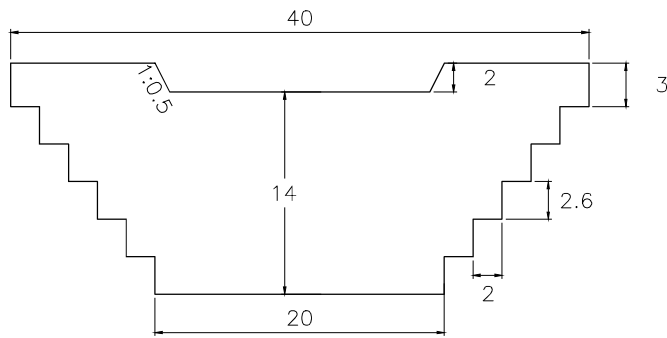

VOLUME: 3,318.00m<sup>3</sup> QUANTITY: 2

## SUB BASIN 12

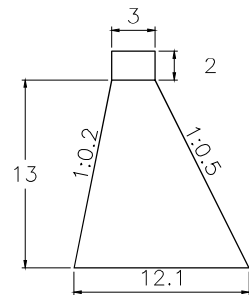
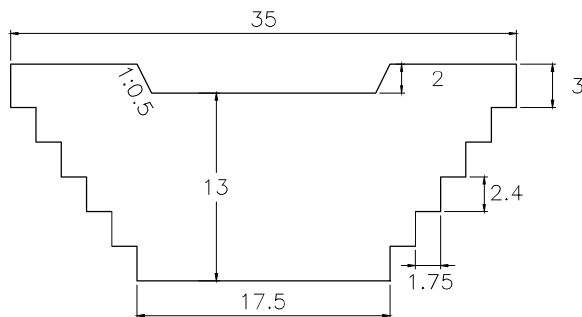

VOLUME: 2,576.44m<sup>3</sup> QUANTITY: 2

**CHECK DAM**

SCALE 1:500

# YAUCA RIVER

## SUB BASIN 13-1

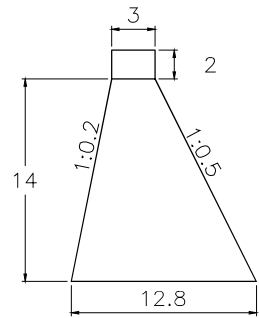
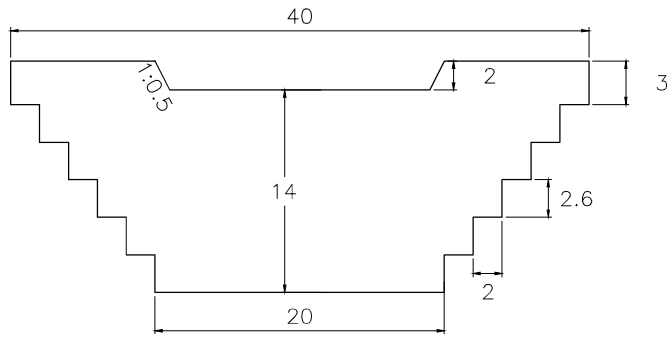

VOLUME: 3,318.00m<sup>3</sup> QUANTITY: 1

## SUB BASIN 16

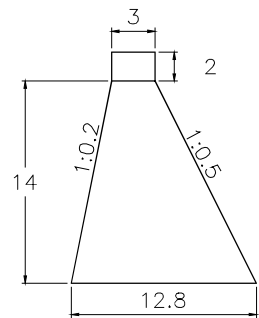
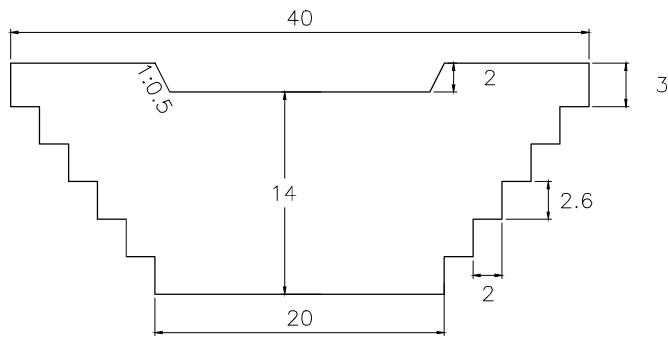

VOLUME: 3,318.00m<sup>3</sup> QUANTITY: 1

## SUB BASIN 17

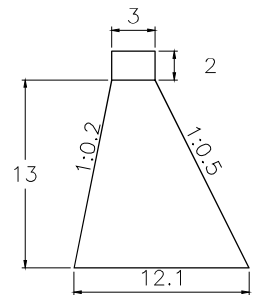
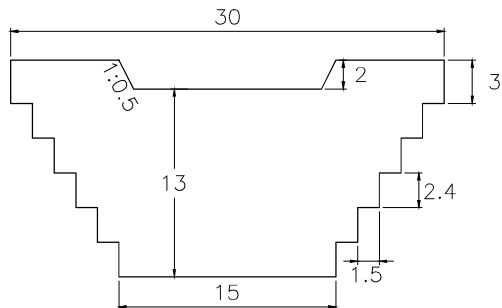

VOLUME: 2,208.38m<sup>3</sup> QUANTITY: 1

**CHECK DAM**

SCALE 1:500

# YAUCA RIVER

## SUB BASIN 18-1

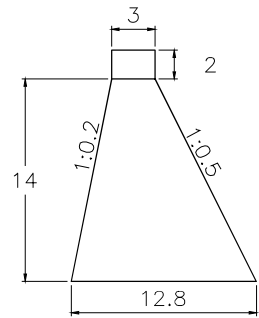
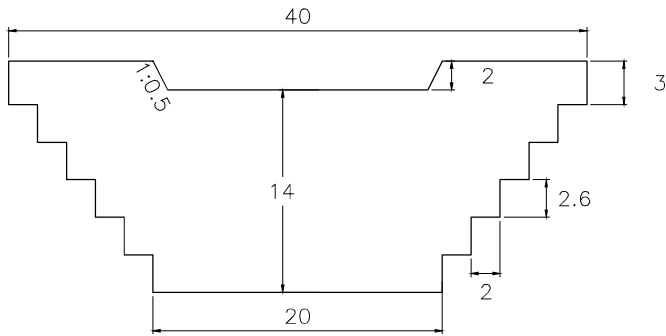

VOLUME: 3,318.00m<sup>3</sup> QUANTITY: 1

## SUB BASIN 19

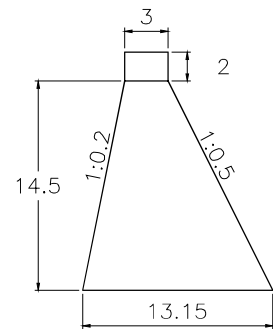
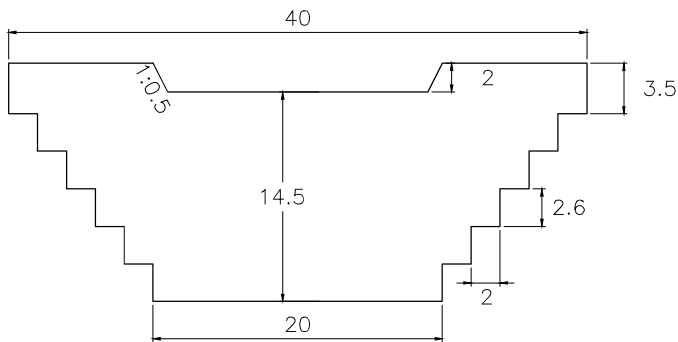

VOLUME: 3,512.70m<sup>3</sup> QUANTITY: 4

## SUB BASIN 19-1

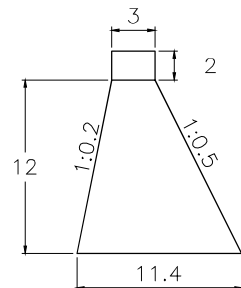
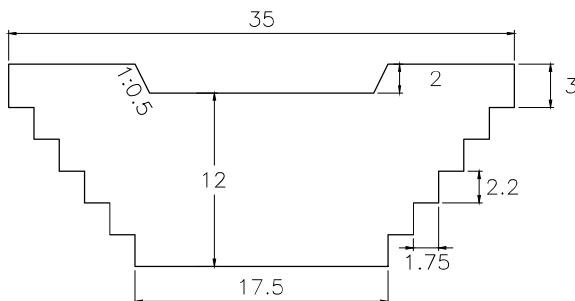

VOLUME: 2,268.00m<sup>3</sup> QUANTITY: 1

**CHECK DAM**

SCALE 1:500

# YAUCA RIVER

## SUB BASIN 20

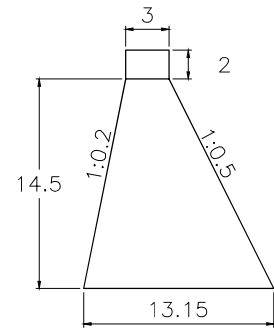
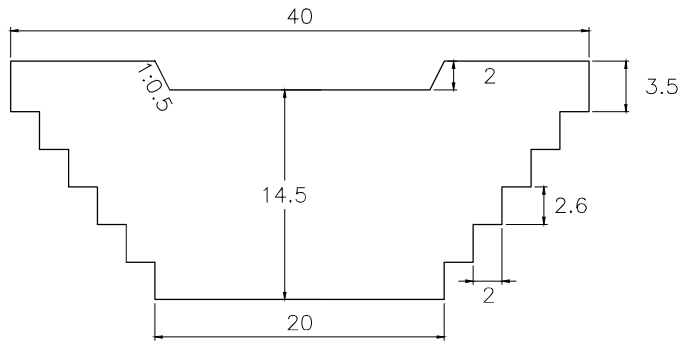

VOLUME: 3,512.70m<sup>3</sup> QUANTITY: 4

## SUB BASIN 21

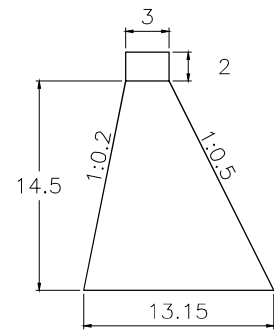
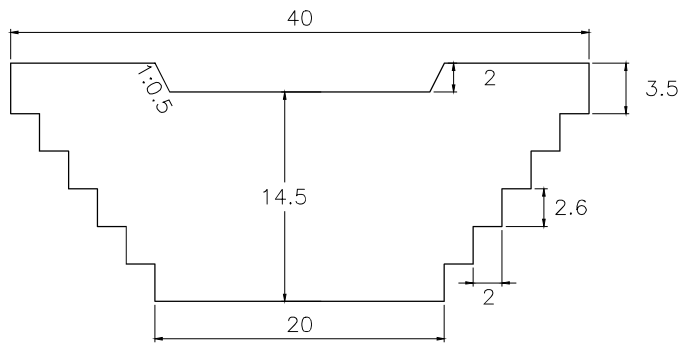

VOLUME: 3,512.70m<sup>3</sup> QUANTITY: 1

## SUB BASIN 21-1

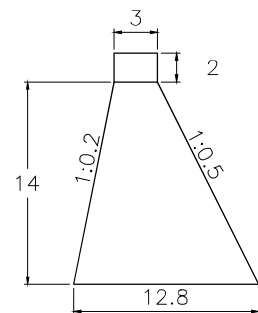
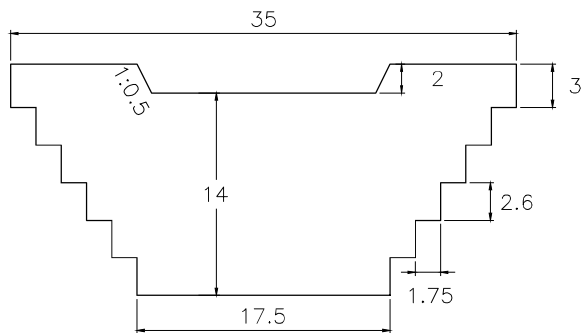

VOLUME: 2,903.25m<sup>3</sup> QUANTITY: 3

**CHECK DAM**

SCALE 1:500

# YAUCA RIVER

## SUB BASIN 22

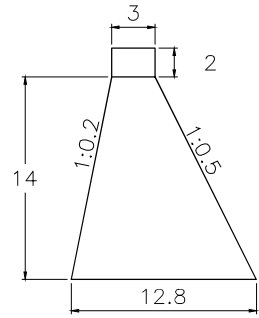
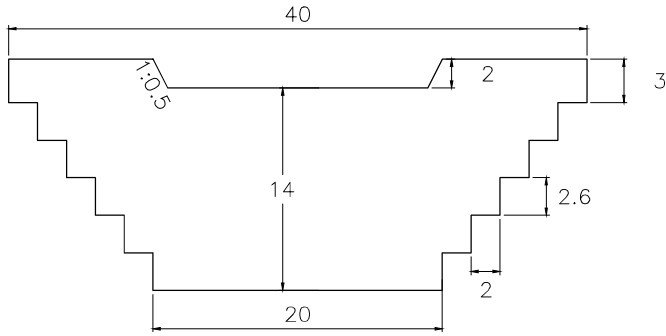

VOLUME: 3,318.00m<sup>3</sup> QUANTITY: 3

## SUB BASIN 23

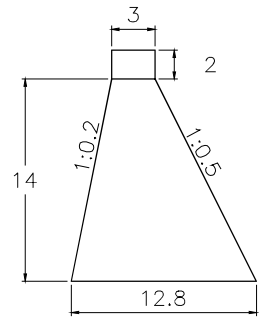
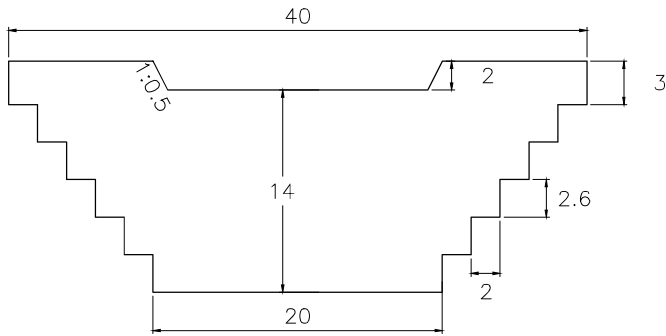

VOLUME: 3,318.00m<sup>3</sup> QUANTITY: 5

## SUB BASIN 23-1

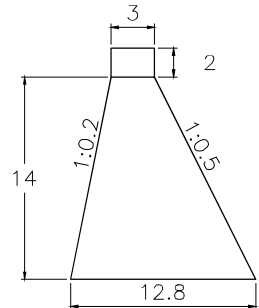
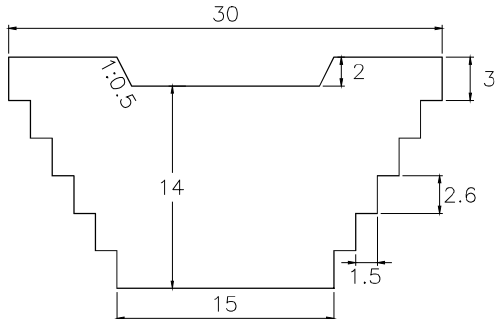

VOLUME: 2,488.50m<sup>3</sup> QUANTITY: 2

**CHECK DAM**

SCALE 1:500

# YAUCA RIVER

## SUB BASIN 24

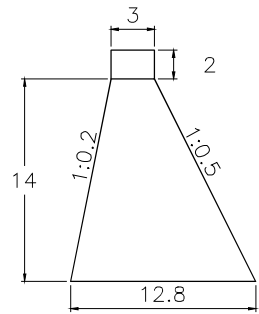
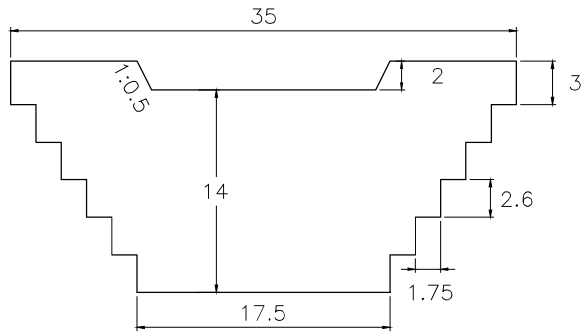

VOLUME: 2,903.25m<sup>3</sup> QUANTITY: 3

## SUB BASIN 25-1

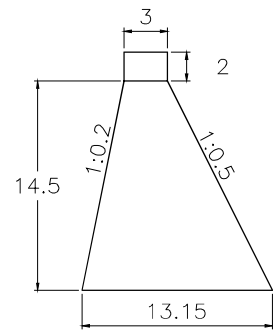
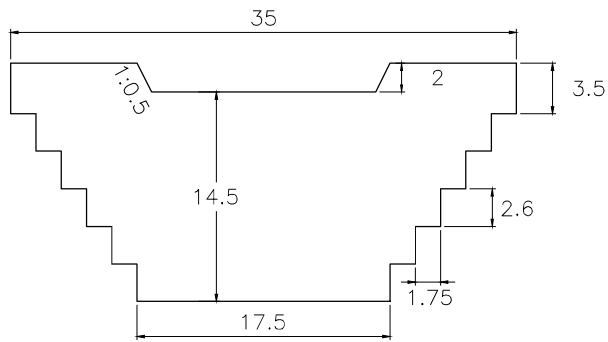

VOLUME: 3,073.61m<sup>3</sup> QUANTITY: 3

## SUB BASIN 25-2

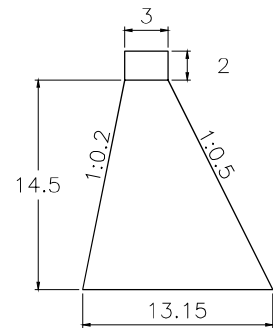
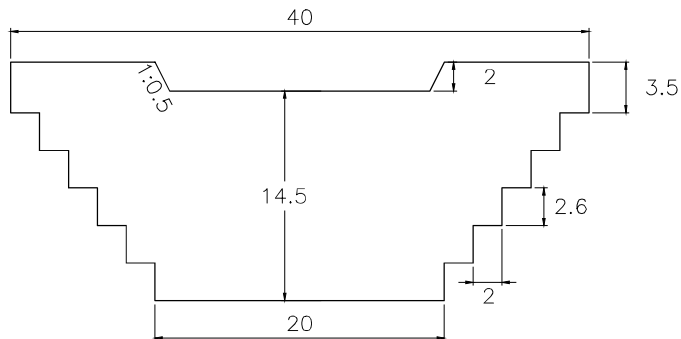

VOLUME: 3,512.70m<sup>3</sup> QUANTITY: 6

**CHECK DAM**

SCALE 1:500



# YAUCA RIVER

## SUB BASIN 25-3

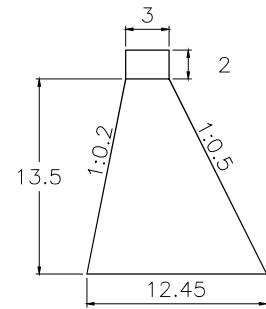
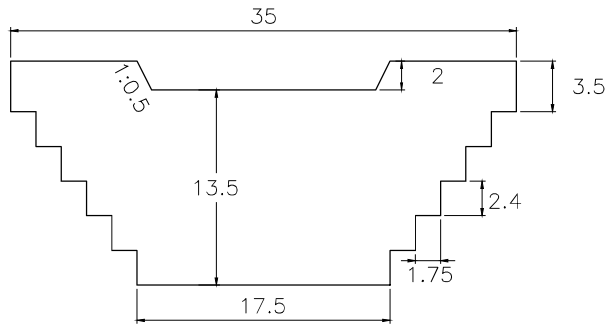

VOLUME: 2,737.61m<sup>3</sup> QUANTITY: 2

## SUB BASIN 26

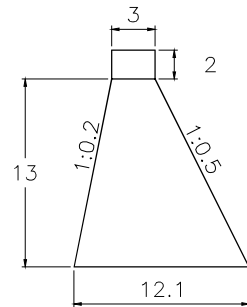
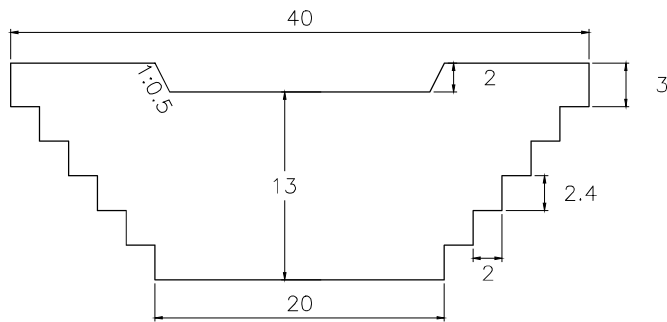

VOLUME: 2,944.50m<sup>3</sup> QUANTITY: 3

## SUB BASIN 26-1

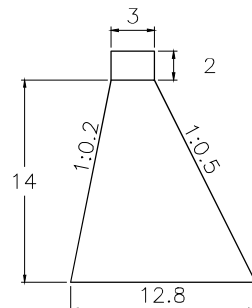
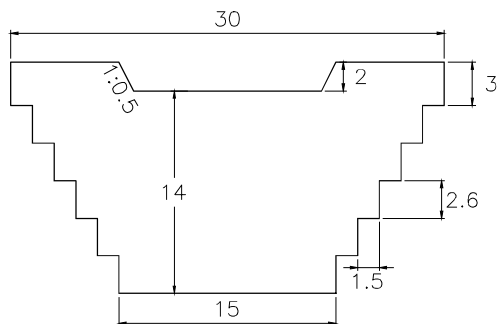

VOLUME: 2,488.50m<sup>3</sup> QUANTITY: 9

**CHECK DAM**

SCALE 1:500

# YAUCA RIVER

## SUB BASIN 27

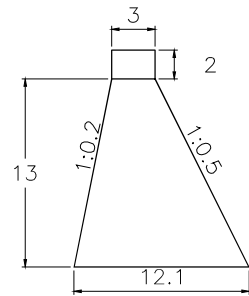
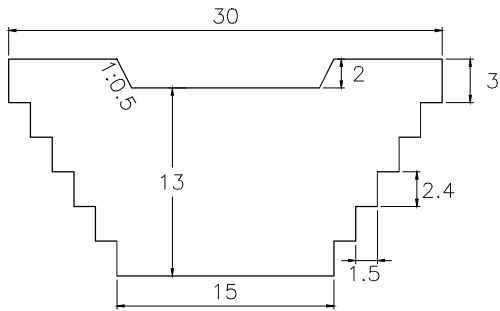

VOLUME: 2,208.38m<sup>3</sup> QUANTITY: 3

## SUB BASIN 26

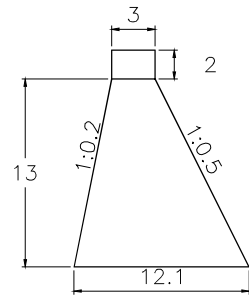
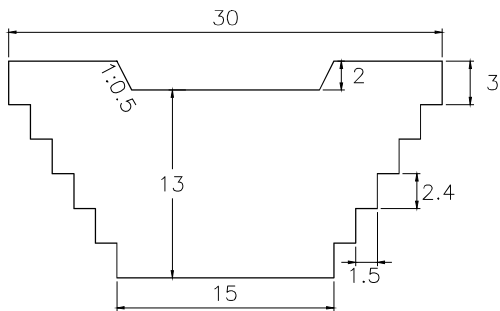

VOLUME: 2,208.38m<sup>3</sup> QUANTITY: 3

## SUB BASIN 28

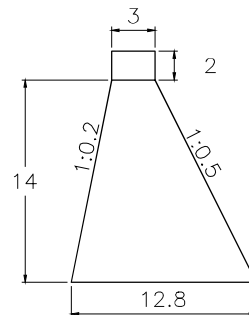
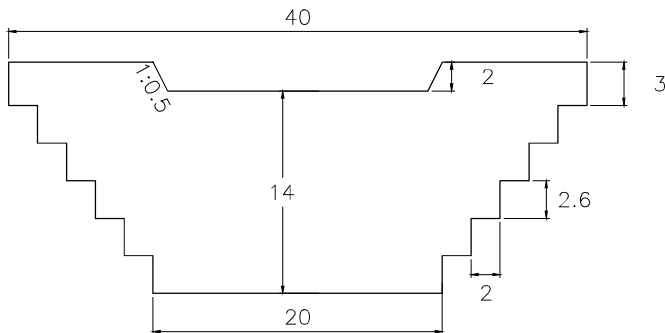

VOLUME: 3,318.00m<sup>3</sup> QUANTITY: 2

**CHECK DAM**

SCALE 1:500

# YAUCA RIVER

## SUB BASIN 29

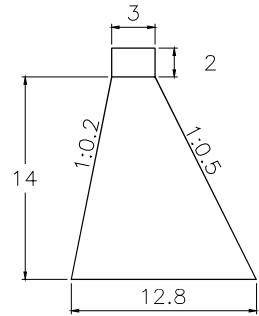
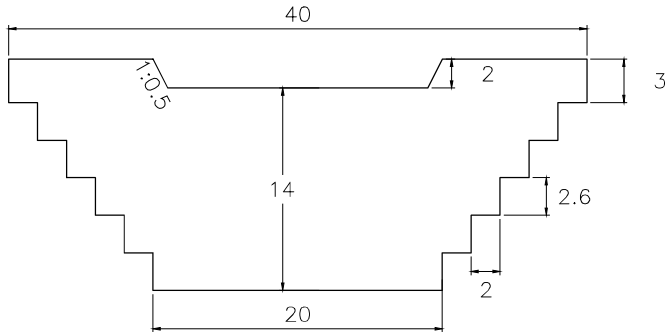

VOLUME: 3,318.00m<sup>3</sup> QUANTITY: 2

## SUB BASIN 30

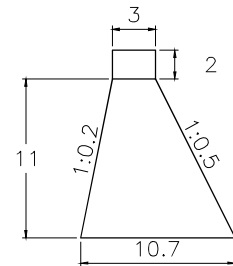
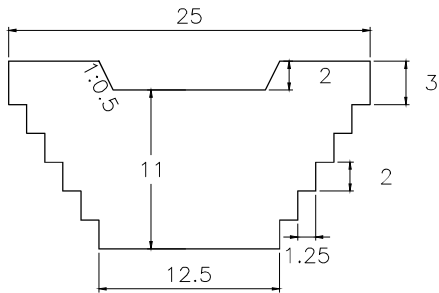

VOLUME: 1,412.81m<sup>3</sup> QUANTITY: 1

## SUB BASIN 30-1

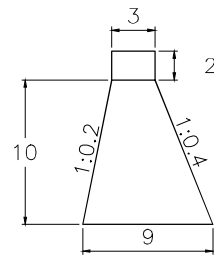
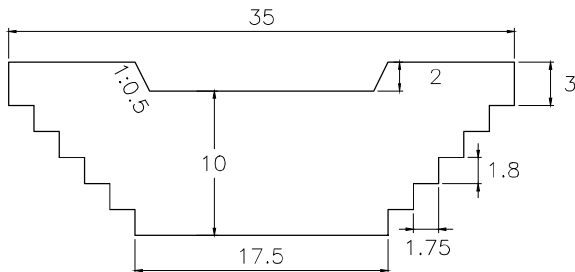

VOLUME: 1,575.00m<sup>3</sup> QUANTITY: 1

**CHECK DAM**

SCALE 1:500

# YAUCA RIVER

## SUB BASIN 31

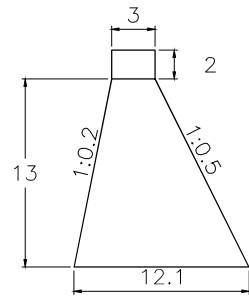
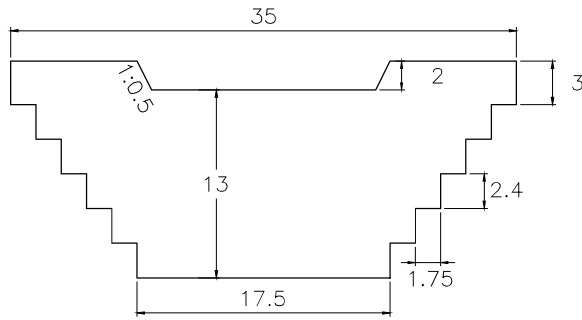

VOLUME: 2,576.44m<sup>3</sup> QUANTITY: 1

## SUB BASIN 31-1

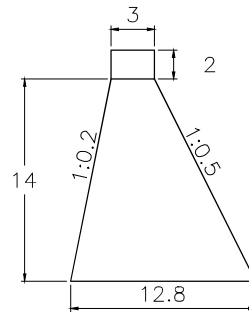
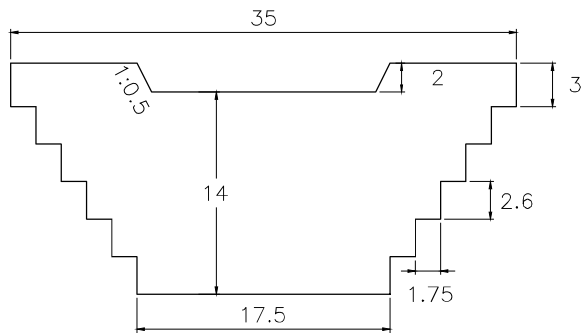

VOLUME: 2,903.25m<sup>3</sup> QUANTITY: 1

## SUB BASIN 31-2

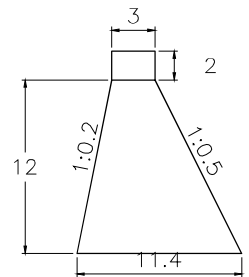
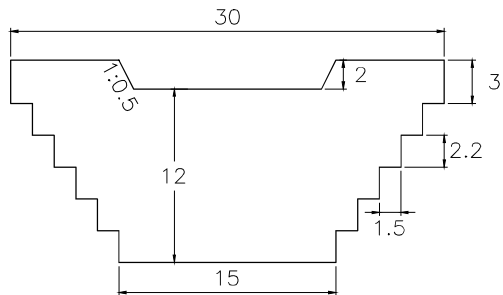



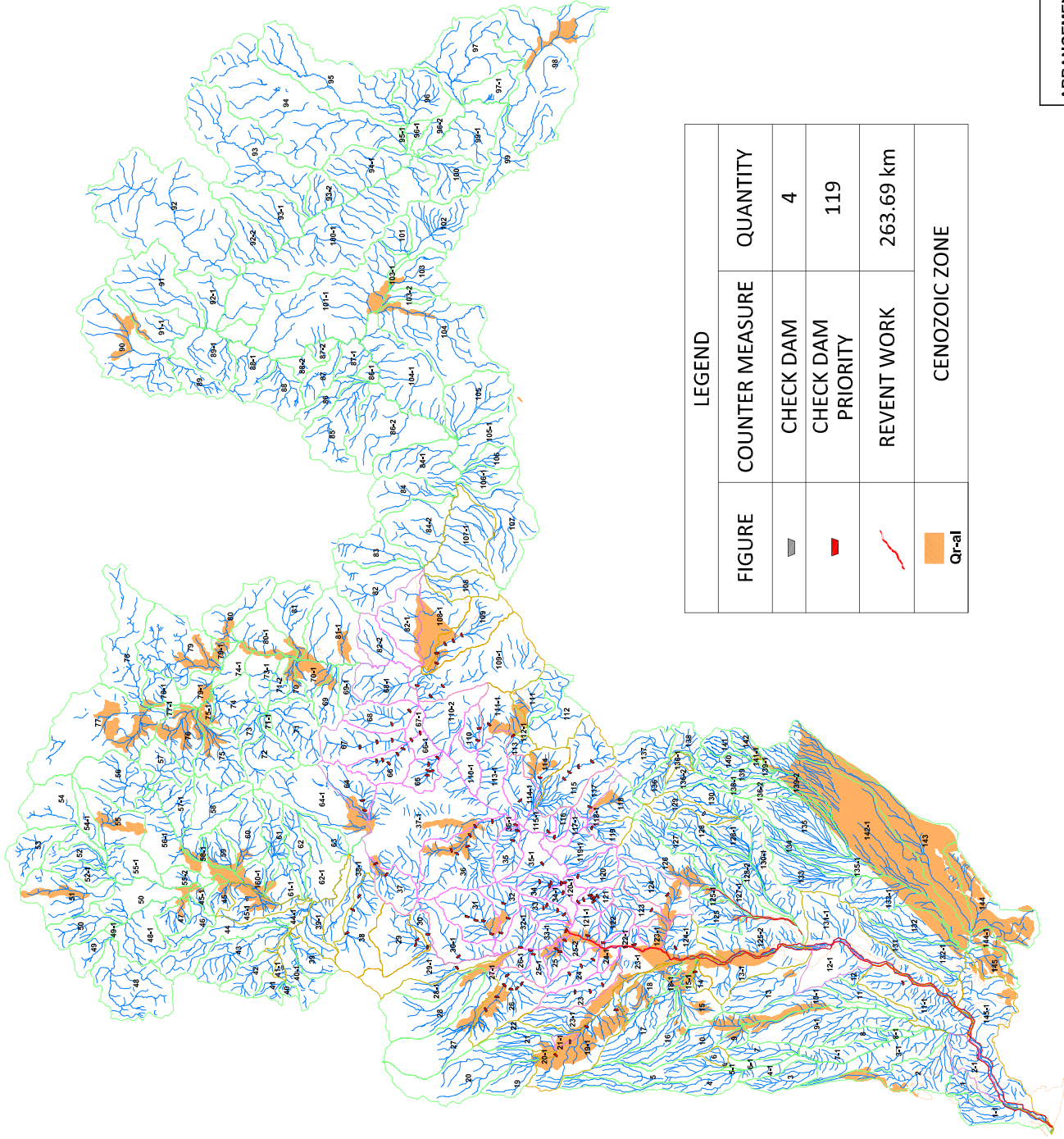

VOLUME: 1,944.00m<sup>3</sup> QUANTITY: 1

**CHECK DAM**

SCALE 1:500



LEGEND			
FIGURE	COUNTER MEASURE	QUANTITY	
	CHECK DAM	4	
	CHECK DAM PRIORITY	119	
	REVENT WORK	263.69 km	
	CENOZOIC ZONE		

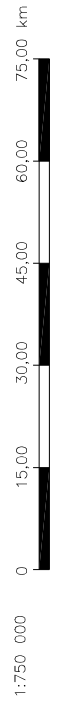

ARRANGEMENT PLAN OF COUNTERMEASURE

CAMAMA MAJES BASIN

SCALE

1:750 000

# CAMANA - MAJES RIVER

## SUB BASIN 6

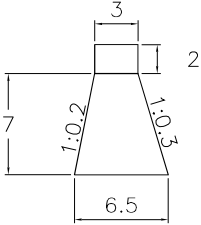
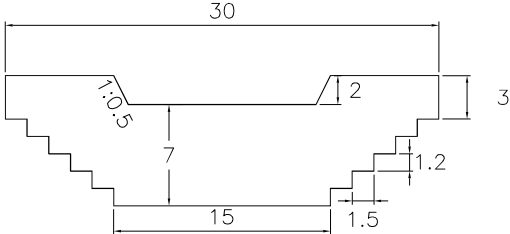

VOLUME: 748.13m<sup>3</sup>    QUANTITY: 1

## SUB BASIN 14

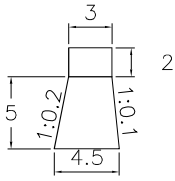
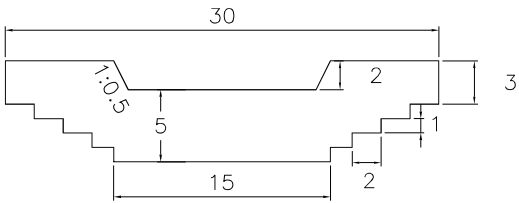

VOLUME: 421.88m<sup>3</sup>    QUANTITY: 1

## SUB BASIN 23

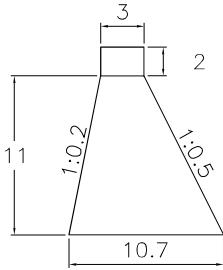
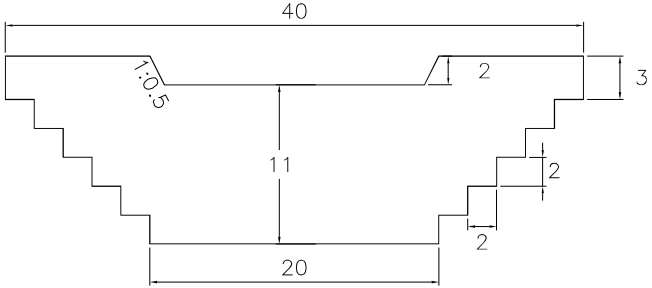

VOLUME: 2,260.50m<sup>3</sup>    QUANTITY: 3

# CHECK DAM

SCALE 1:500

# CAMANA - MAJES RIVER

SUB BASIN 24

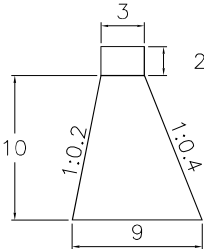
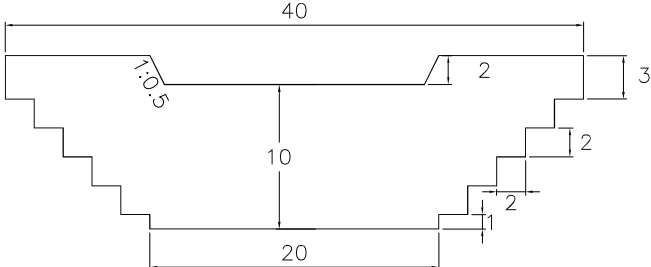

VOLUME: 1,800.00m<sup>3</sup>    QUANTITY: 3

SUB BASIN 25

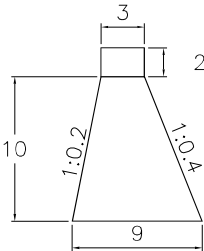
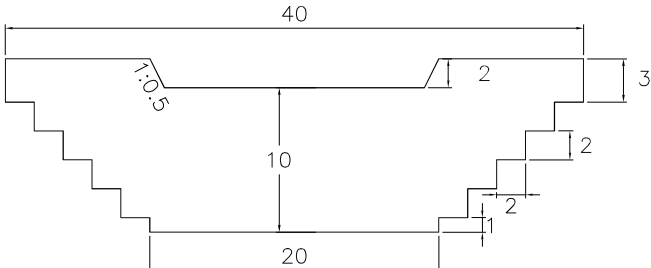

VOLUME: 1,800.00m<sup>3</sup>    QUANTITY: 2

SUB BASIN 26

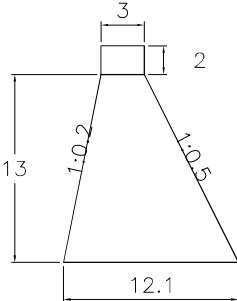
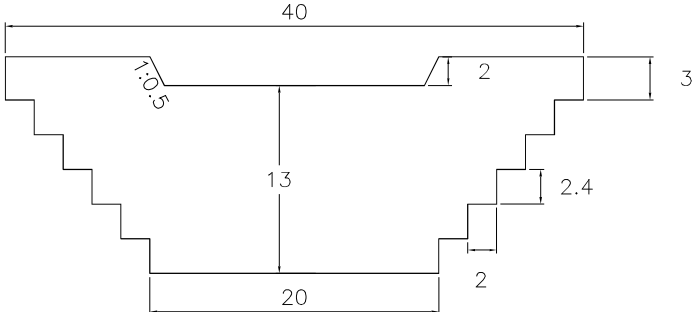

VOLUME: 2,944.50m<sup>3</sup>    QUANTITY: 7

## CHECK DAM

SCALE 1:500

# CAMANA - MAJES RIVER

SUB BASIN 29

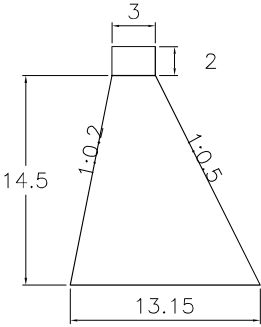
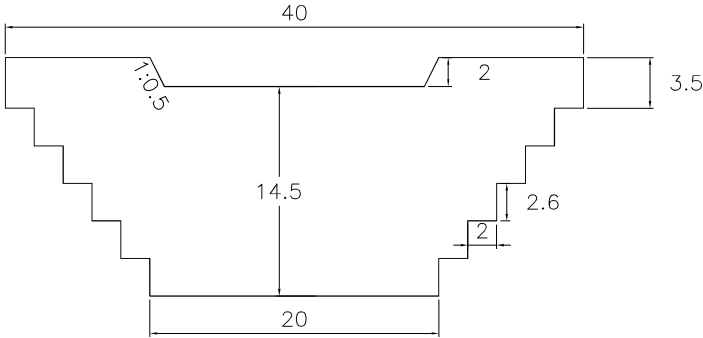

VOLUME: 3,512.70m<sup>3</sup>    QUANTITY: 3

SUB BASIN 30

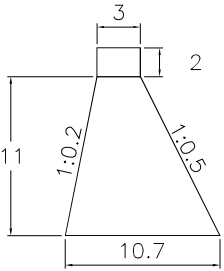
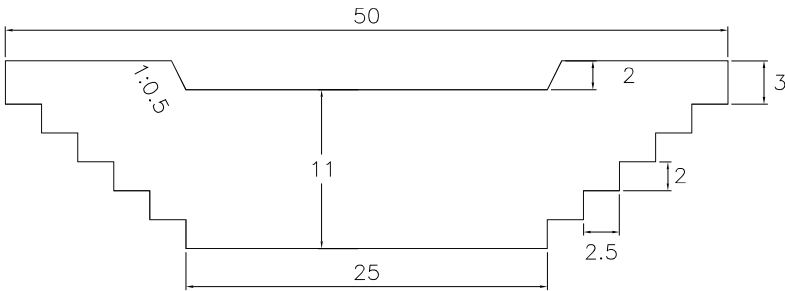

VOLUME: 2,825.63m<sup>3</sup>    QUANTITY: 1

SUB BASIN 31

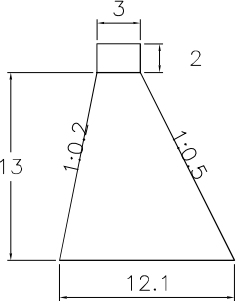
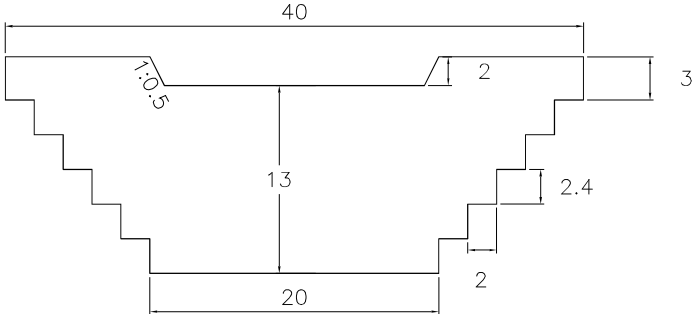

VOLUME: 2,944.50m<sup>3</sup>    QUANTITY: 4

## CHECK DAM

SCALE 1:500



# CAMANA - MAJES RIVER

SUB BASIN 32

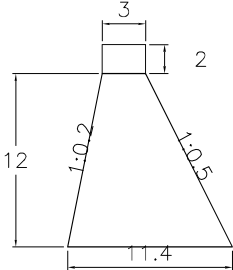
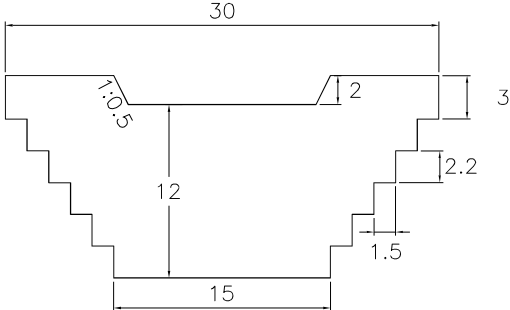

VOLUME: 1,944.00m<sup>3</sup>    QUANTITY: 3

SUB BASIN 33

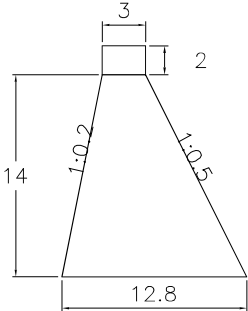
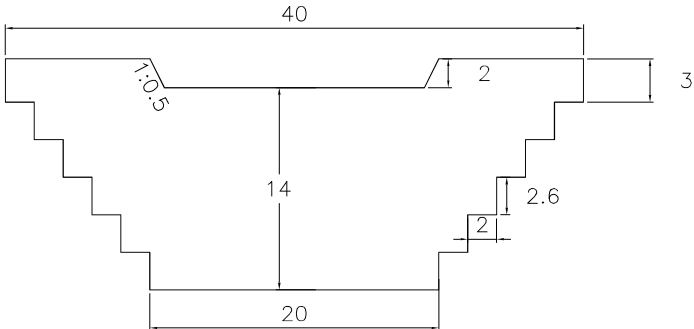

VOLUME: 3,318.00m<sup>3</sup>    QUANTITY: 4

SUB BASIN 34

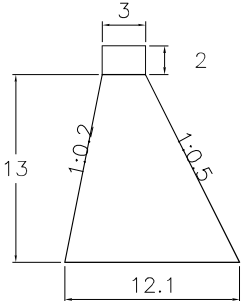
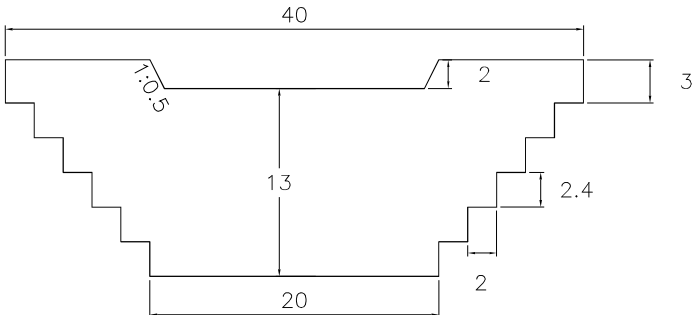

VOLUME: 2,944.50m<sup>3</sup>    QUANTITY: 4

## CHECK DAM

SCALE 1:500

# CAMANA - MAJES RIVER

SUB BASIN 35

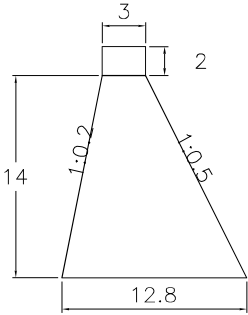
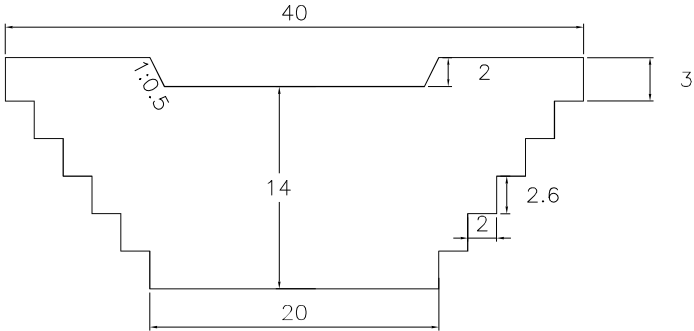

VOLUME: 3,318.00m<sup>3</sup> QUANTITY: 2

SUB BASIN 36

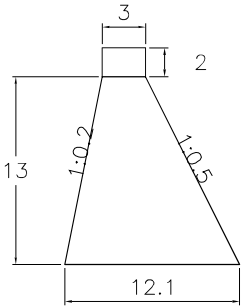
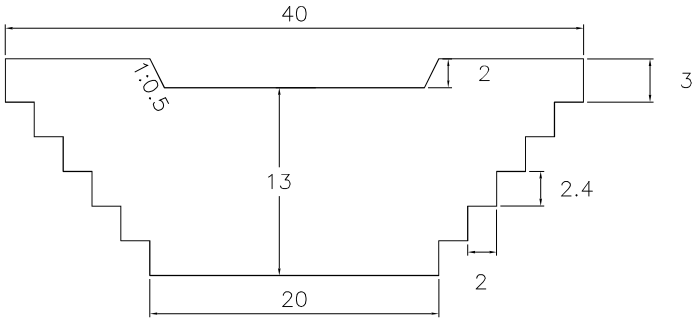

VOLUME: 2,944.50m<sup>3</sup> QUANTITY: 6

SUB BASIN 37

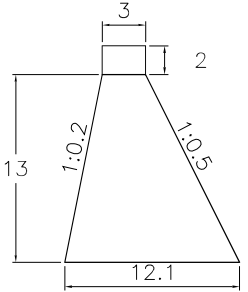
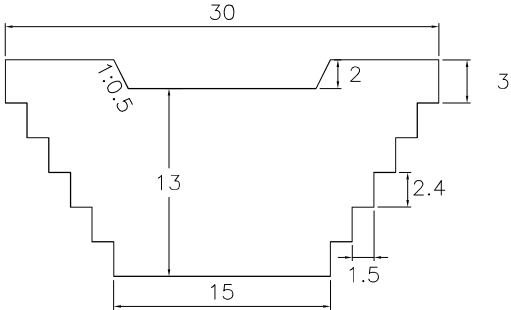

VOLUME: 2,208.38m<sup>3</sup> QUANTITY: 2

**CHECK DAM**

SCALE 1:500

# CAMANA - MAJES RIVER

SUB BASIN 38

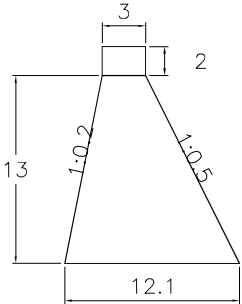
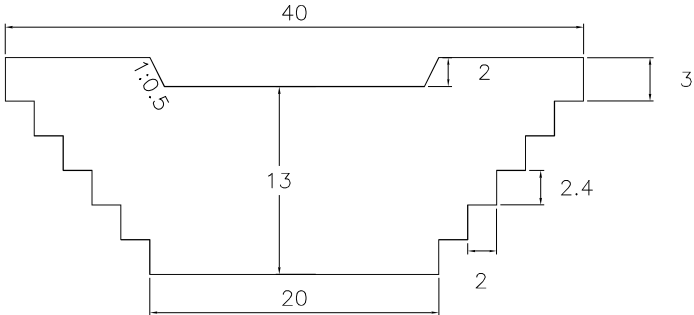

VOLUME: 2,944.50m<sup>3</sup>    QUANTITY: 3

SUB BASIN 64

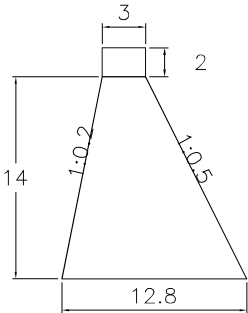
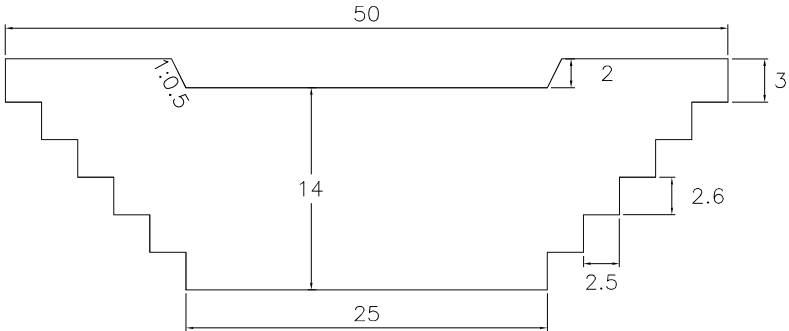

VOLUME: 4,147.50m<sup>3</sup>    QUANTITY: 2

SUB BASIN 65

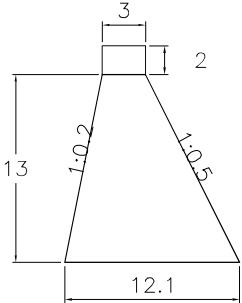
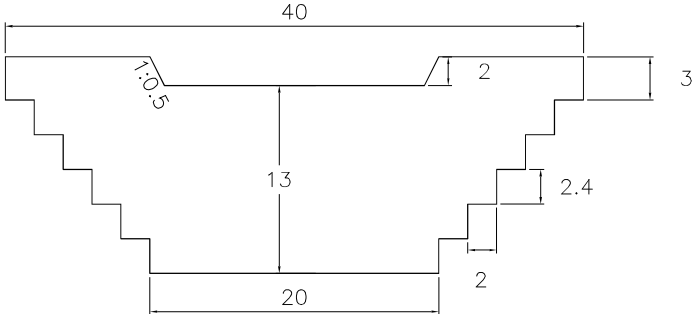

VOLUME: 2,944.50m<sup>3</sup>    QUANTITY: 1

## CHECK DAM

SCALE 1:500

# CAMANA - MAJES RIVER

SUB BASIN 66

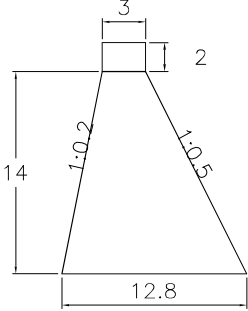
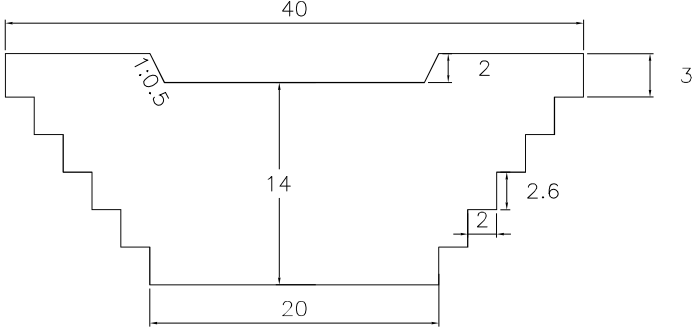

VOLUME: 3,318.00m<sup>3</sup>    QUANTITY: 5

SUB BASIN 67

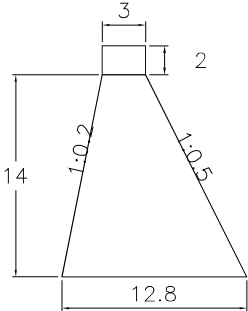
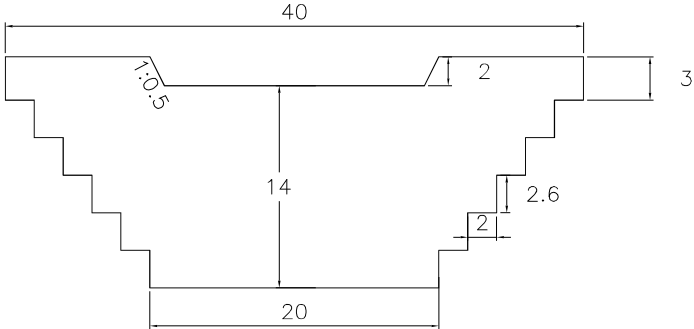

VOLUME: 3,318.00m<sup>3</sup>    QUANTITY: 3

SUB BASIN 68

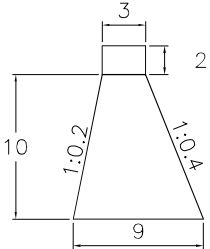
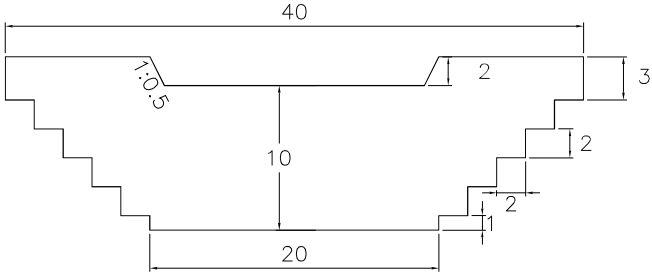

VOLUME: 1,800.00m<sup>3</sup>    QUANTITY: 2

**CHECK DAM**

SCALE 1:500

# CAMANA - MAJES RIVER

SUB BASIN 109

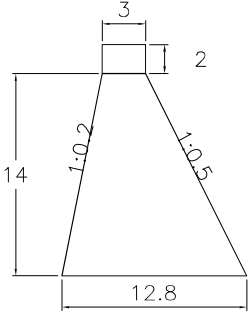
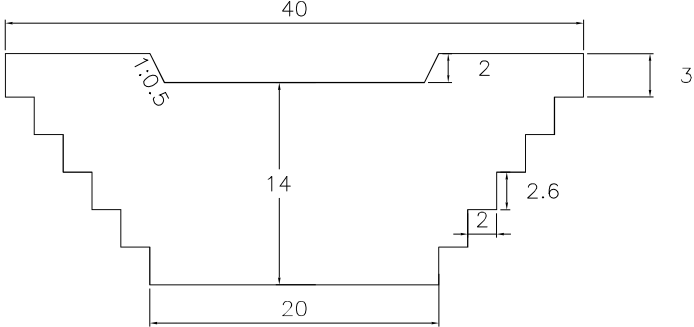

VOLUME: 3,318.00m<sup>3</sup>    QUANTITY: 5

SUB BASIN 110

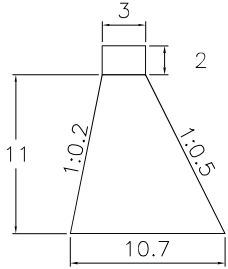
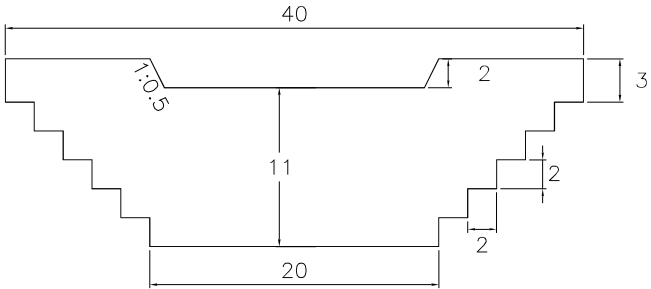

VOLUME: 2,260.50m<sup>3</sup>    QUANTITY: 2

SUB BASIN 113

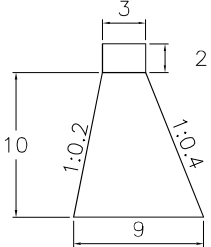
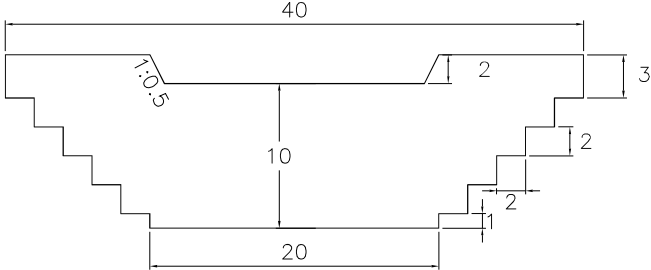

VOLUME: 1,800.00m<sup>3</sup>    QUANTITY: 1

**CHECK DAM**

SCALE 1:500

# CAMANA - MAJES RIVER

SUB BASIN 114

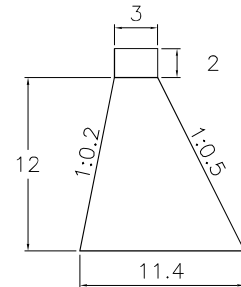
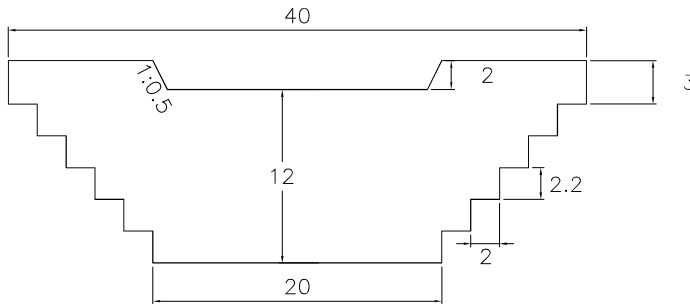

VOLUME: 2,592.00m<sup>3</sup> QUANTITY: 1

SUB BASIN 115

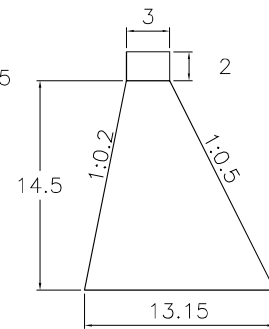
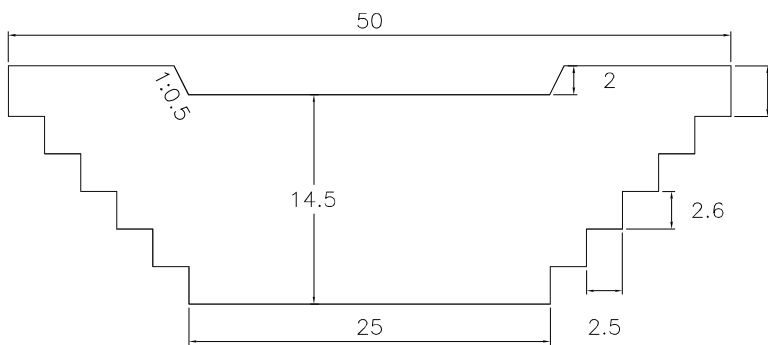

VOLUME: 4,390.88m<sup>3</sup> QUANTITY: 4

SUB BASIN 116

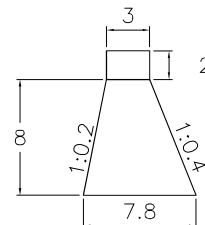
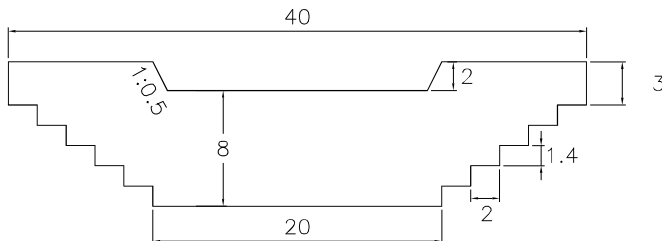

VOLUME: 1296.00m<sup>3</sup> QUANTITY: 1

**CHECK DAM**

SCALE 1:500

# CAMANA - MAJES RIVER

SUB BASIN 117

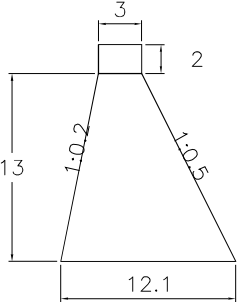
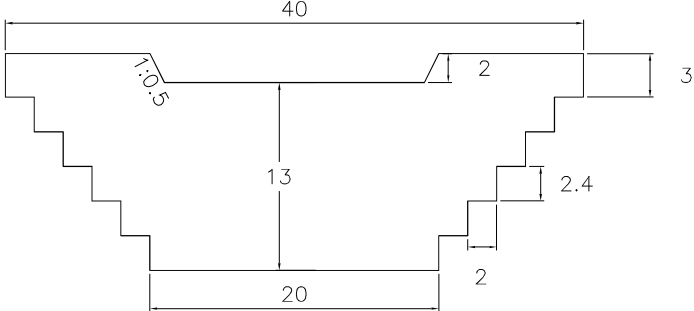

VOLUME: 2,944.50m<sup>3</sup>    QUANTITY: 1

SUB BASIN 119

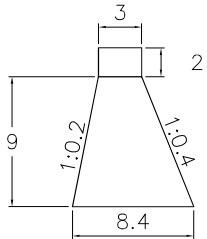
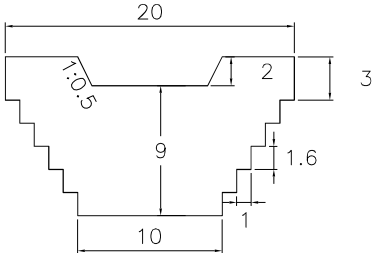

VOLUME: 769.50 m<sup>3</sup>    QUANTITY: 1

SUB BASIN 120

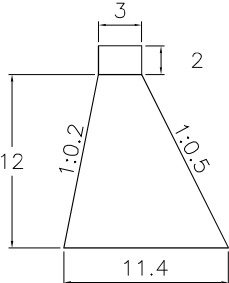
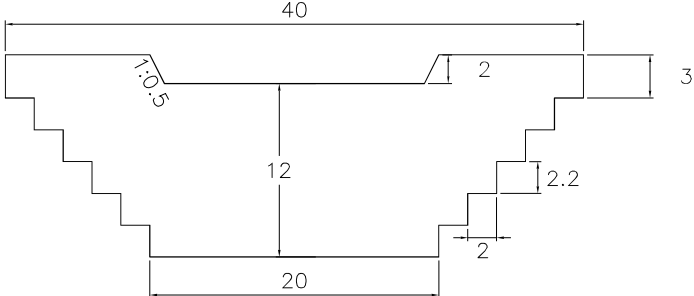

VOLUME: 2,592.00m<sup>3</sup>    QUANTITY: 1

**CHECK DAM**

SCALE 1:500

# CAMANA - MAJES RIVER

SUB BASIN 121

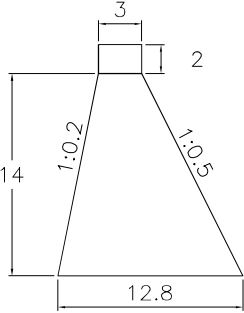
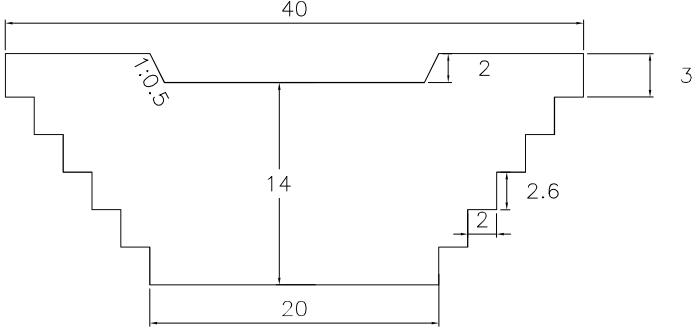

VOLUME: 3,318.00m<sup>3</sup>    QUANTITY: 7

SUB BASIN 122

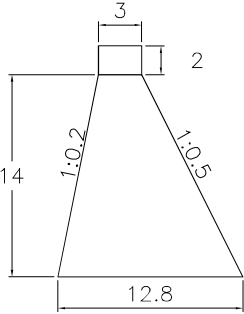
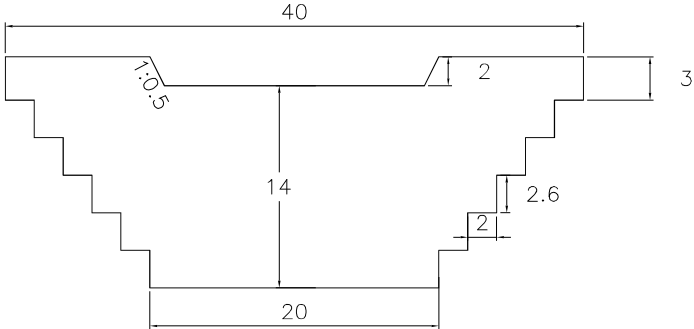

VOLUME: 3,318.00m<sup>3</sup>    QUANTITY: 1

SUB BASIN 123

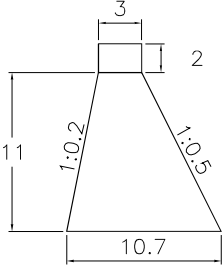
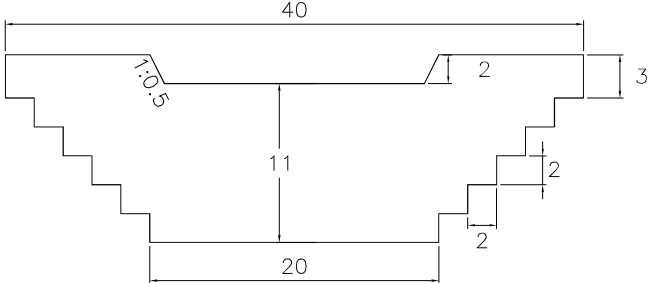

VOLUME: 2,260.50m<sup>3</sup>    QUANTITY: 1

**CHECK DAM**

SCALE 1:500



# CAMANA - MAJES RIVER

SUB BASIN 124

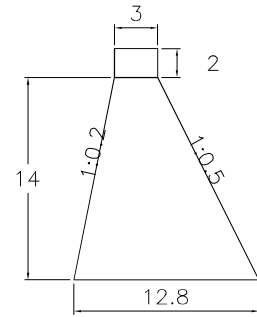
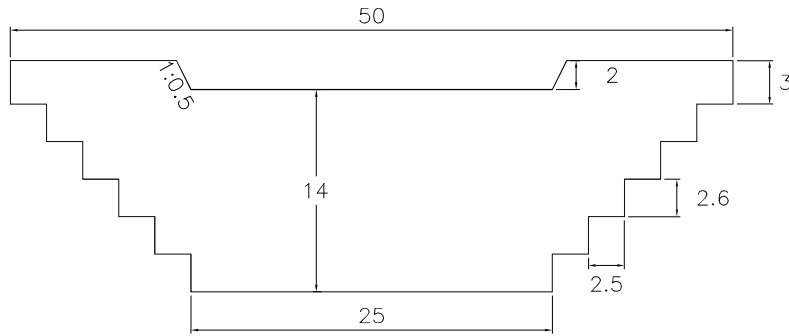

VOLUME: 4,147.50m<sup>3</sup> QUANTITY: 1

SUB BASIN 129

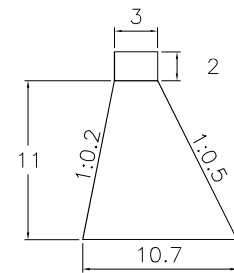
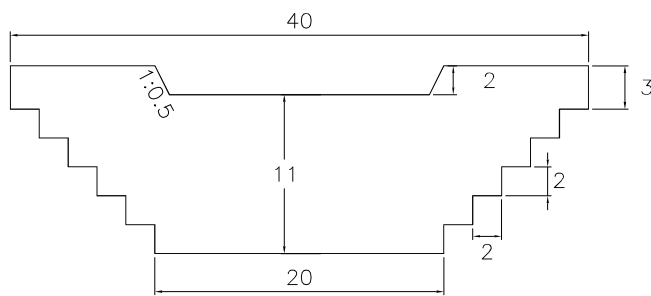

VOLUME: 2,260.50m<sup>3</sup> QUANTITY: 1

SUB BASIN 11-1

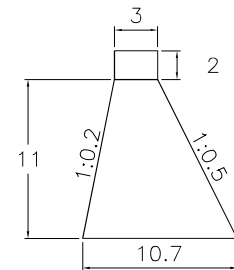
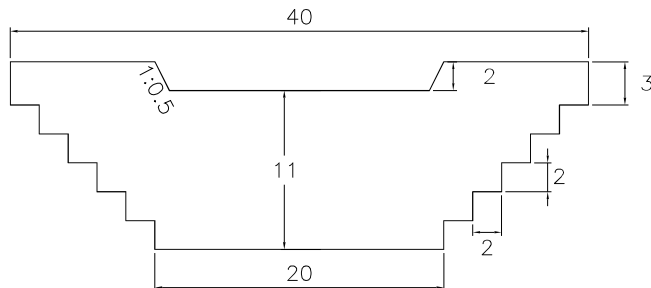

VOLUME: 2,260.50m<sup>3</sup> QUANTITY: 1

**CHECK DAM**

SCALE 1:500

# CAMANA - MAJES RIVER

SUB BASIN 19-1

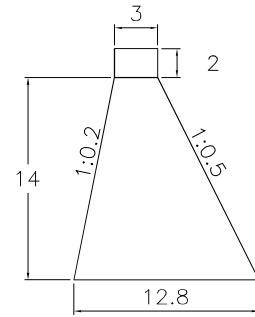
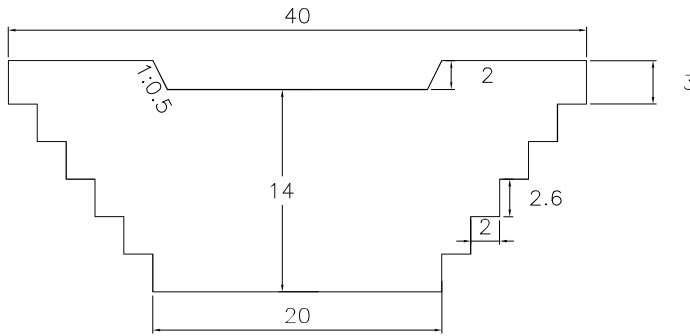

VOLUME: 3,318.00m<sup>3</sup> QUANTITY: 2

SUB BASIN 20-1

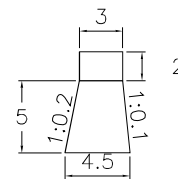
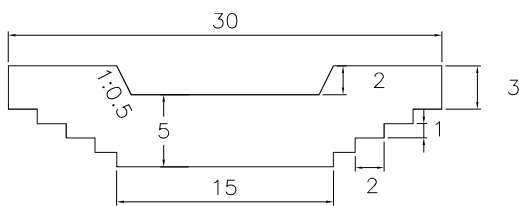

VOLUME: 421.88m<sup>3</sup> QUANTITY: 1

SUB BASIN 21-1

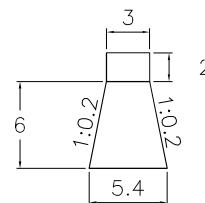
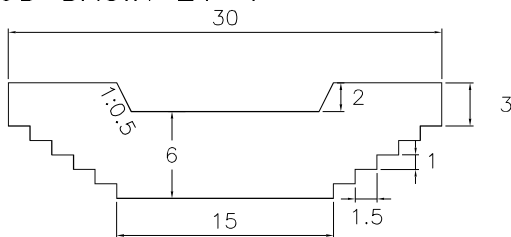

VOLUME: 567.00m<sup>3</sup> QUANTITY: 1

**CHECK DAM**

SCALE 1:500

# CAMANA - MAJES RIVER

SUB BASIN 25-1

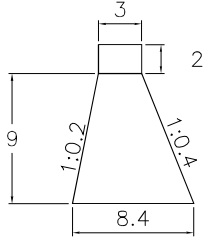
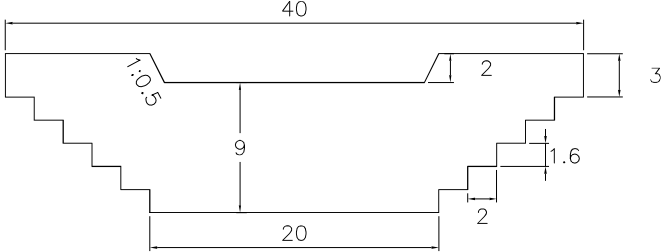

VOLUME: 1,539.00m<sup>3</sup>    QUANTITY: 1

SUB BASIN 25-2

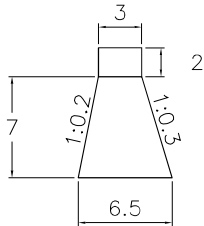
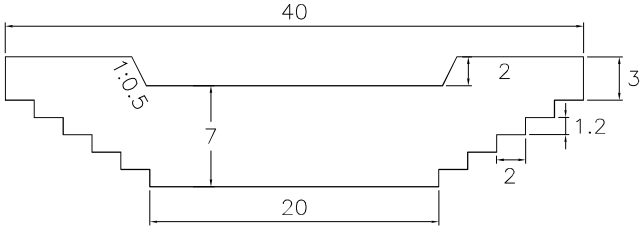

VOLUME: 997.50m<sup>3</sup>    QUANTITY: 1

SUB BASIN 26-1

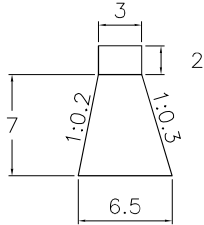
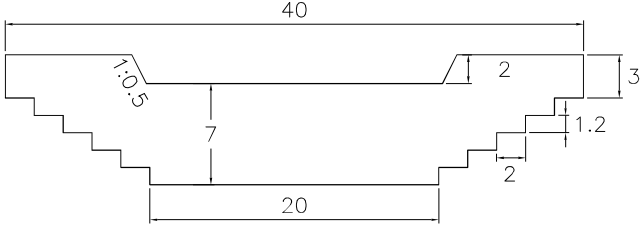

VOLUME: 997.50m<sup>3</sup>    QUANTITY: 1

## CHECK DAM

SCALE 1:500

# CAMANA - MAJES RIVER

SUB BASIN 29-1

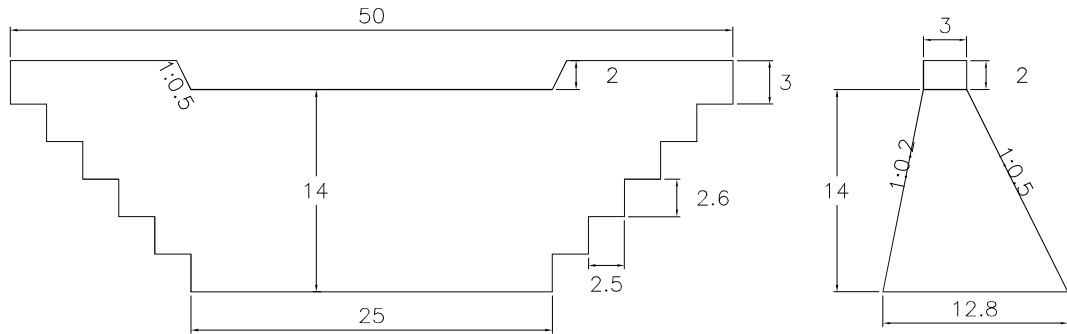

VOLUME: 4,147.50m<sup>3</sup> QUANTITY: 1

SUB BASIN 30-1

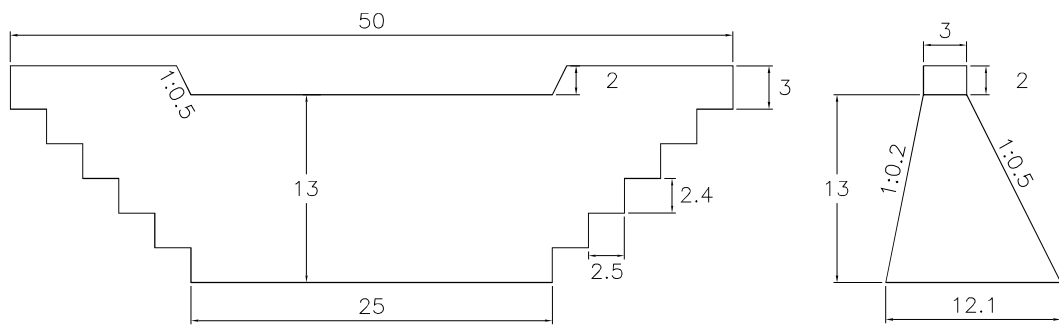

VOLUME: 3,680.63m<sup>3</sup> QUANTITY: 1

SUB BASIN 32-1

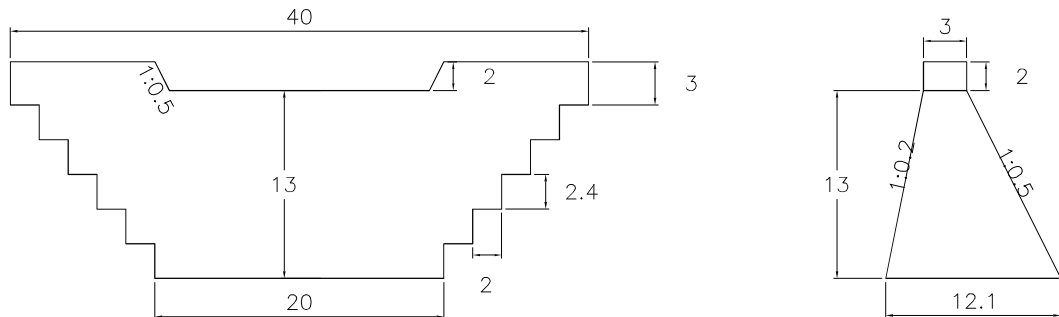

VOLUME: 2,944.50m<sup>3</sup> QUANTITY: 1

**CHECK DAM**

SCALE 1:500

# CAMANA - MAJES RIVER

SUB BASIN 33-1

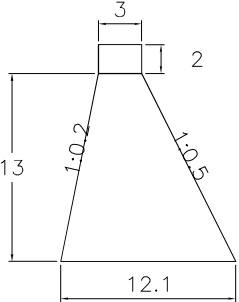
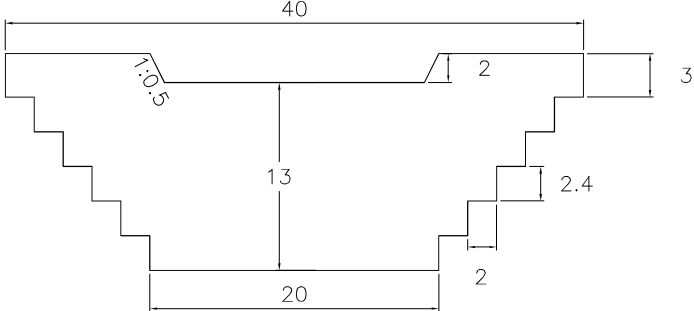

VOLUME: 2,944.50m<sup>3</sup>    QUANTITY: 1

SUB BASIN 34-1

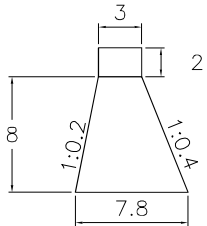
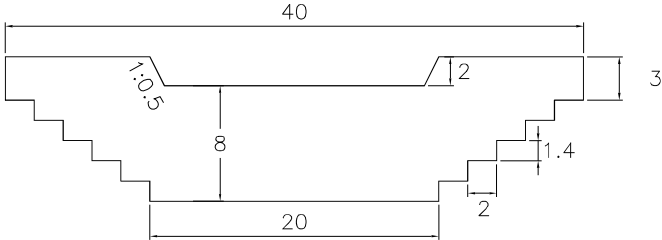

VOLUME: 1296.00m<sup>3</sup>    QUANTITY: 1

SUB BASIN 35-1

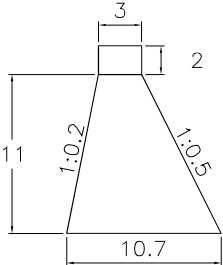
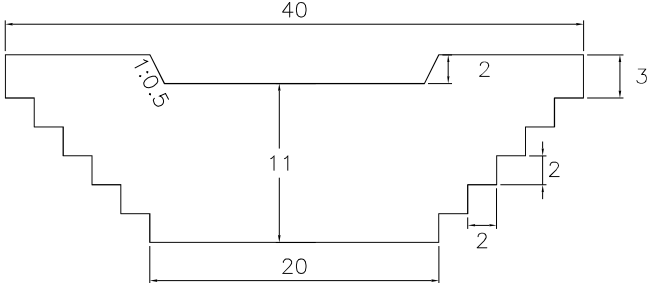

VOLUME: 2,260.50m<sup>3</sup>    QUANTITY: 1

**CHECK DAM**

SCALE 1:500

# CAMANA - MAJES RIVER

SUB BASIN 36-1

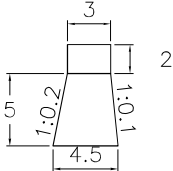
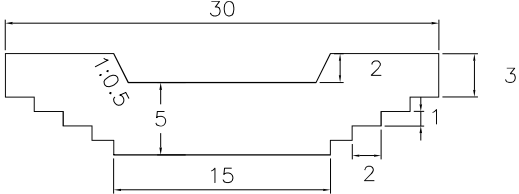

VOLUME: 421.88m<sup>3</sup>    QUANTITY: 1

SUB BASIN 41-1

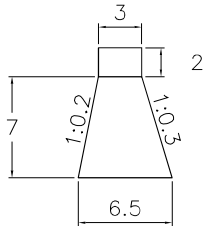
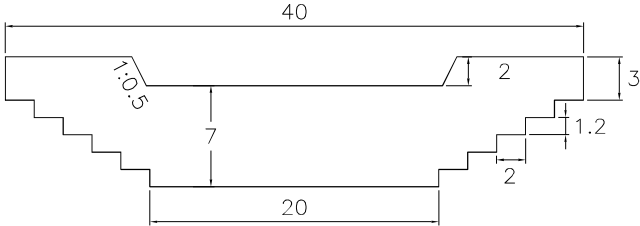

VOLUME: 997.50m<sup>3</sup>    QUANTITY: 1

SUB BASIN 45-1

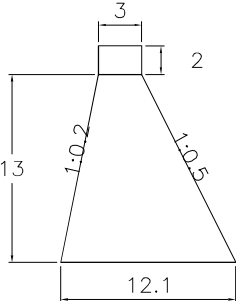
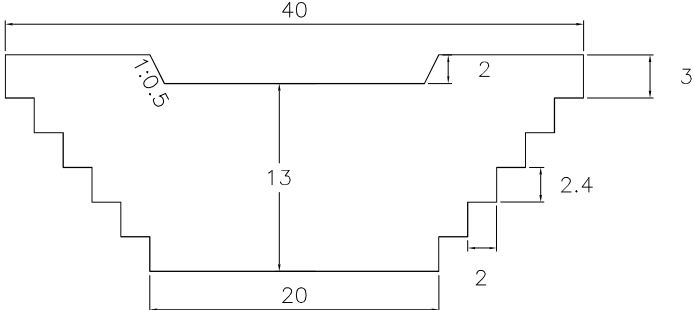

VOLUME: 2,944.50m<sup>3</sup>    QUANTITY: 1

## CHECK DAM

SCALE 1:500

# CAMANA - MAJES RIVER

SUB BASIN 66-1

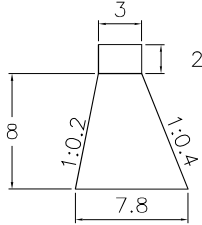
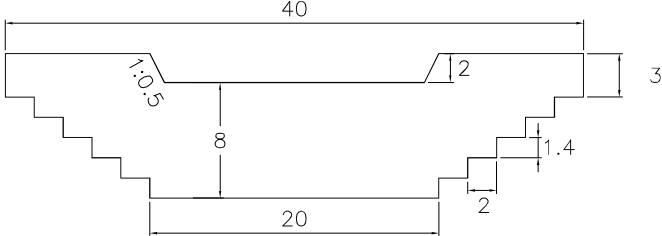

VOLUME: 1296.00m<sup>3</sup>    QUANTITY: 1

SUB BASIN 67-1

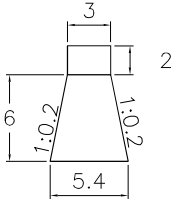
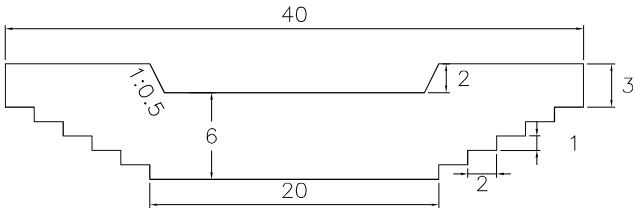

VOLUME: 756.00m<sup>3</sup>    QUANTITY: 1

SUB BASIN 109-1

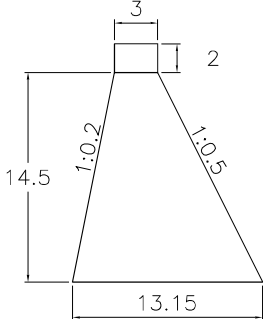
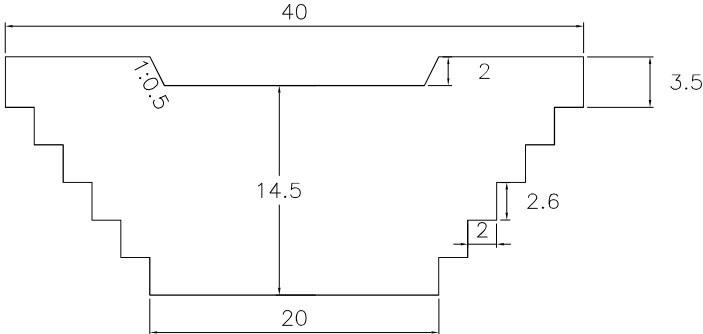

VOLUME: 3,512.70m<sup>3</sup>    QUANTITY: 3

**CHECK DAM**

SCALE 1:500

# CAMANA - MAJES RIVER

SUB BASIN 111-1

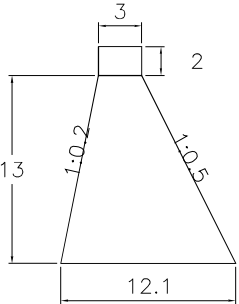
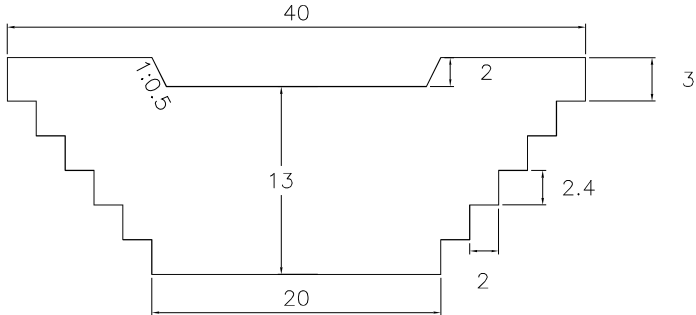

VOLUME: 2,944.50m<sup>3</sup>    QUANTITY: 1

SUB BASIN 114-1

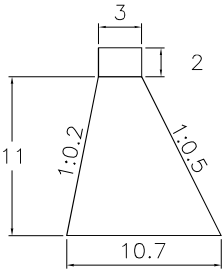
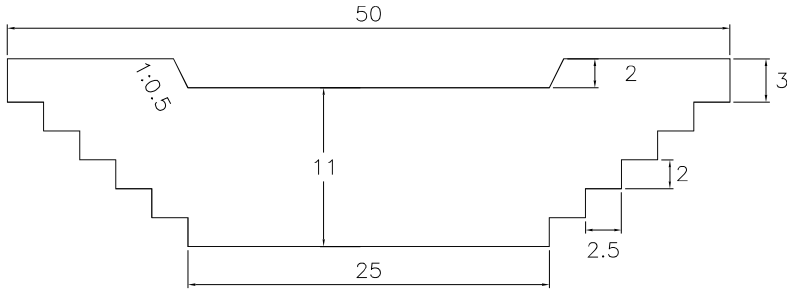

VOLUME: 2,825.63m<sup>3</sup>    QUANTITY: 1

SUB BASIN 115-1

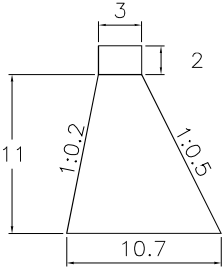
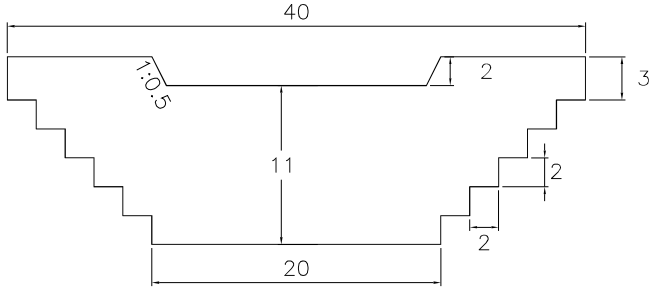

VOLUME: 2,260.50m<sup>3</sup>    QUANTITY: 1

**CHECK DAM**

SCALE 1:500



# CAMANA - MAJES RIVER

SUB BASIN 120-1

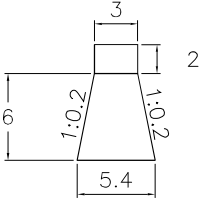
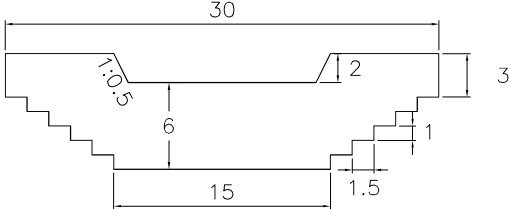

VOLUME: 567.00m<sup>3</sup>    QUANTITY: 1

SUB BASIN 121-1

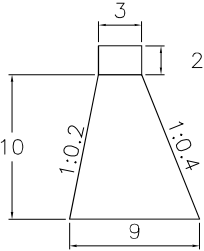
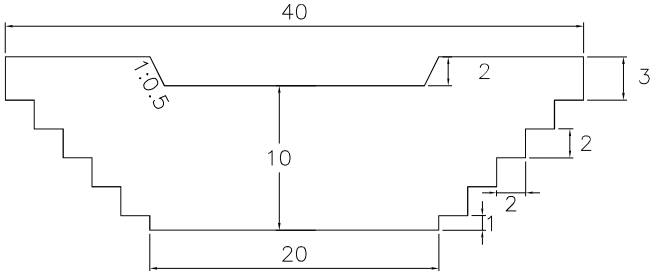

VOLUME: 1,800.00m<sup>3</sup>    QUANTITY: 1

SUB BASIN 122-1

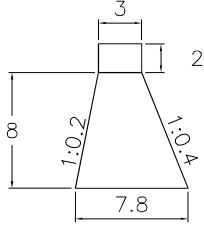
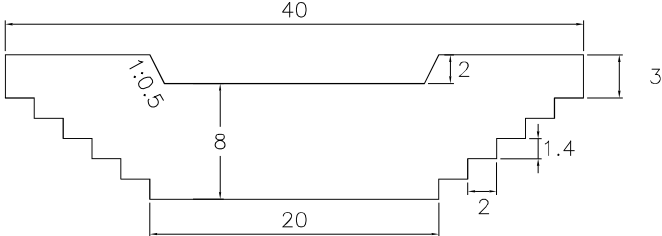

VOLUME: 1296.00m<sup>3</sup>    QUANTITY: 1

## CHECK DAM

SCALE 1:500

# CAMANA - MAJES RIVER

SUB BASIN 124-1

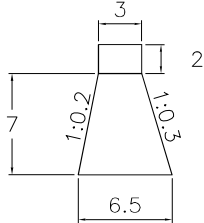
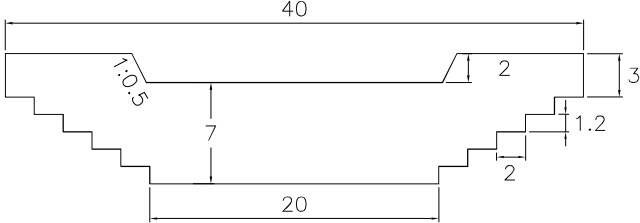

VOLUME: 997.50m<sup>3</sup>    QUANTITY: 1

**CHECK DAM**

SCALE 1:500

