

**CRITERIA FOR AIR VALVE AND WASHOUT BRANCH PIPE**

MAIN PIPE	BRANCH PIPE
Ø 400	Ø 75
Ø 500	Ø 100

- NOTE**
1. THE THICKNESS OF THE BURIED LAYER SPECIFIED IN THE DRAWING IS FOR NORMAL SOIL TYPES. HOWEVER IF THE STRUCTURE IS FOUND ON VERY HARD OR SOFT SOILS.
  2. THE VALVE BOXES FOR AIR VALVE CHAMBER SHOULD BE AT THE SAME LEVEL AS THE ROAD TOP LEVEL.
  3. THE VALVE BOXES FOR WASHOUT MAY BE ON THE BANK OF THE ROAD.
  4. ALL DIMENSIONS ARE IN mm.

<b>PROJECT</b> THE PREPARATORY SURVEY ON THE PROJECT ON ADDITIONAL NEW WATER TREATMENT PLANTS FOR KAMPONG CHAM AND BATTAMBANG WATERWORKS カンボジア地方上水道拡張整備計画準備調査	<b>DESCRIPTION</b> Valve Chamber for Kampong Cham Conveyance Pipe	<b>APPROVE BY</b>	<b>DATE</b>	<b>DRAWING No</b> K-R3
		<b>PREPARED BY</b>	<b>DATE</b>	<b>SCALE</b>

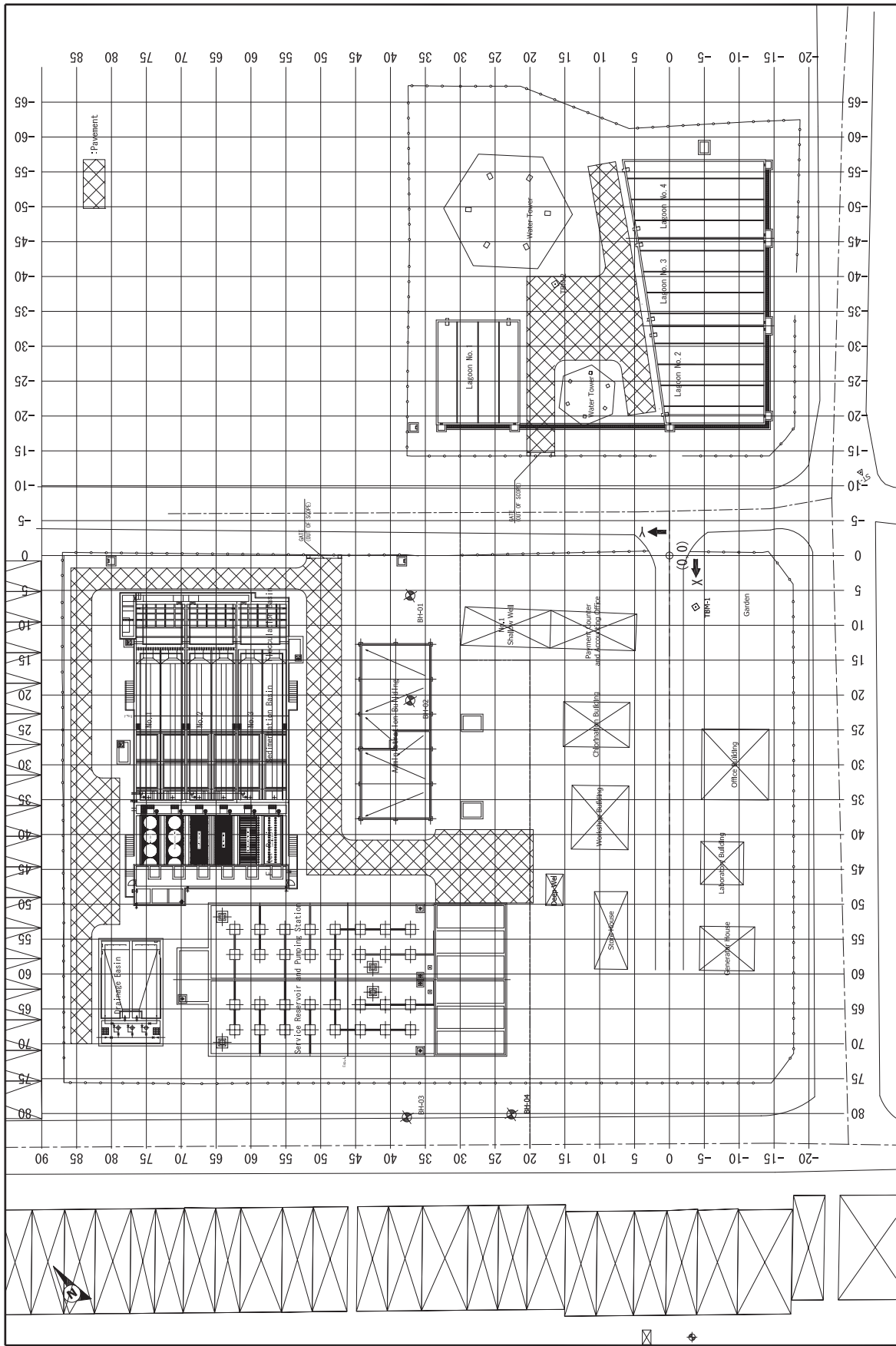

PROJECT	DESCRIPTION		DRAWING No. K-T1
	General Layout Plan of Kampong Cham WTP コンポーンチャム浄水施設全体平面図		
THE PREPARATORY SURVEY ON THE PROJECT ON ADDITIONAL NEW WATER TREATMENT PLANTS FOR KAMPONG CHAM AND BATTAMBANG WATERWORKS カンポーンチャム地方上水道拡張整備計画準備調査		APPROVE BY	DATE
		PREPARED BY	DATE
		NIHON SUDO CONSULTANTS CO., LTD. WATER AND SEWER BUREAU, CITY OF KITAKYUSHU CITI ENGINEERING INTERNATIONAL CO., LTD.	
		SCALE 1:500	

# FLOW DIAGRAM OF KAMPONG CHAM WATER TREATMENT PLANT

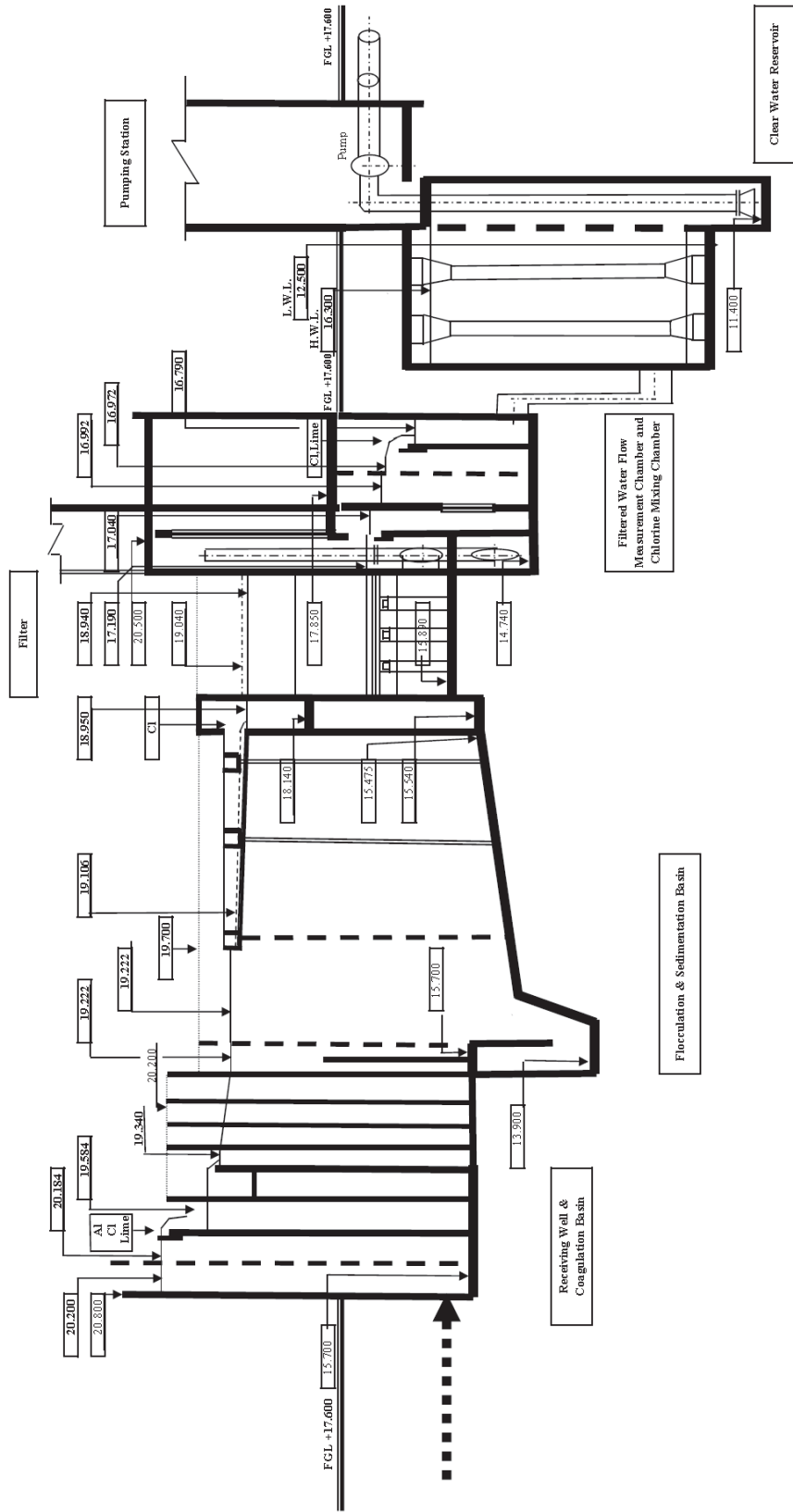

PROJECT	THE PREPARATORY SURVEY ON THE PROJECT ON ADDITIONAL NEW WATER TREATMENT PLANTS FOR KAMPONG CHAM AND BATTAMBANG WATERWORKS カンボジア 国地方上水道拡張整備計画準備調査		DESCRIPTION	Water Level Profile of Kampong Cham WTP コンボーンチャム浄水場水位高低図
	APPROVE BY	DATE	APPROVE BY	DATE
			PREPARED BY	SCALE
			NIHON SUDO CONSULTANTS CO., LTD. WATER AND SEWER BUREAU, CITY OF MIYAKYUSHU CHI ENGINEERING INTERNATIONAL CO., LTD.	
			DRAWING No.	K-T2

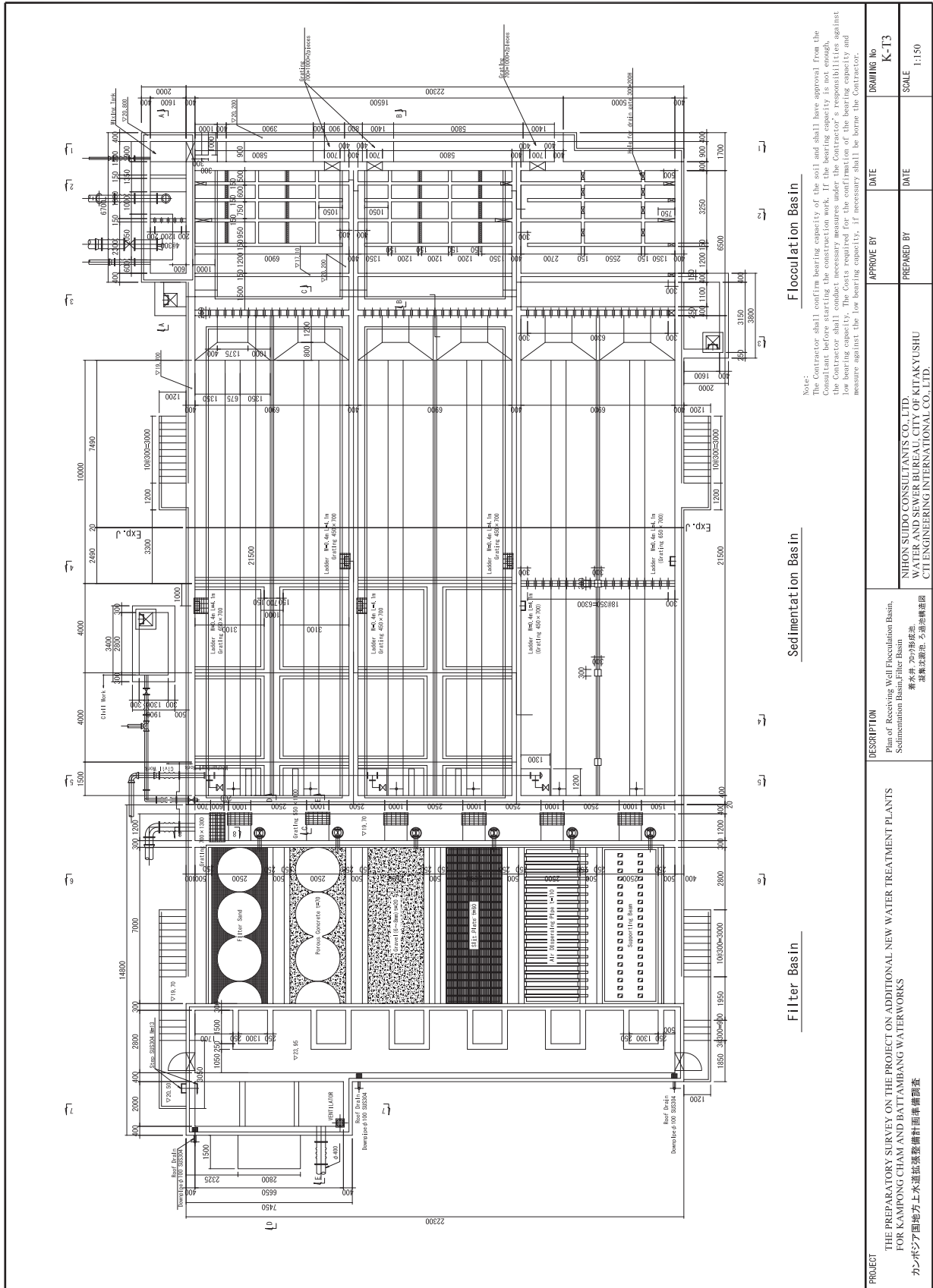

PROJECT	THE PREPARATORY SURVEY ON THE PROJECT ON ADDITIONAL NEW WATER TREATMENT PLANTS FOR KAMPONG CHAM AND BATTAMBANG WATERWORKS カンボジア国地方上水道拡張整備計画準備調査	
	DESCRIPTION Plan of Receiving Well Flocculation Basin, Sedimentation Basin, Filter Basin 受水井・20分形沈殿池、 凝集沈殿池、ろ過池構造図	
APPROVE BY	DATE	DRAWING No
PREPARED BY	DATE	SCALE
NIHON SUDO CONSULTANTS CO., LTD. WATER AND SEWER BUREAU, CITY OF KITAKYUSHU 環水部建設部、北九州市水道局		K-173
		1:150

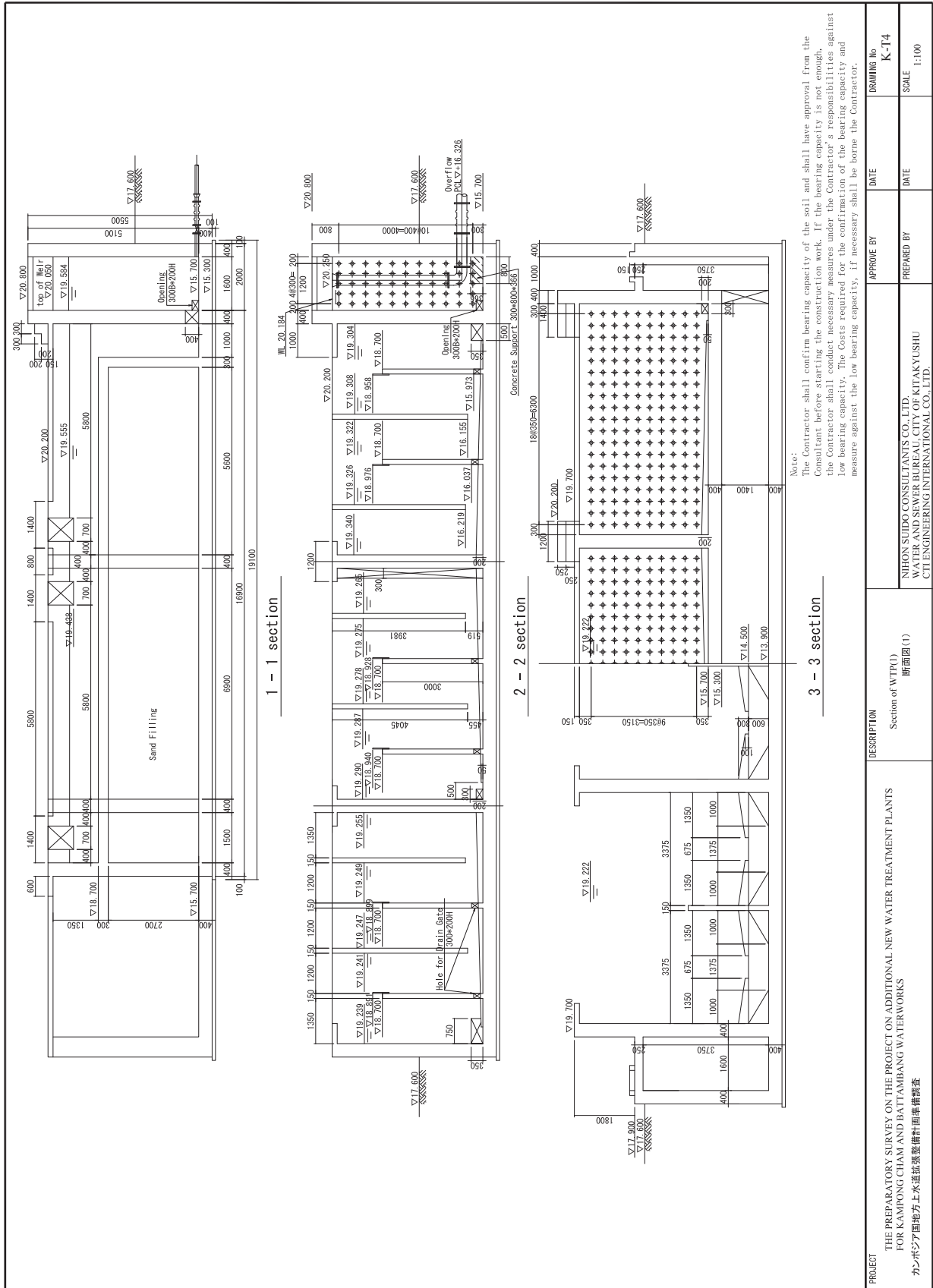

PROJECT	DESCRIPTION	Section of WTP(1) 断面図(1)	APPROVE BY	DATE	DRAWING No
			PREPARED BY	DATE	SCALE
THE PREPARATORY SURVEY ON THE PROJECT ON ADDITIONAL NEW WATER TREATMENT PLANTS FOR KAMPONG CHAM AND BATTAMBANG WATERWORKS カンボジア国地方上水道拡張整備計画調査			NIHON SUDO CONSULTANTS CO., LTD. WATER AND SEWER BUREAU, CITY OF KITAKYUSHU CIT ENGINEERING INTERNATIONAL CO., LTD.		
			K-14		
			1:100		

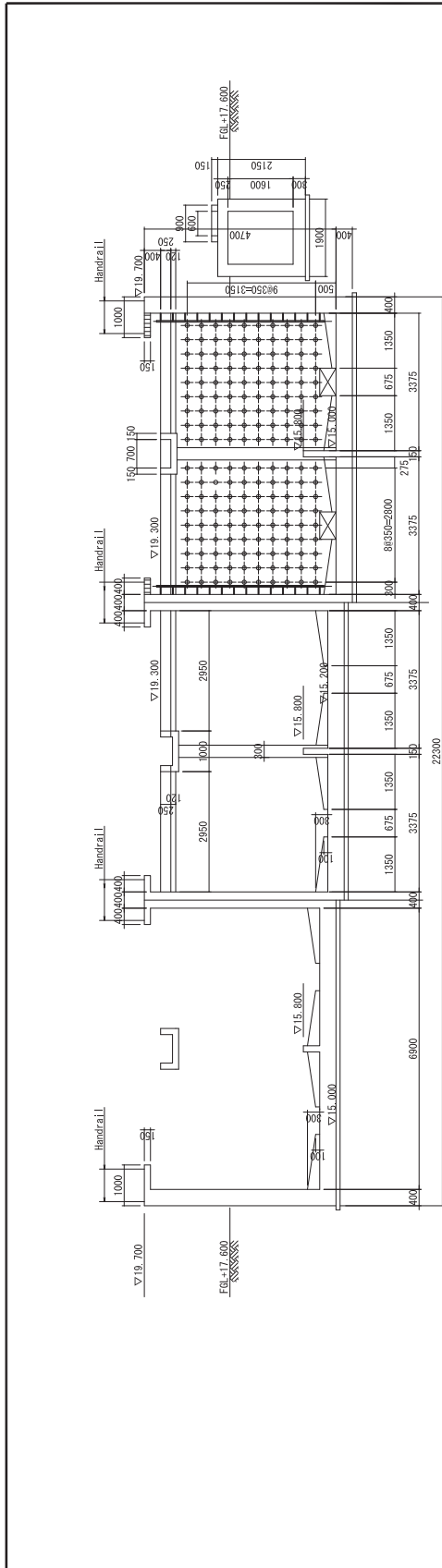

4 - 4 section

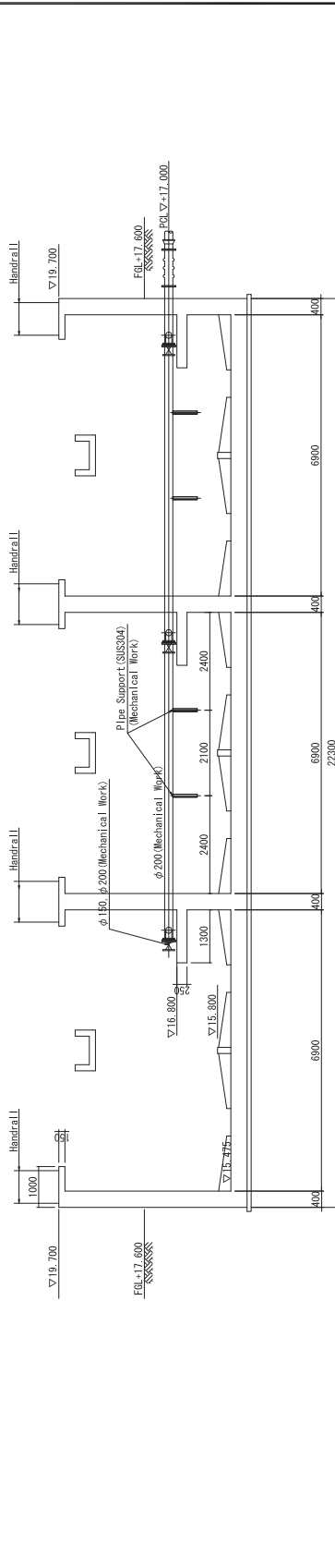

5 - 5 section

Note:  
 The Contractor shall confirm bearing capacity of the soil and shall have approval from the Consultant before starting the construction work. If the bearing capacity is insufficient, the Contractor shall instruct necessary measures under the Contract responsibilities against low bearing capacity. The Costs required for the confirmation of the bearing capacity and measure against the low bearing capacity, if necessary shall be borne the Contractor.

PROJECT THE PREPARATORY SURVEY ON THE PROJECT ON ADDITIONAL NEW WATER TREATMENT PLANTS FOR KAMPONG CHAM AND HATTAMBANG WATERWORKS カンボジア国地方上水道拡張整備計画調査	DESCRIPTION Section of WTP(2) 断面図(2)	APPROVE BY	DATE
		PREPARED BY	DATE
		DRAWING No	K-15
		SCALE	1:100

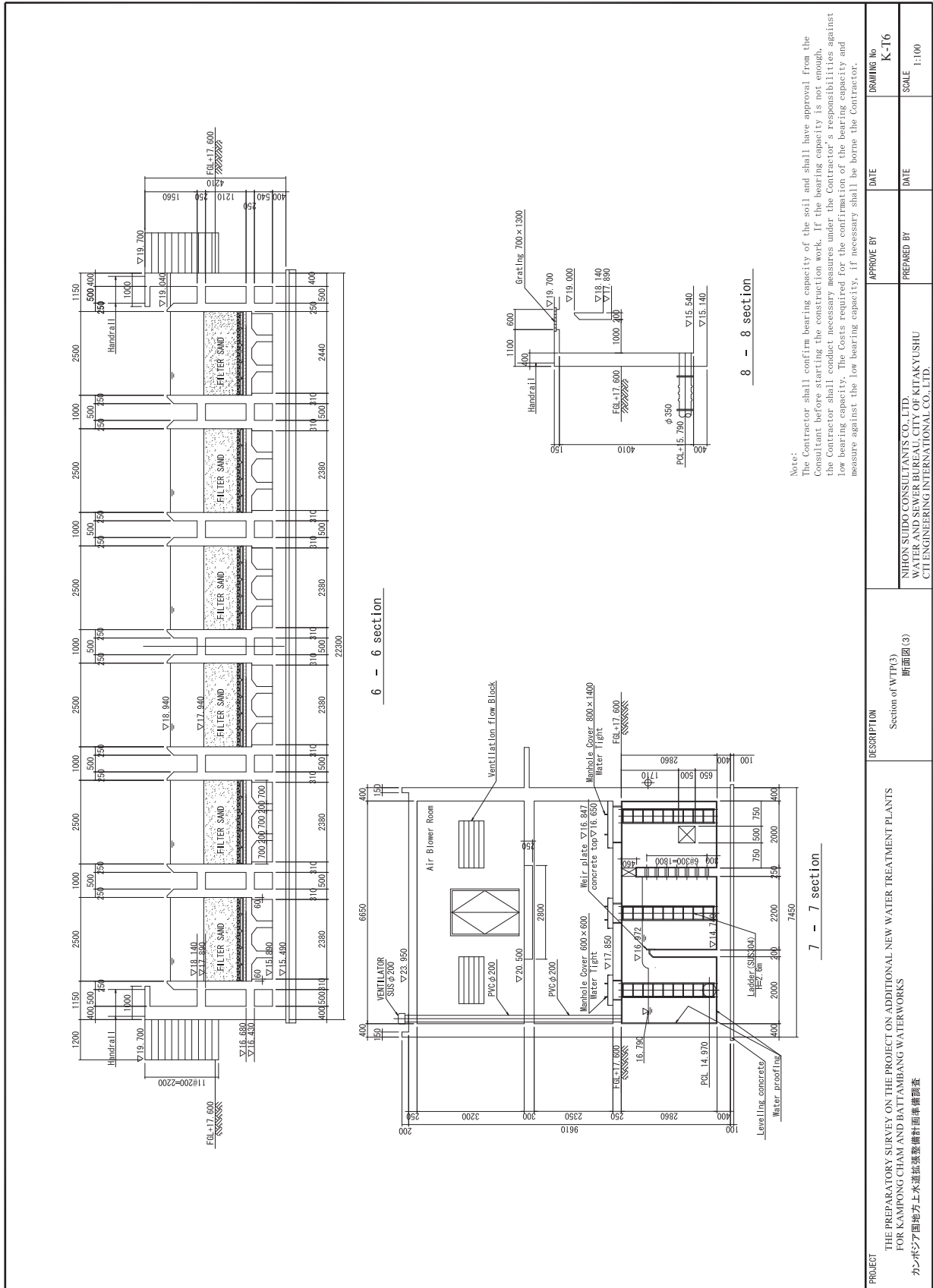

Note:  
 The Contractor shall confirm bearing capacity of the soil and shall have approval from the Consultant before starting the construction work. If the bearing capacity is not enough, the Contractor shall take necessary measures under the Contractor's responsibility against low bearing capacity. The Costs required for the confirmation of the bearing capacity and measure against the low bearing capacity, if necessary shall be borne the Contractor.

PROJECT THE PREPARATORY SURVEY ON THE PROJECT ON ADDITIONAL NEW WATER TREATMENT PLANTS FOR KAMPONG CHAM AND BATTAMBANG WATERWORKS カンボジア国地方上水道拡張整備計画準備調査	DESCRIPTION Section of WTP(3) 断面図(3)	APPROVE BY	DATE
		PREPARED BY	DATE
		DRAWING No	K-16
		SCALE	1:100

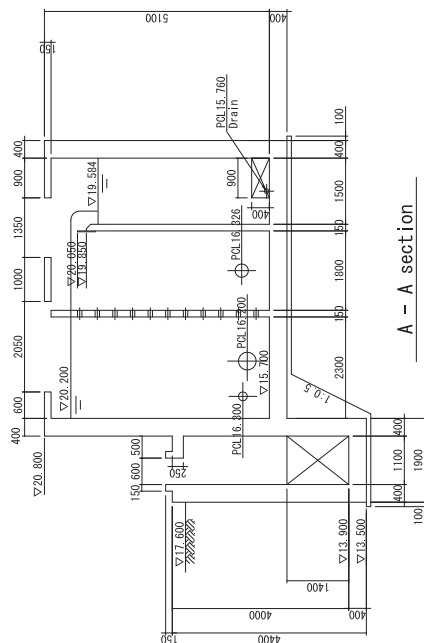

A - A section

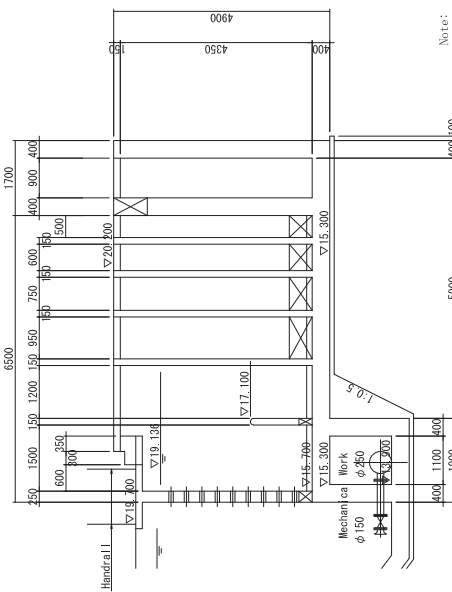

B - B section

Note:  
The Contractor shall confirm bearing capacity of the soil and shall have approval from the Consultant before starting the construction work. If the bearing capacity is insufficient, the Contractor shall rectify it at his own cost. The Contractor shall be responsible against the bearing capacity. The Costs required for the confirmation of the bearing capacity and measure against the low bearing capacity, if necessary shall be borne the Contractor.

PROJECT THE PREPARATORY SURVEY ON THE PROJECT ON ADDITIONAL NEW WATER TREATMENT PLANTS FOR KAMPONG CHAM AND HATTAMBANG WATERWORKS カンボジア国地方上水道拡張整備計画準備調査	DESCRIPTION Section of WTP(4) 断面図(4)	APPROVE BY	DATE	DRAWING No
		PREPARED BY	DATE	SCALE
		NIHON SUDO CONSULTANTS CO., LTD. WATER AND SEWER BUREAU, CITY OF KITAKYUSHU CIT ENGINEERING INTERNATIONAL CO., LTD.		K-17 1:100



Service Reservoir and Pumping Station  
Structure (1/9)  
Scale=1/200

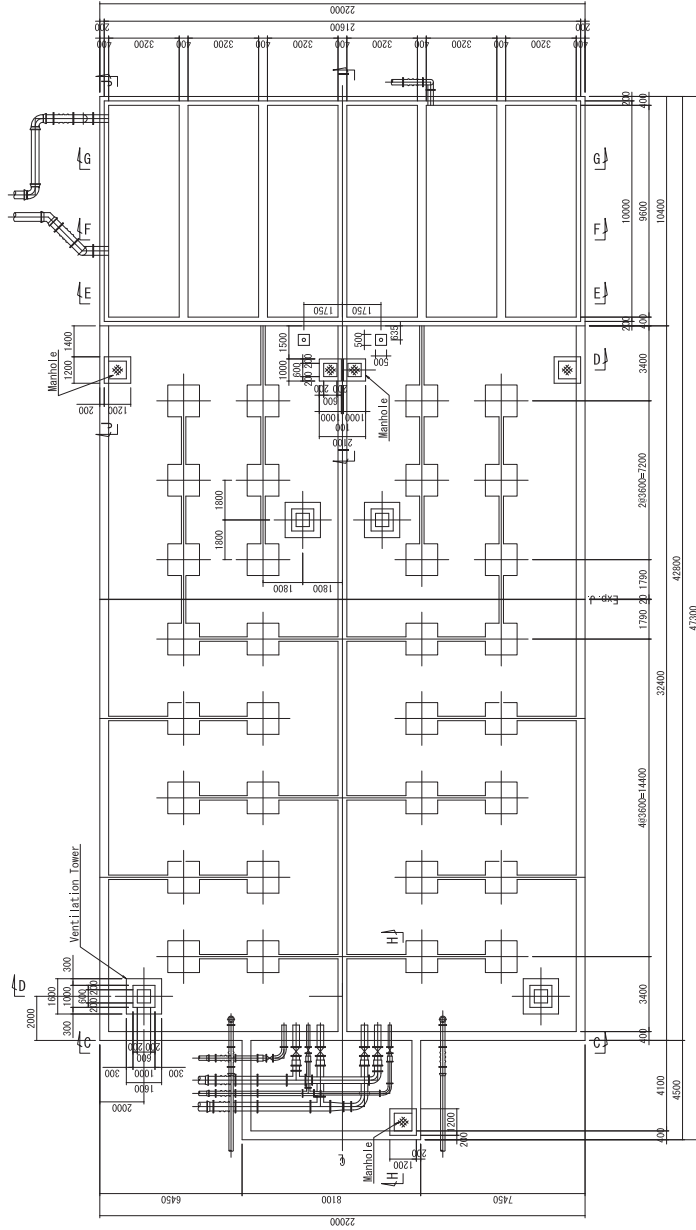

PLAN

Note:  
The Contractor shall confirm bearing capacity of the soil and shall have approval from the Consultant before starting the construction work. If the bearing capacity is insufficient, the Contractor shall be responsible for the necessary measures under the Contractor's responsibility against low bearing capacity. The Costs required for the confirmation of the bearing capacity and measure against the low bearing capacity, if necessary shall be borne the Contractor.

PROJECT	THE PREPARATORY SURVEY ON THE PROJECT ON ADDITIONAL NEW WATER TREATMENT PLANTS FOR KAMPONG CHAM AND HATTAMBANG WATERWORKS カンボジア国地方上水道拡張整備計画準備調査	DESCRIPTION	Service Reservoir and Pumping Station Structure (1) コンボーンチャン配水池構造図(1)	APPROVE BY	DATE	DRAWING No	K-TS
				PREPARED BY	DATE	SCALE	1:200

Service Reservoir and Pumping Station  
Structure (8/9)  
Scale=1/100

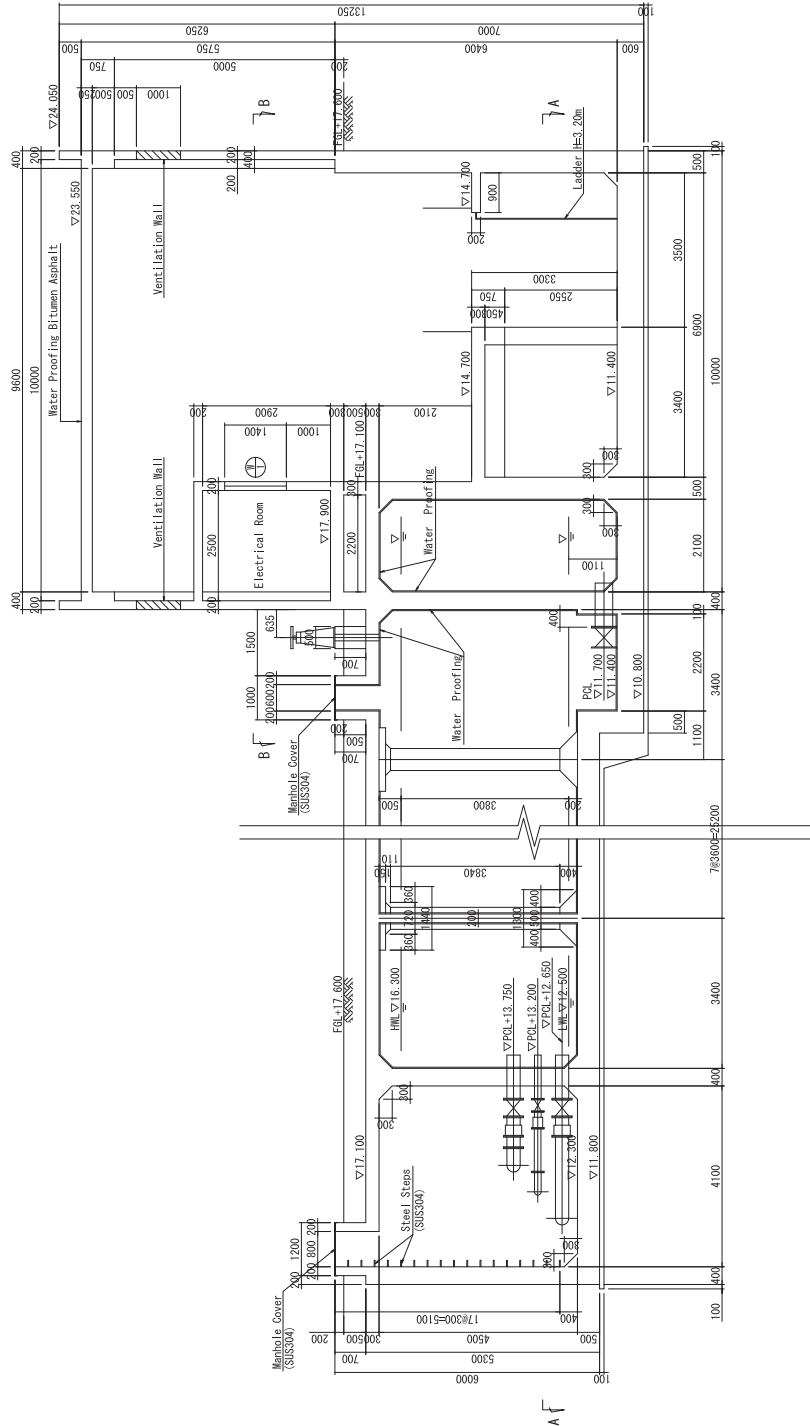

H - H section

I - I section

Note:  
The Contractor shall confirm bearing capacity of the soil and shall have approval from the Consultant before starting the construction work. If the bearing capacity is not enough, the Contractor shall conduct necessary measures under the Contractor's responsibilities against low bearing capacity. The Costs required for the confirmation of the bearing capacity and measure against the low bearing capacity, if necessary shall be borne the Contractor.

PROJECT	DESCRIPTION	APPROVE BY	DRAWING No
THE PREPARATORY SURVEY ON THE PROJECT ON ADDITIONAL NEW WATER TREATMENT PLANTS FOR KAMPONG CHAM AND HATTAMBANG WATERWORKS カンボジア国地方上水道拡張整備計画準備調査	Service Reservoir and Pumping Station Structure (2) コンボチャンダム配水池構造図(2)	PREPARED BY	K-T9
		DATE	SCALE 1:100