

S-5 Kuka Tumticha

Basic Information

Level	Urban/Rural	Remarks
Secondary	Rural	

Primary Enrolment in the Catchment Area (2011/12)

No. of Feeder Primary Schools	G6	G7	G8
5	712	764	843

Project Plan

Purpose	To improve access to secondary education in rural area					
Grade Level	Projected Enrl (2014/15)	Facility to be Constructed				
		CRs	Library	Labs	Tech Drawing	Toilet bldgs
G9-10	935	12	1 Small	3	-	4

Undertakings by the Ethiopian Side

Access Road	Felling	Connecting Electricity	Connecting Water	Drinking Fountain	Gate	Fence	Guard Room
Required (when necessary)	Required	50m	250m	Required (1Place)	Required (1Place)	400m	Required (1 Room)
Others	-						

Photography



Access road to the construction site



Construction site



Adjacent primary school to the construction site



Buildings of Chichu secondary school in woreda capital

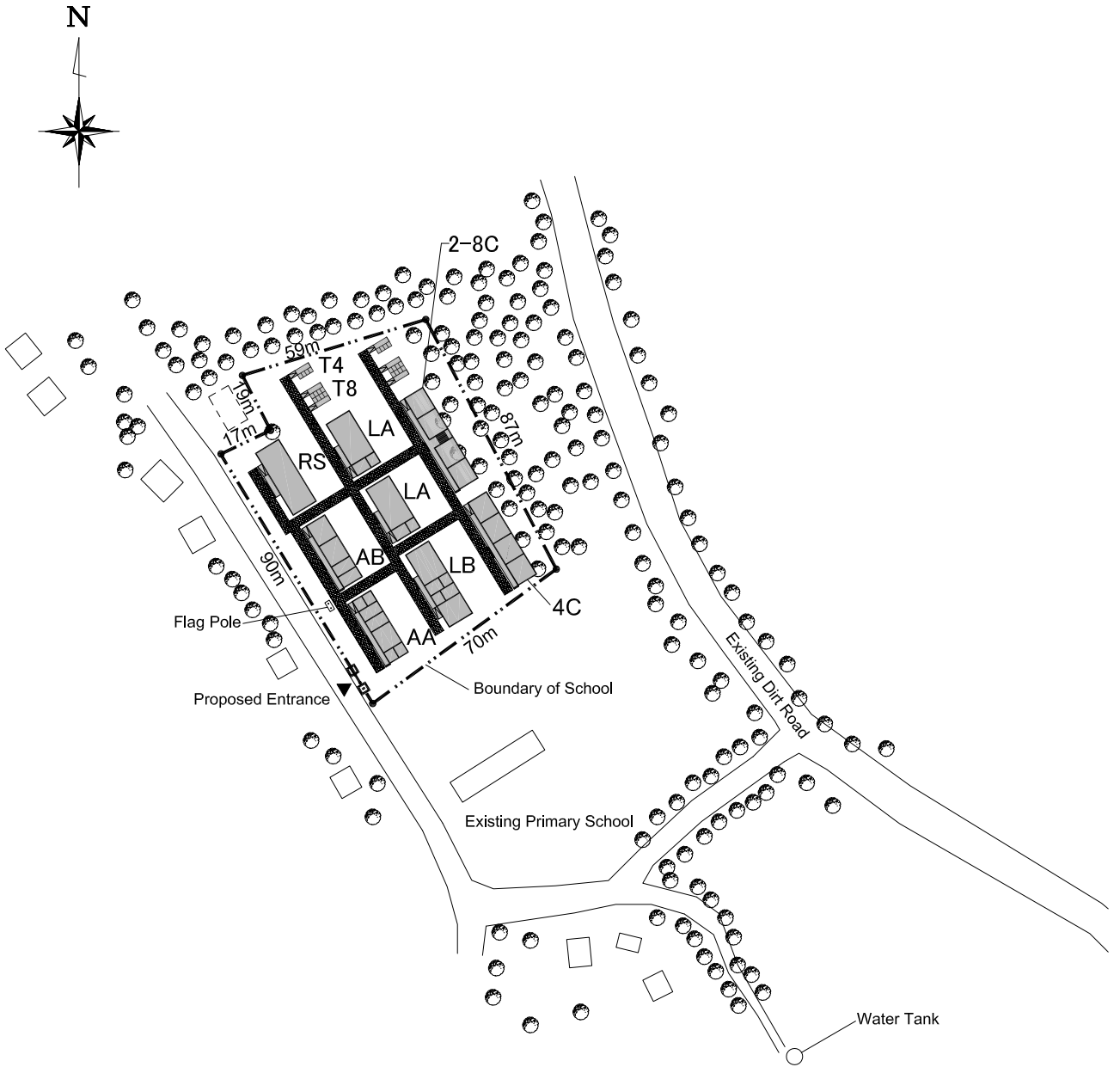

LEGEND

- 4C : Classroom Block (4 classrooms)
- 2-8C : 2-story ClassroomBlock (8 classrooms)
- RL : Library Block A
- RS : Library Block B
- LA : Laboratory Block A
- LB : Laboratory Block B
- LT : Laboratory Block C
- AA : Administration Block A
- AB : Administration Block B
- T8 : Latrine Block (8 booths)
- T4 : Latrine Block (4 booths)

Proposed Site Plan

Scale 1:2000



S-6 Camp Sefer

Basic Information

Level	Urban/Rural	No. of Feeder Secondary Schools in the Catchment	Name of Feeder School
Secondary	Urban	1	Goro Secondary and Preparatory School

Feeder School Information (2011/12)

	G9	G10	G11	G12	G9-12 Total	G9-12 PSR	Existing Facility				
							No. of CRs	Library	Lab	ICT	Toilet pits
Enrolment	1,455	879	836	728	3,898	79.6					
Section	17	13	10	9	49		27	4	2	2	20

Project Plan

Purpose	To reduce classroom congestion of the existing feeder secondary school in the Town.					
Grade Level	Projected Enrl (2014/15)	Facility to be Constructed				
		CRs	Library	Labs	Tech Drawing	Toilet bldgs
G9-12	2,462	32	1 Large	3	1	4

Undertakings by the Ethiopian Side

Access Road	Felling	Connecting Electricity	Connecting Water	Drinking Fountain	Gate	Fence	Guard Room
Required (when necessary)	Required	50m	Already exists	Required (1Place)	Required (1Place)	1,100m	Required (1 Room)
Others	-						

Photography



Construction site



Soil of the construction site



Buildings of Goro secondary & preparatory school



Inside of a classroom Goro secondary & preparatory school

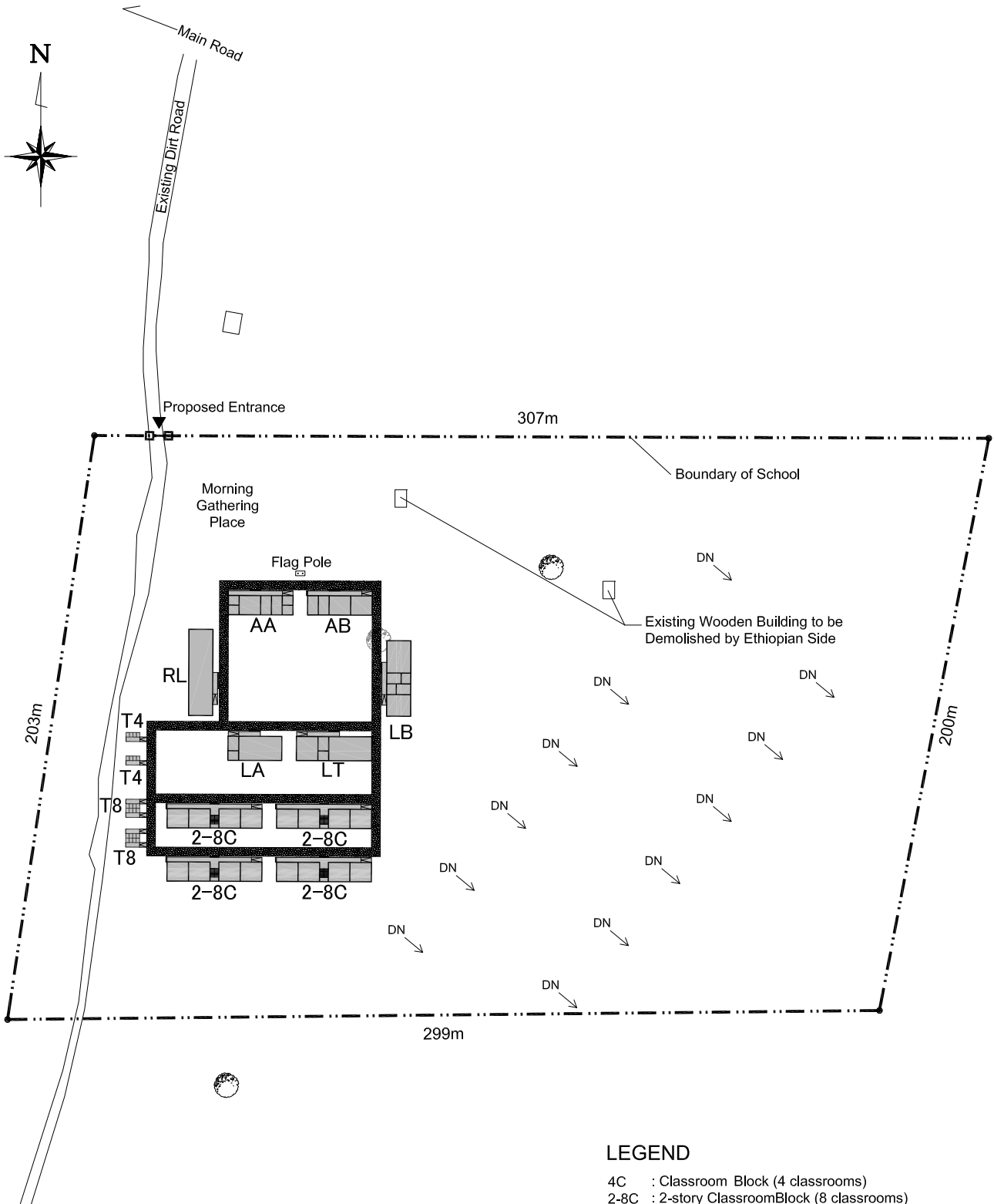

Proposed Site Plan

Scale 1:2000



LEGEND

- 4C : Classroom Block (4 classrooms)
- 2-8C : 2-story ClassroomBlock (8 classrooms)
- RL : Library Block A
- RS : Library Block B
- LA : Laboratory Block A
- LB : Laboratory Block B
- LT : Laboratory Block C
- AA : Administration Block A
- AB : Administration Block B
- T8 : Latrine Block (8 booths)
- T4 : Latrine Block (4 booths)

S-7 Tiya

Basic Information

Level	Urban/Rural	Remarks
Secondary	Rural	

Primary Enrolment in the Catchment Area (2011/12)

No. of Feeder Primary Schools	G6	G7	G8
6	514	426	427

Project Plan

Purpose	To improve access to secondary education in rural area					
Grade Level	Projected Enrl (2014/15)	Facility to be Constructed				
		CRs	Library	Labs	Tech Drawing	Toilet bldgs
G9-10	610	8	1 Small	3	-	2

Undertakings by the Ethiopian Side

Access Road	Felling	Connecting Electricity	Connecting Water	Drinking Fountain	Gate	Fence	Guard Room
-	-	200m	450m	Required (1Place)	Required (1Place)	1,200m	Required (1 Room)
Others	-						

Photography



Access road to the construction site



Construction site



An overview of Soddo Buee secondary and preparatory school in Woreda capital



Inside of the library of Soddo Buee secondary and preparatory school in Woreda capital

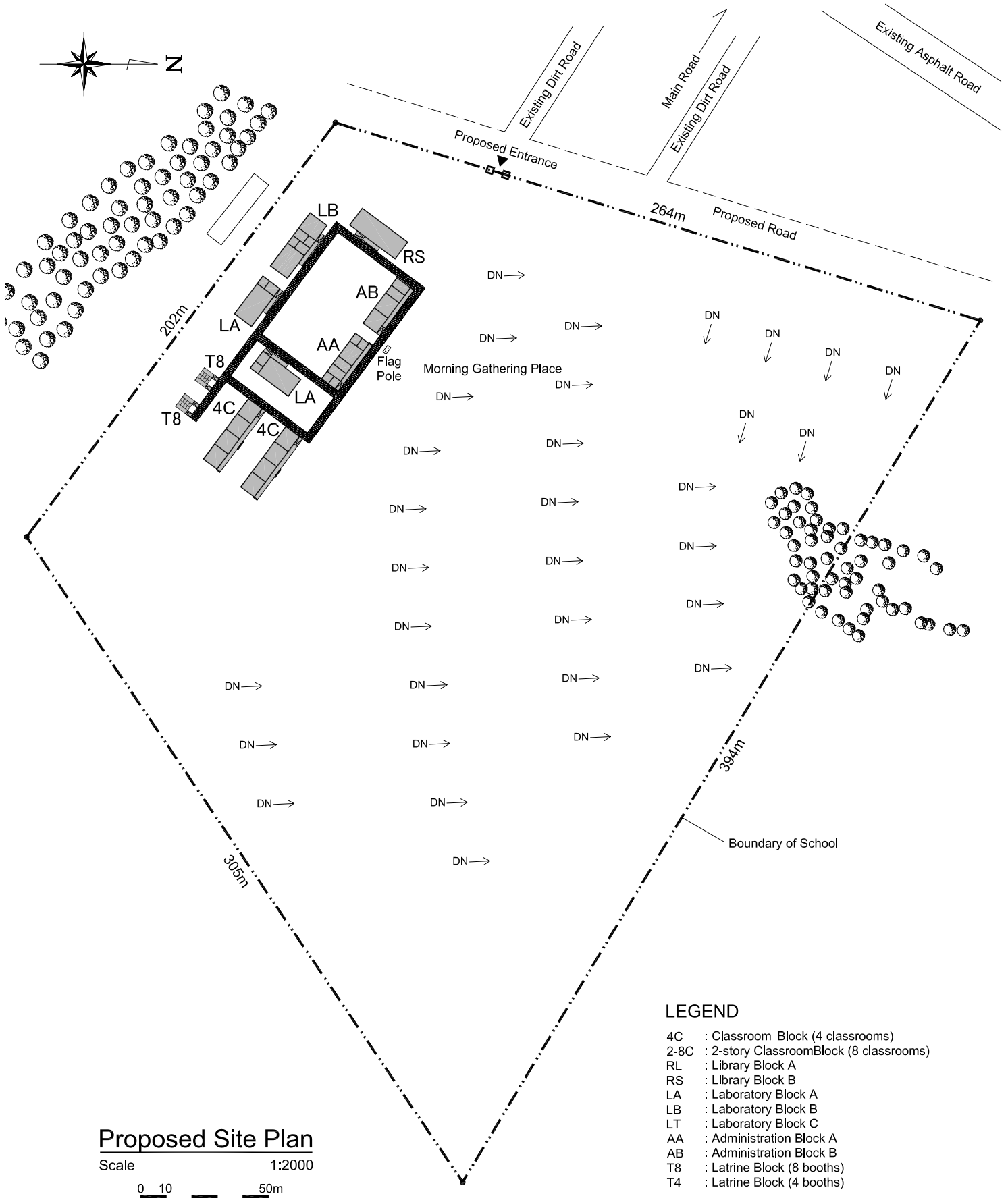

S-8 Gurumo Koyisha

Basic Information

Level	Urban/Rural	Remarks
Secondary	Rural	

Primary Enrolment in the Catchment Area (2011/12)

No. of Feeder Primary Schools	G6	G7	G8
13	936	1,006	857

Project Plan

Purpose	To improve access to secondary education in rural area.					
Grade Level	Projected Enrl (2014/15)	Facility to be Constructed				
		CRs	Library	Labs	Tech Drawing	Toilet bldgs
G9-10	1,231	16	1 Small	3	-	4

Undertakings by the Ethiopian Side

Access Road	Felling	Connecting Electricity	Connecting Water	Drinking Fountain	Gate	Fence	Guard Room
-	Required	Already exists	-	-	Required (1Place)	700m	Required (1 Room)
Others	-						

Photography



Frontal road of the construction site



Construction site



Back of the construction site



Adjacent lot to the construction site

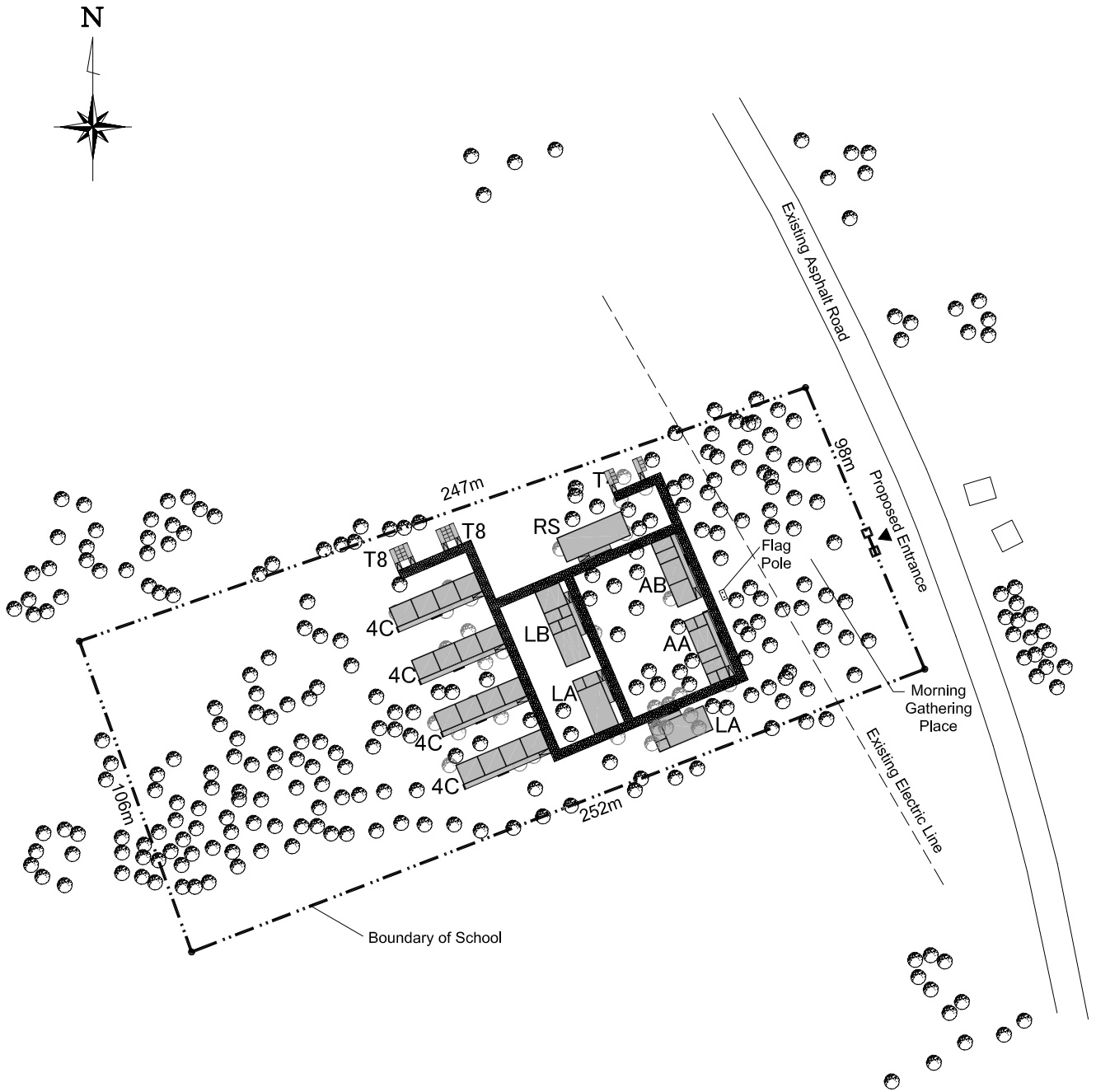

Proposed Site Plan

Scale 1:2000



LEGEND

- 4C : Classroom Block (4 classrooms)
- 2-8C : 2-story Classroom Block (8 classrooms)
- RL : Library Block A
- RS : Library Block B
- LA : Laboratory Block A
- LB : Laboratory Block B
- LT : Laboratory Block C
- AA : Administration Block A
- AB : Administration Block B
- T8 : Latrine Block (8 booths)
- T4 : Latrine Block (4 booths)

S-9 Jata

Basic Information

Level	Urban/Rural	Remarks
Secondary	Rural	

Primary Enrolment in the Catchment Area (2011/12)

No. of Feeder Primary Schools	G6	G7	G8
4	378	166	127

Project Plan

Purpose	To improve access to secondary education in rural area					
Grade Level	Projected Enrl (2014/15)	Facility to be Constructed				
		CRs	Library	Labs	Tech Drawing	Toilet bldgs
G9-10	372	8	1 Small	3	-	2

Undertakings by the Ethiopian Side

Access Road	Felling	Connecting Electricity	Connecting Water	Drinking Fountain	Gate	Fence	Guard Room
Required (when necessary)	Required	400m	-	-	Required (1Place)	1,200m	Required (1 Room)
Others				-			

Photography



Frontal road and adjacent lot to the construction site



Construction site



Buildings of Sankura secondary school in Woreda capital



Scene of a science workshop at Sankura secondary school in Woreda capital

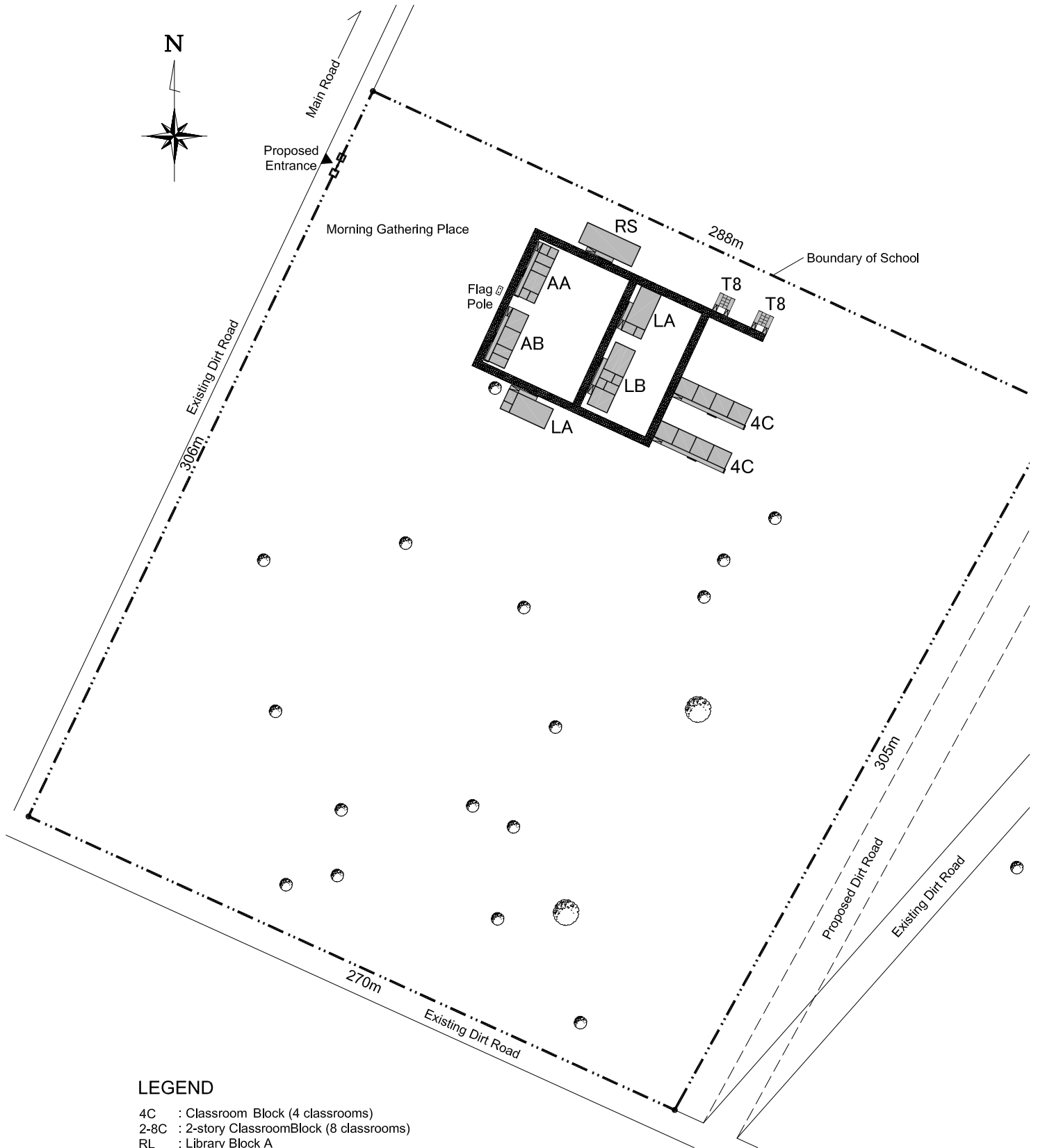

LEGEND

- 4C : Classroom Block (4 classrooms)
- 2-8C : 2-story ClassroomBlock (8 classrooms)
- RL : Library Block A
- RS : Library Block B
- LA : Laboratory Block A
- LB : Laboratory Block B
- LT : Laboratory Block C
- AA : Administration Block A
- AB : Administration Block B
- T8 : Latrine Block (8 booths)
- T4 : Latrine Block (4 booths)

Proposed Site Plan

Scale 1:2000



S-10 Chamo

Basic Information

Level	Urban/Rural	No. of Feeder Secondary Schools in the Catchment	Name of Feeder School
Secondary	Urban	1	Chamo Secondary and Preparatory School

Feeder School Information (2011/12)

	G9	G10	G11	G12	G9-12 Total	G9-12 PSR	Existing Facility				
							No. of CRs	Library	Lab	ICT	Toilet pits
Enrolment	832	758	321		1,911	76.4					
Section	10	10	5		25		0	0	0	0	0

Project Plan

Purpose	To reduce classroom congestion of the existing feeder secondary school in the Town. (A temporary secondary school has been already opened.)					
Grade Level	Projected Enrl (2014/15)	Facility to be Constructed				
		CRs	Library	Labs	Tech Drawing	Toilet bldgs
G9-12	2,414	32	1 Large	3	1	4

Undertakings by the Ethiopian Side

Access Road	Felling	Connecting Electricity	Connecting Water	Drinking Fountain	Gate	Fence	Guard Room
-	Required	50m	50m	Required (1Place)	Required (1Place)	350m	Required (1 Room)
Others	Demolishing the existing toilets						

Photography



Construction site



Back of the construction site



Inside of a classroom of the adjacent primary school (Currently, secondary students are using the room)



Inside of the library of the adjacent primary school (Currently, the library is used by secondary students)

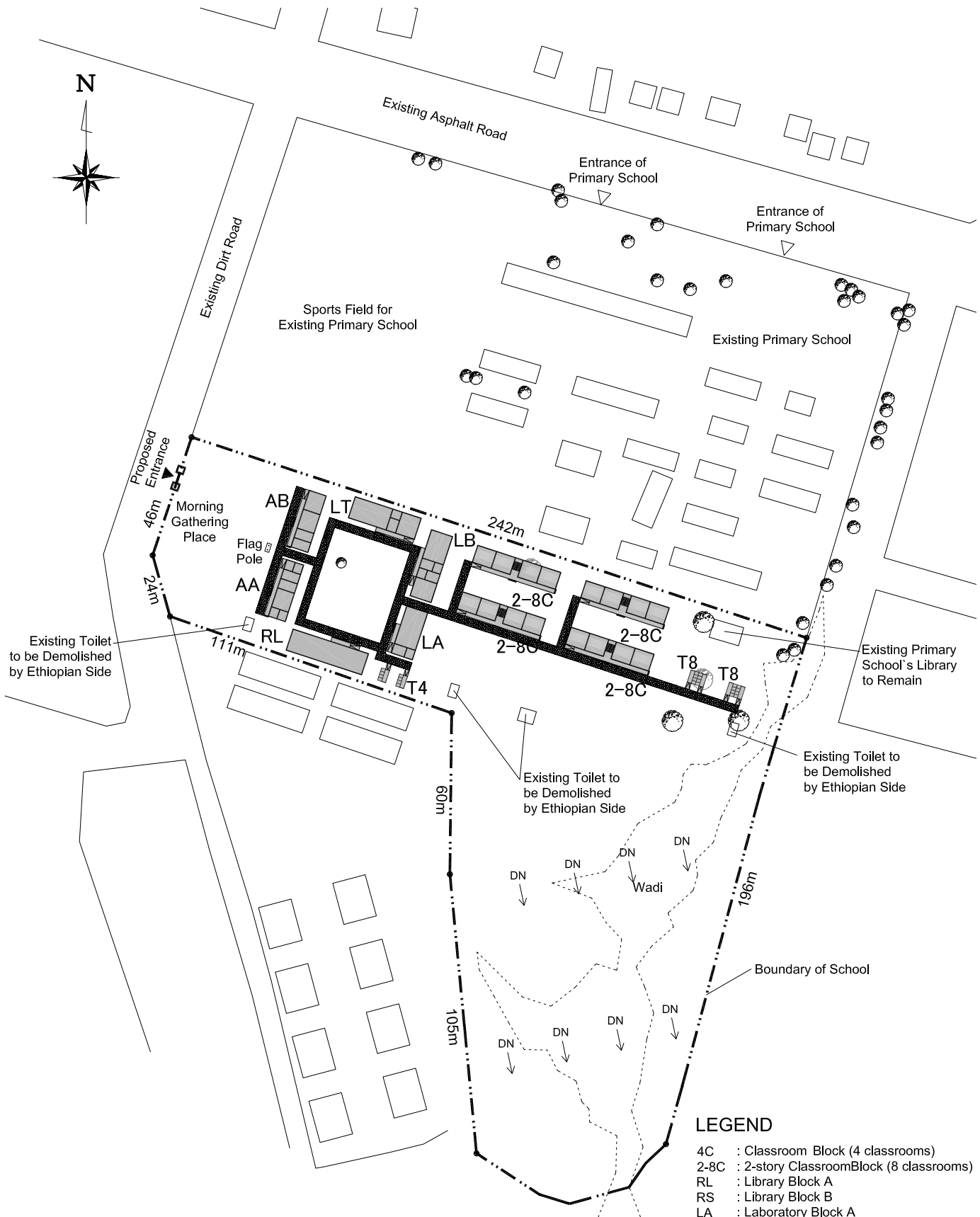

LEGEND

- 4C : Classroom Block (4 classrooms)
- 2-8C : 2-story ClassroomBlock (8 classrooms)
- RL : Library Block A
- RS : Library Block B
- LA : Laboratory Block A
- LB : Laboratory Block B
- LT : Laboratory Block C
- AA : Administration Block A
- AB : Administration Block B
- T8 : Latrine Block (8 booths)
- T4 : Latrine Block (4 booths)

Proposed Site Plan

Scale 1:2000
 0 10 50m

P-1 Tercha Primary School

Basic Information

Level	Grade Level	Shift	Year of Est.	Urban/Rural
Primary School	G1-5	Double	1978/9	Rural

Educational Statistics as of 2011/12

	G1	G2	G3	G4	G5	G6	G7	G8	G1-8 Total	G1-8 PSR	(KG)
Enrolment	48	46	39	38	96	-	-	-	267	44.5	80
Section	1	1	1	1	2	-	-	-	6		1

Existing Facility

No. of Available CRs	No. of Usable CRs	Library	Science Lab	Resource Ctr
6	0	1	0	1

Project Plan

Project Purpose	To extend the facility to upgrade the non-full cycle school to cover G1-8 and to reduce congestion in the existing full-cycle school in the town.		
Facility to be constructed	Expected Enrolment (2014/15)	Future Grade	Future Shift
4 CRs	315	G1-8	Double

Undertakings by the Ethiopian Side

Access Road	Required (when necessary)	Felling	Required
Others	-		

Photography



External view of an existing building



Construction site



Inside of a classroom



A dilapidated school building

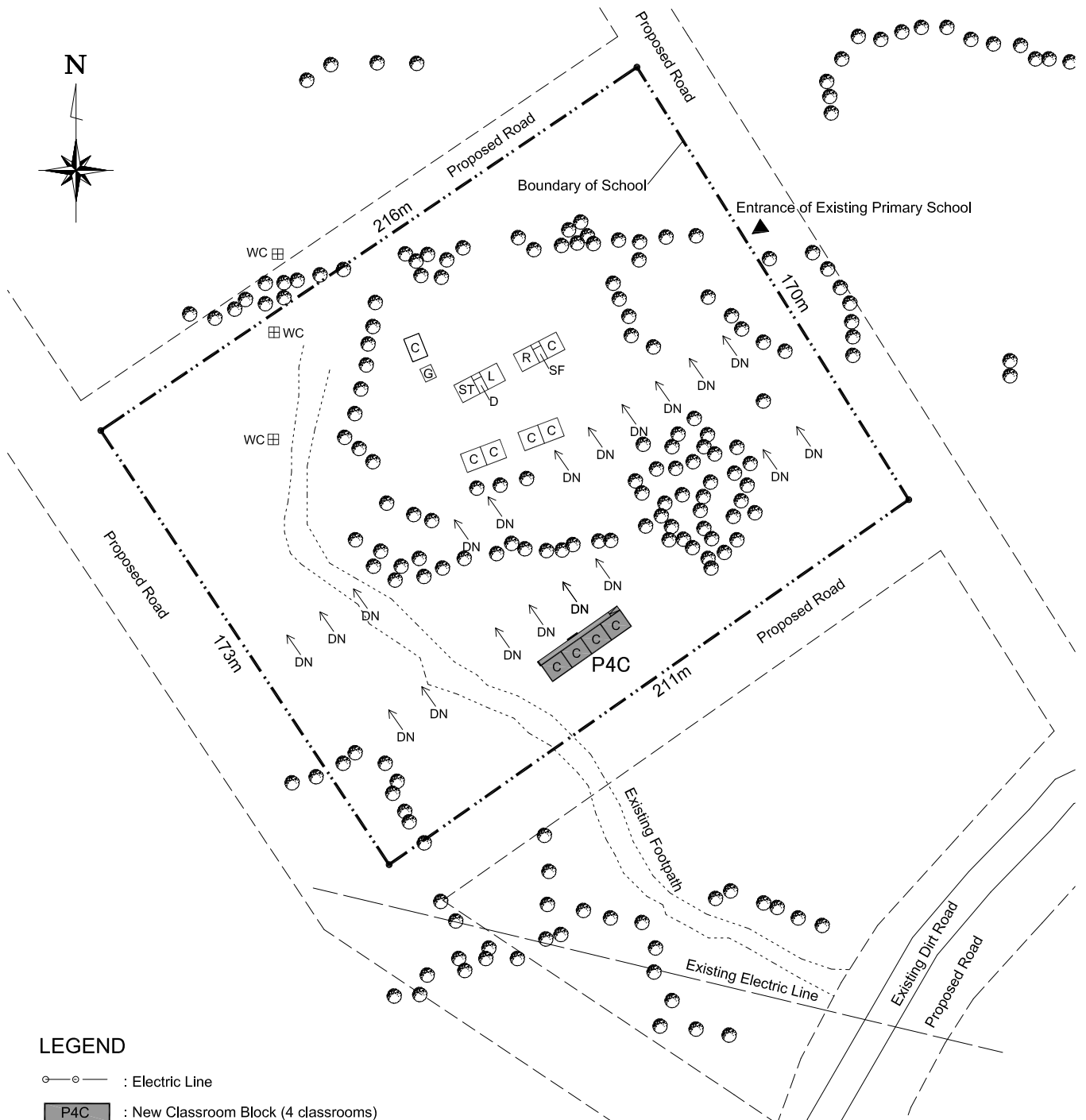

LEGEND

- : Electric Line
- P4C : New Classroom Block (4 classrooms)
- : Existing School Building (Concrete)
- : Existing School Building (Mud or Wooden)
- C : Class Room
- L : Library
- LB : Laboratory
- R : Resource Center
- D : Director Room
- VD : Vice Director Room
- S : Secretary Room
- AD : Administration Office
- SF : Staff Room
- ST : Store Room
- G : Guardian Room
- TE : Tea Room
- WC : Toilet(Teacher, Boy, and Girl)
- O : Others
- K : Kindergarten
- UN : Unused Room

Proposed Site Plan

Scale 1:2000



P-2 Duna Primary School

Basic Information

Level	Grade Level	Shift	Year of Est.	Urban/Rural
Primary School	G1-4	Single	2006/7	Urban

Educational Statistics as of 2011/12

	G1	G2	G3	G4	G5	G6	G7	G8	G1-8 Total	G1-8 PSR	(KG)
Enrolment	64	57	72	47	-	-	-	-	240	48.0	43
Section	1	1	2	1	-	-	-	-	5		1

Existing Facility

No. of Available CRs	No. of Usable CRs	Library	Science Lab	Resource Ctr
6	5	0	0	0

Project Plan

Project Purpose	To extend the facility to upgrade the non-full cycle school to cover G1-8 and to reduce congestion in the existing full-cycle school in the town.		
Facility to be constructed	Expected Enrolment (2014/15)	Future Grade	Future Shift
4 CRs	284	G1-8	Single

Undertakings by the Ethiopian Side

Access Road	Required (when necessary)	Felling	-
Others	-		

Photography



Construction site



External view of an existing building



Inside of a classroom



External view of an administration building

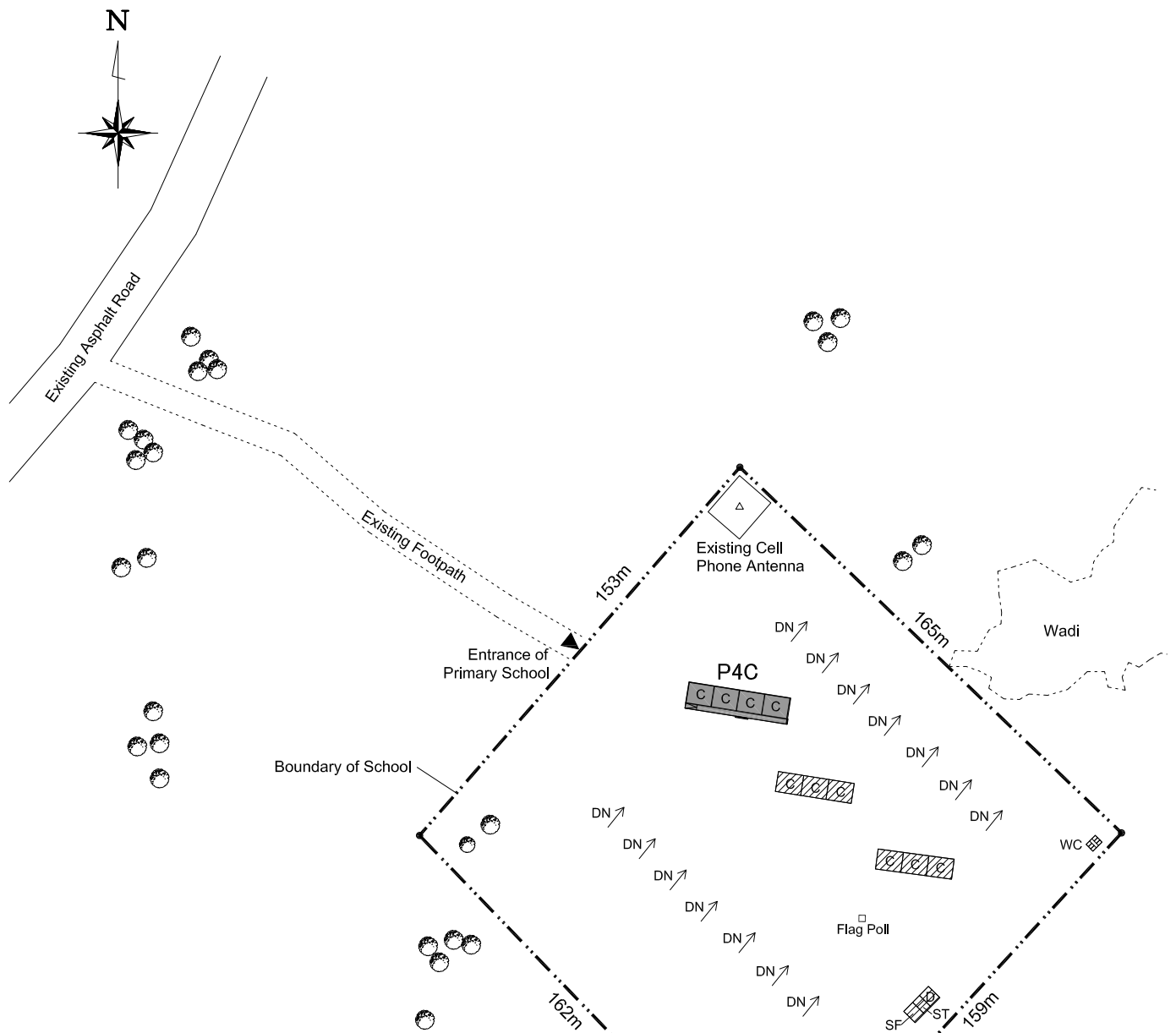

LEGEND

- : Electric Line
- P4C : New Classroom Block (4 classrooms)
- : Existing School Building (Concrete)
- : Existing School Building (Mud or Wooden)
- C : Class Room
- L : Library
- LB : Laboratory
- R : Resource Center
- D : Director Room
- VD : Vice Director Room
- S : Secretary Room
- AD : Administration Office
- SF : Staff Room
- ST : Store Room
- G : Guardian Room
- TE : Tea Room
- WC : Toilet (Teacher, Boy, and Girl)
- O : Others
- K : Kindergarten
- UN : Unused Room

Proposed Site Plan

Scale 1:2000

