

DEPARTMENT OF ROADS
 Ministry of Physical Planning and Works, FDR/ Nepal
 THE PROJECT FOR CONSTRUCTION OF SINDHULI ROAD
 (Section III)

PLAN AND PROFILE
 STA. 9+240 - STA. 9+900

Drawing No. B-25

Date: July, 2009 Scale: 1:2000
 Designed by: *S. Salgotra* Approved by:
 NIPPON KOEI CO., LTD, Consulting Engineers, Japan

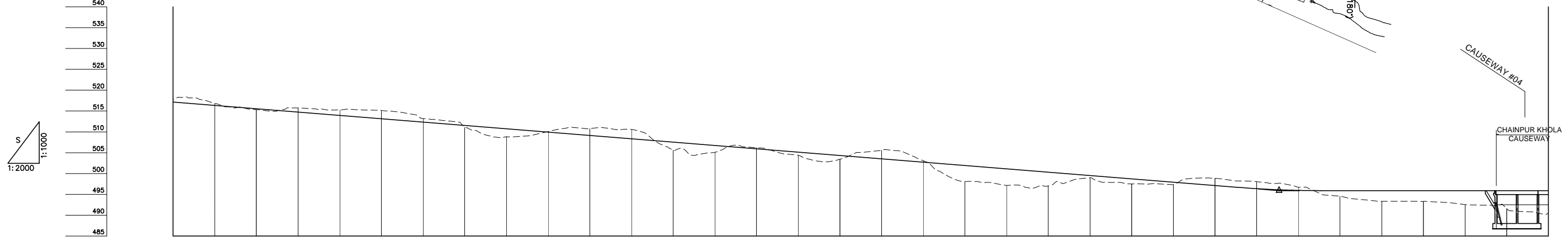
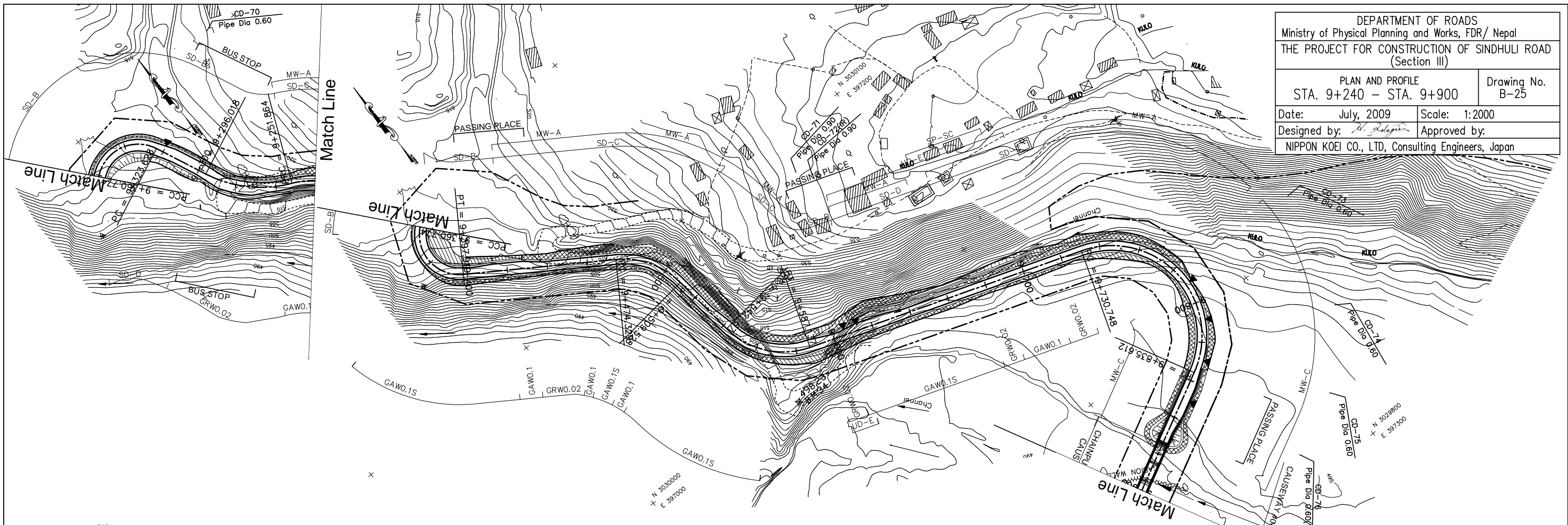

GRADE		-4.000% L=610.750																				495.900 9+770.750		-0.000% L=189.250															
PROPOSED HEIGHT	9+240	9+260	9+280	9+300	9+320	9+340	9+360	9+400	9+420	9+440	9+460	9+480	9+500	9+520	9+540	9+560	9+580	9+600	9+620	9+640	9+660	9+680	9+700	9+720	9+740	9+760	9+780	9+800	9+820	9+840	9+860	9+880	9+900						
GROUND HEIGHT	517.744	516.779	515.334	514.730	513.930	513.130	512.330	511.023	509.930	509.130	508.330	507.530	506.730	505.930	504.387	503.434	503.530	503.066	498.082	501.930	501.130	500.330	499.530	498.730	497.370	497.930	498.845	497.130	498.048	496.696	495.958	494.549	495.900	493.326	495.900	492.548	495.900	491.595	495.900
STATION	9+240	9+260	9+280	9+300	9+320	9+340	9+360	9+400	9+420	9+440	9+460	9+480	9+500	9+520	9+540	9+560	9+580	9+600	9+620	9+640	9+660	9+680	9+700	9+720	9+740	9+760	9+780	9+800	9+820	9+840	9+860	9+880	9+900						
CURVE ELEMENT		R=40 L=40.915	R=60 L=44.154	L=27.610	R=20 L=37.146	R=20 L=37.146	L=76.410	R=40 L=35.199	L=32.639	R=40 L=44.970	L=143.610	R=45 L=104.864	L=144.940																										
SUPER ELEVATION		+251.864	+296.018	+323.628	+360.774	+397.919	+474.329	+509.528	+542.167	+587.137	+730.748	+835.612																											
WIDENING		1.75m	1.75m	1.0m	1.25m	1.5m	1.25m	1.5m	1.25m	1.25m	1.25m	1.25m	1.25m	1.25m	1.25m	1.25m	1.25m	1.25m	1.25m	1.25m	1.25m	1.25m	1.25m	1.25m	1.25m	1.25m	1.25m	1.25m	1.25m	1.25m	1.25m	1.25m	1.25m	1.25m	1.25m	1.25m			
DESIGN SPEED		30 Km/h										20 Km/h										30 Km/h(40 Km/h)																	

