

DEPARTMENT OF ROADS Ministry of Physical Planning and Works, FDR/ Nepal THE PROJECT FOR CONSTRUCTION OF SINDHULI ROAD (Section III)	
PLAN AND PROFILE STA. 19+800 - STA. 21+120	Drawing No. B-43
Date: July, 2009	Scale: 1:2000
Designed by: <i>B. Halgiri</i>	Approved by:
NIPPON KOEI CO., LTD, Consulting Engineers, Japan	

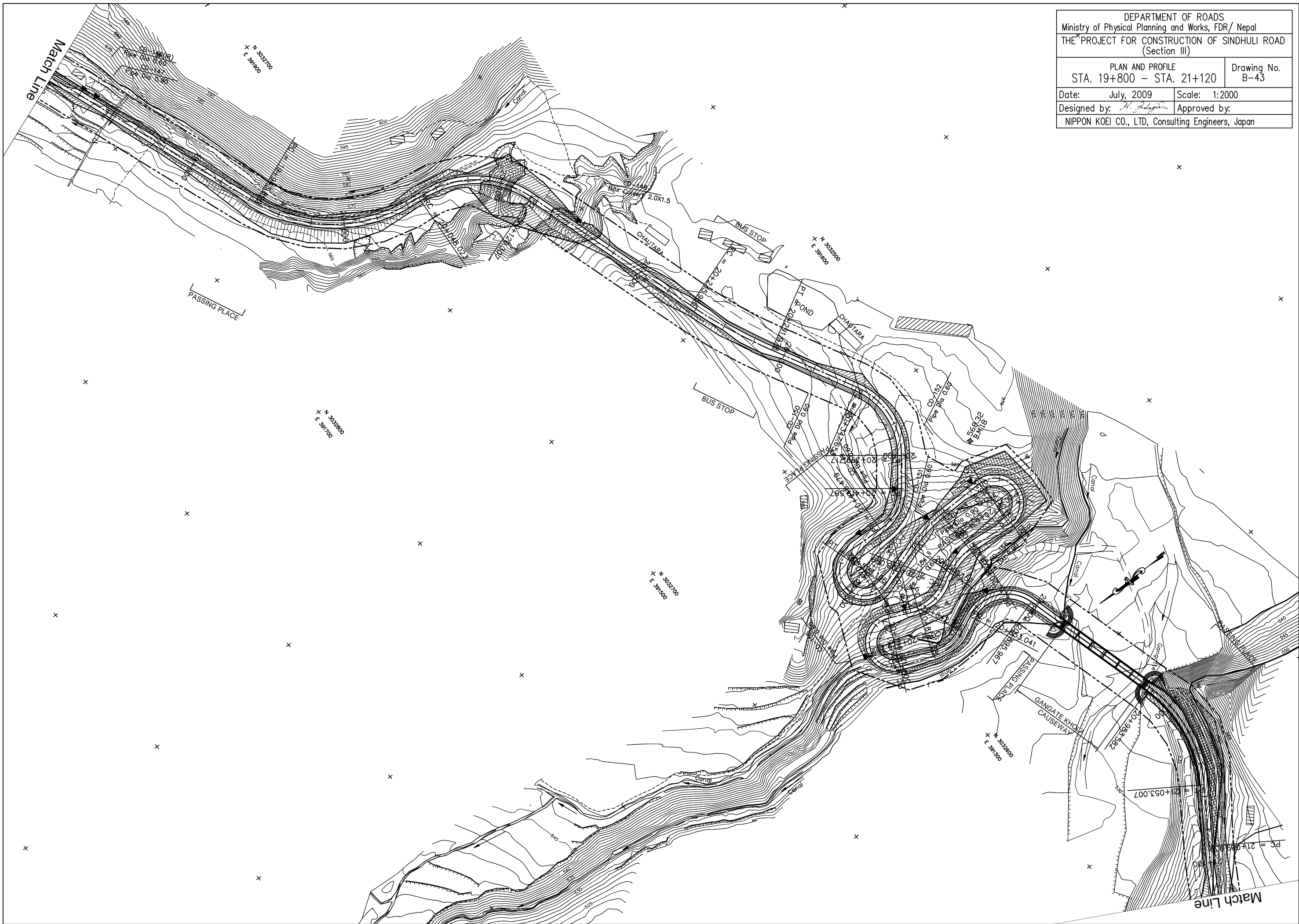

DEPARTMENT OF ROADS
Ministry of Physical Planning and Works, FDR/ Nepal
THE PROJECT FOR CONSTRUCTION OF SINDHULI ROAD
(Section III)

PLAN AND PROFILE STA. 19+800 - STA. 20+460		Drawing No. B-44
Date: July, 2009	Scale: 1:2000	
Designed by: <i>B. Subedi</i>	Approved by:	
NIPPON KOEI CO., LTD, Consulting Engineers, Japan		

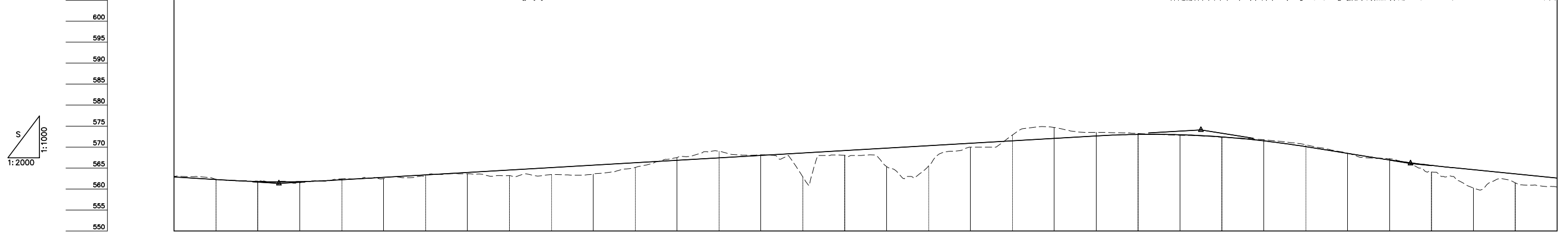
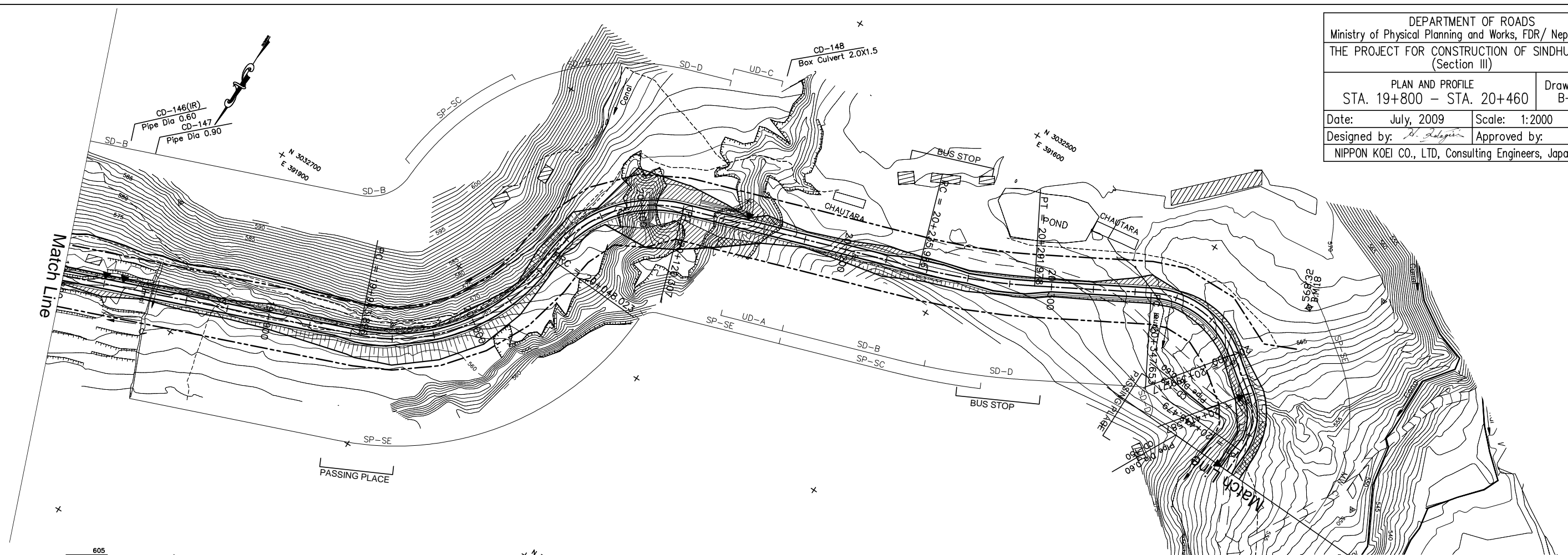

GRADE																																			
PROPOSED HEIGHT	19+800	19+820	19+840	19+860	19+880	19+900	19+920	19+940	19+960	19+980	20+000	20+020	20+040	20+060	20+080	20+100	20+120	20+140	20+160	20+180	20+200	20+220	20+240	20+260	20+280	20+300	20+320	20+340	20+360	20+380	20+400	20+420	20+440	20+460	
GROUND HEIGHT	563.073	562.305	561.964	561.514	562.442	562.457	563.213	563.635	563.204	563.444	563.531	565.130	567.498	569.026	568.162	562.934	568.027	565.373	565.489	570.000	572.860	574.680	573.504	573.247	572.800	572.360	571.751	570.543	568.535	567.224	564.079	560.229	561.484	560.527	
STATION	19+800	19+820	19+840	19+860	19+880	19+900	19+920	19+940	19+960	19+980	20+000	20+020	20+040	20+060	20+080	20+100	20+120	20+140	20+160	20+180	20+200	20+220	20+240	20+260	20+280	20+300	20+320	20+340	20+360	20+380	20+400	20+420	20+440	20+460	
CURVE ELEMENT		L=158.154									R=90 L=104.127				R=60 L=72.284				L=115.679			R=300 L=55.992			L=55.675			R=45 L=52.064		L=19.871	R=30 L=28.891	L=22.090			
SUPER ELEVATION		+943.896									+048.023				+120.307							+235.986			+291.978			+347.653		+399.717	+419.587	+448.479			
WIDENING		1.25m																				1.75m			1.75m										1.25m
DESIGN SPEED	Running speed		30 Km/h(40 Km/h)																																