

DEPARTMENT OF ROADS Ministry of Physical Planning and Works, FDR/ Nepal	
THE PROJECT FOR CONSTRUCTION OF SINDHULI ROAD (Section III)	
PLAN AND PROFILE STA. 13+200 - STA. 13+860	Drawing No. B-32
Date: July, 2009	Scale: 1:2000
Designed by: <i>S. Subedi</i>	Approved by:
NIPPON KOEI CO., LTD, Consulting Engineers, Japan	

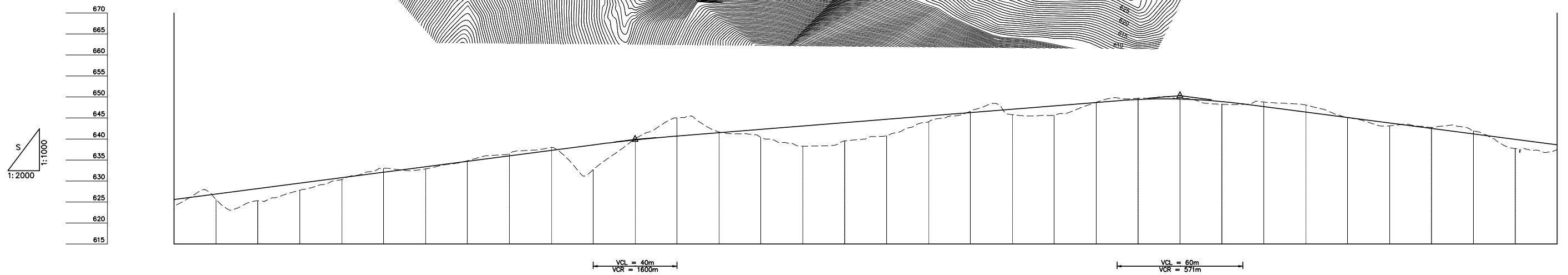
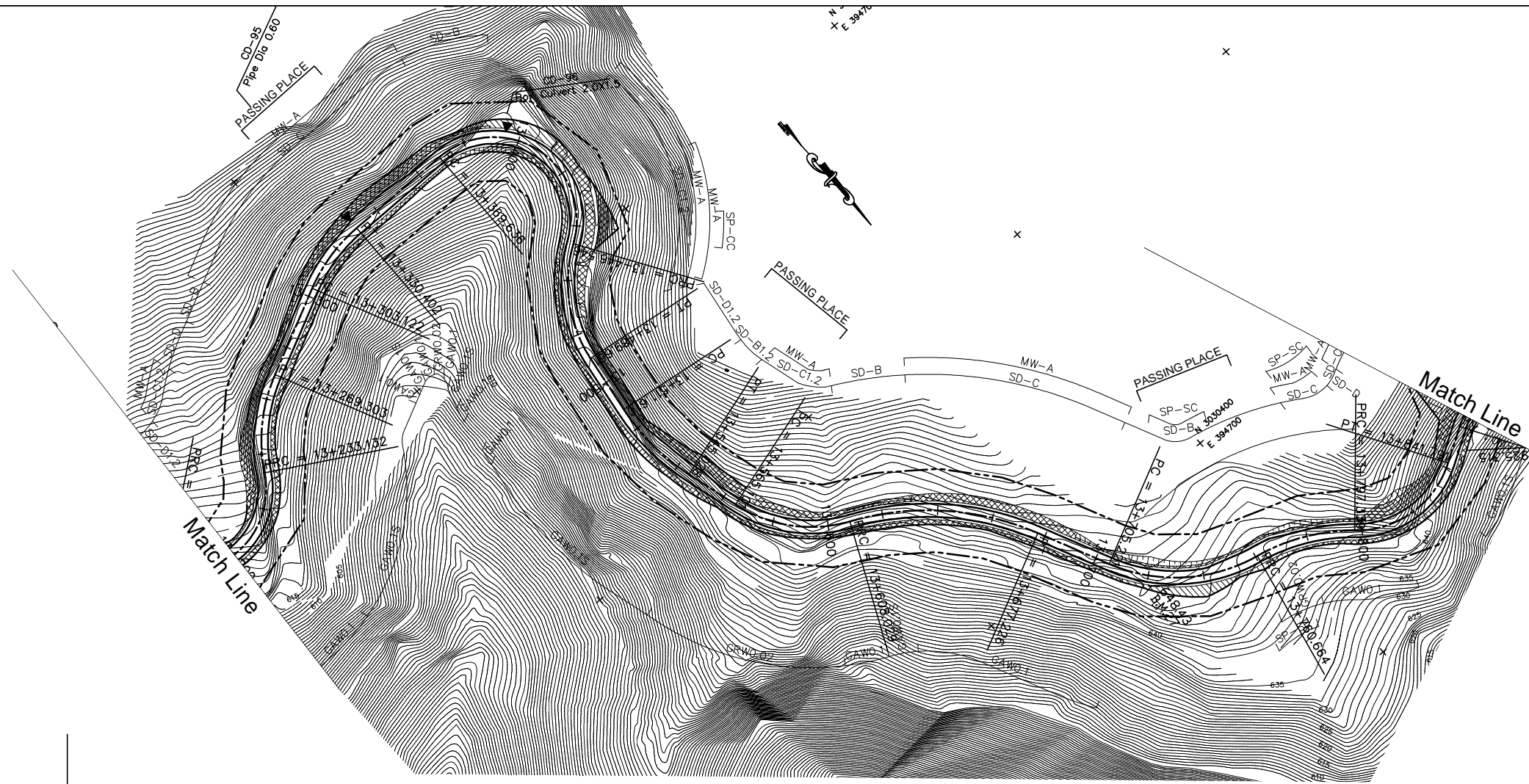

GRADE		6.500% L=460.000		6.39.900 13+420.000		4.000% L=260.000		650.300 13+680.000		-6.500% L=560.000																													
PROPOSED HEIGHT		625.600	626.900	628.200	629.500	630.800	632.100	633.400	634.700	636.000	637.300	638.600	639.775	640.700	641.500	642.300	643.100	643.900	644.700	645.500	646.300	647.100	647.900	648.700	649.413	649.513	649.539	649.513	648.913	648.700	647.700	646.400	645.100	643.800	642.500	641.200	639.900	638.600	
GROUND HEIGHT		623.983	625.595	625.307	627.782	630.333	633.000	632.877	634.818	636.467	638.014	638.689	639.997	645.041	641.685	640.424	638.301	639.547	640.769	644.077	646.630	645.785	645.675	648.700	649.702	649.539	648.266	648.802	648.089	645.088	643.131	642.753	641.966	637.740	637.448				
STATION		13+200	13+220	13+240	13+260	13+280	13+300	13+320	13+340	13+360	13+380	13+400	13+420	13+440	13+460	13+480	13+500	13+520	13+540	13+560	13+580	13+600	13+620	13+640	13+660	13+680	13+700	13+720	13+740	13+760	13+780	13+800	13+820	13+840	13+860				
CURVE ELEMENT		R=30 L=58.872		R=60 L=36.171		L=33.820		R=60 L=27.280		L=39.234		R=30 L=76.910		R=50 L=43.115		L=21.949		R=80 L=33.418		L=20.073		R=50 L=42.928		R=100 L=69.197		L=27.996		R=60 L=55.443		R=70 L=36.674		R=35 L=44.453		L=13.848		R=25 L=69.676			
SUPER ELEVATION	Left Right	+233.132		+269.303		+303.122		+330.402		+369.636		+446.546		+489.661		+511.610		+545.028		+565.101		+608.029		+677.226		+705.221		+760.664		+797.339		+841.791		+855.639					
WIDENING		0.5m		1.25m		1.25m		1.25m		1.25m		1.25m		1.25m		1.25m		1.25m		1.25m		1.25m		1.25m		1.25m		1.25m		1.25m		1.25m		1.25m					
DESIGN SPEED		30 Km/h																																					