

DEPARTMENT OF ROADS
 Ministry of Physical Planning and Works, FDR/ Nepal
 THE PROJECT FOR CONSTRUCTION OF SINDHULI ROAD
 (Section III)

PLAN AND PROFILE
 STA. 12+540 - STA. 13+200

Drawing No. B-31

Date: July, 2009 Scale: 1:2000
 Designed by: *B. Salgin* Approved by:
 NIPPON KOEI CO., LTD, Consulting Engineers, Japan

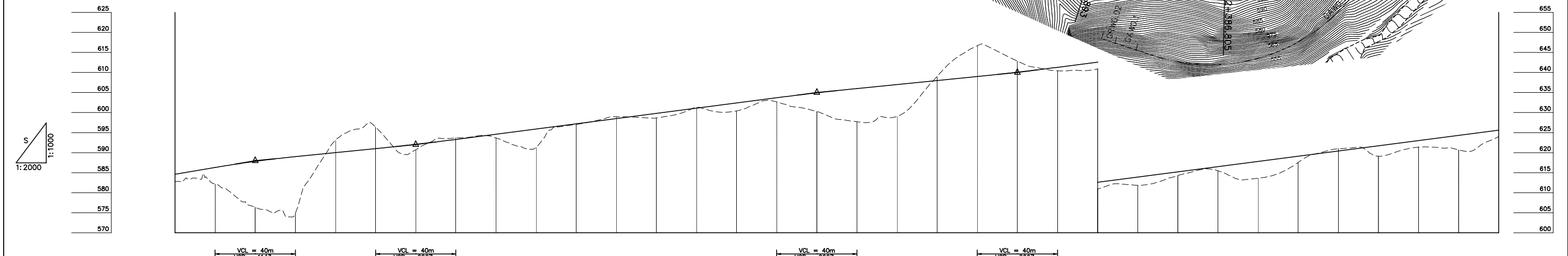
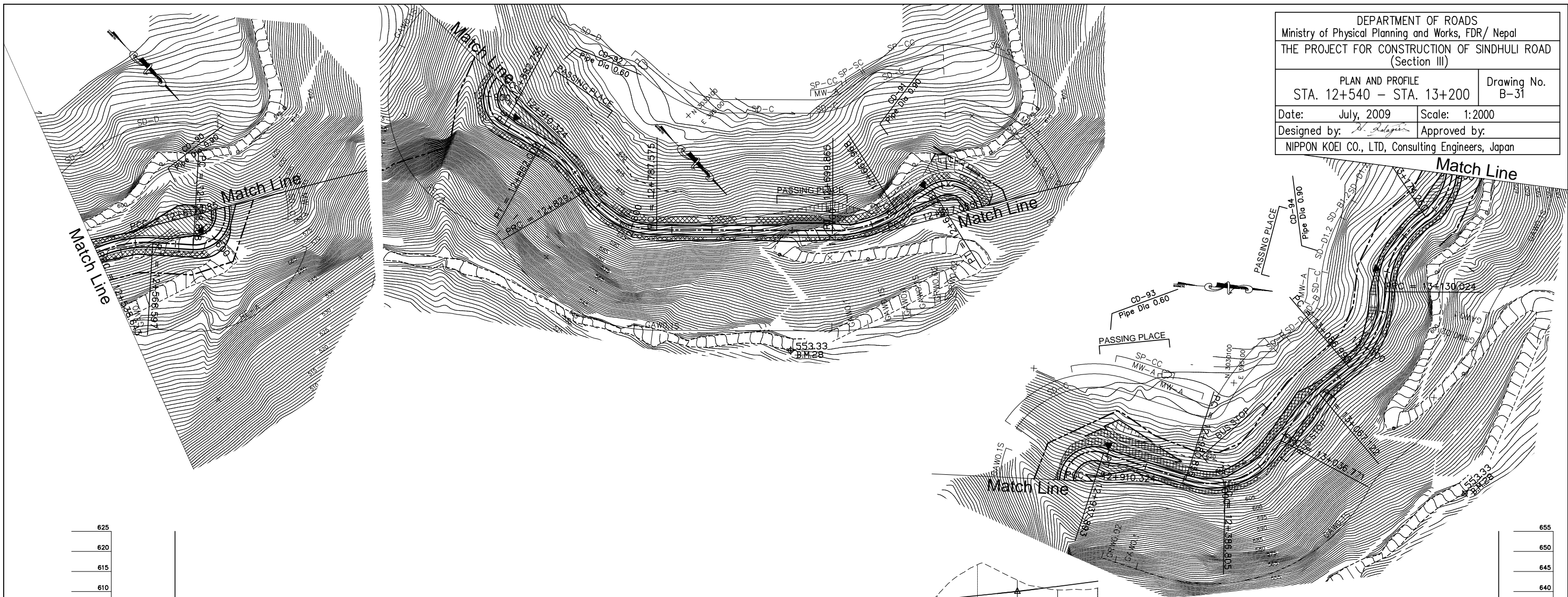

GRADE	8.500% L=600.000		5.000% L=60.000		6.500% L=200.000		5.000% L=100.000		6.500% L=460.000																											
PROPOSED HEIGHT	584.600	586.300	587.825	589.000	590.000	591.000	592.075	593.300	594.600	595.900	597.200	598.500	599.800	601.100	602.400	603.700	604.925	606.000	607.000	608.000	609.000	610.075	611.300	612.600	613.900	615.200	616.500	617.800	619.100	620.400	621.700	623.000	624.300	625.600		
GROUND HEIGHT	582.776	582.162	576.381	574.914	593.120	596.387	590.715	593.702	594.600	591.325	597.067	598.957	598.646	601.296	600.423	602.675	600.290	597.706	599.032	609.047	616.664	612.858	610.426	610.905	611.835	614.294	615.479	613.618	617.554	620.983	619.112	621.373	620.681	623.983		
STATION	12+540	12+560	12+580	12+600	12+620	12+640	12+660	12+680	12+700	12+720	12+740	12+760	12+780	12+800	12+820	12+840	12+860	12+880	12+900	12+920	12+940	12+960	12+980	13+000	13+020	13+040	13+060	13+080	13+100	13+120	13+140	13+160	13+180	13+200		
CURVE ELEMENT	R=60 L=29.953		R=15 L=28.197		R=15 L=28.197		R=60 L=33.897		L=87.711		R=40 L=41.533		R=60 L=32.901		R=15 L=27.569		R=15 L=27.569		L=42.964		R=40 L=55.914		R=80 L=30.351		L=19.873		R=50 L=43.029		R=45 L=44.236		R=30 L=58.872					
SUPER ELEVATION	+568.597		+588.888		+617.085		+645.281		+665.968		+699.865		+787.575		+829.108		+862.009		+882.755		+910.324		+937.893		+980.856		+036.771		+067.122		+086.995		+130.024		+174.260	
WIDENING	2.25m		2.25m		2.25m		1.25m		1.25m		1.25m		2.25m		1.75m		1.75m		1.75m		1.75m		1.25m		1.25m		0.5m		0.5m		0.5m		0.5m			
DESIGN SPEED	30 Km/h				20 Km/h				30 Km/h				20 Km/h				30 Km/h																			