

DEPARTMENT OF ROADS
 Ministry of Physical Planning and Works, FDR/ Nepal
 THE PROJECT FOR CONSTRUCTION OF SINDHULI ROAD
 (Section III)

PLAN AND PROFILE STA. 5+280 - STA. 5+940		Drawing No. B-18
Date: July, 2009	Scale: 1:2000	
Designed by: <i>S. Dalgin</i>	Approved by:	
NIPPON KOEI CO., LTD, Consulting Engineers, Japan		

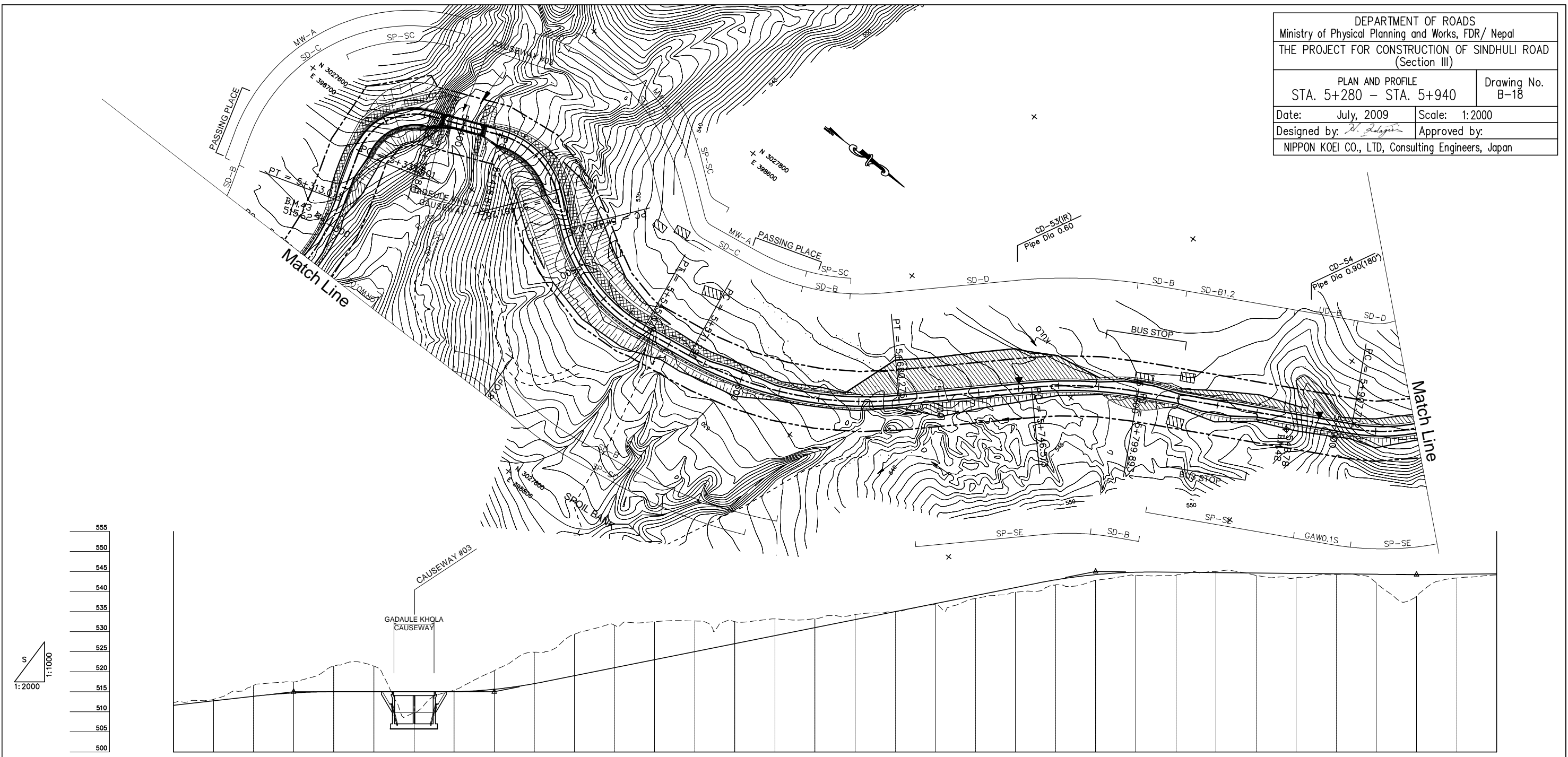

GRADE																																						
PROPOSED HEIGHT	511.640	512.760	513.880	514.720	515.000	515.000	515.025	515.625	517.025	519.000	521.000	523.000	525.000	527.000	529.000	531.000	533.000	535.000	537.000	539.000	541.000	542.913	544.213	544.813	544.800	544.700	544.600	544.500	544.400	544.300	544.250	544.300	544.400					
GROUND HEIGHT	512.340	513.126	516.583	517.447	521.443	521.411	509.715	515.406	520.263	524.886	529.336	531.596	532.469	532.659	532.490	533.186	533.253	534.234	534.975	536.853	537.000	538.246	539.000	539.814	541.678	542.859	544.084	544.037	545.018	544.027	543.443	544.189	544.400	542.118	538.845	543.368	544.138	544.400
STATION	5+280	5+300	5+320	5+340	5+360	5+380	5+400	5+420	5+440	5+460	5+480	5+500	5+520	5+540	5+560	5+580	5+600	5+620	5+640	5+660	5+680	5+700	5+720	5+740	5+760	5+780	5+800	5+820	5+840	5+860	5+880	5+900	5+920	5+940				
CURVE ELEMENT																																						
SUPER ELEVATION																																						
WIDENING																																						
DESIGN SPEED	30 Km/h																																					