

LAMPIRAN 1

**Berita Acara tentang
Laporan Awal, Laporan Kemajuan &
Konsep Laporan Akhir**

MINUTES OF THE MEETING
ON
INCEPTION REPORT
FOR
STUDY ON
DISTRIBUTION MECHANISM REFORM THROUGH DEVELOPMENT OF
WHOLESALE MARKET (IMPROVEMENT OF POST HARVEST HANDLING
AND MARKETING FACILITIES)
IN INDONESIA

In accordance with the Scope of Work for the above study signed on December 17, 2010 the JICA Study Team headed by Mr. Hiroshi Fukao (hereinafter referred to as "the Japanese side") explained and discussed the contents of the Inception Report (IC/R) with the Ministry of Marine Affairs and Fisheries (MMAF) and relevant agencies concerned of the Republic of Indonesia, on March 16, 2011.

The list of attendants is attached in Annex 1.

Salient issues discussed and agreed upon by both sides are shown in the pages attached hereto.

Jakarta, March 18, 2011



Mr. Saut P. Hutagalung
Director of International Marketing
Directorate General of Fisheries Product
Processing and Marketing
Ministry of Marine Affairs and Fisheries,
Republic of Indonesia



Mr. Hiroshi FUKAO
Team Leader
JICA Study Team

1. The Japanese side submitted 30 copies of the Inception Report (in English and Indonesian language respectively) on "Study on Distribution Mechanism Reform Through Development of Wholesale Market (Improvement of Post Harvest Handling and Marketing Facilities) in Indonesia" and explained to the Indonesian side on March 16, 2011.

2. The following are the main issues discussed and agreed on by both sides in relation to the Inception Report.

2.1 Both sides basically agreed on the approaches, methods and procedures of the Study as described in the said Report.

2.2 The first field survey in Indonesia has been commenced on March 9, 2011 and will be conducted until May 7, 2011 (for 60 days). The results of the Study will be outlined in the Progress Report and explained to the Indonesian side on April 27, 2011.

2.3 Logistic matters

(1) Weekly meeting

The Japanese side proposed to the Indonesian side to hold a regular weekly meeting to discuss on the progress of the Study and to formulate the project concept and scope. The Indonesian side agreed to hold the said meeting at 9 – 11 a.m. every Friday at MMAF.

(2) Counterpart

The Indonesian side agreed to appoint counterparts to attend on the weekly meeting mentioned in the above and the contact persons at each agency concerned to assist the Study Team in collecting data and information and exchange of project ideas. The list of counterparts and contact persons will be presented to the Japanese side.

(3) Steering Committee

The MMAF will organize a steering committee to provide directives and coordinate opinions of the different agencies concerned in the course of the implementation of the Study.

(4) Arrangement for survey permits

The Indonesian side agreed to make arrangements for obtaining necessary permits from agencies/organizations concerned for conduct of field surveys, as requested by the Study Team.

(5) Arrangement of separate meetings

The Indonesian side will arrange the separate meetings with the relevant directorates/institutes of MMAF and other agencies/organizations concerned for the Study Team.

(6) Conduct of Environmental Impact Assessment (EIA)

The Indonesian side will conduct the EIA based on the terms of reference prepared by the Study Team, if necessary.

2.4 Technical matters

The following are major technical comments from the Indonesian site.

(1) Nature of wholesale market

The proposed wholesale market should be developed as an integrated complex having the multi-functions such as meeting point to increase opportunities to deal the fisheries products, fish storage point to stabilize supply of fish, and seafood center.

(2) Wholesale market mechanism

The wholesale market mechanism at present and in the future including origin/destination of fish from/to the wholesale market should be analyzed.

(3) Alternative plans

Several alternative plans including selection criteria should be prepared and evaluated, so that the Indonesian side will be able to choose the best plan after the completion of the Study.

(4) Site plan and access road plan

The Indonesian side emphasized the importance of new access road not only for wholesale market but also for whole Jakarta Fishing Port, and showed the preference on new site development with reclamation of the existing water basin. However, these matters should be discussed with the relevant agencies concerning its cost and benefit.

(5) Jakarta Water Front Development Plan

The Study should be conducted in consideration of the linkage with the on-going Jakarta Water Front City Spatial Plan (under preparation). The Study Team will discuss it further with the relevant agencies such as the Directorate General of Capture Fisheries and the Provincial Government of DKI Jakarta.

List of Participants

Ministry of Marine Affairs and Fisheries (MMAF)

- | | |
|---------------------------------|-------------------------------------------------------------------|
| 1. Ir. Saut P. Hutagalung, M.Sc | Director of Foreign Market Development |
| 2. Ir. Sadarma S. Saragih, M.M | Head of Sub.Dir. of Export Development |
| 3. Ir. Rita Dyah W, M.M | Head of Sub.Dir. of Domestic Market Institutions |
| 4. Benny Tambunan | Secretariat General, MMAF |
| 5. Erwin Dwiyana | Directorate General of Fisheries Product Processing and Marketing |
| 6. Yustinus Edy P. | Directorate of Foreign Market Development |
| 7. Helwijaya M. | Directorate of Foreign Market Development |
| 9. Indah Prasetyana | Directorate of Capture Fisheries |
| 10. Bima | Directorate of Capture Fisheries |
| 11. Lola Dwi P. S | Bilateral Cooperation |
| 12. Mr. Motobumi MANABE | JICA Expert |

BAPPENAS

1. M. Heri S.

PERUM Jakarta Fishing Port

- | | |
|-----------------|----------------------------------|
| 1. Ali Supardan | Director of Perum PPS |
| 2. Wahidin H. | Head of Perum PPS Jakarta Branch |
| 3. Agus Wibowo | Staff |

UPT Jakarta Fishing Port

- | | |
|---------------|-------|
| 1. Kuspriyono | Staff |
| 2. Nuralimin | Staff |

DKI Jakarta

- | | |
|-------------------|-------------------------------------------|
| 1. Rita Nirmala | Directorate of Marine Fisheries DKI Jkt |
| 2. Sri Wahyuni S. | Directorate of Marine Fisheries North Jkt |
| 3. Yosi Lusia | Regional Environmental Management Agency |
| 4. M. Ibransah | Spatial Services, DKI |

JICA Indonesia Office

- | | |
|-------------------|----------------|
| 1. Ms. Mari MIURA | Representative |
|-------------------|----------------|

Study Team

- | | |
|------------------------|-------------|
| 1. Mr. Hiroshi FUKAO | Team Leader |
| 2. Mr. Wataru IWASAKI | Member |
| 3. Mr. Seiichi ETOH | Member |
| 4. Mr. Yuichi BABA | Member |
| 5. Mr. Tatsuhiko KONO | Member |
| 6. Mr. Kengo SHIRATORI | Member |
| 7. Mr. Sadao ORISHIMO | Member |

MINUTES OF THE MEETING
ON
PROGRESS REPORT
FOR
STUDY ON
DISTRIBUTION MECHANISM REFORM THROUGH DEVELOPMENT OF
WHOLESALE MARKET (IMPROVING OF POST HARVEST HANDLING AND
MARKETING FACILITIES)
IN INDONESIA

In accordance with the Inception Report of the above study, the JICA Study Team headed by Mr. Hiroshi Fukao (hereinafter referred to as “the Japanese side”) has been carrying out the Study in collaboration with the Ministry of Marine Affairs and Fisheries (MMAF) and relevant agencies concerned of the Republic of Indonesia, since March 9, 2011. As a result of the First Field Work, the Japanese side explained the outline of the Progress Report to MMAF on April 27, 2011.

The list of attendants is attached in Annex 1.

Salient issues discussed and agreed upon by both sides are shown in the pages attached hereto.

Jakarta, April 28, 2011



 Ir. Saut P. Hutagalung
Director of Foreign Market Development
Directorate General of Fisheries Product
Processing and Marketing
Ministry of Marine Affairs and Fisheries,
Republic of Indonesia

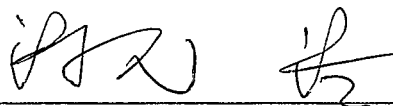

Mr. Hiroshi FUKAO
Team Leader
JICA Study Team

1. The Japanese side explained the outline of the Progress Report on “Study on Distribution Mechanism Reform Through Development of Wholesale Market (Improving of Post Harvest Handling and Marketing Facilities) in Indonesia” to the Indonesian side on April 27, 2011.
2. The Japanese side promised to submit to the Indonesian side 30 copies of the Progress Report (English language) on May 5 and those (Indonesian language) by May 20, 2011 respectively.
3. The followings are the main issues discussed and agreed on by both sides in relation to the outline of the Progress Report.
 - 3.1 The Indonesian side basically agreed on the outline of the Progress Report, and promised to examine carefully the said report and submit the written comments to the Japanese side before June 4, 2011.
 - 3.2 The Japanese side promised to continue the Study in Japan, and submit the Draft Final Report in July 2011, considering the comments of the Indonesian side.
 - 3.3 The Japanese side recommended the alternative plans which will not require the resettlement of inhabitants, and the Indonesian side basically understood thereon. The Indonesian side, however, mentioned that the resettlement issue would have to be solved in the course of the execution of Jakarta Waterfront City Plan (under tendering for Feasibility Study by the MMAF) so that necessary resettlements will be considered to proceed by the Indonesian side without any concern to the proposed project.
 - 3.4 The MMAF will coordinate with DKI Jakarta regarding the land reclamation permit, land acquisition and resettlement issues, based on the contents of the Progress Report.

4. Second Field Study

The First Field Work will be completed on May 7, 2011, and the Second Field Work is scheduled to carry out during July 17 – 23, 2011. Both sides confirmed that the Draft Final Report would be presented and discussed during the Second Field Work.

5. Other Comments from the Indonesian Side

- 5.1 Each project components (facilities) should be compared between present (without the Project) and future (with the Project) in terms of scale of facilities,

and should be shown in the list in the Progress Report.

- 5.2 Seafood Center should be designed in consultation with the relevant private sector, to solicit ideas or their interest and on how the private sector may participate.
- 5.3 The responsible organizations for O & M will be proposed by the Study Team and confirmed by the Indonesian side at the stage of Draft Final Report of the study, but subject to final approval by the Minister of Marine Affairs and Fisheries.
- 5.4 The control of both solid and liquid waste is one of the issues to be solved in the existing wholesale market, and should be also included in the Project.
- 5.5 The Enviromental Impact Aseessment would be conducted by MMAF based upon budget availability.

M

AS

Annex-1

List of Participants

Ministry of Marine Affairs and Fisheries (MMAF)

- | | |
|------------------------|------------------------------------------|
| 1. Saut P. Hutagalung | Director of Foreign Market Development |
| 2. Sadarma S. Saragih | Deputy Director, DGFPPM |
| 3. Edwin Dwiwana | Section Head, DGFPPM |
| 4. Jonet Srialdoko | Deputy Director, DG of Capture Fisheries |
| 5. Muhammad Fathoni | Section Head, DGFPPM |
| 6. Lukman Nur Hakim | Staff, DG of Capture Fisheries |
| 7. Helwijaya M. | Staff, DGFPPM |
| 8. Indah Prasetyana | Staff, DG of Capture Fisheries |
| 9. Mr. Motobumi MANABE | JICA Expert |

UPT Jakarta Fishing Port

- | | |
|------------------|--------------------------|
| 1. Rahmat Irawan | Div. Head of Development |
|------------------|--------------------------|

DKI Jakarta

- | | |
|---------------|--------------------------------------------|
| 1. Emiel A. T | Infrastructure Bureau DKI Jakarta Province |
|---------------|--------------------------------------------|

Study Team

- | | |
|------------------------|-------------|
| 1. Mr. Hiroshi FUKAO | Team Leader |
| 2. Mr. Wataru IWASAKI | Member |
| 3. Mr. Seiichi ETOH | Member |
| 4. Mr. Yuichi BABA | Member |
| 5. Mr. Sadao ORISHIMO | Member |
| 6. Mr. Kengo SHIRATORI | Member |
| 7. Mr. Isao HINO | Member |
| 8. Ms. Kyoko MISHIMA | Member |
| 9. Mrs. Rizzy | Member |
| 10. Mr. Fadil Y | Member |

MINUTES OF THE MEETING
ON
DRAFT FINAL REPORT
FOR
STUDY ON
DISTRIBUTION MECHANISM REFORM THROUGH DEVELOPMENT OF
WHOLESALE MARKET (IMPROVING OF POST HARVEST HANDLING AND
MARKETING FACILITIES)
IN INDONESIA

In accordance with the Inception Report of the above study, the JICA Study Team headed by Mr. Hiroshi FUKAO (hereinafter referred to as “the Japanese side”) has been carrying out the Study in collaboration with the Ministry of Marine Affairs and Fisheries (MMAF) and relevant agencies concerned of the Republic of Indonesia (hereinafter referred to as “the Indonesian side), since March 2011. As a result of this Second Field Work, the Japanese side explained the outline of the Draft Final Report to MMAF on July 14, 2011.

The list of attendants is attached in Annex 1.

Salient issues discussed and agreed upon by both sides are shown in the pages attached hereto.

Jakarta, July 15, 2011

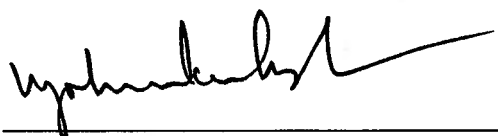

Dr. Victor P.H. Nikijuluw
Director General of Fisheries Product
Processing and Marketing
Ministry of Marine Affairs and Fisheries,
Republic of Indonesia



Mr. Hiroshi FUKAO
Team Leader
JICA Study Team



1. Overall Project

The area surrounding the Jakarta Fishing Port (JFP), including Muara Baru and Muara Angke, is being planned for integrated development under the *Jakarta Fisheries Waterfront Development Project*, which will include not only fish handling, marketing, and distribution facilities but also those related to fish producers and consumers. Considering this higher level development plan, it is proposed that the JFP Wholesale Market (JFPWM) be developed as (i) a fish trading and marketing center (PPPI), to upgrade and improve market mechanism; (ii) fish supply buffer center to stabilize fish supply and price; and (iii) an seafood plaza to attract more consumers to waterfront area.

Project Components

- Fish trading and marketing center “Pusat Perdagangan dan Pemasaran Ikan (PPPI)”
- Fish supply buffer center “cold storage and processing units”
- Seafood plaza “restaurants, fish shops, and event hall”
- Access road
- Seawall and reclaimed land

Project Period – 6.5 years

Estimated Project Cost

Total project cost is estimated around Rp. 1.7 trillion (including price escalation, taxes, land acquisition, and project administration cost)

2. The Japanese side submitted to the Indonesian side the Draft Final Report (30 copies each in English and Indonesian language respectively) for “Study on Distribution Mechanism Reform through Development of Wholesale Market (Improving of Post Harvest Handling and Marketing Facilities) in Indonesia” on July 11, 2011, and explained the outline on July 14, 2011.
3. The Japanese side had a series of meetings with the relevant agencies such as Planning Bureau, DG Capture Fisheries, and DG Fisheries Product Processing and Marketing of the MMAF, Provincial Government of Jakarta (Deputy Governor), UPT PPSNZ and Perum PPS of Jakarta Fishing Port, during July 11–15, 2011.
4. The followings are the main issues discussed and agreed on by both sides in relation to the outline of the Progress Report.

- 4.1 The Indonesian side basically agreed on the outline of the Draft Final Report, and promised to examine carefully the said report and submit the written comments to the Japanese side before August 12, 2011.
- 4.2 The Japanese side will submit the Final Report in October 2011, considering the comments of the Indonesian side.
- 4.3 The Japanese side recommended the alternative plans (Site Plan A-1 and Access Road Plan 2-2) which will not require the resettlement of inhabitants, and the Indonesian side basically agreed thereon. The MMAF will continue to discuss with the Provincial Government of Jakarta for obtaining the mutual consent, based on the said recommended plan, in consideration of the Spatial Plan 2030 (under preparation by the Provincial Government of Jakarta), the Flood Control Plan (Pluit), and Jakarta Waterfront City Plan. The Japanese side also recommended MMAF to request Provincial Government of Jakarta to include proposed site plan and access road plan in the said Spatial Plan.
- 4.4 The MMAF agreed to conduct the Environmental Impact Assessment (EIA) for obtaining the environmental permit and land reclamation permit from the Provincial Government of Jakarta and other relevant agencies, based on the contents of the Draft Final Report. The necessary fund for conducting the EIA will be borne by the Government of Indonesia. MMAF will explore the possibility of utilizing the remaining budget allocated to the on-going Jakarta Fishing Port Project (Package III) within this year, among other possible sources.
- 4.5 The MMAF will promptly take necessary procedure with the BAPPENAS to register the proposed project in the "Blue Book", based on the contents of Draft Final Report.
- 4.6 Both sides agreed that the implementing agency of the Project would be Directorate General of Capture Fisheries, while the proposed project facilities be operated and managed by a new UPT to be organized under the Directorate General of Fisheries Product Processing and Marketing, considering his role and responsibility, but subject to approval by the Minister of Marine Affairs and Fisheries.
- 4.7 Proposed Processing Schedule
 - Application to register proposed project in the Blue Book (September 2011)
 - Conduct of EIA (will be completed by the end of 2012)
 - Land acquisition for access road (by the end of 2013)
 - Reclamation permit (by the end of 2013)

4.8 Major Recommendation

The Japanese side recommended to Indonesian side to expedite all necessary procedures as listed in 4.7 to realize the project implementation as scheduled in the draft final report.

5. Other Comments from the Indonesian Side

- 5.1 The feasibility study on the Jakarta Fisheries Waterfront City Plan is scheduled to prepare by the end of 2011 by the Indonesian side. The results of this Study will be considered and reflected in the said Plan.
- 5.2 The attractive name of a new Jakarta Fishing Port Wholesale Market Complex should be considered and decided by the MMAF.
- 5.3 The related soft-components activities for market mechanism reform should be prepared before the operation of the facilities.
- 5.4 The sources of all data and information should be clearly described in the Final Report, so as to ensure traceability.

Annex-1

List of Participants

Ministry of Marine Affairs and Fisheries (MMAF)

Ir. Saut P. Hutagalung	Director of Foreign Market Development
Yohanes Waluyo Susanto	Head of General Planning
F.P. Budiasih Simorangkir	Sub.Div.Head of Budget Analysis & Formulation
Benny Tambunan	Sub.Div.Head Foreign & Cross Sectoral Planning
Ridwan Mulyana	Section Head of Identification & Analysis
Yustinus Edy Pramono	Section Head of Market Access Safeguarding
Indah Prasetyana	Directorate of Fishing Port, DG Capture Fisheries
Prayudi Budi Utomo	Directorate of Domestic Marketing, DGFPPM
Mr. Motobumi MANABE	JICA Expert

PERUM Jakarta Fishing Port

Sonni Adji P. Witjaksono	Head of Marketing & Business Development Div., Jakarta Fishing Port Branch
--------------------------	-------------------------------------------------------------------------------

UPT PPSNZJ

Dameria Siagian	Head Section of Facility
Diki Indra Perdana	Staff
Amrita Wahyu G.	Staff

DKI Jakarta

Darjamuni	Head of Fisheries Division, Provincial Marine Affairs & Fisheries Service
Sri Wahyuni S.	Provincial Marine Affairs & Fisheries Service
Farida	Provincial Marine Affairs & Fisheries Service
Emiel Afrans T.	City Infrastructure Bureau
Harmawan S.	City Infrastructure Bureau
Siti Harfiah	Spatial Planning Service
Panut	Spatial Planning Service
Zulkifli	Public Works Service
Reza Febiyanto	Public Works Service

JICA Indonesia Office

Ms. Mari MIURA	Representative
----------------	----------------

Study Team

Mr. Hiroshi FUKAO	Team Leader
Mr. Wataru IWASAKI	Member
Mr. Jerome F. Sison	Member
Mr. Sadao ORISHIMO	Member
Mr. Tatsuhiko KONO	Member
Mr. Shingo SHIRATORI	Member
Mrs. Rizzy M	Member

LAMPIRAN 2

**Permintaan dan Pasokan Ikan
(Nasional dan DKI Jakarta)**

APPENDIX 2: FISH DEMAND AND SUPPLY (NATIONAL AND DKI JAKARTA)

2.1 FISH PRODUCTION IN INDONESIA

Production	2000	2001	2002	2003	2004	2005	2006	2007	2008	2009	Average increase per year (%)
1.Marine capture	3,807	3,966	4,074	4,383	4,320	4,408	4,512	4,734	4,702	4,789	2.9
2.Inland capture	318	310	305	305	331	297	294	310	494	496	6.2
3.Capture total	4,125	4,276	4,379	4,688	4,651	4,705	4,806	5,044	5,196	5,285	3.1
4.Mariculture	197	221	235	249	421	890	1,366	1,510	1,966	2,437	126.3
5.BW/FW culture	798	856	902	975	1,048	1,274	1,317	1,684	1,889	2,342	21.5
6.Aquaculture total	995	1,077	1,137	1,224	1,469	2,164	2,683	3,194	3,855	4,779	42.3
T. Production	5,120	5,353	5,516	5,912	6,120	6,869	7,489	8,238	9,051	10,064	10.7

Sources of data: Marine and Fishery Statistics 2009

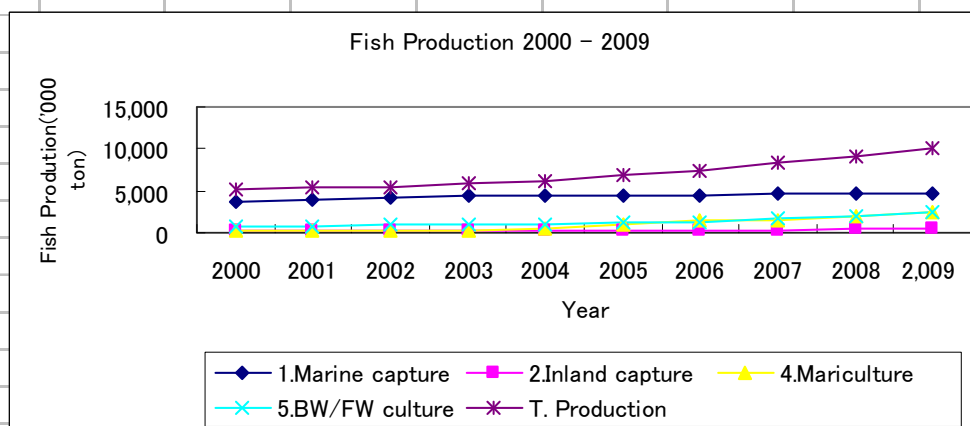

2.2 CURRENT SITUATION OF FISHERYR RESOURCES EXPLOITATION

Fisheries Management Area	Item	Species of fish							Total
		Pelagic (large)	Pelagic (small)	Demersal	Coral fish	Shrimp	Lobster	Squid/ cuttlefish	
1. Malacca Strait	MSY	27.7	147.3	82.4	5.0	11.4	0.4	1.9	276.1
	Production	35.3	132.7	146.2	21.6	49.5	0.9	3.2	389.4
	Exploitation (%)	127.4	90.1	177.4	432.0	434.2	217.5	168.4	141.0
2. South China Sea	MSY	66.1	621.5	334.8	21.6	10.0	0.4	2.7	1,057.1
	Production	35.2	205.6	54.7	7.9	70.5	1.2	4.9	380.0
	Exploitation (%)	53.3	33.1	16.3	36.6	705.0	310.0	181.5	35.9
3. Java Sea	MSY	55.0	340.5	375.2	9.5	11.4	0.5	5.0	797.1
	Production	137.8	507.5	334.2	48.2	52.9	0.9	12.1	1,093.6
	Exploitation (%)	250.5	149.0	89.1	507.4	464.0	186.0	242.0	137.2
4. Makassar Sea	MSY	193.6	605.4	87.2	15.4	4.8	0.7	3.9	911.0
	Production	85.1	333.4	167.4	24.1	30.9	0.7	8.0	649.6
	Exploitation (%)	44.0	55.1	192.0	156.5	643.8	92.9	205.1	71.3
5. Banda Sea	MSY	104.1	132.0	9.3	32.0	-	0.4	0.1	277.9
	Production	29.1	146.7	43.2	6.2	-	0.0	3.5	228.7
	Exploitation (%)	28.0	111.1	464.5	19.4	-	2.5	3,500.0	82.3
6. Seram Sea	MSY	106.5	379.4	83.8	12.5	0.9	0.3	7.1	590.5
	Production	37.5	119.4	32.1	4.6	1.1	0.0	2.9	197.6
	Exploitation (%)	35.2	31.5	38.3	36.8	122.2	6.7	40.8	33.5
7. Sulawesi Sea	MSY	175.3	384.8	54.9	3.5	2.5	0.4	0.5	621.9
	Production	153.4	62.5	15.3	2.2	2.2	0.0	1.5	237.1
	Exploitation (%)	87.5	16.2	27.9	63.1	87.2	10.0	300.0	38.1
8. Arafura Sea	MSY	50.9	468.1	202.3	3.1	43.1	0.1	3.3	770.9
	Production	34.6	12.3	156.8	22.6	36.7	0.2	3.3	266.5
	Exploitation (%)	68.0	2.6	77.5	729.0	85.2	160.0	100.0	34.6
9. Indian Ocean	MSY	396.3	526.6	135.1	12.9	10.7	1.6	3.8	1,087.0
	Production	188.3	264.6	134.8	19.4	10.2	0.2	6.3	623.8
	Exploitation (%)	47.5	50.2	99.8	150.4	95.3	10.0	165.8	57.4
Total	MSY	1,175.5	3,605.6	1,365.0	115.5	94.8	4.8	28.3	6,389.5
	Production	736.3	1,784.7	1,084.7	156.8	253.9	4.1	45.7	4,066.3
	Exploitation (%)	62.6	49.5	79.5	135.8	267.8	85.4	161.5	63.6

Source: Capture Fisheries Statistics of Indonesia, MMAF, 2006

2.3 PROJECTED FISH SUPPLY, DEMAND AND CONSUMPTION IN 2025

Supply/demand	2000	2001	2002	2003	2004	2005	2006	2007	2008	2009
Marine capture	3,807,191	3,966,480	4,073,506	4,383,103	4,320,241	4,408,499	4,512,191	4,734,280	4,701,933	4,789,410
Inland capture	318,334	310,240	304,989	304,989	330,880	297,370	293,921	310,457	494,395	495,610
Capture total	4,125,525	4,276,720	4,378,495	4,688,092	4,651,121	4,705,869	4,806,112	5,044,737	5,196,328	5,285,020
Aquaculture	997,316	1,076,752	1,137,153	1,151,536	1,468,610	2,163,674	2,682,600	3,193,565	3,855,200	4,780,100
T. Production	5,122,841	5,353,472	5,515,648	5,839,628	6,119,731	6,869,543	7,488,712	8,238,302	9,051,528	10,065,120
(Seaweed)	(2,937)	(212,478)	(223,080)	(231,927)	(410,570)	(910,636)	(1,374,462)	(1,728,475)	(2,145,060)	(2,574,000)
Import	179,463	162,472	124,010	107,768	136,040	151,008	184,240	145,227	198,980	218,622
(Fish meal/feed)	(135,541)	(127,883)	(85,214)	(71,899)	(94,898)	(106,456)	(111,997)	(65,679)	(141,333)	(155,221)
Export	519,418	487,113	565,739	857,783	902,358	857,782	926,478	854,328	911,674	796,700
Domesitc cons.	4,644,408	4,688,470	4,765,625	4,785,787	4,847,945	5,145,677	5,260,015	5,735,047	6,052,441	6,757,821
Population	206,265	207,928	210,736	213,551	216,382	219,205	222,051	224,905	227,779	230,306
PC Fish cons.	22.5	22.5	22.6	22.4	22.4	23.5	23.7	25.5	26.6	29.3
Supply/demand	2010	2011	2012	2013	2014	2015	2020	2025		
Marine capture	4,846,880	4,905,040	4,963,900	5,023,470	5,083,750	5,437,588	5,949,849	6,462,110		
Inland capture	501,560	507,580	513,670	519,830	526,070	560,232	660,223	760,214		
Capture total	5,348,440	5,412,620	5,477,570	5,543,300	5,609,820	5,997,819	6,610,072	7,222,324		
Aquaculture	5,736,200	6,847,500	9,415,700	13,020,800	16,891,000	17,689,200	18,782,700	20,426,700		
T. Production	11,084,640	12,260,120	14,893,270	18,564,100	22,500,820	23,687,019	25,392,772	27,649,024		
(Seaweed)	(2,672,800)	(3,504,200)	(5,100,000)	(7,500,000)	(10,000,000)	(10,500,000)	(11,000,000)	(12,000,000)		
Import	280,000	320,000	350,000	410,000	490,000	500,000	540,000	597,276		
(Fish meal/feed)	(132,789)	(140,362)	(147,935)	(155,508)	(163,081)	(170,654)	(208,518)	(246,383)		
Export	1,380,000	1,580,000	1,730,000	2,070,000	2,430,000	2,500,000	2,750,000	3,000,000		
Domesitc cons.	7,179,051	7,355,558	8,265,335	9,248,592	10,397,739	11,016,366	11,974,254	12,999,917		
Population	233,061	235,815	238,570	241,324	244,079	247,527	261,005	273,219		
PC Fish cons.	30.8	31.2	34.6	38.3	42.6	44.5	45.9	47.6		
Source: Fisheries Statistics 2009 MMAF, Population: Proyeksi Penduduk 2000–2005 (www.datastatistiks-Indonesia.com)										

2.4 PROJECTED AQUACULTURE PRODUCTION IN 2005

Species	Actual figure					Next strategy planning period					Predicted period		
	2,005	2,006	2,007	2,008	2,009	2,010	2,011	2,012	2,013	2,014	2,015	2,020	2,025
1. Seaweed	910,636	1,374,462	1,728,475	2,145,060	2,574,000	2,672,800	3,504,200	5,100,000	7,500,000	10,000,000	10,500,000	11,000,000	12,000,000
2. Catfish (Pangasius)	32,575	31,490	36,755	102,021	132,600	225,000	383,000	651,000	1,107,000	1,883,000	1,900,000	1,950,000	2,000,000
3. Catfish (Clarias)	69,386	77,272	91,735	114,371	200,000	270,600	366,000	495,000	670,000	900,000	910,000	950,000	1,000,000
4. Tilapia	148,249	169,390	206,904	291,037	378,300	491,800	639,300	850,000	1,105,000	1,242,900	1,280,000	1,300,000	1,500,000
5. Gouramy	25,442	28,710	35,708	36,636	38,500	40,300	42,300	44,400	46,600	48,900	50,000	65,000	80,000
6. Milkfish	254,067	212,883	263,139	277,471	291,300	349,600	419,000	503,400	604,000	700,000	710,000	750,000	800,000
7. Common carp	216,920	247,633	264,349	242,322	254,400	267,100	280,400	300,000	325,000	350,000	360,000	380,000	400,000
8. Grouper	6,493	4,021	8,035	5,005	5,300	7,000	9,000	11,000	15,000	20,000	20,500	22,000	24,000
9. Seabass	2,935	2,183	4,418	4,371	4,600	5,000	5,500	6,500	7,500	8,500	8,700	10,700	12,700
10. Shrimp	280,629	327,610	358,925	409,590	348,100	400,300	460,000	529,000	608,000	699,000	700,000	705,000	710,000
11. Others	216,342	206,942	195,122	227,317	553,000	646,700	738,800	925,400	1,032,700	1,038,700	1,250,000	1,650,000	1,900,000
Total	2,163,674	2,682,596	3,193,565	3,855,201	4,780,100	5,376,200	6,847,500	9,415,700	13,020,800	16,891,000	17,689,200	18,782,700	20,426,700

Source of data: Marine and Figures in 2009 MMAF, Strategic Plan 2010 – 2014 and computerized projection

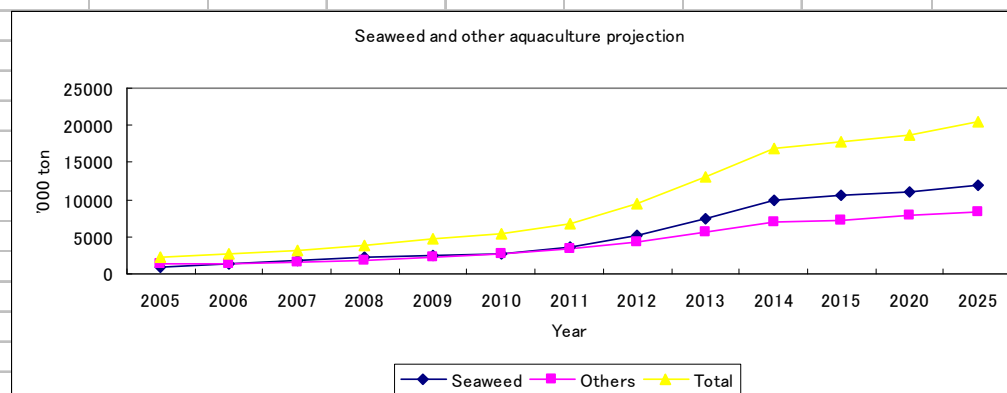

2.5 MONTHLY FISH LANDING IN JFP IN 2009

No.	Species of fish		Month (2009)												Total
	English name	Indonesian name	1	2	3	4	5	6	7	8	9	10	11	12	
1	Skip jack	Cakalang	959.7	994.7	1,348.6	1,474.0	2,123.5	1,450.8	2,654.3	2,354.0	2,019.8	2,680.9	2,189.0	2,182.6	22,431.9
2	Longtail/little tuna	Tongkol	422.3	327.7	277.6	207.4	140.0	97.8	616.9	570.3	535.6	855.1	1,036.0	1,054.0	6,140.7
3	Yellow fin tuna	Madidihang	155.7	200.7	191.9	231.1	424.8	406.0	293.1	466.9	192.4	341.0	166.0	138.1	3,207.7
4	Bigeye tuna	Tuna mata besar	136.0	147.4	133.6	193.7	378.3	257.2	221.8	247.9	238.6	239.2	180.9	79.4	2,454.0
5	Spanish mackerel	Tenggiri	78.5	71.2	78.1	52.0	113.9	81.1	142.3	100.4	83.0	67.9	131.6	160.2	1,160.2
6	Sword fish	Ikan pedang	53.3	140.7	68.4	0.0	253.4	177.8	193.0	97.2	108.2	0.0	37.0	14.6	1,143.6
7	Sail fish	Ikan layaran	53.5	110.4	70.9	90.2	198.6	118.9	119.8	101.3	40.1	30.4	129.8	35.8	1,099.7
8	Shark	Cucut botol	58.7	100.3	56.7	180.7	170.0	145.4	111.8	98.4	29.8	6.0	93.9	10.5	1,062.2
9	Albacore	Albakora	44.1	129.5	75.1	95.5	236.7	151.9	54.5	52.7	12.5	0.0	194.1	15.3	1,061.9
10	Squid	Cumi-cumi	0.0	0.0	0.0	0.0	7.4	48.3	283.7	27.5	282.2	3.2	269.9	11.7	933.9
11	Black marlin	Bawal hitam	27.8	26.1	22.1	92.7	121.1	169.0	191.3	60.2	6.1	0.0	43.9	4.6	764.9
12	Giant catfish	Manyung	5.1	7.5	12.4	9.2	6.2	11.3	17.4	8.6	11.9	9.6	59.5	10.8	169.5
13	Rays	Pari burung	0.6	0.4	0.7	130.3	1.5	1.6	0.9	0.3	0.1	1.8	2.4	1.1	141.7
14	Dolphin fish	Lemadang	1.4	0.4	0.5	0.8	2.4	2.4	25.4	31.6	6.2	14.6	35.1	12.5	133.3
15	Sardine	Lemuru	0.0	0.0	0.0	0.2	0.7	0.1	10.8	2.3	3.0	16.0	55.2	2.9	91.2
16	Black pomfret	Setuhuk hitan	5.9	3.2	9.1	8.7	6.1	2.3	2.4	2.1	4.2	8.6	3.8	3.1	59.5
17	Cobia	Gabus laut	2.0	1.5	1.9	2.0	1.8	1.2	0.0	0.8	2.1	3.1	3.3	1.5	21.2
18	Red snapper	Kakap merah	0.5	0.6	0.7	1.6	0.6	1.6	0.8	0.3	0.2	0.4	0.5	0.4	8.2
19	Hairtail	Layur	0.0	0.0	0.0	0.0	0.0	0.0	0.0	0.0	0.0	0.0	0.0	0.0	0.0
20	Other	Lainnya	104.9	175.7	89.7	109.9	322.0	247.3	143.8	262.2	104.0	187.2	383.1	84.9	2,214.7
Total			2,110.0	2,438.0	2,438.0	2,880.0	4,509.0	3,372.0	5,084.0	4,485.0	3,680.0	4,465.0	5,015.0	3,824.0	44,300.0

Source of data: Statistical Report JFP, KKP, 2010

2.6 FISH LANDED IN JFP AND MARKETED THROUGH PPI in 2009

No.	Species of fish		Month(2009)												Total
	English name	Indonesian name	1	2	3	4	5	6	7	8	9	10	11	12	
1	Skip jack	Cakalang	191.9	198.9	269.7	294.8	424.7	290.2	530.9	470.8	404.0	536.2	437.8	436.5	4,486.4
2	Longtail/little tuna	Tongkol	211.2	163.9	138.8	103.7	70.0	48.9	308.5	285.2	267.8	427.6	518.0	527.0	3,070.4
3	Yellow fin tuna	Madidihang	15.6	20.1	19.2	23.1	42.5	40.6	29.3	46.7	19.2	34.1	16.6	13.8	320.8
4	Bigeye tuna	Tuna mata besar	6.8	7.4	6.7	9.7	18.9	12.9	11.1	12.4	11.9	12.0	9.0	4.0	122.7
5	Spanish mackerel	Tenggiri	27.5	24.9	27.3	18.2	39.9	28.4	49.8	35.1	29.1	23.8	46.1	56.1	406.1
6	Sword fish	Ikan pedang	5.3	14.1	6.8	0.0	25.3	17.8	19.3	9.7	10.8	0.0	3.7	1.5	114.4
7	Sail fish	Ikan layaran	21.4	44.2	28.4	36.1	79.4	47.6	47.9	40.5	16.0	12.2	51.9	14.3	439.9
8	Shark	Cucut botol	2.9	5.0	2.8	9.0	8.5	7.3	5.6	4.9	1.5	0.3	4.7	0.5	53.1
9	Albacore	Albakora	6.6	19.4	11.3	14.3	35.5	22.8	8.2	7.9	1.9	0.0	29.1	2.3	159.3
10	Squid	Cumi-cumi	0.0	0.0	0.0	0.0	4.4	29.0	170.2	16.5	169.3	1.9	161.9	7.0	560.3
11	Black marlin	Bawal hitam	7.0	6.5	5.5	23.2	30.3	42.3	47.8	15.1	1.5	0.0	11.0	1.2	191.2
12	Giant catfish	Manyung	3.8	5.6	9.3	6.9	4.7	8.5	13.1	6.5	8.9	7.2	44.6	8.1	127.1
13	Rays	Pari burung	0.1	0.0	0.1	13.0	0.2	0.2	0.1	0.0	0.0	0.2	0.2	0.1	14.2
14	Dolphin fish	Lemadang	0.6	0.2	0.2	0.3	1.0	1.0	10.2	12.6	2.5	5.8	14.0	5.0	53.3
15	Sardine	Lemuru	0.0	0.0	0.0	0.1	0.3	0.0	4.9	1.0	1.4	7.2	24.8	1.3	41.0
16	Black pomfret	Setuhuk hitan	4.1	2.2	6.4	6.1	4.3	1.6	1.7	1.5	2.9	6.0	2.7	2.2	41.7
17	Cobia	Gabus laut	1.8	1.4	1.7	1.8	1.6	1.1	0.0	0.7	1.9	2.8	3.0	1.4	19.1
18	Red snapper	Kakap merah	0.3	0.3	0.4	0.9	0.3	0.9	0.4	0.2	0.1	0.2	0.3	0.2	4.5
19	Other	Layur	31.5	52.7	26.9	33.0	96.6	74.2	43.1	78.7	31.2	56.2	114.9	25.5	664.4
	Total	Lainnya	538.3	566.8	561.5	594.2	888.4	674.9	1,302.0	1,046.0	982.0	1,133.5	1,494.4	1,107.9	10,889.8
Source of data: Statistical Report 2009, UPT, JFP, KKP, estimated by UPT, JFP															

2.7 VOLUME OF FISH TRANSPORTED OVERLAND TO JFP in 2009

No.	Species of fish		2009												Total
	English name	Indonesian name	1	2	3	4	5	6	7	8	9	10	11	12	
1	Indian mackerel	Banyar/Kembung perempuan	960.2	1,426.3	2,115.5	1,269.8	1,191.5	1,914.3	1,187.3	1,235.9	1,119.7	1,378.6	1,039.7	1,163.5	16,002.3
2	Milk fish	Bandeng	1,475.4	1,034.0	848.0	1,029.9	1,292.9	1,327.6	1,066.6	766.7	733.8	662.7	867.2	895.3	12,000.1
3	Indian scad	Layang/Benggol	700.1	799.6	1,348.0	1,131.8	814.3	1,524.9	1,114.3	713.7	734.3	944.1	868.1	861.2	11,554.4
4	Fresh water fish	Ikkan air tawar	29.3	916.1	1,072.9	1,095.2	1,193.0	1,173.2	1,105.2	1,182.8	636.5	1,110.9	931.0	906.9	11,353.0
5	Longtail tuna / Little tuna	Tongkol abu-abu	293.4	443.5	518.8	317.9	449.7	879.7	848.8	854.2	650.6	1,026.1	701.9	1,097.1	8,081.7
6	Skip jack	Cakalang	323.0	297.3	564.4	584.9	551.1	865.8	781.2	919.0	360.9	922.6	675.9	848.2	7,694.3
7	Shrimp	Udang jerbung/U.putih	527.2	648.3	618.6	570.0	662.5	781.1	758.3	625.5	357.5	446.3	452.0	477.0	6,924.3
8	Yellow fin/bigeye tuna	Madidihang /Tuna mata besar	191.1	314.9	397.5	248.2	404.5	899.1	558.8	476.9	231.8	443.0	245.2	256.9	4,667.9
9	Squid	Cumi	111.3	140.7	260.0	292.3	150.0	202.7	124.4	67.9	90.0	56.4	55.4	101.1	1,652.2
10	Sardine	Lemuru	119.3	287.2	61.0	85.2	114.2	97.6	98.2	57.4	7.0	251.2	99.8	213.4	1,491.5
11	Pomfret	Bawal hitam	792.4	30.1	71.1	55.0	70.1	68.6	47.3	33.2	30.5	24.8	40.6	51.9	1,315.6
12	Spanish mackerel	Tenggiri	43.4	30.8	94.8	100.0	60.1	100.6	100.5	136.8	81.7	58.5	55.5	108.6	971.3
13	Trevally jack	Selar kuning	129.5	121.6	217.4	153.5	148.2	111.4	0.8	6.8	8.7	5.4	0.0	0.0	903.3
14	Ray	Sebelah	0.3	0.0	0.1	0.0	0.0	0.1	99.8	90.4	51.7	98.5	107.8	115.9	564.6
15	Red snapper	Ikkan kakap merah	22.5	45.6	66.9	49.2	40.9	49.2	65.9	42.8	21.1	15.6	18.2	12.6	450.5
16	Shark	Cucut	10.8	30.6	39.6	52.6	64.3	25.4	52.5	5.9	46.2	29.0	9.2	48.5	414.6
17	Black marine	Setuhuk hitan / Maka	22.9	34.1	10.1	43.8	43.5	34.9	37.1	7.8	6.4	36.5	51.9	0.6	329.6
18	Hail tail	Layur	42.2	26.8	17.1	16.2	18.0	14.0	33.1	10.9	3.2	18.5	10.9	41.1	252.0
19	Thread fin bream	Kurisi	18.5	9.5	33.0	15.8	27.6	44.3	26.6	15.4	17.7	6.1	18.3	13.9	246.7
20	Sail fish	Ikkan layaran	7.1	8.7	7.5	14.2	9.3	41.0	4.0	11.4	2.9	27.2	17.2	31.2	181.7
21	Dolphin fish	Lemadang	8.8	21.8	23.8	22.0	20.0	4.2	18.9	1.4	0.2	1.8	6.6	9.9	139.4
22	Sword fish	Ikkan pedang	4.2	3.8	12.9	6.9	22.7	15.6	6.2	2.4	1.2	0.8	0.8	22.6	100.1
23	Others	Lainnya	225.7	137.0	168.0	111.0	172.6	89.3	236.9	136.9	89.0	92.6	171.7	180.4	1,811.1
Total			6,058.6	6,808.3	8,567.0	7,265.4	7,521.0	10,264.6	8,372.7	7,402.1	5,282.6	7,657.2	6,444.9	7,457.8	89,102.2
Source of Data: Statistical Report 2009, JFP, KKP															

2.8 VOLUME OF FISH TRANSPORTED OVERLAND AND MARKETED IN PPI/JFP in 2009

No.	Fish species		2009												Total
	English name	Indonesian name	1	2	3	4	5	6	7	8	9	10	11	12	
1	Indian mackerel	Banyar/Kembung perempuan	960.2	1,426.3	2,115.5	1,269.8	1,191.5	1,914.3	1,187.3	1,235.9	1,119.7	1,378.6	1,039.7	1,163.5	16,002.3
2	Indian scad	Layang/Benggol	700.1	799.6	1,348.0	1,131.8	814.3	1,524.9	1,114.3	713.7	734.3	944.1	868.1	861.2	11,554.4
3	Fresh water fish	Ikan air tawar	29.3	916.1	1,072.9	1,095.2	1,193.0	1,173.2	1,105.2	1,182.8	636.5	1,110.9	931.0	906.9	11,353.0
4	Milk fish	Bandeng	1,032.8	723.8	593.6	720.9	905.0	929.3	746.6	536.7	513.7	463.9	607.0	626.7	8,400.1
5	Longtail tuna / Little tuna	Tongkol	146.7	221.8	259.4	159.0	224.9	439.9	424.4	427.1	325.3	513.1	351.0	548.6	4,040.9
6	Squid	Cumi	111.3	140.7	260.0	292.3	150.0	202.7	124.4	67.9	90.0	56.4	55.4	101.1	1,652.2
7	Skip jack	Cakalang	64.6	59.5	112.9	117.0	110.2	173.2	156.2	183.8	72.2	184.5	135.2	169.6	1,538.9
8	Sardine	Lemuru	119.3	287.2	61.0	85.2	114.2	97.6	98.2	57.4	7.0	251.2	99.8	213.4	1,491.5
9	Pomfret	Bawal hitam	554.7	21.1	49.8	38.5	49.1	48.0	33.1	23.2	21.4	17.4	28.4	36.3	920.9
10	Others	Kurisi	112.9	68.5	84.0	55.5	86.3	44.7	118.5	68.5	44.5	46.3	85.9	90.2	905.6
11	Trevally jack	Selar kuning	129.5	121.6	217.4	153.5	148.2	111.4	0.8	6.8	8.7	5.4	0.0	0.0	903.3
12	Spanish mackerel	Tenggiri	26.0	18.5	56.9	60.0	36.1	60.4	60.3	82.1	49.0	35.1	33.3	65.2	582.8
13	Red snapper	Ikan kakap merah	12.4	25.1	36.8	27.1	22.5	27.1	36.2	23.5	11.6	8.6	10.0	6.9	247.8
14	Thread fin bream	Kurisi	18.5	9.5	33.0	15.8	27.6	44.3	26.6	15.4	17.7	6.1	18.3	13.9	246.7
15	Hail tail	Layur	12.7	8.0	5.1	4.9	5.4	4.2	9.9	3.3	1.0	5.6	3.3	12.3	75.6
16	Ray	Sebelah	0.0	0.0	0.0	0.0	0.0	0.0	10.0	9.0	5.2	9.9	10.8	11.6	56.5
17	Dolphin fish	Lemadang	3.5	8.7	9.5	8.8	8.0	1.7	7.6	0.6	0.1	0.7	2.6	4.0	55.8
18	Sail fish	Ikan layaran	2.1	2.6	2.3	4.3	2.8	12.3	1.2	3.4	0.9	8.2	5.2	9.4	54.5
19	Sword fish	Ikan pedang	2.1	1.9	6.5	3.5	11.4	7.8	3.1	1.2	0.6	0.4	0.4	11.3	50.1
20	Shark	Cucut	0.5	1.5	2.0	2.6	3.2	1.3	2.6	0.3	2.3	1.5	0.5	2.4	20.7
Total			4,039.2	4,861.9	6,326.5	5,245.5	5,103.6	6,818.1	5,266.5	4,642.6	3,661.5	5,047.6	4,285.8	4,854.5	60,153.3

Source of Data: Statistical Report 2009, UPT, JFP, KKP, estimated by UPT/JFP

2.9 FISH PROCESSING FACTORIES OPERATIONAL IN THE COMPLEX OF JFP

1. Industrial area (Block C-T)

No.	Block or area No	Name of company	Tuna			Other fish		Shrimp	Remarks
			Fresh	Frozen	Fillet	Fillet	Cold store	Other process	
1	C	PT. Panutan Minasaba					X		Fish meal
2	E	PT. Arta Mina tama			X	X			
3	F	PT. Lucky Samudera Pratama				X			Mainly Pomfret
4	G	PT. Indoboga Jaya Makmur					X		
5	G	Pt. Subindo Perintis					X		Fish bait
6	G	Pt. Karya Cipta Bayu			X	X			
7	G	Pt. Danau Matano Persado Raya			X			X	
8	H	Pt. Muara Manggalindo	X		X	X		X	Surimi, fish ball
9	I	Pt. First Marine Seafoods						X	Merged with Khom Food
10	J	Pt. Gabungan Era Mandiri			X	X	X		
11	J	Pt. Benua Agri Sejahtera					X		
12	J	Pt. Durian Sari Wangi					X		For rental
13	J	Pt. Bumi Agro Lestari			X				
14	J	Pt. Lautan Bahari Sejahtera I			X				
15	J	Pt. Intimas Surya			X	X			
16	K	Pt. Sembilian Timur Jaya					X		
17	K	Pt. Benua Agri Sejahtera II			X				Same owner with 14
18	K	Pt. Red Ribbon Indonesia						X	Incl. frog leg
19	K	Pt. Sinar Samudera Makmur			X				
20	K	Pt. Sinar Malalugis Makmul					X		
21	K	Pt. Tridaya Eramina Bahari			X				
22	K	Pt. Daya Mululu Karetindo		X					
23	K	Pt. Cilacap Samudera Fishing		X					
24	K	Pt. Tuna Pertama Rezeki			X				
25	L	Pt. Bonecom		X					
26	M	Pt. Halimas Sakti Mina Utama					X		
27	N	Pt. Lola Mina						X	
28	O	Pt. Graha Insan Sejahtera			X	X			Ex-Panggung
31	O	Pt. Kelautan Bahari Sejahtera					X		Ex-Bonecom
32	T	Pt. Bosco					X		

2. East Pier

No.	No of Block or area No	Name of company	Tuna			Other fish			Shrimp	Remarks
			Fresh	Frozen	Fillet	Fillet	Cold store	Other process	Frozen	
1	1	Pt. Segararindo Mina Manunggal	X	X	X					Fresh tuna fiellet
2	2	Pt. Tunamina Ind.	X							
3	3	Pt. KMC Indonesia						X		Frozen fish trade
4	4, 5, 6	Pt. Gabungan Era Mandiri		X						Frozen tuna storage for factory J-4
5	7	Pt. Intinas Surya					X			Frozen tuna & marlin
6	8	Pt. Kaslim					X			Frozen fish trading
7	9	Pt. Majusetia	X							12 boats owner in Cilacap
8	10	Pt. Hokkie Samudra Trijaya	X		X					Tuna fillet/loin for EU
9	11	Pt. Mega Jaya Fishindo	X	X	X		X			L.L. boat owner
10	12 A	Pt. Samudera Mina Persada	X							13 L.L.boat owner
11	14	Pt. Mulia Sejahtera Mandiri	X							8 L.L.boat owner
12	16	Pt. Kraminaba Bina Arta	X	X						50 L.L.boat owner, Tuna fresh, Marlin frozen
13	17 18	Pt. Anugerah Secojaya	X							40 L.L.boat owner
14	19	CV. Harapan Jaya Majo	X					X		9 L.L. boat & 7 squid boat owner
15	20	Pt. Tuna Permata Rejeki	X	X						Fillet for export & local markets
16	21	Pt. FC Sumbindo	X	X						12 L.L.boat owner
17	23	Pt. Global Twindo Perkasa	X	X						12 L.L.boat owner
18	24	Pt. Charlry Wijaya Tuna	X		X					17 L.L.boat owner
19	25	Pt. Mina Sakiti Indonesia	X	X						13 L.L.boat owner
20	26	Pt. Pt. Kencana Jaya Abadi	X	X	X					3 L.L.boat owner from Cilacap
21	27	Pt. Tri Jaya					X			Common fish for local market
22	28	Victorindo Adi Perdama	X							28 L.L. boat owner
23	29	Pt. Bina Abadi Mitra Sejahtera	X							Shared boat owner

3. Muara Baru Center

No.	No Block or area No	Name of company	Tuna			Other fish			Shrimp	Remarks
			Fresh	Frozen	Fillet	Fillet	Cold store	Other process	Frozen	
1	1	PT. Sukardi					X		Mainly skipjack	
2	2	PT. Jojo Tjahjadi					X			
3	-	Pt. Ruangan Pendingin Indonesia					X		New cold storage with 1,000 capa.	

4. West Pier (Ruangu Processing & Cold Storage)

No	Block No.	Name of company	Tuna			Other fish			Shrimp	Remarks
			Fresh	Frozen	Fillet	Fillet	Cold store	Other processing	HL, PUD,	
1	1	PT. Citra Dimensi Arthali						X	Fish ball	
2	2	PT. Inti Makmur					X			
3	3	PT. Lautan Niaga Jaya					X			
4	4	PT. Awindo International			X	X				
5	6-8,10	PT. Bina Wimatraco					X			
6	9	PT. Sudianto					X			
7	Block-A	Pt. Alam Jaya				X			Squid, snapper to market to restaurants	
8	Block-A	Pt. Golden Seahorse Indonesia					X		Purse-seiner owner, muroaji	
9	Block-B	Pt. Krya Cipta Mina Jaya							Closed in Mar. 2011	

5. Wholesale Fish Market (PPI) area

No	Name of company	Tuna			Other fish			Shrimp	Remarks
		Fresh	Frozen	Fillet	Fillet	Cold store	Other processing	HL, PUD,	
1	PT. Mitra Sukses Jaya					X			
2	PT. Sari Pacific					X			
3	PT. Sugi Sejahtera				X				For local market
4	PT. Setia Kawan Adi Pratama					X			
5	PT. Sumber Pahgan Serasi					X			
6	PT. Jawa Kota					X			
7	PT. Matahari Ujung Jaya					X			

Summary of fish processing factory by processing line

1. Cold storage:	28
2. Fresh tuna processing for export	19
3. Frozen tuna processing for export	12
4. Tuna filleting	19
5. Fish filleting for export and local market	10
6. Surimi processing	1
7. Fish meal processing	1
8. Shrim processing for export	3
9. Fish ball processing	2

Total number of factory 73
(some factories have multi business)

2.10 DECREE GOVERNING THE EQUIPMENS FOR FISH MARKET

Decree of Ministry of Marine Affairs and Fisheries Republic of Indonesia

No. KEP.01/2007

LAYING DOWN REQUIREMENTS QUALITY ASSURANCE AND SAFETY OF FISHERY PRODUCTS DURING PRODUCTION, PROCESSING AND DISTRIBUTION

Ministry of Marine Affairs and Fisheries

CHAPTER IV

FISH AUCTION CENTER

A. Requirements for Fish Auction Centers

Requirement for fish auction centers include:

1. Fish auction centers shall comply with the following requirement:
 - a. Well protected, the walls can be easily cleaned;
 - b. The floor are made from water proof materials, easily cleaned, and sanitized, and sufficient drainage and hygienic discharge system for liquid water;
 - c. Have in place sanitation facilities including has washing and toilets in a sufficient numbers. Facilities for washing have to be equipped with soaps and disposable tissues;
 - d. Have in place sufficient lighting facilities to facilitate inspection of fishery products;
 - e. Vehicles discharging smoke as well as the presence of animals which might pose hazards on the quality of fishery products have to be moved from the fish auction centers and groceries;
 - f. Shall be cleaned regularly at least after the auction is completed; all boxes and trays have to be cleaned and rinsed with clear freshwater or clean sea water;
 - g. Equipped with clear signs for no smoking, no spitting, no eating and drinking, situated in places which can be easily noted and visible;
 - h. Have in place sufficient facilities for clean freshwater or clean seawater supply;
 - i. Have in place special non-corrosive and water proof containers to store fishery products unfit for human consumption;
2. Fish auction centers shall comply with the hygiene requirements and apply cold-chain system;
3. Business operators in-charge for auction and central markets as well as other markets which frequently display fishery products, shall comply with the following requirement:
 - a. have in place cold storage facilities which can be locked to store fishery products as well containers to store fishery products unfit for human consumption and put in a marked place;
 - b. have in place special room dedicated for control of fishery products safety unit:

4. During display or storage of fishery products:
 - a. all equipment shall not be used for other purpose;
 - b. vehicle discharging smoke shall not be allowed to contaminate the rooms dedicated to store the equipments;
 - c. officials who have access to room for equipment storage are not allowed to bring animals;
 - d. such equipment should be accessible to Competent Authority
5. If chilling is not possible to be carried out on-board of fishing vessels, the catch has to be immediately iced and kept at a temperature of melting ice;
6. Fisheries business operators have to cooperate with Competent Authority to enable quality inspector officials to carry out inspection in accordance to the prevailing regulation;
7. Fish auction centers shall:
 - a. show to the competent authority their compliance with the requirements stipulated under point 1 to 6;
 - b. implement and prepare documentation on Good Handling Practices (GHdp);
 - c. ensure that such documents and records are maintained and regularly updated;
 - d. keep related documents and records in a certain time period.

LAMPIRAN 3

**Situasi Saat Ini dari Pasar Grosir
& Fasilitas Terkait Yang Ada**

APPENDIX 3. CURRENT SITUATION OF THE EXISTING WHOLESALE MARKET & RELATED FACILITIES

1. Present Situation of Damaged Floor of the Existing Wholesale Market

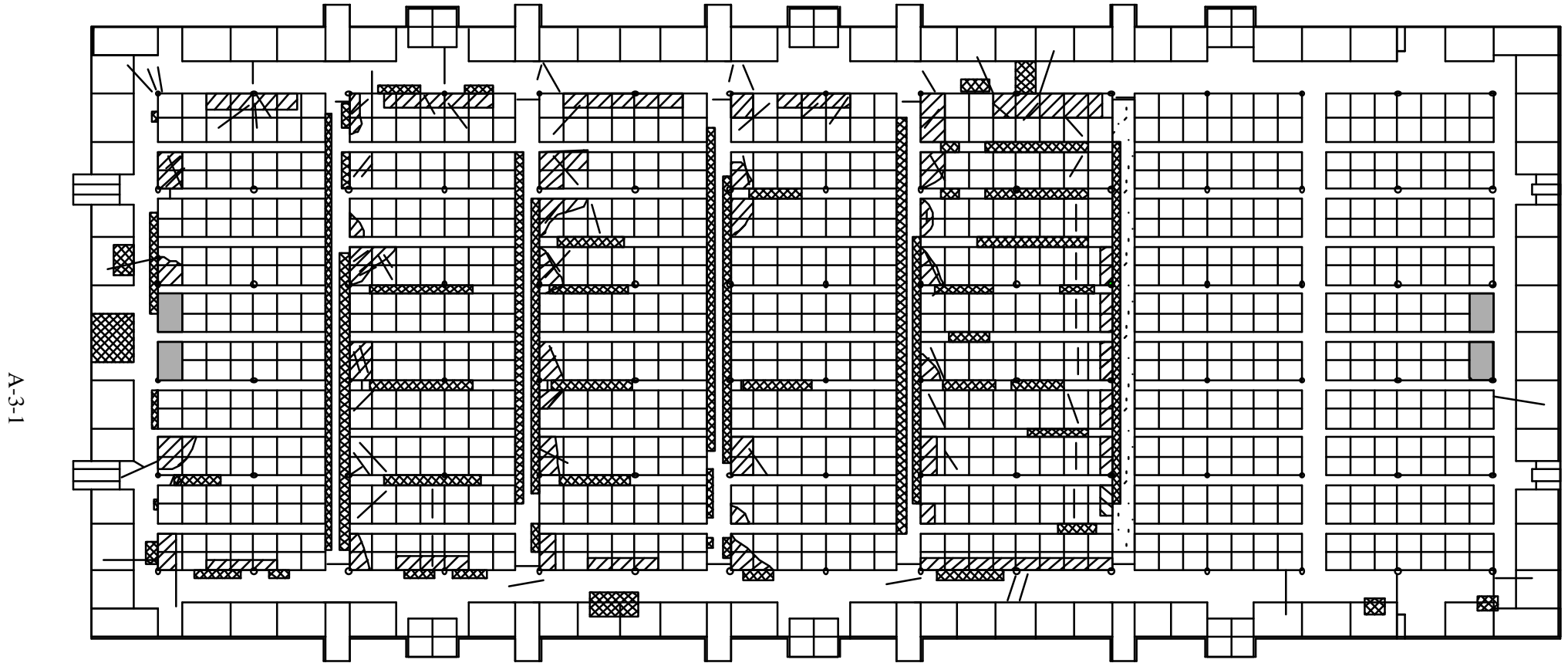

A-3-1

Legend

 Heavily Cracked & Floated Floor

 Heavily Sloped Floor

 Heavy Crack

 Stagnant Pool



2. Present Situation of Unintended Use of the Existing Wholesale Market

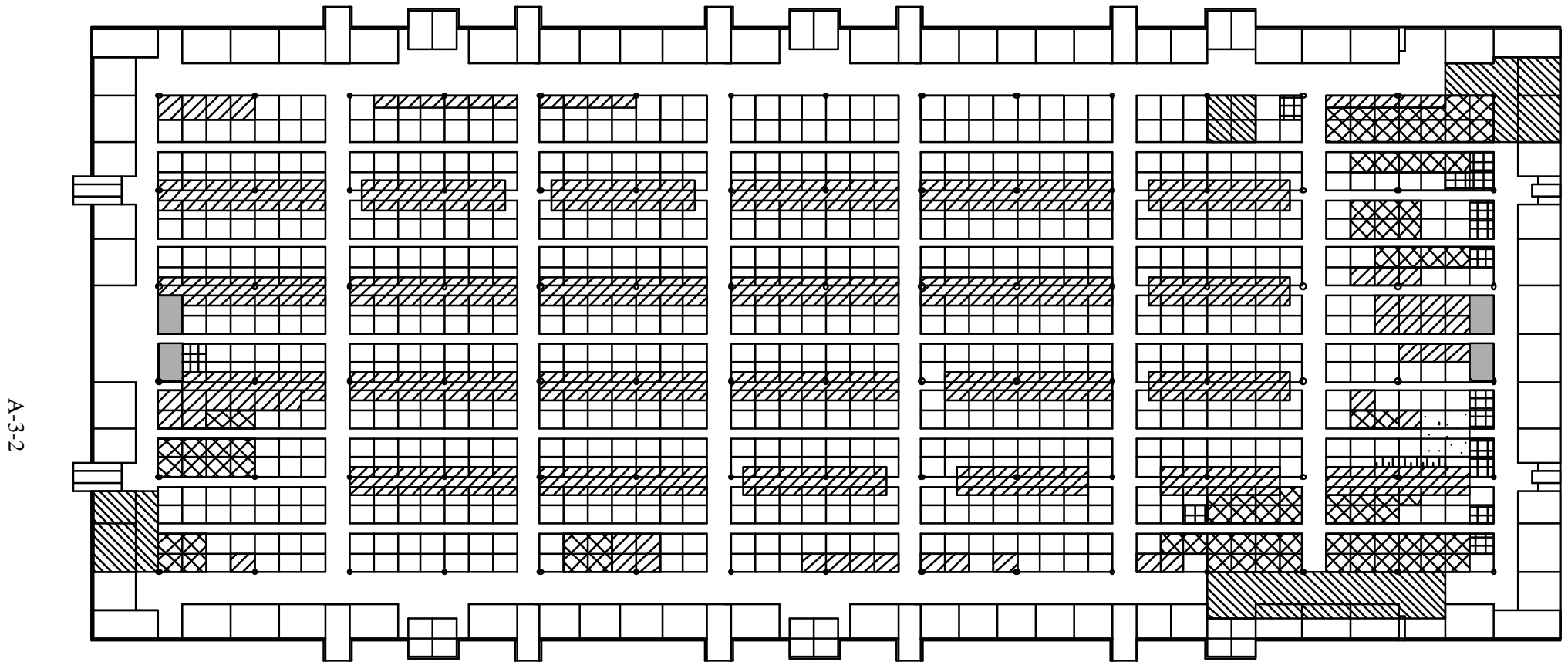

Legend

 Fish Processing Activities

 Storing Space for Fish Insulation Boxes

 Cereals or Solt

 Same as above but in the Daytime

 Food Stand

 Parking Space for Moter Bicycles



3. Present Use of the Existing Wholesale Market Related Facilities in the Existing Site

A-3-3

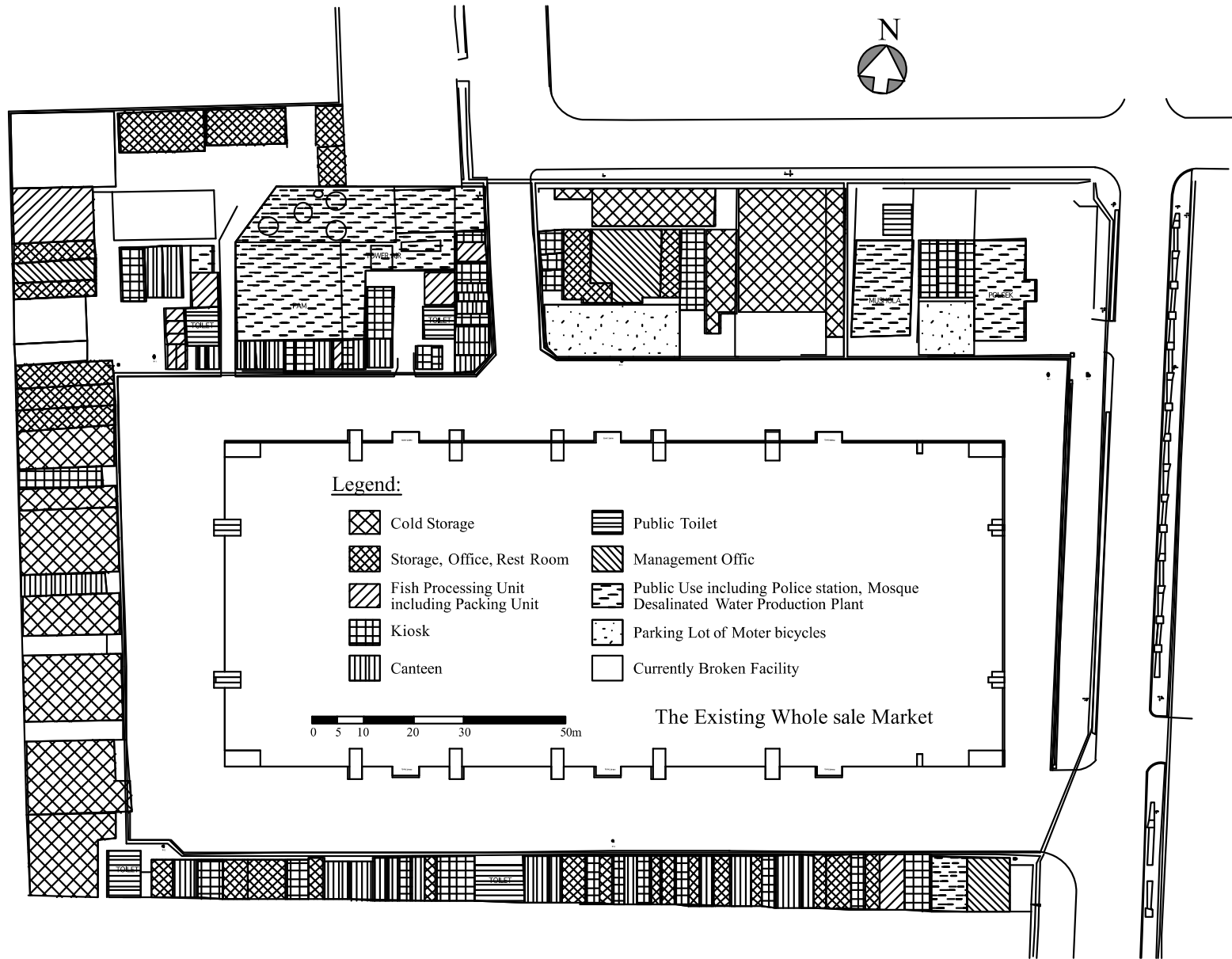

4. All-over layout plan in JFP

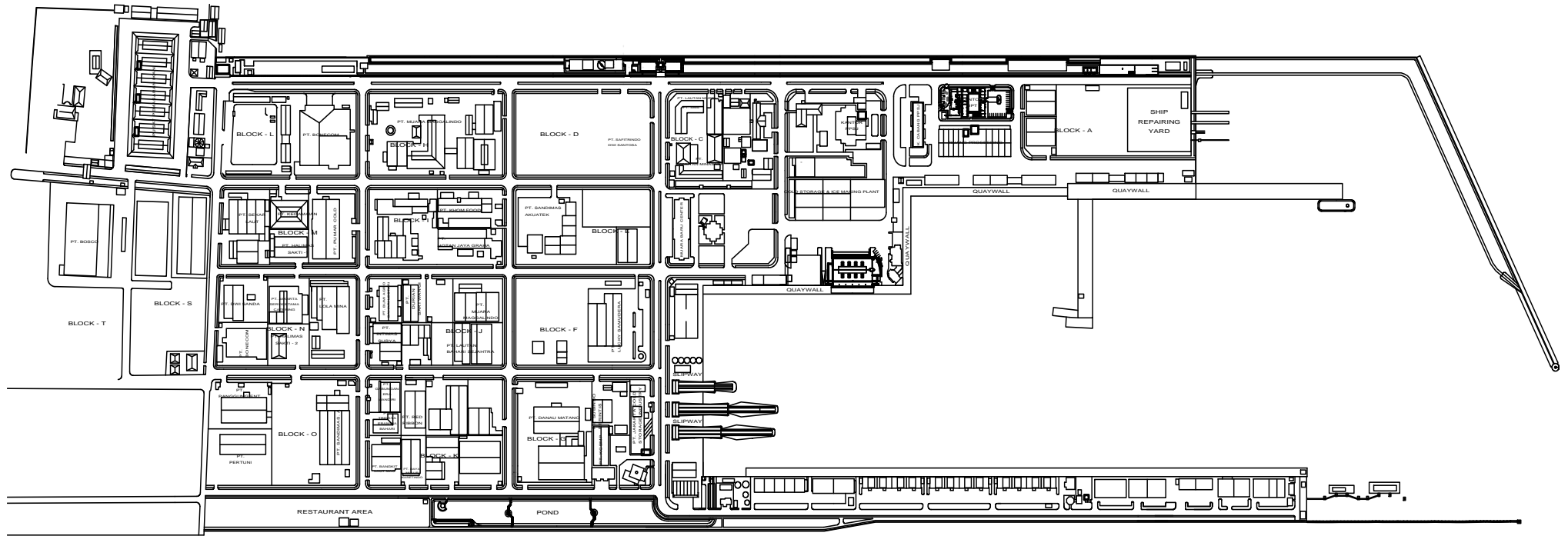

A-3-4

Layout plan of Jakarta Fishing Port

5. Location of Main Utility

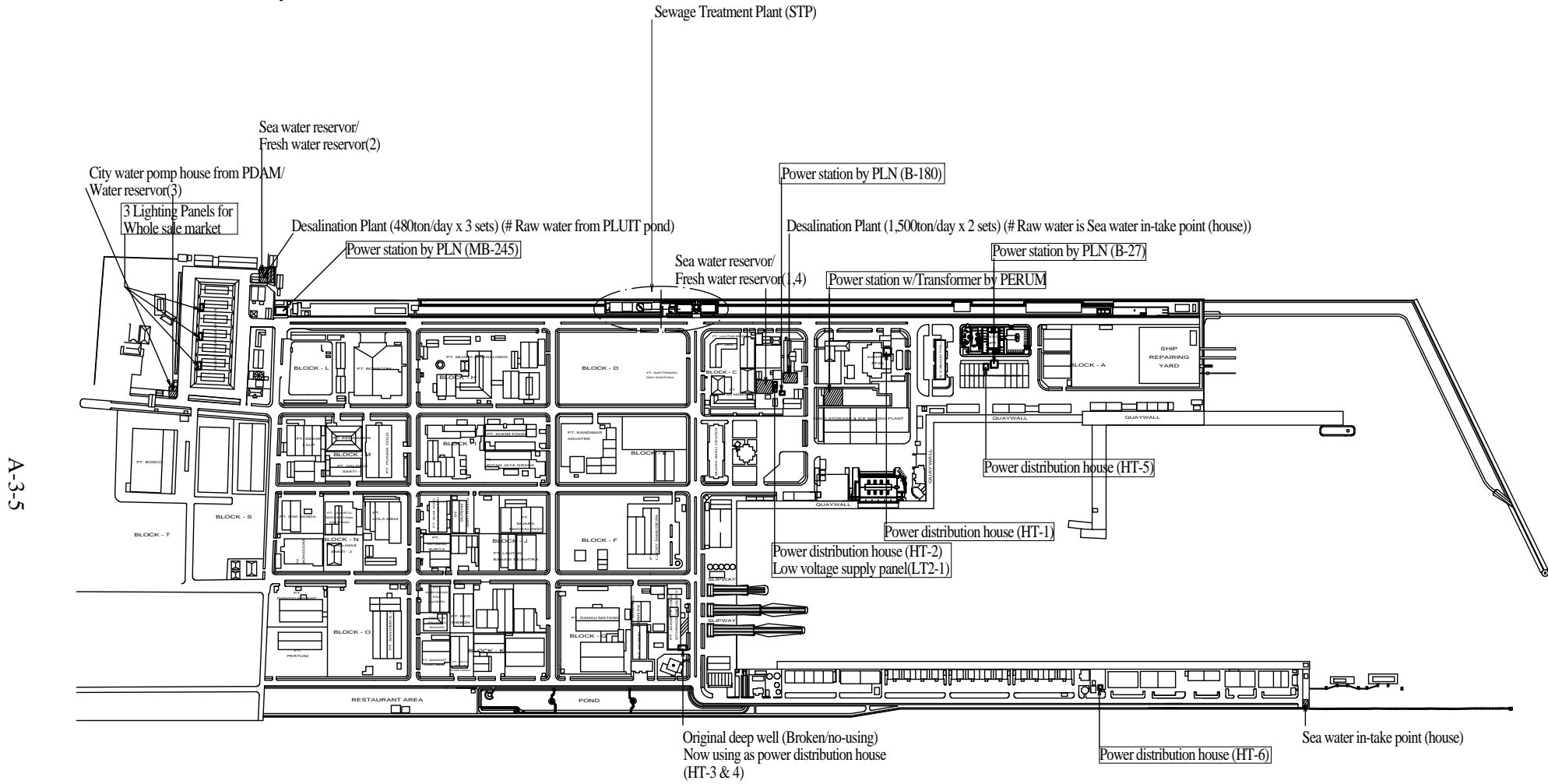

Location of Power houses and Water stations

6. Water supply plan in JFP

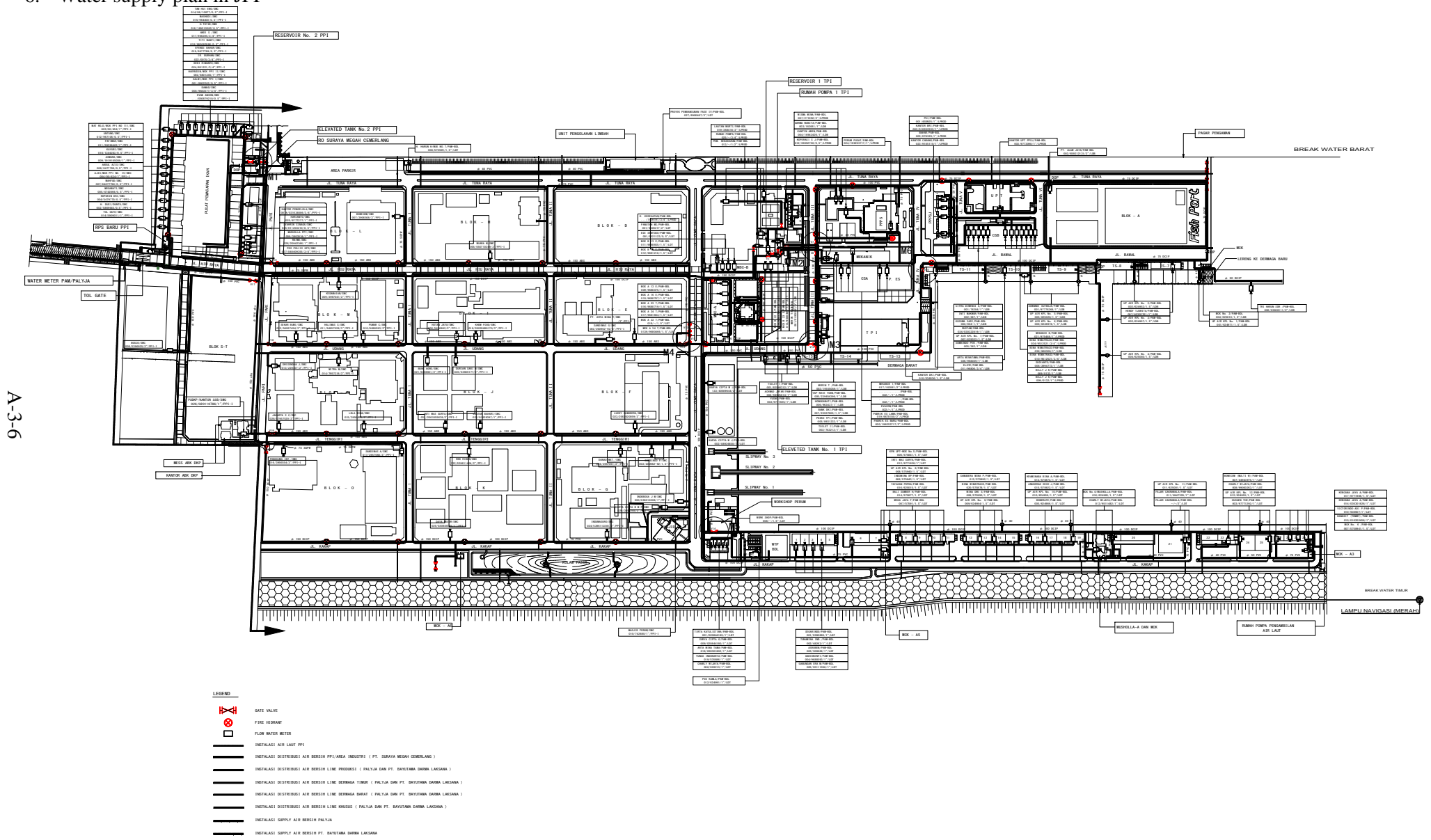

LAY OUT INSTALASI PIPA SUPPLY DAN PIPA DISTRIBUSI AIR BERSIH

A-3-6

7. Location of Fish company in JFP

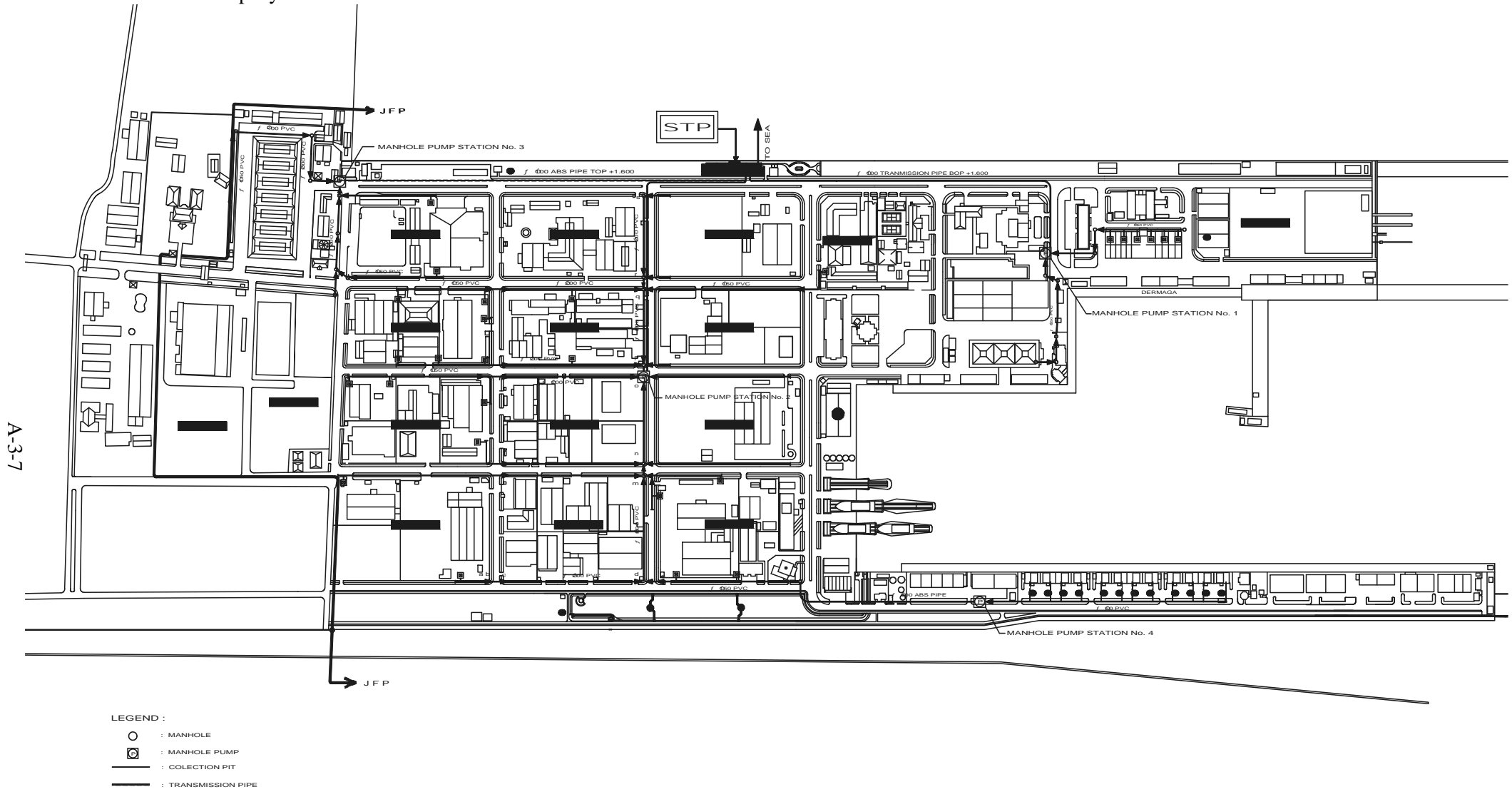

A-3-7



GENERAL PLAN OF SEWERAGE SYSTEM INSTALLATION
SCALE 1 : 5000

8. Existing Refrigeration Facilities

Approx. 135m

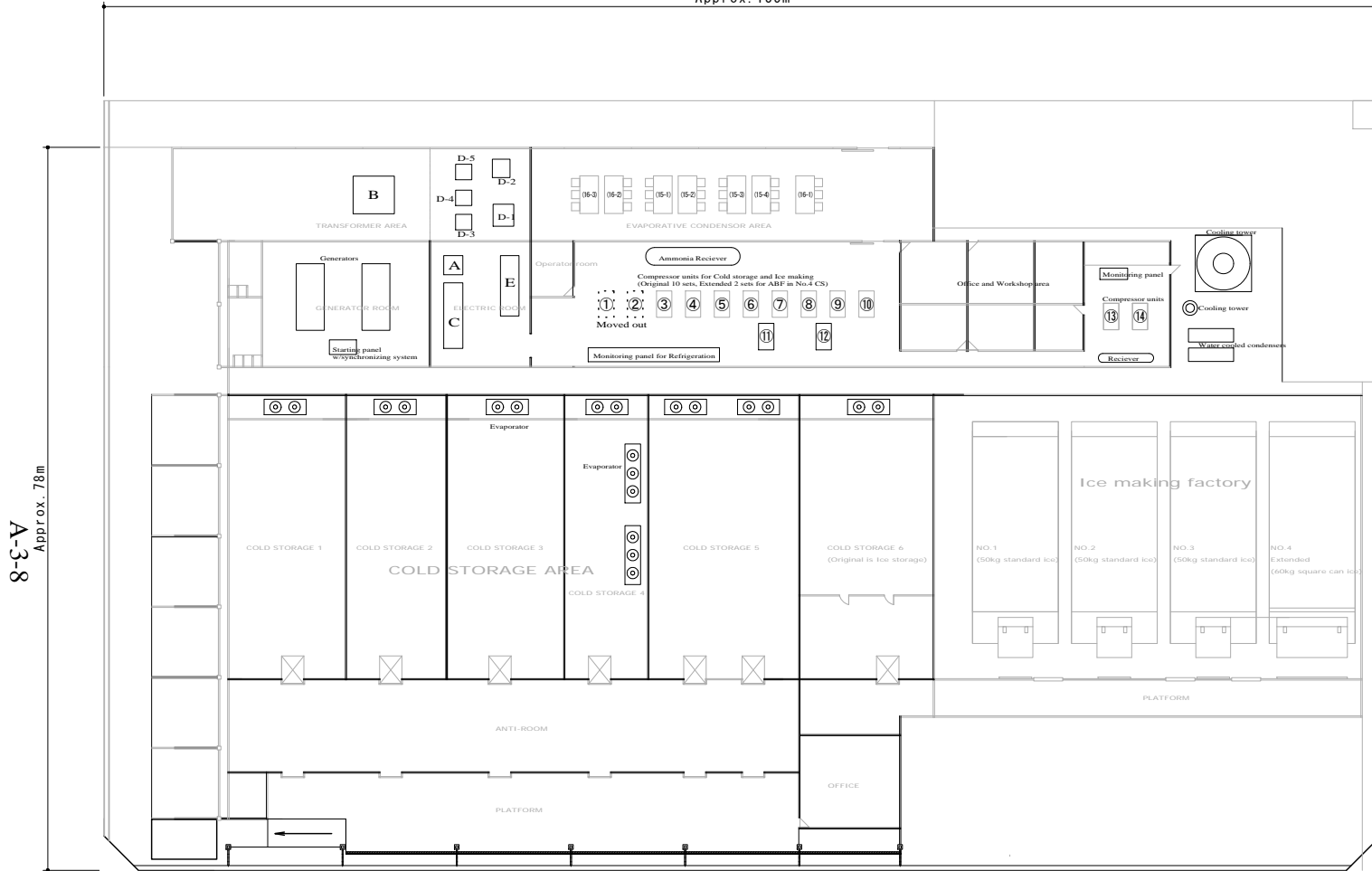

8-C-V
Approx. 78m

Sign	Item
A	High Voltage receiving panel from B180
B	High voltage transformer 20KV/6.6KV
C	Middle voltage distribution panel
D 1 - D 5	Middle voltage transformer 6.6KV/380,220V
E	Low voltage distribution panel
① - ⑤	Compressors for Cold storages, No.1-5
⑥	Compressoros for Cold storage No.6
⑦ - ⑩	Compressoros for Ice making No.1-3
⑪ - ⑫	Compressoros for Air blust freezer in No.4 C.S
⑬ - ⑭	Compressoros for Ice making No.4
(15-1)-(15-4)	Evaporated condensers (Original)
(16-1)-(16-3)	Evaporated condensers (Expanded)

ICE MAKING AND COLD STORAGE FACILTIES W/MACHINE ROOM

SCALE:1/500

9. Location of Cold storage facilities in Wholesale Market

A-3-9

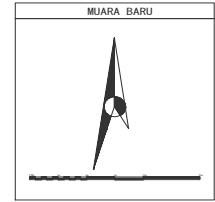
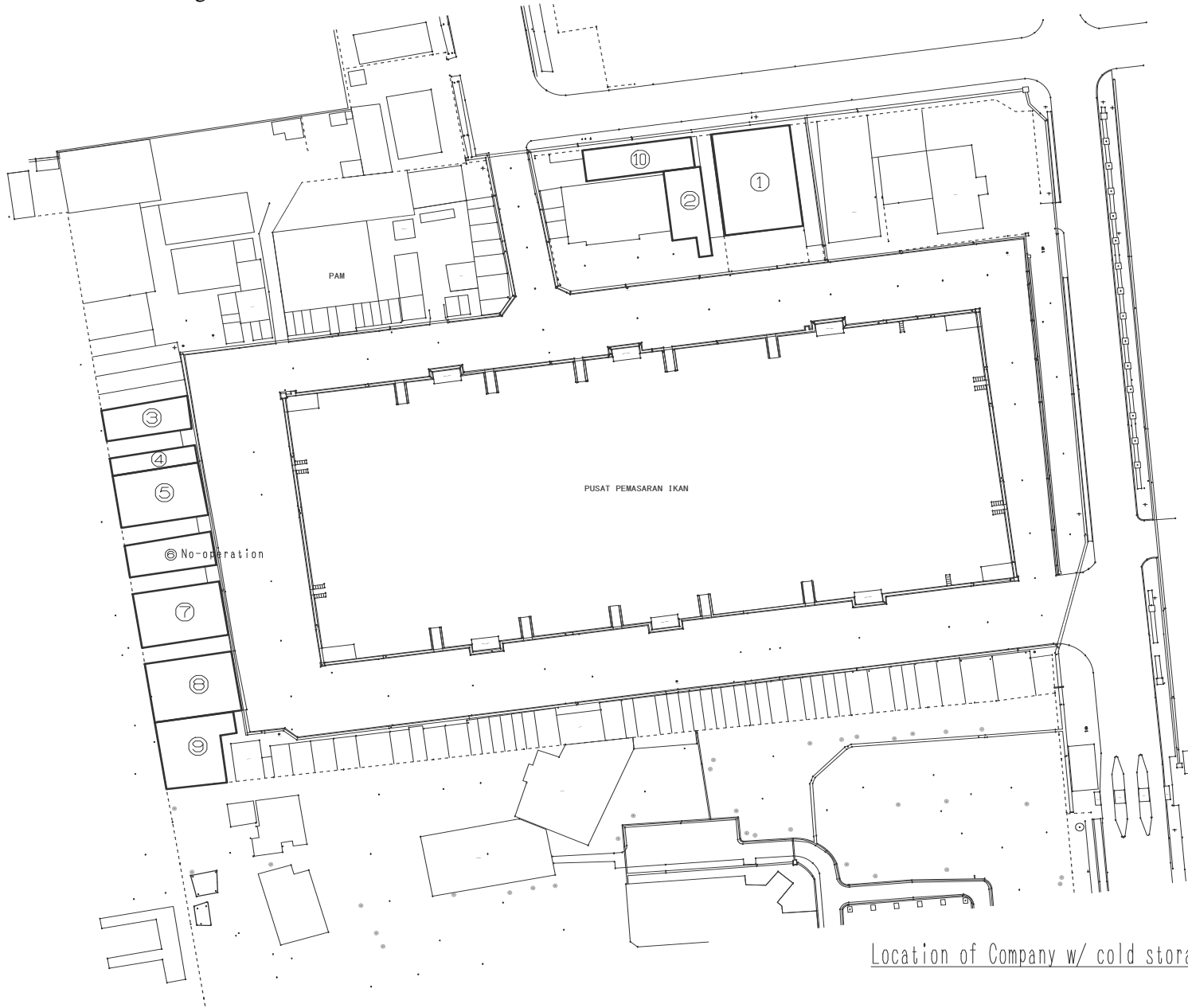

	Name of Company / Personnel
①	MITRA SUKSES JAYA (MR, WILLY)
②	SARI PACIFIC (Mr, HARYANTO)
③	Mr, AHU
④	SUGI SEJAHTERA (Mr, RAHMAN)
⑤	CHENG HONG
⑥	No-Operation
⑦	SUMBER PANGAN SERASI (MR, INDRA)
⑧	SUMBER PANGAN SERASI (MR, INDRA)
⑨	JAYA KOTA (MR, BUDI)
⑩	MATAHARI UJUNG JAYA (Mr, AHMAD JAFAR)

Location of Company w/ cold storage in Whole sale fish market

10. Location of Fish and Fish-related company in JFP

Location of Fish and Fish-related Company in JFP

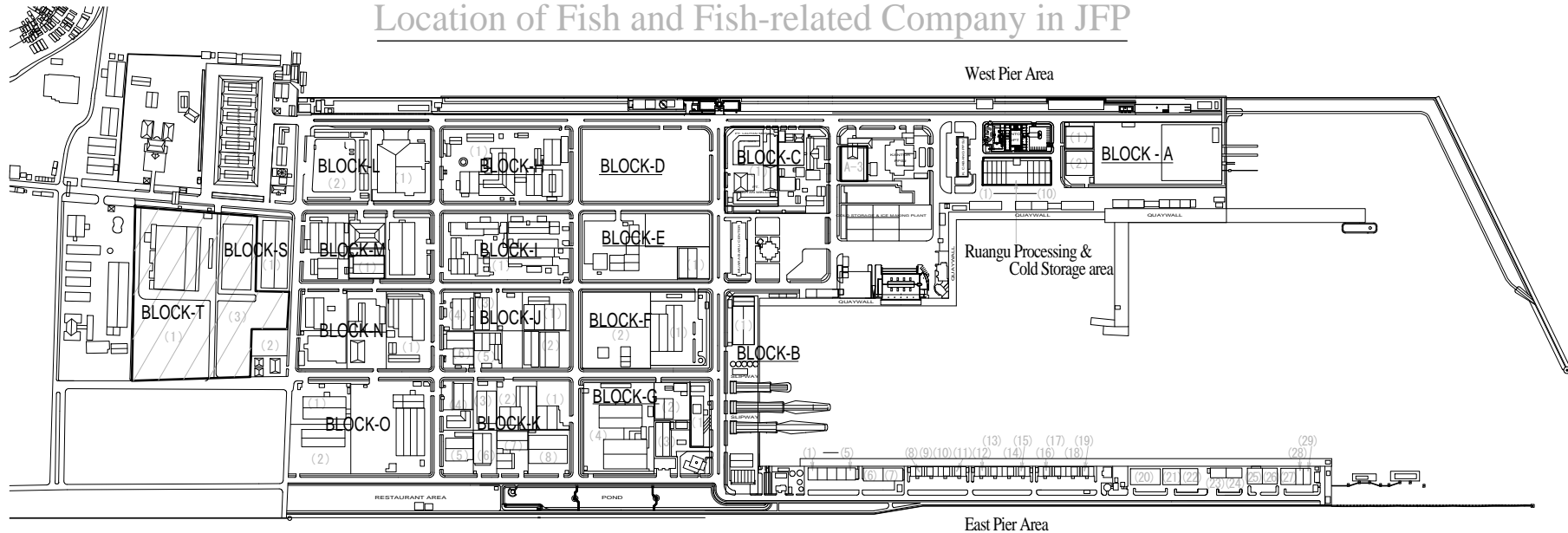

A-3-10

A) INDUSTRIAL AREA			B) EAST PIER AREA			C) WEST PIER AREA		
No. & Block/No	Name of Company	No. & Block/No	Name of Company	No. & House/No	Name of Company	No. & Block/No	Name of Company	
1 B	Closed already (Owner: PT. Krva Cipta Mina Jaya)	25 K 8	PT. Cilicap Samudera Fishing	1 1	PT. Segararindo Mina Manunggal	1 A-1	PT. Alam Jaya	
2 C 1	PT. Panutan Minasaba	26 K 9	PT. Tuna Pertama Rezeki	2 2	PT. Tunamina Indonesia	2 A-2	PT. Golden Seahorse Indonesia	
3 D	No-using space	27 L 1	PT. Bonecom	3 3	PT. KMC Indonesia	3 A-3	PT. Cold Warehouse	
4 E 1	PT. Arta Mina Tama	28 L 2	Under Construction (Owner: Bintani Mandiri Sampurna)	4 4, 5, 6	PT. Gabungan Era Mandiri	D) RUANGU PROCESSING & COLD STORAGE AREA		
5 F 1	PT. Lucky Samudera Pratama	29 M 1	PT. Halimas Sakti Mina Utama	5 7	PT. Intinas Surya			
6 G 1	PT. Indoboga Jaya Makmur	30 N 1	PT. Lola Mina	6 8	PT. Kaslim	1 1	PT. Citra Dimensi Arthali	
7 G 2	PT. Subindo Perintis	31 O 1	PT. Graha Insan Sejahtera	7 9	PT. Majusetia	2 2	PT. Inti Makmur	
8 G 3	Karya Cipta Bayu	32 O 2	PT. Kelautan Bahari Sejahtera	8 10	PT. Hokkie Samudra Trijaya	3 3	PT. Lautan Niaga Jaya	
9 G 4	PT. Danau Matano Presado Raya	33 S 1	PT. Sinar Malalugis Makmur	9 11	PT. Mega Jaya Fishindo	4 4	PT. Awindo International	
10 H 1	PT. Muara Mangga Lindo	34 S 2	Under Construction (Owner: Not-cleared)	10 12 A	PT. Samudera Mina Persada	5 5	Closed already (Owner: Not-cleared)	
11 I 1	PT. First Marine Seafoods	35 S 3	PT. Bosco	11 14	PT. Mulia Sejahtera Mandiri	6 6-8, 10	PT. Bina Wimatraco	
12 J 1	PT. Gabungan Era Mandiri	T 1		12 16	PT. Kraminaba Bina Arta	7 9	PT. Sudianto	
13 J 2	PT. Benua Agri Sejahtera			13 17, 18	PT. Anugerah Secojaya			
14 J 3	PT. Durian Sari Wangi			14 19	CV. Harapan Jaya Majo			
15 J 4	PT. Bumi Agro Lestari			15 20	PT. Tuna Permata Rezeki			
16 J 5	PT. Lautan Bahari Sejahtera I			16 21	PT. FC Sumbindo			
17 J 6	PT. Intimas Surya			17 22	Under Construction (Owner: Not-cleared)			
18 K 1	PT. Sembilian Timur Jaya			18 23	PT. Global Twindo Perkasa			
19 K 2	PT. Benua Agri Sejahtera II			19 24	PT. Charly Wijaya Tuna			
20 K 3	PT. Red Ribbon Indonesia			20 25	PT. Mina Sakiti Indonesia			
21 K 4	PT. Sinar Samudera Makmul			21 26	PT. Kencana Jaya Abadi			
22 K 5	PT. Sinar Maralugis Makmur			22 27	PT. Tri Jaya			
23 K 6	PT. Tridaya Eramina Bahari			23 28	Victorindo Adi Perdama			
24 K 7	PT. Daya Mululu Karetindo			24 29	PT. Bina Abadi Mitra Sejahtera			

11. Current Situation of Utilization of the Existing Wholesale Market



Food stands at parking area of wholesale market

1



Unloading of aqua culture fish from outside of Jakarta

2



Frozen Fish from JFP cold storage

3



Unloading space is utilized as parking area

8

INDEX

	F/D FISH DRUM		F/ED EMPTY DRUM FOR FISH
	F/T FISH TUB		F/ET EMPTY TUB FOR FISH (FLEED)
	F/B FISH BOX (INSULATED)		F/ET NOT OBVIOUS

	U/PU UNLOADING PICKUP OR ONE BOXCAR...ALMOST 2.5 TON
	U/T UNLOADING TRUCK...ALMOST 7.5 TON - 8 TON

- FOOD STAND
- ICE (LAD DOWN ON THE FLOOR, BUT COVERED BY CLOTH)
- ICE CRUSHER
- A/D WATER - DRUM (DRUM FOR WATER) O/A/ED EMPTY FOR FISH
- F/CS FISH FROM COLD STORAGE DIRECTLY
- PROCESSING WAS CARRIED OUT MAINLY BIG MARINE FISH
- FISH HANDLING AREA
- CLASSIFICATION OF FISH WITH TO FISH TUB
- WOODEN CART (4 WHEELED)
- FISH BASKET (PURCHASED FISH INSIDE)
- FISH BASKET (NOT YET PURCHASED)

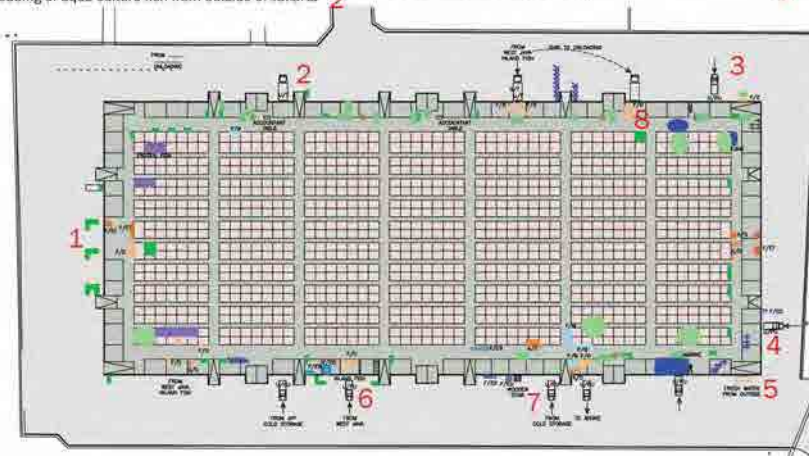

FIELD SURVEY - FOR UNLOADING ACTIVITIES
March 17 th. 16.30 p.m - 17.20 p.m



Ice Crusher

9



Frozen Fish from JFP cold storage

4



Empty drum, insulation box and others at loading and unloading space

7



Loading of fresh fish which is transported to Muara Angke

6



Fresh water from outside of JFP

5



Ice box depot at unloading space

1



Unloading of Fish from aqua culture in Cianjur

2



Unloading of fresh seawater fish from outside of Jakarta

3



Fish Processing at unloading space

4

INDEX

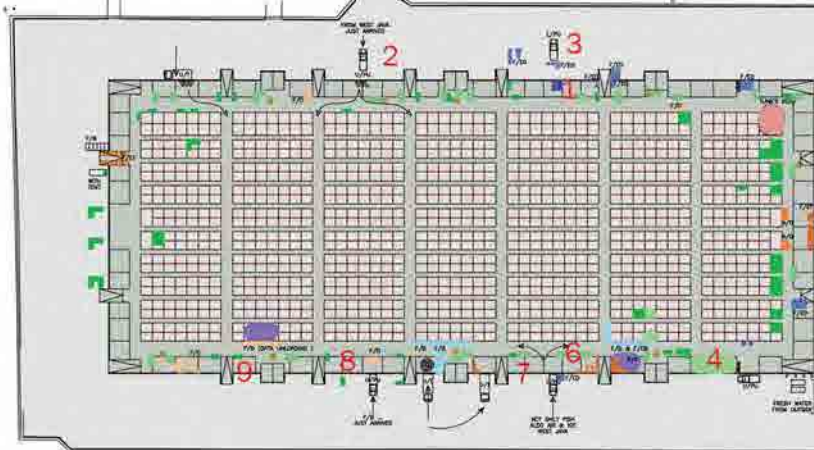
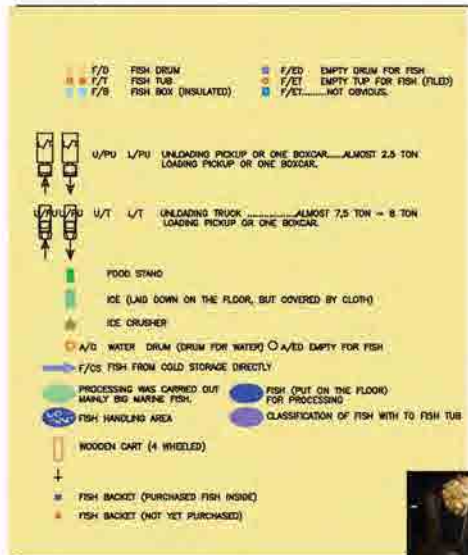

FIELD SURVEY - FOR UNLOADING ACTIVITIES
March 17 th. 17.30 p.m ~ 18.15 p.m



Empty drums for distribution of fresh water supply



Ice box depot at unloading space

6



Food Stands at unloading space

9



Food Stands at unloading space

8



Food stand occupied unloading space

7



2 Fish processing activity at unloading space



3 Seawater fish from outside of Jakarta is transported by truck



4 Unloading of inland fish from Cianjur (West Java)



5 Food stand at unloading space



1 Unloading of fresh seawater fish from outside of Jakarta



6 Fish processing at unloading space



7 Empty box drums return to the aqua culture

INDEX

F/D FISH DRUM	F/ED EMPTY DRUM FOR FISH
F/T FISH TUB	F/ET EMPTY TUB FOR FISH (FILED)
F/B FISH BOX (INSULATED)	F/ET.....NOT OBVIOUS.

U/PU UNLOADING PICKUP OR ONE BOXCAR.....ALMOST 2.8 TON LOADING PICKUP OR ONE BOXCAR.	
U/T UNLOADING TRUCK.....ALMOST 7.5 TON ~ 8 TON LOADING PICKUP OR ONE BOXCAR.	

- FOOD STAND
- ICE (LAD DOWN ON THE FLOOR, BUT COVERED BY CLOTH)
- ICE CRUSHER
- W/D WATER DRUM (DRUM FOR WATER) ○ A/ED EMPTY FOR FISH
- F/CS FISH FROM COLD STORAGE DIRECTLY
- PROCESSING WAS CARRIED OUT MAINLY BIG MARINE FISH.
- FISH HANDLING AREA
- WOODEN CART (4 WHEELED)
- FISH BACKET (PURCHASED FISH INSIDE)
- FISH BACKET (NOT YET PURCHASED)
- FISH (PUT ON THE FLOOR) FOR PROCESSING
- CLASSIFICATION OF FISH WITH TO FISH TUB

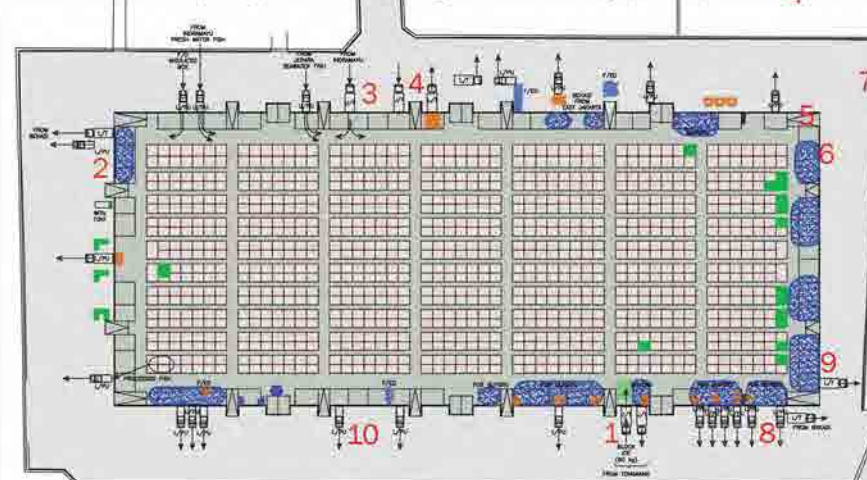

FIELD SURVEY - FOR UNLOADING ACTIVITIES
March 17 th. 18.30 p.m ~ 19.10 p.m



10 Frozen fish from JFP cold storage



9 The buyers was waiting for lowest fish price at unloading space



8 Frozen fish from JFP cold storage



1 Fish display on the insulation box



14 Utilization of fish compartment as a food stand



13 Utilization of fish compartment as a cold storage box



12 Fish display on the plastic basin



2 Main corridor also is used for fish display area

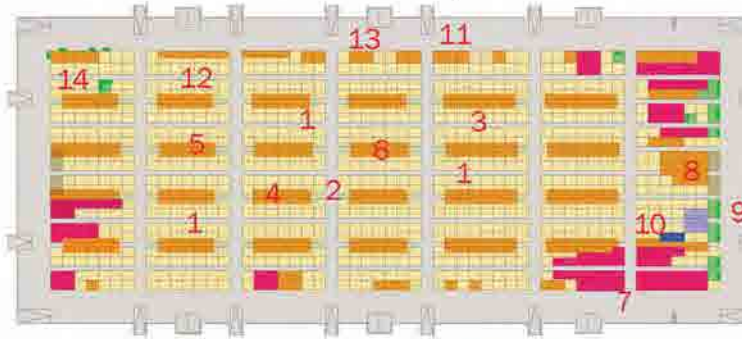

INDEX

Orange	Fish compartment	Green	Fish compartment
Red	Fish compartment	Dark Blue	Fish compartment
Light Blue	Fish compartment	Purple	Fish compartment

FIELD SURVEY - PRESENT CONDITION OF MARKET HALL



11 Utilization of compartment as a store of insulation box



3 Fish display on the plastic basin



10 Utilization of fish compartments as store of salt



9 Food stands on the compartments



4 The enclosed corridor cause of the utilization of corridor as store



5 The enclosed corridor cause of the utilization of corridor as store



6 The enclosed corridor cause of the utilization of corridor as store



7 Utilization of compartments as fish processing



8 Some compartments are used for store of plastic basins, insulation boxes, trolleys and others.