

**Basic Information**

Type	Year of Establishment	No. of Shifts	Distance from Main Road	Access Road	Declination	Size of Site	Remarks
4, 5	1971	2	500 (m)	Available	Flat	50 m × 30 m	

**Project Plan and Undertakings by the Ethiopian Side**

Construction Plan		Required Preparation Work by Ethiopian Side			
No. of Planned CRs	Library and its Capacity	Land Formation Work	Removal of the obstacles	Installation of Gate, Fence, Guard Room, etc	Electricity Installation from nearby bldg
4	150	-	Felling, removing roots and rocks	-	50m

**No. of Students and Sections**

	G9	G10	G11	G12	Total	Student/Section	Student/Classroom (CR)	No. of Teachers
Student	1,411	706	-	-	2,117	50	64	73
Section	28	14	-	-	42			

**Existing Facility**

No. of CRs			Library		Science Laboratories			Remarks
Total	No. of dilapidated/unusable CRs	No. of Usable CRs	No.	Capacity	Physics	Chemistry	Biology	Library rooms; main one and female students'.
33	0	33	2	Main: 70 Female: 20	1 (Temporary)	1 (Temporary)	1 (Temporary)	



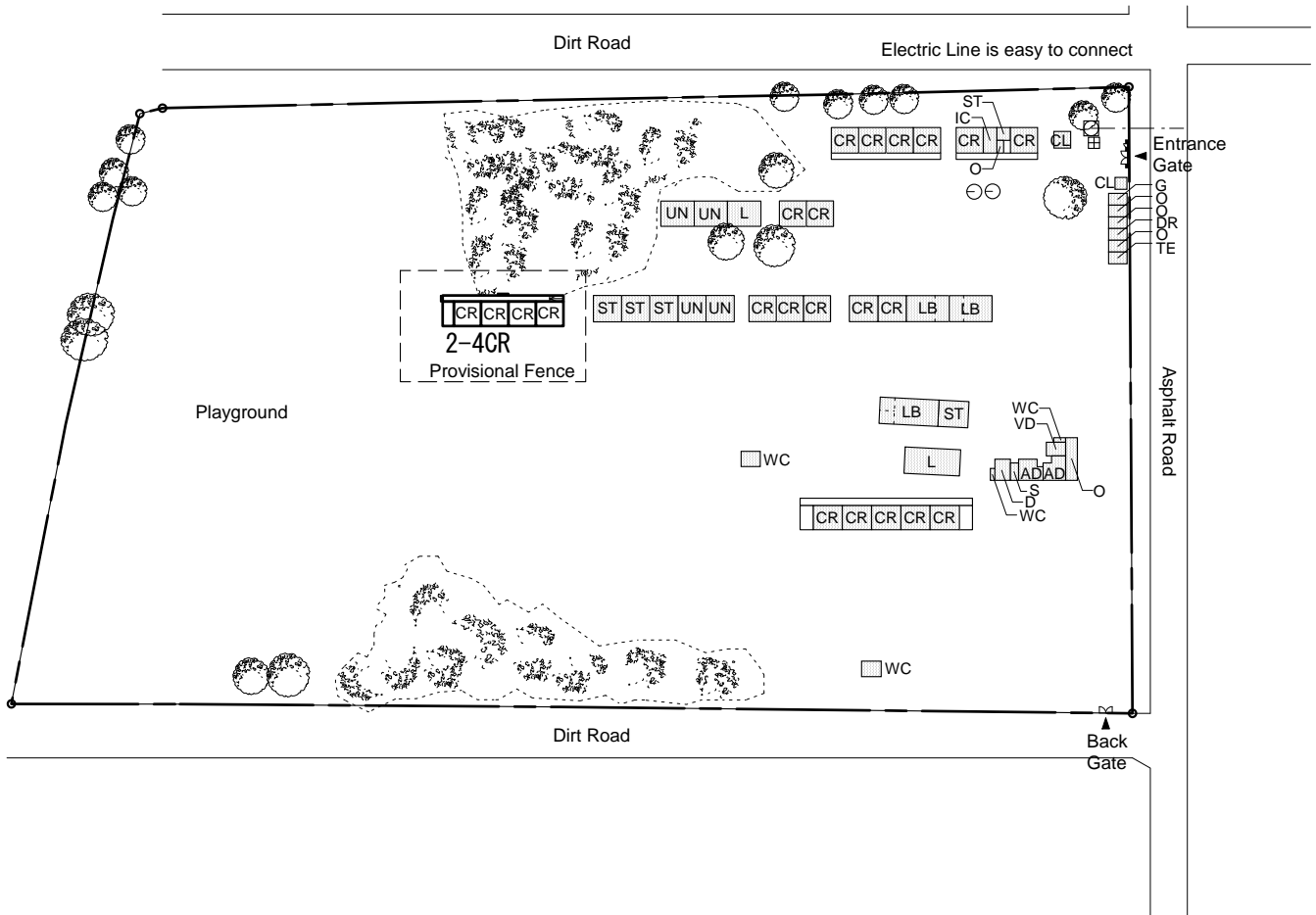

- Electric Line
- ⊠ Water Meter
- ⊙ Satellite Dish
- ⊞ Washbasin

- CR Class Room
- L Library
- LB Laboratory
- IC ICT Center
- IT IT Center
- R Resource Center
- D Director Room
- VD Vice Director Room
- S Secretary Room
- AD Administration Office
- AS Assembly Hall
- DR Department Room
- ST Store Room
- SA Satellite Receiver Room
- G Guardian Room
- TE Tea Room
- WC Toilet(Teacher, Boy, and Girl)
- O Others
- UN Unused Room

**Proposed Site Plan**

Scale 1:2000



**Basic Information**

Type	Year of Establishment	No. of Shifts	Distance from Main Road	Access Road	Declination	Size of Site	Remarks
4, 5	1934	2	Along the Main Street	Available	Slope	38 m × 20 m 40 m × 24 m	

**Project Plan and Undertakings by the Ethiopian Side**

Construction Plan		Required Preparation Work by the Ethiopian Side			
No. of Planned CRs	Library and its Capacity	Land Formation Work	Removal of the obstacles	Installation of Gate, Fence, Guard Room, etc	Electricity Installation from nearby bldg
4	300	400m3	Scrapping existing fence (50m) and building (50m2)	-	50m

**No. of Students and Sections (As of Nov. 2010)**

	G9	G10	G11	G12	Total	Student/Section	Student/Classroom (CR)	No. of Teachers
Student	1,675	1,682	-	-	3,357	70	120	78
Section	24	24	-	-	48			

**Existing Facility**

No. of CRs			Library		Science Laboratories			Remarks
Total	No. of dilapidated/ unusable CRs	No. of Usable CRs	No.	Capacity	Physics	Chemistry	Biology	Large number of CRs are dilapidated with high risk of collapse at any moment.
28	19	9	1	90	0	0	0	





- Electric Line
- Water Meter
- ⊙ Satellite Dish
- ⊞ washbasin

- CR Class Room
- L Library
- LB Laboratory
- IC ICT Center
- IT IT Center
- R Resource Center
- D Director Room
- VD Vice Director Room
- S Secretary Room
- AD Administration Office
- AS Assembly Hall
- DR Department Room
- ST Store Room
- SA Satellite Receiver Room
- G Guardian Room
- TE Tea Room
- WC Toilet(Teacher, Boy, and Girl)
- O Others
- UN Unused Room

**Proposed Site Plan**

Scale 1:2000



# GD-13

# Edgit Feleg Secondary School

## Basic Information

Type	Year of Establishment	No. of Shifts	Distance from Main Road	Access Road	Declination	Size of Site	Remarks
4, 5	1981	2	1.5 (km)	Available	Steep	45 m × 35 m	

## Project Plan and Undertakings by the Ethiopian Side

Construction Plan		Required Preparation Work by the Ethiopian Side			
No. of Planned CRs	Library and its Capacity	Land Formation Work	Removal of the obstacles	Installation of Gate, Fence, Guard Room, etc	Electricity Installation from nearby bldg
4	150	800m3	Felling and removing roots	-	50m

## No. of Students and Sections (As of Nov. 2010)

	G9	G10	G11	G12	Total	Student/Section	Student/Classroom (CR)	No. of Teachers
Student	1,460	559	-	-	2,019	59	119	66
Section	24	10	-	-	34			

## Existing Facility

No. of CRs			Library		Science Laboratories			Remarks
Total	No. of dilapidated/ unusable CRs	No. of Usable CRs	No.	Capacity	Physics	Chemistry	Biology	All labs: Normal CRs are used.
17	7	10	1 (Temporary)	50	1	1	1	

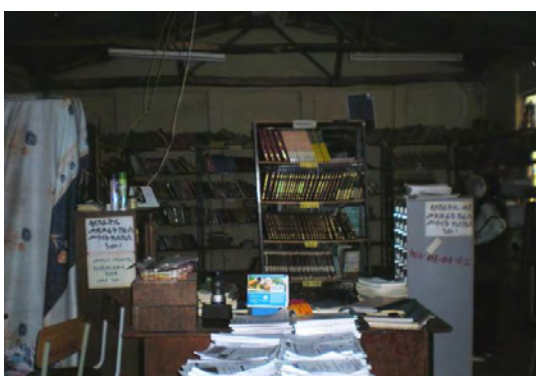

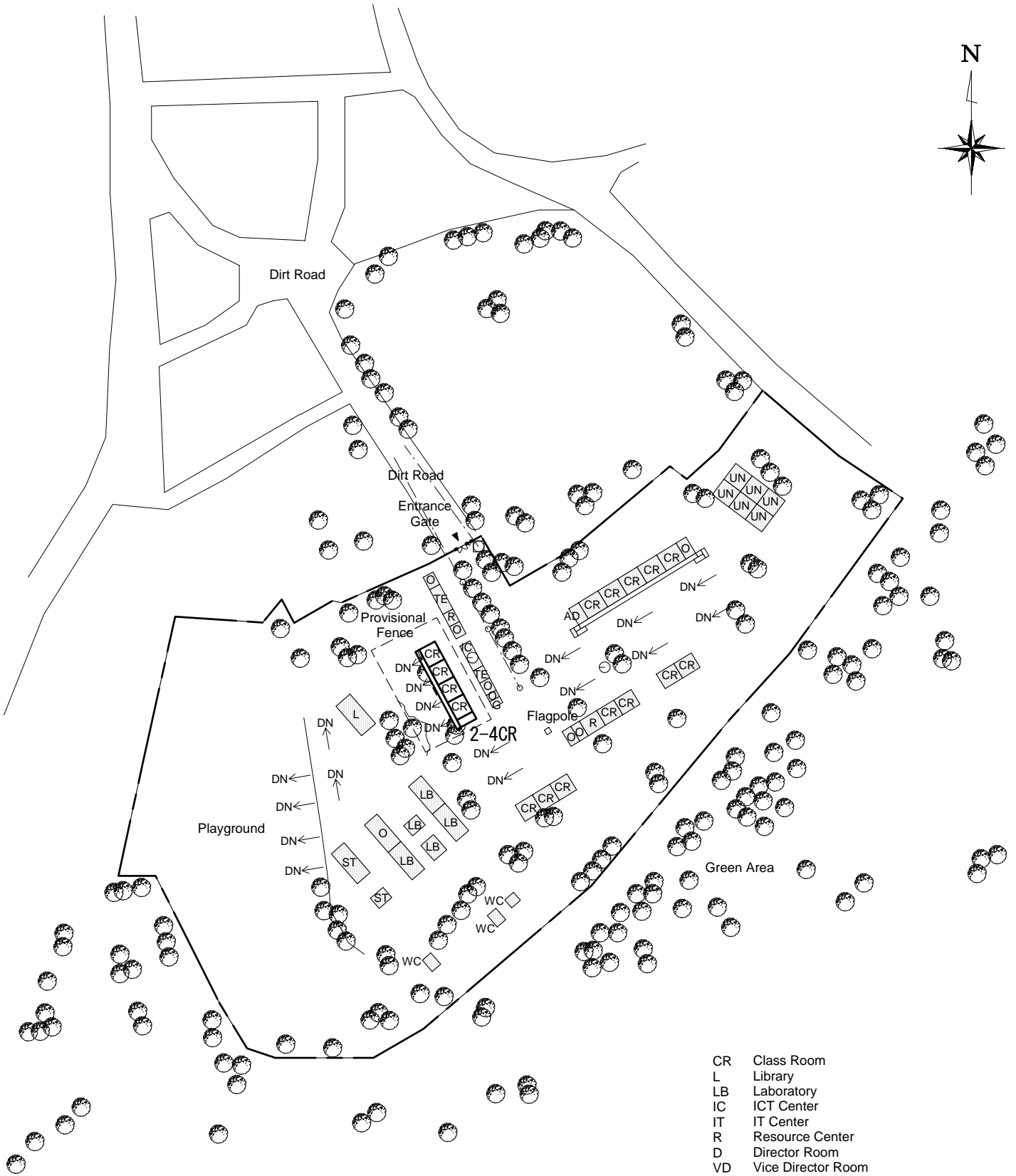
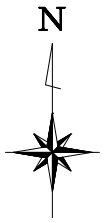

- — Electric Line
- — Water Meter
- ⊙ — Satellite Dish
- ▣ — Washbasin

**Proposed Site Plan**

Scale 1:2000



- CR Class Room
- L Library
- LB Laboratory
- IC ICT Center
- IT IT Center
- R Resource Center
- D Director Room
- VD Vice Director Room
- S Secretary Room
- AD Administration Office
- AS Assembly Hall
- DR Department Room
- ST Store Room
- SA Satellite Receiver Room
- G Guardian Room
- TE Tea Room
- WC Toilet(Teacher, Boy, and Girl)
- O Others
- UN Unused Room

# GD-14

# Azezo Secondary School

## Basic Information

Type	Year of Establishment	No. of Shifts	Distance from Main Road	Access Road	Declination	Size of Site	Remarks
4, 5	1974	G9-10: 2 G11-12: 1	500 (m)	Available	Flat	45 m × 35 m 45 m × 35 m	

## Project Plan and Undertakings by the Ethiopian Side

Construction Plan		Required Preparation Work by the Ethiopian Side			
No. of Planned CRs	Library and its Capacity	Land Formation Work	Removal of the obstacles	Installation of Gate, Fence, Guard Room, etc	Electricity Installation from nearby bldg
4	150	-	-	-	25m

## No. of Students and Sections (As of Nov. 2010)

	G9	G10	G11	G12	Total	Student/Section	Student/Classroom (CR)	No. of Teachers
Student	1,361	981	476	322	3,140	73	116	74
Section	18	12	8	5	43			

## Existing Facility

No. of CRs			Library		Science Laboratories			Remarks
Total	No. of dilapidated/ unusable CRs	No. of Usable CRs	No.	Capacity	Physics	Chemistry	Biology	Physics and Biology Labs: Normal CRs are used.
27	0	27	1	50	1	1	1	



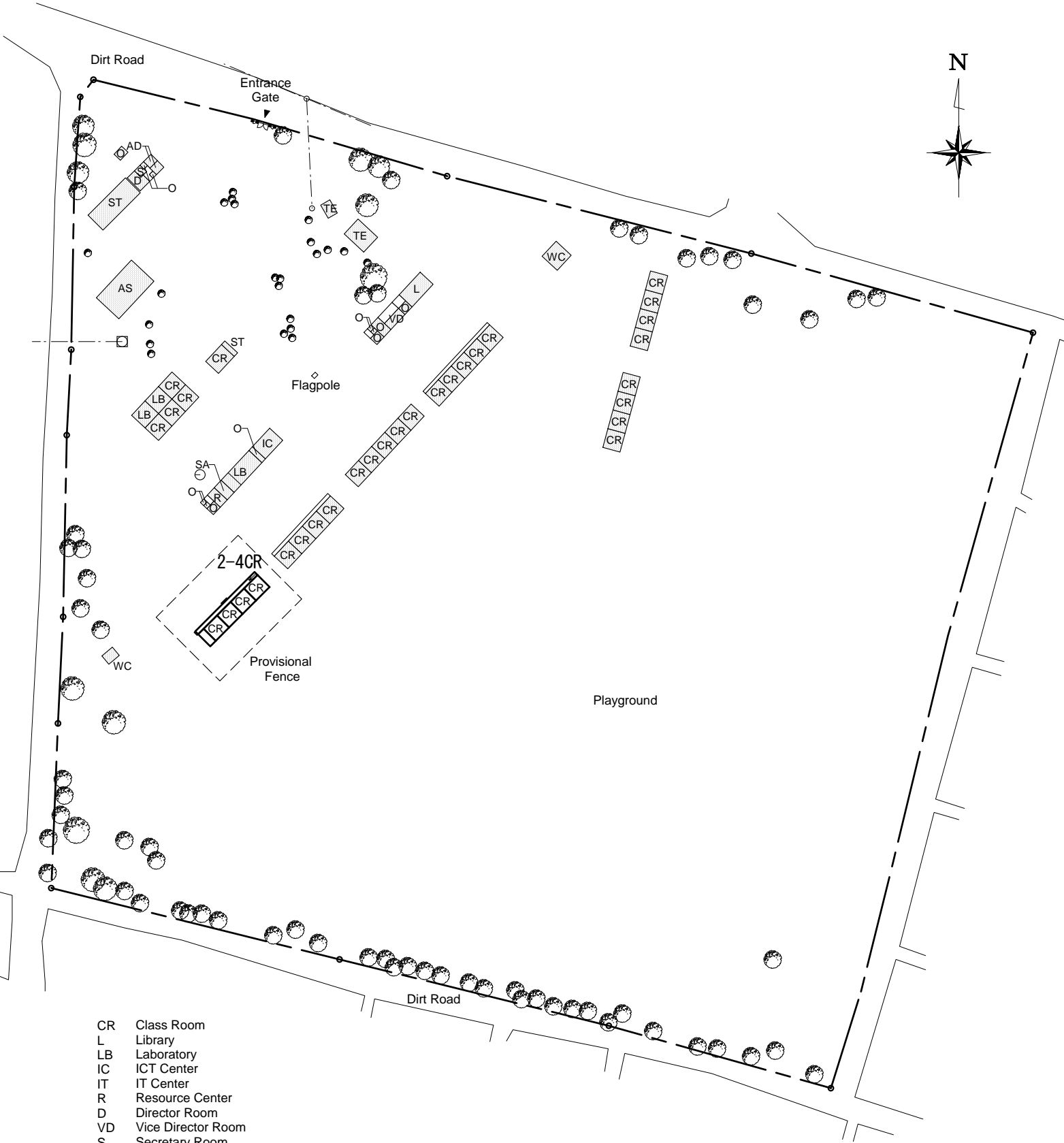

- CR Class Room
- L Library
- LB Laboratory
- IC ICT Center
- IT IT Center
- R Resource Center
- D Director Room
- VD Vice Director Room
- S Secretary Room
- AD Administration Office
- AS Assembly Hall
- DR Department Room
- ST Store Room
- SA Satellite Receiver Room
- G Guardian Room
- TE Tea Room
- WC Toilet(Teacher, Boy, and Girl)
- O Others
- UN Unused Room

- Electric Line
- Water Meter
- ⊙ Satellite Dish
- ⊞ Washbasin

**Proposed Site Plan**

Scale 1:2000





# DS-15

# Hottie Secondary School

## Basic Information

Type	Year of Establishment	No. of Shifts	Distance from Main Road	Access Road	Declination	Size of Site	Remarks
4, 5	1967	G9-10: 2 G11-12: 1	300 (m)	Available	Flat	45 m × 35 m	

## Project Plan and Undertakings by the Ethiopian Side

Construction Plan		Required Preparation Work by the Ethiopian Side			
No. of Planned CRs	Library and its Capacity	Land Formation Work	Removal of the obstacles	Installation of Gate, Fence, Guard Room, etc	Electricity Installation from nearby bldg
4	300	-	Scrapping the existing CR bldg (250m2), felling and removing roots	-	50m

## No. of Students and Sections (As of Nov.2010)

	G9	G10	G11	G12	Total	Student/Section	Student/Classroom (CR)	No. of Teachers
Student	1,646	915	531	375	3,467	51	58	G9-10: 95 G11-12:40
Section	30	18	10	10	68			

## Existing Facility

No. of CRs			Library		Science Laboratories			Remarks
Total	No. of dilapidated/ unusable CRs	No. of Usable CRs	No.	Capacity	Physics	Chemistry	Biology	
70 (39 out of 70 : temporary)	0	31	2 (Both temporary)	Main: 180 Female: 20	1	1	1	1. 2 libraries; main one and female students'. 2. All labs: Normal CRs are used.

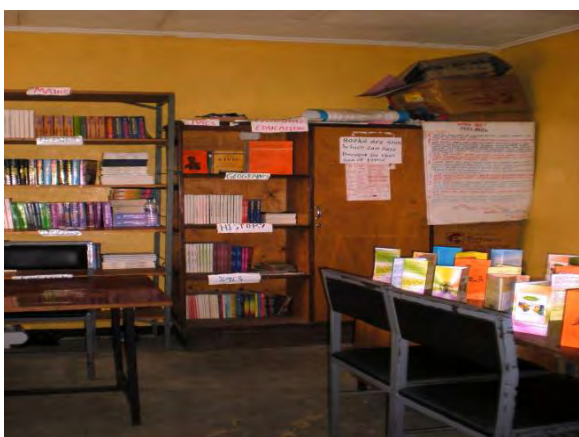



# DS-16

# Niguse Michael Secondary School

## Basic Information

Type	Year of Establishment	No. of Shifts	Distance from Main Road	Access Road	Declination	Size of Site	Remarks
4, 5	1929	2	200 (m)	Available	Slope	45 m × 30 m	

## Project Plan and Undertakings by the Ethiopian Side

Construction Plan		Required Preparation Work by the Ethiopian Side			
No. of Planned CRs	Library and its Capacity	Land Formation Work	Removal of the obstacles	Installation of Gate, Fence, Guard Room, etc	Electricity Installation from nearby bldg
4	150	1200 m3	Felling and removing roots	-	50m

## No. of Students and Sections (As of Nov.2010)

	G9	G10	G11	G12	Total	Student/Section	Student/Classroom (CR)	No. of Teachers
Student	1,382	775	-	-	2,157	55	77	72
Section	24	15	-	-	39			

## Existing Facility

No. of CRs			Library		Science Laboratories			Remarks
Total	No. of dilapidated/unusable CRs	No. of Usable CRs	No.	Capacity	Physics	Chemistry	Biology	
28	3	25	1 (Temporary)	54	1 (Temporary)	1 (Temporary)	1 (Temporary)	



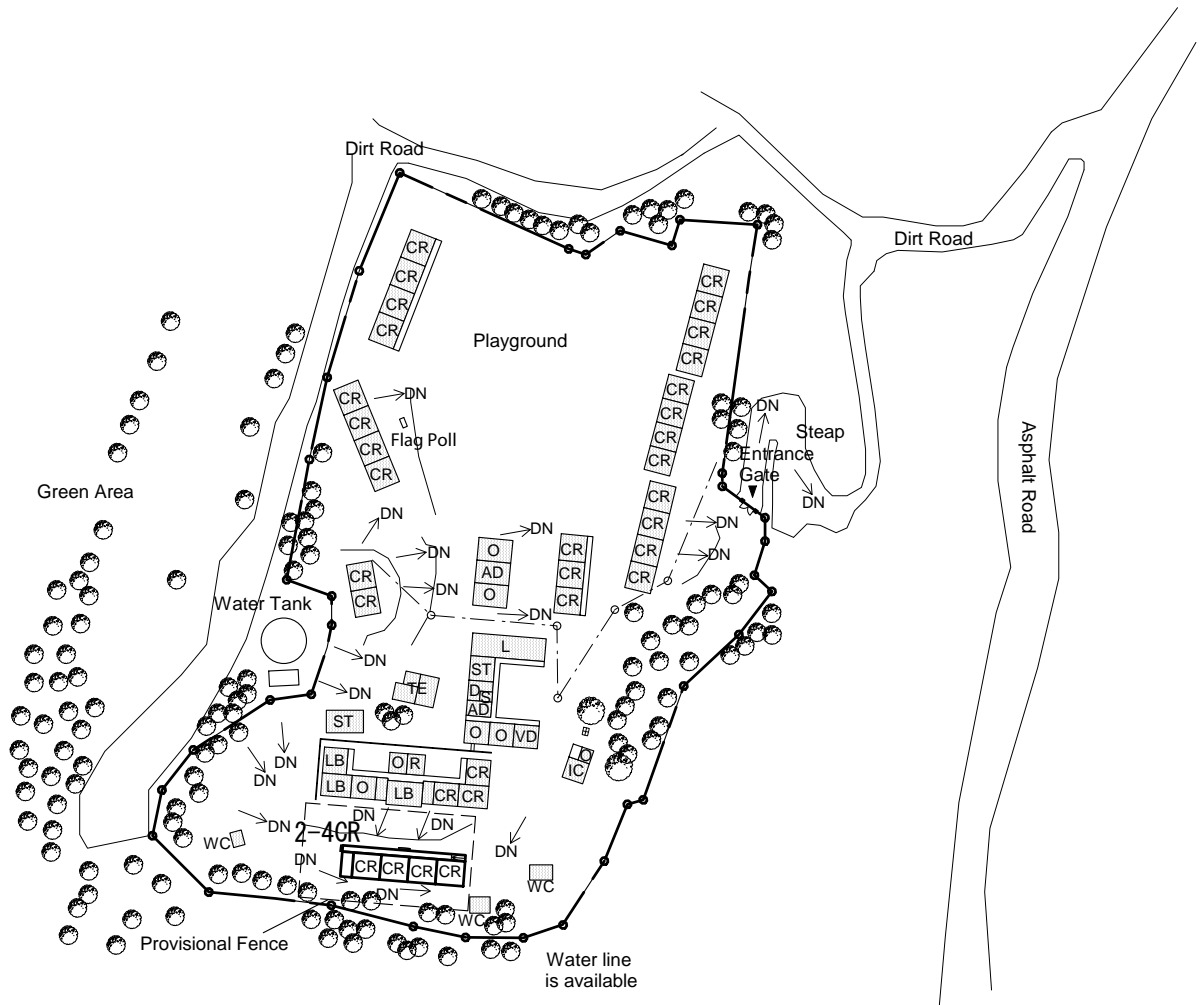

- Electric Line
- ⊠ Water Meter
- ⊙ Satellite Dish
- ⊞ Washbasin

- CR Class Room
- L Library
- LB Laboratory
- IC ICT Center
- IT IT Center
- R Resource Center
- D Director Room
- VD Vice Director Room
- S Secretary Room
- AD Administration Office
- AS Assembly Hall
- DR Department Room
- ST Store Room
- SA Satellite Receiver Room
- G Guardian Room
- TE Tea Room
- WC Toilet(Teacher, Boy, and Girl)
- O Others
- UN Unused Room

**Proposed Site Plan**

Scale 1:2000



**Basic Information**

Type	Year of Establishment	No. of Shifts	Distance from Main Road	Access Road	Declination	Size of Site	Remarks
4, 5	1966	2	200 (m)	Available	Slope	45 m × 35 m	

**Project Plan and Undertakings by the Ethiopian Side**

Construction Plan		Required Preparation Work by the Ethiopian Side			
No. of Planned CRs	Library and its Capacity	Land Formation Work	Removal of the obstacles	Installation of Gate, Fence, Guard Room, etc	Electricity Installation from nearby bldg
4	150	400m <sup>3</sup>	Felling and removing roots	-	50m

**No. of Students and Sections (As of Nov.2010)**

	G9	G10	G11	G12	Total	Student/Section	Student/Classroom (CR)	No. of Teachers
Student	1,194	898	-	-	2,092	47	70	79
Section	24	20	-	-	44			

**Existing Facility**

No. of CRs			Library		Science Laboratories			Remarks
Total	No. of dilapidated/unusable CRs	No. of Usable CRs	No.	Capacity	Physics	Chemistry	Biology	
31	0	31	1	108	1 (Temporary)	1 (Temporary)	1 (Temporary)	



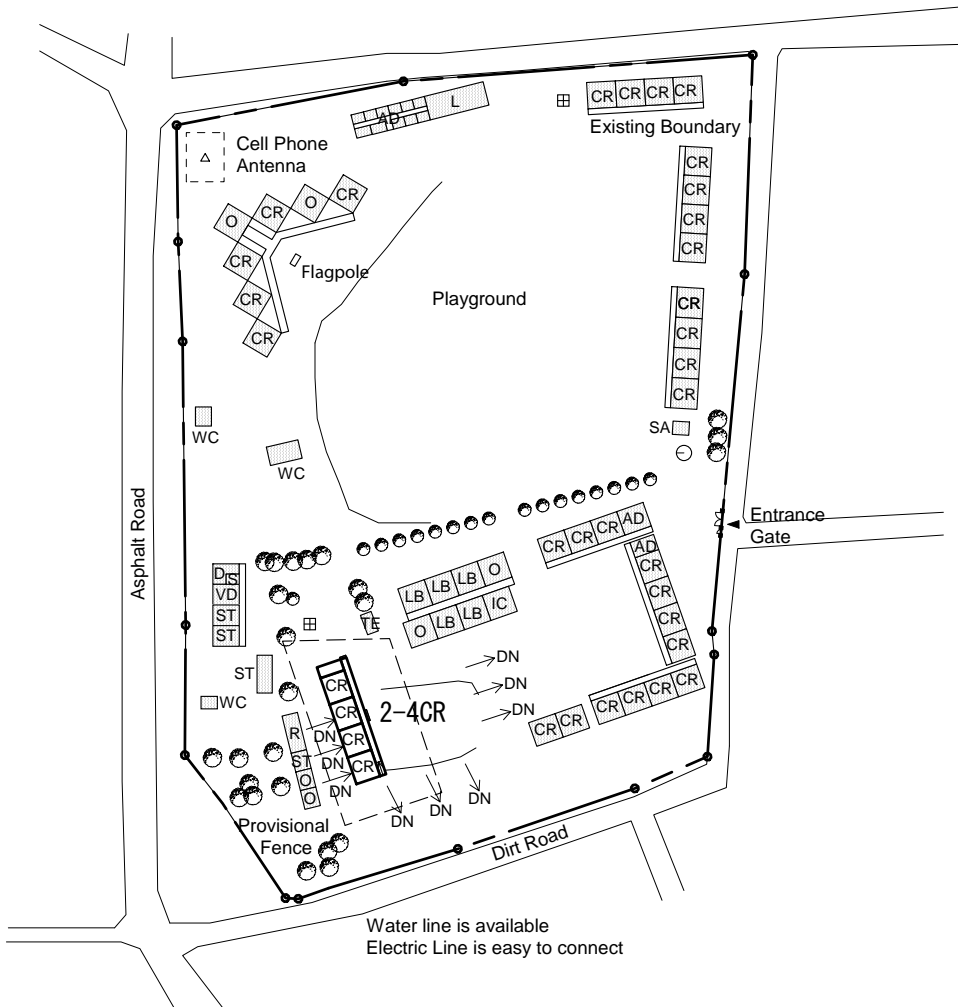

- — Electric Line
- ⊠ — Water Meter
- ⊙ — Satellite Dish
- ⊞ — Washbasin

- CR Class Room
- L Library
- LB Laboratory
- IC ICT Center
- IT IT Center
- R Resource Center
- D Director Room
- VD Vice Director Room
- S Secretary Room
- AD Administration Office
- AS Assembly Hall
- DR Department Room
- ST Store Room
- SA Satellite Receiver Room
- G Guardian Room
- TE Tea Room
- WC Toilet(Teacher, Boy, and Girl)
- O Others
- UN Unused Room

**Proposed Site Plan**

Scale 1:2000

