

NOTES:
 1. THIS DRAWING IS FOR REFERENCE ONLY AND NOT FOR CONSTRUCTION USE
 2. THE COORDINATES AND ELEVATION ARE BASED ON THE TOPOGRAPHIC MAP PREPARED BY USING SATELLITE IMAGE OF JUBA IN MARCH OF 2009 AND IS NOT BASED ON THE FIELD SURVEY.

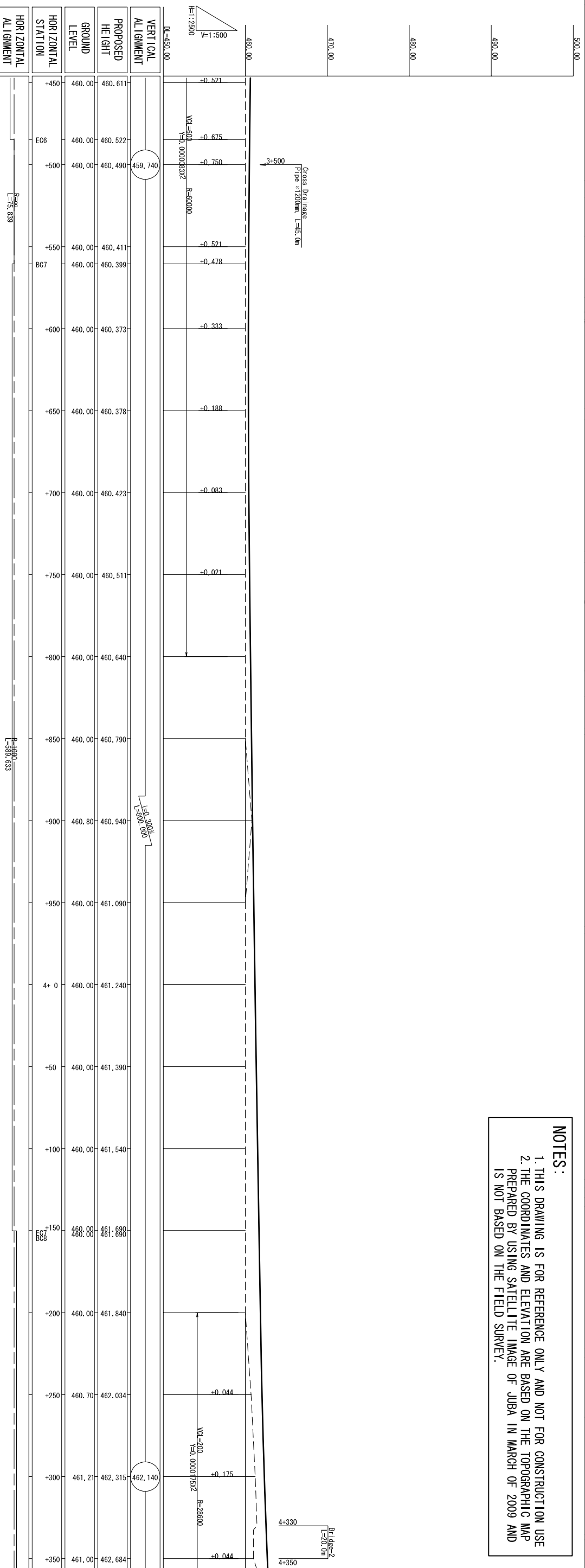

HORIZONTAL ALIGNMENT	HORIZONTAL STATION	GROUND LEVEL	PROPOSED HEIGHT	VERTICAL ALIGNMENT	
E=5.839	+450	460.00	460.611	459, 740	
	EC6	460.00	460.522		
	+500	460.00	460.490		
	BC7	+550	460.00		460.411
		460.00	460.399		
	+600	460.00	460.373		
	+650	460.00	460.378		
	+700	460.00	460.423		
	+750	460.00	460.511		
	+800	460.00	460.640		
	E=300.633	+850	460.00		460.790
		+900	460.00		460.940
	+950	460.00	461.090		
	+0	460.00	461.240		
	+50	460.00	461.390		
+100	460.00	461.540			
EC7	+150	460.00	461.690		
	460.00	461.840			
+200	460.00	461.840			
+250	460.70	462.034			
+300	461.21	462.315	462, 140		
+350	461.00	462.684			

MINISTRY OF TRANSPORT AND ROADS
 GOVERNMENT OF SOUTHERN SUDAN
 MINISTRY OF PHYSICAL INFRASTRUCTURE
 CENTRAL EQUATORIA STATE

JUBA URBAN TRANSPORT INFRASTRUCTURE
 AND CAPACITY DEVELOPMENT STUDY
 IN THE SOUTHERN SUDAN

CTI ENGINEERING INTERNATIONAL CO.,LTD
 YACHYO ENGINEERING CO.,LTD.

TITLE :
 PLAN AND PROFILE (ROUTE-C2) (5/10)

SCALE
 H=1:2500, V=1:500

Drawing No. PL2-5
 Sheet No. 9

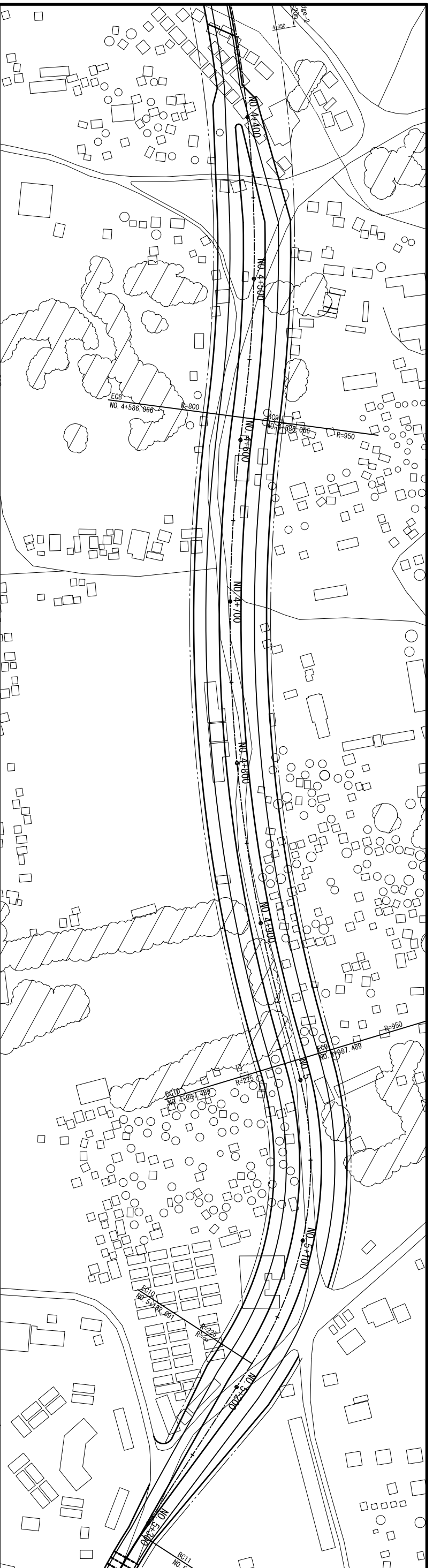

NOTES:
 1. THIS DRAWING IS FOR REFERENCE ONLY AND NOT FOR CONSTRUCTION USE
 2. THE COORDINATES AND ELEVATION ARE BASED ON THE TOPOGRAPHIC MAP PREPARED BY USING SATELLITE IMAGE OF JUBA IN MARCH OF 2009 AND IS NOT BASED ON THE FIELD SURVEY.

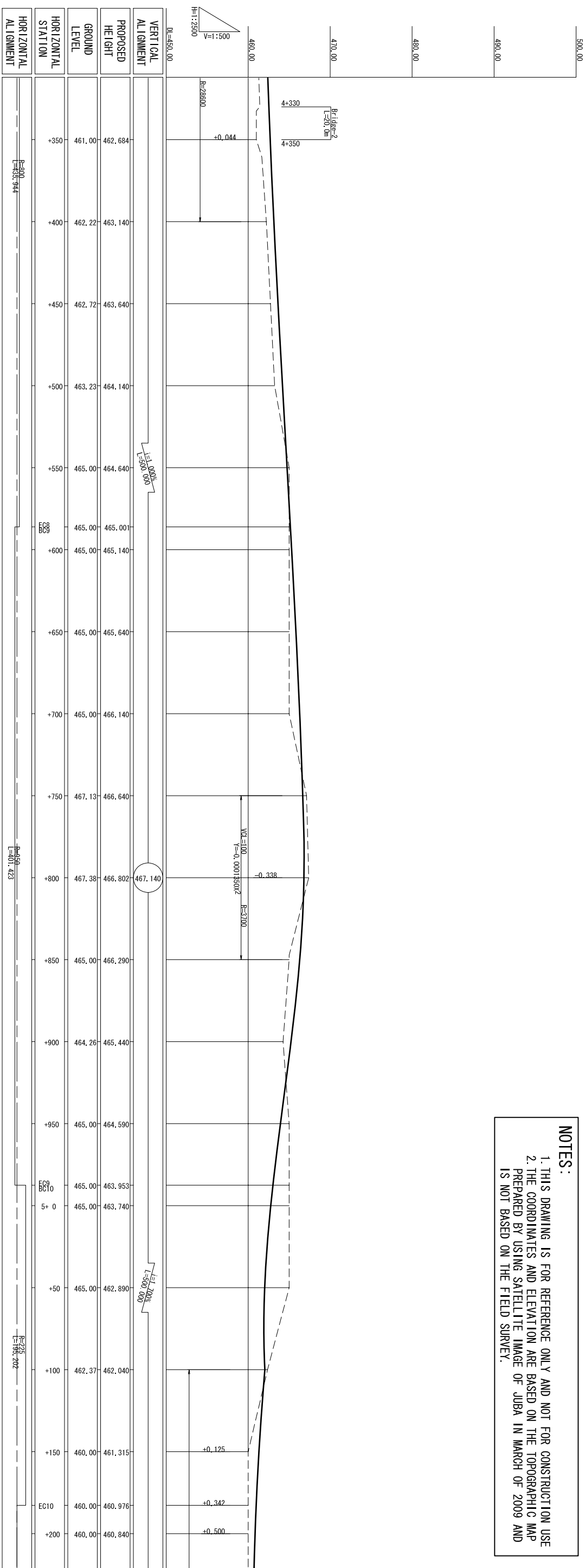

VERTICAL ALIGNMENT	PROPOSED HEIGHT	GROUND LEVEL	HORIZONTAL STATION	HORIZONTAL ALIGNMENT
	462.684	461.00	+350	
	463.140	462.22	+400	
	463.640	462.72	+450	
	464.140	463.23	+500	
	464.640	465.00	+550	
	465.001	465.00	+600	
	465.140	465.00	+650	
	466.140	465.00	+700	
	466.640	467.13	+750	
	466.802	467.38	+800	
	466.290	465.00	+850	
	465.440	464.26	+900	
	464.590	465.00	+950	
	463.953	465.00	+100	
	463.740	465.00	+150	
	462.890	465.00	+200	
	462.040	462.37	+250	
	461.315	460.00	+300	
	460.976	460.00	+350	
	460.840	460.00	+400	

MINISTRY OF TRANSPORT AND ROADS
 GOVERNMENT OF SOUTHERN SUDAN
 MINISTRY OF PHYSICAL INFRASTRUCTURE
 CENTRAL EQUATORIA STATE

JUBA URBAN TRANSPORT INFRASTRUCTURE
 AND CAPACITY DEVELOPMENT STUDY
 IN THE SOUTHERN SUDAN

CTI ENGINEERING INTERNATIONAL CO.,LTD
 YACHYO ENGINEERING CO.,LTD.

TITLE :
 PLAN AND PROFILE (ROUTE-C2) (6/10)

SCALE
 H=1:2500, V=1:500

Drawing No. PL2-6
 Sheet No. 10



NOTES:
 1. THIS DRAWING IS FOR REFERENCE ONLY AND NOT FOR CONSTRUCTION USE
 2. THE COORDINATES AND ELEVATION ARE BASED ON THE TOPOGRAPHIC MAP PREPARED BY USING SATELLITE IMAGE OF JUBA IN MARCH OF 2009 AND IS NOT BASED ON THE FIELD SURVEY.

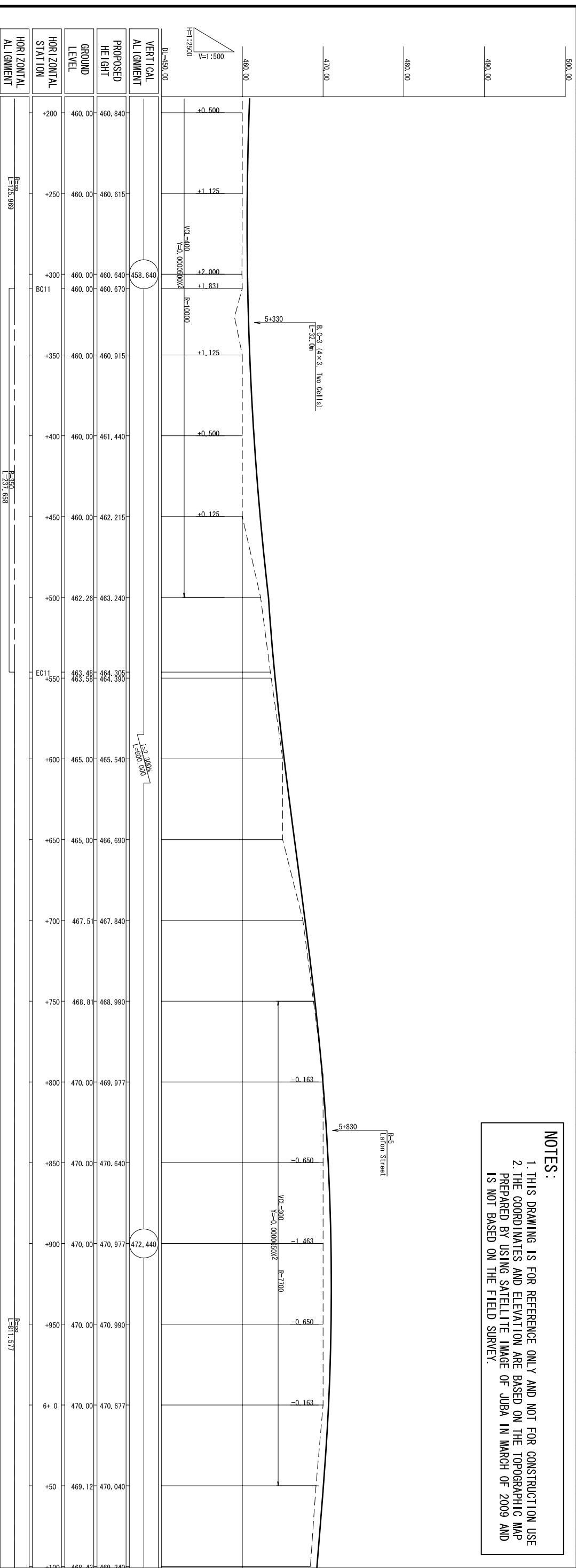

HORIZONTAL ALIGNMENT	GROUND LEVEL	PROPOSED HEIGHT	VERTICAL ALIGNMENT
+200	460.00	460.840	
+250	460.00	460.615	
+300	460.00	460.640	458.640
	460.00	460.670	
+350	460.00	460.915	
+400	460.00	461.440	
+450	460.00	462.215	
+500	462.26	463.240	
+550	463.48 463.58	464.305 464.390	
+600	465.00	465.540	
+650	465.00	466.690	
+700	467.51	467.840	
+750	468.81	468.990	
+800	470.00	469.977	
+850	470.00	470.640	
+900	470.00	470.977	472.440
+950	470.00	470.990	
+0	470.00	470.677	
+50	469.12	470.040	
+100	468.12	469.240	

MINISTRY OF TRANSPORT AND ROADS
 GOVERNMENT OF SOUTHERN SUDAN
 CENTRAL EQUATORIA STATE

JUBA URBAN TRANSPORT INFRASTRUCTURE
 AND CAPACITY DEVELOPMENT STUDY
 IN THE SOUTHERN SUDAN

CTI ENGINEERING INTERNATIONAL CO.,LTD
 YACHIO ENGINEERING CO.,LTD.

TITLE :
 PLAN AND PROFILE (ROUTE-C2) (7/10)

SCALE
 H=1:2500, V=1:500

Drawing No. PL2-7
 Sheet No. 11

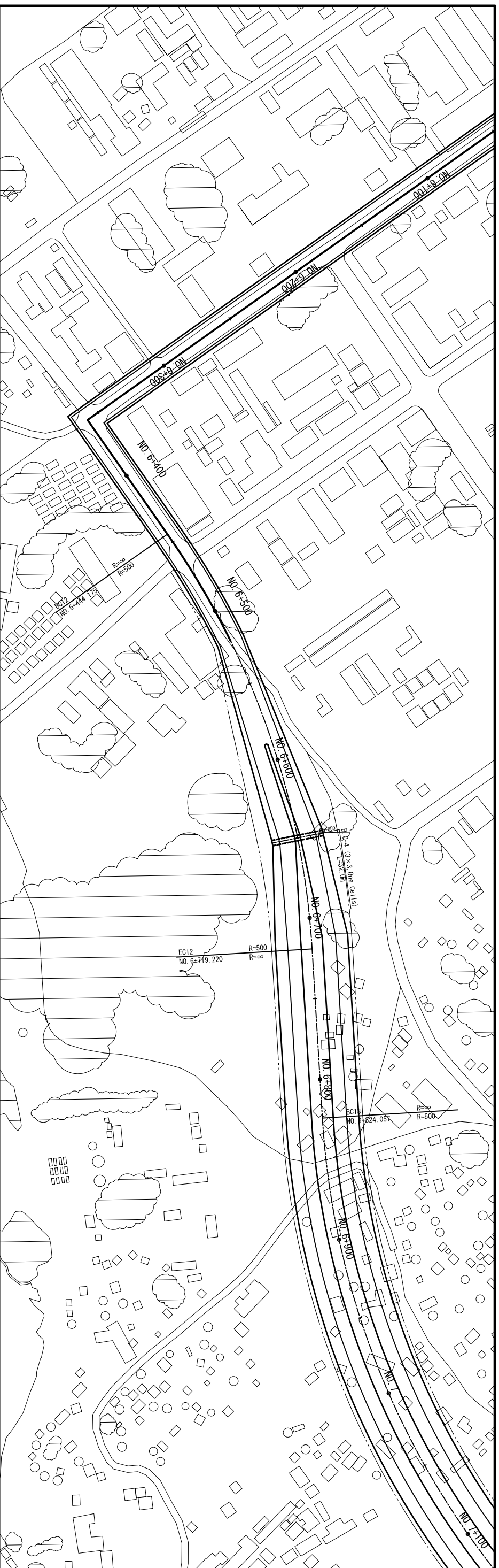

NOTES:
 1. THIS DRAWING IS FOR REFERENCE ONLY AND NOT FOR CONSTRUCTION USE
 2. THE COORDINATES AND ELEVATION ARE BASED ON THE TOPOGRAPHIC MAP PREPARED BY USING SATELLITE IMAGE OF JUBA IN MARCH OF 2009 AND IS NOT BASED ON THE FIELD SURVEY.

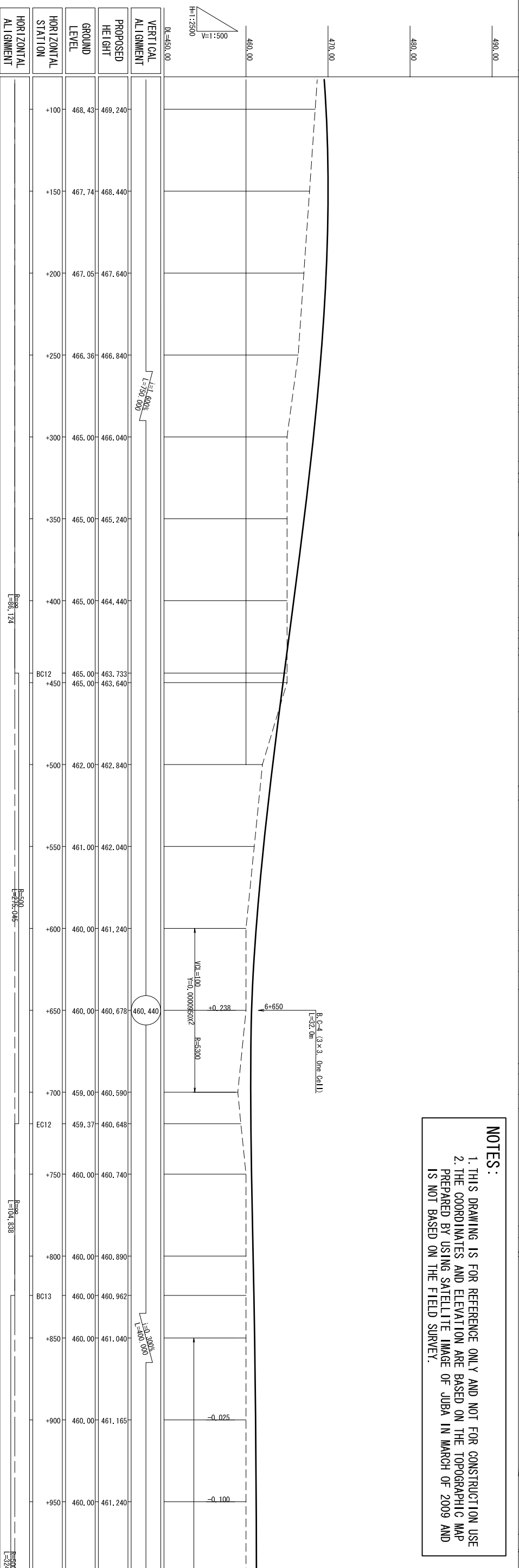

MINISTRY OF TRANSPORT AND ROADS GOVERNMENT OF SOUTHERN SUDAN MINISTRY OF PHYSICAL INFRASTRUCTURE CENTRAL EQUATORIA STATE		JUBA URBAN TRANSPORT INFRASTRUCTURE AND CAPACITY DEVELOPMENT STUDY IN THE SOUTHERN SUDAN		CTI ENGINEERING INTERNATIONAL CO.,LTD YACHYO ENGINEERING CO.,LTD.		TITLE : PLAN AND PROFILE (ROUTE-C2) (8/10)		SCALE H=1:2500, V=1:500		Drawing No. Sheet No.		PL2-8 12	
---	--	--	--	--	--	--	--	-----------------------------------	--	---------------------------------	--	-------------	--

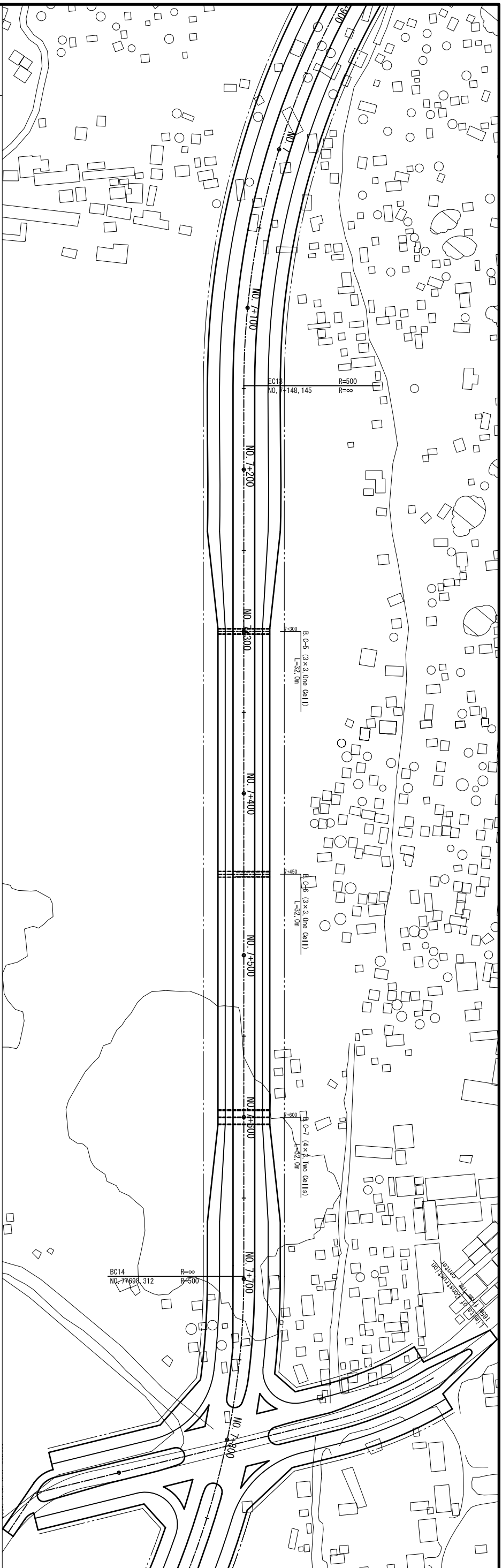

NOTES:

1. THIS DRAWING IS FOR REFERENCE ONLY AND NOT FOR CONSTRUCTION USE
2. THE COORDINATES AND ELEVATION ARE BASED ON THE TOPOGRAPHIC MAP PREPARED BY USING SATELLITE IMAGE OF JUBA IN MARCH OF 2009 AND IS NOT BASED ON THE FIELD SURVEY.

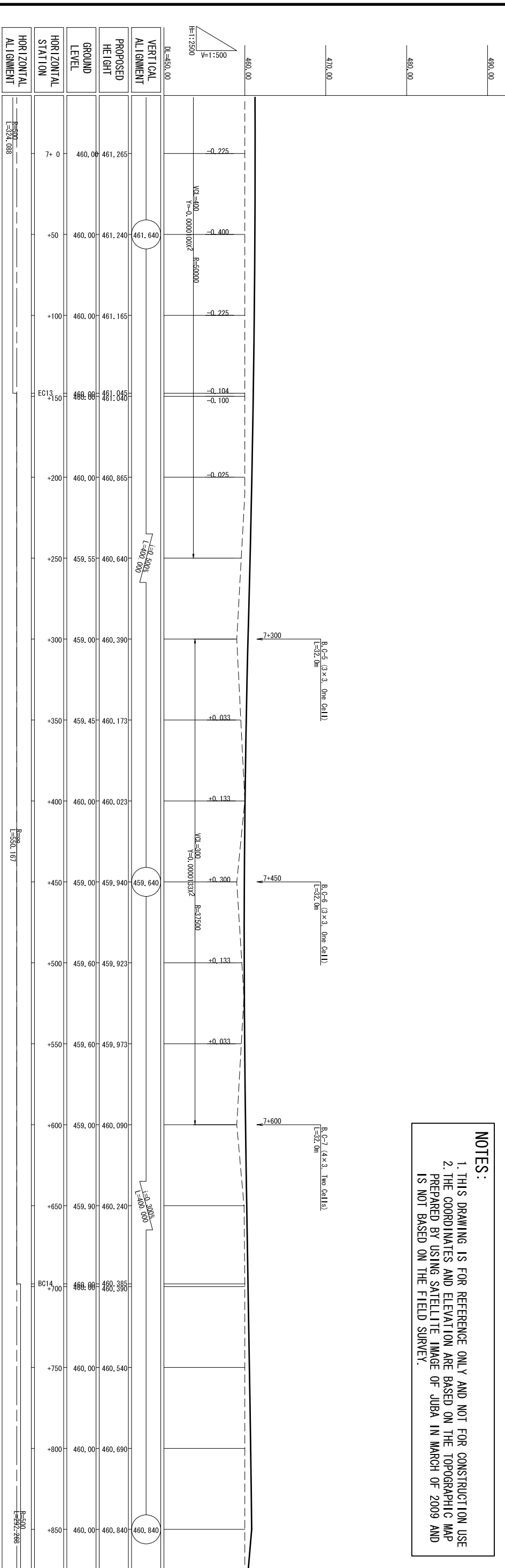

HORIZONTAL ALIGNMENT	HORIZONTAL STATION	GROUND LEVEL	PROPOSED HEIGHT	VERTICAL ALIGNMENT
P=500 L=324.088	7+0	460.00	461.265	D=+50.00
	+50	460.00	461.240	
P=500 L=324.088	+100	460.00	461.165	V=400 Y=-0.000010002 R=500000
	+150	460.00	461.045	
P=500 L=324.088	+200	460.00	460.865	V=400 Y=-0.000010002 R=500000
	+250	459.55	460.640	
P=500 L=324.088	+300	459.00	460.390	V=400 Y=-0.000010002 R=500000
	+350	459.45	460.173	
P=500 L=324.088	+400	460.00	460.023	V=400 Y=-0.000010002 R=500000
	+450	459.00	459.940	
P=500 L=324.088	+500	459.60	459.923	V=400 Y=-0.000010002 R=500000
	+550	459.60	459.973	
P=500 L=324.088	+600	459.00	460.090	V=400 Y=-0.000010002 R=500000
	+650	459.90	460.240	
P=500 L=324.088	+700	460.00	460.385	V=400 Y=-0.000010002 R=500000
	+750	460.00	460.540	
P=500 L=324.088	+800	460.00	460.690	V=400 Y=-0.000010002 R=500000
	+850	460.00	460.840	

MINISTRY OF TRANSPORT AND ROADS GOVERNMENT OF SOUTHERN SUDAN MINISTRY OF PHYSICAL INFRASTRUCTURE CENTRAL EQUATORIA STATE		JUBA URBAN TRANSPORT INFRASTRUCTURE AND CAPACITY DEVELOPMENT STUDY IN THE SOUTHERN SUDAN		CTI ENGINEERING INTERNATIONAL CO.,LTD YACHYO ENGINEERING CO.,LTD.		TITLE : PLAN AND PROFILE (ROUTE-C2) (9/10)		SCALE H=1:2500, V=1:500		Drawing No. Sheet No.		PL2-9 13	
---	--	--	--	--	--	---	--	----------------------------	--	--------------------------	--	-------------	--

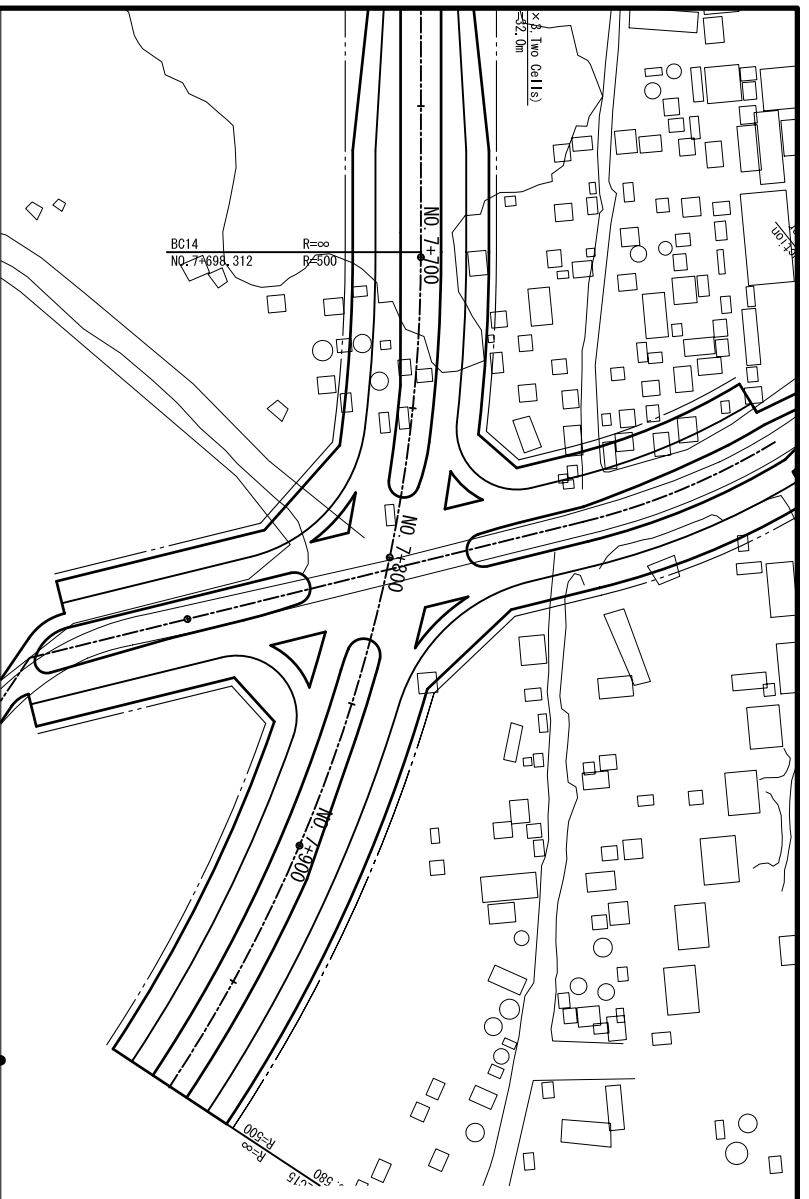

NOTES:
 1. THIS DRAWING IS FOR REFERENCE ONLY AND NOT FOR CONSTRUCTION USE
 2. THE COORDINATES AND ELEVATION ARE BASED ON THE TOPOGRAPHIC MAP PREPARED BY USING SATELLITE IMAGE OF JUBA IN MARCH OF 2009 AND IS NOT BASED ON THE FIELD SURVEY.

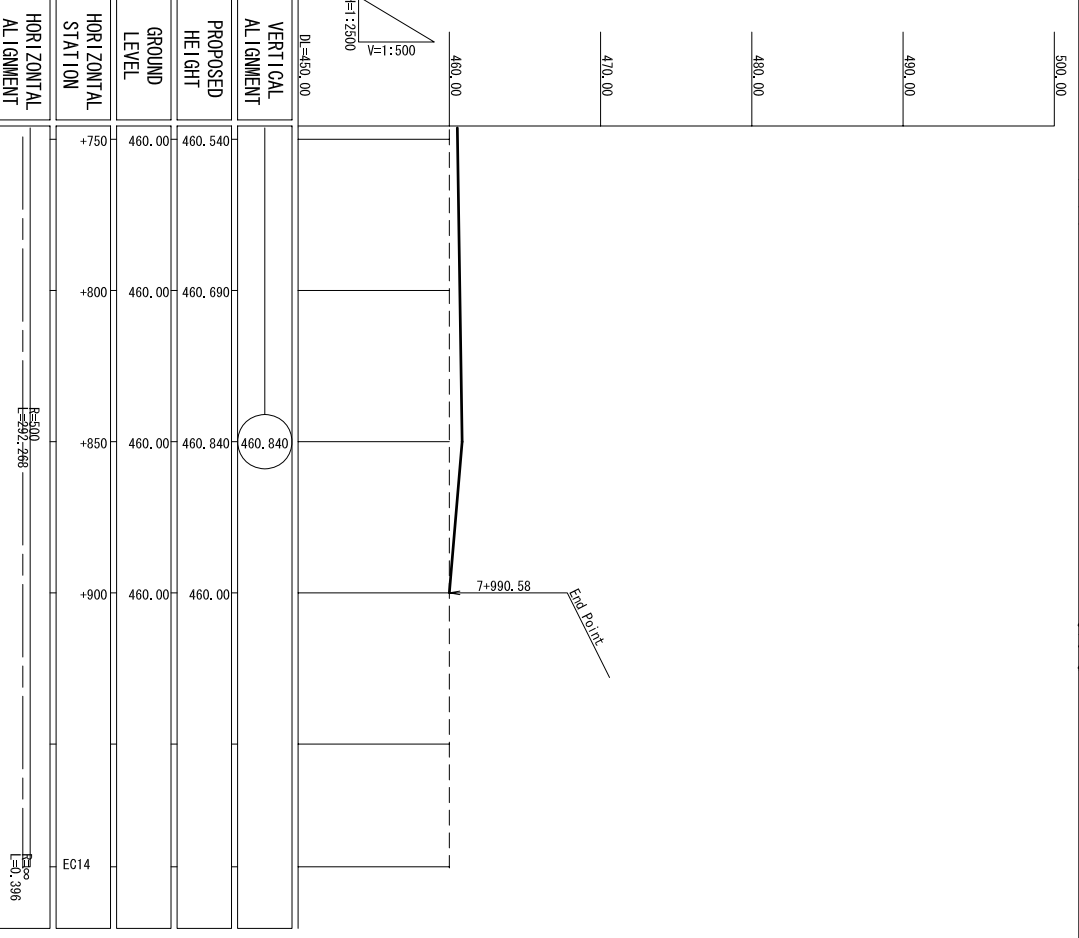

VERTICAL ALIGNMENT	PROPOSED HEIGHT	GROUND LEVEL
7+750	460.540	460.690
7+800	460.000	460.000
7+850	460.840	460.840
7+900	460.000	460.000

MINISTRY OF TRANSPORT AND ROADS
 GOVERNMENT OF SOUTHERN SUDAN
 MINISTRY OF PHYSICAL INFRASTRUCTURE
 CENTRAL EQUATORIA STATE

JUBA URBAN TRANSPORT INFRASTRUCTURE
 AND CAPACITY DEVELOPMENT STUDY
 IN THE SOUTHERN SUDAN

CTI ENGINEERING INTERNATIONAL CO.,LTD
 YACHYO ENGINEERING CO.,LTD.

TITLE :
 PLAN AND PROFILE (ROUTE-C2) (10/10)

SCALE
 H=1:2500, V=1:500

Drawing No. PL2-10
 Sheet No. 14

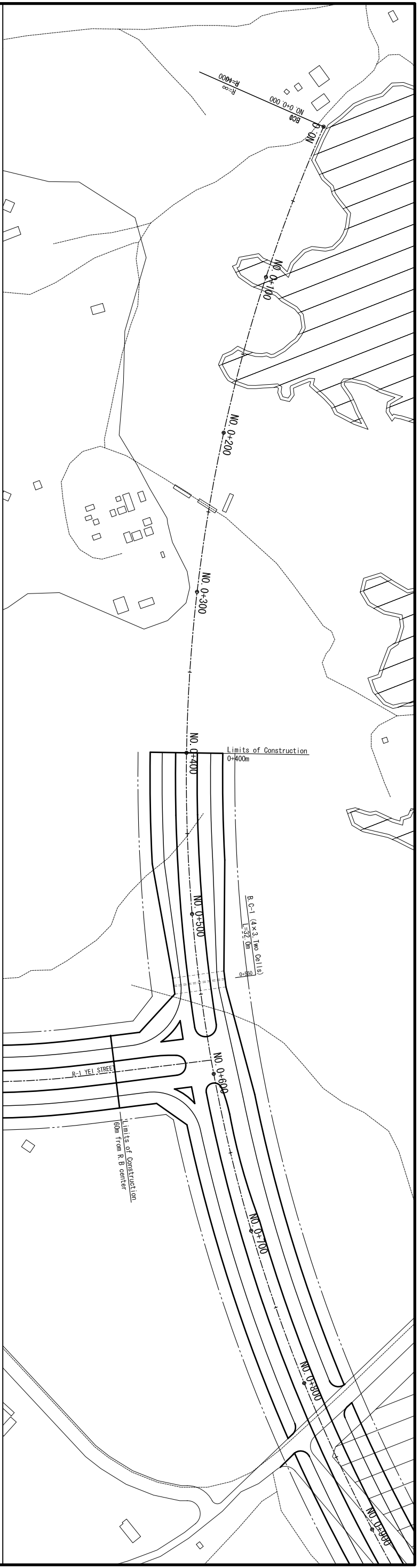

NOTES:

1. THIS DRAWING IS FOR REFERENCE ONLY AND NOT FOR CONSTRUCTION USE.
2. THE COORDINATES AND ELEVATION ARE BASED ON THE TOPOGRAPHIC MAP PREPARED BY USING SATELLITE IMAGE OF JUBA IN MARCH OF 2009 AND IS NOT BASED ON THE FIELD SURVEY.

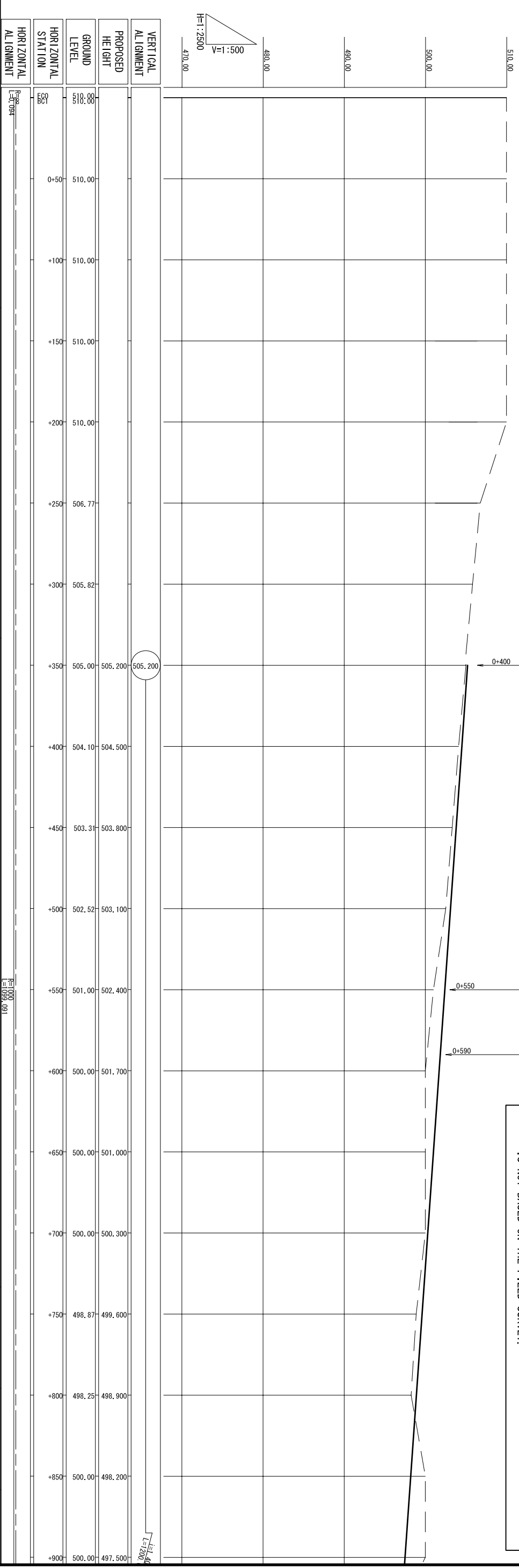

HORIZONTAL ALIGNMENT File: 1009_081		HORIZONTAL ALIGNMENT File: 1009_081	
MINISTRY OF TRANSPORT AND ROADS GOVERNMENT OF SOUTHERN SUDAN MINISTRY OF PHYSICAL INFRASTRUCTURE CENTRAL EQUATORIA STATE		JUBA URBAN TRANSPORT INFRASTRUCTURE AND CAPACITY DEVELOPMENT STUDY IN THE SOUTHERN SUDAN	
CTI ENGINEERING INTERNATIONAL CO.,LTD YACHIYO ENGINEERING CO.,LTD.		TITLE : PLAN AND PROFILE (ROUTE-C3) (1/14)	
SCALE H=1:2500, V=1:500		Drawing No. PL3-1	
Sheet No. 15			

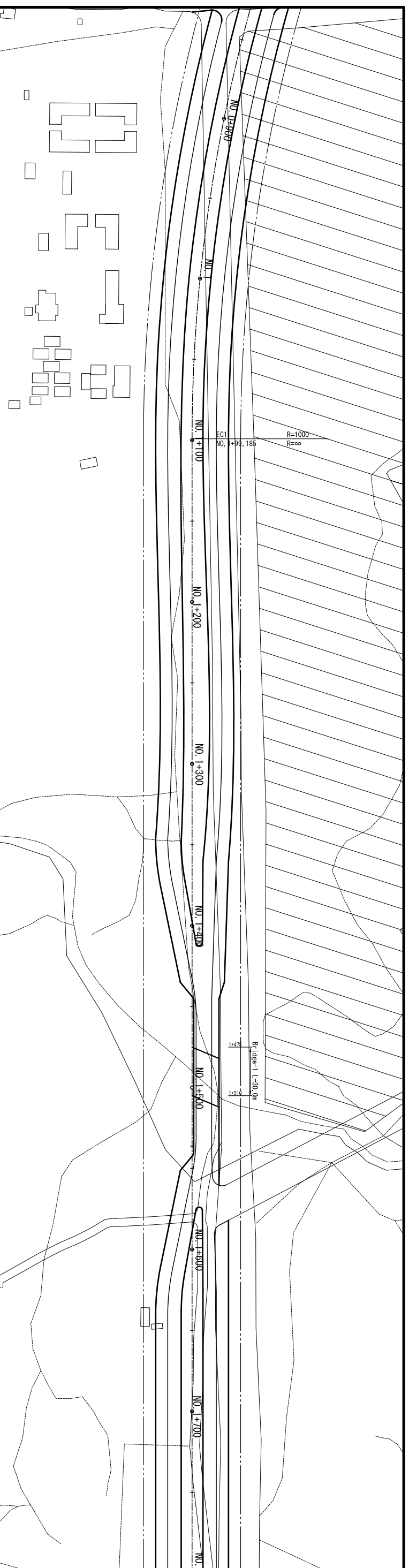

NOTES:
 1. THIS DRAWING IS FOR REFERENCE ONLY AND NOT FOR CONSTRUCTION USE.
 2. THE COORDINATES AND ELEVATION ARE BASED ON THE TOPOGRAPHIC MAP PREPARED BY USING SATELLITE IMAGE OF JUBA IN MARCH OF 2009 AND IS NOT BASED ON THE FIELD SURVEY.

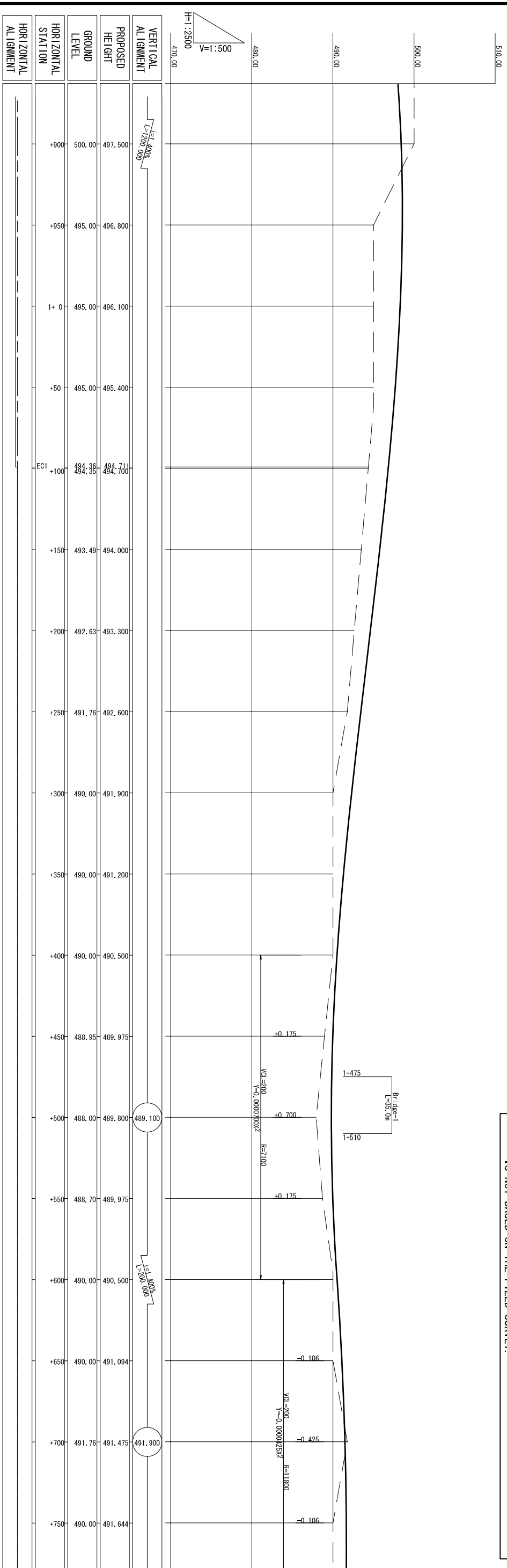

VERTICAL ALIGNMENT	PROPOSED HEIGHT	GROUND LEVEL	HORIZONTAL STATION	HORIZONTAL ALIGNMENT
	497.500	500.00	+900	
	496.800	495.00	+950	
	496.100	495.00	1+0	
	495.400	495.00	+50	
	494.700	494.36	+100	EC1
	494.700	494.35	+100	
	494.000	493.49	+150	
	493.300	492.63	+200	
	492.600	491.76	+250	
	491.900	490.00	+300	
	491.200	490.00	+350	
	490.500	490.00	+400	
	489.975	488.95	+450	
	489.800	488.00	+500	
	489.975	488.70	+550	
	490.500	490.00	+600	
	491.094	490.00	+650	
	491.475	491.76	+700	
	491.644	490.00	+750	

MINISTRY OF TRANSPORT AND ROADS
 GOVERNMENT OF SOUTHERN SUDAN
 MINISTRY OF PHYSICAL INFRASTRUCTURE
 CENTRAL EQUATORIA STATE

JUBA URBAN TRANSPORT INFRASTRUCTURE
 AND CAPACITY DEVELOPMENT STUDY
 IN THE SOUTHERN SUDAN

CTI ENGINEERING INTERNATIONAL CO.,LTD
 YACHIYO ENGINEERING CO.,LTD.

TITLE :
 PLAN AND PROFILE (ROUTE-C3) (2/14)

SCALE
 H=1:2500, V=1:500

Drawing No.
 PL3-2

Sheet No.
 16

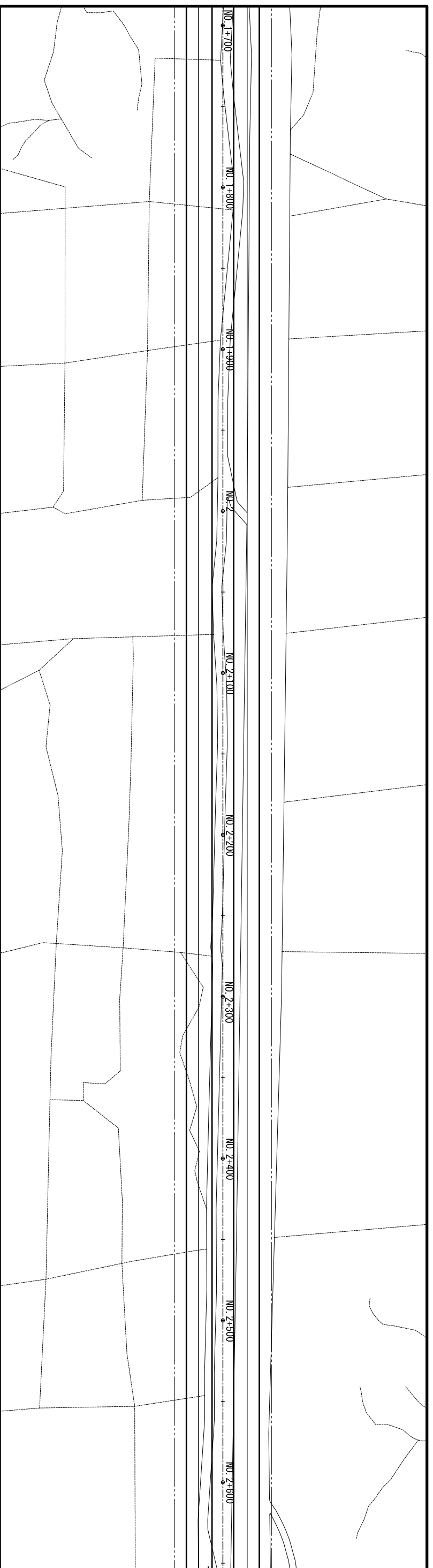

NOTES:
 1. THIS DRAWING IS FOR REFERENCE ONLY AND NOT FOR CONSTRUCTION USE.
 2. THE COORDINATES AND ELEVATION ARE BASED ON THE TOPOGRAPHIC MAP PREPARED BY USING SATELLITE IMAGE OF JUBA IN MARCH OF 2009 AND IS NOT BASED ON THE FIELD SURVEY.

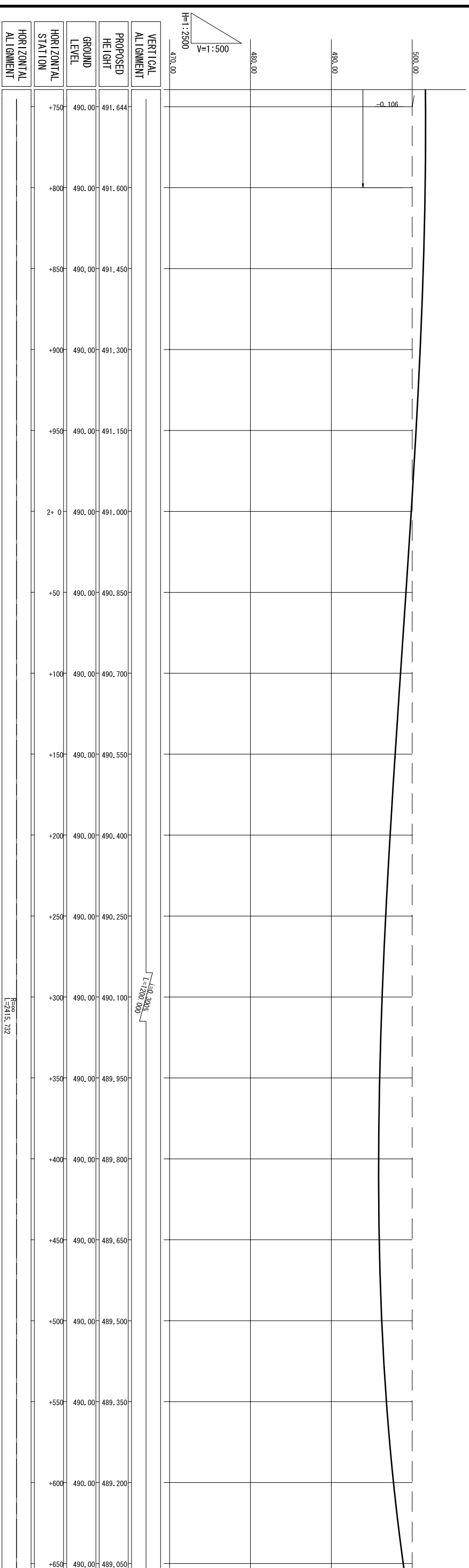

MINISTRY OF TRANSPORT AND ROADS GOVERNMENT OF SOUTHERN SUDAN MINISTRY OF PHYSICAL INFRASTRUCTURE CENTRAL EQUATORIA STATE	JUBA URBAN TRANSPORT INFRASTRUCTURE AND CAPACITY DEVELOPMENT STUDY IN THE SOUTHERN SUDAN	CTI ENGINEERING INTERNATIONAL CO.,LTD YACHIYO ENGINEERING CO.,LTD.	TITLE : PLAN AND PROFILE (ROUTE-C3) (3/14)	SCALE H=1:2500, V=1:500	Drawing No. Sheet No.	PL3-3 17
---	--	---	---	----------------------------	--------------------------	-------------

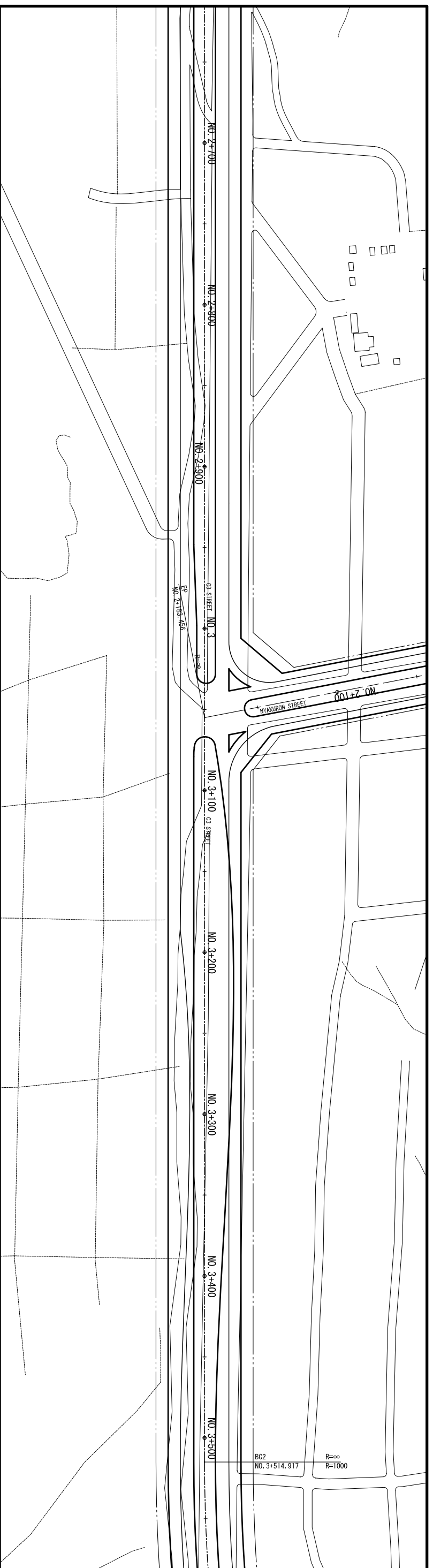

NOTES:
 1. THIS DRAWING IS FOR REFERENCE ONLY AND NOT FOR CONSTRUCTION USE.
 2. THE COORDINATES AND ELEVATION ARE BASED ON THE TOPOGRAPHIC MAP PREPARED BY USING SATELLITE IMAGE OF JUBA IN MARCH OF 2009 AND IS NOT BASED ON THE FIELD SURVEY.

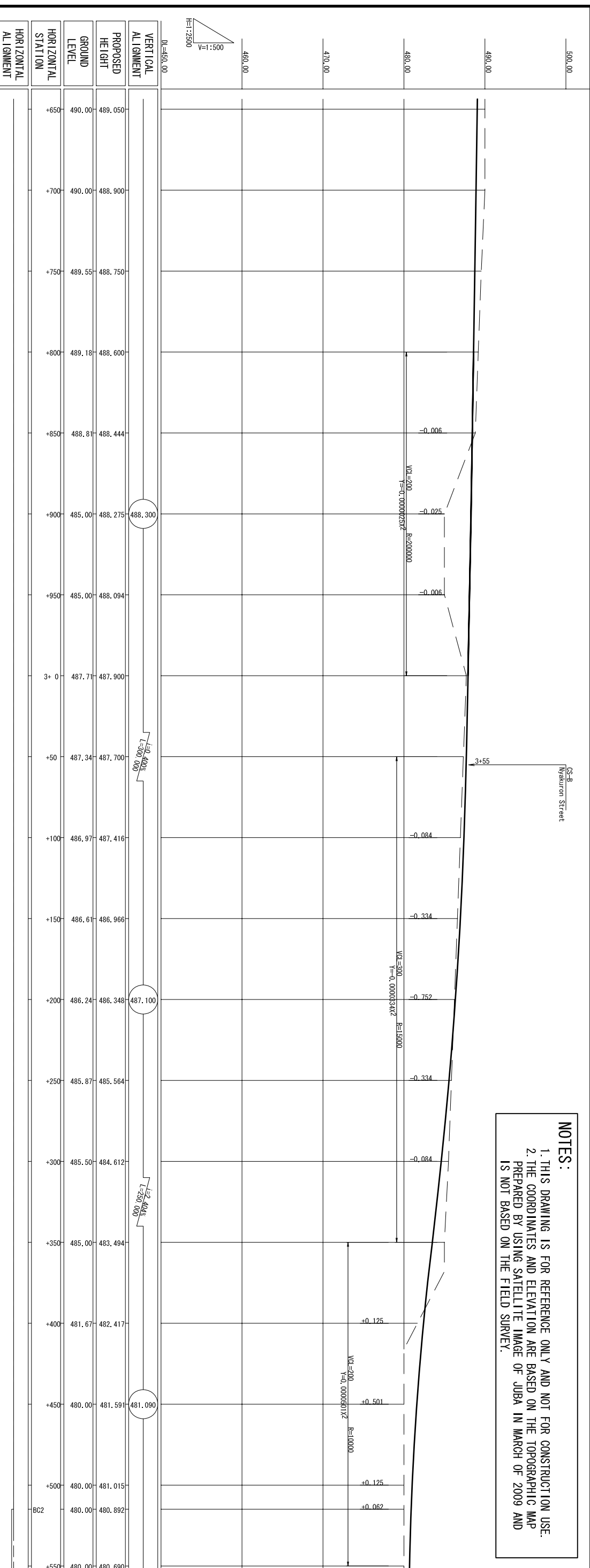

HORIZONTAL STATION	GROUND LEVEL	PROPOSED HEIGHT	VERTICAL ALIGNMENT
+650	490.00	489.050	
+700	490.00	488.900	
+750	489.55	488.750	
+800	489.18	488.600	
+850	488.81	488.444	
+900	485.00	488.275	488.300
+950	485.00	488.094	
3+0	487.71	487.900	
+50	487.34	487.700	
+100	486.97	487.416	
+150	486.61	486.966	
+200	486.24	486.348	487.100
+250	485.87	485.564	
+300	485.50	484.612	
+350	485.00	483.494	
+400	481.67	482.417	
+450	480.00	481.591	481.090
+500	480.00	481.015	
+550	480.00	480.892	

MINISTRY OF TRANSPORT AND ROADS
 GOVERNMENT OF SOUTHERN SUDAN
 MINISTRY OF PHYSICAL INFRASTRUCTURE
 CENTRAL EQUATORIA STATE

JUBA URBAN TRANSPORT INFRASTRUCTURE
 AND CAPACITY DEVELOPMENT STUDY
 IN THE SOUTHERN SUDAN

CTI ENGINEERING INTERNATIONAL CO.,LTD
 YACHIYO ENGINEERING CO.,LTD.

TITLE :
 PLAN AND PROFILE (ROUTE-C3) (4/14)

SCALE
 H=1:2500, V=1:500

Drawing No. PL3-5
 Sheet No. 18