

PLAN (4)
S=1:2500
(CHIPIMBERE HIGHWAY AND LIVINGSTONE AVENUE)

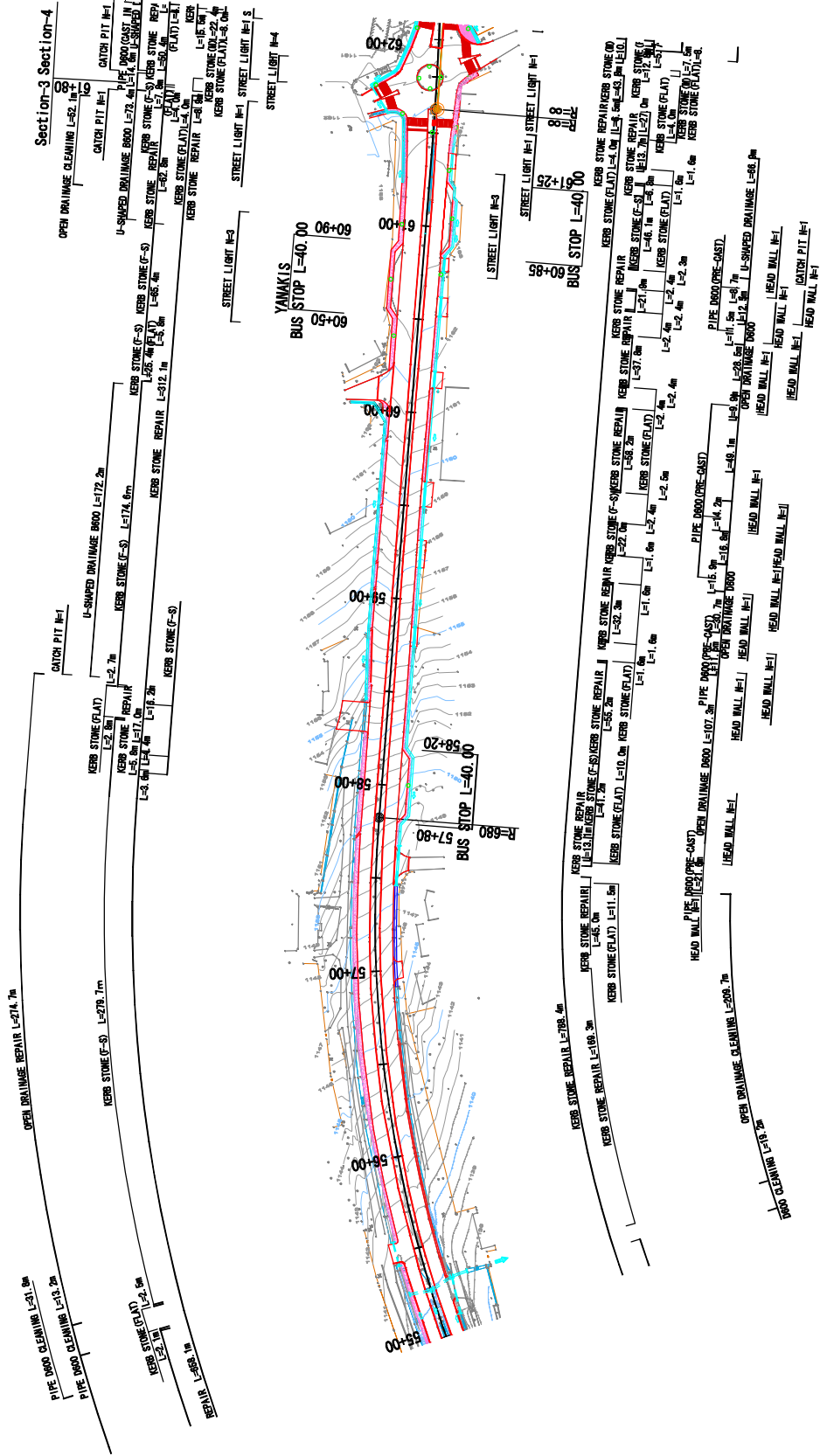

BLANTYRE CITY ASSEMBLY THE REPUBLIC OF MALAWI	JAPAN INTERNATIONAL COOPERATION AGENCY KATAHIRA & ENGINEERS INTERNATIONAL	THE PREPARATORY SURVEY ON THE PROJECT FOR THE IMPROVEMENT OF BLANTYRE CITY ROADS IN THE REPUBLIC OF MALAWI	Drawing No. P L - 4 SCALE S=1:2500 DATE TITLE: PLAN (4/7) (STA. 55+00 ~62+00)
--	---	--	--

PLAN (5)

S=1:2500

(CHIPEMBERE HIGHWAY AND LIVINGSTONE AVENUE)

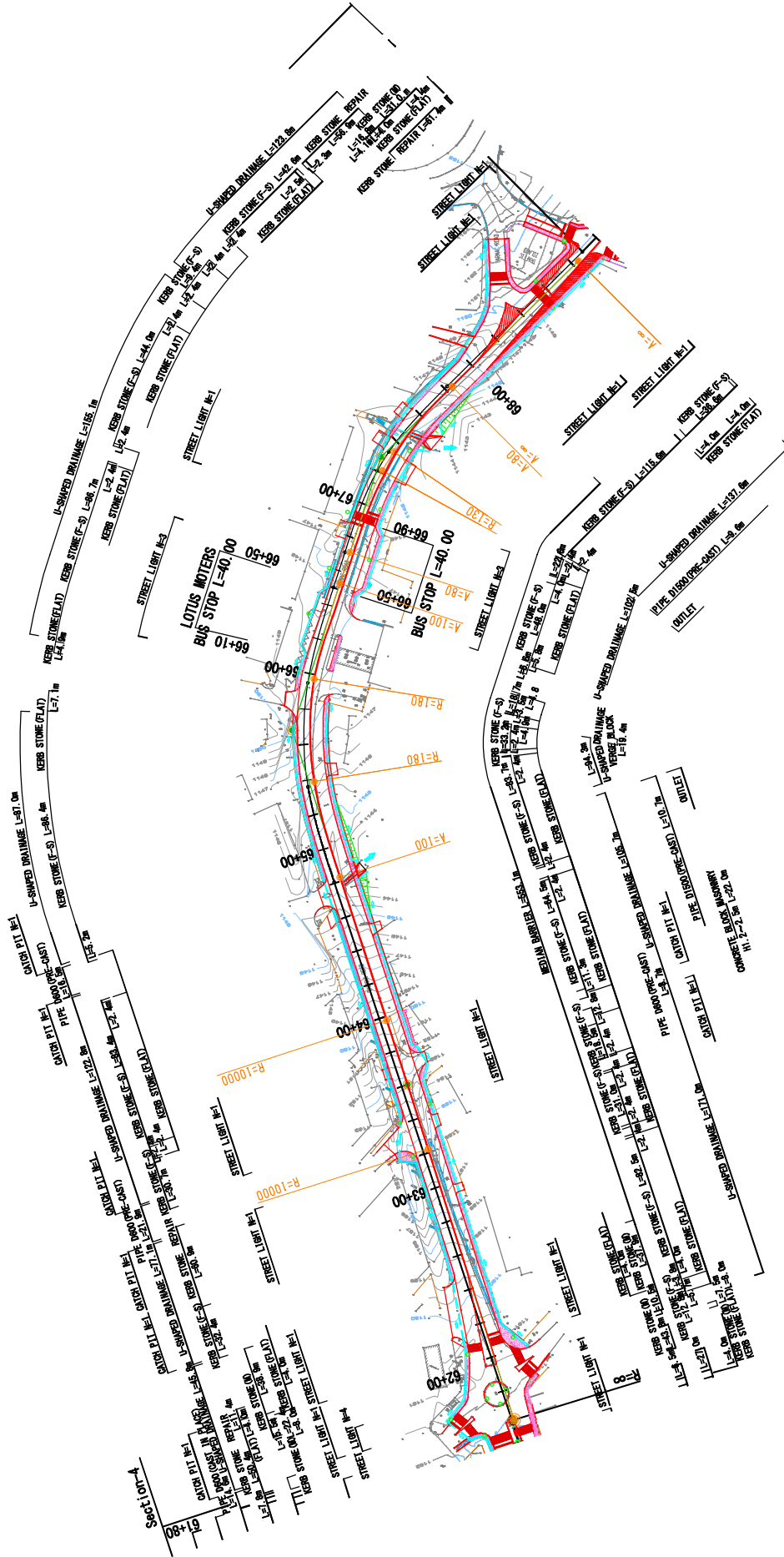

Drawing No.	P L - 5
SCALE	S=1:2500
DATE	
TITLE:	THE PREPARATORY SURVEY ON THE PROJECT FOR THE IMPROVEMENT OF BLANTYRE CITY ROADS IN THE REPUBLIC OF MALAWI
JAPAN INTERNATIONAL COOPERATION AGENCY KATAHIRA & ENGINEERS INTERNATIONAL	
BLANTYRE CITY ASSEMBLY THE REPUBLIC OF MALAWI	

PLAN (6) S=1:2500
 (CHIPEMBERE HIGHWAY AND LIVINGSTONE AVENUE)

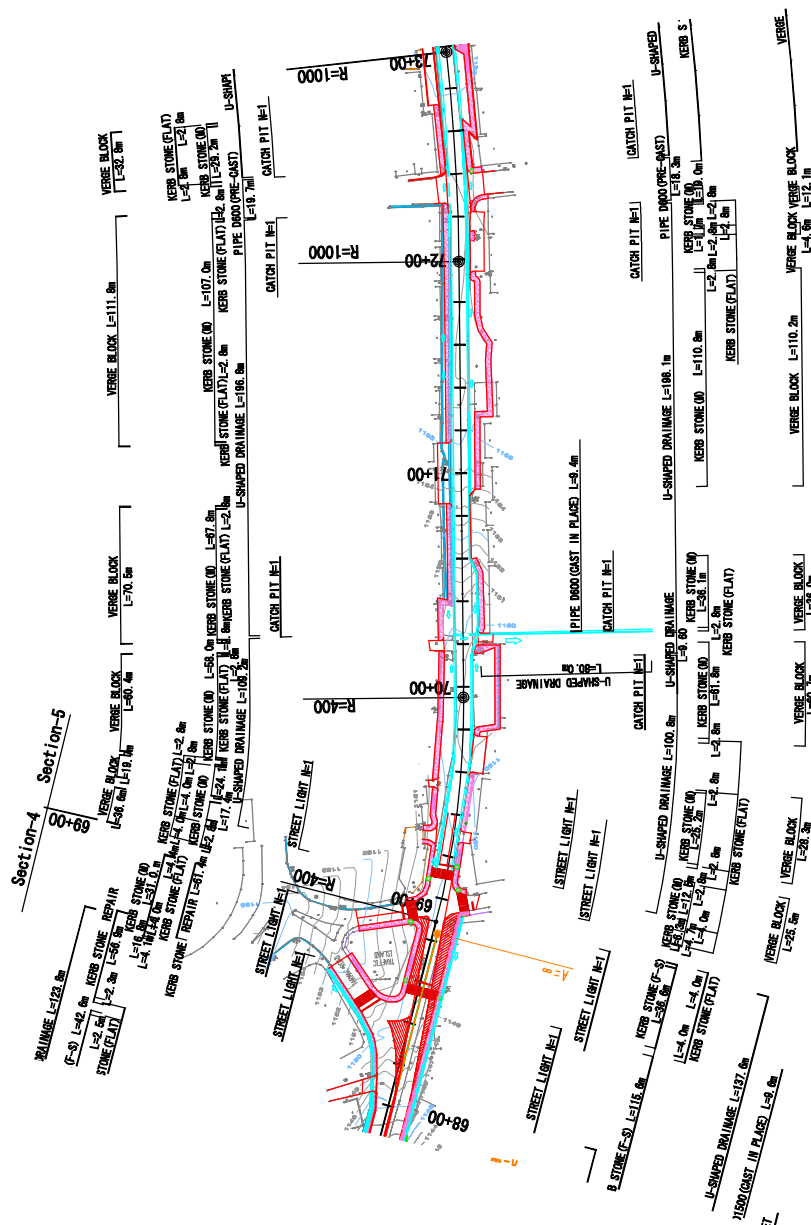

BLANTYRE CITY ASSEMBLY THE REPUBLIC OF MALAWI	JAPAN INTERNATIONAL COOPERATION AGENCY KATAHIRA & ENGINEERS INTERNATIONAL	THE PREPARATORY SURVEY ON THE PROJECT FOR THE IMPROVEMENT OF BLANTYRE CITY ROADS IN THE REPUBLIC OF MALAWI	Drawing No.	P L - 6
			SCALE	S=1:2500
			DATE	

PLAN (7)

(CHIPIMBERE HIGHWAY AND LIVINGSTONE AVENUE)

S=1:2500

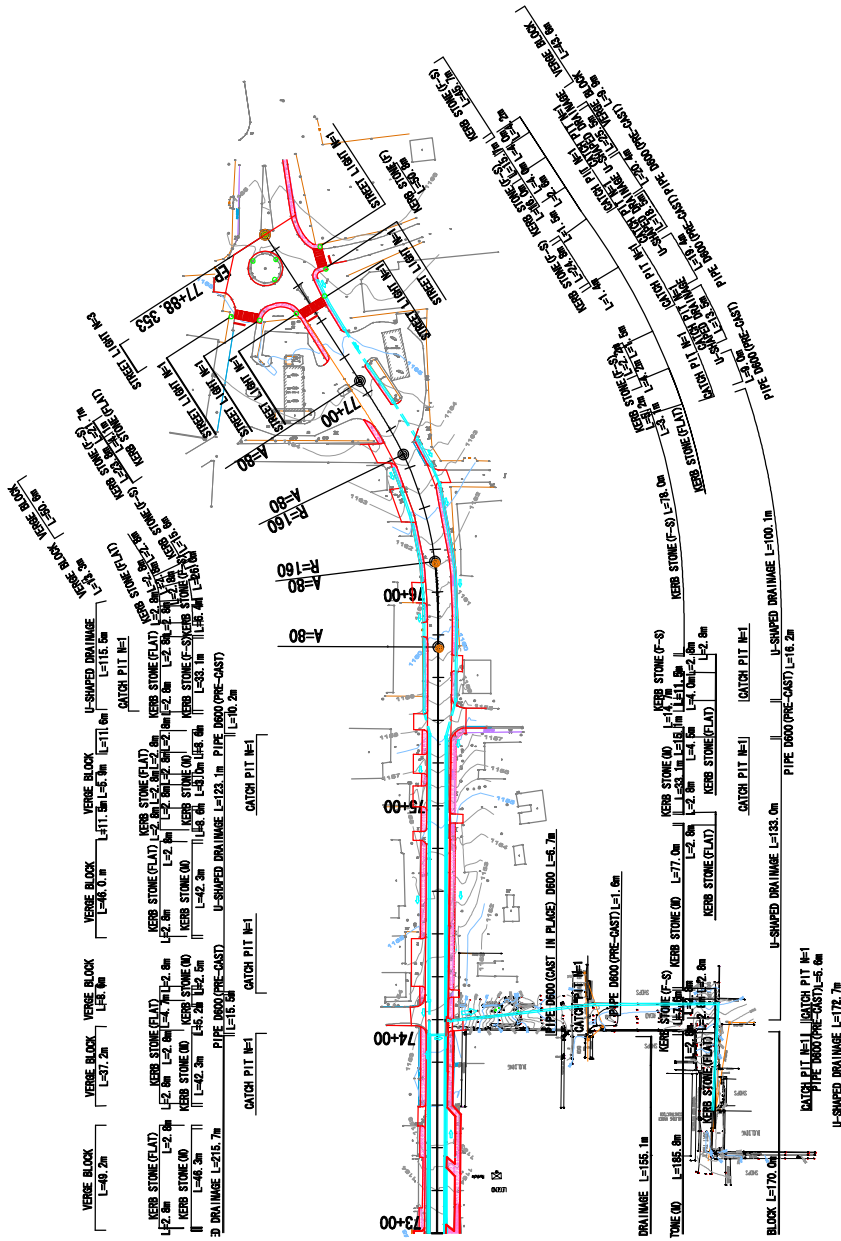

BLANTYRE CITY ASSEMBLY THE REPUBLIC OF MALAWI	JAPAN INTERNATIONAL COOPERATION AGENCY KATAHIRA & ENGINEERS INTERNATIONAL	THE PREPARATORY SURVEY ON THE PROJECT FOR THE IMPROVEMENT OF BLANTYRE CITY ROADS IN THE REPUBLIC OF MALAWI	TITLE:	PLM (7/7) (STA. 73+00'EP)	Drawing No.	PL - 7
					SCALE	S=1:2500
					DATE	