

PLAN (1)  
S=1:2500  
CHIPIMBERE HIGHWAY AND LIVINGSTONE AVENUE

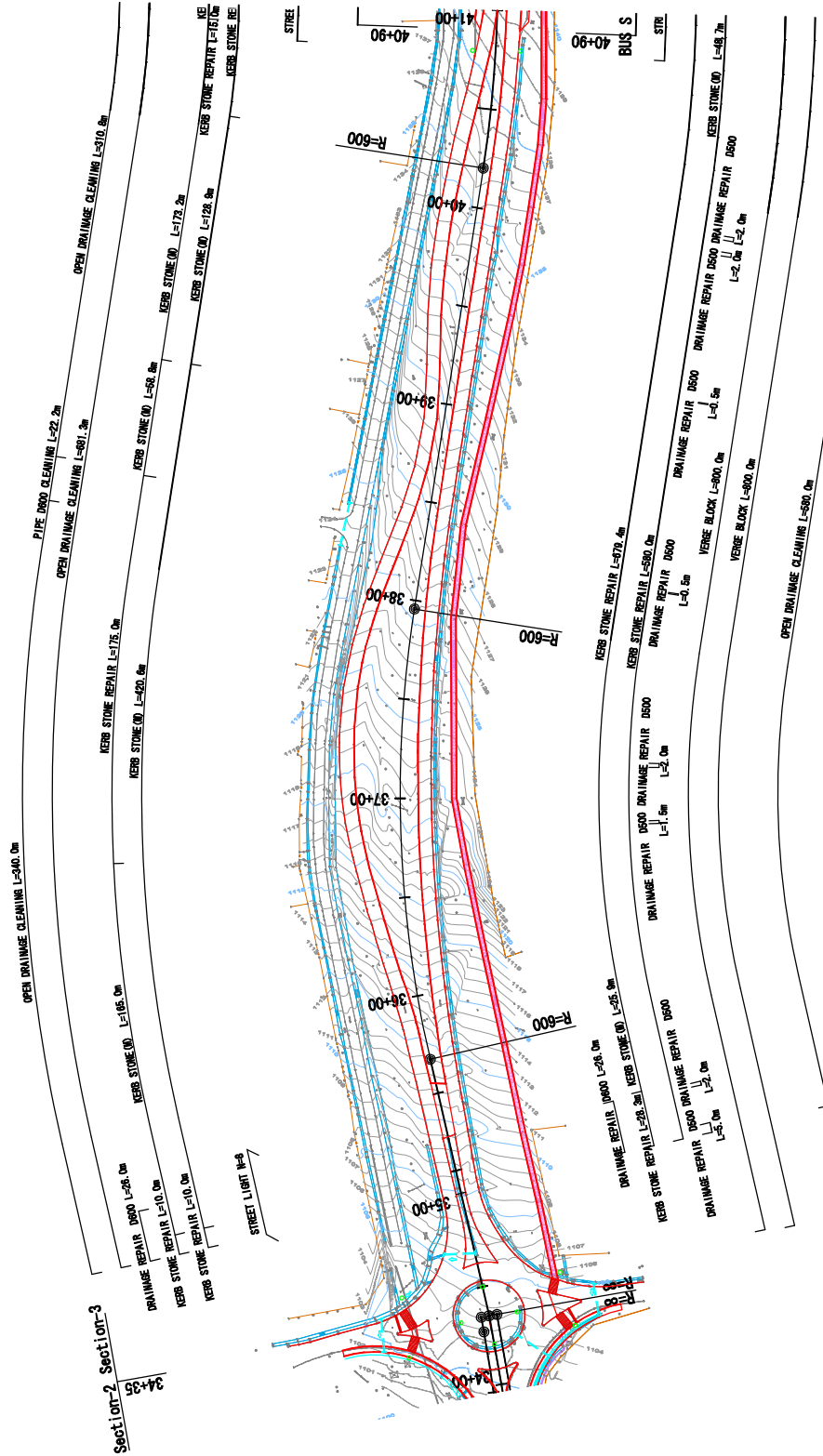

BLANTYRE CITY ASSEMBLY THE REPUBLIC OF MALAWI	JAPAN INTERNATIONAL COOPERATION AGENCY KATAHIRA & ENGINEERS INTERNATIONAL	THE PREPARATORY SURVEY ON THE PROJECT FOR THE IMPROVEMENT OF BLANTYRE CITY ROADS IN THE REPUBLIC OF MALAWI	Drawing No. P L - 1 SCALE S=1:2500 DATE TITLE: PLAN (1/7) (STA. 34+00~41+00)
--	---	--	---

PLAN (2)  
S=1:2500  
(CHIPEMBE HIGHWAY AND LIVINGSTONE AVENUE)

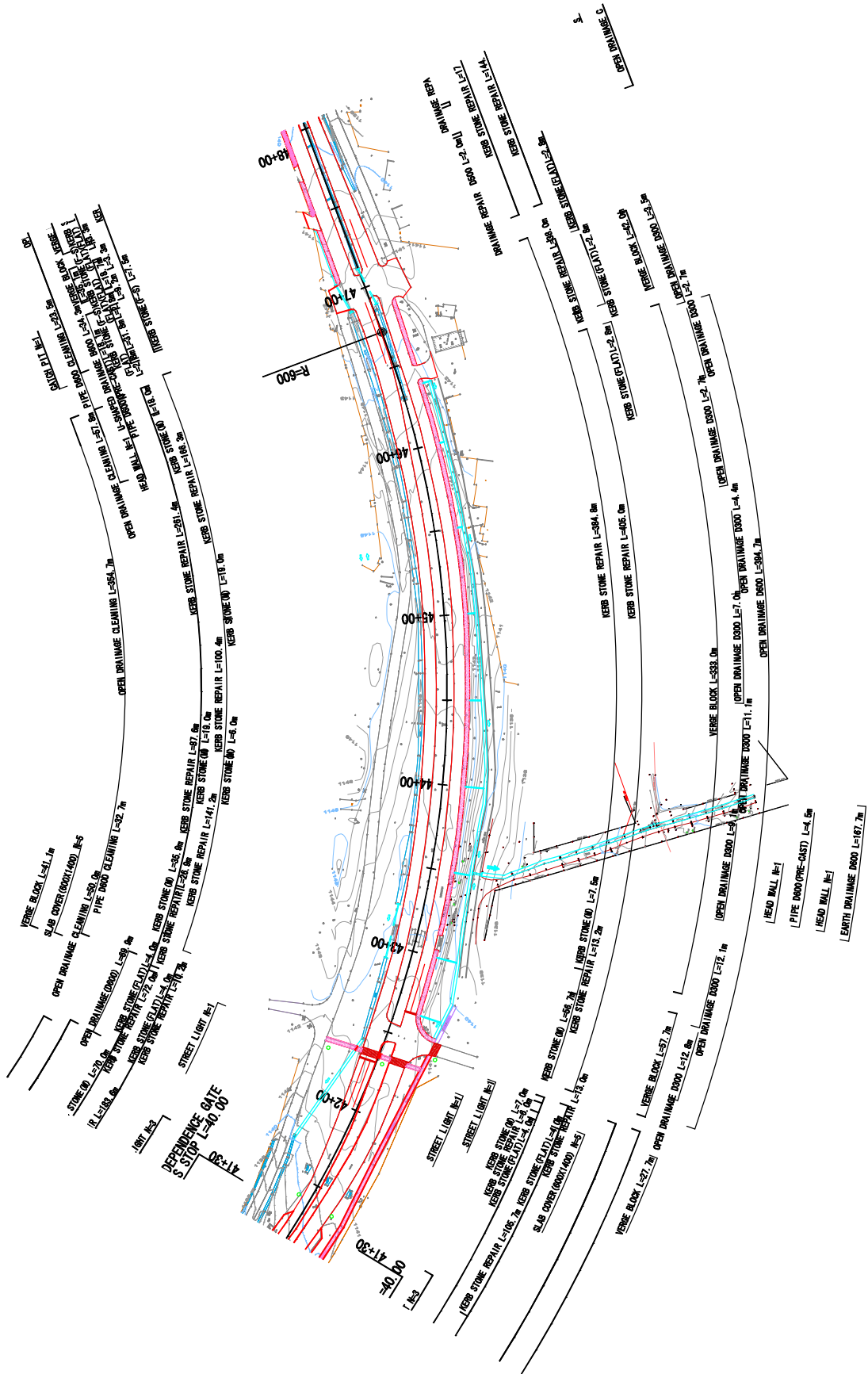

BLANTYRE CITY ASSEMBLY THE REPUBLIC OF MALAWI	JAPAN INTERNATIONAL COOPERATION AGENCY KATAHIRA & ENGINEERS INTERNATIONAL	THE PREPARATORY SURVEY ON THE PROJECT FOR THE IMPROVEMENT OF BLANTYRE CITY ROADS IN THE REPUBLIC OF MALAWI	Drawing No.	P L - 2
			SCALE	S=1:2500
TITLE:			DATE	

# PLAN (3)

S=1:2500

(CHIPEMBERE HIGHWAY AND LIVINGSTONE AVENUE)

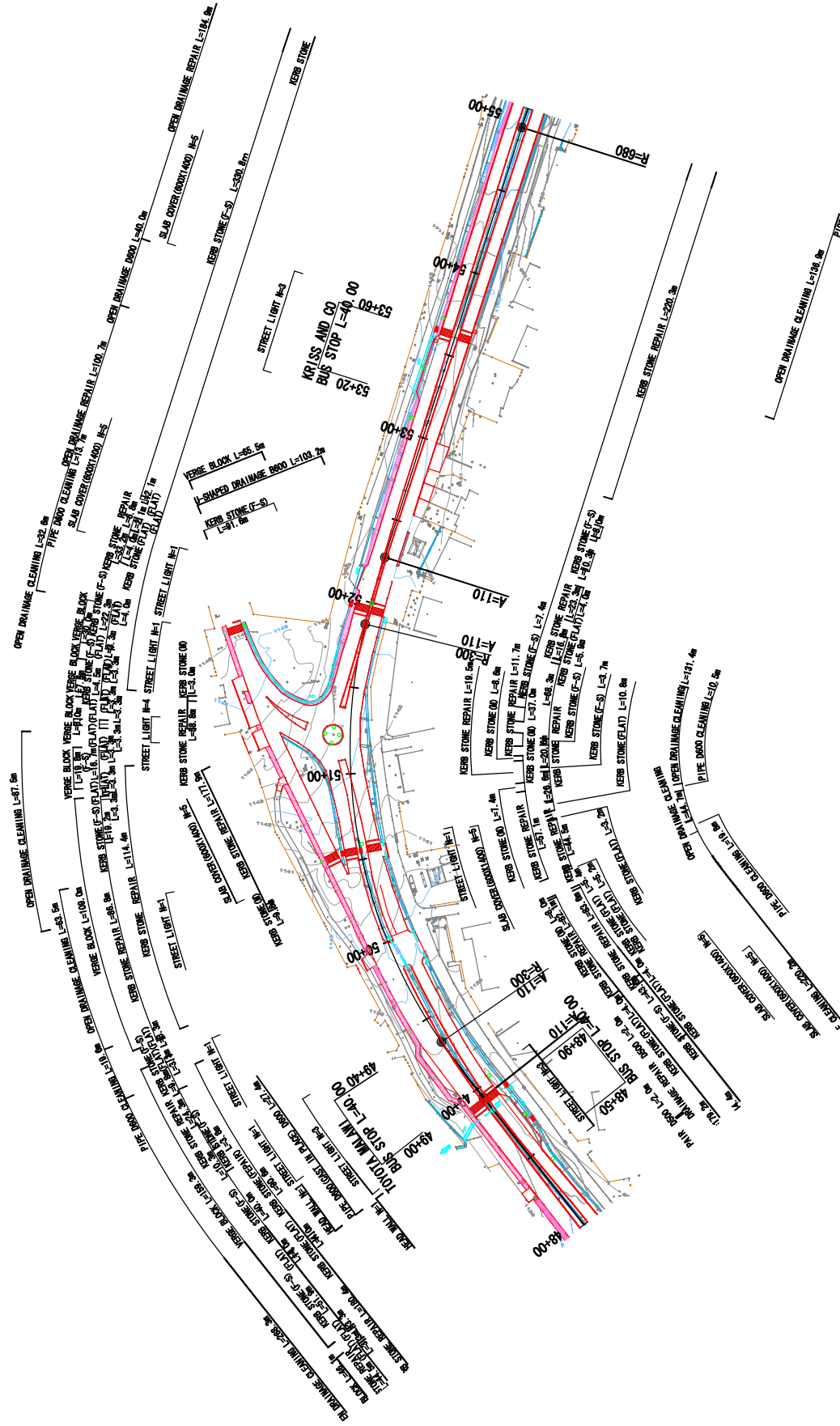

BLANTYRE CITY ASSEMBLY THE REPUBLIC OF MALAWI	JAPAN INTERNATIONAL COOPERATION AGENCY KATAHIRA & ENGINEERS INTERNATIONAL	THE PREPARATORY SURVEY ON THE PROJECT FOR THE IMPROVEMENT OF BLANTYRE CITY ROADS IN THE REPUBLIC OF MALAWI	TITLE:	PLM (3/7) (STA. 48+00-55+00)	Drawing No.	P L - 3
					SCALE	S=1:2500
					DATE	

PLAN (4)  
S=1:2500  
(CHIPIMBERE HIGHWAY AND LIVINGSTONE AVENUE)

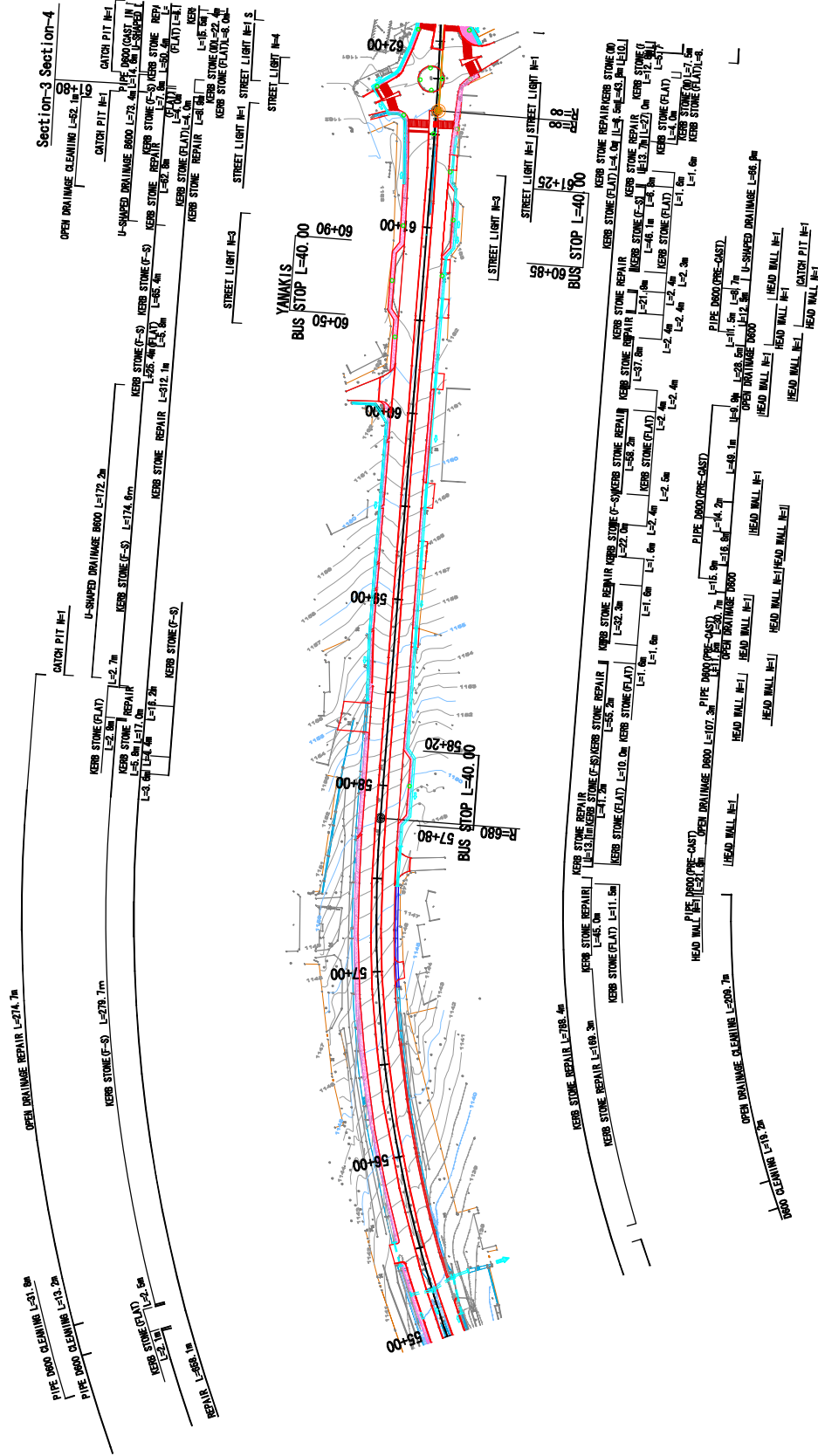

BLANTYRE CITY ASSEMBLY THE REPUBLIC OF MALAWI	JAPAN INTERNATIONAL COOPERATION AGENCY KATAHIRA & ENGINEERS INTERNATIONAL	THE PREPARATORY SURVEY ON THE PROJECT FOR THE IMPROVEMENT OF BLANTYRE CITY ROADS IN THE REPUBLIC OF MALAWI	TITLE:	PLM (4/7) (STA. 55+00~62+00)	Drawing No. P L - 4
					SCALE S=1:2500
				DATE	

# PLAN (5)

S=1:2500

(CHIPEMBERE HIGHWAY AND LIVINGSTONE AVENUE)

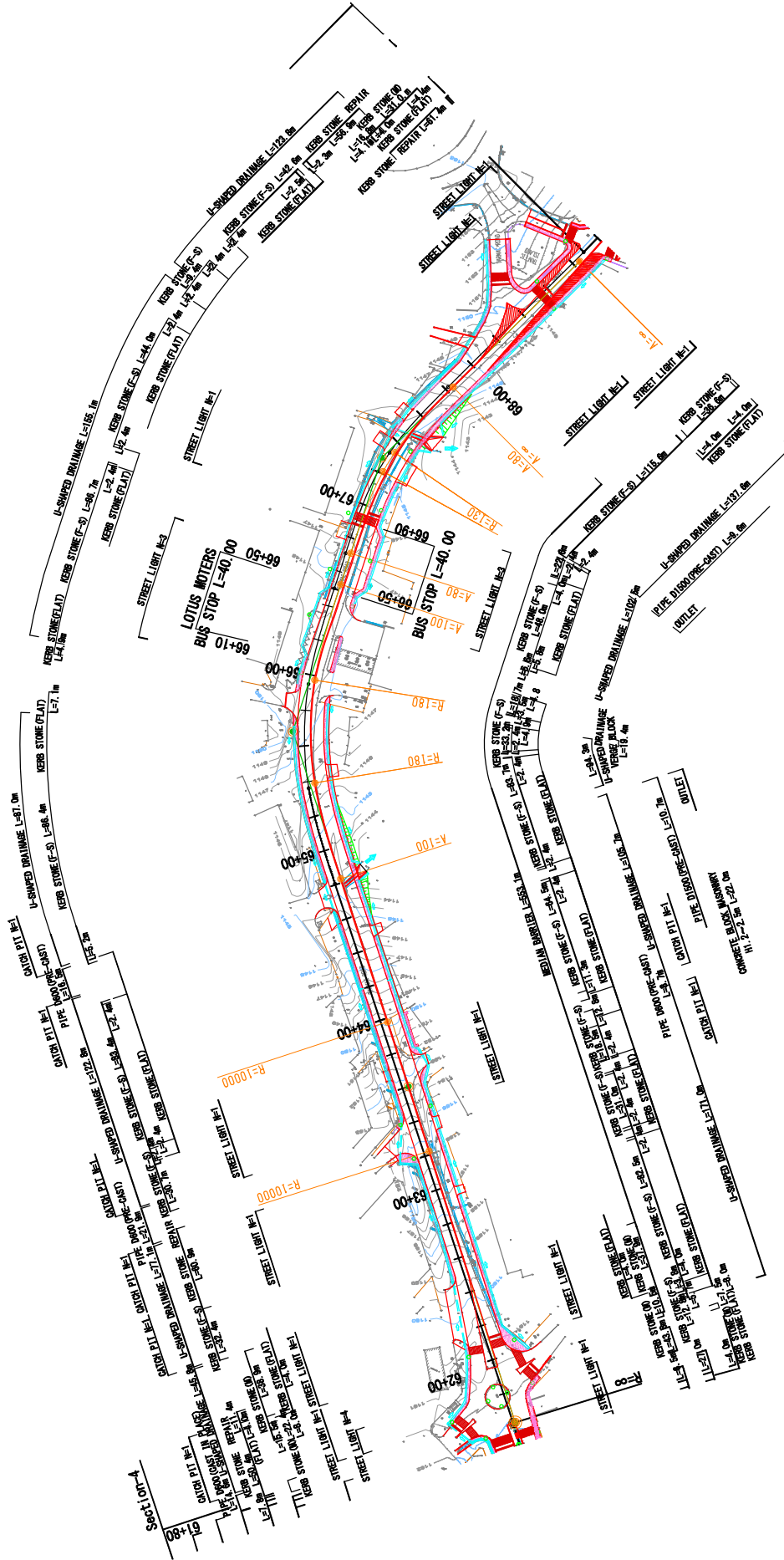

BLANTYRE CITY ASSEMBLY  
THE REPUBLIC OF MALAWI

JAPAN INTERNATIONAL  
COOPERATION AGENCY  
KATAHIRA & ENGINEERS INTERNATIONAL

THE PREPARATORY SURVEY  
ON THE PROJECT FOR THE IMPROVEMENT  
OF BLANTYRE CITY ROADS  
IN  
THE REPUBLIC OF MALAWI

PLAN (5/7)  
(STA. 62+00~69+00)

Drawing No.	P L - 5
SCALE	S=1:2500
DATE	

PLAN (6) S=1:2500  
 (CHIPEMBERE HIGHWAY AND LIVINGSTONE AVENUE)

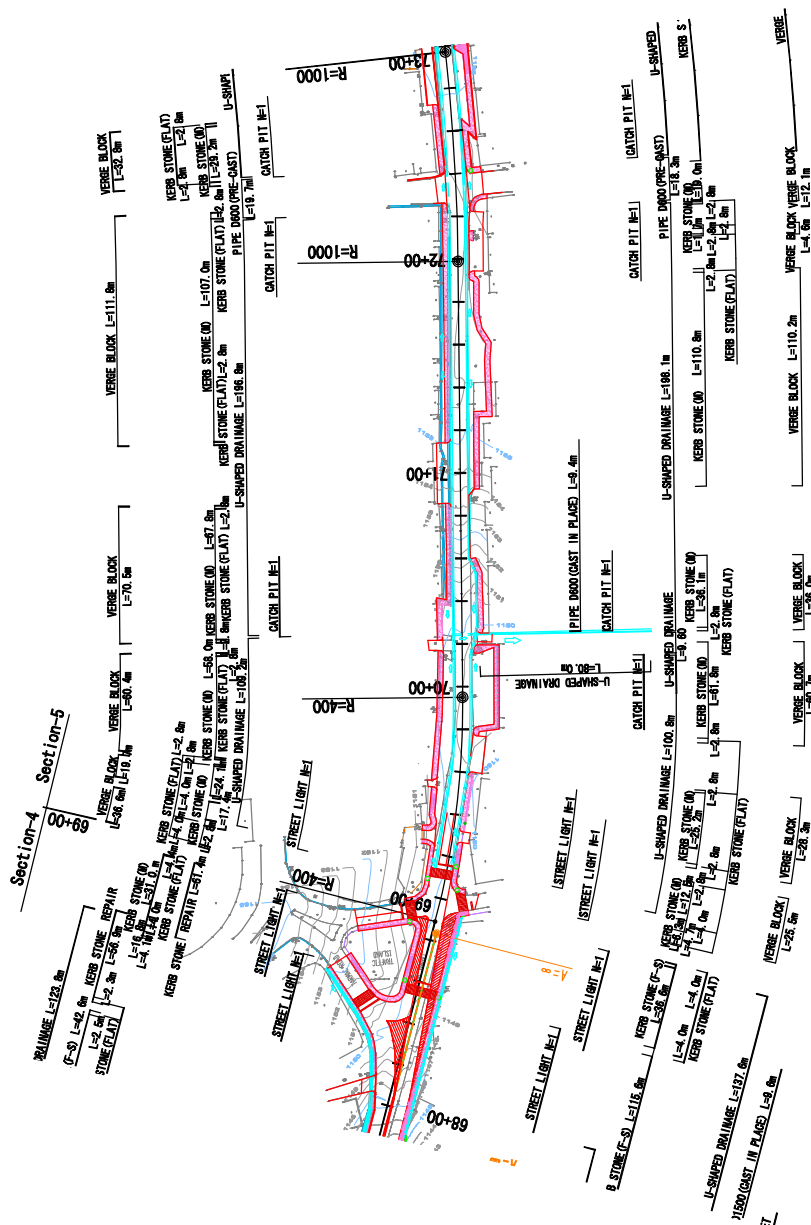

BLANTYRE CITY ASSEMBLY THE REPUBLIC OF MALAWI	JAPAN INTERNATIONAL COOPERATION AGENCY KATAHIRA & ENGINEERS INTERNATIONAL	THE PREPARATORY SURVEY ON THE PROJECT FOR THE IMPROVEMENT OF BLANTYRE CITY ROADS IN THE REPUBLIC OF MALAWI	Drawing No.	P L - 6
			SCALE	S=1:2500
			DATE	

# PLAN (7)

(CHIPIMBERE HIGHWAY AND LIVINGSTONE AVENUE)

S=1:2500

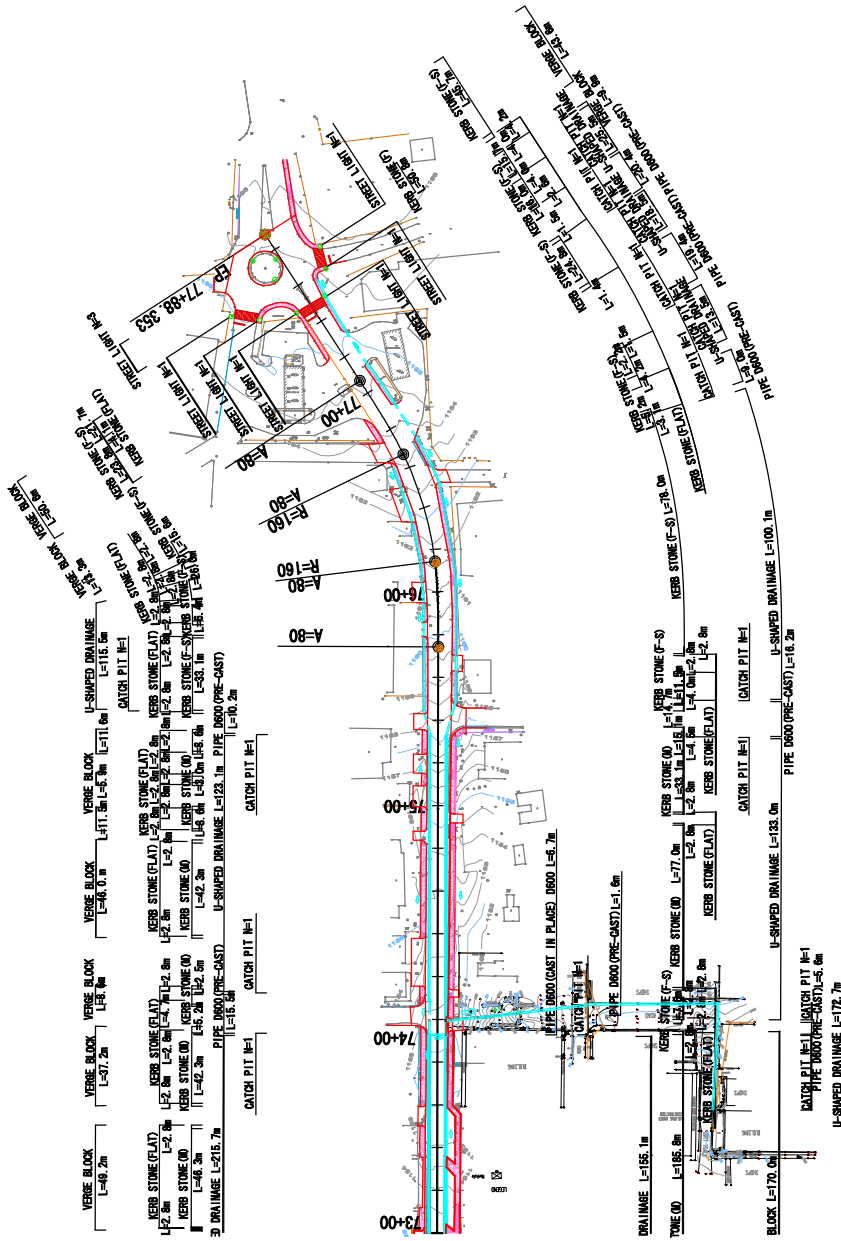

BLANTYRE CITY ASSEMBLY THE REPUBLIC OF MALAWI	JAPAN INTERNATIONAL COOPERATION AGENCY KATAHIRA & ENGINEERS INTERNATIONAL	THE PREPARATORY SURVEY ON THE PROJECT FOR THE IMPROVEMENT OF BLANTYRE CITY ROADS IN THE REPUBLIC OF MALAWI	TITLE:	PLM (7/7) (STA. 73+00'EP)	Drawing No.	PL - 7
					SCALE	S=1:2500
					DATE	