

5-4 GENERAL VIEW OF THAKUR KHOLA-3 BRIDGE

PROFILE S=1:500

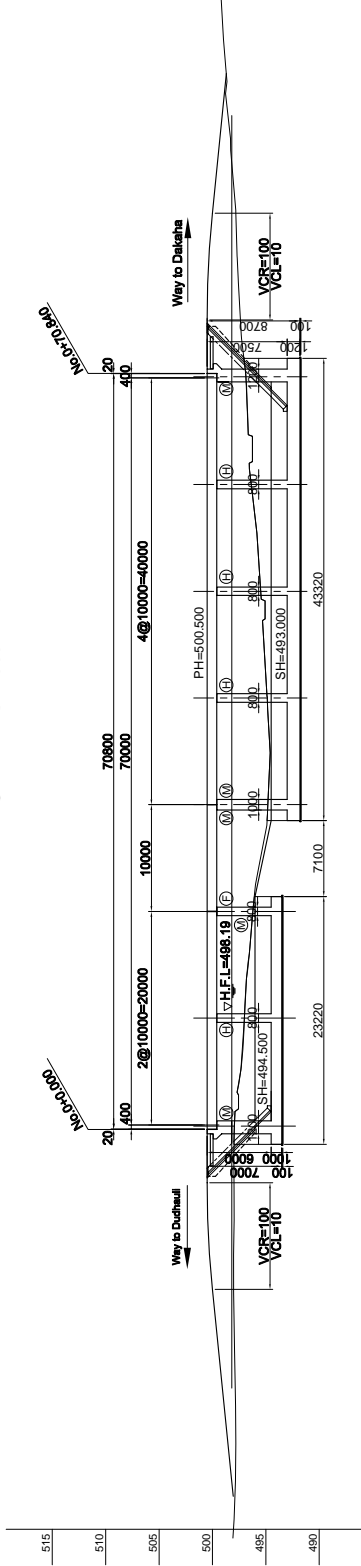

GRADE	PROPOSED HEIGHT	GROUND HEIGHT	STATION	CURVE ELEMENT	SUPER ELEVATION
498.060	498.06	498.06	-0-34.400		
498.000	498.00	498.00	-0-20.000		
499.500	499.50	499.50	-0-10.000		
500.375	500.375	500.375	-0-10.000		
498.000	498.00	498.00	-0-10.000		
497.94	497.94	497.94	-0+0.000		
500.500	500.500	500.500	+0-20.000		
496.24	496.24	496.24	+0-20.000		
500.500	500.500	500.500	+0-40.000		
494.85	494.85	494.85	+0-40.000		
500.500	500.500	500.500	+0-60.000		
496.31	496.31	496.31	+0-60.000		
500.500	500.500	500.500	+0-80.000		
497.65	497.65	497.65	+0-80.000		
500.413	500.413	500.413	+0-80.000		
500.500	500.500	500.500	+0-98.940		

TYPICAL CROSS SECTION S=1:200

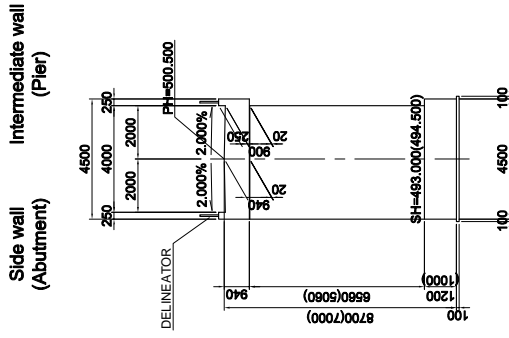

APPROACH ROAD S=1:200

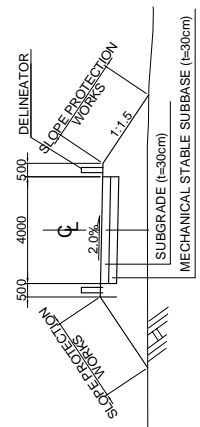

PLAN S=1:500

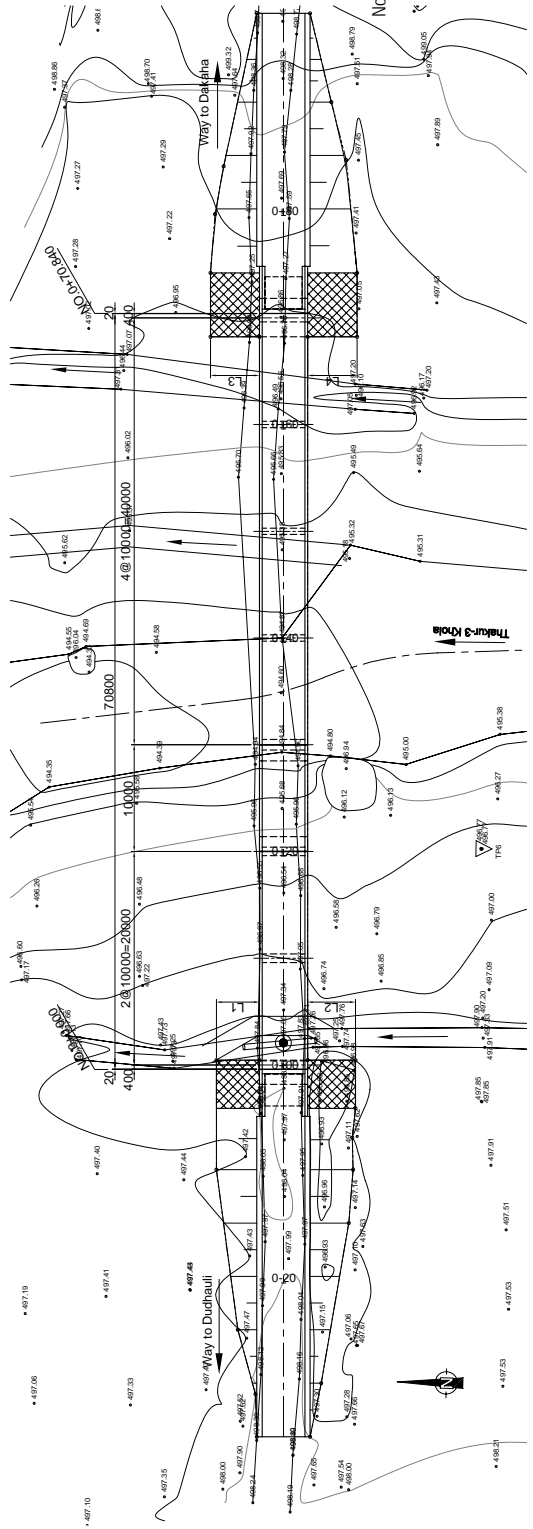

Note: The details around abutments including the lengths of L1, L2, L3 and L4 will be determined based on the actual site condition. The contractor has to prepare the shop drawings for the shape and dimension of embankment slopes, retaining walls and other structures necessary to complete the works based on the site condition for approval of the engineer. No claim except adjustment of quantities shall be made by this adjustment.

OUTLINE DESIGN OF RIVER CROSSING STRUCTURES	THE PROJECT FOR THE IMPROVEMENT OF COMMUNITY ACCESS IN NEPAL LOT - 6	DRAWING TITLE:		PROVINCE	Sindhuli
		5-4 GENERAL VIEW OF THAKUR KHOLA-3 BRIDGE		ROAD NAME	Dakaha-Sindhuli-Dudhauli-Katari
		SCALE		SITE NO.	5-4
		AS SHOWN		RIVER NAME	THAKUR KHOLA-3
				DRAWING NO.	16

5-3 GENERAL VIEW OF THAKUR KHOLA-2 BRIDGE

PROFILE S=1:500

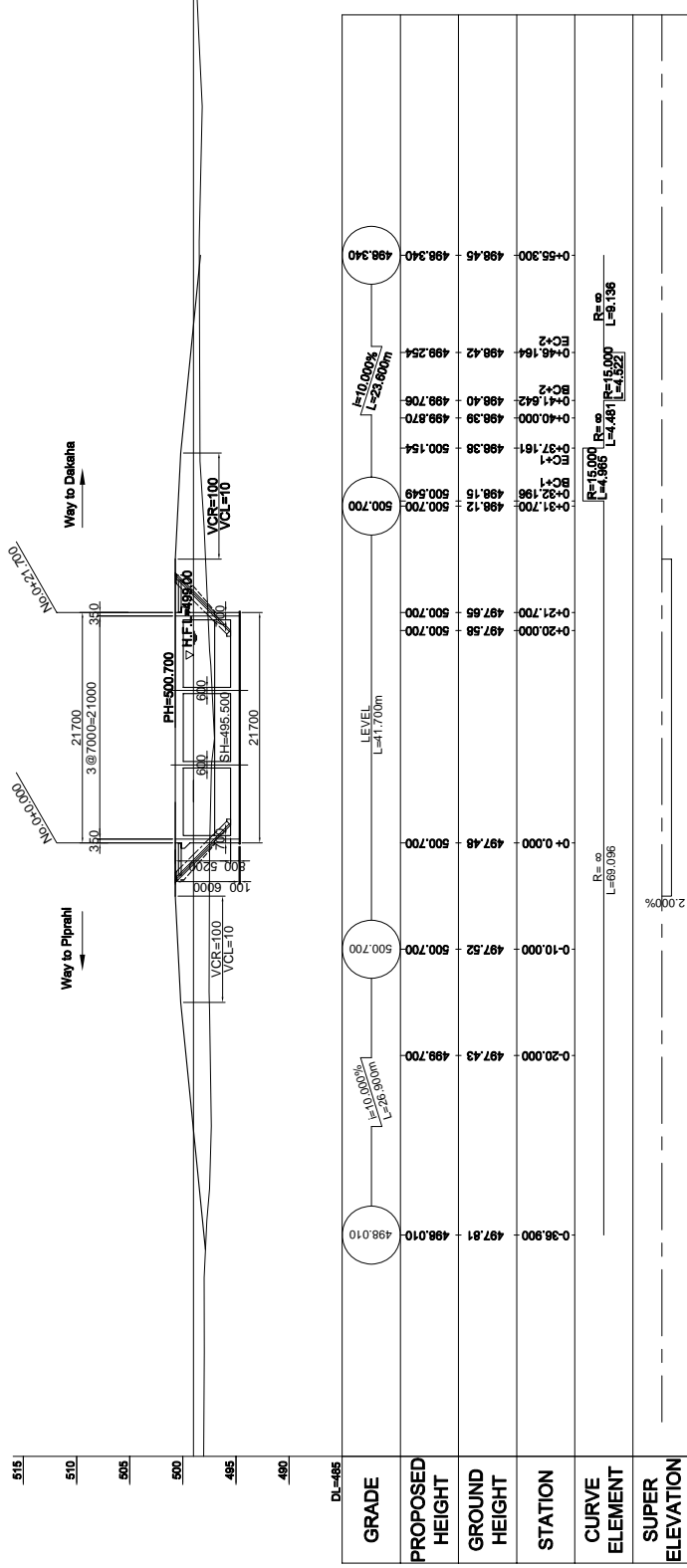

TYPICAL CROSS SECTION S=1:200

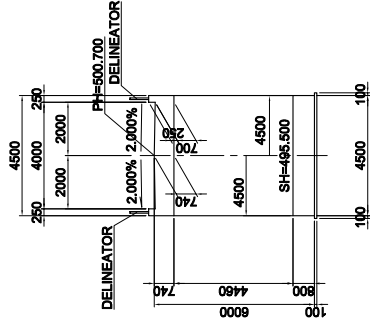

APPROACH ROAD S=1:200

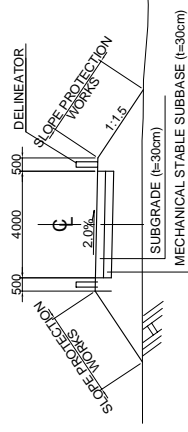

PLAN S=1:500

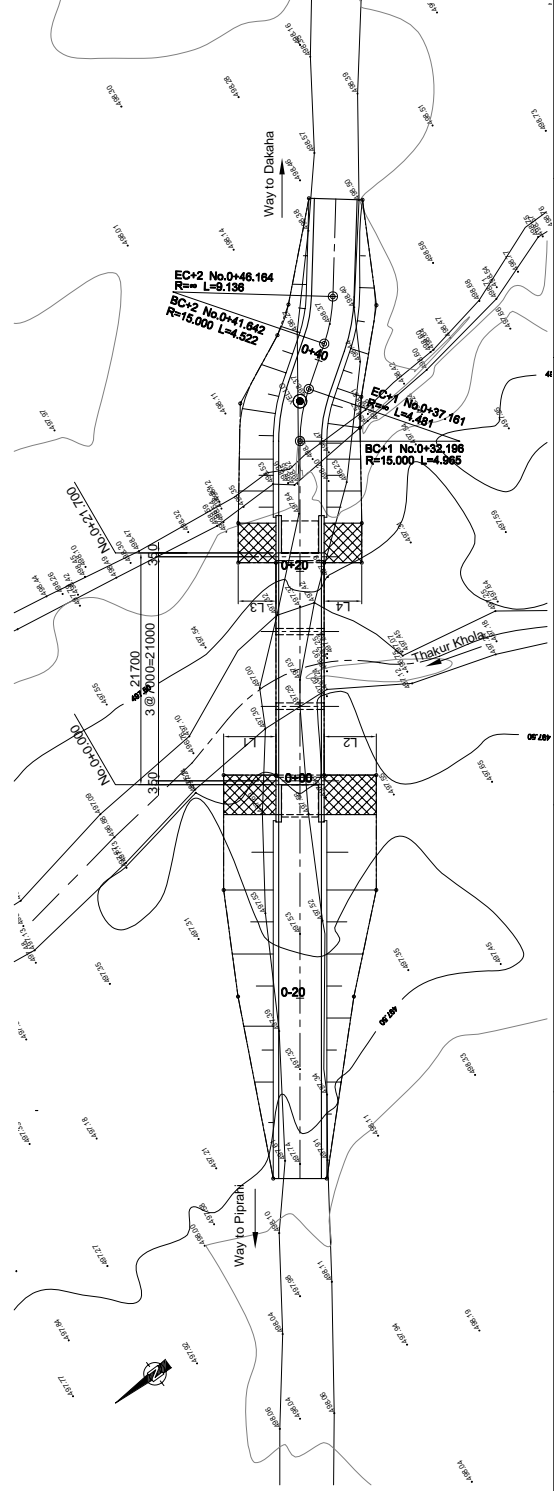

Note: The details around abutments including the lengths of L1, L2, L3 and L4 will be determined based on the actual site condition. The contractor has to prepare the shop drawings for the shape and dimension of embankment slopes, retaining walls and other structures necessary to complete the works based on the site condition for approval of the engineer. No claim except adjustment of quantities shall be made by this adjustment.

OUTLINE DESIGN OF RIVER CROSSING STRUCTURES LOT - 6	DRAWING TITLE:		PROVINCE	Sindhuli	DRAWING NO.	
	5-3 GENERAL VIEW OF THAKUR KHOLA-2 BRIDGE		ROAD NAME	Dakaha-Sindhuli-Dudhauhi-Katari	SCALE	AS SHOWN
			SITE NO.	5-3		17
			RIVER NAME	THAKUR KHOLA-2		

5-1 GENERAL VIEW OF TAMORNI KHOLA BRIDGE

PROFILE S=1:500

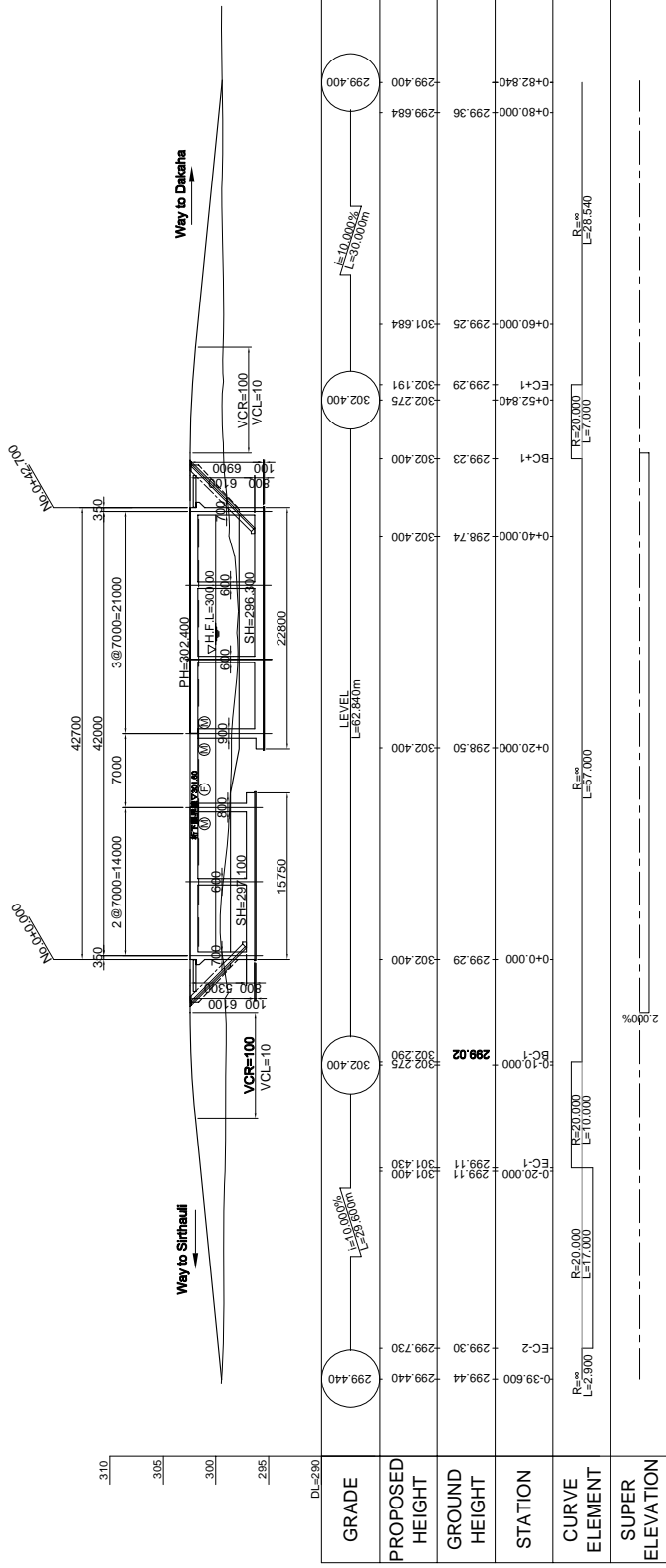

TYPICAL CROSS SECTION

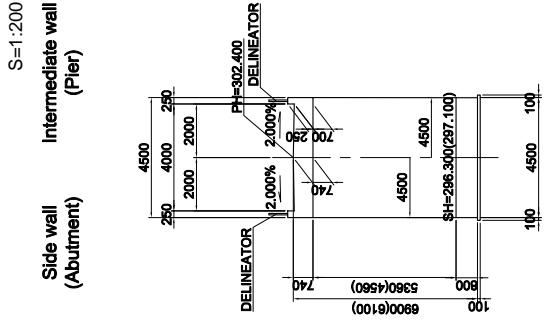

PLAN S=1:500

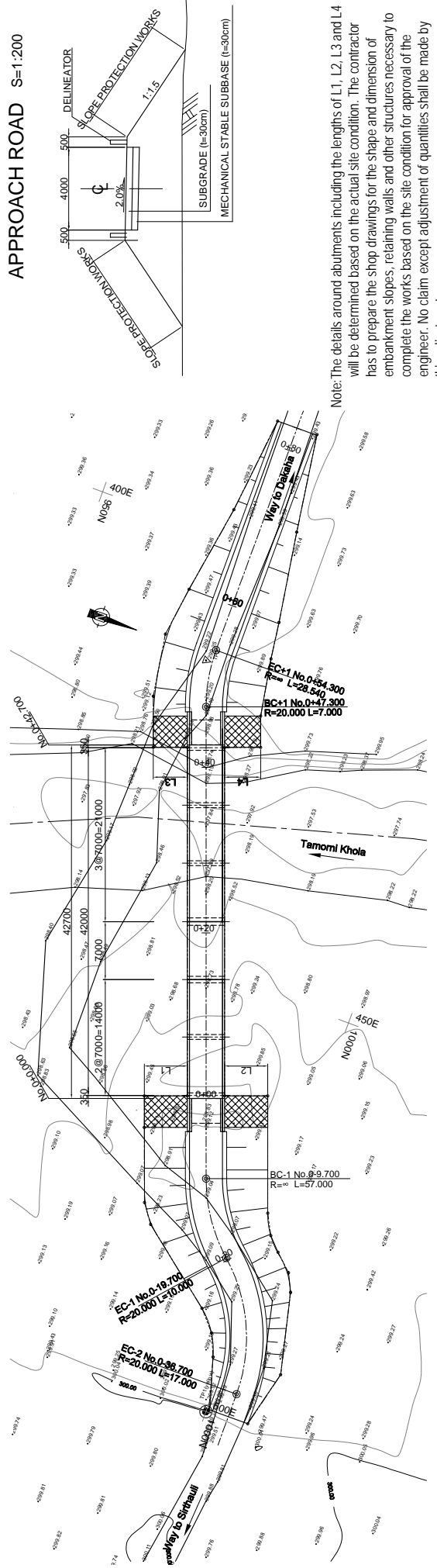

Note: The details around abutments including the lengths of L1, L2, L3 and L4 will be determined based on the actual site condition. The contractor has to prepare the shop drawings for the shape and dimension of embankment slopes, retaining walls and other structures necessary to complete the works based on the site condition for approval of the engineer. No claim except adjustment of quantities shall be made by this adjustment.

OUTLINE DESIGN OF RIVER CROSSING STRUCTURES	THE PROJECT FOR THE IMPROVEMENT OF COMMUNITY ACCESS IN NEPAL LOT - 6	DRAWING TITLE:		PROVINCE	Sindhuli	SCALE	DRAWING NO.
		5-1 GENERAL VIEW OF TAMORNI KHOLA BRIDGE		ROAD NAME	Dakrha Sindhuli Dudhauli Katari	AS SHOWN	19
				SITE NO.	5-1		
				RIVER NAME	TAMORNI KHOLA		

13-6 GENERAL VIEW OF KHALTE KHOLA BRIDGE

PROFILE S=1:400

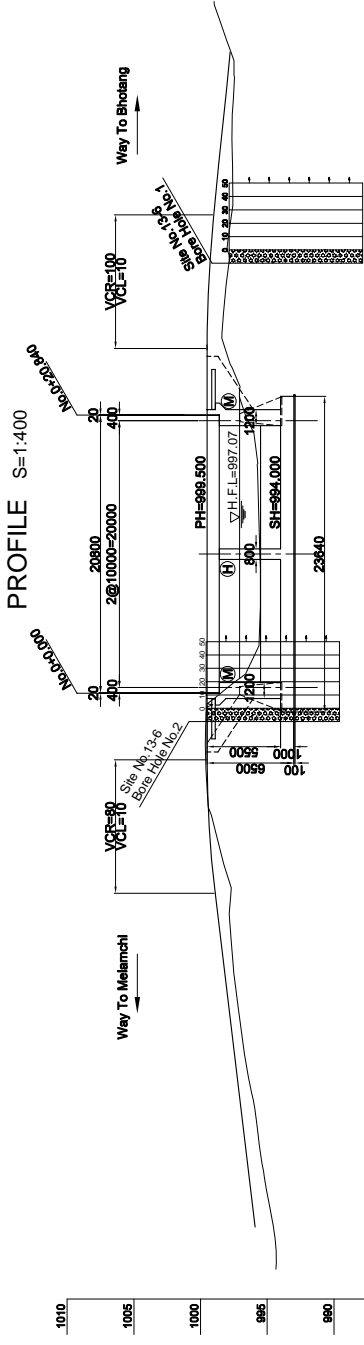

GRADE	PROPOSED HEIGHT	GROUND HEIGHT	STATION	CURVE ELEMENT	SUPER ELEVATION
995.900	995.900	994.54	-0+40.000		
998.300	999.350	998.714	-0+20.000		
998.300	999.350	998.714	-0+10.000	R=15,000 L=14.276	
999.500	999.500	998.49	+0+0.000		
999.500	999.500	998.24	+0+20.000		
999.500	999.375	998.61	+0+30.840		
997.780	997.780	998.584	+0+40.000	R=20,000 L=9.095	
997.780	997.780	997.71	+0+48.040		

PLAN S=1:400

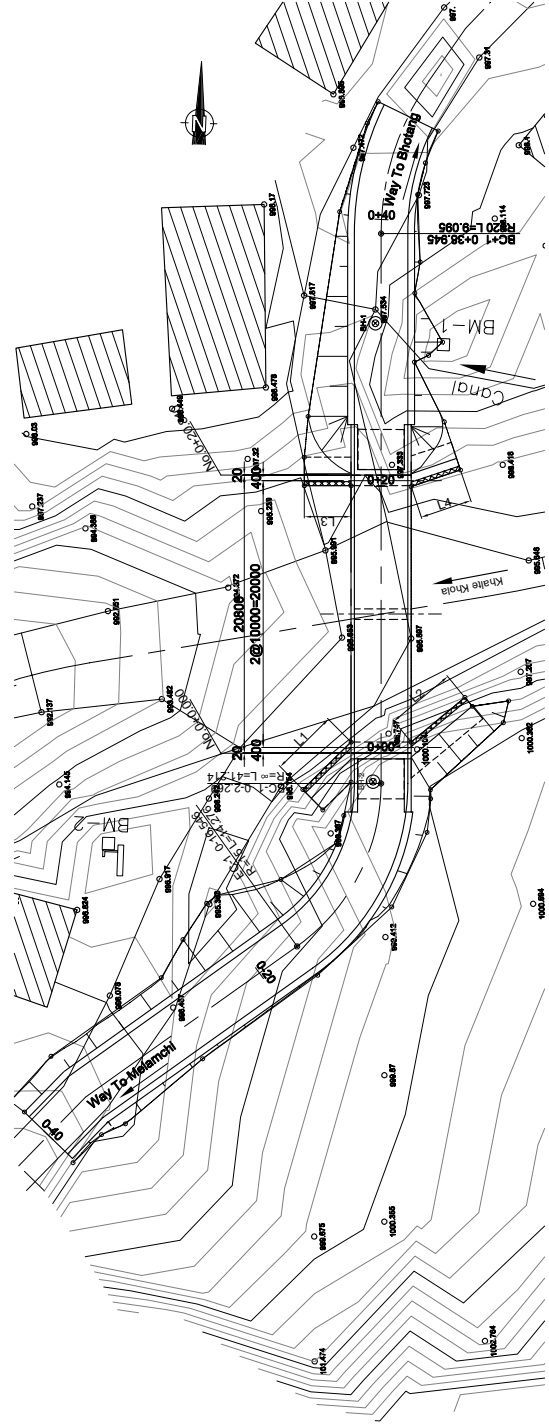

TYPICAL CROSS SECTION S=1:200

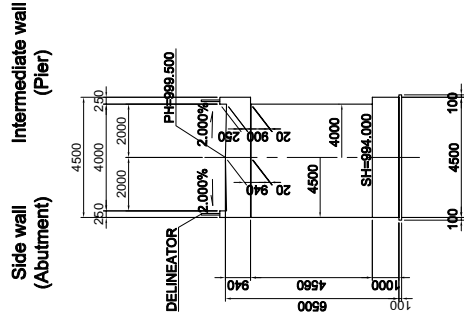

APPROACH ROAD S=1:200

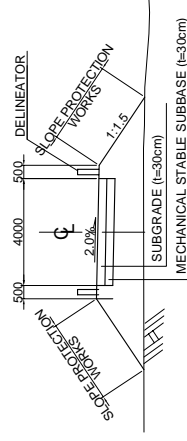

Note: The details around abutments including the lengths of L1, L2, L3 and L4 will be determined based on the actual site condition. The contractor has to prepare the shop drawings for the shape and dimension of embankment slopes, retaining walls and other structures necessary to complete the works based on the site condition for approval of the engineer. No claim except adjustment of quantities shall be made by this adjustment.

OUTLINE DESIGN OF RIVER CROSSING STRUCTURES	THE PROJECT FOR THE IMPROVEMENT OF COMMUNITY ACCESS IN NEPAL LOT - 7		DRAWING TITLE: 13-6 GENERAL VIEW OF KHALTE KHOLA BRIDGE		PROVINCE: Sindhupalchok	DRAWING NO: 20
	ROAD NAME: Melamchi-Bhotang	SITE NO: 13-6	RIVER NAME: KHALTE KHOLA	SCALE: AS SHOWN		

13-14 GENERAL VIEW OF HADI KHOLA BRIDGE

PROFILE S=1:500

TYPICAL CROSS SECTION SUPERSTRUCTURE S=1:100

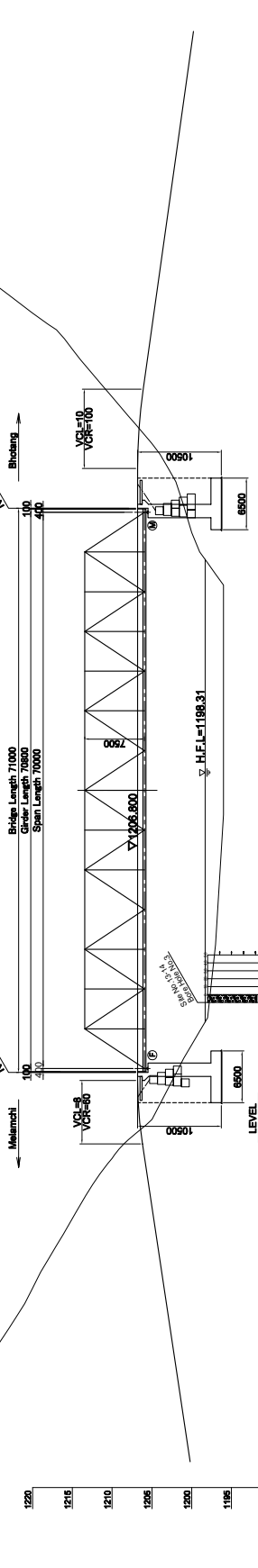
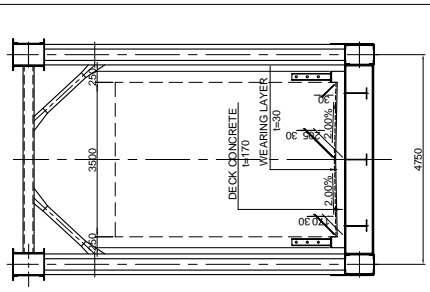

GRADE	PROPOSED HEIGHT	GROUND HEIGHT	STATION	CURVE ELEMENT	SUPER ELEVATION
1220.00			1200.20		
1218.00			1199.90		
1216.00			1200.80		
1214.00			1201.50		
1212.00			1201.975		
1210.00			1202.45		
1208.00			1202.925		
1206.00			1203.40		
1204.00			1203.875		
1202.00			1204.35		
1200.00			1204.825		
1198.00			1205.30		
1196.00			1205.775		
1194.00			1206.25		
1192.00			1206.725		
1190.00			1207.20		
1188.00			1207.675		
1186.00			1208.15		
1184.00			1208.625		
1182.00			1209.10		
1180.00			1209.575		
1178.00			1210.05		
1176.00			1210.525		
1174.00			1211.00		
1172.00			1211.475		
1170.00			1211.95		
1168.00			1212.425		
1166.00			1212.90		
1164.00			1213.375		
1162.00			1213.85		
1160.00			1214.325		
1158.00			1214.80		
1156.00			1215.275		
1154.00			1215.75		
1152.00			1216.225		
1150.00			1216.70		
1148.00			1217.175		
1146.00			1217.65		
1144.00			1218.125		
1142.00			1218.60		
1140.00			1219.075		
1138.00			1219.55		
1136.00			1220.025		
1134.00			1220.50		
1132.00			1220.975		
1130.00			1221.45		
1128.00			1221.925		
1126.00			1222.40		
1124.00			1222.875		
1122.00			1223.35		
1120.00			1223.825		
1118.00			1224.30		
1116.00			1224.775		
1114.00			1225.25		
1112.00			1225.725		
1110.00			1226.20		
1108.00			1226.675		
1106.00			1227.15		
1104.00			1227.625		
1102.00			1228.10		
1100.00			1228.575		
1098.00			1229.05		
1096.00			1229.525		
1094.00			1230.00		
1092.00			1230.475		
1090.00			1230.95		
1088.00			1231.425		
1086.00			1231.90		
1084.00			1232.375		
1082.00			1232.85		
1080.00			1233.325		
1078.00			1233.80		
1076.00			1234.275		
1074.00			1234.75		
1072.00			1235.225		
1070.00			1235.70		
1068.00			1236.175		
1066.00			1236.65		
1064.00			1237.125		
1062.00			1237.60		
1060.00			1238.075		
1058.00			1238.55		
1056.00			1239.025		
1054.00			1239.50		
1052.00			1239.975		
1050.00			1240.45		
1048.00			1240.925		
1046.00			1241.40		
1044.00			1241.875		
1042.00			1242.35		
1040.00			1242.825		
1038.00			1243.30		
1036.00			1243.775		
1034.00			1244.25		
1032.00			1244.725		
1030.00			1245.20		
1028.00			1245.675		
1026.00			1246.15		
1024.00			1246.625		
1022.00			1247.10		
1020.00			1247.575		
1018.00			1248.05		
1016.00			1248.525		
1014.00			1249.00		
1012.00			1249.475		
1010.00			1250.00		
1008.00			1250.475		
1006.00			1250.95		
1004.00			1251.425		
1002.00			1251.90		
1000.00			1252.375		
998.00			1252.85		
996.00			1253.325		
994.00			1253.80		
992.00			1254.275		
990.00			1254.75		
988.00			1255.225		
986.00			1255.70		
984.00			1256.175		
982.00			1256.65		
980.00			1257.125		
978.00			1257.60		
976.00			1258.075		
974.00			1258.55		
972.00			1259.025		
970.00			1259.50		
968.00			1260.00		
966.00			1260.475		
964.00			1260.95		
962.00			1261.425		
960.00			1261.90		
958.00			1262.375		
956.00			1262.85		
954.00			1263.325		
952.00			1263.80		
950.00			1264.275		
948.00			1264.75		
946.00			1265.225		
944.00			1265.70		
942.00			1266.175		
940.00			1266.65		
938.00			1267.125		
936.00			1267.60		
934.00			1268.075		
932.00			1268.55		
930.00			1269.025		
928.00			1269.50		
926.00			1270.00		
924.00			1270.475		
922.00			1270.95		
920.00			1271.425		
918.00			1271.90		
916.00			1272.375		
914.00			1272.85		
912.00			1273.325		
910.00			1273.80		
908.00			1274.275		
906.00			1274.75		
904.00			1275.225		
902.00			1275.70		
900.00			1276.175		
898.00			1276.65		
896.00			1277.125		
894.00			1277.60		
892.00			1278.075		
890.00			1278.55		
888.00			1279.025		
886.00			1279.50		
884.00			1280.00		
882.00			1280.475		
880.00			1280.95		
878.00			1281.425		
876.00			1281.90		
874.00			1282.375		
872.00			1282.85		
870.00			1283.325		
868.00			1283.80		
866.00			1284.275		
864.00			1284.75		
862.00			1285.225		
860.00			1285.70		
858.00			1286.175		
856.00			1286.65		
854.00			1287.125		
852.00			1287.60		
850.00			1288.075		
848.00			1288.55		
846.00			1289.025		
844.00			1289.50		
842.00			1290.00		
840.00			1290.475		
838.00			1290.95		
836.00			1291.425		
834.00			1291.90		
832.00			1292.375		
830.00			1292.85		
828.00			1293.325		
826.00			1293.80		
824.00			1294.275		
822.00			1294.75		
820.00			1295.225		
818.00			1295.70		
816.00			1296.175		
814.00			1296.65		
812.00			1297.125		
810.00			1297.60		
808.00			1298.075		
806.00			1298.55		
804.00			1299.025		
802.00			1299.50		
800.00			1300.00		
798.00			1300.475		
796.00			1300.95		
794.00			1301.425		
792.00			1301.90		
790.00			1302.375		
788.00			1302.85		
786.00			1303.325		
784.00			1303.80		
782.00			1304.275		
780.00			1304.75		
778.00			1305.225		
776.00			1305.70		
774.00			1306.175		
772.00					

2-1 GENERAL VIEW OF MARIN KHOLA BRIDGE

PROFILE S=1:800

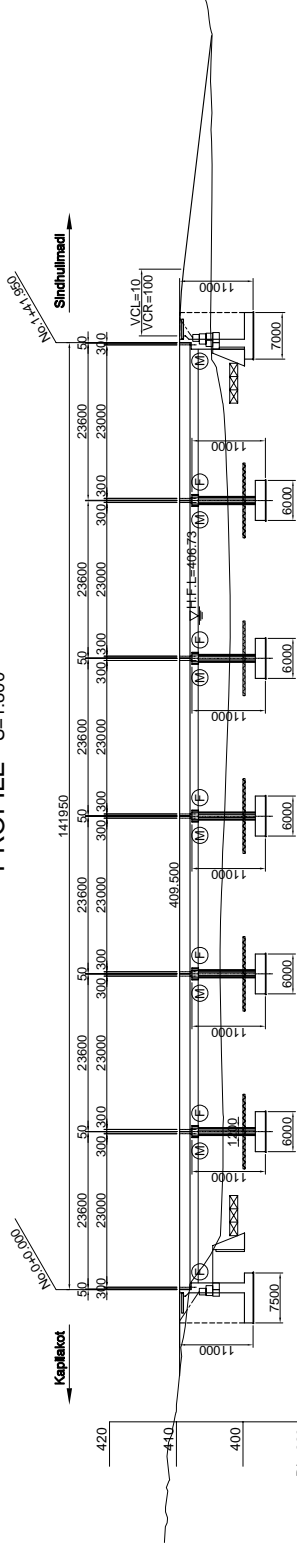

GRADE	PROPOSED HEIGHT	GROUND HEIGHT	STATION	CURVE ELEMENT	SUPER ELEVATION
DL=390			409.500		
			409.52		
			409.500		
			403.00		
			403.00		
			403.00		
			403.42		
			409.500		
			403.31		
			409.500		
			403.00		
			402.29		
			409.500		
			409.500		
			409.500		
			404.72		
			409.350		
			404.84		
			409.500		
			404.83		
			405.654		
			404.700		

TYPICAL CROSS SECTION SUPERSTRUCTURE S=1:100

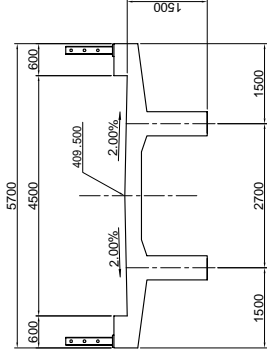

SUBSTRUCTURE S=1:200 A1 ABUTMENT P1 PIER

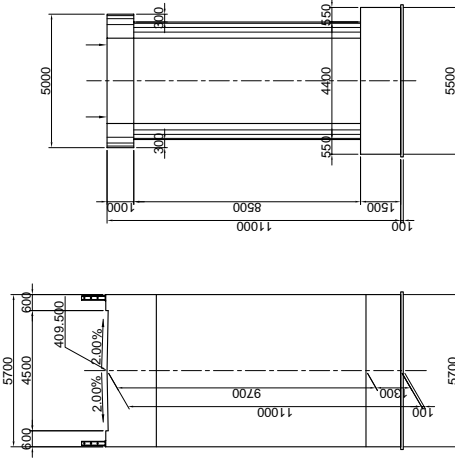

APPROACH ROAD S=1:200

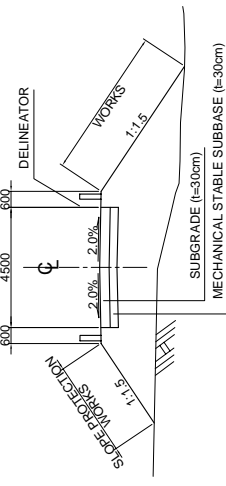

Note: The details around abutments including the lengths will be determined based on the actual site condition. The contractor has to prepare the shop drawings for the shape and dimension of embankment slopes; retaining walls and other structures necessary to complete the works based on the site condition for approval of the engineer. No claim except adjustment of quantities shall be made by this adjustment.

PLAN S=1:800

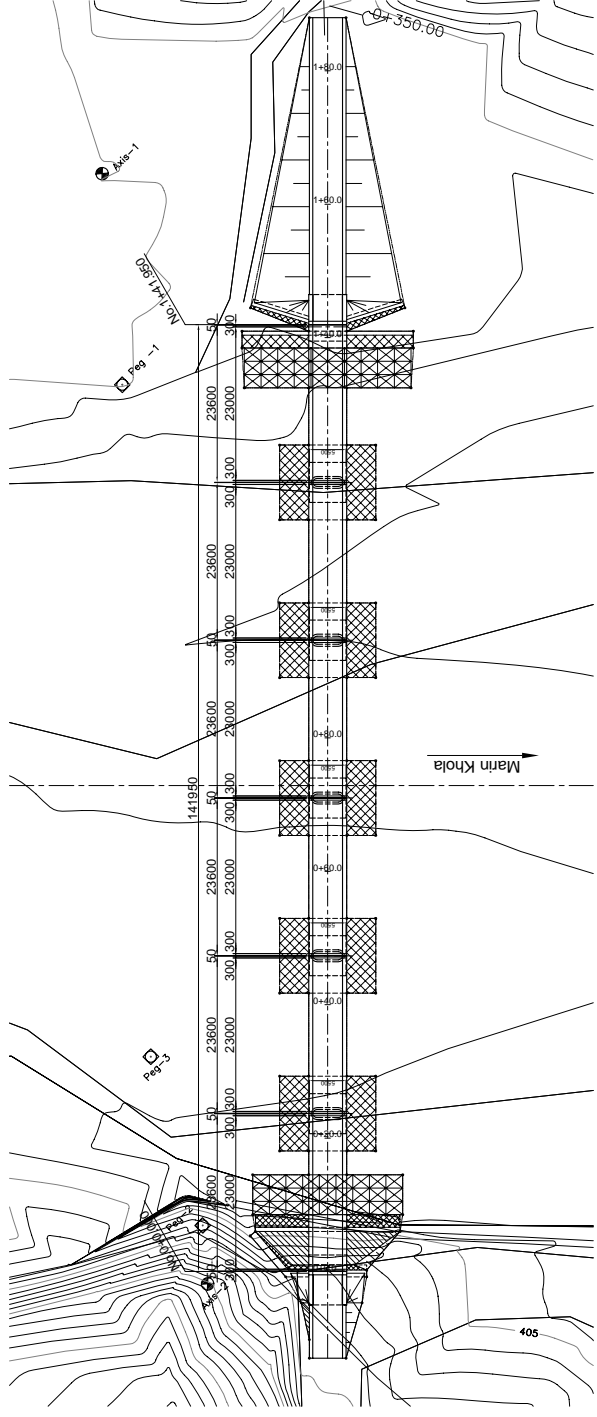

OUTLINE DESIGN OF RIVER CROSSING STRUCTURES LOT - 8	DRAWING TITLE: 2-1 GENERAL VIEW OF MARIN KHOLA BRIDGE		PROVINCE Sindhuli	SCALE AS SHOWN	DRAWING NO. 25
	THE PROJECT FOR THE IMPROVEMENT OF COMMUNITY ACCESS IN NEPAL		ROAD NAME Sindhulimadhi-Kapilakot	RIVER NAME MARIN KHOLA	

2-5 GENERAL VIEW OF DEVJOR KHOLA BRIDGE

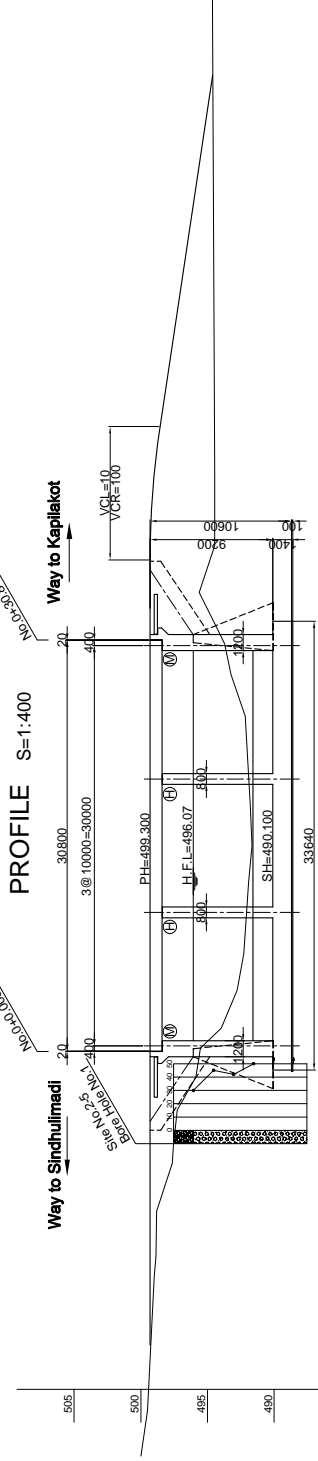

GRADE	PROPOSED HEIGHT	GROUND HEIGHT	STATION	CURVE ELEMENT	SUPER ELEVATION
499.300	499.300	499.25	-0+22.000		2.000%
499.300	499.300	494.70	0+0.000		
499.300	499.300	491.95	+0+20.000	R=∞ L=92.840	
499.300	499.225	494.50	+0+40.000		
499.300	499.113	494.50	+0+41.840		
499.300	496.576	494.50	+0+60.000	L=15.000% L=37.000m	
494.650	494.650	494.650	-0+72.840		

TYPICAL CROSS SECTION S=1:200

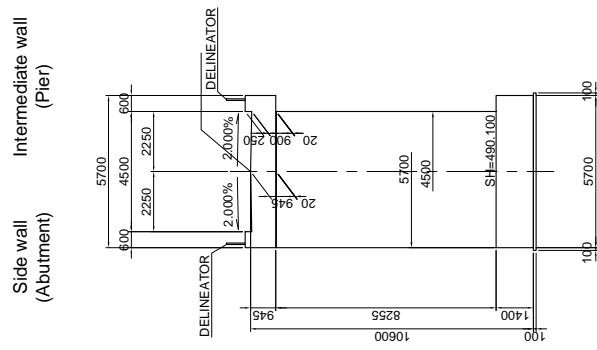

PLAN S=1:400

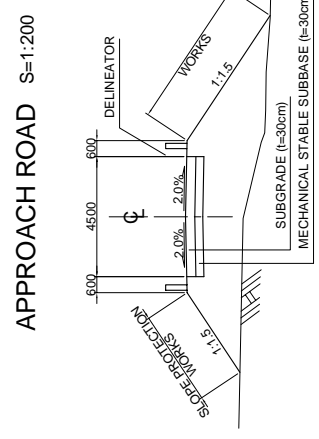
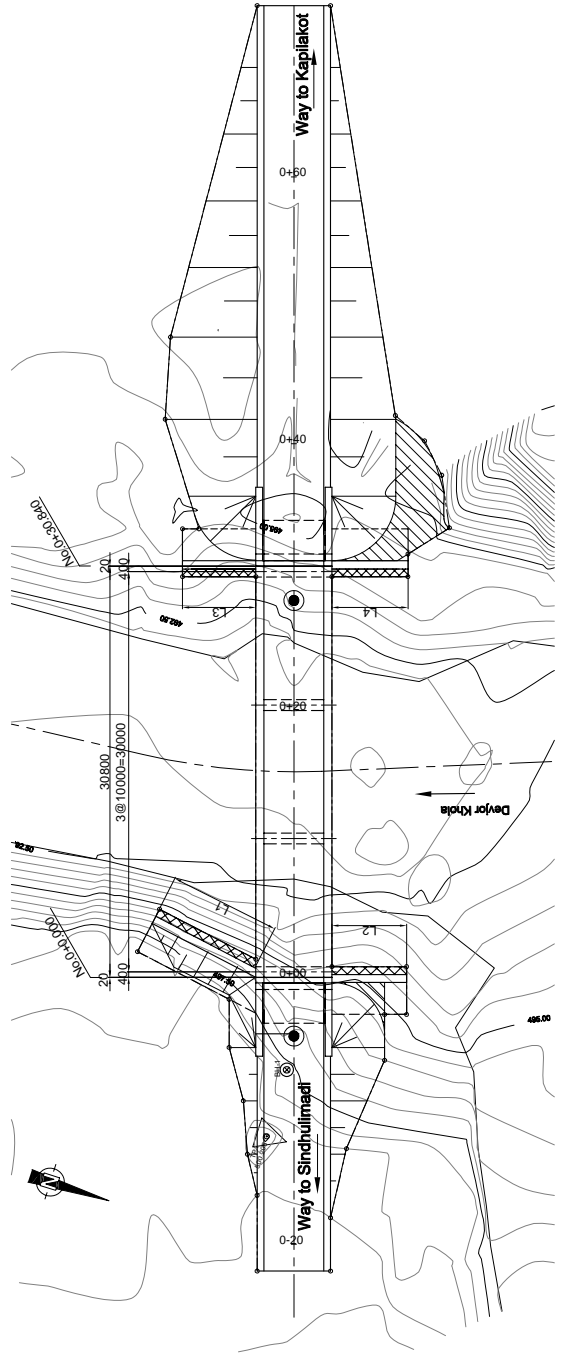

Note: The details around abutments including the lengths of L1, L2, L3 and L4 will be determined based on the actual site condition. The contractor has to prepare the shop drawings for the shape and dimension of embankment slopes, retaining walls and other structures necessary to complete the works based on the site condition for approval of the engineer. No claim except adjustment of quantities shall be made by this adjustment.

OUTLINE DESIGN OF RIVER CROSSING STRUCTURES	THE PROJECT FOR THE IMPROVEMENT OF COMMUNITY ACCESS IN NEPAL	DRAWING TITLE:	2-5 GENERAL VIEW OF DEVJOR KHOLA BRIDGE	SCALE:	AS SHOWN	DRAWING NO.:	26
	LOT - 9	PROVINCE:	Sindhuli	ROAD NAME:	Sindhulimadi-Kapliakot	RIVER NAME:	DEVJOR KHOLA
		SITE NO.:	2-5				

2-6 GENERAL VIEW OF MAHESWATA KHOLA BRIDGE

PROFILE S=1:500

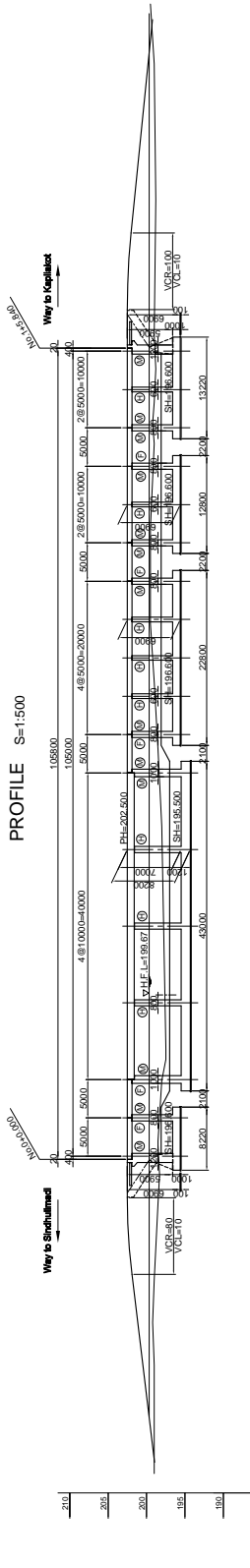

GRADE	PROPOSED HEIGHT	GROUND HEIGHT	STATION	CURVE ELEMENT	SUPER ELEVATION
198.860	199.000	198.960	198.900	FC-1 L=15.000m G=0.00%	
199.000	199.000	199.000	199.000	FC-2 L=20.000m G=0.00%	
199.000	199.000	199.000	199.000	FC-3 L=20.000m G=0.00%	
199.000	199.000	199.000	199.000	FC-4 L=20.000m G=0.00%	
199.000	199.000	199.000	199.000	FC-5 L=20.000m G=0.00%	
199.000	199.000	199.000	199.000	FC-6 L=20.000m G=0.00%	
199.000	199.000	199.000	199.000	FC-7 L=20.000m G=0.00%	
199.000	199.000	199.000	199.000	FC-8 L=20.000m G=0.00%	
199.000	199.000	199.000	199.000	FC-9 L=20.000m G=0.00%	
199.000	199.000	199.000	199.000	FC-10 L=20.000m G=0.00%	
199.000	199.000	199.000	199.000	FC-11 L=20.000m G=0.00%	
199.000	199.000	199.000	199.000	FC-12 L=20.000m G=0.00%	
199.000	199.000	199.000	199.000	FC-13 L=20.000m G=0.00%	
199.000	199.000	199.000	199.000	FC-14 L=20.000m G=0.00%	
199.000	199.000	199.000	199.000	FC-15 L=20.000m G=0.00%	
199.000	199.000	199.000	199.000	FC-16 L=20.000m G=0.00%	
199.000	199.000	199.000	199.000	FC-17 L=20.000m G=0.00%	
199.000	199.000	199.000	199.000	FC-18 L=20.000m G=0.00%	
199.000	199.000	199.000	199.000	FC-19 L=20.000m G=0.00%	
199.000	199.000	199.000	199.000	FC-20 L=20.000m G=0.00%	
199.000	199.000	199.000	199.000	FC-21 L=20.000m G=0.00%	
199.000	199.000	199.000	199.000	FC-22 L=20.000m G=0.00%	
199.000	199.000	199.000	199.000	FC-23 L=20.000m G=0.00%	
199.000	199.000	199.000	199.000	FC-24 L=20.000m G=0.00%	
199.000	199.000	199.000	199.000	FC-25 L=20.000m G=0.00%	
199.000	199.000	199.000	199.000	FC-26 L=20.000m G=0.00%	
199.000	199.000	199.000	199.000	FC-27 L=20.000m G=0.00%	
199.000	199.000	199.000	199.000	FC-28 L=20.000m G=0.00%	
199.000	199.000	199.000	199.000	FC-29 L=20.000m G=0.00%	
199.000	199.000	199.000	199.000	FC-30 L=20.000m G=0.00%	
199.000	199.000	199.000	199.000	FC-31 L=20.000m G=0.00%	
199.000	199.000	199.000	199.000	FC-32 L=20.000m G=0.00%	
199.000	199.000	199.000	199.000	FC-33 L=20.000m G=0.00%	
199.000	199.000	199.000	199.000	FC-34 L=20.000m G=0.00%	
199.000	199.000	199.000	199.000	FC-35 L=20.000m G=0.00%	
199.000	199.000	199.000	199.000	FC-36 L=20.000m G=0.00%	
199.000	199.000	199.000	199.000	FC-37 L=20.000m G=0.00%	
199.000	199.000	199.000	199.000	FC-38 L=20.000m G=0.00%	
199.000	199.000	199.000	199.000	FC-39 L=20.000m G=0.00%	
199.000	199.000	199.000	199.000	FC-40 L=20.000m G=0.00%	
199.000	199.000	199.000	199.000	FC-41 L=20.000m G=0.00%	
199.000	199.000	199.000	199.000	FC-42 L=20.000m G=0.00%	
199.000	199.000	199.000	199.000	FC-43 L=20.000m G=0.00%	
199.000	199.000	199.000	199.000	FC-44 L=20.000m G=0.00%	
199.000	199.000	199.000	199.000	FC-45 L=20.000m G=0.00%	
199.000	199.000	199.000	199.000	FC-46 L=20.000m G=0.00%	
199.000	199.000	199.000	199.000	FC-47 L=20.000m G=0.00%	
199.000	199.000	199.000	199.000	FC-48 L=20.000m G=0.00%	
199.000	199.000	199.000	199.000	FC-49 L=20.000m G=0.00%	
199.000	199.000	199.000	199.000	FC-50 L=20.000m G=0.00%	
199.000	199.000	199.000	199.000	FC-51 L=20.000m G=0.00%	
199.000	199.000	199.000	199.000	FC-52 L=20.000m G=0.00%	
199.000	199.000	199.000	199.000	FC-53 L=20.000m G=0.00%	
199.000	199.000	199.000	199.000	FC-54 L=20.000m G=0.00%	
199.000	199.000	199.000	199.000	FC-55 L=20.000m G=0.00%	
199.000	199.000	199.000	199.000	FC-56 L=20.000m G=0.00%	
199.000	199.000	199.000	199.000	FC-57 L=20.000m G=0.00%	
199.000	199.000	199.000	199.000	FC-58 L=20.000m G=0.00%	
199.000	199.000	199.000	199.000	FC-59 L=20.000m G=0.00%	
199.000	199.000	199.000	199.000	FC-60 L=20.000m G=0.00%	
199.000	199.000	199.000	199.000	FC-61 L=20.000m G=0.00%	
199.000	199.000	199.000	199.000	FC-62 L=20.000m G=0.00%	
199.000	199.000	199.000	199.000	FC-63 L=20.000m G=0.00%	
199.000	199.000	199.000	199.000	FC-64 L=20.000m G=0.00%	
199.000	199.000	199.000	199.000	FC-65 L=20.000m G=0.00%	
199.000	199.000	199.000	199.000	FC-66 L=20.000m G=0.00%	
199.000	199.000	199.000	199.000	FC-67 L=20.000m G=0.00%	
199.000	199.000	199.000	199.000	FC-68 L=20.000m G=0.00%	
199.000	199.000	199.000	199.000	FC-69 L=20.000m G=0.00%	
199.000	199.000	199.000	199.000	FC-70 L=20.000m G=0.00%	
199.000	199.000	199.000	199.000	FC-71 L=20.000m G=0.00%	
199.000	199.000	199.000	199.000	FC-72 L=20.000m G=0.00%	
199.000	199.000	199.000	199.000	FC-73 L=20.000m G=0.00%	
199.000	199.000	199.000	199.000	FC-74 L=20.000m G=0.00%	
199.000	199.000	199.000	199.000	FC-75 L=20.000m G=0.00%	
199.000	199.000	199.000	199.000	FC-76 L=20.000m G=0.00%	
199.000	199.000	199.000	199.000	FC-77 L=20.000m G=0.00%	
199.000	199.000	199.000	199.000	FC-78 L=20.000m G=0.00%	
199.000	199.000	199.000	199.000	FC-79 L=20.000m G=0.00%	
199.000	199.000	199.000	199.000	FC-80 L=20.000m G=0.00%	
199.000	199.000	199.000	199.000	FC-81 L=20.000m G=0.00%	
199.000	199.000	199.000	199.000	FC-82 L=20.000m G=0.00%	
199.000	199.000	199.000	199.000	FC-83 L=20.000m G=0.00%	
199.000	199.000	199.000	199.000	FC-84 L=20.000m G=0.00%	
199.000	199.000	199.000	199.000	FC-85 L=20.000m G=0.00%	
199.000	199.000	199.000	199.000	FC-86 L=20.000m G=0.00%	
199.000	199.000	199.000	199.000	FC-87 L=20.000m G=0.00%	
199.000	199.000	199.000	199.000	FC-88 L=20.000m G=0.00%	
199.000	199.000	199.000	199.000	FC-89 L=20.000m G=0.00%	
199.000	199.000	199.000	199.000	FC-90 L=20.000m G=0.00%	
199.000	199.000	199.000	199.000	FC-91 L=20.000m G=0.00%	
199.000	199.000	199.000	199.000	FC-92 L=20.000m G=0.00%	
199.000	199.000	199.000	199.000	FC-93 L=20.000m G=0.00%	
199.000	199.000	199.000	199.000	FC-94 L=20.000m G=0.00%	
199.000	199.000	199.000	199.000	FC-95 L=20.000m G=0.00%	
199.000	199.000	199.000	199.000	FC-96 L=20.000m G=0.00%	
199.000	199.000	199.000	199.000	FC-97 L=20.000m G=0.00%	
199.000	199.000	199.000	199.000	FC-98 L=20.000m G=0.00%	
199.000	199.000	199.000	199.000	FC-99 L=20.000m G=0.00%	
199.000	199.000	199.000	199.000	FC-100 L=20.000m G=0.00%	

TYPICAL CROSS SECTION S=1:200

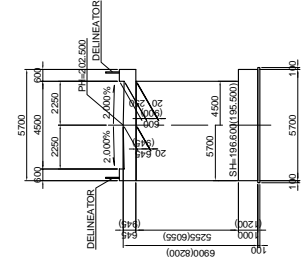

PLAN S=1:500

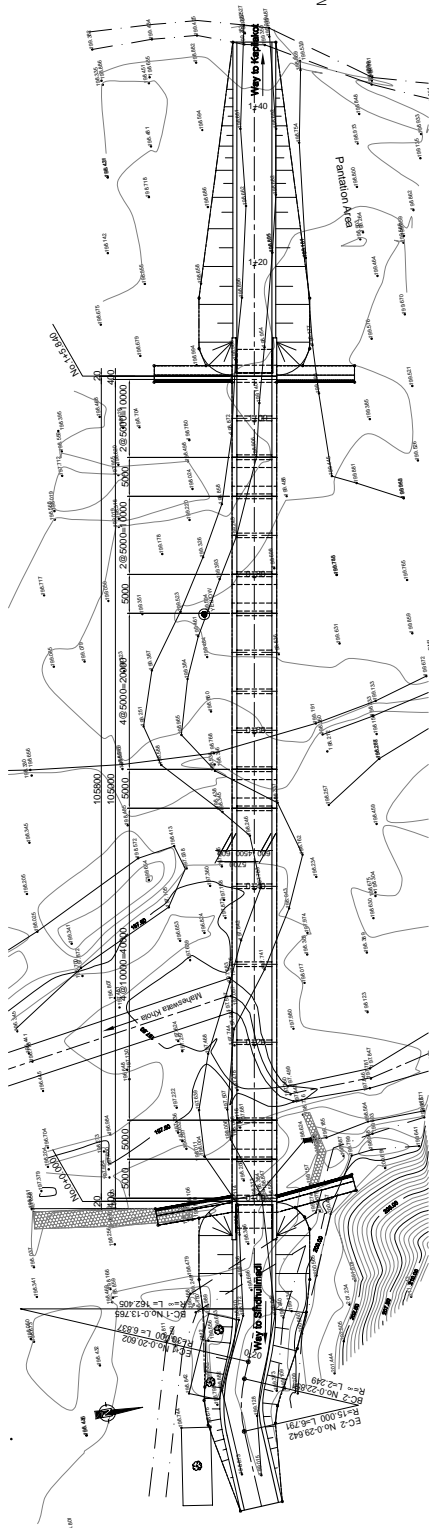

APPROACH ROAD S=1:200

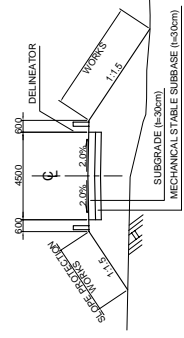

Note: The details around abutments including the lengths will be determined based on the actual site condition. The contractor has to prepare the shop drawings for the shape and dimension of embankment slopes, retaining walls and other structures necessary to complete the works based on the site condition for approval of the engineer. No claim except adjustment of quantities shall be made by this adjustment.

DRAWING TITLE:	PROVINCE	Sindhuli	SCALE	DRAWING NO.
	ROAD NAME	Sindhulimadi-Kaptolhat		
THE PROJECT FOR THE IMPROVEMENT OF COMMUNITY ACCESS IN NEPAL LOT- 9	SITE NO	2-6	AS SHOWN	27
	RIVER NAME	MAHESWATA KHOLA		

2-7 GENERAL VIEW OF CHANTULI KHOLA BRIDGE

PROFILE S=1:500

TYPICAL CROSS SECTION S=1:200

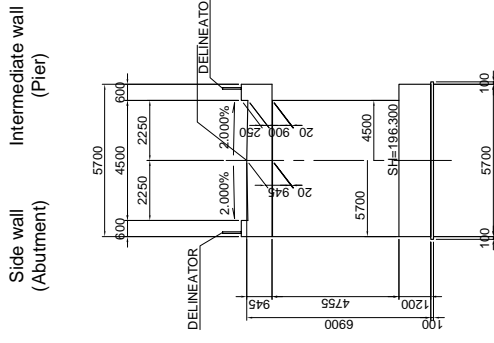
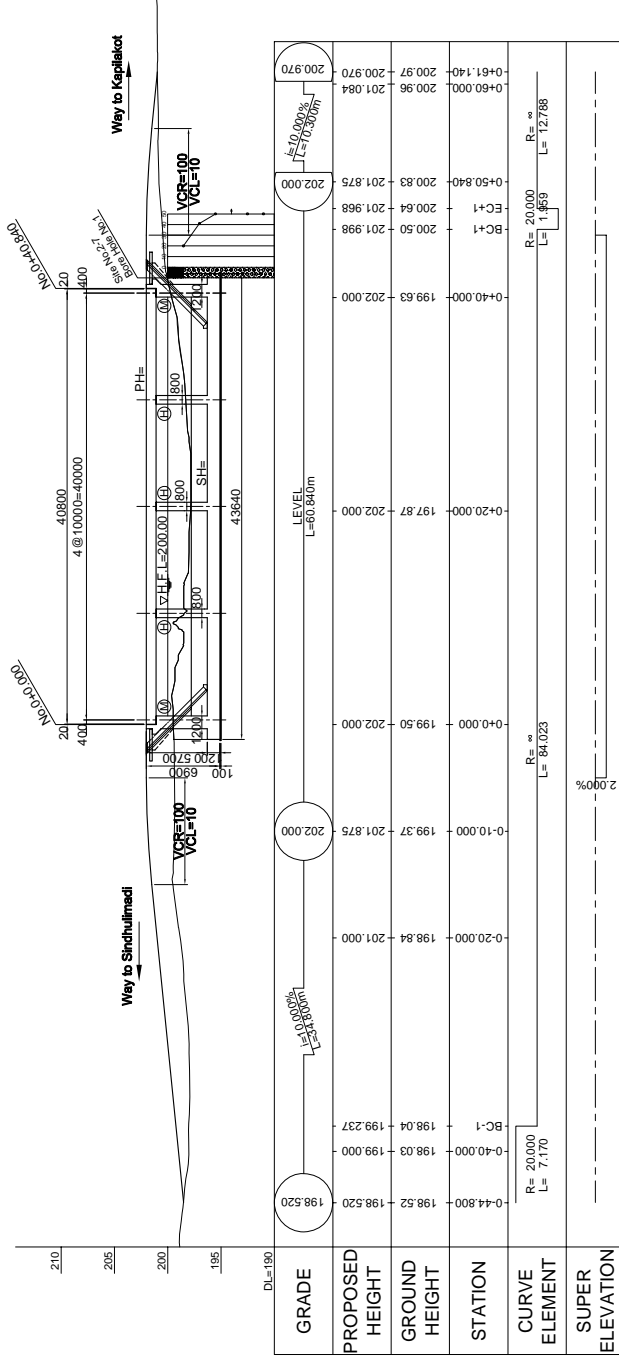

PLAN S=1:500

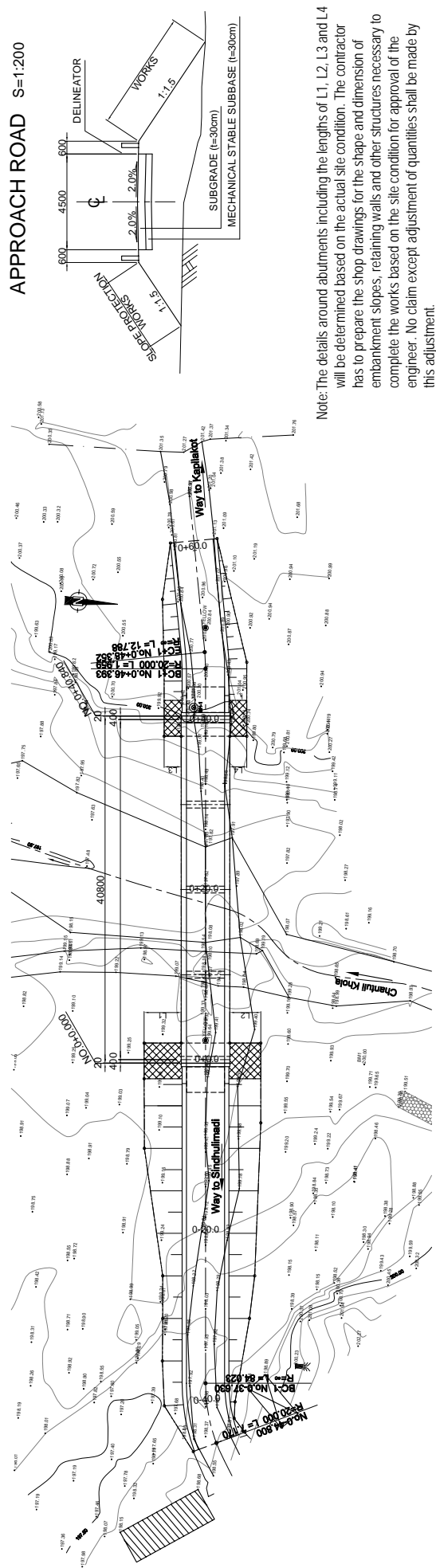

Note: The details around abutments including the lengths of L1, L2, L3 and L4 will be determined based on the actual site condition. The contractor has to prepare the shop drawings for the shape and dimension of embankment slopes, retaining walls and other structures necessary to complete the works based on the site condition for approval of the engineer. No claim except adjustment of quantities shall be made by this adjustment.

OUTLINE DESIGN OF RIVER CROSSING STRUCTURES	THE PROJECT FOR THE IMPROVEMENT OF COMMUNITY ACCESS IN NEPAL LOT - 9		DRAWING TITLE:		2-7 GENERAL VIEW OF CHANTULI KHOLA BRIDGE	PROVINCE	Sindhuli	SCALE	AS SHOWN	DRAWING NO.	28
						ROAD NAME	Sindhulimadi-Kaptlakot				
						SITE NO.	2-7				
						RIVER NAME	CHANTULI KHOLA				

3-1 GENERAL VIEW OF DHAMILE KHOLA BRIDGE

PROFILE S=1:500

TYPICAL CROSS SECTION S=1:200

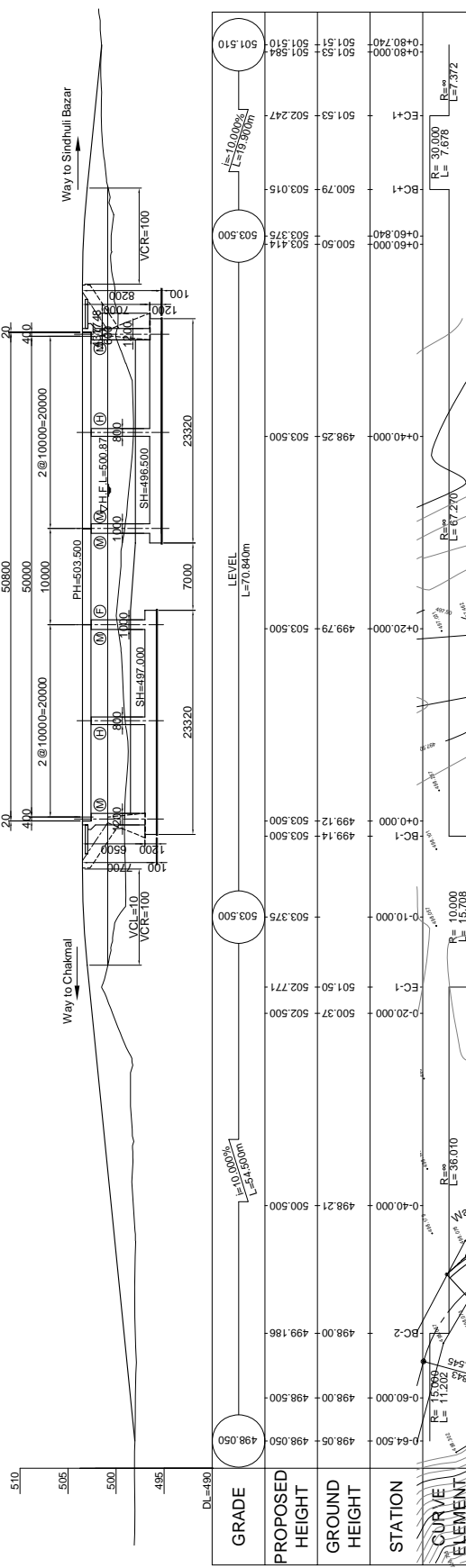
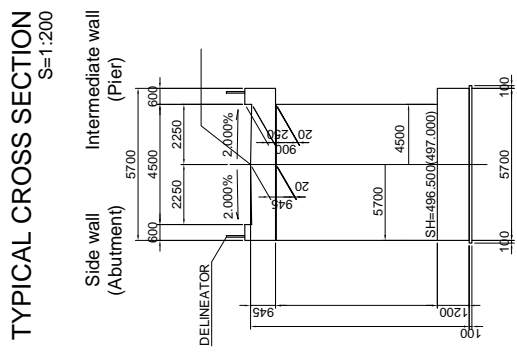

PLAN S=1:500

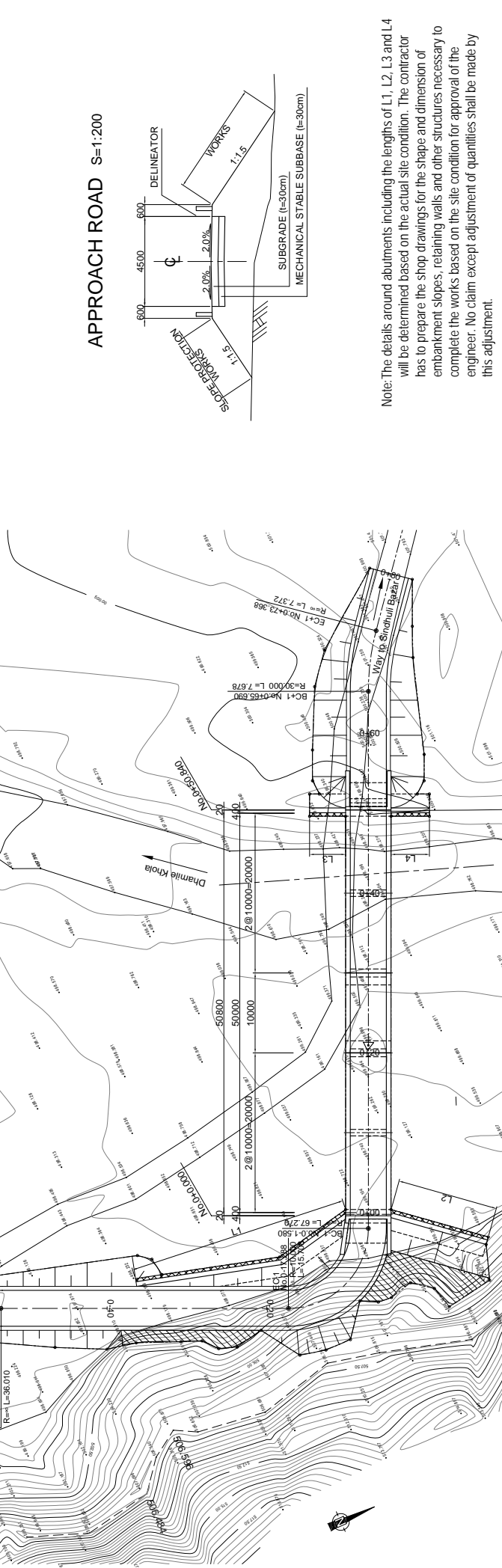

APPROACH ROAD S=1:200

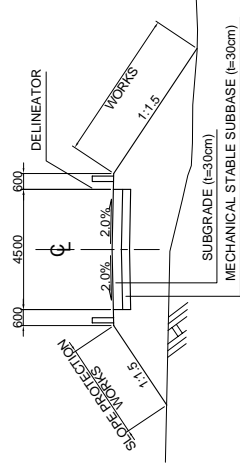

Note: The details around abutments including the lengths of L1, L2, L3 and L4 will be determined based on the actual site condition. The contractor has to prepare the shop drawings for the shape and dimension of embankment slopes, retaining walls and other structures necessary to complete the works based on the site condition for approval of the engineer. No claim except adjustment of quantities shall be made by this adjustment.

GRADE	PROPOSED HEIGHT	GROUND HEIGHT	STATION	CURVE ELEMENT	SUPER ELEVATION
498.050		498.050	498.050		
		498.000	498.000		
		499.186	499.186		
		498.500	498.500		
		498.000	498.000		
		499.14	499.14		
		503.500	503.500		
		503.500	503.500		
		502.771	502.771		
		503.375	503.375		
		503.500	503.500		
		499.12	499.12		
		503.500	503.500		
		498.25	498.25		
		503.500	503.500		
		500.50	500.50		
		503.414	503.414		
		503.375	503.375		
		503.500	503.500		
		502.247	502.247		
		501.53	501.53		
		501.584	501.584		
		501.510	501.510		
		501.510	501.510		

OUTLINE DESIGN OF RIVER CROSSING STRUCTURES LOT - 10	THE PROJECT FOR THE IMPROVEMENT OF COMMUNITY ACCESS IN NEPAL		DRAWING TITLE: 3-1 GENERAL VIEW OF DHAMILE KHOLA BRIDGE		SCALE AS SHOWN	DRAWING NO. 30
	PROVINCE Sindhuli	ROAD NAME Sindhulimadi-Bhimsthan	RIVER NAME DHAMILE KHOLA	SITE NO. 3-1		