

7. 概略設計図

8-1 GENERAL VIEW OF PALATI KHOLA BRIDGE

PROFILE S=1:400

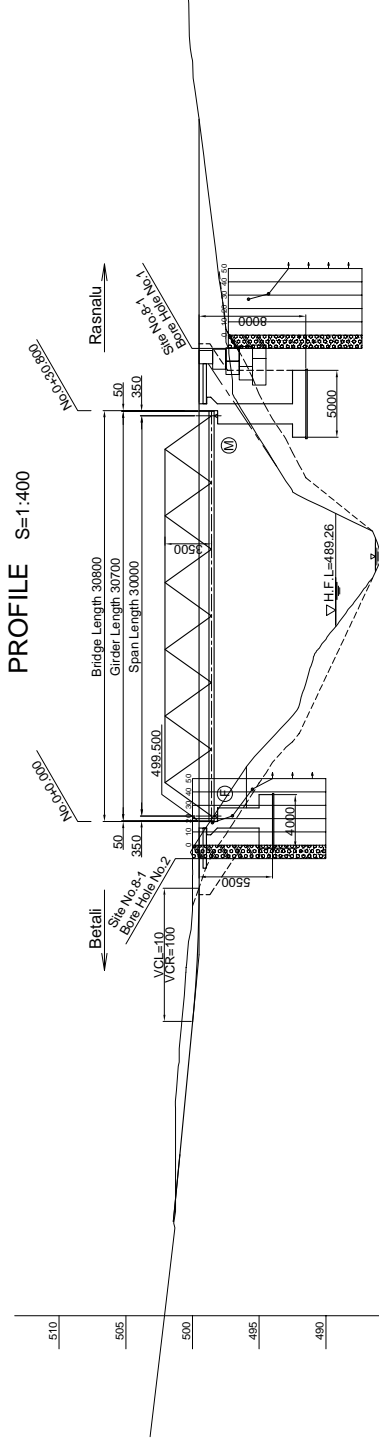

| GRADE | LEVEL | LEVEL | LEVEL | LEVEL |
|-----------------|-------------|------------------|-------------|------------------|
| DL=485 | 501.500 | 499.500 | 499.500 | 499.500 |
| E.R.L.G | 501.500 | 499.500 | 499.500 | 499.500 |
| PROPOSED HEIGHT | 0.000 | 0.000 | 0.000 | 0.000 |
| GROUND HEIGHT | 501.40 | 500.46 | 499.63 | 498.03 |
| STATION | -0.30.000 | -0.10.946 | -0.1.417 | +0.40.715 |
| CURVE ELEMENT | R=∞ L=8.391 | R=15.000 L=6.414 | R=∞ L=4.249 | R=10.000 L=9.315 |
| SUPER ELEVATION | | | | |

TYPICAL CROSS SECTION SUPERSTRUCTURE S=1:100

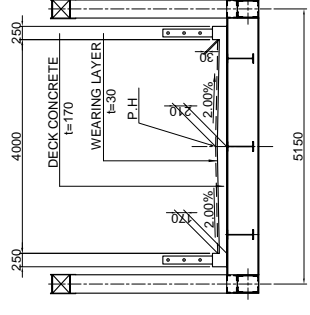

SUBSTRUCTURE A1 ABUTMENT S=1:200

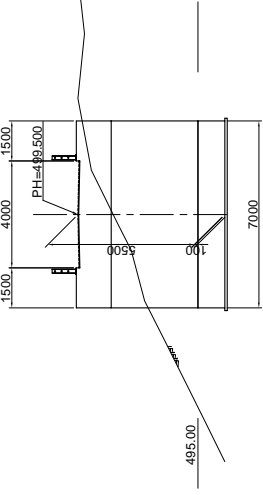

A2 ABUTMENT

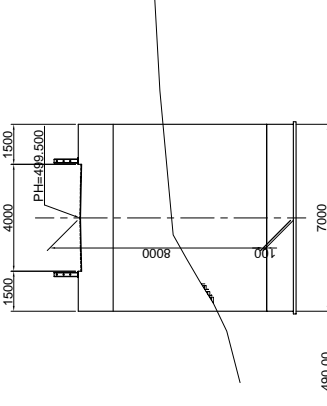

APPROACH ROAD S=1:200

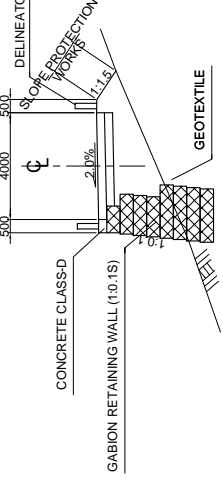

PLAN S=1:400

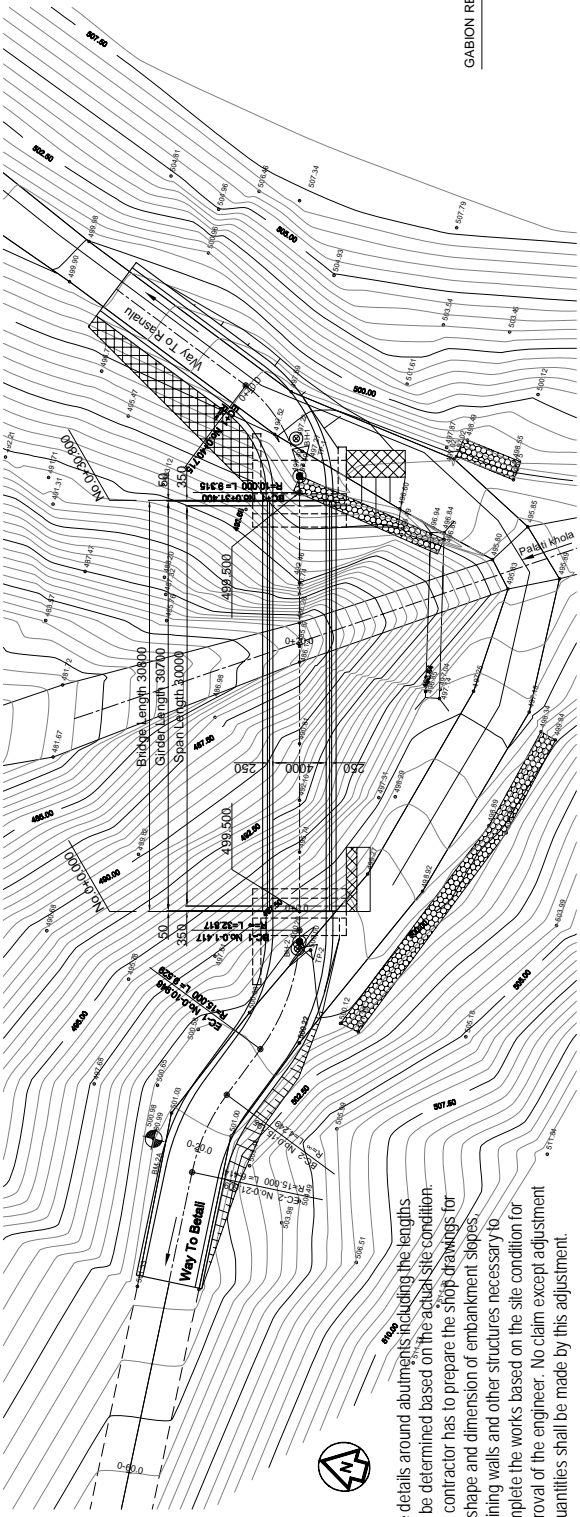

Note: The details around abutments including the lengths will be determined based on the actual site condition. The contractor has to prepare the shop drawings for the shape and dimension of embankment slopes retaining walls and other structures necessary to complete the works based on the site condition for approval of the engineer. No claim except adjustment of quantities shall be made by this adjustment.

| | | | | |
|---|--|---|-------|-------------|
| OUTLINE DESIGN OF RIVER CROSSING STRUCTURES | DRAWING TITLE: | | SCALE | DRAWING NO. |
| | THE PROJECT FOR THE IMPROVEMENT OF COMMUNITY ACCESS IN NEPAL LOT - 1 | 8-1 GENERAL VIEW OF PALATI KHOLA BRIDGE | | |
| | PROVINCE | Ramechhap | | |
| | ROAD NAME | Betali-Namsadi-Khimi | | |
| | SITE NO. | 8-1 | | |
| | RIVER NAME | PALATI KHOLA | | |

8-3 GENERAL VIEW OF HALUWA KHOLA BRIDGE

PROFILE S=1:400

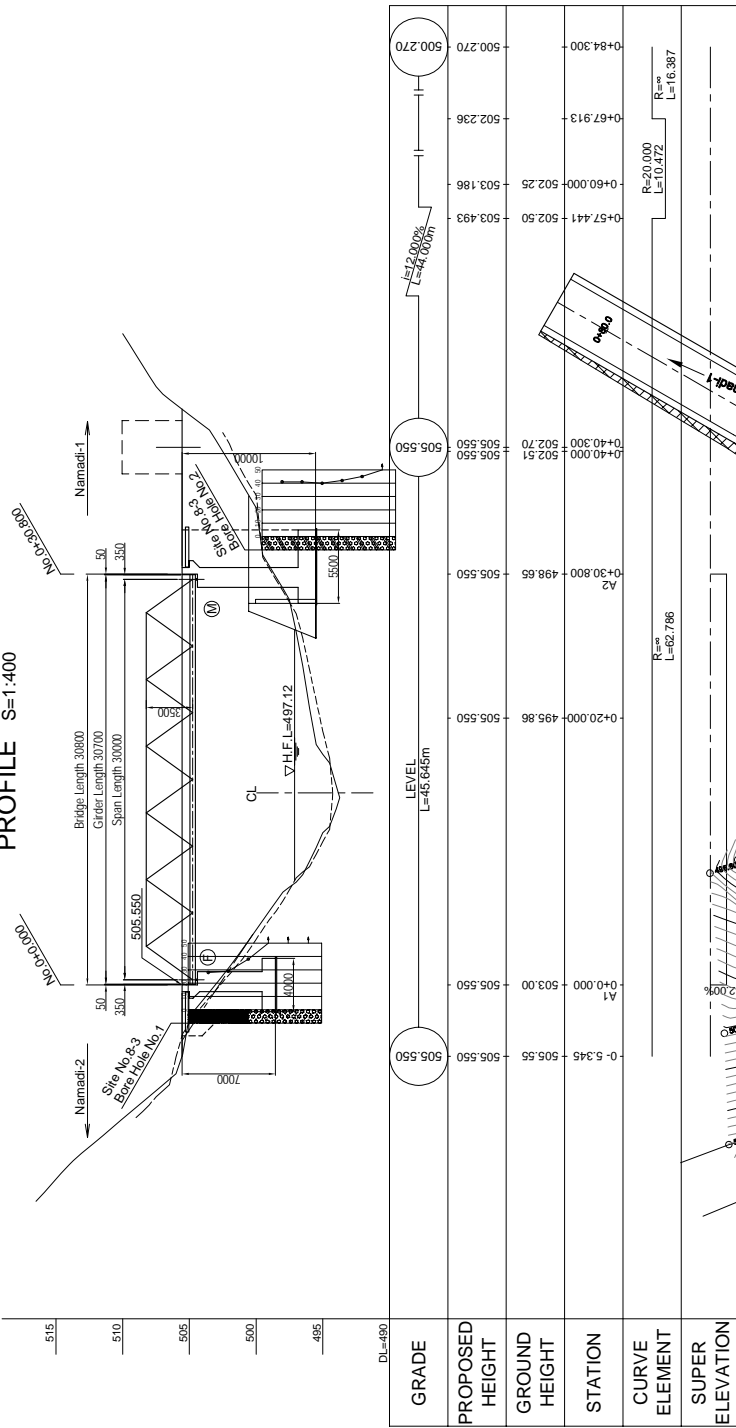

TYPICAL CROSS SECTION SUPERSTRUCTURE S=1:100

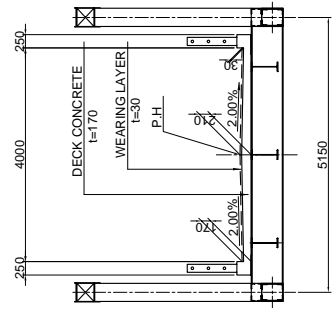

SUBSTRUCTURE S=1:200

A1 ABUTMENT

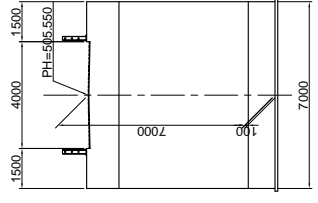

A2 ABUTMENT

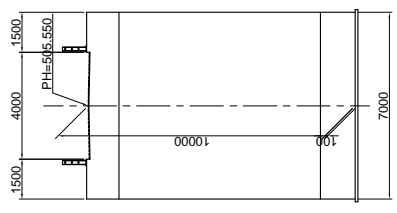

APPROACH ROAD S=1:200

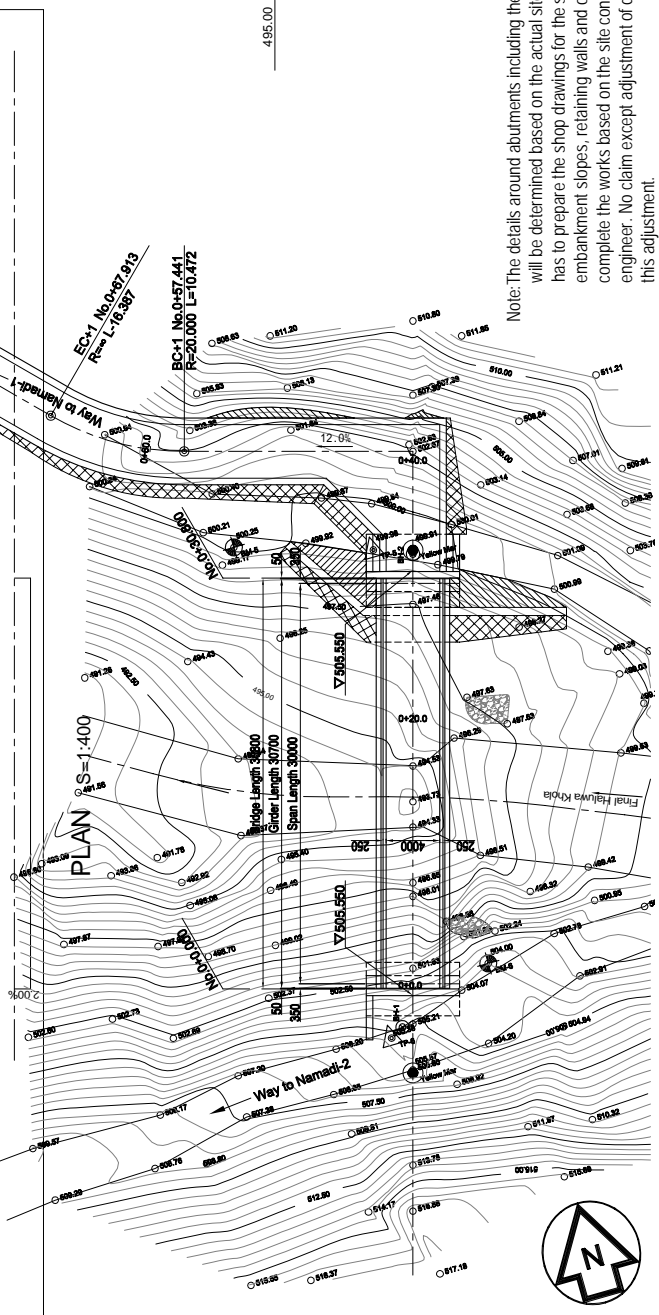
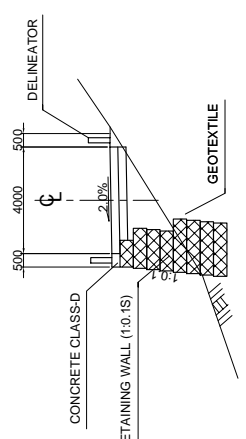

Note: The details around abutments including the lengths will be determined based on the actual site condition. The contractor has to prepare the shop drawings for the shape and dimension of embankment slopes, retaining walls and other structures necessary to complete the works based on the site condition for approval of the engineer. No claim except adjustment of quantities shall be made by this adjustment.

| DRAWING NO | SCALE | PROVINCE | DRAWING TITLE: | | |
|------------|----------|---------------------|---|--------------|------------|
| | | | ROAD NAME | SITE NO. | RIVER NAME |
| 2 | AS SHOWN | Ramechhap | 8-3 GENERAL VIEW OF HALUWA KHOLA BRIDGE | | |
| | | Betali-Namadi-Khimi | 8-3 | HALUWA KHOLA | |

THE PROJECT FOR THE IMPROVEMENT OF COMMUNITY ACCESS IN NEPAL LOT - 1

OUTLINE DESIGN OF RIVER CROSSING STRUCTURES

8-4 GENERAL VIEW OF PHARPU KHOLA BRIDGE

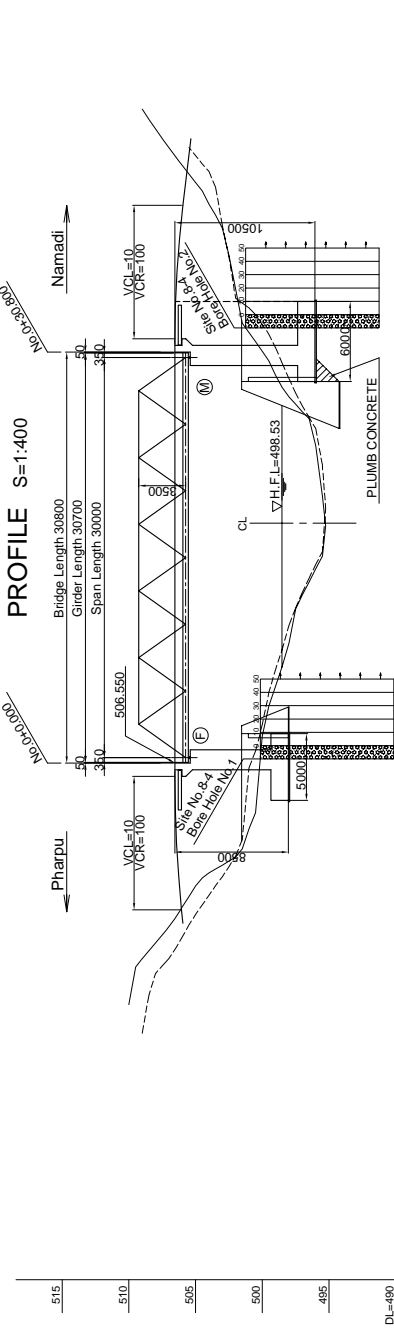

| GRADE | PROPOSED HEIGHT | GROUND HEIGHT | STATION | CURVE ELEMENT | SUPER ELEVATION |
|---------|-----------------|---------------|----------|----------------------|-----------------|
| 503.500 | 503.500 | 503.48 | -0.36500 | R=10.000 L=24.856 | |
| 504.464 | 504.464 | 504.30 | -0.26856 | R=3.644 L=9.644 | |
| 505.150 | 505.150 | 505.30 | -0.20000 | R=15.000 L=9.163 | |
| 506.425 | 506.425 | 506.145 | -0.60000 | | |
| 506.550 | 506.550 | 506.18 | -2.00000 | | |
| 506.550 | 506.550 | 500.00 | 0.00000 | | |
| 506.550 | 506.550 | 506.550 | 6.00000 | | |
| 506.550 | 506.550 | 506.14 | 0.31071 | | |
| 506.550 | 506.550 | 506.95 | 0.30800 | | |
| 506.550 | 506.550 | 499.95 | 0.31071 | | |
| 506.550 | 506.550 | 502.26 | 0.36800 | | |
| 506.550 | 506.550 | 502.90 | 0.40000 | | |
| 506.550 | 506.550 | 503.08 | 0.40234 | | |
| 506.550 | 506.550 | 506.124 | 0.44000 | | |
| 506.550 | 506.550 | 504.40 | 0.54800 | | |
| 504.390 | 504.390 | 504.40 | 0.54390 | | |

TYPICAL CROSS SECTION SUPERSTRUCTURE S=1:100

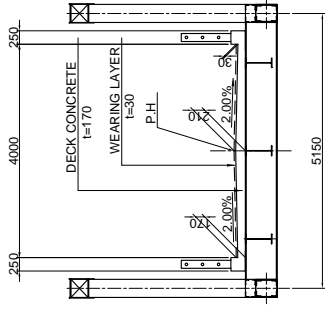

SUBSTRUCTURE A2 ABUTMENT S=1:200

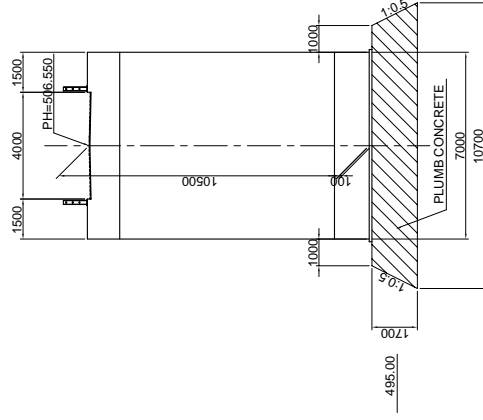
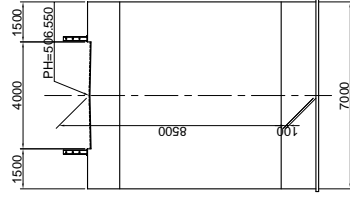

APPROACH ROAD S=1:200

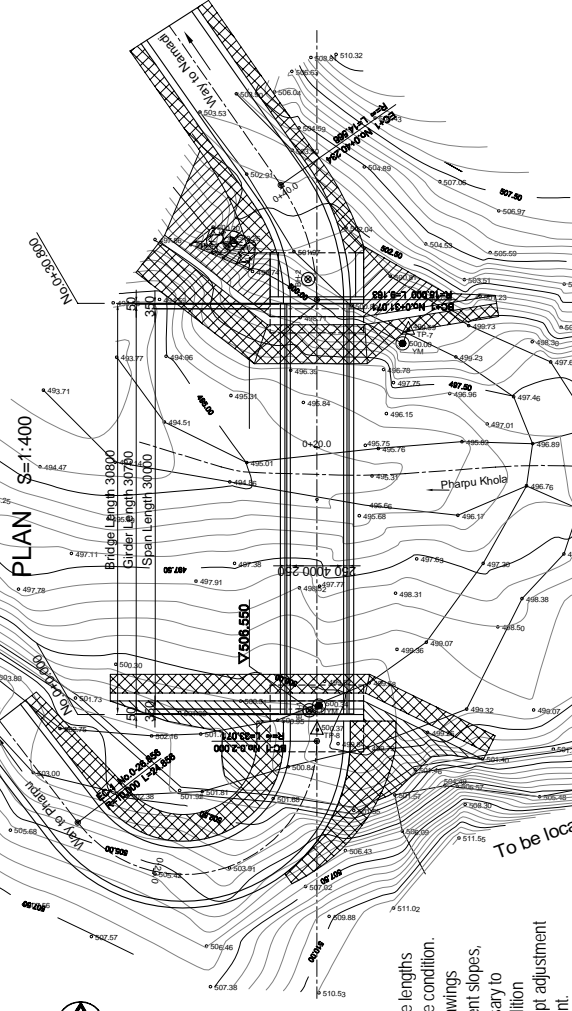
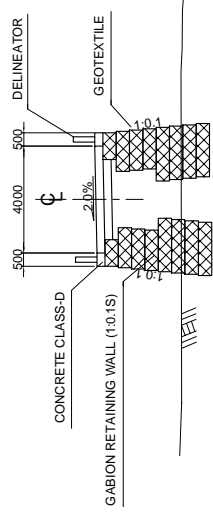

Note: The details around abutments including the lengths will be determined based on the actual site condition. The contractor has to prepare the shop drawings for the shape and dimension of embankment slopes, retaining walls and other structures necessary to complete the works based on the site condition for approval of the engineer. No claim except adjustment of quantities shall be made by this adjustment.

| | |
|--|---|
| DRAWING NO | 3 |
| | AS SHOWN |
| SCALE | Rameshchhap |
| PROVINCE | Betahel Namadzi Khimri |
| ROAD NAME | 8-4 |
| SITE NO. | PHARPU KHOLA |
| RIVER NAME | |
| DRAWING TITLE: | 8-4 GENERAL VIEW OF PHARPU KHOLA BRIDGE |
| THE PROJECT FOR THE IMPROVEMENT OF COMMUNITY ACCESS IN NEPAL | LOT - 1 |
| OUTLINE DESIGN OF RIVER CROSSING STRUCTURES | |

8-5 GENERAL VIEW OF CHHATAUNI KHOLA BRIDGE

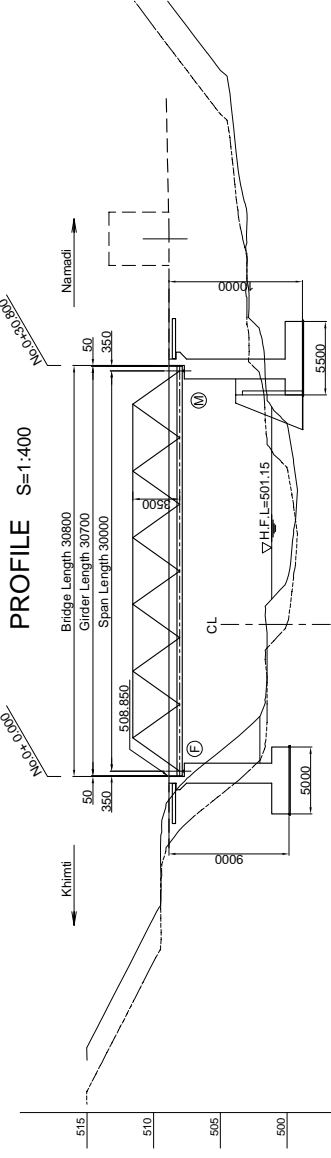

PROFILE S=1:400

| GRADE | LEVEL | STATION |
|-----------------|---------|----------------------|
| | 508.850 | 0+0.000 |
| PROPOSED HEIGHT | 508.850 | 0+0.800 |
| GROUND HEIGHT | 507.33 | 0+1.66 |
| CURVE ELEMENT | | R=10.000 L=15.525 |
| SUPER ELEVATION | | R=∞ L=31.794 |
| | 508.850 | 0+4.000 |
| | 508.850 | 0+4.800 |
| | 508.850 | 0+5.600 |
| | 508.850 | 0+6.400 |
| | 508.850 | 0+7.200 |
| | 508.850 | 0+8.000 |
| | 508.850 | 0+8.800 |
| | 508.850 | 0+9.600 |
| | 508.850 | 0+10.400 |
| | 508.850 | 0+11.200 |
| | 508.850 | 0+12.000 |
| | 508.850 | 0+12.800 |
| | 508.850 | 0+13.600 |
| | 508.850 | 0+14.400 |
| | 508.850 | 0+15.200 |
| | 508.850 | 0+16.000 |
| | 508.850 | 0+16.800 |
| | 508.850 | 0+17.600 |
| | 508.850 | 0+18.400 |
| | 508.850 | 0+19.200 |
| | 508.850 | 0+20.000 |

PLAN S=1:400

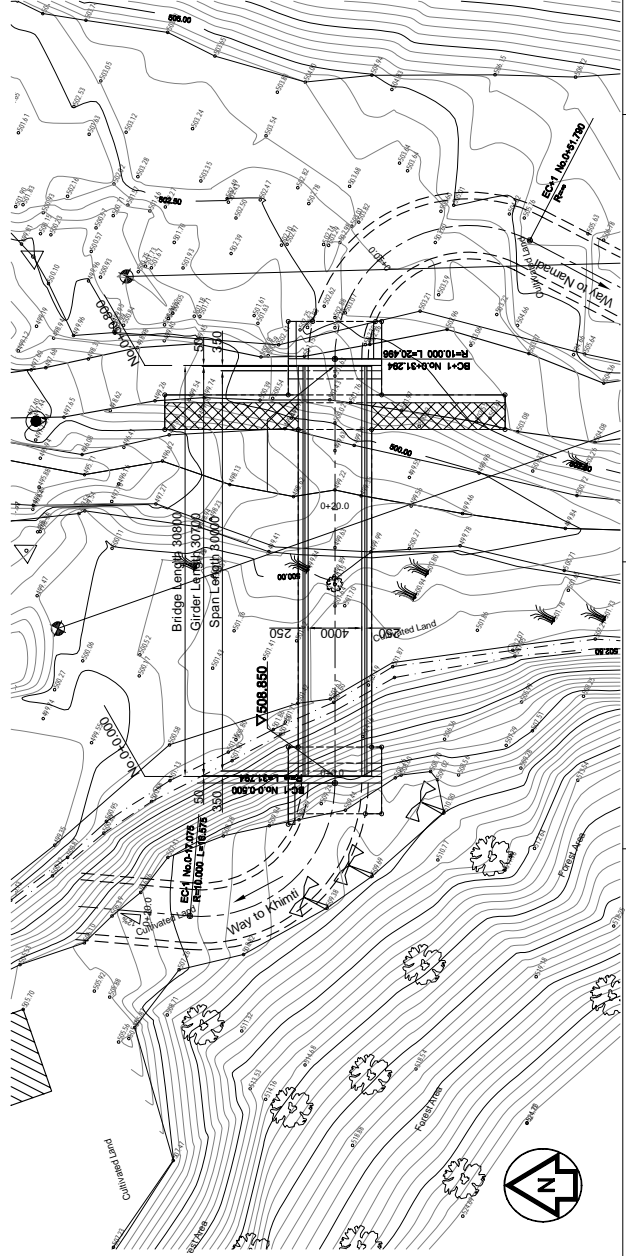

TYPICAL CROSS SECTION SUPERSTRUCTURE S=1:100

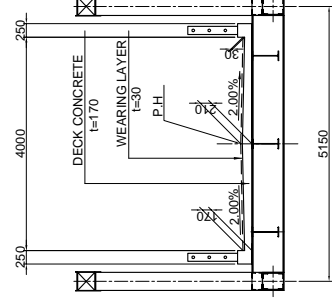

SUBSTRUCTURE S=1:200

A1 ABUTMENT

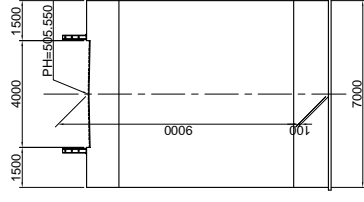

A2 ABUTMENT

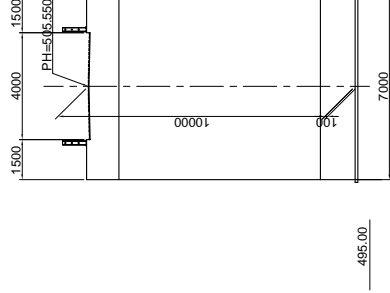

APPROACH ROAD S=1:200

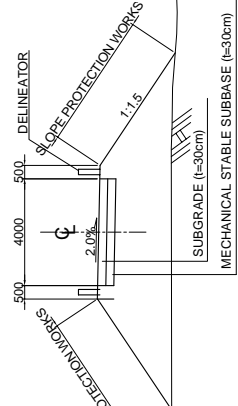

Note: The details around abutments including the lengths will be determined based on the actual site condition. The contractor has to prepare the shop drawings for the shape and dimension of embankment slopes, retaining walls and other structures necessary to complete the works based on the site condition for approval of the engineer. No claim except adjustment of quantities shall be made by this adjustment.

| | | | | | | |
|--|--|--|------------|----------------------|-------------|----------|
| OUTLINE DESIGN OF RIVER CROSSING STRUCTURES LOT - 2 | THE PROJECT FOR THE IMPROVEMENT OF COMMUNITY ACCESS IN NEPAL | | PROVINCE | Rameshchhap | DRAWING NO. | 5 |
| | 8-5 GENERAL VIEW OF CHHATAUNI KHOLA BRIDGE | | ROAD NAME | Betali-Namadi-Khimti | SCALE | AS SHOWN |
| | | | SITE NO. | 8-5 | | |
| | | | RIVER NAME | CHHATAUNI KHOLA | | |

1-1 GENERAL VIEW OF DHOLAN KHOLA BRIDGE

TYPICAL CROSS SECTION S=1:100

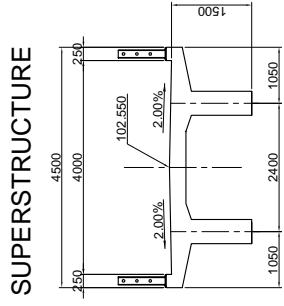

SUBSTRUCTURE S=1:200
A1 ABUTMENT

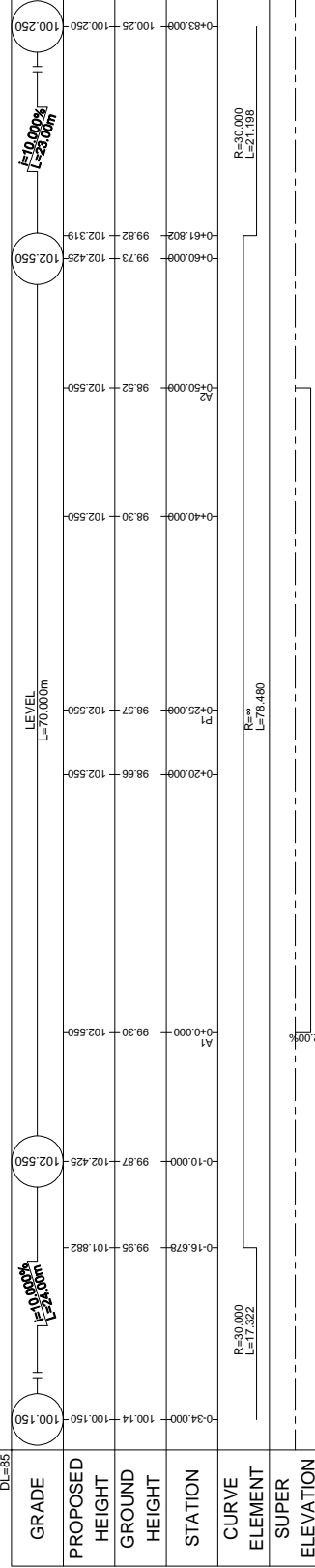

PROFILE S=1:400

PLAN S=1:400

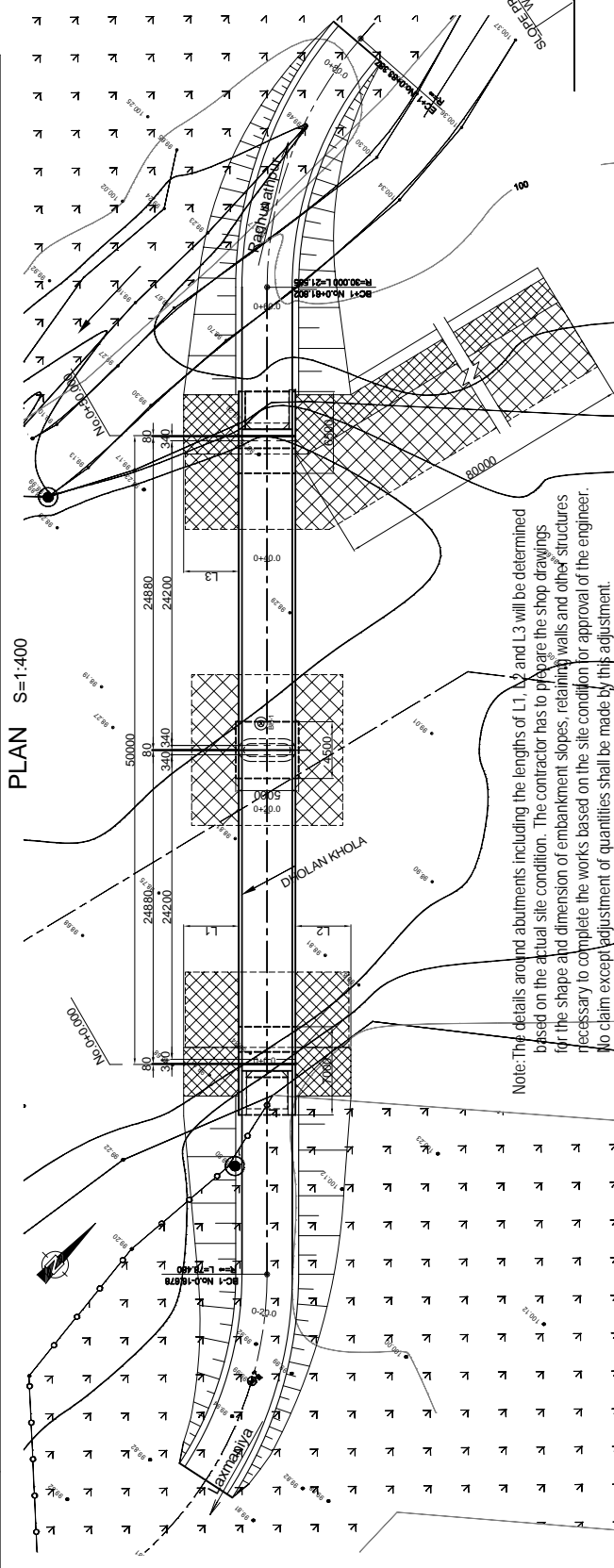

Note: The details around abutments including the lengths of L1, L2 and L3 will be determined based on the actual site condition. The contractor has to prepare the shop drawings for the shape and dimension of embankment slopes, retaining walls and other structures necessary to complete the works based on the site condition for approval of the engineer. No claim except adjustment of quantities shall be made by the adjustment.

APPROACH ROAD S=1:200

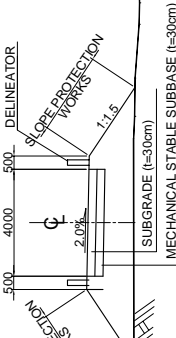

| | | | | | | | | | |
|--|--|----------------|---|-------------|---------------------------------|--------|----------|-------------|---|
| OUTLINE DESIGN OF RIVER CROSSING STRUCTURES LOT - 4 | THE PROJECT FOR THE IMPROVEMENT OF COMMUNITY ACCESS IN NEPAL | DRAWING TITLE: | 1-1 GENERAL VIEW OF DHOLAN KHOLA BRIDGE | PROVINCE: | Mahotari | SCALE: | AS SHOWN | DRAWING NO: | 8 |
| | | | | ROAD NAME: | Laxmaniyas-Baratpur-Raghnathpur | | | | |
| | | | | SITE NO.: | 1-1 | | | | |
| | | | | RIVER NAME: | DHOLAN KHOLA | | | | |

1-2 GENERAL VIEW OF KANTWA KHOLA BRIDGE

PROFILE S=1:500

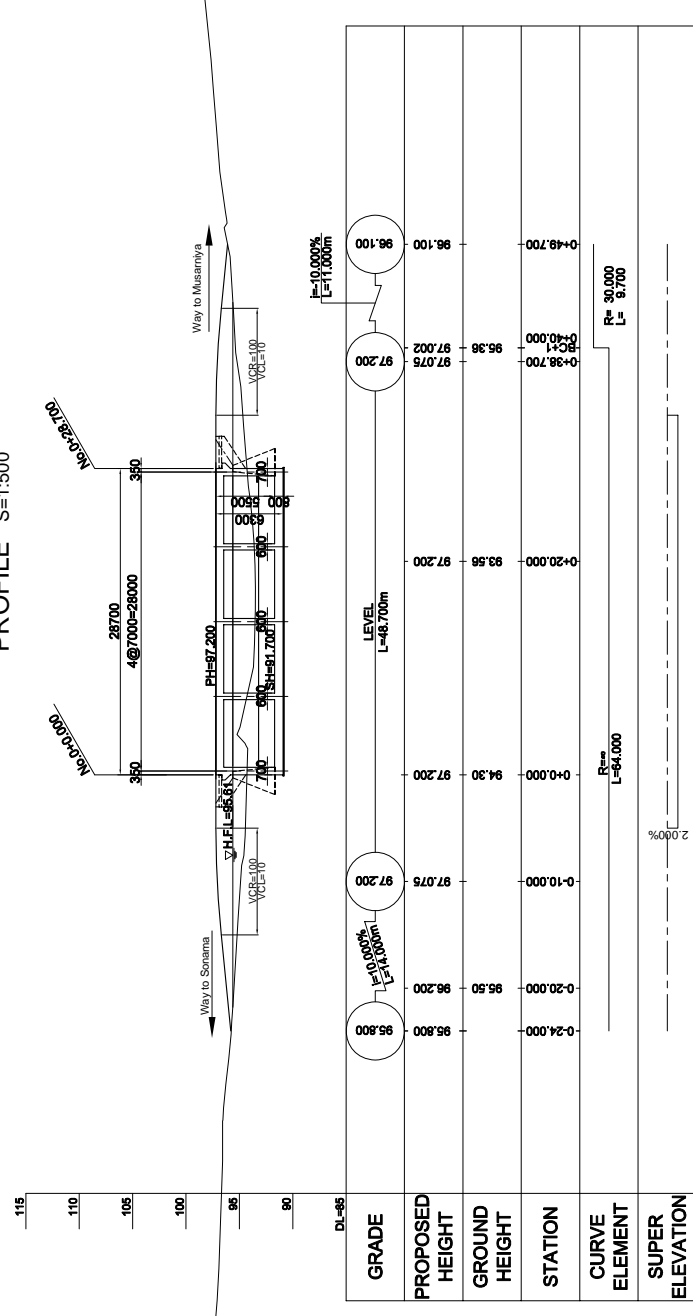

TYPICAL CROSS SECTION S=1:200

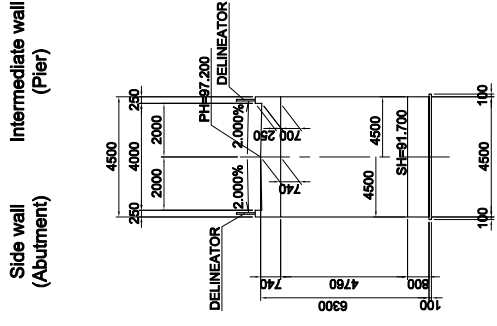

APPROACH ROAD S=1:200

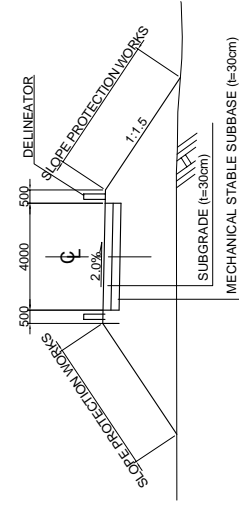

Note: The details around abutments including the lengths will be determined based on the actual site condition. The contractor has to prepare the shop drawings for the shape and dimension of embankment slopes, retaining walls and other structures necessary to complete the works based on the site condition for approval of the engineer. No claim except adjustment of quantities shall be made by this adjustment.

PLAN S=1:500

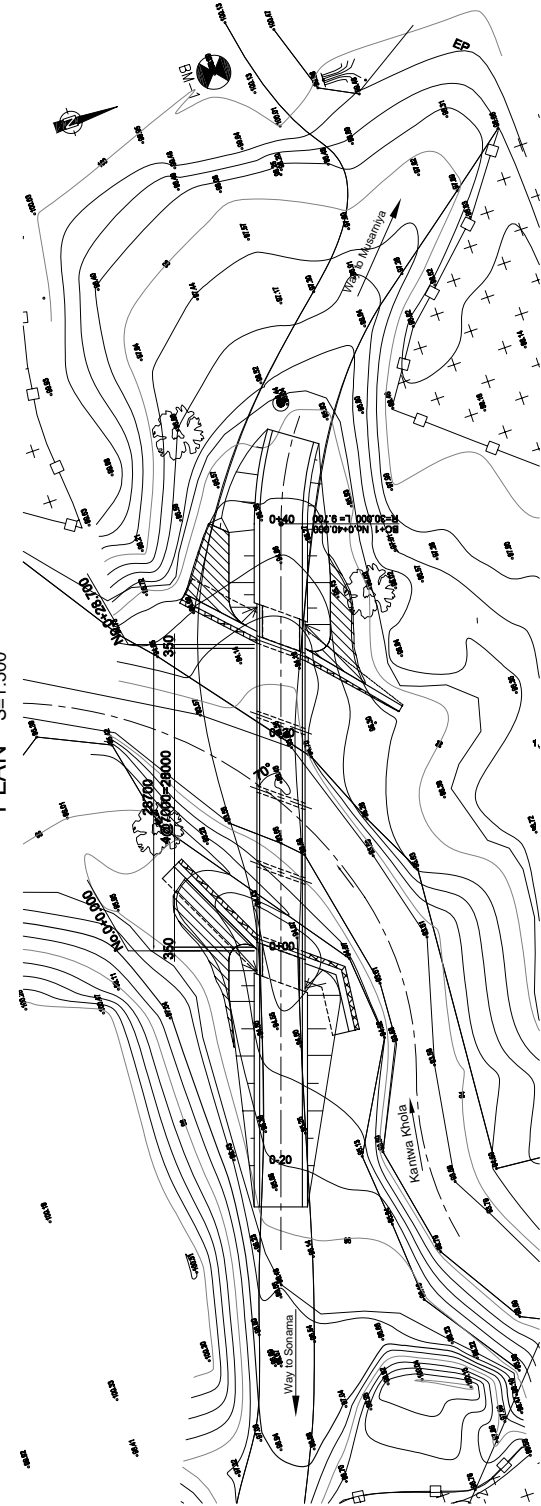

| | | | | | |
|---|--|---|-------------------------------|----------|-------------|
| OUTLINE DESIGN OF RIVER CROSSING STRUCTURES | THE PROJECT FOR THE IMPROVEMENT OF COMMUNITY ACCESS IN NEPAL LOT - 4 | DRAWING TITLE: | | SCALE | DRAWING NO. |
| | | 1-2 GENERAL VIEW OF KANTWA KHOLA BRIDGE | | | |
| | | PROVINCE | Mahottari | AS SHOWN | 9 |
| | | ROAD NAME | Laxmaniya-Barapur-Rajhathapur | | |
| | | SITE NO. | 1-2 | | |
| | | RIVER NAME | KANTWA KHOLA | | |

5-11 GENERAL VIEW OF KARTHA KHOLA BRIDGE

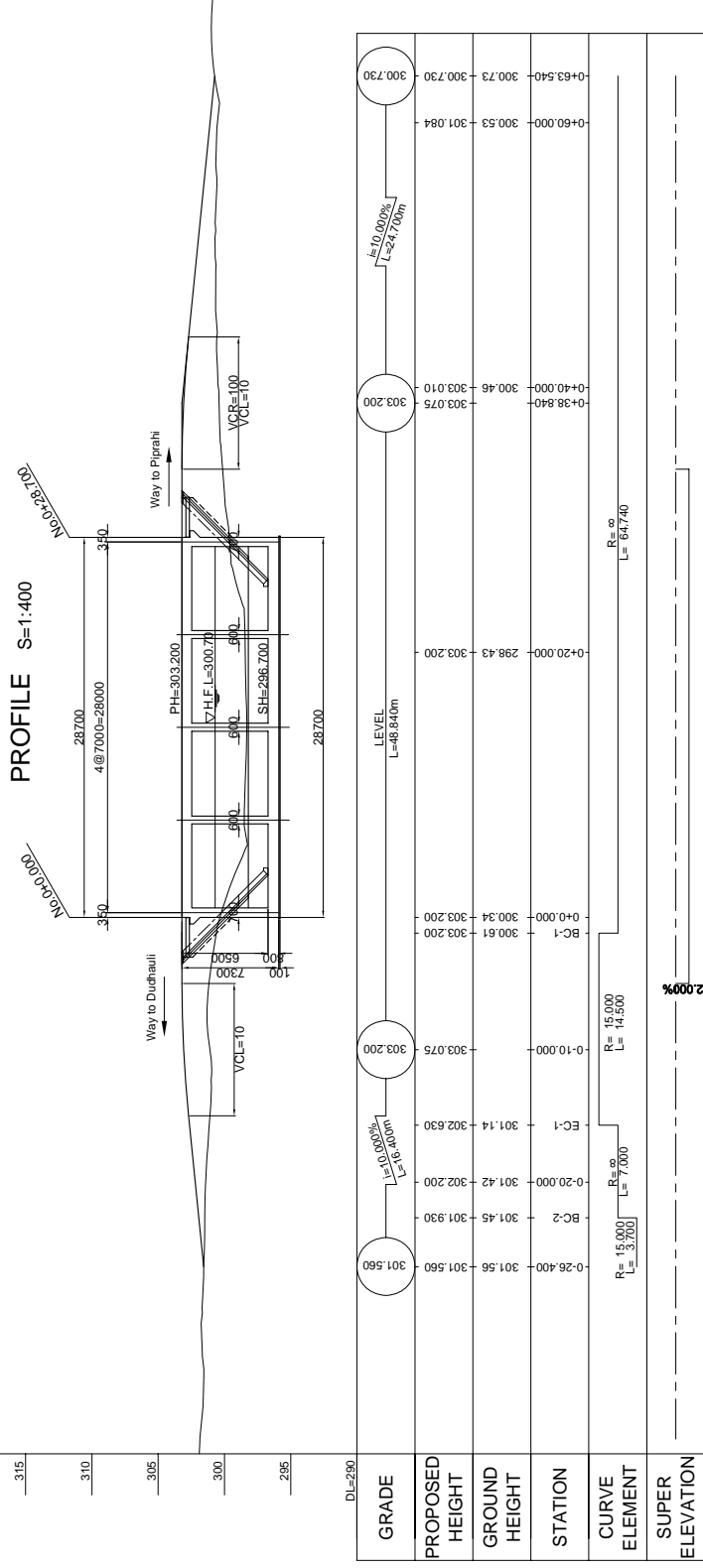

TYPICAL CROSS SECTION S=1:200

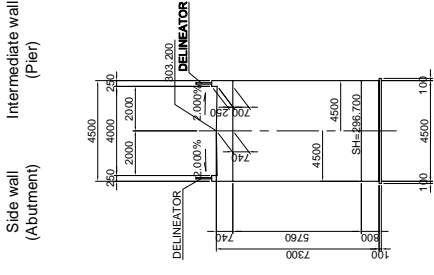

APPROACH ROAD S=1:200

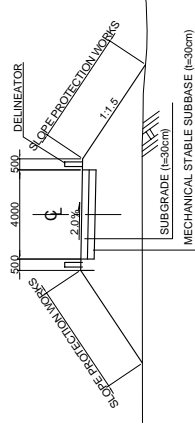

PLAN S=1:400

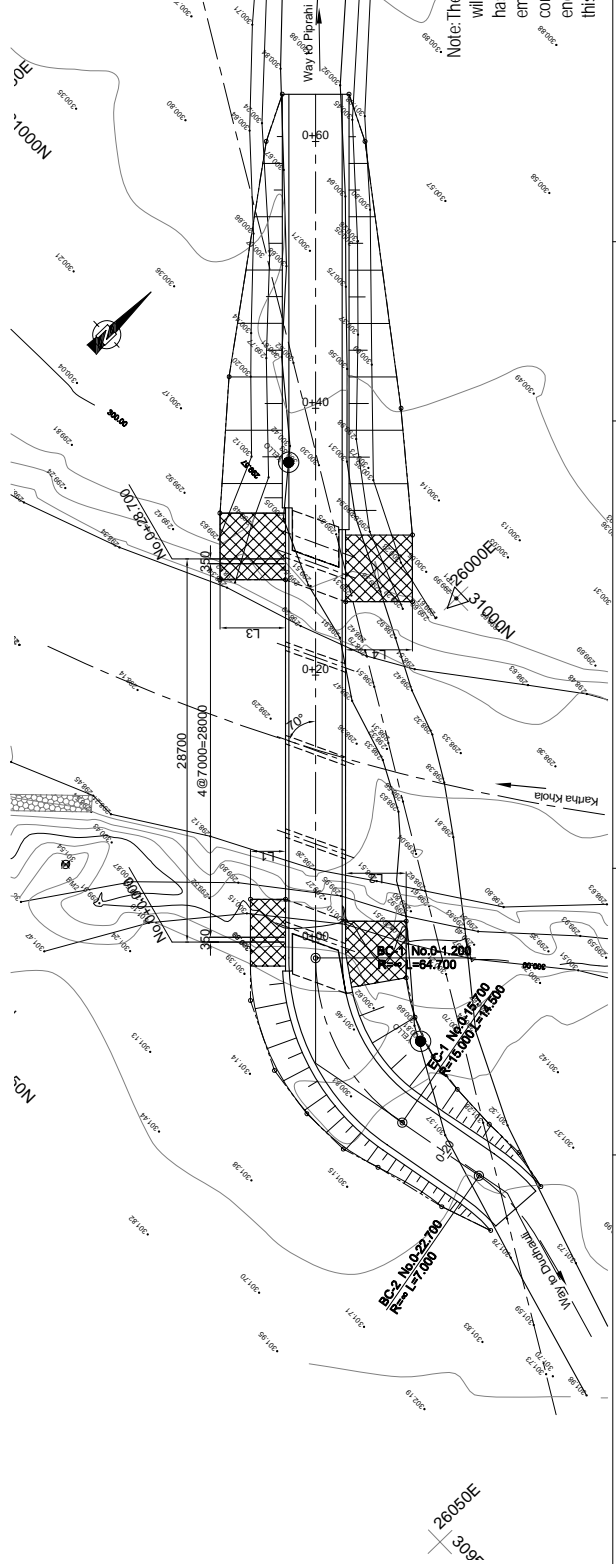

Note: The details around abutments including the lengths of L1, L2, L3 and L4 will be determined based on the actual site condition. The contractor has to prepare the shop drawings for the shape and dimension of embankment slopes, retaining walls and other structures necessary to complete the works based on the site condition for approval of the engineer. No claim except adjustment of quantities shall be made by this adjustment.

| | | | | | | |
|---|---|--|---------------------------------|----------|-------|-------------|
| OUTLINE DESIGN OF RIVER CROSSING STRUCTURES | THE PROJECT FOR THE IMPROVEMENT OF COMMUNITY ACCESS IN NEPAL LOT - 5 | DRAWING TITLE: | | | SCALE | DRAWING NO. |
| | | 5-11 GENERAL VIEW OF KARTHA KHOLA BRIDGE | | | | |
| | | PROVINCE | Sindhuli | | | |
| | | ROAD NAME | Dakrha-Sindhuli-Dudhauri-Katari | | | |
| | | SITE NO. | 5-11 | AS SHOWN | | 11 |
| | | RIVER NAME | KARTHA KHOLA | | | |

5-7 GENERAL VIEW OF KANTAWA KHOLA BRIDGE

PROFILE S=1:400

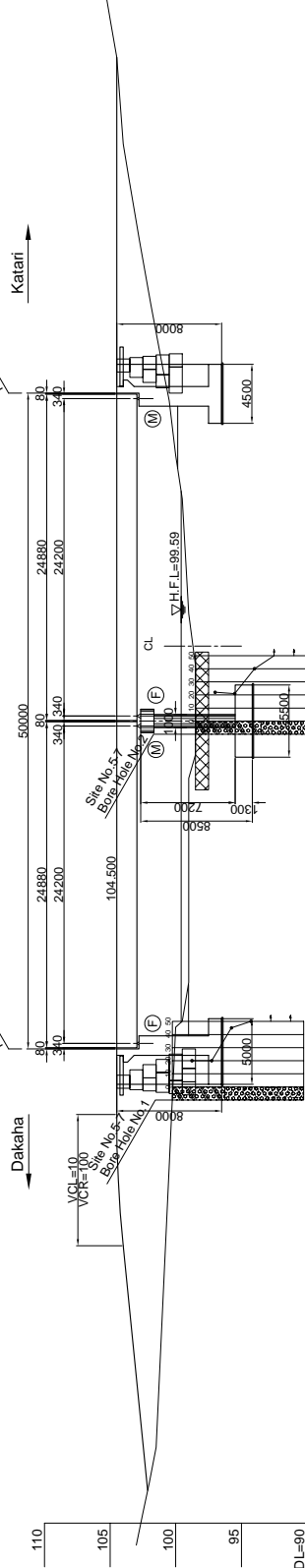

| GRADE | PROPOSED HEIGHT | GROUND HEIGHT | STATION | CURVE ELEMENT | SUPER ELEVATION |
|-------|-----------------|---------------|----------|-----------------------|-----------------|
| DL=90 | 104.500 | 102.150 | 0+33.500 | R=50.000 L=15.412 | |
| | | 102.10 | 0-21.576 | R=61.276 | |
| | | 101.09 | 0-10.000 | | |
| | | 100.55 | 0-6.164 | | |
| | | 100.37 | 104.500 | | |
| | | 100.08 | 104.500 | | |
| | | 98.50 | 104.500 | | |
| | | 100.61 | 104.500 | | |
| | | 101.59 | 104.500 | | |
| | | 104.50 | 104.500 | | |
| | | 104.50 | 0+76.000 | R=100.000 L=20.986 | |

TYPICAL CROSS SECTION SUPERSTRUCTURE

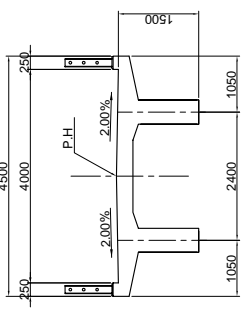

SUBSTRUCTURE A1 ABUTMENT

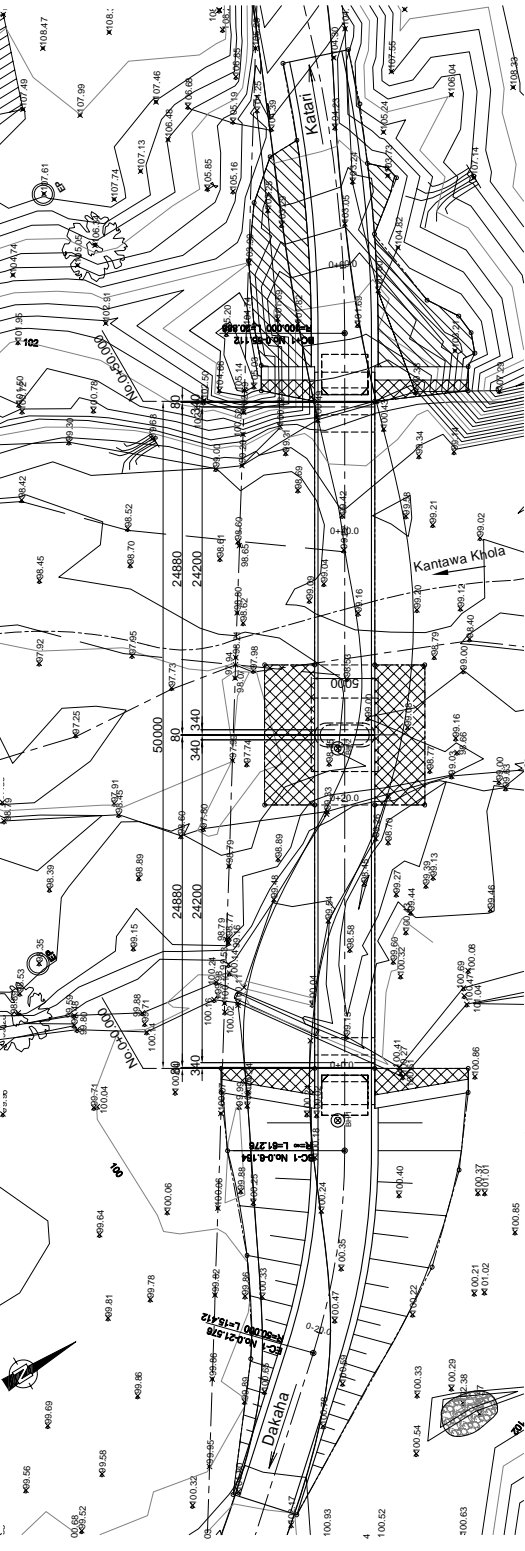
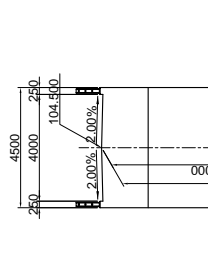

PLAN S=1:400

Note: The details around abutments including the lengths will be determined based on the actual site condition. The contractor has to prepare the shop drawings for the shape and dimension of embankment slopes, retaining walls and other structures necessary to complete the works based on the site condition for approval of the engineer. No claim except adjustment of quantities shall be made by this adjustment.

APPROACH ROAD

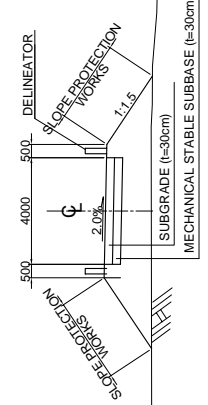

| | | | | | |
|---|--|------------|----------------------------------|----------|-------------|
| OUTLINE DESIGN OF RIVER CROSSING STRUCTURES | DRAWING TITLE: | | PROVINCE | SCALE | DRAWING NO. |
| | THE PROJECT FOR THE IMPROVEMENT OF COMMUNITY ACCESS IN NEPAL LOT - 5 | | Sindhuli | AS SHOWN | 13 |
| 5-7 GENERAL VIEW OF KANTAWA KHOLA BRIDGE | | ROAD NAME | Dakaha-Sindhuli-Dudhauri-Kantari | | |
| | | SITE NO. | 5-7 | | |
| | | RIVER NAME | KANTAWA-KHOLA | | |

