

**JAPAN INTERNATIONAL COOPERATION AGENCY**  

**NATIONAL ROAD ADMINISTRATION**

REMARKS:

**THE PREPARATORY SURVEY ON ROAD IMPROVEMENT PLAN IN NACALA DEVELOPMENT CORRIDOR (N13: CUAMBA-MANDIMBA-LICHINGA)**  
 Eight-Japan Engineering Consultants Inc.  
 Oriental Consultants Co., Ltd

DRAWING TITLE

Plan and Profile (4)

NAME	PREPARED BY	CHECKED BY	APPROVED BY	SCALE	SHEET NO.	DRAWING NO.	REV. NO.
SIGNATURE				1/10,000	5	5	-
DATE							

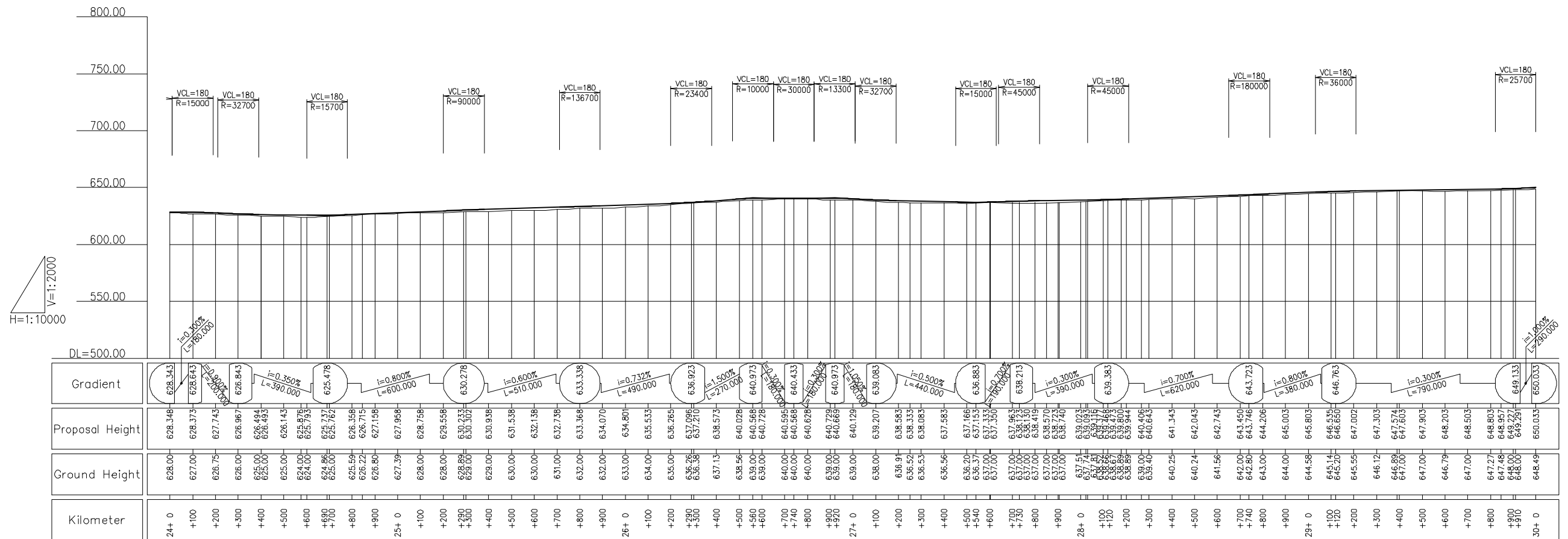

Kilometer	Ground Height	Proposal Height	Gradient
24+ 0	628.00	628.348	628.343
+100	627.00	628.375	628.643
+200	626.75	627.43	628.843
+300	626.00	626.967	$i=0.350\%$ $L=390.000$
+400	625.00	626.494	625.478
+500	625.00	626.143	$i=0.800\%$ $L=600.000$
+600	624.00	625.876	630.278
+700	624.86	625.737	$i=0.600\%$ $L=510.000$
+800	625.59	626.358	633.368
+900	626.22	626.715	$i=0.732\%$ $L=490.000$
25+ 0	626.80	627.158	634.070
+100	627.39	627.958	634.801
+200	628.00	628.758	635.533
+300	628.00	629.558	636.265
+400	628.86	630.237	$i=1.500\%$ $L=270.000$
+500	629.00	630.938	636.923
+600	630.00	631.538	$i=0.500\%$ $L=440.000$
+700	630.00	632.138	637.210
+800	631.00	632.738	638.575
+900	632.00	633.368	640.078
26+ 0	632.00	634.070	640.568
+100	633.00	634.801	640.973
+200	634.00	635.533	640.728
+300	635.00	636.265	640.568
+400	636.26	637.096	640.433
+500	636.38	637.210	640.288
+600	637.13	638.575	$i=0.300\%$ $L=390.000$
+700	638.56	640.078	640.728
+800	639.00	640.568	640.973
+900	639.00	640.669	$i=0.700\%$ $L=620.000$
27+ 0	639.00	640.129	640.973
+100	638.00	639.207	638.083
+200	636.91	638.583	638.883
+300	636.52	638.333	$i=0.800\%$ $L=380.000$
+400	636.53	638.083	638.213
+500	636.56	637.583	$i=0.300\%$ $L=390.000$
+600	637.00	637.166	639.023
+700	637.00	637.153	639.023
+800	637.00	637.333	639.116
+900	637.00	637.333	639.116
28+ 0	637.00	637.000	639.213
+100	637.00	638.133	639.473
+200	637.00	638.473	639.773
+300	637.00	638.575	639.800
+400	637.00	638.723	639.944
+500	637.00	638.740	640.023
+600	637.57	639.023	640.023
+700	637.81	639.116	640.023
+800	638.26	639.213	640.023
+900	638.67	639.473	640.023
29+ 0	638.89	639.800	640.023
+100	639.00	640.023	640.023
+200	640.25	641.343	642.043
+300	640.25	642.043	642.743
+400	640.24	642.043	643.450
+500	641.56	642.743	643.746
+600	642.00	643.450	644.206
+700	642.80	643.746	645.003
+800	643.00	644.206	645.803
+900	644.00	645.003	646.535
30+ 0	644.58	645.803	646.650
+100	645.14	646.535	647.002
+200	645.20	646.650	647.303
+300	645.55	647.002	647.603
+400	646.12	647.303	647.903
+500	646.88	647.603	648.203
+600	647.00	647.903	648.503
+700	647.00	648.203	648.803
+800	647.27	648.503	649.133
+900	647.48	648.957	650.033
30+ 0	648.00	649.257	650.033
30+ 0	648.49	650.033	650.033

 JAPAN INTERNATIONAL COOPERATION AGENCY  
 NATIONAL ROAD ADMINISTRATION

REMARKS:

THE PREPARATORY SURVEY ON ROAD IMPROVEMENT PLAN IN NACALA DEVELOPMENT CORRIDOR  
 (N13: CUAMBA-MANDIMBA-LICHINGA)

Eight-Japan Engineering Consultants Inc.  
 Oriental Consultants Co., Ltd

DRAWING TITLE

Plan and Profile (5)

PREPARED BY	CHECKED BY	APPROVED BY	SCALE	SHEET NO.	DRAWING NO.	REV. NO.
NAME			1/10,000		6	-
SIGNATURE						
DATE						

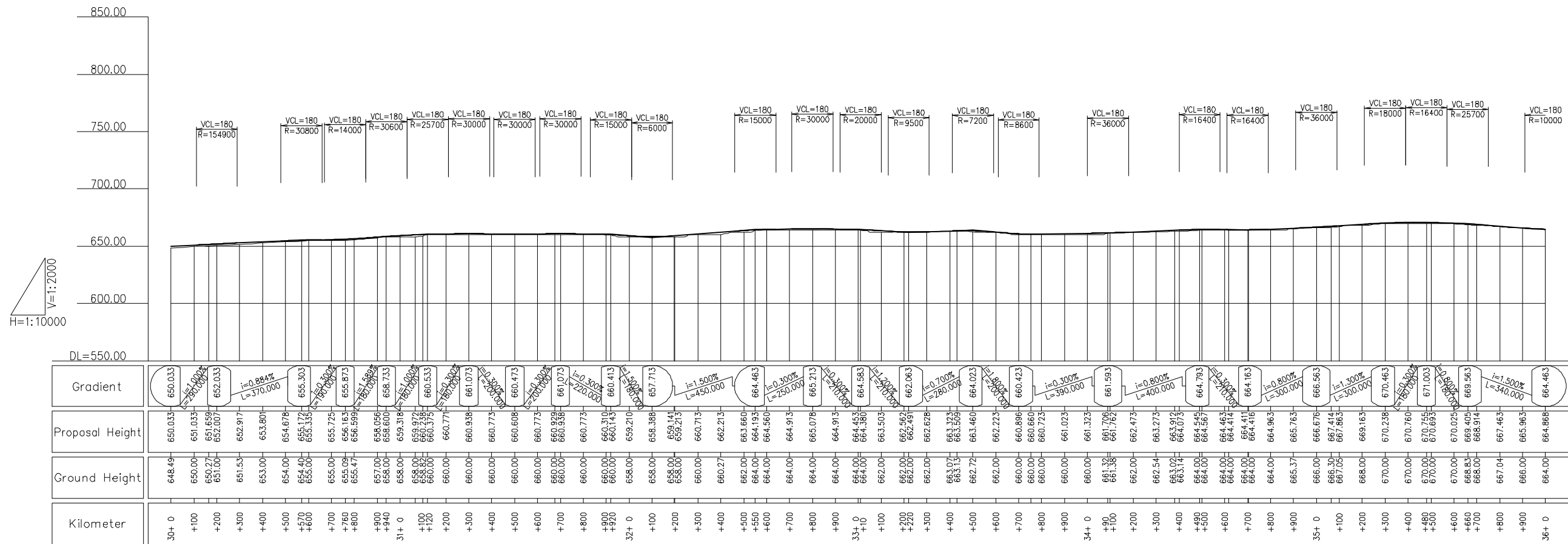

JAPAN INTERNATIONAL COOPERATION AGENCY  
 NATIONAL ROAD ADMINISTRATION

REMARKS:

THE PREPARATORY SURVEY ON ROAD IMPROVEMENT PLAN IN NACALA DEVELOPMENT CORRIDOR  
 (N13: CUAMBA-MANDIMBA-LICHINGA)

Eight-Japan Engineering Consultants Inc.  
 Oriental Consultants Co., Ltd

DRAWING TITLE

Plan and Profile (6)

PREPARED BY	CHECKED BY	APPROVED BY	SCALE	SHEET NO.	DRAWING NO.	REV. NO.
NAME			1/10,000	7	7	-
SIGNATURE						
DATE						



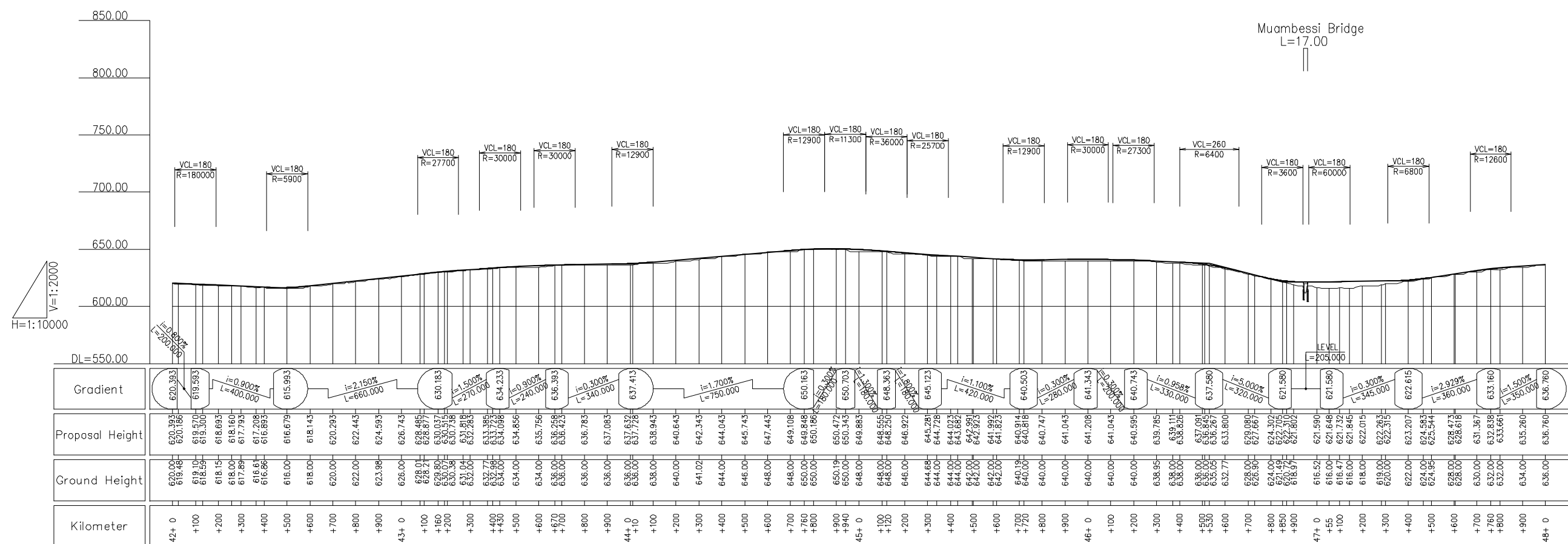
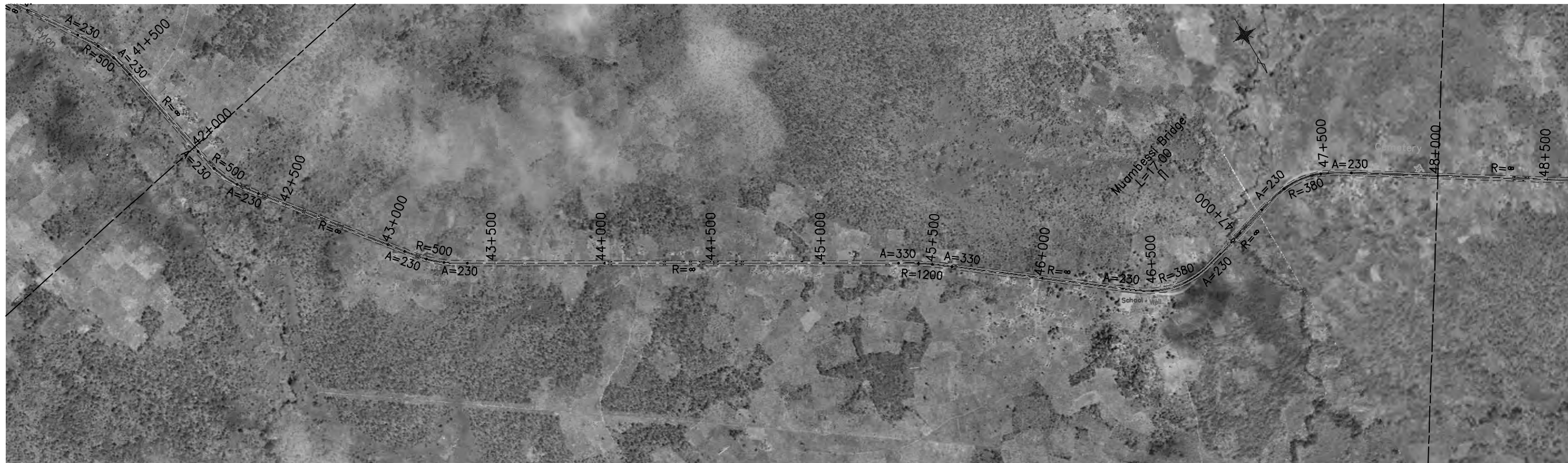

	<b>REMARKS:</b> 	<b>THE PREPARATORY SURVEY ON ROAD IMPROVEMENT PLAN IN NACALA DEVELOPMENT CORRIDOR (N13: CUAMBA-MANDIMBA-LICHINGA)</b>			
		Eight-Japan Engineering Consultants Inc. Oriental Consultants Co., Ltd		DRAWING TITLE <b>Plan and Profile (8)</b>	
		PREPARED BY	CHECKED BY	APPROVED BY	
		NAME			
		SIGNATURE			
		DATE		SCALE	SHEET NO.
				1/10,000	9
				DRAWING NO.	REV. NO.
					-

