

**ADMINISTRAÇÃO NACIONAL DE ESTRADAS
REPÚBLICA DE MOÇAMBIQUE**

**O ESTUDO PREPARATÓRIO
SOBRE
PLANO DE MELHORAMENTO DA ESTRADA
NO CORREDOR DE DESENVOLVIMENTO DE NACALA
(N13: CUAMBA-MANDIMBA-LICHINGA)
NA
REPÚBLICA DE MOÇAMBIQUE**

**RELATÓRIO FINAL
3 de 3
Desenhos**

Secção Cuamba-Mandimba

Fevereiro de 2010

AGÊNCIA JAPONESA DE COOPERAÇÃO INTERNACIONAL

Eight - Japan Engineering Consultants Inc.

Oriental Consultants Co., Ltd.

Mapa da Localização

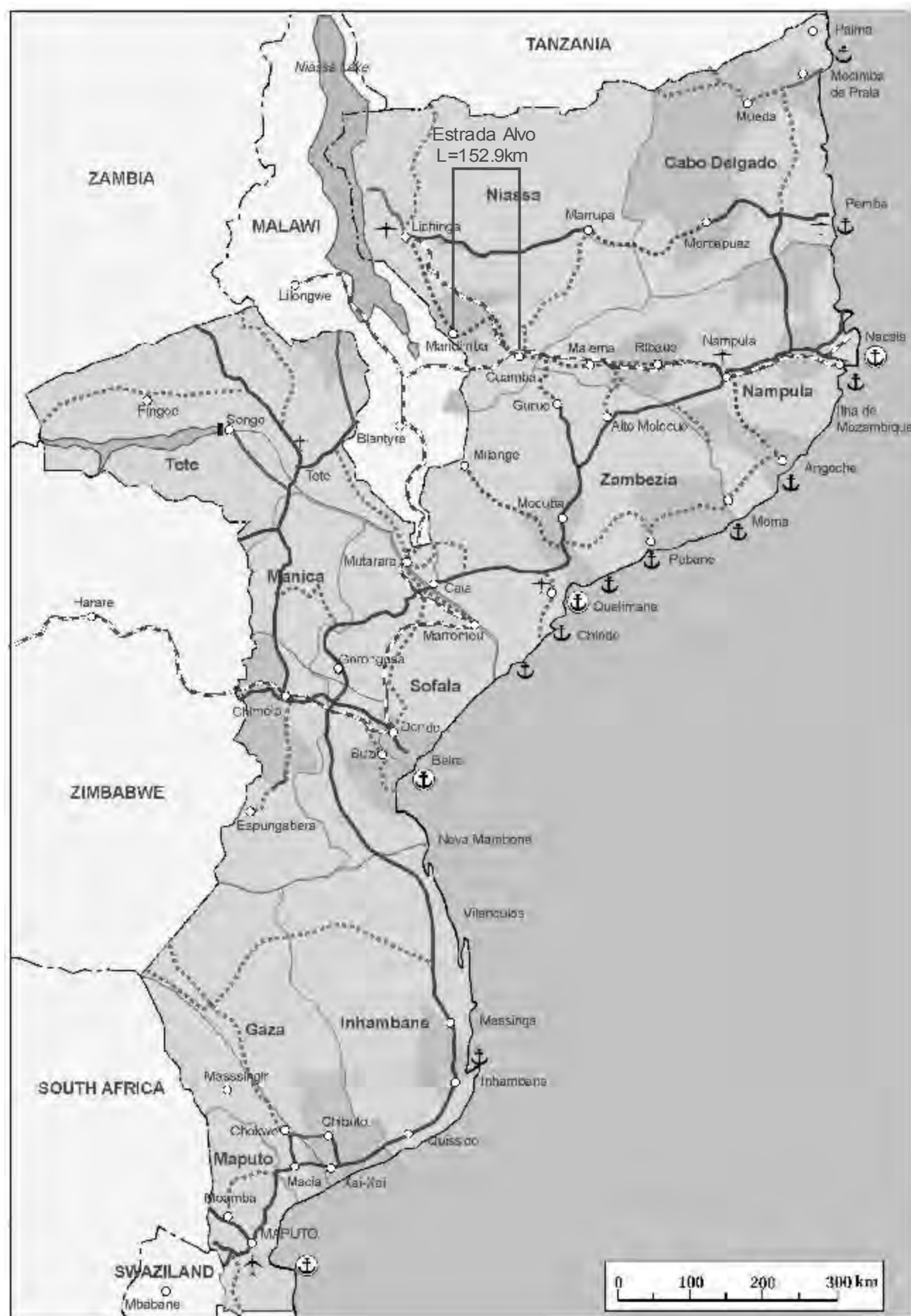
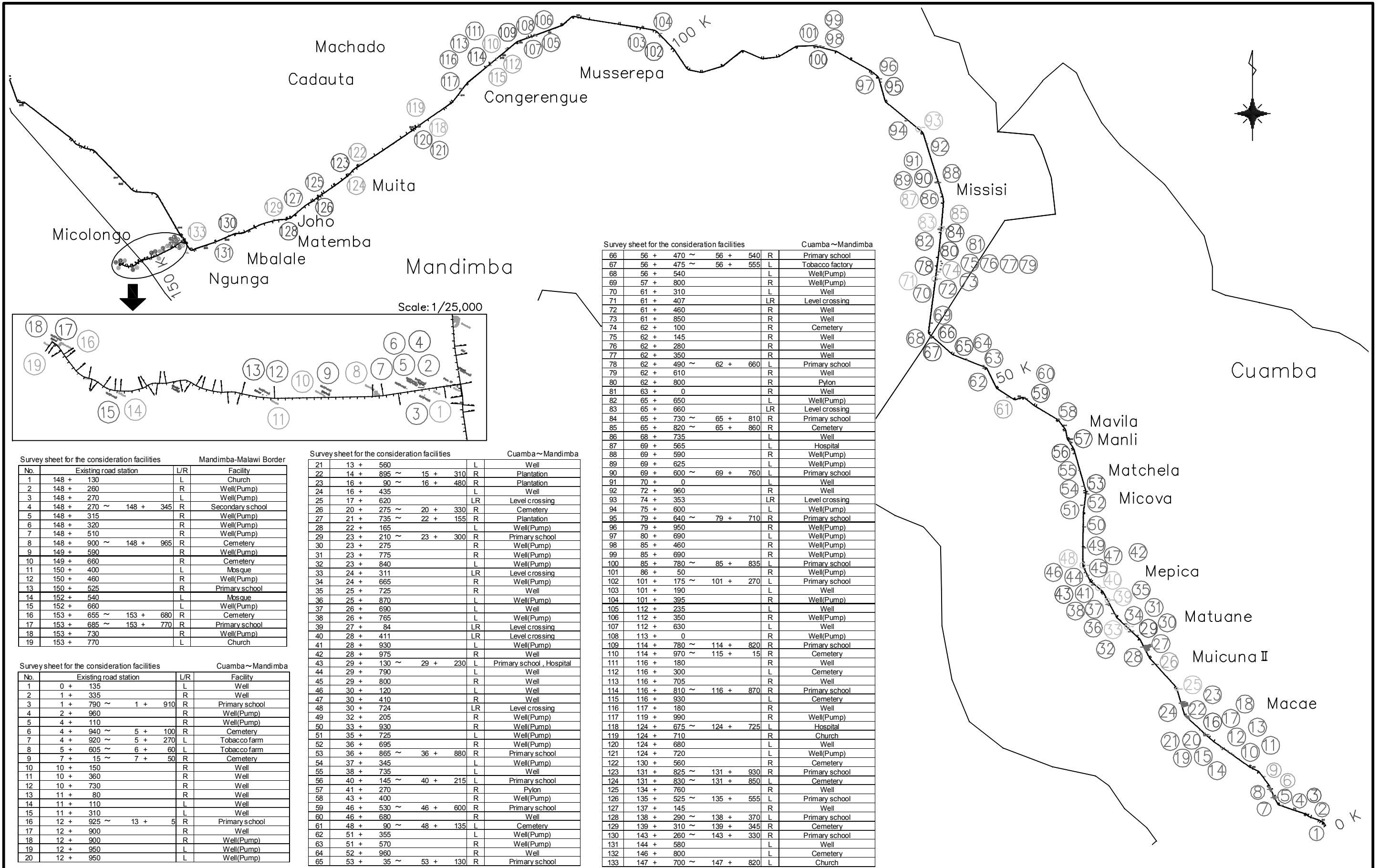

Table of Contents

Drawing Title	No.
1. Mapa da Localização das Instalações a serem Consideradas	1
2. Plano e Perfil	2~27
3. Perfil Transversal Típico	28
4. Vista Geral da Ponte	29~32
5. Detalhes Estruturais do Aqueduto	33~42
6. Detalhes Estruturais do Aqueduto de Tubo	43~46
7. Detalhes de Drenagem	47
8. Obra Anexa	48
9. Detalhes para Colocação de Barreiras de Protecção	49
10. Sinais Rodoviários	50
11. Marcação Rodoviária	51
12. Detalhes da Passagem de Nível	52
13. A passagem de nível com o cruzamento sobreposto (como uma referência)	53~54



Survey sheet for the consideration facilities Mandimba-Malawi Border

No.	Existing road station	L/R	Facility
1	148 + 130	L	Church
2	148 + 260	R	Well(Pump)
3	148 + 270	L	Well(Pump)
4	148 + 270 ~ 148 + 345	R	Secondary school
5	148 + 315	R	Well(Pump)
6	148 + 320	R	Well(Pump)
7	148 + 510	R	Well(Pump)
8	148 + 900 ~ 148 + 965	R	Cemetery
9	149 + 590	R	Well(Pump)
10	149 + 660	R	Cemetery
11	150 + 400	L	Mosque
12	150 + 460	R	Well(Pump)
13	150 + 525	R	Primary school
14	152 + 540	L	Mosque
15	152 + 660	L	Well(Pump)
16	153 + 655 ~ 153 + 680	R	Cemetery
17	153 + 685 ~ 153 + 770	R	Primary school
18	153 + 730	R	Well(Pump)
19	153 + 770	L	Church

Survey sheet for the consideration facilities Cuamba~Mandimba

No.	Existing road station	L/R	Facility
21	13 + 560	L	Well
22	14 + 895 ~ 15 + 310	R	Plantation
23	16 + 90 ~ 16 + 480	R	Plantation
24	16 + 435	L	Well
25	17 + 620	LR	Level crossing
26	20 + 275 ~ 20 + 330	R	Cemetery
27	21 + 735 ~ 22 + 155	R	Plantation
28	22 + 165	L	Well(Pump)
29	23 + 210 ~ 23 + 300	R	Primary school
30	23 + 275	R	Well(Pump)
31	23 + 775	R	Well(Pump)
32	23 + 840	L	Well(Pump)
33	24 + 311	LR	Level crossing
34	24 + 665	R	Well(Pump)
35	25 + 725	R	Well
36	25 + 870	L	Well(Pump)
37	26 + 690	L	Well
38	26 + 765	L	Well(Pump)
39	27 + 84	LR	Level crossing
40	28 + 411	LR	Level crossing
41	28 + 930	L	Well(Pump)
42	28 + 975	R	Well
43	29 + 130 ~ 29 + 230	L	Primary school, Hospital
44	29 + 790	R	Well
45	29 + 800	R	Well
46	30 + 120	L	Well
47	30 + 410	R	Well
48	30 + 724	LR	Level crossing
49	32 + 205	R	Well(Pump)
50	33 + 930	R	Well(Pump)
51	35 + 725	L	Well(Pump)
52	36 + 695	R	Well(Pump)
53	36 + 865 ~ 36 + 880	R	Primary school
54	37 + 345	L	Well(Pump)
55	38 + 735	L	Well
56	40 + 145 ~ 40 + 215	R	Primary school
57	41 + 270	R	Pylon
58	43 + 400	R	Well(Pump)
59	46 + 530 ~ 46 + 600	R	Primary school
60	46 + 680	R	Well
61	48 + 90 ~ 48 + 135	L	Cemetery
62	51 + 355	L	Well(Pump)
63	51 + 570	R	Well(Pump)
64	52 + 960	R	Well
65	53 + 35 ~ 53 + 130	R	Primary school

Survey sheet for the consideration facilities Cuamba~Mandimba

No.	Existing road station	L/R	Facility
66	56 + 470 ~ 56 + 540	R	Primary school
67	56 + 475 ~ 56 + 555	L	Tobacco factory
68	56 + 540	L	Well(Pump)
69	57 + 800	R	Well(Pump)
70	61 + 310	L	Well
71	61 + 407	LR	Level crossing
72	61 + 460	R	Well
73	61 + 850	R	Well
74	62 + 100	R	Cemetery
75	62 + 145	R	Well
76	62 + 280	R	Well
77	62 + 350	R	Well
78	62 + 490 ~ 62 + 660	L	Primary school
79	62 + 610	R	Well
80	62 + 800	R	Pylon
81	63 + 0	R	Well
82	65 + 650	L	Well(Pump)
83	65 + 660	LR	Level crossing
84	65 + 730 ~ 65 + 810	R	Primary school
85	65 + 820 ~ 65 + 860	R	Cemetery
86	68 + 735	L	Well
87	69 + 565	L	Hospital
88	69 + 590	R	Well(Pump)
89	69 + 625	L	Well(Pump)
90	69 + 600 ~ 69 + 760	L	Primary school
91	70 + 0	L	Well
92	72 + 960	R	Well
93	74 + 353	LR	Level crossing
94	75 + 600	L	Well(Pump)
95	79 + 640 ~ 79 + 710	R	Primary school
96	79 + 950	R	Well(Pump)
97	80 + 690	L	Well(Pump)
98	85 + 460	R	Well(Pump)
99	85 + 690	R	Well(Pump)
100	85 + 780 ~ 85 + 835	L	Primary school
101	86 + 50	R	Well(Pump)
102	101 + 175 ~ 101 + 270	L	Primary school
103	101 + 190	L	Well
104	101 + 395	R	Well(Pump)
105	112 + 235	L	Well
106	112 + 350	R	Well(Pump)
107	112 + 630	L	Well
108	113 + 0	R	Well(Pump)
109	114 + 780 ~ 114 + 820	R	Primary school
110	114 + 970 ~ 115 + 15	R	Cemetery
111	116 + 180	R	Well
112	116 + 300	L	Cemetery
113	116 + 705	R	Well
114	116 + 810 ~ 116 + 870	R	Primary school
115	116 + 930	L	Cemetery
116	117 + 180	R	Well
117	119 + 990	R	Well(Pump)
118	124 + 675 ~ 124 + 725	L	Hospital
119	124 + 710	R	Church
120	124 + 680	L	Well
121	124 + 720	L	Well(Pump)
122	130 + 560	R	Cemetery
123	131 + 825 ~ 131 + 930	R	Primary school
124	131 + 830 ~ 131 + 850	L	Cemetery
125	134 + 760	R	Well
126	135 + 525 ~ 135 + 555	L	Primary school
127	137 + 145	R	Well
128	138 + 290 ~ 138 + 370	L	Primary school
129	139 + 310 ~ 139 + 345	R	Cemetery
130	143 + 260 ~ 143 + 330	R	Primary school
131	144 + 580	L	Well
132	146 + 800	L	Cemetery
133	147 + 700 ~ 147 + 820	L	Church

Survey sheet for the consideration facilities Cuamba~Mandimba

No.	Existing road station	L/R	Facility
1	0 + 135	L	Well
2	1 + 335	R	Well
3	1 + 790 ~ 1 + 910	R	Primary school
4	2 + 960	R	Well(Pump)
5	4 + 110	R	Well(Pump)
6	4 + 940 ~ 5 + 100	R	Cemetery
7	4 + 920 ~ 5 + 270	L	Tobacco farm
8	5 + 605 ~ 6 + 60	L	Tobacco farm
9	7 + 15 ~ 7 + 50	R	Cemetery
10	10 + 150	R	Well
11	10 + 360	R	Well
12	10 + 730	R	Well
13	11 + 80	R	Well
14	11 + 110	L	Well
15	11 + 310	L	Well
16	12 + 925 ~ 13 + 5	R	Primary school
17	12 + 900	R	Well
18	12 + 900	R	Well(Pump)
19	12 + 950	L	Well(Pump)
20	12 + 950	L	Well(Pump)

JICA JAPAN INTERNATIONAL COOPERATION AGENCY

ANE NATIONAL ROAD ADMINISTRATION

REMARKS:

THE PREPARATORY SURVEY ON ROAD IMPROVEMENT PLAN IN NACALA DEVELOPMENT CORRIDOR (N13: CUAMBA-MANDIMBA-LICHINGA)

Eight-Japan Engineering Consultants Inc.
Oriental Consultants Co., Ltd

DRAWING TITLE: Location Map of the Consideration Facilities

PREPARED BY	CHECKED BY	APPROVED BY
NAME		
SIGNATURE		
DATE		

SCALE	SHEET NO.	DRAWING NO.	REV. NO.
1/150,000		1	-

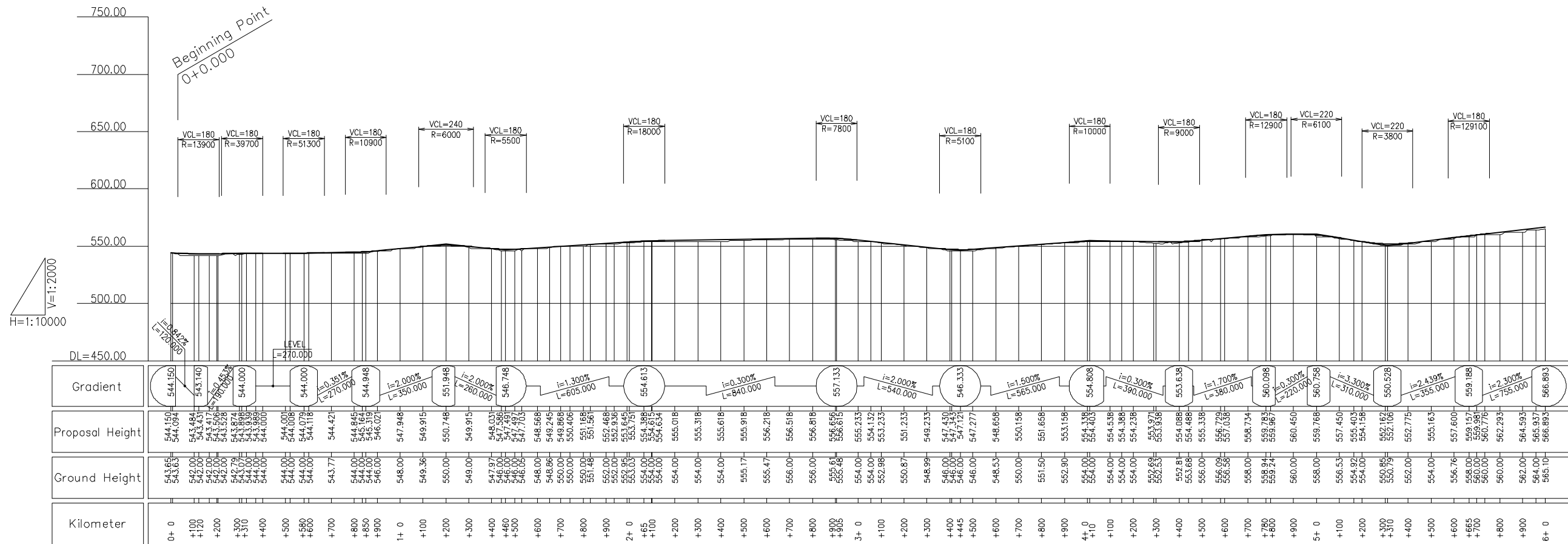

JICA JAPAN INTERNATIONAL COOPERATION AGENCY

ANE NATIONAL ROAD ADMINISTRATION

REMARKS:

THE PREPARATORY SURVEY ON ROAD IMPROVEMENT PLAN IN NACALA DEVELOPMENT CORRIDOR (N13: CUAMBA-MANDIMBA-LICHINGA)

Eight-Japan Engineering Consultants Inc.
Oriental Consultants Co., Ltd

DRAWING TITLE

Plan and Profile (1)

	PREPARED BY	CHECKED BY	APPROVED BY
NAME			
SIGNATURE			
DATE			

SCALE	SHEET NO.	DRAWING NO.	REV. NO.
1/10,000		2	-

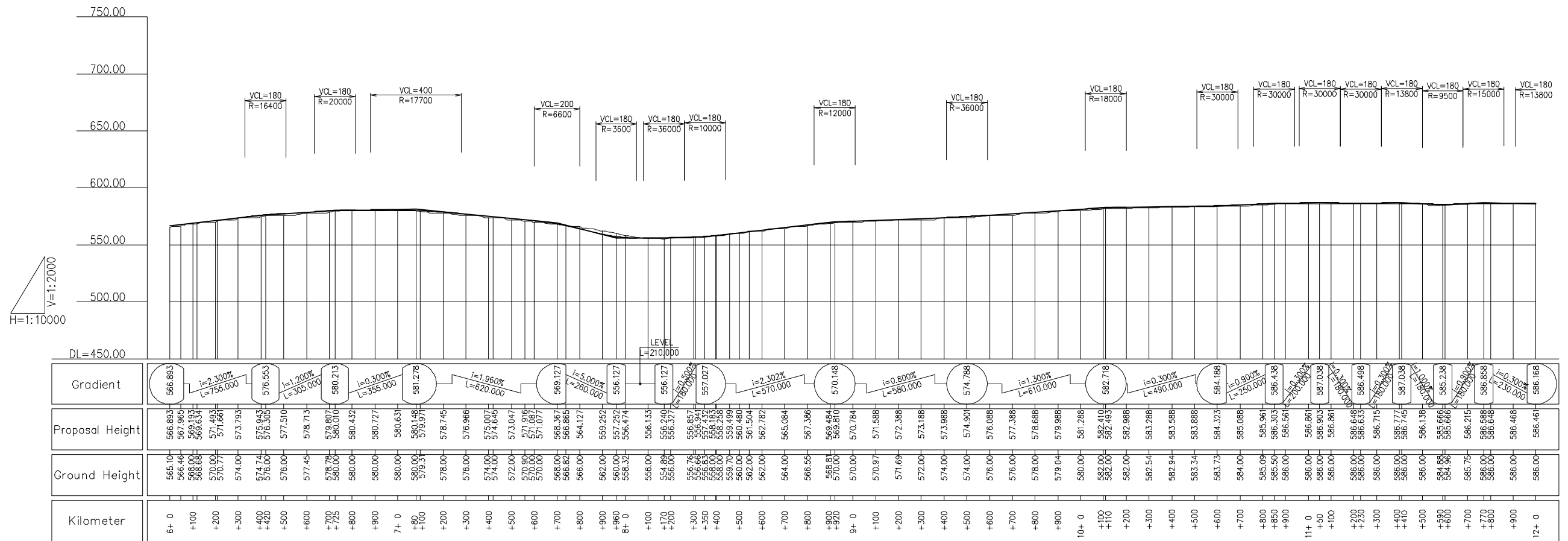
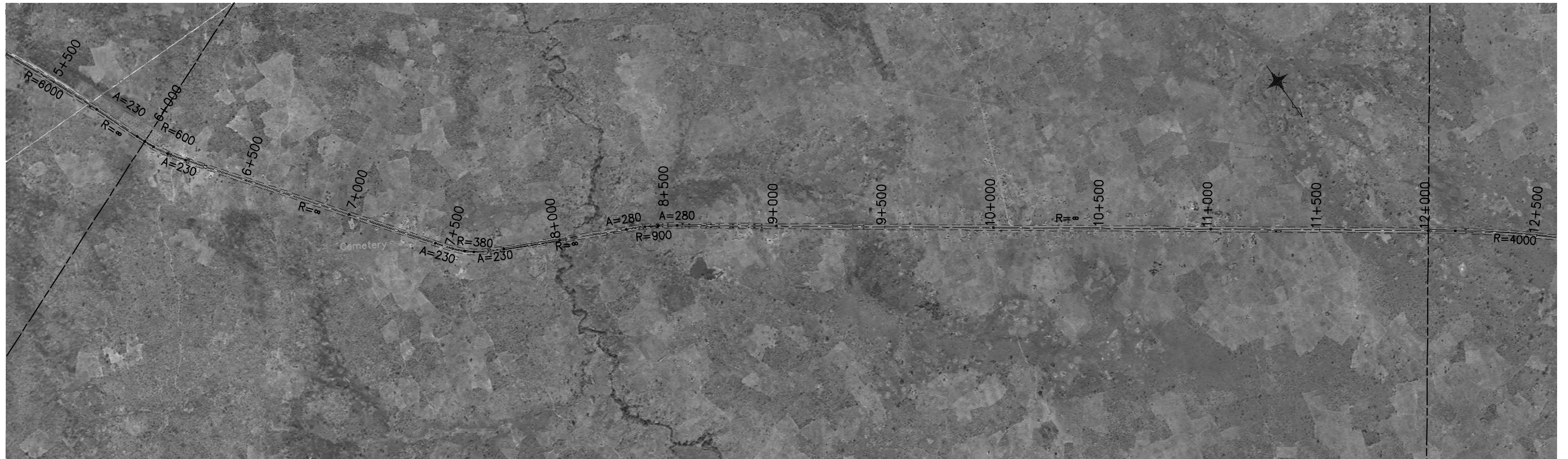

JICA JAPAN INTERNATIONAL COOPERATION AGENCY

ANE NATIONAL ROAD ADMINISTRATION

REMARKS:

THE PREPARATORY SURVEY ON ROAD IMPROVEMENT PLAN IN NACALA DEVELOPMENT CORRIDOR (N13: CUAMBA-MANDIMBA-LICHINGA)

Eight-Japan Engineering Consultants Inc.
Oriental Consultants Co., Ltd

DRAWING TITLE

Plan and Profile (2)

	PREPARED BY	CHECKED BY	APPROVED BY
NAME			
SIGNATURE			
DATE			

SCALE	SHEET NO.	DRAWING NO.	REV. NO.
1/10,000		3	-

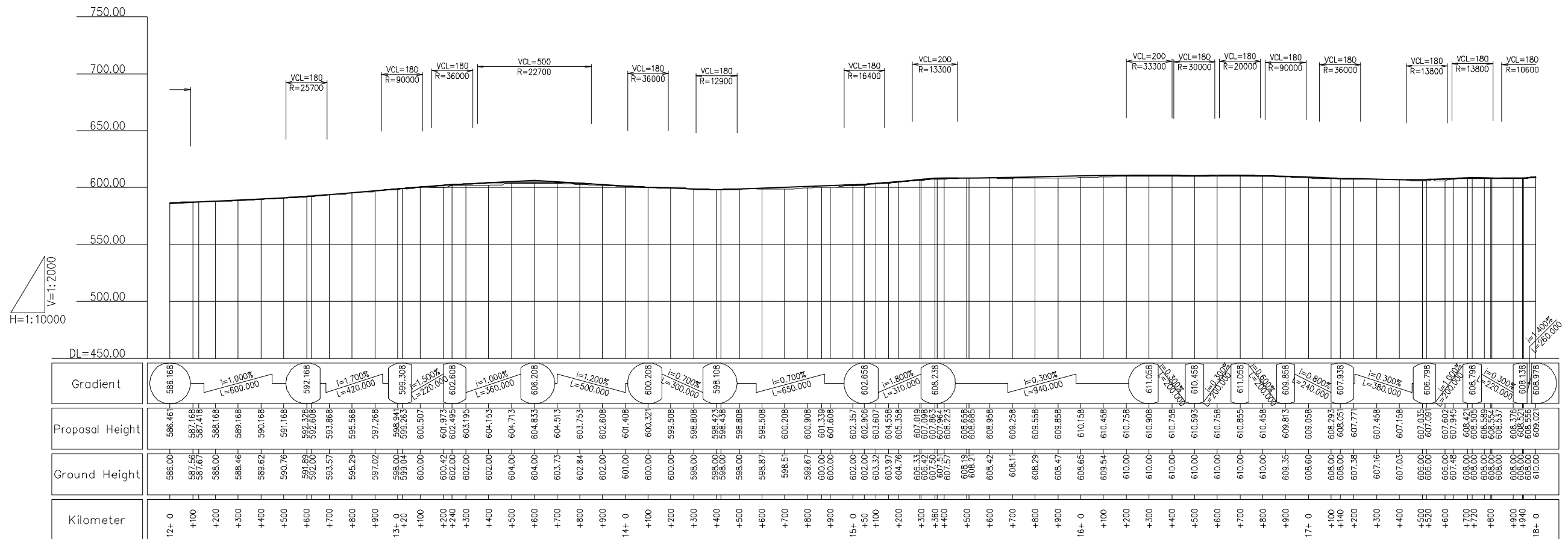

Kilometer	Ground Height	Proposal Height	Gradient
12+0	586.00	586.46	586.168
+100	587.56	587.16	$i=1.000\%$ $L=600.000$
+200	588.00	588.168	592.168
+300	588.46	589.168	$i=1.700\%$ $L=420.000$
+400	589.62	590.168	598.941
+500	590.76	591.168	599.263
+600	591.86	592.608	$i=1.500\%$ $L=220.000$
+700	593.57	593.868	600.507
+800	595.29	595.568	601.973
+900	597.02	597.268	602.495
13+0	598.00	599.04	$i=1.000\%$ $L=360.000$
+100	600.00	600.507	603.195
+200	600.42	601.973	604.153
+300	602.00	602.495	604.713
+400	602.00	602.608	604.833
+500	604.00	604.713	604.513
+600	604.00	604.833	603.753
+700	603.73	604.513	$i=1.200\%$ $L=500.000$
+800	602.84	603.753	600.208
+900	602.00	602.608	$i=0.700\%$ $L=300.000$
14+0	601.00	601.408	598.108
+100	600.00	600.321	598.423
+200	600.00	599.508	598.438
+300	598.00	598.808	598.808
+400	598.00	598.808	599.508
+500	598.87	599.508	600.208
+600	598.87	600.208	600.908
+700	598.51	600.908	601.339
+800	599.67	600.000	601.608
+900	600.00	600.000	602.000
15+0	602.00	602.357	602.658
+50	602.00	602.906	$i=1.800\%$ $L=310.000$
+100	603.32	603.607	602.658
+200	603.97	604.558	607.019
+300	604.76	605.358	607.088
+400	606.33	607.019	607.964
+500	605.42	607.088	607.57
+600	607.57	608.223	608.238
+700	608.18	608.658	608.958
+800	608.21	608.658	609.258
+900	608.42	608.958	609.258
16+0	608.11	609.258	610.158
+100	608.29	609.558	610.458
+200	608.47	609.858	610.758
+300	608.65	610.158	610.908
+400	609.54	610.458	610.798
+500	610.00	610.758	610.593
+600	610.00	610.000	610.758
+700	610.00	610.855	611.058
+800	610.00	610.458	$i=0.300\%$ $L=940.000$
+900	609.35	609.813	611.058
17+0	608.60	609.098	610.858
+100	608.00	608.293	$i=0.800\%$ $L=240.000$
+200	608.00	608.051	607.938
+300	607.38	607.77	$i=0.300\%$ $L=360.000$
+400	607.16	607.458	606.798
+500	607.03	607.158	606.798
+600	606.00	607.035	$i=1.000\%$ $L=300.000$
+700	606.00	607.099	608.421
+800	606.00	607.945	608.505
+900	608.00	608.000	608.589
18+0	608.00	608.376	608.505
+100	608.00	608.505	608.505
+200	608.00	608.505	608.505
+400	608.00	608.505	608.505
+600	608.00	608.505	608.505
+800	608.00	608.505	608.505
+900	608.00	608.505	608.505
18+0	610.00	609.021	608.918

JICA JAPAN INTERNATIONAL COOPERATION AGENCY

ANE NATIONAL ROAD ADMINISTRATION

REMARKS:

THE PREPARATORY SURVEY ON ROAD IMPROVEMENT PLAN IN NACALA DEVELOPMENT CORRIDOR
(N13: CUAMBA-MANDIMBA-LICHINGA)

Eight-Japan Engineering Consultants Inc.
Oriental Consultants Co., Ltd

DRAWING TITLE

Plan and Profile (3)

	PREPARED BY	CHECKED BY	APPROVED BY
NAME			
SIGNATURE			
DATE			

SCALE	SHEET NO.	DRAWING NO.	REV. NO.
1/10,000		4	-