

**NATIONAL ROAD ADMINISTRATION
REPUBLIC OF MOZAMBIQUE**

**THE PREPARATORY STUDY
ON
ROAD IMPROVEMENT PLAN
IN NACALA DEVELOPMENT CORRIDOR
(N13: CUAMBA-MANDIMBA-LICHINGA)
IN
THE REPUBLIC OF MOZAMBIQUE**

**FINAL REPORT
3 of 3
Drawings**

Cuamba-Mandimba Section

February 2010

JAPAN INTERNATIONAL COOPERATION AGENCY

Eight - Japan Engineering Consultants Inc.

Oriental Consultants Co., Ltd.

Location Map



Table of Contents

Drawing Title	No.
1. Location Map of the Consideration Facilities	1
2. Plan and Profile	2~27
3. Typical Cross Section	28
4. General View of the Bridge	29~32
5. Box Culvert Structural Details	33~42
6. Pipe Culvert Structural Details	43~46
7. Drainage Details	47
8. Ancillary Work	48
9. Guardrail Placing Details	49
10. Traffic Signs	50
11. Traffic Marking	51
12. Level Crossing Details	52
13. Level Crossing with an Overpass (as a reference)	53~54

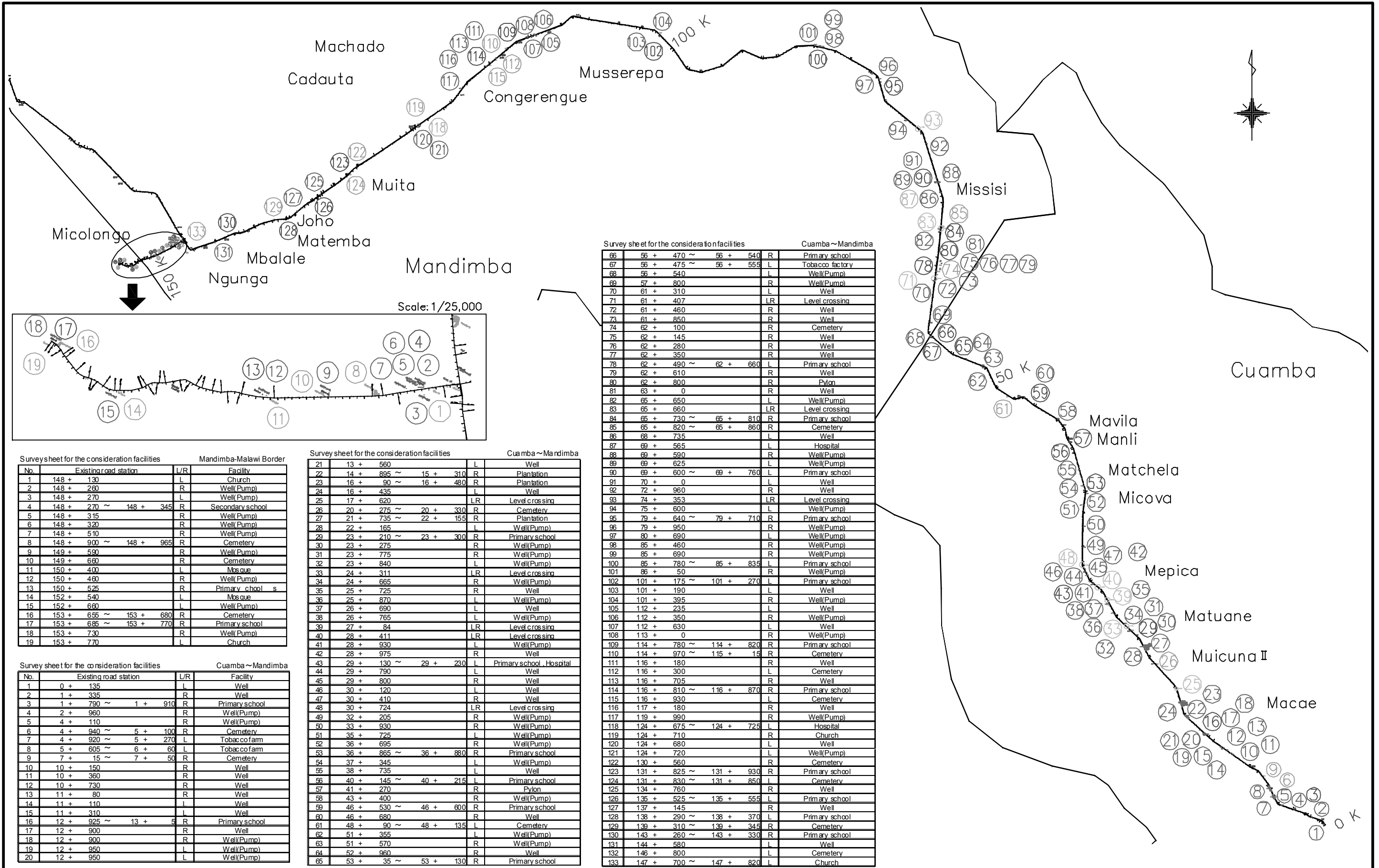

Survey sheet for the consideration facilities Cuamba ~ Mandimba

66	56 + 470 ~ 56 + 540	R	Primary school
67	56 + 475 ~ 56 + 555	L	Tobacco factory
68	56 + 540	L	Well(Pump)
69	57 + 800	R	Well(Pump)
70	61 + 310	L	Well
71	61 + 407	LR	Level crossing
72	61 + 460	R	Well
73	61 + 850	R	Well
74	62 + 100	R	Cemetery
75	62 + 145	R	Well
76	62 + 280	R	Well
77	62 + 350	R	Well
78	62 + 490 ~ 62 + 660	L	Primary school
79	62 + 610	R	Well
80	62 + 800	R	Pylon
81	63 + 0	R	Well
82	65 + 650	L	Well(Pump)
83	65 + 660	LR	Level crossing
84	65 + 730 ~ 65 + 810	R	Primary school
85	65 + 820 ~ 65 + 860	R	Cemetery
86	68 + 735	L	Well
87	69 + 565	L	Hospital
88	69 + 590	R	Well(Pump)
89	69 + 625	L	Well(Pump)
90	69 + 600 ~ 69 + 760	L	Primary school
91	70 + 0	L	Well
92	72 + 960	R	Well
93	74 + 353	LR	Level crossing
94	75 + 600	L	Well(Pump)
95	79 + 640 ~ 79 + 710	R	Primary school
96	79 + 950	R	Well(Pump)
97	80 + 690	L	Well(Pump)
98	85 + 460	R	Well(Pump)
99	85 + 690	R	Well(Pump)
100	85 + 780 ~ 85 + 835	L	Primary school
101	86 + 50	R	Well(Pump)
102	101 + 175 ~ 101 + 270	L	Primary school
103	101 + 190	L	Well
104	101 + 395	R	Well(Pump)
105	112 + 235	L	Well
106	112 + 350	R	Well(Pump)
107	112 + 630	L	Well
108	113 + 0	R	Well(Pump)
109	114 + 780 ~ 114 + 820	R	Primary school
110	114 + 970 ~ 115 + 15	R	Cemetery
111	116 + 180	R	Well
112	116 + 300	L	Cemetery
113	116 + 705	R	Well
114	116 + 810 ~ 116 + 870	R	Primary school
115	116 + 930	L	Cemetery
116	117 + 180	R	Well
117	119 + 990	R	Well(Pump)
118	124 + 675 ~ 124 + 725	L	Hospital
119	124 + 710	R	Church
120	124 + 680	L	Well
121	124 + 720	L	Well(Pump)
122	130 + 560	R	Cemetery
123	131 + 825 ~ 131 + 930	R	Primary school
124	131 + 830 ~ 131 + 850	L	Cemetery
125	134 + 760	R	Well
126	135 + 525 ~ 135 + 555	L	Primary school
127	137 + 145	R	Well
128	138 + 290 ~ 138 + 370	L	Primary school
129	139 + 310 ~ 139 + 345	R	Cemetery
130	143 + 260 ~ 143 + 330	R	Primary school
131	144 + 580	L	Well
132	146 + 800	L	Cemetery
133	147 + 700 ~ 147 + 820	L	Church

Survey sheet for the consideration facilities Mandimba-Malawi Border

No.	Existing road station	L/R	Facility
1	148 + 130	L	Church
2	148 + 260	R	Well(Pump)
3	148 + 270	L	Well(Pump)
4	148 + 270 ~ 148 + 345	R	Secondary school
5	148 + 315	R	Well(Pump)
6	148 + 320	R	Well(Pump)
7	148 + 510	R	Well(Pump)
8	148 + 900 ~ 148 + 965	R	Cemetery
9	149 + 590	R	Well(Pump)
10	149 + 660	R	Well(Pump)
11	150 + 400	L	Mosque
12	150 + 460	R	Well(Pump)
13	150 + 525	R	Primary school
14	152 + 540	L	Mosque
15	152 + 660	L	Well(Pump)
16	153 + 655 ~ 153 + 680	R	Cemetery
17	153 + 685 ~ 153 + 770	R	Primary school
18	153 + 730	R	Well(Pump)
19	153 + 770	L	Church

Survey sheet for the consideration facilities Cuamba ~ Mandimba

21	13 + 560	L	Well
22	14 + 895 ~ 15 + 310	R	Plantation
23	16 + 90 ~ 16 + 480	R	Plantation
24	16 + 435	L	Well
25	17 + 620	LR	Level crossing
26	20 + 275 ~ 20 + 330	R	Cemetery
27	21 + 735 ~ 22 + 155	R	Plantation
28	22 + 165	L	Well(Pump)
29	23 + 210 ~ 23 + 300	R	Primary school
30	23 + 275	R	Well(Pump)
31	23 + 775	R	Well(Pump)
32	23 + 840	L	Well(Pump)
33	24 + 311	LR	Level crossing
34	24 + 665	R	Well(Pump)
35	25 + 725	R	Well
36	25 + 870	L	Well(Pump)
37	26 + 690	L	Well
38	26 + 765	L	Well(Pump)
39	27 + 84	LR	Level crossing
40	28 + 411	LR	Level crossing
41	28 + 930	L	Well(Pump)
42	28 + 975	R	Well
43	29 + 130 ~ 29 + 230	L	Primary school, Hospital
44	29 + 790	R	Well
45	29 + 800	L	Well
46	30 + 120	L	Well
47	30 + 410	LR	Well
48	30 + 724	LR	Level crossing
49	32 + 205	R	Well(Pump)
50	33 + 930	R	Well(Pump)
51	35 + 725	L	Well(Pump)
52	36 + 695	R	Well(Pump)
53	36 + 865 ~ 36 + 880	R	Primary school
54	37 + 345	L	Well(Pump)
55	38 + 735	L	Well
56	40 + 145 ~ 40 + 215	L	Primary school
57	41 + 270	R	Pylon
58	43 + 400	R	Well(Pump)
59	46 + 530 ~ 46 + 600	R	Primary school
60	46 + 680	R	Well
61	48 + 90 ~ 48 + 135	L	Cemetery
62	51 + 355	L	Well(Pump)
63	51 + 570	R	Well(Pump)
64	52 + 960	R	Well
65	53 + 35 ~ 53 + 130	R	Primary school

Survey sheet for the consideration facilities Cuamba ~ Mandimba

No.	Existing road station	L/R	Facility
1	0 + 135	L	Well
2	1 + 335	R	Well
3	1 + 790 ~ 1 + 910	R	Primary school
4	2 + 960	R	Well(Pump)
5	4 + 110	R	Well(Pump)
6	4 + 940 ~ 5 + 100	R	Cemetery
7	4 + 920 ~ 5 + 270	L	Tobacco farm
8	5 + 605 ~ 6 + 60	L	Tobacco farm
9	7 + 15 ~ 7 + 50	R	Cemetery
10	10 + 150	R	Well
11	10 + 360	R	Well
12	10 + 730	R	Well
13	11 + 80	R	Well
14	11 + 110	L	Well
15	11 + 310	L	Well
16	12 + 925 ~ 13 + 5	R	Primary school
17	12 + 900	R	Well
18	12 + 900	R	Well(Pump)
19	12 + 950	L	Well(Pump)
20	12 + 950	L	Well(Pump)

JICA JAPAN INTERNATIONAL COOPERATION AGENCY

ANE NATIONAL ROAD ADMINISTRATION

REMARKS:

THE PREPARATORY SURVEY ON ROAD IMPROVEMENT PLAN IN NACALA DEVELOPMENT CORRIDOR (N13: CUAMBA-MANDIMBA-LICHINGA)

Eight-Japan Engineering Consultants Inc.
Oriental Consultants Co., Ltd

DRAWING TITLE: Location Map of the Consideration Facilities

NAME	PREPARED BY	CHECKED BY	APPROVED BY
SIGNATURE			
DATE			

SCALE	SHEET NO.	DRAWING NO.	REV. NO.
1/150,000		1	-

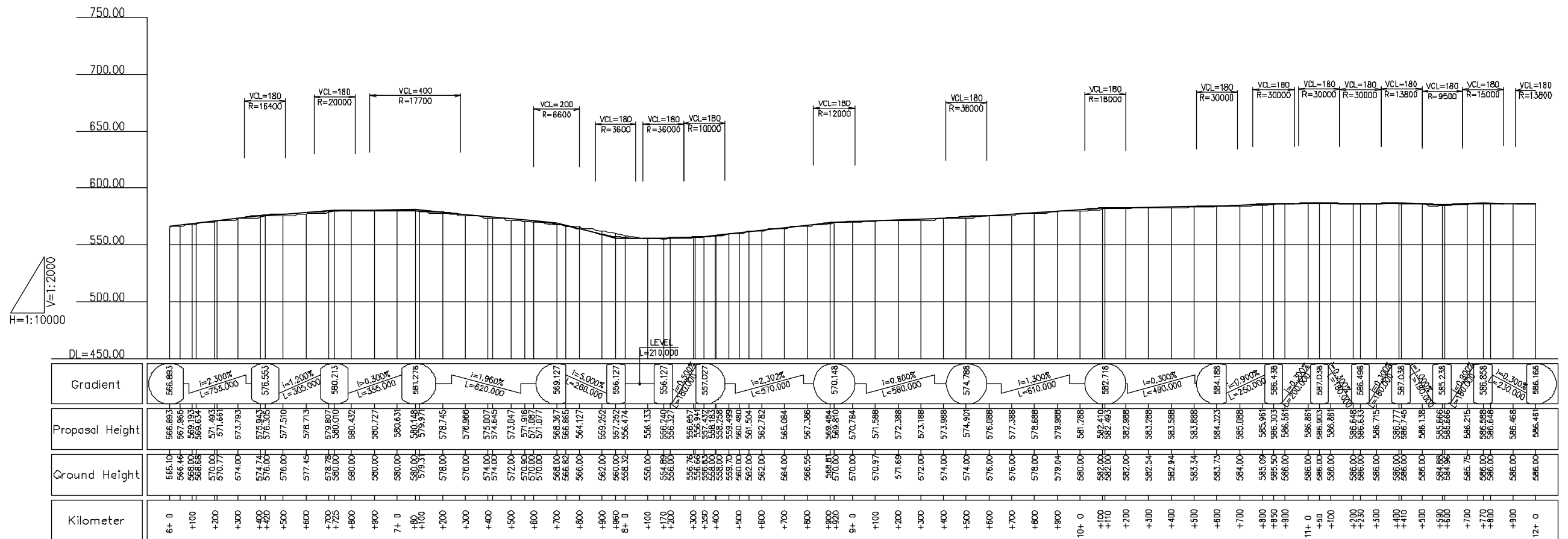
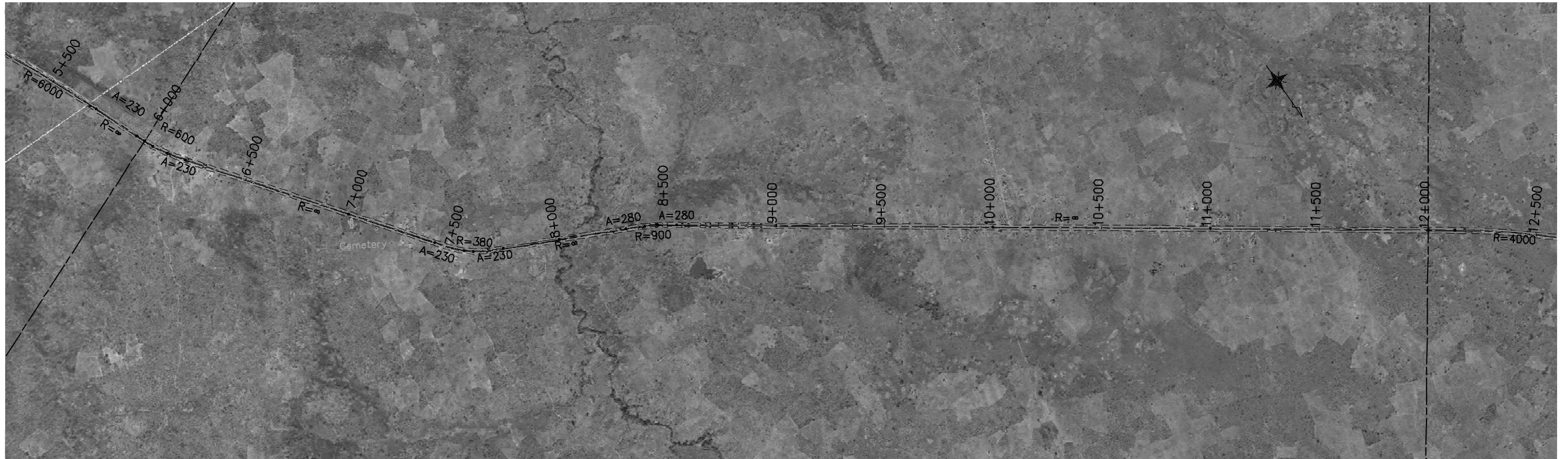

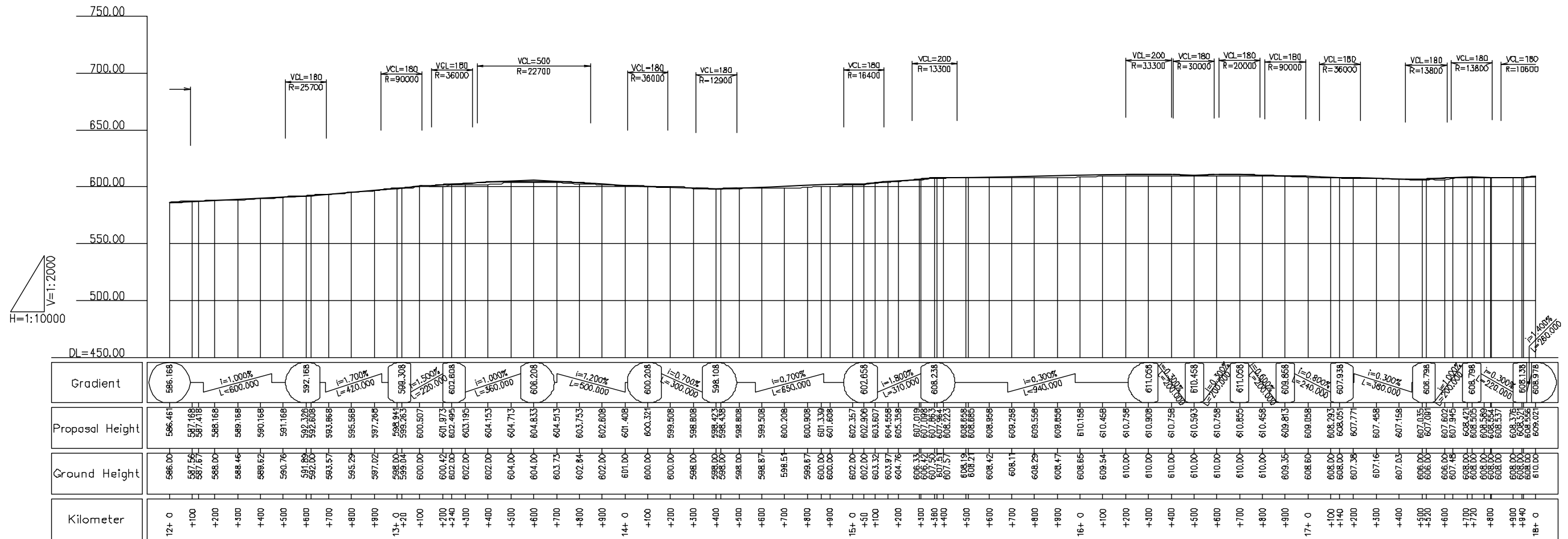

REMARKS:

THE PREPARATORY SURVEY ON ROAD IMPROVEMENT PLAN IN NACALA DEVELOPMENT CORRIDOR (N13: CUAMBA-MANDIMBA-LICHINGA)

Eight-Japan Engineering Consultants Inc.
 Oriental Consultants Co., Ltd

DRAWING TITLE
Plan and Profile (3)

	PREPARED BY	CHECKED BY	APPROVED BY
NAME			
SIGNATURE			
DATE			

SCALE	SHEET NO.	DRAWING NO.	REV. NO.
1/10,000		4	-