

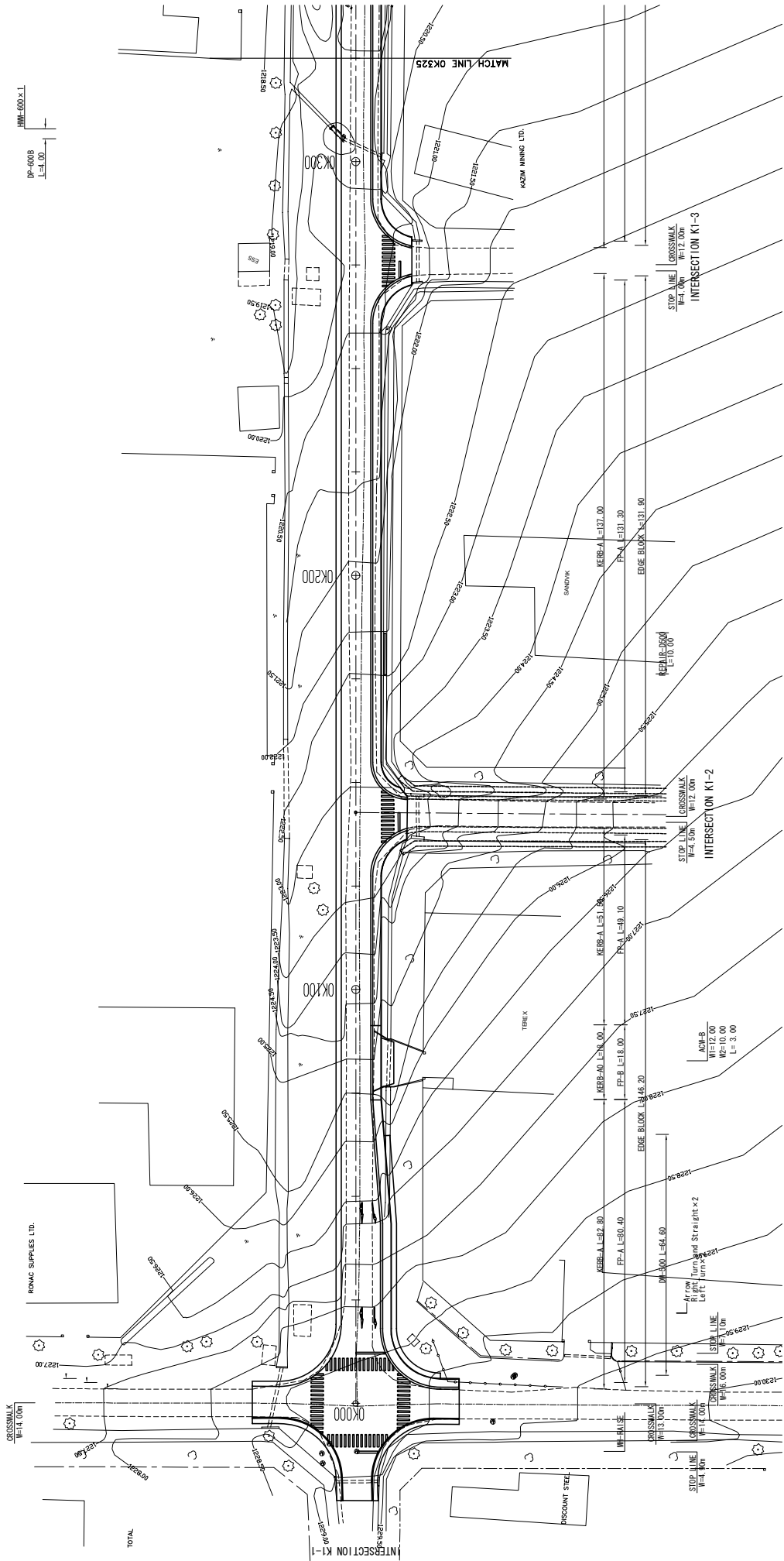



DP-600B  
L=1.00  
MM=600x1.1



MINISTRY OF LOCAL GOVERNMENT AND HOUSING THE REPUBLIC OF ZAMBIA	JAPAN INTERNATIONAL COOPERATION AGENCY (JICA)	PLAN	SCALE	APPROVED	KATAHIRA & ENGINEERS INTERNATIONAL	PREPARED CHECKED	DATE	SHEET NO
						SUBMITTED		
BASIC DESIGN FOR THE PROJECT FOR IMPROVEMENT AND MAINTENANCE OF NDDLA AND KITWE CITY ROADS THE REPUBLIC OF ZAMBIA		KI: DR. AGGREY AVENUE(1/3)		DATE	DATE			



INTERSECTION KI-4

ADP-A  
W=12.00  
W2=3.00  
L=7.00

ADP-A  
W=12.00  
W2=3.00  
L=7.00

STOP LINE  
W=4.70m

ADP-A  
W=12.00  
W2=3.00  
L=7.00

ADP-A  
W=12.00  
W2=3.00  
L=7.00

ADP-A  
W=12.00  
W2=3.00  
L=7.00

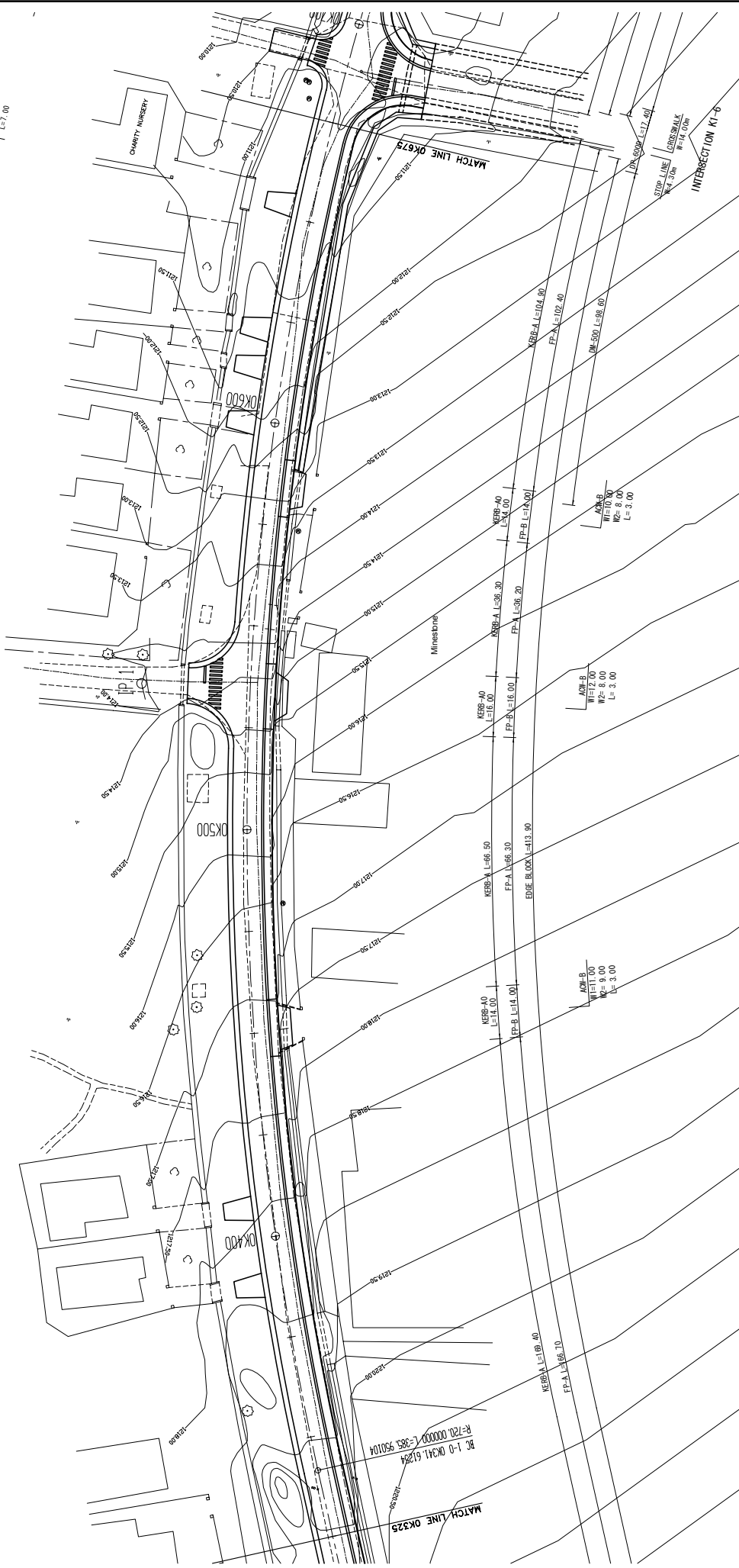

MINISTRY OF LOCAL GOVERNMENT AND HOUSING THE REPUBLIC OF ZAMBIA	BASIC DESIGN FOR THE PROJECT FOR IMPROVEMENT AND MAINTENANCE OF NDDLA AND KITWE CITY ROADS THE REPUBLIC OF ZAMBIA	JAPAN INTERNATIONAL COOPERATION AGENCY (JICA)	PLAN	SCALE S=1:500	APPROVED	KATAMBA & ENGINEERS INTERNATIONAL	PREPARED CHECKED	DATE	SHEET NO PL-39
					DATE		SUBMITTED		



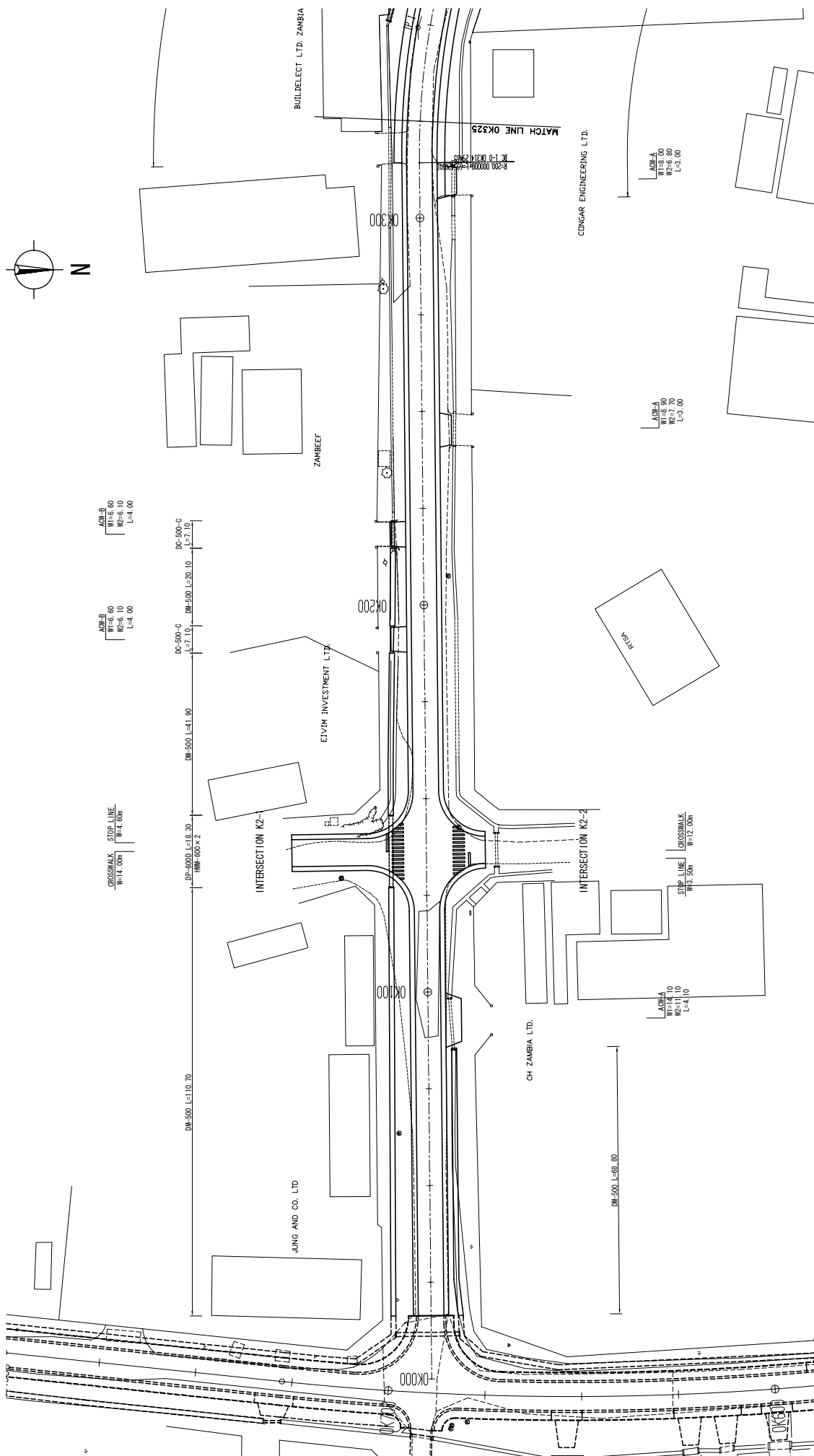

MINISTRY OF LOCAL GOVERNMENT AND HOUSING THE REPUBLIC OF ZAMBIA	JAPAN INTERNATIONAL COOPERATION AGENCY (JICA)	PLAN	SCALE	APPROVED	KATAHIRA & ENGINEERS INTERNATIONAL	PREPARED CHECKED	DATE	SHEET NO
						SUBMITTED		
K2: EUCLID ROAD (1/2)			S=1:500	DATE				

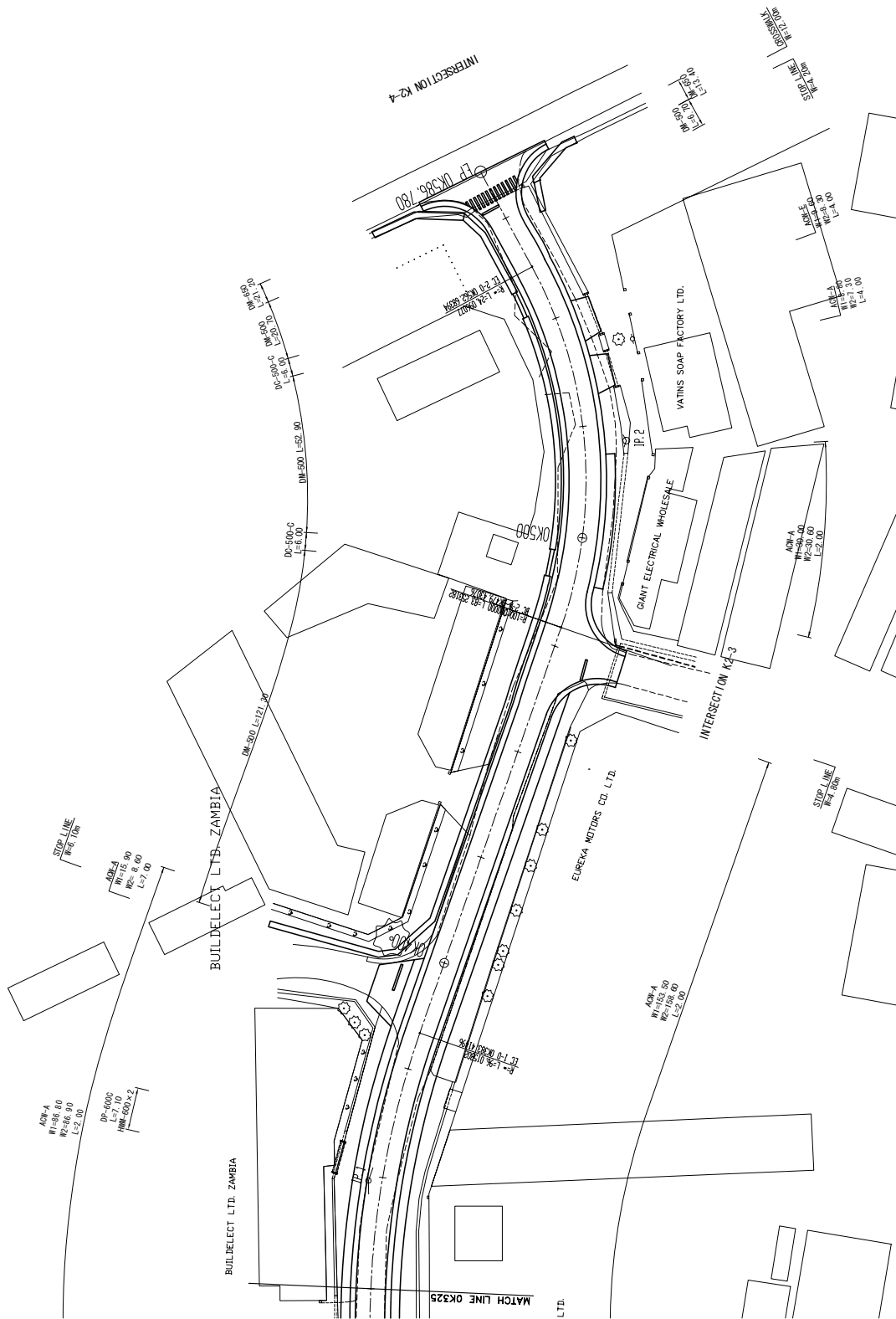
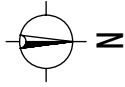

MINISTRY OF LOCAL GOVERNMENT AND HOUSING THE REPUBLIC OF ZAMBIA	JAPAN INTERNATIONAL COOPERATION AGENCY (JICA)	PLAN	SCALE	APPROVED	KATAHIRA & ENGINEERS INTERNATIONAL	PREPARED CHECKED	SHEET NO
						DATE	PL-42
BASIC DESIGN FOR THE PROJECT FOR IMPROVEMENT AND MAINTENANCE OF NDDLA AND KITWE CITY ROADS THE REPUBLIC OF ZAMBIA		K2: EUCLID ROAD (2/2)	S=1:500	DATE	DATE	SUBMITTED	

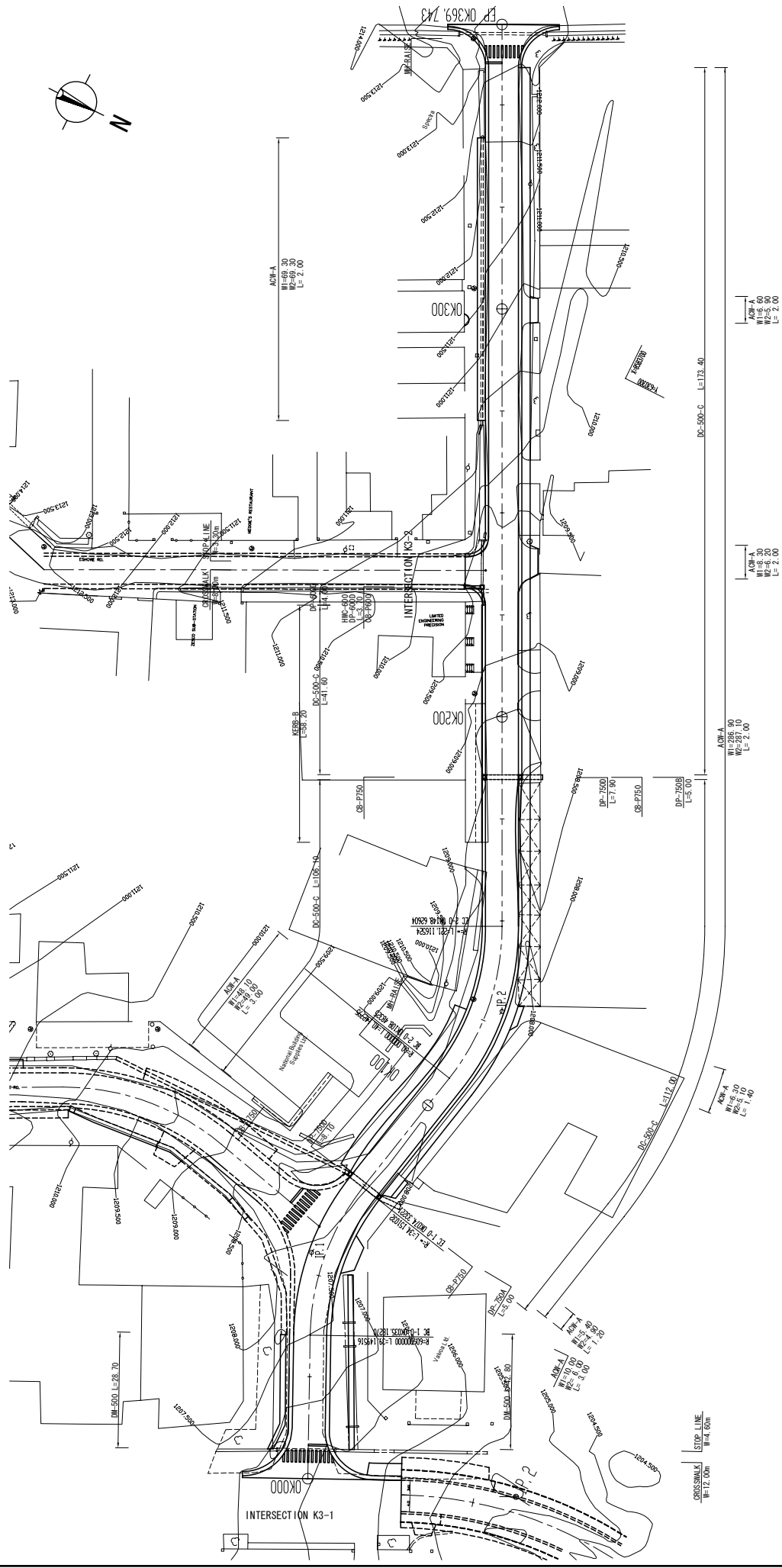
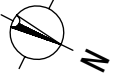

















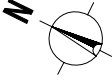

AS/LE  
W1=8.00  
W2=1.00  
L=4.00

AS/LE  
W1=7.00  
W2=5.00  
L=4.00

AS/LE  
W1=6.00  
W2=4.00  
L=4.00

HUMP  
H=6.40

AS/LE  
W1=7.00  
W2=5.00  
L=4.00

AS/LE  
W1=8.70  
W2=4.50  
L=3.00

AS/LE  
W1=8.70  
W2=4.50  
L=3.00

AS/LE  
W1=7.70  
W2=5.50  
L=3.00

AS/LE  
W1=7.70  
W2=5.50  
L=3.00

STOP LINE  
W=7.60m

CROSSWALK  
W=30.00m

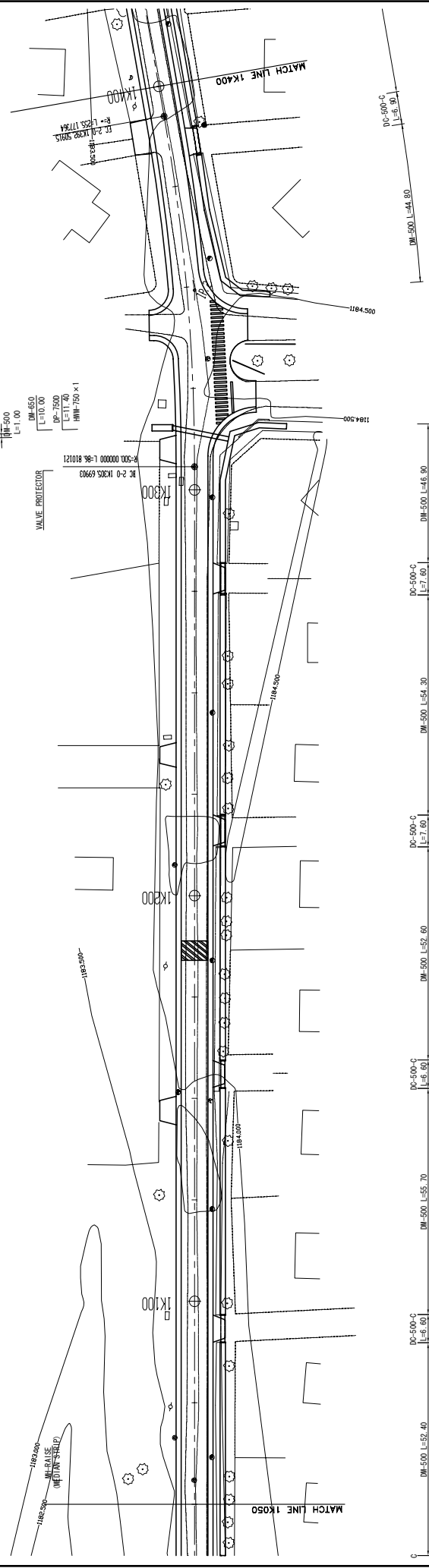

MINISTRY OF LOCAL GOVERNMENT AND HOUSING THE REPUBLIC OF ZAMBIA	BASIC DESIGN FOR THE PROJECT FOR IMPROVEMENT AND MAINTENANCE OF MDDLA AND KITWE CITY ROADS THE REPUBLIC OF ZAMBIA	JAPAN INTERNATIONAL COOPERATION AGENCY (JICA)	PLAN	SCALE S=1:500	APPROVED	PREPARED CHECKED	DATE	SHEET NO PL-51
					DATE	SUBMITTED		
K7: KANTANTA STREET(4/7)					KATAHRA & ENGINEERS INTERNATIONAL			





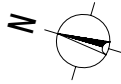

AW-E  
W1=5.00  
W2=4.00  
L=4.00

AW-E  
W1=6.00  
W2=6.00  
L=10.00

DM-650  
L=13.90  
DP=1500  
L=13.50  
HM=150 x 1

AW-E  
W1=8.10  
W2=6.30  
L=4.00

AW-E  
W1=5.40  
W2=3.30  
L=4.00

AW-E  
W1=5.70  
W2=3.90  
L=4.00

HUMP  
W=3.30

AW-E  
W1=5.80  
W2=4.80  
L=4.00

AW-E  
W1=6.80  
W2=4.80  
L=4.00

AW-E  
W1=5.00  
W2=4.00  
L=4.00

AW-E  
W1=5.80  
W2=4.00  
L=3.50

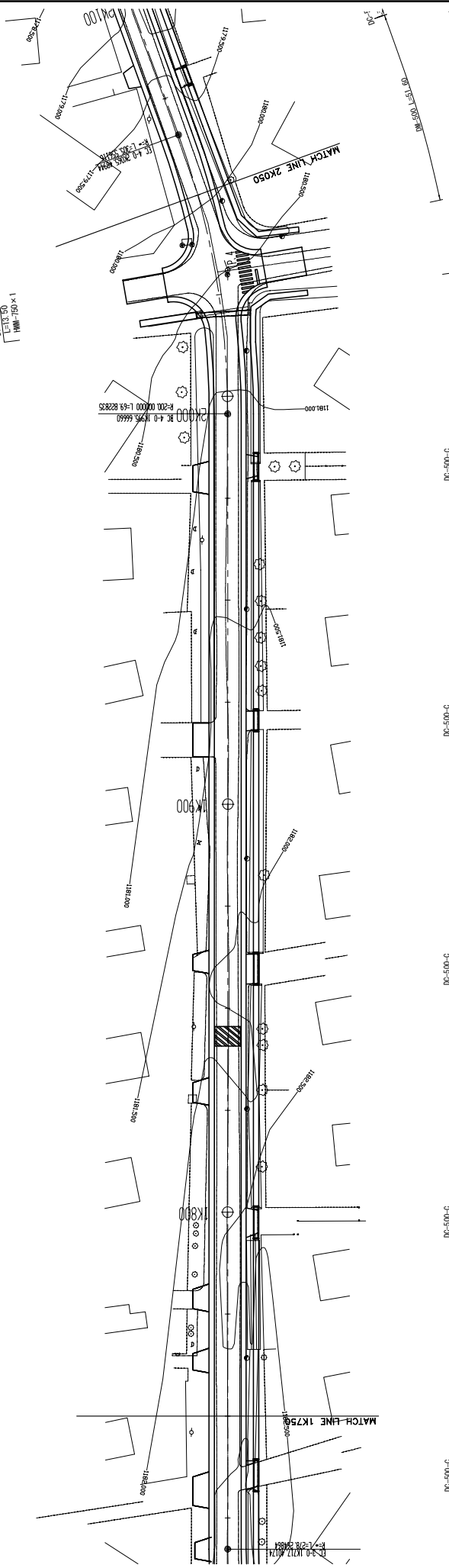

AW-E  
W1=7.30  
W2=5.40  
L=3.00

AW-E  
W1=7.30  
W2=5.40  
L=3.00

AW-E  
W1=4.80  
W2=4.70  
L=3.00

AW-E  
W1=5.90  
W2=4.70  
L=3.00

AW-E  
W1=4.00  
W2=1.00  
L=10.00

STOP LINE  
W=3.00  
CROSSWALKS  
W=10.00M

MINISTRY OF LOCAL GOVERNMENT AND HOUSING THE REPUBLIC OF ZAMBIA	BASIC DESIGN FOR THE PROJECT FOR IMPROVEMENT AND MAINTENANCE OF NDDLA AND KITWE CITY ROADS THE REPUBLIC OF ZAMBIA	JAPAN INTERNATIONAL COOPERATION AGENCY (JICA)	PLAN	SCALE S=1:500	APPROVED	PREPARED CHECKED	DATE	SHEET NO PL-53
					DATE	SUBMITTED		
		KATAHIRA & ENGINEERS INTERNATIONAL						

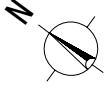

AOW-E  
 W1= 6.00  
 W2= 6.00  
 W3= 10.00  
 L= 3.00  
 DM-650  
 DP= 7500  
 L= 13.30  
 HW= 750 x 1

AOW-E  
 W1= 5.50  
 W2= 4.00  
 W3= 5.00  
 L= 3.00

AOW-E  
 W1= 5.50  
 W2= 4.00  
 W3= 5.00  
 L= 3.00

HUMP  
 HW= 6.30  
 AOW-E  
 W1= 5.50  
 W2= 4.00  
 W3= 5.00  
 L= 3.00

AOW-E  
 W1= 5.50  
 W2= 4.00  
 W3= 5.00  
 L= 3.00

AOW-E  
 W1= 5.50  
 W2= 4.00  
 W3= 5.00  
 L= 3.00

AOW-E  
 W1= 5.50  
 W2= 4.00  
 W3= 5.00  
 L= 3.00

DM-650  
 DP= 7500  
 L= 10.50  
 HW= 750 x 1

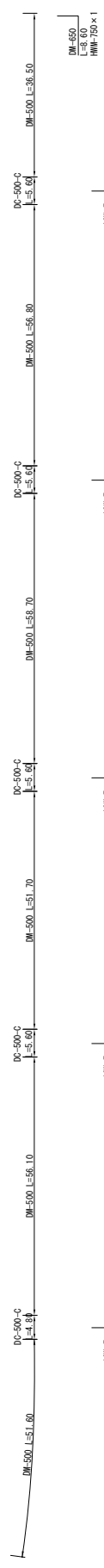
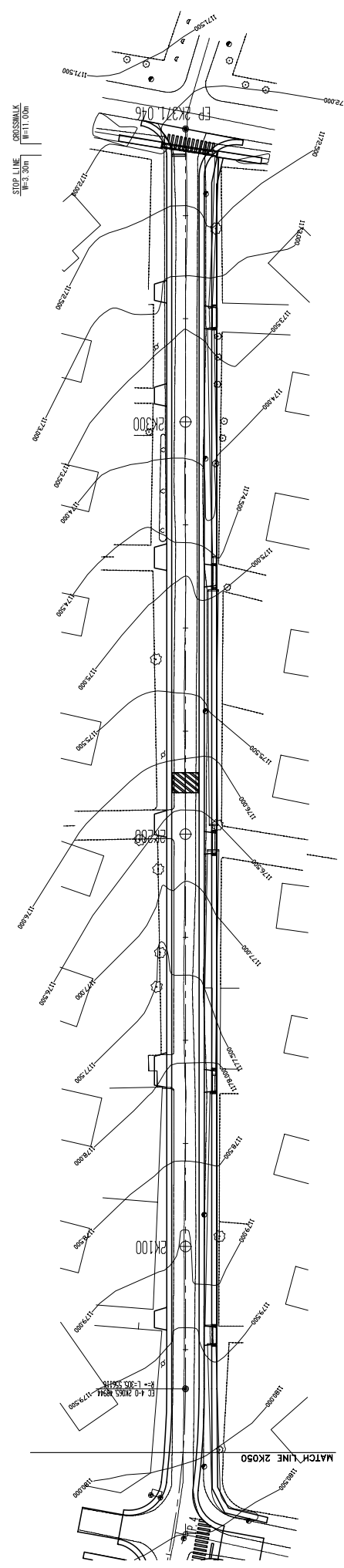

AOW-E  
 W1= 4.80  
 W2= 4.00  
 W3= 5.00  
 L= 3.00

AOW-E  
 W1= 5.60  
 W2= 4.80  
 W3= 5.00  
 L= 3.00

AOW-E  
 W1= 5.60  
 W2= 4.80  
 W3= 5.00  
 L= 3.00

AOW-E  
 W1= 5.60  
 W2= 4.80  
 W3= 5.00  
 L= 3.00

AOW-E  
 W1= 5.50  
 W2= 4.80  
 W3= 5.00  
 L= 3.00

DM-650  
 HW= 750 x 1

MINISTRY OF LOCAL GOVERNMENT AND HOUSING THE REPUBLIC OF ZAMBIA	BASIC DESIGN FOR THE PROJECT FOR IMPROVEMENT AND MAINTENANCE OF NDDLA AND KITWE CITY ROADS THE REPUBLIC OF ZAMBIA	JAPAN INTERNATIONAL COOPERATION AGENCY (JICA)	PLAN	SCALE	APPROVED	DATE	KATAHIRA & ENGINEERS INTERNATIONAL	PREPARED CHECKED	DATE	SHEET NO
				K7: KANTANTA STREET(7/7)				S=1500		

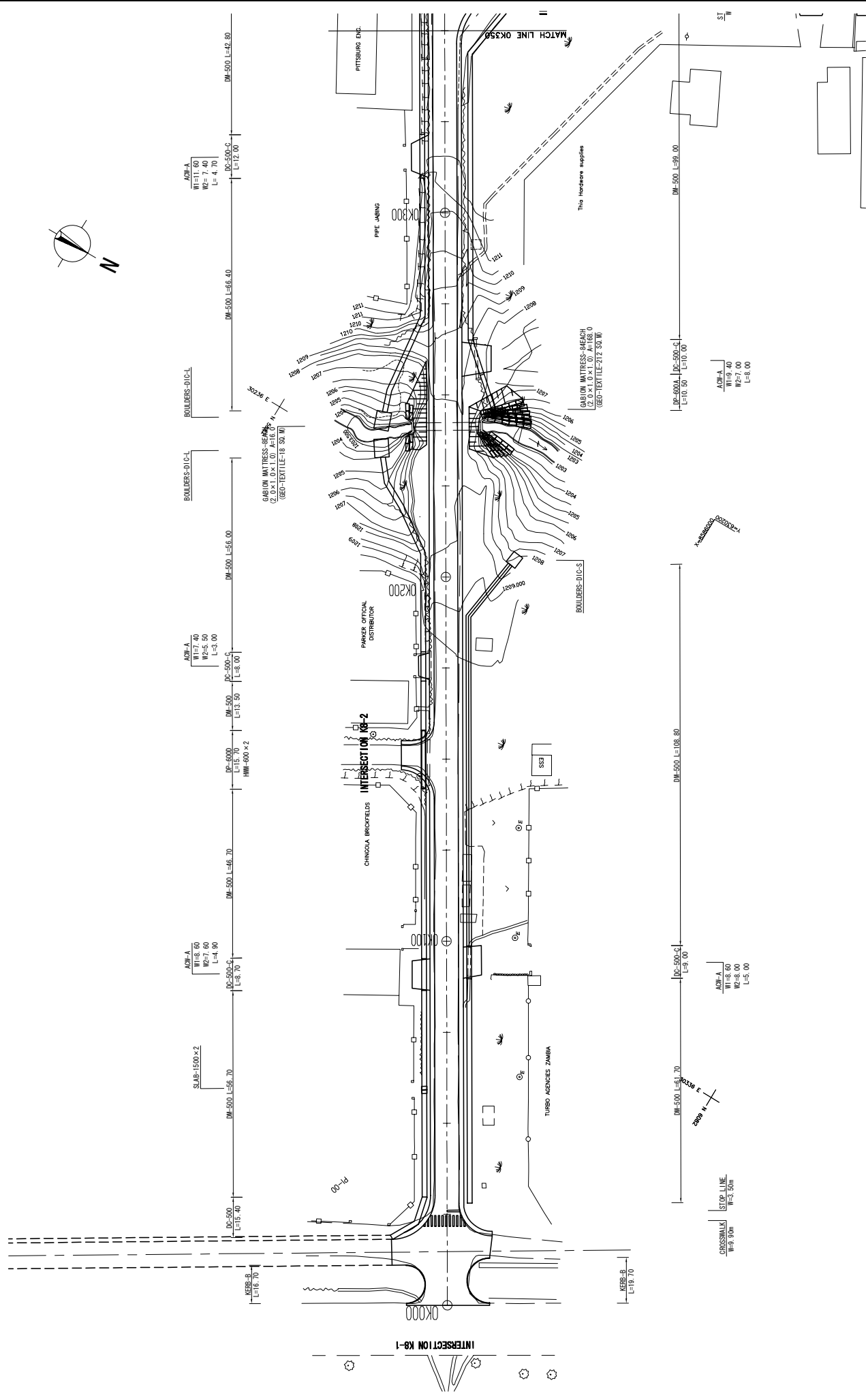

MINISTRY OF LOCAL GOVERNMENT AND HOUSING THE REPUBLIC OF ZAMBIA	BASIC DESIGN FOR THE PROJECT FOR IMPROVEMENT AND MAINTENANCE OF NODDA AND NATWANGE ROADS IN THE REPUBLIC OF ZAMBIA	JAPAN INTERNATIONAL COOPERATION AGENCY (JICA)	PLAN	SCALE S=1500	APPROVED DATE	KATAHIRA & ENGINEERS INTERNATIONAL	PREPARED CHECKED	DATE	SHEET NO
							SUBMITTED		



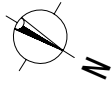

STOP LINE  
W=3.00m  
CROSSWALK  
W=3.00m

ALPH-E  
W=7.20  
W=7.20  
W=7.20  
L=3.00

ALPH-A  
W=8.80  
W=8.80  
W=8.80  
L=3.00

ALPH-E  
W=8.80  
W=8.80  
W=8.80  
L=3.00

SLAB-1500x2  
DM-500 L=63.80

STOP LINE  
W=3.40m  
CROSSWALK  
W=3.40m

ALPH-A  
W=7.20  
W=7.20  
W=7.20  
L=3.00

SLAB FOR RAILWAY CROSSING  
FOR CARRIAGEWAY W=3.60

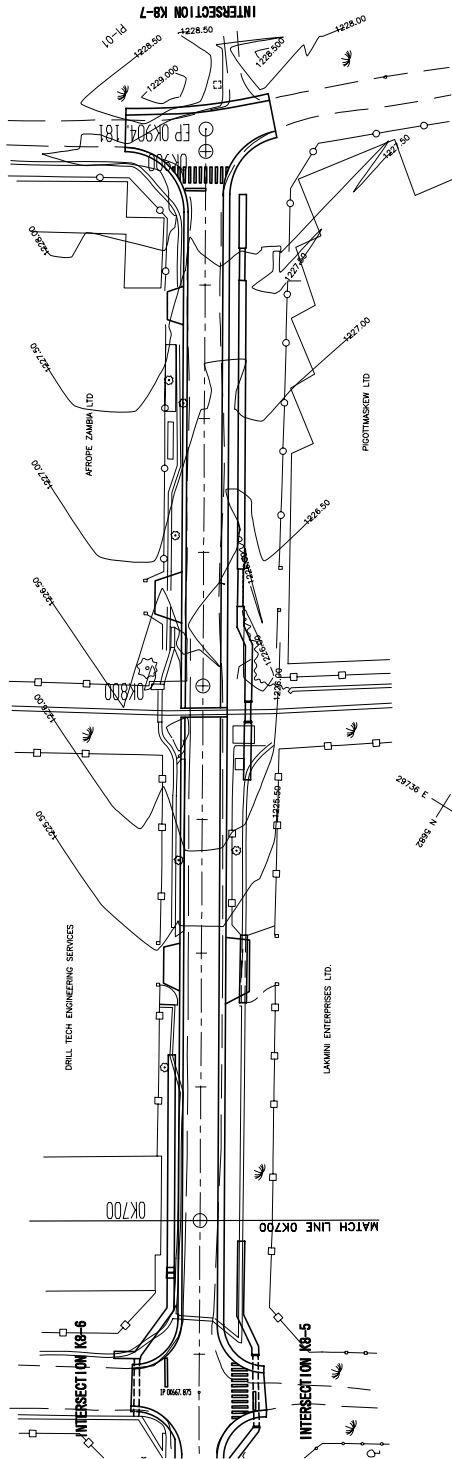

DM-500 L=51.00  
DM-500 L=22.60  
L=6.00

DM-500 L=18.10  
DM-500 L=7.00  
L=7.00

DM-500 L=72.00  
DM-500 L=21.80  
L=72.00

DM-500 L=21.80  
DM-500 L=21.80  
L=21.80

DM-500 L=21.80  
DM-500 L=21.80  
L=21.80

DM-500 L=21.80  
DM-500 L=21.80  
L=21.80

ALPH-A  
W=7.20  
W=7.20  
W=7.20  
L=3.00

ALPH-A  
W=7.20  
W=7.20  
W=7.20  
L=3.00

STOP LINE  
W=3.50m  
CROSSWALK  
W=3.40m

MINISTRY OF LOCAL GOVERNMENT AND HOUSING THE REPUBLIC OF ZAMBIA	BASIC DESIGN FOR THE PROJECT FOR IMPROVEMENT AND MAINTENANCE OF NODDA AND NATVANGE CITY ROADS IN THE REPUBLIC OF ZAMBIA	JAPAN INTERNATIONAL COOPERATION AGENCY (JICA)	PLAN	SCALE S=1500	APPROVED DATE	KATAHIRA & ENGINEERS INTERNATIONAL	PREPARED CHECKED	DATE	SHEET NO PL-57
							SUBMITTED		





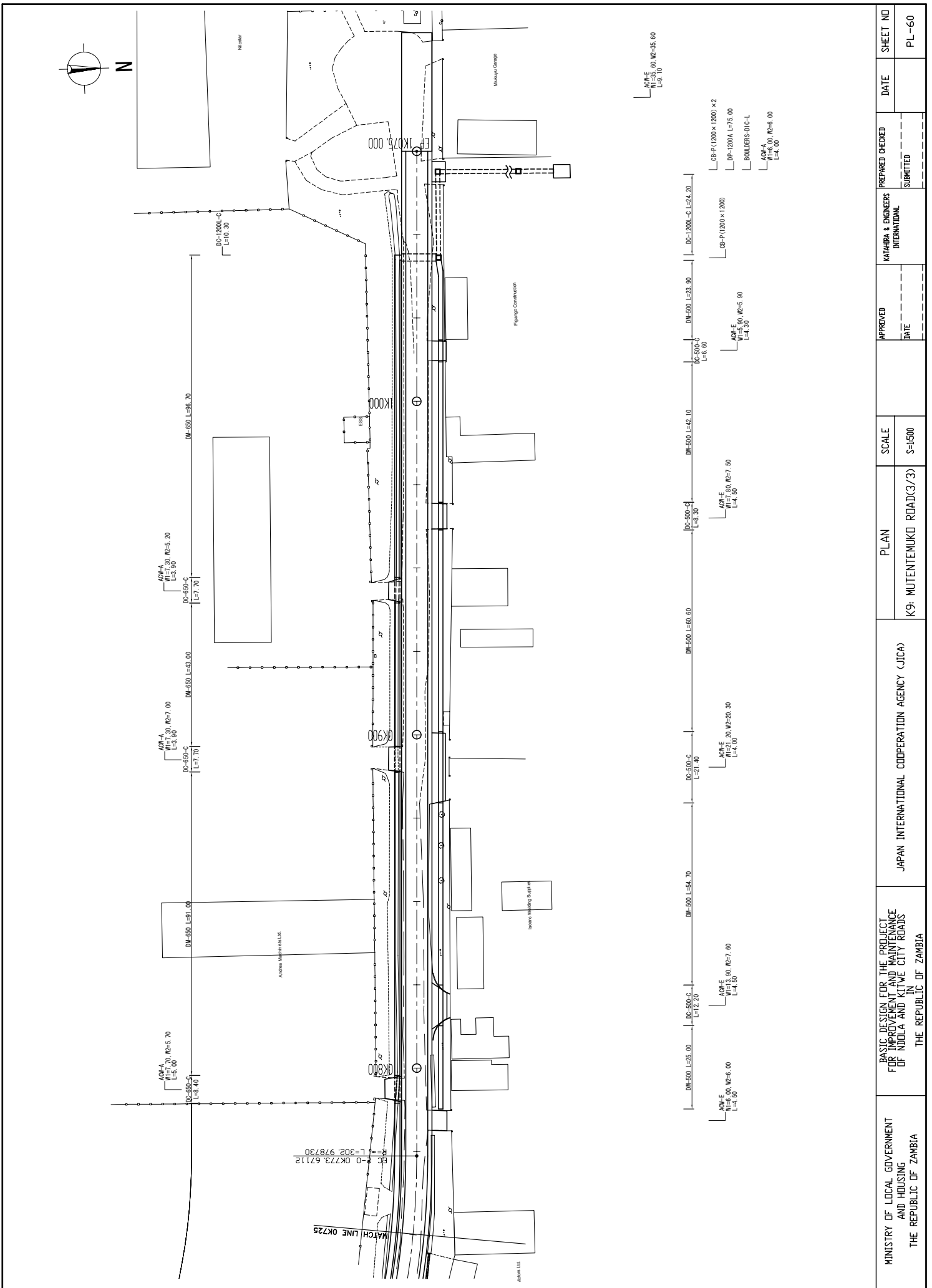

MINISTRY OF LOCAL GOVERNMENT AND HOUSING THE REPUBLIC OF ZAMBIA	JAPAN INTERNATIONAL COOPERATION AGENCY (JICA)	PLAN	SCALE	APPROVED	KATAHIRA & ENGINEERS INTERNATIONAL	PREPARED CHECKED	SHEET NO
						DATE	
BASIC DESIGN FOR THE PROJECT FOR IMPROVEMENT AND MAINTENANCE OF NDDLA AND KITWE CITY ROADS THE REPUBLIC OF ZAMBIA		K9: MUTENTEMUKO ROAD(3/3)	S=1:500			SUBMITTED	





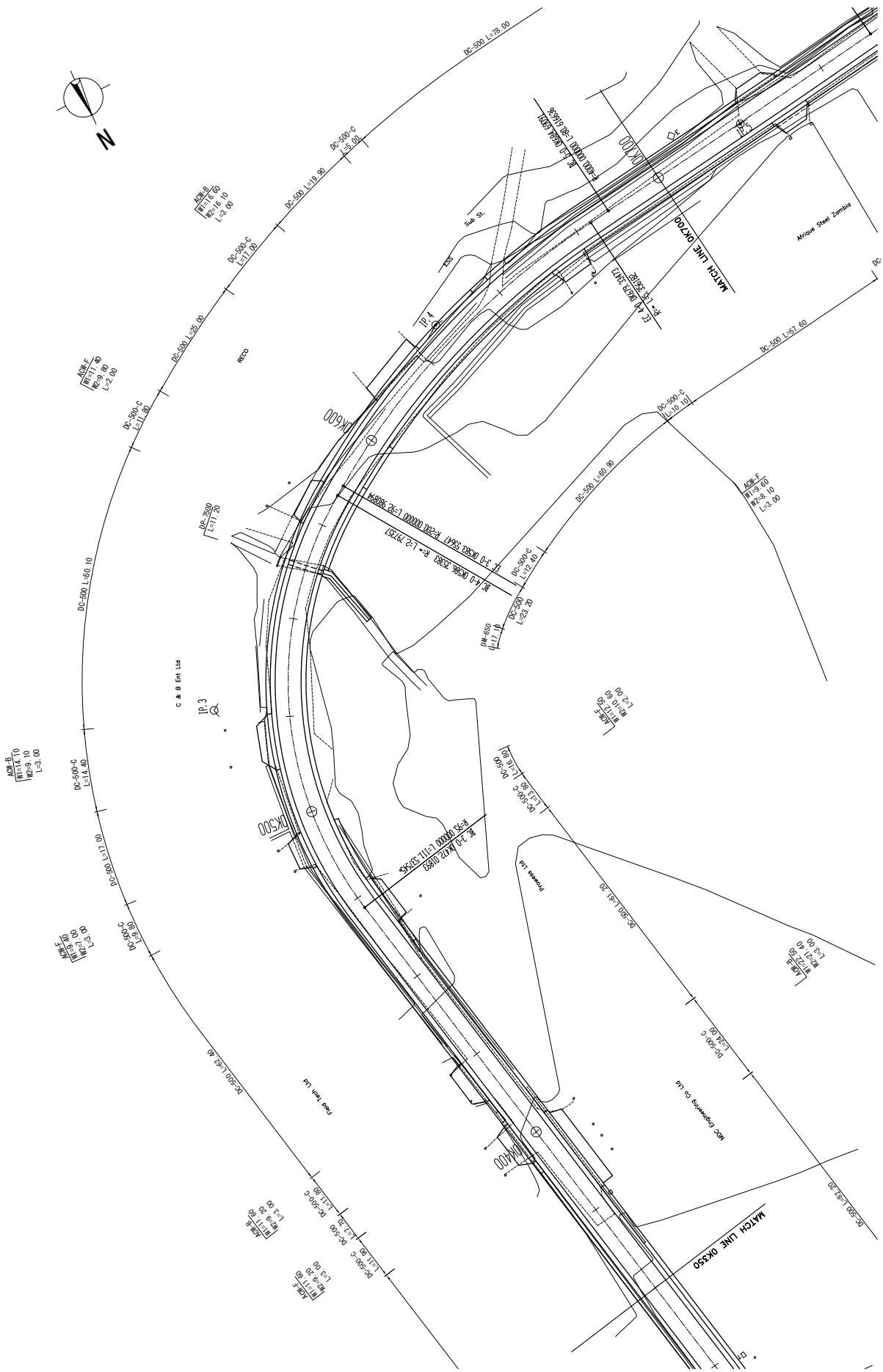

MINISTRY OF LOCAL GOVERNMENT AND HOUSING THE REPUBLIC OF ZAMBIA	BASIC DESIGN FOR THE PROJECT FOR IMPROVEMENT AND MAINTENANCE OF NDDLA AND KITWE CITY ROADS THE REPUBLIC OF ZAMBIA	JAPAN INTERNATIONAL COOPERATION AGENCY (JICA)	PLAN	SCALE S=1:500	APPROVED	PREPARED CHECKED	DATE	SHEET NO
					DATE	SUBMITTED		PL-62
			K10: MISESHI STREET (2/3)					



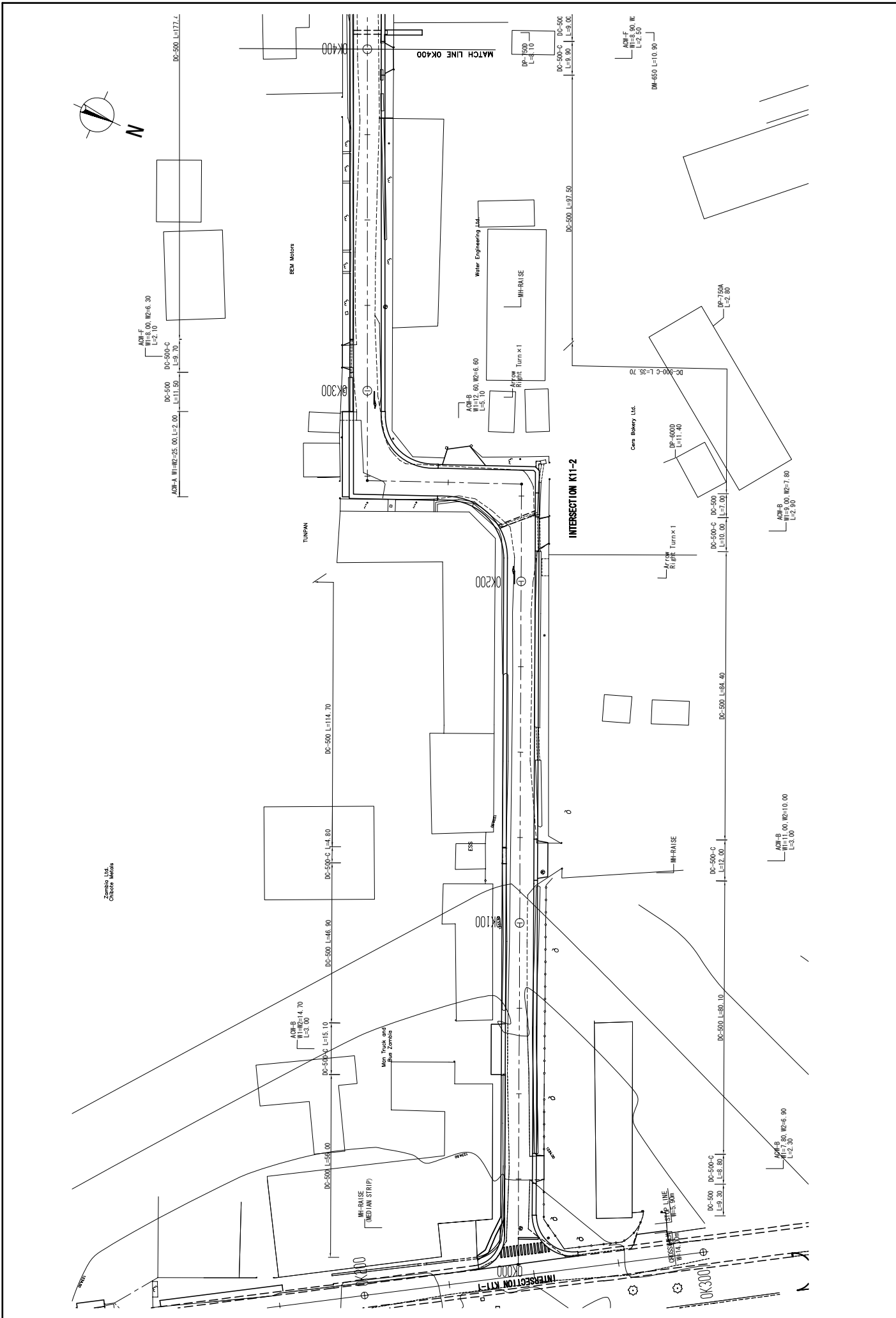

MINISTRY OF LOCAL GOVERNMENT AND HOUSING THE REPUBLIC OF ZAMBIA	JAPAN INTERNATIONAL COOPERATION AGENCY (JICA)		PLAN	SCALE S=1:500	APPROVED DATE	KATAHIRA & ENGINEERS INTERNATIONAL	PREPARED CHECKED SUBMITTED	DATE	SHEET NO PL-64
	K11: KANDGESHA ROAD (1/2)								



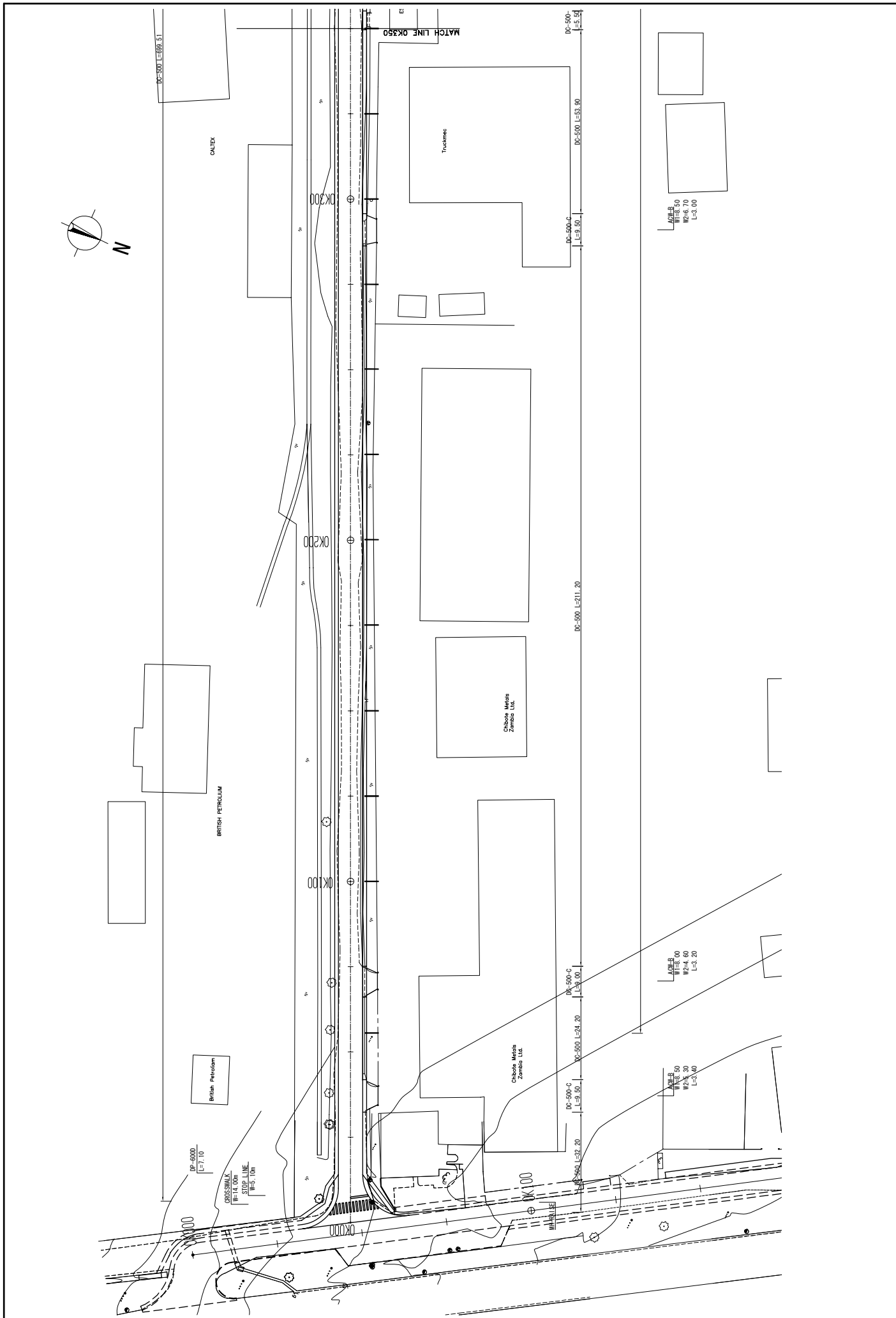

MINISTRY OF LOCAL GOVERNMENT AND HOUSING THE REPUBLIC OF ZAMBIA	BASIC DESIGN FOR THE PROJECT FOR IMPROVEMENT AND MAINTENANCE OF NDOLA AND KITWE CITY ROADS IN THE REPUBLIC OF ZAMBIA	JAPAN INTERNATIONAL COOPERATION AGENCY (JICA)	PLAN	SCALE	APPROVED DATE	KATAJIRA & ENGINEERS INTERNATIONAL	PREPARED CHECKED	DATE	SHEET NO
			K12: MULLAKWENDA ROAD (1/2)	S=1500			DATE	SUBMITTED	PL-66

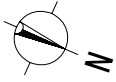

DC-650 DC-650 DC-650  
L=1.50 L=1.50 L=1.50  
DC-750 DC-750  
L=6.00 L=6.00  
HMC-750 x 2 HMC-750 x 2

STOP LINE  
W=3.80m  
H=10.00m

Total

OK500

OK500

OK400

MATCH LINE OK350

gmc LOGISTICS (Z) LTD.

INDUSTRIAL EQUIPMENT

KITWE REPAIRS

SCAW LTD.

DC-500-C  
L=20.00

DC-500-C  
L=81.50

DC-500-C  
L=14.40

DC-500-C  
L=51.20

DC-500-C  
L=11.90

DC-500-C  
L=59.50

DC-500-C  
L=10.00

DC-7500  
L=7.10

PVC-150 L=4.00 x 23=92.0m  
TINLET-10EL x 23

AGILE  
W=10.00  
H=2.80  
L=3.80

AGILE  
W=13.40  
H=2.80  
L=3.80

AGILE  
W=10.90  
H=2.80  
L=3.40

AGILE  
W=8.00  
H=2.80  
L=3.80

Copperbelt Steel

MINISTRY OF LOCAL GOVERNMENT AND HOUSING THE REPUBLIC OF ZAMBIA	BASIC DESIGN FOR THE PROJECT FOR IMPROVEMENT AND MAINTENANCE OF NDOLA AND KITWE CITY ROADS IN THE REPUBLIC OF ZAMBIA	JAPAN INTERNATIONAL COOPERATION AGENCY (JICA)	PLAN	SCALE S=1500	APPROVED DATE	KATAHIRA & ENGINEERS INTERNATIONAL	PREPARED CHECKED	DATE	SHEET NO PL-67
							SUBMITTED		

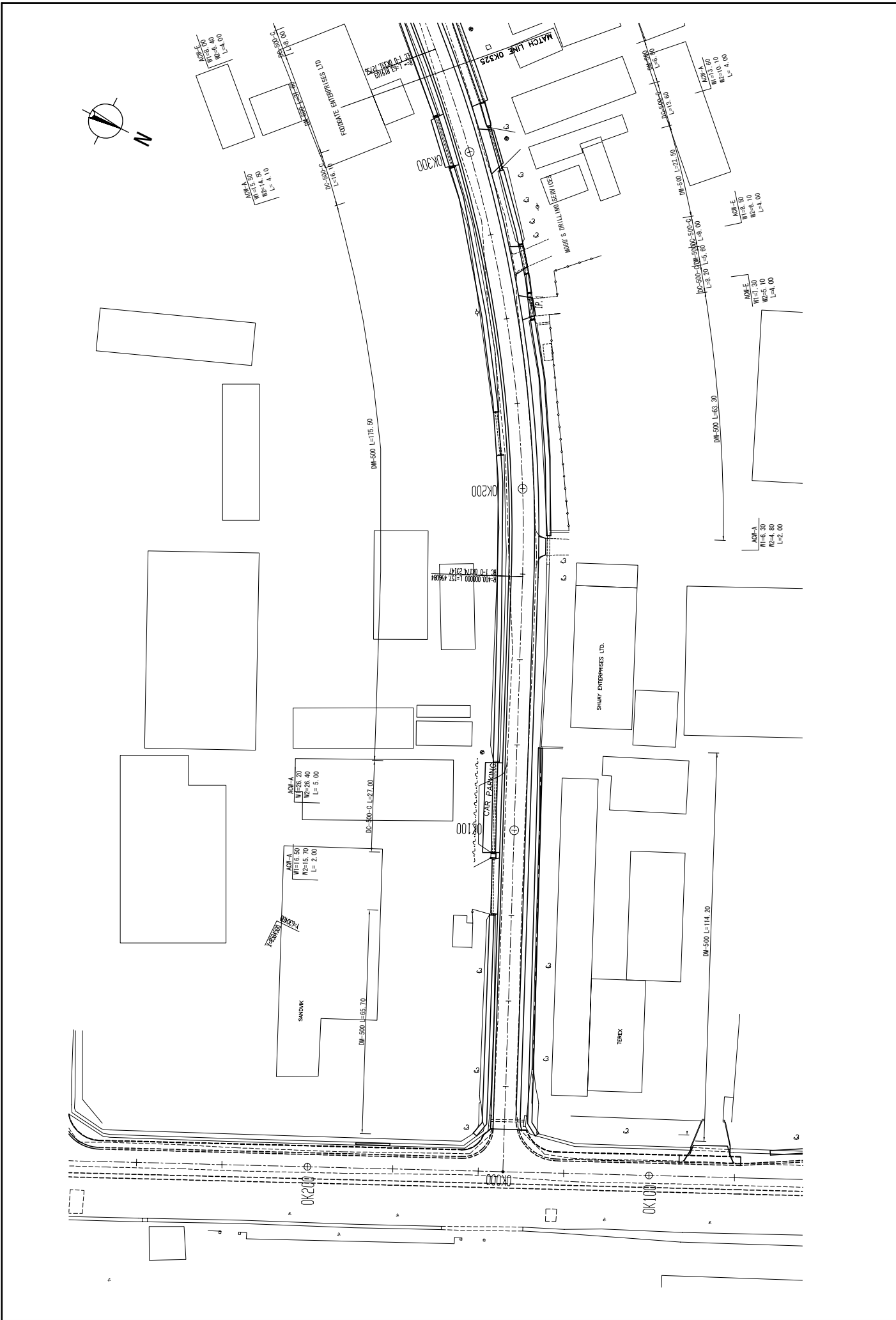

MINISTRY OF LOCAL GOVERNMENT AND HOUSING THE REPUBLIC OF ZAMBIA	BASIC DESIGN FOR THE PROJECT FOR IMPROVEMENT AND MAINTENANCE OF NDDLA AND KITWE CITY ROADS THE REPUBLIC OF ZAMBIA	JAPAN INTERNATIONAL COOPERATION AGENCY (JICA)	PLAN	SCALE	S=1:500	APPROVED	KATAHIRA & ENGINEERS INTERNATIONAL	PREPARED CHECKED	DATE	SHEET NO
						DATE		SUBMITTED		
			K13: LILLOGWE ROAD (1/2)							PL-68







