

資料 7-6 基本設計図

図面目録

図面番号	図面名称	枚数
ZL BD A-1	図面目録	1
ZL BD B-1	位置図	1
ZL BD B-2	配置図	1
ZL BD C-1	標準断面 2車線	1
ZL BD C-2	標準断面 4車線	1
ZL BD D-1~20	平面・縦断図 (1/20-20/20)	20
ZL BD E-1	排水工 1 U型側溝	1
ZL BD E-2	排水工 2 コンクリート管	1
ZL BD E-3	排水工 3 柵	1
ZL BD F-1	付帯工 1 歩道取付部	1
ZL BD F-2	付帯工 2 縁石	1
ZL BD F-3	付帯工 3 小構造物	1
ZL BD F-4	付帯工 4 路面表示	1
ZL BD F-5	付帯工 5 交差点及び路面表示	1
ZL BD F-6	付帯工 6 ハンプ	1
ZL BD F-7	付帯工 7 街路灯	1
ZL BD G-1	交差点設計(M10)	1
合 計		36

BASIC DESIGN STUDY
ON
THE PROJECT FOR IMPROVEMENT OF LIVINGSTONE CITY ROADS
IN
THE REPUBLIC OF ZAMBIA

DRAWINGS

May, 2008

JAPAN INTERNATIONAL COOPERATION AGENCY
CONSTRUCTION PROJECT CONSULTANTS, INC

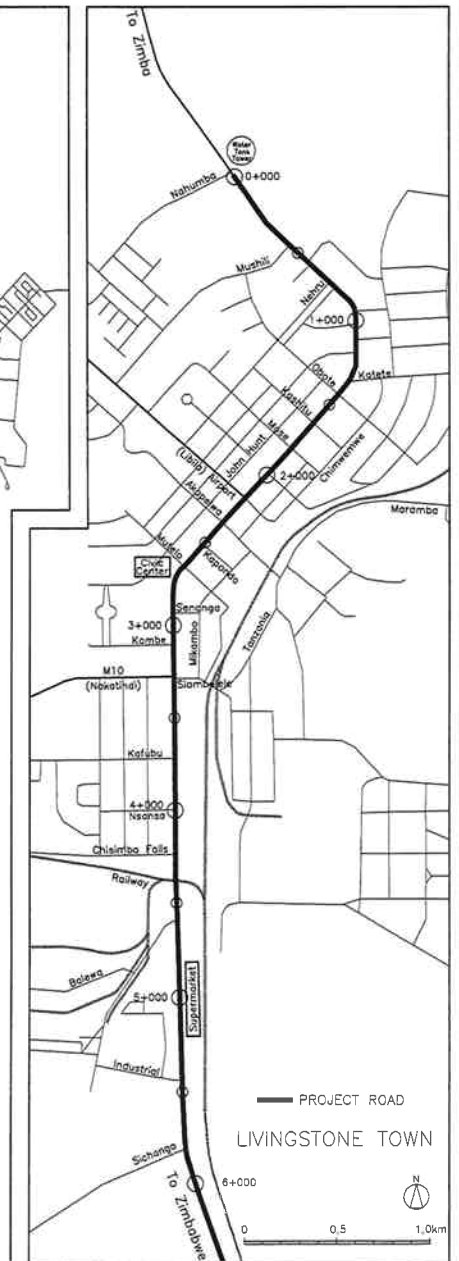
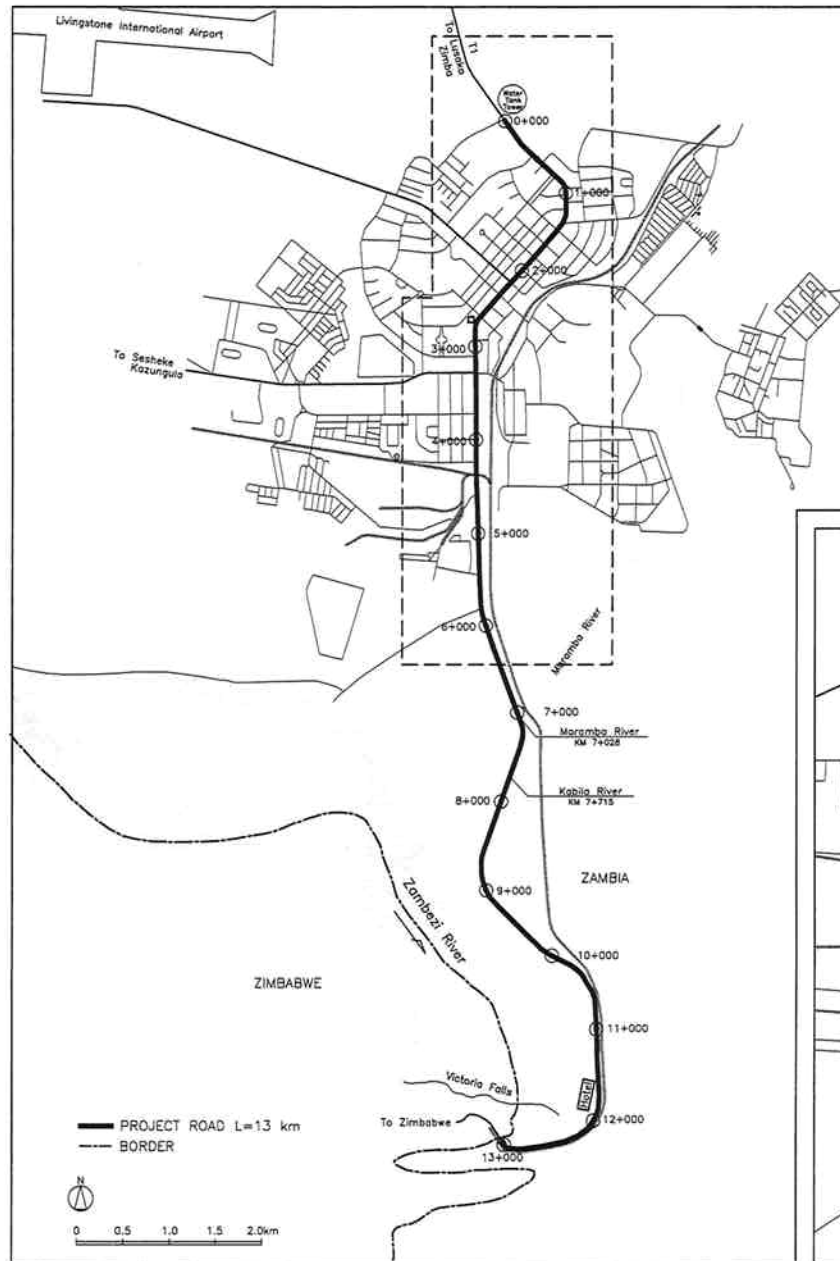
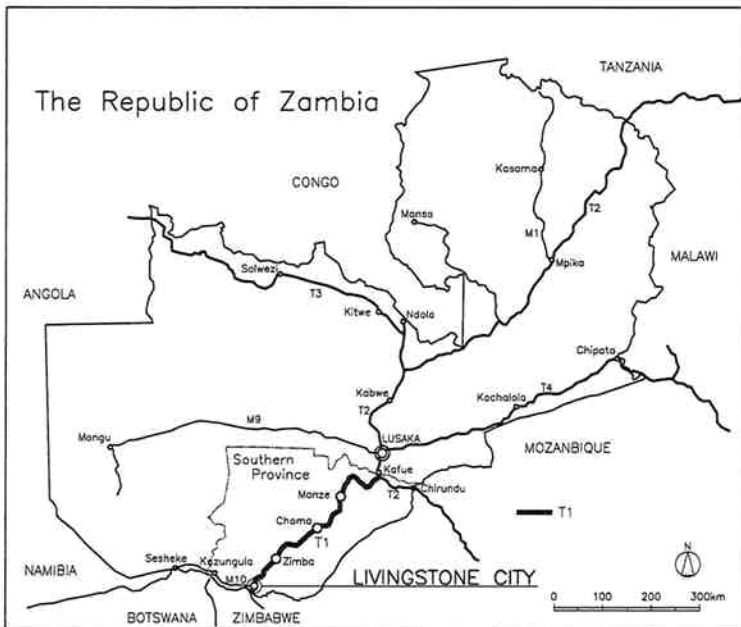
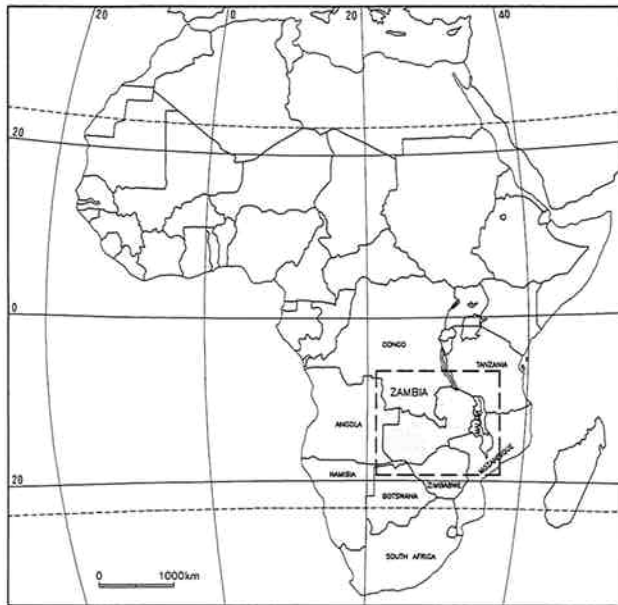

<ul style="list-style-type: none"> • The Ministry of Local Government and Housing of The Republic of Zambia • Japan International Cooperation Agency 	CONSULTANTS:	PROJECT NAME:	DRAWING TITLE:	Date: March 2008	DRAWING No.:
	Construction Project Consultants, INC. (CPC)	THE PROJECT FOR IMPROVEMENT OF LIVINGSTONE CITY ROADS	PROJECT LOCATION MAP	Prepared by:	ZL BD B-1
				Checked by:	

TYPICAL CROSS SECTION FOR 2-LANE SECTION

2-A

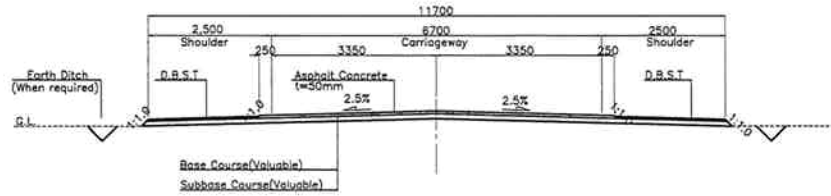

2-B

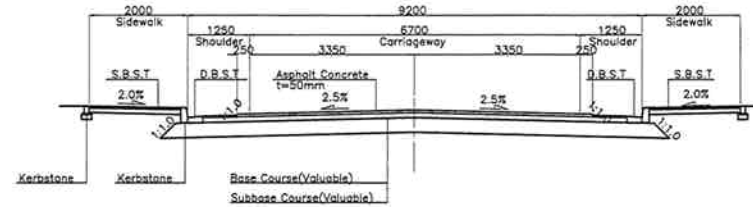

2-C

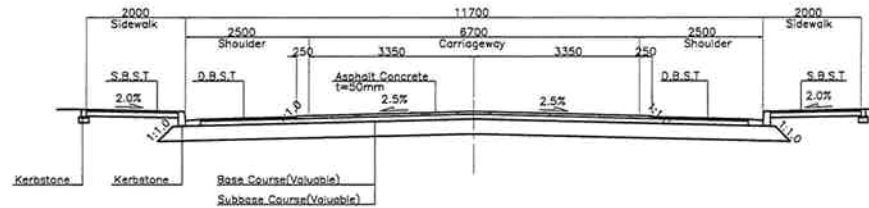

2-D

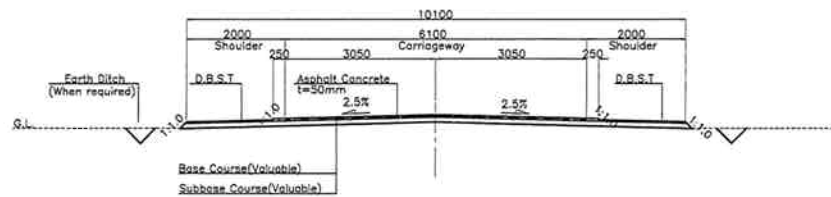

<ul style="list-style-type: none"> The Ministry of Local Government and Housing of The Republic of Zambia Japan International Cooperation Agency 	CONSULTANTS:	PROJECT NAME:	DRAWING TITLE:	Date: March 2008	DRAWING No.:
	Construction Project Consultants, INC. (CPC)	THE PROJECT FOR IMPROVEMENT OF LIVINGSTONE CITY ROADS	TYPICAL CROSS SECTION FOR 2-LANE SECTION	Prepared by:	ZL BD C-1
				Checked by:	

TYPICAL CROSS SECTION FOR 4-LANE SECTION

4-A

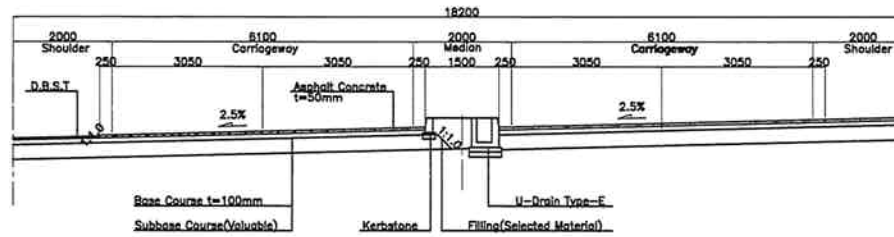

4-B

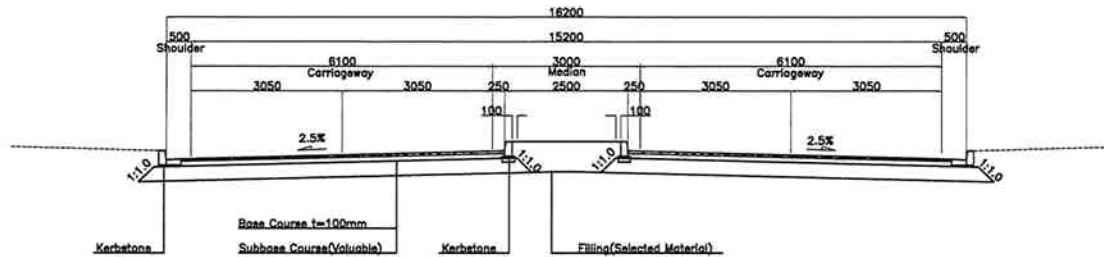

4-C

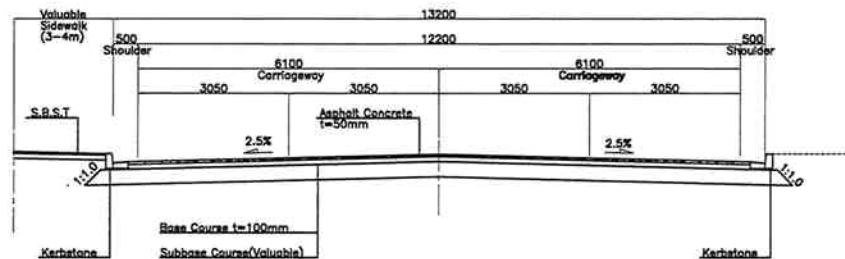

- The Ministry of Local Government and Housing of The Republic of Zambia
- Japan International Cooperation Agency

CONSULTANTS:
Construction Project Consultants, INC. (CPC)

PROJECT NAME:
THE PROJECT FOR IMPROVEMENT OF LIVINGSTONE CITY ROADS

DRAWING TITLE:
TYPICAL CROSS SECTION FOR 4-LANE SECTION

Date: March 2008
Prepared by:
Checked by:

DRAWING No.:
ZL BD C-2

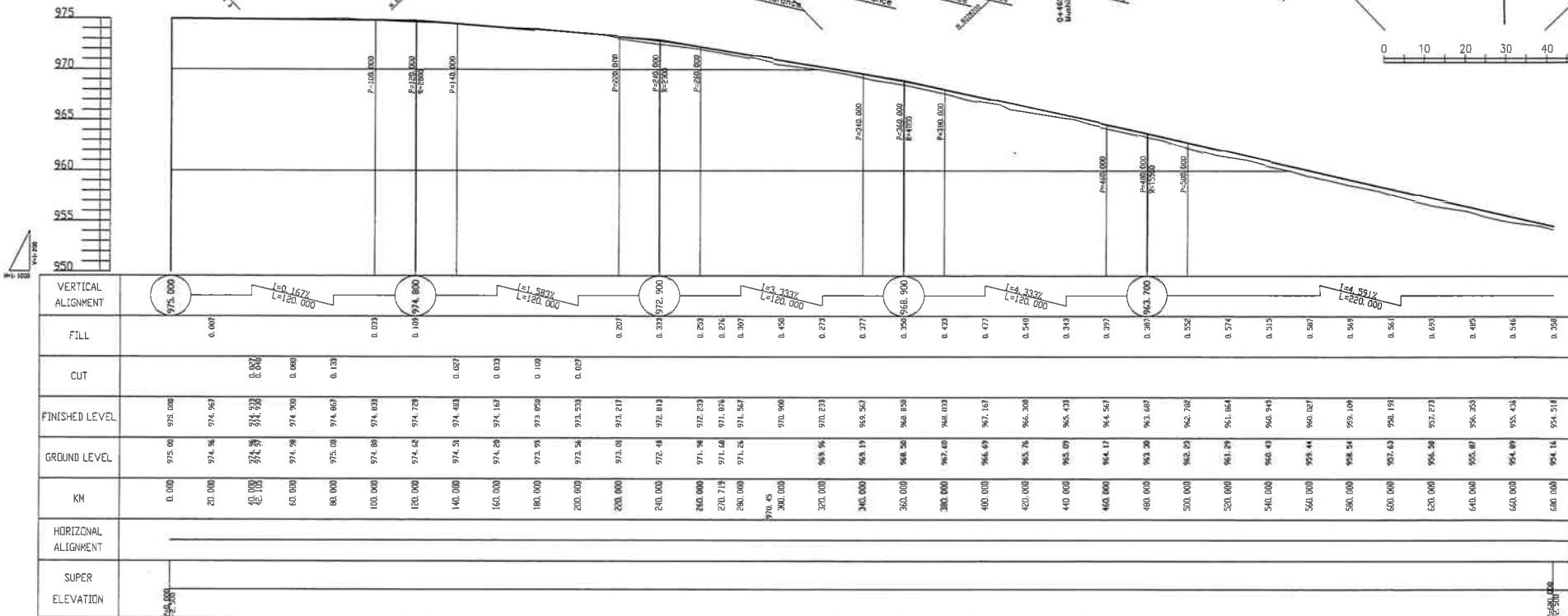
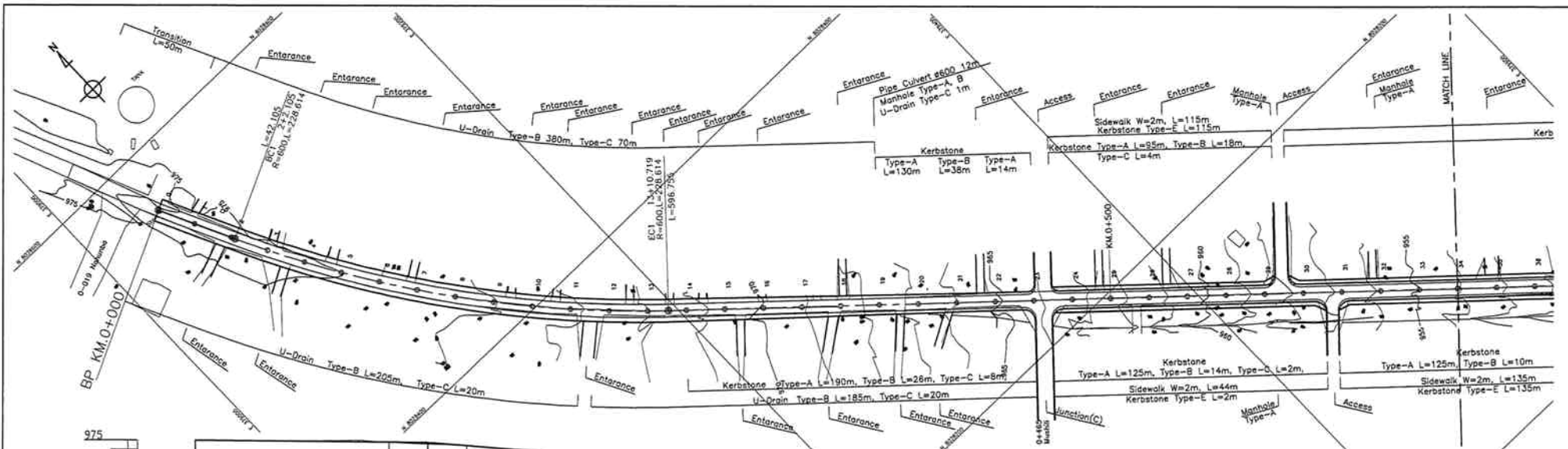

<ul style="list-style-type: none"> The Ministry of Local Government and Housing of The Republic of Zambia Japan International Cooperation Agency 	CONSULTANTS:	PROJECT NAME:	DRAWING TITLE:	Date: March 2008	DRAWING No.:
	Construction Project Consultants, Inc. (CPC)	THE PROJECT FOR IMPROVEMENT OF LIVINGSTONE CITY ROADS	PLAN AND PROFILE (1/20)	Prepared by:	ZL BD D-1
			KM 0+000 - KM 0+680	Checked by:	

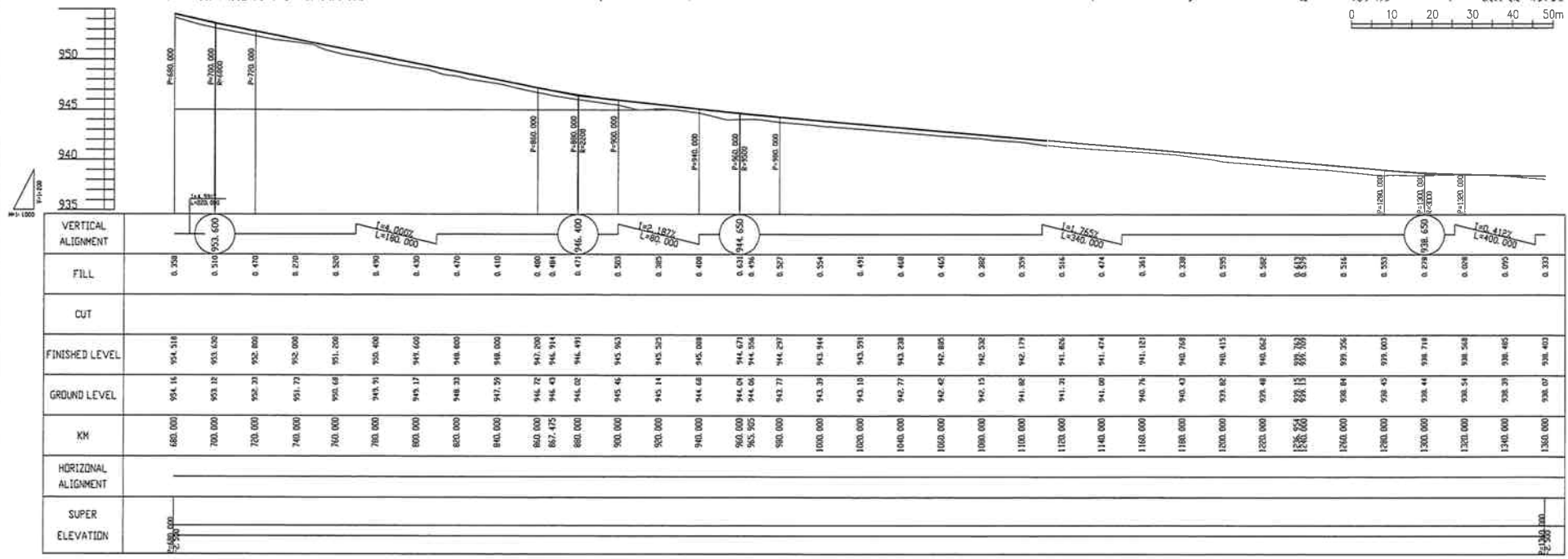
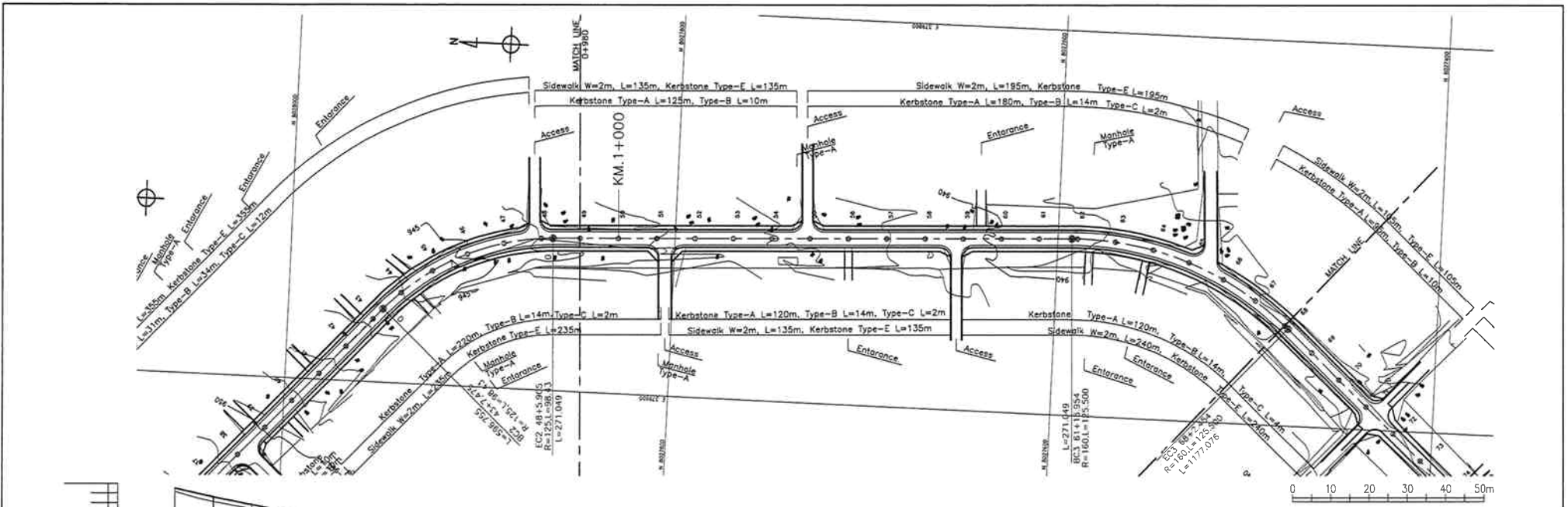

<ul style="list-style-type: none"> The Ministry of Local Government and Housing of The Republic of Zambia Japan International Cooperation Agency 	CONSULTANTS:	PROJECT NAME:	DRAWING TITLE:	Date: March 2008	DRAWING No.:
	Construction Project Consultants, Inc. (CPC)	THE PROJECT FOR IMPROVEMENT OF LIVINGSTONE CITY ROADS	PLAN AND PROFILE (3/20)	Prepared by:	ZL BD D-3
			KM 0+980 - KM 1+360	Checked by:	

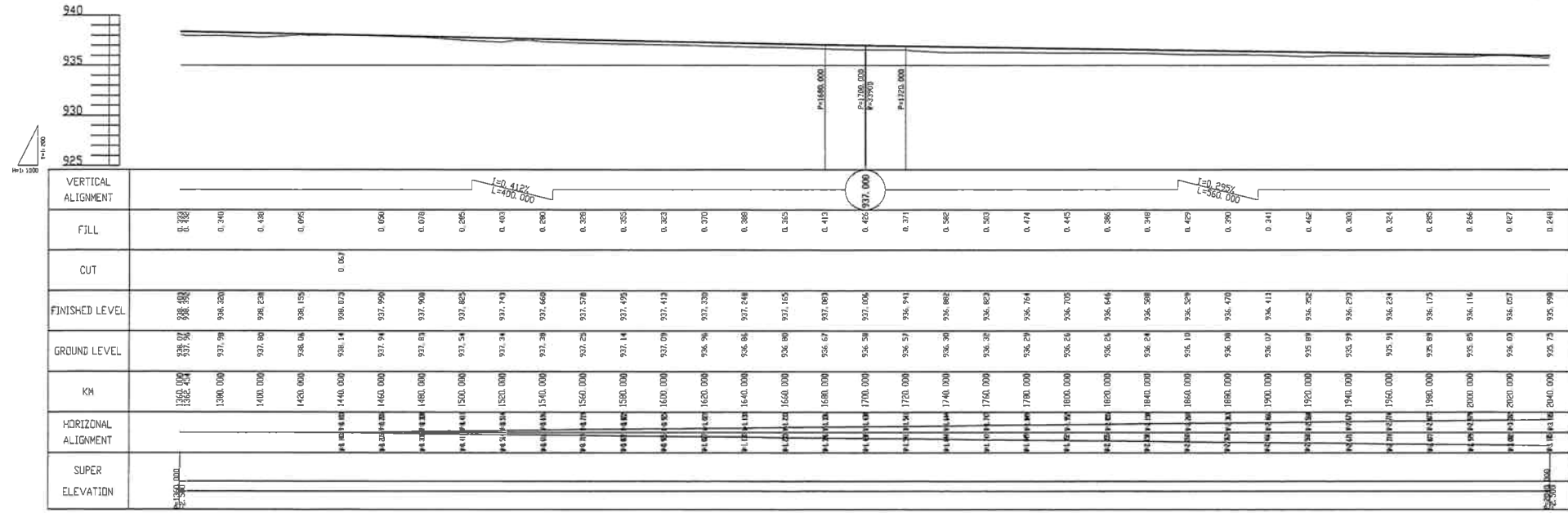
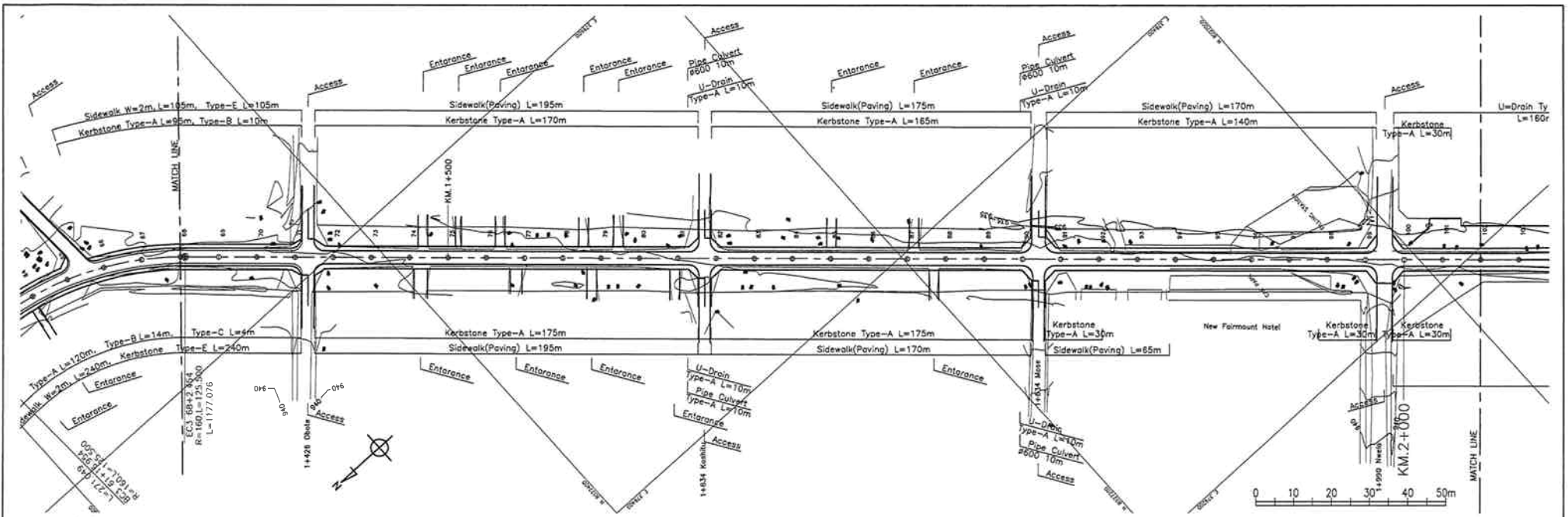

<ul style="list-style-type: none"> The Ministry of Local Government and Housing of The Republic of Zambia Japan International Cooperation Agency 	CONSULTANTS:	PROJECT NAME:	DRAWING TITLE:	Date: March 2008	DRAWING No.:
	Construction Project Consultants, INC. (CPC)	THE PROJECT FOR IMPROVEMENT OF LIVINGSTONE CITY ROADS	PLAN AND PROFILE (4/20)	Prepared by:	ZL BD D-4
			KM 1+360 - KM 2+040	Checked by:	

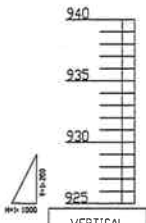
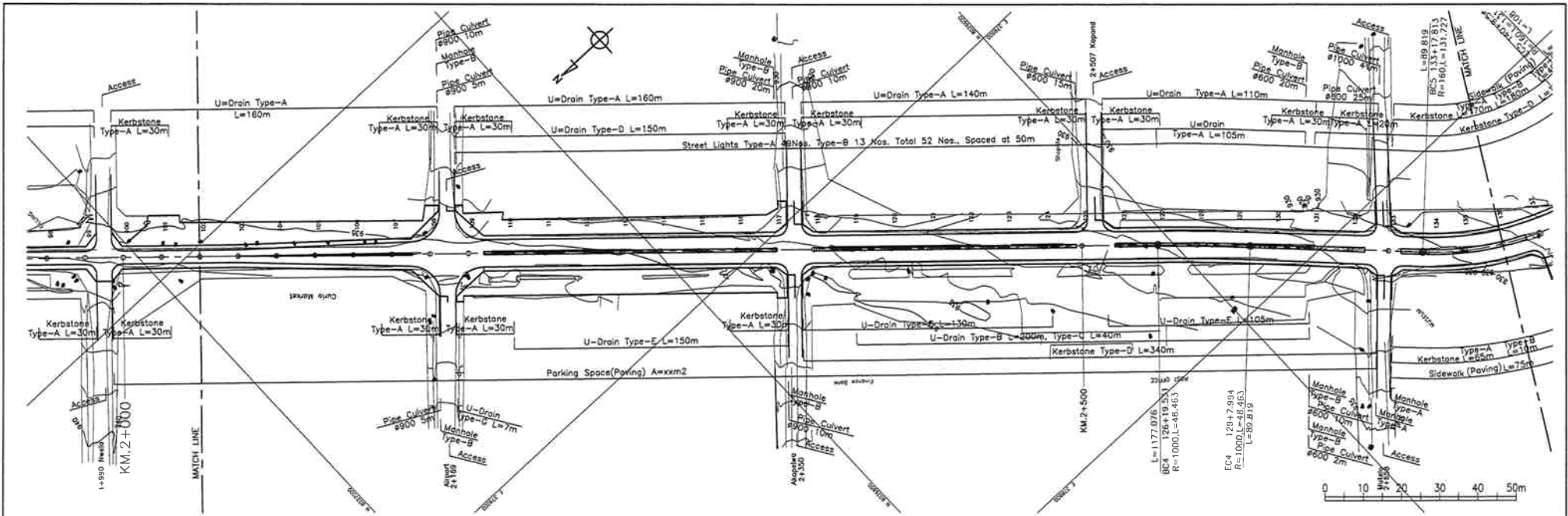

VERTICAL ALIGNMENT	Profile Line																																		
FILL	0.216	0.271	0.186	0.171	0.223	0.204	0.233	0.446	0.307	0.306	0.306	0.307	0.453	0.437	0.420	0.333	0.177	0.340	0.313	0.237	0.200	0.343	0.227	0.436	0.403	0.237	0.416	0.423	0.457	0.497	0.206	0.509	0.487	0.092	
CUT																																			0.084
FINISHED LEVEL	935.794	935.939	935.890	935.821	935.763	935.704	935.645	935.596	935.527	935.468	935.409	935.311	935.133	934.917	934.700	934.483	934.267	934.050	933.833	933.617	933.400	933.183	932.967	932.750	932.533	932.317	932.100	931.883	931.794	931.657	931.500	931.233	931.017	929.244	
GROUND LEVEL	935.79	935.64	935.70	935.63	935.51	935.50	935.39	935.14	935.25	935.14	935.09	935.01	934.68	934.48	934.28	934.15	934.04	934.05	933.25	933.36	933.26	932.64	932.35	932.19	932.08	931.64	931.44	931.31	931.17	931.64	931.13	930.71	931.17	930.51	930.07
KM	2040.000	2040.000	2050.000	2100.000	2120.000	2140.000	2160.000	2190.000	2200.000	2220.000	2240.000	2260.000	2280.000	2310.000	2320.000	2340.000	2360.000	2380.000	2400.000	2420.000	2440.000	2460.000	2500.000	2520.000	2540.000	2560.000	2580.000	2600.000	2620.000	2640.000	2660.000	2680.000	2700.000	2720.000	
HORIZONTAL ALIGNMENT	[Diagrammatic representation of horizontal alignment]																																		
SUPER ELEVATION	[Diagrammatic representation of super elevation]																																		

<ul style="list-style-type: none"> The Ministry of Local Government and Housing of The Republic of Zambia Japan International Cooperation Agency 	CONSULTANTS:	PROJECT NAME:	DRAWING TITLE:	Date: March 2008	DRAWING No.:
	Construction Project Consultants, INC. (CPC)	THE PROJECT FOR IMPROVEMENT OF LIVINGSTONE CITY ROADS	PLAN AND PROFILE (5/20) KM 2+040 - KM 2+720	Prepared by:	ZL BD D-5
				Checked by:	

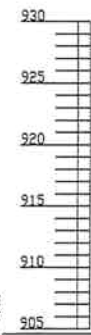
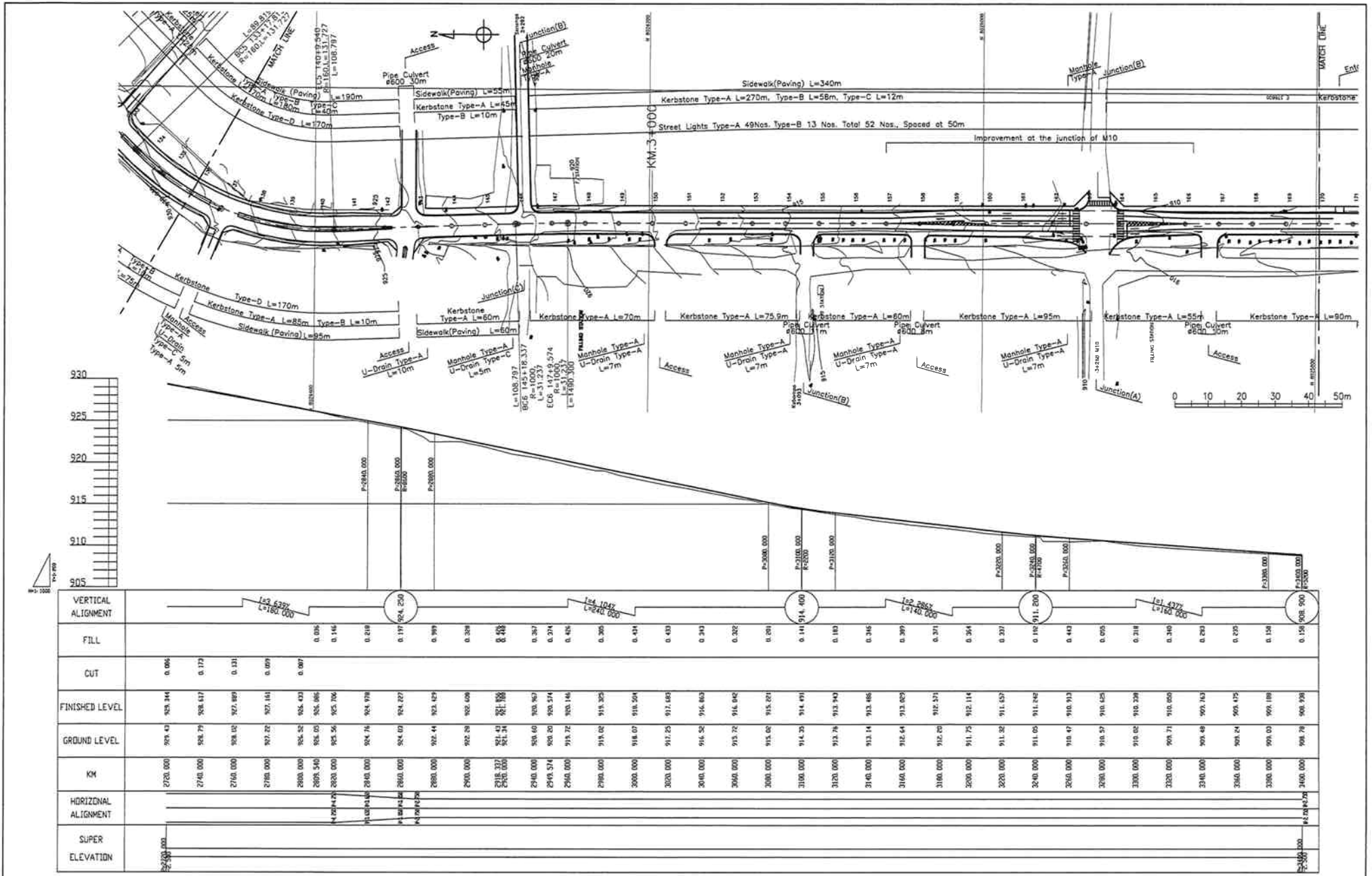

VERTICAL ALIGNMENT	FILL	CUT	FINISHED LEVEL	GROUND LEVEL	KM	HORIZONTAL ALIGNMENT	SUPER ELEVATION
			923.144	923.43	2720.000		
			928.417	928.79	2740.000		
			927.889	928.02	2760.000		
			927.141	927.22	2780.000		
			925.423	925.32	2800.000		
			925.885	925.02	2805.540		
			925.706	925.26	2808.000		
			924.978	924.76	2810.000		
			924.227	924.02	2815.000		
			923.429	922.44	2820.000		
			922.008	922.29	2830.000		
			921.188	921.41	2835.327		
			921.108	921.31	2835.000		
			920.927	920.60	2840.000		
			920.374	920.20	2845.574		
			920.146	919.72	2850.000		
			919.325	919.02	2855.000		
			918.294	918.07	2860.000		
			917.085	917.25	2870.000		
			916.883	916.52	2880.000		
			916.042	915.72	2890.000		
			915.221	915.02	2900.000		
			914.491	914.35	2910.000		
			913.747	913.76	2920.000		
			913.486	913.14	2930.000		
			913.029	912.64	2940.000		
			912.521	912.02	2950.000		
			912.114	911.75	2960.000		
			911.537	911.32	2970.000		
			911.242	911.02	2980.000		
			910.913	910.47	2990.000		
			910.425	910.27	3000.000		
			910.228	910.02	3010.000		
			910.000	909.71	3020.000		
			909.763	909.48	3030.000		
			909.175	909.24	3040.000		
			909.188	909.02	3050.000		
			908.798	908.78	3060.000		

<ul style="list-style-type: none"> The Ministry of Local Government and Housing of The Republic of Zambia Japan International Cooperation Agency 	CONSULTANTS:	PROJECT NAME:	DRAWING TITLE:	Date: March 2008	DRAWING No.:
	Construction Project Consultants, INC. (CPC)	THE PROJECT FOR IMPROVEMENT OF LIVINGSTONE CITY ROADS	PLAN AND PROFILE (6/20) KM 2+720 - KM 3+400	Prepared by:	ZL BD D-6
				Checked by:	

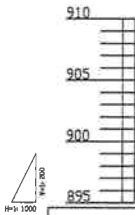
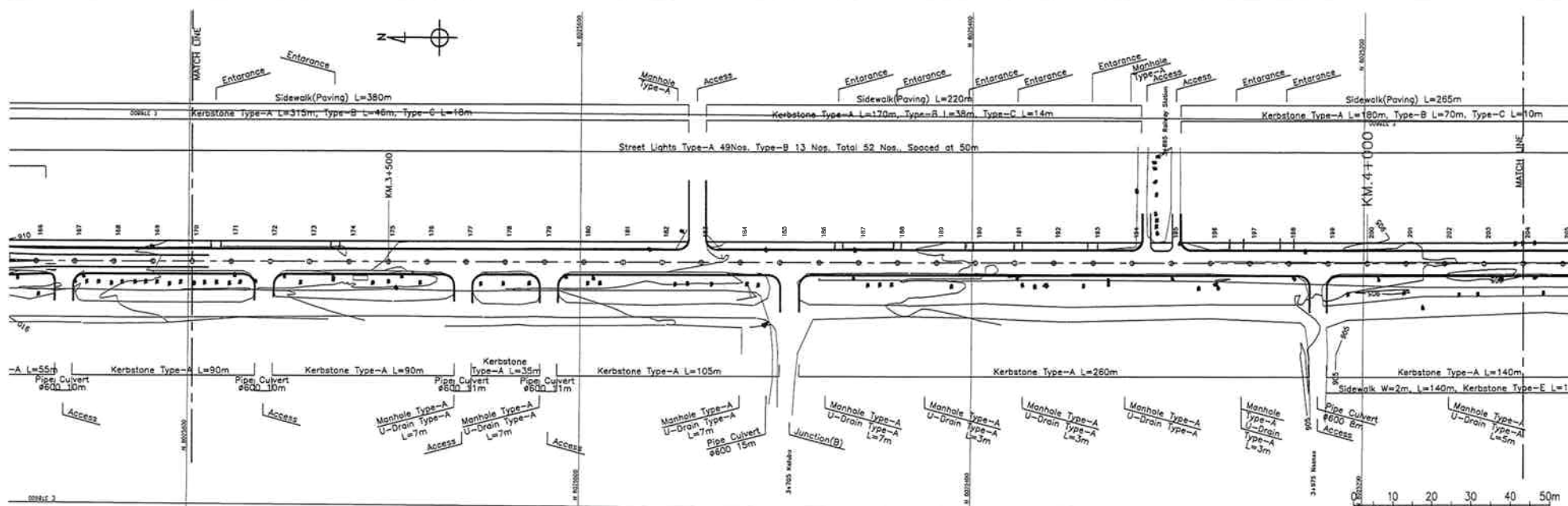

VERTICAL ALIGNMENT	FILL	CUT	FINISHED LEVEL	GROUND LEVEL	KM	HORIZONTAL ALIGNMENT	SUPER ELEVATION
908.900	0.150		908.538	908.781	3400.000		
	0.426		908.165	908.341	3420.000		
	0.280		908.020	908.251	3440.000		
	0.275		908.455	908.221	3460.000		
	0.426		908.367	907.941	3480.000		
	0.285		908.225	907.941	3500.000		
	0.276		908.006	907.821	3520.000		
	0.245		907.950	907.711	3540.000		
	0.216		907.824	907.591	3560.000		
	0.189		907.685	907.501	3580.000		
	0.230		907.520	907.321	3600.000		
	0.180		907.250	907.161	3620.000		
	0.085		907.145	907.061	3640.000		
	0.190		907.010	906.821	3660.000		
	0.205		906.877	906.671	3700.000		
	0.240		906.740	906.501	3720.000		
	0.145		906.620	906.441	3740.000		
	0.316		906.470	906.141	3760.000		
	0.315		906.355	906.021	3780.000		
	0.211		906.211	906.001	3800.000		
	0.251		906.111	905.861	3820.000		
	0.331		906.021	905.671	3840.000		
	0.302		905.922	905.621	3860.000		
	0.132		905.842	905.671	3880.000		
	0.133		905.753	905.421	3900.000		
	0.153		905.667	905.511	3920.000		
	0.114		905.574	905.441	3940.000		
	0.204		905.464	905.281	3960.000		
	0.225		905.395	905.171	3980.000		
	0.189		905.300	905.121	4000.000		
	0.156		905.214	905.061	4020.000		
	0.186		905.124	904.941	4040.000		
	0.037		905.037	905.001	4060.000		
	0.077		904.947	904.871	4080.000		

• The Ministry of Local Government and Housing of The Republic of Zambia
 • Japan International Cooperation Agency

CONSULTANTS:
 Construction Project Consultants, INC. (CPC)

PROJECT NAME:
 THE PROJECT FOR IMPROVEMENT OF LIVINGSTONE CITY ROADS

DRAWING TITLE:
 PLAN AND PROFILE (7/20)
 KM 3+400 - KM 4+080

Date: March 2008
 Prepared by:
 Checked by:

DRAWING No.:
 ZL BD D-7

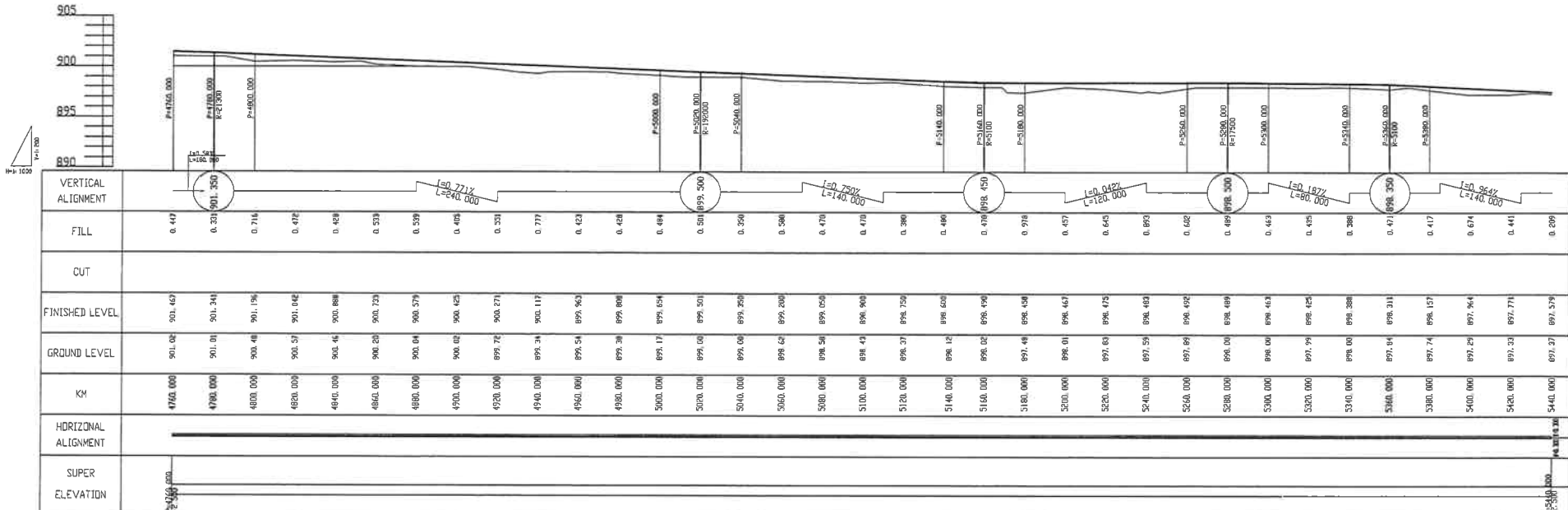
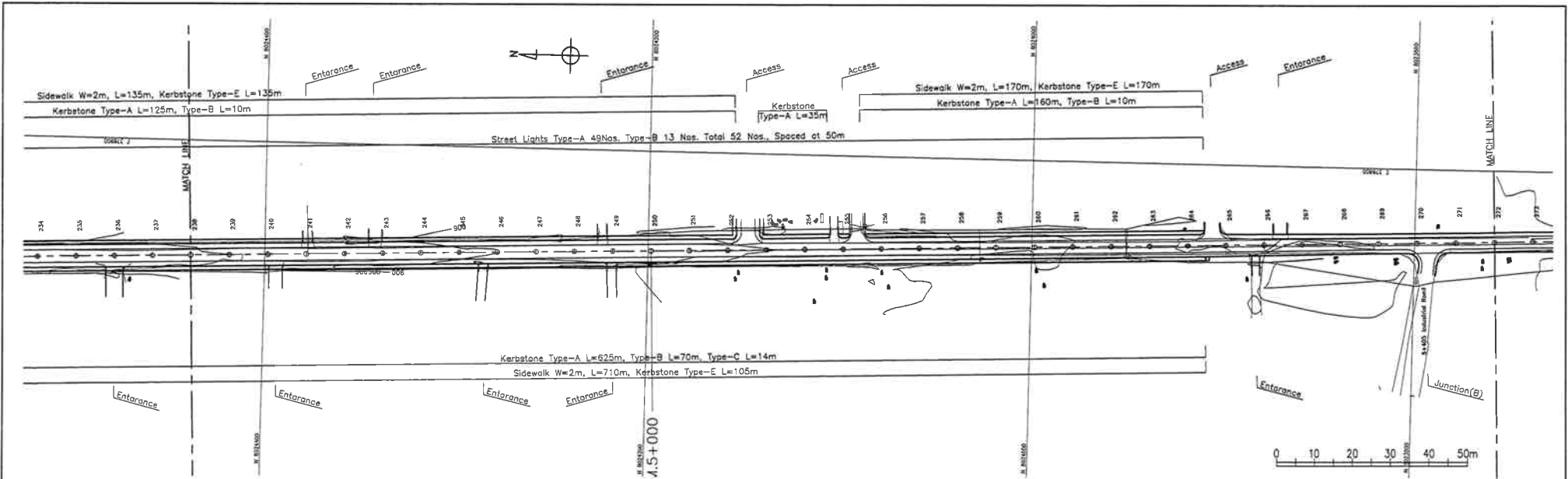

VERTICAL ALIGNMENT	FILL	CUT	FINISHED LEVEL	GROUND LEVEL	KM	HORIZONTAL ALIGNMENT	SUPER ELEVATION
	0.44		901.63	901.08	4760.000		
	0.33		901.34	901.01	4790.000		
	0.71		901.19	900.48	4800.000		
	0.47		901.04	900.57	4850.000		
	0.42		900.88	900.46	4860.000		
	0.53		900.73	900.20	4860.000		
	0.53		900.57	900.04	4880.000		
	0.40		900.42	900.02	4900.000		
	0.33		900.27	899.72	4920.000		
	0.77		900.11	899.34	4940.000		
	0.43		899.96	899.54	4960.000		
	0.45		899.80	899.38	4980.000		
	0.48		899.65	899.17	5000.000		
	0.50		899.50	899.00	5020.000		
	0.56		899.29	899.00	5040.000		
	0.58		899.20	899.64	5060.000		
	0.47		899.05	899.54	5080.000		
	0.47		898.90	898.43	5100.000		
	0.38		898.75	898.37	5120.000		
	0.48		898.60	898.12	5140.000		
	0.47		898.45	898.02	5160.000		
	0.78		898.45	897.48	5180.000		
	0.47		898.46	898.01	5200.000		
	0.64		898.45	897.61	5220.000		
	0.65		898.43	897.59	5240.000		
	0.62		898.42	897.89	5260.000		
	0.49		898.49	898.00	5280.000		
	0.43		898.43	898.00	5300.000		
	0.45		898.42	897.91	5320.000		
	0.38		898.38	898.00	5340.000		
	0.47		898.31	897.84	5360.000		
	0.47		898.15	897.74	5380.000		
	0.64		897.94	897.29	5400.000		
	0.44		897.77	897.33	5420.000		
	0.28		897.59	897.37	5440.000		

<ul style="list-style-type: none"> The Ministry of Local Government and Housing of The Republic of Zambia Japan International Cooperation Agency 	CONSULTANTS:	PROJECT NAME:	DRAWING TITLE:	Date: March 2008	DRAWING No.:
	Construction Project Consultants, INC. (CPC)	THE PROJECT FOR IMPROVEMENT OF LIVINGSTONE CITY ROADS	PLAN AND PROFILE (9/20) KM 4+760 - KM 5+440	Prepared by:	ZL BD D-9
				Checked by:	

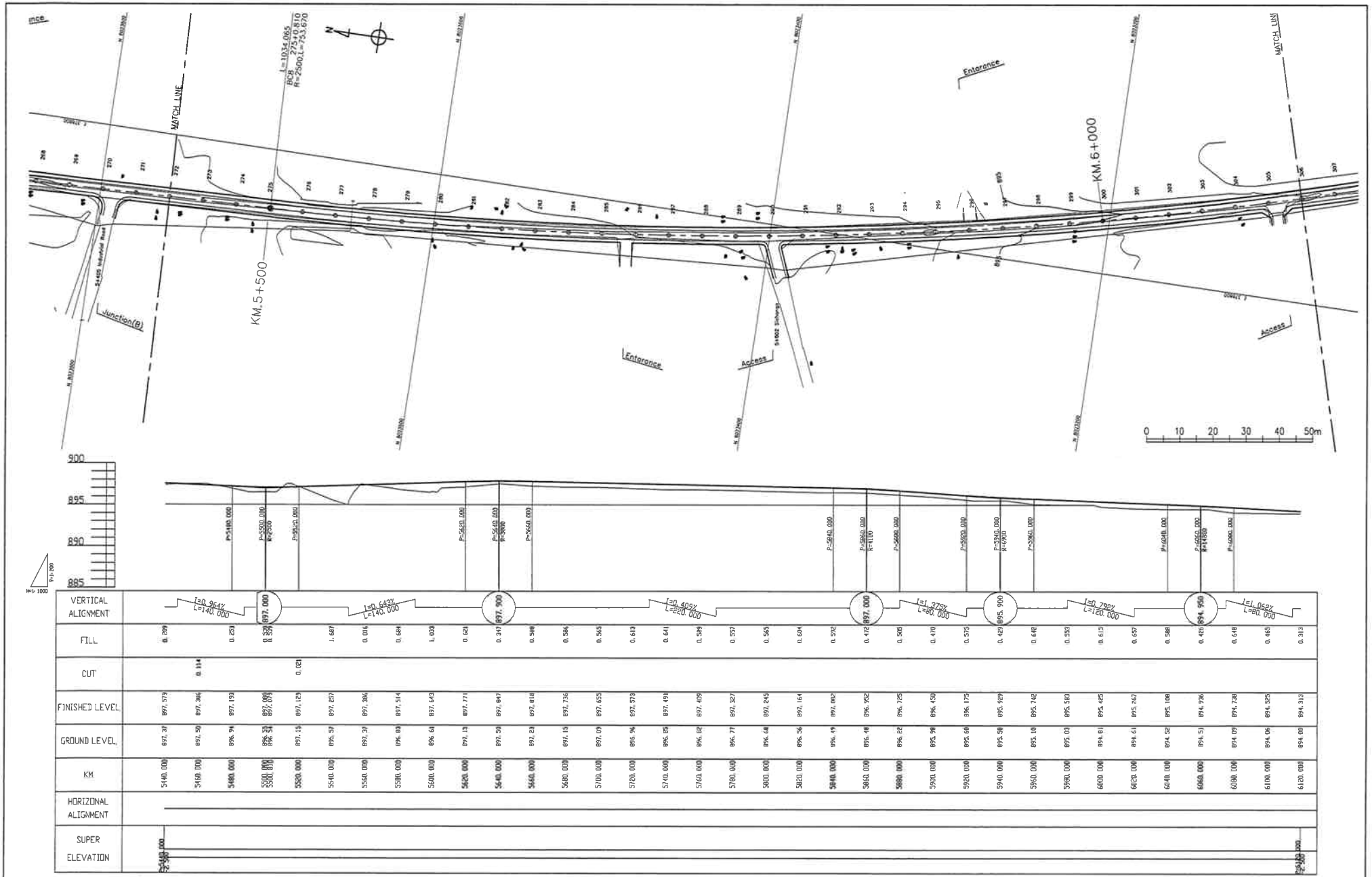

<ul style="list-style-type: none"> The Ministry of Local Government and Housing of The Republic of Zambia Japan International Cooperation Agency 	CONSULTANTS:	PROJECT NAME:	DRAWING TITLE:	Date: March 2008	DRAWING No.:
	Construction Project Consultants, INC. (CPC)	THE PROJECT FOR IMPROVEMENT OF LIVINGSTONE CITY ROADS	PLAN AND PROFILE (10/20) KM 5+440 - KM 6+120	Prepared by:	ZL BD D-10
				Checked by:	

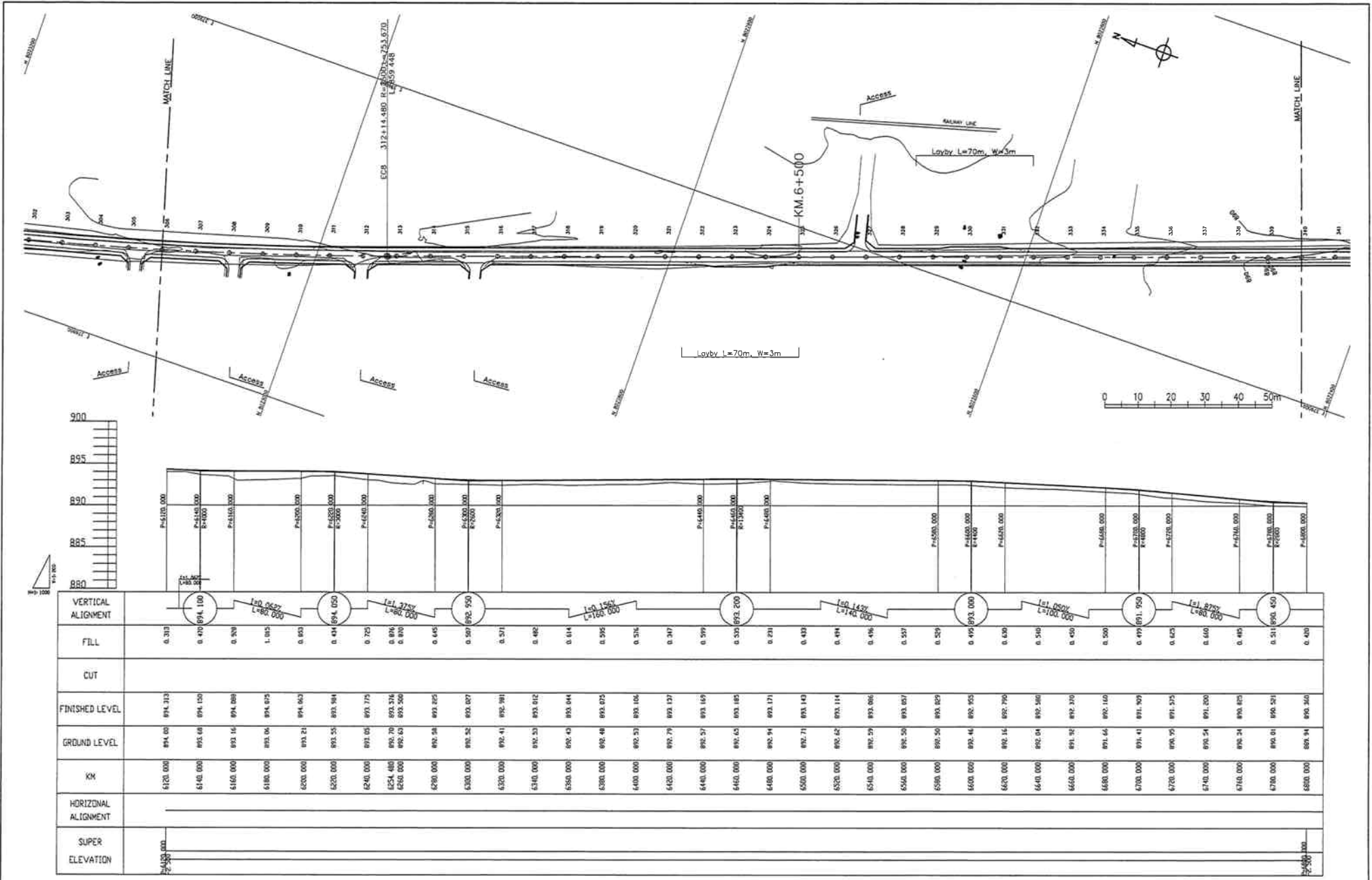

<ul style="list-style-type: none"> The Ministry of Local Government and Housing of The Republic of Zambia Japan International Cooperation Agency 	CONSULTANTS:	PROJECT NAME:	DRAWING TITLE:	Date: March 2008	DRAWING No.:
	Construction Project Consultants, INC. (CPC)	THE PROJECT FOR IMPROVEMENT OF LIVINGSTONE CITY ROADS	PLAN AND PROFILE (11/20) KM 6+120 - KM 6+800	Prepared by:	ZL BD D-11
				Checked by:	

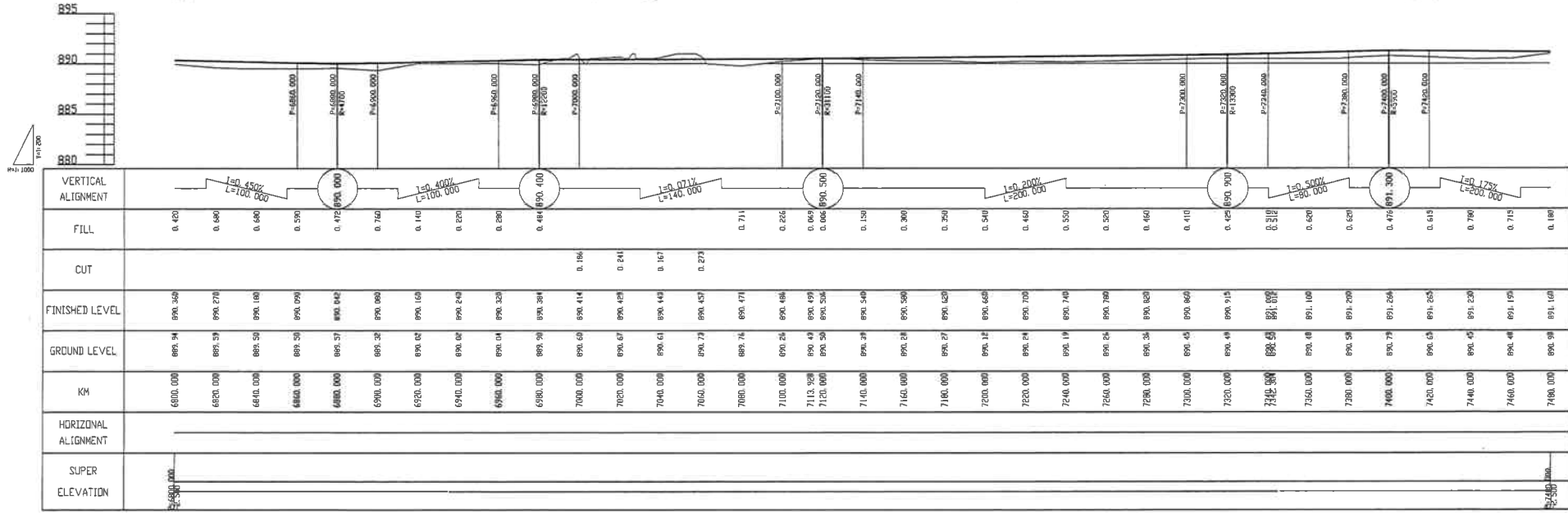
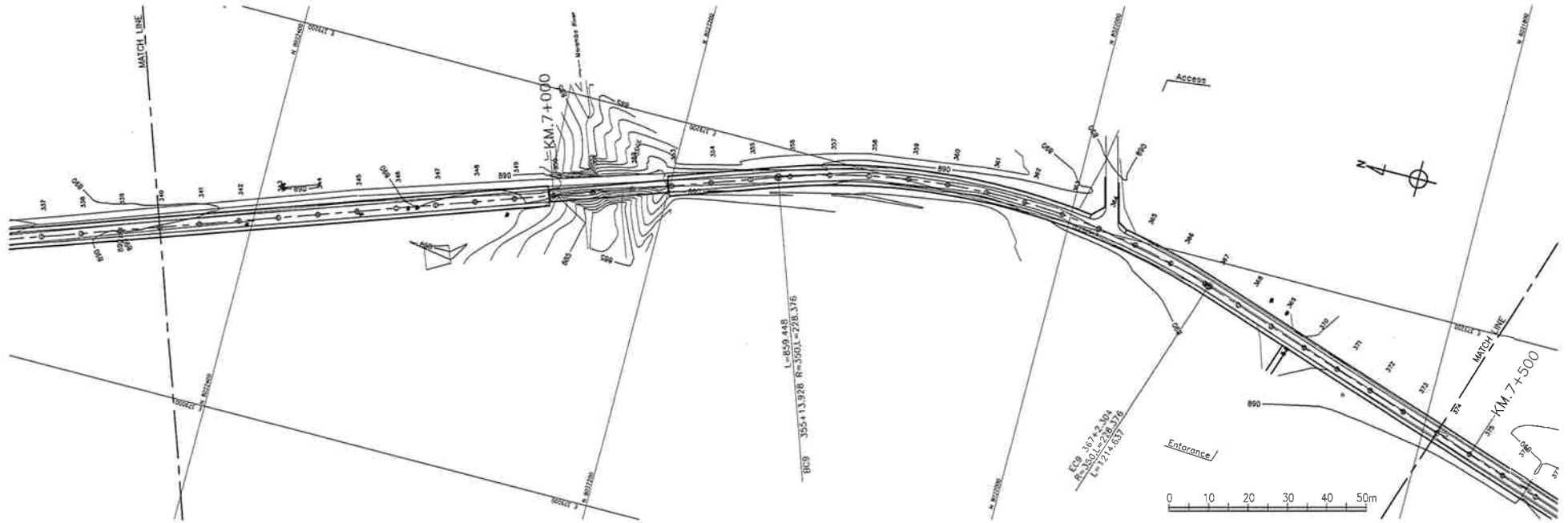

- The Ministry of Local Government and Housing of The Republic of Zambia
- Japan International Cooperation Agency

CONSULTANTS: Construction Project Consultants, INC. (CPC)	PROJECT NAME: THE PROJECT FOR IMPROVEMENT OF LIVINGSTONE CITY ROADS	DRAWING TITLE: PLAN AND PROFILE (12/20) KM 6+800 - KM 7+480	Date: March 2008	DRAWING No.:
			Prepared by:	ZL BD D-12
			Checked by:	