

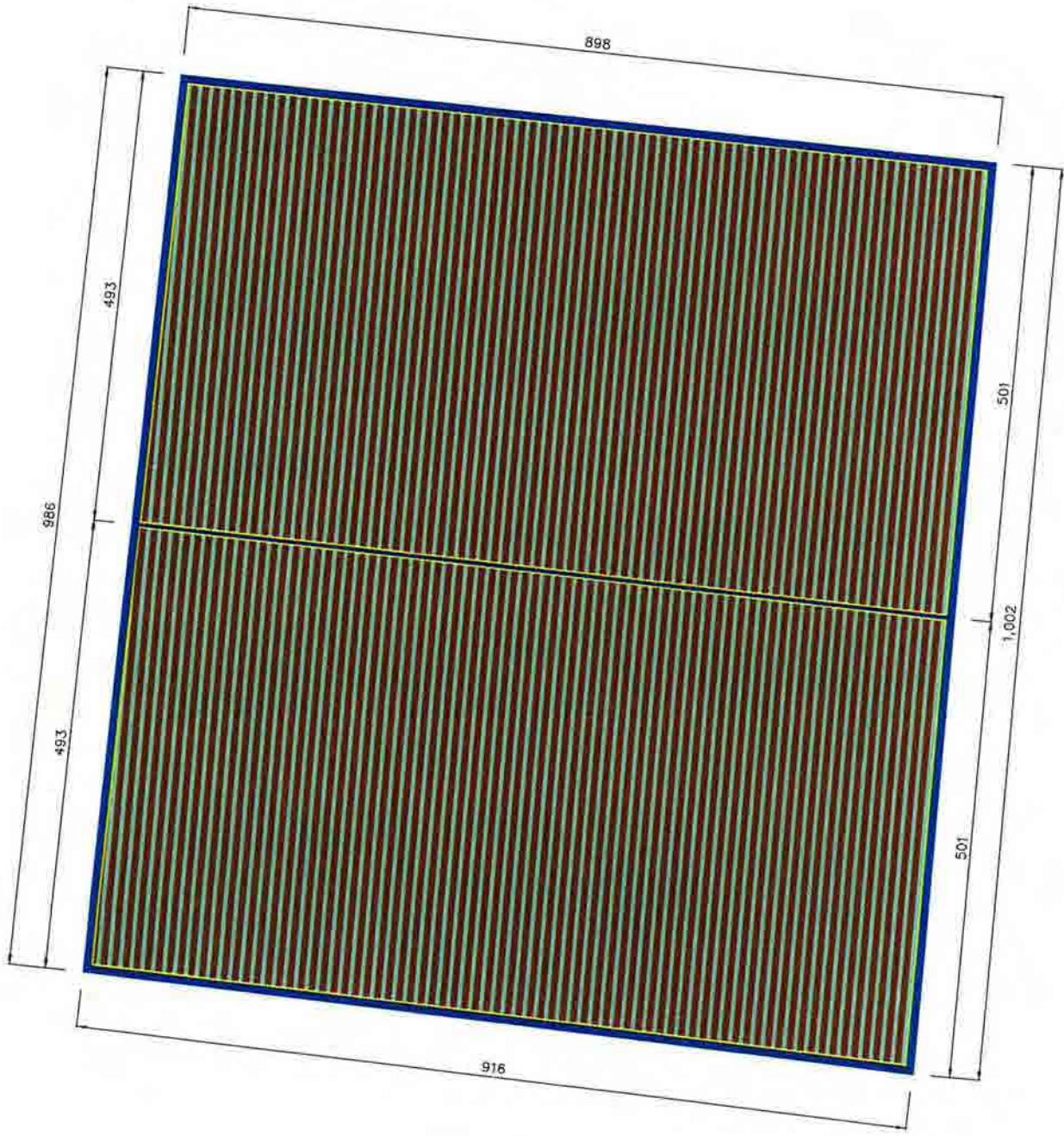

5. OUTLINE DESIGN DRAWINGS



Remarks
凡例





	Embankment エンバンクメント
	Mound 高田のマウンド (2m)
	Pitch 溝 (4m)
	Canal (Surrounding : w=8m, Center : w=4m) 水路 (周囲8m、中央4m)

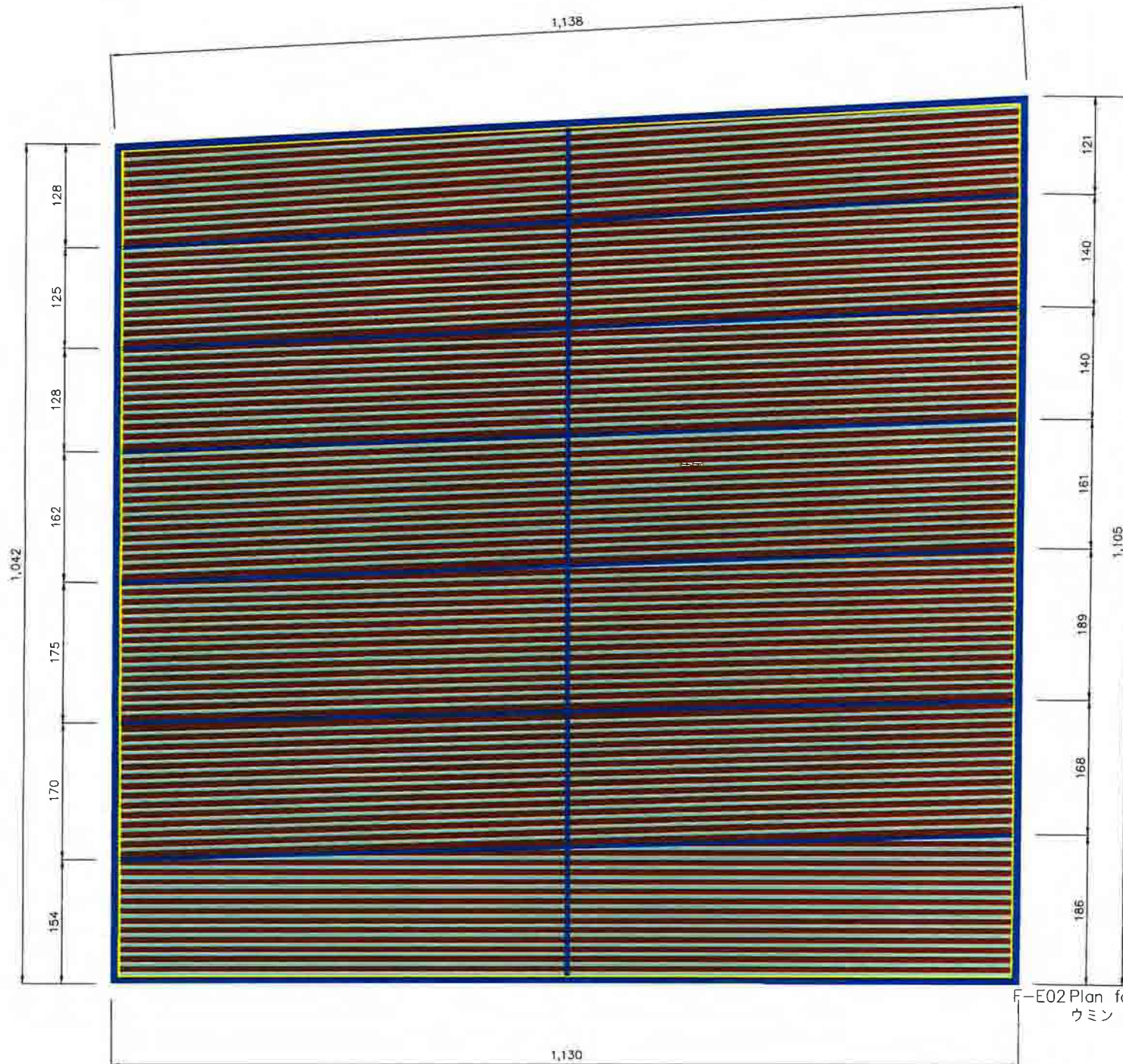

F-E01 Plan for the embankment in U Minh I Forest Company
ウミン I 森林会社エンバンクメント計画



Remarks
凡例

	Embankment エンバンクメント
	Mound 周囲のマウンド (2m)
	Pitch 溝 (4m)
	Canal (Surrounding : w=8m, Center : w=4m) 水路 (周囲8m、中央4m)



F-E02 Plan for the embankment in U Minh II Forest Company
ウミン II 森林会社エンバンクメント計画

A-5-3

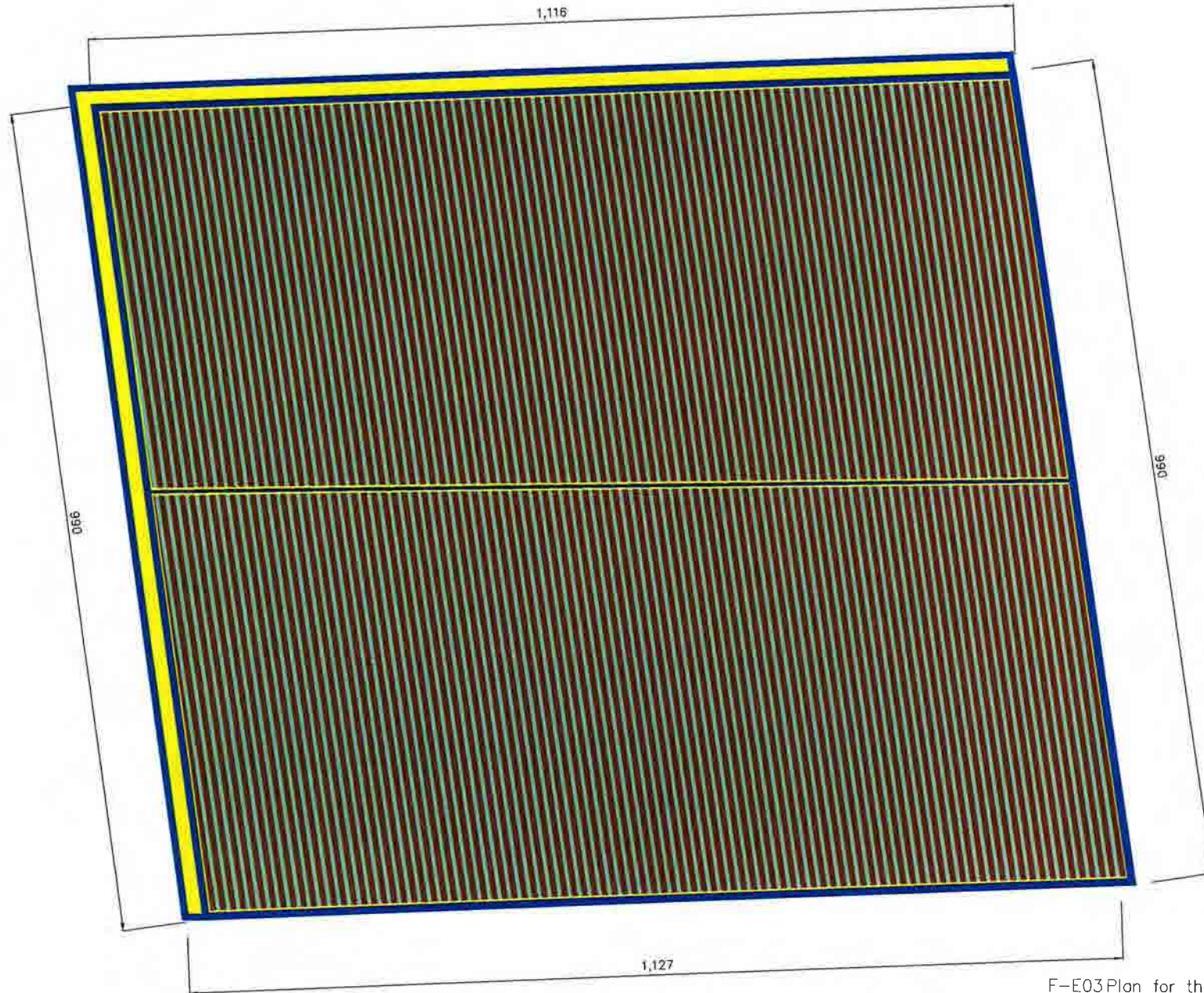

Remarks
凡例

	Embankment エンバンクメント
	Mound 周囲のマウンド (2m)
	Pitch 溝 (4m)
	Canal (Surrounding : w=8m, Center : w=4m) 水路 (周囲8m、中央4m)





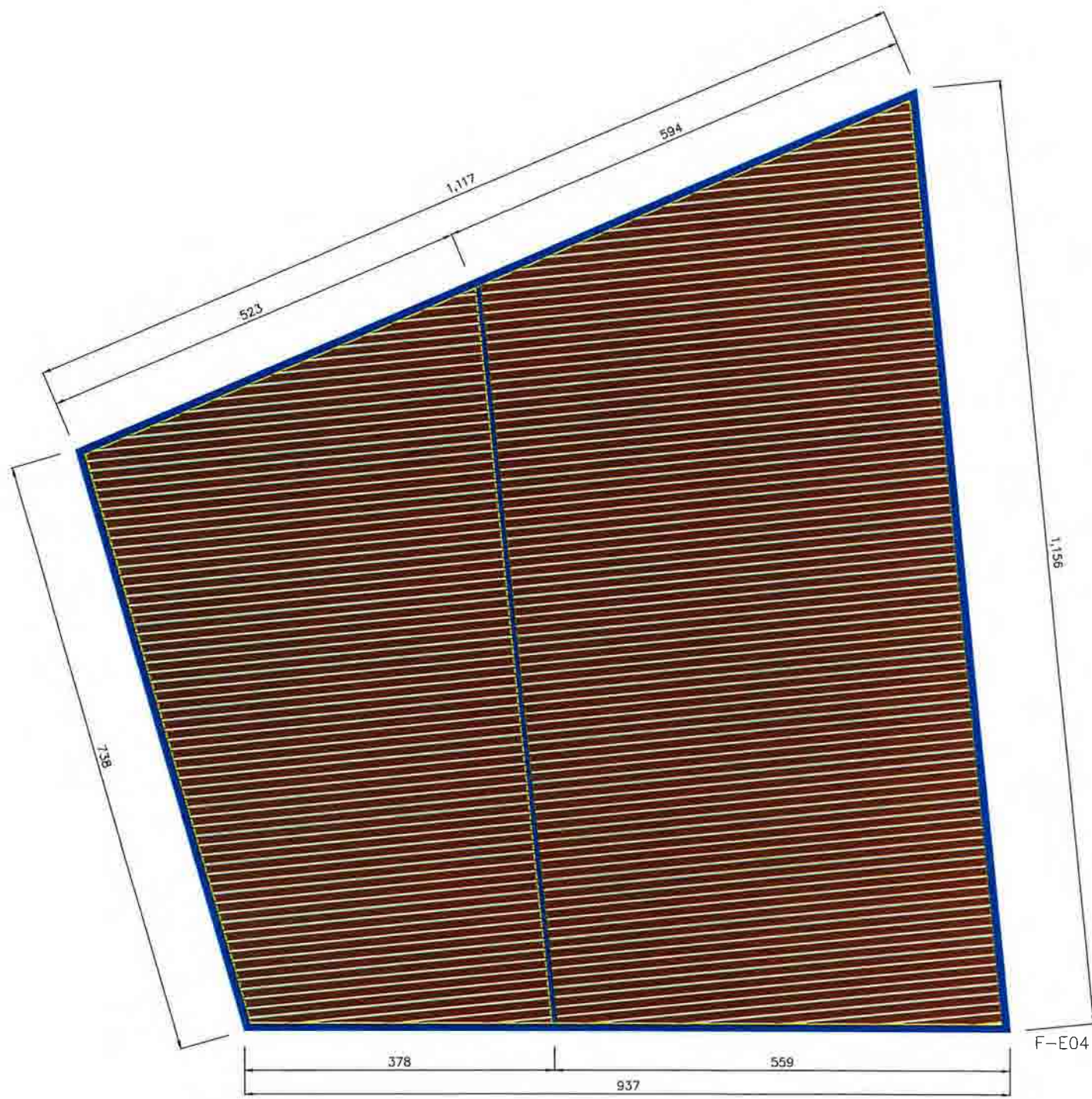

F-E03 Plan for the embankment in
Tran Van Thoi Forest Forest Company
チャンbantイ 森林会社エンバンクメント計画

A-5-4



Remarks
凡例

-  Embankment
エンバンクメント
-  Mound
周囲のマウンド (2m)
-  Pitch
溝 (4m)
-  Canal (Surrounding : w=8m,
Center : w=4m)
水路 (周囲8m、中央4m)

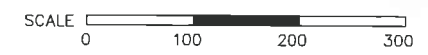

F-E04 Plan for the embankment in 30/40 Forest Company
4月30日 森林会社エンバンクメント計画

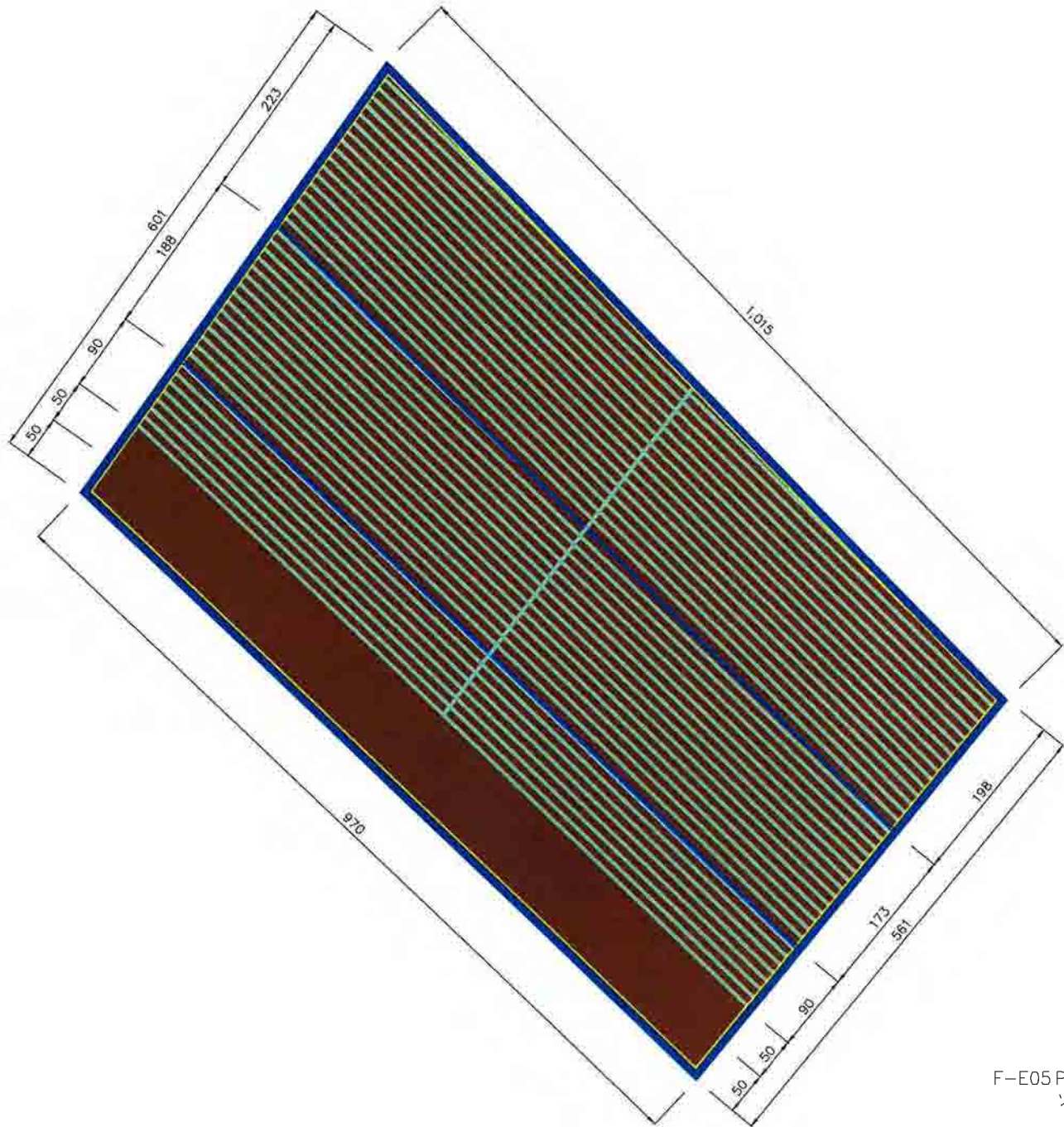

Remarks
凡例

	Embankment エンバンクメント
	Mound 周囲のマウンド (2m)
	Pitch 溝 (4m)
	Canal (Surrounding : w=8m, Center : w=4m) 水路 (周囲8m、中央4m)



F-E05 Plan for the embankment in Song Trem Forest Company
ソンテム 森林会社エンバンクメント計画

Dry season 乾季

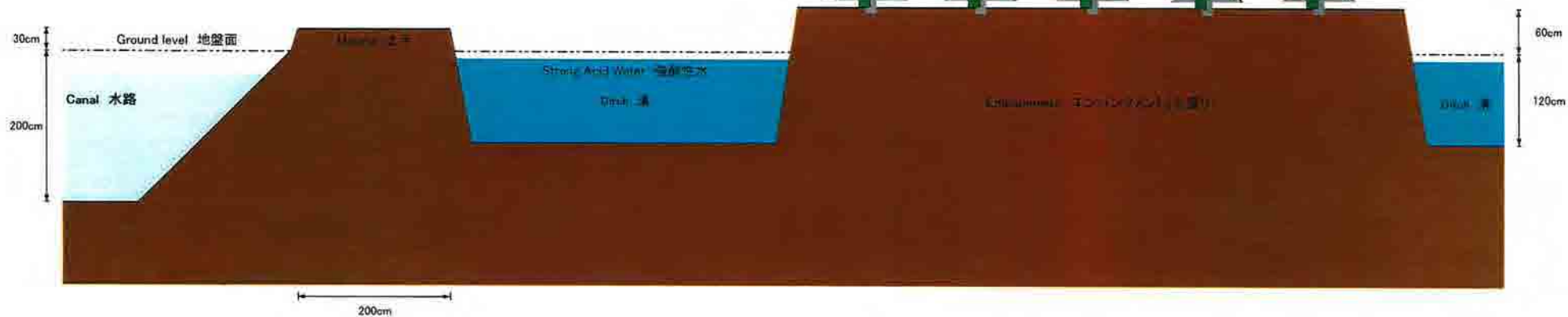

A-5-6

Rainy season 雨季

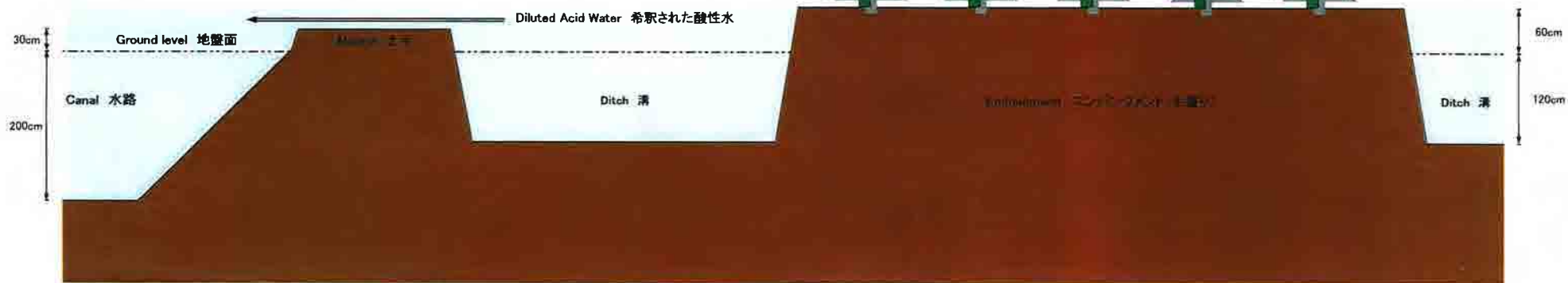

F-E06 Typical Cross Section of Forest Land Improvement
林地改良標準断面図

A-5-8

水路両側に土手がある場合
Canal with two Banks

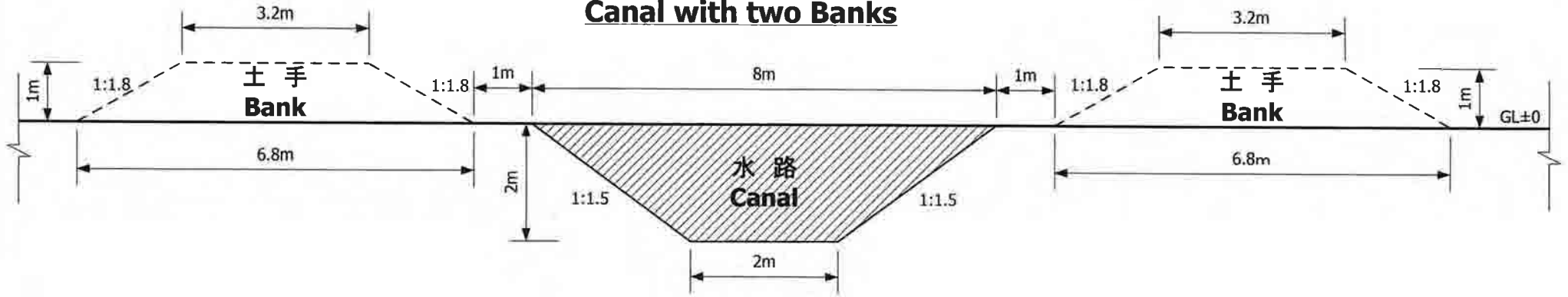

水路片側に土手が有る場合
Canal with one Bank

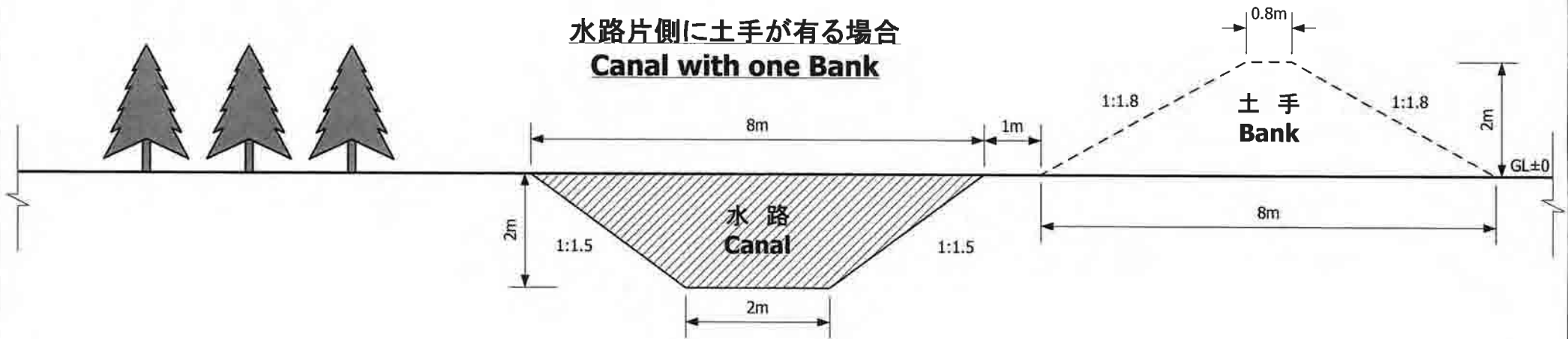

C-C01 Typical Cross Section of New Canal and Bank
水路標準断面図

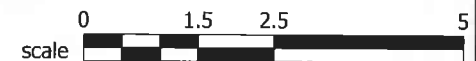

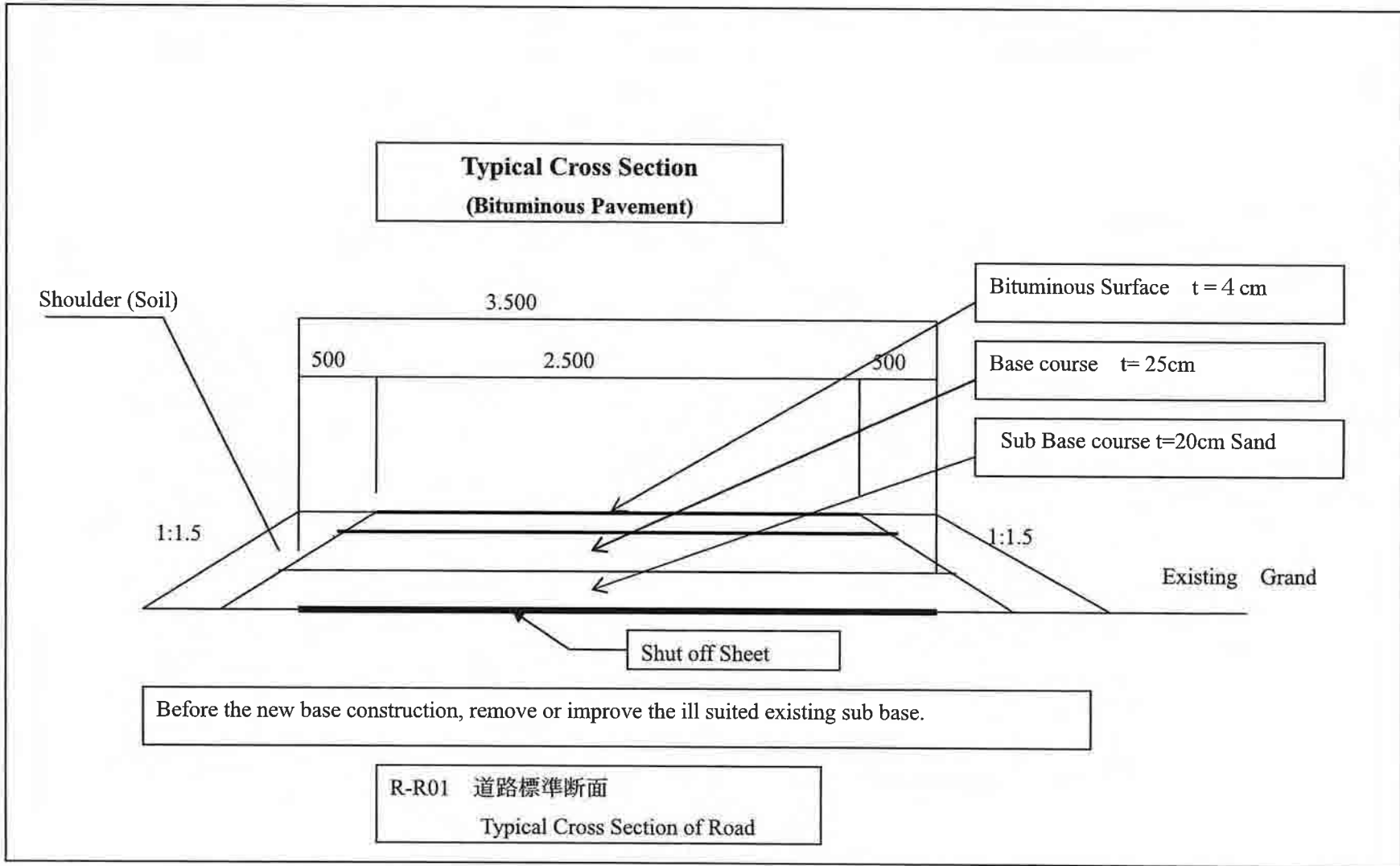

Construction Method of Bituminous Penetration Macadam Surface (4cm)

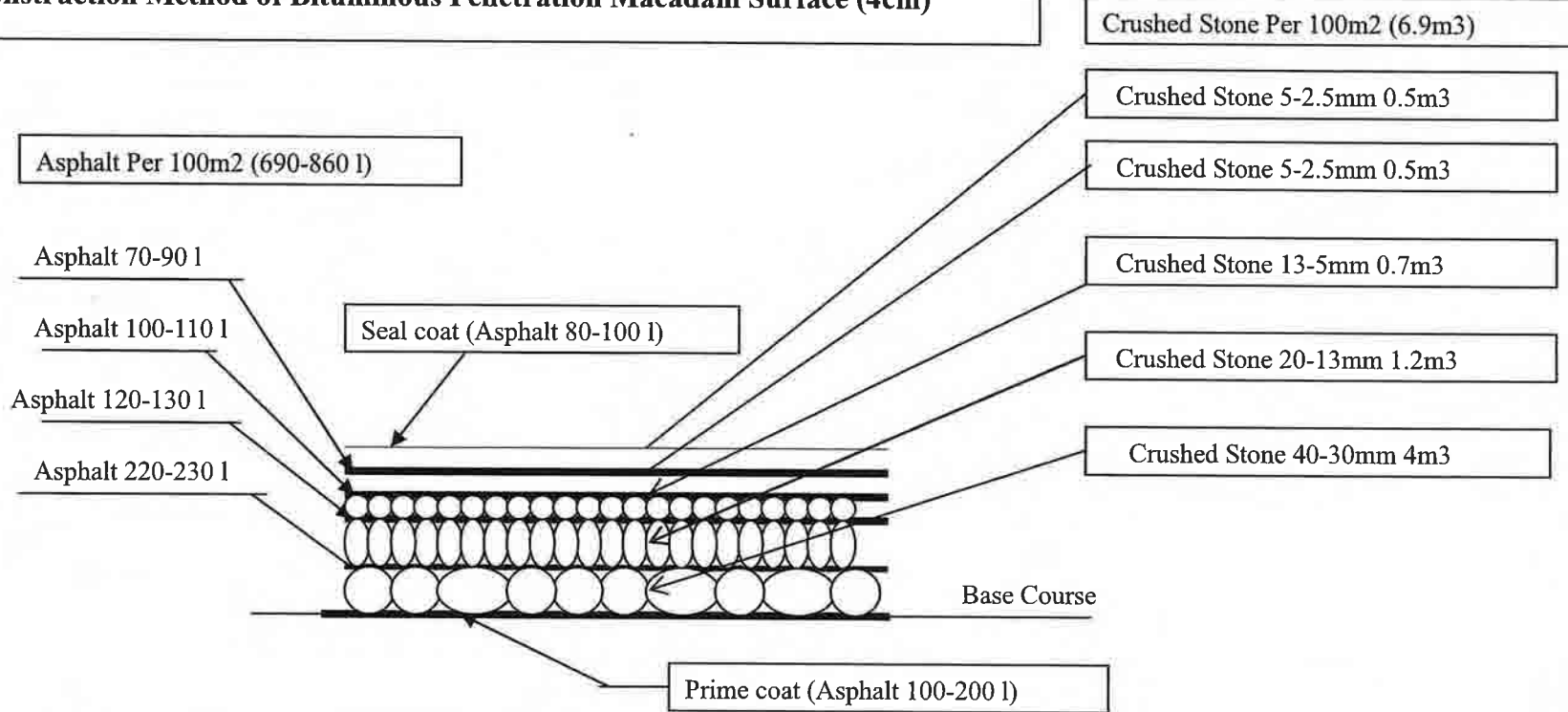

Before the Bituminous surface construction, remove or improve the ill suited base and shall be spread on the top of the completed upper base as prime coat prime coat(100-200l/100m2).
 After laying the surface course, the road surface shall be covered with seal coat (80-100l/100m2).

R-R02 アスファルト舗装構成
 Structure of Bituminous Surface Course

A-5-11

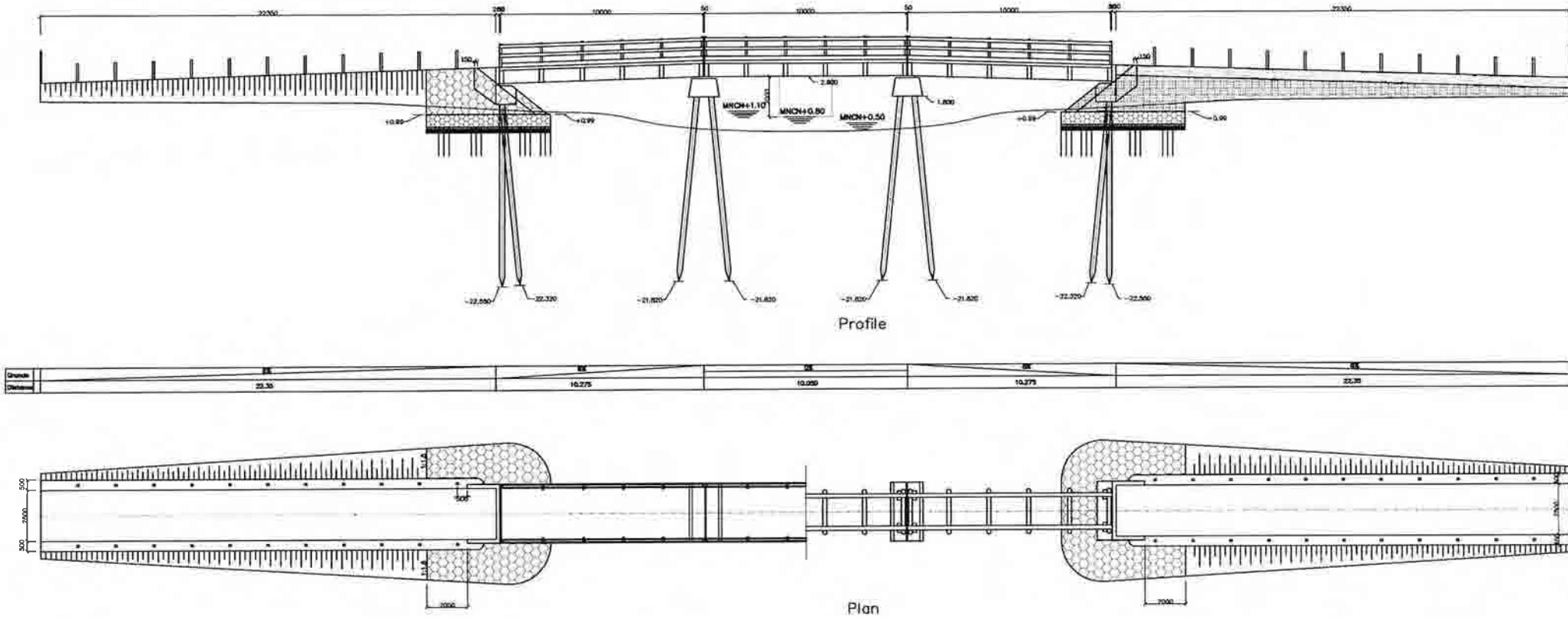

R-B01 Bridge Pier General View
橋梁一般 縦断、平面図（取り付け部 | タイプ）

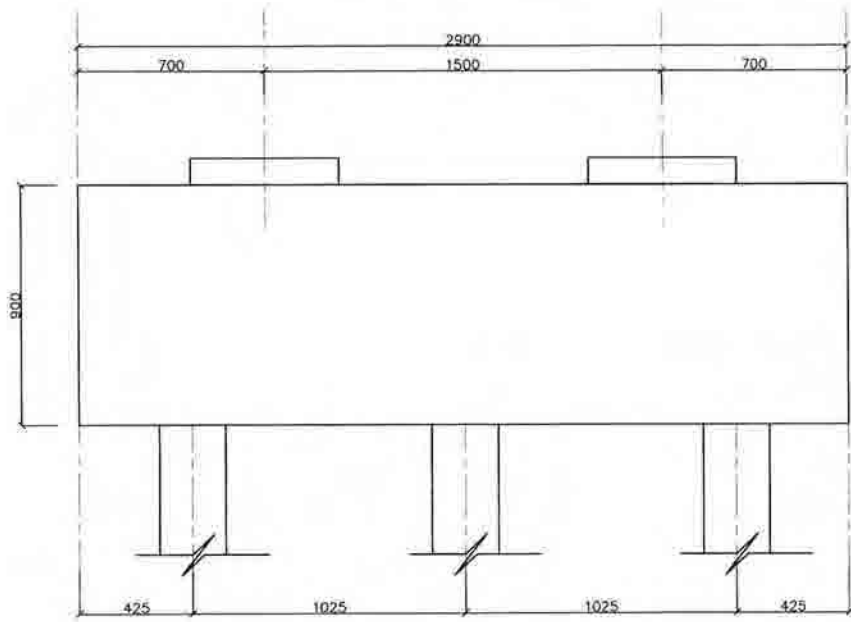

Cross Section

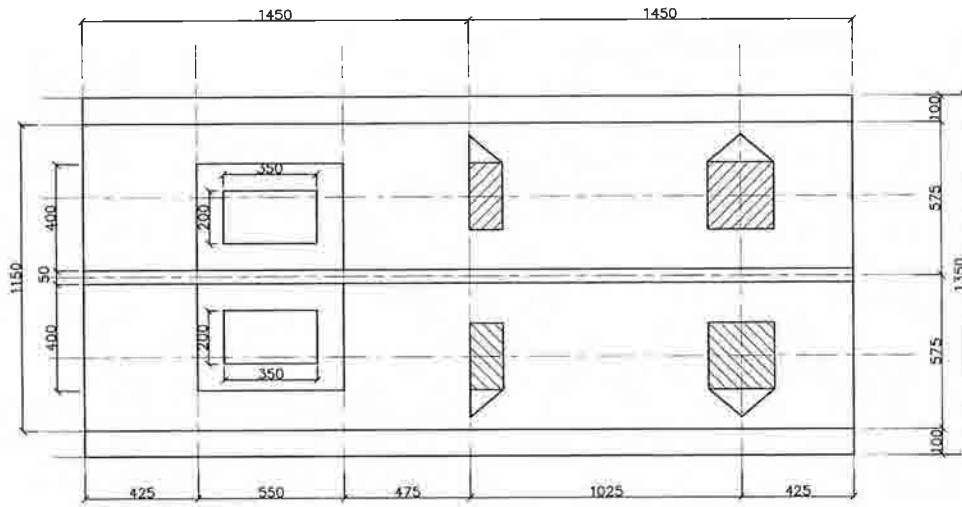
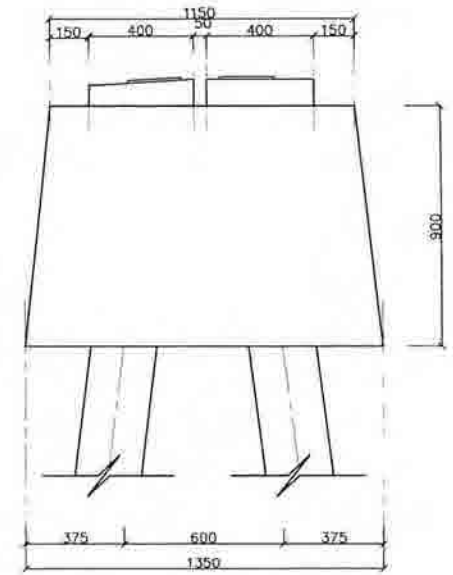

Plan

R-B02 Bridge Pier General View
橋脚 一般図

A-5-13

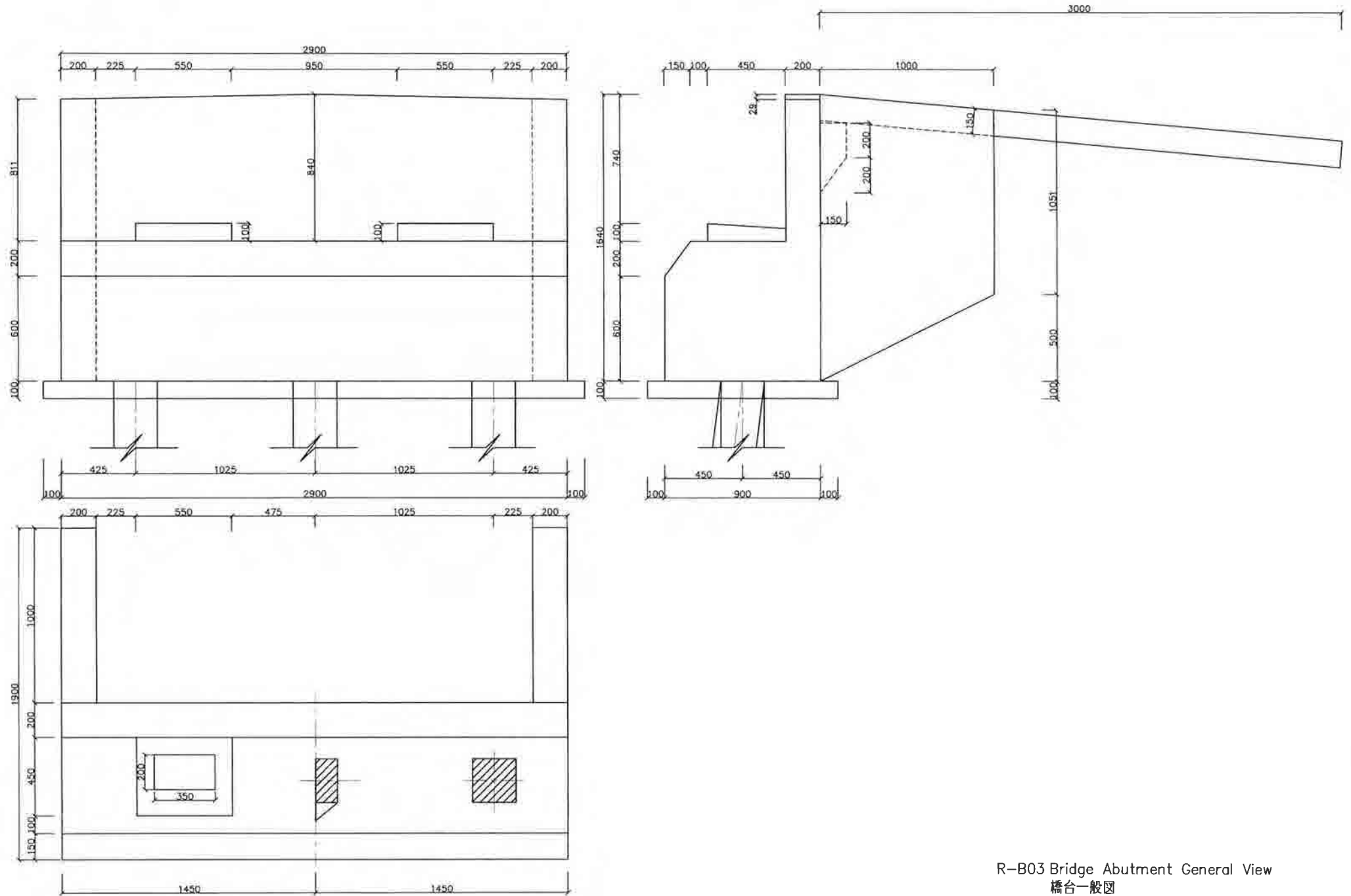

R-B03 Bridge Abutment General View
橋台一般図

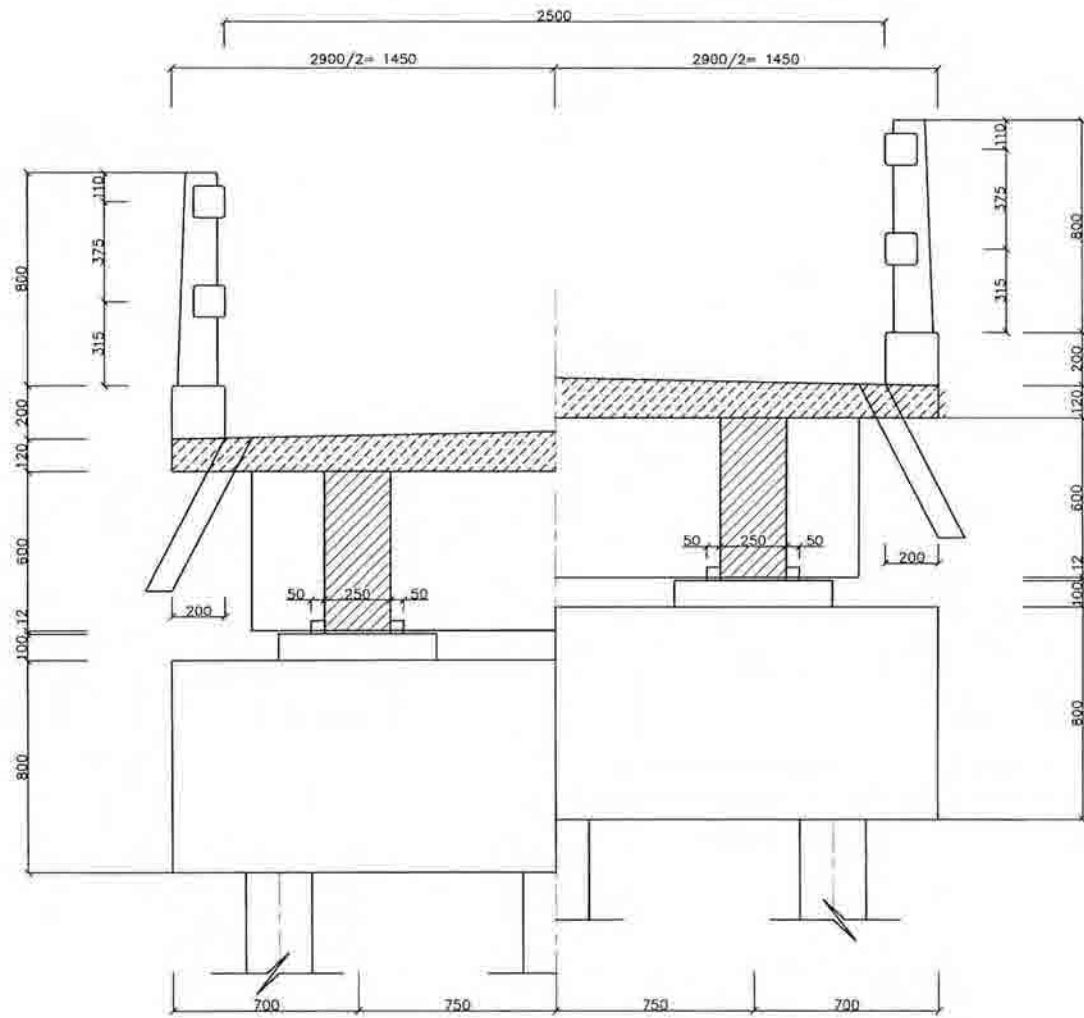

R-B04 Bridge Superstructure Cross Section
橋梁断面図

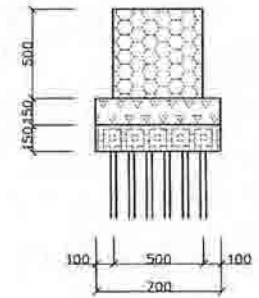
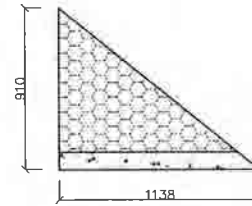
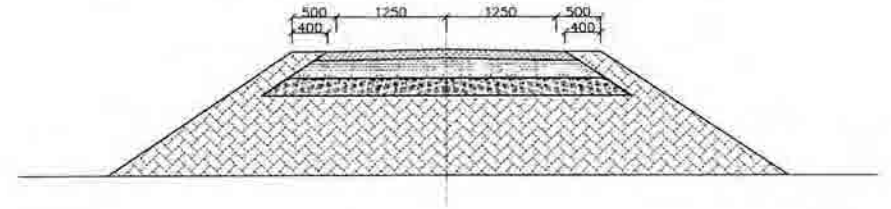
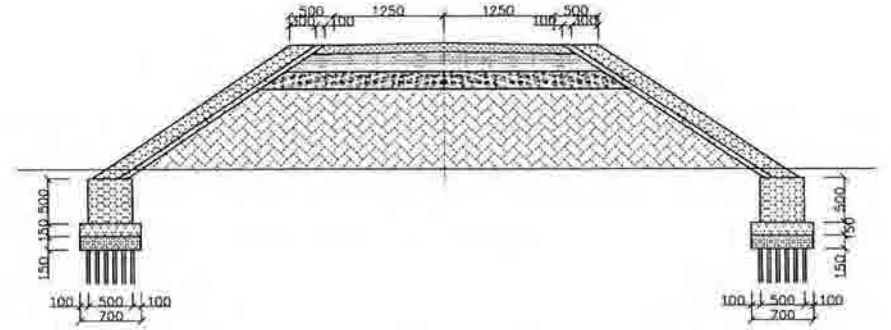
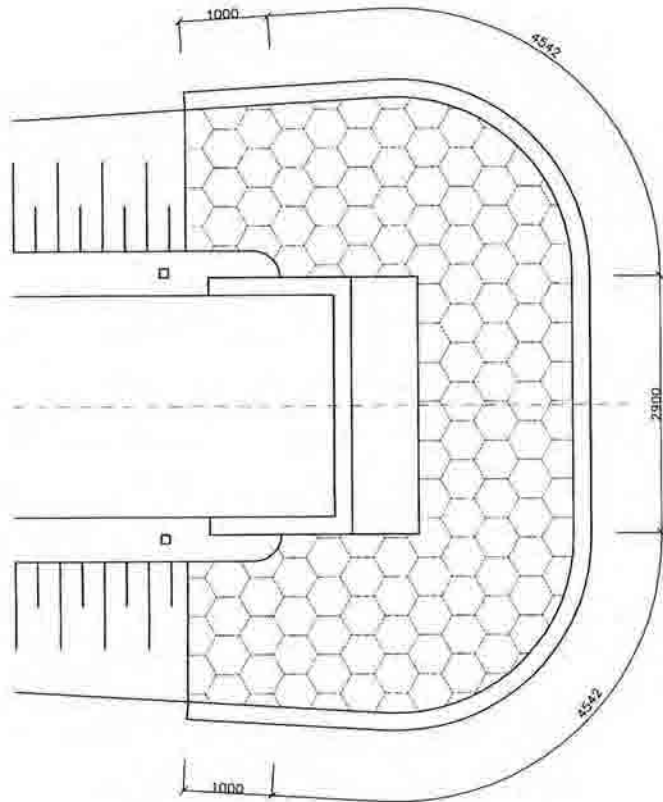
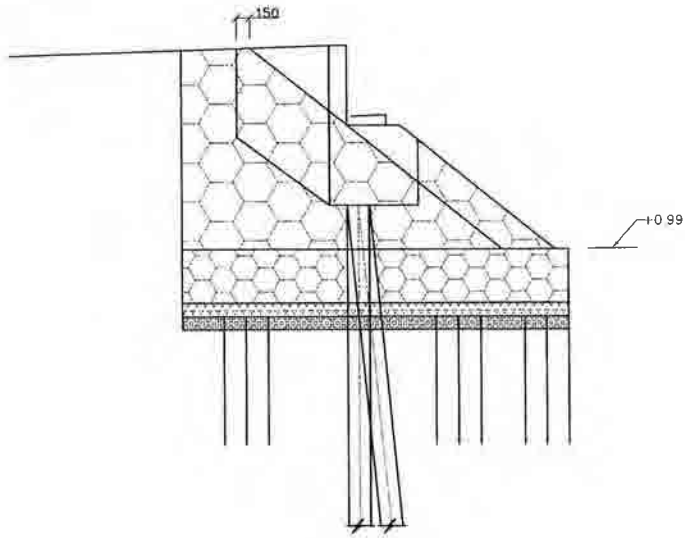

R-B05 Bridge Approach I-Type
橋梁取り付け部 構造図

A-5-16

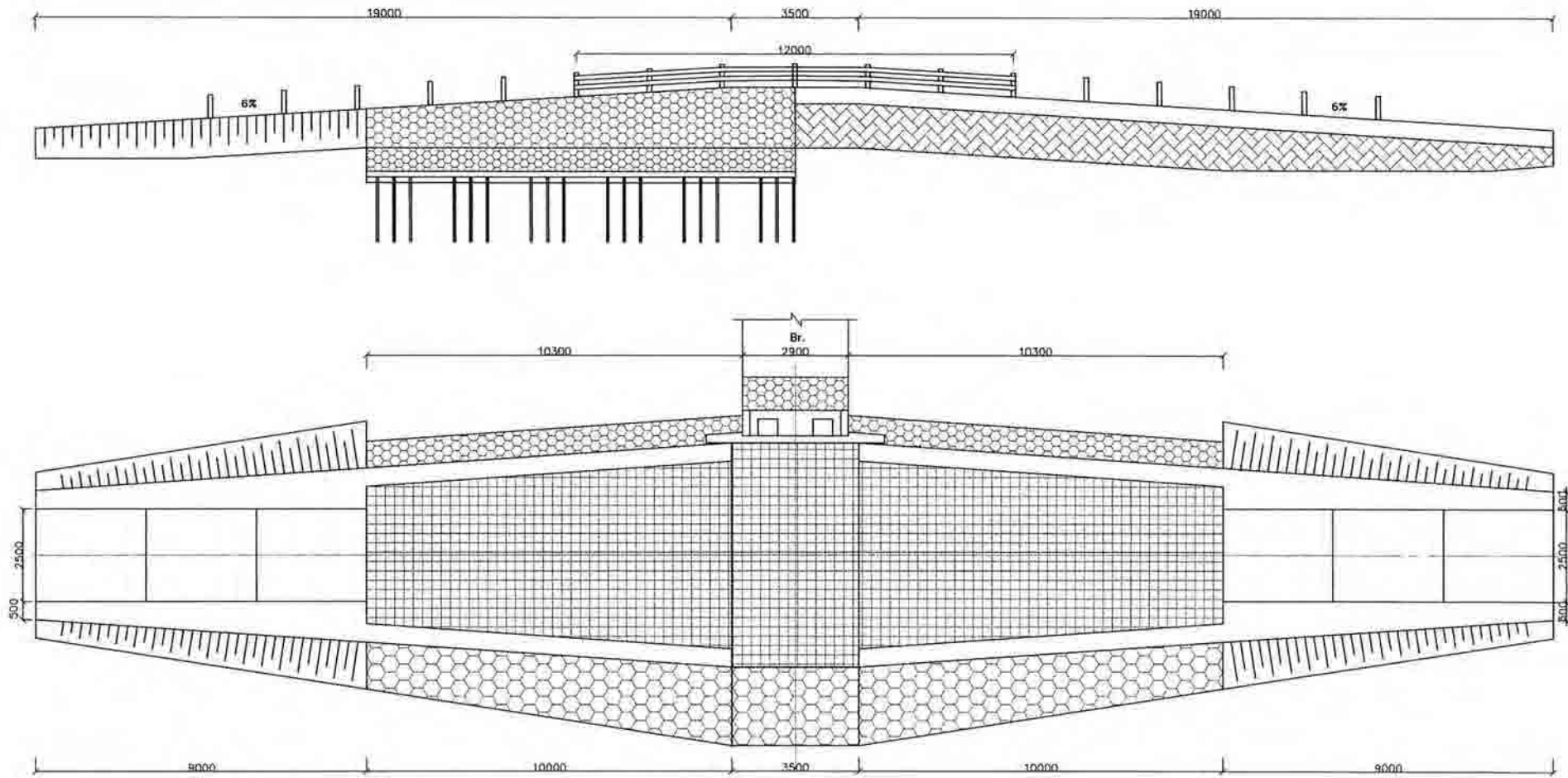

R-B06 Bridge Approach T-Type
橋梁取り付け部 Tタイプ 一般 縦断、平面図

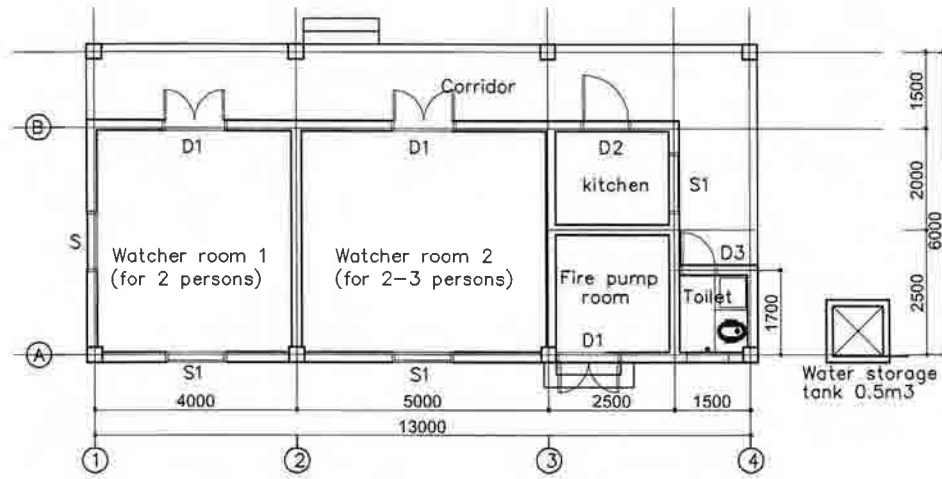

plan

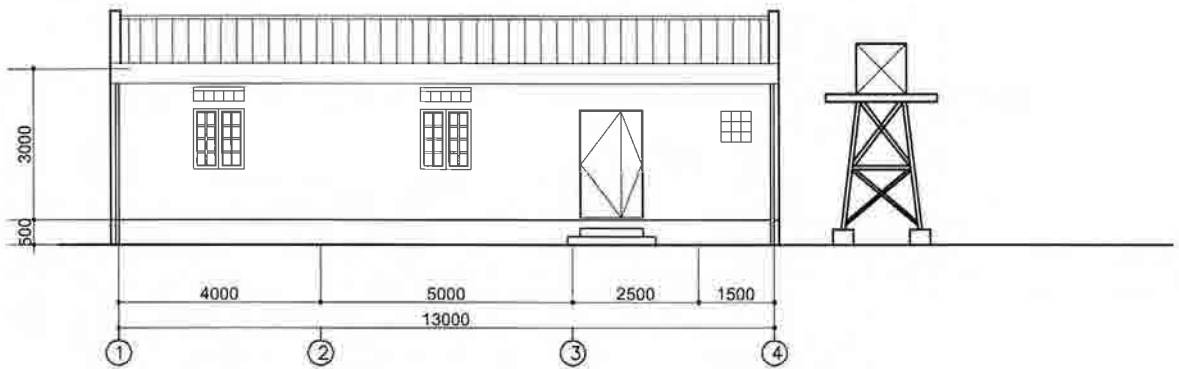

FRONT VIEW

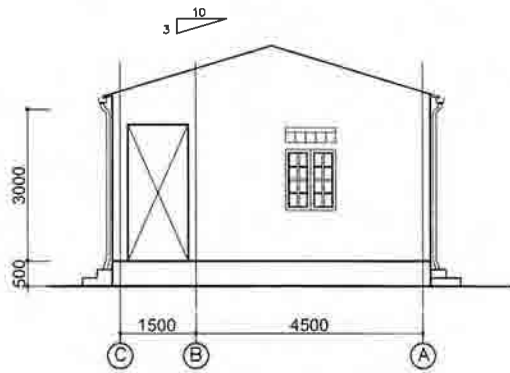

SIDE VIEW

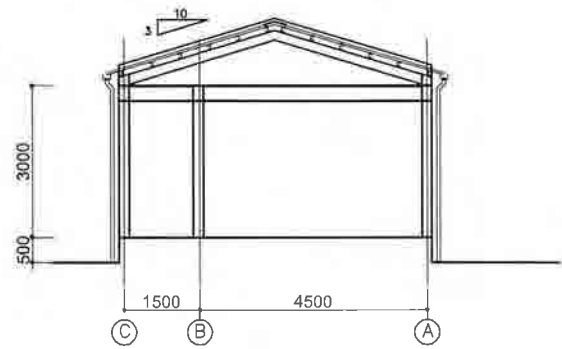

SECTION

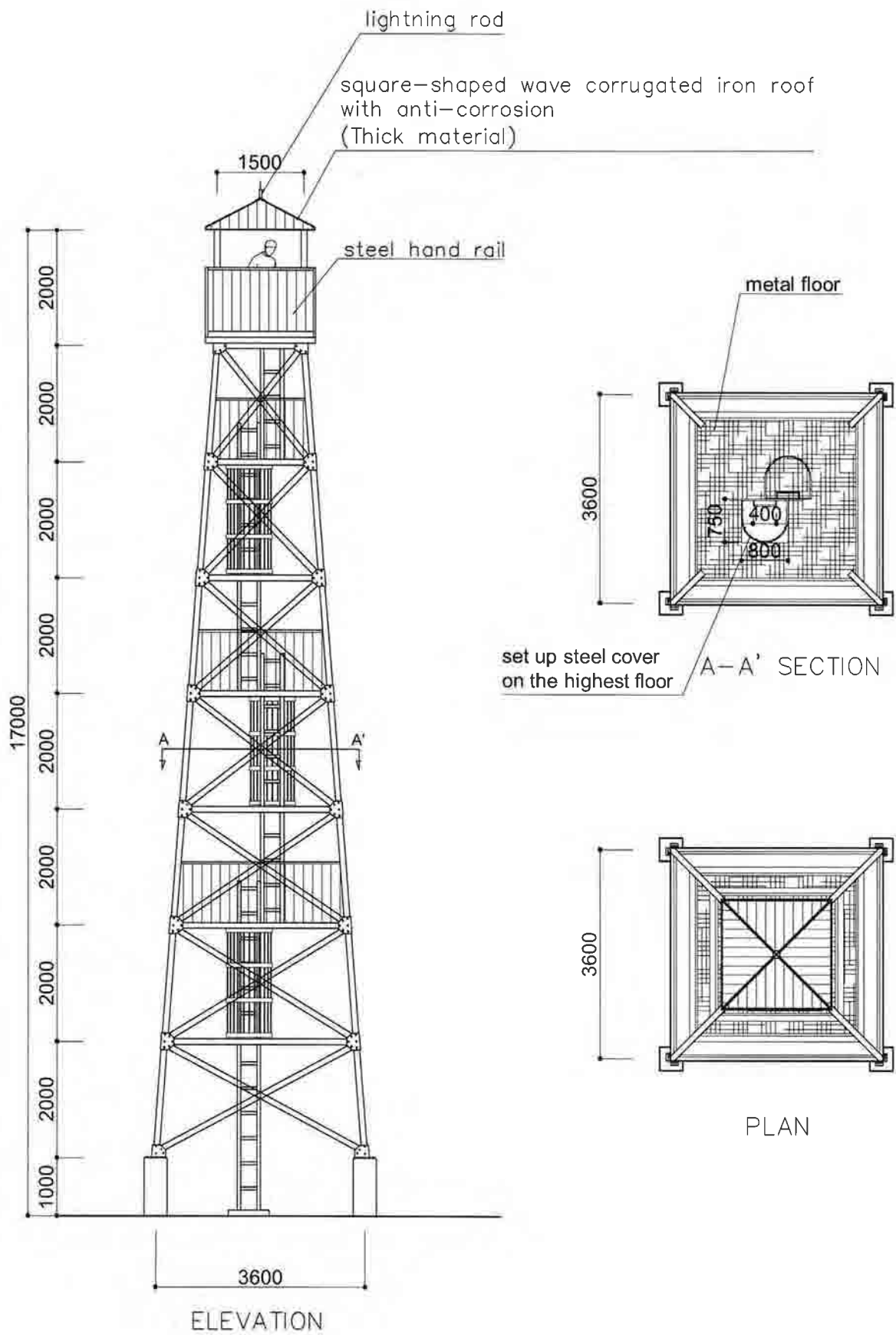

A-F02 Fire Watch Tower
森林火災監視タワー

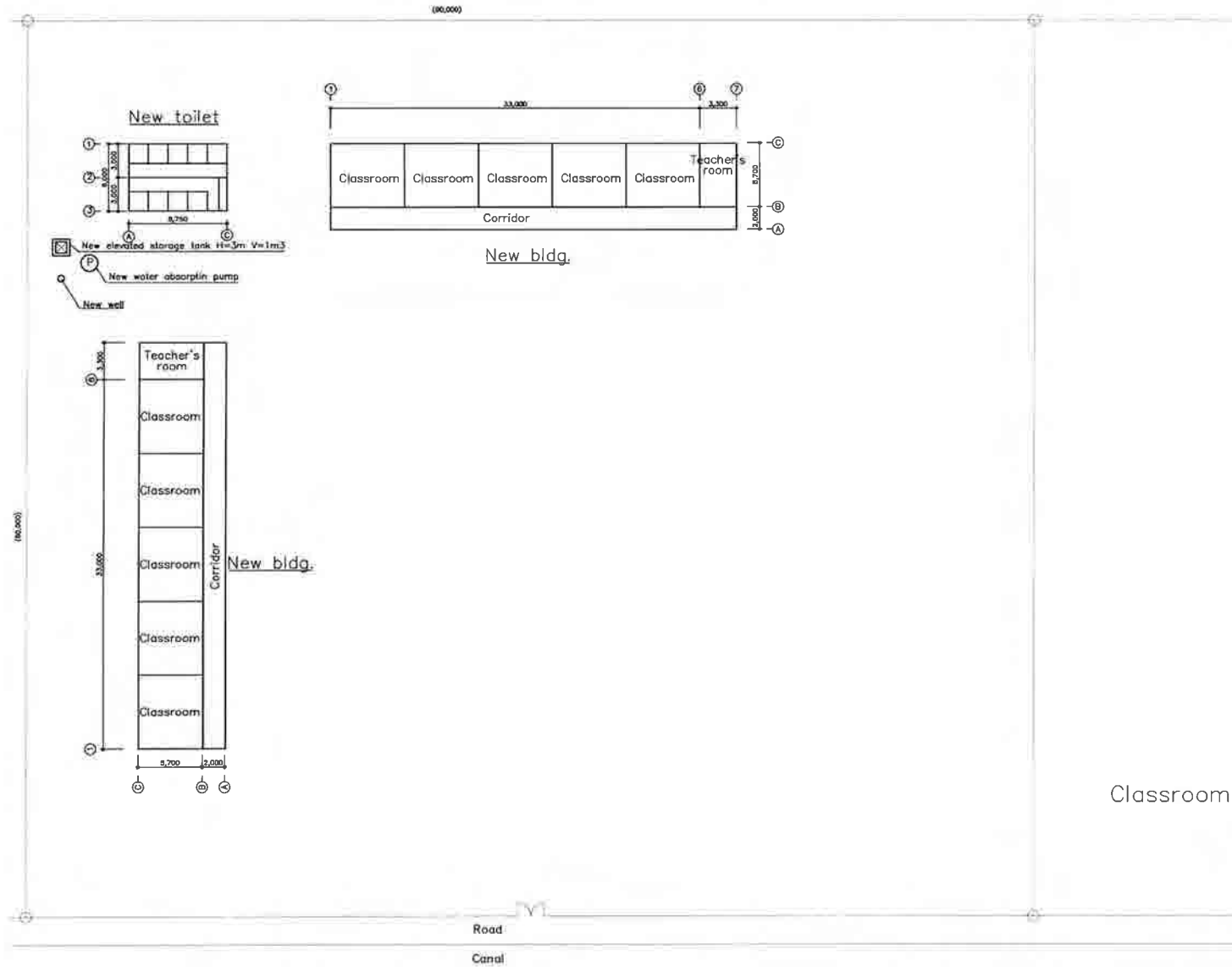

FLOOR AREA
 Classroom & Teacher's room: 559.0m²
 Toilet: 52.5m²

 611.5m²

A-S01 Lam Ngu Truong I Primary School
 (5Classrooms+1Teacher's room) x2bldgs., Toilet 10booths
 MASTER PLAN
 ラムグチュオンI小学校全体計画

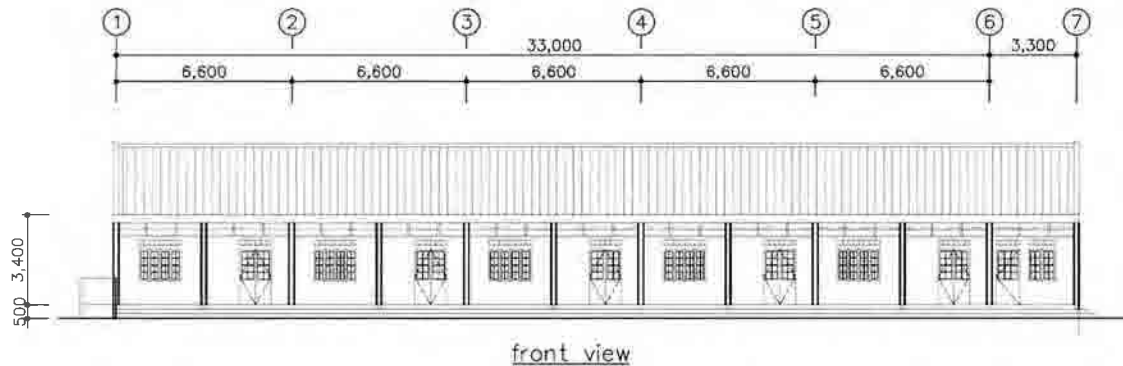

front view

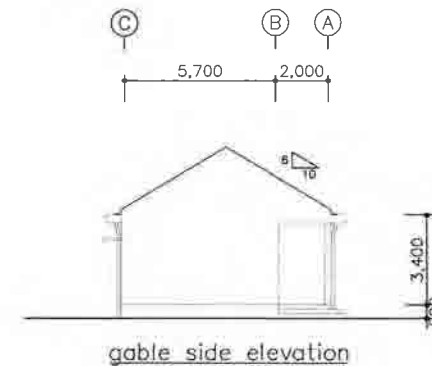

gable side elevation

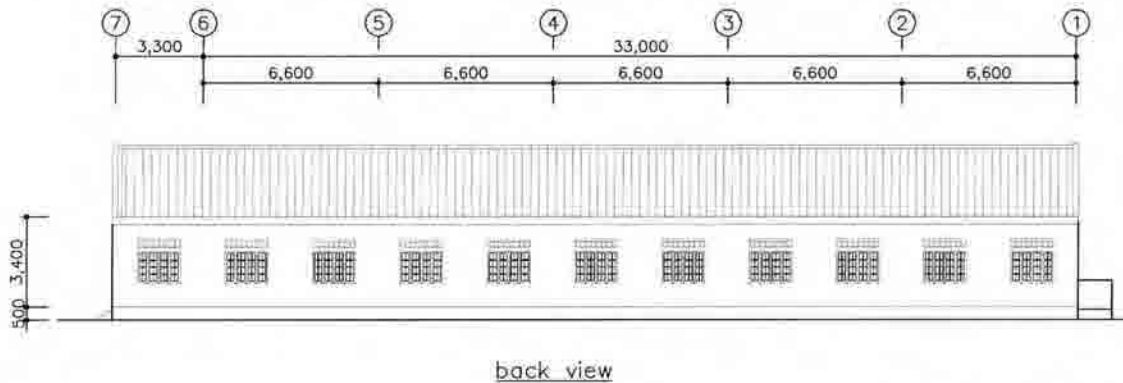

back view

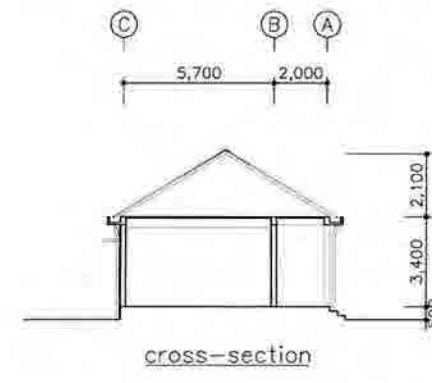

cross-section

A-5-20

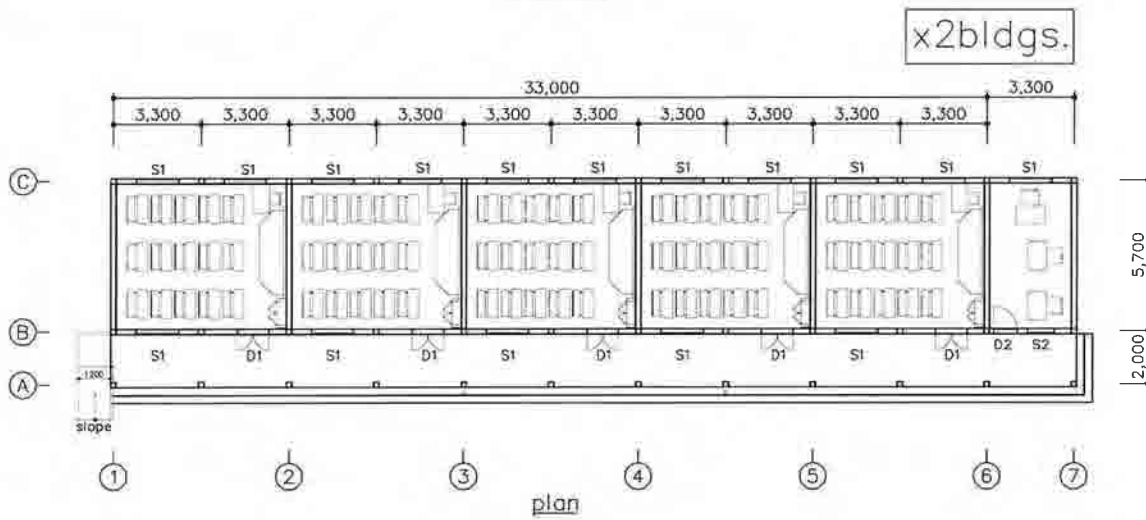

plan

A-S02 Lam Ngu Truong Primary School
 (5Classrooms+1Teacher's room) x2bldgs.
 ラムグチュオン1小学校2校舎

FLOOR AREA
52.5m²

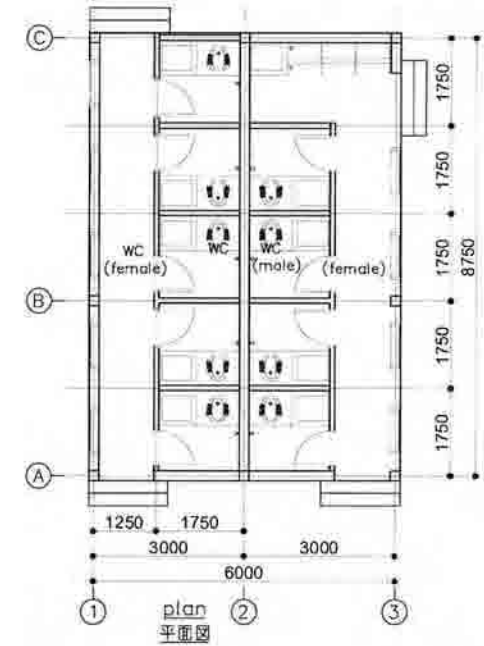
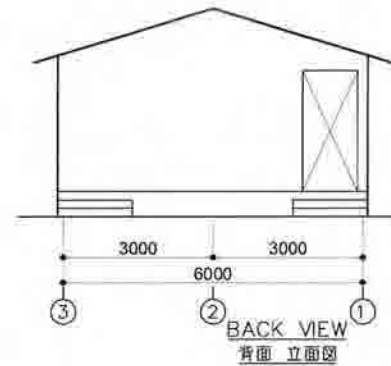
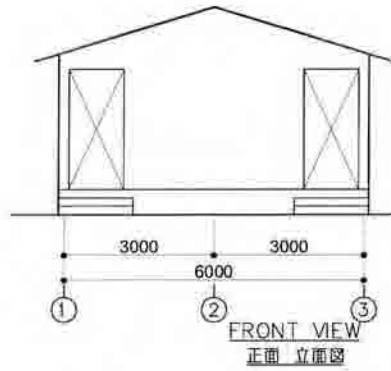
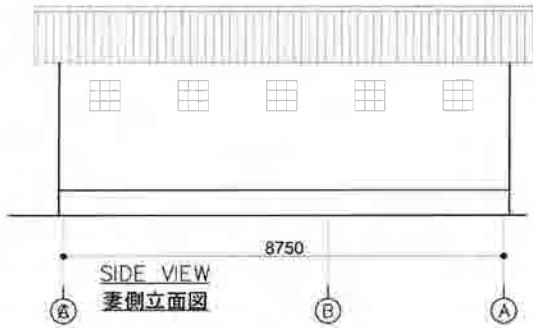
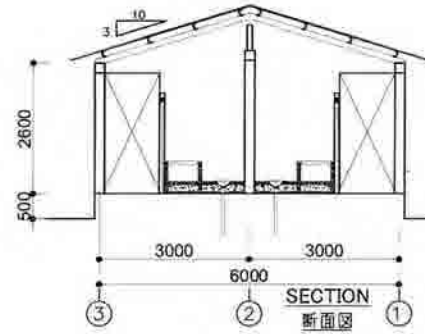
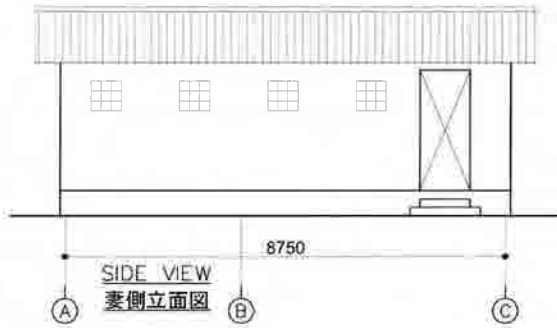

A-S03 Lam Ngu Truong Primary School Toilet
ラムグチュオンI小学校トイレ

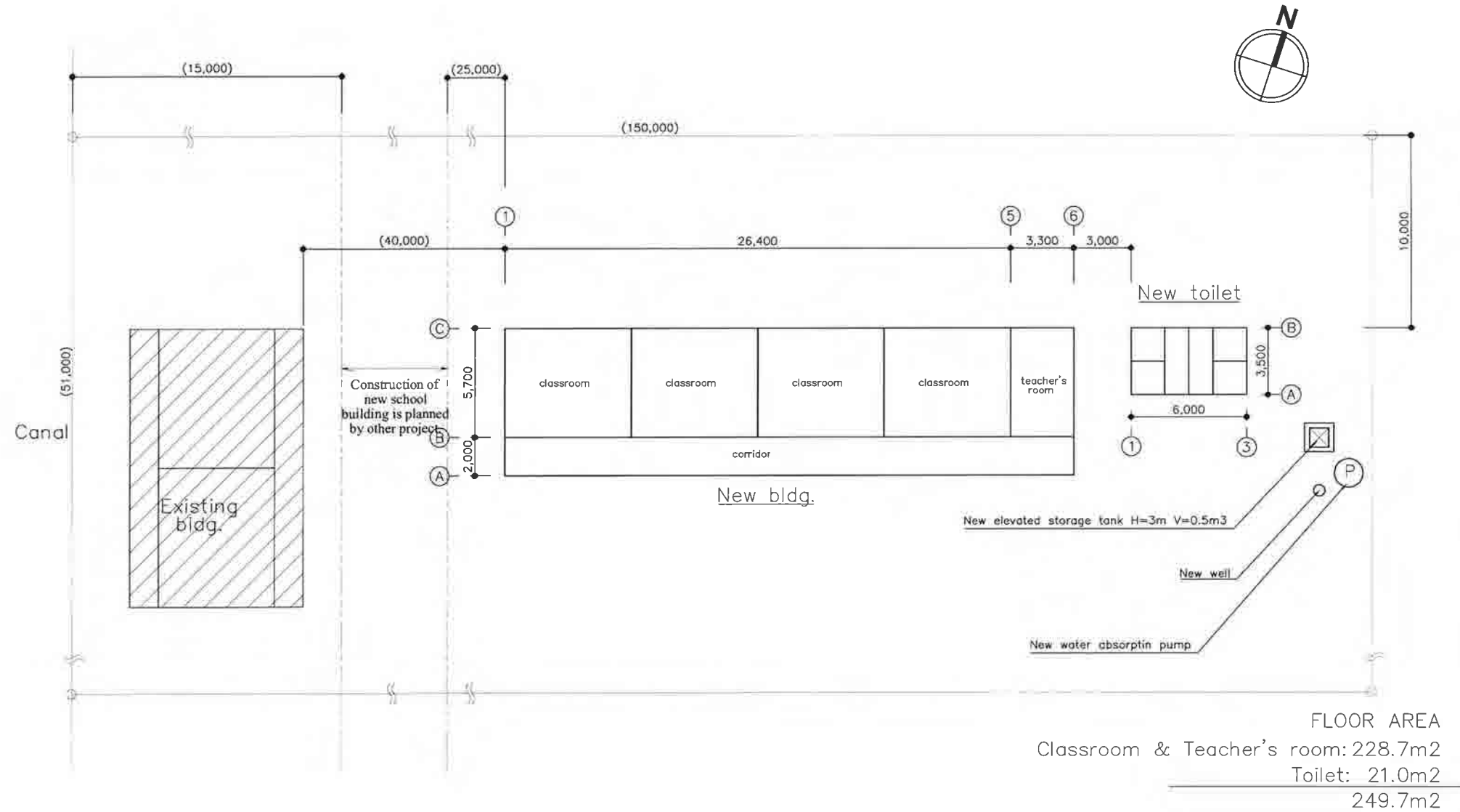

A-S04 Lam Ngu Truong II Primary School-Branch1
 4Classrooms+1Teacher's room, Toilet 4booths
MASTER PLAN
 ラムグチュオンII小学校分校1全体計画

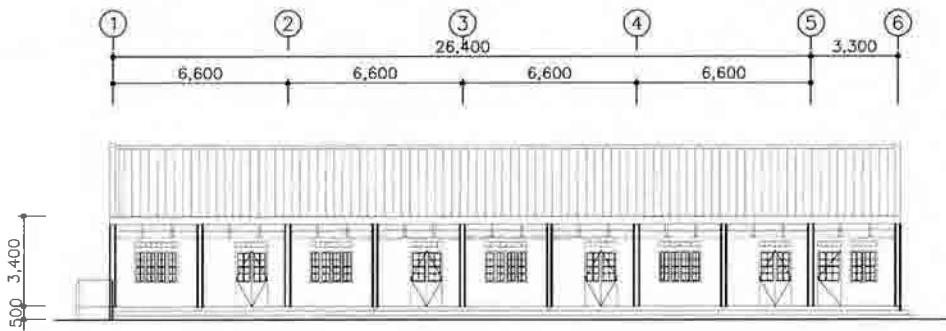

front view

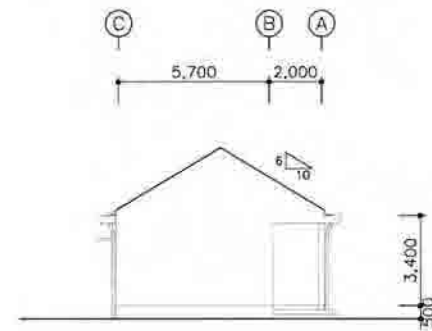

gable side elevation

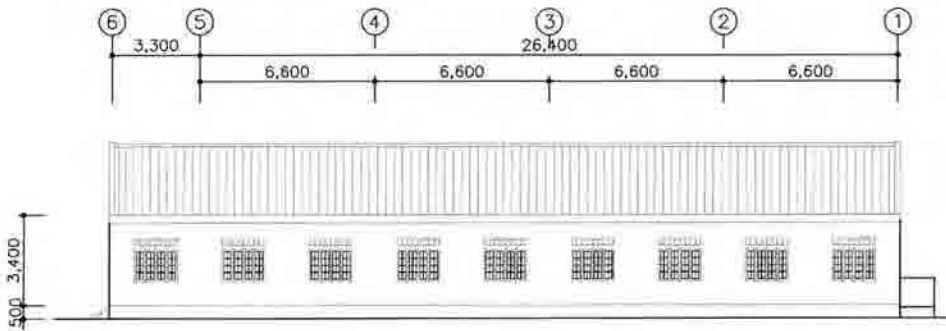

back view

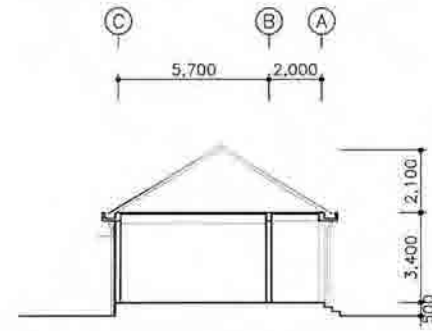

cross-section

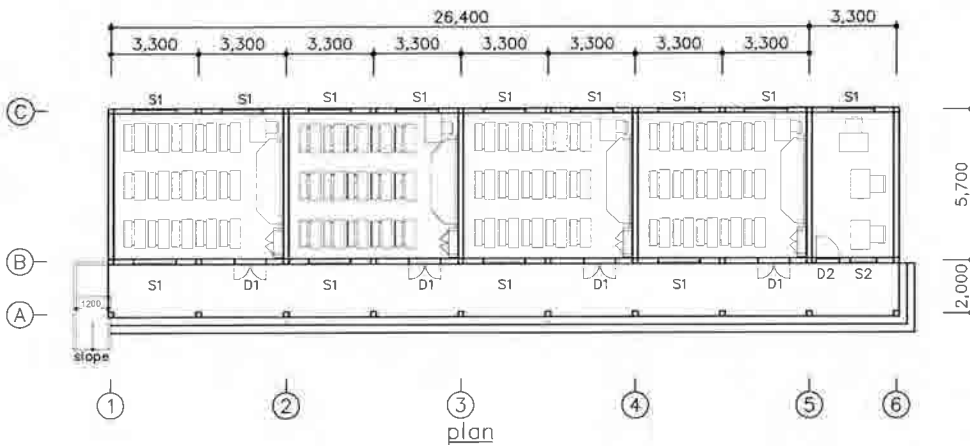

plan

A-S05 Lam Ngu Trung Minh2 Primary School-Branch1
 4Classrooms+1Teacher's room
 ラムグチュオンII小学校分校1,4教室+1教員室

FLOOR AREA
21.0m²

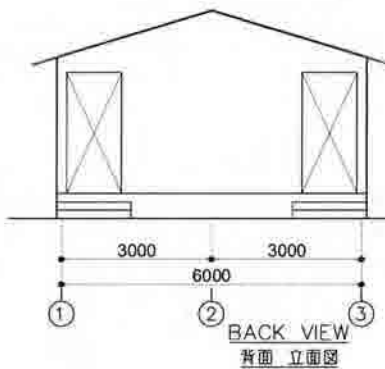
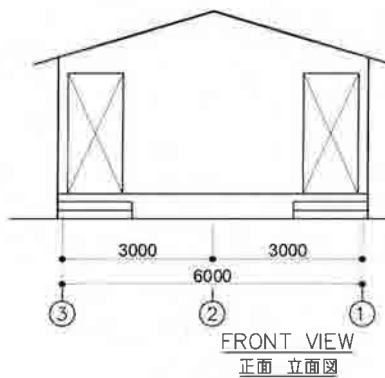
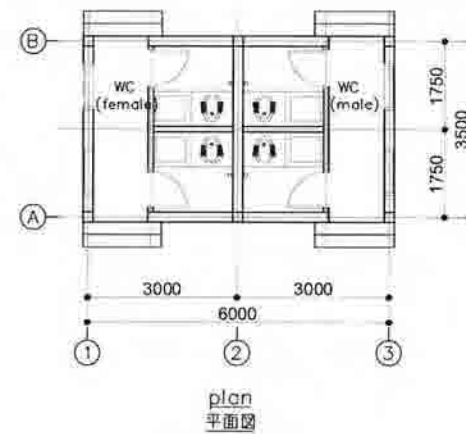
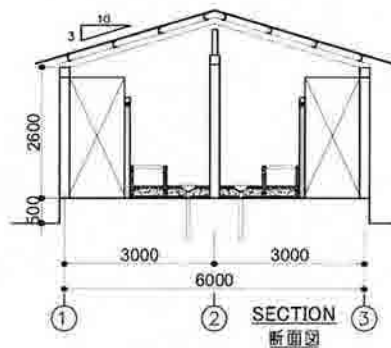
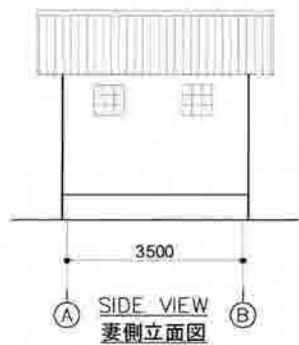

A-5-24

A-S06 Lam Ngu Truong Minh2 Primary
School-Branch1 Toilet
ラムグチュオンII小学校分校1トイレ

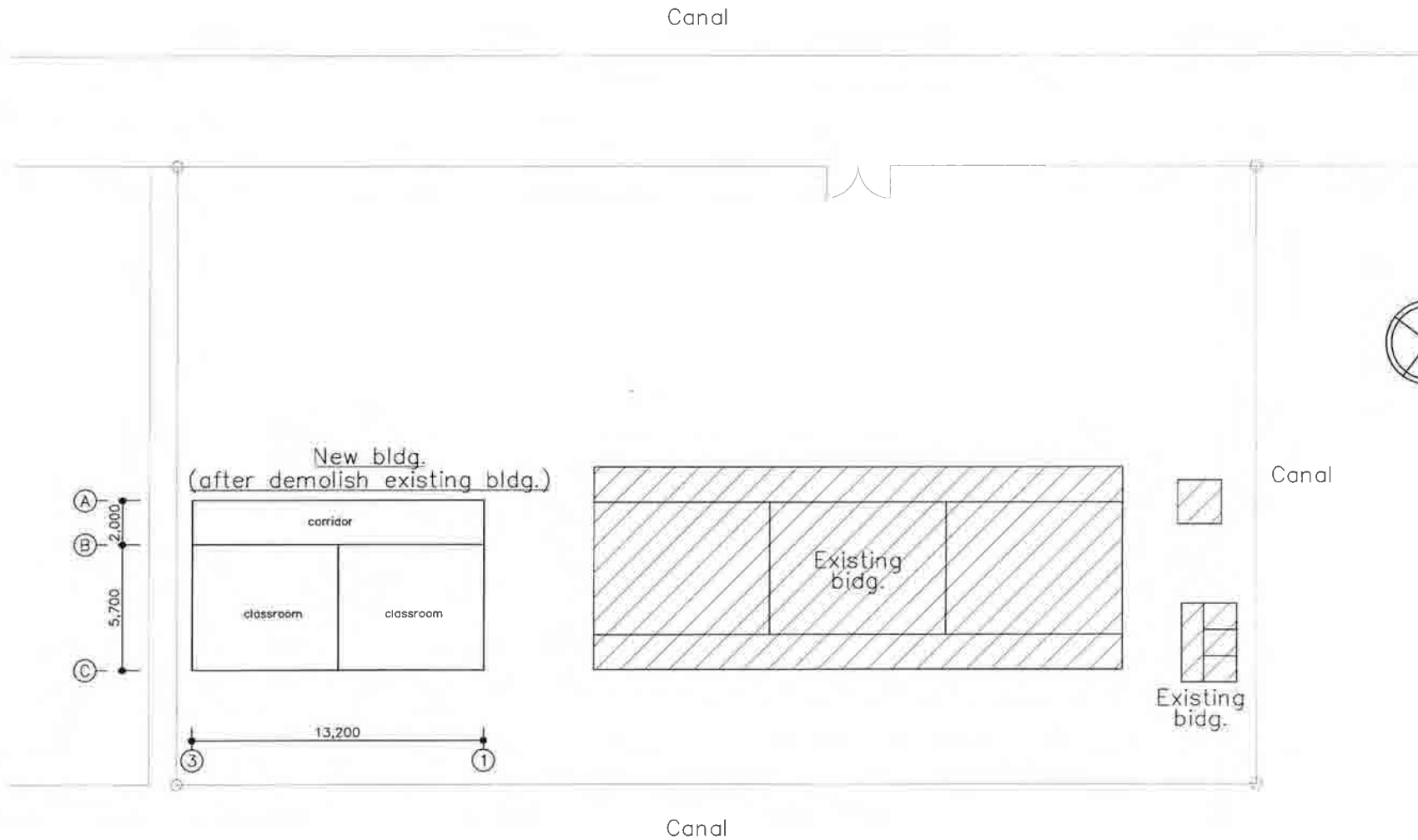

FLOOR AREA
Classroom: 101.6m²
101.6m²

A-S07 Lam Ngu Truong II Primary School-Branch2
2Classrooms, Toilet 2booths
MASTER PLAN
ラムグチュオンII小学校分校2全体計画

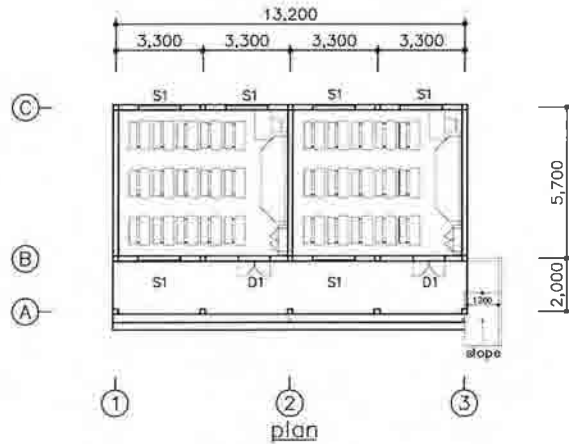
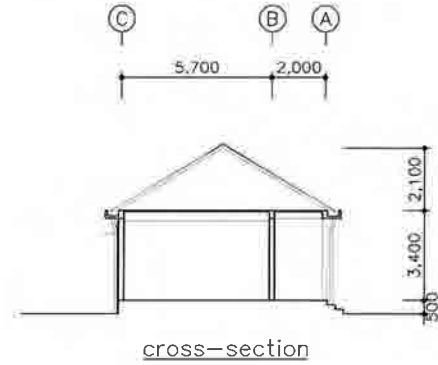
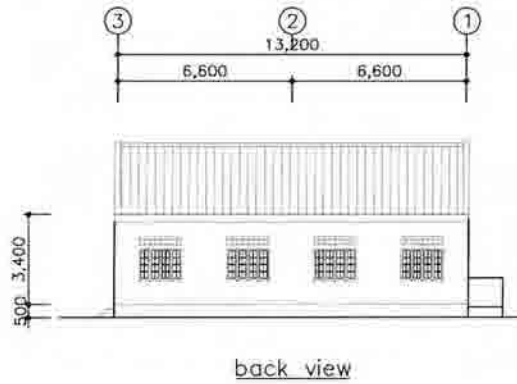
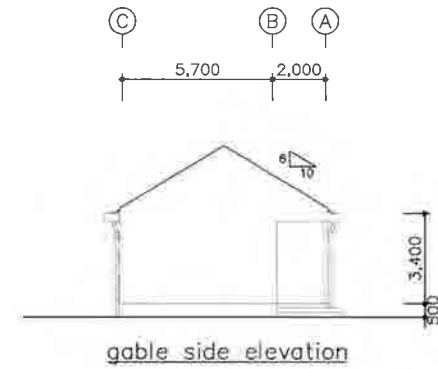
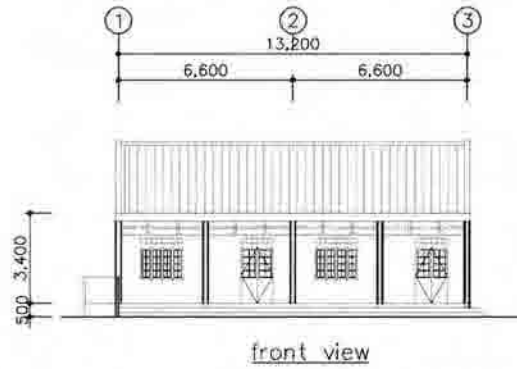

A-5-26

A-S08 Lam Ngu Truong Minh2 Primary School-Branch2
 2Classrooms
 ラムグチュオンII小学校分校2、2教室

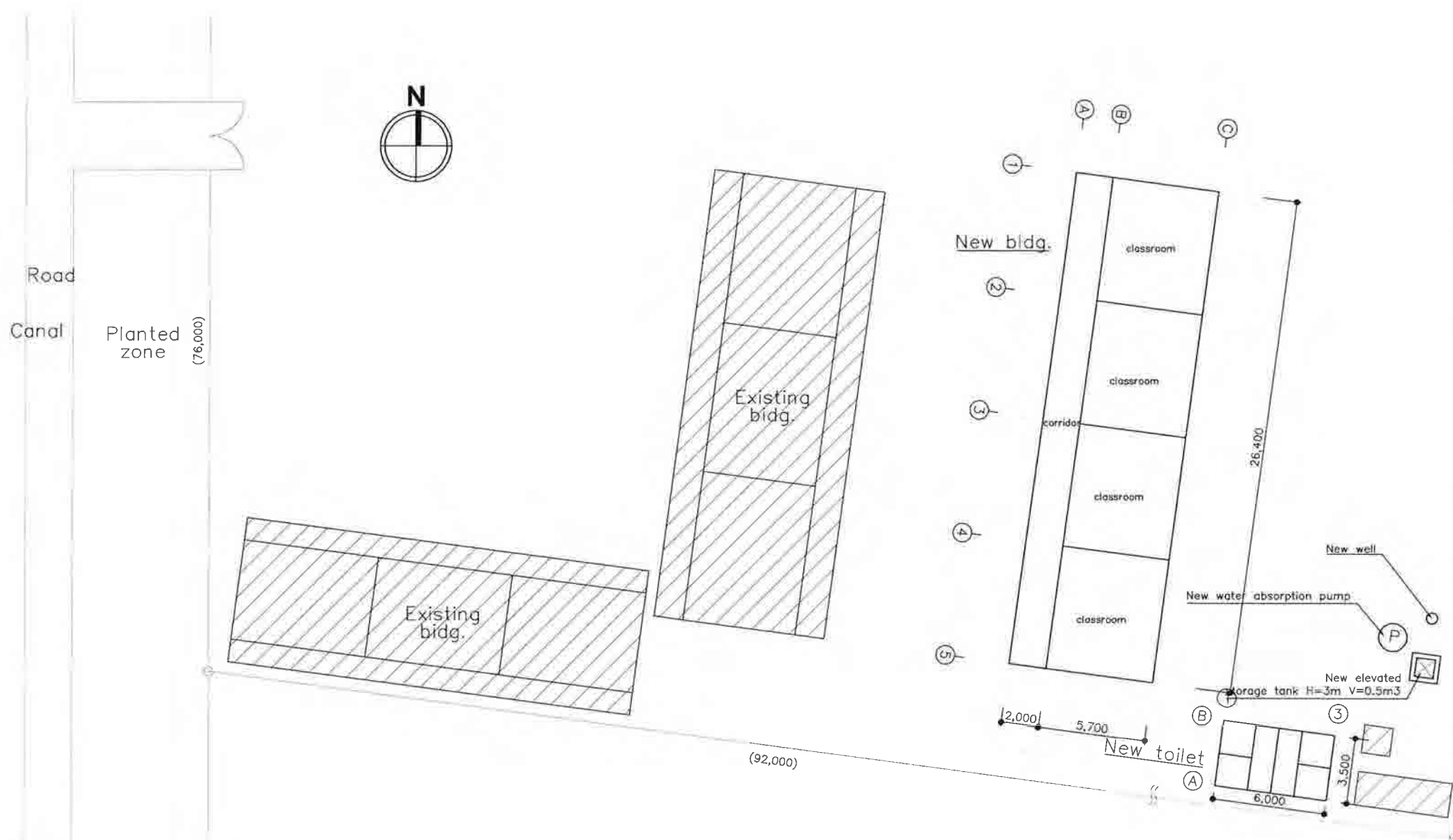

FLOOR AREA
 Classroom: 203.3m²
 Toilet: 21.0m²

 224.3m²

A-S09 Khanh Binh Tay Bac II Primary School
 4Classrooms, Toilet 4booths
MASTER PLAN
 カンビンタイバックII小学校全体計画

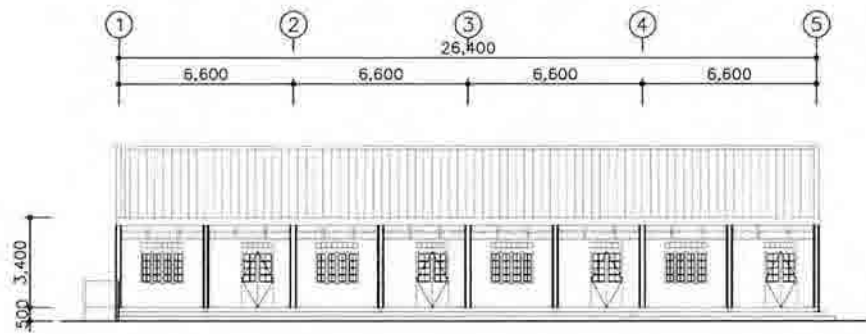

front view

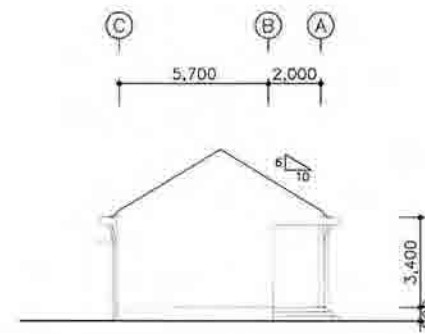

gable side elevation

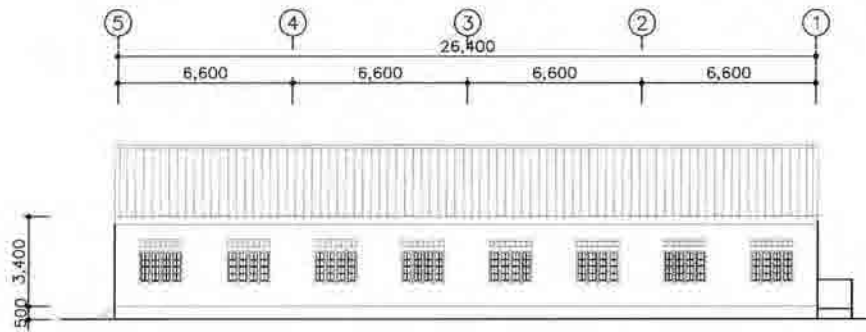

back view

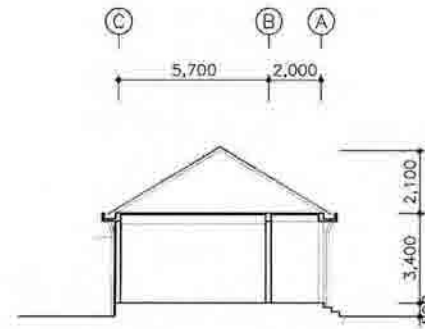

cross-section

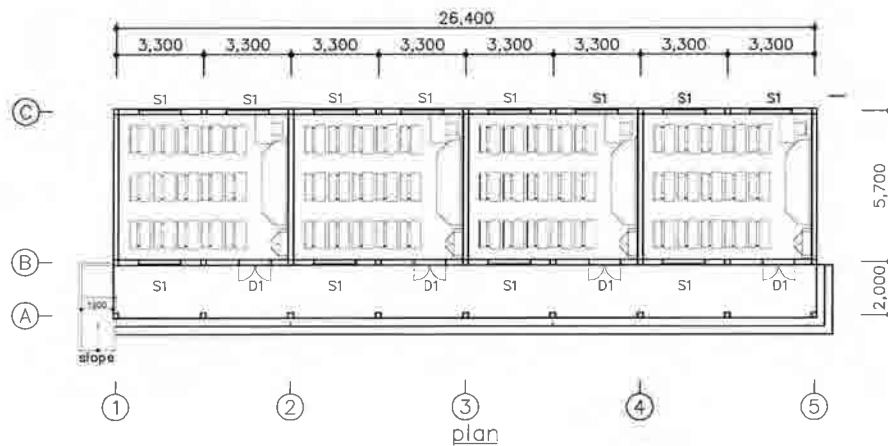

plan

A-S10 Khanh Binh Tay Bac2 Primary School
 4Classrooms
 カンビンタイバックII小学校4教室

FLOOR AREA
21.0m²

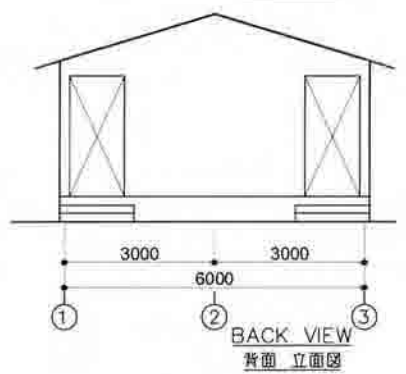
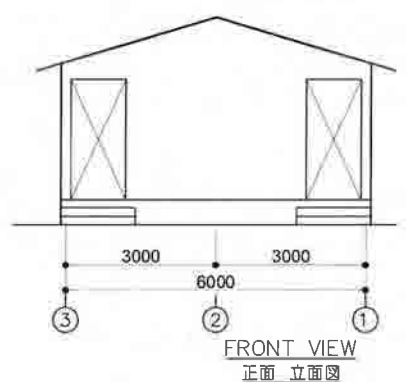
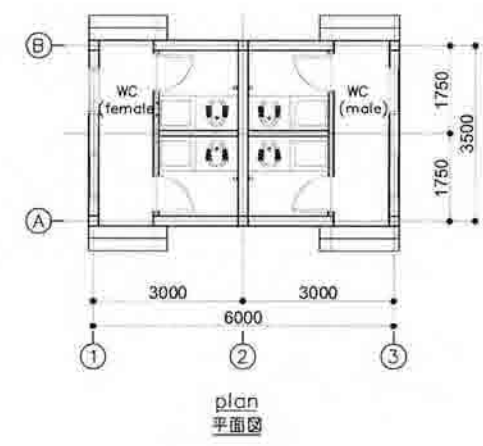
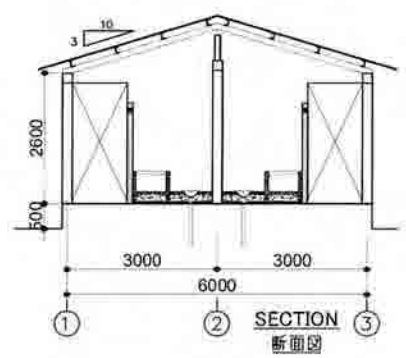
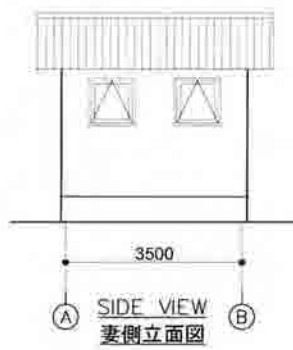

A-5-29

A-S11 Khanh Binh Tay Bac2 Primary School Toilet
カンビンタイバックII小学校トイレ

A-5-30

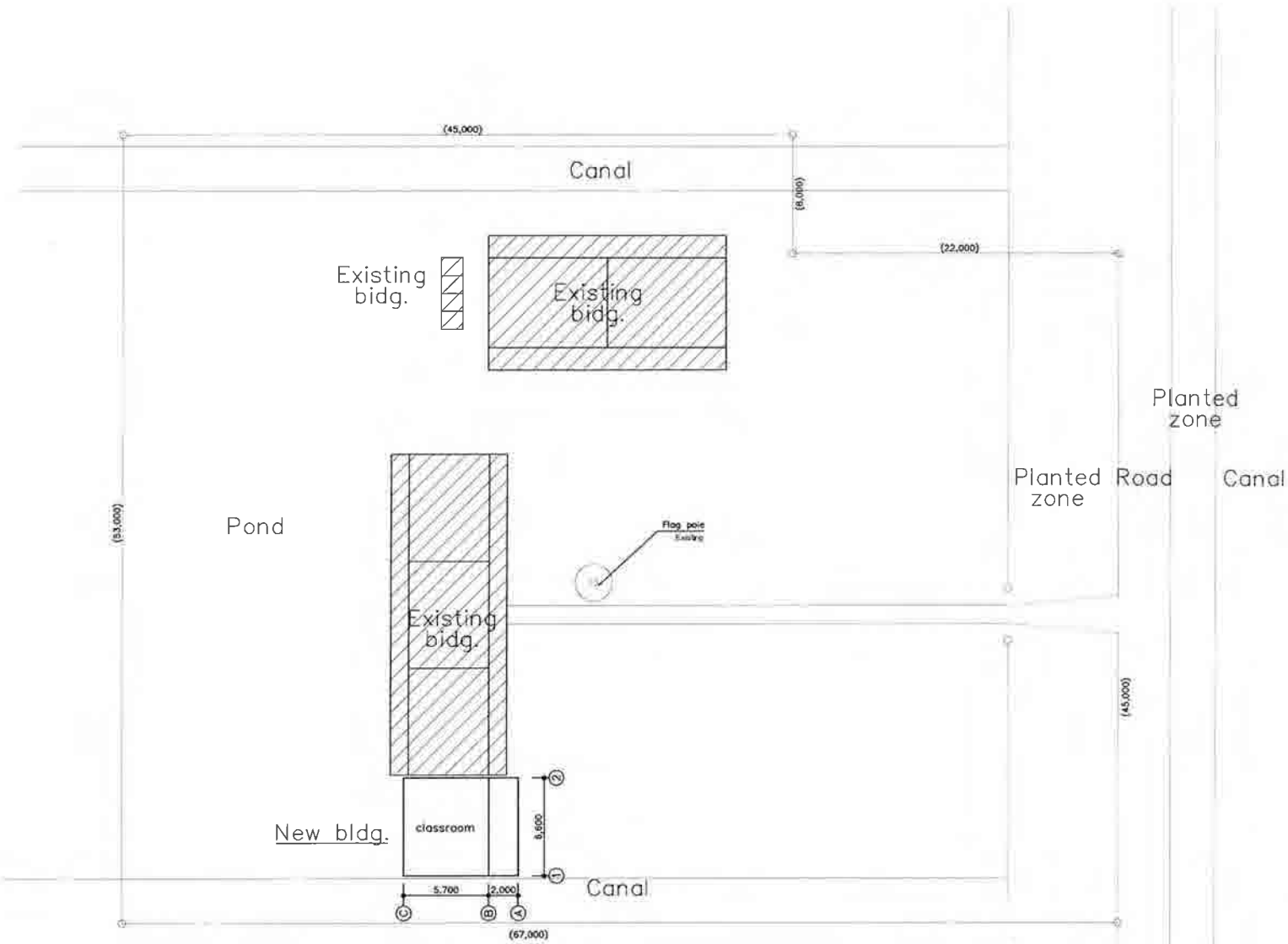

FLOOR AREA
Classroom: 50.8m²
50.8m²

A-S12 U Minh III Primary School 1 Classroom
MASTER PLAN
ウミンIII小学校全体計画

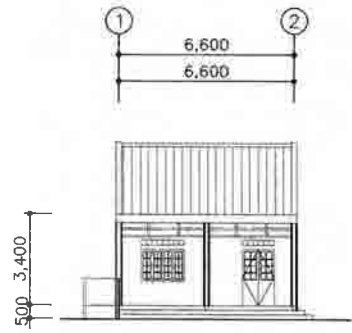

front view

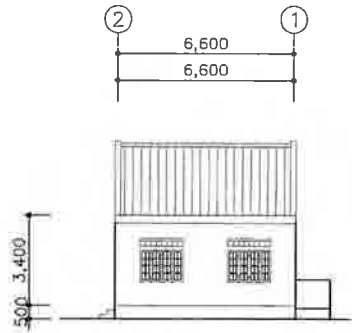

back view

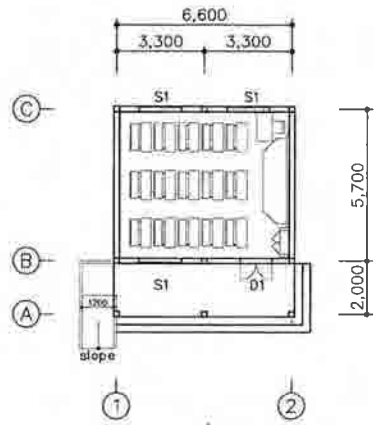

plan

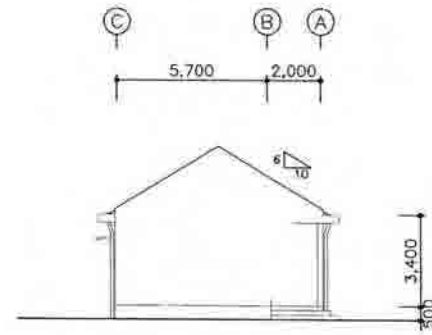

gable side elevation

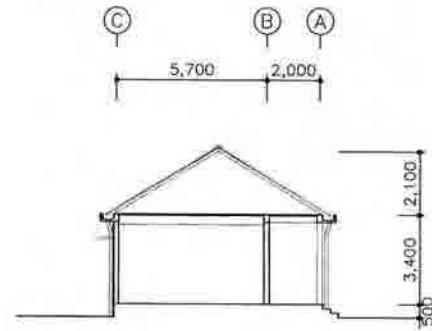

cross-section

A-5-31

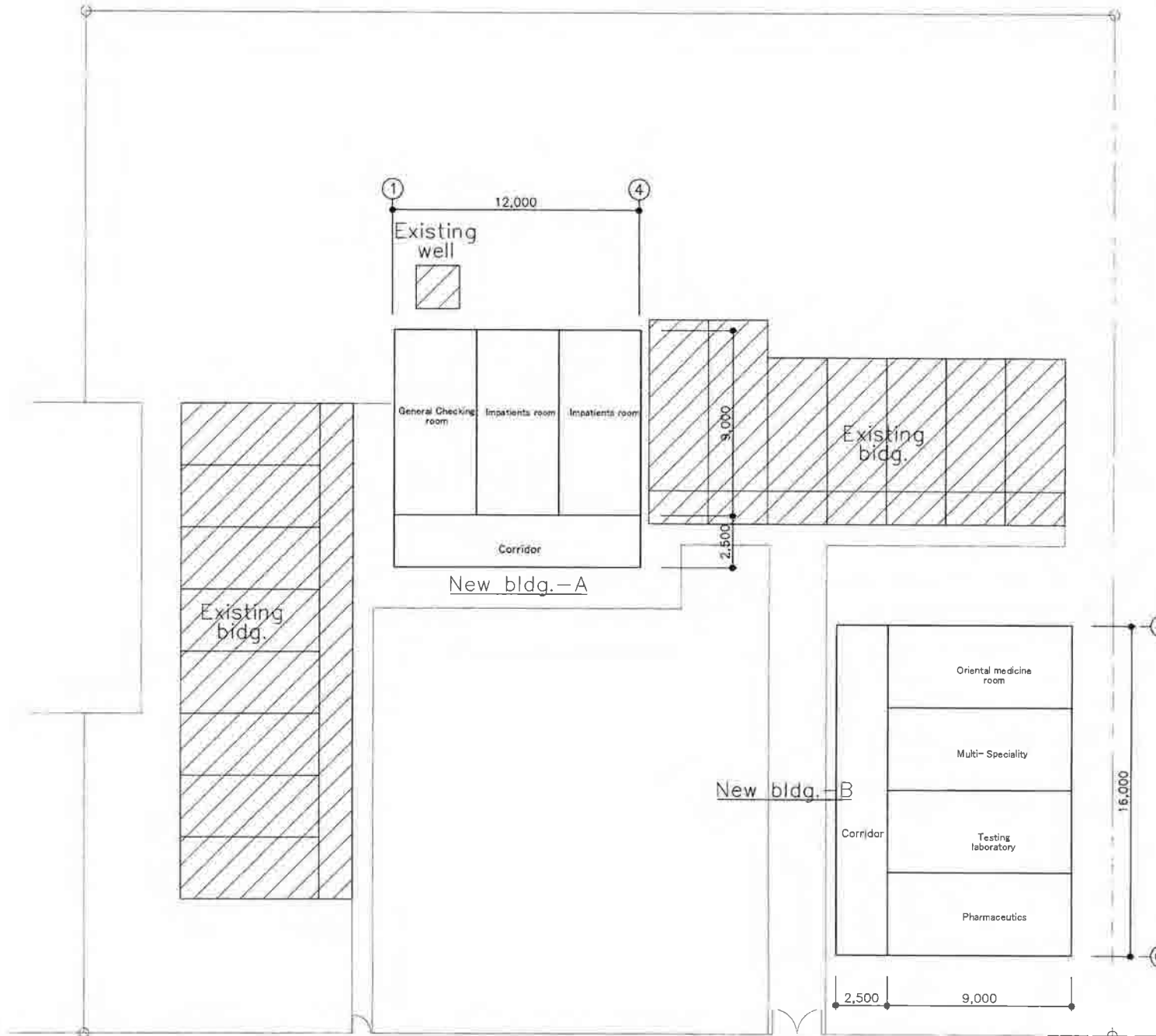

FLOOR AREA A: 138.0m²
FLOOR AREA B: 184.0m²
322.0m²

Road

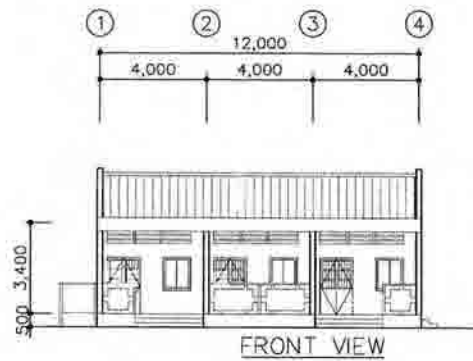

FRONT VIEW

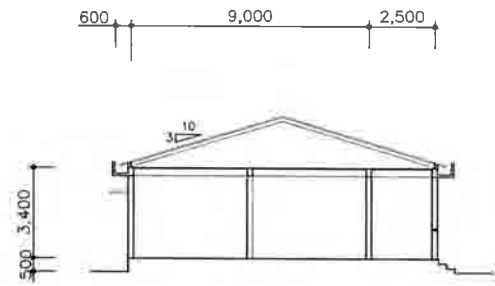

SECTION

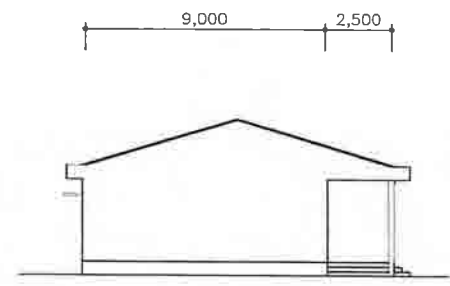

SIDE VIEW

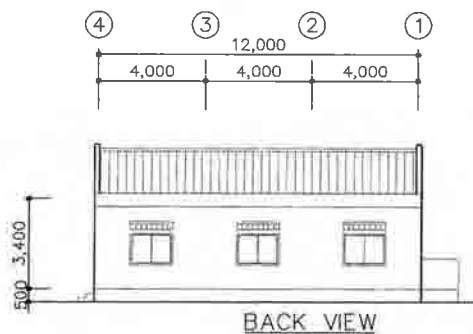

BACK VIEW

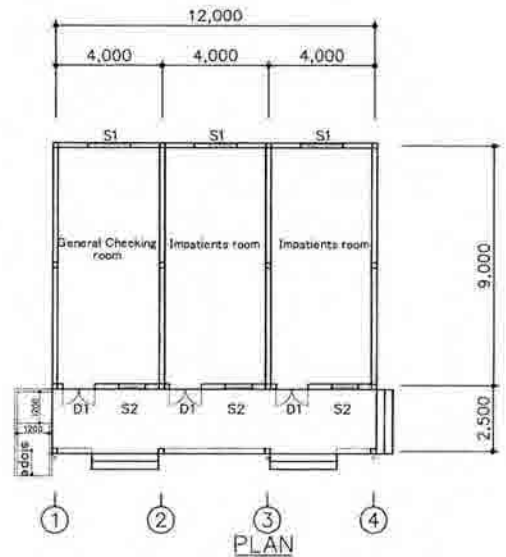

PLAN

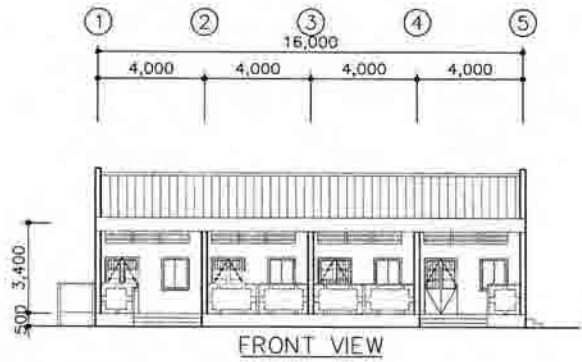

FRONT VIEW

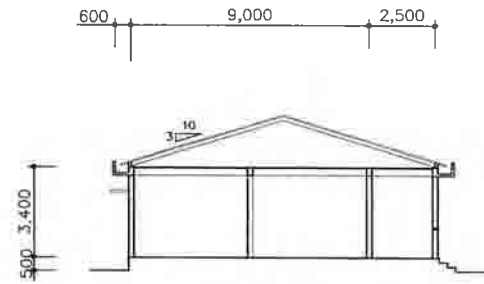

SECTION

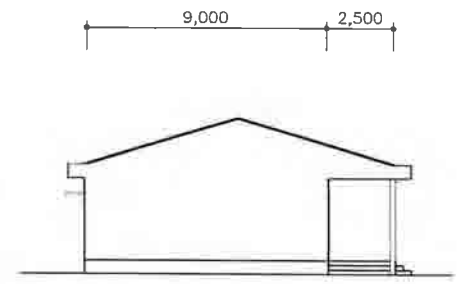

SIDE VIEW

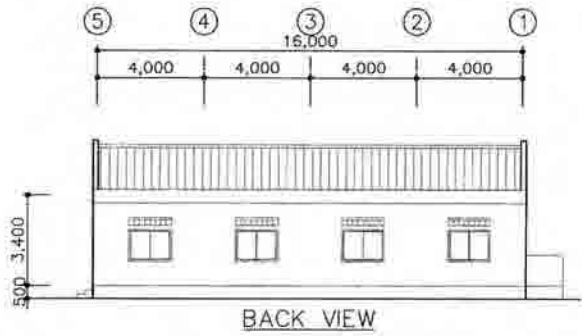

BACK VIEW

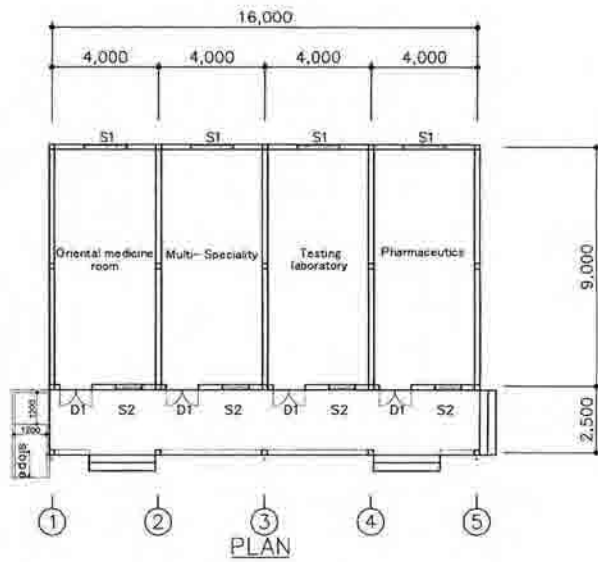

PLAN

A-H03 Khanh An General Clinic-Bldg.-B 4 Rooms
カンアンゼネラルクリニックB病棟4室

A-5-35

(43,000)

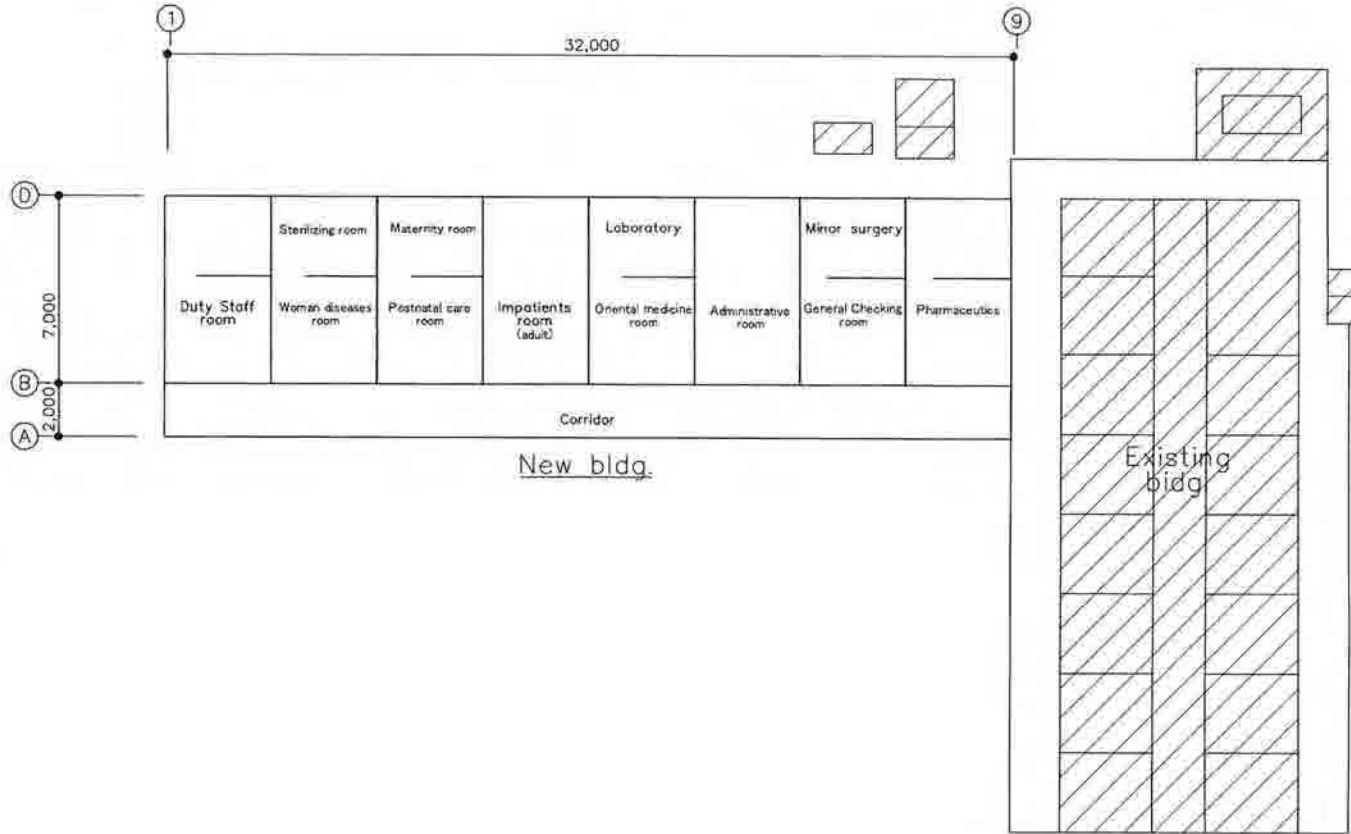

32,000

7,000

12,000

Sterilizing room

Maternity room

Laboratory

Minor surgery

Duty Staff room

Woman diseases room

Postnatal care room

Impatients room (adult)

Oriental medicine room

Administrative room

General Checking room

Pharmaceutics

Corridor

New bldg.

Existing bldg.

FLOOR AREA 288.0m2

(66,000)

Bank(Road)

Canal

A-H04 Khanh Lam Health Center MASTER PLAN
カンラム保健センター全体計画

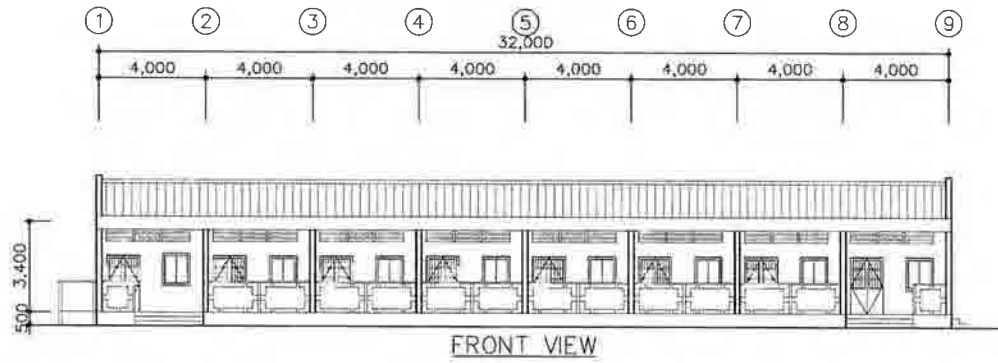

FRONT VIEW

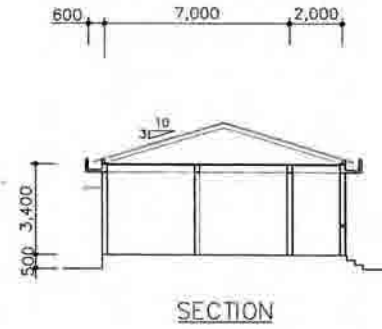

SECTION



SIDE VIEW

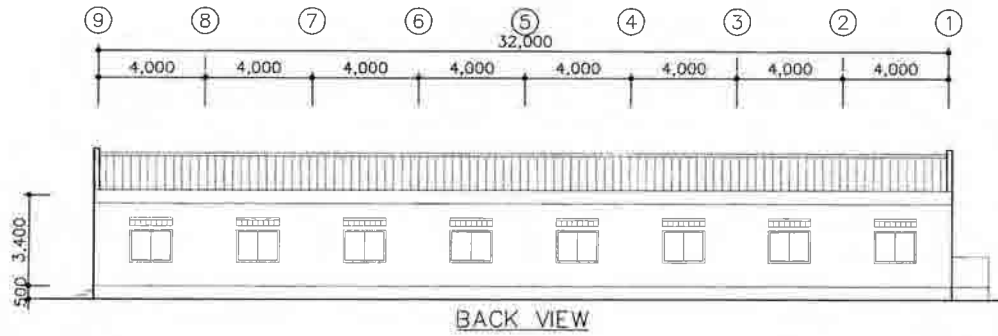

BACK VIEW

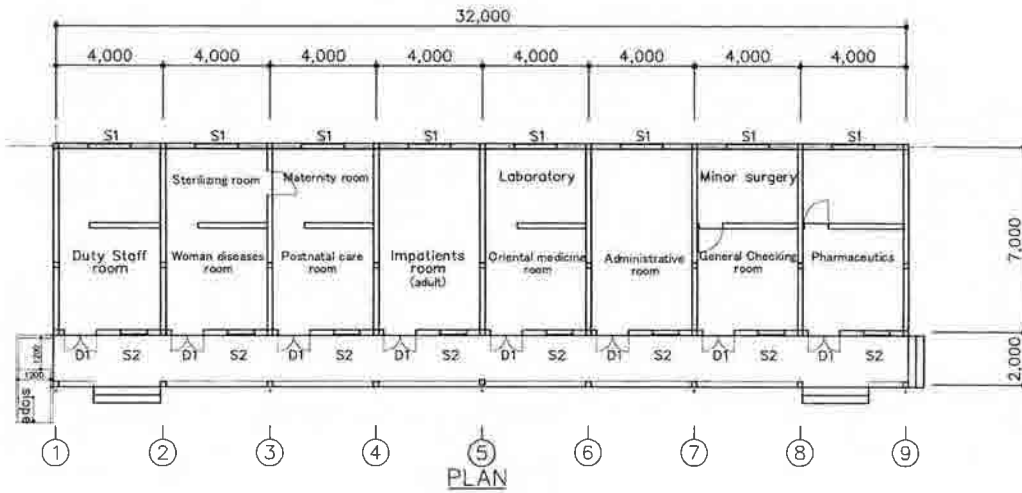

PLAN

A-H05 Khanh Lam Health Center 8 Rooms
カンラム保健センター8室

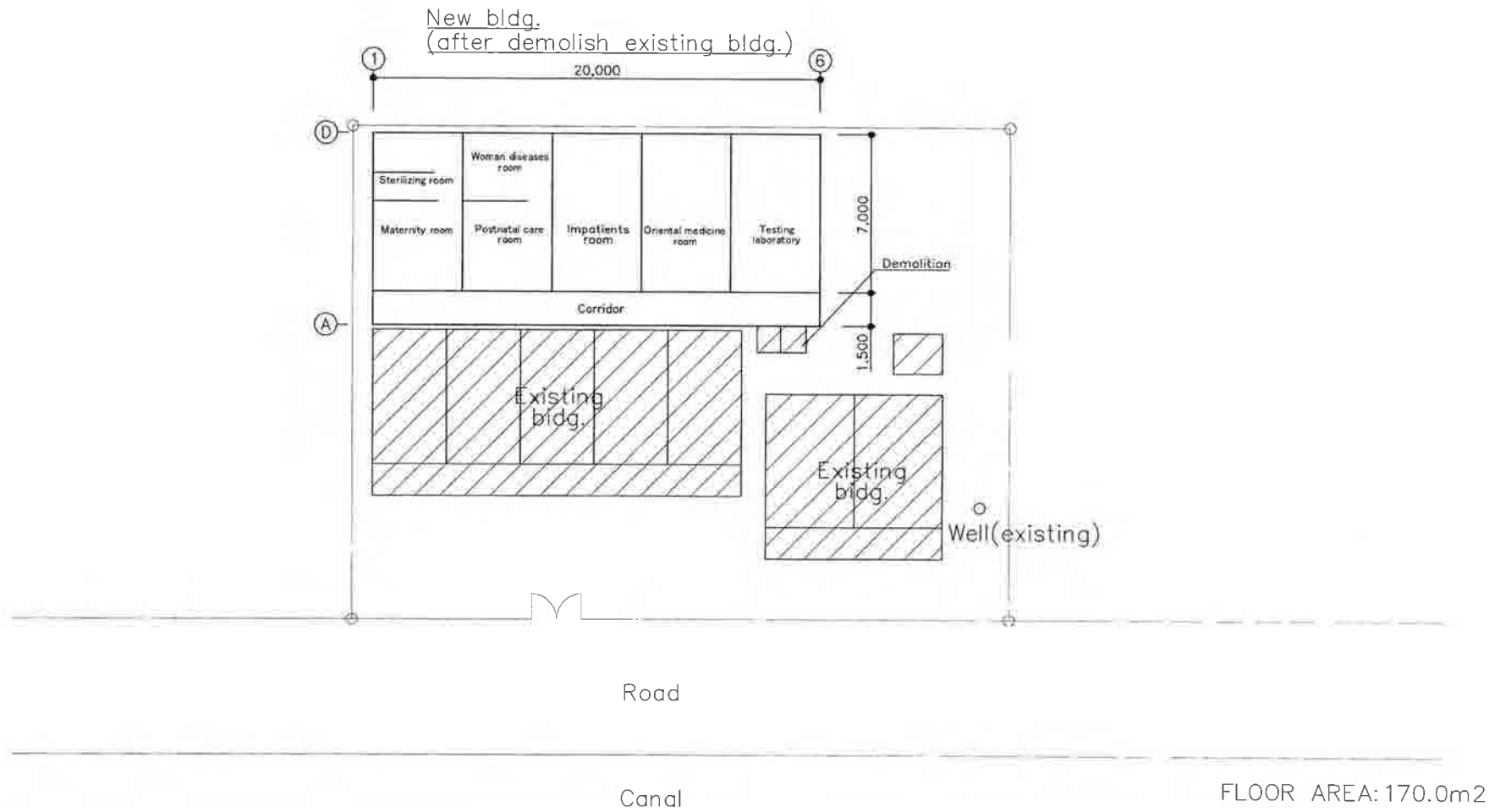

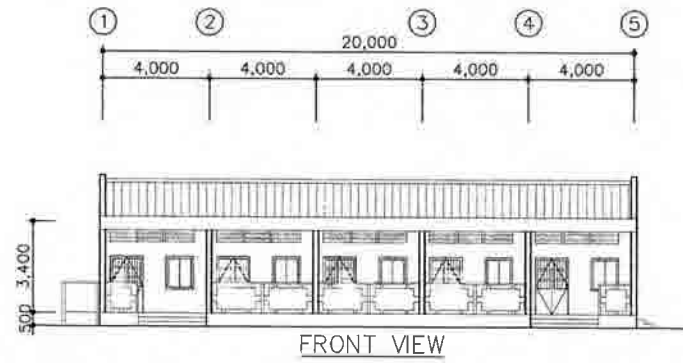

FRONT VIEW

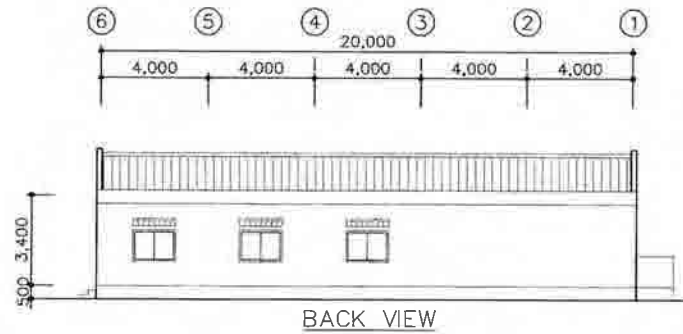

BACK VIEW

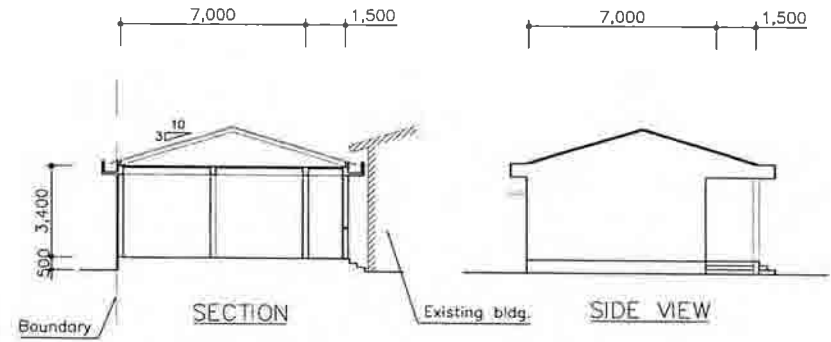

SECTION

SIDE VIEW

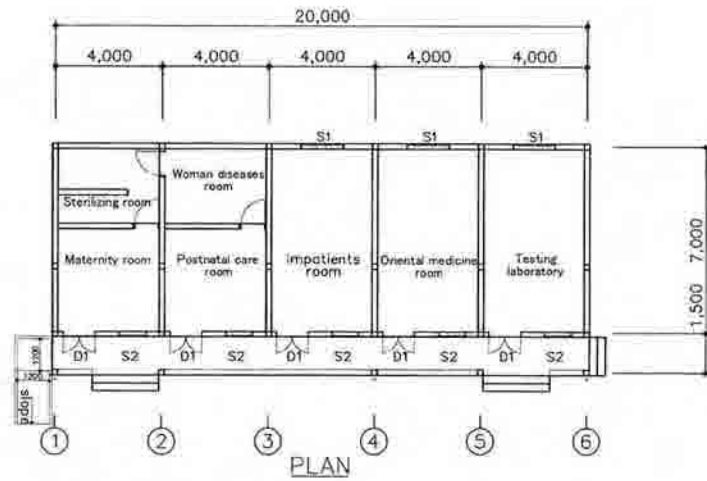

PLAN

A-H07 Khanh Tien Health Center 5 Rooms
カンティエン保健センター5室

New bldg.
(after demolish existing bldg.)

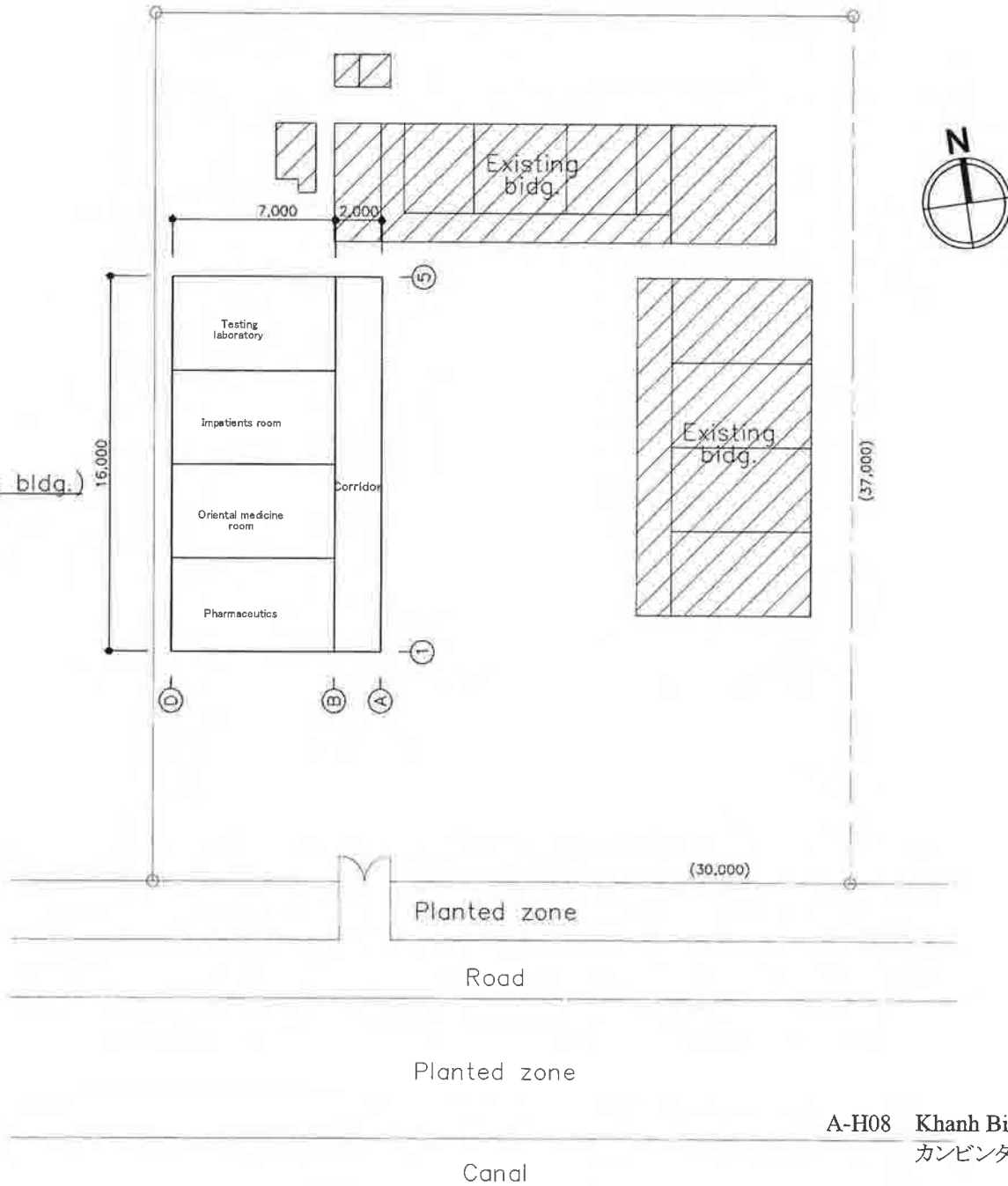

FLOOR AREA 144.0m2

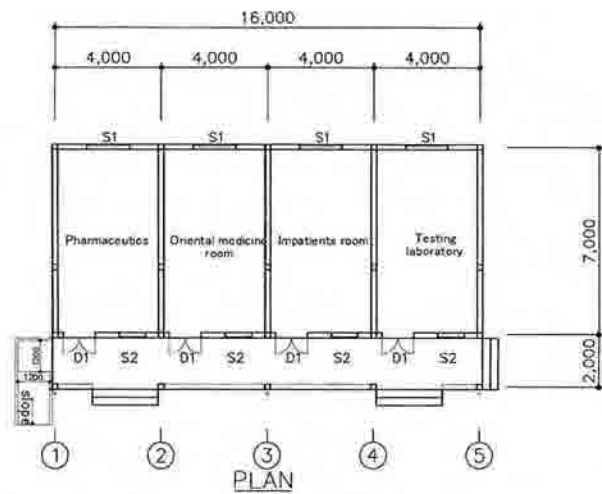
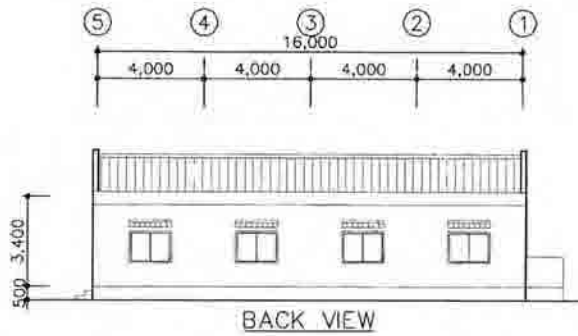
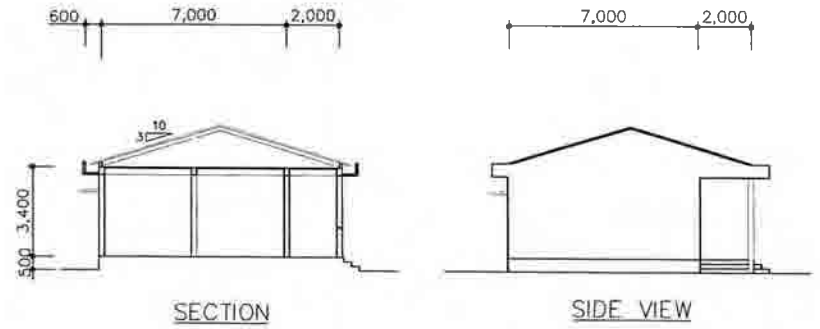
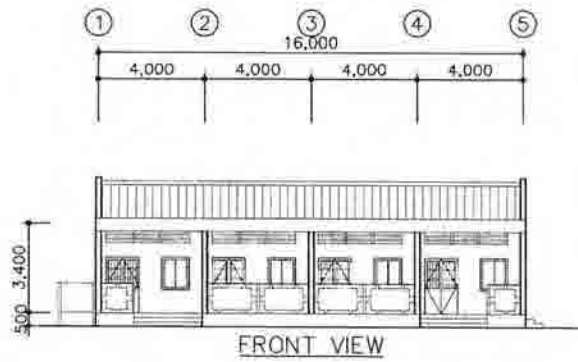

A-H09 Khanh Binh Tay Bac Health Center 4 Rooms
カンビンタイバック保健センター4室

A-5-41

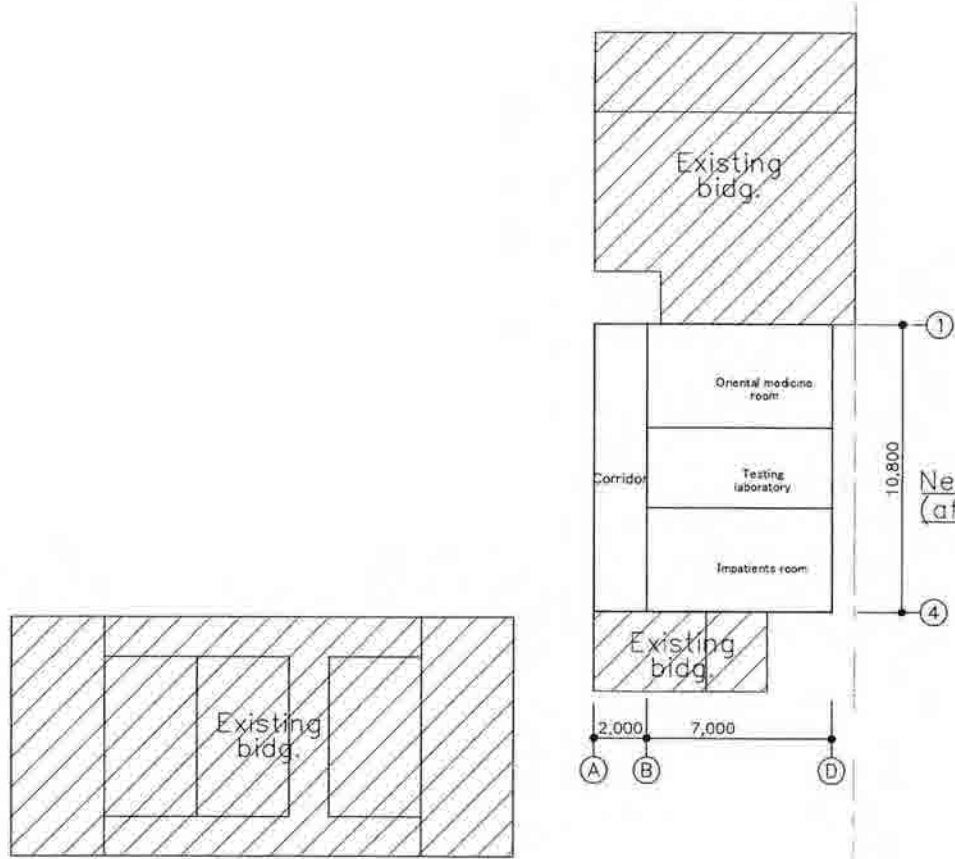
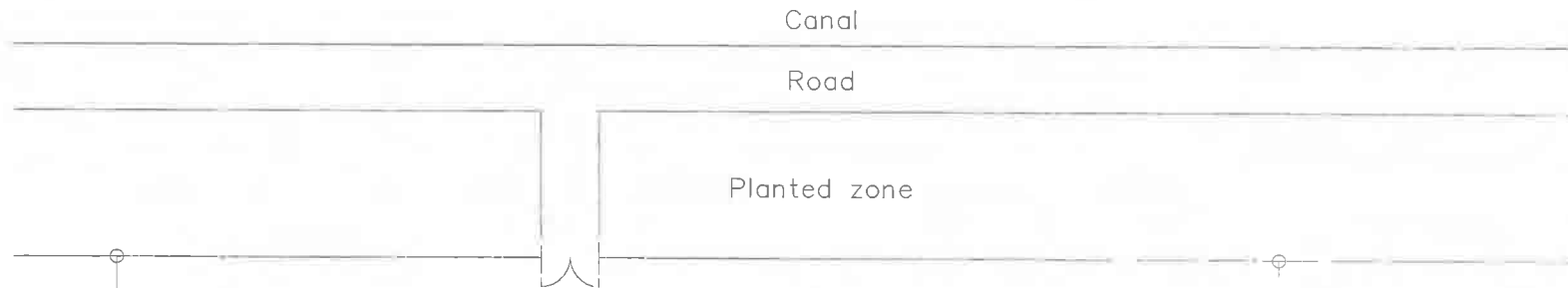

New bldg.
(after demolish existing bldg.)

FLOOR AREA 97.2m²

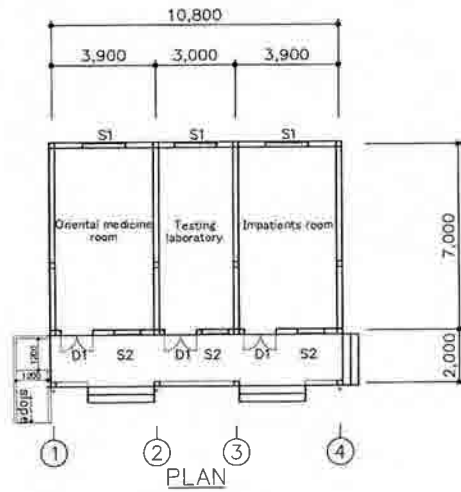
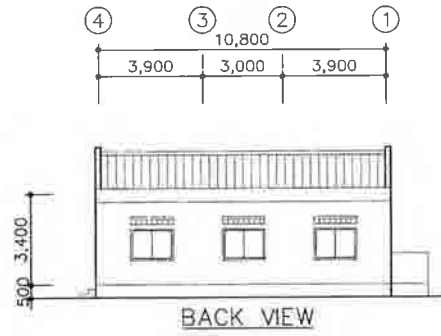
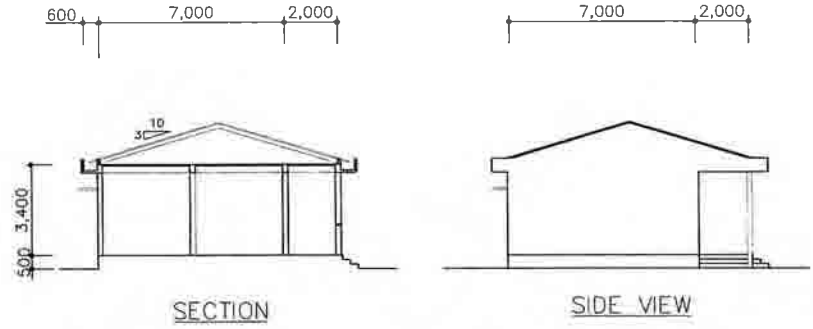
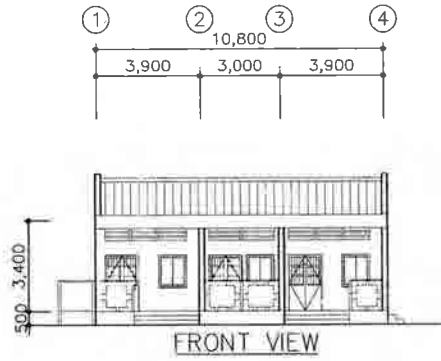

A-H11 Tran Hoi Health Center 3 Rooms
チャンホイ保健センター3室