

Intersection Av. Nicolas Ayllon - Av. Nicolas Arriola

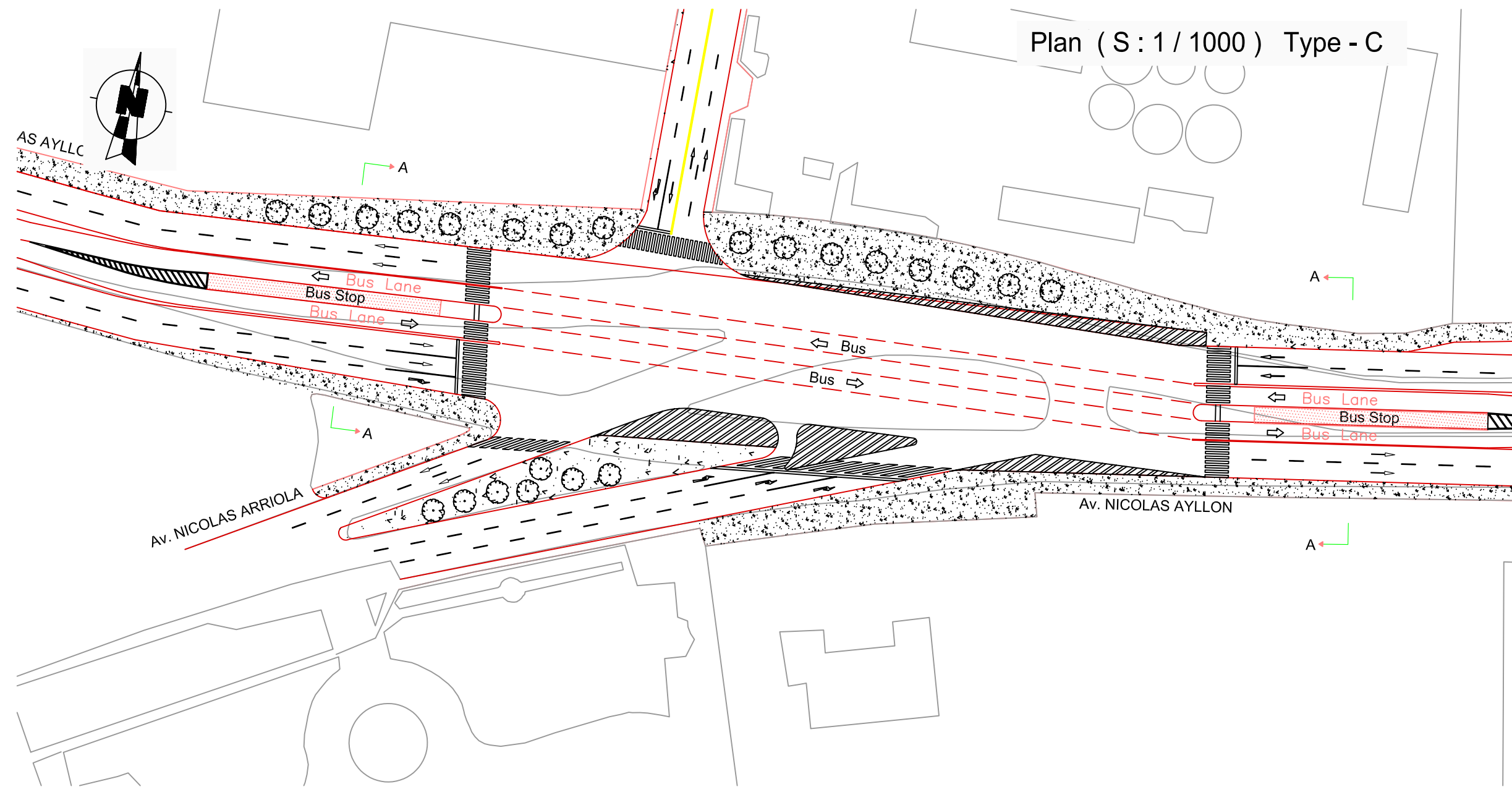

A - A Section
S = 1/500

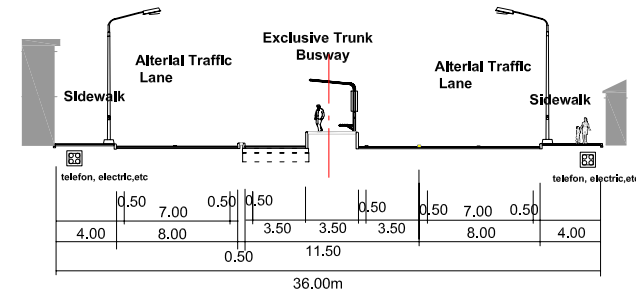

<p>INTERSECTION Av. NICOLAS AYLLON - Av. NICOLAS ARRIOLA</p>	<p>TRANSPORT COUNCIL OF LIMA AND CALLAO (CTLC) MINISTRY OF TRANSPORT AND COMMUNICATION (MTC)</p>	<p>JAPAN INTERNATIONAL COOPERATION AGENCY (JICA)</p>	<p>FEASIBILITY STUDY ON URBAN TRANSPORTATION IN THE LIMA AND CALLAO METROPOLITAN AREA IN THE REPUBLIC OF PERU</p>	<p>SCALE : Indicated DWG N°: 52 / 80</p>
---	--	--	---	--

Intersection Av. Nicolas Ayllon - Av. La Molina

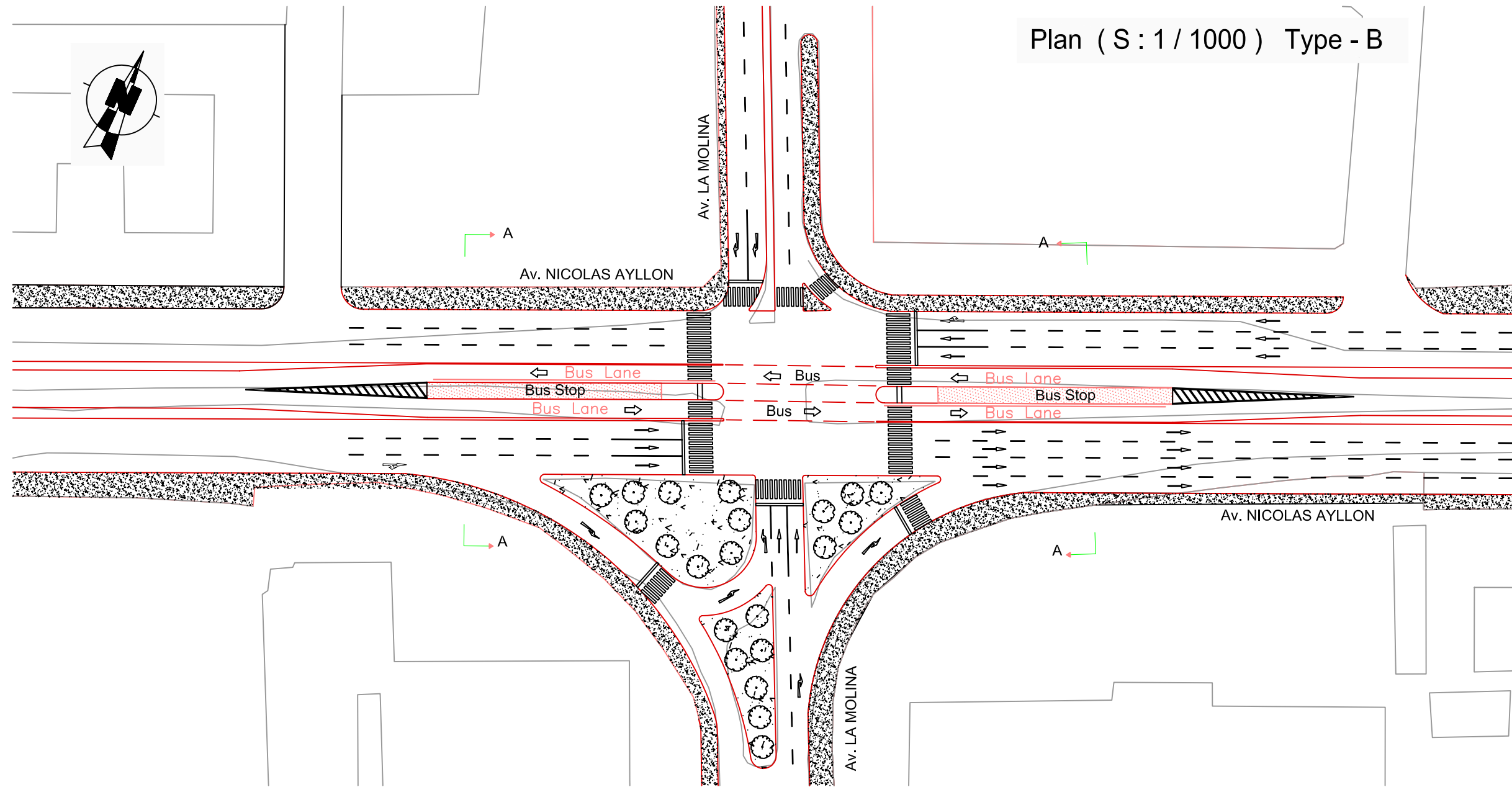

B - B Section
S = 1/500

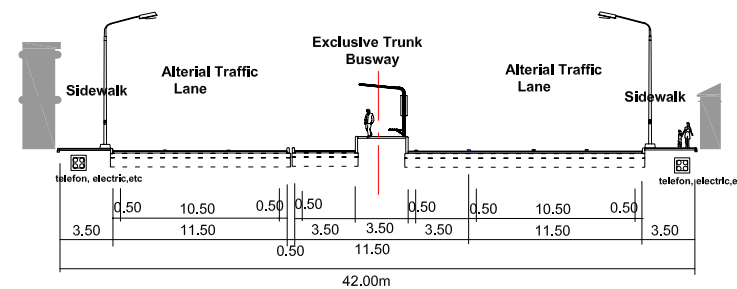

INTERSECTION
Av. NICOLAS AYLLON - Av. LA MOLINA

TRANSPORT COUNCIL OF LIMA AND CALLAO (CTLC)
MINISTRY OF TRANSPORT AND COMMUNICATION (MTC)

JAPAN INTERNATIONAL
COOPERATION AGENCY
(JICA)

FEASIBILITY STUDY ON URBAN TRANSPORTATION IN THE LIMA AND CALLAO
METROPOLITAN AREA IN THE REPUBLIC OF PERU

SCALE : Indicated

DWG N°: 53 / 80

Intersection Carret. Central - Avs. La Cultura, Asturias

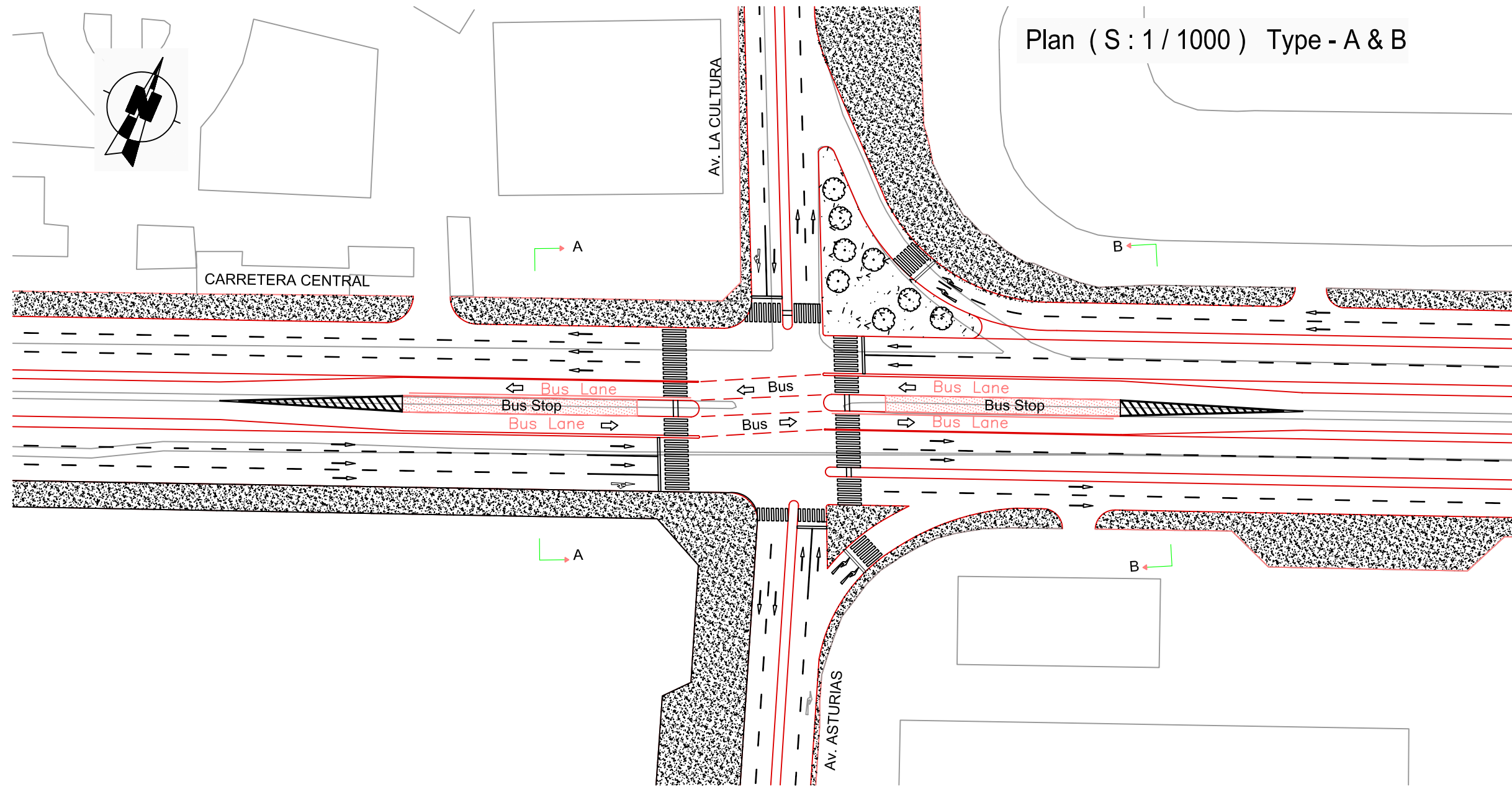

A - A Section
S = 1/500

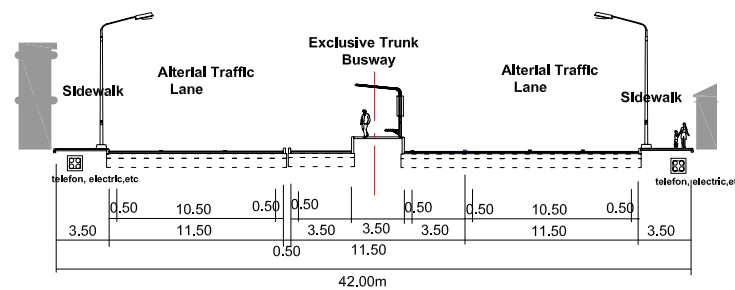

B - B Section
S = 1/500

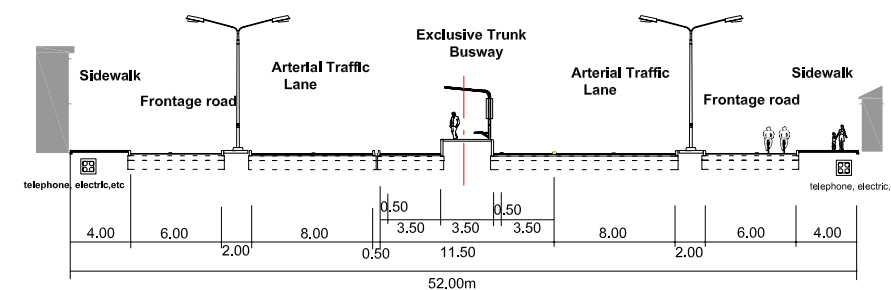

INTERSECTION
Av. CARRET. CENTRAL - Avs. LA CULTURA, ASTURIAS

TRANSPORT COUNCIL OF LIMA AND CALLAO (CTLC)
MINISTRY OF TRANSPORT AND COMMUNICATION (MTC)

JAPAN INTERNATIONAL
COOPERATION AGENCY
(JICA)

FEASIBILITY STUDY ON URBAN TRANSPORTATION IN THE LIMA AND CALLAO
METROPOLITAN AREA IN THE REPUBLIC OF PERU

SCALE : Indicated

DWG N°: 54 / 80

Pavement Design

1. Av. Venezuela

(Av.Venezuela - Av.Arica)

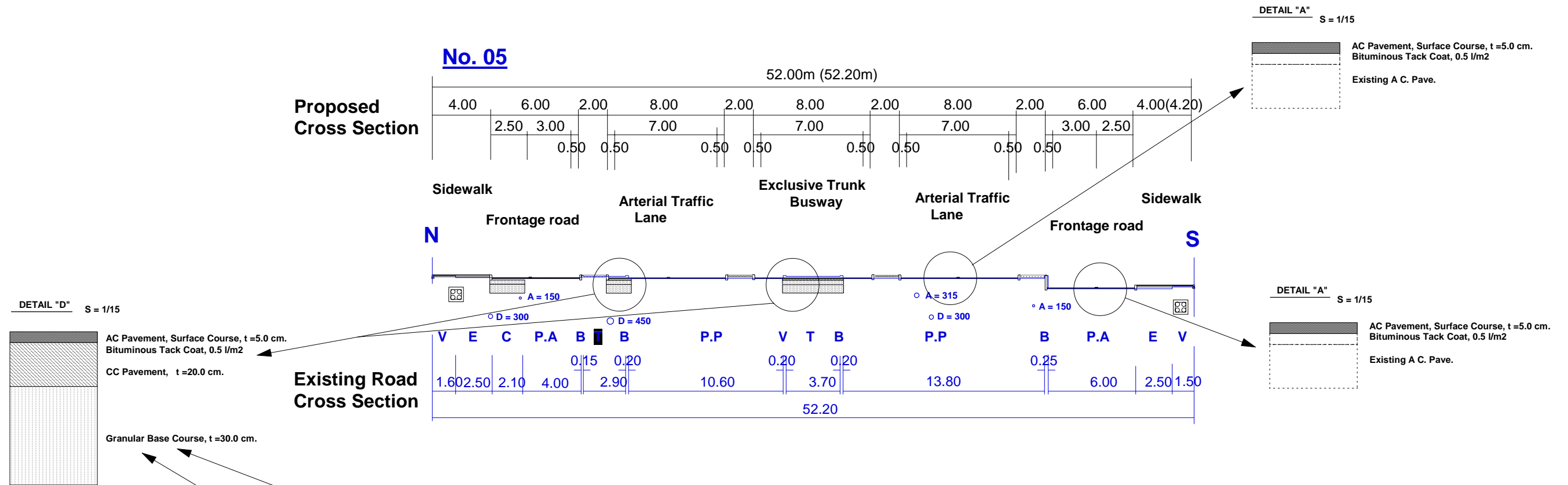

2. Av. Arica

No. 43

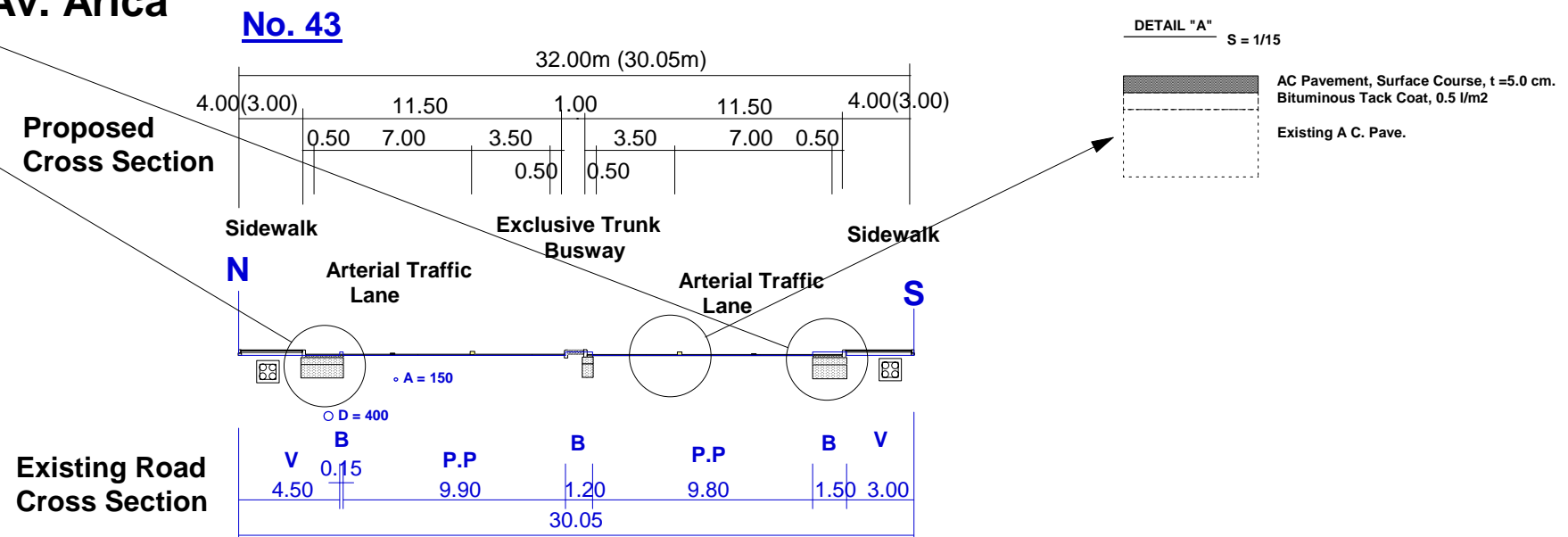

Pavement Design

(Av. Nicolas Ayllon - Carretera Central)

1. Av. Nicolas Ayllon

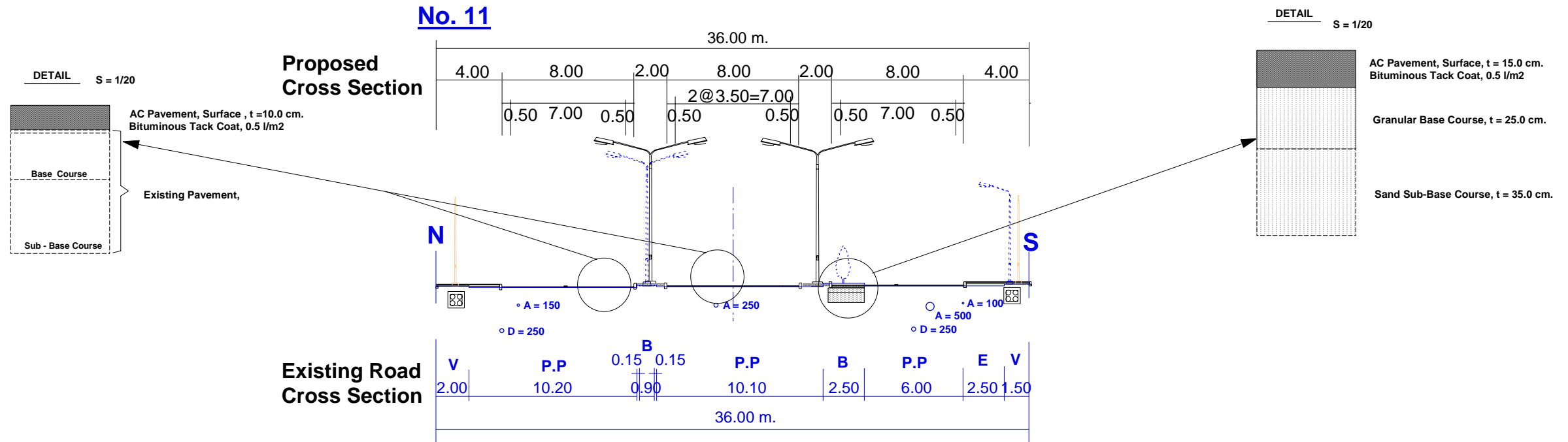

2. Carretera Central

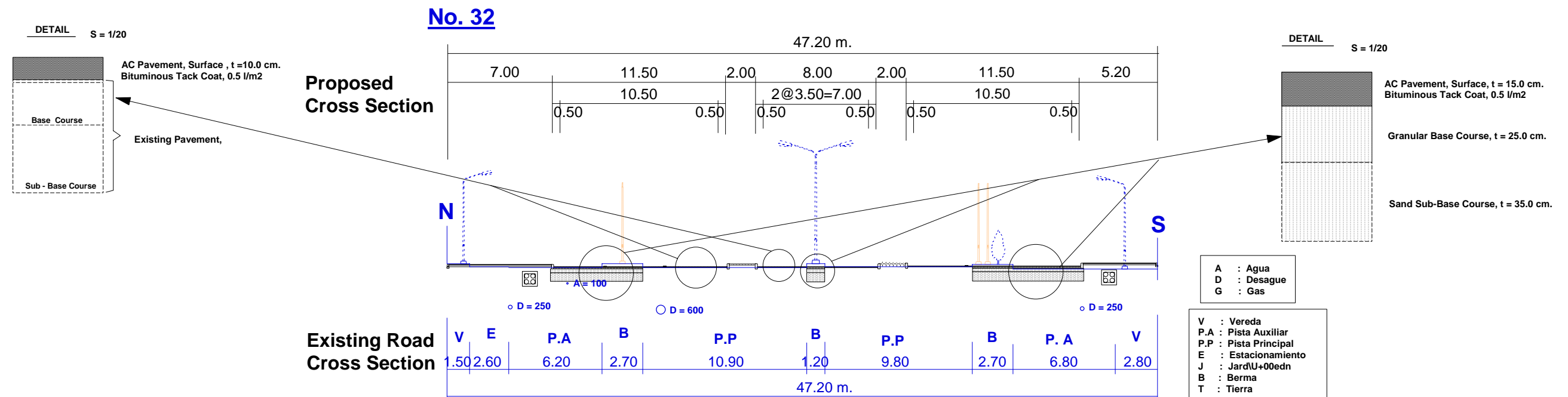

BUS STOP PLAN - 52.0m (Type - A)

Bus Stop Plan (S : 1/ 500)

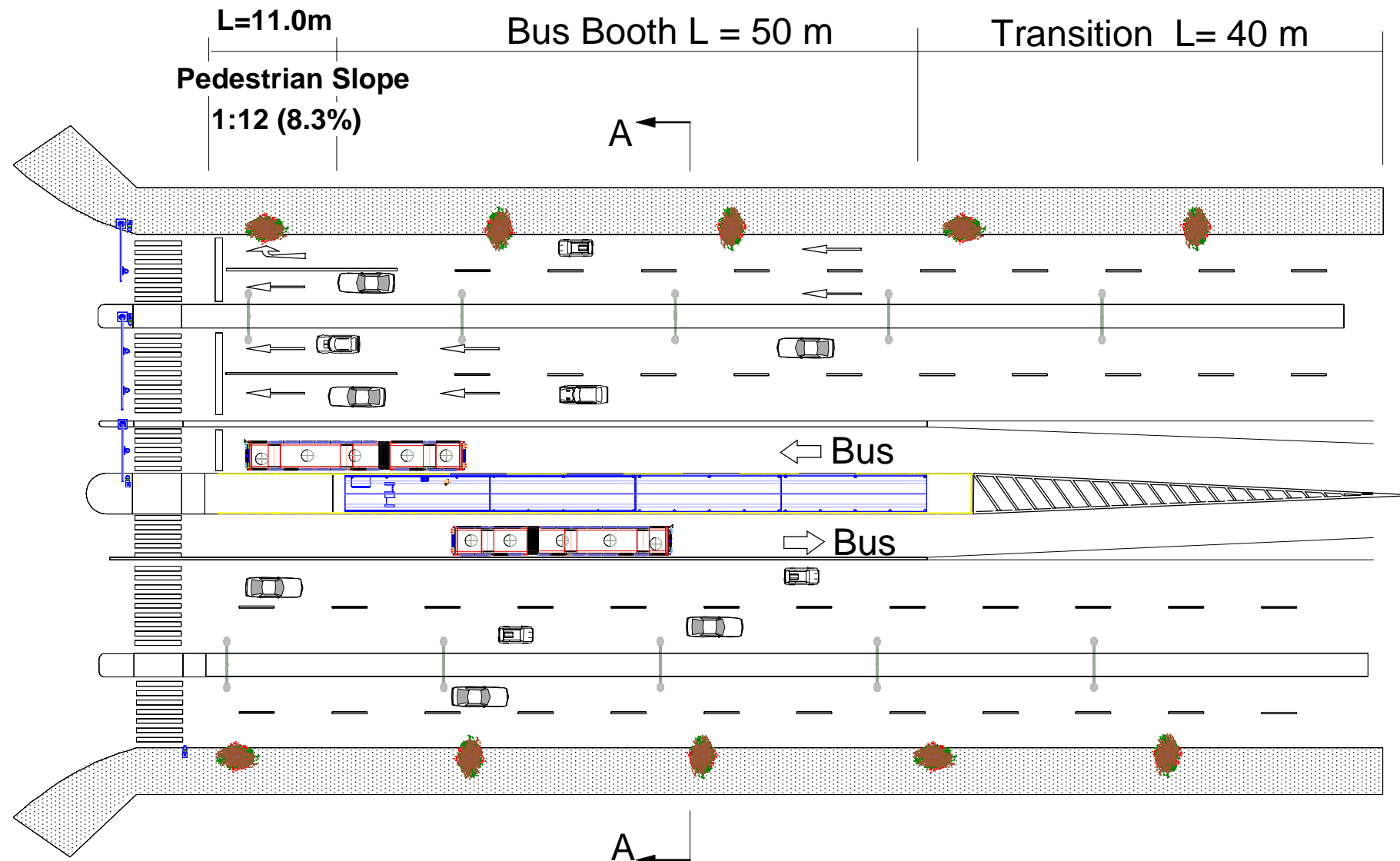

A - A Cross Section (on Bus Stop)
Scale = 1 / 300

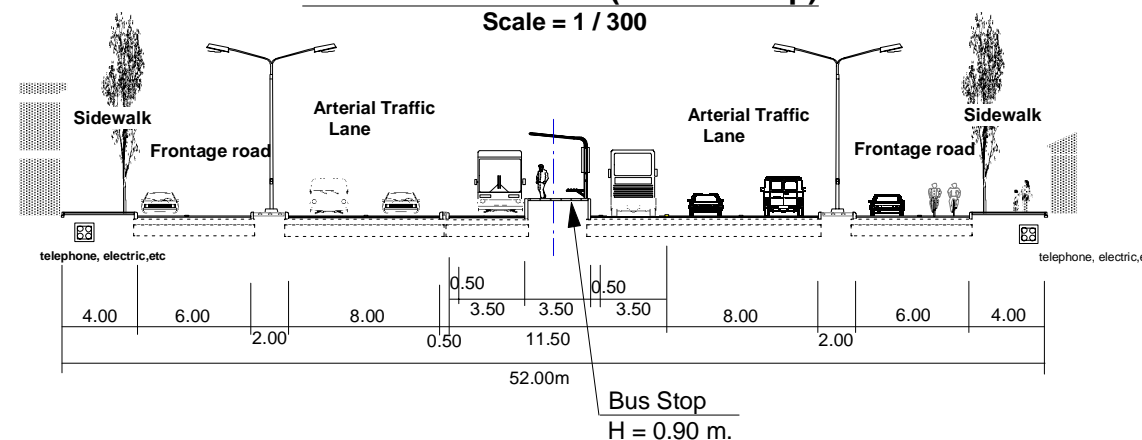

Widening Condition along Huaca Aramburu

Plan
S = 1 / 5,000

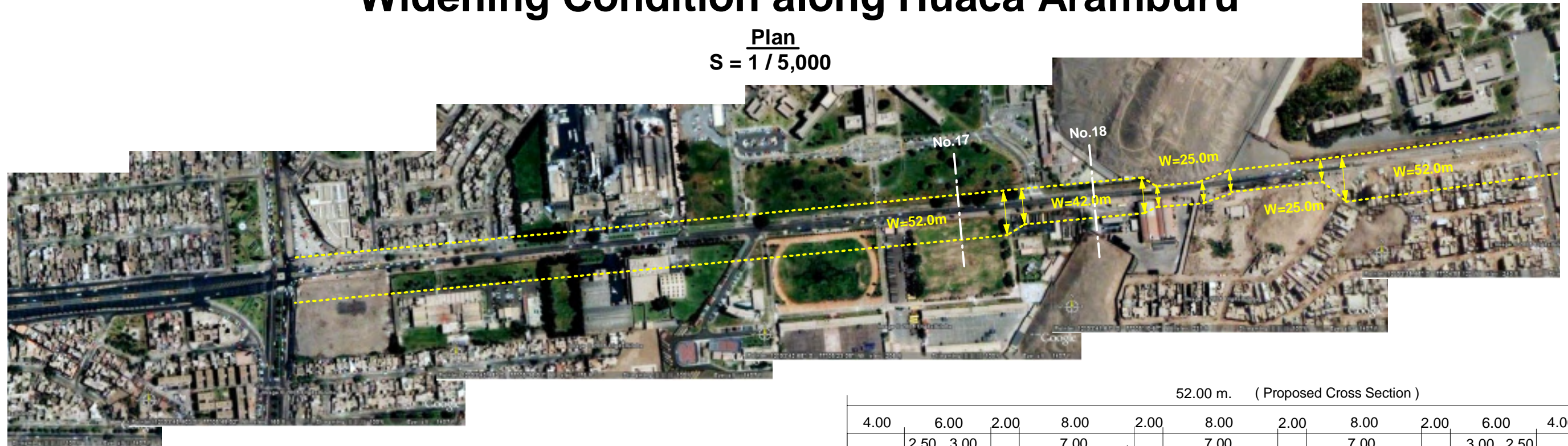

Typical Cross Section Type - A (w=52.0)

S = 1 / 300

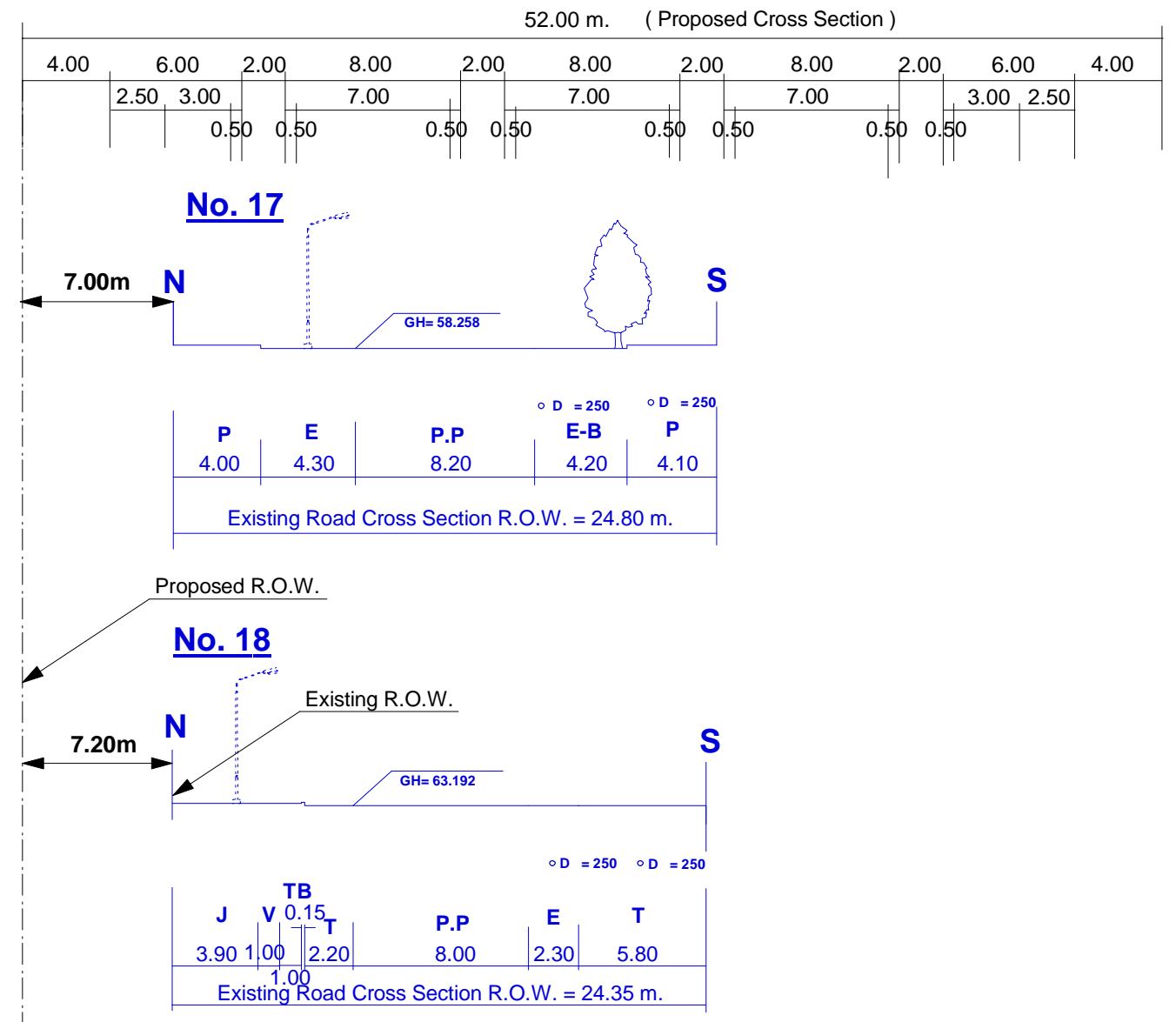
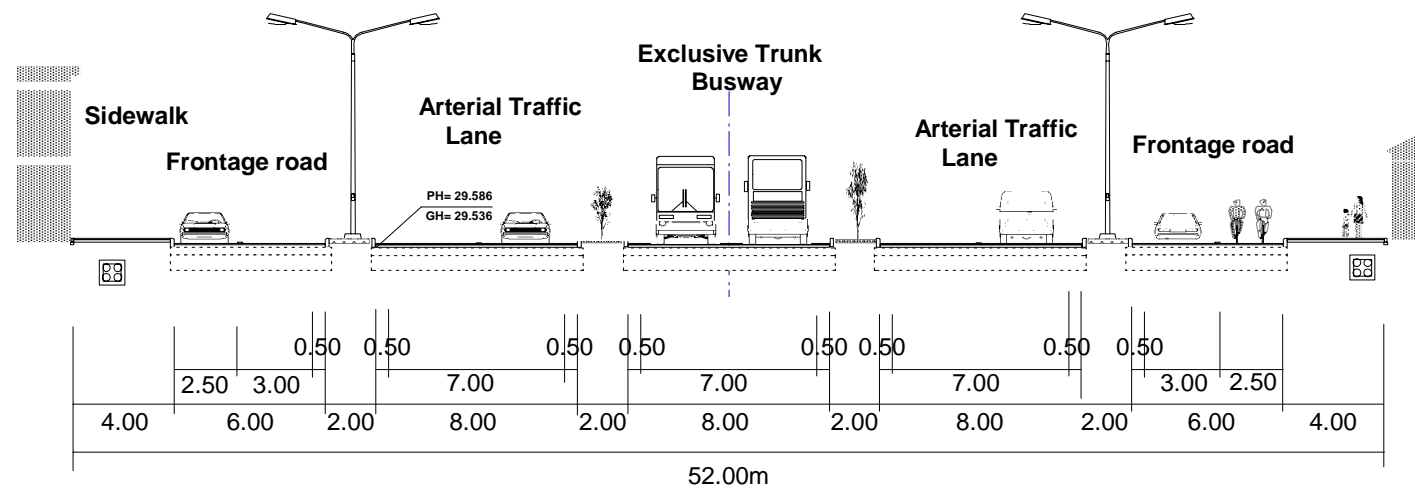

Connection Bus Route (Av. Arica - Central Bus Station)



LEGEND

- Bus Stop
- ➔ East (Callao) - West
- ➔ West - East (Callao)

<p>Connection Bus Route (Av. Arica - Central Bus Station)</p>	<p>TRANSPORT COUNCIL OF LIMA AND CALLAO (CTLC) MINISTRY OF TRANSPORT AND COMMUNICATION (MTC)</p>	<p>JAPAN INTERNATIONAL COOPERATION AGENCY (JICA)</p>	<p>FEASIBILITY STUDY ON URBAN TRANSPORTATION IN THE LIMA AND CALLAO METROPOLITAN AREA IN THE REPUBLIC OF PERU SCALE : 1 / 7,500 DWG N°: 59 / 80</p>
---	---	--	---