

F. Plan of
Related Projects

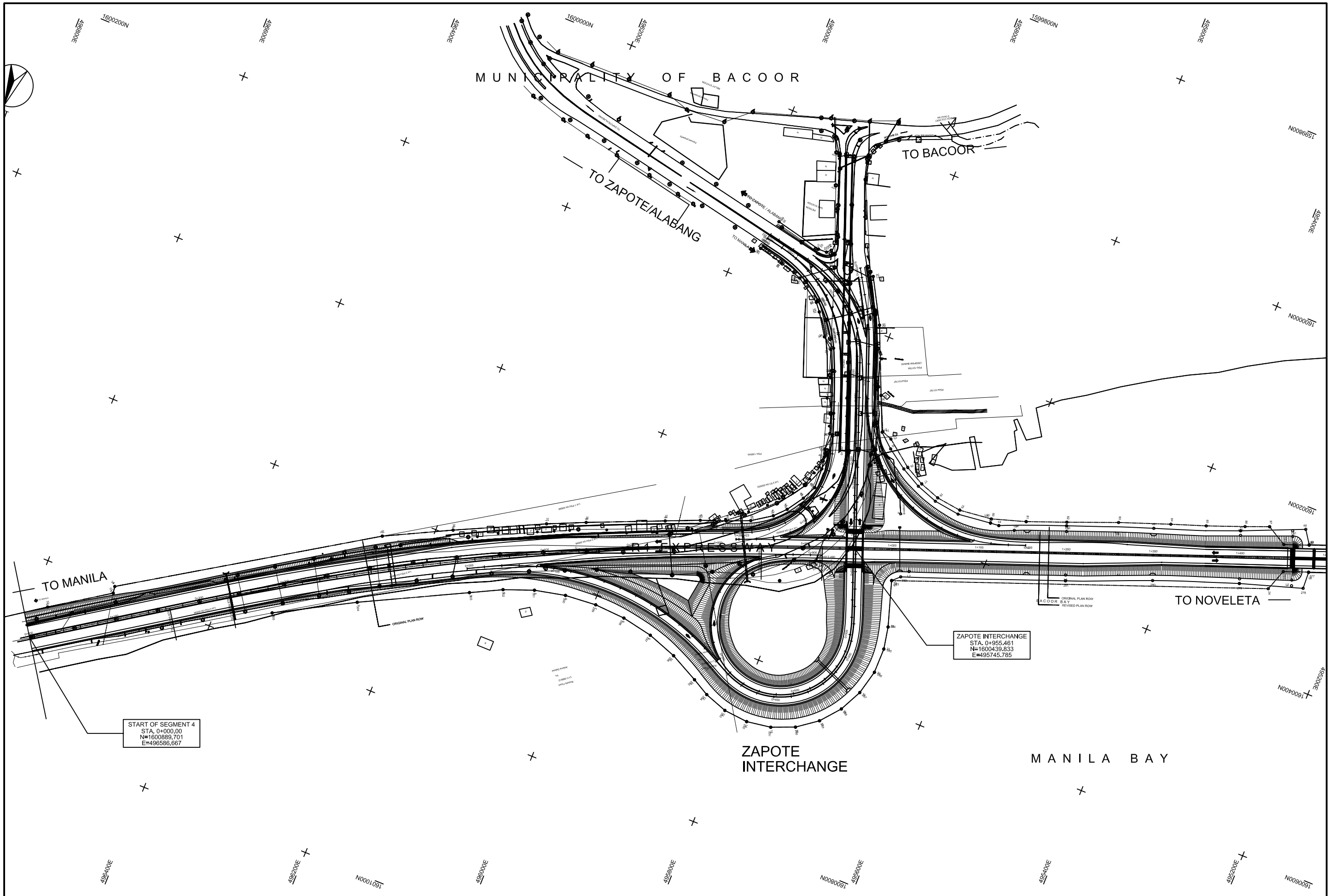



JICA JAPAN INTERNATIONAL COOPERATION AGENCY
DPWH DEPARTMENT OF PUBLIC WORKS AND HIGHWAYS

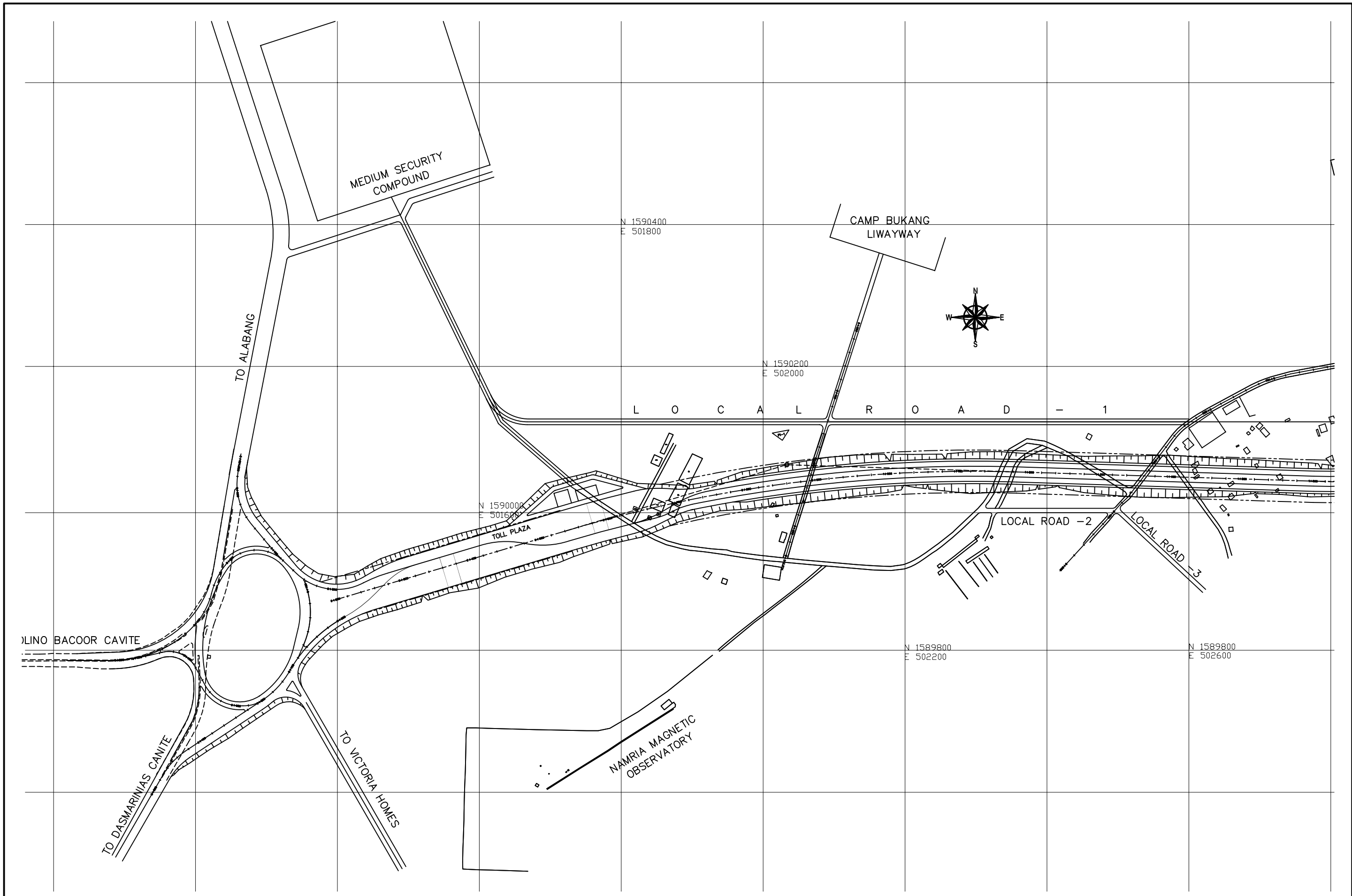

ALMEC ALMEC CORPORATION
NKC NIPPON KOEI CO., LTD.

REMARKS:

THE FEASIBILITY STUDY AND IMPLEMENTATION SUPPORT ON THE CALA EAST-WEST NATIONAL ROAD PROJECT	
DRAWING TITLE	Zapote Interchange Original Plan Prepared by UEM-MARA Philippines Corporation
SCALE	1:4,000
DRAWING NO.	RP-1
SHEET NO.	





 JAPAN INTERNATIONAL COOPERATION AGENCY
 DEPARTMENT OF PUBLIC WORKS AND HIGHWAYS

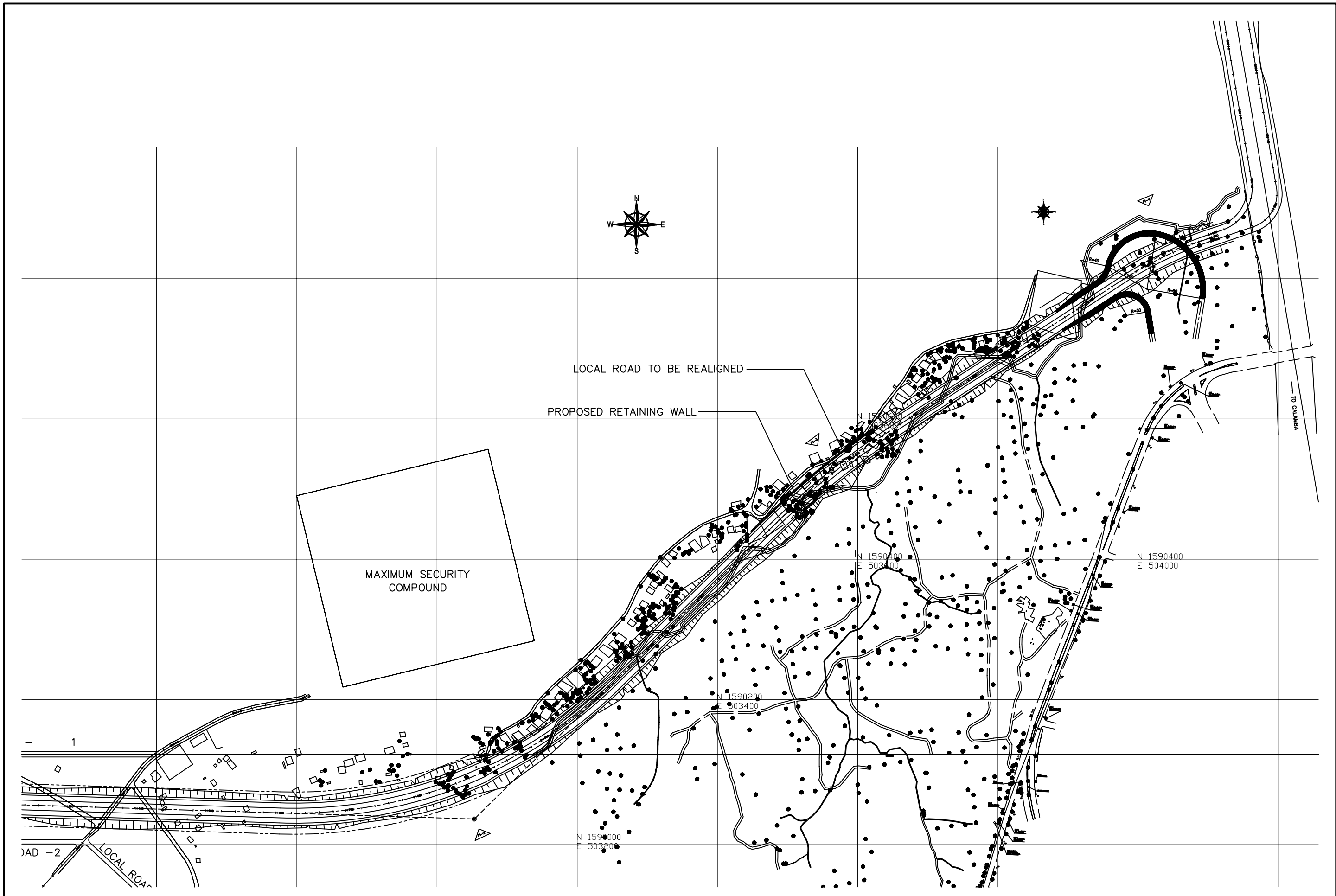

 ALMEC CORPORATION
 NIPPON KOEI CO., LTD.

REMARKS:

THE FEASIBILITY STUDY AND IMPLEMENTATION SUPPORT ON THE CALA EAST-WEST NATIONAL ROAD PROJECT		
DRAWING TITLE Plan of Daang Hari Road, DH2 Section (1/2) Prepared by National Development Corporation	SCALE	1:5,000
	DRAWING NO.	PR-2
	SHEET NO.	



 JAPAN INTERNATIONAL COOPERATION AGENCY
 DEPARTMENT OF PUBLIC WORKS AND HIGHWAYS

 ALMEC CORPORATION
 NIPPON KOEI CO., LTD.

REMARKS:

THE FEASIBILITY STUDY AND IMPLEMENTATION SUPPORT
 ON THE CALA EAST-WEST NATIONAL ROAD PROJECT
 DRAWING TITLE: Plan of Daang Hari Road, DH2 Section (2/2)
 Prepared by National Development Corporation
 SCALE: 1:5,000
 DRAWING NO.: PR-3
 SHEET NO.: