

GRADE	-2.676%																									166.300					-1.609%					162.600				
PROPOSED HEIGHT	177.16	177.06	177.809	177.274	176.738	176.203	175.668	175.132	174.597	174.062	173.526	172.991	172.456	171.921	171.385	170.850	170.315	169.779	169.244	168.709	168.174	167.638	167.124	166.653	166.225	165.839	165.496	165.174	164.852	164.530	164.209	163.887	163.565	163.243	162.907	162.543				
GROUND HEIGHT	177.16	177.06	176.53	176.19	176.738	176.203	175.70	175.68	175.132	174.597	174.33	173.41	171.93	172.00	171.53	170.94	170.34	169.75	169.15	168.56	167.96	167.35	166.70	166.04	165.49	165.20	164.91	164.62	164.33	164.04	163.74	163.45	163.15	162.86	162.56	162.26				
STATION	20+126	20+140	20+160	20+180	20+200	20+220	20+240	20+260	20+280	20+300	20+320	20+340	20+360	20+380	20+400	20+420	20+440	20+460	20+480	20+500	20+520	20+540	20+560	20+580	20+600	20+620	20+640	20+660	20+680	20+700	20+720	20+740	20+760	20+780	20+800					
CURVE ELEMENT	R=00 L=696.392															R=3000.000 L=1250.612																								

JICA JAPAN INTERNATIONAL COOPERATION AGENCY
 DEPARTMENT OF PUBLIC WORKS AND HIGHWAYS

ALMEC ALMEC CORPORATION
 NIPPON KOEI CO., LTD.

REMARKS:

THE FEASIBILITY STUDY AND IMPLEMENTATION SUPPORT
 ON THE CALA EAST-WEST NATIONAL ROAD PROJECT

DRAWING TITLE: CALA Expressway Plan & Profile (30/33)

SCALE: 1:2,000
 DRAWING NO.: CE-30
 SHEET NO.:

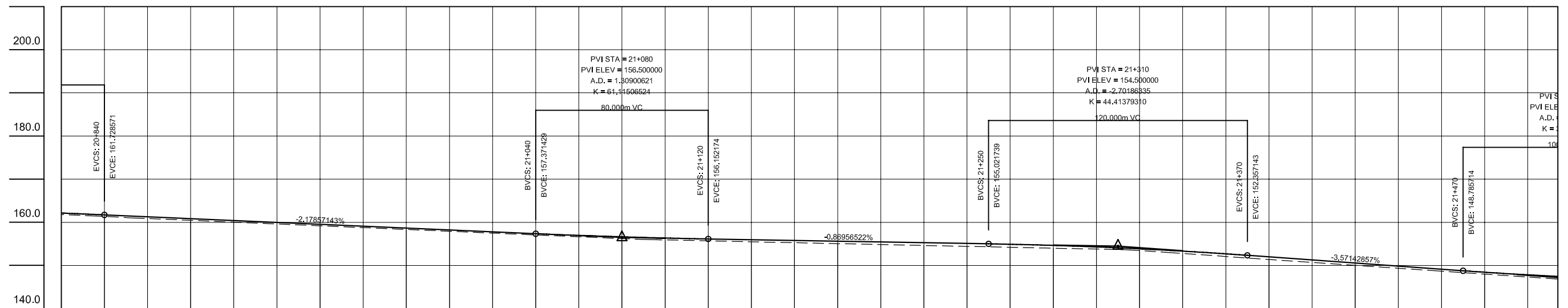

GRADE	-2.179%										-0.870%										-3.571%																	
PROPOSED HEIGHT	162.150	161.729	161.293	160.857	160.421	159.986	159.550	159.114	158.679	158.243	157.807	157.371	156.935	156.500	156.064	155.628	155.192	154.756	154.320	153.884	153.448	153.012	152.576	152.140	151.704	151.268	150.832	150.396	149.960	149.524	149.088	148.652	148.216	147.780	147.344	146.908		
GROUND HEIGHT	161.82	161.36	160.89	160.47	160.04	159.62	159.19	158.77	158.35	157.92	157.50	157.08	156.66	156.24	155.83	155.41	154.99	154.57	154.15	153.73	153.31	152.89	152.47	152.05	151.63	151.21	150.79	150.37	149.95	149.53	149.11	148.69	148.27	147.85	147.43	147.01		
STATION	20+820	20+840	20+860	20+880	20+900	20+920	20+940	20+960	20+980	21+000	21+020	21+040	21+060	21+080	21+100	21+120	21+140	21+160	21+180	21+200	21+220	21+240	21+260	21+280	21+300	21+320	21+340	21+360	21+380	21+400	21+420	21+440	21+460	21+480	21+500			
CURVE ELEMENT	R=3000.000 L=1250.612																																					