

GRADE	4.762%																				183.000	5.000%																				200.000
PROPOSED HEIGHT	165.857	166.810	167.762	168.714	169.667	170.619	171.571	172.524	173.476	174.429	175.381	176.333	177.286	178.238	179.190	180.143	181.095	182.054	183.024	184.006	185.000	186.000	187.000	188.000	189.000	190.000	191.000	192.000	193.000	194.000	195.000	196.000	197.000	197.500	197.982	198.839						
GROUND HEIGHT	164.63	165.06	166.07	167.18	168.25	168.43	168.84	169.29	169.88	170.42	171.00	171.55	173.53	175.00	175.00	175.00	173.82	172.67	167.19	167.40	173.20	174.68	174.61	174.68	175.86	178.06	180.54	182.21	183.96	186.72	191.30	195.92	201.07	204.96	208.25							
STATION	6+940	6+960	6+980	7+000	7+020	7+040	7+060	7+080	7+100	7+120	7+140	7+160	7+180	7+200	7+220	7+240	7+260	7+280	7+300	7+320	7+340	7+360	7+380	7+400	7+420	7+440	7+460	7+480	7+500	7+520	7+540	7+560	7+580	7+590	7+600	7+620						
CURVE ELEMENT	R=0 L=1450.058										R=3000.000 L=2787.203																															

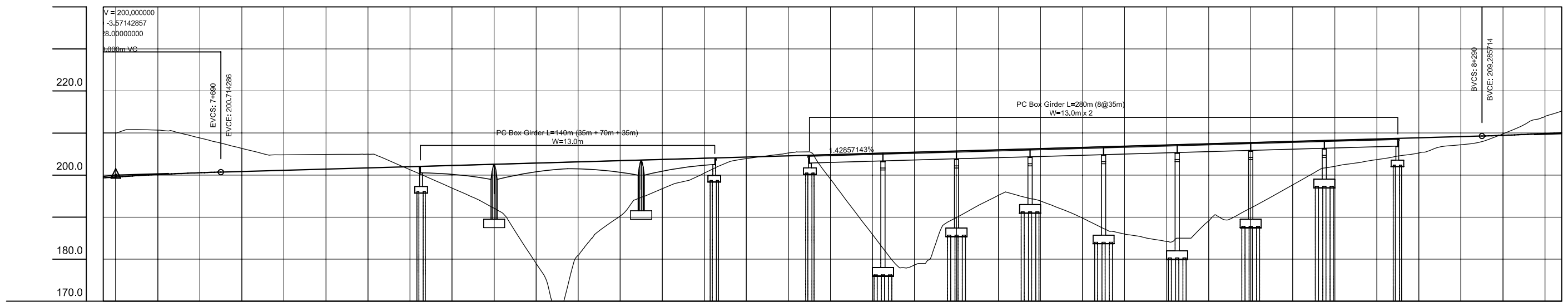

GRADE	1.429%																												210.000									
PROPOSED HEIGHT	199.554	200.125	200.554	200.714	200.857	201.143	201.429	201.714	202.000	202.286	202.571	202.857	203.143	203.429	203.714	204.000	204.286	204.571	204.857	205.143	205.429	205.714	206.000	206.286	206.571	206.857	207.143	207.429	207.714	208.000	208.286	208.571	208.857	209.143	209.286	209.446	209.875	
GROUND HEIGHT	210.00	210.00	210.67	208.83	206.37	204.81	204.92	204.96	201.28	196.92	192.12	179.00	181.00	190.28	196.79	200.44	203.90	205.25	199.06	185.88	178.61	189.91	195.19	193.83	189.76	185.97	184.21	189.10	192.16	197.68	202.08	203.70	205.27	207.20	209.286	209.80	213.95	
STATION	7+634	7+640	7+660	7+680	7+690	7+700	7+720	7+740	7+760	7+780	7+800	7+820	7+840	7+860	7+880	7+900	7+920	7+940	7+960	7+980	8+000	8+020	8+040	8+060	8+080	8+100	8+120	8+140	8+160	8+180	8+200	8+220	8+240	8+260	8+280	8+290	8+300	8+320
CURVE ELEMENT	R=3000.000 L=2787.203																																					

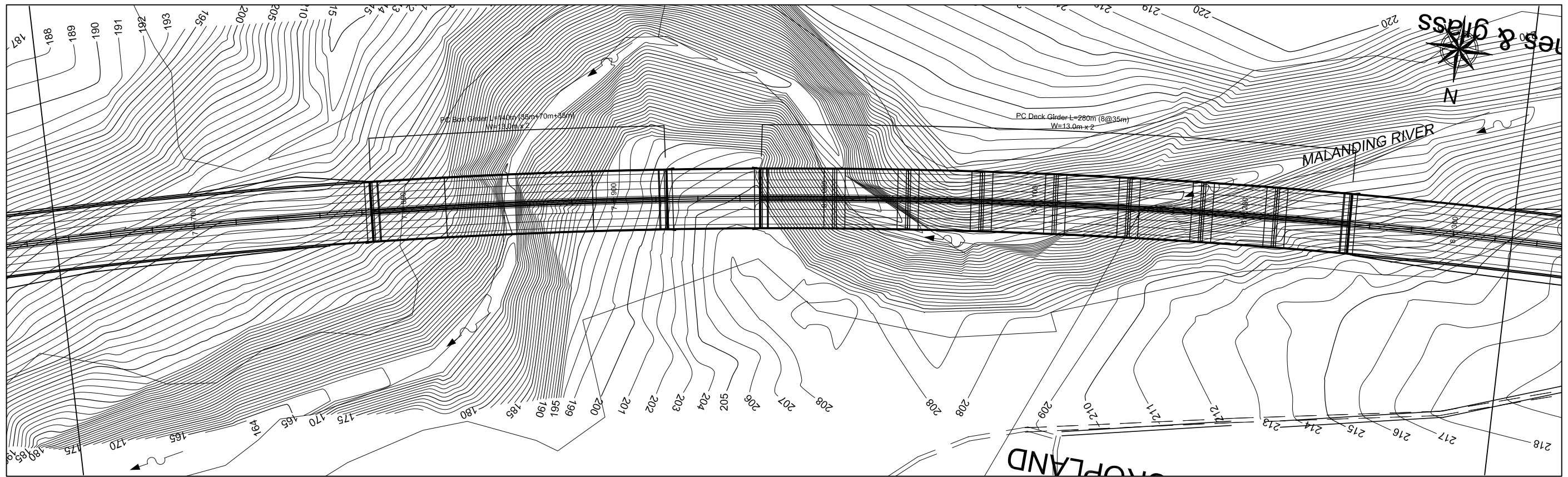
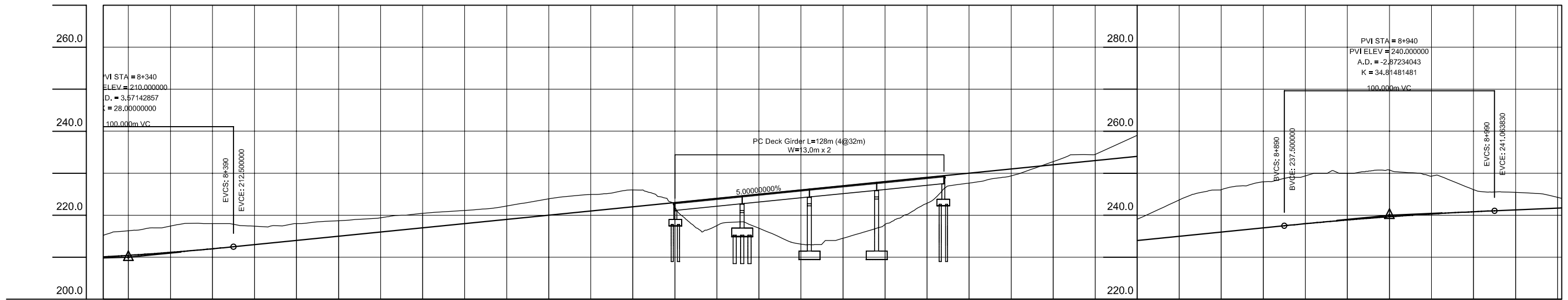
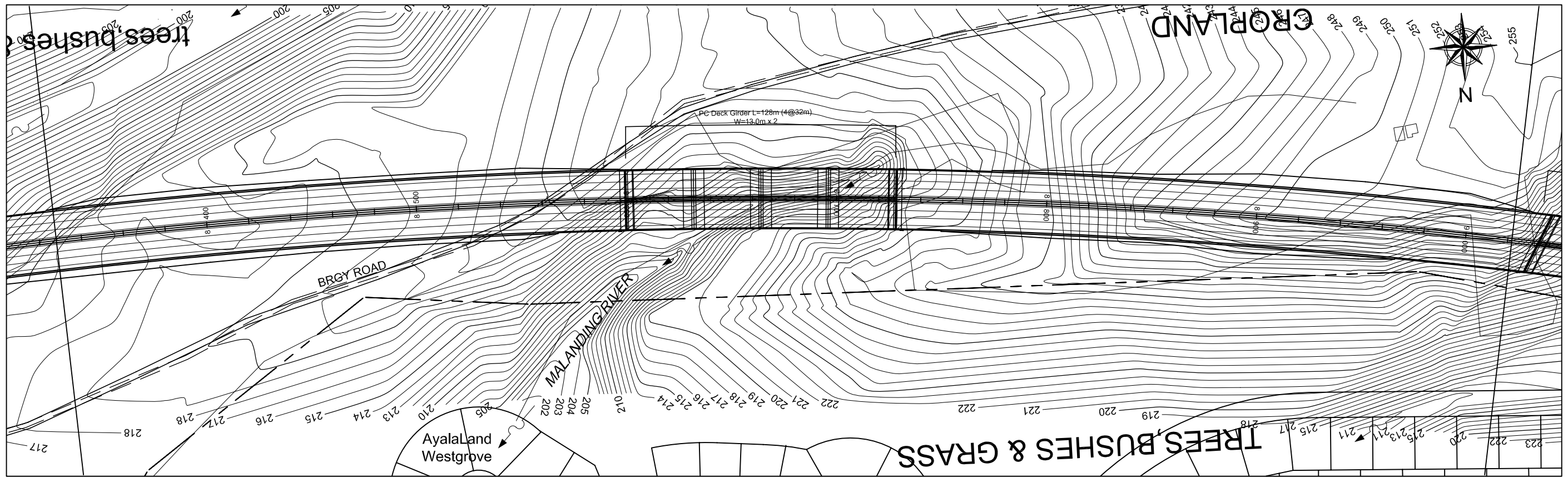

GRADE	5.000%																				2.128%																	
PROPOSED HEIGHT	210.000	210.446	211.161	212.018	212.500	213.000	214.000	215.000	216.000	217.000	218.000	219.000	220.000	222.000	223.000	224.000	225.000	226.000	227.000	228.000	229.000	230.000	231.000	232.000	233.000	234.000	235.000	236.000	237.000	237.500	237.986	238.871	239.641	240.296	240.837	241.064	241.277	
GROUND HEIGHT	215.22	216.31	217.42	218.00	217.39	218.00	218.70	219.38	220.34	221.13	222.21	223.90	224.91	226.00	221.95	217.55	216.91	213.13	214.52	217.82	222.86	227.65	229.37	232.75	234.46	239.03	243.62	246.06	247.99	249.35	250.00	250.77	249.31	246.09	245.44			
STATION	8+328	8+340	8+360	8+380	8+390	8+400	8+420	8+440	8+460	8+480	8+500	8+520	8+540	8+560	8+580	8+600	8+620	8+640	8+660	8+680	8+700	8+720	8+740	8+760	8+780	8+800	8+820	8+840	8+860	8+880	8+890	8+900	8+920	8+940	8+960	8+980	8+990	9+000
CURVE ELEMENT	PC=3000.000 L=2787.203																																					

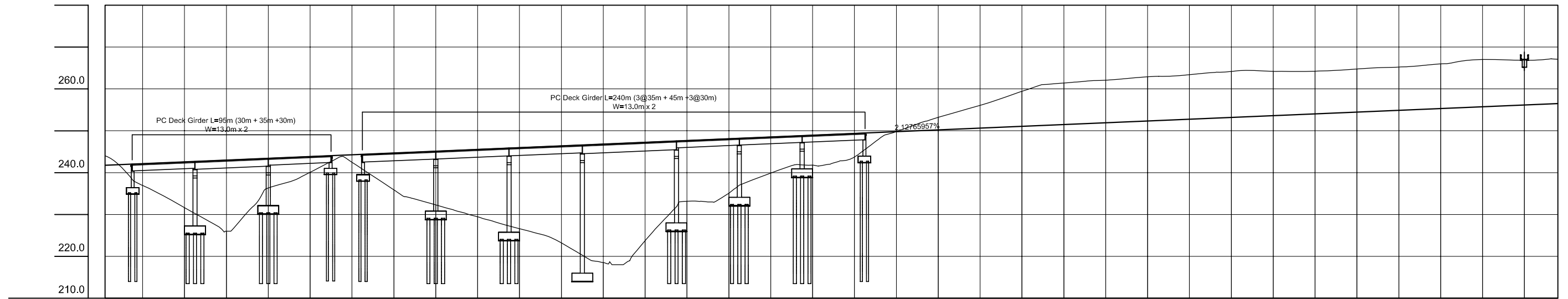
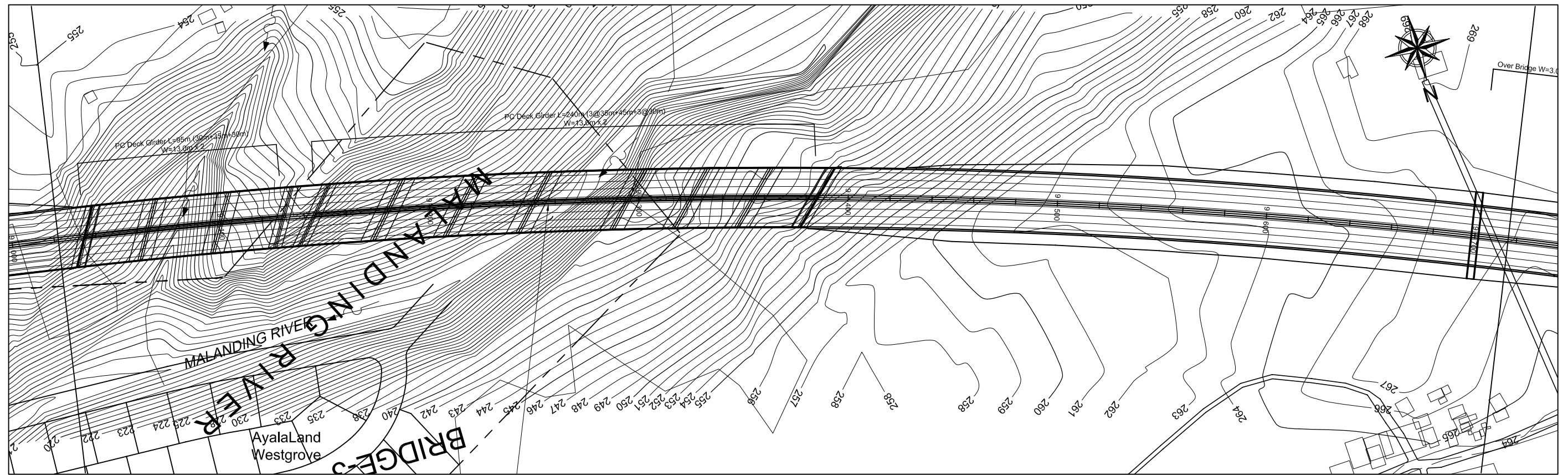

GRADE	2.128%																																		
PROPOSED HEIGHT		242.128	242.553	242.979	243.404	243.830	244.255	244.681	245.106	245.532	245.957	246.383	246.809	247.234	247.660	248.085	248.511	248.936	249.362	249.787	250.213	250.638	251.064	251.489	251.915	252.340	252.766	253.191	253.617	254.043	254.468	254.894	255.319	255.745	256.170
GROUND HEIGHT	244.00	236.94	231.65	226.00	236.33	240.09	242.47	235.89	232.31	229.48	226.62	223.22	218.53	223.76	233.15	235.10	239.90	241.82	243.74	249.80	253.21	256.07	259.41	261.40	262.11	262.86	263.40	264.20	264.19	264.25	264.74	265.21	265.99	267.00	267.09
STATION	9+022	9+040	9+060	9+080	9+100	9+120	9+140	9+160	9+180	9+200	9+220	9+240	9+260	9+280	9+300	9+320	9+340	9+360	9+380	9+400	9+420	9+440	9+460	9+480	9+500	9+520	9+540	9+560	9+580	9+600	9+620	9+640	9+660	9+680	9+700
CURVE ELEMENT	P=3000.000 L=2787.203																																		

**JICA** JAPAN INTERNATIONAL COOPERATION AGENCY  
 DEPARTMENT OF PUBLIC WORKS AND HIGHWAYS

**ALMEC** ALMEC CORPORATION  
**NK** NIPPON KOEI CO., LTD.

**REMARKS:**

**THE FEASIBILITY STUDY AND IMPLEMENTATION SUPPORT ON THE CALA EAST-WEST NATIONAL ROAD PROJECT**

DRAWING TITLE: CALA Expressway Plan & Profile (14/33)

SCALE	1:2,000
DRAWING NO.	CE-14
SHEET NO.	

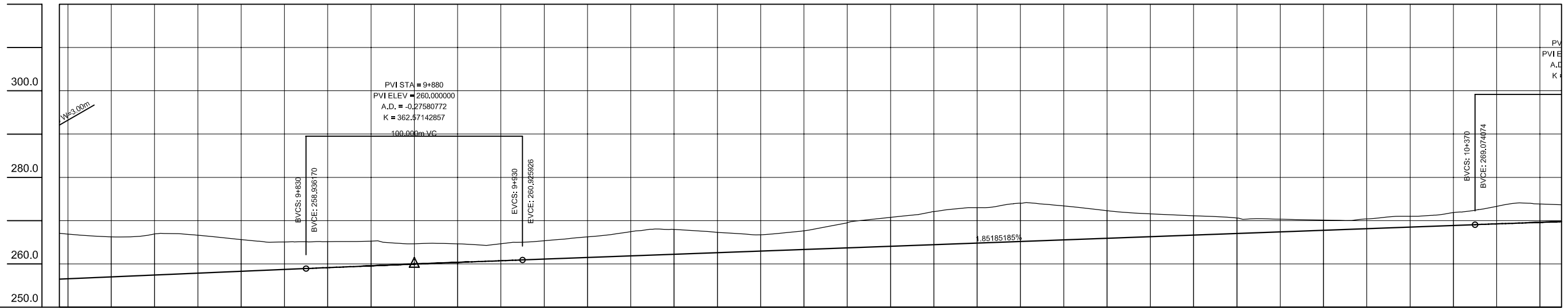

GRADE	2.128%		260.000		1.852%		270.000																															
PROPOSED HEIGHT	256.596	257.021	257.447	257.872	258.298	258.723	259.148	259.562	259.966	260.358	260.739	261.111	261.481	261.852	262.222	262.593	262.963	263.333	263.704	264.074	264.444	264.815	265.185	265.556	265.926	266.296	266.667	267.037	267.407	267.778	268.148	268.519	268.889	269.256	269.598			
GROUND HEIGHT	267.07	266.92	266.26	266.65	265.64	265.08	258.936	265.16	264.64	264.67	260.926	265.36	266.23	267.45	267.97	267.29	266.74	267.69	269.51	270.76	272.10	273.00	274.00	273.40	272.29	271.57	271.13	270.61	270.33	270.13	270.42	271.00	271.85	273.27	273.86			
STATION	9+716 9+720	9+740	9+760	9+780	9+800	9+820	9+830	9+840	9+860	9+880	9+900	9+920	9+930	9+940	9+960	9+980	10+000	10+020	10+040	10+060	10+080	10+100	10+120	10+140	10+160	10+180	10+200	10+220	10+240	10+260	10+280	10+300	10+320	10+340	10+360	10+370	10+380	10+400
CURVE ELEMENT	R=3000.000 L=2787.203																																		R=3000.000 L=1223.928			



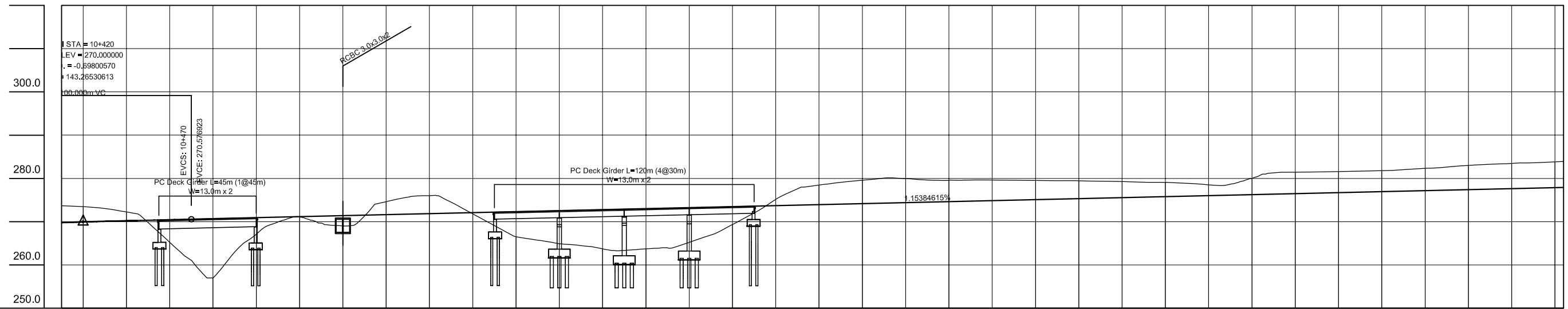
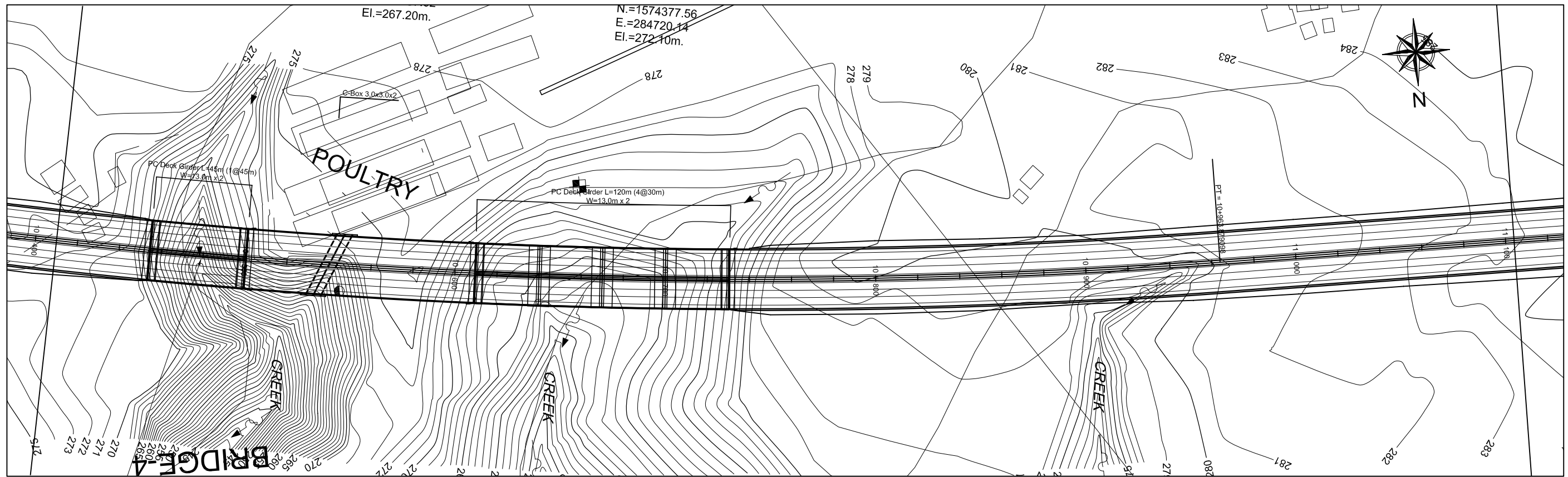

GRADE	270.000																																				
PROPOSED HEIGHT	269.913	269.913	270.199	270.458	270.577	270.692	270.923	271.154	271.385	271.615	271.846	272.077	272.308	272.538	272.769	273.000	273.231	273.462	273.692	273.923	274.154	274.385	274.615	274.846	275.077	275.308	275.538	275.769	276.000	276.231	276.462	276.692	276.923	277.154	277.385	277.615	277.846
GROUND HEIGHT	273.68	273.47	272.24	265.22	270.577	257.00	267.11	271.10	269.03	274.63	276.01	271.82	266.51	264.91	263.73	263.72	265.22	269.35	275.15	278.47	279.58	279.96	279.58	279.63	279.52	279.45	279.28	279.07	278.49	280.00	281.45	281.58	281.80	282.32	283.10	283.46	283.83
STATION	10+410	10+420	10+440	10+460	10+470	10+480	10+500	10+520	10+540	10+560	10+580	10+600	10+620	10+640	10+660	10+680	10+700	10+720	10+740	10+760	10+780	10+800	10+820	10+840	10+860	10+880	10+900	10+920	10+940	10+960	10+980	11+000	11+020	11+040	11+060	11+080	11+100
CURVE ELEMENT	<div style="display: flex; justify-content: space-between;"> <span>R=3000.000 L=1223.928</span> <span>R=00 L=374.786</span> </div>																																				