

GRADE	1.098%																				-1.721%																			
PROPOSED HEIGHT	22.232	22.201	22.270	22.439	22.659	22.878	23.098	23.318	23.537	23.757	23.976	24.196	24.416	24.635	24.855	25.075	25.294	25.514	25.733	25.953	26.173	26.392	26.612	26.831	26.941	27.039	27.165	27.197	27.134	26.978	26.728	26.568	26.395	26.051	25.879	25.720	25.477			
GROUND HEIGHT	21.29	21.26	21.39	22.13	22.07	22.64	22.57	22.73	22.86	23.00	23.08	23.26	23.41	23.58	23.86	24.00	24.07	24.24	24.40	24.65	25.00	24.90	25.25	25.31	25.20	25.20	24.31	21.51	22.19	25.20	25.30	26.568	26.395	24.65	24.51	24.15				
STATION	15+268	15+280	15+300	15+320	15+340	15+360	15+380	15+400	15+420	15+440	15+460	15+480	15+500	15+520	15+540	15+560	15+580	15+600	15+620	15+640	15+660	15+680	15+700	15+720	15+740	15+750	15+760	15+780	15+800	15+820	15+840	15+860	15+870	15+880	15+900	15+910	15+920	15+940		
CURVE ELEMENT	R=1800.000 L=791.252										R=0 L=956.886																													

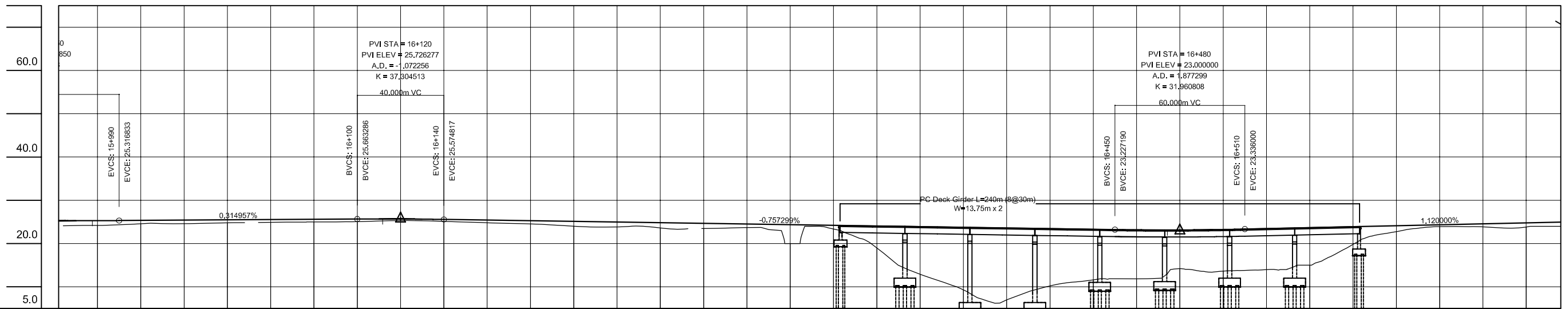

GRADE	0.315%										-0.757%										23.000										1.120%							
PROPOSED HEIGHT	25.191	25.298	25.317	25.348	25.411	25.474	25.537	25.600	25.663	25.673	25.575	25.423	25.272	25.120	24.969	24.818	24.666	24.515	24.363	24.212	24.060	23.909	23.757	23.606	23.454	23.303	23.227	23.167	23.141	23.240	23.336	23.448	23.672	23.896	24.120	24.344	24.568	24.792
GROUND HEIGHT	24.09	24.20	24.57	24.60	24.79	24.92	25.01	25.09	25.32	25.12	24.81	24.54	24.01	23.89	23.60	23.48	23.70	20.00	23.37	18.99	12.89	9.30	6.98	10.20	11.61	11.85	14.20	13.67	23.336	13.98	15.00	19.81	22.76	23.93	23.88	23.92		
STATION	15+962	15+980	15+990	16+000	16+020	16+040	16+060	16+080	16+100	16+120	16+140	16+160	16+180	16+200	16+220	16+240	16+260	16+280	16+300	16+320	16+340	16+360	16+380	16+400	16+420	16+440	16+450	16+460	16+480	16+500	16+510	16+520	16+540	16+560	16+580	16+600	16+620	16+640
CURVE ELEMENT	R=00 L=956.886										A=250 L=125.000										R=500.000 L=189.202				A=250 L=125.000													