

Remarks The section of DH-3 from STA. 0+000 to STA. 4+270 is already improved as a dual 2-lane highway, and no further construction is required.
The balance section of DH-3 from STA. 4+270 to STA. 9+205 is currently upgraded by DPWH, and, consequently, the design of DH-3 is not included in the Feasibility Study.

CL-04
N.=1589988.199

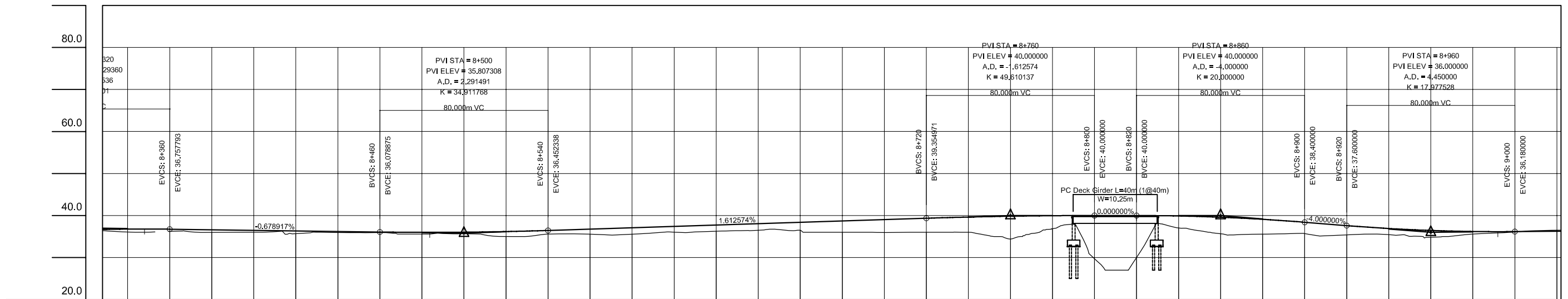

GRADE	-0.679%										1.613%										LEVEL										-4.000%										0.450%																															
PROPOSED HEIGHT	36.780	36.758	36.622	36.486	36.350	36.215	36.079	36.000	36.036	36.187	36.452	36.775	37.097	37.420	37.742	38.065	38.387	38.710	39.032	39.355	39.637	39.839	39.960	40.000	40.000	39.900	39.600	39.100	38.400	37.600	36.911	36.445	36.201	36.180																																						
GROUND HEIGHT	36.40	36.08	36.23	36.10	36.00	35.68	35.96	35.94	35.59	35.63	35.00	35.57	35.56	35.58	36.05	36.26	36.51	36.49	36.00	35.95	36.00	34.42	36.86	29.73	30.00	37.09	35.66	35.58	35.69	35.41	35.42	34.83	35.55	36.08																																						
STATION	8+328	8+340	8+360	8+380	8+400	8+420	8+440	8+460	8+480	8+500	8+520	8+540	8+560	8+580	8+600	8+620	8+640	8+660	8+680	8+700	8+720	8+740	8+760	8+780	8+800	8+820	8+840	8+860	8+880	8+900	8+920	8+940	8+960	8+980	9+000																																					
CURVE ELEMENT	A=100 L=33.333		R=0 L=242.191										A=70 L=32.667										R=0 L=109.593										A=80 L=26.600										R=250.000 L=101.644										A=80 L=25.800										R=0 L=197.529									