

GRADE	2.812%		223.413		4.000%		242.613		LEVEL																																
PROPOSED HEIGHT	219.51	219.97	221.164	221.726	222.288	222.569	222.861	223.502	224.223	224.613	225.013	225.813	226.613	227.413	228.213	229.013	229.813	230.613	231.413	232.213	233.013	233.813	234.613	235.413	236.213	237.013	237.813	238.613	239.413	240.213	240.946	241.546	242.013	242.346	242.546	242.613	242.613	242.613	242.613		
GROUND HEIGHT	219.51	219.97	220.42	220.64	220.64	221.76	221.76	223.20	224.54	224.613	225.40	226.01	226.29	226.75	227.04	227.54	228.13	228.90	229.58	230.41	231.23	231.66	232.27	232.90	233.81	235.56	237.30	239.04	240.81	242.05	242.22	242.84	243.22	243.56	242.54	241.80	241.81	241.60	242.613	242.613	242.613
STATION	27+066	27+080	27+100	27+120	27+130	27+140	27+160	27+180	27+190	27+200	27+220	27+240	27+260	27+280	27+300	27+320	27+340	27+360	27+380	27+400	27+420	27+440	27+460	27+480	27+500	27+520	27+540	27+560	27+580	27+600	27+620	27+640	27+660	27+680	27+700	27+720	27+740	27+740	27+740	27+740	27+740
CURVE ELEMENT	R=00 L=1606.594																																								

**JICA** JAPAN INTERNATIONAL COOPERATION AGENCY  
 DEPARTMENT OF PUBLIC WORKS AND HIGHWAYS

**ALMEC** ALMEC CORPORATION  
 NIPPON KOEI CO., LTD.

REMARKS:

THE FEASIBILITY STUDY AND IMPLEMENTATION SUPPORT  
 ON THE CALA EAST-WEST NATIONAL ROAD PROJECT

DRAWING TITLE: North-South Road Plan & Profile (40/41)

SCALE: 1:2,000  
 DRAWING NO.: NS-40  
 SHEET NO.:

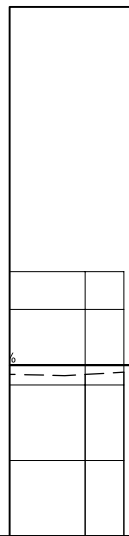
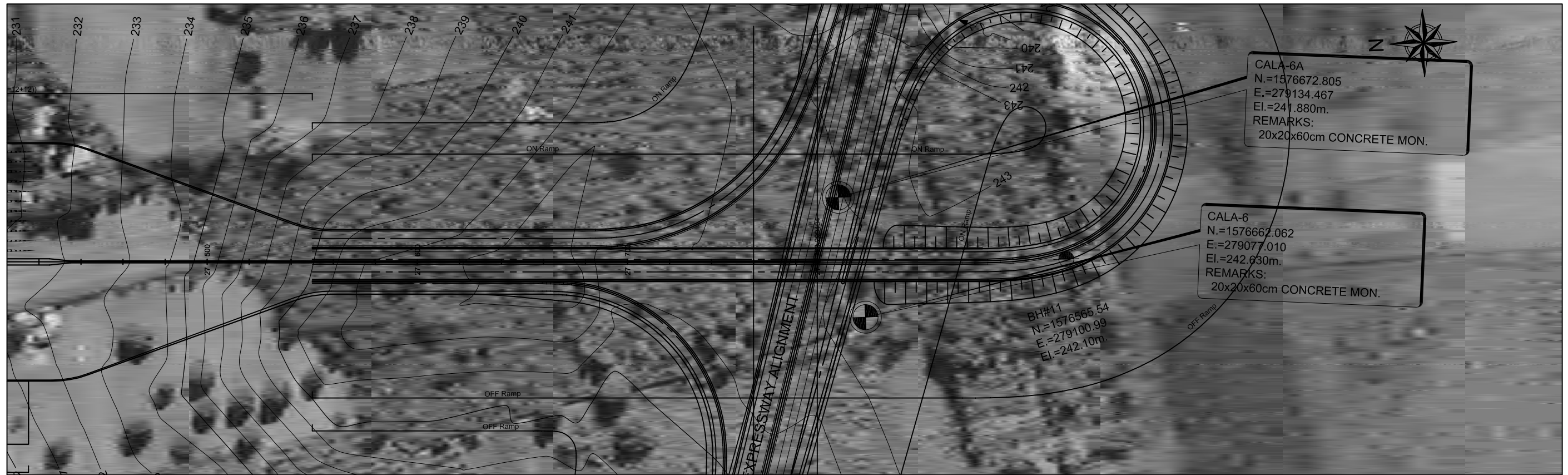

GRADE	LEVEL	
	PROPOSED HEIGHT	242.613
GROUND HEIGHT	241.41	241.40
STATION	27+760	27+780 27+790
CURVE ELEMENT	R=00 L=1606.594	