

GRADE	4.000%																												LEVEL										0.778%									
PROPOSED HEIGHT	122.800	123.600	124.400	125.200	126.000	126.800	127.600	128.400	128.600	129.144	129.694	130.044	130.194	130.200	130.200	130.200	130.200	130.219	130.278	130.375	130.511	130.667	130.822	130.978	131.133	131.289	131.444	131.600	131.756	131.911	132.067	132.222	132.378	132.585	132.897													
GROUND HEIGHT	113.55	113.54	113.44	112.71	112.48	114.35	115.86	117.19	119.89	120.63	120.42	119.57	119.85	130.194	130.200	121.77	122.42	122.13	122.33	123.66	124.18	125.65	126.74	129.69	132.32	132.31	131.04	130.11	129.27	128.72	128.74	128.75	128.20	127.54	128.73	128.99	130.67											
STATION	22+208	22+220	22+240	22+260	22+280	22+300	22+320	22+340	22+360	22+365	22+380	22+400	22+420	22+440	22+445	22+460	22+480	22+500	22+520	22+540	22+560	22+580	22+600	22+620	22+640	22+660	22+680	22+700	22+720	22+740	22+760	22+780	22+800	22+820	22+840	22+860	22+880											
CURVE ELEMENT	A=80 L=32.000		R=200.000 L=155.044										A=80 L=32.000		R=0 L=413.523										A=180 L=81.000																							

JICA JAPAN INTERNATIONAL COOPERATION AGENCY
DPWH DEPARTMENT OF PUBLIC WORKS AND HIGHWAYS

ALMEC ALMEC CORPORATION
NKC NIPPON KOEI CO., LTD.

REMARKS:

THE FEASIBILITY STUDY AND IMPLEMENTATION SUPPORT
 ON THE CALA EAST-WEST NATIONAL ROAD PROJECT

DRAWING TITLE: North-South Road Plan & Profile (33/41)

SCALE	1:2,000
DRAWING NO.	NS-33
SHEET NO.	

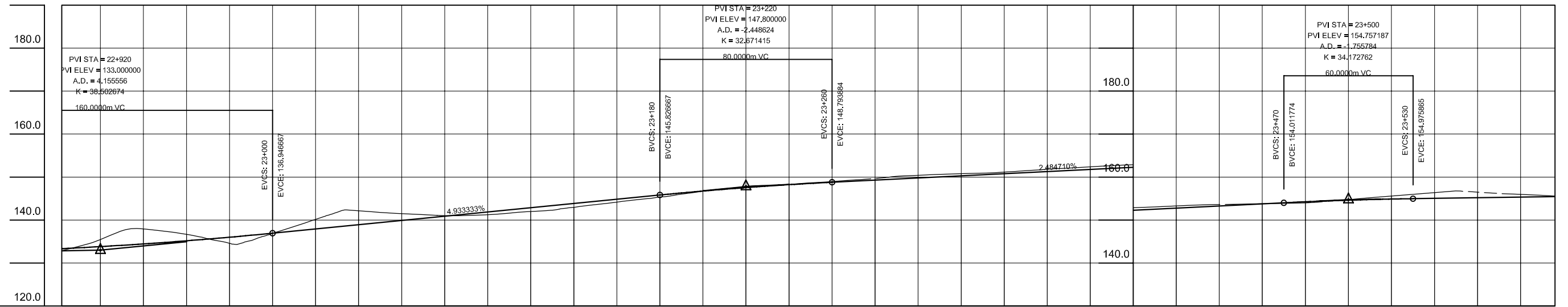

GRADE	4.933%										2.485%										0.729%																					
PROPOSED HEIGHT	133.831	134.454	135.181	136.012	136.947	137.933	138.920	139.907	140.893	141.880	142.867	143.853	144.840	145.827	146.752	147.555	148.236	148.794	149.291	149.788	150.285	150.782	151.279	151.776	152.272	152.769	153.266	153.763	154.012	154.246	154.626	154.888	154.976	155.049	155.195	155.340						
GROUND HEIGHT	132.87	135.47	137.95	136.69	134.58	136.91	140.16	142.16	141.49	141.03	141.25	142.00	142.87	142.97	144.17	144.840	145.34	146.70	147.79	148.28	148.96	148.794	149.69	150.41	150.79	151.16	151.83	152.39	152.87	153.28	153.63	153.63	153.266	153.81	154.012	154.246	154.76	155.60	156.39	156.49	156.00	156.00
STATION	22+902	22+920	22+940	22+960	22+980	23+000	23+020	23+040	23+060	23+080	23+100	23+120	23+140	23+160	23+180	23+200	23+220	23+240	23+260	23+280	23+300	23+320	23+340	23+360	23+380	23+400	23+420	23+440	23+460	23+470	23+480	23+500	23+520	23+530	23+540	23+560	23+580					
CURVE ELEMENT	A=180, L=81.000		R=400.000, L=177.923										A=180, L=81.000										R=700.000, L=349.206																			

		REMARKS:	THE FEASIBILITY STUDY AND IMPLEMENTATION SUPPORT ON THE CALA EAST-WEST NATIONAL ROAD PROJECT	
			DRAWING TITLE: North-South Road Plan & Profile (34/41)	SCALE: 1:2,000 DRAWING NO.: NS-34 SHEET NO.: