

GRADE	0.567%										0.760%										1.174%																
PROPOSED HEIGHT	7.847	7.960	8.073	8.191	8.319	8.457	8.604	8.756	8.908	9.060	9.212	9.364	9.516	9.668	9.820	9.972	10.124	10.276	10.428	10.580	10.732	10.884	11.036	11.188	11.340	11.492	11.644	11.796	11.958	12.110	12.262	12.414	12.566	12.718	12.870	13.022	13.174
GROUND HEIGHT	7.34	7.24	7.34	7.97	7.99	7.98	8.05	8.09	8.04	8.05	8.02	8.37	8.54	9.02	9.21	9.40	9.02	9.62	9.60	10.09	10.22	10.12	10.35	10.19	10.68	11.09	11.42	11.25	11.20	11.55	12.06	12.05	12.31	12.23	12.51		
STATION	4+868	4+880	4+900	4+920	4+940	4+960	4+980	5+000	5+020	5+040	5+060	5+080	5+100	5+120	5+140	5+160	5+180	5+200	5+220	5+240	5+260	5+280	5+300	5+320	5+340	5+360	5+380	5+400	5+420	5+440	5+460	5+480	5+500	5+520	5+540		
CURVE ELEMENT	R=00 L=149.918		A=60 L=24.000		R=150.000 L=86.581		A=60 L=24.000		R=00 L=723.900																												

JICA JAPAN INTERNATIONAL COOPERATION AGENCY
DPWH DEPARTMENT OF PUBLIC WORKS AND HIGHWAYS

ALMEC ALMEC CORPORATION
NKC NIPPON KOEI CO., LTD.

REMARKS:

THE FEASIBILITY STUDY AND IMPLEMENTATION SUPPORT
 ON THE CALA EAST-WEST NATIONAL ROAD PROJECT

DRAWING TITLE: North-South Road Plan & Profile (8 /41)

SCALE: 1:2,000
 DRAWING NO.: NS-8
 SHEET NO.:

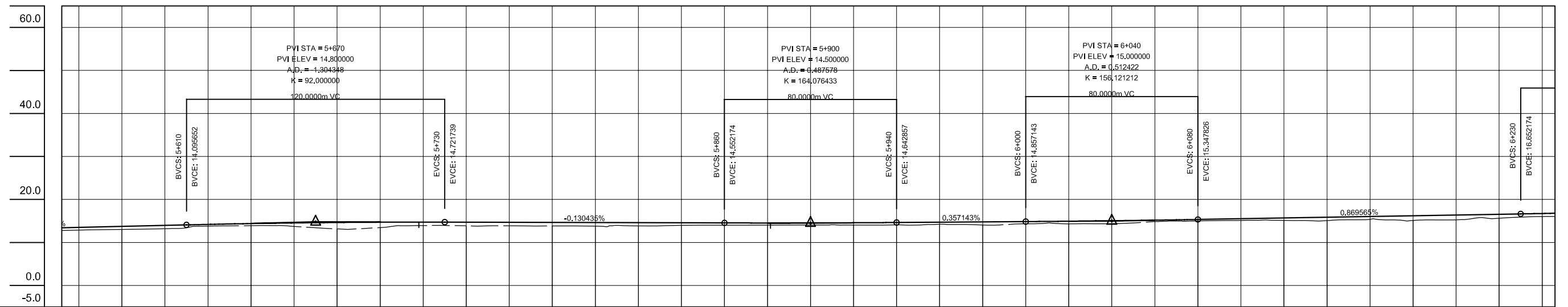

GRADE	1.174%		14.800										-0.130%		14.500						0.357%				15.000				0.870%				17.000						
PROPOSED HEIGHT	13.509	13.743	13.978	14.096	14.208	14.399	14.547	14.651	14.712	14.729	14.722	14.709	14.683	14.657	14.630	14.604	14.578	14.552	14.538	14.549	14.584	14.643	14.714	14.786	14.857	14.941	15.051	15.187	15.348	15.522	15.696	15.870	16.043	16.217	16.391	16.565	16.652	16.739	
GROUND HEIGHT	12.80	12.88	13.03	13.21	13.81	13.92	13.74	13.17	13.47	13.93	13.87	13.87	13.89	13.85	13.81	13.86	14.00	14.02	14.04	14.05	14.06	14.09	14.26	14.08	14.33	14.36	14.38	14.87	15.02	15.13	15.12	15.09	15.42	15.13	15.27	15.63	16.02		
STATION	5+552	5+560	5+580	5+600	5+610	5+620	5+640	5+660	5+680	5+700	5+720	5+730	5+740	5+760	5+780	5+800	5+820	5+840	5+860	5+880	5+900	5+920	5+940	5+960	5+980	6+000	6+020	6+040	6+060	6+080	6+100	6+120	6+140	6+160	6+180	6+200	6+220	6+230	6+240
CURVE ELEMENT	R=00 L=723.900										A=200 L=66.666						R=450.000 L=222.467																						