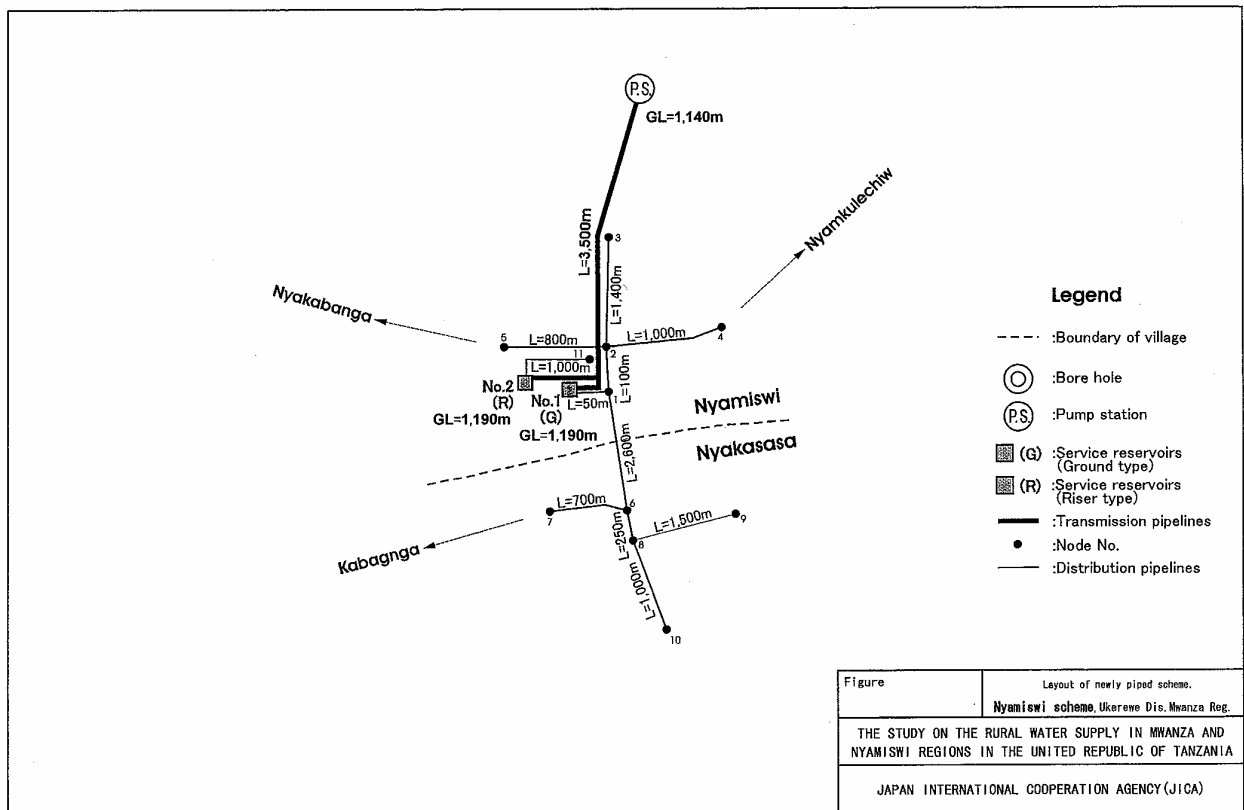
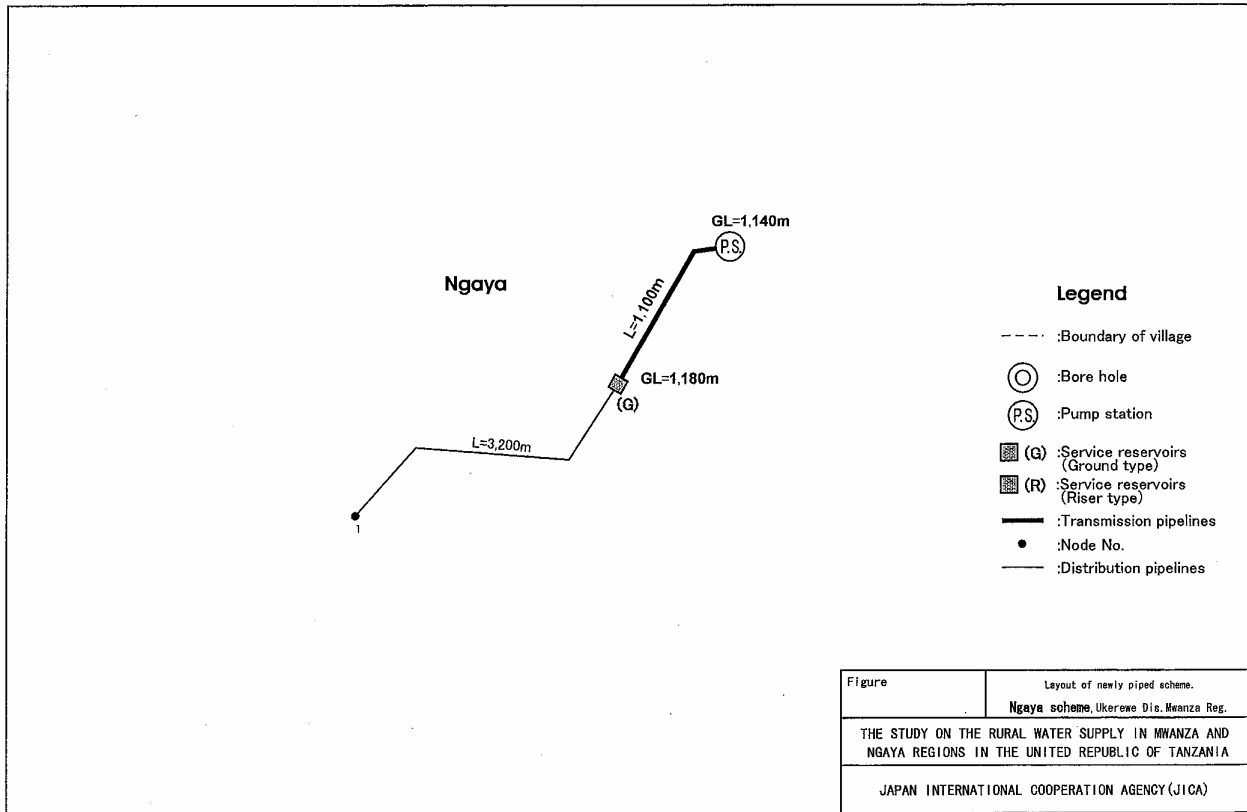
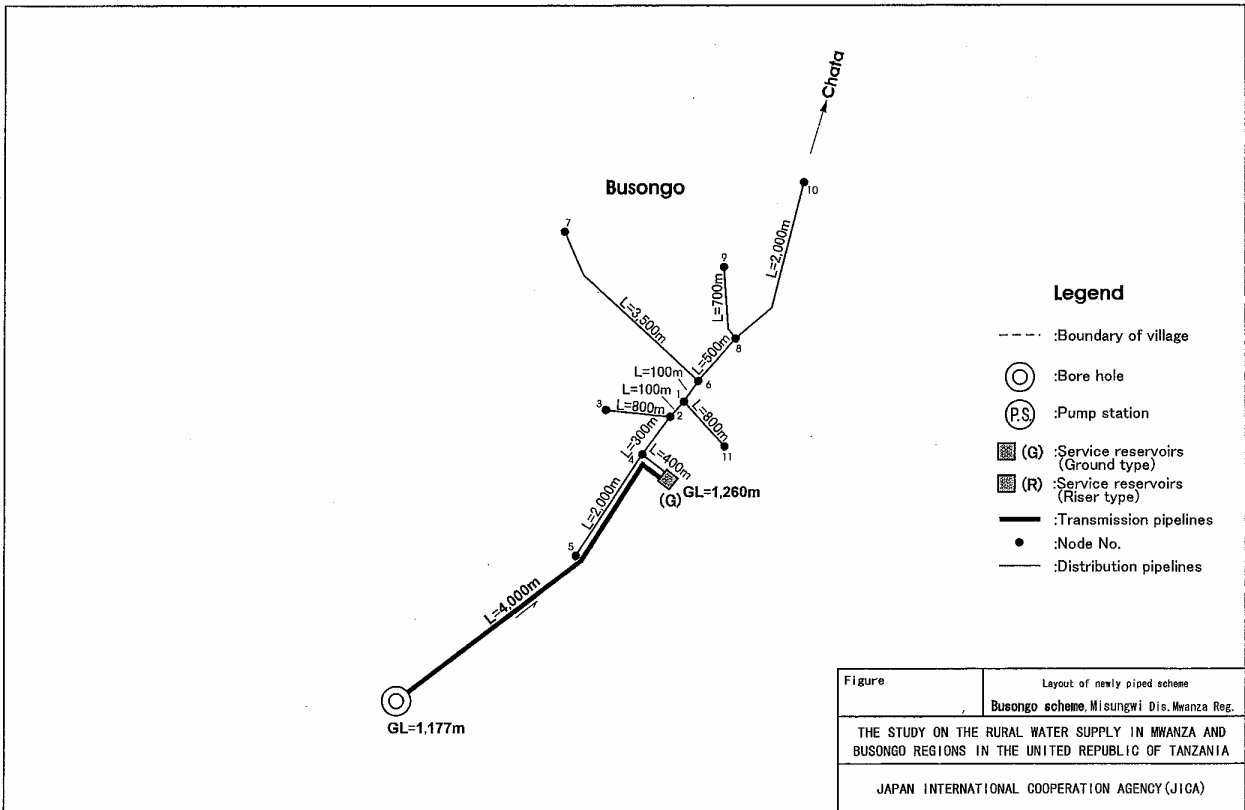
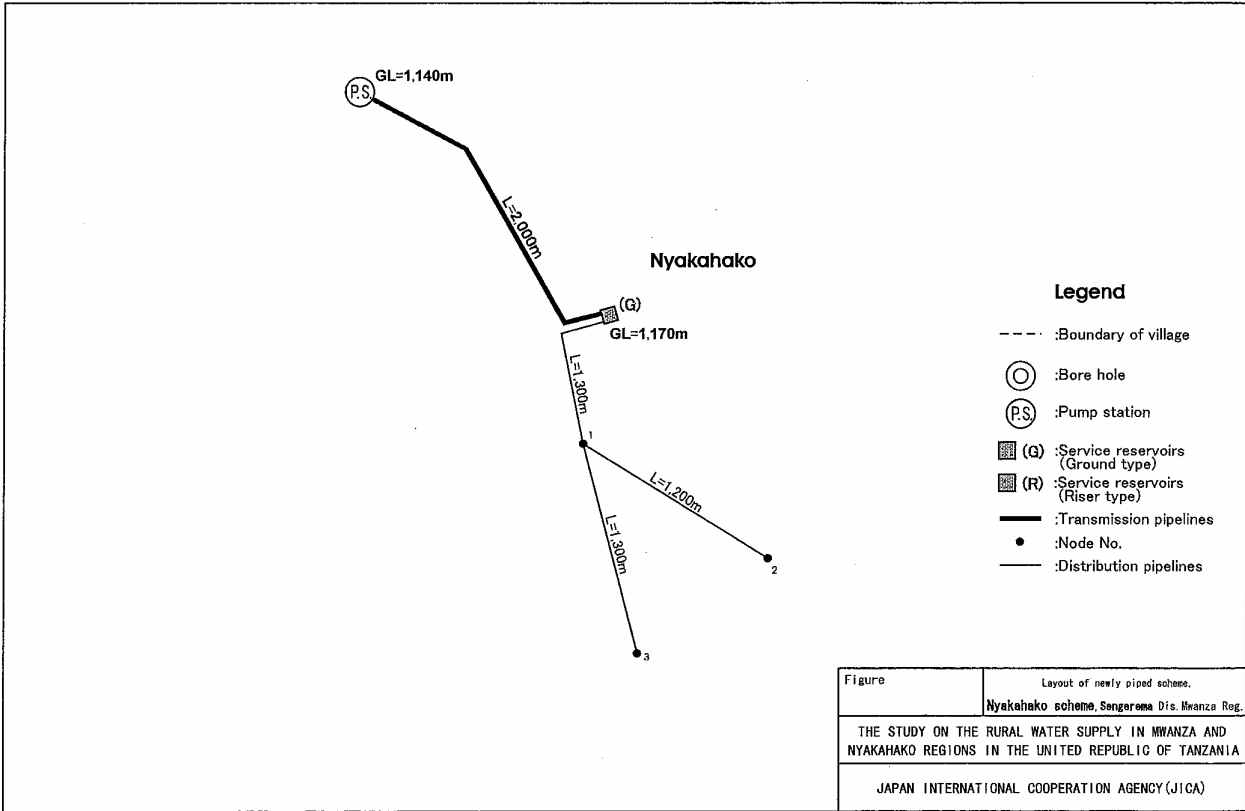

Figure	Rehabilitation and Expansion piped scheme.
	Musati Gravity scheme, Serengeti Dis. Mara Reg.
THE STUDY ON THE RURAL WATER SUPPLY IN MWANZA AND MARA REGIONS IN THE UNITED REPUBLIC OF TANZANIA	
JAPAN INTERNATIONAL COOPERATION AGENCY (JICA)	

8 Piped Schemes of Priority Project

① **Layout of Piped Scheme**





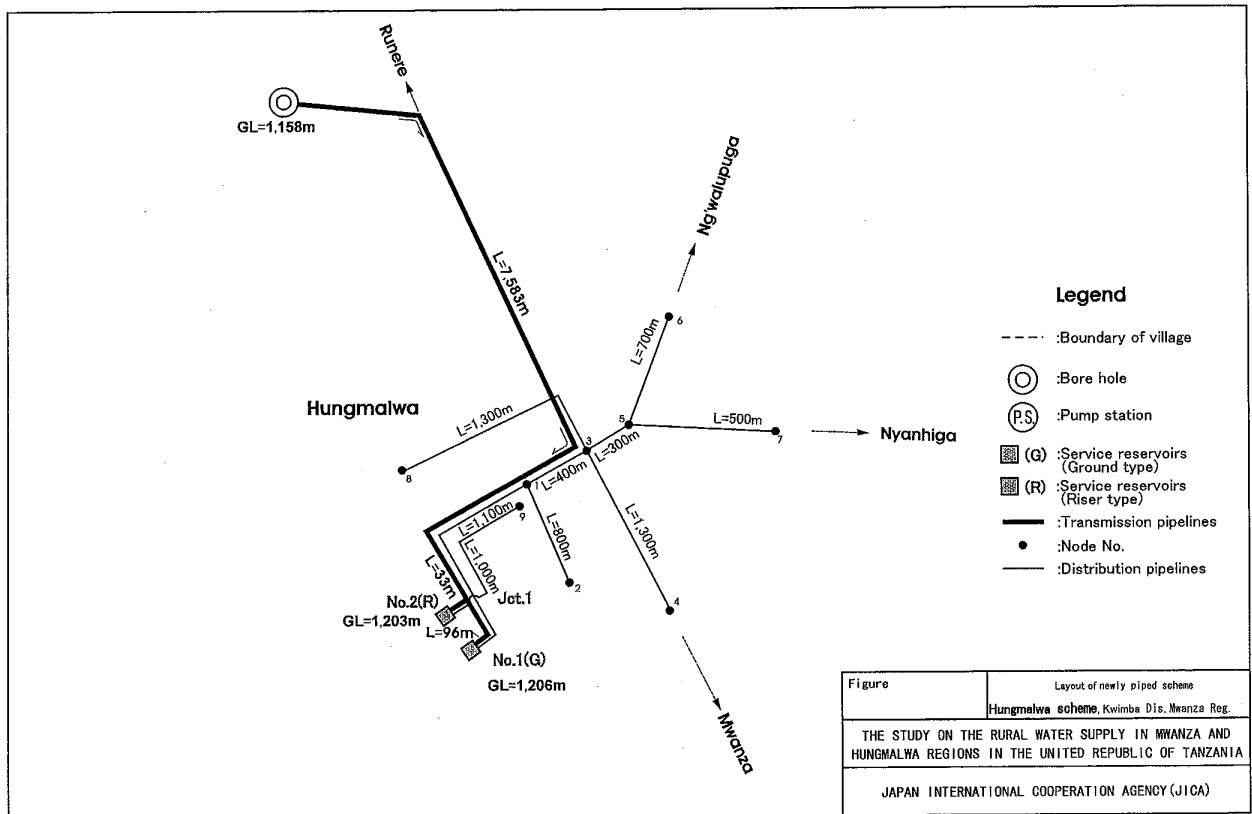
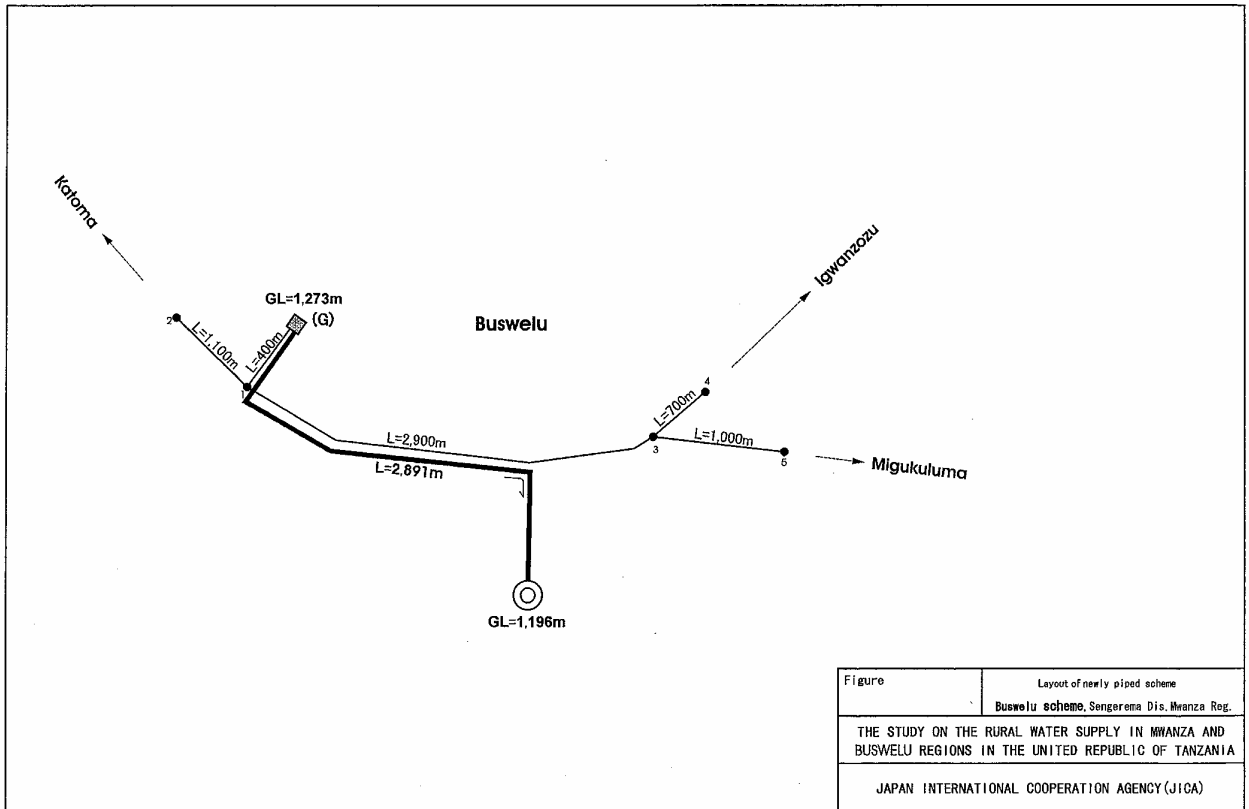

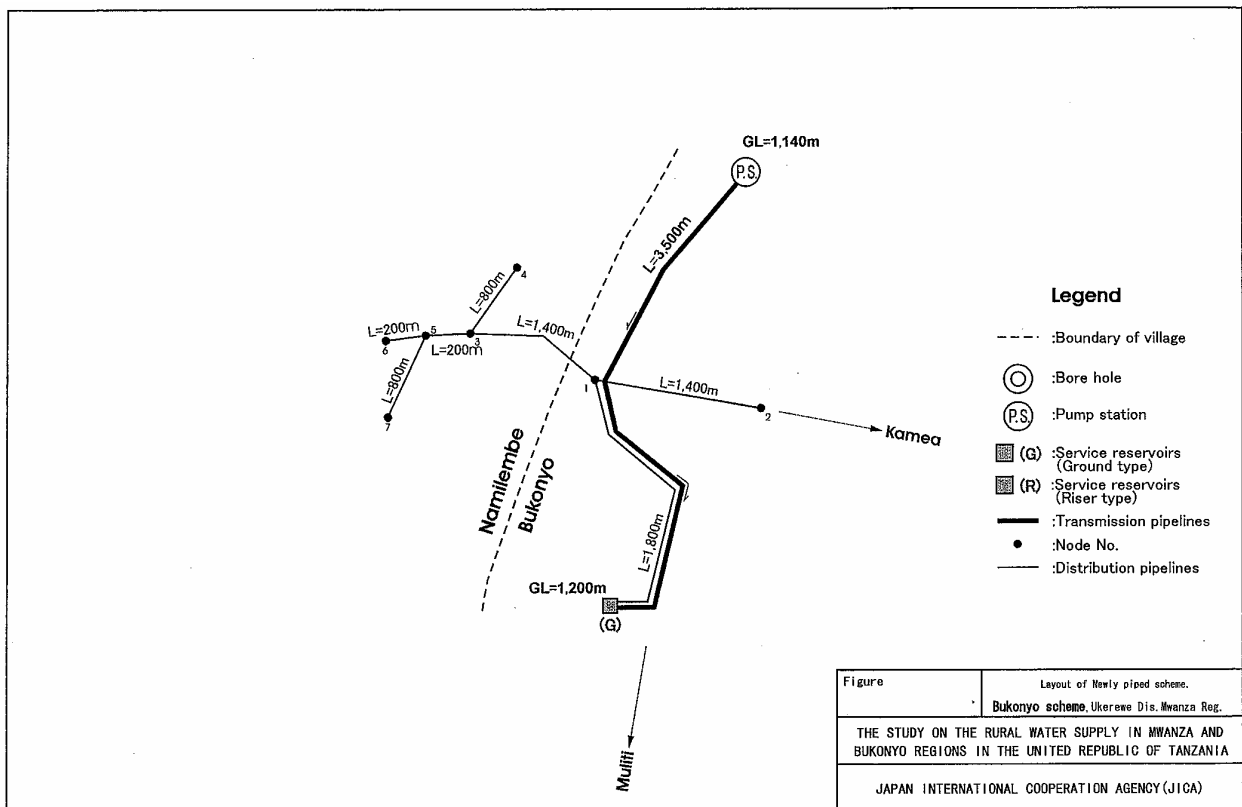
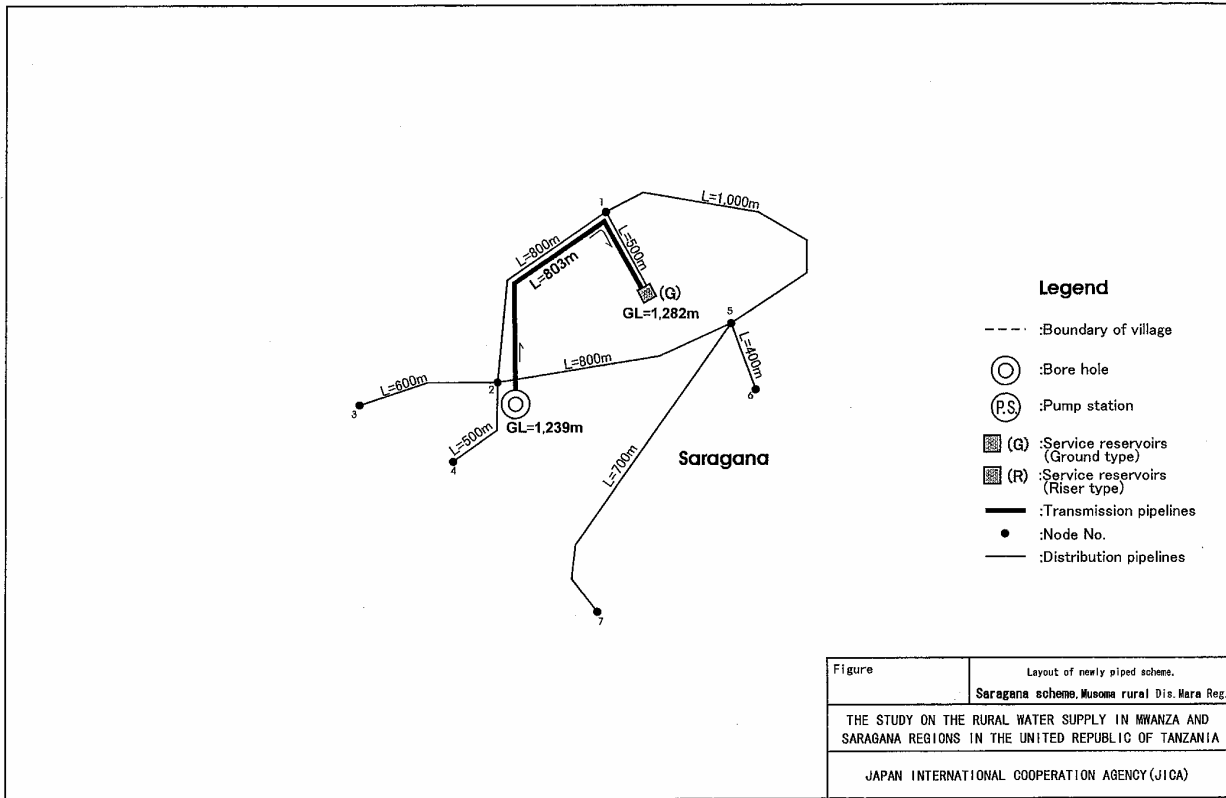

**② Hydrological Calculation of Transmission and
Distribution Line**

Table: Hydraulic Calculation of Transmission Pipelines (1/8)

Busongo Piped Scheme:

Node data

Node No.	Ground elevation (m)	Static level (m)	Effective head (m)
BH	1,177	1,177	
S.R.	1,260	1,265	5.0

H.W.L. of S.R. (m)	Elevation of P.S. (m)	Head loss (m)	Residual head (m)	Total head of pump (m)
1,263	1,177	3.2	5	94

Pipe data

Pipeline	Flow rate (m ³ /d)	Pipe length (m)	C	Velocity (m)	Hydraulic gradient	Pipe diameter (mm)	Head loss (m)	Flow type
BH → S.R.	207.4	4,000	120	0.27	0.00080	150	3.2	Pump

Pipe diameter (mm)	Pipe length (m)
50	
80	
100	
150	4,000
200	
250	
300	

Ngaya Piped Scheme:

Node data

Node No.	Ground elevation (m)	Static level (m)	Effective head (m)
P.S.	1,140	1,140	
S.R.	1,180	1,185	5.0

H.W.L. of S.R. (m)	Elevation of P.S. (m)	Head loss (m)	Residual head (m)	Total head of pump (m)
1,183	1,140	9.2	5	57

Pipe data

Pipeline	Flow rate (m ³ /d)	Pipe length (m)	C	Velocity (m)	Hydraulic gradient	Pipe diameter (mm)	Head loss (m)	Flow type
P.S. → S.R.	140.8	1,100	120	0.65	0.00837	80	9.2	Pump

Pipe diameter (mm)	Pipe length (m)
50	
80	1,100
100	
150	
200	
250	
300	

Table: Hydraulic Calculation of Transmission Pipelines (2/8)

Buswelu Piped Scheme:

Node data

Node No.	Ground elevation (m)	Static level (m)	Effective head (m)
BH	1,196	1,196	
S.R.	1,273	1,278	5.0

H.W.L. of S.R. (m)	Elevation of P.S. (m)	Head loss (m)	Residual head (m)	Total head of pump (m)
1,276	1,196	7.6	5	93

Pipe data

Pipeline			Flow rate (m ³ /d)	Pipe length (m)	C	Velocity (m)	Hydraulic gradient	Pipe diameter (mm)	Head loss (m)	Flow type
BH	→	S.R.	135.2	2,891	120	0.40	0.00262	100	7.6	Pump

Pipe diameter (mm)	Pipe length (m)
50	
80	
100	2,891
150	
200	
250	
300	

Nyamiswi Piped Scheme:

Node data

Node No.	Ground elevation (m)	Static level (m)	Effective head (m)
P.S.	1,140	1,140	
S.R. No.1 &2	1,190	1,195	5.0

H.W.L. of S.R. (m)	Elevation of P.S. (m)	Head loss (m)	Residual head (m)	Total head of pump (m)
1,198	1,140	7.3	5	70

Pipe data

Pipeline			Flow rate (m ³ /d)	Pipe length (m)	C	Velocity (m)	Hydraulic gradient	Pipe diameter (mm)	Head loss (m)	Flow type
P.S.	→	S.R. No.1 &2	348.5	3,500	120	0.46	0.00210	150	7.3	Pump

Pipe diameter (mm)	Pipe length (m)
50	
80	
100	
150	3,500
200	
250	
300	

Table: Hydraulic Calculation of Transmission Pipelines (3/8)

Nyakahako Piped Scheme:

Node data

Node No.	Ground elevation (m)	Static level (m)	Effective head (m)
P.S.	1,140	1,140	
S.R.	1,170	1,175	5.0

H.W.L. of S.R. (m)	Elevation of P.S. (m)	Head loss (m)	Residual head (m)	Total head of pump (m)
1,173	1,140	2.9	5	41

Pipe data

Pipeline		Flow rate (m ³ /d)	Pipe length (m)	C	Velocity (m)	Hydraulic gradient	Pipe diameter (mm)	Head loss (m)	Flow type
P.S.	→ S.R.	287.4	2,000	120	0.38	0.00147	150	2.9	Pump

Pipe diameter (mm)	Pipe length (m)
50	
80	
100	
150	2,000
200	
250	
300	

Hungumalwa Piped Scheme:

Node data

Node No.	Ground elevation (m)	Static level (m)	Effective head (m)
BH	1,158	1,158	
Jct.1	1,201	1,215	13.6
S.R. No.1	1,206	1,210	3.9
S.R. No.2	1,203	1,213	10.0

H.W.L. of S.R. (m)	Elevation of P.S. (m)	Head loss (m)	Residual head (m)	Total head of pump (m)
1,211	1,158	7.9	5	66

Pipe data

Pipeline		Flow rate (m ³ /d)	Pipe length (m)	C	Velocity (m)	Hydraulic gradient	Pipe diameter (mm)	Head loss (m)	Flow type
BH	→ Jct.1	211.9	7,583	120	0.28	0.00084	150	6.3	Pump
Jct.1	→ S.R. No.1	106.0	96	120	1.26	0.04883	50	4.7	Pump
Jct.1	→ S.R. No.2	106.0	33	120	1.26	0.04883	50	1.6	Pump

Pipe diameter (mm)	Pipe length (m)
50	129
80	
100	
150	7,583
200	
250	
300	

Table: Hydraulic Calculation of Transmission Pipelines (4/8)

Bukonyo Piped Scheme:

Node data

Node No.	Ground elevation (m)	Static level (m)	Effective head (m)
BH	1,158	1,158	
S.R. No.1	1,200	1,205	5.0

H.W.L. of S.R. (m)	Elevation of P.S. (m)	Head loss (m)	Residual head (m)	Total head of pump (m)
1,203	1,158	14.3	5	64

Pipe data

Pipeline		Flow rate (m ³ /d)	Pipe length (m)	C	Velocity (m)	Hydraulic gradient	Pipe diameter (mm)	Head loss (m)	Flow type
P.S.	→ S.R. No.1	172.0	3,500	120	0.51	0.00409	100	14.3	Pump

Pipe diameter (mm)	Pipe length (m)
50	
80	
100	3,500
150	
200	
250	
300	

Saragana Piped Scheme:

Node data

Node No.	Ground elevation (m)	Static level (m)	Effective head (m)
BH	1,239	1,239	
S.R.	1,282	1,287	5.0

H.W.L. of S.R. (m)	Elevation of P.S. (m)	Head loss (m)	Residual head (m)	Total head of pump (m)
1,285	1,239	9.8	5	61

Pipe data

Pipeline		Flow rate (m ³ /d)	Pipe length (m)	C	Velocity (m)	Hydraulic gradient	Pipe diameter (mm)	Head loss (m)	Flow type
BH	→ S.R.	172.6	803	120	0.80	0.01220	80	9.8	Pump

Pipe diameter (mm)	Pipe length (m)
50	
80	803
100	
150	
200	
250	
300	

Table: Hydraulic Calculation of Transmission Pipelines (5/8)

Busongo Piped Scheme:

Pipe data

Node No.			Diameter mm	Pipe length m	Flow m ³ /day	Velocity m/s	Headloss m/km
S.R.	→	4	150	400	-622.6	0.41	2.35
4	→	5	50	2,000	56.6	0.33	5.83
4	→	2	150	300	509.4	0.33	1.62
2	→	3	100	800	56.6	0.08	0.2
2	→	1	150	100	396.2	0.26	1.02
11	→	1	50	800	56.6	0.33	5.83
1	→	6	100	100	283.0	0.42	3.92
6	→	7	50	3,500	56.6	0.33	5.83
6	→	8	80	500	169.8	0.39	4.52
8	→	9	40	700	56.6	0.52	17.29
8	→	10	40	2,000	56.6	0.52	17.29
Total				11,200			

Pipe length by diameter

Diameter mm	Pipe length m
40	700
50	6,300
80	500
100	900
150	800
200	0
	9,200

Node data

Node No.	Elevation m	Base Demand CMD	Head m	Pressure m
2	1179	97.0	1,194.8	15.8
1	1180	97.0	1,197.0	17.0
3	1183	64.4	1,190.0	7.0
4	1182	64.4	1,189.4	7.4
5	1183	64.4	1,188.9	5.9
6	1183	64.4	1,187.4	4.4
7	1165	64.4	1,171.3	6.3
S.R.	1200		1,200.0	0.0

Ngaya Piped Scheme:

Pipe data

Node No.			Diameter mm	Pipe length m	Flow m ³ /day	Velocity m/s	Headloss m/km
S.R.	→	1	150	3,300	422.4	0.27	0.79
Total				3,300			

Pipe length by diameter

Diameter mm	Pipe length m
40	700
50	6,300
80	500
100	900
150	0
200	0
	8,400

Node data

Node No.	Elevation m	Base Demand CMD	Head m	Pressure m
1	1,160	422.4	1,197.0	37.0
S.R.	1,200		1,200.0	0.0

Table: Hydraulic Calculation of Transmission Pipelines (6/8)

Buswelu Piped Scheme:

Pipe data

Node No.			Diameter mm	Pipe length m	Flow m ³ /day	Velocity m/s	Headloss m/km
S.R.	→	1	80	400	441.5	1.02	18.92
1	→	2	50	1,100	88.3	0.52	9.48
1	→	3	80	2,900	264.9	0.61	7.35
3	→	4	40	700	88.3	0.81	28.10
3	→	5	40	1,000	88.3	0.81	28.10
Total				6,100			

Pipe length by diameter

Diameter mm	Pipe length m
40	0
50	2,000
80	0
100	800
150	700
200	0
	3,500

Node data

Node No.	Elevation m	Base Demand CMD	Head m	Pressure m
1	1,235	88.3	1,265.4	30.4
3	1,205	88.3	1,244.1	39.1
4	1,218	88.3	1,224.5	6.5
5	1,200	88.3	1,216.0	16.0
2	1,225	88.3	1,255.0	30.0
S.R.	1,273		1,273.0	0.0

Nyamiswi Piped Scheme:

Pipe data

Node No.			Diameter mm	Pipe length m	Flow m ³ /day	Velocity m/s	Headloss m/km
S.R. No.1	→	1	150	50	892.0	0.58	4.56
1	→	2	80	100	145.2	0.33	3.38
2	→	4	40	1,000	36.3	0.33	7.59
2	→	5	40	800	36.3	0.33	7.59
2	→	3	40	1,400	36.3	0.33	7.59
1	→	6	150	2,600	710.5	0.47	3.00
6	→	7	100	700	142.1	0.21	1.10
6	→	8	100	250	426.3	0.63	8.38
8	→	9	80	1,500	142.1	0.33	3.25
8	→	10	80	1,000	142.1	0.33	3.25
S.R. No.2	→	11	80	1,000	225.0	0.52	7.61
Total				10,400			

Pipe length by diameter

Diameter mm	Pipe length m
40	700
50	6,300
80	500
100	900
150	800
200	0
	9,200

Node data

Node No.	Elevation m	Base Demand CMD	Head m	Pressure m
5	1,170	36.3	1185.2	15.2
2	1,184	36.3	1189.5	5.5
1	1,185	36.3	1189.8	4.8
4	1,172	36.3	1184.1	12.1
3	1,158	36.3	1182.0	24.0
6	1,174	142.1	1184.2	10.2

Table: Hydraulic Calculation of Transmission Pipelines (7/8)

Nyakahako Piped Scheme:

Pipe data

Node No.			Diameter mm	Pipe length m	Flow m ³ /day	Velocity m/s	Headloss m/km
S.R.	→	1	150	1,300	862.5	0.57	3.06
1	→	3	150	1,300	287.5	0.19	0.40
1	→	2	150	1,200	287.5	0.19	0.40
Total				3,800			

Pipe length by diameter

Diameter mm	Pipe length m
40	0
50	6,300
80	0
100	900
150	800
200	0
	8,000

Node data

Node No.	Elevation m	Base Demand CMD	Head m	Pressure m
1	1,159	287.5	1166.0	7.0
2	1,160	287.5	1165.5	5.5
3	1,155	287.5	1165.5	10.5
S.R.	1,170		1170.0	0.0

Hungumalwa Piped Scheme:

Pipe data

Node No.			Diameter mm	Pipe length m	Flow m ³ /day	Velocity m/s	Headloss m/km
S.R. No.1	→	1	150	1,100	443.2	0.29	0.89
1	→	2	80	800	55.4	0.13	0.40
1	→	3	100	400	332.4	0.49	3.77
3	→	4	80	1,300	55.4	0.13	0.41
3	→	5	80	300	166.2	0.38	3.10
5	→	7	80	500	55.4	0.13	0.40
5	→	6	80	700	55.4	0.13	0.40
3	→	8	80	1,300	55.4	0.13	0.41
S.R. No.2	→	9	80	1,000	225	0.52	5.43
Total				7,400			

Pipe length by diameter

Diameter mm	Pipe length m
40	0
50	6,300
80	0
100	900
150	800
200	0
	8,000

Node data

Node No.	Elevation m	Base Demand CMD	Head m	Pressure m
1	1,200	55.4	1205.0	5.0
2	1,200	55.4	1204.7	4.7
3	1,195	55.4	1203.5	8.5
4	1,194	55.4	1203.0	9.0
5	1,194	55.4	1202.6	8.6
7	1,196	55.4	1202.4	6.4
6	1,190	55.4	1202.3	12.3
8	1,200	55.4	1203.0	3.0
9	1,202	225	1207.6	5.6
S.R.No.2	1,213		1213.0	0.0
S.R.No.1	1,206		1206.0	0.0

Table: Hydraulic Calculation of Transmission Pipelines (8/8)

Bukonyo Piped Scheme:

Pipe data

Node No.			Diameter mm	Pipe length m	Flow m ³ /day	Velocity m/s	Headloss m/km
S.R.	→	1	150	1,800	516.0	0.34	1.66
1	→	2	80	1,400	97.0	0.22	1.60
1	→	3	100	1,400	322.0	0.47	4.98
3	→	4	80	800	64.4	0.15	0.75
3	→	5	80	200	193.2	0.45	5.74
5	→	7	40	800	64.4	0.59	21.95
5	→	6	50	200	64.4	0.38	7.40
Total				6,600			

Pipe length by diameter

Diameter mm	Pipe length m
40	0
50	2,800
80	0
100	800
150	800
200	0
	4,400

Node data

Node No.	Elevation m	Base Demand CMD	Head m	Pressure m
2	1,179	97.0	1194.8	15.8
1	1,180	97.0	1197.0	17.0
3	1,183	64.4	1190.0	7.0
4	1,182	64.4	1189.4	7.4
5	1,183	64.4	1188.9	5.9
6	1,183	64.4	1187.4	4.4
7	1,165	64.4	1171.3	6.3
S.R.	1,200		1200.0	0.0

Saragana Piped Scheme:

Pipe data

Node No.			Diameter mm	Pipe length m	Flow m ³ /day	Velocity m/s	Headloss m/km
S.R.	→	1	100	500	524.3	0.77	8.77
1	→	5	80	1,000	211.5	0.49	4.84
5	→	6	40	400	74.9	0.69	20.72
5	→	7	50	700	74.9	0.44	6.99
5	→	2	80	800	-13.2	0.03	0.03
2	→	4	40	500	74.9	0.69	20.72
2	→	3	40	600	74.9	0.69	20.72
2	→	1	80	800	-237.9	0.55	6.02
Total				5,300			

Pipe length by diameter

Diameter mm	Pipe length m
40	0
50	2,800
80	0
100	900
150	800
200	0
	4,500

Node data

Node No.	Elevation m	Base Demand CMD	Head m	Pressure m
1	1,241	74.9	1,277.6	36.6
5	1,262	74.9	1,272.8	10.8
6	1,250	74.9	1,264.5	14.5
7	1,220	74.9	1,267.9	47.9
2	1,240	74.9	1,272.8	32.8
4	1,232	74.9	1,262.4	30.4
3	1,232	74.9	1,260.4	28.4
S.R.	1,282		1282.0	0.0

Table: Hydraulic Calculation of Transmission Pipelines (5/8)

Busongo Piped Scheme:

Pipe data

Node No.			Diameter mm	Pipe length m	Flow m ³ /day	Velocity m/s	Headloss m/km
S.R.	→	4	150	400	-622.6	0.41	2.35
4	→	5	50	2,000	56.6	0.33	5.83
4	→	2	150	300	509.4	0.33	1.62
2	→	3	100	800	56.6	0.08	0.2
2	→	1	150	100	396.2	0.26	1.02
11	→	1	50	800	56.6	0.33	5.83
1	→	6	100	100	283.0	0.42	3.92
6	→	7	50	3,500	56.6	0.33	5.83
6	→	8	80	500	169.8	0.39	4.52
8	→	9	40	700	56.6	0.52	17.29
8	→	10	40	2,000	56.6	0.52	17.29
Total				11,200			

Pipe length by diameter

Diameter mm	Pipe length m
40	700
50	6,300
80	500
100	900
150	800
200	0
	9,200

Node data

Node No.	Elevation m	Base Demand CMD	Head m	Pressure m
2	1179	97.0	1,194.8	15.8
1	1180	97.0	1,197.0	17.0
3	1183	64.4	1,190.0	7.0
4	1182	64.4	1,189.4	7.4
5	1183	64.4	1,188.9	5.9
6	1183	64.4	1,187.4	4.4
7	1165	64.4	1,171.3	6.3
S.R.	1200		1,200.0	0.0

Ngaya Piped Scheme:

Pipe data

Node No.			Diameter mm	Pipe length m	Flow m ³ /day	Velocity m/s	Headloss m/km
S.R.	→	1	150	3,300	422.4	0.27	0.79
Total				3,300			

Pipe length by diameter

Diameter mm	Pipe length m
40	700
50	6,300
80	500
100	900
150	0
200	0
	8,400

Node data

Node No.	Elevation m	Base Demand CMD	Head m	Pressure m
1	1,160	422.4	1,197.0	37.0
S.R.	1,200		1,200.0	0.0

Table: Hydraulic Calculation of Transmission Pipelines (6/8)

Buswelu Piped Scheme:

Pipe data

Node No.			Diameter mm	Pipe length m	Flow m ³ /day	Velocity m/s	Headloss m/km
S.R.	→	1	80	400	441.5	1.02	18.92
1	→	2	50	1,100	88.3	0.52	9.48
1	→	3	80	2,900	264.9	0.61	7.35
3	→	4	40	700	88.3	0.81	28.10
3	→	5	40	1,000	88.3	0.81	28.10
Total				6,100			

Pipe length by diameter

Diameter mm	Pipe length m
40	0
50	2,000
80	0
100	800
150	700
200	0
	3,500

Node data

Node No.	Elevation m	Base Demand CMD	Head m	Pressure m
1	1,235	88.3	1,265.4	30.4
3	1,205	88.3	1,244.1	39.1
4	1,218	88.3	1,224.5	6.5
5	1,200	88.3	1,216.0	16.0
2	1,225	88.3	1,255.0	30.0
S.R.	1,273		1,273.0	0.0

Nyamiswi Piped Scheme:

Pipe data

Node No.			Diameter mm	Pipe length m	Flow m ³ /day	Velocity m/s	Headloss m/km
S.R. No.1	→	1	150	50	892.0	0.58	4.56
1	→	2	80	100	145.2	0.33	3.38
2	→	4	40	1,000	36.3	0.33	7.59
2	→	5	40	800	36.3	0.33	7.59
2	→	3	40	1,400	36.3	0.33	7.59
1	→	6	150	2,600	710.5	0.47	3.00
6	→	7	100	700	142.1	0.21	1.10
6	→	8	100	250	426.3	0.63	8.38
8	→	9	80	1,500	142.1	0.33	3.25
8	→	10	80	1,000	142.1	0.33	3.25
S.R. No.2	→	11	80	1,000	225.0	0.52	7.61
Total				10,400			

Pipe length by diameter

Diameter mm	Pipe length m
40	700
50	6,300
80	500
100	900
150	800
200	0
	9,200

Node data

Node No.	Elevation m	Base Demand CMD	Head m	Pressure m
5	1,170	36.3	1185.2	15.2
2	1,184	36.3	1189.5	5.5
1	1,185	36.3	1189.8	4.8
4	1,172	36.3	1184.1	12.1
3	1,158	36.3	1182.0	24.0
6	1,174	142.1	1184.2	10.2

Table: Hydraulic Calculation of Transmission Pipelines (7/8)

Nyakahako Piped Scheme:

Pipe data

Node No.			Diameter mm	Pipe length m	Flow m3/day	Velocity m/s	Headloss m/km
S.R.	→	1	150	1,300	862.5	0.57	3.06
1	→	3	150	1,300	287.5	0.19	0.40
1	→	2	150	1,200	287.5	0.19	0.40
Total				3,800			

Pipe length by diameter

Diameter mm	Pipe length m
40	0
50	6,300
80	0
100	900
150	800
200	0
	8,000

Node data

Node No.	Elevation m	Base Demand CMD	Head m	Pressure m
1	1,159	287.5	1166.0	7.0
2	1,160	287.5	1165.5	5.5
3	1,155	287.5	1165.5	10.5
S.R.	1,170		1170.0	0.0

Hungumalwa Piped Scheme:

Pipe data

Node No.			Diameter mm	Pipe length m	Flow m3/day	Velocity m/s	Headloss m/km
S.R. No.1	→	1	150	1,100	443.2	0.29	0.89
1	→	2	80	800	55.4	0.13	0.40
1	→	3	100	400	332.4	0.49	3.77
3	→	4	80	1,300	55.4	0.13	0.41
3	→	5	80	300	166.2	0.38	3.10
5	→	7	80	500	55.4	0.13	0.40
5	→	6	80	700	55.4	0.13	0.40
3	→	8	80	1,300	55.4	0.13	0.41
S.R. No.2	→	9	80	1,000	225	0.52	5.43
Total				7,400			

Pipe length by diameter

Diameter mm	Pipe length m
40	0
50	6,300
80	0
100	900
150	800
200	0
	8,000

Node data

Node No.	Elevation m	Base Demand CMD	Head m	Pressure m
1	1,200	55.4	1205.0	5.0
2	1,200	55.4	1204.7	4.7
3	1,195	55.4	1203.5	8.5
4	1,194	55.4	1203.0	9.0
5	1,194	55.4	1202.6	8.6
7	1,196	55.4	1202.4	6.4
6	1,190	55.4	1202.3	12.3
8	1,200	55.4	1203.0	3.0
9	1,202	225	1207.6	5.6
S.R.No.2	1,213		1213.0	0.0
S.R.No.1	1,206		1206.0	0.0

Table: Hydraulic Calculation of Transmission Pipelines (8/8)

Bukonyo Piped Scheme:

Pipe data

Node No.			Diameter mm	Pipe length m	Flow m ³ /day	Velocity m/s	Headloss m/km
S.R.	→	1	150	1,800	516.0	0.34	1.66
1	→	2	80	1,400	97.0	0.22	1.60
1	→	3	100	1,400	322.0	0.47	4.98
3	→	4	80	800	64.4	0.15	0.75
3	→	5	80	200	193.2	0.45	5.74
5	→	7	40	800	64.4	0.59	21.95
5	→	6	50	200	64.4	0.38	7.40
Total				6,600			

Pipe length by diameter

Diameter mm	Pipe length m
40	0
50	2,800
80	0
100	800
150	800
200	0
	4,400

Node data

Node No.	Elevation m	Base Demand CMD	Head m	Pressure m
2	1,179	97.0	1194.8	15.8
1	1,180	97.0	1197.0	17.0
3	1,183	64.4	1190.0	7.0
4	1,182	64.4	1189.4	7.4
5	1,183	64.4	1188.9	5.9
6	1,183	64.4	1187.4	4.4
7	1,165	64.4	1171.3	6.3
S.R.	1,200		1200.0	0.0

Saragana Piped Scheme:

Pipe data

Node No.			Diameter mm	Pipe length m	Flow m ³ /day	Velocity m/s	Headloss m/km
S.R.	→	1	100	500	524.3	0.77	8.77
1	→	5	80	1,000	211.5	0.49	4.84
5	→	6	40	400	74.9	0.69	20.72
5	→	7	50	700	74.9	0.44	6.99
5	→	2	80	800	-13.2	0.03	0.03
2	→	4	40	500	74.9	0.69	20.72
2	→	3	40	600	74.9	0.69	20.72
2	→	1	80	800	-237.9	0.55	6.02
Total				5,300			

Pipe length by diameter

Diameter mm	Pipe length m
40	0
50	2,800
80	0
100	900
150	800
200	0
	4,500

Node data

Node No.	Elevation m	Base Demand CMD	Head m	Pressure m
1	1,241	74.9	1,277.6	36.6
5	1,262	74.9	1,272.8	10.8
6	1,250	74.9	1,264.5	14.5
7	1,220	74.9	1,267.9	47.9
2	1,240	74.9	1,272.8	32.8
4	1,232	74.9	1,262.4	30.4
3	1,232	74.9	1,260.4	28.4
S.R.	1,282		1282.0	0.0

9 Socio-economic Survey

① **Survey Sheet**

NTz project number 210023 Mwanza and Mara water project village questionnaire	ENUMERATOR TODAY'S DATE	DISTRICT VILLAGE	QUESTIONNAIRE NUMBER PAGE NUMBER 1
---	--------------------------------	-------------------------	--

1. Questionnaire sheet for Village Profile Survey

time now _____ at beginning of meeting; issue an attendance sheet for all to fill.

Table 1 village people

village total population	of whom, male
n ^o . of disabled people in the village	n ^o . of children in this village
number of households	<i>of whom</i> , female-headed hh n ^o .
.. hh moved <i>into</i> the village since 2002?	approx. n ^o . of hh moved <i>out</i> since 2002?
approx. n ^o . of hh with many livestock?	approx. n ^o . of hh without livestock?
ethnic groups (<i>largest first</i>)	
religious affiliation (<i>largest first</i>)	

Table 2 village government

name / sex of village chairperson	
How long has s/he been the chairperson?	When was this village established?
Which committees does the village council have? Which are active?	
How is the work of the committees financed?	
Please explain in detail about the water committee: its activities and funding.	

Table 3 other village organisations

Is there a village school? Describe.... (pupils, teachers, grades)	
Is there one or more church?	Is there one or more mosque?
How many water user groups does the village have? Describe.....	

NTz project number 210023 Mwanza and Mara water project village questionnaire	ENUMERATOR TODAY'S DATE	DISTRICT VILLAGE	QUESTIONNAIRE NUMBER PAGE NUMBER 2
---	--------------------------------	-------------------------	--

Please name and describe any <i>other</i> organisations that are active in this village. What do they do?	
Did this village participate in the HESAWA programme? If so, what did HESAWA achieve here in this village? What remains of that?	
What other projects have taken place in this village? (If possible, mention <i>funding, objective, achievements, villagers' participation, what remains now</i>).	

Table 4 village energy and transport

Village has one or more wood-lot?	Charcoal made here?
Village has electricity?	Who uses electricity?
Which is nearest town?	How far is that town?
How (<i>good/bad</i>) is the road to that town?	Buses link the village to town?
How is produce transported to market?	

Table 5 village products

Main farm products of this village?	
Which are consumed here?	
Which are sold, and where? (specify types and amounts if possible)	
What else (if anything) does this village produce?	
Which are sold, and where? (specify types and amounts if possible)	
Total livestock belonging to this village? (specify types)	

NTz project number 210023 Mwanza and Mara water project village questionnaire	ENUMERATOR TODAY'S DATE	DISTRICT VILLAGE	QUESTIONNAIRE NUMBER PAGE NUMBER 3
---	--------------------------------	-------------------------	--

Which other businesses are there in this village and around here? (specify types and whether done by villagers or outsiders)	
---	--

Table 6 health and sanitation

Health problems in this community?	
Is there a village clinic and/or dispensary? Describe....	
Does the village have any medical personnel (including nurse, midwife or TBA)? If yes, which?	
Any health campaigns or projects have been here?	If so, which?
Where do sick people go for treatment? Alternative choice?	
Do many households have their own latrines?	<i>(very few; some; many; all or nearly all)</i>

Table 7 water consumption in this village

Estimate the average daily use of water per person in this village (nº of 20-litre buckets)	Estimate the average daily use of water per household in this village (nº of 20-litre buckets)
If <i>average</i> is a problem, then in a range from ___ to ___ buckets per day in this village.	If <i>average</i> is a problem, then in a range from ___ to ___ buckets per day in this village.
Where are livestock watered?	
If people water their vegetable gardens, where do they get the water?	
What other uses of water are there in this village?	

NTz project number 210023 Mwanza and Mara water project village questionnaire	ENUMERATOR TODAY'S DATE	DISTRICT VILLAGE	QUESTIONNAIRE NUMBER PAGE NUMBER 4
---	--------------------------------	-------------------------	--

Table 8 village water supply sources

The village has any piped water supply? (If so, describe: number of pumps, whether working.)	
The village has one or more well? (If so, describe.)	
The village has one or more dam? (If so, describe.)	
Which are the main sources of water for non-household use (such as gardening, livestock?)	
Which are the main sources of household water in the wet season?	
Which are the main sources of household water in the dry season?	
How is the water quality in the dry season?	
What happens when the source runs dry? (Describe coping mechanisms.)	

Table 9 village water supply maintenance at the present time

Who maintains the water supply?	
Does that succeed?	
Do you have problems with spare parts? (if so, what problems?)	

Table 10 water supply problems and preferences

What don't you like about your current water supply?	
What type of water facilities would you like to be installed in your village?	
What do you like about those (<i>above mentioned</i>) water facilities?	
How do disadvantaged people (<i>elderly, sick, very poor</i>) get water? Do they have to pay anything?	

NTz project number 210023 Mwanza and Mara water project village questionnaire	ENUMERATOR TODAY'S DATE	DISTRICT VILLAGE	QUESTIONNAIRE NUMBER PAGE NUMBER 5
---	--------------------------------	-------------------------	--

Table 11 willingness and ability to pay for improved water supplies

What do you think the households in this village will be able to afford for water?	
for maintenance of the water supply system, per month (<i>tick one</i>)	less than TShs 500/= TShs 500 to 1000/= TShs 1000 to 1500/= TShs 1500 to 2000/= more than TShs 2000/=
per 20-litre bucket (<i>tick one</i>)	less than TShs 10/= TShs 10 or 15/= TShs 15 or 20/= more than TShs 20/=

time now _____ at the end of meeting; collect the attendance sheet.

NTz project number 210023 Mwanza and Mara water project village questionnaire	ENUMERATOR TODAY'S DATE	DISTRICT VILLAGE	QUESTIONNAIRE NUMBER PAGE NUMBER 6
---	--------------------------------	-------------------------	--

2. Questionnaire sheet for Sample Household Survey

time now _____ at beginning of interaction with this household

the respondent	<i>(the person who is answering the questions)</i>
name of respondent	
sex of respondent	(approximate) age of respondent
respondent's position in the household	
highest educational level of respondent	
occupation of respondent	

head of household <i>(if not the respondent)</i>	
name of head of household	
sex of head of household	(approximate) age of head of household
highest education level of head of household	
occupation of head of household	

this household <i>(the respondent's household)</i>	
languages spoken <i>(underline main one)</i>	
religion of this household	
How many adults in this household?	How many children in this household?
How many of those adults earn money?	How many of those children attend school?

this dwelling house	Year when this house was built?
Who owns this house?	
How many rooms in this house?	Other buildings in the same yard – yes/no?
Building materials of walls?	
Construction material of roof?	
indoor kitchen: yes/ no?	indoor bathroom: yes/ no?

NTz project number 210023 Mwanza and Mara water project village questionnaire	ENUMERATOR TODAY'S DATE	DISTRICT VILLAGE	QUESTIONNAIRE NUMBER PAGE NUMBER 7
---	--------------------------------	-------------------------	--

this dwelling house	Year when this house was built?
Any other notable features?	
Approximate location in village	

this household's health	
What health problems does this household have?	
Is anyone in this household sick now?	If <i>yes</i> , sick with what?
How do you cope with sickness?	

this household's sanitation	
Does this household have its own toilet?	
If so, what sort of toilet?	
If not, what do household members use?	

this household's present water supply	If it is early in the day, ask about ' <i>yesterday</i> ', instead of ' <i>today</i> '.
Where did you get water today?	
How far away is that source?	
How much did you pay for water today?	
To whom did you pay that money?	
Does that source always have water: <i>yes/</i> <i>no?</i> If not, where else do you get water?	
Is the water usually clean?	Do you have to wait long at the source?
How do you store water at home?	
What don't you like about your current water supply?	

NTz project number 210023 Mwanza and Mara water project village questionnaire	ENUMERATOR TODAY'S DATE	DISTRICT VILLAGE	QUESTIONNAIRE NUMBER PAGE NUMBER 8
---	--------------------------------	-------------------------	--

this household's water supply preference	
What type of water facility would you like to be installed in your village?	
What do you like about that water facility?	

Willingness and ability to pay for improved water supply	
Would your household be able to pay...?	
for maintenance of the water supply system, per month (<i>tick one</i>)	less than TShs 500/= TShs 500 to 1000/= TShs 1000 to 1500/= TShs 1500 to 2000/= more than TShs 2000/=
per 20-litre bucket (<i>tick one</i>)	less than TShs 10/= TShs 10 or 15/= TShs 15 or 20/= more than TShs 20/=

respondent's own comments	
Any points the respondent would like to make...	
Question(s) the respondent would like to be answered	

THANK YOU: time now _____ at the end of interaction with this household

NTz project number 210023 Mwanza and Mara water project village questionnaire	ENUMERATOR TODAY'S DATE	DISTRICT VILLAGE	QUESTIONNAIRE NUMBER PAGE NUMBER 9
---	--------------------------------	-------------------------	--

3. Questionnaire sheet for Focus Group Discussions (FGD)

List members on separate page (or overleaf).

traditional land entitlement and allocation
traditional water entitlement and allocation
traditional water resource management
customary resolution of conflicts over water

NTz project number 210023 Mwanza and Mara water project village questionnaire	ENUMERATOR TODAY'S DATE	DISTRICT VILLAGE	QUESTIONNAIRE NUMBER PAGE NUMBER 10
---	--------------------------------	-------------------------	---

<p>customary coping mechanisms to deal with drought and water shortages</p>
<p>customary organisations (type, membership, leadership, functions)</p>
<p>relationship with district offices</p>
<p>relationships with neighbouring villages</p>
<p>socio-cultural and economic barriers confronting women</p>

village offer?	Name of Activity(2): _____ a. fund; b. labor; c. construction materials (e.g. sands, stones); d. food; e. drinks; f. other (_____)
	Name of Activity(2): _____ a. fund; b. labor; c. construction materials (e.g. sands, stones); d. food; e. drinks; f. other (_____)

2. Water Use Situation

2.1 Existing water source: What kind of water sources exist in the village?	<ol style="list-style-type: none"> 1. Piped water with communal taps Number _____ Average distance (meter) _____ 2. Hand pump <Dry season> Number _____ Average distance (meter) _____ <Rainy season> Number _____ Average distance (meter) _____ 3. Ring well <Dry season> Number _____ Average distance (meter) _____ <Rainy season> Number _____ Average distance (meter) _____ 4. Hand dug wells <Dry season> Number _____ Average distance (meter) _____ <Rainy season> Number _____ Average distance (meter) _____ 5. Traditional wells <Dry season> Number _____ Average distance (meter) _____ <Rainy season> Number _____ Average distance (meter) _____ 6. Lake water Number _____ Average distance (meter) _____ 7. Charco dam <Dry season> Number _____ Average distance (meter) _____ <Rainy season> Number _____ Average distance (meter) _____ 8. River <Dry season> Number _____ Average distance (meter) _____ <Rainy season> Number _____ Average distance (meter) _____ 9. Spring <Dry season> Number _____ Average distance (meter) _____ <Rainy season> Number _____ Average distance (meter) _____
---	--

	<p>10. Pond</p> <p><Dry season> Number _____ Average distance (meter) _____</p> <p><Rainy season> Number _____ Average distance (meter) _____</p> <p>11. Other ()</p> <p><Dry season> Number _____ Average distance (meter) _____</p> <p><Rainy season> Number _____ Average distance (meter) _____</p>	
2.2 Main water sources in dry / rainy season	<p><Dry season> _____, _____, _____.</p> <p><Rainy season></p>	
2.3 What kinds of <u>water supply organizations</u> are available in the village?	<p>1. Village Water Committee (VWC) is available and active.</p> <p>2. VWC is available but not active.</p> <p>3. Water Committee(s) at sub-villages is/are available. Number of Water Committee(s) is/are _____</p> <p>4. Water User Group(s) are available. Number of Water User Group(s) is/are _____</p> <p>5. Other water supply organizations: _____</p>	
2.4 Is the water fund for O&M collected?	<p>a. Yes b. No</p> <p>If Yes, Amount of water fee collected Tsh _____ Amount of total water fund collected Tsh _____</p>	
2.5 Water consumption per HH per day	<p>Dry season _____ Rainy season _____</p>	
2.6 Frequency of water fetching per HH per day	<p>Dry season _____ Rainy season _____</p>	
2.7 How much will the village people pay as the <u>water fee per bucket payment</u> , if the new water supply system would have been constructed?	<p>If it is <u>per bucket payment</u></p> <p>a1. less than 10 Tsh a2. 10 to 15 Tsh a3. 15 to 20 Tsh a4. more than 20 Tsh</p> <p>If it is <u>monthly payment</u></p> <p>b1. less than 500 Tsh b2. 500 to 1000 Tsh b3. 1000 to 1500 Tsh b4. 1500 to 2000 Tsh b5. more than 2000 Tsh</p>	<p>If the rehabilitation of the piped scheme needs Tsh _____ per HH per month,</p> <p>How much will the village people pay?</p> <p>Tsh _____</p>
2.8 Before commencement of the construction of the project, how much can your village contribute to the proposed piped scheme water project?	<p>a. The village can contribute the amount of Tsh _____</p> <p>b. The village can not contribute any amount.</p>	

2.9 During the construction of the project, what kind of <u>contributions</u> can your village offer for the proposed piped scheme water project?	a. land for construction of the facilities; b. construction materials such as sands, stones, etc.; c. drinks for contractors; d. food for contractors; e. labor force for minor construction works; f. other ()
---	---

3. Health Condition

3.1 Which medical facilities do villagers usually consult when they get sick?	1. A dispensary in the village 2. A dispensary in the neighboring village 3. A health centre at _____ 4. A district hospital at _____ 5. other (specify)
3.2 Main <u>water-related diseases</u> in the village	No 1. _____ No 2. _____ No 3. _____ a. Diarrhea; b. Skin diseases; c. Eye diseases; d. Dysentery; e. Typhoid; f. Cholera; G. Malaria; h. Schistosomiasis deceases i. Other (specify)
3.3 Average medical expenses per household per year	Tsh

**SOCIO-ECONOMIC EVALUATION QUESTINANNAITRE
(FOR 40 VILLAGES)**

The Study on Rural Water Supply in Mwanza and Mara Regions, JICA

1. Date....., 2006
2. Village
3. Ward:
4. District:
5. Region: Mwanza Mara
6. Informants:
 - 1) Village Chairperson
 - 2) Village Executive Officer
 - 3) Village Water Committee members.....
 - 4) WUG Committee members
 - 5) Village Government member.....
 - 6) Others

Q1. Family members and water fetching ranking

	Relation	Water Fetching Ranking (1: most often, 2:often, 3:sometimes, 4: never)
1	Adult Women	1, 2, 3, 4
2	Adult Men	1, 2, 3, 4
3	Child Girls	1, 2, 3, 4
4	Child Boys	1, 2, 3, 4
5		1, 2, 3, 4
6		1, 2, 3, 4

Q2. What is your main water source for drinking, cooking, washing and bathing and distance to the sources?

	Drinking	Cooking	Washing	Bathing
1. Rainy Season	1) Traditional Well 2) Hand pump 3) River 4) Lake 5) Other () Distance (approximate) : _____ km	1) Traditional Well 2) Hand pump 3) River 4) Lake 5) Other () Distance (approximate) : _____ km	1) Traditional Well 2) Hand pump 3) River 4) Lake 5) Other () Distance (approximate) : _____ km	1) Traditional Well 2) Hand pump 3) River 4) Lake 5) Other () Distance (approximate) : _____ km
2. Dry Season	1) Traditional Well 2) Hand pump 3) River 4) Lake 5) Other () Distance (approximate) : _____ km	1) Traditional Well 2) Hand pump 3) River 4) Lake 5) Other () Distance (approximate) : _____ km	1) Traditional Well 2) Hand pump 3) River 4) Lake 5) Other () Distance (approximate) : _____ km	1) Traditional Well 2) Hand pump 3) River 4) Lake 5) Other () Distance (approximate) : _____ km

Q3. How many times a day do you go to fetch water?

Rainy season: 1) once a day; 2) twice a day; 3) 3 times a day; 4 more than 3 times

Dry season: 1) once a day; 2) twice a day; 3) 3 times a day; 4 more than 3 times

Q4. How many hours do you spend time to fetch water?

(Including travel time, queuing time, and filling time)

Rainy season: about _____ hours per day

Dry season: about _____ hours per day

Ask 2 households (A and B)

Q5. Did some of your family members get medical treatment in the last 12 month?

	No. of family member	Frequency	Distance to medical facilities	Cost of medical treatment	Cost of transport
A		time (s)	1. within the village 2. _____ km	Tsh per year	Tsh per year
B		time (s)	1. within the village 2. _____ km	Tsh per year	Tsh per year

Ask 4 households (A to D)

Q. 6 Average household income per year (Tsh)

	A	B	C	D
Crop income* Food crops, Cash crops				
Livestock income** Cows, Goats etc.				
Fishing income				
Employment (government, company etc.)				
Remittance (money from children)				
Commercial income (selling vegetables, kiosk etc)				
Others (wage labour etc.)				
Total				

*Gross income minus production cost

** Gross income minus production cost

② 205 Villages Profile

205 Villages Profile

No.	District	Village name	Population (village data)	Male	Female	No of disabled people	Children	No of HH	Female headed HH	Water Committee	WUG	Project experience	Activities of CBOs	HESAWA activities	Available water Sources
1	BUNDA	Sanzate	2,858	1,340	1,518	66	1,776	366	na	1	0	TASAF, DDP, PEDEP and CSPD with contribution	- bee keeping - handicraft - burnt brick making - furniture making	- constructed 2 shallow wells with hand pump (SWs) and 10 improved traditional wells (ITWs) - 1 SW and 9 ITWs are functioning	2 SWs (HP), 9 traditional wells 4 Ponds Springs Charco dam
2	BUNDA	Nyang'aranga	2,841	1,312	1,529	50	1,513	406	100	1	0	PEDP, DBSOE, CSPD with contribution	- fish preservation - bee keeping	- constructed 2 shallow wells with hand pump (SWs) - 1 SW is still working	2 SWs 16 traditional wells (13 wells are seasonal) Ponds, Springs Charco dam
3	BUNDA	Ligamba B	1,522	787	735	26	866	220	46	1	0	PEDP, DDP with contribution	- construction of VIP latrines at school - HIV/AIDS campaign	- constructed 1 SW - pump has been stolen	1 SW (HP), Traditional wells Streams
4	BUNDA	Mcharo	1,018	na	na	16	na	170	na	1	1	PED	None	- constructed 1 SW - SW is functioning	1 SW 1 Traditional well Streams
5	BUNDA	Buzimbwe	2,281	1,077	1,204	12	1,124	303	60	1	0	PEDEP, CSPD with contribution	- construction of school - tree planting - livestock keeping	- constructed VIP lstrines in schools and for 60 households (HHs)	Streams Lake Victoria
6	BUNDA	Nafuba (island)	2,876	826	2,050	30	1,572	236	30	0	0	PEDEP, CSPD with contribution	- gardening (women group)	None	Lake Victoria
7	BUNDA	Namalama	1,597	751	846	27	na	219	22	0	0	TASAF, DDP, PEDEP and CSPD	- agriculture labour - petty business - fish vending	None	5 Traditional wells Lake Victoria
8	MUSOMA	Sirorisimba	3,589	1,700	1,889	60	no data	354	70	0	1	PEDEP and CSPD	- credit services (women group)	- constructed 1 SW - SW is not functioning (broken down in September 2005)	1 SW (HP), Traditional wells Streams
9	MUSOMA	Ryamisanga	4,136	no data	no data	No data	2,062	734	no data	1	1	PEDP, LVEMP, CDPD, WWF	- envieonmental conservation - burnt brick making - livestock keeping - local credit services	- constructed 4 SWs and slabs for pit latrines - 3 hand pumps were stolen and 1 HP is kept in the office	PWS (wind pump, 150 HHs) 8 Traditional wells (3 permanent wells) River, Ponds
10	MUSOMA	Magunga	no data	no data	no data	No data	no data	450	no data	1	0	WWF, TACAIDS, and CSPD	- fishing group (credit) - credit group	- constructed 1 borehole well with hand pump (BH) and provided training and seminars for water users - BH is still working	1 BH (HP) 5 Traditional wells Charco dam River, ponds, wetland
11	MUSOMA	Busegwe	3,990	1,915	2,075	64	2,114	684	54	1	0	PEDP, CDPD with contribution	None	None	Traditional wells Ponds Streams
12	MUSOMA	Kisamwene	3,685	1,206	2,479	300	no data	456	50	1	0	PEDP, TASAF, CDPD with contribution	- tailoring - burnt brick making - agriculture marketing	None	4 Traditional wells Ponds Streams
13	MUSOMA	Bukabwa	2,932	1,400	1,532	No data	no data	404	59	1	1	RVEMP, VI, ECOVIC, IFAFI, TRCS	None	- constructed VIP lstrines in primary school	Traditional wells Charco dam Spring, river

205 Villages Profile

No.	District	Village name	Population (village data)	Male	Female	No of disabled people	Children	No of HH	Female headed HH	Water Committee	WUG	Project experience	Activities of CBOs	HESAWA activities	Available water Sources
14	MUSOMA	Mmazami	3,974	2,099	1,875	35	1,570	768	no data	1	1	PEDP, CDPD with contribution	- assistance for elders - supporting children - HIV/AIDS campaign	- constructed 1 improved well without hand pump, a VIP latrine for primary school and 7 VIP latrines in the village	3 SWs (1 is in operation) Traditional wells Spring, ponds Streams
15	MUSOMA	Kirumi	2,004	922	1,082	56	1,085	446	70	1	0	REDEMP, PEDP, CDPD with contribution	- tree nursery- environmental conservation- vegetable gardening	None	12 Traditional wells (2 permanent wells) Lake Victoria Mara river
16	MUSOMA	Bwaikumsoma	3,795	1,759	2,036	23	1,782	613	56	0	0	PEDP with contribution	- HIV/AIDS campaign	None	3 Improved dug wells (without HP) River Lake Victoria
17	MUSOMA	Chirorwe	2,928	1,312	1,616	17	1,669	378	41	0	0	PEDP, CSPD, MARAFIP (agriculture)	- rice cultivation - cassava cultivation (women group)	None	8 Traditional wells River Lake Victoria
18	MUSOMA	Bugoji	5,993	2,386	3,607	113	2,543	620	115	1	9	PEDP, UNICEF, CSPD	- assistance for elders - credit services	None	4 BH wells (HP) Traditional wells River Ponds, wetlands
19	MUSOMA	Saragana	3,864	1,987	1,877	20	2,190	607	64	1	0	PEDP, fish pond construction	- assistance for elders - assistance for children	None	1 BH (not working) Springs Streams
20	MUSOMA	Kaburabura	1,892	No data	no data	No data	No data	260	No data	1	0	PEDP (construction of schools)	- joint cultivation - HIV/AIDS campaign	None	20 Traditional wells (4 permanent wells) Stream
21	MUSOMA	Kwigutu	3,600	no data	no data	8	no data	300	no data	1	0	PEDP (school construction)	None	- constructed 1BH - BH is still working	1 BH well Traditional wells Streams 1 Spring
22	MUSOMA	Nyasirori	4,370	2,013	2,357	20	1,500	458	50	0	0	PEDP (school construction)	- support children	- constructed 2 SWs - 1 SW has dried up	2 SWs (HP) Traditional wells (for livestock) River Ponds
23	MUSOMA	Nyamikoma	4,246	2,026	2,220	6	2,423	601	70	1	0	PEDP, CDPD with contribution	- farming together	- constructed 6 SWs, 9 ITWs, and improved pit latrines - 5 SWs are working	6 SWs (HP) 9 Improved wells 16 Traditional wells River, springs, ponds
24	MUSOMA	Nyarukoru	1,140	559	581	No data	No data	164	No data	0	0	PEDP, CDPD	- commercial farming (women group) - Local credit	- constructed lstrines in primary school	2 Traditional wells 1 Nyangomba dam 1 Charco dam (Nying'ombe)
25	MUSOMA	Bisumwa	7,660	3,000	4,660	39	2,105	615	225	0	4	PEDP with contribution	- improvement of traditional wells - assistance for elders	None	Improved wells Traditional wells Lake Victoria River
26	MUSOMA	Nyabekwabi	4,752	2,621	2,131	20	2,620	740	150	0	0	PEDP, CDPD with contribution	None	None	Traditional wells Lake Victoria Ponds, streams
27	MUSOMA	Isaba	2,900	1,366	1,534	no data	no data	459	100	1	0	PEDP, CDPD with contribution	- assistance for children - assistance for elders	- constructed 1 SW	1 SW (HP) Traditional wells Streams, ponds

205 Villages Profile

No.	District	Village name	Population (village data)	Male	Female	No of disabled people	Children	No of HH	Female headed HH	Water Committee	WUG	Project experience	Activities of CBOs	HESAWA activities	Available water Sources
28	MUSOMA	Songora	5,937	2,753	3,184	no data	no data	no data	no data	0	0	NA	- Local credit	None	Traditional wells Streams, ponds
29	MUSOMA	Ryamugabo	2,224	916	1,308	120	1,130	246	57	1	0	- PEDP (construction of class rooms, etc.) - CSPD (maternal & child care) - VI (agroforestry)	- farming together - constructed improved latrines in primary school		12 Traditional wells 2 Spring 1 Charco dam Ponds, streams
30	MUSOMA	Musanja	4,439	1,916	2,523	no data	1,866	584	44	1	0	- PEDP (construction of class rooms, etc.) - CSPD (maternal & child care) - VI (agroforestry)	- smoking fish-buying crops and cotton- carpentry	None	7 Traditional wells Lake Victoria
31	MUSOMA	Butata	4,259	2,111	2,148	69	1,751	667	89	0	0	- PEDP (construction of class rooms, etc.) - Construction of a secondary school	- orphan and women health - youth skills development (handicraft)	None	3 Traditional wells Lake Victoria Wetland during rainy season
32	MUSOMA	Rusoli	3,479	1,648	1,831	44	1,523	420	57	0	8	- PEDP (construction of schools, etc.) - VI (agroforestry) - VIFAFI (agriculture) - CSPD (maternal & child care)	- tree planting - gardening - milling machine operation	None	5 Traditional wells (2 permanent wells) Lake Victoria
33	MUSOMA	Kwikerege	1,220	571	649	119	622	137	20	0	0	- PEDP (construction of class rooms, etc.)	- child care	None	4 Traditional wells Wetland during rainy season
34	MUSOMA	Bukumi	1,998	962	1,036	30	1,568	350	45	0	0	- PEDP (construction of schools, etc.) - VI (agroforestry)	- agroforestry	None	2 Traditional wells Lake Victoria Wetland
35	MUSOMA	Tegeruka	2,349	1,092	1,257	20	1,129	318	no data	1	1	NA	- tree planting - local credit - petty business	- constructed 3 SWs - SWs has dried up	3 SWs (HP) 3 Traditional wells 2 Local dams, ponds Springs
36	MUSOMA	Makojo	2,142	1,059	1,083	104	1,118	323	no data	1	0	- UNICEF (HIV/AIDS) - WAMATA (HIV/AIDS) - CSPD (maternal & child care)	- agroforestry	None	3 Traditional wells Ponds Wetland during rainy season
37	MUSOMA	Mkirira	4,267	1,701	2,566	11	no data	418	no data	0	2	- PEDP (construction of schools, etc.) - Construction of a secondary school	- tree planting - rehabilitation of wells	None	4 Traditional wells 1 Dam 2 Springs Wetland during rainy season
38	MUSOMA	Rukuba (Lukuba)	1,354	no data	no data	not found	736	324	38	0	0	- PEDP (construction of schools, etc.)	None	None	Lake Victoria
39	MUSOMA	Kiemba	2,883	no data	no data	no data	no data	493	no data	0	0	- PEDP (construction of schools, etc.) - VI (agroforestry) - Beach Management	None	None	2 SWs (1 private) 6 Traditional wells Streams 6 Springs
40	MUSOMA	Kigera (Kigera Etuma)	5,600	no data	no data	no data	no data	800	140	0	5	- PEDP (construction of schools, etc.) - VODP (furniture workshop) - CSPD (maternal & child care)	- collective agriculture labour - fishing - local credit	None	3 Improved wells Lake Victoria

205 Villages Profile

No.	District	Village name	Population (village data)	Male	Female	No of disabled people	Children	No of HH	Female headed HH	Water Committee	WUG	Project experience	Activities of CBOs	HESAWA activities	Available water Sources
41	MUSOMA	Kiriba	2,973	1,157	1,816	48	1,723	364	38	1	1	- PEDP (construction of schools, etc.) - VI (agro-forestry) - CSPD (maternal & child care)	- farming together and sharing produce	- constructed a BH	1 BH (broken) Traditional wells Streams Ponds
42	TARIME	Nkende	2,811	1,411	1,400	28	1,381	663	No data	0	4	- PEDP (construction of schools, etc.) - IFAD (construction of SWs)	- local credit	- constructed 4 SWs and latrines - 2 SWs are working	8 SWs (HP) 1 dam 4 Traditional wells River, rain water
43	TARIME	Magena	2,195	516	1,679	18	544	450	No data	0	16	- PEDP (construction of schools, etc.)- construction of a dispensary	- vegetable gardening	- constructed 4 SWs and school latrines- 3 SWs are working	5 SWs (2 working)11 Traditional wells8 SpringsRiver, streams
44	TARIME	Kemakorere	4,356	2,083	2,273	28	1,858	626	145	0	16	- PEDP (construction of schools, etc.) - IFAD (construction of borehole)	- joint cultivation - local credit - HIV/AIDS campaign	- constructed 3 SWs and school latrines - 3 SWs are working	3 SWs (HP) 1 BH (HP) 12 Traditional wells 1 Pond River
45	TARIME	Nyarero	2,904	1,402	1,502	No data	1,212	440	No data	0	0	- UNICEF (health.) - CSPD (maternal & child care)	None	- constructed ITW and improved latrines for primary school and village people	Improved wells Traditional wells
46	TARIME	Soroneta	2,673	1,280	1,393	18	1,397	538	49	0	0	- PEDP (construction of schools, etc.) - Dairy cows project - CSPD (maternal & child care)	- gardening - dairy cows - mixed farming	- constructed 6 ITWs	6 Improved wells Streams
47	TARIME	Rosana	1,258	600	658	No data	No data	247	No data	0	0	- PEDP (construction of schools, etc.) -- CSPD (maternal & child care)	- local credit - dairy cows	None	5 Improved wells Streams, ponds
48	TARIME	Magoto	3,140	1,260	1,880	18	540	512	No data	0	0	- PEDP (construction of schools, etc.)	- bee keeping - fish breeding - burnt brick making	None	24 Traditional wells Streams
49	TARIME	Kebweye	no data	no data	no data	no data	no data	no data	no data	0	0	- PEDP (construction of schools, etc.)	None	None	11 Traditional wells Streams
50	TARIME	Nyarwana	3,886	1,581	2,305	11	1,163	577	107	1	1	- PEDP (construction of schools, etc.) - DWE water project (construction of a borehole and piped water scheme)	- agroforestry	None	1 BH (not working) 10 Traditional wells River, wetland
51	TARIME	Nyankunguru	4,450	1,650	2,800	16	1,553	923	20	1	0	- VI (agroforestry.) - LVEMP (rehabilitation of class rooms) - CSPD (maternal & child care)	- agroforestry	None	36 Traditional wells River, ponds Wetland during rainy season
52	TARIME	Wegita (Weigita)	5,406	1,273	4,133	10	1,643	482	203	0	0	- PEDP (construction of schools, etc.)	- environmental conservation	None	Streams 1 Pond
53	TARIME	Nyantira	8,076	3,477	4,599	Not available	Not available	1,346	Not available	0	0	- PEDP (construction of schools, etc.) - Dairy cows project - CSPD (maternal & child care)	- carpentry - burnt brick making - vegetable gardening - dairy cows	None	1 SW (HP) 12 Traditional wells Streams Wetland

205 Villages Profile

No.	District	Village name	Population (village data)	Male	Female	No of disabled people	Children	No of HH	Female headed HH	Water Committee	WUG	Project experience	Activities of CBOs	HESAWA activities	Available water Sources
54	TARIME	Mangucha	6,803	3,240	3,563	31	3,189	1,315	No data	1	0	- PEDP (construction of schools, etc.) - TANAPA (shallow wells) - CSPD (maternal & child care)	- livestock keeping - local credit - vegetable and fruit gardening - bee keeping	None	5 Traditional wells Charco dam River, streams
55	TARIME	Kegonga	4,441	2,106	2,335	24	2,461	850	54	0	0	- PEDP (construction of schools, etc.) - TANAPA (shallow wells) - CSPD (maternal & child care)	- burnt brick making - gardening - bee keeping	None	3 SWs (TAZAPA?) 4 Traditional wells Streams
56	TARIME	Genkuru	4,744	2,134	2,610	38	3,264	776	157	1	0	- PEDP (construction of schools, etc.)	- joint cultivation - construction of a secondary school	None	7 Traditional wells River Ponds
57	TARIME	Masanga	5,000	2,358	2,642	No data	812	890	No data	0	0	- UNICEF (child care.) - VI (agroforestry) - CSPD (maternal & child care)	- construction of a secondary school	None	Traditional wells Wetland during rainy season
58	TARIME	Matongo	4,035	No data	no data	No data	No data	435	No data	0	0	- PEDP (construction of primary school)	- joint cultivation	None	Pond River, streams
59	TARIME	Kiwanja (Kewanja)	4,061	1,959	2,102	Not known	1,442	640	57	0	0	- PEDP (construction of primary school)	- gardening (women group) - sewing	None	10 Traditional wells 1 dam Streams
60	TARIME	Ng'reng'ere	2,413	1,191	1,222	12	1,243	454	94	0	2	- PEDP (construction of schools, etc.)- CSPD (maternal & child care)	- joint farming	- constructed 2 BHs, 6 ITWs and improved pit latrines- 2 BHs are working	2 BH (HP) 6 Improved wells 8 Traditional wells 4 Streams Wetland
61	TARIME	Getenga	2,570	1,252	1,318	7	1,490	500	No data	0	0	- PEDP (construction of schools, etc.) - CSPD (maternal & child care)	- dairy cows keeping - poultry	- constructed 3 privately owned SWs, 5 ITWs and school latrines	2 SWs (private) 2 Improved wells 8 Traditional wells Streams
62	TARIME	Nyabisaga	2,636	1,306	1,330	23	1,730	675	No data	0	0	- PEDP (construction of schools, etc.) - CSPD (maternal & child care)	- vegetable gardening - zero grazing	- constructed 1 BH and school latrines - 1 BH is working	1 BH (HP) 15 Traditional wells Streams Wetland, ponds
63	TARIME	Kiongera	3,062	1,457	1,605	70	2,220	648	170	0	0	- PEDP (construction of class rooms and teachers' houses)	- carpentry - bicycle repair - local credit	None	5 Traditional wells 4 Ponds
64	TARIME	Nyabirongo	3,543	1,662	1,881	65	2,357	521	145	0	0	- PEDP (construction of class rooms and teachers' houses)	- local credit	None	4 Traditional wells 2 Ponds Streams
65	TARIME	Kikomori	5,000	2,236	2,764	28	1,500	397	16	0	0	- UNICEF (child care.) - VI (agroforestry) - PEDP (construction of class rooms, etc.)	None	None	Traditional wells Spring
66	TARIME	Kubiterere	3,144	1,508	1,636	No data	1,152	681	No data	0	0	- CSPD (maternal & child care) - PEDP (construction of class rooms, etc.) - UNICEF (child care)	- joint farming - food vending	None	14 Traditional wells (4 permanent wells) 1 Pond Streams

205 Villages Profile

No.	District	Village name	Population (village data)	Male	Female	No of disabled people	Children	No of HH	Female headed HH	Water Committee	WUG	Project experience	Activities of CBOs	HESAWA activities	Available water Sources
67	TARIME	Korotambe	3,234	1,556	1,678	25	2,247	642	30	0	0	- Road construction (district fund) - PEDP (construction of class rooms, etc.)	None	None	8 Traditional wells 3 Spring River
68	TARIME	Nyamhunda	1,680	859	821	10	No data	583	20	0	0	- PEDP (construction of class rooms, etc.)	- joint farming	None	12 Traditional wells Ponds Spring Streams
69	TARIME	Nkerege	4,000	no data	no data	no data	no data	no data	no data	0	0	- PEDP (construction of class rooms, etc.) - construction of village office	- environmental conservation - joint farming	- constructed school latrines	2 BH (without HP) 4 Traditional wells 1 Pond River
70	TARIME	Nyagisya (Nyangisha)	1,468	697	771	20	855	329	30	0	0	- CSPD (maternal & child care) - PEDP (construction of class rooms, etc.)	- construction of a school	- constructed school latrines and 15 households latrines	4 Traditional wells Ponds, springs Streams
71	TARIME	Gamasara	2,305	no data	no data	no data	985	400	25	0	0	- VI (agroforestry) - PEDP (construction of class rooms, etc.)	- construction of a school	- constructed 2 BHs and school latrines - BHs are working	3 BH (HP) 2 Improved wells 5 Traditional wells River Ponds
72	TARIME	Sombanyasoko	856	161	695	4	491	147	25	1	1	- CSPD (maternal & child care) - PEDP (construction of class rooms, etc.) - VI (agroforestry)	- brick making - tree planting - poultry	- constructed 1 SW and 20 slabs for pit latrines	1 SW (HP) 4 Traditional wells Streams 1 Pond
73	TARIME	Bisarwi (Bisuwari)	2,379	1,095	1,284	12	1,282	380	46	1	1	- IFAD (cattle dipping) - PEDP (construction of class rooms, etc.)	- carpentry - cattle dipping - joint farming - shop	- constructed 1 SW and 32 households pit latrines - SW is working	1 SW (HESAWA) 8 Traditional wells (4 permanent wells) River
74	TARIME	Kiterere	1,098	201	897	12	651	169	45	0	0	- PEDP (construction of class rooms, etc.)	None	- constructed school latrines - started construction of 1 SW but not completed	1 SW (not working) 6 Traditional wells River
75	TARIME	Utegi	2,390	744	1,646	No data	1,112	457	No data	0	0	- PEDP (construction of class rooms, etc.)	- joint farming (agricultural input)	- constructed 11 SWs and school latrines - 10 SWs are working (one hand pump was stolen)	17 SWs (1 not working) 1 Dam 1 Traditional well Streams
76	TARIME	Ikoma	2,355	1,159	1,196	41	1,434	582	137	0	0	- PEDP (construction of class rooms and teachers' houses)	- carpentry - sewing - joint farming - bicycle repair	None	14 Traditional wells 5 Ponds, charco dam 2 Springs Rain water
77	TARIME	Kisumwa	1,931	962	969	23	1,354	405	Not available	1	0	- CSPD (maternal & child care) - PEDP (construction of class rooms, etc.) - VI (agroforestry)	- rice growing - tailoring - burnt brick making	None	6 Traditional wells (3 permanent wells) Wetland Neighbouring village
78	TARIME	Nyanchabakenye	2,812	1,392	1,420	32	1,617	418	48	0	1	- IFA (cattle dipping) - WWF (water source conservation) - PEDP (construction of class rooms, etc.) - VI (agroforestry)	- tree planting - burnt brick making	None	3 Traditional wells Wetland Neighbouring village
79	TARIME	Lolwe	no data	no data	no data	no data	no data	no data	no data	1	NA	None	None	None	5 Traditional wells Ponds Streams Wetland

205 Villages Profile

No.	District	Village name	Population (village data)	Male	Female	No of disabled people	Children	No of HH	Female headed HH	Water Committee	WUG	Project experience	Activities of CBOs	HESAWA activities	Available water Sources
80	TARIME	Nyankonge (Nyamkonge)	1,411	542	869	37	527	435	no data	1	NA	- CSPD (maternal & child care) - PEDP (construction of class rooms, etc.)	- farming (women group)	- constructed 1 BH - BH is working	1 BH (HP) 3 Traditional wells Lake Victoria Ponds Wetland
81	TARIME	Omoche	3,343	1,542	1,801	20	1,540	722	50	1	1	- PEDP (construction of class rooms, etc.) - VI (agroforestry)	- vegetable gasrdening - tailoring	- constructed a BH and school latrines - BH is working	2 BH (HP) 3 Traditional wells Ponds, river Wetland
82	TARIME	Kirongwe	2,642	1,214	1,428	58	1,551	479	No data	0	0	- PEDP (construction of class rooms, etc.) - VI (agroforestry)	None	- constructed 2 SWs - SWs are not working	2 SWs 4 Traditional wells Lake Victoria
83	TARIME	Thabache	1,683	779	904	26	597	332	none	0	NA	- CSPD (maternal & child care) - PEDP (construction of class rooms, etc.)	None	- started construction of a BH but not completed	3 Traditional wells 1 Charco dam
84	TARIME	Kyngasaga	3,453	no data	no data	30	1,995	877	no data	0	0	- PEDP (construction of class rooms and teachers' houses) - Community Feeder Road project	None	None	4 Traditional wells Stremas, ponds Lake Victoria
85	TARIME	Muharago (Muharango)	3,637	no data	no data	no data	no data	604	no data	0	0	- PEDP (construction of class rooms and teachers' houses)	- bicycle repair - petty business - burnt brick making	None	5 Traditional wells (3 permanent wells) Lake Victoria
86	TARIME	Bureta (Burere)	3,876	no data	no data	no data	no data	350	no data	0	0	- PEDP (construction of class rooms and teachers' houses)	None	None	4 Traditional wells Ponds, springs Lake Victoria
87	TARIME	Radienya	2,803	600	2,203	16	1,353	540	No data	0	0	- PEDP (construction of class rooms and teachers' houses) - Dispensary construction	None	None	3 Traditional wells Ponds Lake Victoria
88	TARIME	Masike	1,874	1,033	841	53	1,064	494	N/A	0	0	- PEDP (construction of class rooms and teachers' houses) - District Road Project - REDEP (construction of a BH well, unsuccessful)	None	- constructed a BH - BH is not working	2 BH (HP) 5 Traditional wells Spring River
89	TARIME	Randa	4,885	2,170	2,715	94	1,777	807	157	0	0	- PEDP (construction of class rooms, etc.) - VI (agroforestry) - IFAD (cattle crash construction)	- vegetable growing - petty business - tailoring - carpentry	None	5 Traditional wells River
90	TARIME	Bukama	3,920	1,943	1,977	86	1,780	850	No data	0	0	- PEDP (construction of class rooms, etc.) - Cattle dip construction - Construction of a secondary school	- tree planting- tailoring- carpentry- bicycle repair	- started construction of a SW but not completed- constructed school latrines	13 Traditional wells 3 Springs River
91	TARIME	Raranya	6,797	243	6,554	No data	4,426	484	98	1	13	- PEDP (construction of class rooms, etc.) - Construction of a dispensary	- cereals selling - health care for child and mothers	None	7 Traditional wells 7 Springs Streams

205 Villages Profile

No.	District	Village name	Population (village data)	Male	Female	No of disabled people	Children	No of HH	Female headed HH	Water Committee	WUG	Project experience	Activities of CBOs	HESAWA activities	Available water Sources
92	TARIME	Busanga	3,222	1,507	1,715	28	1,095	583	No data	0	0	- CSPD (maternal & child care) - PEDP (construction of class rooms, etc.)	- vegetable gardening - furniture making - bicycle repair - sewing	None	4 Traditional wells Ponds Lake Victoria
93	TARIME	Manira (Manila)	1,517	418	1,099	6	716	305	No data	0	0	- CSPD (maternal & child care) - PEDP (construction of class rooms, etc.)	None	None	6 Traditional wells Ponds Lake Victoria
94	TARIME	Nyarombo	1,895	476	1,419	No data	876	441	No data	0	0	- CSPD (maternal & child care) - PEDP (construction of class rooms, etc.)	- credit facilities - toilet construction - carpentry	- started construction of 2 BHs and a SW but 2 BHs are not completed - BHs are not working (no pump)	1 SW 1 BH (not working) 6 Traditional wells Streamx Lake Victoria
95	TARIME	Rwang'enyi	2,974	1,395	1,579	25	1,428	627	No data	0	NA	- CSPD (maternal & child care) - PEDP (construction of class rooms, etc.) - LWEMP (construction of a dispensary)	- irrigation	None	8 Traditional wells Ponds Lake Victoria
96	TARIME	Oliyo	3,325	1,556	1,769	499	1,320	634	unknown	1	3	- Construction of a dispensary - PEDP (construction of class rooms, etc.)	None	- started construction of 1 BH and 2 SWs but 1 SW has no water - BH is working - 1 SW is working	3 SWs (2 not working) 1 BH 1 Traditional well Stream
97	TARIME	Ryagoro	2,885	1,307	1,578	48	1,385	486	No data	0	0	- PEDP (construction of class rooms, etc.)	None	None	5 Traditional well 4 Streams
98	TARIME	Balongo (Malongo)	2,293	1,088	1,205	82	no data	258	no data	0	0	- CSPD (maternal & child care) - PEDP (construction of class rooms, etc.)	- farming - butchery	None	River
99	TARIME	Sudi	3,713	no data	no data	33	2,142	866	No data	0	0	- CSPD (maternal & child care) - PEDP (construction of class rooms, etc.)	None	None	3 Streams 5 Springs
100	TARIME	Nyamsi (Nyamusi)	1,050	470	580	39	448	241	no data	0	0	- CSPD (maternal & child care) - PEDP (construction of class rooms, etc.)	- tailoring - gardening - sugar cane farming	None	8 Traditional wells Ponds, springs Streams
101	TARIME	Panyakoo	3,235	1,590	1,645	32	1,347	650	No data	0	1	- CSPD (maternal & child care) - PEDP (construction of class rooms, etc.)	None	None	18 Traditional wells Ponds
102	TARIME	Tatwe	3,182	1,516	1,666	38	1,500	680	no data	0	2	- Roman catholic church (construction of vocational training centre) - PEDP (construction of class rooms, etc.)	None	None	8 Traditional wells River Ponds
103	SERENGETI	Kono	1,439	685	754	not stated	543	183	33	1	0	- CSPD (maternal & child care) - PEDP (construction of class rooms, etc.)	None	- constructed ITW and school latrines	6 Traditional wells River, Spring Ponds
104	SERENGETI	Nyamitita	1,968	906	1,062	39	832	357	61	1	3	- CSPD (maternal & child care) - PEDP (construction of class rooms, etc.)	None	- constructed 3 ITWs and school latrines	3 Improved wells 9 Traditional wells River

205 Villages Profile

No.	District	Village name	Population (village data)	Male	Female	No of disabled people	Children	No of HH	Female headed HH	Water Committee	WUG	Project experience	Activities of CBOs	HESAWA activities	Available water Sources
105	SERENGETI	Busawe	2,316	1,024	1,292	unknown	not stated	168	not stated	1(inactive)	0	- PEDP (construction of class rooms, etc.)	- bicycle repair - gardening-environmental conservation	- startd construction of a BH but not operating (low yield)	1 BH (not working)4 Traditional wells2 StreamsRiver, ponds
106	SERENGETI	Nyansurura	9,177	4,371	4,806	248	4,556	821	107	0	0	- PEDP (construction of class rooms, etc.)	- construction of public institutions (e.g. school)	- constructed 3 SWs - 2 SWs are working	3 SWs (2 working) 4 Traditional wells 2 Streams River, ponds
107	SERENGETI	Kebanchabancha	2,579	1,149	1,430	20	1,415	373	128	1	4	- CSPD (maternal & child care) - PEDP (construction of class rooms, etc.) - DDP (construction of staff house for a dispensary)	- local credit facilities	- constructed 1 BH, 3 SWs, water tank and school latrines - 2 SWs are working	5 SWs 14 Traditional wells Streams
108	MISUNGWI	Mapilinga	2,475	1,074	1401	36	1,276	345	32	1	6	- CSPD (maternal & child care) - PEDP (construction of class rooms, etc.)	3 groups (gardening, etc.)	- constructed 8 SWs - 6 SWs are working during wet season	6 SWs (HP), 2 Charco-dam, 7 traditional wells Spring
109	MISUNGWI	Kabale	3,609	1,380	2229	18	1,537	438	38	1	3	- Village office - PEDP (construction of class rooms, etc.)	None	- constructed 1 BH and 2 SWs - BH and SWs are working	2 SWs (HP), 1 BH 2 Traditional wells Ponds (6) Streams
110	MISUNGWI	Busongo	3,195	1,220	1,975	na	na	885	na	1	1	- PEDP (construction of class rooms, etc.) - Construction of secondary school	None	- constructed 1 BH - BH is working	1 BH 15 Traditional wells Ponds (8)
111	MISUNGWI	Mbarika	2,953	na	na	6	1,069	428	21	1	1	-LVEMP (pipd water scheme) - Irrigation scheme (vegetables, maize) with community contribution	NA	- constructed 2 SWs - 1 SW dries up in dry season	PWS (4 water points) 2 SWs (1 not working in dry season) Traditional dug wells 4 Charco dams Streams Lake Victoria
112	MISUNGWI	Ngaya	4,002	1,990	2,012	30	na	290	22	1	0	- PEDP (construction of class rooms, etc. with community contribution)	NA	- constructed 2 SWs - 2 SWs are working	2 SWs (1 privetly owned) Traditional dug wells Charco dams Lake Victoria
113	MISUNGWI	Usagara	5,776	2973	2,803	81	1,150	1,076	113	1	7	- water project (deistrict council budget) - school facilities - health	4 groups (agriculture, credit, etc.)	- constructed 8 SWs - 5 SWs are working	PWS (not functioning) 8 Hesawa SWs 8 Traditional dug wells Charco dams Ponds
114	MISUNGWI	Mwalogwabagole	3,208	1609	1,599	62	1679	545	87	0	2	- LIVEP (construction of a clinic) - PEDP (construction of school)	4 groups (agriculture, credit, etc.)	- constructed 2 SWs and school latrines - 2 SWs are working	2 SWs Traditional dug wells Charco dams Lake Victoria Ponds
115	SENGEREMA	Ibondo	5,462	2,518	2,944	150	2,776	562	107	0	0	- village government office construction - school facilities - school library	- credit - agriculture	None	10 Traditional wells Springs
116	SENGEREMA	Iusungangholo	2,014	948	1,066	3	280	287	15	0	0	- school facilities - health training	- credit - health	None	18 Traditional dug wells

205 Villages Profile

No.	District	Village name	Population (village data)	Male	Female	No of disabled people	Children	No of HH	Female headed HH	Water Committee	WUG	Project experience	Activities of CBOs	HESAWA activities	Available water Sources
117	SENGEREMA	Sima	4,630	2,167	2,463	21	429	717	72	1	0	- health (family planning, etc.)- school building	4 groups (agriculture, credit, etc.)	- constructed 2 SWs but not operating- 2 SWs dries up	PWS (not functioning)2 HESAWA wells (not operating)5 dams for cattlesTraditional wellsSprings
118	SENGEREMA	Igulumuki	2,109	986	1,123	10	549	310	14	0	0	- construction of village office - school building	- gardening - credit	None	7 Traditional dug wells 3 Charco dams 3 Ponds (seasonal)
119	SENGEREMA	Ijinga	1,676	858	818	22	904	226	24	0	0	- construction of village office - school building - health	- credit - religiou group	None	1 permanent dug well 3 temporary dug wells Ponds Lake Victoria (15 km)
120	SENGEREMA	Sogoso	3,554	1,306	2,248	58	1,184	385	46	1	2	- construction of BH (UNICEF) - village office construction - school building	- credit	None	2 SWs 12 traditional wells 4 charco dams Ponds
121	SENGEREMA	Tabaruka	4,013	1,998	2,015	98	2,000	510	50	1	0	- CSPD (child care) - TANZAKESHO (building village office) - school building	- local credit - assistance for the disabled - poultry - gardening	- constructed 2 SWs and 20 school latrines - 1 SW is operating	2 SWs (Hesawa & CSPD) 9 traditional wells Charco dams 2 Ponds
122	SENGEREMA	Nyampande	4,061	1,348	2,713	39	1,500	458	101	0	0	- health (family planning, etc.) - school building	- credit - youth group (sport)	- constructed 1 SW - SW has no water	1 SW (not working) Hand dug wells 1 Pond Streams
123	SENGEREMA	Nyamasale	2,144	1,068	1,076	9	1,263	324	65	0	0	- village library - school building	- credit - cotton growers group	None	15 Hand dug wells 12 Springs 2 Streams Lake Victori
124	SENGEREMA	Nyitundu	1,928	970	958	13	498	297	27	0	0	- school buiding - library - milling machine	- credit - tree planting - livestock keeping	- there was a plan to construct ring wells but it was not realized	Many traditional wells River 2 charco dams Lake Victoria
125	SENGEREMA	Lubanda	2,316	1,109	1,207	54	516	352	32	0	0	- school buiding - health (HIV/AIDS)	- credit - farming - livestock keeping	None	Many traditional wells River Spring Wetlands Lake Victoria
126	SENGEREMA	Juma kisiwani	2,314	1,444	870	10	1,400	239	50	0	0	- school buiding - health (child care) - assiting orphans	- environment conservation	None	Lake Victoria
127	SENGEREMA	Kasomeko	3,101	1,522	1,579	no data	680	550	96	0	0	- school building - village library - health	- credit - fishermen group	- constructed 2 SWs and 2 ITWs - 2 SWs dries up during dry season - water is salty	2 HESAWA SWs 10 Traditional dug wells 2 charco dams Lake Victoria
128	SENGEREMA	Mwaliga	1,460	660	800	25	360	186	30	1	0	- primary school improvement	- health	None	Traditional dug wells Stream close to Lake Victoria

205 Villages Profile

No.	District	Village name	Population (village data)	Male	Female	No of disabled people	Children	No of HH	Female headed HH	Water Committee	WUG	Project experience	Activities of CBOs	HESAWA activities	Available water Sources
129	SENGEREMA	Kijuka	3,387	1,316	2,071	58	1,412	455	38	0	0	- school building - village library - health	- brick makingt - credit	None	2 permsanent dug well 18 temporary dug wells Lake Victoria Wetlands
130	SENGEREMA	Nyakahako	4,380	2,212	2,168	25	1,092	708	unknown	0	0	- school building	- credit - fish breeding	- constructed 1 SW - SW dries up during dry season	1 SW (working only wet season) 11 Traditional dug wells Ponds Lake Victoria
131	SENGEREMA	Bupandwa (Bupandwamhela)	11,960	4,920	7,040	145	no data	2,191	34	0	12	- primary school construction- LIDEP (construction of wells)	- farming group-pottery group	- constructed 3 SWs and a ITW - 3 SWs are working	6 SWs (3 HESAWA, 3 LIDEP)15 Traditional dug wells 3 StreamsCharco dams15 springs
132	SENGEREMA	Sotta	3,500	1,700	1,800	30	1,600	430	25	1	1	- school building - charcoal dam construction	- credit - religious group	- constructed 1 SW - SW is working	1 SW (HP) 6 Traditional dug wells 1 Charco dam Lake Victoria
133	SENGEREMA	Isole	3,009	1,443	1,566	6	712	346	60	1	2	- flour milling - school facilities - school library	- credit - marketing society for cotton	- constructed 1 BH and 1SW - BH and SW are working	1 SW (HP) 1 BH (HP) 24 Traditional dug wells Stream Lake Victoria
134	SENGEREMA	Bitoto	2,669	1,368	1,301	22	1,531	408	34	0	0	- school facilities - health - village library	- credit - youth group (sport)	None	17 hand dug wells Ponds Lake Victoria
135	SENGEREMA	Kalangalanga (Kalangalala)	1,773	794	979	26	695	205	24	0	0	- school facilities - health	- credit - religious group	- constructed 1SW and school latrines	5 Temporary traditional wells Charco dams
136	SENGEREMA	Mlaga (Mulaga)	1,476	869	607	17	927	250	9	0	0	- school facilities - village library	- credit - bicycle repair group	None	2 Traditional dug wells Springs Streams Lake Victoria
137	SENGEREMA	Buswelu	2,437	1,209	1,228	21	incomplete data	300	30	0	0	- village government office - school facilities - health	- credit - carpentry group	None	6 Traditional dug wells Streams
138	SENGEREMA	Luharanyonga (Ruharanyonda)	3,241	1,602	1,639	10	unknown	565	33	0	5	- primary school construction - health	- health group	- constructed ring wells - 3 ring wells dry up during dry season	3 SWs 2 Traditional dug wells Streams
139	SENGEREMA	Kayenze	5,455	2,810	2,645	8	2,208	484	30	1	5	- education - health	- credit - dance group (self-help)	- constructed 3 SWs - 2 SWs are working	3 SWs Traditional dug wells Charco dams Streams River
140	SENGEREMA	Busekeseke	2,925	1,010	1,915	17	1,132	322	35	0	0	- SW construction (district budget) - maize production (FAO) - school buiding	- women group (credit)	None	5 Hand dug wells Springs

205 Villages Profile

No.	District	Village name	Population (village data)	Male	Female	No of disabled people	Children	No of HH	Female headed HH	Water Committee	WUG	Project experience	Activities of CBOs	HESAWA activities	Available water Sources
141	SENGEREMA	Katoma	3,229	1,565	1,664	60	1,612	367	45	0	0	- dispensary - education - health	- marketing of farm products - farming group	None	10 Hand dug wells 1 Charco dam Springs
142	SENGEREMA	Magulukenda	3,422	1,536	1,886	27	1,839	501	54	0	0	- construction of SW (district budget) - school building - construction of village government - construction	- credit group - farming group	None	5 Hand dug wells 2 Streams 1 Spring Wetlands
143	SENGEREMA	Buzilasoga	2,519	1,196	1,323	no data	1,519	251	19	1	0	- improvement of primary education	NA	None	5 Hand dug wells 1 Charco dam Streams
144	SENGEREMA	Kanyebele (Nyenebele?)	2,262	1,128	1,134	13	387	255	48	0	0	- school building	- credit - social service improvement	None	6 Hand dug wells Chraco dams Ponds
145	SENGEREMA	Bukokwa	6,893	3,388	3,505	49	1,817	1,079	70	0	0	- school building - health	- Lake Victoria conservation - gardening group	None	5 Hand dug wells 5 Springs (2 are seasonal) Lake Victoria Wetland
146	SENGEREMA	Nyancheche (Nyanchenche)	4,845	2,308	2,537	6	2,360	607	44	0	0	- PEDEP (school building)- Village library building	- credit	- excavated a SW but was not successful	1 HESAWA SW (not working) 19 Hand dug wells PondStream
147	SENGEREMA	Nyanzumla	3,594	1,701	1,893	15	2,179	418	22	0	1	- PEDEP (school buiding) - CSPD (child care)	- credit	None	Traditional dug wells Water from neighbouring village
148	SENGEREMA	Nyamiswi	2,052	542	1,510	11	941	407	41	0	0	- school buiding (primary and secondary)	- credit	None	6 Traditional dug wells 2 streans Lake Victoria
149	SENGEREMA	Nyakasasa	3,021	1,220	1,801	18	1,596	622	41	1	5	- Family planning - school buiding - child care	- credit - agriculture - brick making	None	15 Traditional dug wells Lake Victoria
150	SENGEREMA	Lugata	9,303	4,863	4,440	47	1,416	1,532	116	0	0	- school buiding	- health group	None	2 SWs (privately owned) Traditional dug wells Spring Stream Lake Victoria
151	SENGEREMA	Lushamba	8,400	no data	na	7	no data	1,100	no data	0	0	- school buiding - library	- credit - agriculture	None	7 Hand dug wells 3 Streams Lake Victoria
152	SENGEREMA	Bulyaheke	5,849	1,058	4,791	12	3,596	824	61	1	0	- school facilities - health	- tree planting - credit	None	9 Traditional dug wells River Lake Victoria
153	SENGEREMA	Ilyamchele	1,600	710	890	15	1,170	233	30	0	0	- school facilities	- assisting elderly - child care	None	Traditional dug wells Streams
154	SENGEREMA	Isengeng'he	unknown	unknown	na	50	unknown	unknown	70	0	0	- school facilities - health	- credit - farming	None	3 Traditional dug wells Wetland Lake Victorias
155	KWIMBA	Hungumalwa	7,795	2,978	4,817	11	unknown	900	352	1	7	- school facilities - saving credit	NA	- constructed 7 SWs and school latrines	7 SWs (HP) 4 Charco dams River

205 Villages Profile

No.	District	Village name	Population (village data)	Male	Female	No of disabled people	Children	No of HH	Female headed HH	Water Committee	WUG	Project experience	Activities of CBOs	HESAWA activities	Available water Sources
156	KWIMBA	Ilula	2,727	no data	na	no data	no data	502	no data	1	2	- school facilities - health	3 groups (education, credit)	- rehabilitated 3 wells constructed by RIDEP and MoWLD - 1 SW is working	2 BHs (1 not working) 1 SW Ponds Streams
157	KWIMBA	Igumangobo	1,813	906	907	29	978	259	15	1	0	- school facilities - health	3 groups (agriculture, credit, etc.)	- HESAWA failed to get water	8 Springs River Mwame
158	KWIMBA	Izizimba A	3,307	unknown	na	22	1,502	456	42	1	0	- school facilities	NA	- constructed 1SW but could not get water	1 SW (without HP) 5 Charco dams Stream
159	KWIMBA	Izizimba B	5,400	2,492	2,908	36	2,517	355	25	1	0	- school facilities - health - library	3 groups (agriculture, credit, etc.)	- started construction of school latrines but was not completed - drilled some wells but could not get water	Community ponds Private ponds
160	KWIMBA	Sanga	3,344	no data	na	no data	no data	425	no data	1(inactive)	0	- primary school building - secondary school	- credit	- drilled some boreholes but could not get water	Ponds
161	KWIMBA	Nyamatala	no data	no data	na	no data	no data	no data	no data	1	0	- primary school building - dispensary	1 group (credit)	- constructed 2 SWs - 1 SW is working	2 SWs (1 not working) 3 Ponds Streams
162	KWIMBA	Mhulya	no data	no data	na	no data	no data	no data	no data	0	0	- primary school building - dispensary	None	None	3 Traditional dug wells 2 Ponds Wetland
163	KWIMBA	Mwangika	1,981	967	1,014	24	925	350	63	1	5	- school building- health- rural road improvement	- fish sale group- local brewing	- constructed 1 SW	1 HESAWA SW6 Traditional wells1 Spring
164	KWIMBA	Ngwasweng'hele	2,177	1,065	1,112	13	1,000	379	50	1	2	- improvement of primary school building (community contributed labour and mason chsarge)	NA	- constructed 2 SWs and 8 VIP latrines	2 SWs 5 Traditional dug well Stream 1 Charco dam Streams
165	MAGU	Kitumba	3,287	1611	1,676	no data	888	600	no data	1	0	- health (child care) ^ school building	4 groups (credit, tree planting, etc.)	- constructed SWs and ITWs - SWs dries up	3 SWs (1 still working) 9 Traditional dug well 1 Charco dam 17 Ponds
166	MAGU	Bulima	7,134	3018	4,116	15	unknown	1238	200	0	0	- improvement of primary school building - health(vaccination, etc.)	None	- constructed 2 SWs and school latrines	2 SWs (1 still working) Streams Lake Victoria
167	MAGU	Ihayabuyaga A	3,979	1926	2,053	83	1639	483	78	1	1	- school building - child care - milling machine	4 groups (agriculture, tree planting, etc.)	- constructed 1 SW which is still working	2 SWs (HP) 3 Traditional hand dug wells Charco dams Springs Ponds
168	MAGU	Kijereshi (Kijilishi)	9,968	3984	5,984	26	na	712	162	1	2	- school building - child care - dispensary construction	2 groups (credit and agriculture)	- constructed 2 SWs which are still working	2 SWs (HP) 1 dam 8 Hand dug wells Streams Spring

205 Villages Profile

No.	District	Village name	Population (village data)	Male	Female	No of disabled people	Children	No of HH	Female headed HH	Water Committee	WUG	Project experience	Activities of CBOs	HESAWA activities	Available water Sources
169	GEITA	Igate	4,244	1,111	3,133	587	1,792	587	50	0	0	- school building	- credit group - farming group	None	Traditional wells Rain water Lake Victoria River
170	GEITA	Idosero	3,713	1,741	1,972	539	1,760	539	35	0	0	- school building - dispensary - health	- credit group	None	8 Traditional wells
171	GEITA	Lwenzera (Lwezera)	10,809	3,348	7,461	1,779	3,880	1,779	na	0	7	- school building - village government office construction - dispensary	- credit group	None	56 Traditional wells Rain water Stream
172	GEITA	Nzera	6,918	1,304	5,614	1,229	2,727	1,229	2,887	0	7	- school building - village government office construction	None	7 shallow wells with pumps	7 SWs Traditional wells Rain water
173	GEITA	Buligi	7,112	3,431	3,681	na	1,895	na	40	0	7	- school building - village government office construction	None	None	48 Traditional wells Rain water Stream
174	GEITA	Kakubilo (Kakubiro)	13,379	6,692	6,687	2,164	7,867	2,164	108	0	0	- saving credit - school building - health	- credit group - self-help group	None	26 Traditional wells Rain water
175	GEITA	Nyabalasana (Nyabarasana)	5,256	2,513	2,743	480	2,872	480	28	0	7	- school building - health	- credit group - self-help group	None	Traditional wells Springs Lake Victoria
176	GEITA	Kaseni	2,916	1,452	1,464	341	568	341	10	1	0	- school building - Village projects (construction of a secondary school and VG office)	- credit group - farming group	None	6 Traditional wells Rain water Stream Lake Victoria
177	GEITA	Nyamboge	7,085	3,192	3,893	1,079	2,094	1,079	na	1	0	- school facilities- library	None	None	10 Traditional wells Rain water Lake Victoria
178	GEITA	Bugulala (Bugulula)	5,430	2,010	3,420	604	3,600	604	31	0	0	- school facilities - library	- credit group	None	22 Traditional wells
179	GEITA	Kasota	8,221	952	7,269	730	5,788	730	74	0	0	- school facilities - library	None	None	9 Traditional wells Streams
180	GEITA	Nyamilongo (Nyamilyango)	3,684	1,910	1,774	626	2,408	626	na	0	0	- school facilities - environemnt conservation	None	None	7 Traditional wells Rain water Streams
181	GEITA	Kamena	6,217	na	na	520	1,726	520	na	0	0	- education (school facilities) - road - market	None	None	8 Traditional wells Rain water 5 Local dams
182	GEITA	Bushishi	3,176	1,783	1,393	512	1,997	512	96	0	0	- primary education development - road construction	Income generation (credit, handicraft, etc.)	None	7 Traditional wells Rain water 1 Charco dam
183	GEITA	Ndelema	2,454	1,198	1,256	304	517	304	21	0	0	- primary education development - road construction	- self-help group	None	5 Traditional wells 1 Charco dam
184	GEITA	Nyashishima	1,384	598	786	160	470	160	16	0	0	- primary education development - health	- women group (credit, handicraft, etc.)	None	4 Traditional wells 1 Charco dam Ponds
185	GEITA	Bogogo (Bugogo)	6,079	3,039	3,040	Unknown	1,811	na	na	1 (inactive)	0	- school facilities - health	- women group (credit, etc.)	Constructed 1 borehole-the well has not been working since 2004, now the VG has rehabilitated it	5 boreholes Traditional wells
186	GEITA	Ikina	1,638	846	792	265	673	265	13	0	0	- primary education development - school facilities	None	None	3 Traditional wells 2 Charco dams Springs

205 Villages Profile

No.	District	Village name	Population (village data)	Male	Female	No of disabled people	Children	No of HH	Female headed HH	Water Committee	WUG	Project experience	Activities of CBOs	HESAWA activities	Available water Sources
187	GEITA	Ntono	10,864	5,430	5,434	882	2,973	882	20	0	0	- health - school facilities - village library	None	None	Traditional wells 1 Charco dams Rain water
188	GEITA	Ihega	2,500	1,096	1,404	337	1,244	337	21	0	0	- school facilities - library	- health - credit	None	2 SWs (not functioning now) Traditional wells Rain water, Stream
189	GEITA	Nyaruyeye	4,227	2,085	2,142	540	2,510	540	35	0	0	- primary education development - health	- farming - brick making	None	4 Traditional wells Chraco dam Spring
190	GEITA	Kasangamile	1,732	847	885	260	na	260	10	0	0	- school facilities - health	- credit	None	4 Traditional wells 3 Chraco dams
191	GEITA	Ibondo	6,320	1,777	4,543	500	2,289	500	49	0	0	- school facilities - health (dispensary)	- credit	None	10 Traditional wells Rain water
192	GEITA	Kasangwa	7,548	3,600	3,948	1,200	3,782	1,200	40	0	0	- school facilities - health	- farming group	None	9 Traditional wells Rain water
193	GEITA	Isima	3,229	1,520	1,709	516	659	516	na	0	0	- school facilities - village library	- irriigation - credit	None	Traditional wells Stream
194	GEITA	Ikangala	1,303	626	677	206	227	206	19	1	1	- school facilities - health	- women group - youth group	None	3 Traditional wells Rain water Pipeline? 3 Charco dams
195	UKEREWE	Bwasa	3,614	no data	na	21	1591	434	69	1	5	- school building - Local SACCOS (credit services)	3 groups (education, etc.)	- constructed 2 SWs and 3 ITWs- One hand pump was stole	PWS (not working) 5 SWs (2 with HP) Traditional wells Lake Victoria
196	UKEREWE	Namasabo	1,602	806	796	15	713	570	42	1	3	- school building - Local SACCOS (credit services)	NA	- constructed 1 SW and rehabilitated 3 SWs - 1 SW is not operating	4 SWs (1 with HP) 4 Traditional wells River, Lake Victoria
197	UKEREWE	Bugala (Bugula)	5,143	2451	2,692	23	2645	971	no data	1	12	- school building - CSPD (child care)	4 groups (agriculture, credit, etc.)	- constructed 9 SWs	9 HESAWA wells 10 Traditional wells Springs Lake Victoria
198	UKEREWE	Ihebo	no data	na	na	no data	no data	no data	no data	1	4	- school building - CSPD (child care)	3 groups (agriculture, fishing, etc.)	- constructed 1 SW	1 HESAWA well 3 Traditional wells Springs Lake Victoria
199	UKEREWE	Masonga	7,872	na	na	no data	no data	no data	no data	1	6	- school building - construction of a secondary school	2 groups (tree planting and credi)	- constructed 6 SWs	5 SWs 2 Traditional wells Streama Lake Victoria
200	UKEREWE	Kweru (Kweru island)	3,430	1,210	2,220	20	1692	490	50	0	1	- school building - CSPD (child care)	2 groups (agriculture, etc.)	None	1 Traditional wells Springs Lake Victoria
201	UKEREWE	Bulamba	5,793	3,339	2,454	47	no data	615	62	0	5	- school building - CSPD (child care) - VI (agro-forestry)	5 groups (gardening, fishing, etc.)	- constructed 3 SWs and 1 ITW	10 Traditional wells 4 Improved wells Ponds Lake Victoria
202	UKEREWE	Nantare	no data	na	na	no data	no data	no data	no data	0	0	- school building - VI (agro-forestry)	2 groups (gardening, etc.)	None	2 Traditional wells Springs Lake Victoria
203	UKEREWE	Halwego	5,480	na	na	130	2,877	711	200	1	3	- school building - Local SACCOS (credit services)	3 groups (gardening, etc.)	None	3 SWs (HP) 6 Improved SWs Springs, Ponds River
204	UKEREWE	Buhima	5,972	na	na	30	2,000	729	50	1	0	- school building - Local SACCOS (credit services)	NA	- constructed school latrines - improvement of 4 SWs	4 Improved SWs Traditional wells Springs, Ponds River

205 Villages Profile

No.	District	Village name	Population (village data)	Male	Female	No of disabled people	Children	No of HH	Female headed HH	Water Committee	WUG	Project experience	Activities of CBOs	HESAWA activities	Available water Sources
205	NYAMAGANA	Kishili	4,878	2,355	2,523	30	702	852	66	0	9	- construction of 1 SW under CSPD - school facilities	- credit (ifogong'ho) - gardening	- constructed 8 SWs, 7 latrines and 3 ITWs - 2 SWs are working - 6 hand pumps were stolen	9 SWs (HP) Traditional wells Ponds, River, Wetlands

Note: HH = household; WUG = water user group; CBO = community based organization; na = data are not available; SW = shallow well with hand pump; BH = borehole well with hand pump; ITW = improved traditional wells; PEDP = Primary Education Development Plan; CSPD = Child Survival Protection and Development Program; TANZAKESHO = government project working to strengthen decentralization through capacity building in participatory planning; SACCOS = Savings, Credit and Cooperative Societies; TASAF = Tanzania Social Action Fund; TANAPA = Tanzania National Parks Project

Source: Socio-economic Survey, JICA, October 2005

③ 100 Villages Profile

100 Villages Profile

No.	1	2	3	4	5	6	7	8	9
District	BUNDA	BUNDA	BUNDA	MUSOMA	MUSOMA	MUSOMA	MUSOMA	MUSOMA	MUSOMA
Village name	Mcharo	Buzimbwe	Namalama	Sirorisimba	Ryamisanga	Kisamwene	Mmazami	Chirorwe	Bugoji
No. of sub-village	4	5	na	na	na	6	na	na	9
Population (2002 census)	1,019	2,129	1,473	3,047	3,636	3,375	3,812	2,486	4,155
Population (village data)	1,018	2,281	1,597	3,589	4,136	3,685	3,974	2,928	5,993
Male	Na	1,077	751	1,700	no data	1,206	2,099	1,312	2,386
Female	Na	1,204	846	1,889	no data	2,479	1,875	1,616	3,607
No of disabled people	16	12	27	60	No data	300	35	17	113
Children	Na	1,124	Na	no data	2,062	no data	1,570	1,669	2,543
No of HH	170	303	219	354	734	456	768	378	620
Female headed HH	no data	60	22	70	no data	50	no data	41	115
Ethnic group	Sukuma, Sizaki, Wajita	Wakurya, Wajita, Jaluo, Sukuma	Wajita, Wakara, Wakerewe	Kurya, Ngirimi	Kurya	Zanaki, Wakabwa, Jita	Wakabwa, Wazanaki, Wajita	Jita, Sukuma, Luo	Jita, Sukuma, Zanaki
Name of Village Chairperson	Joseph Sambezi	Augustine Hewa	Zablom Nyabutuna	Maroba Maroba	Martin Maiga	Charles Mwita	Raphael Kigarwire	Bernard Maiba	Tamasi Bwire
No. of active Water Committee	1	1	0	0	1	1	1	0	1
No. of active WUG	1	0	0	1	1	0	1	0	9
Project experience	PEDEP (primary education development plan)	PEDEP, CSPD with contribution	TASAF, DDP, PEDEP and CSPD	PEDEP and CSPD	PEDEP, LVEMP, CSPD, WWF	PEDEP, TASAF, CSPD with contribution	PEDEP, CSPD with contribution	PEDEP, CSPD, MARAFIP (agriculture)	PEDEP, UNICEF, CSPD
Activities of CBOs	None	- construction of school - tree planting - livestock keeping	- agriculture labour - petty business - fish vending	- credit services (women group)	- environmental conservation - burnt brick making - livestock keeping - local credit services	- tailoring - burnt brick making - agriculture marketing	- assistance for elders - supporting children - HIV/AIDS campaign	- rice cultivation - cassava cultivation (women group)	- assistance for elders - credit services
HESAWA activities	- constructed 1 SW - SW is functioning	- constructed VIP latrines in schools and for 60 households (HHs)	None	- constructed 1 SW - SW is not functioning (broken down in September 2005)	- constructed 4 SWs and slabs for pit latrines - 3 hand pumps were stolen and 1 HP is kept in the office	None	- constructed 1 improved well without hand pump, a VIP latrine for primary school and 7 VIP latrines in the village	None	None
Available water sources	1 SW 1 Traditional well Streams	Streams Lake Victoria	5 Traditional wells Lake Victoria	1 SW (HP), Traditional wells Streams	PWS (wind pump, 150 HHs) 8 Traditional wells (3 permanent wells) River, Ponds	4 Traditional wells Ponds Streams	3 SWs (1 is in operation) Traditional wells Spring, ponds Streams	8 Traditional wells River Lake Victoria	4 BH wells (HP) Traditional wells River Ponds, wetlands
Availability of electricity	None	None	None	None	None	None	None	None	None
Willingness to pay (WTP) for monthly payment (Tsh)	1000 - 1500	500 - 1000	500 - 1000	500 to 1000	500 to 1000	500 to 1000	500 to 1000	1000 to 1500	500<
Willingness to pay (WTP) per bucket of 20 liters (Tsh)	15 - 20	10 - 15	15 - 20	10 - 15	15 - 20	10 - 15	10 - 15	10 - 15	15 - 20
Water Consumption per person per day (lpd)	14	16	23	11	13	12	7	18	4
Collection of water charge or fund (Tsh)	20,000	0	0	0	186,000	0	20,000	0	0
Main farm products	Cotton, maize, cassava, sweet potatoes, millet	Cotton, maize, cassava, millet, lentils	Cassava, sweet potatoes, maize, cotton	Cassava, millet, beans, maize	Cassava, millet, ground nuts	Cassava, millet, maize	Cassava, millet, sweet potatoes	Cassava, millet, cotton, maize, rice	Cassava, millet, cotton, maize, sweet potatoes
Disposable monthly income (Tsh)	49,381	19,781	30,113	61,150	64,750	24,375	20,700	59,531	82,438
Remarks	Water committee was established by HESAWA and a WUG is available.	Water committee was established by HESAWA, but no WUG is available.	There is no water committee.	There is no water committee, but a WUG is available.	Water committee was established by HESAWA and a WUG is available.	Water committee was established by HESAWA, but WUG is not available.	Water committee was established by HESAWA and a WUG is available.	There is not a water committee, nor WUG.	Water committee was established by HESAWA and 9 WUGs are available.

Source : Socio-economic Survey, JICA, 2005

100 Villages Profile

No.	10	11	12	13	14	15	16	17	18
District	MUSOMA	MUSOMA	MUSOMA	MUSOMA	MUSOMA	MUSOMA	MUSOMA	MUSOMA	MUSOMA
Village name	Saragana	Kaburabura	Nyabekwabi	Isaba	Songora	Musanja	Butata	Rusoli	Bukumi
No. of sub-village	na	Na	9	na	na	na	na	Na	Na
Population (2002 census)	3,538	1,714	4,084	3,160	5,621	3,937	4,938	2,836	2,272
Population (village data)	3,864	1,892	4,752	2,900	5,937	4,439	4,259	3,479	1,998
Male	1,987	No data	2,621	1,366	2,753	1,916	2,111	1,648	962
Female	1,877	no data	2,131	1,534	3,184	2,523	2,148	1,831	1,036
No of disabled people	20	No data	20	no data	no data	no data	69	44	30
Children	2,190	No data	2,620	no data	no data	1,866	1,751	1,523	1,568
No of HH	607	260	740	459	no data	584	667	420	350
Female headed HH	64	No data	150	100	no data	44	89	57	45
Ethnic group	Jita, Sukuma, Kurya	Jita, Sukuma, Jalu	Wakurya, Jita, Zanaki	Wazanaki, Wajita, Wasukuma	Wazanaki, Waluo, Wakurya	Jita, Luo, Sukuma	Jita, Kwaya, Kerewe	Jita	Jita
Name of Village Chairperson	Alfonce K. Sanda	Baysou Bugera	Mfungo Nyamaka	Iddy Lukonge	Abubakari Tange	Joel Magiti	Jumapili Eganya	Boaz Nyelula	Mangerepa Rugina
No. of active Water Committee	1	1	0	1	0	1	0	0	0
No. of active WUG	0	0	0	0	0	0	0	8	0
Project experience	- PEDEP - fish pond construction	- PEDEP (construction of schools)	- PEDEP, CSPD with contribution	- PEDEP, CSPD with contribution	NA	- PEDEP (construction of class rooms, etc.) - CSPD (maternal & child care) - VI (agro-forestry)	- PEDEP (construction of class rooms, etc.) - Construction of a secondary school	- PEDEP (construction of schools, etc.) - VI (agro-forestry) - VIFAFI (agriculture) - CSPD (maternal & child care)	- PEDEP (construction of schools, etc.) - VI (agro-forestry)
Activities of CBOs	- assistance for elders - assistance for children	- joint cultivation - HIV/AIDS campaign	None	- assistance for children - assistance for elders	- Local credit	- smoking fish - buying crops and cotton - carpentry	- orphan and women health - youth skills development (handicraft)	- tree planting - gardening - milling machine operation	- agro-forestry
HESAWA activities	None	None	None	- constructed 1 SW	None	None	None	None	None
Available water sources	1 BH (not working) Springs Streams	20 Traditional wells (4 permanent wells) Stream	Traditional wells Lake Victoria Ponds, streams	1 SW (HP) Traditional wells Streams, ponds	Traditional wells Streams, ponds	7 Traditional wells Lake Victoria	3 Traditional wells Lake Victoria Wetland during rainy season	5 Traditional wells (2 permanent wells) Lake Victoria	2 Traditional wells Lake Victoria Wetland
Availability of electricity	None	None	None	None	None	None	None	None	None
Willingness to pay (WTP) for monthly payment (Tsh)	500	1000 to 1500	500	500	1500 to 2000	500 to 1000	1500	500 to 1000	500 to 1000
Willingness to pay (WTP) per bucket of 20 liters (Tsh)	10	10 - 15	20	10	15 - 20	15 - 20	20	15 - 20	15 - 20
Water Consumption per person per day (liter)	10	16	14	7	13	8	11	11	9
Collection of water charge or fund (Tsh)	0	12,000	0	0	0	150,000	0	0	0
Main farm products	Cassava, millet, sweet potatoes, maize, rice	Cassava, maize, millet, sweet potatoes, rice	Cassava, Sweet potatoes	Cassava, sweet potatoes	Cassava, maize, sweet potatoes, millet	Cassava, millet, cotton, maize	Cotton, cassava, sweet potatoes, millet, rice	Cassava, millet, cotton, rice, sweet potatoes	Cassava, Rice, cotton, sweet potatoes
Disposable monthly income (Tsh)	13,300	13,953	59,869	91,750	18,019	50,750	45,763	13,681	54,500
Remarks	Water committee was established by HESAWA, but no WUG is available.	Water committee was established by HESAWA, but no WUG is available.	There is not a water committee, nor WUG.	Water committee was established by HESAWA, but no WUG is available.	There is not a water committee, nor WUG.	Water committee was established by HESAWA, but no WUG is available.	There is not a water committee, nor WUG.	There is no water committee, but 8 WUGs are available.	There is not a water committee, nor WUG.

Source : Socio-economic Survey, JICA, 2005

100 Villages Profile

No.	19	20	21	22	23	24	25	26	27
District	MUSOMA	MUSOMA	MUSOMA	MUSOMA	TARIME	TARIME	TARIME	TARIME	TARIME
Village name	Mkirira	Kiamba	Kigera	Kiriba	Magena	Kebweye	Nyankunguru	Matongo	Kewanja
No. of sub-village	na	9	7	na	6	3	7	7	6
Population (2002 census)	2,626	3,202	5,697	2,776	2,314	2,105	4,102	2,934	3,679
Population (village data)	4,267	2,883	5,600	2,973	2,195	no data	4,450	4,035	4,061
Male	1,701	no data	no data	1,157	516	no data	1,650	No data	1,959
Female	2,566	no data	no data	1,816	1,679	no data	2,800	no data	2,102
No of disabled people	11	no data	no data	48	18	no data	16	No data	Not known
Children	no data	no data	no data	1,723	544	no data	1,553	No data	1,442
No of HH	418	493	800	364	450	no data	923	435	640
Female headed HH	no data	no data	140	38	No data	no data	20	No data	57
Ethnic group	Kwaya, Jita, Kurya	Wakwaya, Wakurya, Waluo	Kwaya, Luo, Jita	Jita, Kwaya	Kurya	Kurya	Kurya	Kurya	Kurya
Name of Village Chairperson	Paschal Bwano	Peter Kokela	Aloyce Alphone	Yohana Magaye	Constantino Moniko	Ambrose Basil	Abel Y.Maginga	John Nyangi	Bogomba R. Makonge
No. of active Water Committee	0	0	0	1	0	0	1	0	0
No. of active WUG	2	0	5	1	16	0	0	0	0
Project experience	- PEDEP (construction of schools, etc.) - Construction of a secondary school	- PEDEP (construction of schools, etc.) - VI (agro-forestry) - Beach Management	- PEDEP (construction of schools, etc.) - VODP (furniture workshop) - CSPD (maternal & child care)	- PEDEP (construction of schools, etc.) - VI (agro-forestry) - CSPD (maternal & child care)	- PEDEP (construction of schools, etc.) - construction of a dispensary	- PEDEP (construction of schools, etc.)	- VI (agro-forestry.) - LVEMP (rehabilitation of class rooms) - CSPD (maternal & child care)	- PEDEP (construction of primary school)	- PEDEP (construction of primary school)
Activities of CBOs	- tree planting - rehabilitation of wells	None	- collective agriculture labour - fishing - local credit	- farming together and sharing produce	- vegetable gardening	None	- agro-forestry	- joint cultivation	- gardening (women group) - sewing
HESAWA activities	None	None	None	- constructed a BH	- constructed 4 SWs and school latrines - 3 SWs are working	None	None	None	None
Available water sources	4 Traditional wells 1 Dam 2 Springs Wetland during rainy season	2 SWs (1 private) 6 Traditional wells Streams 6 Springs	3 Improved wells Lake Victoria	1 BH (broken) Traditional wells Streams Ponds	5 SWs (2 working) 11 Traditional wells 8 Springs River, streams	11 Traditional wells Streams	36 Traditional wells River, ponds Wetland during rainy season	Pond River, streams	10 Traditional wells 1 dam Streams
Availability of electricity	None	None	None	None	None	None	None	None	None
Willingness to pay (WTP) for monthly payment (Tsh)	1000 to 1500	1500 to 2000	500<	500<	1500 - 2000	1500 -2000	500 -1000	1500 -2000	1500 -2000
Willingness to pay (WTP) per bucket of 20 liters (Tsh)	10 – 15	15 - 20	15 – 20	10<	15 - 20	15 - 20	20>	15 - 20	15 – 20
Water Consumption per person per day (liter)	14	21	8	6	21	10	12	13	15
Collection of water charge or fund (Tsh)	0	0	0	0	0	0	24,400	0	0
Main farm products	Cotton, beans, maize, cassava, rice	Maize, cassava, cotton, rice, beans, groundnuts	Cotton, maize, cassava, beans, sweet potatoes, pineapples	cotton, beans, maize, cassava, rice, ground nuts, pineapples	Millet, cassava, finger millet, sweet potatoes, banana	Cassava, millet, finger millet, maize, sweet potatoes, beans, tomatoes, banana	Millet, cassava, maize, paddy	Cassava, millet, finger millet, ,maize, paddy	Cassava, millet, Finger millet, maize, rice, groundnuts
Disposable monthly income (Tsh)	89,563	48,650	27,856	32,688	28,310	11,220	5,099	41,592	34,281
Remarks	There is no water committee, but 2 WUGs are available..	There is not a water committee, nor WUG.	There is no water committee, but 5 WUGs are available..	Water committee was established by HESAWA, and a WUG is available.	There is no water committee, but 16 WUGs are available..	There is not a water committee, nor WUG.	Water committee was established by HESAWA, but no WUG is available.	There is not a water committee, nor WUG.	There is not a water committee, nor WUG.

Source : Socio-economic Survey, JICA, 2005

100 Villages Profile

Village No.	28	29	30	31	32	33	34	35	36
District	TARIME	TARIME	TARIME	TARIME	TARIME	TARIME	TARIME	TARIME	TARIME
Village name	Ng'ereng'ere	Kikomori	Nkerege	Sombanyasoko	Bisarwi	Kisumwa	Nyankonge	Omoche	Thabache
No. of sub-village	na	na	na	4	8	8	6	5	4
Population (2002 census)	2,102	1,914	2,482	847	2,618	1,912	1,472	3,271	1,568
Population (village data)	2,413	5,000	4,000	856	2,379	1,931	1,411	3,343	1,683
Male	1,191	2,236	no data	161	1,095	962	542	1,542	779
Female	1,222	2,764	no data	695	1,284	969	869	1,801	904
No of disabled people	12	28	no data	4	12	23	37	20	26
Children	1,243	1,500	no data	491	1,282	1,354	527	1,540	597
No of HH	454	397	no data	147	380	405	435	722	332
Female headed HH	94	16	no data	25	46	Not available	no data	50	None
Ethnic group	Kurya	Kurya	Kurya	Kurya, Jaluo	Kurya, Jaluo	Kurya	Kurya, Kine	Jaluo, Kine	Rieri, Jaluo
Name of Village Chairperson	William N.Wangubo	Magesa Ketonga	Gimano Gibe	Charles J.Nyihambe	Abel Chacha Choggo	Thobias Chacha	Joash D.Makenge	Chacha Antony	Christopher Oleke Osen
No. of active Water Committee	0	0	0	1	1	1	1	1	0
No. of active WUG	2	0	0	1	1	0	NA	1	0
Project experience	- PEDEP (construction of schools, etc.) - CSPD (maternal & child care)	- UNICEF (child care.) - VI (agro-forestry) - PEDEP (construction of class rooms, etc.)	- PEDEP (construction of class rooms, etc.) - construction of village office	- CSPD (maternal & child care) - PEDEP (construction of class rooms, etc.) - VI (agro-forestry)	- IFAD (cattle dipping) - PEDEP (construction of class rooms, etc.)	- CSPD (maternal & child care) - PEDEP (construction of class rooms, etc.) - VI (agro-forestry)	- CSPD (maternal & child care) - PEDEP (construction of class rooms, etc.)	- PEDEP (construction of class rooms, etc.) - VI (agro-forestry)	- CSPD (maternal & child care) - PEDEP (construction of class rooms, etc.)
Activities of CBOs	- joint farming	None	- environmental conservation - joint farming	- brick making - tree planting - poultry	- carpentry - cattle dipping - joint farming - shop	- rice growing - tailoring - burnt brick making	- farming (women group)	- vegetable gardening - tailoring	None
HESAWA activities	- constructed 2 BHs, 6 ITWs and improved pit latrines - 2 BHs are working	None	- constructed school latrines	- constructed 1 SW and 20 slabs for pit latrines	- constructed 1 SW and 32 households pit latrines - SW is working	None	- constructed 1 BH - BH is working	- constructed a BH and school latrines - BH is working	- started construction of a BH but not completed
Available water sources	2 BH (HP) 6 Improved wells 8 Traditional wells 4 Streams Wetland	Traditional wells Spring	2 BH (without HP) 4 Traditional wells 1 Pond River	1 SW (HP) 4 Traditional wells Streams 1 Pond	1 SW (HESAWA) 8 Traditional wells (4 permanent wells) River	6 Traditional wells (3 permanent wells) Wetland Neighbouring village	1 BH (HP) 3 Traditional wells Lake Victoria Ponds Wetland	2 BH (HP) 3 Traditional wells Ponds, river Wetland	3 Traditional wells 1 Charco dam
Availability of electricity	None	None	None	None	None	Yes	None	None	None
Willingness to pay (WTP) for monthly payment (Tsh)	500 -1000	500 -1000	1500 -2000	500 -1000	500 -1000	1000 -1500	500 -1000	500 -1000	500 -1000
Willingness to pay (WTP) per bucket of 20 liters (Tsh)	15 – 20	15 – 20	15 - 20	15 - 20	15 - 20	10 - 15	10 - 15	15 - 20	10 – 15
Water Consumption per person per day (liter)	17	12	17	12	13	12	11	11	10
Collection of water charge or fund (Tsh)	0	0	0	0	0	0	24,400	0	0
Main farm products	Millet, cassava	Millet, cassava, finger millet, sweet potatoes, banana	Millet, finger millet, maize, sweet potatoes	Millet, finger millet, maize, cassava	Millet, maize, cotton, cassava	Millets, cassava, maize, finger millet, paddy, peas	Cassava, maize, paddy, millet, groundnuts, beans	Millets, cassava, maize, finger millet, cotton	Millet, Cassava, maize, finger millet, sweet potatoes
Disposable monthly income (Tsh)	50,684	18,453	6,393	31,597	49,043	22,552	12,244	32,292	16,693
Remarks	There is no water committee, but 2 WUGs are available.	There is not a water committee, nor WUG.	There is not a water committee, nor WUG.	Water committee was established by HESAWA, and a WUG is available.	Water committee was established by HESAWA, and a WUG is available.	Water committee is available, but there is no WUG.	Water committee is available, but there is no WUG.	Water committee was established by HESAWA, and a WUG is available.	There is not a water committee, nor WUG.

Source : Socio-economic Survey, JICA, 2005

100 Villages Profile

No.	37	38	39	40	41	42	43	44	45
District	TARIME	TARIME	TARIME	TARIME	TARIME	TARIME	TARIME	TARIME	TARIME
Village name	Radienya	Masike	Bukama	Nyarombo	Rwang'enyi	Oliyo	Ryagoro	Nyamusi	Tatwe
No. of sub-village	3	6	4	4	5	5	4	5	8
Population (2002 census)	1,699	2,359	3,713	1,894	2,971	3,229	2,682	1,632	3,777
Population (village data)	2,803	1,874	3,920	1,895	2,974	3,325	2,885	1,050	3,182
Male	600	1,033	1,943	476	1,395	1,556	1,307	470	1,516
Female	2,203	841	1,977	1,419	1,579	1,769	1,578	580	1,666
No of disabled people	16	53	86	No data	25	499	48	39	38
Children	1,353	1,064	1,780	876	1,428	1,320	1,385	448	1,500
No of HH	540	494	850	441	627	634	486	241	680
Female headed HH	No data	N/A	No data	No data	No data	unknown	No data	no data	no data
Ethnic group	Jaluo	Jaluo	Jaluo, Kine	Kurya, Jaluo	Kakiseru, Jaluo, Kine	Jaluo	Jaluo, Kurya, Suba	Luo	Jaluo, Riene, Kurya
Name of Village Chairperson	Eliphace Keke	William Ager Ogot	Aron Aweti	Nicholaus Omusi	Nchama Nyarwaro	Susan Onea	Ernest Paulo Agalla	Philipo Karani	Aloyce Ojoi
No. of active Water Committee	0	0	0	0	0	1	0	0	0
No. of active WUG	0	0	0	0	0	3	0	0	2
Project experience	- PEDEP (construction of class rooms and teachers' houses) - Dispensary construction	- PEDEP (construction of class rooms and teachers' houses) - District Road Project - REDEP (construction of a BH well, unsuccessful)	- PEDEP (construction of class rooms, etc.) - Cattle dip construction - Construction of a secondary school	- CSPD (maternal & child care) - PEDEP (construction of class rooms, etc.)	- CSPD (maternal & child care) - PEDEP (construction of class rooms, etc.) - LWEMP (construction of a dispensary)	- Construction of a dispensary - PEDEP (construction of class rooms, etc.)	- PEDEP (construction of class rooms, etc.)	- CSPD (maternal & child care) - PEDEP (construction of class rooms, etc.)	- Roman catholic church (construction of vocational training centre) - PEDEP (construction of class rooms, etc.)
Activities of CBOs	None	None	- tree planting - tailoring - carpentry - bicycle repair	- credit facilities - toilet construction - carpentry	- irrigation	None	None	- tailoring - gardening - sugar cane farming	None
HESAWA activities	None	- constructed a BH - BH is not working	- started construction of a SW but not completed - constructed school latrines	- constructed 2 BHs and a SW but BHs are not completed - BHs are not working (no pump)	None	- constructed 1 BH and 2 SWs but 1 SW has no water - BH is working - 1 SW is working	None	None	None
Available water sources	3 Traditional wells Ponds Lake Victoria	2 BH (HP) 5 Traditional wells Spring River	13 Traditional wells 3 Springs River	1 SW 1 BH (not working) 6 Traditional wells Streams Lake Victoria	8 Traditional wells Ponds Lake Victoria	3 SWs (2 not working) 1 BH 1 Traditional well Stream	5 Traditional well 4 Streams	8 Traditional wells Ponds, springs Streams	8 Traditional wells River Ponds
Availability of electricity	None	Yes	None	None	None	Yes	None	None	None
Willingness to pay (WTP) for monthly payment (Tsh)	500 -1000	500 -1000	1500 -2000	1000 -1500	500 -1000	1500 -2000	1500 -2000	500 -1000	500 -1000
Willingness to pay (WTP) per bucket of 20 liters (Tsh)	10 - 15	10 - 15	15 - 20	15 - 20	10 - 15	15 - 20	15 - 20	10 - 15	10 - 15
Water Consumption per person per day (liter)	15	10	22	11	9	17	21	11	14
Collection of water charge or fund (Tsh)	0	0	0	0	0	52,316	0	0	0
Main farm products	Cassava, millet, beans, maize	Millet, cassava, maize, sweet potatoes	Millet, cassava, maize, finger millet	Cassava, millet, maize, beans, groundnuts	Millet, Cassava, Maize, paddy, sweet potatoes	Cassava, Millet, beans, Maize	Millet, cassava, maize, beans	Cassava, maize, sweet potatoes, millet	Millet, cassava, maize, finger millet, sweet potatoes
Disposable monthly income (Tsh)	13,604	13,901	35,313	22,589	8,573	24,381	15,167	13,984	43,391
Remarks	There is not a water committee, nor WUG.	There is not a water committee, nor WUG.	There is not a water committee, nor WUG.	There is not a water committee, nor WUG.	There is not a water committee, nor WUG.	Water committee was established by HESAWA, and 3 WUGs are available.	There is not a water committee, nor WUG.	There is not a water committee, nor WUG.	There is no water committee, but 2 WUGs are available.

Source : Socio-economic Survey, JICA, 2005

100 Villages Profile

No.	46	47	48	49	50	51	52	53	54
District	SERENGETI	SERENGETI	SERENGETI	MISUNGWI	MISUNGWI	SENGEREMA	SENGEREMA	SENGEREMA	SENGEREMA
Village name	Busawe	Nyansurura	Kebanchabancha	Busongo	Ngaya	Sogoso	Nyampande	Nyitundu	Lubanda
No. of sub-village	na	3	4	6	9	6	12	5	5
Population (2002 census)	1,101	2,828	4,568	4,715	3,687	3,604	3,222	1,906	2,242
Population (village data)	2,316	9,177	2,579	3,195	4,002	3,554	4,061	1,928	2,316
Male	1,024	4,371	1,149	1,220	1,990	1,306	1,348	970	1,109
Female	1,292	4,806	1,430	1,975	2,012	2,248	2,713	958	1,207
No of disabled people	unknown	248	20	na	30	58	39	13	54
Children	not stated	4,556	1,415	na	na	1,184	1,500	498	516
No of HH	168	821	373	885	290	385	458	297	352
Female headed HH	not stated	107	128	na	22	46	101	27	32
Ethnic group	Wangurime, Jaluo, Sukuma	Wakurya	Wakurya	Sukuma	Sukuma	Sukuma, Waha, Zinza,	Sukuma, Wazinza	Sukuma, Wazinza	Sukuma, Wazinza
Name of Village Chairperson	Boniface Richard Masambe	Jeremia Mbatiami Mwita	Anthony Maguga	Mishati Tindigwa	Meza Lunyilija	Salu Maduka	Nyororo Bundala	Samuel Buzinza	Clement Joseph
No. of active Water Committee	1(inactive)	0	1	1	1	1	0	0	0
No. of active WUG	0	0	4	1	0	2	0	0	0
Project experience	- PEDEP (construction of class rooms, etc.)	- PEDEP (construction of class rooms, etc.)	- CSPD (maternal & child care) - PEDEP (construction of class rooms, etc.) - DDP (construction of staff house for a dispensary)	- PEDEP (construction of class rooms, etc.) - Construction of secondary school	- PEDEP (construction of class rooms, etc. with community contribution)	- construction of BH (UNICEF) - village office construction - school building	- health (family planning, etc.) - school building	- school building - library - milling machine	- school building - health (HIV/AIDS)
Activities of CBOs	- bicycle repair - gardening - environmental conservation	- construction of public institutions (e.g. school)	- local credit facilities	None	NA	- credit	- credit - youth group (sport)	- credit - tree planting - livestock keeping	- credit - farming - livestock keeping
HESAWA activities	- constructed a BH but not operating (low yield)	- constructed 3 SWs - 2 SWs are working	- constructed 1 BH, 3 SWs, water tank and school latrines - 2 SWs are working	- constructed 1 BH - BH is working	- constructed 2 SWs - 2 SWs are working	None	- constructed 1 SW - SW has no water	- there was a plan to construct ring wells but it was not realized	None
Available water sources	1 BH (not working) 4 Traditional wells 2 Streams River, ponds	3 SWs (2 working) 4 Traditional wells 2 Streams River, ponds	5 SWs 14 Traditional wells Streams	1 BH 15 Traditional wells Ponds (8)	2 SWs (1 privately owned) Traditional dug wells Charco dams, Lake Victoria	2 SWs 12 traditional wells 4 charco dams Ponds	1 SW (not working) Hand dug wells 1 Pond Streams	Many traditional wells, River 2 charco dams Lake Victoria	Many traditional wells, River, Spring Wetlands Lake Victoria
Availability of electricity	None	None	None	None	None	None	None	None	None
Willingness to pay (WTP) for monthly payment (Tsh)	1000 -1500	1500 -2000	500 -1000	1500 – 2000	500 – 1000	500>	1500 to 2000	500>	500 to 1000
Willingness to pay (WTP) per bucket of 20 liters (Tsh)	15 – 20	15 - 20	10 - 15	10 – 15	10 – 15	10 - 15	15 - 20	15 - 20	10 – 15
Water Consumption per person per day (liter)	11	14	15	16	17	8	14	11	13
Collection of water charge or fund (Tsh)	40,000	0	65,000	800,000	0 (communities contribute the cost when needed)	80,000 (traditional wells)	0	0	0
Main farm products	Maize, cassava, rice, millet, sweet potatoes	Tobacco, maize, cassava, rice, sweet potatoes, millet	Cassava, maize, cassava, finger millet, millet	Maize, cassava, rice, cotton, millet, sweet potatoes	Maize, cassava, rice, cotton	Cassava, maize, rice, cotton	Cotton, maize, rice, millet, cassava, beans	Cotton, cassava, maize, rice, sweet potatoes	Cotton, cassava, maize, rice
Disposable monthly income (Tsh)	8,953	24,142	23,543	9,714	8,058	23,458	18,056	23,423	30,500
Remarks	Water committee was established but it is not active.	There is not a water committee, nor WUG.	Water committee was established by HESAWA, and 4 WUGs are available.	Water committee was established by HESAWA, and a WUG is available.	Water committee was established by HESAWA, but no WUG is available.	Water committee was established by HESAWA, and 2 WUGs are available.	There is not a water committee, nor WUG.	There is not a water committee, nor WUG.	There is not a water committee, nor WUG.

Source : Socio-economic Survey, JICA, 2005

100 Villages Profile

No.	55	56	57	58	59	60	61	62	63
District	SENGEREMA	SENGEREMA	SENGEREMA	SENGEREMA	SENGEREMA	SENGEREMA	SENGEREMA	SENGEREMA	SENGEREMA
Village name	Juma Kisiwani	Mwaliga	Nyakahako	Sotta	Isole	Mlaga	Buswelu	Luharanyonga	Busekeseke
No. of sub-village	3	na	8	5	8	4	na	5	4
Population (2002 census)	2,661	1,352	4,637	2,765	3,153	1,784	2,374	3,102	2,148
Population (village data)	2,314	1,460	4,380	3,500	3,009	1,476	2,437	3,241	2,925
Male	1,444	660	2,212	1,700	1,443	869	1,209	1,602	1,010
Female	870	800	2,168	1,800	1,566	607	1,228	1,639	1,915
No of disabled people	10	25	25	30	6	17	21	10	17
Children	1,400	360	1,092	1,600	712	927	incomplete data	unknown	1,132
No of HH	239	186	708	430	346	250	300	565	322
Female headed HH	50	30	unknown	25	60	9	30	33	35
Ethnic group	Kerewe, Zinza, Sukuma	Sukuma, Zinza, Haya	Zinza, Sukuma	Sukuma	Sukuma, Wazinza	Sukuma, Wazinza	Sukuma, Waha, Wasumbwa	Wakala, Sukuma	Sukuma, Wazinza, Waha
Name of Village Chairperson	Richard Rwerenja	Julius Corneli	Zaidi Mashauri	Patsory Lusangija	Paulin Gusule	Martius Tesh	Ikumbo Hobela	Magobe Maganda	Julius M. Maunugu
No. of active Water Committee	0	1	0	1	1	0	0	0	0
No. of active WUG	0	0	0	1	2	0	0	5	0
Project experience	- school building - health (child care) - assisting orphans	- primary school improvement	- school building	- school building - charcoal dam construction	- flour milling - school facilities - school library	- school facilities - village library	- village government office - school facilities - health	- primary school construction - health	- SW construction (district budget) - maize production (FAO) - school building
Activities of CBOs	- environment conservation	- health	- credit - fish breeding	- credit - religious group	- credit - marketing society for cotton	- credit - bicycle repair group	- credit - carpentry group	- health group	- women group (credit)
HESAWA activities	None	None	- constructed 1 SW - SW dries up during dry season	- constructed 1 SW - SW is working	- constructed 1 BH and 1SW - BH and SW are working	None	None	- constructed ring wells - 3 ring wells dry up during dry season	None
Available water sources	Lake Victoria	Traditional dug wells Stream close to Lake Victoria	1 SW (working only wet season) 11 Traditional dug wells Ponds Lake Victoria	1 SW (HP) 6 Traditional dug wells 1 Charco dam Lake Victoria	1 SW (HP) 1 BH (HP) 24 Traditional dug wells Stream Lake Victoria	2 Traditional dug wells Springs Streams Lake Victoria	6 Traditional dug wells Streams	3 SWs 2 Traditional dug wells Streams	5 Hand dug wells Springs
Availability of electricity	None	None	None	None	None	None	None	None	None
Willingness to pay (WTP) for monthly payment (Tsh)	500 to 1000	500 to 1000	1500 to 2000	500<	500 to 1000	500 to 1000	500 to 1000	1000 to 1500	500 to 1000
Willingness to pay (WTP) per bucket of 20 liters (Tsh)	15 - 20	10 - 15	15 - 20	15 - 20	15 - 20	15 - 20	15 - 20	15 - 20	10>
Water Consumption per person per day (liter)	19	10	13	10	11	17	12	24	12
Collection of water charge or fund (Tsh)	0	0	38,000	200,000	50,000	0	0	0	0
Main farm products	Cassava, sweet potatoes, cotton, fish	Cassava, maize, rice, cotton	Cassava, sweet potatoes, maize, rice, millet, cotton	Cotton, maize, beans (dengu), rice cassava	Maize, cotton, rice, cassava, groundnuts, sweet potatoes	Cotton, maize, cassava, rice, sweet potatoes, millet	Maize, cassava, cotton, rice, sweet potatoes	Cassava, rice, cotton, maize, sisal fibres	Cassava, maize, sweet potatoes, rice, cotton
Disposable monthly income (Tsh)	32,807	37,792	16,146	47,493	6,594	12,365	8,245	12,109	9,301
Remarks	There is not a water committee, nor WUG.	Water committee is available, but no WUG is available.	There is not a water committee, nor WUG.	Water committee was established by HESAWA, and a WUG is available.	Water committee was established by HESAWA, and 2 WUGs are available.	There is not a water committee, nor WUG.	There is not a water committee, nor WUG.	Water committee was established by HESAWA, but no WUG is available.	There is not a water committee, nor WUG.

Source : Socio-economic Survey, JICA, 2005

100 Villages Profile

No.	64	65	66	67	68	69	70	71	72
District	SENGEREMA	SENGEREMA	SENGEREMA	SENGEREMA	SENGEREMA	SENGEREMA	SENGEREMA	SENGEREMA	SENGEREMA
Village name	Katoma	Magulukenda	Bukokwa	Nyanchenche	Nyamiswi	Nyakasasa	Lugata	Lushamba	Bulyaheke
No. of sub-village	5	6	5	7	5	9	8	7	9
Population (2002 census)	2,541	3,198	6,861	4,821	2,050	3,585	10,953	9,496	4,628
Population (village data)	3,229	3,422	6,893	4,845	2,052	3,021	9,303	8,400	5,849
Male	1,565	1,536	3,388	2,308	542	1,220	4,863	No data	1,058
Female	1,664	1,886	3,505	2,537	1,510	1,801	4,440	na	4,791
No of disabled people	60	27	49	6	11	18	47	7	12
Children	1,612	1,839	1,817	2,360	941	1,596	1,416	No data	3,596
No of HH	367	501	1,079	607	407	622	1,532	1,100	824
Female headed HH	45	54	70	44	41	41	116	No data	61
Ethnic group	Sukuma, Waha, Wazinza	Sukuma, Wakerewe, Wazinza	Sukuma, Wazinza, Wagita	Sukuma, Zinza	Zinza, Sukuma, Kerewe	Zinza, Sukuma, Kerewe	Zinza, Kerewe, Sukuma	Zinza, Kerewe, Sukuma	Sukuma, Zinza, Gita, Waha
Name of Village Chairperson	Titus Lucas	Musa Paulo Mukerebe	Amos Mayunga	Mayalla Sanja	Kaligonga Malunga	Vitus Balichenu	Tibaheba Kaheza	Jonathan Lubazoha	James Joseph Mayala
No. of active Water Committee	0	0	0	0	0	1	0	0	1
No. of active WUG	0	0	0	0	0	5	0	0	0
Project experience	- dispensary - education - health	- construction of SW (district budget) - school building - construction of village government - construction	- school building - health	- PEDEP (school building) - Village library building	- school building (primary and secondary)	- Family planning - school building - child care	- school building	- school building - library	- school facilities - health
Activities of CBOs	- marketing of farm products - farming group	- credit group - farming group	- Lake Victoria conservation - gardening group	- credit	- credit	- credit - agriculture - brick making	- health group	- credit - agriculture	- tree planting - credit
HESAWA activities	None	None	None	- excavated a SW but was not successful	None	None	None	None	None
Available water sources	10 Hand dug wells 1 Charco dam Springs	5 Hand dug wells 2 Streams 1 Spring Wetlands	5 Hand dug wells 5 Springs (2 are seasonal) Lake Victoria Wetland	1 HESAWA SW (not working) 19 Hand dug wells Pond Stream	6 Traditional dug wells 2 streams Lake Victoria	15 Traditional dug wells Lake Victoria	2 SWs (privately owned) Traditional dug wells Spring Stream Lake Victoria	7 Hand dug wells 3 Streams Lake Victoria	9 Traditional dug wells River Lake Victoria
Availability of electricity	None	None	None	None	None	None	None	None	None
Willingness to pay (WTP) for monthly payment (Tsh)	1500 to 2000	1000 to 1500	1000 to 1500	1500 to 2000	1500 to 2000	500 to 1000	500 to 1000	1500 to 2000	500 to 1000
Willingness to pay (WTP) per bucket of 20 liters (Tsh)	10>	15 - 20	15 - 20	15 - 20	15 - 20	15 - 20	15 - 20	15 - 20	15 - 20
Water Consumption per person per day (liter)	11	19	27	20	16	16	17	20	23
Collection of water charge or fund (Tsh)	0	60,000	0	0	0	0	0	0	0
Main farm products	Cassava, maize beans, sweet potatoes	Cassava, maize, cotton, rice, beans, millet	Cotton, maize, rice, cassava, beans	Cotton, rice, maize, beans, groundnuts, chick peas	Cassava, maize, rice, sweet potatoes	Cotton, rice, bananas, fruits and vegetables	Cassava, maize, rice	Cassava, sweet potatoes, maize, rice, cotton	Rice, cassava, cotton, fruits
Disposable monthly income (Tsh)	7,794	9,592	18,784	19,250	10,584	13,032	22,242	35,875	20,370
Remarks	There is not a water committee, nor WUG.	There is not a water committee, nor WUG.	There is not a water committee, nor WUG.	There is not a water committee, nor WUG.	There is not a water committee, nor WUG.	A water committee and 5 WUGs are available.	There is not a water committee, nor WUG.	There is not a water committee, nor WUG.	A water committee is available.

Source : Socio-economic Survey, JICA, 2005

100 Villages Profile

No.	73	74	75	76	77	78	79	80	81
District	SENGEREMA	SENGEREMA	KWIMBA	KWIMBA	MAGU	GEITA	GEITA	GEITA	GEITA
Village name	Ilyamchele	Isengeng'he	Hungumalwa	Mhulya	Kijereshi	Idosero	Lwenzera	Buligi	Kakubilo
No. of sub-village	3	5	na	na	8	4	6	5	Na
Population (2002 census)	1,526	2,750	4,952	2,135	5,646	3,690	10,759	6,935	13,331
Population (village data)	1,600	unknown	7,795	no data	9,968	3,713	10,809	7,112	13,379
Male	710	unknown	2,978	no data	3,984	1,741	3,348	3,431	6,692
Female	890	na	4,817	no data	5,984	1,972	7,461	3,681	6,687
No of disabled people	15	50	11	no data	26	539	1,779	na	2,164
Children	1,170	unknown	unknown	no data	na	1,760	3,880	1,895	7,867
No of HH	233	unknown	900	no data	712	539	1,779	na	2,164
Female headed HH	30	70	352	no data	162	35	na	40	108
Ethnic group	Wakala, Sukuma, Wazinza	Sukuma, Gita, Zinza, Waha	Sukuma, Haya, Kurya	Sukuma	Sukuma	Sukuma Waha, Zinza, Sumbwa	Zinza, Sukuma	Sukuma, Waha, Jita	Sukuma, Waha, Jita
Name of Village Chairperson	Bwakuruma Bulebele	Michael Kitwima Kantoro	Aloyce Petro	Wilfred Lusomi	Francis Katambi	Clement Makono Maronja	Musa Kakinda	Deus Runyilya	Lugiko Ruduka
No. of active Water Committee	0	0	1	0	1	0	0	0	0
No. of active WUG	0	0	7	0	2	0	7	7	0
Project experience	- school facilities	- school facilities - health	- school facilities - saving credit	- primary school building - dispensary	- school building - child care - dispensary construction	- school building - dispensary - health	- school building - village government office construction - dispensary	- school building - village government office construction	- saving credit - school building - health
Activities of CBOs	- assisting elderly - child care	- credit - farming	NA	None	2 groups (credit and agriculture)	- credit group	- credit group	None	- credit group - self-help group
HESAWA activities	None	None	- constructed 7 SWs and school latrines	None	- constructed 2 SWs which are still working	None	None	None	None
Available water sources	Traditional dug wells Streams	3 Traditional dug wells Wetland Lake Victorias	7 SWs (HP) 4 Charco dams River	3 Traditional dug wells 2 Ponds Wetland	2 SWs (HP) 1 dam 8 Hand dug wells Streams Spring	8 Traditional wells	56 Traditional wells Rain water Stream	48 Traditional wells Rain water Stream	26 Traditional wells Rain water
Availability of electricity	None	None	None	None	None	None	None	None	None
Willingness to pay (WTP) for monthly payment (Tsh)	500	1500 to 2000	500 to 1000	1500 to 2000	1500 to 2000	500 to 1000	1000 to 1500	500 to 1000	1000 to 1500
Willingness to pay (WTP) per bucket of 20 liters (Tsh)	10 – 15	10 - 15	15 - 20	15 - 20	20<	15 - 20	15 - 20	15 - 20	10>
Water Consumption per person per day (liter)	24	13	13	12	12	10	17	9	13
Collection of water charge or fund (Tsh)	0	0	0 (water users contribute the cost when needed)	0	0	0	0	0	0
Main farm products	Cassava, rice, sweet potatoes	Cassava, Rice, Cotton	Cotton, Maize, Cassava, Rice, sweet potatoes	Cassava, millet, cotton, rice	Cotton, Cassava, Rice, sweet potatoes, maize, millet	cotton, beans, maize, cassava, rice	maize, cassava, rice, ground nuts, millet, cotton	maize, cassava, rice, ground nuts, sweet potatoes	maize, cassava, rice, sweet potatoes, pineapples
Disposable monthly income (Tsh)	10,645	15,564	16,414	4,002	18,786	10,438	27,648	9,422	39,479
Remarks	There is not a water committee, nor WUG.	There is not a water committee, nor WUG.	Water committee was established by HESAWA, and 7 WUGs are available.	There is not a water committee, nor WUG.	Water committee was established by HESAWA, and 2 WUGs are available.	There is not a water committee, nor WUG.	7 WUGs are available.	7 WUGs are available.	There is not a water committee, nor WUG.

Source : Socio-economic Survey, JICA, 2005

100 Villages Profile

No.	82	83	84	85	86	87	88	89	90
District	GEITA	GEITA	GEITA	GEITA	GEITA	GEITA	GEITA	GEITA	GEITA
Village name	Nyabalasana	Kaseni	Bugulula	Kasota	Nyamilyango	Kamena	Bushishi	Ndelema	Nyashishima
No. of sub-village	4	3	5	6	6	5	4	5	4
Population (2002 census)	(5,090) *	2,906	5,764	6,521	5,438	5,525	(3,154) *	2,790	1,318
Population (village data)	5,256	2,916	5,430	8,221	3,684	6,217	3,176	2,454	1,384
Male	2,513	1,452	2,010	952	1,910	na	1,783	1,198	598
Female	2,743	1,464	3,420	7,269	1,774	na	1,393	1,256	786
No of disabled people	480	341	604	730	626	520	512	304	160
Children	2,872	568	3,600	5,788	2,408	1,726	1,997	517	470
No of HH	480	341	604	730	626	520	512	304	160
Female headed HH	28	10	31	74	na	na	96	21	16
Ethnic group	Sukuma, Waha, Jita	Jita, Sukuma, Zinza	Waha, Sukuma, Rongo, Sumbwa	Waha, Sukuma, Sumbwa	Sukuma, Waha, Zinza	Sukuma, Sumbwa	Sukuma	Sukuma, Sumbwa	Sukuma, Sumbwa
Name of Village Chairperson	Magesa Mayogya	Fortunatus Makene	Joseph Mpondi	John Jeremia	Lucas Kanyoni	Kambona Lugaila	Metodi Magereja	Deus Malashi	Masunga Mayalla
No. of active Water Committee	0	1	0	0	0	0	0	0	0
No. of active WUG	7	0	0	0	0	0	0	0	0
Project experience	- school building - health	- school building - Construction of a secondary school and village office)	- school facilities - library	- school facilities - library	- school facilities - environmental conservation	- education (school facilities) - road - market	- primary education development - road construction	- primary education development - road construction	- primary education development - health
Activities of CBOs	- credit group - self-help group	- credit group - farming group	- credit group	None	None	None	- income generation groups (credit, handicraft, etc.)	- self-help group	- women group (credit, handicraft, etc.)
HESAWA activities	None	None	None	None	None	None	None	None	None
Available water sources	Traditional wells Springs Lake Victoria	6 Traditional wells Rain water Stream Lake Victoria	22 Traditional wells	9 Traditional wells Streams	7 Traditional wells Rain water Streams	8 Traditional wells Rain water 5 Local dams	7 Traditional wells Rain water 1 Charco dam	5 Traditional wells 1 Charco dam	4 Traditional wells 1 Charco dam Ponds
Availability of electricity	None	None	None	None	None	None	None	None	None
Willingness to pay (WTP) for monthly payment (Tsh)	500 to 1000	1000 to 1500	1500 to 2000	1500 to 2000	500 to 1000	500-1000	500>	500 to 1000	1000-1500
Willingness to pay (WTP) per bucket of 20 liters (Tsh)	15 – 20	15 - 20	10<	15 - 20	15 – 20	15 - 20	10 – 15	15 - 20	15 – 20
Water Consumption per person per day (liter)	11	18	19	21	20	19	11	20	10
Collection of water charge or fund (Tsh)	0	0	0	15,000	100 per month	0	20 per bucket	0	157,000
Main farm products	Maize, cassava, rice, pineapples	maize, cassava, rice, sweet potatoes, millet, cotton	Cotton, maize, cassava, sweet potatoes, rice	Cotton, maize, cassava, beans, yams	Cotton, maize, cassava, beans, sweet potatoes, pineapples	Cotton, Maize, Cassava, Groundnuts, Rice, Beans, Sweet potatoes	Maize, Cassava, Cotton, Rice, Beans, Groundnuts	Cotton, Maize, Groundnuts, Cassava, Sweet potatoes, Beans	Cotton, Rice, Maize, Cassava, Beans
Disposable monthly income (Tsh)	12,625	14,498	8,573	10,174	9,077	15,308	29,703	12,128	9,103
Remarks	7 WUGs are available. Nyabalasana was a sub-village at the time of 2002 census.	Water committee is available, but no WUG is available.	There is not a water committee, nor WUG.	There is not a water committee, nor WUG.	There is not a water committee, nor WUG.	There is not a water committee, nor WUG.	There is not a water committee, nor WUG.	There is not a water committee, nor WUG.	There is not a water committee, nor WUG.

Source : Socio-economic Survey, JICA, 2005

Note: * Nyabalasana and Bushishi were sub-villages at the time of 2002 census.

100 Villages Profile

No.	91	92	93	94	95	96	97	98	99	100
District	GEITA	GEITA	GEITA	GEITA	GEITA	GEITA	GEITA	GEITA	UKEREWE	UKEREWE
Village name	Bugogo	Ikina	Ntono	Ihega	Nyaruyeye	Ibondo	Kasangwa	Isima	Namasabo	Masonga
No. of sub-village	6	3	8	5	5	7	5	4	Na	7
Population (2002 census)	6,626	1,592	6,219	2,531	3,702	4,894	6,094	2,699	2,074	5,211
Population (village data)	6,079	1,638	10,864	2,500	4,227	6,320	7,548	3,229	1,602	7,872
Male	3,039	846	5,430	1,096	2,085	1,777	3,600	1,520	806	na
Female	3,040	792	5,434	1,404	2,142	4,543	3,948	1,709	796	na
No of disabled people	Unknown	265	882	337	540	500	1,200	516	15	no data
Children	1,811	673	2,973	1,244	2,510	2,289	3,782	659	713	no data
No of HH	na	265	882	337	540	500	1,200	516	570	no data
Female headed HH	na	13	20	21	35	49	40	na	42	no data
Ethnic group	Sumbwa, Sukuma	Sukuma, Sumbwa, Lungo, Nyiramba	Sukuma, Nyamwezi, Sumbwa	Sumbwa, Sukuma	Sukuma, Sumwa, nyiramba, nyamwezi	Sukuma, Sumbwa, Waha	Sukuma, Zinza, Jita, Kerewe	Sukuma, Zinza, Waha	Kerewe, Gita, Kara, Sukuma	no data
Name of Village Chairperson	Jeremia Mayalla	Faustin Ntaliyo	Manyanda Mashimba	Semandito Mnyami	Mandikilo Kasoga	Julius Samwel	Maganda Kudema	Shalu Masala	Gabriel Bihemu	Kisu Nyamola
No. of active Water Committee	0	0	0	0	0	0	0	0	1	1
No. of active WUG	0	0	0	0	0	0	0	0	3	6
Project experience	- school facilities - health	- primary education development - school facilities	- health - school facilities - village library	- school facilities - library	- primary education development - health	- school facilities - health (dispensary)	- school facilities - health	- school facilities - village library	- school building - Local SACCOS (credit services)	- school building - construction of a secondary school
Activities of CBOs	- women group (credit, etc.)	None	None	- health - credit	- farming - brick making	- credit	- farming group	- irrigation - credit	NA	2 groups (tree planting and credit)
HESAWA activities	- Constructed 1 borehole well (BH) - Village government rehabilitated the BH	None	None	None	None	None	None	None	- constructed 1 SW and rehabilitated 3 SWs - 1 SW is not operating	- constructed 6 SWs
Available water sources	5 BHs Traditional wells	3 Traditional wells 2 Charco dams Springs	Traditional wells 1 Charco dams Rain water	2 SWs (not functioning now) Traditional wells Rain water, Stream	4 Traditional wells Chraco dam Spring	10 Traditional wells Rain water	9 Traditional wells Rain water	Traditional wells Stream	4 SWs (1 with HP) 4 Traditional wells River, Lake Victoria	5 SWs 2 Traditional wells Streams Lake Victoria
Availability of electricity	None	None	None	None	None	None	None	None	None	None
Willingness to pay (WTP) for monthly payment (Tsh)	500 to 1000	1500 to 2000	500 to 1000	500 to 1000	500 to 1000	500 to 1000	1000 to 1500	500 to 1000	1000	2000<
Willingness to pay (WTP) per bucket of 20 liters (Tsh)	15 – 20	10>	10>	10 - 15	15 - 20	10 to 15	10 to 15	15 - 20	10	20<
Water Consumption per person per day (liter)	13	14	16	15	10	16	14	13	8	13
Collection of water charge or fund (Tsh)	0	0	25,000	0	40,000	0	0	0	0	0
Main farm products	Cotton, groundnuts, beans, maize, cassava	Cotton, maize, cassava, groundnuts	Cotton, maize, groundnuts, beans, cassava, rice	Cotton, maize, beans, groundnuts, cassava	Cotton, rice, maize, cassava	Cotton, maize, cassava	Cotton, maize, cassava	Cotton, rice, maize, cassava	Cassava, sweet potatoes, rice	Cassava, sweet potatoes, rice, maize
Disposable monthly income (Tsh)	24,249	60,208	12,972	19,248	13,294	21,615	15,072	22,188	21,349	18,571
Remarks	There is not a water committee, nor WUG.	There is not a water committee, nor WUG.	There is not a water committee, nor WUG.	There is not a water committee, nor WUG.	There is not a water committee, nor WUG.	There is not a water committee, nor WUG.	There is not a water committee, nor WUG.	There is not a water committee, nor WUG.	Water committee was established by HESAWA, and 3 WUGs are available.	Water committee was established by HESAWA, and 6 WUGs are available.

Source : Socio-economic Survey, JICA, 2005

④ **Supplementary Survey**

Data for 17 Piped Schemes

No.	DISTRICT	Scheme	Village	No. of sub-village	No. of HH	Monthly income	HESAWA experience	Project experience	Main water source in dry season	Main water source in rainy season	Distance to water sources	Water supply organization	Water fund collection	Water consumption	WTP per bucket	WTP per month	Medical expenses per month (Tsh)
1	MISUNGWI	Usagara	Usagara	8	769	91,667	- shallow well construction - latrines construction - construction of rain water harvesting	PEDEP, CSPD, CARE, Water project supervised by VG	TWs, SWS	TWs, SWS	0.75 km	1 VWC (active), 8 WCs and 18 WUGs at sub-villages.	Yes	200 liters per day	10 - 15	1500 -2000	30,000
2	MISUNGWI	Usagara	Fella	6	597	43,333	- shallow well construction (5 SWS) - latrines construction - O&M seminars	PEDEP, CDPD and VI	TWs, river	TWs, HP	1 km	1 VWC (inactive) and 7 WCs at sub-village.	Tsh 1,000 per HH per year	100 liters per day	na	Tsh 500 to 1000	100,000
3	MISUNGWI	Usagara	Nyang'homango	11	569	107,375	- shallow well construction - latrines construction - construction of rain water harvesting	PEDEP, CDPD and VI	TWs (charco dam dug wells, etc.)	TWs (charco dam), SWS	0.5 km	1 VWC (active), 11 WCs and 15 WUGs at sub-village.	Tsh 1,000 per HH per year	100 liters per day	Tsh 15 - 20	Tsh 500 to 1000	50,000
4	MISUNGWI	Ukiriguru	Nyang'holongo	6	664	25,083	- latrines construction - O&M for latrine	PEDEP, CDPD and NGO (primary school building, etc.)	TWs (charco dam)	TWS (charco dam)	10 km	1 VWC (inactive) and 6 WCs at sub-village.	Tsh 200 to 500 per HH per year	-100 liters per day in dry season - 200 liters in rainy season	more than Tsh 20	Tsh 1500 to 2000	400,000
5	MISUNGWI	Ukiriguru	Ngudama	6	304	38,333	No	PEDEP, CSPD and NGO (primary school building, etc.)	neighborin g village	TWs	2.5 km	1 VWC (active)	Tsh 1,000 per HH per year	-40 liters per day in dry season - 140 liters in rainy season	Tsh 10 to 15	Tsh 500 to 1000	250,000
6	MISUNGWI	Ukiriguru	Nyamatala	8	355	79,708	No	PEDEP, CDPD and REDEP	TWs (dug wells)	TWs (dug wells)	1 km	1 VWC (inactive) and 8 WCs at sub-village.	Tsh 5,000 per HH per year	100 liters per day	Tsh 15 to 20	more than Tsh 2000	60,000
7	MISUNGWI	Ukiriguru	Mwagala	10	478	27,958	No	PEDEP, RIDEP, HAM (hand pump) and NGO	HP (1)	HP, river	2 km	1 VWC (inactive), 10 WCs at sub-village and 10 WUGs.	Tsh 200 per HH per year	- 100 liters per day in dry season - 200 liters per day in rainy season	Tsh 10 to 15	Tsh 1500 to 2000	200,000

Data for 17 Piped Schemes

No.	DISTRICT	Scheme	Village	No. of sub-village	No. of HH	Monthly income	HESAWA experience	Project experience	Main water source in dry season	Main water source in rainy season	Distance to water sources	Water supply organization	Water fund collection	Water consumption	WTP per bucket	WTP per month	Medical expenses per month (Tsh)
8	MISUNGWI	Ukiriguru	Buganda	9	359	69,625	No	PEDEP, DDP and CSPD	TWs (dug wells)	TWs (dug wells)	3 km	1 VWC (inactive)	Tsh 10,000 per HH per year (past year)	100 liters per day	more than Tsh 20	more than Tsh 2000	60,000
9	GEITA	Nyakagomba	Chigunga	5	678	92,208	- shallow well construction (3 SWs) - latrines construction	PEDEP	TWs	TWs, SWs (3)	2km	1 VWC (active) and 3 WCs & WUGs at sub-villages.	No	- 400 liters per day in dry season - 400 liters in rainy season	Less than Tsh 10	Less than Tsh 500	100,000
10	GEITA	Nyakagomba	Kabugozo	4	345	47,479	- shallow well construction (2 SWs)	CSPD (HIV/AIDS training)	TWs (2), SW (1)	TWs (11), SWs	1.5km	1 VWC (active) and 4 WCs & 4 WUGs at sub-villages.	Tsh 20 per bucket	- 120 liters per day in dry season - 200 liters in rainy season	Tsh 10 to 15	Less than Tsh 500	100,000
11	GEITA	Nyakagomba	Busaka	3	243	18,542	No	No	TWs (2)	TWs (11)	3km	1 VWC (active) and 3 WUGs	No	- 80 liters per day in dry season - 160 liters in rainy season	more than Tsh 20	Less than Tsh 500	30,000
12	GEITA	Nyakagomba	Bukondo	5	840	132,396	No	No	TWs (4), lake	TWs (7), lake	2.5km	1 VWC (active) and 3 WUGs at sub-villages.	No	- 140 liters per day in dry season - 200 liters in rainy season	Tsh 20	Tsh 500	30,000
13	GEITA	Nyakagomba	Nyamwilelewa	3	840	71,458	No	PEDEP	TWs (3)	TWs (6)	3km	1 VWC (active) and 3 WUGs at sub-villages.	Income generating activities	-50 liters per day in dry season - 200 liters in rainy season	Tsh 15 to 20	Tsh 500 to 1000	50,000
14	GEITA	Nyang'hwale	Ibambila	5	255	75,208	- shallow well construction (1 SW) - latrines construction	PEDEP and CSPD (only training)	TWs (2)	TWs (10), SW	1.2 km	1 VWC (active), 5 WCs and 5 WUGs at sub-villages.	No	- 100 liters per day in dry season - 160 liters in rainy season	Tsh 20	Tsh 500	50,000

Data for 17 Piped Schemes

No.	DISTRICT	Scheme	Village	No. of sub-village	No. of HH	Monthly income	HESAWA experience	Project experience	Main water source in dry season	Main water source in rainy season	Distance to water sources	Water supply organization	Water fund collection	Water consumption	WTP per bucket	WTP per month	Medical expenses per month (Tsh)
15	GEITA	Nyanghwale	Kaseme A	3	294	42,708	- shallow well construction (2 SWs) - latrines construction	PEDEP and CSPD	TWs (3)	TWs (10)	5 km	1 VWC (active) and 3 WCs at sub-villages.	No	- 80 liters per day in dry season - 120 liters in rainy season	less than Tsh 10	less than Tsh 500	30,000
16	GEITA	Karumwa/Msalala	Nyarubele	5	300	74,792	- shallow wells construction (4 SWs) - latrines construction	PEDEP	TWs (3)	TWs (3), SW	2 km	1 VWC (active) and 5 WUGs at sub-villages.	No	-100 liters per day in dry season - 400 liters in rainy season	Tsh 10 to 15	Tsh 500 to 1000	100,000
17	GEITA	Karumwa/Msalala	Kakora	4	521	43,958	- shallow wells construction (2 SWs) - latrines construction	PEDEP and CDPD	Lake	TWs, SWs (2)	2 km (rainy season) 8km (dry season)	1 VWC (active) and 4 WUGs at sub-villages.	Tsh 300/HH/year	-60 liters per day in dry season - 120 liters in rainy season	Tsh 10 to 15	Tsh 500 to 1000	100,000
18	GEITA	Karumwa/Msalala	Kharumwa	4	900	10,313	- shallow wells construction (6 SWs) - latrines construction	PEDEP and CDPD	neighborin g village (Kayenze)	TWs, SWs (2)	1.5 km	1 VWC (active) and 4 WUGs at sub-villages.	no	-60 liters per day in dry season - 200 liters in rainy season	less than Tsh 10	less than Tsh 500	100,000
19	GEITA	Karumwa/Msalala	Bukwimba	6	446	67,375	- shallow well construction (1 SW)	PEDEP and CSPD	TWs (1), HP	TWs (6), HP	3km	1 VWC (active), 5 WUGs	Tsh 50 per HH per month	-120 liters per day in dry season - 240 liters in rainy season	Tsh 10 to 15	Tsh 500 to 1000	60,000
20	GEITA	Karumwa/Msalala	Kayenze	5	702	100,000	No	PEDEP and CSPD	TWs (2)	TWs (7)	2km	No organization	No	-200 liters per day in dry season - 400 liters in rainy season	Tsh 10 to 15	Tsh 500 to 1000	100,000
21	GEITA	Karumwa/Msalala	Izunya	4	329	68,438	- shallow wells construction (3 SWs) - latrines construction	PEDEP and CSPD	SW (1), charco dam	TWs (12), SWs (3)	2km	1 VWC (active) and 4 WCs at sub-villages.	No	- 240 liters per day in dry season - 400 liters in rainy season	Tsh 10 to 15	less than Tsh 500	100,000
22	GEITA	Nzera	Nyamboge	5	873	118,333	No	PEDEP and CSPD	Lake	TWs (6)	3km	No organization	No	- 120 liters per day in dry season - 200 liters in rainy season	Tsh 10 to 15	Tsh 500 to 1000	100,000

Data for 17 Piped Schemes

No.	DISTRICT	Scheme	Village	No. of sub-village	No. of HH	Monthly income	HESAWA experience	Project experience	Main water source in dry season	Main water source in rainy season	Distance to water sources	Water supply organization	Water fund collection	Water consumption	WTP per bucket	WTP per month	Medical expenses per month (Tsh)
23	GEITA	Nyakagomba	Nyakagomba	5	719	22,042	- shallow well construction (3 SWs) - latrines construction - O&M training	PEDEP, DDP and CSPD	TWs (dug wells, etc.)	SWs (3), TWs (dug wells, etc.)	1.5km	1 VWC (active) and 3 WCs and 3 WUGs at sub-villages.	Tsh 3000 per HH per year	- 100 liters per day in dry season - 200 liters in rainy season	Tsh 10 to 15	Tsh 500 to 1000	125,000
24	GEITA	Nyakagomba	Chikobe	3	594	49,208	- shallow well construction (1 SW) - O&M training	PEDEP, DDP and CSPD	Lake, TW	TWs, SW	2 km	1 VWC (active), 1 WC and 1 WUG	Tsh 10 per bucket (HP)	- 40 liters per day in dry season - 80 liters in rainy season	Tsh 10 to 15	Tsh 1500 to 2000	10,000
25	GEITA	Nyakagomba	Kitigiri	2	200	50,646	- shallow well construction (1 SW) - RWH (rain water harvesting tank)	PEDEP, DDP, CSPD and VI	TWs	TWs	1.5km	1 VWC (active) and 2 WCs	No	- 100 liters per day in dry season - 120 liters in rainy season	Tsh 10 to 15	Tsh 1500 to 2000	150,000
26	GEITA	Nyakagomba	Chankolongo	3	490	50,000	- shallow well construction (1 SW) - O&M training	PEDEP, DDP and CSPD	TWS (3)	TWs (9)	1.5km	1 VWC (active) and 1 WC at sub-village.	No	- 100 liters per day in dry season - 140 liters in rainy season	Tsh 10 to 15	Tsh 1500 to 2000	100,000
27	GEITA	Nyakagomba	Mwenegeza	4	427	29,500	No	PEDEP	TWs (4)	TWs (34)	2 km	1 VWC (just started)	No	- 90 liters per day in dry season - 170 liters in rainy season	Tsh 10 to 15	Tsh 1500 to 2000	100,000
28	GEITA	Nyang'hwale	Nyang'hwale	6	424	79,167	- shallow well construction (1 SW) - latrines construction	PEDEP, DDP and CSPD	TWs (6)	SWs (2), TWs (6)	1km	1 VWC (active) and 6 WCs at sub-villages.	Tsh 500 per HH	- 40 liters per day in dry season - 60 liters in rainy season	Tsh 10 to 15	Tsh 1500 to 2000	100,000
29	GEITA	Nyang'hwale	Nyaruguguna	5	230	89,583	- shallow well construction (1 SW) - latrines construction - O&M training	PEDEP, DDP and CSPD	SW (1), TW (1)	SWs (4), TWs (9)	1km	1 VWC (active) and 5 WCs at sub-villages.	Tsh 200 per HH	- 40 liters per day in dry season - 150 liters in rainy season	Tsh 10 to 15	Tsh 1500 to 2000	100,000

Data for 17 Piped Schemes

No.	DISTRICT	Scheme	Village	No. of sub-village	No. of HH	Monthly income	HESAWA experience	Project experience	Main water source in dry season	Main water source in rainy season	Distance to water sources	Water supply organization	Water fund collection	Water consumption	WTP per bucket	WTP per month	Medical expenses per month (Tsh)
30	GEITA	Karumwa/Msalala	Nyamtukuza	3	267	72,917	No	PEDEP, DDP and SW project by DWE	Kahama goldmines water points, Lake	TWs, Lake	1km	1 VWC (active) and WCs at water points	Tsh 1,500 per HH per year	-100 liters per day in dry season - 120 liters in rainy season	Tsh 15 to 20	Tsh 1500 to 2000	75,000
31	GEITA	Karumwa/Msalala	Kabiga	4	450	33,333	- shallow wells construction (4 SWs) - latrines construction - O&M seminars	PEDEP and CSPD	Lake	Lake, SWs (3)	1km	1 VWC (active) and 3 WCs at sub-villages.	Tsh 300/HH/year	-60 liters per day in dry season - 100 liters in rainy season	Tsh 10 to 15	Tsh 1000 to 1500	180,000
32	GEITA	Karumwa/Msalala	Kitongo	4	322	102,500	No	PEDEP, CSPD and DDP	Kahama goldmines water points, Lake	TWs (6)	3km	1 VWC (active) and 4 WCs at sub-villages.	Tsh 54,798 per sub-village	-70 liters per day in dry season - 100 liters in rainy season	Tsh 10 to 15	Tsh 1000 to 1500	100,000
33	GEITA	Karumwa/Msalala	Bukungu	3	316	200,000	- boreholw well construction - O&M training - latrines construction	PEDEP, DDP, CSPD and tree planting project	TWs (8), HP (1)	TWs (18), HP (1)	1km	1 VWC (active) and 3 WCs at sub-villages.	No	- 60 liters per day in dry season - 100 liters in rainy season	Tsh 10 to 15	Tsh 1500 to 2000	150,000
34	GEITA	Karumwa/Msalala	Bumanda	4	406	251,875	No	PEDEP, DDP and CSPD	Kahama goldmines water points, TWs (3)	Kahama goldmines water points, TWs (9)	2km	1 VWC (inactive) and 3 WUGs at Kahama water points	Tsh 1,000 per HH	-40 liters per day in dry season - 150 liters in rainy season	Tsh 10 to 15	Tsh 1500 to 2000	85,000
35	GEITA	Karumwa/Msalala	Nyang'holongo	3	254	90,000	- boreholw well construction - O&M training - latrines construction	PEDEP and DDP	neighborin g village	TWs (5)	0.7km	1 VWC (active), 1 WC and 1 WUG	Tsh 200 per HH	-40 liters per day in dry season - 150 liters in rainy season	Tsh 10 to 15	more than 2000	200,000
36	GEITA	Nzeraa	Sungusira	4	1,234	261,667	No	PEDEP, DDP and CSPD	TWs (6)	TWs (15)	2km	1 VWC (active) and 4 WCs at sub-villages.	No	- 60 liters per day in dry season - 120 liters in rainy season	Tsh 10 to 15	more than Tsh 2000	150,000
37	GEITA	Nzeraa	Nzera	5	1,242	34,375	- shallow well construction (1 SW) - O&M training	PEDEP, DDP, CSPD, LWEMP, VI, piped scheme	TWs (4)	TWs (4), SWs (7)	2km	1 VWC (active) and 5WCs at sub-villages.	Tsh 1,000 per HH	- 60 liters per day in dry season - 120 liters in rainy season	Tsh 10 to 15	more than Tsh 2000	120,000

Data for 17 Piped Schemes

No.	DISTRICT	Scheme	Village	No. of sub-village	No. of HH	Monthly income	HESAWA experience	Project experience	Main water source in dry season	Main water source in rainy season	Distance to water sources	Water supply organization	Water fund collection	Water consumption	WTP per bucket	WTP per month	Medical expenses per month (Tsh)
38	SENGEREMA	Sima	Sima	9	800	82,633	- constructed 2 SWs - SWs are not functioning	PEDEP, CDPD and REDEP	TWs, vendors	TWs, rain water	0.75 km	WCs at each sub-village	Yes	19 lpd	Tsh 10 to 15	Tsh 500 - 1000	100,000
39	SENGEREMA	Luchili	Nyanzenda	8	487	143,750	No	PEDEP, DDP and CSPD	Lake	TWs	1 km	1 VWC (active).	No	- 80 liters per day in dry season - 150 liters per day in rainy season	Tsh 10 to 15	Tsh 1,500 - 2000	100,000
40	SENGEREMA	Luchili	Migukulama	6	374	48,958	- constructed a SW	PEDEP, DDP and CSPD	TWs	TWs	1 km	1 VWC (active) and 1 WC at sub-village.	Tsh 300/HH/year	- 60 liters per day in dry season - 150 liters per day in rainy season	Tsh 10 to 15	Tsh 1,500 - 2000	150,000
41	SENGEREMA	Luchili	Luchili	9	950	33,333	- constructed 2 SWs - construction of latrines	PEDEP, DDP and CSPD	TWs	TWs, SWs	0.75 km	1 VWC (active), 2 WCs and 2 WUGs at sub-village.	Tsh 500 per HH at once	- 60 liters per day in dry season - 150 liters per day in rainy season	Tsh 10 to 15	Tsh 1,500 - 2000	200,000
42	SENGEREMA	Lugasa	Nyakarilo	10	1,086	21,854	- constructed a SW	PEDEP, DDP, CSPD and LVEMP	Lake (50%), TWs (25%), SWs (25%)	TWs	0.75 km	2 WUGs	No	- 200 liters per day in dry season - 300 liters per day in rainy season	Tsh 15 to 20	Tsh 500 - 1000	150,000
43	SENGEREMA	Luchili	Nyakasungwa	10	874	100,625	- constructed a SW	PEDEP, DDP, CSPD and WAMATA	Lake	TWs	1.5 km	1 VWC (active) and 10 WCs at sub-village.	No	- 70 liters per day in dry season - 100 liters per day in rainy season	Tsh 10 to 15	Tsh 1,500 - 2000	60,000
44	UKEREWE	Kagunguli/Bukindo	Kagunguli	7	1,500	71,875	- shallow well construction (4 SWs) - latrines construction - RWH (2 units)	PEDEP and CSPD	SW (25%), TW (75%)	SW (75%), TW (25%)	0.75km	1 VWC (active) and 7 WCs and 4 WUGs at sub-villages.	No	- 120 liters per day in dry season - 160 liters in rainy season	Tsh 20	na	60,000
45	UKEREWE	Kagunguli/Bukindo	Buguza	7	685	79,708	No	PEDEP, DDP, CSPD, LVEMP and VI	Lake	Lake, TW	2 km	0 VWC, 7 WCs and 6 WUGs at sub-villages.	No	- 200 liters per day in both dry and rainy season	Tsh 10 to 15	Tsh 500 to 1000	50,000

Data for 17 Piped Schemes

No.	DISTRICT	Scheme	Village	No. of sub-village	No. of HH	Monthly income	HESAWA experience	Project experience	Main water source in dry season	Main water source in rainy season	Distance to water sources	Water supply organization	Water fund collection	Water consumption	WTP per bucket	WTP per month	Medical expenses per month (Tsh)
46	UKEREWE	Kagunguli/Bukindo	Muhande	7	400	156,458	- shallow well construction (1 SW)	PEDEP, VI and bee keeping project.	Lake	TW	2 km	1 VWC (inactive), 7 WCs and 4 WUGs at sub-villages.	No	- 60 liters per day in dry season - 100 liters in rainy season	Tsh 20	Tsh 1000	70,000
47	UKEREWE	Kagunguli/Bukindo	Nansole	6	315	31,458	- shallow well construction (1 SW)	PEDEP, CSPD and VI.	Lake	TW, SW	0.5 km	1 VWC (active), 2 WCs and 2 WUGs at sub-villages.	Tsh 500 per HH	- 40 liters per day in dry season - 100 liters in rainy season	Tsh 10 to 15	Tsh 500 to 1000	100,000
48	UKEREWE	Kagunguli/Bukindo	Bukindo	7	235	96,875	No	PEDEP, DDP, VI and CSPD	Lake	Lake, TW	0.5 km	1 WC at a traditional well	No	- 60 liters per day in dry season - 100 liters in rainy season	Tsh 10 to 15	Tsh 500 to 1000	100,000
49	UKEREWE	Gallu	Masonga	7	793	50,750	- shallow well construction (4 SWs) - latrines construction	PEDEP and CSPD	Lake	Lake	1.5 km	1 VWC (active) and 5 WCs and 5 WUGs at sub-villages.	Tsh 150 per HH per month	- 180 liters per day in dry season - 230 liters in rainy season	Tsh 10	Tsh 200	50,000
50	UKEREWE	Gallu	Murutilima	7	840	24,596	- shallow well construction (2 SWs) - latrines construction	PEDEP, DDP, CSPD and CBEP (assistance for the disabled)	TW, Lake	TWs	1.16km	0 VWC, 3 WCs and 3 WUGs at sub-villages.	No	- 150 liters per day in dry season - 250 liters in rainy season	Tsh 20	Less than Tsh 500	125,011
51	UKEREWE	Gallu	Gallu	7	718	249,792	- shallow well construction (1 SW) - latrines construction - O&M training	PEDEP, DDP and CSPD	Lake	TW, SW, hand dug well	1 km	1VWC (active) and 7 WCs and 7 WUGs at sub-villages.	Tsh 200 per HH when necessary	- 40 liters per day in dry season - 150 liters in rainy season	Tsh 10 to 15	Tsh 500 to 1000	100,000
52	UKEREWE	Gallu	Nakamwa	7	481	101,042	- shallow well construction (5 SWs) - latrines construction - O&M training	PEDEP, DDP and CSPD	TW	TW, SW, hand dug well	0.5 km	1 VWC (active) and 5 WCs and 5 WUGs at sub-villages.	Tsh 1000 per HH	- 40 liters per day in dry season - 150 liters in rainy season	Tsh 10 to 15	Tsh 500 to 1000	100,000

Data for 17 Piped Schemes

No.	DISTRICT	Scheme	Village	No. of sub-village	No. of HH	Monthly income	HESAWA experience	Project experience	Main water source in dry season	Main water source in rainy season	Distance to water sources	Water supply organization	Water fund collection	Water consumption	WTP per bucket	WTP per month	Medical expenses per month (Tsh)
53	UKEREWE	Gallu	Busangu	7	531	44,583	- shallow well construction (6 SWs) - latrines construction - O&M training	PEDEP, DDP and CSPD	Lake, TWs	TWs, SWs	0.5 km	1 VWC (active) and 6 WCs and 6 WUGs at sub-villages.	Tsh 100 to 1,000 per HH per year	- 100 liters per day in dry season - 200 liters in rainy season	Tsh 5	Tsh 500 to 1010	100,000
54	UKEREWE	Bukonyo	Bukonyo	7	247	133,750	- shallow well construction (2 SWs) - latrines construction - O&M training	PEDEP, DDP, CSPD and health project (Vitamin A)	Lake	TW, SW, hand dug well	1.5 km	1 VWC (active), 2 WCs and 2 WUGs at sub-villages.	Tsh 100 per HH	- 80 liters per day in dry season - 150 liters in rainy season	Tsh 10 to 15	Tsh 500 to 1000	40,000
55	UKEREWE	Bukonyo	Namilembe	7	455	112,500	- shallow well construction (4 SWs) - latrines construction - O&M training	PEDEP, DDP and CSPD	Lake, SWs, Ring wells	TW, SW, hand dug well	2 km	1 VWC (active), 11 WCs and 11 WUGs at sub-villages.	Tsh 500 per HH	- 40 liters per day in dry season - 200 liters in rainy season	Tsh 10 to 15	Tsh 500 to 1000	100,000
56	UKEREWE	Muriti	Bugula	7	955	45,625	- shallow well construction (8 SWs) - latrines construction	PEDEP, DDP, CSPD and ACHOP (forestry)	SWs and TWs	Lake	1.2 km	1 VWC (active) and 7 WCs and 15 WUGs at sub-villages.	Tsh 1,000 per HH per year	- 200 liters per day in dry season - 240 liters in rainy season	Tsh 10	Tsh 500	150,000
57	UKEREWE	Muriti	Ihebo	7	422	38,458	- shallow well construction (1 SW) - latrines constructio	PEDEP, DDP and CSPD	Lake	SWs, TWs	1.4 km	4 WUGs	Tsh 6,000 per HH per year	- 120 liters per day in dry season - 200 liters in rainy season	Tsh 10 to 15	Tsh 200	225,000
58	UKEREWE	Muriti	Itira	7	#REF!	15,896	- construction of shallow wells (2 SWs) and traditional wells	PEDEP and CSPD	TWs	Lake, TWs	0.8 km	4 WUGs	No	- 140 liters per day in dry season - 180 liters in rainy season	Tsh 10	Tsh 200	250,000

Data for 17 Piped Schemes

No.	DISTRICT	Scheme	Village	No. of sub-village	No. of HH	Monthly income	HESAWA experience	Project experience	Main water source in dry season	Main water source in rainy season	Distance to water sources	Water supply organization	Water fund collection	Water consumption	WTP per bucket	WTP per month	Medical expenses per month (Tsh)
59	UKEREWE	Muriti	Kameya	7	975	28,115	- shallow well construction (1 SW) - TW constructio	PEDEP, DDP, CSPD and VI	Lake, TWs	SWs, TWs	1.7 km	1 VWC (active) and 6 WCs and 2 WUGs at sub-villages.	No	- 120 liters per day in dry season - 160 liters in rainy season	Tsh 10 to 15	Less than Tsh 500	100,000
60	UKEREWE	Kagunguli/Bukindo	Bugombe	7	291	20,417	- latrines construction	PEDEP, CSPD and VI.	TWs	TWs, dug wells	0.75 km	1 VWC (inactive) and 7 WUGs	No	- 120 liters per day in dry season - 160 liters in rainy season	Tsh 10	Less than Tsh 500	60,000
61	UKEREWE	Muriti	Muriti	7	1,250	129,167	- shallow well construction (5 SWs) - latrines construction - O&M training	PEDEP, DDP and CSPD	TWs	SWs, TWs	0.5 km	1 VWC (active) and 5 WCs and 5 WUGs at sub-villages.	Tsh 500 to 2000 per HH	- 40 liters per day in dry season - 200 liters in rainy season	Tsh 10 to 15	Tsh 500 to 1000	125,000
62	UKEREWE	Muriti	Igongo	7	360	85,625	-- latrines construction	PEDEP and CSPD	TWs	TWs	0.5 km	1 VWC (inactive) and 5 WUGs at sub-villages.	No	- 100 liters per day in dry season - 200 liters in rainy season	Tsh 10 to 15	Tsh 500 to 1000	75,000
63	UKEREWE	Kagunguli/Bukindo	Bulamba	7	615	89,583	- shallow well construction (4 SWs) - latrines construction - O&M training	PEDEP, DDP, CSPD and VI	Lake, spring	Spring, SWs, hand dug well, rain water	0.5 km	4 WCs and 4 WUGs at sub-villages.	- Tsh 50 per HH per month - Tsh 200 per HH for construction - Tsh 500 per HH for new comers during dry season - Tsh 500 or 1000 per user for penalty - Tsh 100 per HH for construction	- 80 liters per day in dry season - 100 liters in rainy season	Tsh 10 to 15	Tsh 500 to 1000	100,000
64	TARIME	Nyamagaro	Muharango	4	604	104,792	No	PEDEP, DDP, CSPD and LVEMP	Lake	TWs	3.5 km	1 VWC (for a charco dam) and 4 WUGs.	Tsh 2,500 per HH per year (for charco dam)	- 60 liters per day in dry season - 100 liters in rainy season	Tsh 10	Tsh 500 to 1000	0

Data for 17 Piped Schemes

No.	DISTRICT	Scheme	Village	No. of sub-village	No. of HH	Monthly income	HESAWA experience	Project experience	Main water source in dry season	Main water source in rainy season	Distance to water sources	Water supply organization	Water fund collection	Water consumption	WTP per bucket	WTP per month	Medical expenses per month (Tsh)
65	TARIME	Nyamagaro	Rwang'enyi	5	755	65,167	No	PEDEP, CSPD and LVEMP	Lake	Springs	3.5 km	0	No	- 100 liters per day in dry season - 120 liters in rainy season	Tsh 10 to 15	Tsh 500 to 1000	100,000
66	TARIME	Nyamagaro	Nyang'ombe	6	600	137,292	No	PEDEP, DDP, CSPD, LVEMP and dispensary repairing	TWs, Lake	TW, lake, rain water	1.5 km	Nyamagaro Water Board	No	- 60 liters per day in dry season - 150 liters in rainy season	Tsh 10 to 15	Tsh 500 to 1000	110,000
67	TARIME	Nyamagaro	Manila	4	385	123,083	No	PEDEP and CSPD	Lake	TWs	3.5 km	1 VWC (for a charco dam) and 4 WUGs.	No	- 40 liters per day in dry season - 120 liters in rainy season	Tsh 10 to 15	Tsh 500 to 1000	100,000
68	TARIME	Kyangasaga	Kyangasaga	5	877	37,917	No	PEDEP, DDP, LVEMP and CSPD	Lake, SWs	TW, Lake, river	2.1 km	1 VWC (inactive) and 15 WUGs at water points	No	- 50 liters per day in dry season - 200 liters in rainy season	Tsh 15 to 20	Tsh 1000 to 1500	110,000
69	MAGU	Kabila/Ndagulu	Kabila	5	720	57,823	- shallow wells construction (8 SWs) - latrines construction	PEDEP, DDP and CSPD	HP	HP, charco dam, rain	1.1 km	1 VWC (active) and 9 WUGs.	no	- 160 liters per day in dry season - 200 liters per day in rainy season	Tsh 10	Tsh 500	10,000
70	MAGU	Kabila/Ndagulu	Ndagalu	7	660	30,219	- shallow wells construction (3 SWs) - latrines construction	PEDEP, DDP and CSPD	HP, river	HP, TWs	1.5 km	1 VWC (inactive) and 5 WUGs.	Tsh 500 per penalty	- 100 liters per day in dry season - 160 liters per day in rainy season	Tsh 10	Tsh 500	10,000
71	MAGU	Kabila/Ndagulu	Ng'washepi (Mwashepi)	4	301	103,375	- shallow wells construction (10 SWs) - O&M training	PEDEP, DDP, LVEMP and CSPD	SWs and TWs	SWs, TWs, rain water	2.0 km	1 VWC (active) and 10 WUGs.	Tsh 1,000 per HH as a revolving fund	-80 liters per day in dry season - 300 liters in rainy season	Tsh 10 to 15	Tsh 500 to 1000	175,000

Data for 17 Piped Schemes

No.	DISTRICT	Scheme	Village	No. of sub-village	No. of HH	Monthly income	HESAWA experience	Project experience	Main water source in dry season	Main water source in rainy season	Distance to water sources	Water supply organization	Water fund collection	Water consumption	WTP per bucket	WTP per month	Medical expenses per month (Tsh)
72	MAGU	Kabila/Ndagulu	Kayenze B	4	420	113,033	- shallow wells construction (9 SWs) - O&M training	PEDEP, DDP and CSPD	River	SWs, TWs	2 km	1 VWC (active), 10 WCs and 10 WUGs.	Tsh 1,000 per HH as a revolving fund	- 60 liters per day in dry season - 150 liters per day in rainy season	Tsh 10 to 15	Tsh 500 to 1000	150,000
73	KWIMBA	Mantare	Mantare	3	334	100,208	- shallow wells construction (3 SWs) - latrines construction - O&M training	PEDEP, DDP, CSPD and UNDP	TWs, SWs	TWs, SWs	2 km	1 VWC (active), 3 WCs and 3 WUGs.	Tsh 1,000 per HH per evry two months (Tsh 500 per month)	- 40 liters per day in dry season - 150 liters per day in rainy season	Tsh 10 to 15	Tsh 500 to 1000	150,000
74	KWIMBA	Mantare	Ishingisha	9	630	106,042	- shallow wells construction (5 SWs) - latrines construction - O&M training	PEDEP, DDP and CSPD	TWs (dug wells, etc.)	TWs, SWs	0.75 km	1 VWC (active), 5 WCs and 5 WUGs	Tsh 1000 to 3000 per HH	- 40 liters per day in dry season - 200 liters per day in rainy season	Tsh 10 to 15	Tsh 500 to 1000	200,000
75	MISUNGWI	Ukiriguru	Mwalogwabagole	7	545	44,692	- constructed 2 SWs and school latrines - 2 SWs are working	PEDEP, CSPD, CARE, LVEMP	TWs, lake Victoria	SWs, Tws	1.5 km	1 VWC (inactive) and 2 WCs at sub-village.	Yes	19	10<	500<	100,000
76	GEITA	Karumwa/Msalala	Ikangala	7	206	43,302	No	PEDEP and CSPD	TWs, pipeline supply of Kahama Mining Co.	TWs, rain water tapping, pipeline supply of Kahama Mining Co.	0.5 km	No VWC	None	13 lpd	Tsh 15 to 20	Tsh 500 to 1000	100,000
77	GEITA	Nyakagomba	Isima	4	516	259,812	- shallow well construction (10 SWs) - latrines construction - O&M training	PEDEP, DDP and CSPD	Nyambya mbo Stream	TWs	1 km	no VWC	No	13 lpd	Tsh 15 to 20	Tsh 500 to 1000	100,000

Note: TW = traditional water source; SW = shallow well; Tsh = Tanzania shilling; VWC = Village Water Committee; WUG = Water User Group; VG = village government
Source: Socio-economic Supplementary Survey, JICA, 2006