

TRANSVERSE MERCATOR PROJECTION

0 50 100 150 200 250m

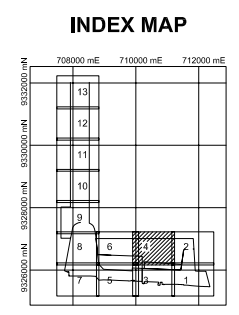

LEGEND :

12.4 Water Depth (meter C.D.)

—5— Depth Contour (1 meter interval)

PROJECTION : UTM

SPHEROID : WGS-84

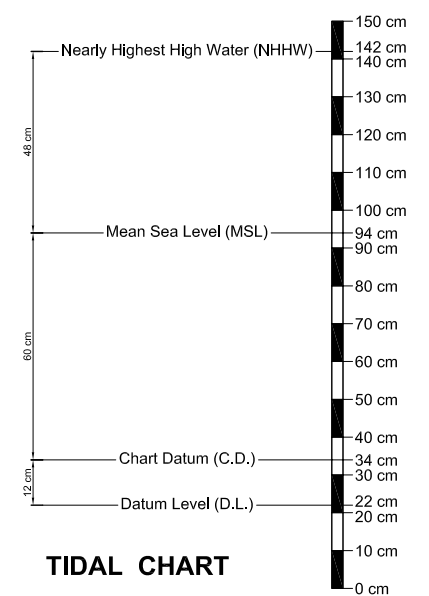

REV. NO.	DATE	COORDINATE	BY	APPROVED	DATE

JICA JAPAN INTERNATIONAL COOPERATION AGENCY (JICA)

DIRECTORATE GENERAL OF SEA COMMUNICATION (DGSC)

THE DETAILED DESIGN ON THE URGENT REHABILITATION PROJECT OF THE TANJUNG PRIK PORT IN THE REPUBLIC OF INDONESIA

NIPPON KOEI CO., LTD.

JAPAN PORT CONSULTANTS, LTD.

PREPARED BY: *[Signature]*

CHECKED BY: *[Signature]*

APPROVED BY: *[Signature]*

Y. PRASETYANTO
M. IMAMURA
K. OKUBO

SECTION : CHANNEL AND BASIN IMPROVEMENT

SUB-SECTION : GENERAL

TITLE : Turning Basin Area (2)

DATE : MARCH 2006

SCALE : 1:5000

DRAWING NO. : P-G-019

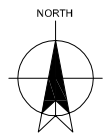
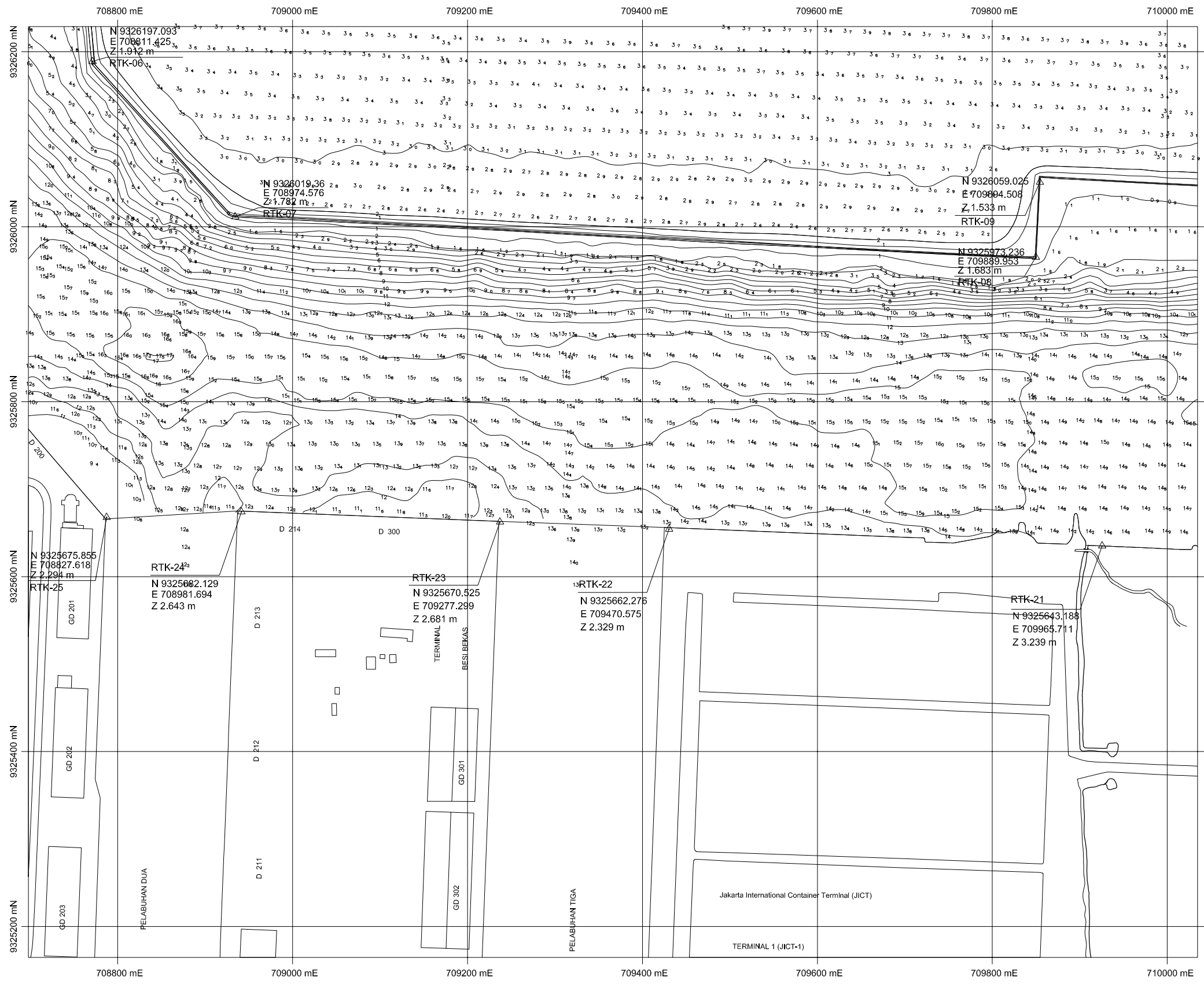

TRANSVERSE MERCATOR PROJECTION
 0 50 100 150 200 250m

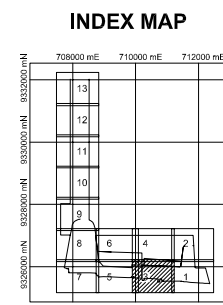

LEGEND :
 12.4 Water Depth (meter C.D.)
 -5- Depth Contour (1 meter interval)

PROJECTION : UTM
 SPHEROID : WGS-84

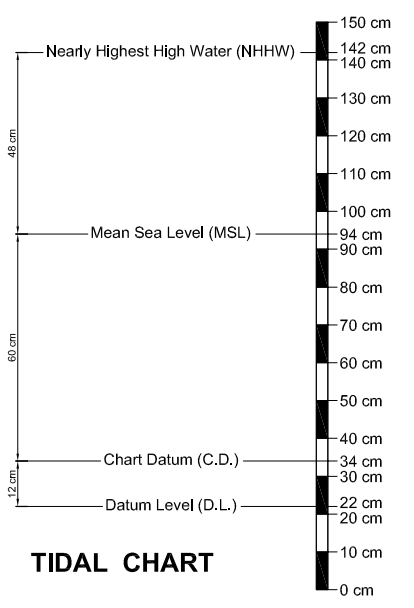

REV. NO.	DATE	COORDINATE	BY	APPROVED	DATE

JICA
 JAPAN INTERNATIONAL COOPERATION AGENCY (JICA)
 DIRECTORATE GENERAL OF SEA COMMUNICATION (DGSC)

THE DETAILED DESIGN
 ON THE URGENT REHABILITATION PROJECT
 OF THE TANJUNG PRIOK PORT
 IN THE REPUBLIC OF INDONESIA
 NIPPON KOEI CO., LTD.
 JAPAN PORT CONSULTANTS, LTD.

PREPARED BY : *[Signature]*
 Y. PRASETYANTO
 CHECKED BY : *[Signature]*
 M. IMAMURA
 APPROVED BY : *[Signature]*
 K. OKUBO

SECTION : CHANNEL AND BASIN IMPROVEMENT
 SUB-SECTION : GENERAL
 TITLE : Turning Basin Area (3)

DATE : MARCH 2006
 SCALE : 1:5000
 DRAWING NO. : P-G-020

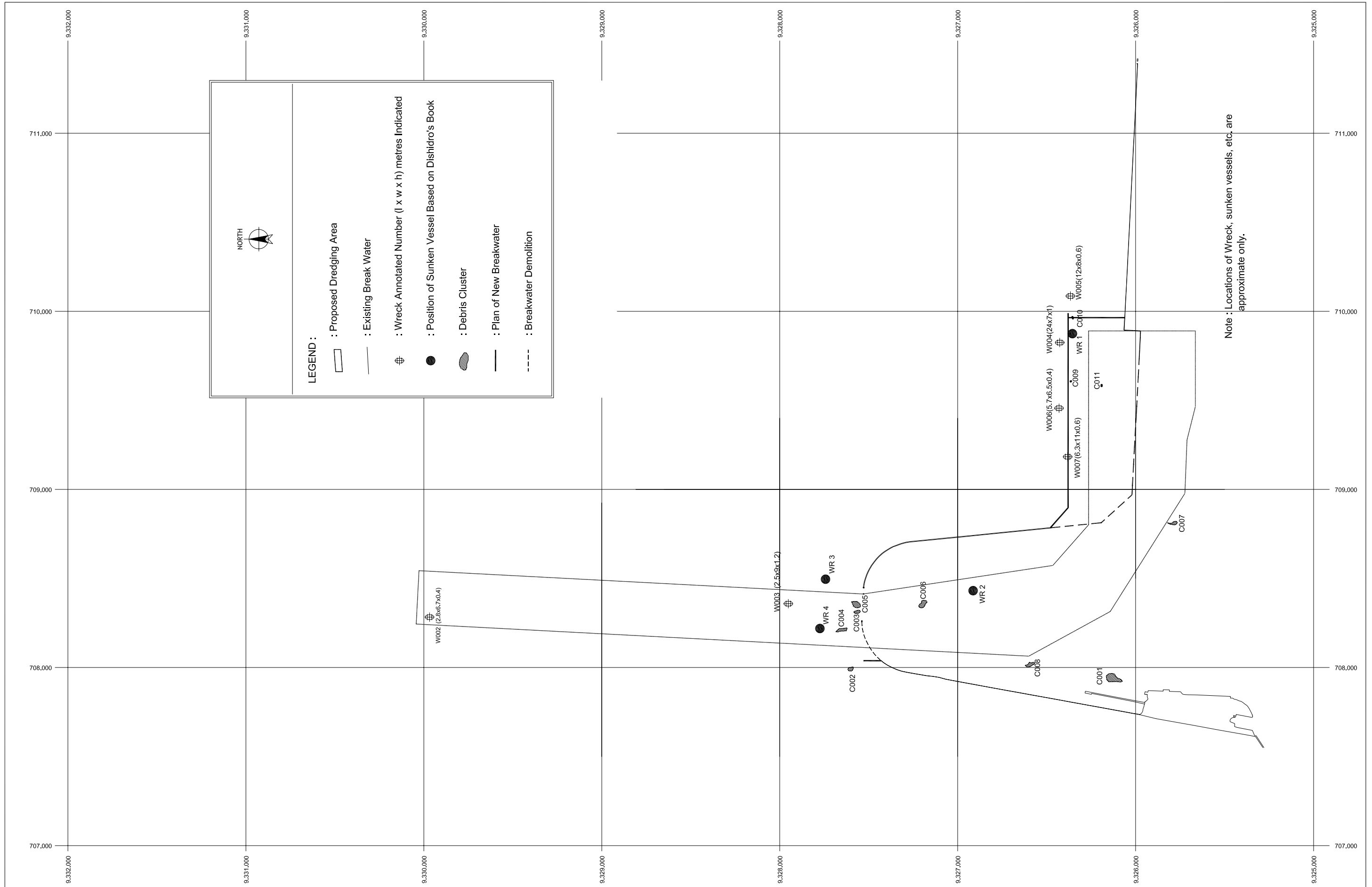

REV. NO.	DATE	COORDINATE	BY	APPROVED	DATE

JICA
 JAPAN INTERNATIONAL COOPERATION AGENCY (JICA)
 DIRECTORATE GENERAL OF SEA COMMUNICATION (DGSC)

THE DETAILED DESIGN
 ON THE URGENT REHABILITATION PROJECT
 OF THE TANJUNG PRIOK PORT
 IN THE REPUBLIC OF INDONESIA
 NIPPON KOEI CO., LTD.
 JAPAN PORT CONSULTANTS, LTD.

PREPARED BY :
A. E. Sulistiadi
 A. E. SULISTIADI
 CHECKED BY :
M. Shiguro
 M. SHIGURO
 APPROVED BY :
K. Okubo
 K. OKUBO

SECTION : CHANNEL AND BASIN IMPROVEMENT
 SUB-SECTION : GENERAL
 TITLE : Wreck, Sunken Vessel and Debris in Project Site

DATE : MARCH 2006
 SCALE : 1:20000
 DRAWING NO. : P-G-021

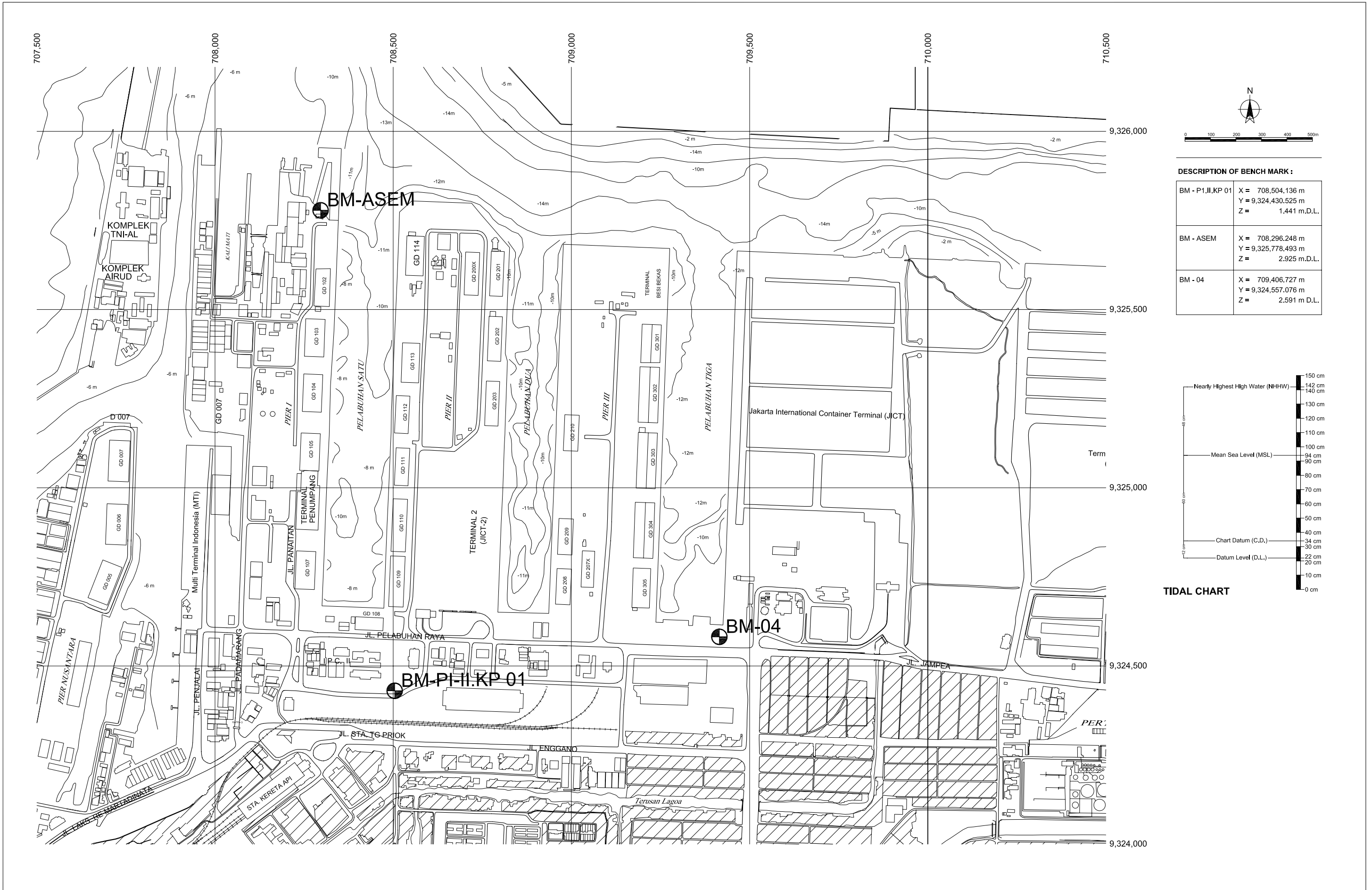

DESCRIPTION OF BENCH MARK :

BM - P1.II.KP 01	X = 708,504.136 m Y = 9,324,430.525 m Z = 1.441 m.D.L.
BM - ASEM	X = 708,296.248 m Y = 9,325,778.493 m Z = 2.925 m.D.L.
BM - 04	X = 709,406.727 m Y = 9,324,557.076 m Z = 2.591 m D.L.

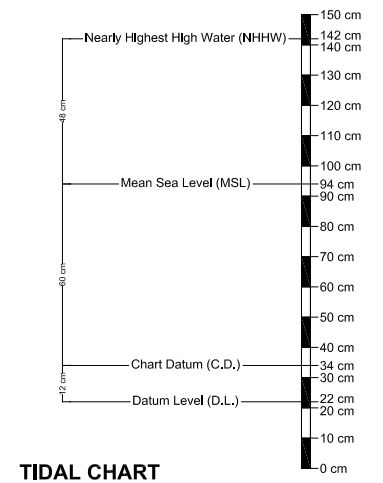

REV. NO.	DATE	COORDINATE	BY	APPROVED	DATE	<p>JICA JAPAN INTERNATIONAL COOPERATION AGENCY (JICA)</p> <p>DIRECTORATE GENERAL OF SEA COMMUNICATION (DGSC)</p>	<p>THE DETAILED DESIGN ON THE URGENT REHABILITATION PROJECT OF THE TANJUNG PRIOK PORT IN THE REPUBLIC OF INDONESIA</p> <p>NIPPON KOEI CO., LTD.</p> <p>JAPAN PORT CONSULTANTS, LTD.</p>	<p>PREPARED BY : <i>[Signature]</i> Y. PRASETYANTO</p> <p>CHECKED BY : <i>[Signature]</i> M. IMAMURA</p> <p>APPROVED BY : <i>[Signature]</i> K. OKUBO</p>	<p>SECTION : CHANNEL AND BASIN IMPROVEMENT</p> <p>SUB-SECTION : GENRAL</p> <p>TITLE : Bench Marks for Marine Work</p>	DATE :	MARCH 2006			
SCALE :										1 : 10000				
DRAWING NO. :										P-G-022				

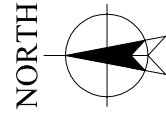

712,000 + 9,331,000
 711,000 +
 710,000 +
 709,000 +
 708,000 +

3°
 Q
 (X= 708,393.9755)
 (Y= 9,330,034.9335)

Point	Coordinate of Key Positions (Boundary of Dredging Area)			
	(UTM)		(Geographic)	
	East (m)	North (m)	Longitude (° ' ")	Latitude (° ' ")
a	708,244.1810	9,330,042.7840	106° 52' 53.36"	06° 03' 28.16"
b	708,543.7700	9,330,027.0830	106° 53' 03.30"	06° 03' 28.63"
c	708,412.9149	9,327,530.2172	106° 52' 59.33"	06° 04' 49.92"
d	708,573.1200	9,326,465.3000	106° 53' 04.66"	06° 05' 24.56"
e	708,801.4086	9,326,264.2825	106° 53' 12.10"	06° 05' 31.08"
f	709,890.0857	9,326,264.2825	106° 53' 47.50"	06° 05' 30.96"
g	709,890.0857	9,325,664.2825	106° 53' 47.57"	06° 05' 50.49"
h	709,465.1755	9,325,664.2825	106° 53' 33.76"	06° 05' 50.53"
i	709,277.4486	9,325,711.2869	106° 53' 27.65"	06° 05' 49.03"
j	708,978.0500	9,325,723.0959	106° 53' 17.91"	06° 05' 48.67"
k	708,314.5247	9,326,142.5841	106° 52' 56.29"	06° 05' 35.10"
l	708,063.7733	9,326,600.3947	106° 52' 48.08"	06° 05' 20.22"
m	708,113.3260	9,327,545.9180	106° 52' 49.58"	06° 04' 49.44"

Remarks

- Ⓐ : Outer Channel
- Ⓑ : Inner Channel
- Ⓒ : Turning Basin

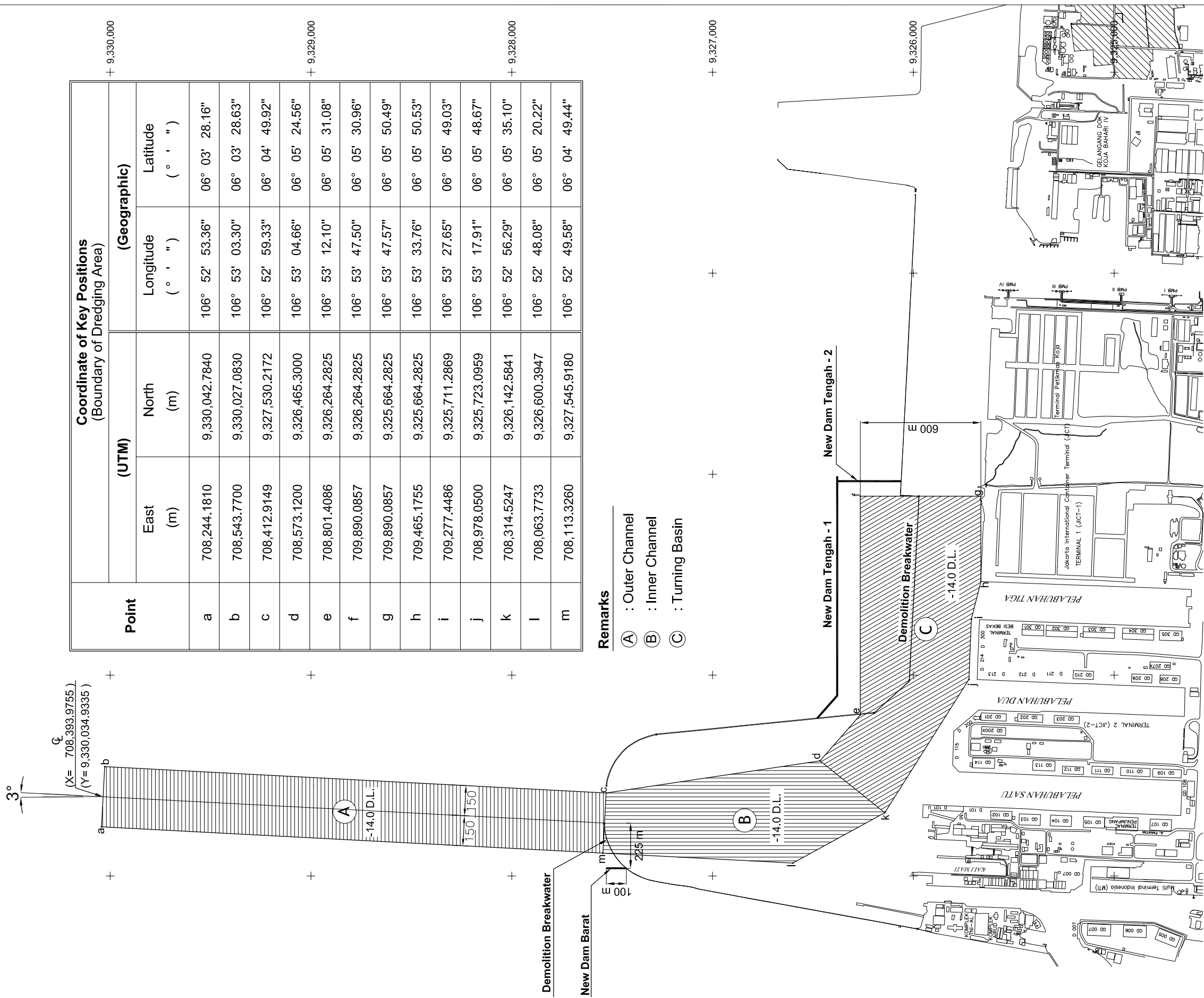

REV. NO.	DATE	COORDINATE	BY	APPROVED	DATE

JICA
 JAPAN INTERNATIONAL COOPERATION AGENCY (JICA)

 DIRECTORATE GENERAL OF SEA COMMUNICATION (DGSC)

THE DETAILED DESIGN
 ON THE URGENT REHABILITATION PROJECT
 OF THE TANJUNG PRIOK PORT
 IN THE REPUBLIC OF INDONESIA

 NIPPON KOEI CO., LTD.

 JAPAN PORT CONSULTANTS, LTD.

PREPARED BY: *[Signature]*
 W. WIDIYANTO
 CHECKED BY: *[Signature]*
 M. IMAMURA
 APPROVED BY: *[Signature]*
 K. OKUBO

SECTION : CHANNEL AND BASIN IMPROVEMENT
 SUB-SECTION : DREDGING
 TITLE : Dredging Plan - General Area

DATE : MARCH 2006
 SCALE : 1:20000
 DRAWING NO. : P-D-001

REV. NO.	DATE	COORDINATE	BY	APPROVED	DATE

JICA
JAPAN INTERNATIONAL COOPERATION AGENCY (JICA)

DIRECTORATE GENERAL OF SEA COMMUNICATION (DGSC)

THE DETAILED DESIGN ON THE URGENT REHABILITATION PROJECT OF THE TANJUNG PRIOK PORT IN THE REPUBLIC OF INDONESIA

NIPPON KOEI CO., LTD.
JAPAN PORT CONSULTANTS, LTD.

PREPARED BY: *[Signature]*
W. WIDIYANTO

CHECKED BY: *[Signature]*
M. IMAMURA

APPROVED BY: *[Signature]*
K. OKUBO

SECTION : CHANNEL AND BASIN IMPROVEMENT
SUB-SECTION : DREDGING
TITLE : Cross Sectional Dredging Plan

DATE : MARCH 2006
SCALE : 1:20000
DRAWING NO. : P-D-002

712,000 +
+ 9,331,000

711,000 +

710,000 +

709,000 +

708,000 +

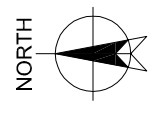
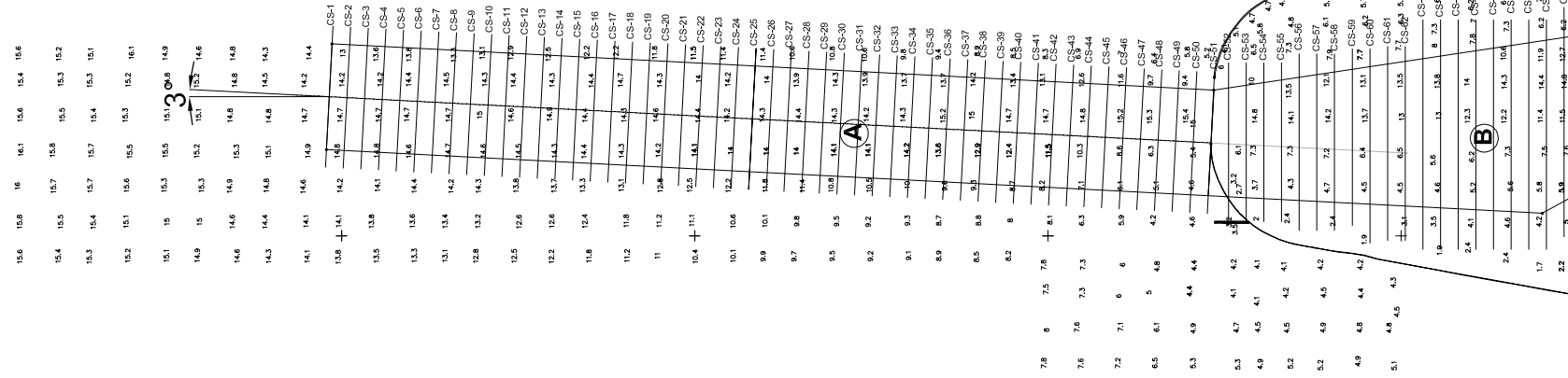

Remarks

(A) : Outer Channel
Cross Section 1 ~ Cross Section 51
(See Drawing No. P-D-003)

(B) : Inner Channel
Cross Section 51 ~ Cross Section 80
(See Drawing No. P-D-004)

(C) : Turning Basin
Cross Section 80 ~ Cross Section 113
(See Drawing No. P-D-005)

+ 9,330,000

+

+

+ 9,329,000

+

+

+ 9,328,000

+

+

+ 9,327,000

+

+

+ 9,326,000

+

+

