

**LOCATION MAP OF PROPOSED COMPONENTS IN  
KHALIAJURI UPAZILA  
NETROKONA DISTRICT  
(Proposed Site: Lipsha)**

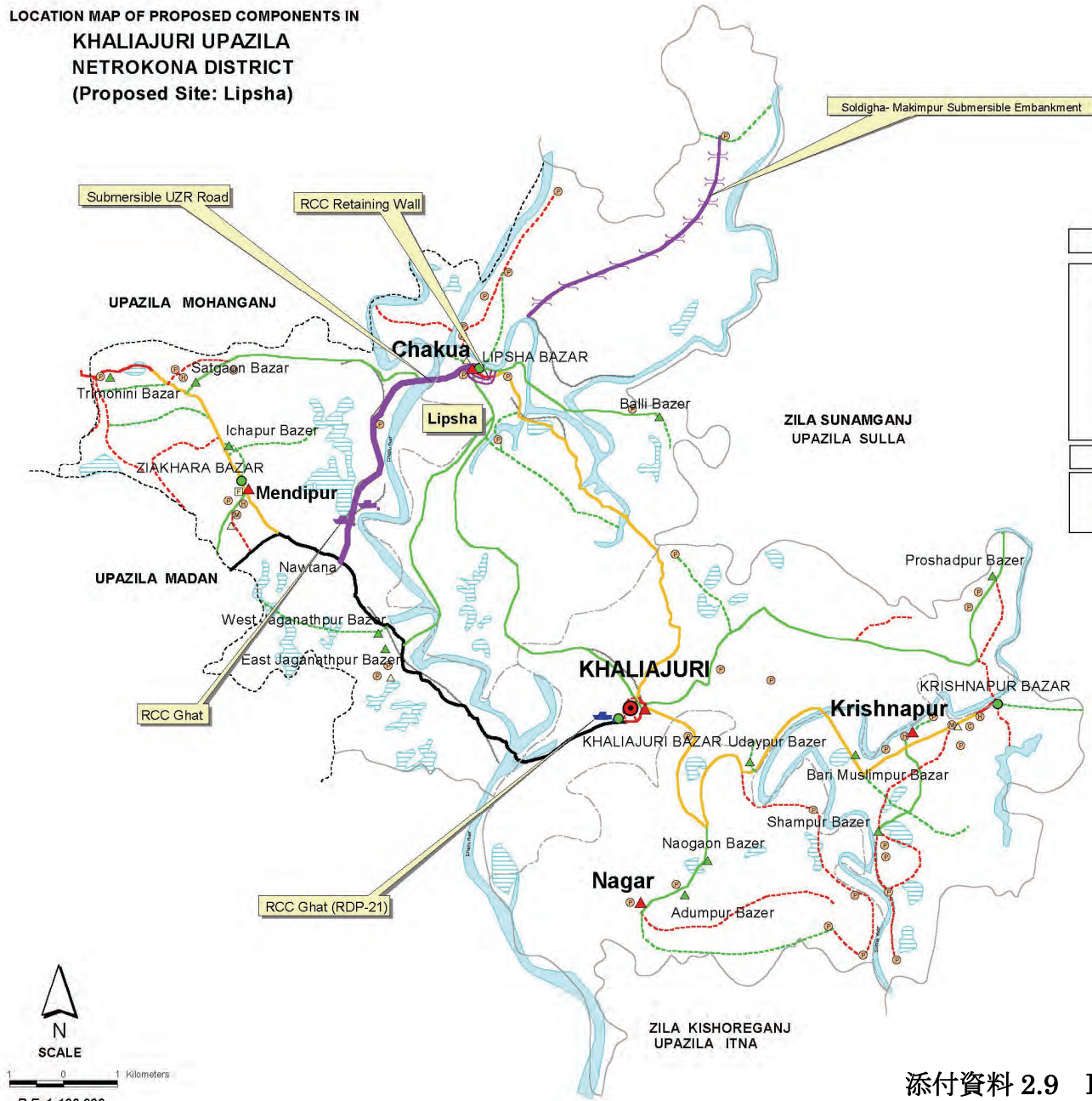

LEGEND (PROPOSED PROJECT)	
	Pontoon Ghat
	Sluice Gate
	Submersible Embankment
	Retaining Wall
	Submersible Road(UZR)

LEGEND (EXISTING FACILITIES)	
	Submersible Road(Zila Road)
	Pontoon Ghat (JBIC List)

LEGEND	
<b>Administrative Boundary</b>	
	International Boundary
	District Boundary
	Upazila Boundary
	Union Boundary
<b>Administrative HQs</b>	
	District HQ
	Upazila HQ
	Union HQ
<b>Physical Infrastructures</b>	
	National Highway
	Regional Highway
	Zila Road
	Upazila Road Pucca
	Upazila Road Katcha
	Union Road Pucca
	Union Road Katcha
	Village Road A Pucca
	Village Road A Katcha
	Village Road B Pucca
	Village Road B Katcha
	Road Cum Embankment
	Railway Network
<b>Natural Features</b>	
	Wide River
	Water Bodies
	Char
	Khal
<b>Socio-Economic Infrastructures</b>	
	Growth Centre
	Rural Market
	Police Station
	Upazila Health Complex
	Family welfare Centre
	Post Office
	College
	High School
	Primary School
	Madrasa
	Mosque

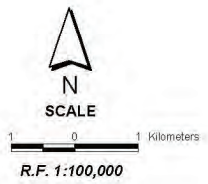

添付資料 2.9 Lipsha Site

Compiled from : I.G.E.D Upazila Base Maps 1994-95, Landsat TM 1998,  
GPS Survey 1998 and Field Checking in May 2001  
Projection : Lambert's Conformal Conic  
PREPARED BY : GIS UNIT  
LOCAL GOVERNMENT ENGINEERING DEPARTMENT

**LOCATION MAP OF PROPOSED COMPONENTS IN  
DHARMAPASHA UPAZILA  
SUNAMGANJ DISTRICT  
(Proposed Site: Nazarpur Village)**

**LEGEND (PROPOSED PROJECT)**

- Paved Agriculture Road
- Pontoon Ghat
- Drying Yard
- Sluice Gate
- Submersible Embankment
- Retaining Wall
- Submersible Road(UZR)

**LEGEND (EXISTING FACILITIES)**

- Submersible Road(UZR)
- Pontoon Ghat (JBIC List)

**LEGEND**

- Administrative Boundary**
  - International Boundary
  - District Boundary
  - Upazila Boundary
  - Union Boundary
- Administrative HQs**
  - District HQ
  - Upazila HQ
  - Union HQ
- Physical Infrastructures**
  - National Highway
  - Regional Highway
  - Zila Road
  - Upazila Road Pucca
  - Upazila Road Katcha
  - Union Road Pucca
  - Union Road Katcha
  - Village Road A Pucca
  - Village Road A Katcha
  - Village Road B Pucca
  - Village Road B Katcha
  - Road Cum Embankment
  - Railway Network
- Natural Features**
  - Wide River
  - Water Bodies
  - Char
  - Khal
- Socio-Economic Infrastructures**
  - Growth Centre
  - Rural Market
  - Police Station
  - Upazila Health Complex
  - Family welfare Centre
  - Post Office
  - College
  - High School
  - Primary School
  - Madrasa
  - Mosque

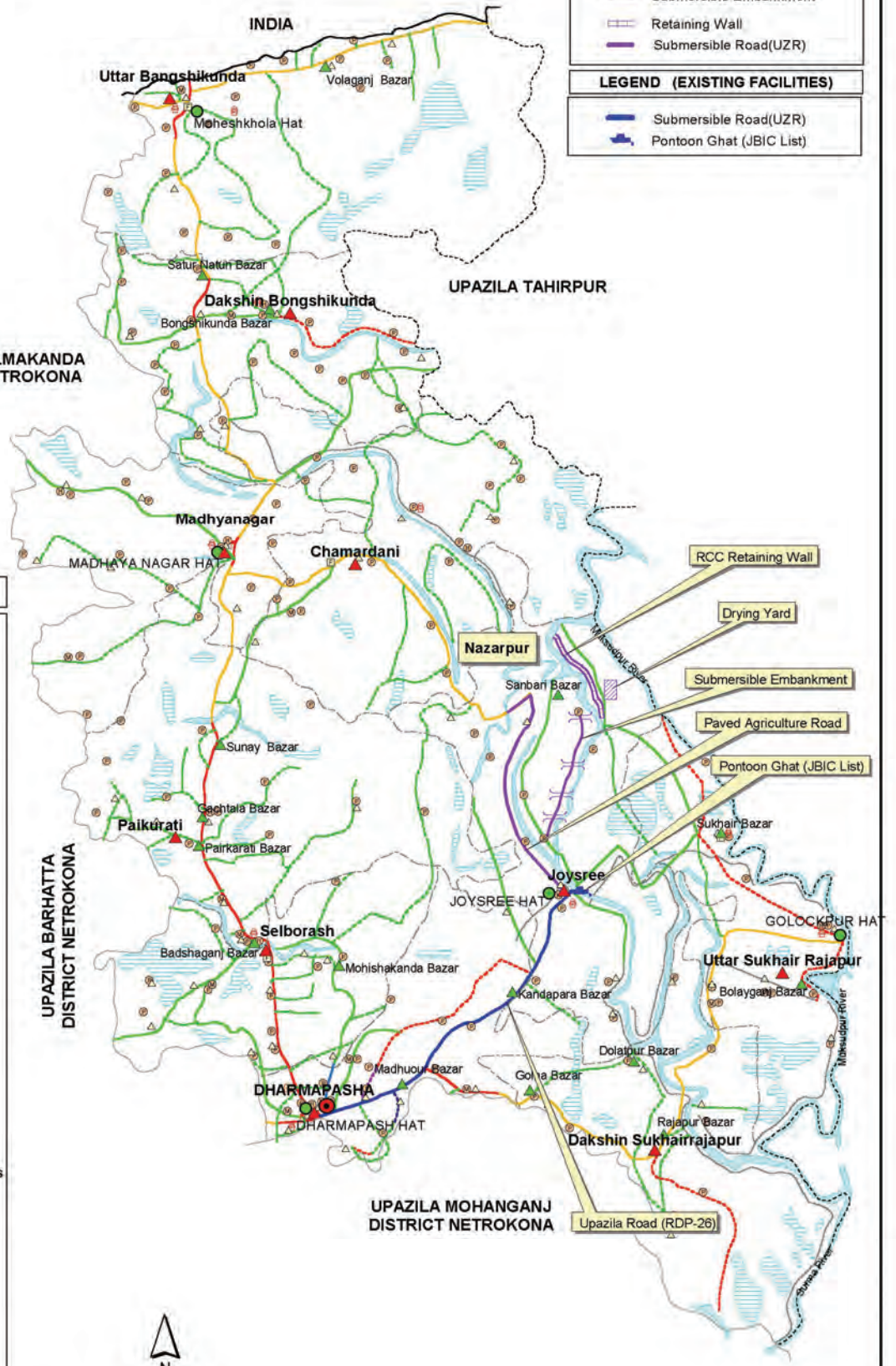

Compiled from: 1. LEGS Upazila Base Maps 1984-85, 1:50,000  
 GPS Survey 1999 and Field Checkling in May 2001  
 Projection: UTM  
 L.L. Lambert's Conformal Conic  
 PREPARED BY: GIS UNIT  
 LOCAL GOVERNMENT ENGINEERING DEPARTMENT

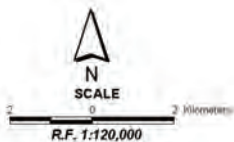

添付資料 2.9 Nazarpur Site

LOCATION MAP OF PROPOSED COMPONENTS IN  
**NIKLI UPAZILA**  
**KISHOREGANJ DISTRICT**  
 (Proposed Site: Gurai Village)

**LEGEND**

- Administrative Boundary**
- International Boundary
  - District Boundary
  - Upazila Boundary
  - Union Boundary
- Administrative HQs**
- District HQ
  - Upazila HQ
  - Union HQ
- Physical Infrastructures**
- National Highway
  - Regional Highway
  - Zila Road
  - Upazila Road Pucca
  - Upazila Road Katcha
  - Union Road Pucca
  - Union Road Katcha
  - Village Road A Pucca
  - Village Road A Katcha
  - Village Road B Pucca
  - Village Road B Katcha
  - Road Cum Embankment
  - Railway Network
- Natural Features**
- Wide River
  - Water Bodies
  - Char
  - Khal
- Socio-Economic Infrastructures**
- Growth Centre
  - Rural Market
  - Police Station
  - Upazila Health Complex
  - Family welfare Centre
  - Post Office
  - College
  - High School
  - Primary School
  - Madrassa
  - Mosque

**LEGEND (PROPOSED PROJECT)**

- Drying Yard
- Sluice Gate
- Submersible Embankment
- Retaining Wall
- Paved Agriculture Road (UZR)

**LEGEND (EXISTING FACILITIES)**

- Submersible Road(UZR)
- Pontoon Ghat
- Retaining Wall

Compiled from ICGED Upazila Base Maps 1994-95, Landsat TM 1998,  
 GPS Survey 1998 and Field Checking in May 2001  
 Projection: Lambert's Conformal Conic  
 PREPARED BY: GIS UNIT  
 LOCAL GOVERNMENT ENGINEERING DEPARTMENT

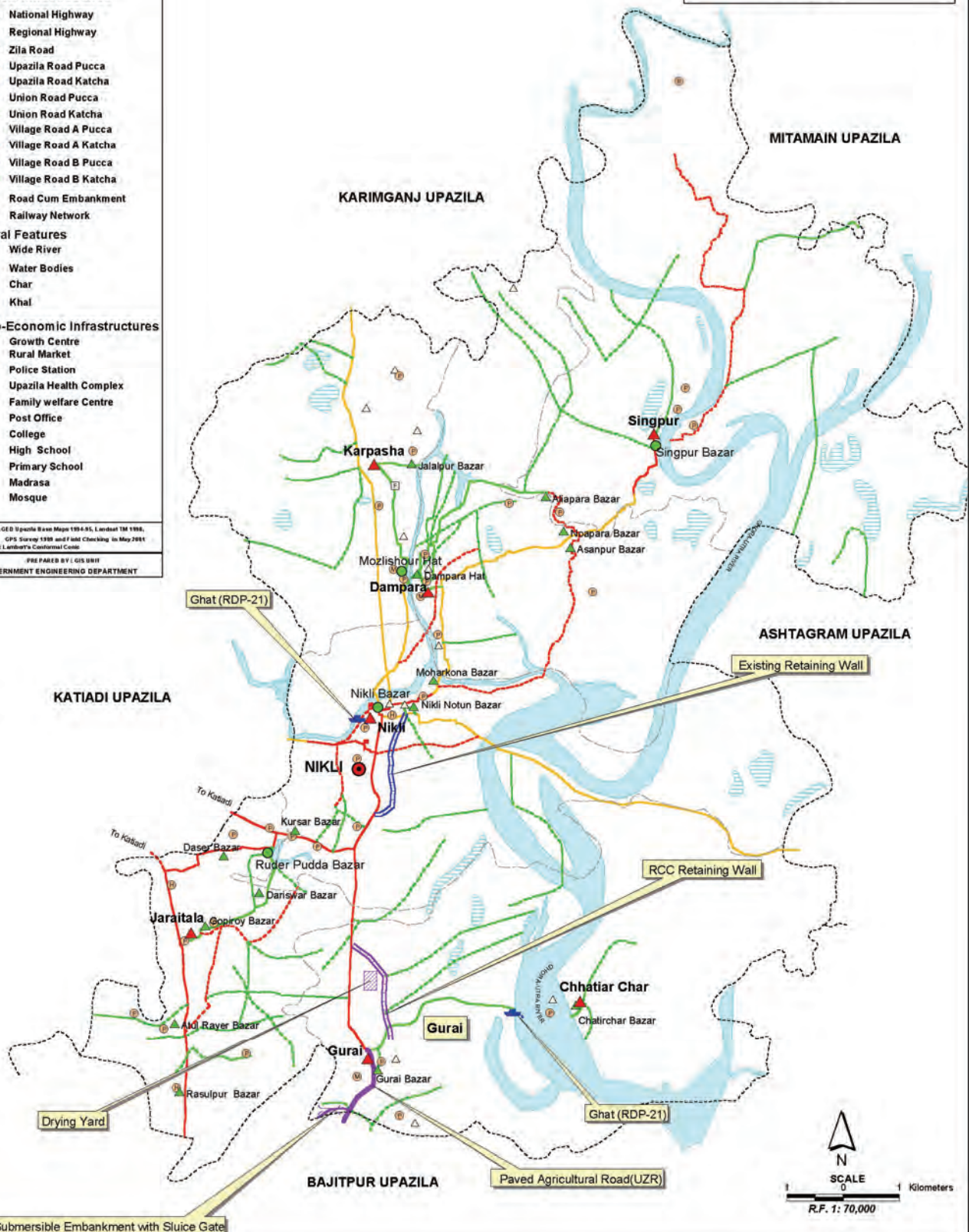

添付資料 2.9 Nikli Site

**LOCATION MAP OF PROPOSED COMPONENTS IN  
LAKHAI UPAZILA  
HABIGANJ DISTRICT  
(Proposed Site: Sazan Village)**

- LEGEND (PROPOSED PROJECT)**
- Pontoon Ghat
  - Drying Yard
  - Retaining Wall
  - Paved Agriculture Road (UZR)
- LEGEND (EXISTING FACILITIES)**
- Paved Agriculture Road (JBIC List)

- LEGEND**
- Administrative Boundary**
    - International Boundary
    - District Boundary
    - Upazila Boundary
    - Union Boundary
  - Administrative HQs**
    - District HQ
    - Upazila HQ
    - Union HQ
  - Physical Infrastructures**
    - National Highway
    - Regional Highway
    - Zila Road
    - Upazila Road Pucca
    - Upazila Road Katcha
    - Union Road Pucca
    - Union Road Katcha
    - Village Road A Pucca
    - Village Road A Katcha
    - Village Road B Pucca
    - Village Road B Katcha
    - Road Cum Embankment
    - Railway Network
  - Natural Features**
    - Wide River
    - Water Bodies
    - Char
    - Khal
  - Socio-Economic Infrastructures**
    - Growth Centre
    - Rural Market
    - Police Station
    - Upazila Health Complex
    - Family welfare Centre
    - Post Office
    - College
    - High School
    - Primary School
    - Madrasa
    - Mosque
- Compiled from : LGED Upazila Base Maps 1994-95, Landat TM 1998, GIS Survey 1998 and Field Checking in May 2001  
Projection : Lambert's Conformal Conic  
PREPARED BY : GIS UNIT  
LOCAL GOVERNMENT ENGINEERING DEPARTMENT

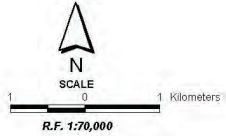
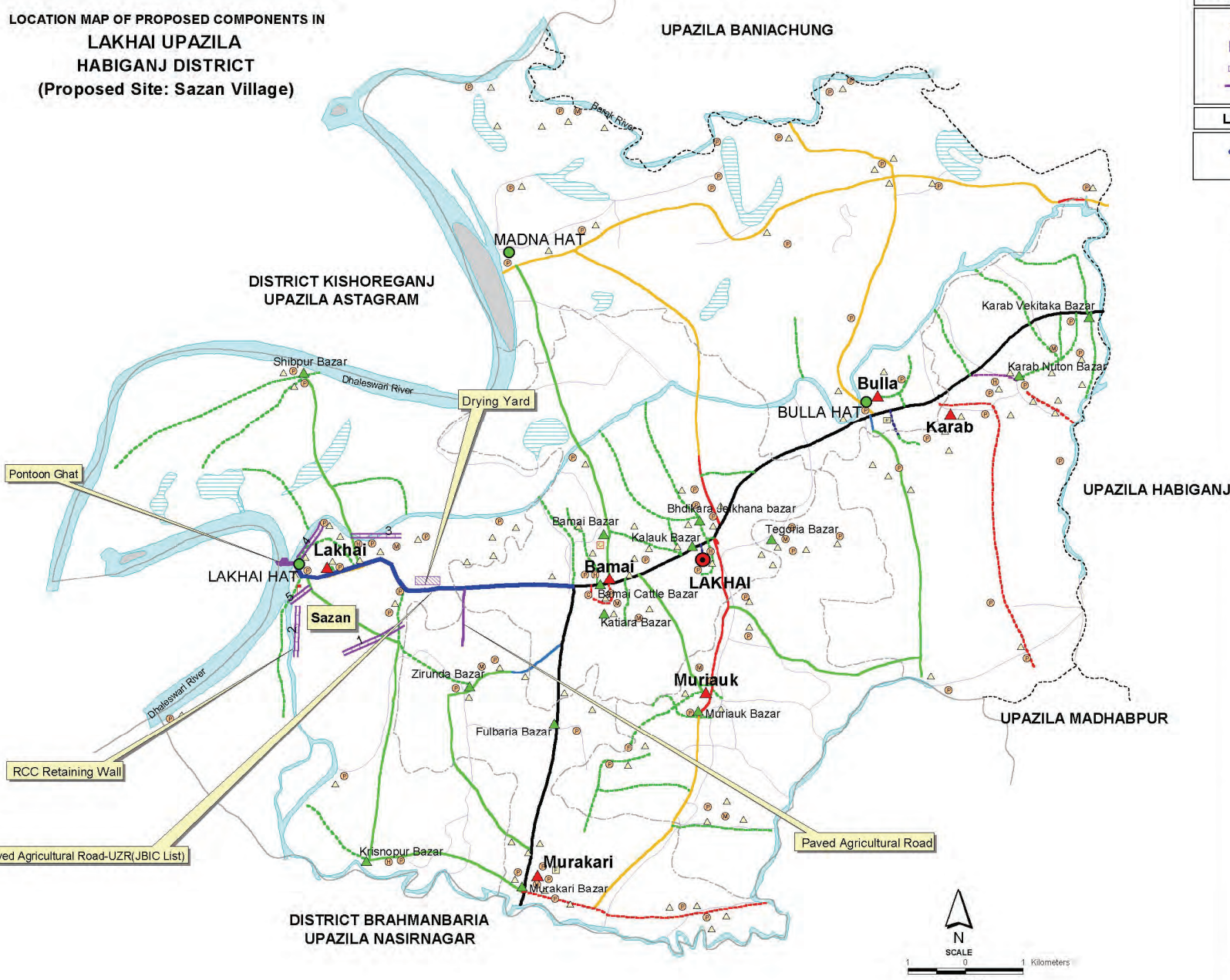

添付資料 2.9 Sazan Site

**添付資料 2. 10 LGED による必要コスト試算**

**1. Gurai Village, Gurai Union in Nikli Upazila (Kishorganji District)**

Component	Sub component	Proposed Dimension	Construction Cost (million TK)	
			Unit Rate	Amount
RCC retaining wall for wave protection	-	Length: 1,700 m Average height: 1.5 m	0.03 per m	51.00
Submergible embankment with sluice gate	Embankment	Length: 200 m Top width: 7.3 m Height: 3 m	0.004 per m	0.80
	Sluice gate	Slope gradient: 1:1.5 Sluice gate: 2 m wide×1 place	1.0 per place	1.00
Paved agricultural road (UZR) with slope protection	-	Length: 1,000 m Paved width: 3.6m with 1m wide shoulder×2 (Road height: 2m with 1:1.5 slope)	0.004 per m	4.00
Drying yard with parboil	-	Area: 4,800 sq.m (80 m× 59m) Parboil: 1 set	0.00035 per sq.m	1.68
Total cost				58.48

出典 : LGED HQ。

UZR: Upazila Road

**2. Lipsha Village , Chakuwa Union in Khaliajuri Upazila (Netrokona District)**

Component	Sub Component	Proposed Dimension	Construction Cost (million TK)	
			Unit Rate	Amount
RCC retaining wall for wave protection	-	Length: 1,000 m Average height: 4 m	0.06 per m	60.0
Submergible agricultural road (UZR)	-	Length: 6,000m Top width: 7.3 m Height: 1 m Slope gradient: 1:1.5	0.004 per m	24.0
Submergible embankment with sluice gate	Embankment	Length: 8,000 m Top width: 7.3m Height: 1m	0.004 per m	32.0
	Sluice gate	Slope gradient: 1:1.5 Sluice gate: 1.5 to 3m wide×10 places	1.2 per place	12.0
RCC ghat	-	4m high×7m wide×2 places	2.0 per place	4.0
Total cost				132.0

出典 : LGED HQ

### 3. Sazan Village, Lakhi Union in Lakhi Upazila (Habigonji District)

Component	Sub Component	Proposed Dimension	Construction cost (million TK)	
			Unit rate	Amount
RCC retaining wall for wave protection	-	(1) Length: 1,500 m (2) Length: 400 m (3) Length: 300 m (4) Length: 300m (5) Length: 100m Total length: 2,600m Average height: 2.5 m	0.045 per m	117.0
Drying yard	-	Area: 16,000sq.m (800m× 20m)	0.00035 per sq.m	5.6
Pontoon ghat	-	7m ×7m area×1place	3.0 per place	3.0
Paved agricultural road (UZR) with slope protection	-	Length: 1,000 m Paved width: 3.6m with 1m wide shoulder×2 (Road height: 1m with 1:2 slope)	0.004 per m	4.0
Total cost				129.6

出典 : LGED HQ

### 4. Nazarpur Village, Joysree Union in Dharmapasha Upazila (Sunamganji District)

Component	Sub Component	Proposed Dimensin	Construction cost (million TK)	
			Unit rate	Amount
RCC retaining wall for wave protection	-	Length: 1,100 m Average height: 4 m	0.06 per m	66.0
Drying yard	-	Area: 20,000sq.m Parboil: 1	0.00035 per sq.m	7.0
Submergible agricultural road (UZR)	-	Length: 5,000m Top width: 7.3 m Height: 2 m Slope gradient: 1:2	0.004 per m	20.0
Submergible embankment with sluice gate	Embankment	Length: 4,000 m Top width: 7.3m Height: 2m Slope gradient: 1:2	0.004 per m	16.0
	Sluice gate	Sluice gate: 3.5m wide×2 lanes×4 places	1.5 per place	6.0
Paved agricultural road (UZR) with slope protection	-	Length: 1,000 m Paved width: 3.6m with 1m wide shoulder×2 (Road height: 2m with 1:2 slope)	0.004 per m	4.0
Total cost				119.0

出典 : LGED HQ

Grand Total Cost in Haor Area: 439.08 million TK

RCC Wall only: 294.0 million TK

## 添付資料 2.11

洪水適応構造物一般図面

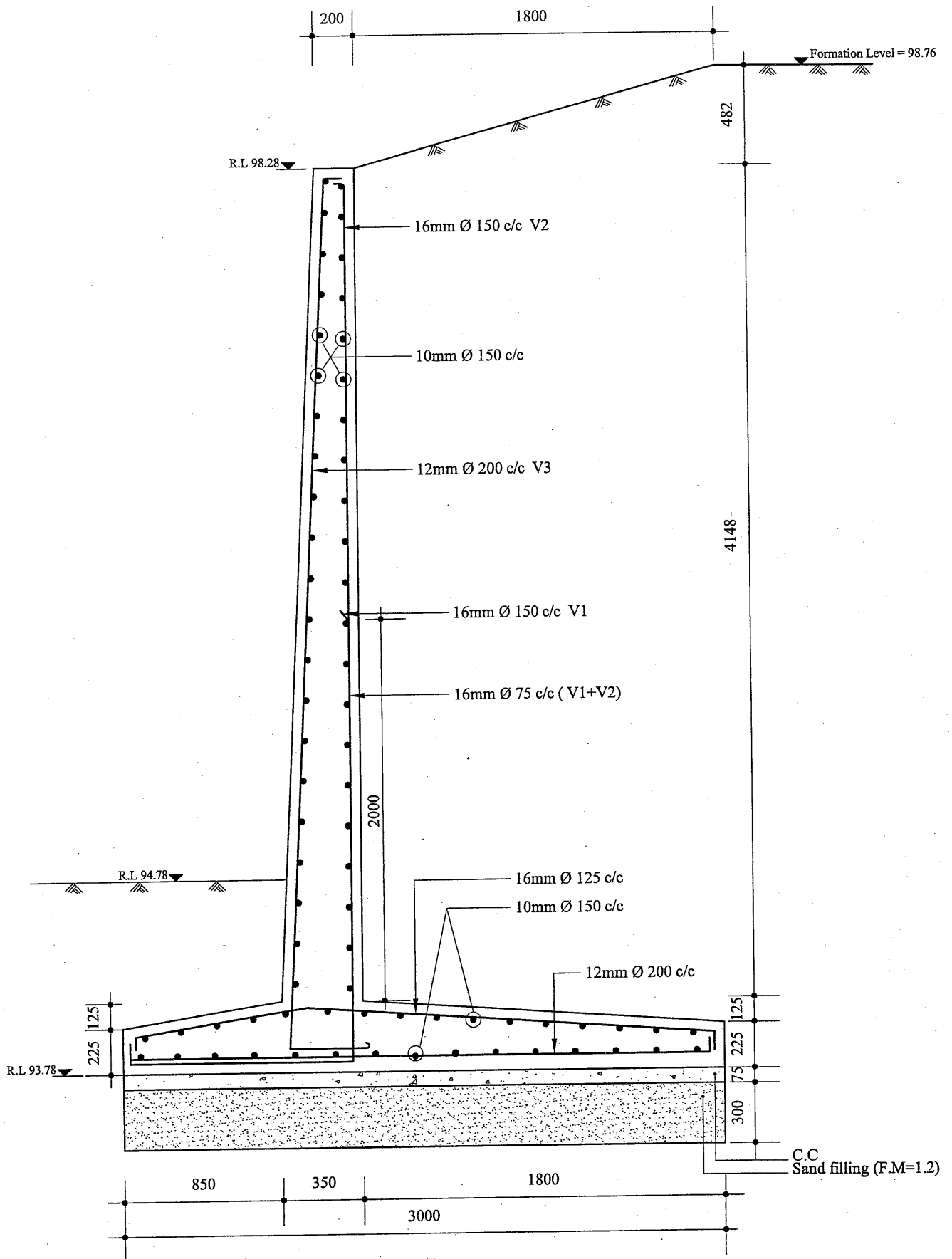

鉄筋コンクリート擁壁



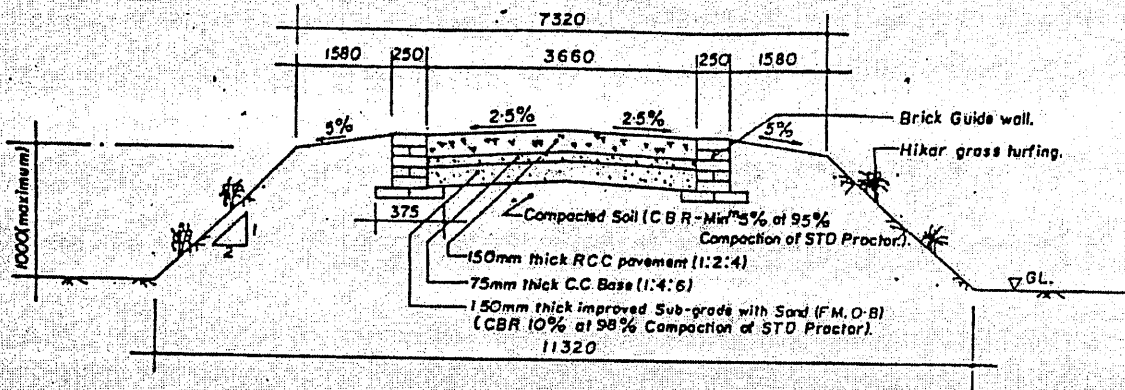

**SECTION A-A**  
SCALE = H:1:75, V:1:40

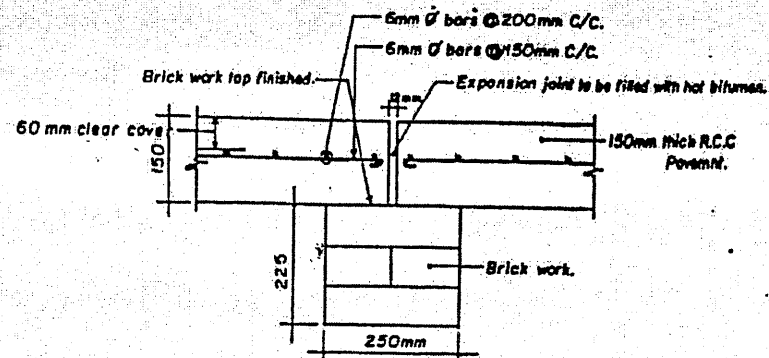

**SECTION X-X**

*J. Manam*  
 Dy. Road Engineer  
 PMA, RDP-21  
 25/10-99

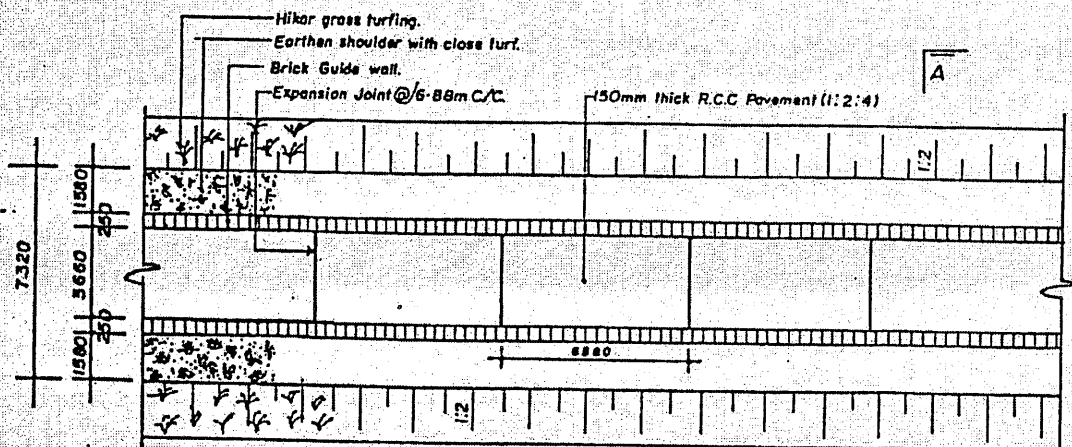

**PART PLAN OF A SUBMERSIBLE ROAD WITH R.C.C. TOP SLAB**  
SCALE: - 1:200

潜水農道

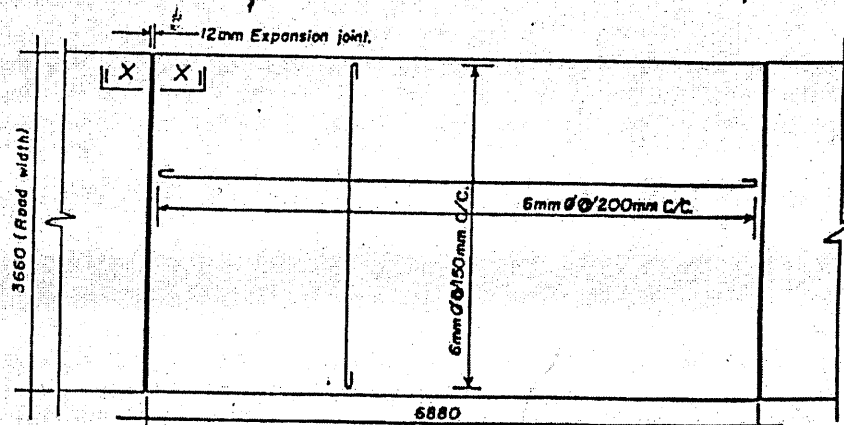

**REINFORCEMENT DETAILS OF R.C.C. PAVEMENT ROAD**

**NOTES:**

1. All dimensions are in millimeter unless otherwise mentioned.
2. 28 days cylinder crushing strength of concrete  $f_c = 20.68 \text{ N/mm}^2 (3000 \text{ psi})$ .
3. Yield strength of M.S. bar  $f_y = 276 \text{ N/mm}^2 (40000 \text{ psi})$
4. Provide one layer Polythene sheet on the top of improved sub-grade before casting 75mm thick c.c.

LOCAL GOVERNMENT ENGINEERING DEPARTMENT		
THIRD RURAL INFRASTRUCTURE DEVELOPMENT PROJECT (RDP-21)		
<b>TYPE - II</b>		
<b>DETAILS OF R.C.C. SUBMERSIBLE ROAD.</b>		
DRG NO: STD/SR/01	DATE: OCT, '99	ISSUED BY:

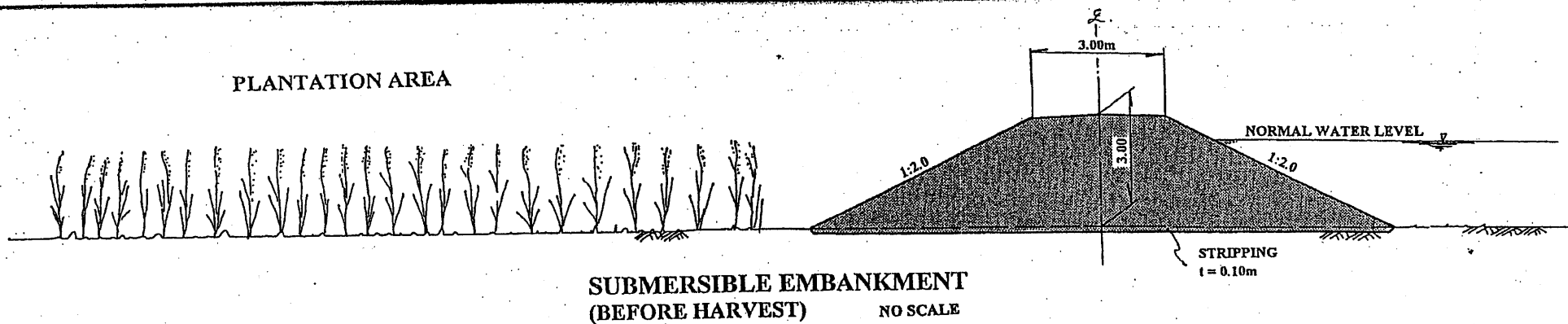

NOTE: BASED ON THE INUNDATION AREA AND FLOOD DEPTH, THE DIMENSIONS OF CULVERT ON WATER REGULATION STRUCTURE SHALL BE MODIFIED.

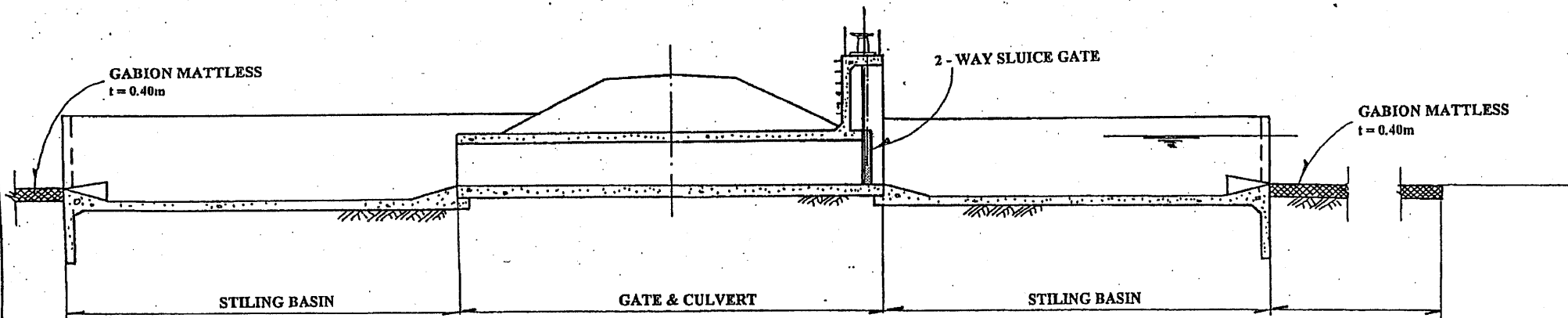
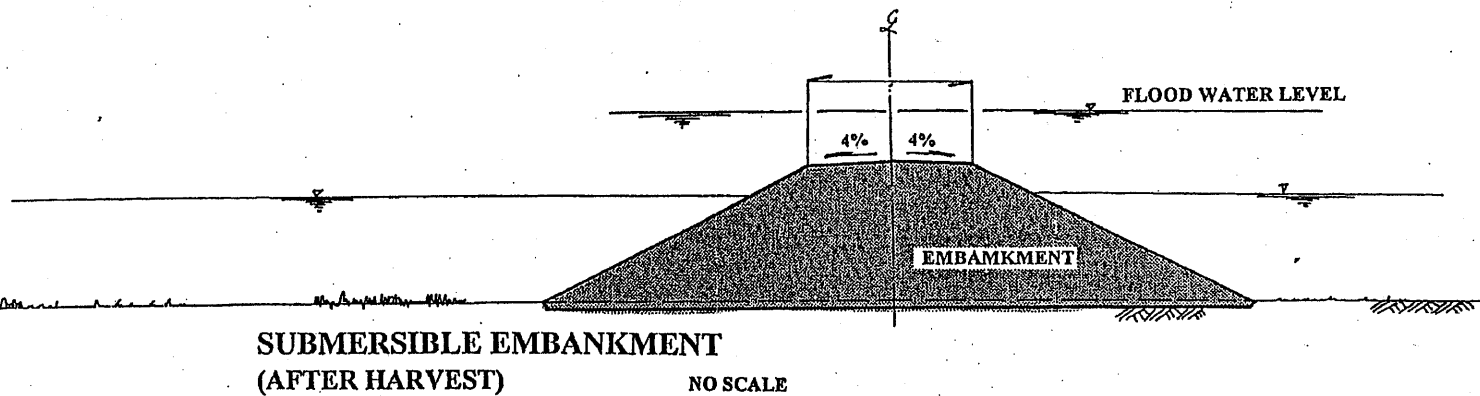

水門付潜水堤防

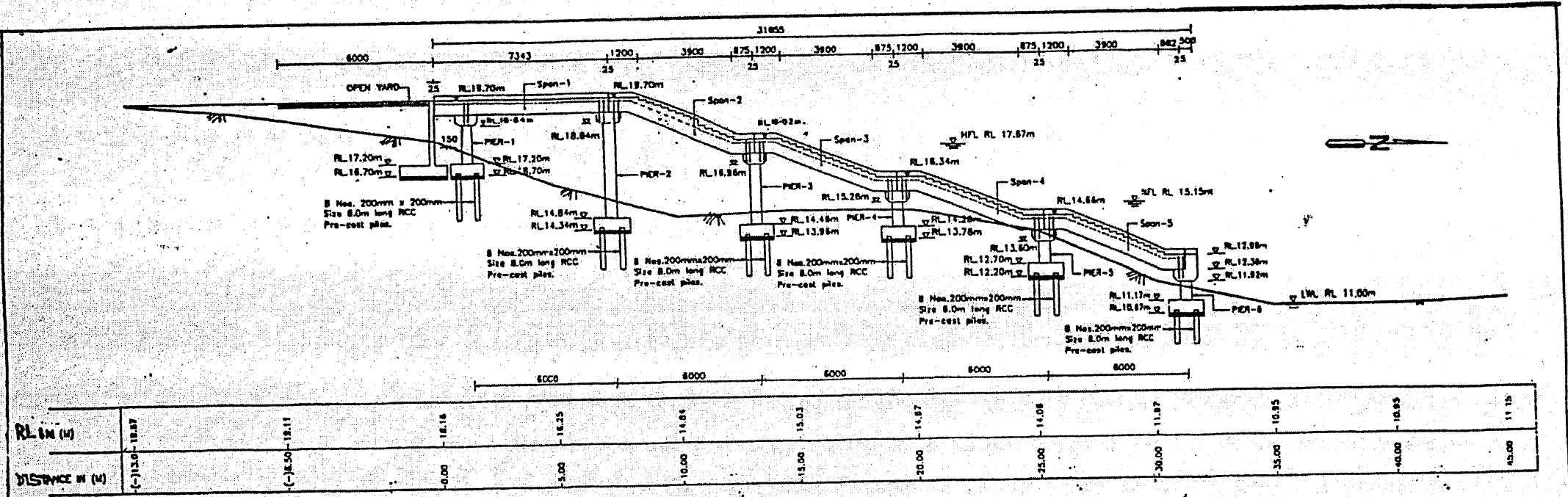

**SECTIONAL ELEVATION  
SECTION A-A**

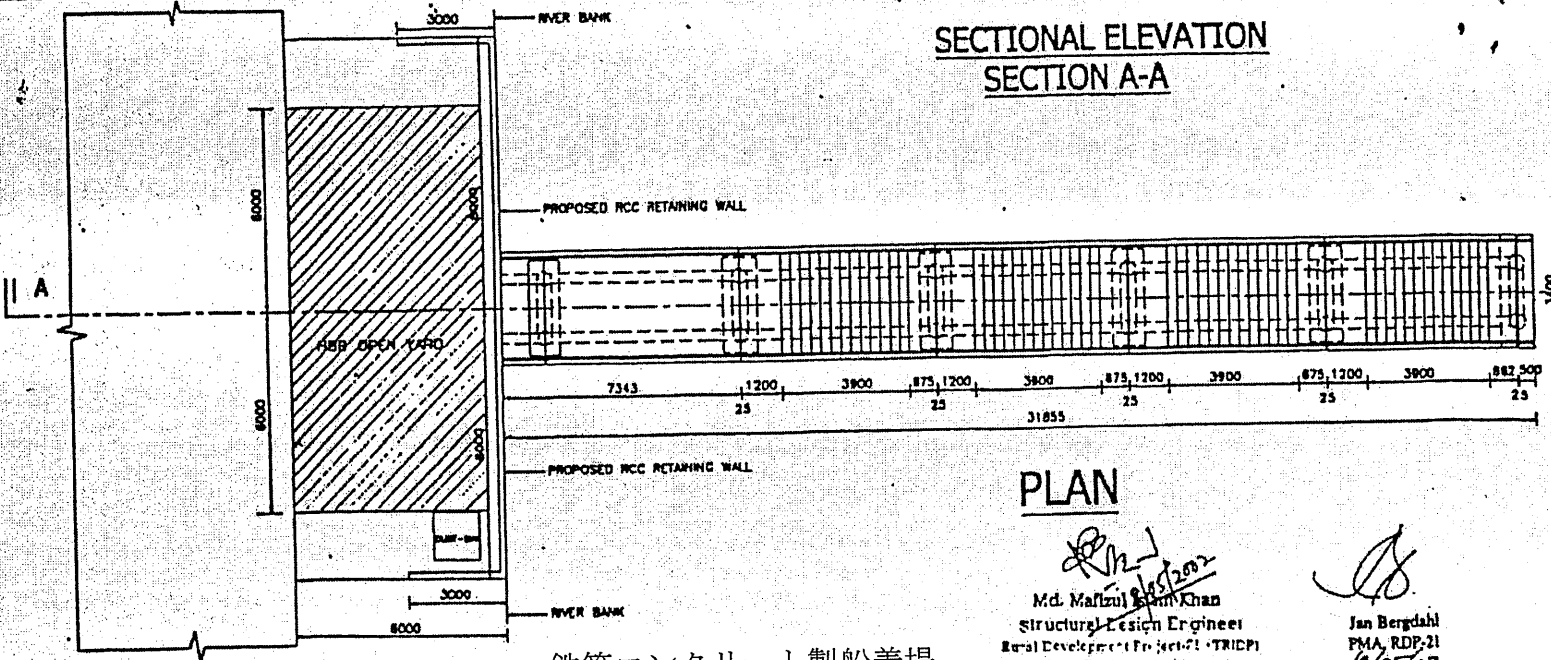

鉄筋コンクリート製船着場

**PLAN**

Md. Marizul Islam Khan  
Structural Design Engineer  
Rural Development Project (TRIDP)  
Local Govt. Engineering Department.

Jan Bergdahl  
PMA, RDP-21  
19/05/02

LOCAL GOVERNMENT ENGINEERING DEPARTMENT		
THIRD RURAL INFRASTRUCTURE DEVELOPMENT PROJECT (ROP-3)		
DEVELOPMENT OF NARUNCI BAZAR FERRY GHAT IN UPAZILA JAMALPUR SADAR, DISTRICT JAMALPUR		
<b>PLAN &amp; ELEVATION OF STEP OF GHAT</b>		
DESIGN CELL, ROP-21, LGED BHABAN (LEVEL-12)		
AGARCAON, SHER-E-BANGLA NAGAR, DHAKA-1207		
DRG. NO. CH/1/04	DATE: MAY-2002	CAD: A. AU

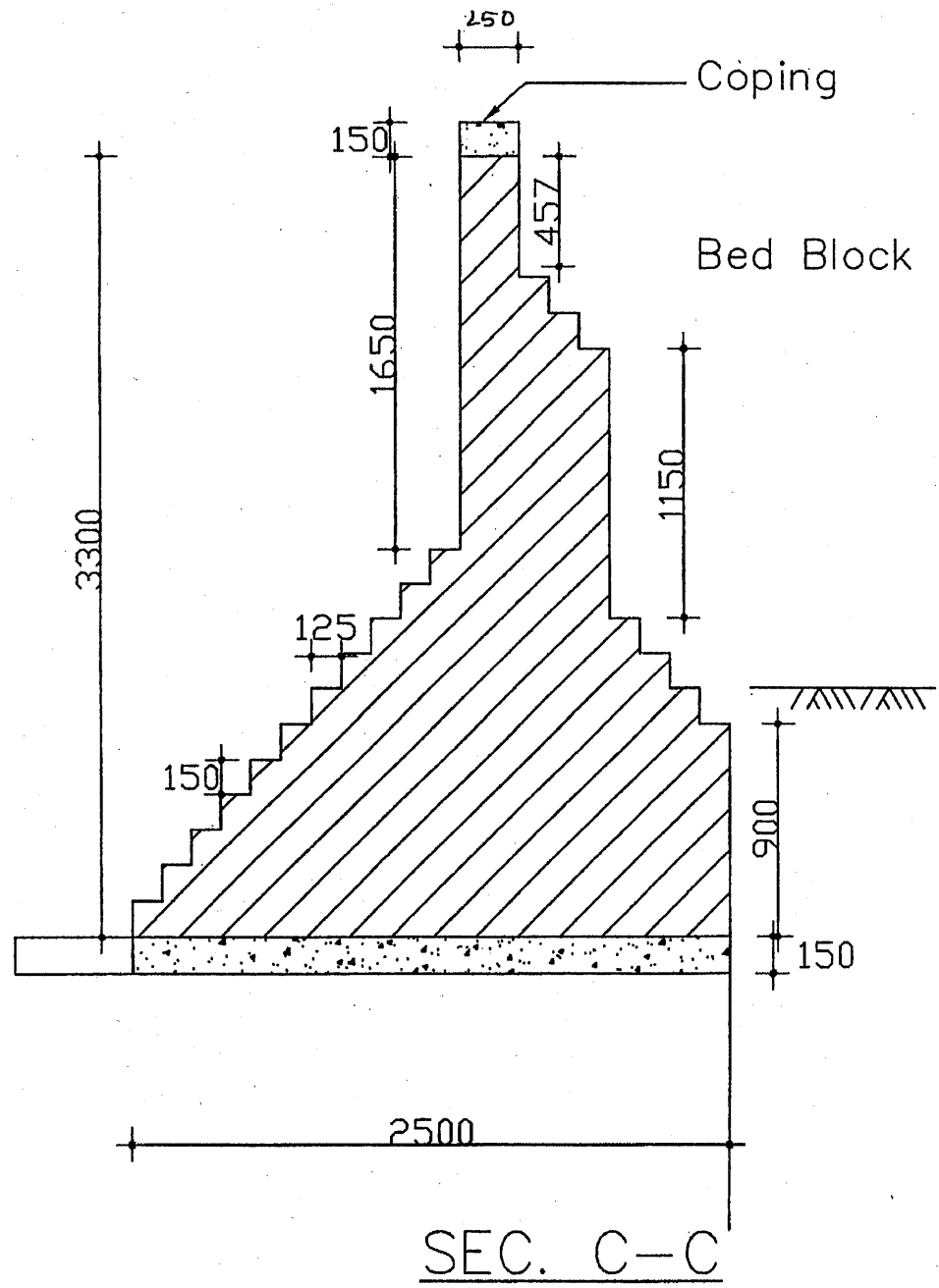

レンガ擁壁

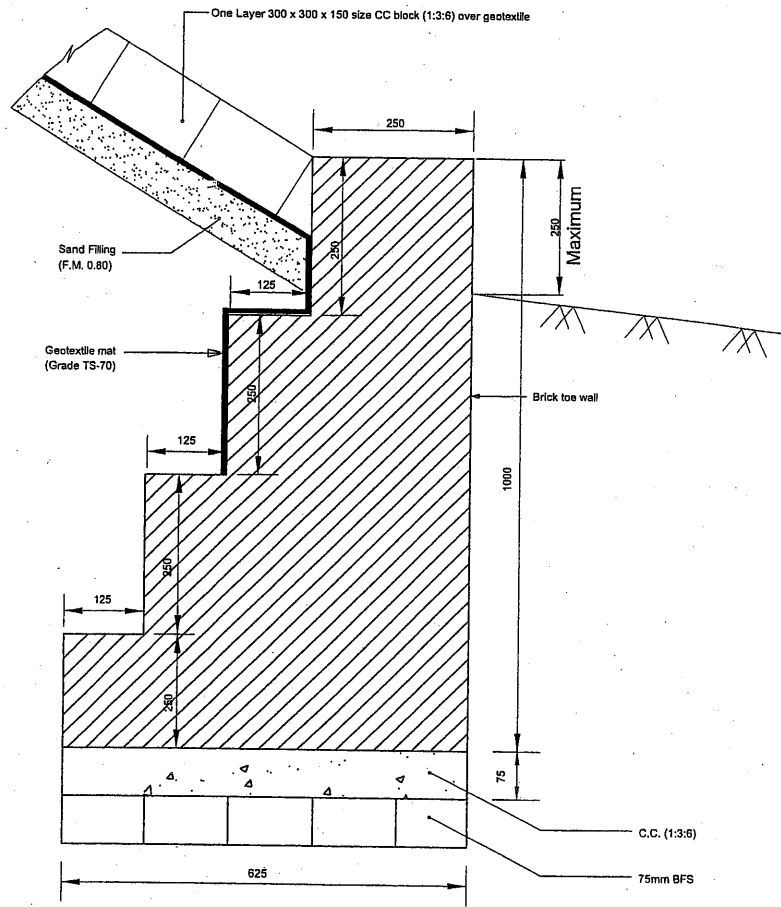

**DETAIL-A**

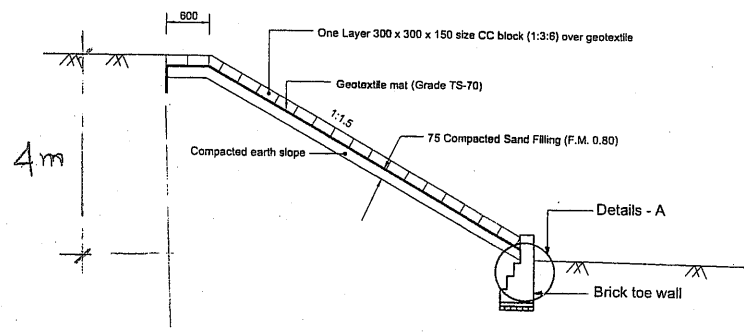

コンクリートブロック傾斜護岸

## 添付資料3

## 収集資料リスト

調査名 バングラデシュ国「チャール及びハオール地域総合農村開発計画」予備調査

番号	名 称	形態 (図書・ビデオ・ 地図・写真等)	オリジナル ・コピー	発行機関	発行年	
A	社会経済・法規類					
A-1					-	
B	国家開発計画、農業開発計画、自治体計画、組織及び予算					
B-1	LGED組織図(1)及びLGED機能	(報告書への添付資料2.5)	印刷	コピー	LGED	2005.9
B-2	LGED組織図(2)及びLGED機能		印刷	コピー	LGED	不明
B-3	LGED関係予算(過去5年間)		印刷	コピー	LGED	不明
B-4	LGED Rural Road Master Plan	CD-Rでの保存形式と文書名 PDF: Home	PC File	オリジナル	LGED	2005
B-5	LGED Brochure		製本	オリジナル	LGED	2002
B-6	Unlocking the Potential (PRSP draft)	CD-Rでの保存形式と文書名 ZIP圧縮MSワード: PRSP-First Draft	PC File	コピー	Bangladesh Planning Commission	2004
C	自然条件(気象、地形、地質等、被害資料)					
C-1	Wellcome to ADB Mission for Visiting the Site of Emergency Flood Damaged Rehabilitation Project- 2004		印刷	コピー	LGED	2004
C-2	Flood Assesment-2004	(報告書への添付資料2.4)	印刷	コピー	LGED	2004
D	地図類					
D-1						
E	施設設計、施工関係データ					
E-1	Design Manual for Structural Flood Proofing measures in Haor Area	CD-Rでの保存形式と文書名 PDF: Design Manual for Structural Flood Proofing Measure in Haor Area	PC File	オリジナル	LGED	2000
E-2	Road Structure Manual	(報告書への添付資料2.7)	製本	コピー	LGED	不明
E-3	Road Design Standard		製本	コピー	LGED	不明

添付資料3

収集資料リスト

調査名 バングラデシュ国「チャール及びハオール地域総合農村開発計画」予備調査

番号	名 称	形態 (図書・ビデオ・ 地図・写真等)	オリジナル ・コピー	発行機関	発行年	
E-4	Standard Specifications for Embankment, Sluice/Regulator for Drainage/Irrigation Schemes		製本	コピー	LGED	不明
E-5	Standard Specifications for Feeder Road Type-B and Rural Road type-R1 under LGED		製本	コピー	LGED	不明
E-6	Sample:Bill of Quantity of tender Document for Construction of Three Numbers of Hydraulic Structures and Road		印刷	コピー	LGED	2004
E-7	General Drawing of Flood proofing Structures	(報告書への添付資料2. 11)	印刷	コピー	LGED	不明
E-8	Breakdown of Cost estimate for Retaining Wall		印刷	コピー	LGED	2005
F	環境社会配慮					
F-1	The Bangladesh Environment Conservation Act, 1995		印刷	コピー	DEPARTMENT OF ENVIRONMENT	不明
F-2	The Environment Conservation Rules, 1997		印刷	コピー	DEPARTMENT OF ENVIRONMENT	不明
F-3	環境基準関係データ(1)		印刷	コピー	DEPARTMENT OF ENVIRONMENT	不明
F-4	環境基準関係データ(2)		印刷	コピー	DEPARTMENT OF ENVIRONMENT	不明
F-5	土地収用法に関する法律	The Acquisition and Requisition of immovable property Ordinance, 1982	印刷	コピー	不明	不明
F-6	土地収用フロー	Chart-2: Institutional Arrangement in land Acquisition Process as per Ordinance (ii) of 1982	印刷	コピー	不明	不明
F-7	World Environment Day - Green Cites-Planfor the Planet		製本	オリジナル	DEPARTMENT OF ENVIRONMENT	2005

## 添付資料3

## 収集資料リスト

調査名 バングラデシュ国「チャール及びハオール地域総合農村開発計画」予備調査

番号	名 称	形態 (図書・ビデオ・ 地図・写真等)	オリジナル ・コピー	発行機関	発行年
F-8	Manual on Land and Water Use Planning		製本	オリジナル Ministry of Local Government, Rural Development and Corporatives Local Government	1992
F-9	Environmental Assessment & Monitoring Guidelines prepared for Flood Proofing Component, Integrated Food Security Program		印刷	コピー LGED, CARE and USAID	2001
G	他ドナー、NGO関係				
G-1	Integrated Food Security Program Final Evaluation	(抜粋)(8月1日にJICAからの提供分になかった Appendix E 25-30を入手)	印刷	コピー CARE	2004
G-2	Baseline Survey of Vulnerable Households in Char & Haor Areas of Sirajgonj & Sunamgonj Districts		製本	コピー CARE	2003
G-3	IFSP FPP component Annual Seasonal Survey 2002		製本	コピー CARE	2003
G-4	Seasonal Survey of Flood Proofing Project, IFSP		製本	コピー CARE	2002
G-5	Geographical Concentration of Rural Poverty in Bangladesh	CD-Rでの保存形式と文書名 PDF: BDpovmap_Rpt4FAO_col	PC File	オリジナル LGED/FAO	2004
G-6	Local Estimation of Poverty and Malnutrition in Bangladesh		製本	コピー LGED/WFP	2004