

* LEGEND OF EXISTING LANDSCAPING
(IN BLUE COLOR)

| | |
|--|----------------------------|
| | PLANTER BOX (VARIES SIZES) |
| | PLANTER BOX (5X5 M) |
| | BIG TREE |
| | SMALL TREE |

* LEGEND OF PROPOSED LANDSCAPING

| | |
|--|---|
| | PROPOSED PLANTER BOX (10X2 M) TOTAL NUMBER: 15 |
| | PROPOSED PLANTER BOX (3X3 M) TOTAL NUMBER: 21 |
| | PALM TREE TOTAL NUMBER: 37 |
| | BENCHES TOTAL NUMBER: 40 |

* LEGEND OF DEMOLISHED ITEMS
(IN BLUE COLOR)

| | |
|--|-------------------------------|
| | PLANTING BOX TO BE DEMOLISHED |
| | PLANTING BOX TO BE DEMOLISHED |
| | TREE TO BE CUT |

NOTE: BIG TREES TO BE TRIMMED AS PER SITE

| | |
|--|------------------------------------|
| | THIS SECTION TO BE CONCRETE PAVING |
| | RESIDENTIAL PAVEMENT |
| | PAVEMENT PATTERN DETAIL 1 |

NOTE: CROSS MARKING REFER TO AREAS TO BE EXCLUDED FROM NEW PAVEMENT WORK
EXISTING FINISHES TO BE MAINTAINED

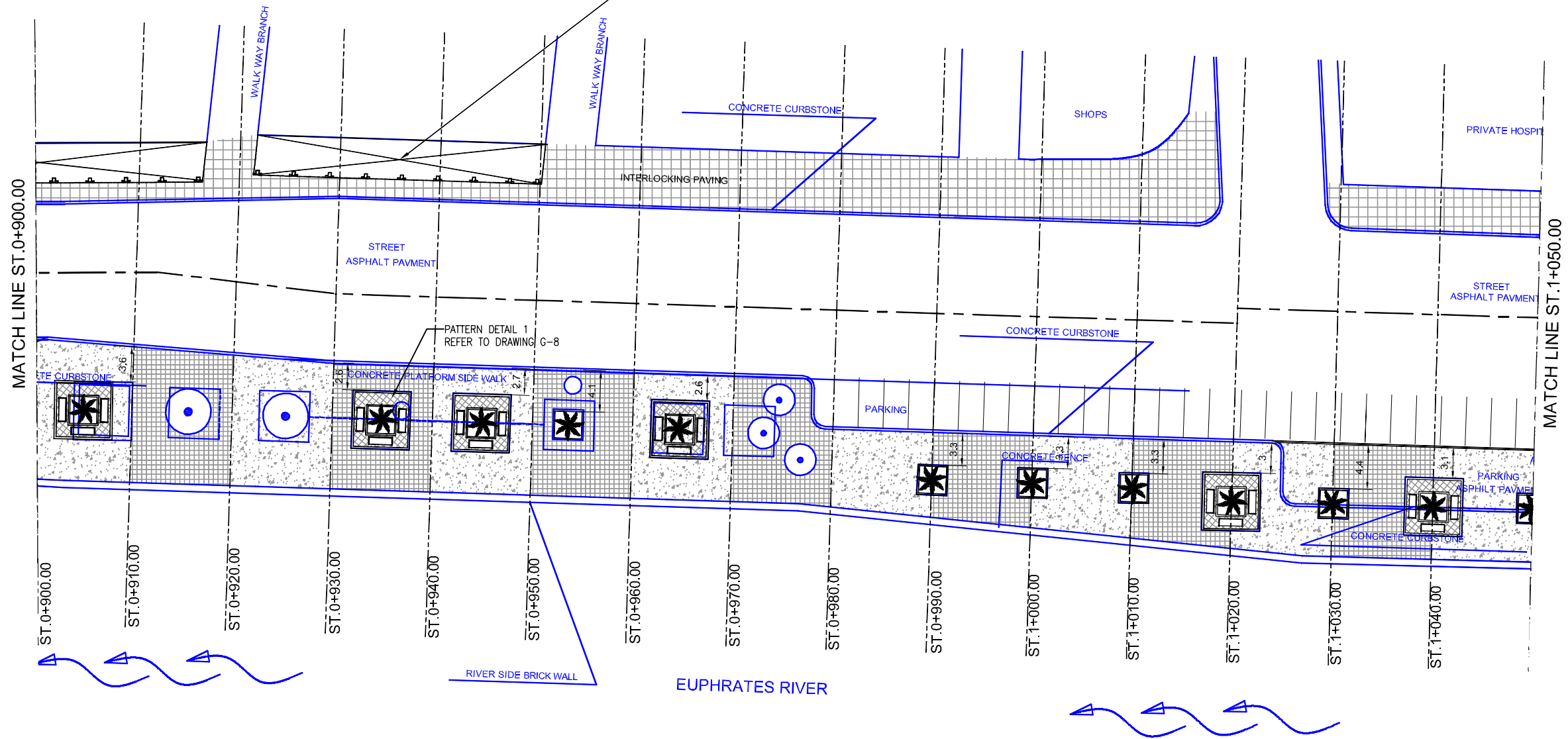

NOTE:
ALL THE EXISTING LAYOUTS ARE IN BLUE

| | | | | | | |
|---|-------------|----------|---|-------------|----------|-------------|
| Owner: SAMAWAH MAYORALTY MUTHANNA GOVERNORATE REPUBLIC OF IRAQ | Consultant: | Client : | Project : | Drawing No. | Rev: | Drawn by : |
| | | | REHABILITATION AND IMPROVEMENT OF THE ROADS AND ROAD SIDES IN SAMAWAH FOR SAMAWAH PROMENADE DEVELOPMENT PLAN | G-4 | 0 | B.H. |
| | | | Dwg Title: | Scale | Date: | Checked by: |
| | | | SIDEWALK, PLANTING AND BENCH LAYOUT (4-6) | AS SHOWN | 8-5-2005 | M.J. |

* LEGEND OF EXISTING LANDSCAPING
(IN BLUE COLOR)

| | |
|--|----------------------------|
| | PLANTER BOX (VARIES SIZES) |
| | PLANTER BOX (5X5 M) |
| | BIG TREE |
| | SMALL TREE |

* LEGEND OF PROPOSED LANDSCAPING

| | |
|--|---|
| | PROPOSED PLANTER BOX (10X2 M) TOTAL NUMBER: 15 |
| | PROPOSED PLANTER BOX (3X3 M) TOTAL NUMBER: 21 |
| | PALM TREE TOTAL NUMBER: 37 |
| | BENCHES TOTAL NUMBER: 40 |

* LEGEND OF DEMOLISHED ITEMS
(IN BLUE COLOR)

| | |
|--|-------------------------------|
| | PLANTING BOX TO BE DEMOLISHED |
| | PLANTING BOX TO BE DEMOLISHED |
| | TREE TO BE CUT |

NOTE: BIG TREES TO BE TRIMMED AS PER SITE

| | |
|--|------------------------------------|
| | THIS SECTION TO BE CONCRETE PAVING |
| | RESIDENTIAL PAVEMENT |
| | PAVEMENT PATTERN DETAIL 1 |

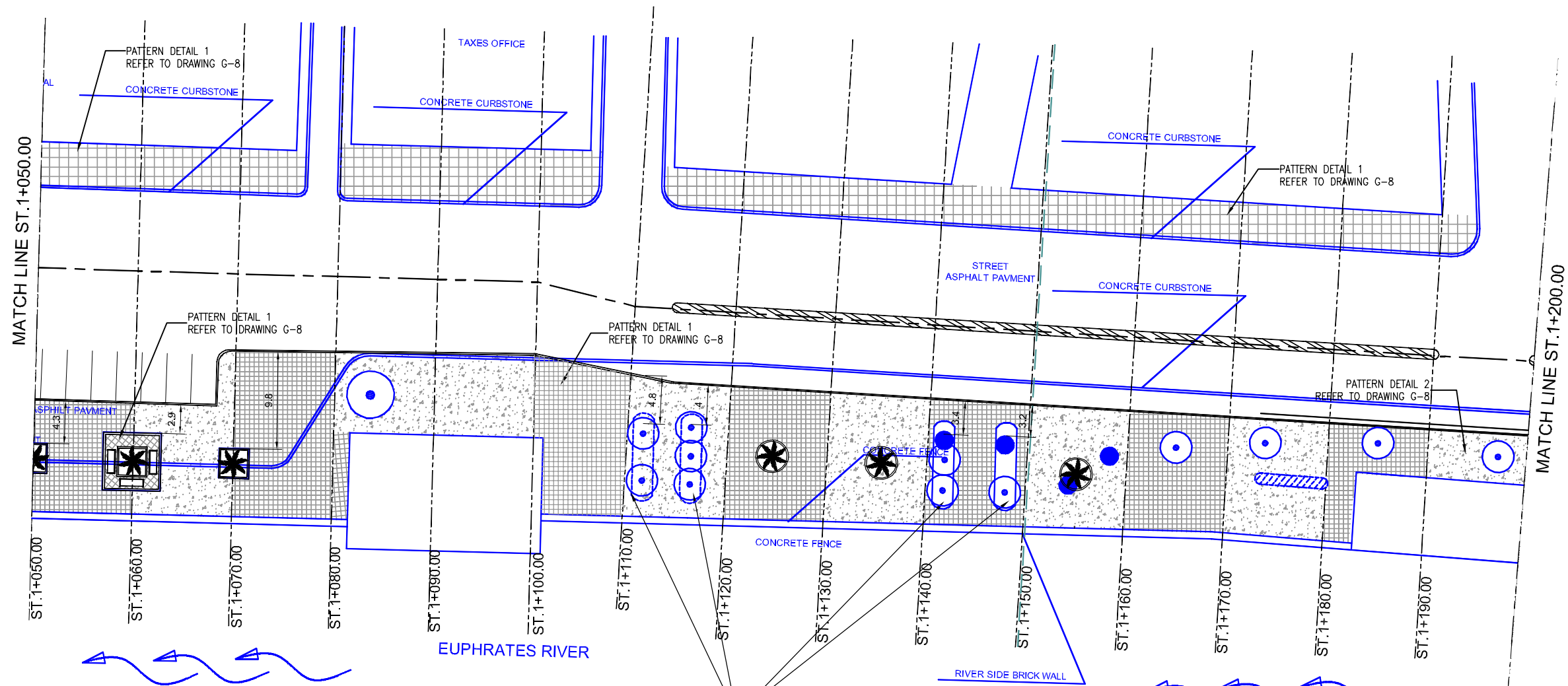

NOTE:
REMOVE EDGE OF EXISTING PLANTING
AREA FOR PAVEMENT

NOTE:
ALL THE EXISTING LAYOUTS ARE IN BLUE

C:\IPRAC\FROM APRIL 2005 WORKING DRAWINGS (11) G-1 SIDEWALK PLANTING & BENCH\G-1 SIDEWALK PLANTING & BENCH.DWG (6) May 11, 2005 10:01 PM

| | | | | | | |
|---|-------------|----------|---|-------------|----------|-------------|
| Owner: SAMAWAH MAYORALTY MUTHANNA GOVERNORATE REPUBLIC OF IRAQ | Consultant: | Client : | Project : | Drawing No. | Rev: | Drawn by : |
| | | | REHABILITATION AND IMPROVEMENT OF THE ROADS AND ROAD SIDES IN SAMAWAH FOR SAMAWAH PROMENADE DEVELOPMENT PLAN | G-5 | 0 | B.H. |
| | | | Dwg Title: | Scale | Date: | Checked by: |
| | | | SIDEWALK, PLANTING AND BENCH LAYOUT (5-6) | AS SHOWN | 8-5-2005 | M.J. |

* LEGEND OF EXISTING LANDSCAPING
(IN BLUE COLOR)

| | |
|--|----------------------------|
| | PLANTER BOX (VARIES SIZES) |
| | PLANTER BOX (5X5 M) |
| | BIG TREE |
| | SMALL TREE |

* LEGEND OF PROPOSED LANDSCAPING

| | |
|--|---|
| | PROPOSED PLANTER BOX (10X2 M) TOTAL NUMBER: 15 |
| | PROPOSED PLANTER BOX (3X3 M) TOTAL NUMBER: 21 |
| | PALM TREE TOTAL NUMBER: 37 |
| | BENCHES TOTAL NUMBER: 40 |

* LEGEND OF DEMOLISHED ITEMS
(IN BLUE COLOR)

| | |
|--|-------------------------------|
| | PLANTING BOX TO BE DEMOLISHED |
| | PLANTING BOX TO BE DEMOLISHED |
| | TREE TO BE CUT |

NOTE: BIG TREES TO BE TRIMMED AS PER SITE

| | |
|--|------------------------------------|
| | THIS SECTION TO BE CONCRETE PAVING |
| | RESIDENTIAL PAVEMENT |
| | PAVEMENT PATTERN DETAIL 1 |

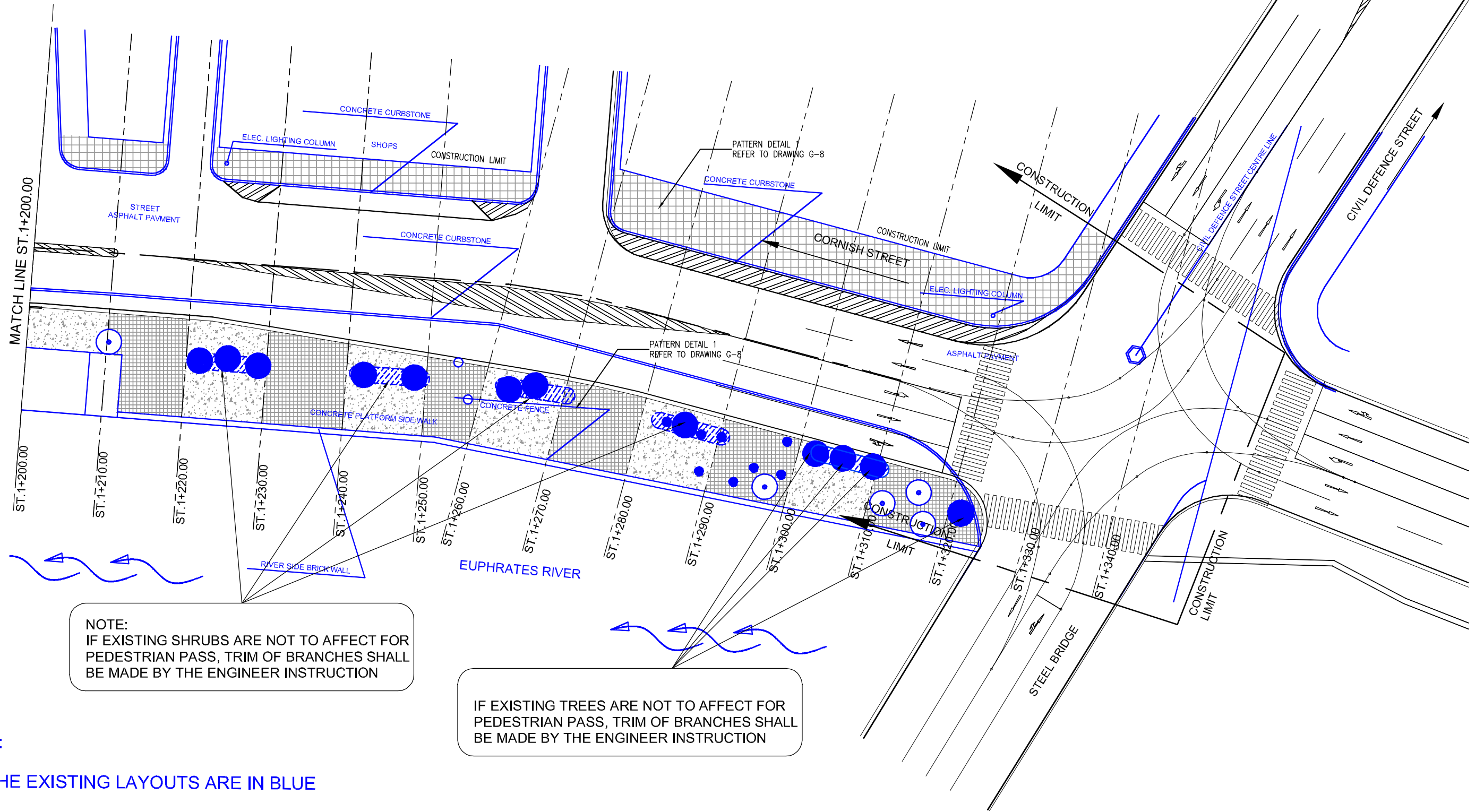

NOTE:
IF EXISTING SHRUBS ARE NOT TO AFFECT FOR PEDESTRIAN PASS, TRIM OF BRANCHES SHALL BE MADE BY THE ENGINEER INSTRUCTION

IF EXISTING TREES ARE NOT TO AFFECT FOR PEDESTRIAN PASS, TRIM OF BRANCHES SHALL BE MADE BY THE ENGINEER INSTRUCTION

NOTE:
ALL THE EXISTING LAYOUTS ARE IN BLUE

C:\PRAJ\FROM APRIL 2005\WORKING DRAWINGS\1(1)G-1 SIDEWALK PLANTING & BENCH\1(1)G-1 SIDEWALK PLANTING & BENCH.DWG (6) May 11, 2005-10:01 PM

| | | | | | | |
|---|-------------|----------|--|-------------|----------|-------------|
| Owner: SAMAWAH MAYORALTY MUTHANNA GOVERNORATE REPUBLIC OF IRAQ | Consultant: | Client : | Project : | Drawing No. | Rev: | Drawn by : |
| | | | REHABILITATION AND IMPROVEMENT OF THE ROADS AND ROAD SIDES IN SAMAWAH FOR SAMAWAH PROMENADE DEVELOPMENT PLAN | G-6 | 0 | B.H. |
| | | | Dwg Title: | Scale | Date: | Checked by: |
| | | | SIDEWALK, PLANTING AND BENCH LAYOUT (6-6) | AS SHOWN | 8-5-2005 | M.J. |

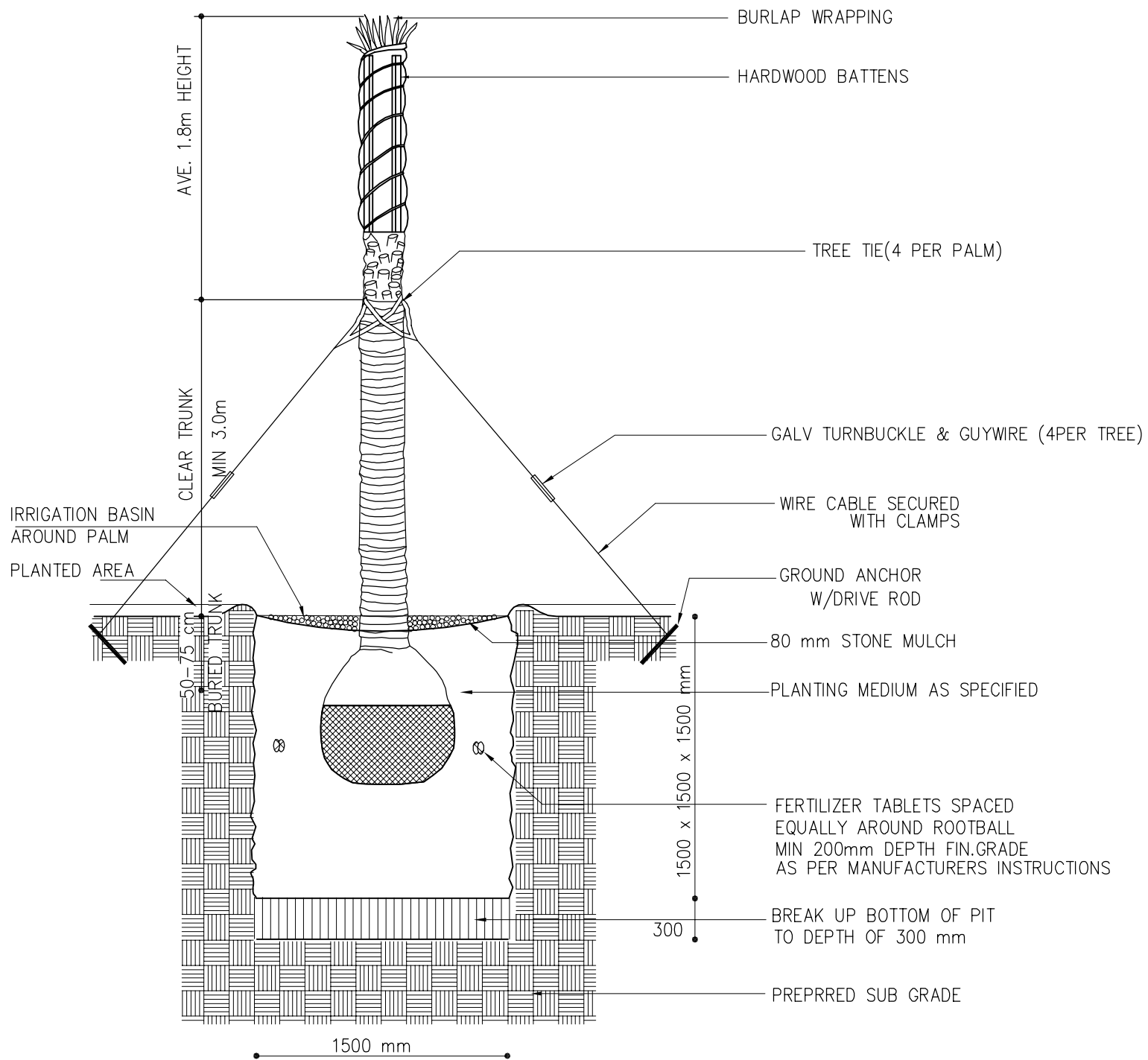

PALM PLANTING AND BRACING

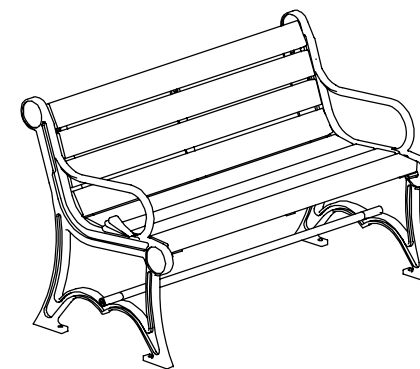
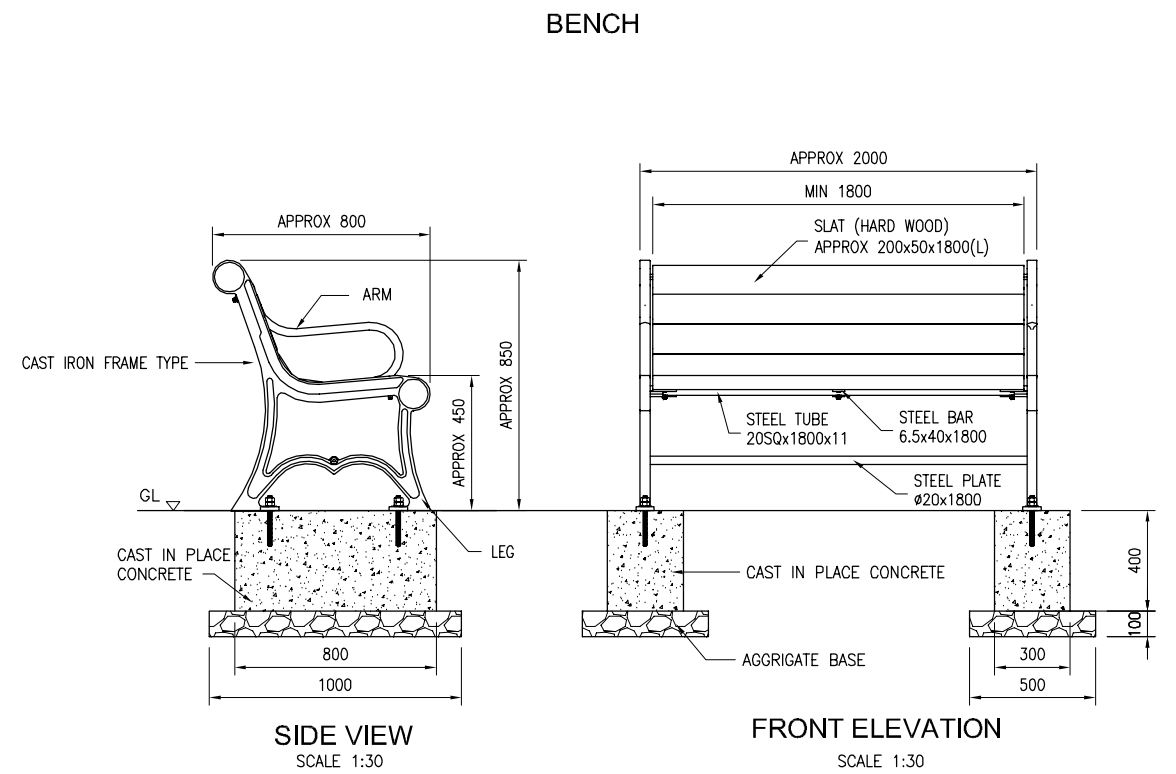

ISOMETRIC VIEW

NOTES:

1. INSTALLATION TO BE COMPLETED IN ACCORDANCE WITH MANUFACTURER'S SPECIFICATIONS.
2. DESIGN OF BENCH SHALL BE REFERENCE FOR SELECTION OF MANUFACTURED TYPE OF BENCH. THE CONTRACTOR SHALL SUBMIT SAMPLE OF PHOTOS OF BENCH TO THE ENGINEER FOR APPROVAL.

C:\I\BAG\FROM APRIL 2005\WORKING DRAWINGS\08B\G-07 BENCH AND PLANTING DETAILS.DWG G-10 May 12, 2005-11:27 AM

| | | | | | | |
|---|-------------|----------|--|--------------------|-------|-------------|
| Owner: SAMAWAH MAYORALTY MUTHANNA GOVERNORATE REPUBLIC OF IRAQ | Consultant: | Client : | Project : REHABILITATION AND IMPROVEMENT OF THE ROADS AND ROAD SIDES IN SAMAWAH FOR SAMAWAH PROMENADE DEVELOPMENT PLAN | Drawing No. G-7 | Rev: | Drawn by : |
| | | | Dwg Title: BENCH AND PLANTING DETAILS | Scale AS SHOWN | Date: | Checked by: |

PLANTING AREA EDGE CURB TYPICAL PLAN

SCALE 1:20

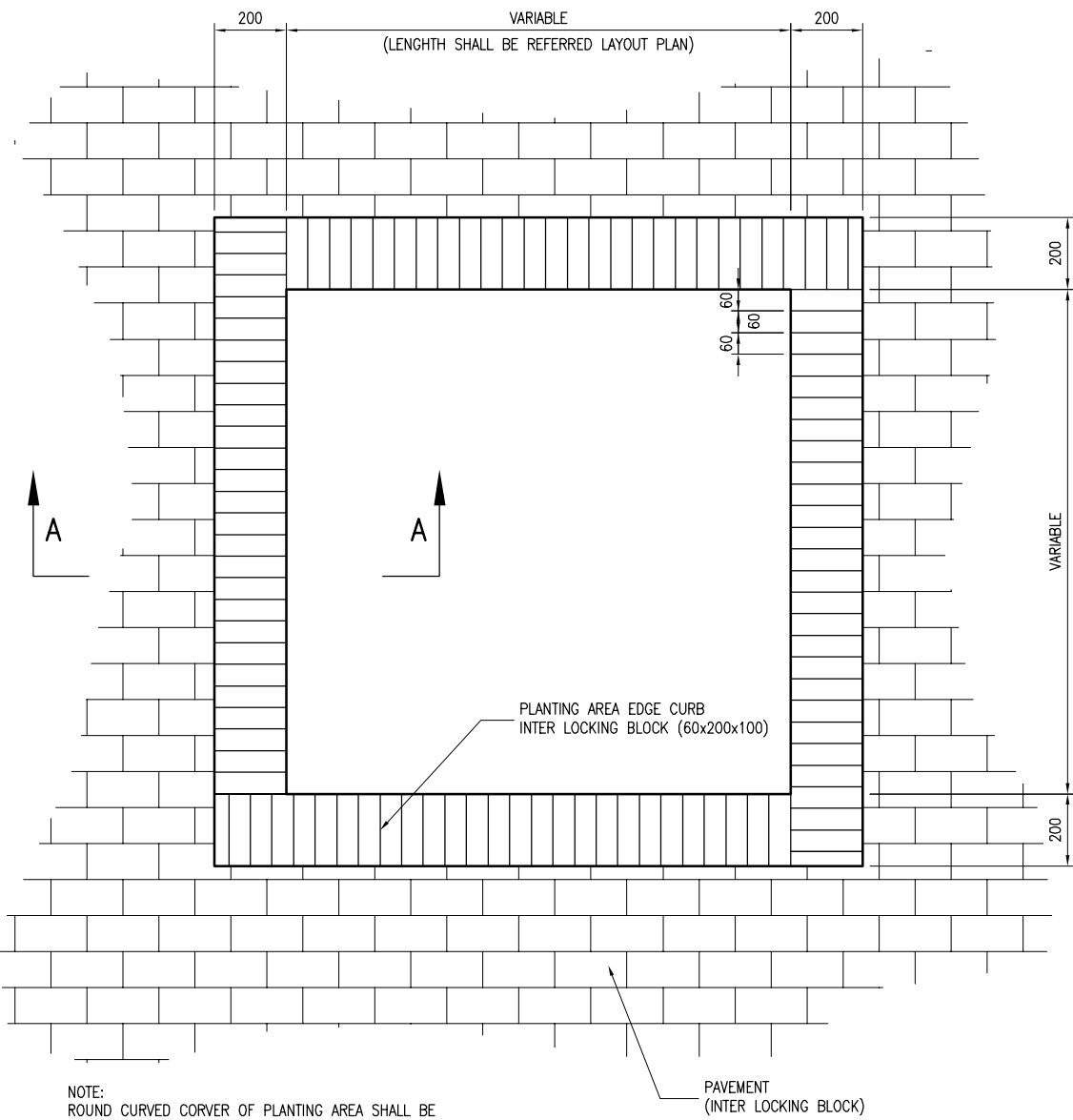

PATTERN DETAIL 1

SCALE 1:50

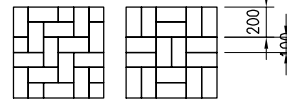

PATTERN DETAIL 2

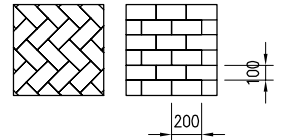

CONCRETE BLOCK DETAIL

SCALE 1:20

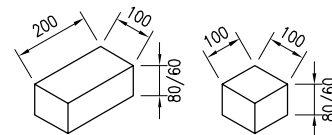

NOTE: THK 80 FOR DRIVE WAY WITHIN THE SIDE WALK

SECTION A-A

SCALE 1:20

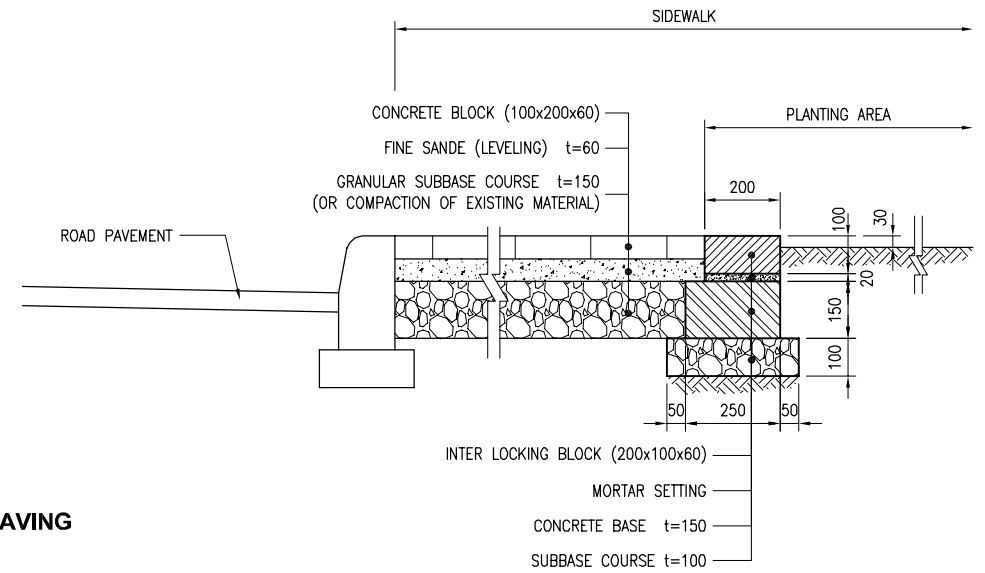

CONCRETE TILE PAVING

SCALE 1:10

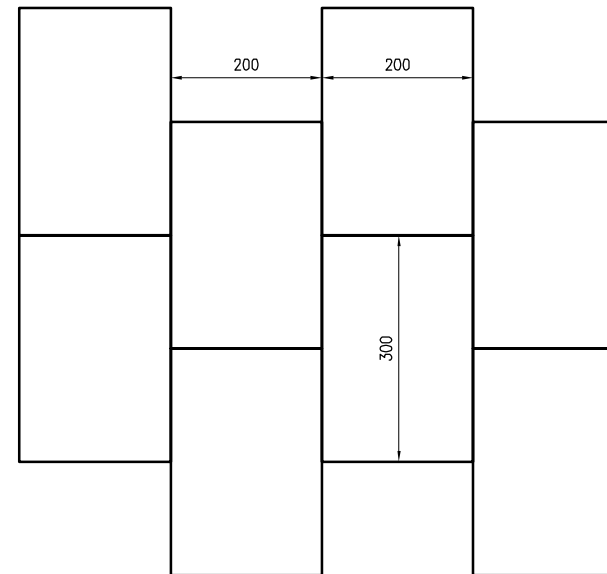

PLANTING SPACE DETAIL

SCALE 1:100

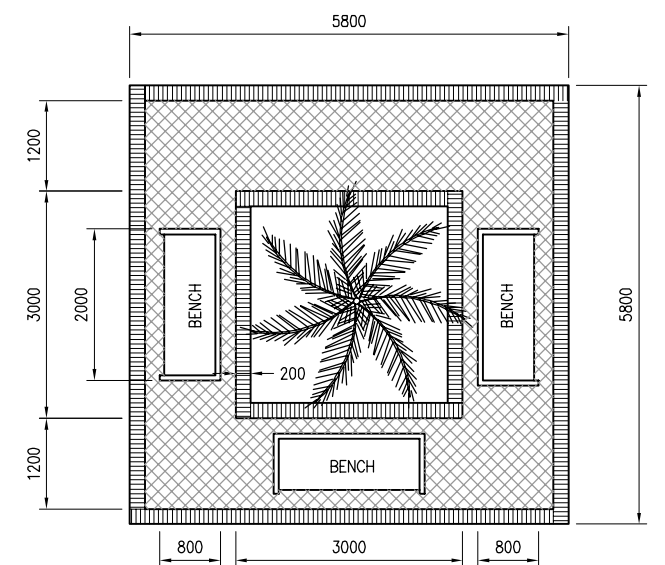

RIVER SIDE PAVEMENT

SCALE 1:10

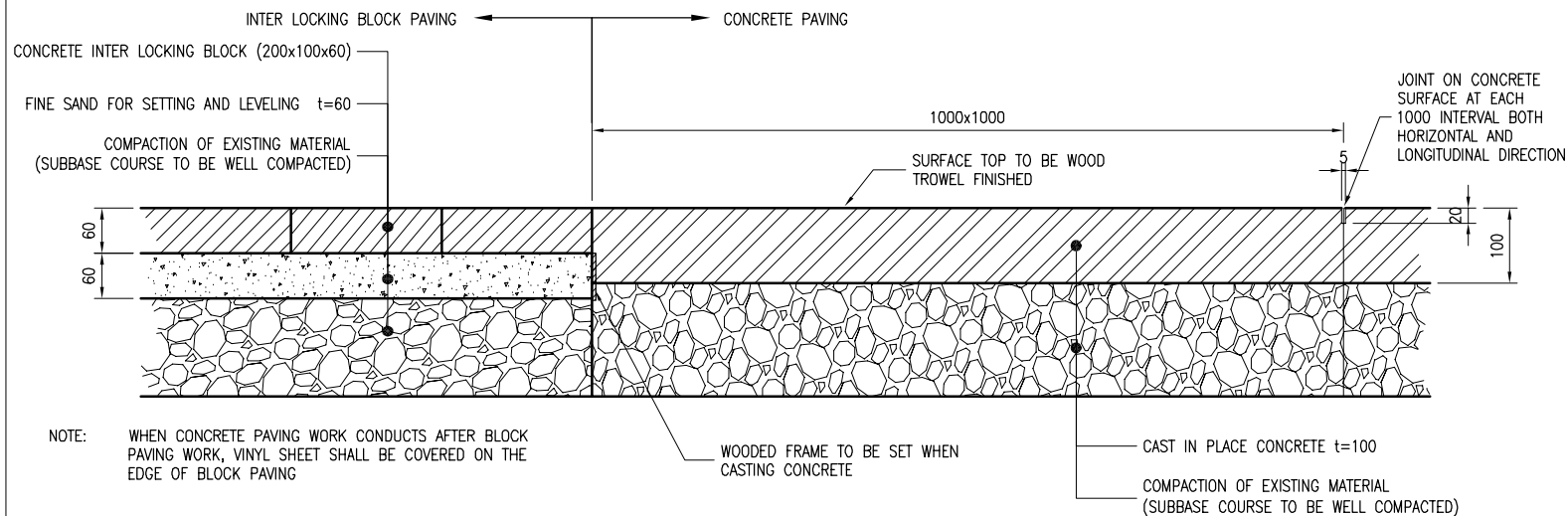

SECTION

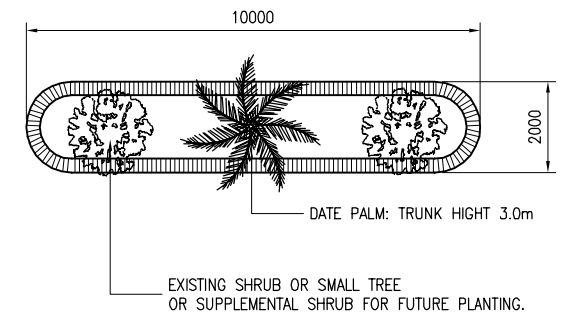
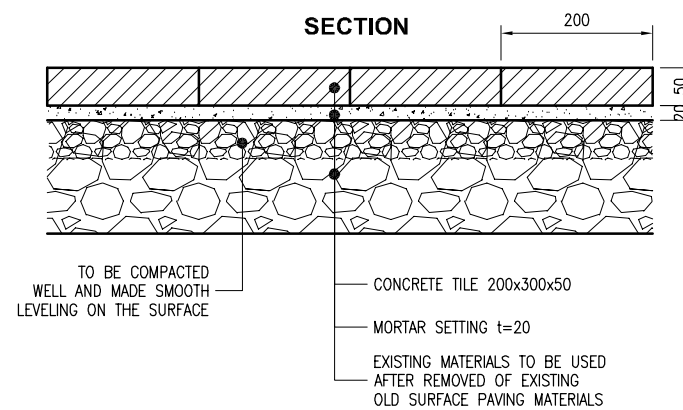

C:\IPRAG\FROM APRIL 2005 WORKING DRAWINGS (13) G-08 DETAIL OF SIDEWALK & PLANTING AREA.DWG G-11 May 11, 2005-9:22 PM

| | | | | | | |
|---|-------------|----------|---|---------------------------|-------|-------------|
| Owner: SAMAWAH MAYORALTY MUTHANNA GOVERNORATE REPUBLIC OF IRAQ | Consultant: | Client : | Project : REHABILITATION AND IMPROVEMENT OF THE ROADS AND ROAD SIDES IN SAMAWAH FOR SAMAWAH PROMENADE DEVELOPMENT PLAN | Drawing No. G-8 | Rev: | Drawn by : |
| | | | Dwg Title: DETAIL OF SIDEWALK AND PLANTING AREA | Scale AS SHOWN | Date: | Checked by: |

**DEPARTMENT OF BRIDGES AND ROADS
MUTHANNA GOVERNMENT
REPUBLIC OF IRAQ**

**THE PROJECTS FOR CONSTRUCTION AND IMPROVEMENT OF ROADS
AND BRIDGES IN SAMAWAH AND SUBURBAN AREA IN IRAQ**

SAMAWAH PROMENADE DEVELOPMENT PLAN

**DESIGN DRAWINGS
GIRLS SCHOOL STREET**

JUNE 2005



JAPAN INTERNATIONAL COOPERATION AGENCY



PACIFIC CONSULTANTS INTERNATIONAL

DRAWING LIST

| Drawing No. | Drawing Title | Remarks |
|---|--|--------------------|
| A. General | | |
| A-1 | Location Map & Site Plan | |
| B. Typical Cross Section and Pavement Detail | | |
| B-1 | Typical Cross Section | |
| C. Plan and Profile | | |
| C-1 | Plan and Profile (1/6) | STA. 0+00 - 0+150 |
| C-2 | Plan and Profile (2/6) | STA. 0+150 - 0+300 |
| C-3 | Plan and Profile (3/6) | STA. 0+300 - 0+450 |
| C-4 | Plan and Profile (4/6) | STA. 0+450 - 0+600 |
| C-5 | Plan and Profile (5/6) | STA. 0+600 - 0+750 |
| C-6 | Plan and Profile (6/6) | STA. 0+750 - 0+850 |
| D. Drainage | | |
| D-1 | Drainage System Plan (1/6) | STA. 0+00 - 0+150 |
| D-2 | Drainage System Plan (2/6) | STA. 0+150 - 0+300 |
| D-3 | Drainage System Plan (3/6) | STA. 0+300 - 0+450 |
| D-4 | Drainage System Plan (4/6) | STA. 0+450 - 0+600 |
| D-5 | Drainage System Plan (5/6) | STA. 0+600 - 0+750 |
| D-6 | Drainage System Plan (6/6) | STA. 0+750 - 0+850 |
| D-7 | Detail of inlet, Manhole and Backfilling Methods of Pipe Excavations | |
| E. Details | | |
| E-1 | Road Marking Details | |
| E-2 | Cross Section (1/3) | |
| E-3 | Cross Section (2/3) | |
| E-4 | Cross Section (3/3) | |

| Drawing No. | Drawing Title | Remarks |
|--|---|--------------------|
| F. Street Lighting | | |
| F-1 | Street Lighting Layout (1/6) | STA. 0+00 - 0+150 |
| F-2 | Street Lighting Layout (2/6) | STA. 0+150 - 0+300 |
| F-3 | Street Lighting Layout (3/6) | STA. 0+300 - 0+450 |
| F-4 | Street Lighting Layout (4/6) | STA. 0+450 - 0+600 |
| F-5 | Street Lighting Layout (5/6) | STA. 0+600 - 0+750 |
| F-6 | Street Lighting Layout (6/6) | STA. 0+750 - 0+850 |
| F-7 | Distribution Panels (1/2) | |
| F-8 | Distribution Panels (2/2) | |
| F-9 | Manhole, Foundation, Distribution Board Details for Street Lighting | |
| F-10 | Lighting Poles Details | |
| G. Sidewalk, Planting and Bench | | |
| G-1 | Sidewalk, Planting and Bench Layout (1/6) | STA. 0+00 - 0+150 |
| G-2 | Sidewalk, Planting and Bench Layout (2/6) | STA. 0+150 - 0+300 |
| G-3 | Sidewalk, Planting and Bench Layout (3/6) | STA. 0+300 - 0+450 |
| G-4 | Sidewalk, Planting and Bench Layout (4/6) | STA. 0+450 - 0+600 |
| G-5 | Sidewalk, Planting and Bench Layout (5/6) | STA. 0+600 - 0+750 |
| G-6 | Sidewalk, Planting and Bench Layout (6/6) | STA. 0+750 - 0+850 |
| G-7 | Planting and Pavement Details | |

H:\SAMAWAH\JUNE 18, 2005\GIRLS SCHOOL ROAD\00B\DRAWING LIST.DWG (0-0) Jun 18, 2005-3:37 PM

| | | | | | | |
|--|--------------------|-----------------|---|--------------------|--------------|--------------------|
| Owner: SAMAWAH MAYORALTY MUTHANNA GOVERNORATE REPUBLIC OF IRAQ | Consultant: | Client : | Project : REHABILITATION AND IMPROVEMENT OF THE ROADS AND ROAD SIDES IN SAMAWAH FOR SAMAWAH PROMENADE DEVELOPMENT PLAN | Drawing No. | Rev: | Drawn by : |
| | | | Dwg Title: DRAWING LIST FOR THE GIRLS SCHOOL STREET | Scale | Date: | Checked by: |