

- NOTES:**
- GTS BENCH MARK ON YAMUNA BRIDGE LOCATED ON STONE AT EAST END OF 9th PIER FROM SOUTH OF YAMUNA BRIDGE 292.075 Ft. (89.024 m.)
 - ALL LEVELS ARE IN METERS
- LEGEND**
- PROPOSED SEWER LINE
 - PROPOSED RISING MAIN
 - ROAD EDGE
 - UNDERGROUND LINES
 - CULVERT/BRIDGE
 - HANDPUMP
 - ELECTRIC POLE
 - ELECTRIC LINE
 - TELEPHONE POLE
 - TELEPHONE LINE
 - TRANSFORMER
 - OFC PILLAR
 - KILOMETER POST
 - TREE
 - HECTOMETER POST
 - LAMP POST
 - RAILWAY LINE
 - NALA
 - WATER MAIN
 - EXISTING SEWER
 - TRENCHLESS TECHNOLOGY
 - NALA CROSSING
 - RAILWAY LINE CROSSING
- PIPE DETAILS:**
- PIPE ID
LENGTH-DIA
MATERIAL
SLOPE
- REFERENCE DRAWING:**

INST.					
ELEC.					
MECH.					
STRU.					
CIVIL					
REV NO.	0	1	2	3	4

REV.	DESCRIPTION OF REVISIONS	DATE	CHECKED
CHECKED BY: A.Bhatnagar		APPROVED BY: D.Sarkar	
DRAWN: M.Pahuja		SCALE: H=1:1000, V=1:100	
DESIGNED: R.Mittal		DATE: 15-12-2004	
SURVEYED: S.Sharma			

JICA JAPAN INTERNATIONAL COOPERATION AGENCY

CONSULTANTS:

 TOKYO ENGINEERING CONSULTANTS CO., LTD.
 CTI ENGINEERING INTERNATIONAL CO., LTD.
 STUP CONSULTANTS LTD.

PROJECT:
 THE STUDY ON
 WATER QUALITY MANAGEMENT PLAN
 FOR GANGA RIVER IN THE REPUBLIC OF INDIA
 FEASIBILITY STUDY FOR ALLAHABAD CITY

CORRIDOR: District : D
 Muir Road To Stanley Road
 Node : 3 to 4

SHEET CONTENTS: PLAN AND PROFILE (1/4)
 (Proposed Sewer Line)
 (Ch. 00 - 600)

DRAWING NO.	SHT. NO.
ALD-SE-D (MR-SR)-1	31

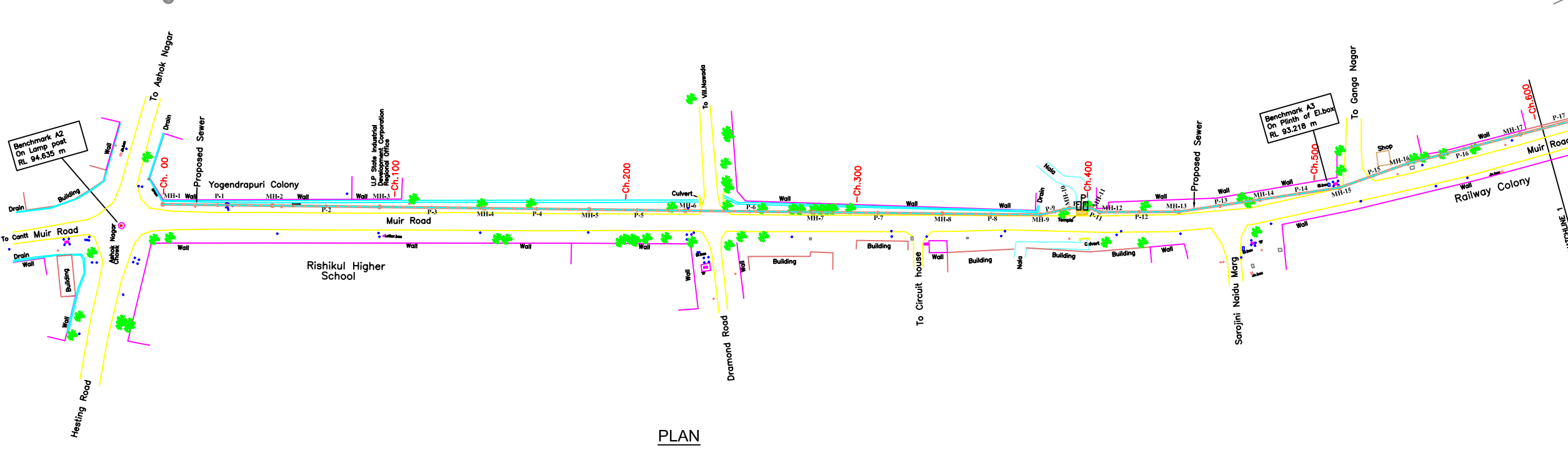

GROUND LEVEL (M)	COVERING (M)	INVERT LEVEL (M)	CHAINAGE (M)
93.925	2.581	90.844	0.0
94.368 94.63	3.363	90.777 90.725	47.0 50.0
94.257 94.196	3.149	90.659 90.608	93.0 100.0
93.856 93.685	2.864	90.543 90.492	138.0 150.0
93.535 93.459	2.802	90.428 90.233	183.0 200.0
93.197 92.935	2.931	90.173 89.766	225.0 250.0
92.718 92.664	2.907	89.686 89.311	281.0 300.0
92.263 92.122	2.826	89.231 88.937	337.0 350.0
91.900 91.907 91.910 91.912	2.539 2.575 2.596 2.642	88.875 88.861 88.842 88.832 88.819 88.814 88.809 88.770	380.0 393.0 402.0 406.0
92.469 92.56	3.288 3.661	88.721 88.681	440.0 450.0
92.752 92.944 92.958	3.661 3.953	88.631 88.591 88.541 88.505	475.0 500.0 510.0
93.070 93.096	4.168	88.459 88.402	542.0 550.0
93.184 93.184	4.410	88.330 88.274	592.0 600.0

L-SECTION



- NOTES:**
- GTS BENCH MARK ON YAMUNA BRIDGE LOCATED ON STONE AT EAST END OF 9th PIER FROM SOUTH OF YAMUNA BRIDGE 292.075 Ft. (89.024 m.)
 - ALL LEVELS ARE IN METERS

- LEGEND**
- PROPOSED SEWER LINE
 - PROPOSED RISING MAIN
 - ROAD EDGE
 - UNDERGROUND LINES
 - CULVERT/BRIDGE
 - HANDPUMP
 - ELECTRIC POLE
 - ELECTRIC LINE
 - TELEPHONE POLE
 - TELEPHONE LINE
 - TRANSFORMER
 - OFC PILLAR
 - KILOMETER POST
 - TREE
 - HECTOMETER POST
 - LAMP POST
 - RAILWAY LINE
 - NALA
 - WATER MAIN
 - EXISTING SEWER
 - TRENCHLESS TECHNOLOGY
 - NALA CROSSING
 - RAILWAY LINE CROSSING

- PIPE DETAILS:**
- PIPE ID
LENGTH-DIA
MATERIAL
SLOPE

REFERENCE DRAWING:

INST.					
ELEC.					
MECH.					
STRU.					
CIVIL					
REV NO.	0	1	2	3	4

REV.	DESCRIPTION OF REVISIONS	DATE	CHECKED

CHECKED BY: A.Bhatnagar	APPROVED BY: D.Sarkar
DRAWN M.Pahuja	APPROVE
DESIGNED R.Mittal	SCALE H=1:1000 V=1:100
SURVEYED S.Sharma	DATE 15-12-2004

JICA JAPAN INTERNATIONAL COOPERATION AGENCY

CONSULTANTS:

 TOKYO ENGINEERING CONSULTANTS CO., LTD.
 CTI ENGINEERING INTERNATIONAL CO., LTD.

 STUP CONSULTANTS LTD.

PROJECT:
 THE STUDY ON WATER QUALITY MANAGEMENT PLAN FOR GANGA RIVER IN THE REPUBLIC OF INDIA
 FEASIBILITY STUDY FOR ALLAHABAD CITY

CORRIDOR: District : D
 Muir Road To Stanley Road
 Node : 3 to 4

SHEET CONTENTS: PLAN AND PROFILE (2/4)
 (Proposed Sewer Line)
 (Ch. 600 - 1200)

DRAWING NO. ALD-SE-D (MR-SR)-2	SHT. NO. 32
-----------------------------------	----------------

TO NODE-3 ← 3D (500Ø) → TO NODE-4

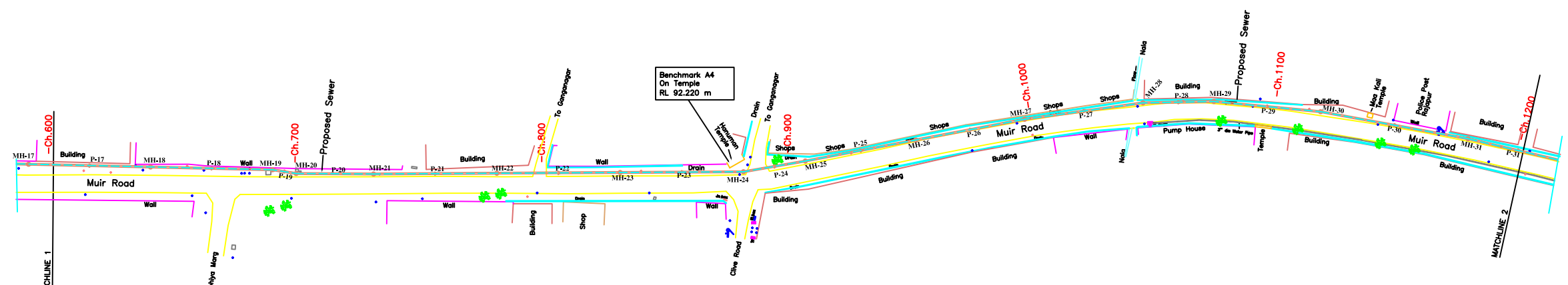

PLAN

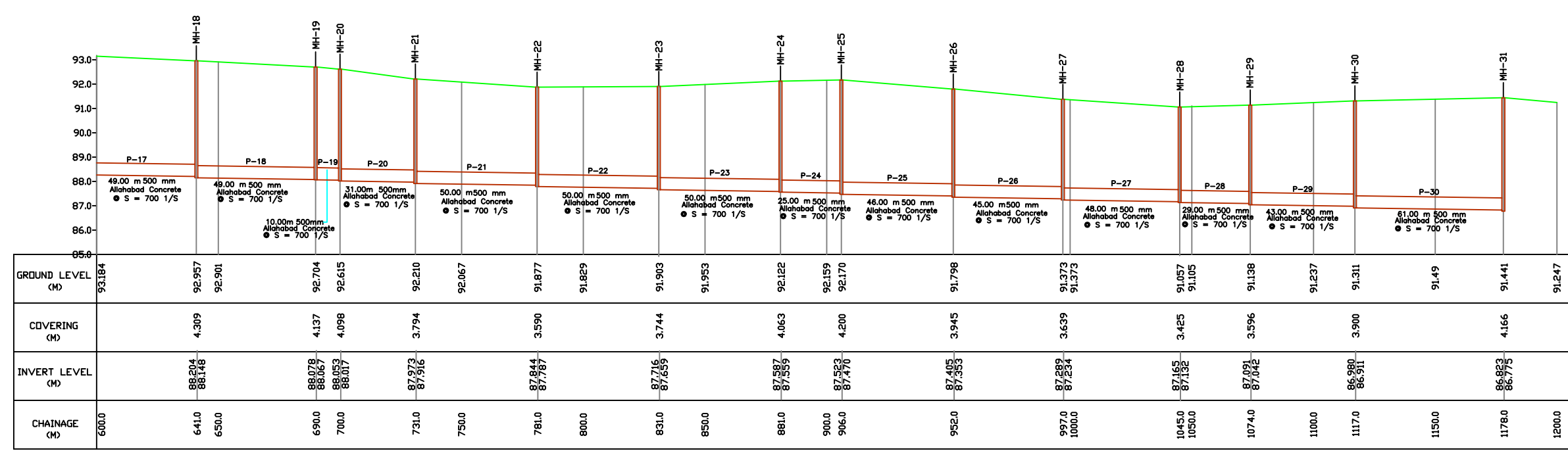

L-SECTION

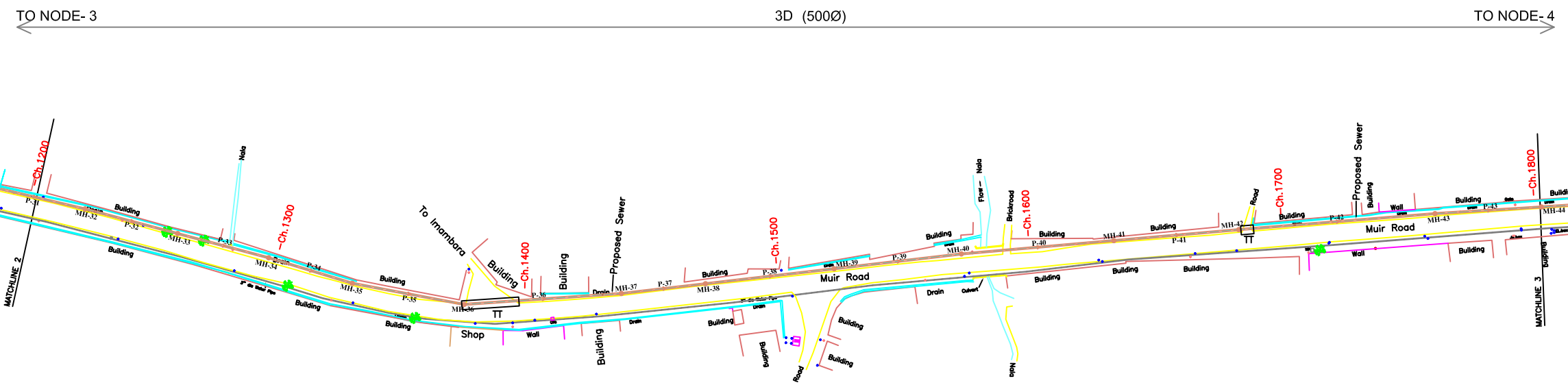

PLAN

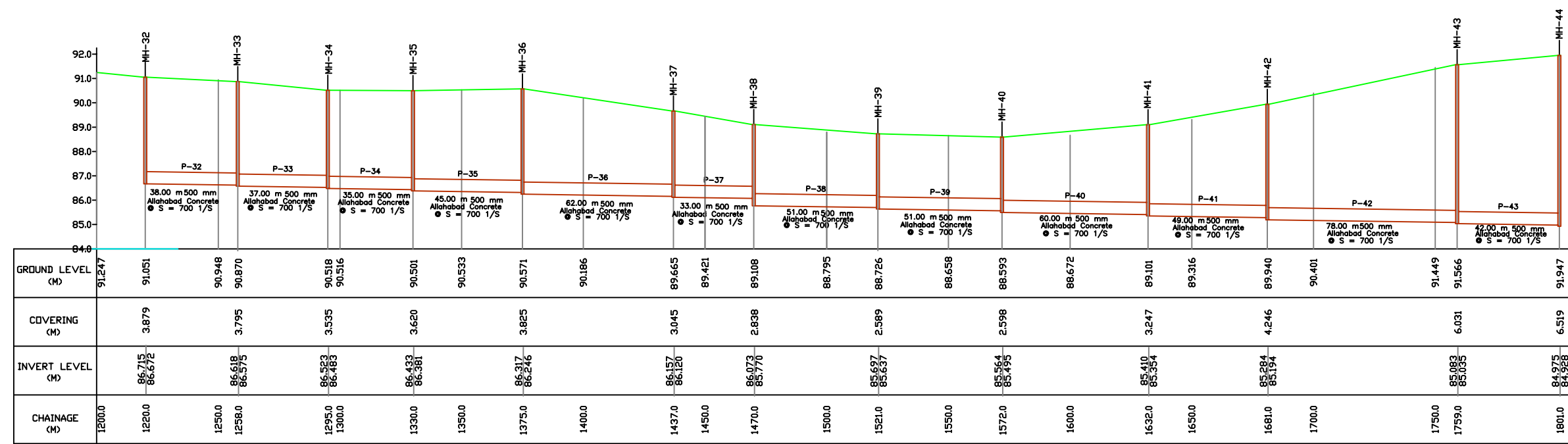

L-SECTION

- NOTES:**
- GTS BENCH MARK ON YAMUNA BRIDGE LOCATED ON STONE AT EAST END OF 9th PIER FROM SOUTH OF YAMUNA BRIDGE 292.075 Ft. (89.024 m.)
 - ALL LEVELS ARE IN METERS
- LEGEND**
- PROPOSED SEWER LINE
 - PROPOSED RISING MAIN
 - ROAD EDGE
 - UNDERGROUND LINES
 - CULVERT/BRIDGE
 - HANDPUMP
 - ELECTRIC POLE
 - ELECTRIC LINE
 - TELEPHONE POLE
 - TELEPHONE LINE
 - TRANSFORMER
 - OFC PILLAR
 - KILOMETER POST
 - TREE
 - HECTOMETER POST
 - LAMP POST
 - RAILWAY LINE
 - NALA
 - WATER MAIN
 - EXISTING SEWER
 - TRENCHLESS TECHNOLOGY
 - NALA CROSSING
 - RAILWAY LINE CROSSING
- PIPE DETAILS:**
- PIPE ID
LENGTH-DIA
MATERIAL
SLOPE
- REFERENCE DRAWING:**

INST.					
ELEC.					
MECH.					
STRU.					
CIVIL					
REV NO.	0	1	2	3	4
REV.					
DESCRIPTION OF REVISIONS					
DATE					
CHECKED BY:	A.Bhatnagar		APPROVED BY:		
CHECK			D.Sarkar		
DRAWN	M.Pahuja		APPROVE		
DESIGNED	R.Mittal		SCALE		
SURVEYED	S.Sharma		DATE		
			15-12-2004		

JICA JAPAN INTERNATIONAL COOPERATION AGENCY

CONSULTANTS:

PROJECT:
 THE STUDY ON WATER QUALITY MANAGEMENT PLAN FOR GANGA RIVER IN THE REPUBLIC OF INDIA
 FEASIBILITY STUDY FOR ALLAHABAD CITY

CORRIDOR: District : D
 Muir Road To Stanley Road
 Node : 3 to 4

SHEET CONTENTS: PLAN AND PROFILE (3/4)
 (Proposed Sewer Line)
 (Ch. 1200 - 1800)

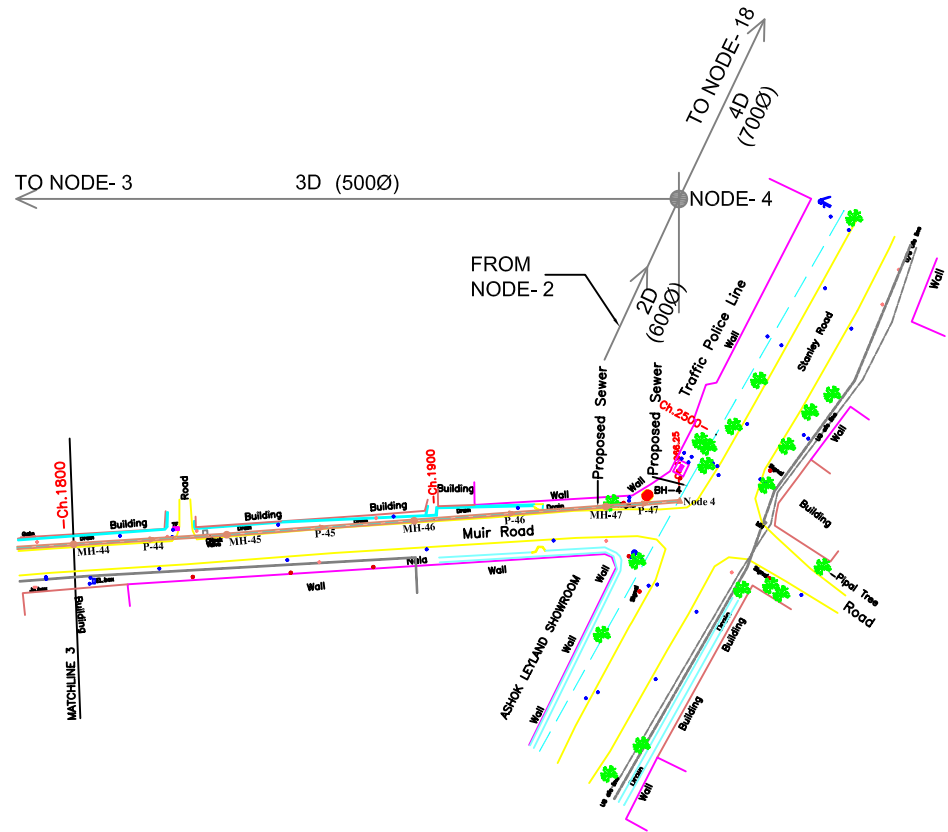

PLAN

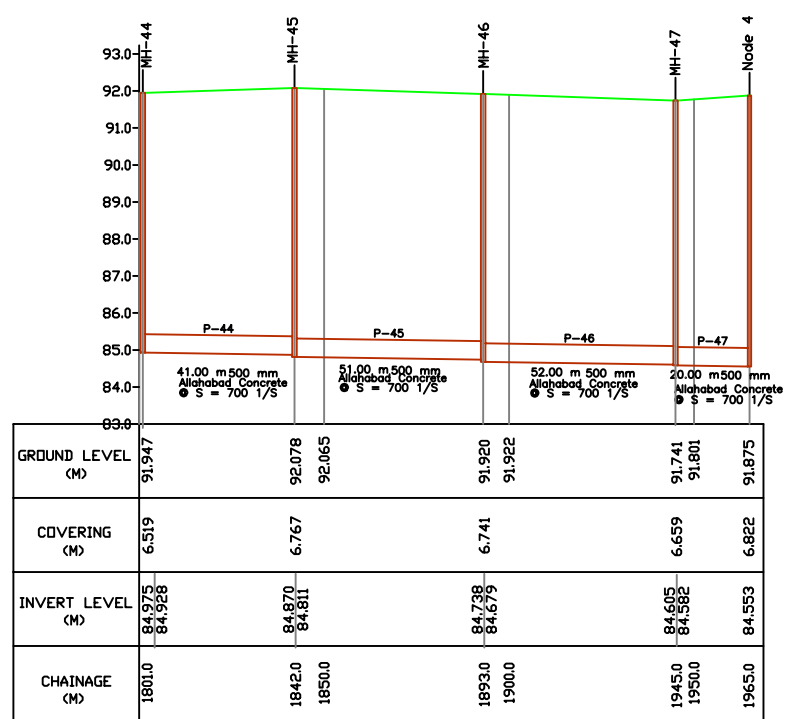

L-SECTION



- NOTES:**
- GTS BENCH MARK ON YAMUNA BRIDGE LOCATED ON STONE AT EAST END OF 9th PIER FROM SOUTH OF YAMUNA BRIDGE 292.075 Ft. (89.024 m.)
 - ALL LEVELS ARE IN METERS
- LEGEND**
- PROPOSED SEWER LINE
 - PROPOSED RISING MAIN
 - ROAD EDGE
 - UNDERGROUND LINES
 - CULVERT/BRIDGE
 - HANDPUMP
 - ELECTRIC POLE
 - ELECTRIC LINE
 - TELEPHONE POLE
 - TELEPHONE LINE
 - TRANSFORMER
 - OFC PILLAR
 - KILOMETER POST
 - TREE
 - HECTOMETER POST
 - LAMP POST
 - RAILWAY LINE
 - NALA
 - WATER MAIN
 - EXISTING SEWER
 - TRENCHLESS TECHNOLOGY
 - NALA CROSSING
 - RAILWAY LINE CROSSING
- PIPE DETAILS:**
- PIPE ID
LENGTH-DIA
MATERIAL
SLOPE
- REFERENCE DRAWING:**

INST.					
ELEC.					
MECH.					
STRU.					
CIVIL					
REV NO.	0	1	2	3	4

REV.	DESCRIPTION OF REVISIONS	DATE	CHECKED

CHECKED BY: A.Bhatnagar
CHECKED: M.Pahuja
APPROVED BY: D.Sarkar
APPROVE

DESIGNED: R.Mittal
SCALE: H=1:1000, V=1:100
SURVEYED: S.Sharma
DATE: 15-12-2004

JICA JAPAN INTERNATIONAL COOPERATION AGENCY

CONSULTANTS:

PROJECT:
 THE STUDY ON
 WATER QUALITY MANAGEMENT PLAN
 FOR GANGA RIVER IN THE REPUBLIC OF INDIA
 FEASIBILITY STUDY FOR ALLAHABAD CITY

CORRIDOR: District : D
 Muir Road To Stanley Road
 Node : 3 to 4

SHEET CONTENTS: PLAN AND PROFILE (4/4)
 (Proposed Sewer Line)
 (Ch. 1800 - 1966.25)

DRAWING NO. ALD-SE-D (MR-SR)-4
SHT. NO. 34

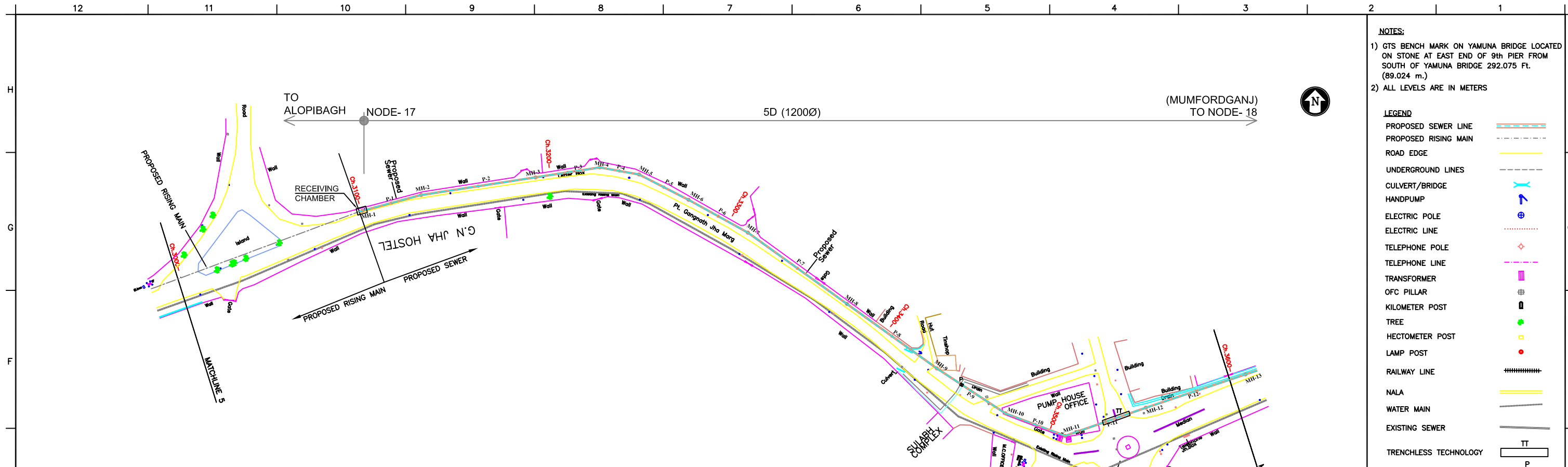

PLAN

- NOTES:**
- GTS BENCH MARK ON YAMUNA BRIDGE LOCATED ON STONE AT EAST END OF 9th PIER FROM SOUTH OF YAMUNA BRIDGE 292.075 Ft. (89.024 m.)
 - ALL LEVELS ARE IN METERS
- LEGEND**
- PROPOSED SEWER LINE
 - PROPOSED RISING MAIN
 - ROAD EDGE
 - UNDERGROUND LINES
 - CULVERT/BRIDGE
 - HANDPUMP
 - ELECTRIC POLE
 - ELECTRIC LINE
 - TELEPHONE POLE
 - TELEPHONE LINE
 - TRANSFORMER
 - OFC PILLAR
 - KILOMETER POST
 - TREE
 - HECTOMETER POST
 - LAMP POST
 - RAILWAY LINE
 - NALA
 - WATER MAIN
 - EXISTING SEWER
 - TRENCHLESS TECHNOLOGY
 - NALA CROSSING
 - RAILWAY LINE CROSSING
- PIPE DETAILS:**
- PIPE ID
 - LENGTH-DIA
 - MATERIAL
 - SLOPE
- REFERENCE DRAWING:**

INST.					
ELEC.					
MECH.					
STRU.					
CIVIL					
REV NO.	0	1	2	3	4
REV.					
DESCRIPTION OF REVISIONS					
DATE					
CHECKED BY:	A.Bhatnagar		APPROVED BY:		
CHECK			D.Sarkar		
DRAWN	M.Pahuja		APPROVE		
DESIGNED	R.Mittal		SCALE		
SURVEYED	S.Sharma		DATE		
			15-12-2004		

JICA JAPAN INTERNATIONAL COOPERATION AGENCY

CONSULTANTS:

- TOKYO ENGINEERING CONSULTANTS CO., LTD.
- CTI ENGINEERING INTERNATIONAL CO., LTD.
- STUP CONSULTANTS LTD.

PROJECT:
THE STUDY ON WATER QUALITY MANAGEMENT PLAN FOR GANGA RIVER IN THE REPUBLIC OF INDIA
FEASIBILITY STUDY FOR ALLAHABAD CITY

CORRIDOR: District : D
Alopiabag PS to Mumfordganj PS
Node : APS-11-8-17-MPS

SHEET CONTENTS:
PLAN AND PROFILE (1/3)
(Proposed Sewer Line)
(Ch. 3100 - 3600)

DRAWING NO.	SHT. NO.
ALD-SE-D (APS-MPS)-1	35

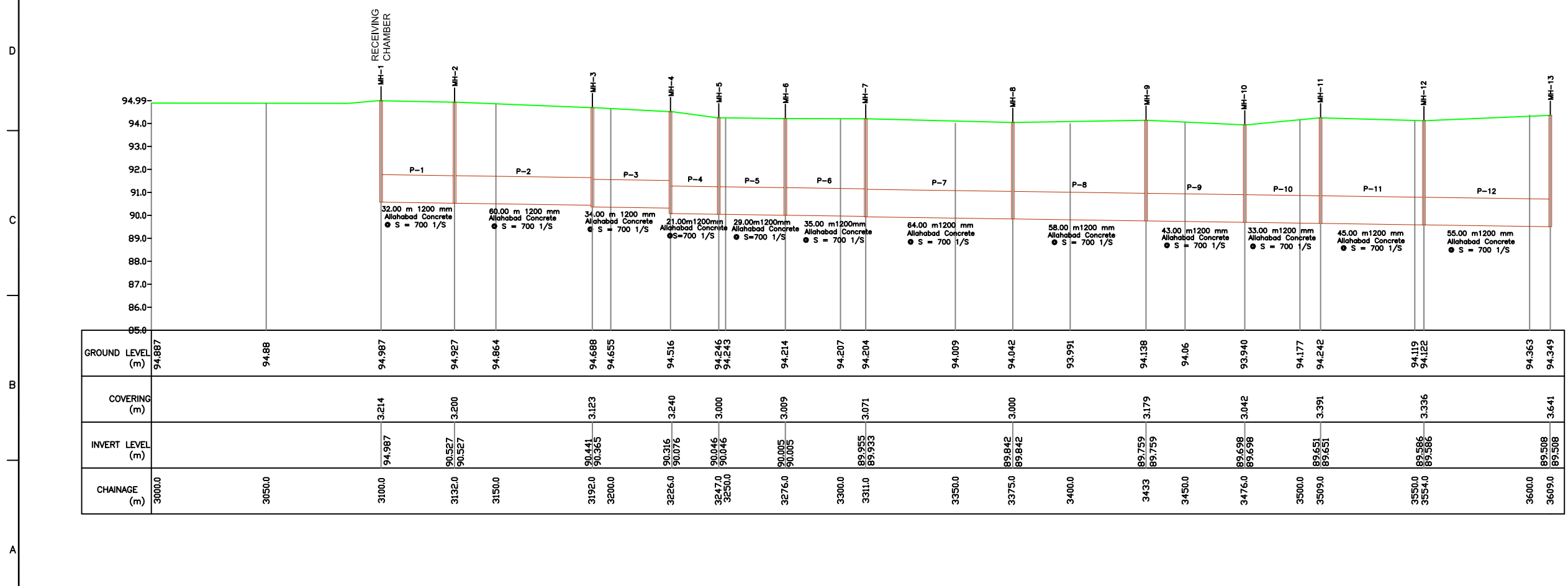

L-SECTION

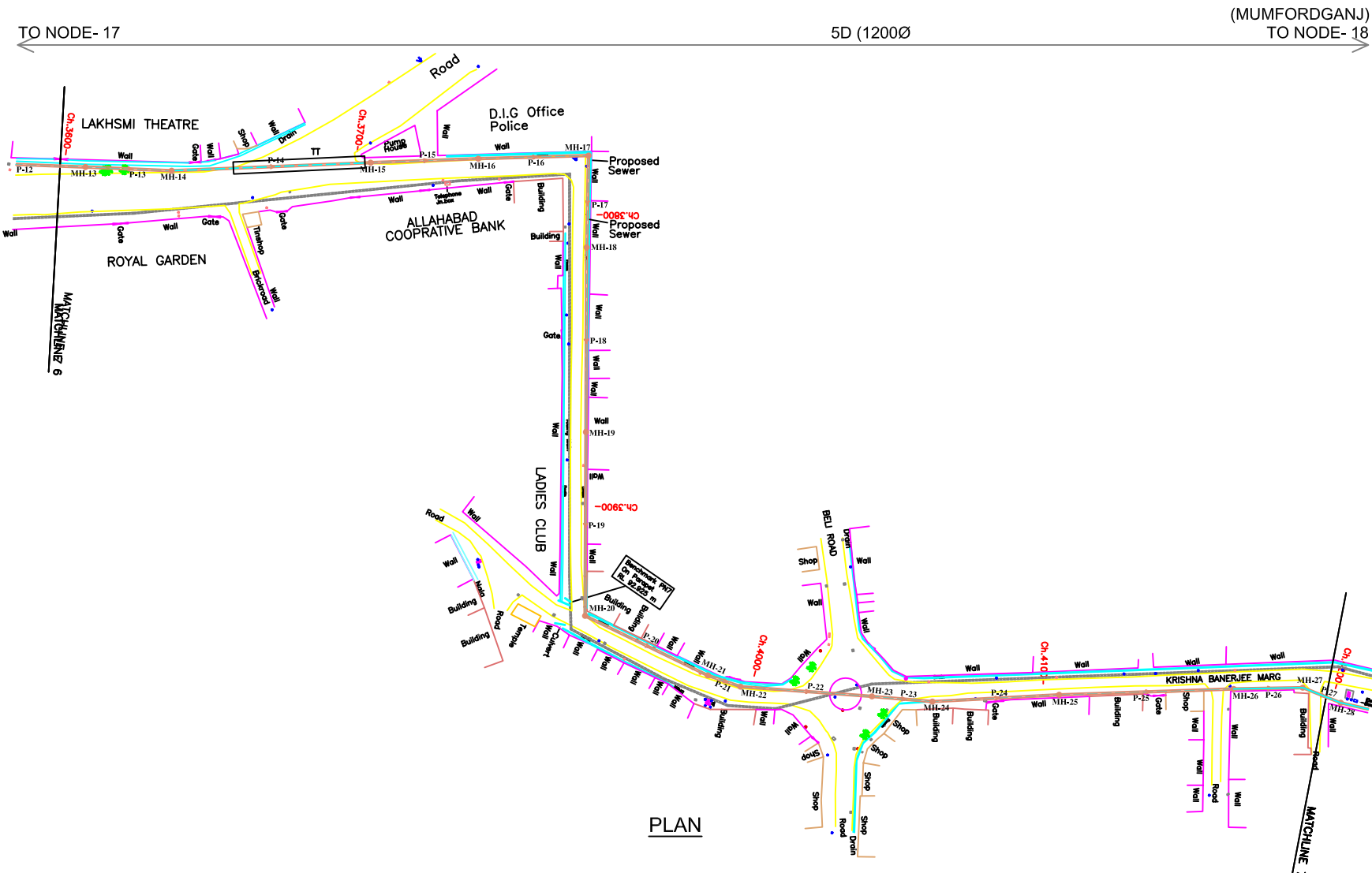

PLAN

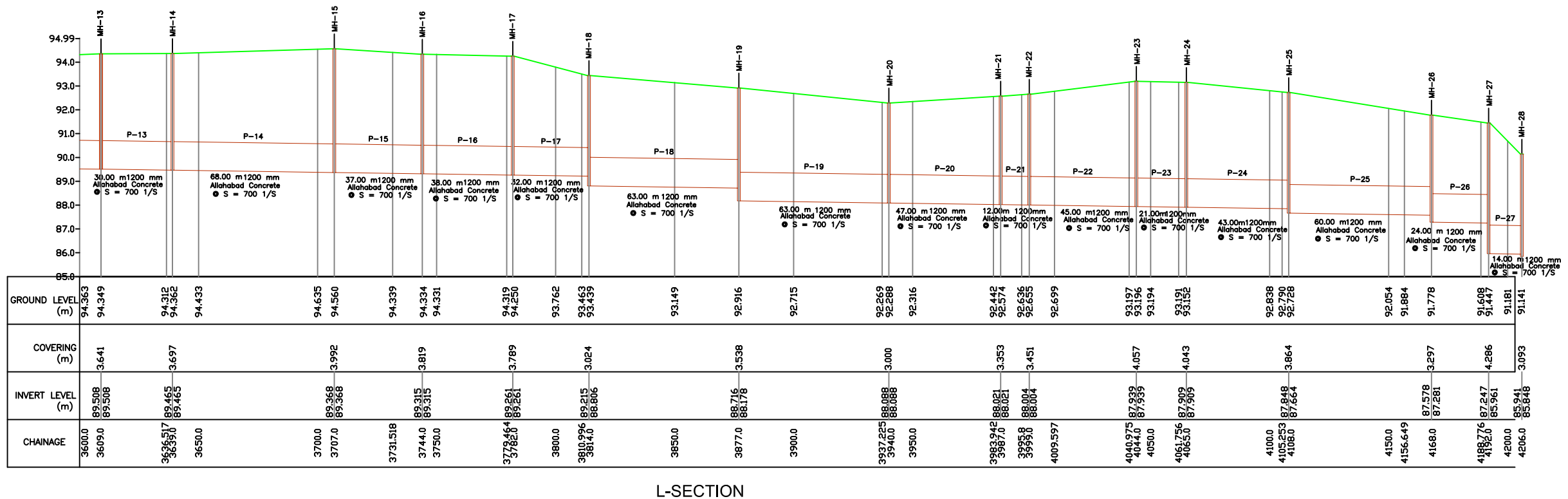

L-SECTION

- NOTES:**
- GTS BENCH MARK ON YAMUNA BRIDGE LOCATED ON STONE AT EAST END OF 9th PIER FROM SOUTH OF YAMUNA BRIDGE 292.075 Ft. (89.024 m.)
 - ALL LEVELS ARE IN METERS
- LEGEND**
- PROPOSED SEWER LINE
 - PROPOSED RISING MAIN
 - ROAD EDGE
 - UNDERGROUND LINES
 - CULVERT/BRIDGE
 - HANDPUMP
 - ELECTRIC POLE
 - ELECTRIC LINE
 - TELEPHONE POLE
 - TELEPHONE LINE
 - TRANSFORMER
 - OFC PILLAR
 - KILOMETER POST
 - TREE
 - HECTOMETER POST
 - LAMP POST
 - RAILWAY LINE
 - NALA
 - WATER MAIN
 - EXISTING SEWER
 - TRENCHLESS TECHNOLOGY
 - NALA CROSSING
 - RAILWAY LINE CROSSING
- PIPE DETAILS:**
- PIPE ID
 - LENGTH-DIA
 - MATERIAL
 - SLOPE
- REFERENCE DRAWING:**

INST.					
ELEC.					
MECH.					
STRU.					
CIVIL					
REV NO.	0	1	2	3	4
REV.					
DESCRIPTION OF REVISIONS					
DATE					
CHECKED BY:	A.Bhatnagar		APPROVED BY:		
CHECK			D.Sarkar		
DRAWN	M.Pahuja		APPROVE		
DESIGNED	R.Mittal		SCALE		
SURVEYED	S.Sharma		DATE		
			15-12-2004		

JICA JAPAN INTERNATIONAL COOPERATION AGENCY

CONSULTANTS:

- TOKYO ENGINEERING CONSULTANTS CO., LTD.
- CTI ENGINEERING INTERNATIONAL CO., LTD.
- STUP CONSULTANTS LTD.

PROJECT:
 THE STUDY ON WATER QUALITY MANAGEMENT PLAN FOR GANGA RIVER IN THE REPUBLIC OF INDIA
 FEASIBILITY STUDY FOR ALLAHABAD CITY

CORRIDOR: District : D
 Alopibag PS to Mumfordganj PS
 Node : APS-11-8-17-MPS

SHEET CONTENTS:
 PLAN AND PROFILE (2/3)
 (Proposed Sewer Line)
 (Ch. 3600 - 4200)

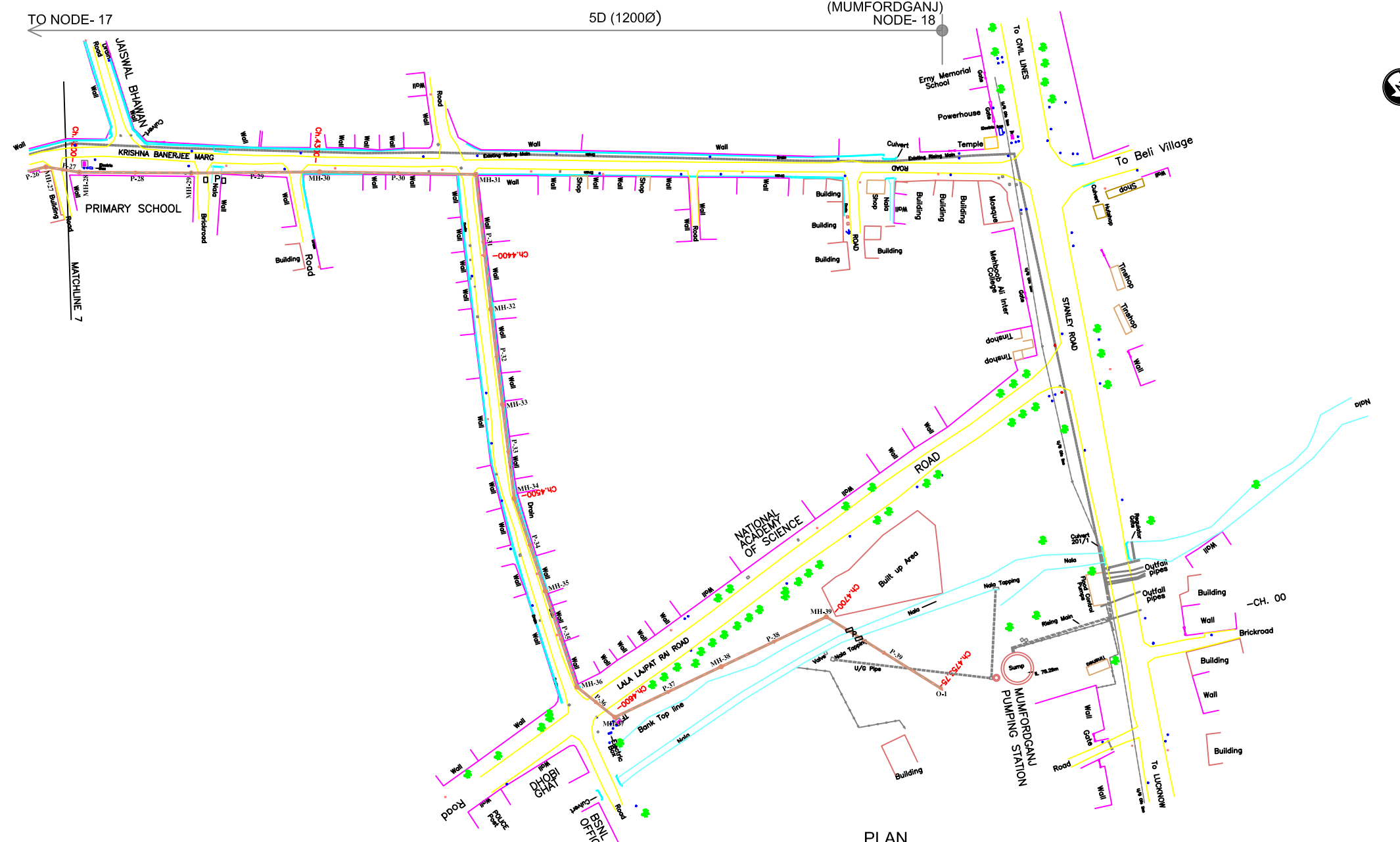

PLAN

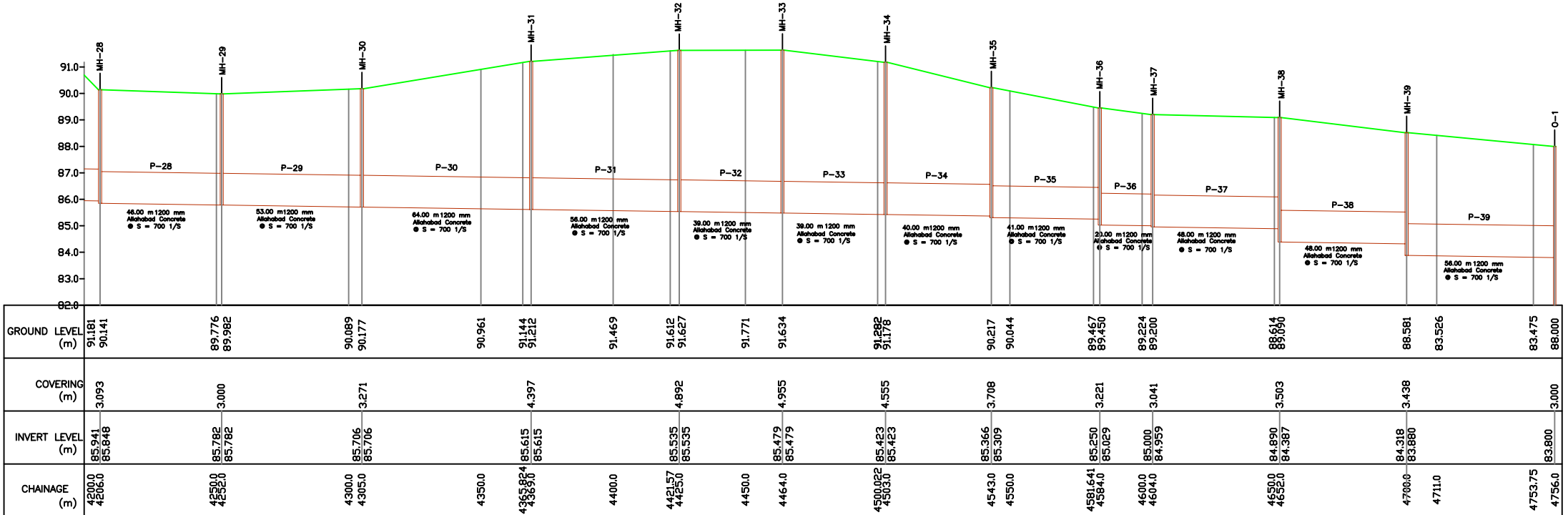

L-SECTION

- NOTES:**
- GTS BENCH MARK ON YAMUNA BRIDGE LOCATED ON STONE AT EAST END OF 9th PIER FROM SOUTH OF YAMUNA BRIDGE 292.075 Ft. (89.024 m.)
 - ALL LEVELS ARE IN METERS

LEGEND

- PROPOSED SEWER LINE
- PROPOSED RISING MAIN
- ROAD EDGE
- UNDERGROUND LINES
- CULVERT/BRIDGE
- HANDPUMP
- ELECTRIC POLE
- ELECTRIC LINE
- TELEPHONE POLE
- TELEPHONE LINE
- TRANSFORMER
- OFC PILLAR
- KILOMETER POST
- TREE
- HECTOMETER POST
- LAMP POST
- RAILWAY LINE
- NALA
- WATER MAIN
- EXISTING SEWER
- TRENCHLESS TECHNOLOGY
- NALA CROSSING
- RAILWAY LINE CROSSING

PIPE DETAILS:

PIPE ID
LENGTH-DIA
MATERIAL
SLOPE

REFERENCE DRAWING:

REV. NO.	0	1	2	3	4

REV.	DESCRIPTION OF REVISIONS	DATE	CHECKED

JICA JAPAN INTERNATIONAL COOPERATION AGENCY
 CONSULTANTS:
 TOKYO ENGINEERING CONSULTANTS CO., LTD.
 CTI ENGINEERING INTERNATIONAL CO., LTD.
 STUP CONSULTANTS LTD.

PROJECT:
 THE STUDY ON WATER QUALITY MANAGEMENT PLAN FOR GANGA RIVER IN THE REPUBLIC OF INDIA
 FEASIBILITY STUDY FOR ALLAHABAD CITY
CORRIDOR: District : D
 Alopibag PS to Mumfordganj PS
 Node : APS-11-8-17-MPS
SHEET CONTENTS:
 PLAN AND PROFILE (3/3)
 (Proposed Sewer Line)
 (Ch. 4200 - 4753.75)

DRAWING NO. ALD-SE-D (APS-MPS)-3
SHT. NO. 37

H
G
F
E
D
C
B
A

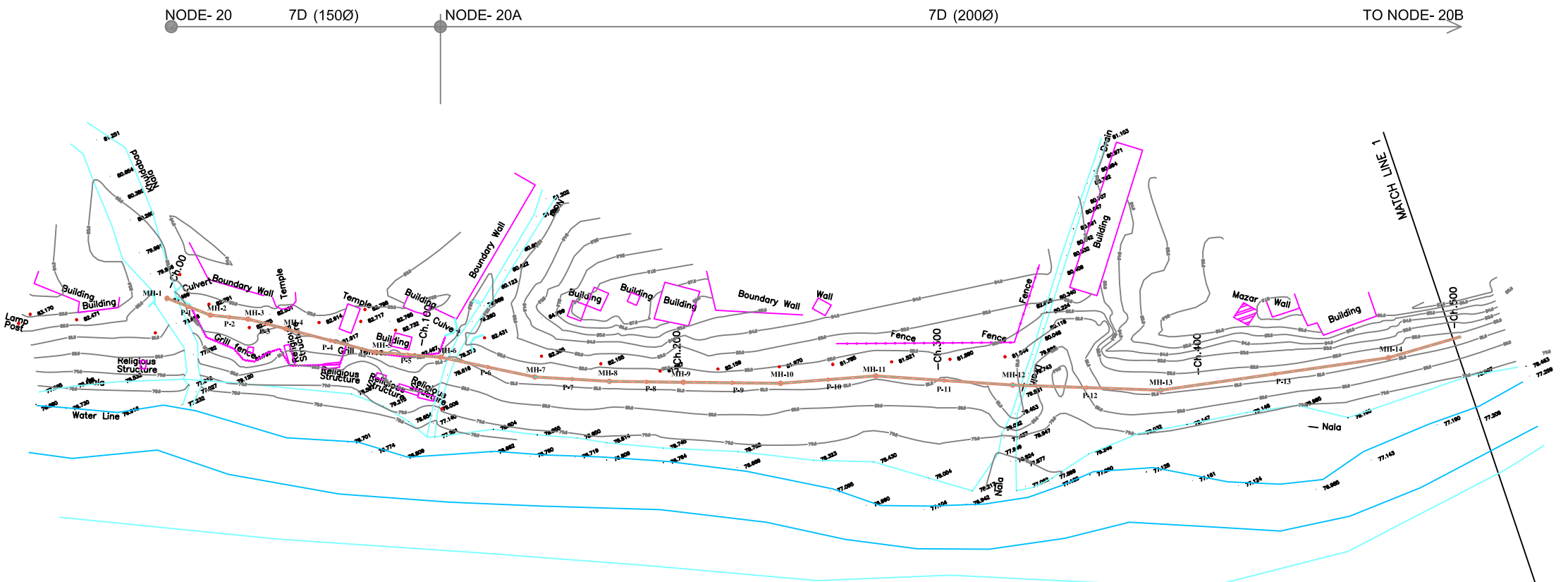

NOTES:

- GTS BENCH MARK ON YAMUNA BRIDGE LOCATED ON STONE AT EAST END OF 9th PIER FROM SOUTH OF YAMUNA BRIDGE 292.075 Ft. (89.024 m.)
- ALL LEVELS ARE IN METERS

LEGEND

- PROPOSED SEWER LINE
- PROPOSED RISING MAIN
- ROAD EDGE
- UNDERGROUND LINES
- CULVERT/BRIDGE
- HANDPUMP
- ELECTRIC POLE
- ELECTRIC LINE
- TELEPHONE POLE
- TELEPHONE LINE
- TRANSFORMER
- OFC PILLAR
- KILOMETER POST
- TREE
- HECTOMETER POST
- LAMP POST
- RAILWAY LINE
- NALA
- WATER MAIN
- EXISTING SEWER
- TRENCHLESS TECHNOLOGY
- NALA CROSSING
- RAILWAY LINE CROSSING

PIPE DETAILS:

PIPE ID
LENGTH-DIA
MATERIAL
SLOPE

REFERENCE DRAWING:

INST.				
ELEC.				
MECH.				
STRU.				
CIVL.				
REV NO.	0	1	2	3

REV.	DESCRIPTION OF REVISIONS	DATE	CHECKED

CHECKED BY:	A.Bhatnagar	APPROVED BY:	D.Sarkar
	CHECK		APPROVE
DRAWN	Surendra	DESIGNED	R.Mittal
			SCALE
SURVEYED	S.Sharma		DATE

JICA JAPAN INTERNATIONAL COOPERATION AGENCY

CONSULTANTS:

PROJECT:
 THE STUDY ON WATER QUALITY MANAGEMENT PLAN FOR GANGA RIVER IN THE REPUBLIC OF INDIA
 FEASIBILITY STUDY FOR ALLAHABAD CITY

CORRIDOR: District : D
 NALA INTERCEPTING AT RAJAPUR STP

SHEET CONTENTS:
 PLAN AND PROFILE (1/3)
 (Proposed Intercepting Sewer Line)
 (Ch. 00 - 525)

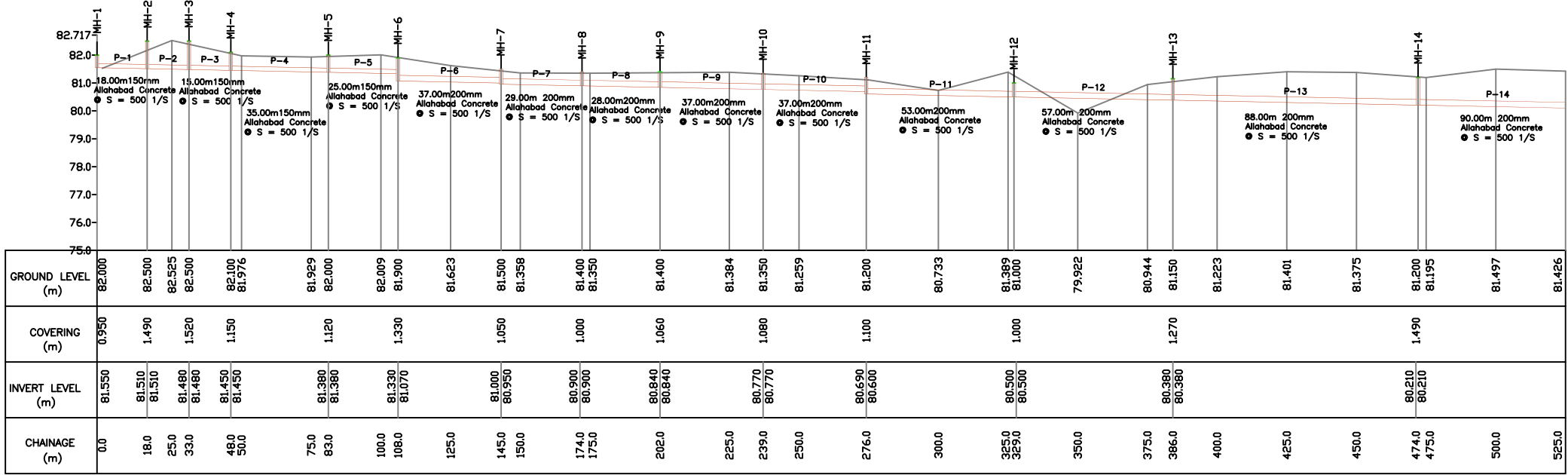

TO NODE- 20A 7D (200Ø) NODE- 20B 7D (500Ø) TO NODE- 20C

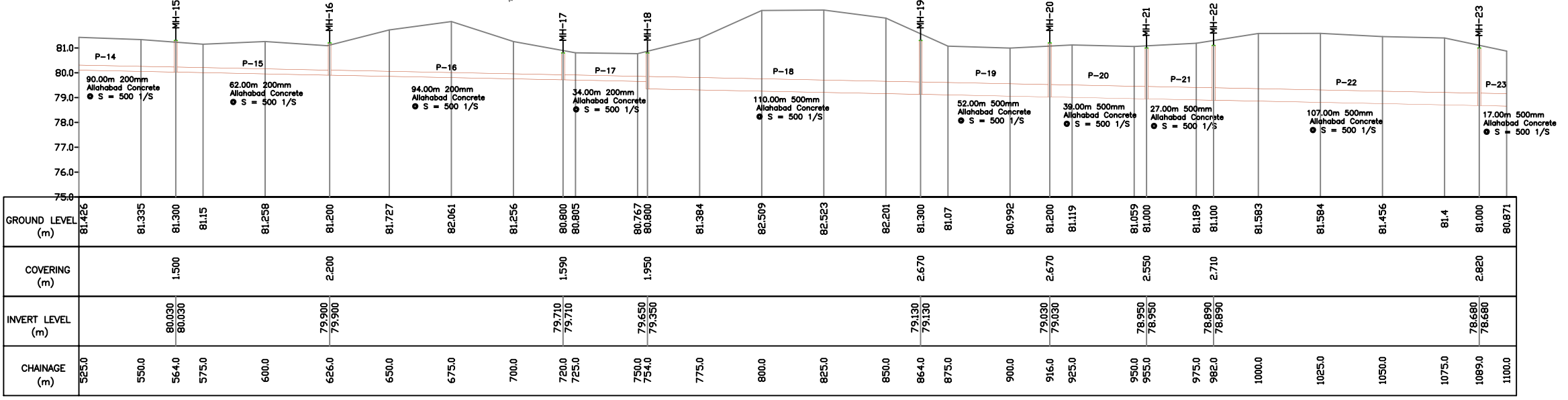
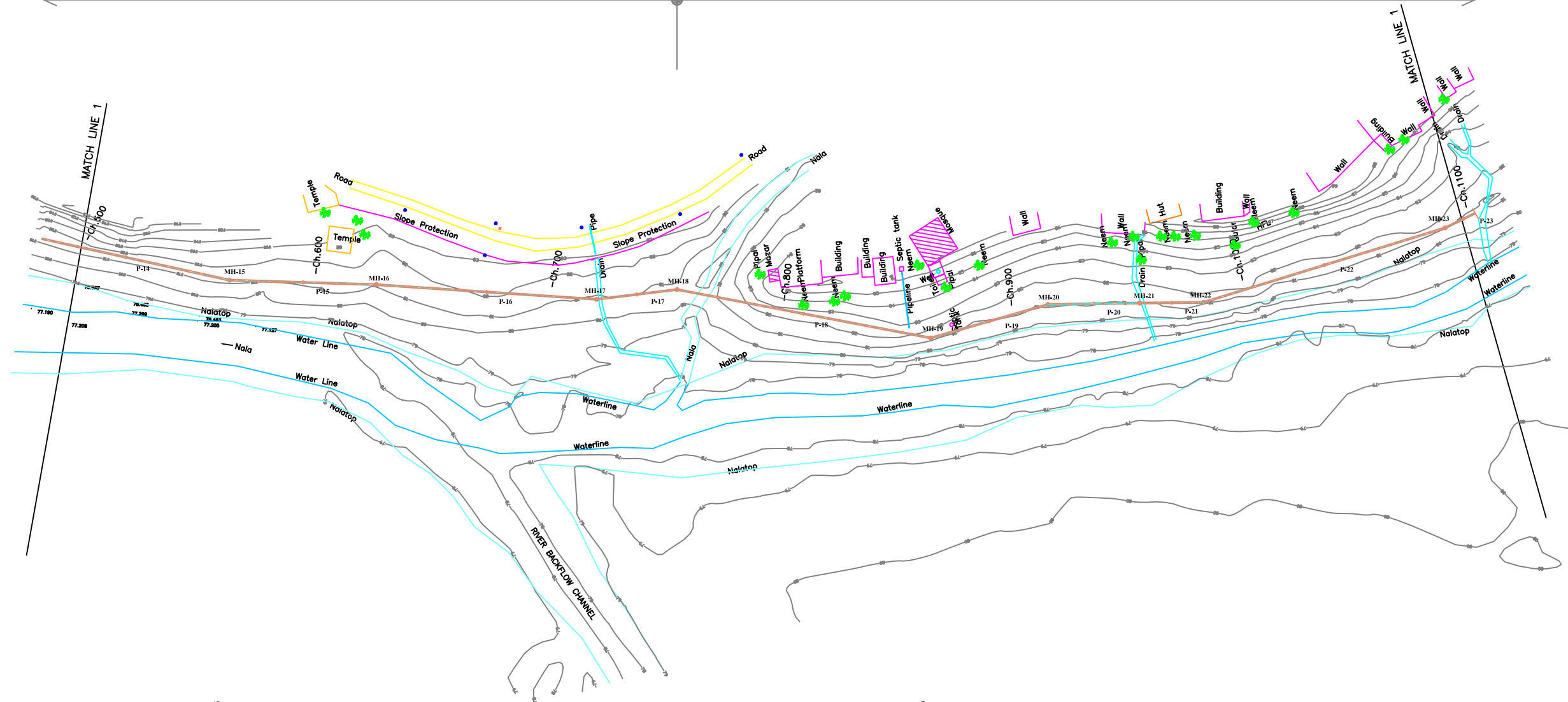

CHAINAGE (m)	GROUND LEVEL (m)	COVERING (m)	INVERT LEVEL (m)
5250	81.426		
5500	81.335		
5640	81.300	1.500	80.030
5750	81.115		80.030
6000	81.256		
6260	81.200	2.200	79.900
6500	81.727		79.900
6750	82.061		
7000	81.256		
7200	80.800	1.590	79.710
7250	80.805		79.710
7500	80.767	1.950	79.650
7540	80.800		79.350
7750	81.384		
8000	82.509		
8250	82.523		
8500	82.201		
8640	81.300	2.670	79.130
8750	81.07		79.130
9000	80.992		
9160	81.200	2.670	79.030
9250	81.119		79.030
9500	81.059	2.550	78.950
9550	81.000		78.950
9750	81.189	2.710	78.890
9820	81.100		78.890
10000	81.583		
10250	81.584		
10500	81.456		
10750	81.4		
10890	81.000	2.820	78.680
11000	80.871		78.680

NOTES:
 1) GTS BENCH MARK ON YAMUNA BRIDGE LOCATED ON STONE AT EAST END OF 9th PIER FROM SOUTH OF YAMUNA BRIDGE 292.075 Ft. (89.024 m.)
 2) ALL LEVELS ARE IN METERS

LEGEND

- PROPOSED SEWER LINE
- PROPOSED RISING MAIN
- ROAD EDGE
- UNDERGROUND LINES
- CULVERT/BRIDGE
- HANDPUMP
- ELECTRIC POLE
- ELECTRIC LINE
- TELEPHONE POLE
- TELEPHONE LINE
- TRANSFORMER
- OFC PILLAR
- KILOMETER POST
- TREE
- HECTOMETER POST
- LAMP POST
- RAILWAY LINE
- NALA
- WATER MAIN
- EXISTING SEWER
- TRENCHLESS TECHNOLOGY
- NALA CROSSING
- RAILWAY LINE CROSSING

PIPE DETAILS:
 PIPE ID
 LENGTH-DIA
 MATERIAL
 SLOPE

REFERENCE DRAWING:

INST.					
ELEC.					
MECH.					
STRU.					
CIVIL					
REV. NO.	0	1	2	3	4

REV.	DESCRIPTION OF REVISIONS	DATE	CHECKED
CHECKED BY:	A.Bhatnagar	APPROVED BY:	D.Sarkar
DRAWN	Surendra	SCALE	H=1:1000 V=1:100
DESIGNED	R.Mittal	DATE	08-01-2005
SURVEYED	S.Sharma		

JICA JAPAN INTERNATIONAL COOPERATION AGENCY

CONSULTANTS:
 TOKYO ENGINEERING CONSULTANTS CO., LTD.
 CTI ENGINEERING INTERNATIONAL CO., LTD.
 STUP CONSULTANTS LTD.

PROJECT:
 THE STUDY ON WATER QUALITY MANAGEMENT PLAN FOR GANGA RIVER IN THE REPUBLIC OF INDIA
 FEASIBILITY STUDY FOR ALLAHABAD CITY

CORRIDOR: District : D
 NALA INTERCEPTING AT RAJAPUR STP

SHEET CONTENTS:
 PLAN AND PROFILE (2/3)
 (Proposed Intercepting Sewer Line)
 (Ch. 525 - 1100)

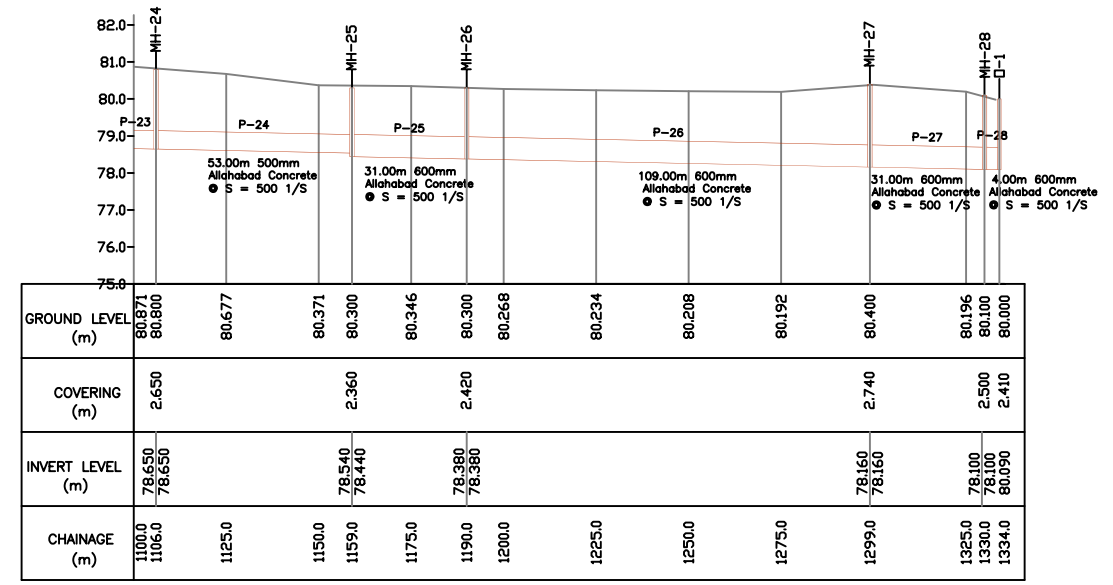
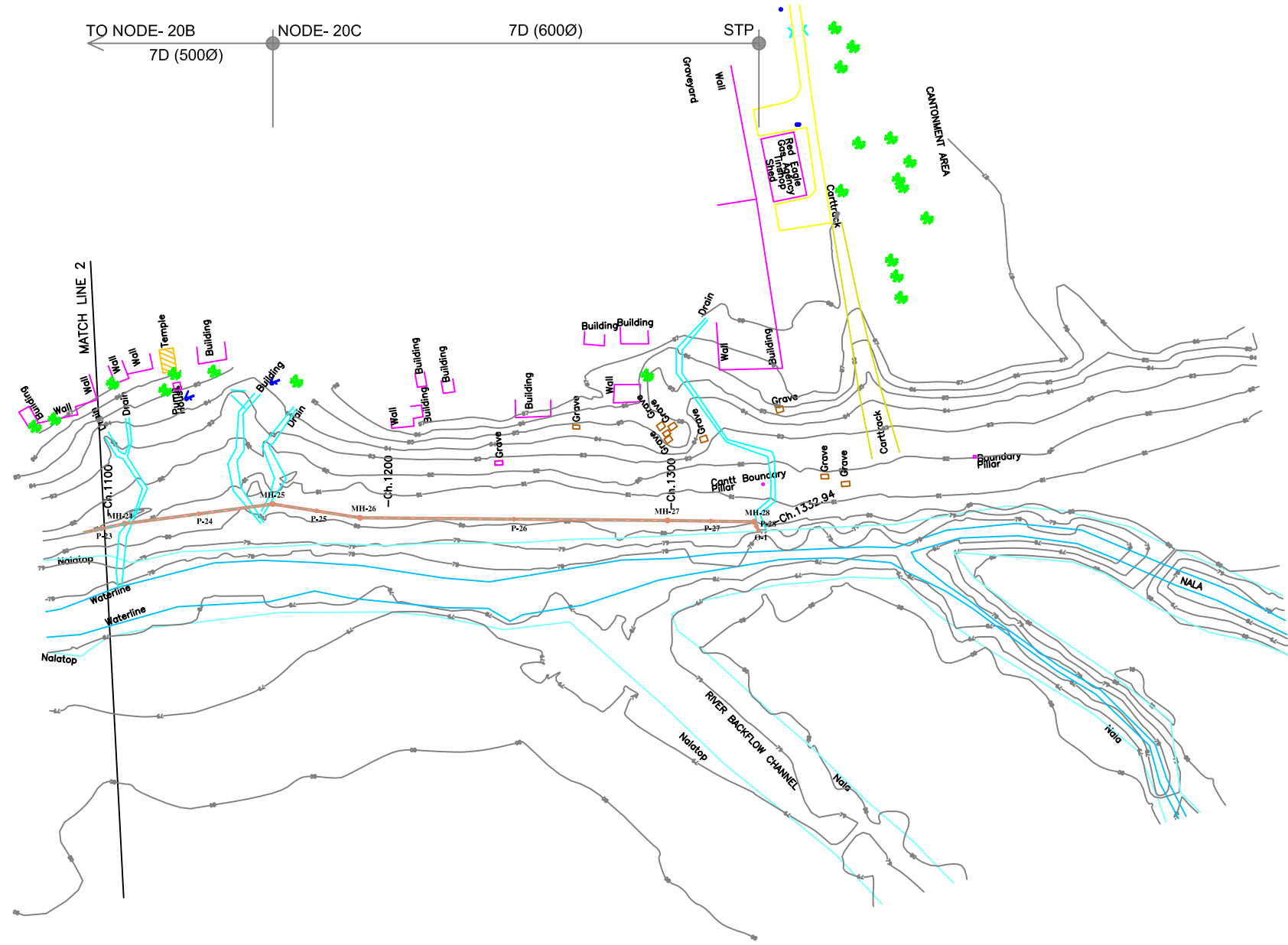

NOTES:
 1) GTS BENCH MARK ON YAMUNA BRIDGE LOCATED ON STONE AT EAST END OF 9th PIER FROM SOUTH OF YAMUNA BRIDGE 292.075 Ft. (89.024 m.)
 2) ALL LEVELS ARE IN METERS

LEGEND

- PROPOSED SEWER LINE
- PROPOSED RISING MAIN
- ROAD EDGE
- UNDERGROUND LINES
- CULVERT/BRIDGE
- HANDPUMP
- ELECTRIC POLE
- ELECTRIC LINE
- TELEPHONE POLE
- TELEPHONE LINE
- TRANSFORMER
- OFC PILLAR
- KILOMETER POST
- TREE
- HECTOMETER POST
- LAMP POST
- RAILWAY LINE
- NALA
- WATER MAIN
- EXISTING SEWER
- TRENCHLESS TECHNOLOGY
- NALA CROSSING
- RAILWAY LINE CROSSING

PIPE DETAILS:
 PIPE ID
 LENGTH-DIA
 MATERIAL
 SLOPE

REFERENCE DRAWING:

INST.				
ELEC.				
MECH.				
STRU.				
CIVIL				
REV. NO.	0	1	2	3

REV.	DESCRIPTION OF REVISIONS	DATE	CHECKED
CHECKED BY: A.Bhatnagar		APPROVED BY: D.Sarkar	
DRAWN: Surendra		APPROVE	
DESIGNED	R.Mittal	SCALE	H=1:1000 V=1:100
SURVEYED	S.Sharma	DATE	08-01-2005

JICA JAPAN INTERNATIONAL COOPERATION AGENCY
 CONSULTANTS:
 TOKYO ENGINEERING CONSULTANTS CO., LTD.
 CTI ENGINEERING INTERNATIONAL CO., LTD.
 STUP CONSULTANTS LTD.

PROJECT:
 THE STUDY ON WATER QUALITY MANAGEMENT PLAN FOR GANGA RIVER IN THE REPUBLIC OF INDIA
 FEASIBILITY STUDY FOR ALLAHABAD CITY

CORRIDOR: District : D
 NALA INTERCEPTING AT RAJAPUR STP

SHEET CONTENTS:
 PLAN AND PROFILE (3/3)
 (Proposed Intercepting Sewer Line)
 (Ch. 1100 - 1334)

DRAWING NO. ALD-SE-D(RJ)-3
SHT. NO. 40