

DRAWINGS

LIST OF DRAWINGS

Layout of Equipment

- Figure 1 Master Control Station and Rainfall Gauging Station (Islamabad),
Pakistan Meteorological Department (PMD)
- Figure 2 Rainfall Gauging Station (Saidpur)
- Figure 3 Rainfall Gauging Station (Golra)
- Figure 4 Rainfall Gauging Station (Bokra)
- Figure 5 Rainfall Gauging Station (Chaklala)
- Figure 6 Rainfall Gauging Station and Repeater Station (RAMC)
- Figure 7 Water-level Gauging Station (Katarian Bridge)
- Figure 8 Water-level Gauging Station(Gawal Mandi Bridge)
- Figure 9 Monitoring Station, Federal Flood Commission (FFC)
- Figure 10 Monitoring Station, Water and Sanitation Agency (WASA)
- Figure 11 Executive Warning Station and Warning Post (WP-1) , TMA-Rawalpindi
- Figure 12 Warning Post (WP-2)
- Figure 13 Warning Post (WP-3)
- Figure 14 Warning Post (WP-4)
- Figure 15 Warning Post (WP-5)
- Figure 16 Warning Post (WP-6)
- Figure 17 Warning Post (WP-7)
- Figure 18 Warning Post (WP-8)
- Figure 19 Warning Post (WP-9)
- Figure 20 Warning Post (WP-10)

Layout of Facilities

- Figure 21 Layout Plan of Rainfall Gauging Station (Golra)
- Figure 22 Elevation of Rainfall Gauging Station (Golra)
- Figure 23 Layout Plan of Rainfall Gauging Station (Bokra)
- Figure 24 Elevation of Rainfall Gauging Station (Bokra)
- Figure 25 Layout Plan of Water-level Gauging Station (Katarian Bridge)
- Figure 26 Elevation of Water-level Gauging Station (Katarian Bridge)
- Figure 27 Layout Plan of Water-level Gauging Station (Gawal Mandi Bridge)
- Figure 28 Elevation of Water-level Gauging Station (Gawal Mandi Bridge)
- Figure 29 Layout Plan of Warning Post
- Figure 30 Elevation of Warning Post

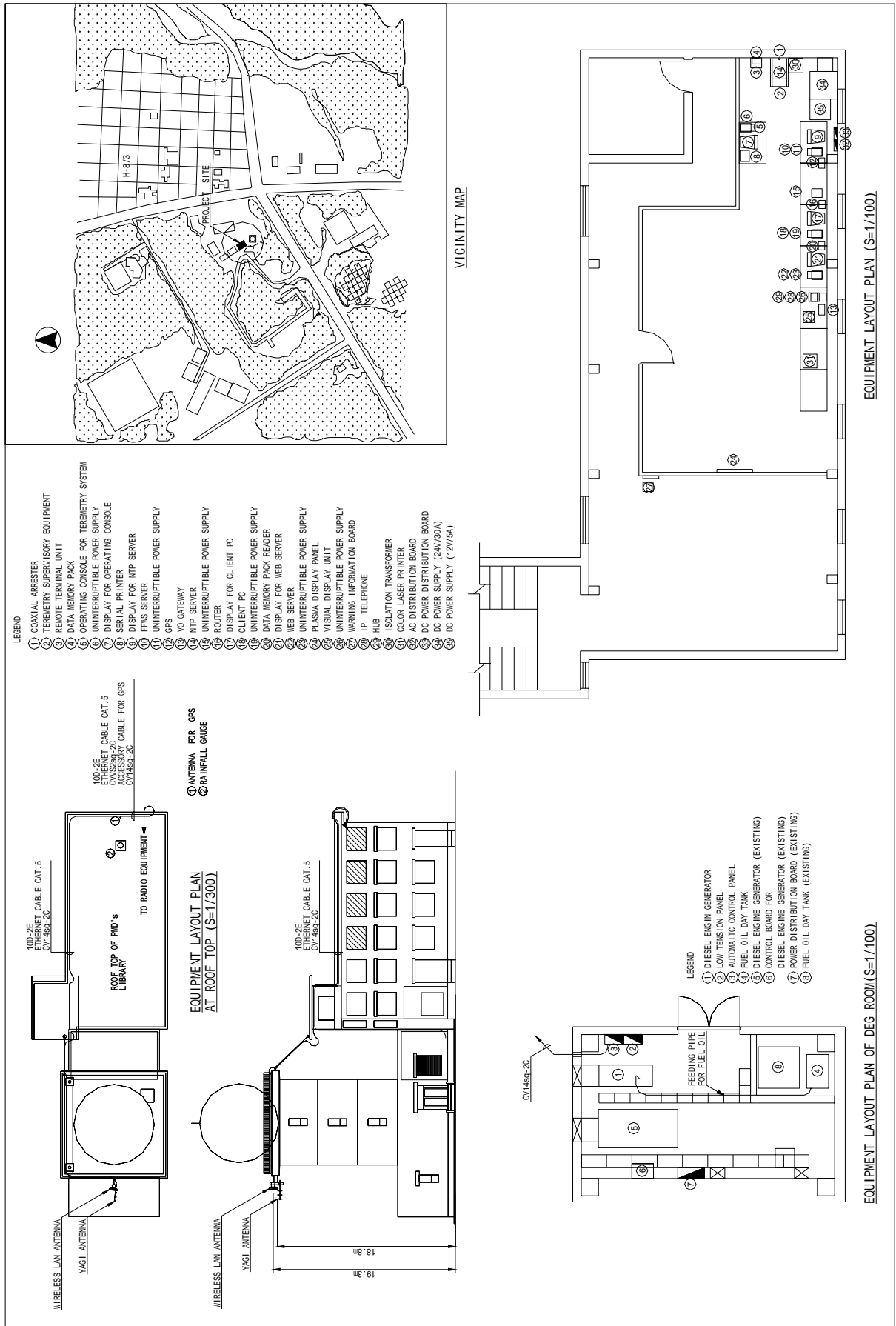

Figure 1 Master Control Station and Rainfall Gauging Station (Islamabad), Pakistan Meteorological Department (PMD)

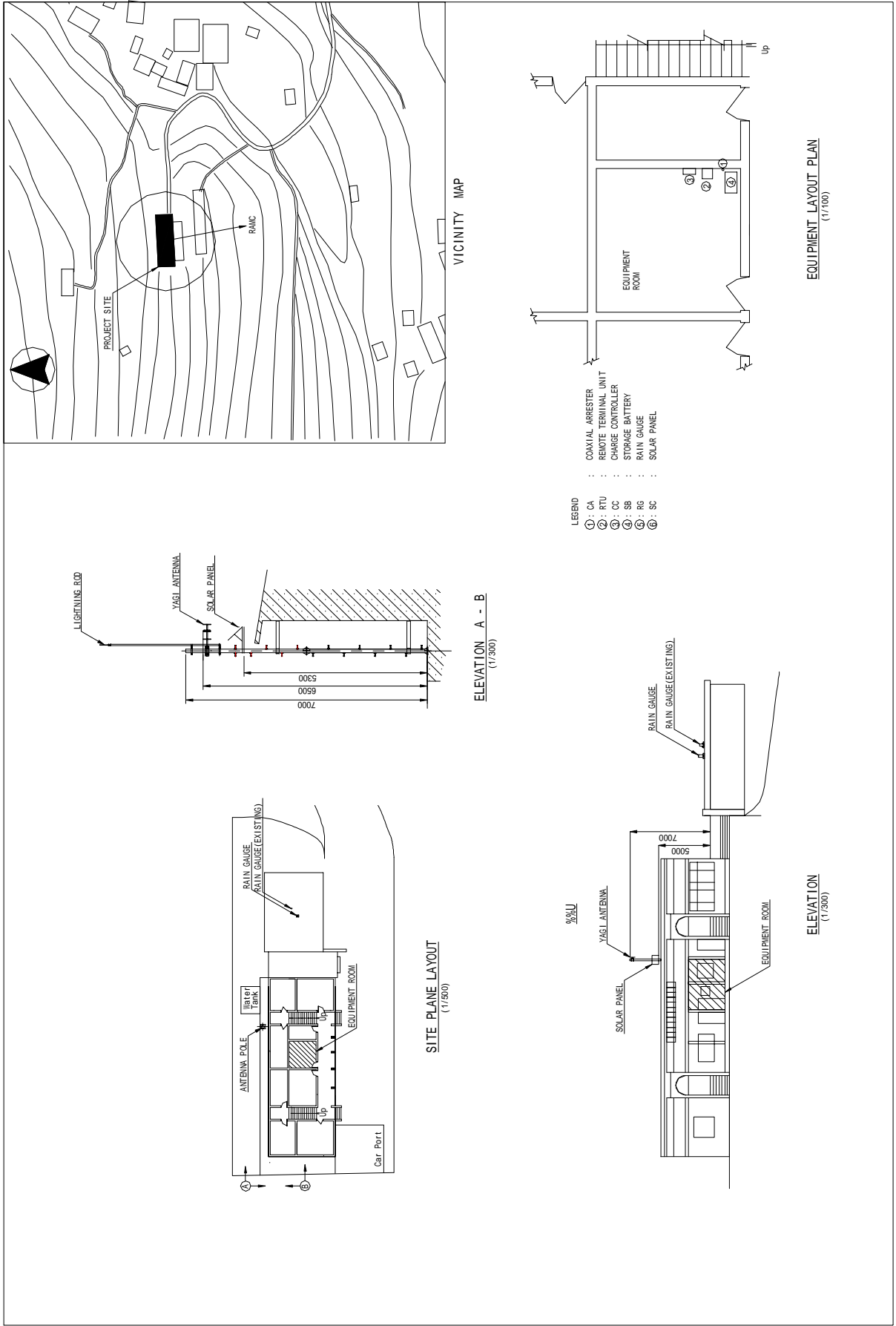

Figure 2 Rainfall Gauging Station (Saidpur)

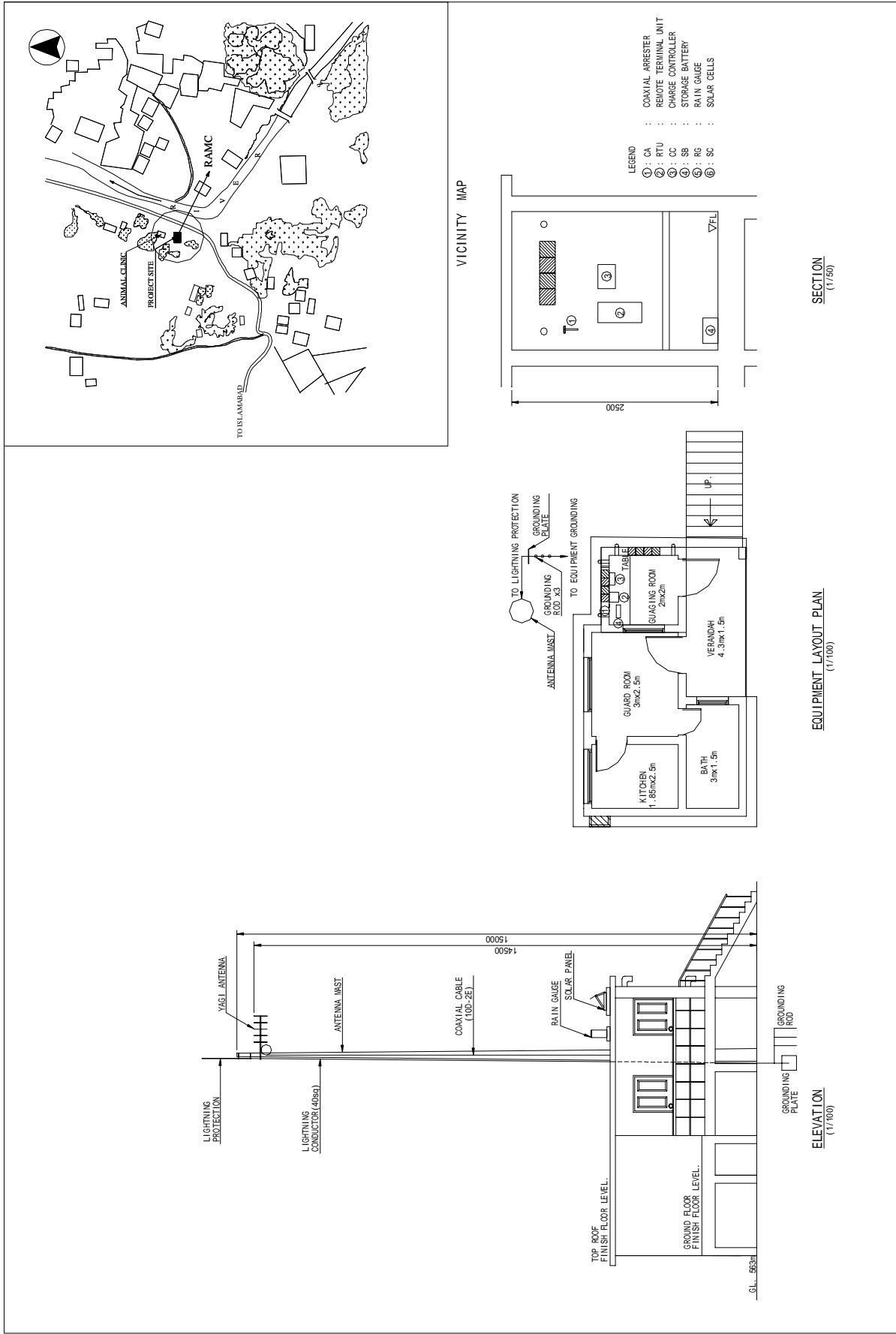

Figure 3 Rainfall Gauging Station (Golra)

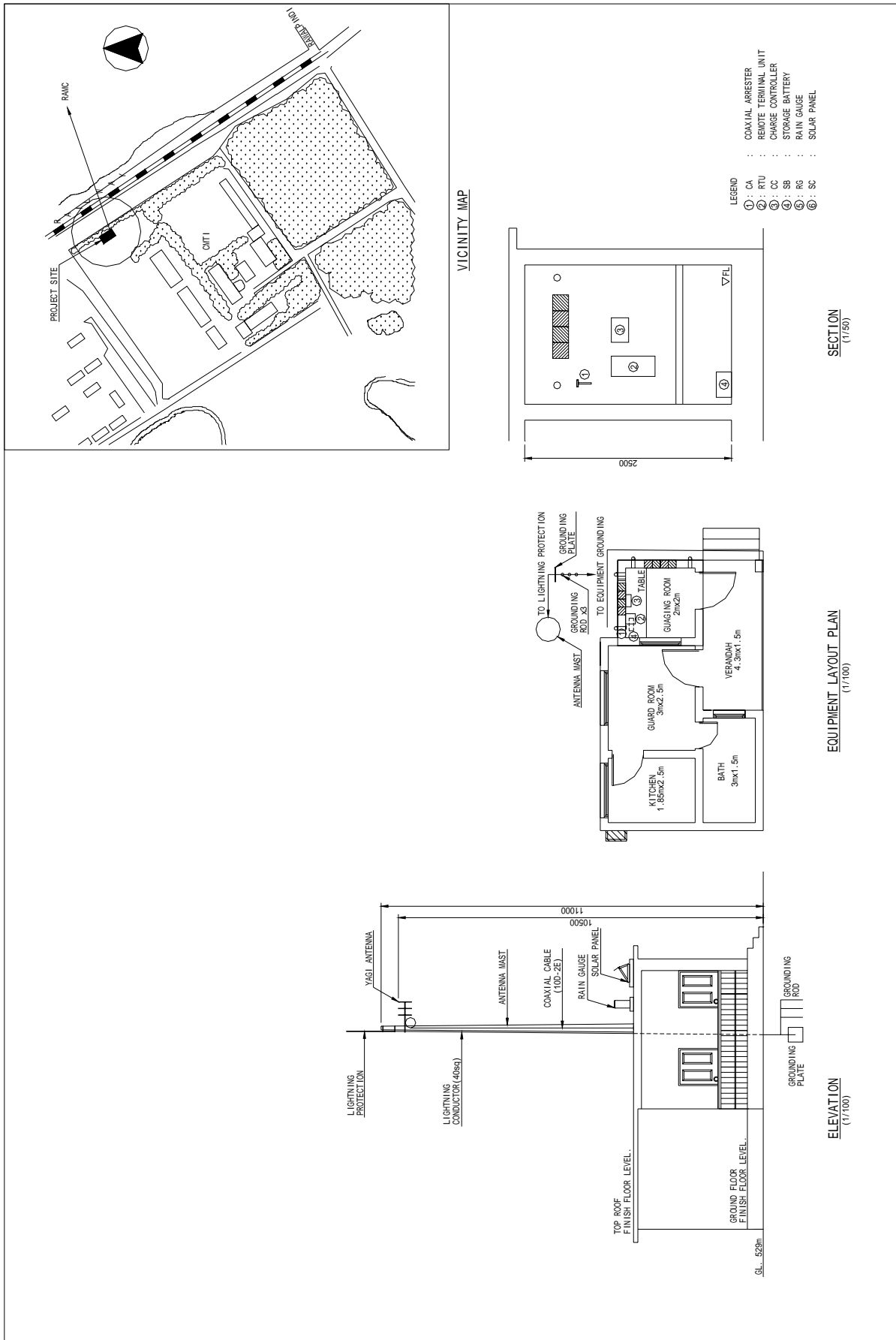

Figure 4 Rainfall Gauging Station (Bokra)

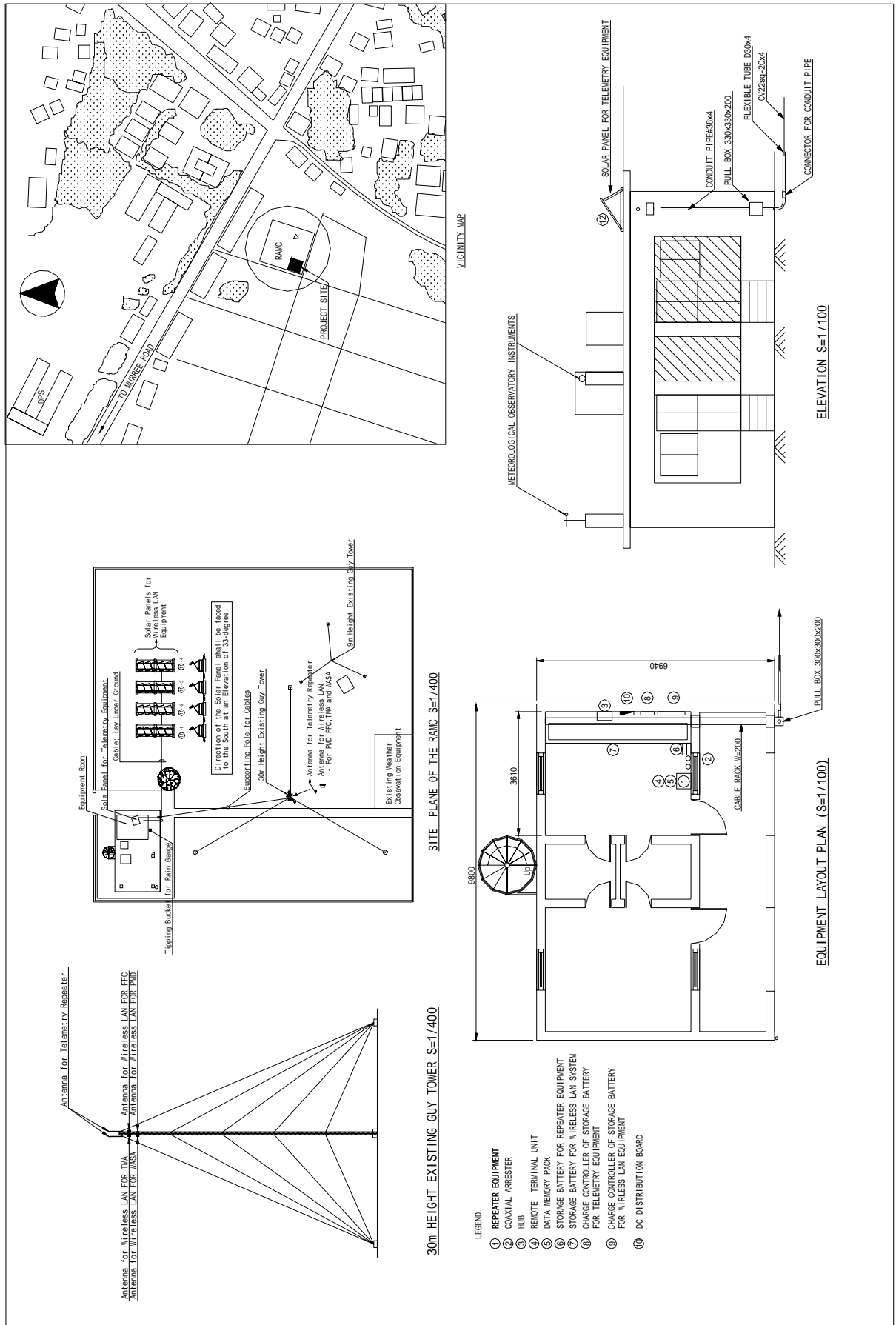

Figure 6 Rainfall Gauging Station and Repeater Station (RAMC)

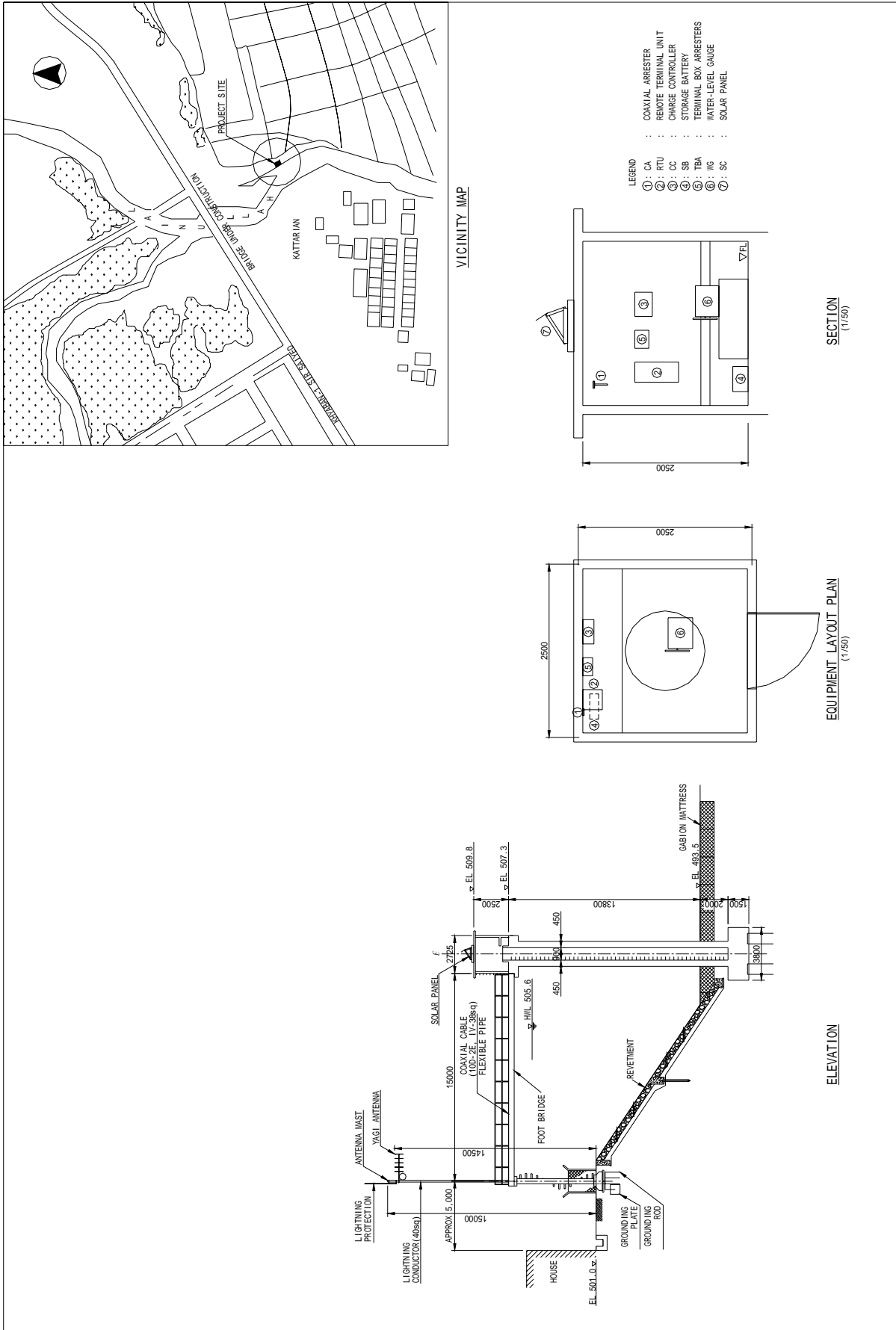

Figure 7 Water-level Gauging Station (Katarian Bridge)

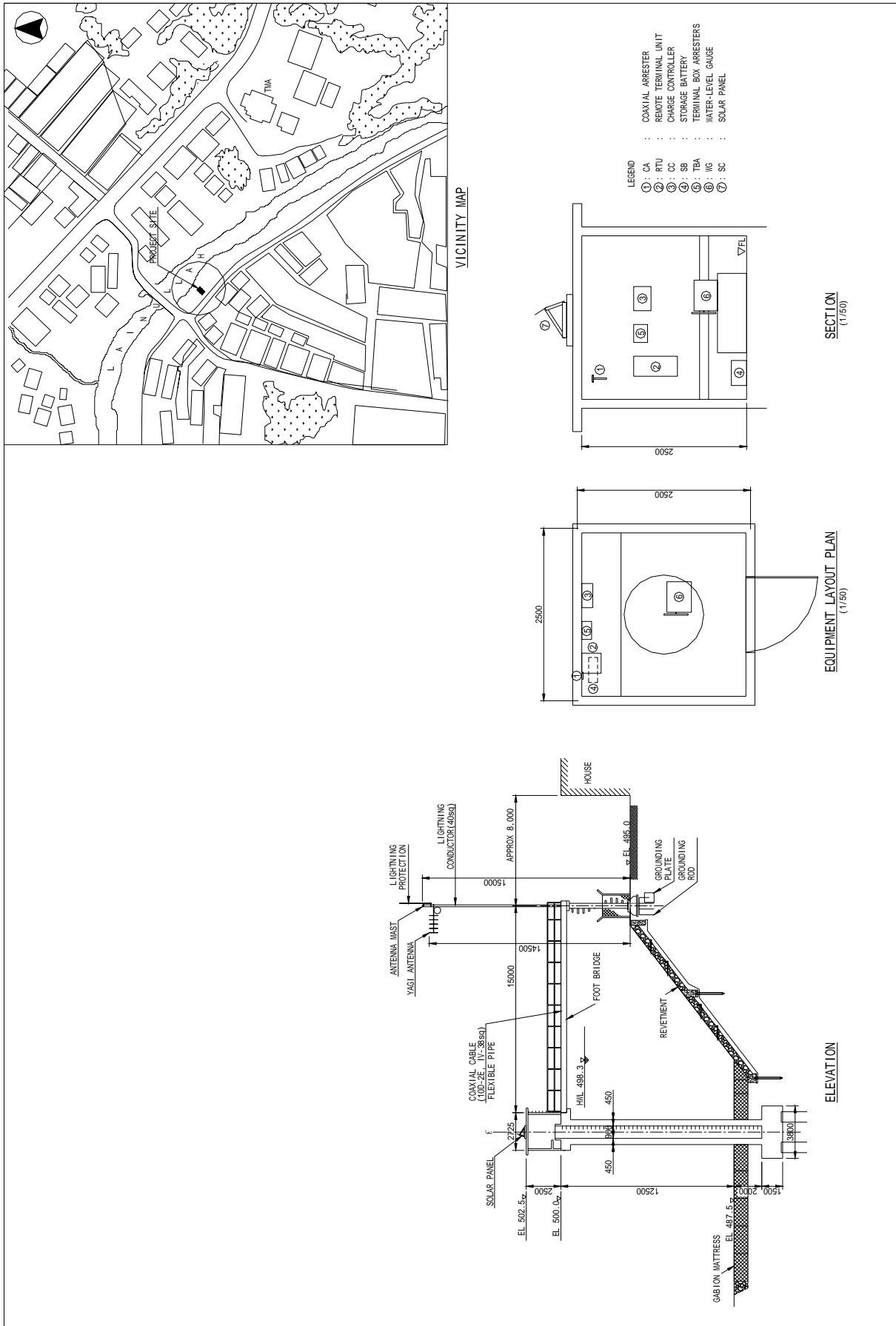

Figure 8 Water-level Gauging Station(Gawal Mandi Bridge)

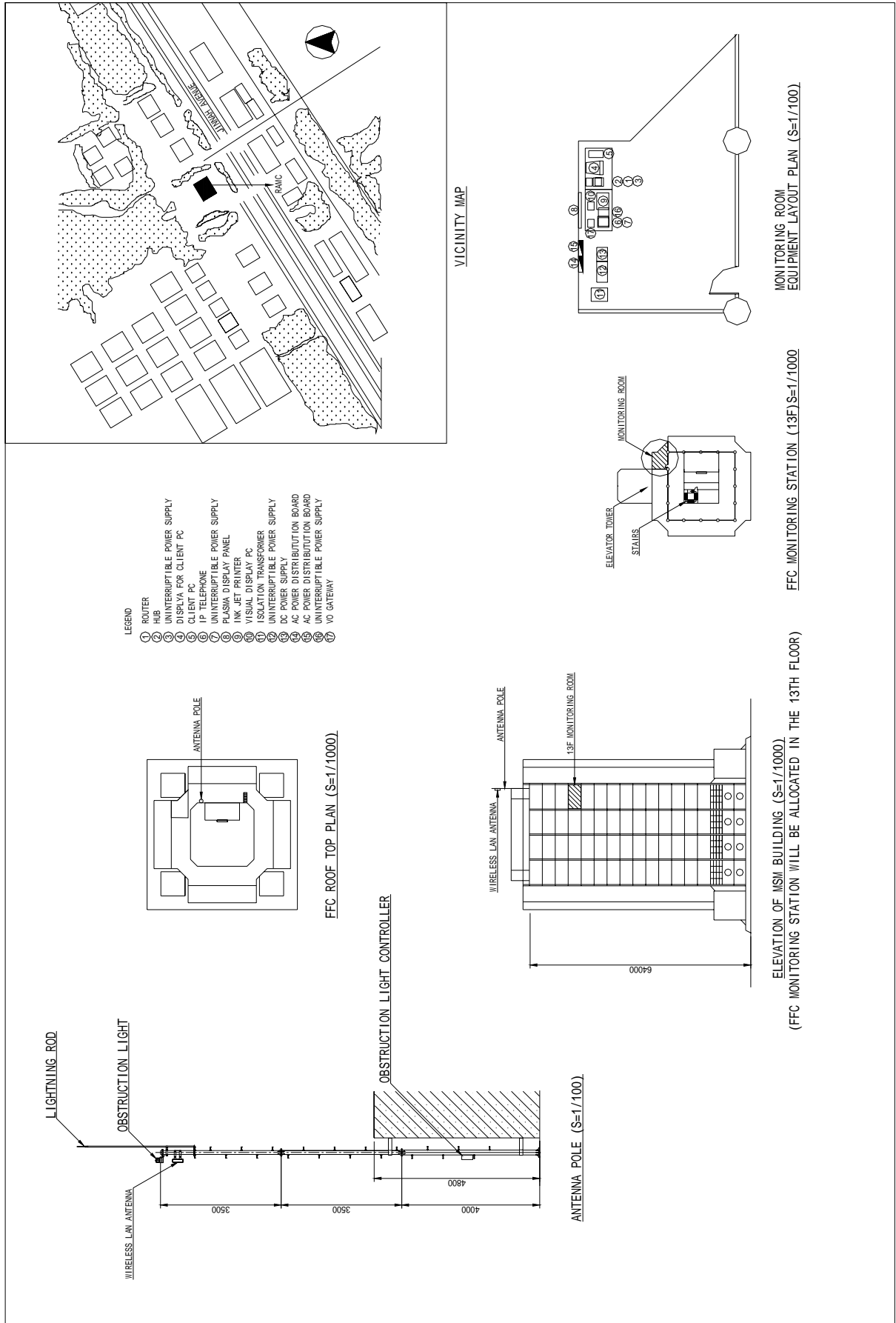

Figure 9 Monitoring Station, Federal Flood Commission (FFC)

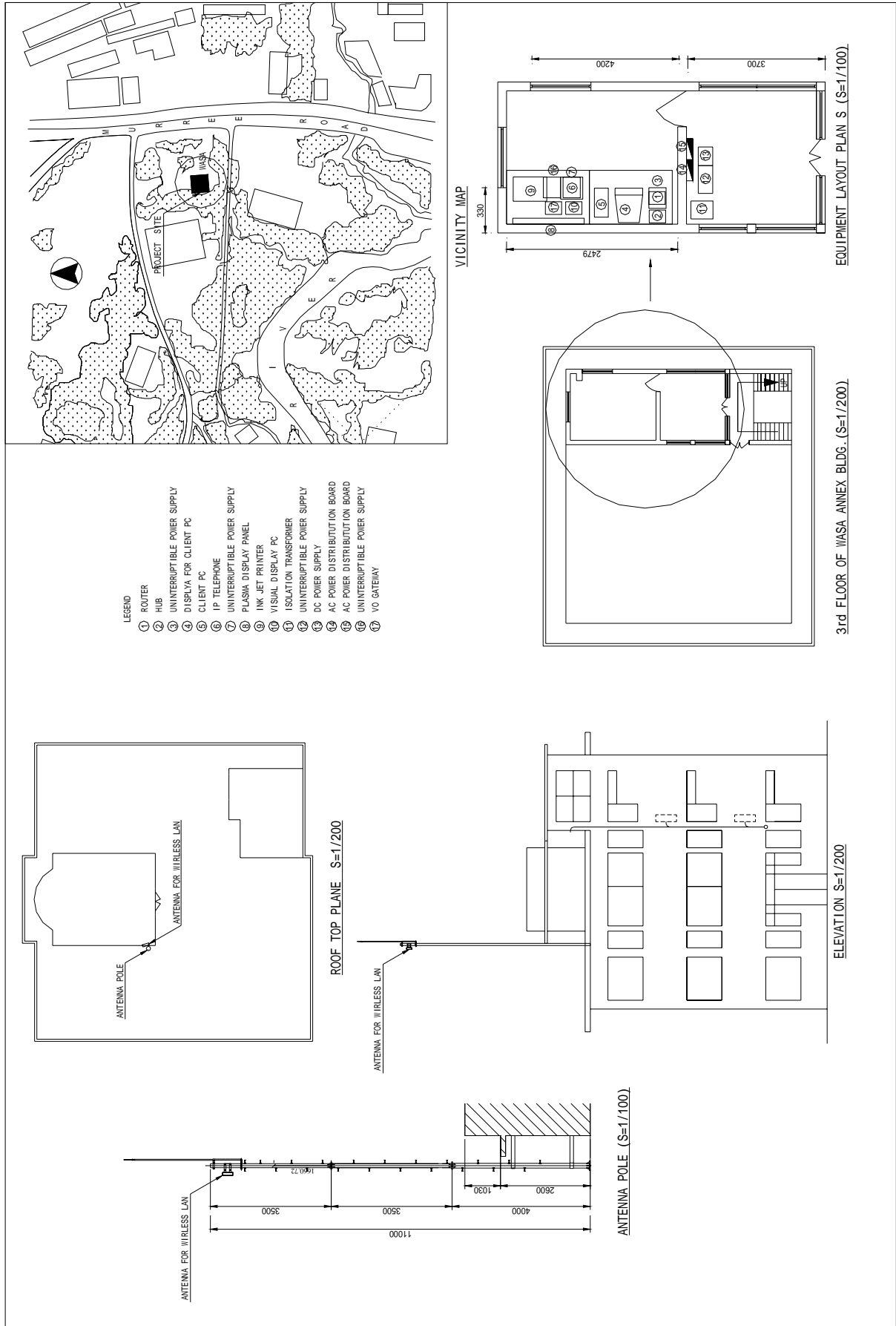

Figure 10 Monitoring Station, Water and Sanitation Agency (WASA)

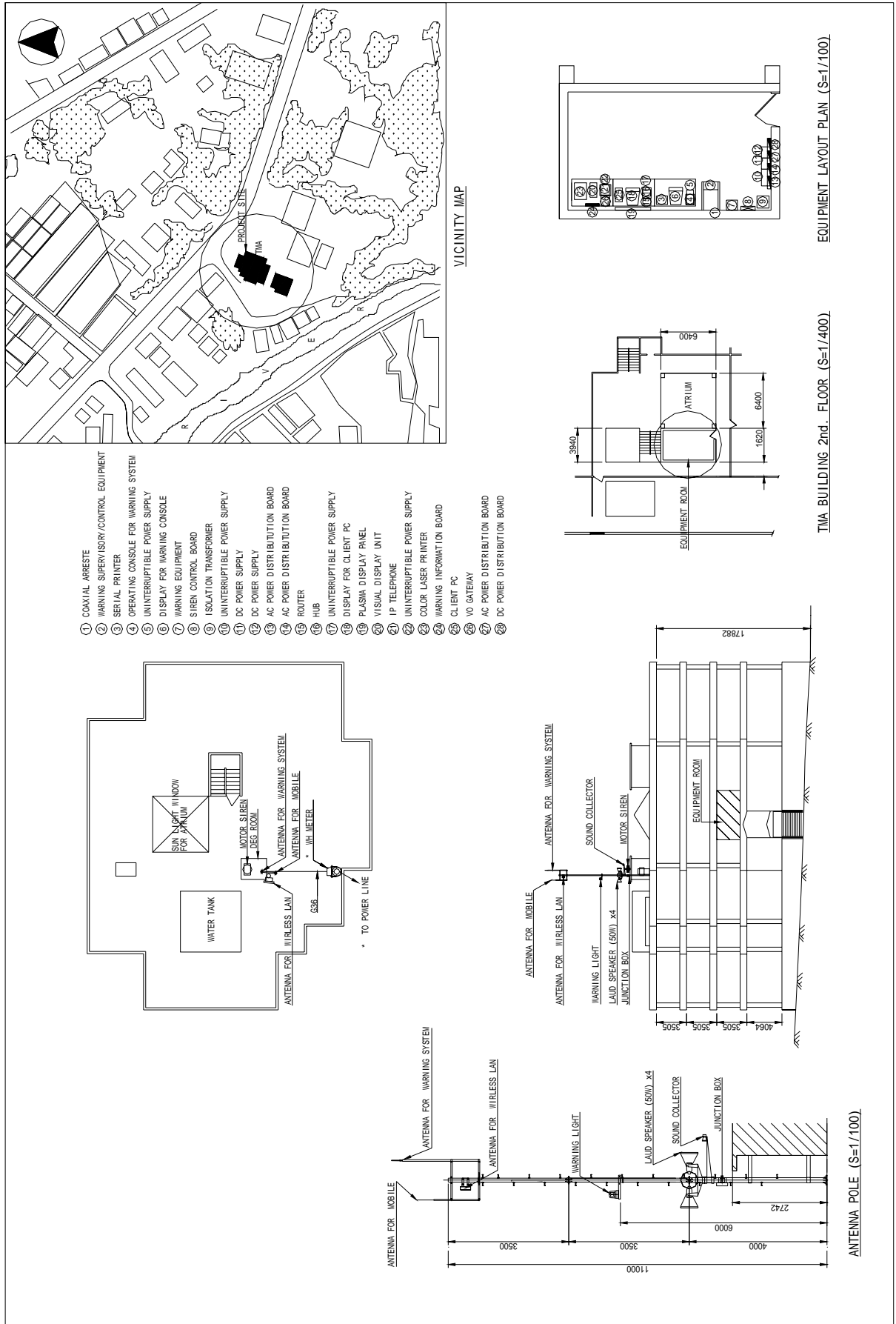

Figure 11 Executive Warning Station and Warning Post (WP-1), TMA-Rawalpindi

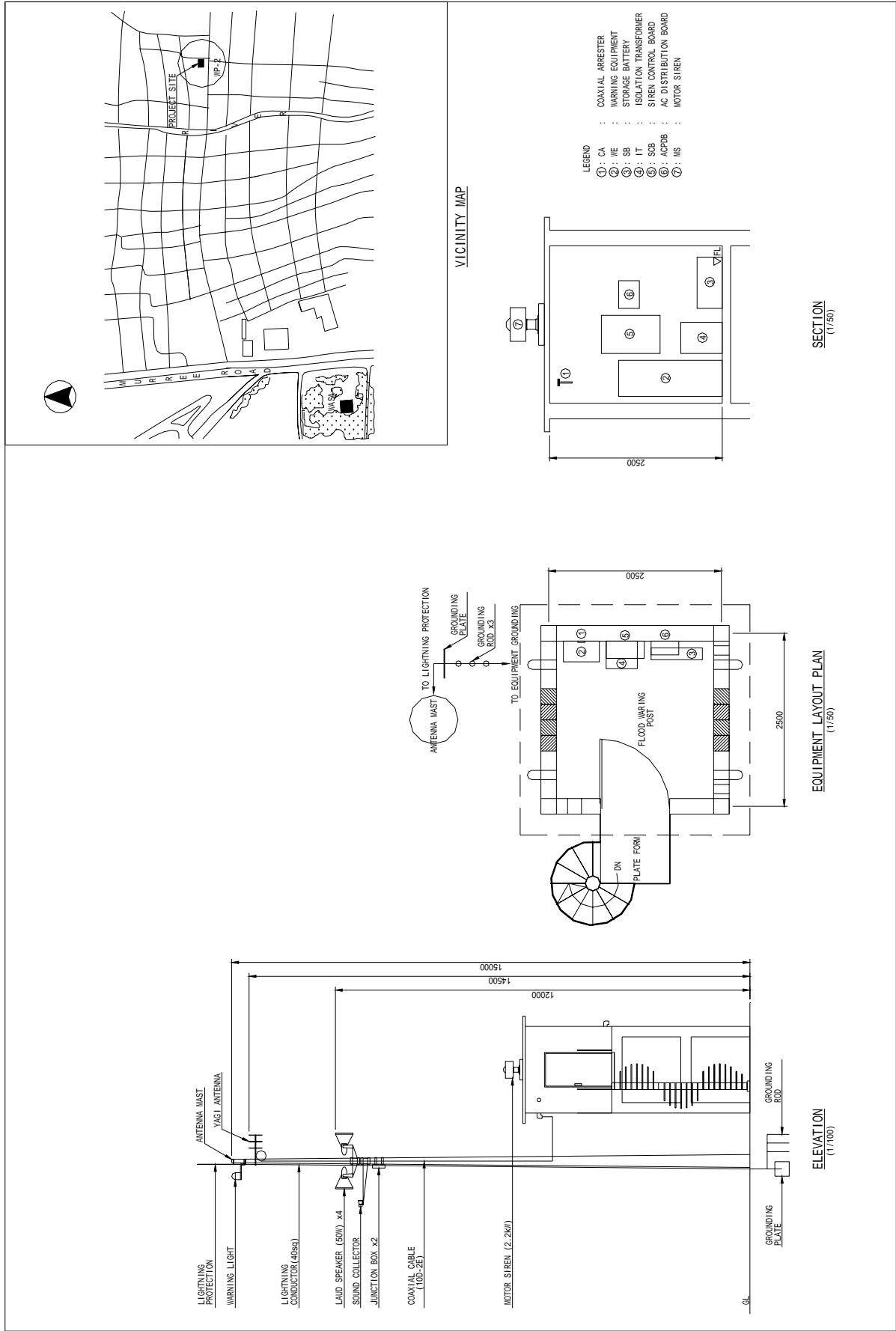

Figure 12 Warning Post (WP-2)

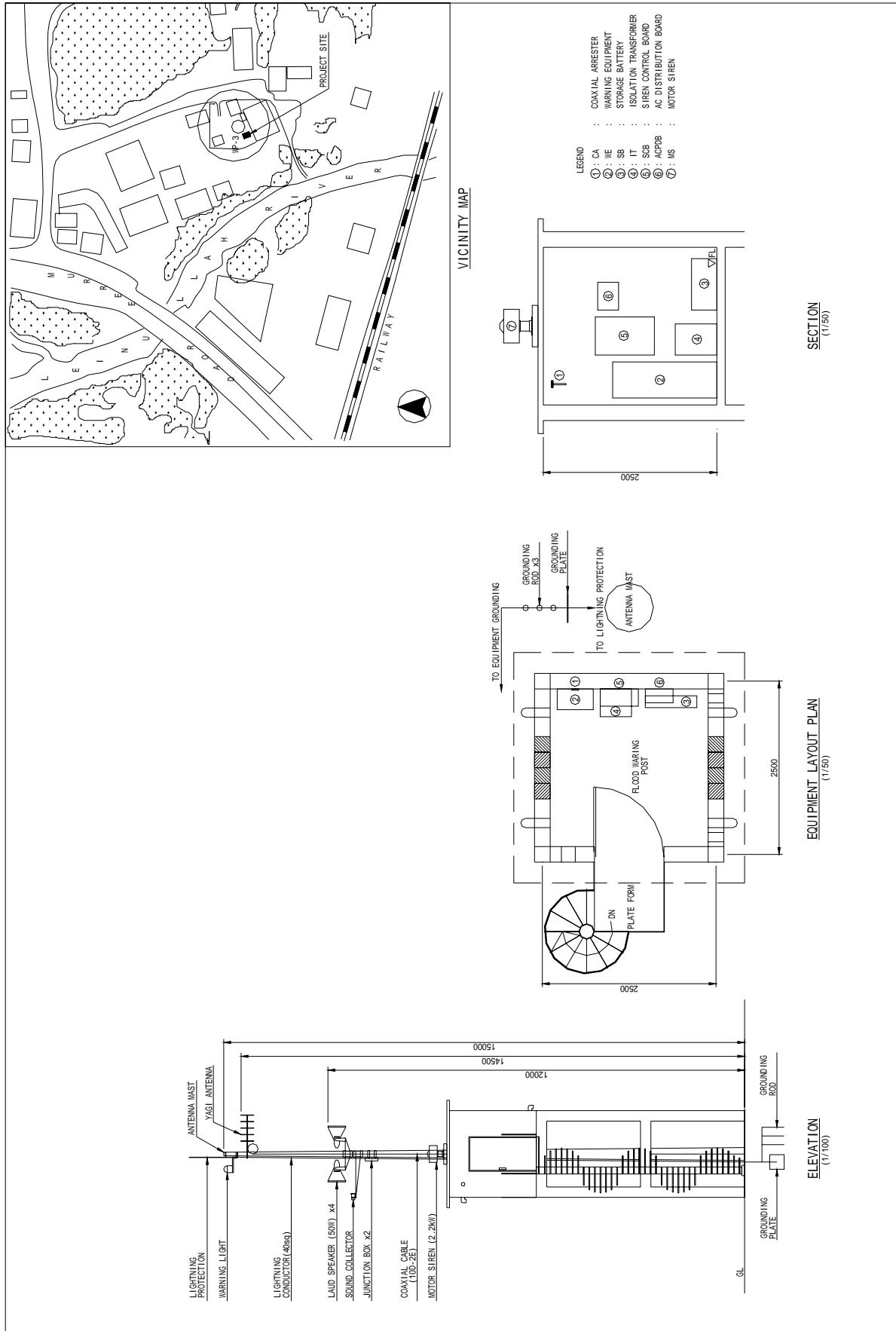
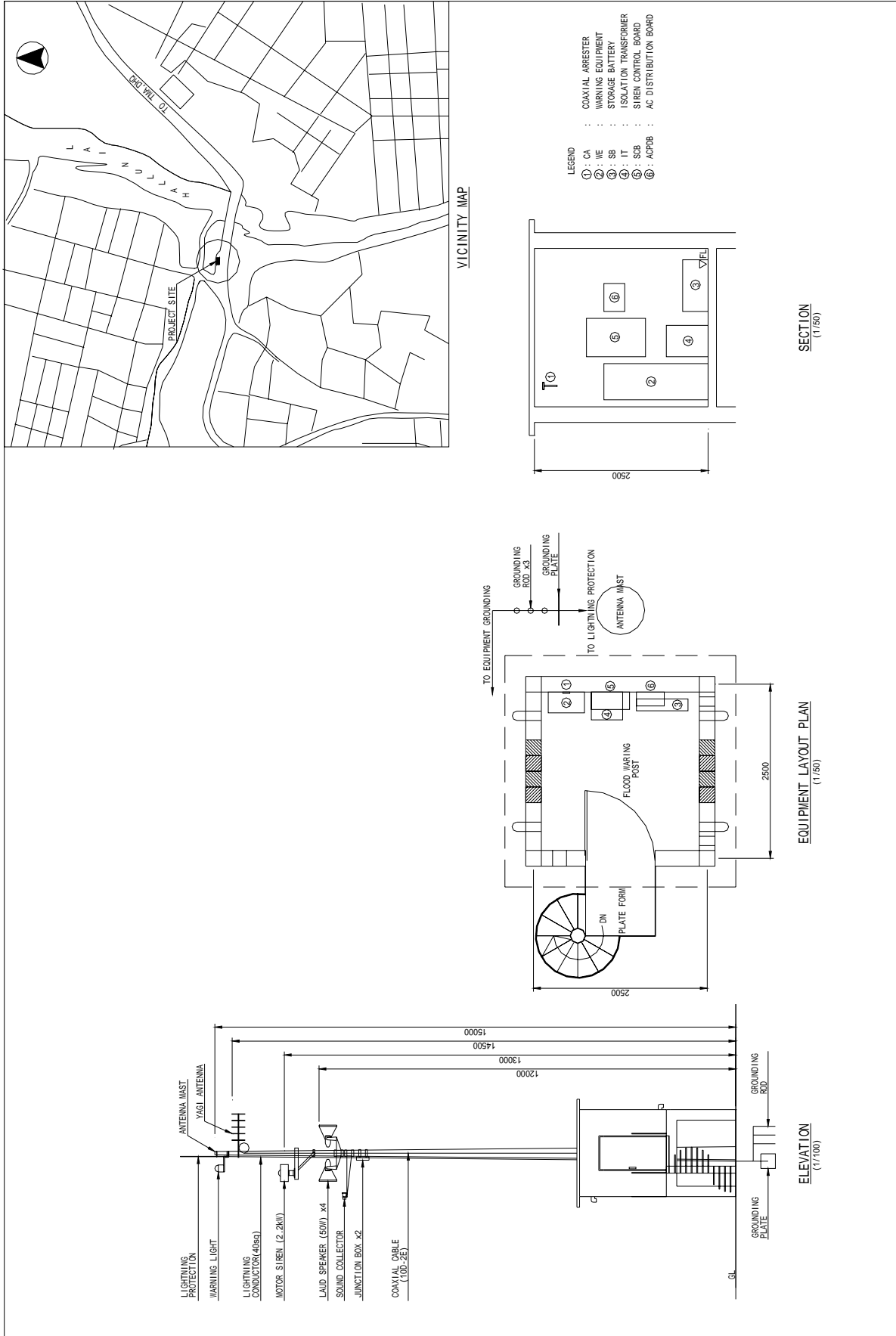

Figure 13 Warning Post (WP-3)



F-14

Figure 14 Warning Post (WP-4)

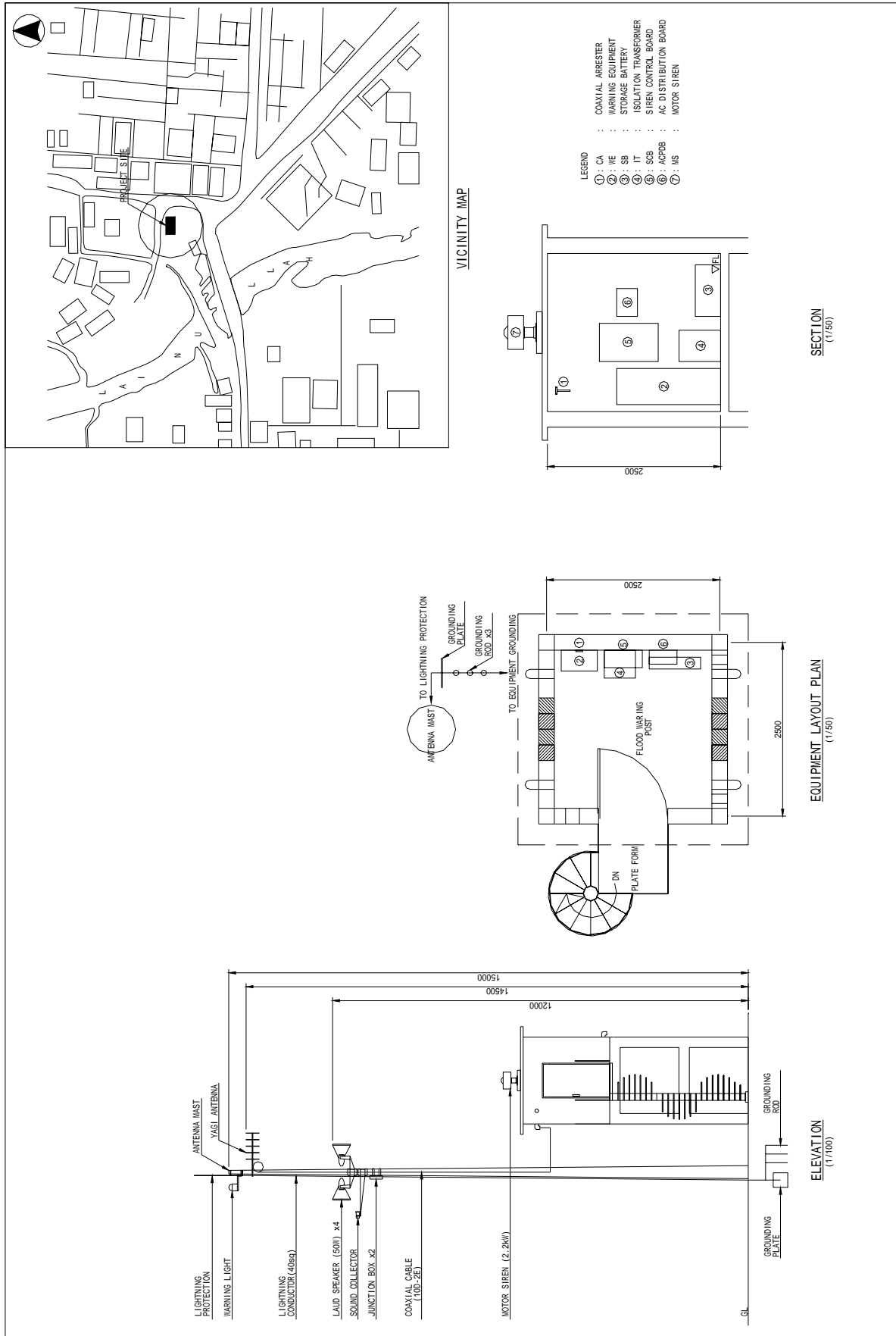
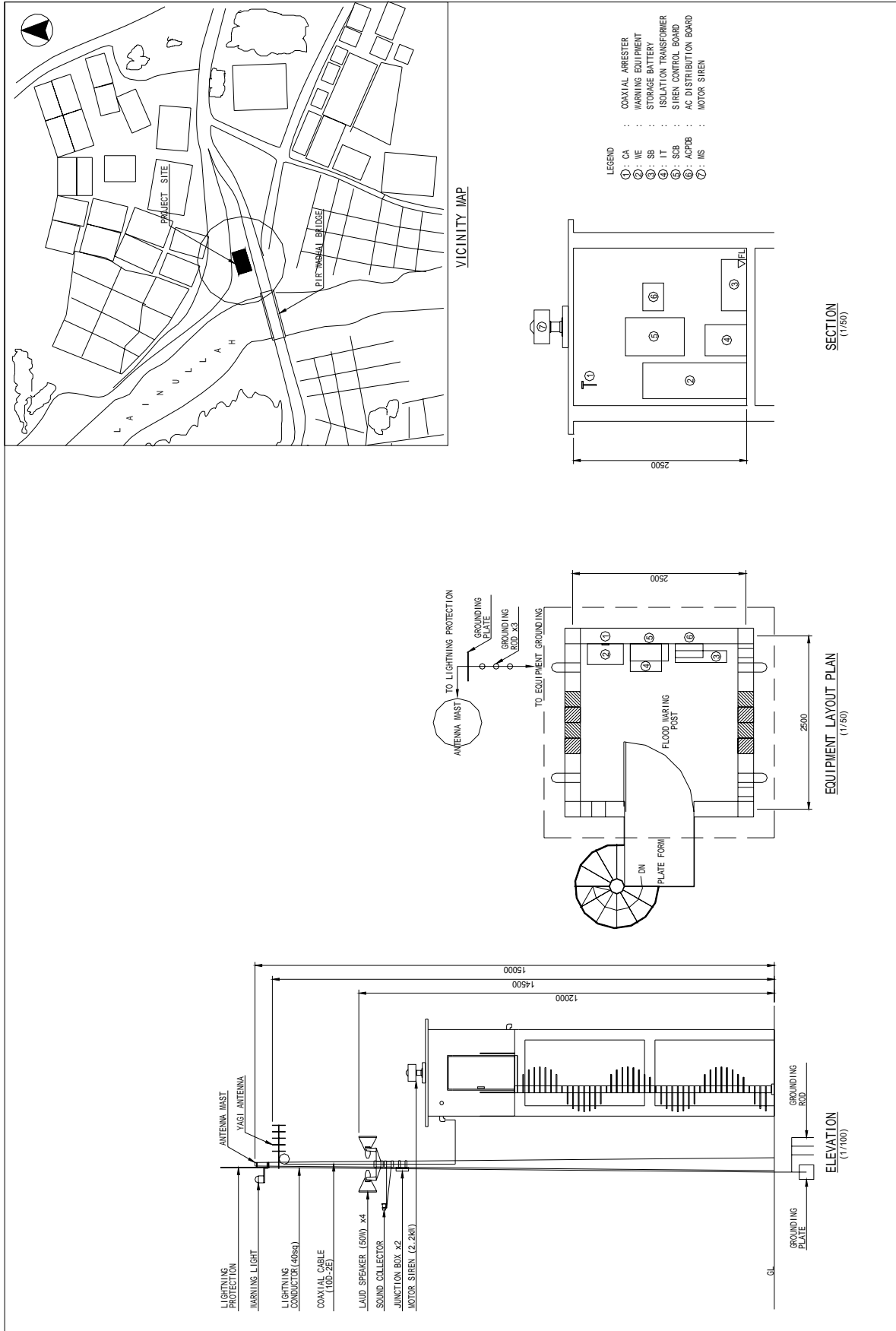

Figure 15 Warning Post (WP-5)



F-16

Figure 16 Warning Post (WP-6)

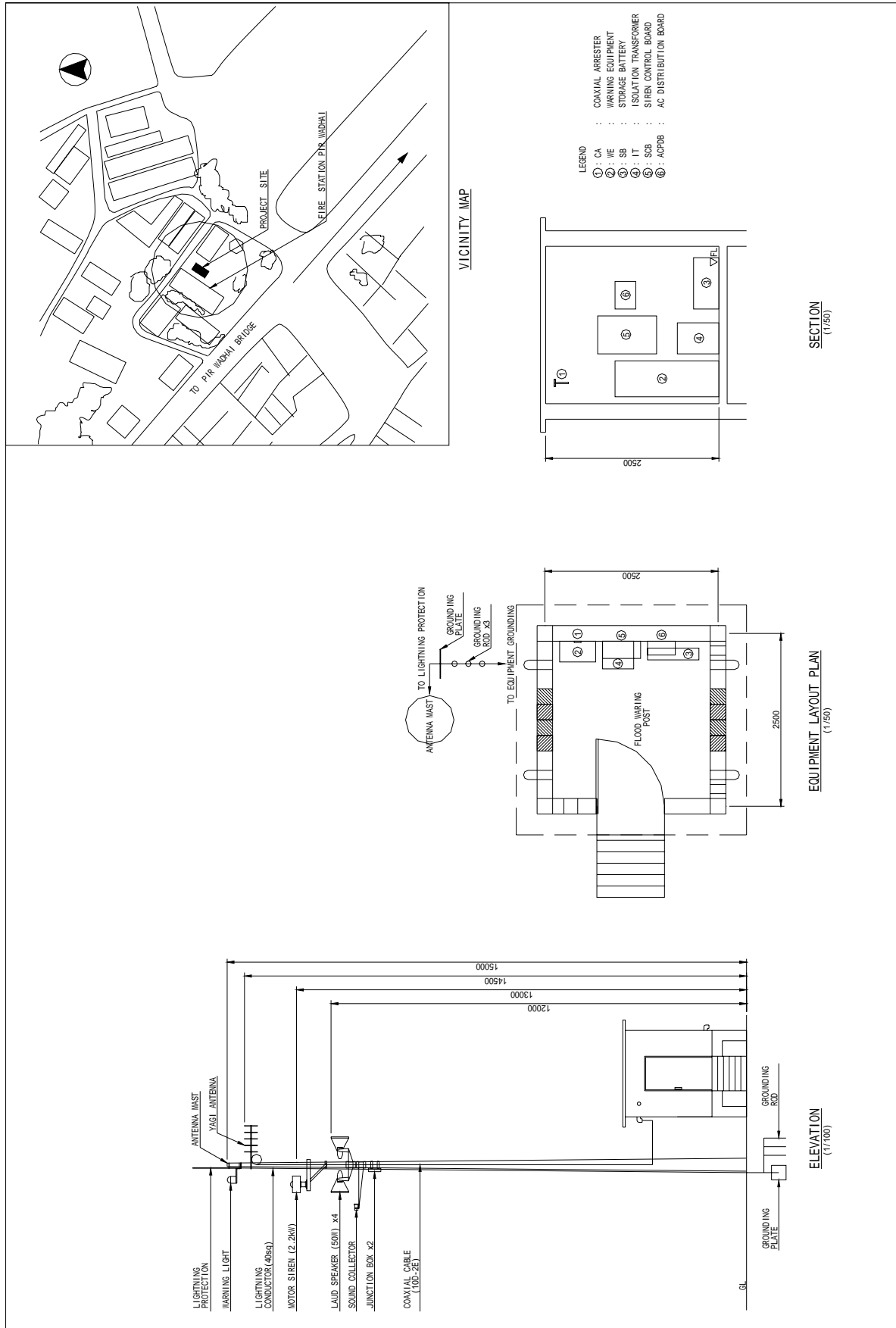

Figure 17 Warning Post (WP-7)

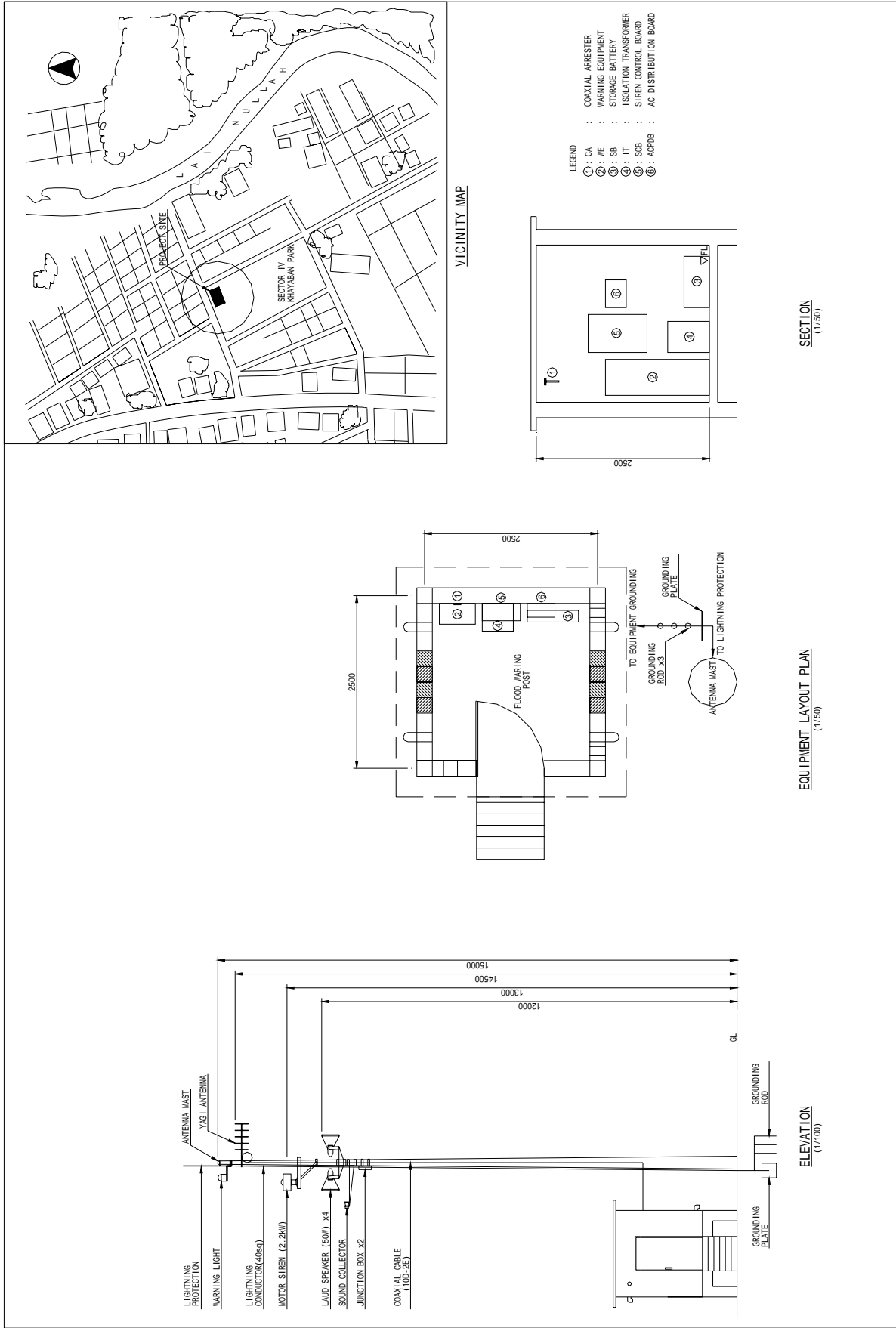

Figure 18 Warning Post (WP-8)

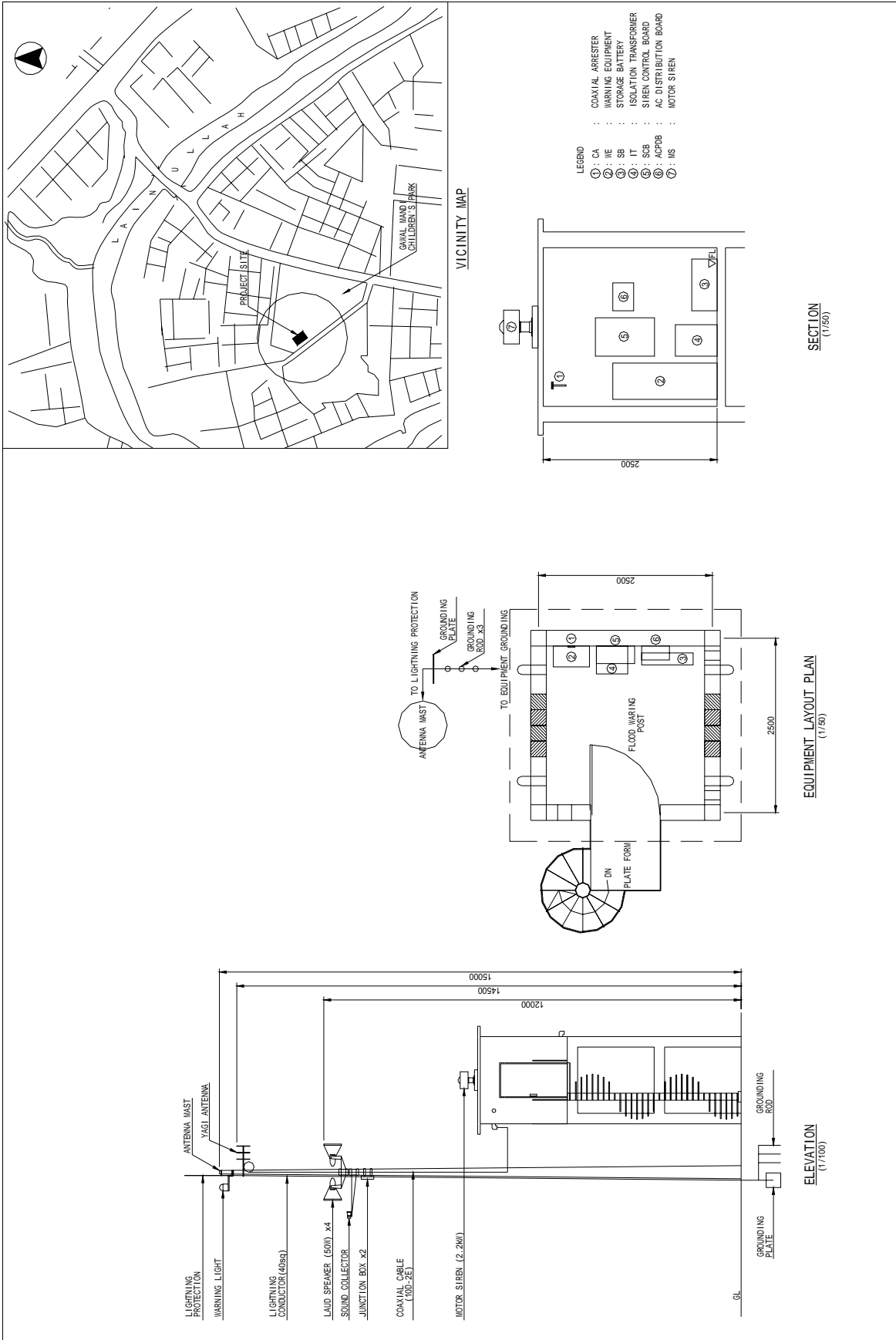

Figure 19 Warning Post (WP-9)

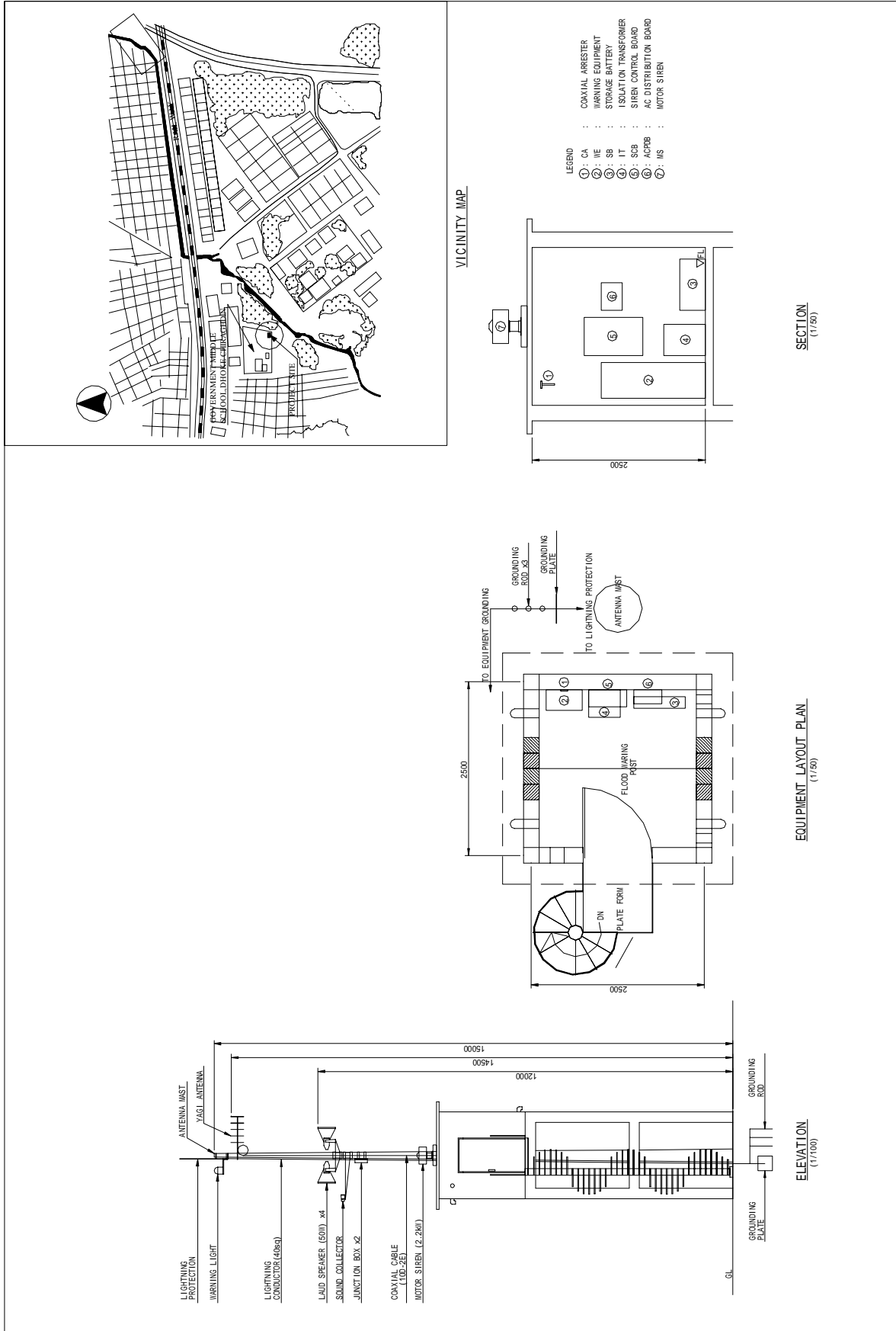

Figure 20 Warning Post (WP-10)

NOTE:
 (1) SCOPE OF WORK
 a) GAUGING ROOM : BY JAPAN
 b) EXCEPT FOR GAUGING ROOM : BY PAKISTAN

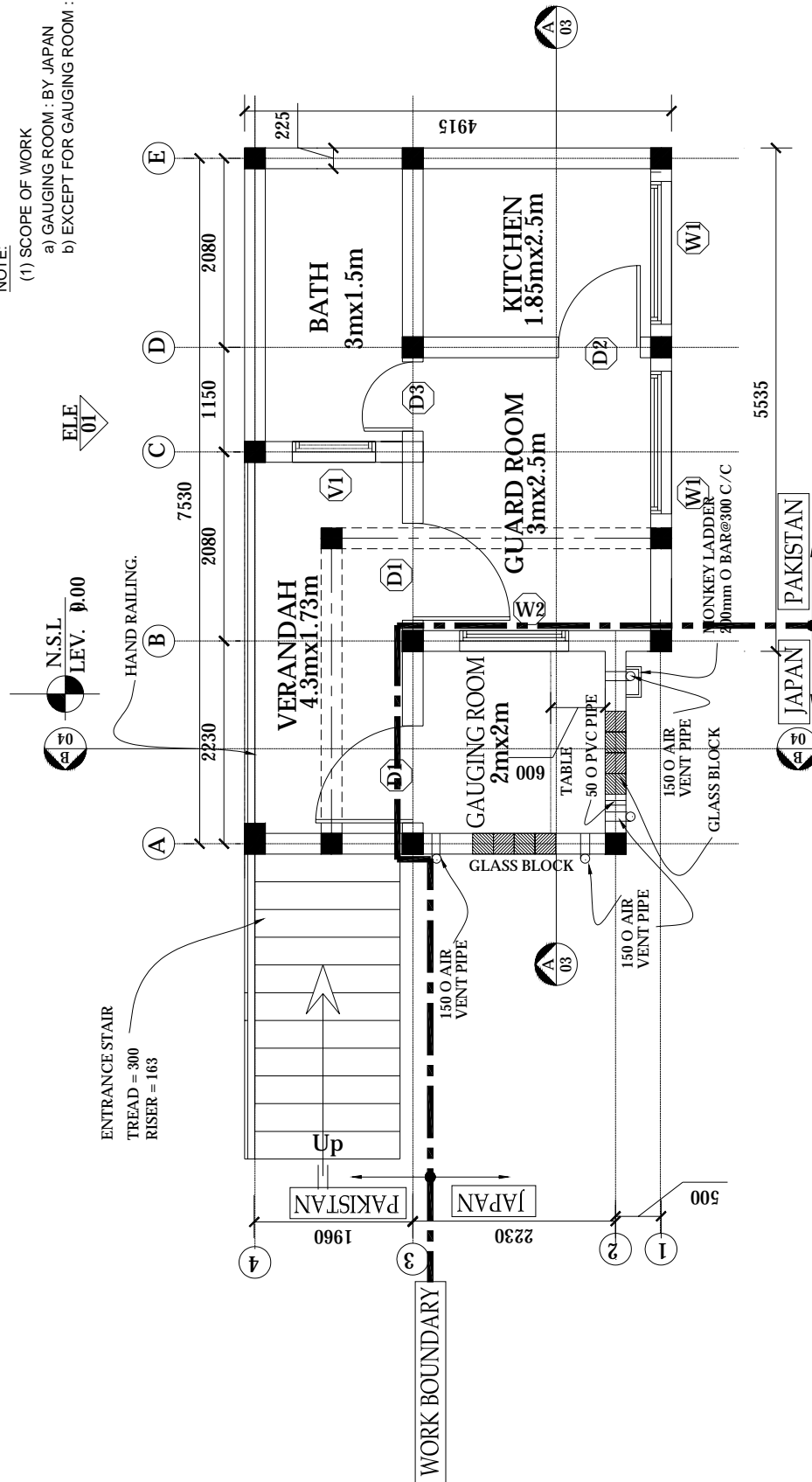

Figure 21 Layout Plan of Rainfall Gauging Station (Golra)

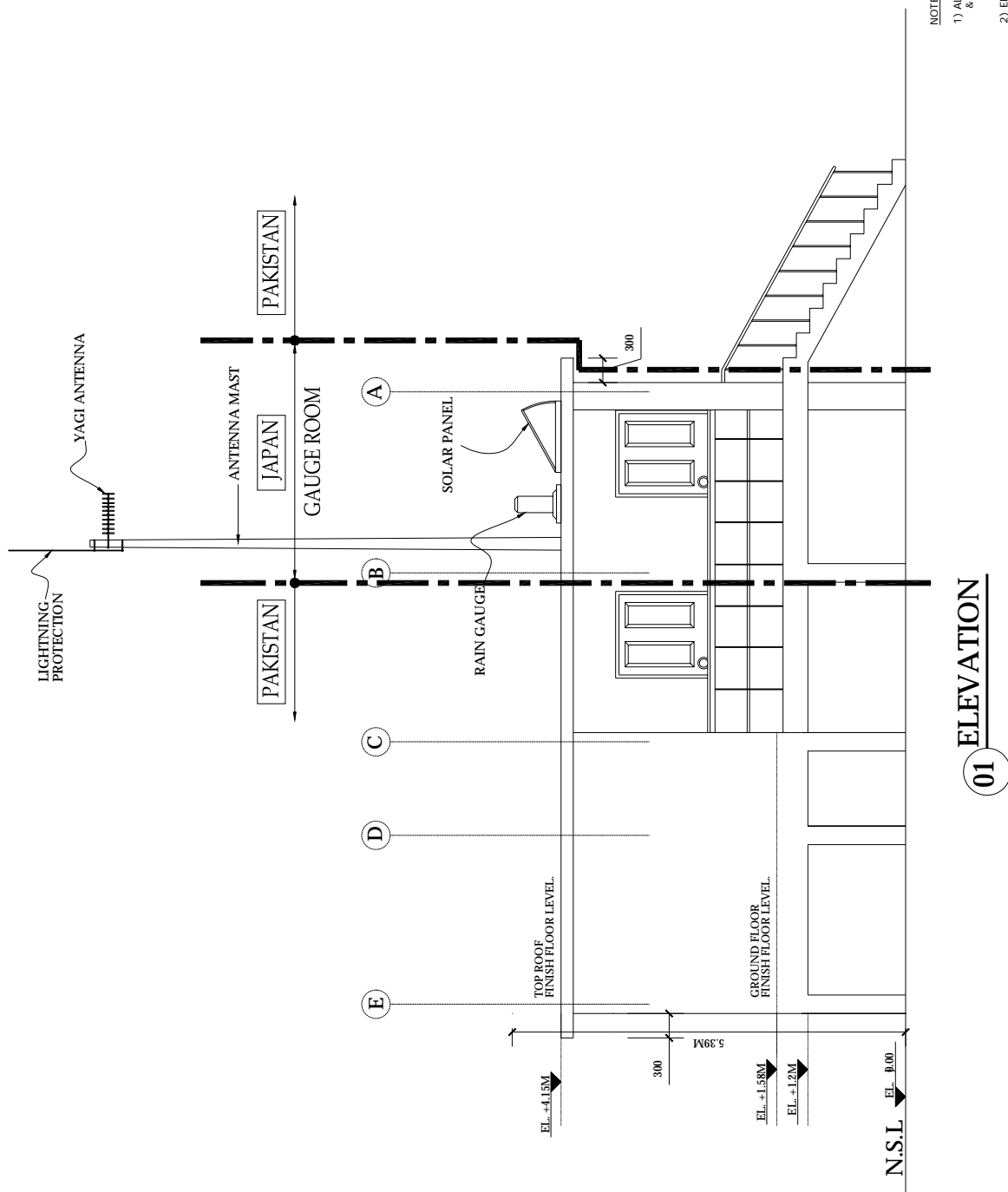

Figure 22 Elevation of Rainfall Gauging Station (Golra)

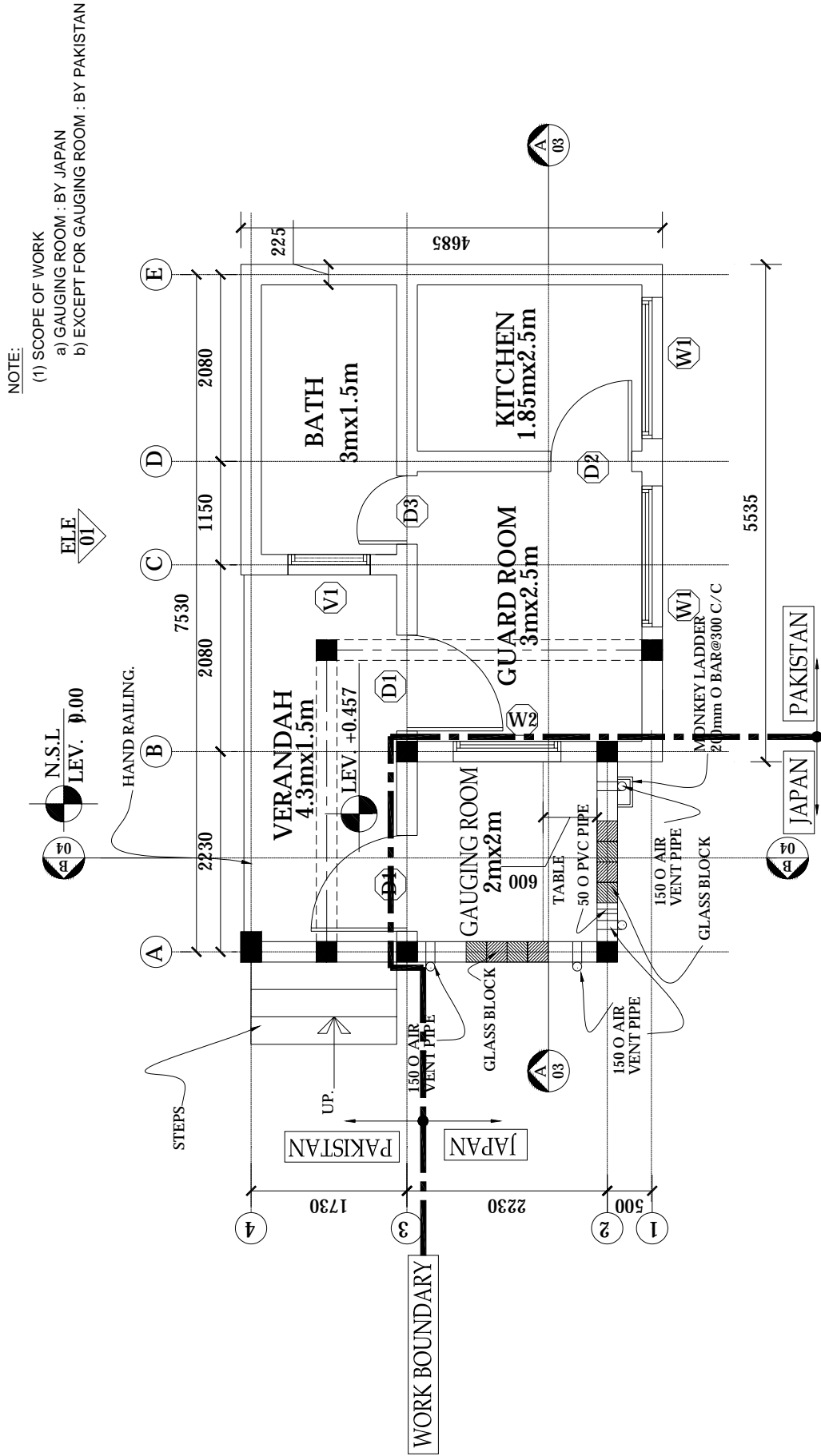
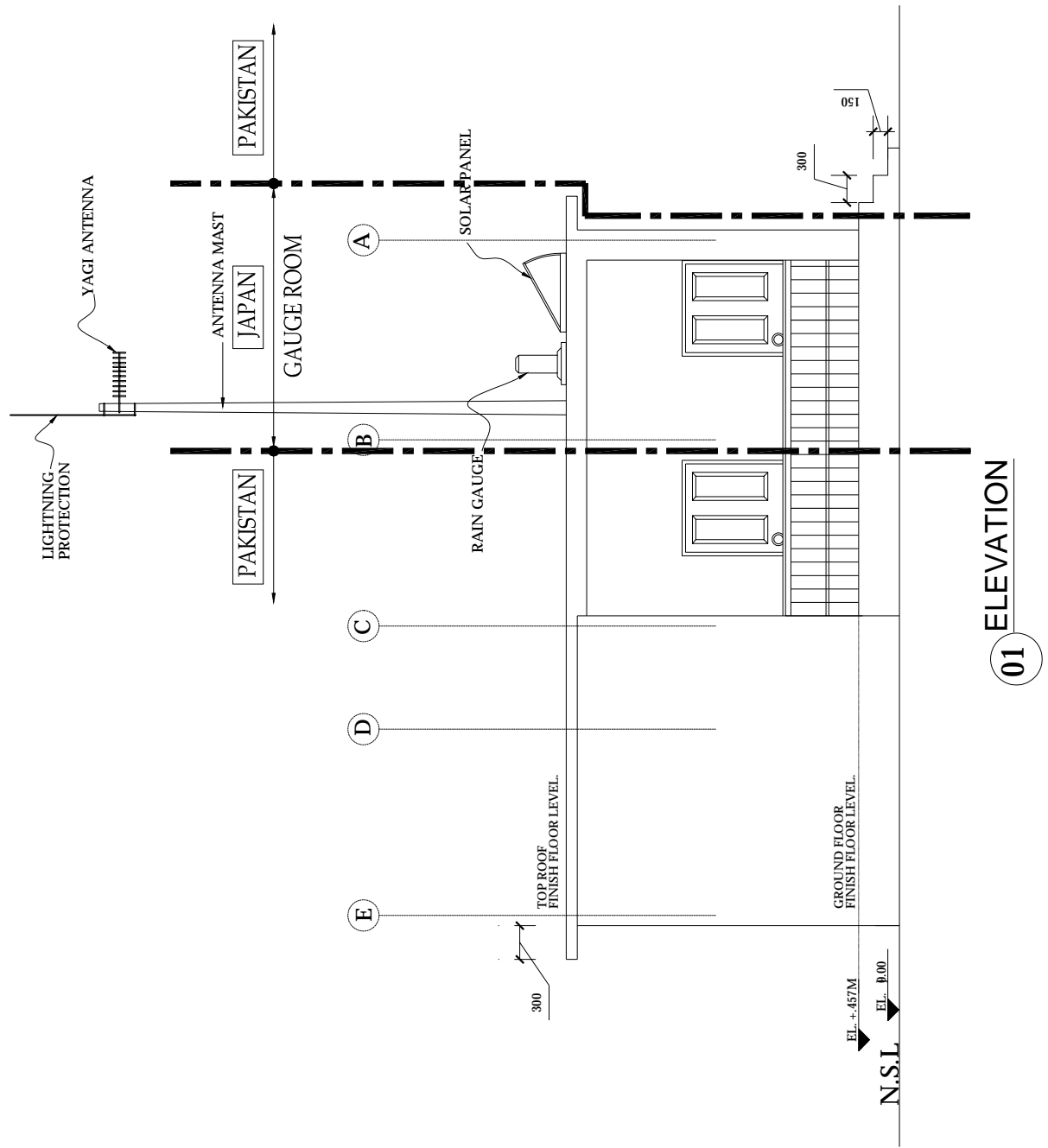

Figure 23 Layout Plan of Rainfall Gauging Station (Bokra)



NOTES:
 1) ALL DIMENSIONS ARE IN MILLIMETRES & METRES
 & LEVELS ARE IN METRES. (U.N.O)

Figure 24 Elevation of Rainfall Gauging Station (Bokra)

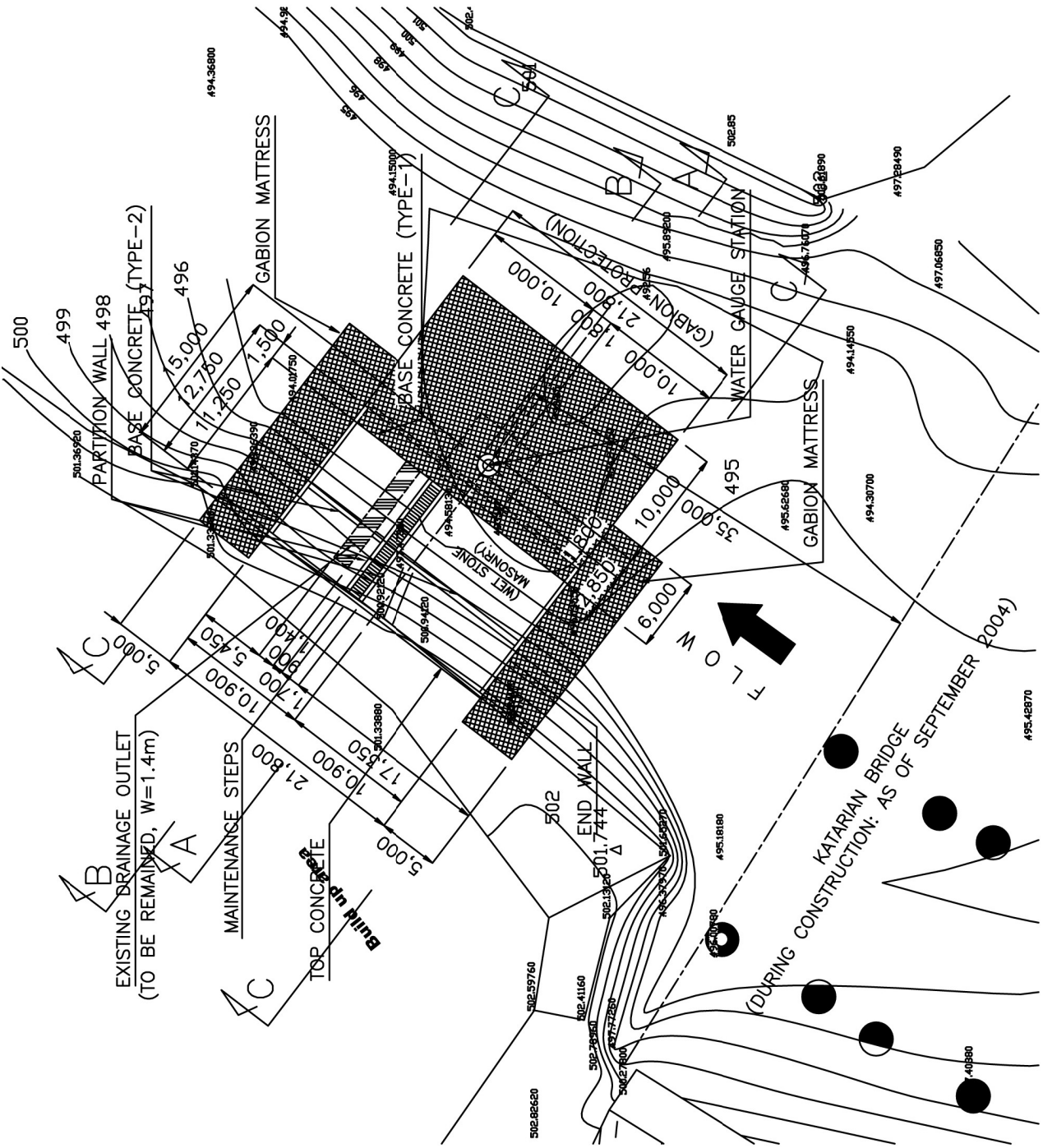

Figure 25 Layout Plan of Water-level Gauging Station (Katarian Bridge)

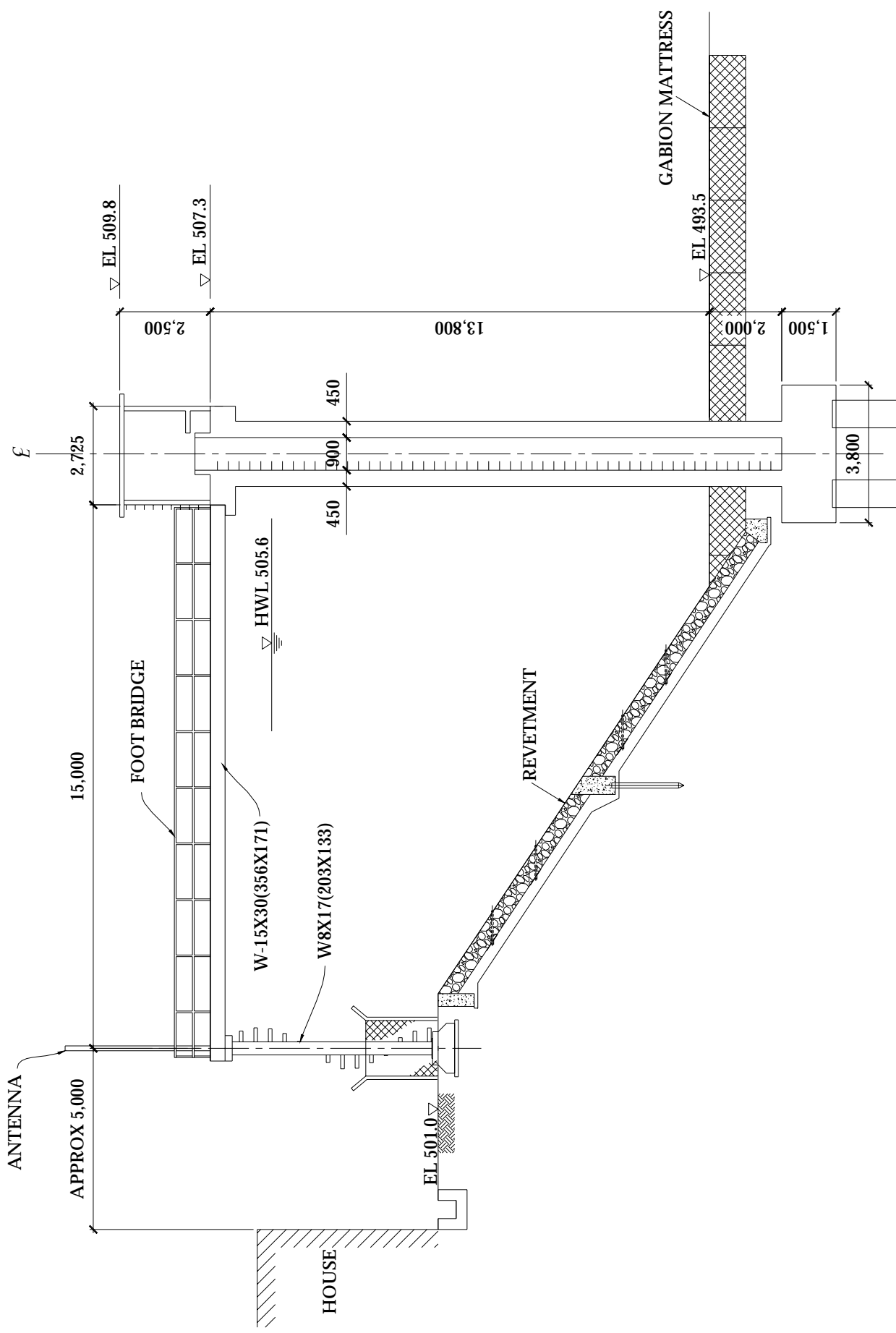

Figure 26 Elevation of Water-level Gauging Station (Katarian Bridge)

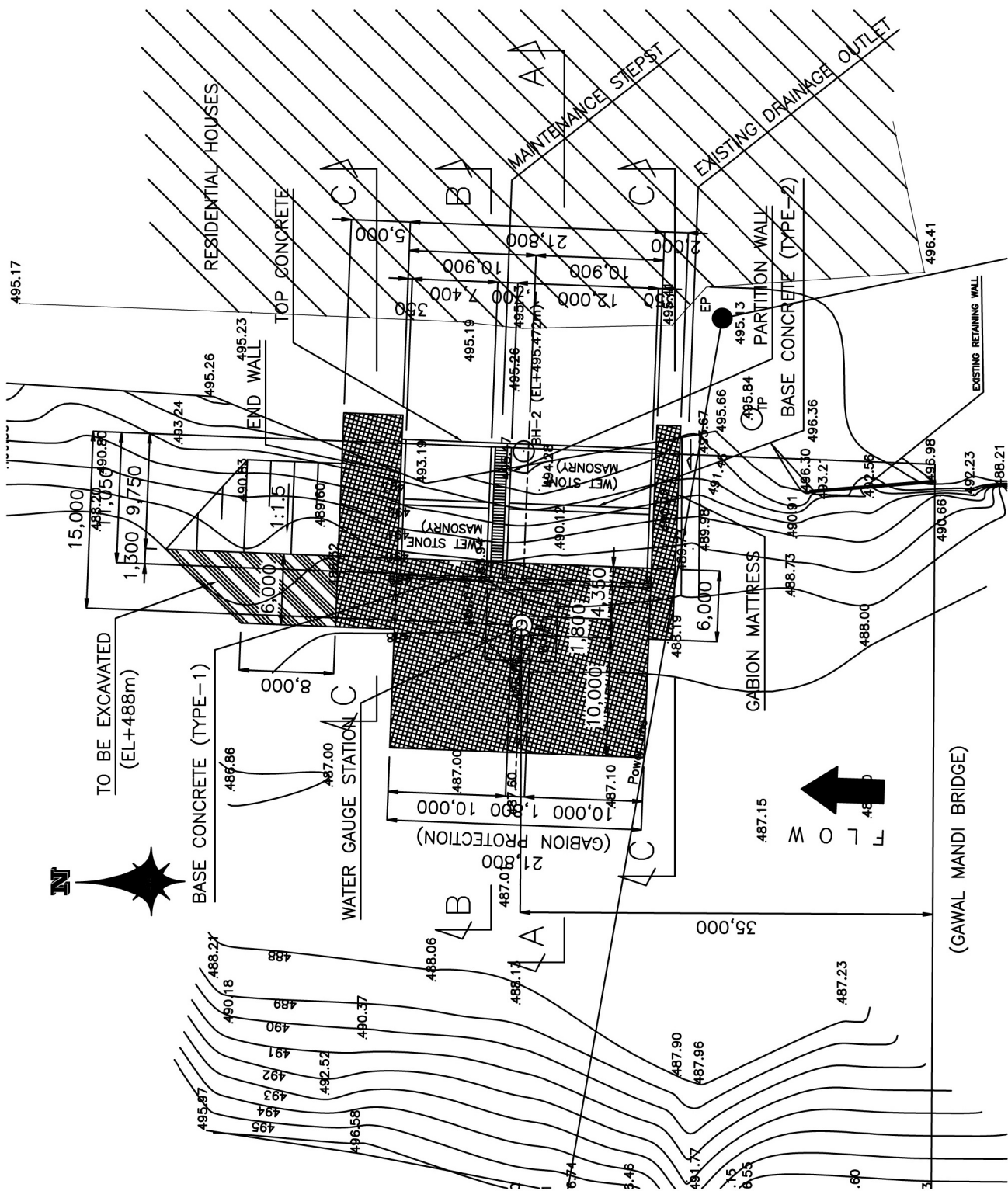

Figure 27 Layout Plan of Water-level Gauging Station (Gawal Mandi Bridge)

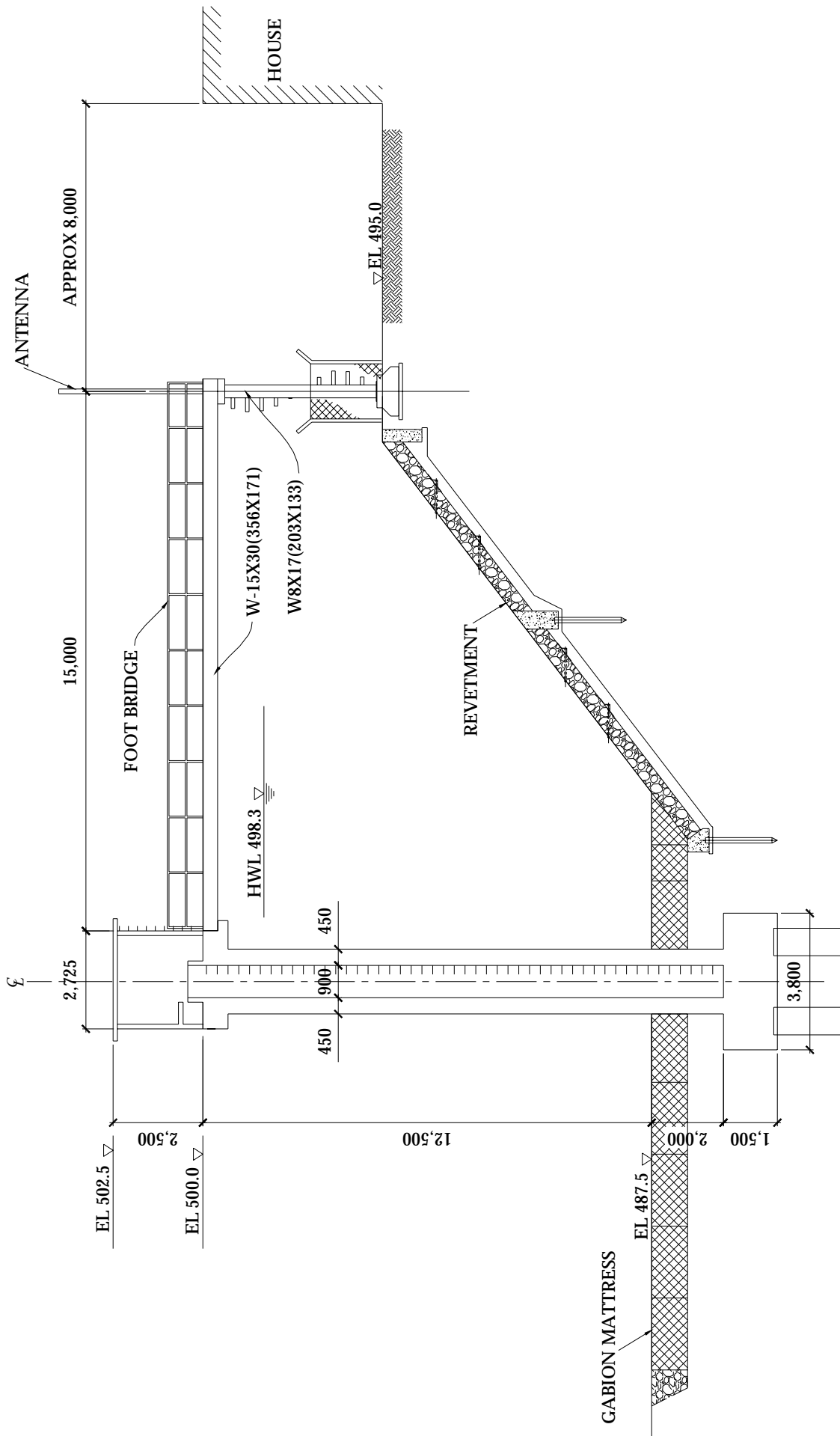

Figure 28 Elevation of Water-level Gauging Station (Gawal Mandi Bridge)

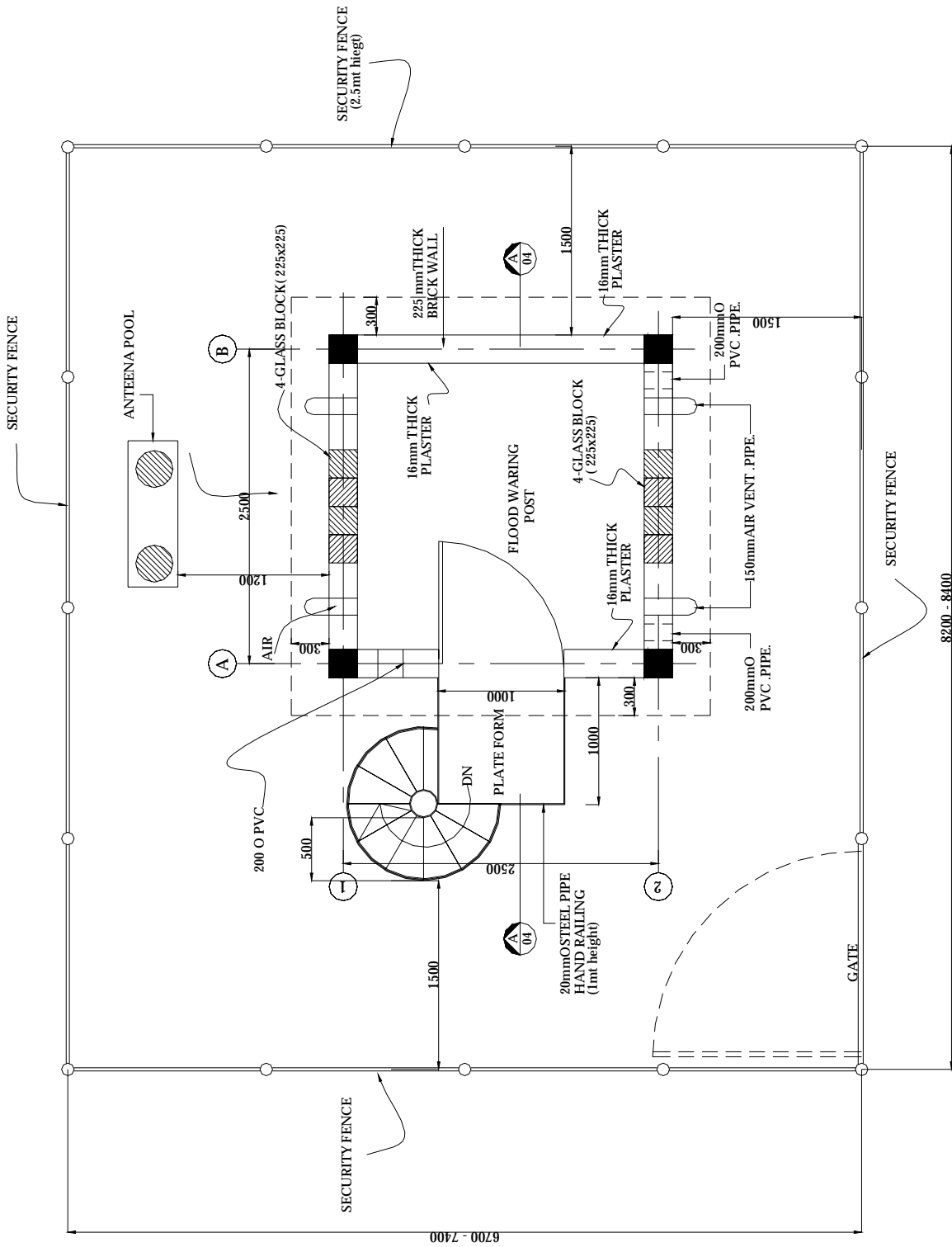
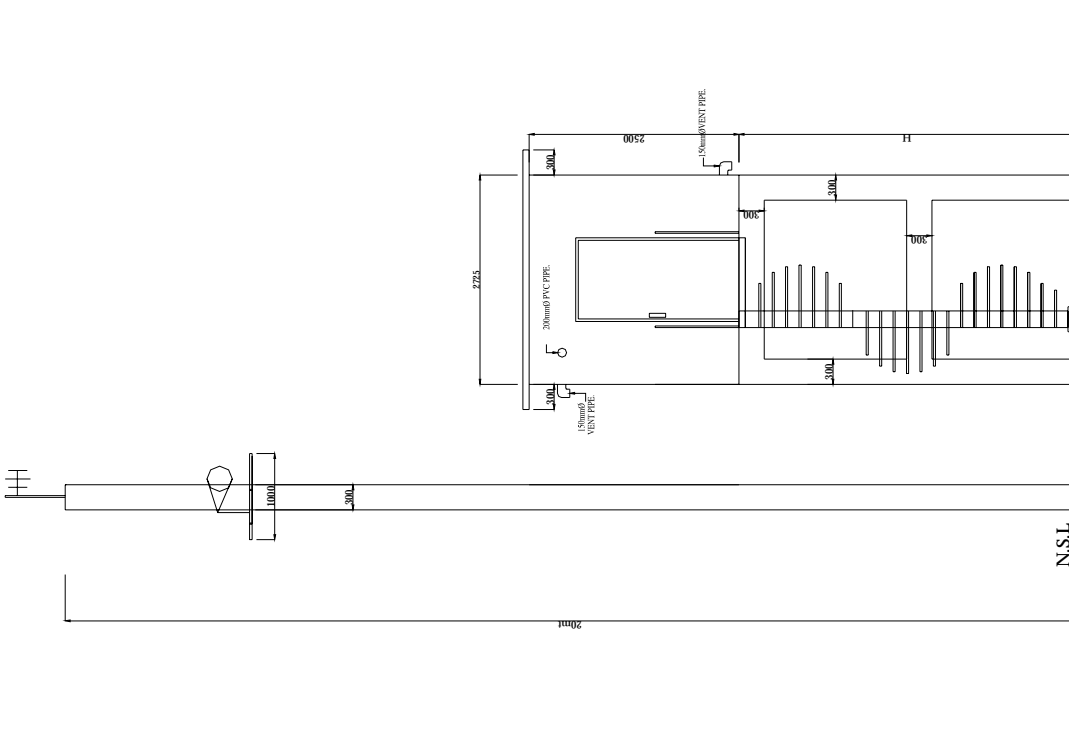

Figure 29 Layout Plan of Warning Post



Warning Post	H (mm)
WP-2	4000
WP-3	6000
WP-4	2000
WP-5	4000
WP-6	7500
WP-7	1000
WP-8	1000
WP-9	5000
WP-10	5000

Figure 30 Elevation of Warning Post