

jica JAPAN INTERNATIONAL COOPERATION AGENCY (JICA)
JAMUNA MULTIPURPOSE BRIDGE AUTHORITY (JMBA)

*The Feasibility Study of
Padoma Bridge in
The People's Republic of BANGLADESH*

FINAL REPORT

Volume 8

DRAWINGS OF PRELIMINARY FACILITY DESIGN

MARCH, 2005

 NIPPON KOEI CO., LTD
in association with
 CONSTRUCTION PROJECT CONSULTANTS, INC.

S D
J R
05-017

jica JAPAN INTERNATIONAL COOPERATION AGENCY (JICA)
JAMUNA MULTIPURPOSE BRIDGE AUTHORITY (JMBA)

FINAL REPORT

(VOLUME VIII : DRAWINGS OF PRELIMINARY FACILITY DESIGN)

**THE FEASIBILITY STUDY OF THE PADMA BRIDGE
THE PEOPLES' REPUBLIC OF BANGLADESH**

MARCH-2005

**NIPPON KOEI CO. LTD.
IN ASSOCIATION WITH
CONSTRUCTION PROJECT CONSULTANTS, INC.**

INDEX OF DRAWINGS

DRAWING NO.	DRAWING TITLE
PDM FS I1	INDEX OF DRAWINGS
PDM FS L1	PROJECT LOCATION MAP
PDM FS A1	TYPICAL CROSS SECTION
PDM FS A2	DETAIL OF PAVEMENT STRUCTURE
PDM FS B1-19	APPROACH ROAD : PLAN AND PROFILE (Km.0+000~1+000 to Km.17+000~17+743)
PDM FS B20-25	: MINOR WATERWAY BRIDGE (GENERAL VIEW & PLAN)
PDM FS B26	: GENERAL LAYOUT OF MINOR STRUCTURES
PDM FS B27	: PLAN OF TOLL GATE AND SERVICE AREA
PDM FS B28	: INCIDENTAL STRUCTURE (ROAD UNDERPASS)
PDM FS B29	: INCIDENTAL STRUCTURE (DRAINAGE STRUCTURE)
PDM FS C1-2	PADMA MAIN BRIDGE : STANDARD CROSS SECTION
PDM FS C3-4	: SIDE VIEW & PLAN (Alternative H1, H2)
PDM FS C5-10	: GENERAL VIEW (Alternative H1, H2)
PDM FS C11-12	: SIDE VIEW & PLAN (Alternative HR, HR2)
PDM FS C13-18	: GENERAL VIEW (Alternative HR, HR2)
PDM FS C19	: SIDE VIEW & PLAN (Alternative H3)
PDM FS C20	: GENERAL VIEW (Alternative H3)
PDM FS D1	RIVER WORKS : GENERAL PLAN
PDM FS D2-5	: STANDARD DESIGN OF REVETMENT (Type A1, A2, B1, B2)
PDM FS D6	: MISCELLANEOUS DETAILS
PDM FS D7-9	: PLAN OF RIVER WORKS (For Site L1, L2, L3, R1, R2, R3, R4)
PDM FS D10-12	: LONGITUDINAL PROFILE
PDM FS D13-15	: TYPICAL CROSS SECTION

PROJECT LOCATION MAP

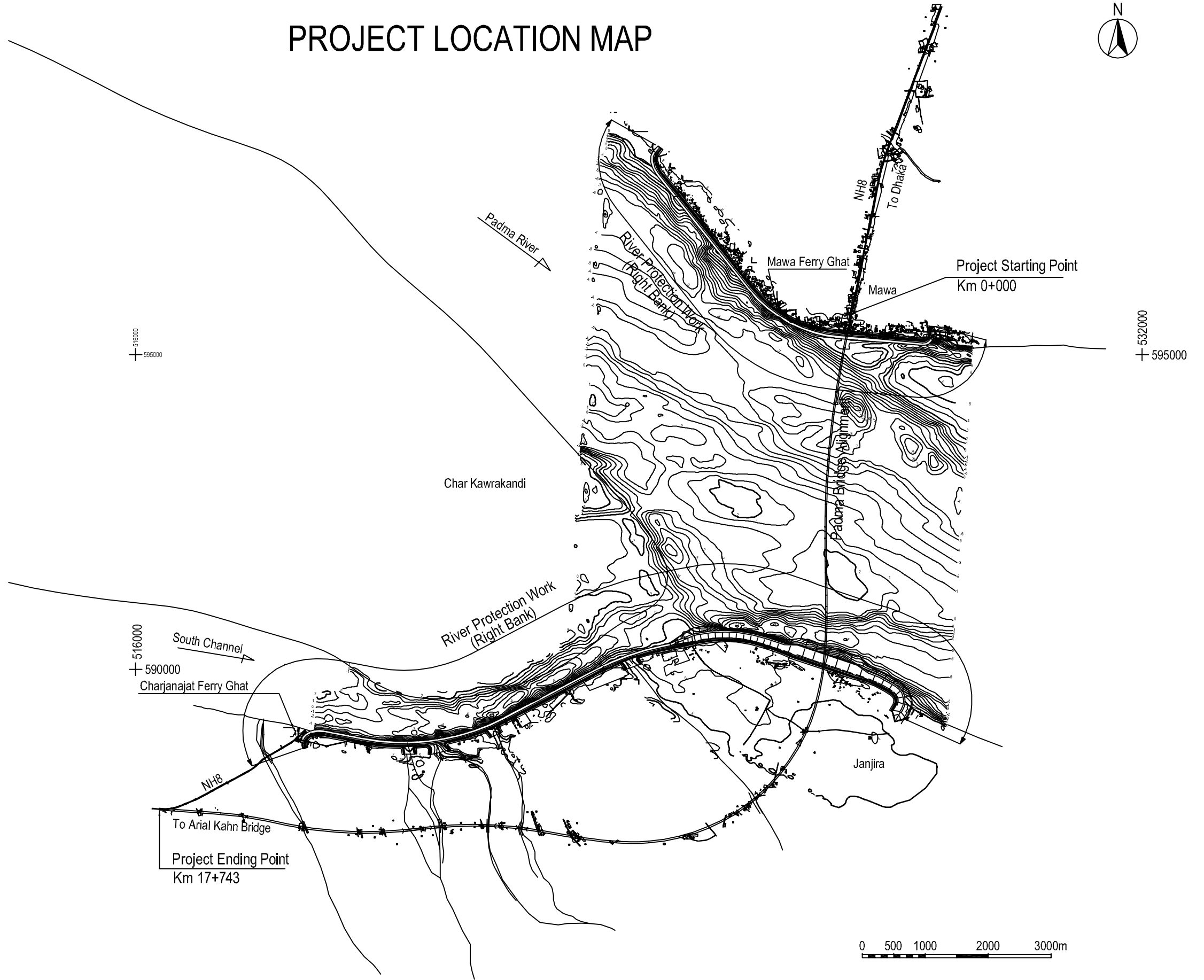
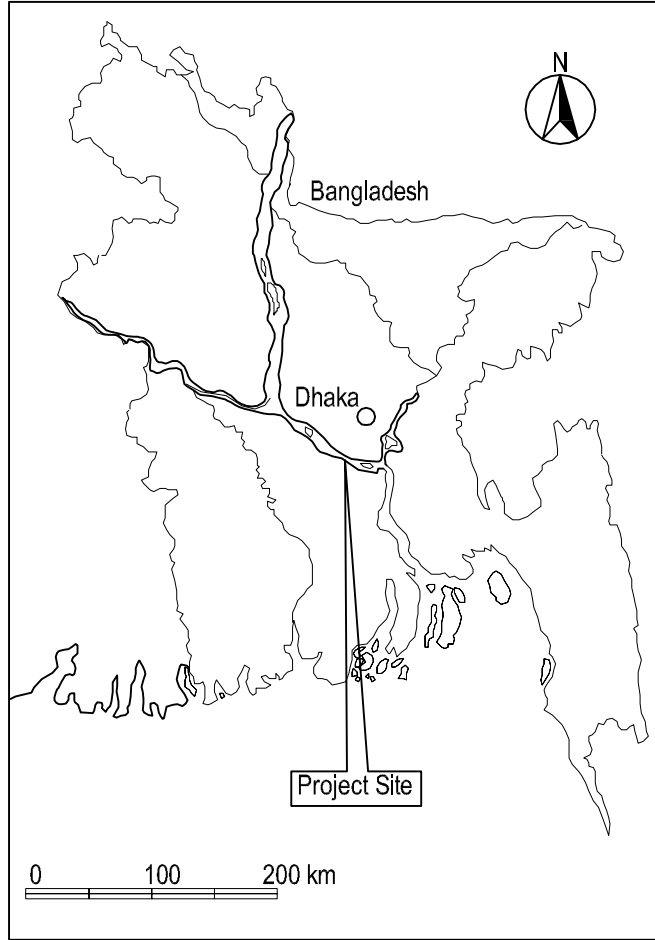

Typical Cross Section

MAIN BRIDGE (WITHOUT RAILWAY PROVISION)

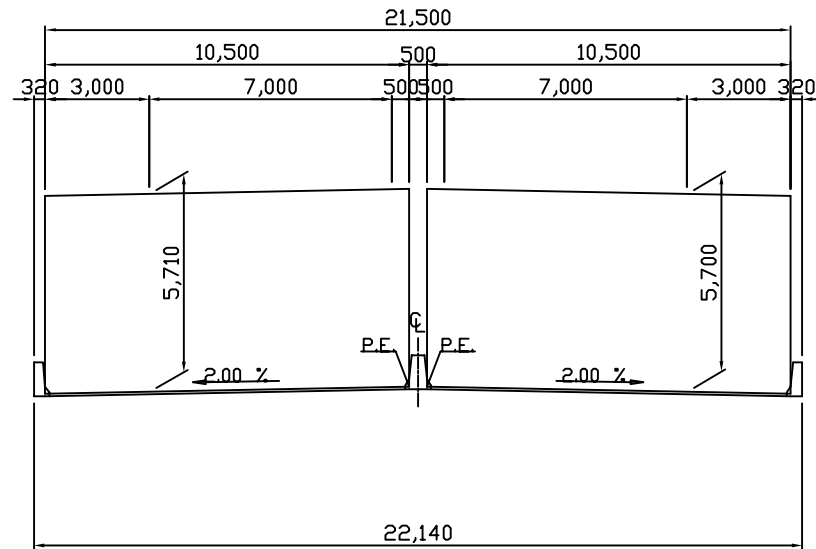

MAIN BRIDGE (WITH RAILWAY PROVISION)

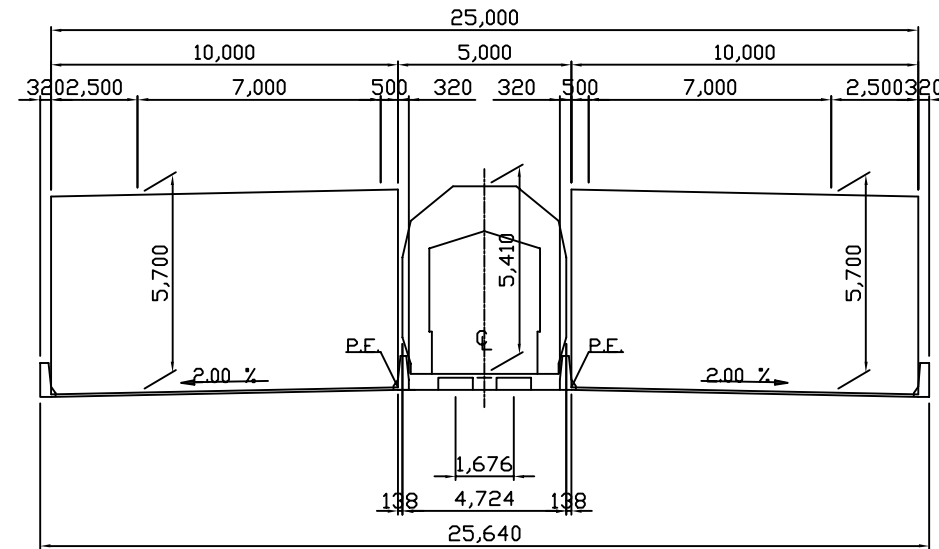

APPROACH ROAD

ROW Boundary

Right of Way (ROW) = 100.0m

ROW Boundary

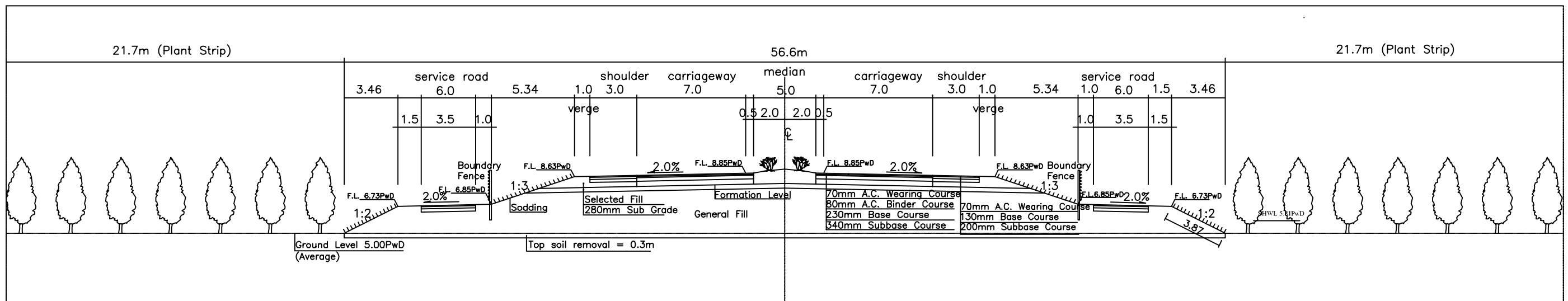

JAMUNA MULTIPURPOSE BRIDGE AUTHORITY
THE PEOPLE'S REPUBLIC OF BANGLADESH

THE FEASIBILITY STUDY OF PADMA BRIDGE
IN THE PEOPLE'S REPUBLIC OF BANGLADESH

JICA JAPAN INTERNATIONAL COOPERATION AGENCY (JICA)
NK NIPPON KOEI CO., LTD. in Association with
CPC CONSTRUCTION PROJECT CONSULTANTS, INC.

TITLE :	DATE :	SHEET NO.
Typical Cross Section	MARCH-2005	PDM FS A1

Detail of Pavement Structure

Approach Road

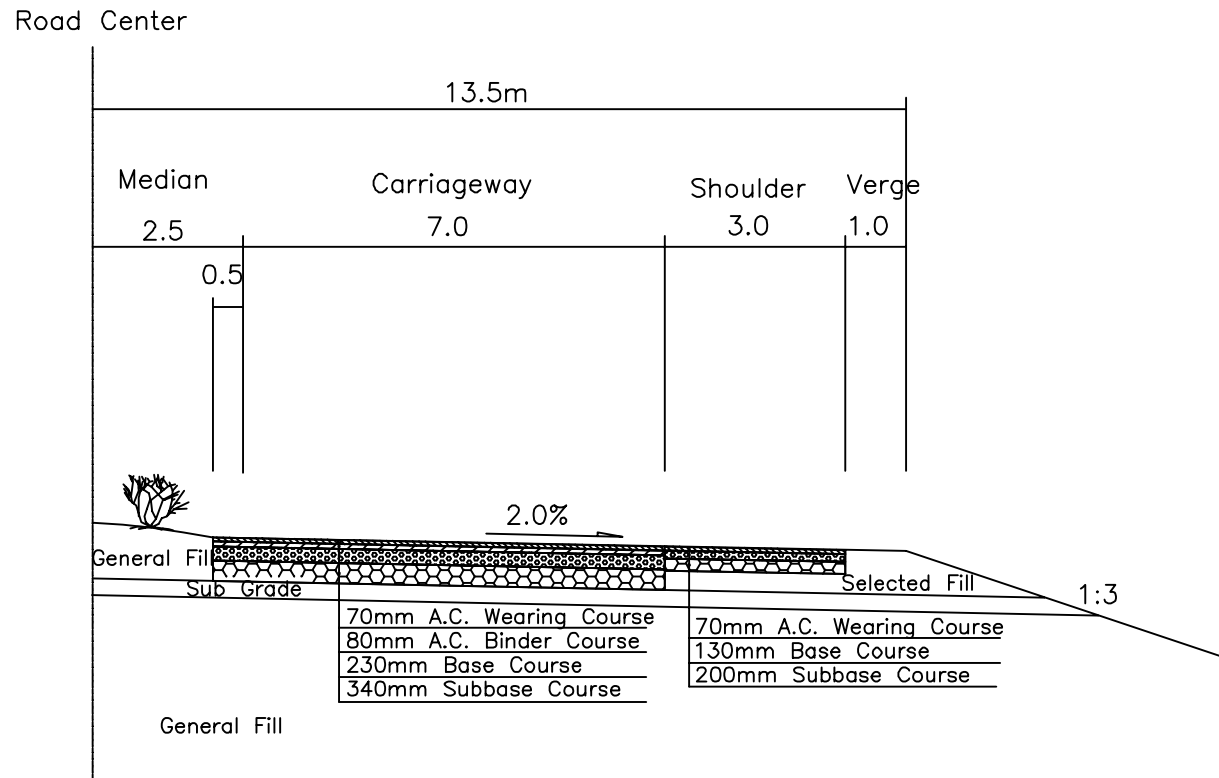

Main Bridge

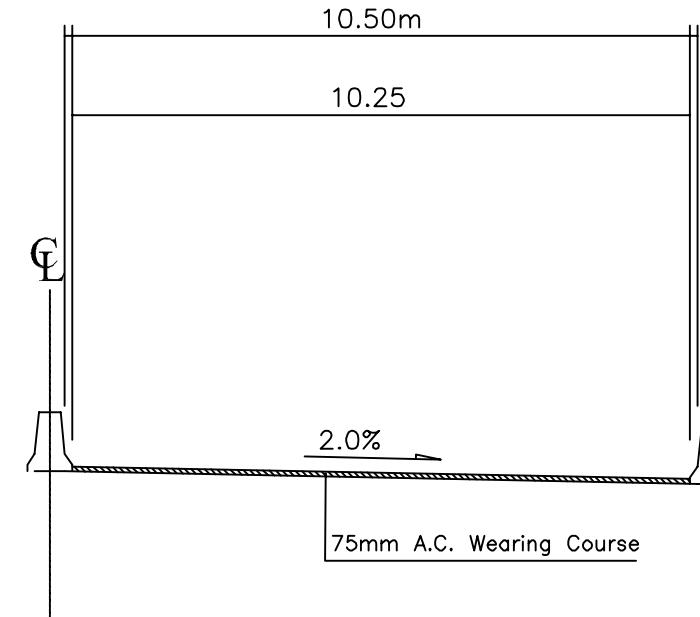

Service Road

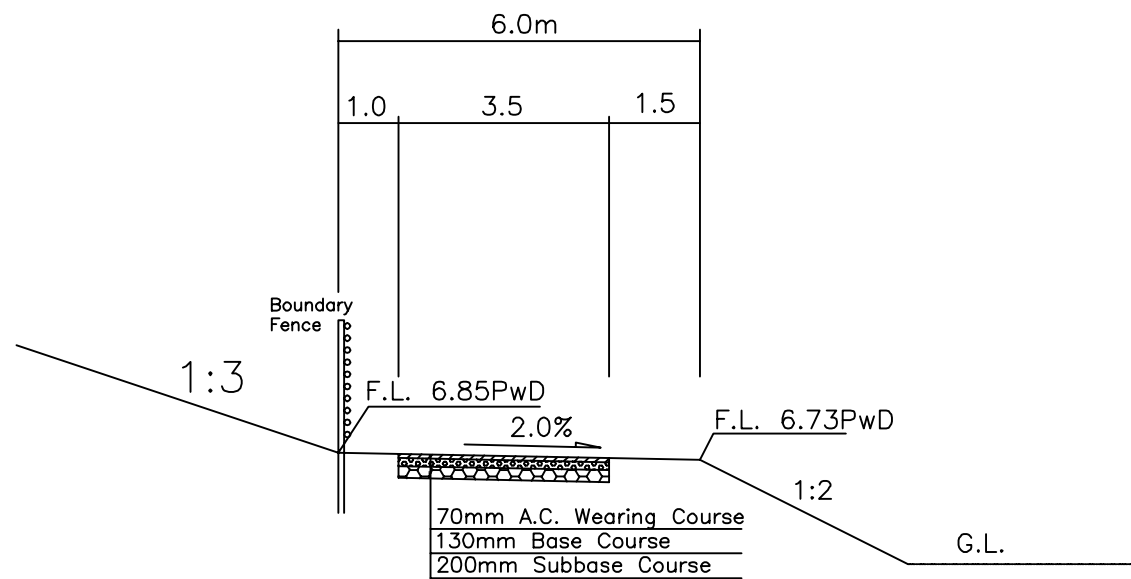

S.A. Ramp

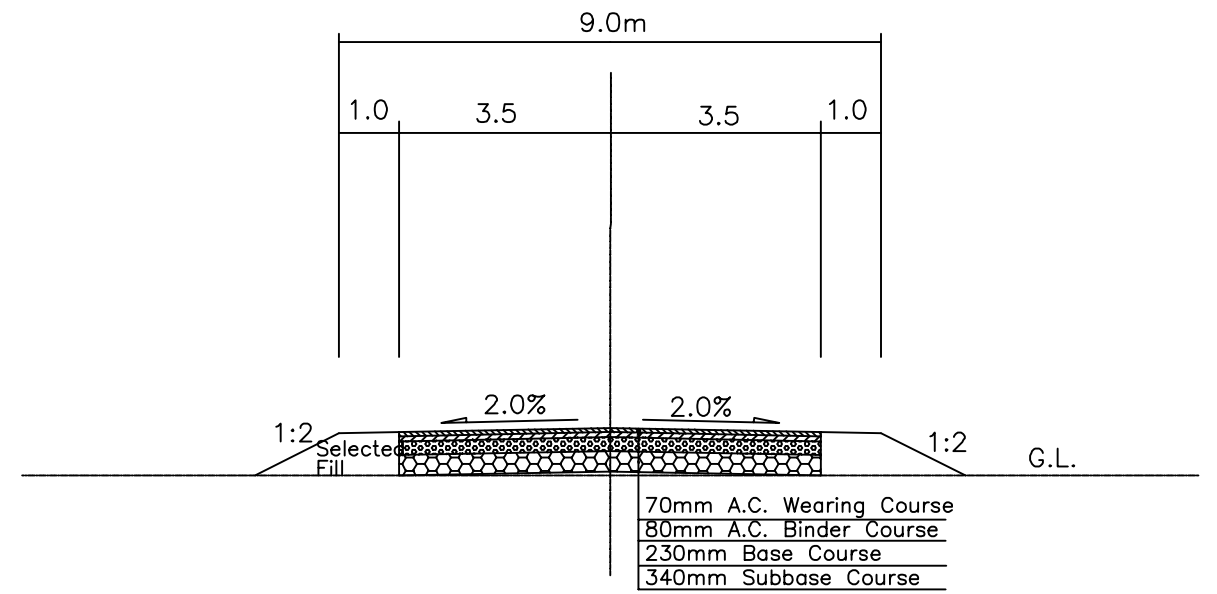

Legend :

- | | | | |
|-----------------|--|---------------------------------------|--|
| Paved Edge | | Tube Well | |
| Earth Road | | Grave Yard | |
| Footpath | | Mosque | |
| Soling Road | | Educational Place | |
| River Bank | | Toilet | |
| Cannel | | Building (Permanent) | |
| Fence | | Semipucca (Semi Permanent) | |
| Electric Line | | Shed (Temporary Building) | |
| Gate | | Wall | |
| Pond | | Ditch | |
| Religious Place | | (Natural Depression) | |
| Paddy Field | | Brick Field Area | |
| Box Culvert | | Petrol Pump | |
| Bridge | | Car Wash | |
| Pipe Culvert | | Homestead | |
| Electric Post | | Bore Hole | |
| Light Post | | (Project Geo.Investigation Bore hole) | |
| Tree | | Property owner | |
| Control Point | | Md. X.. | |

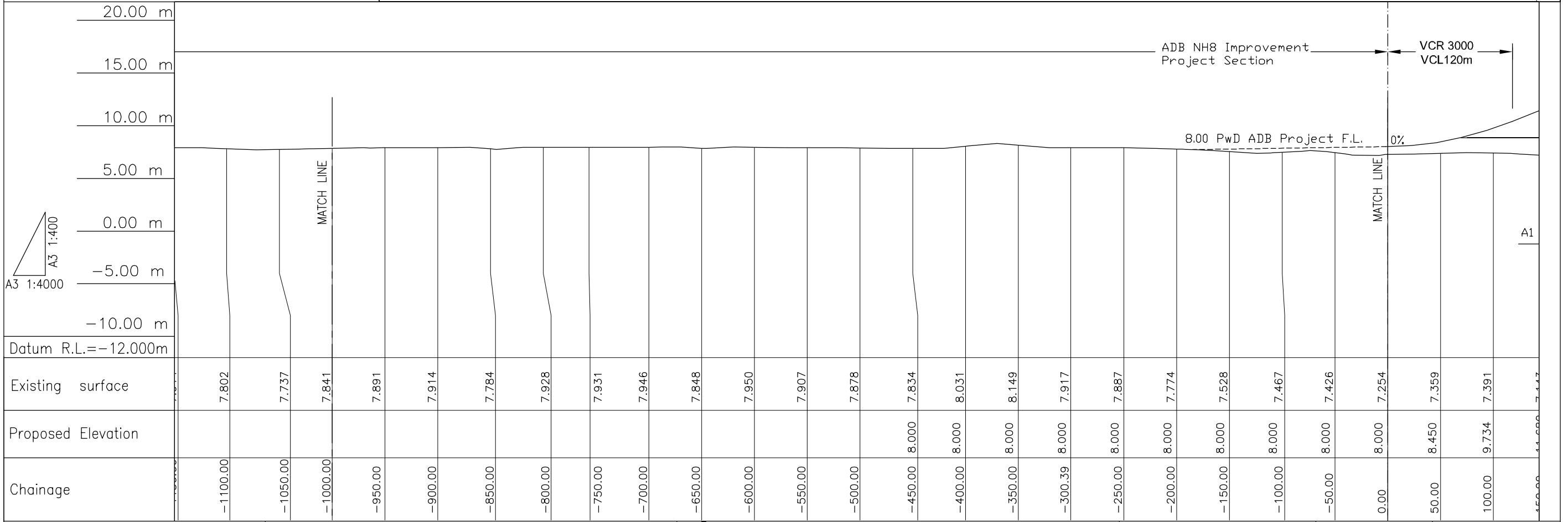
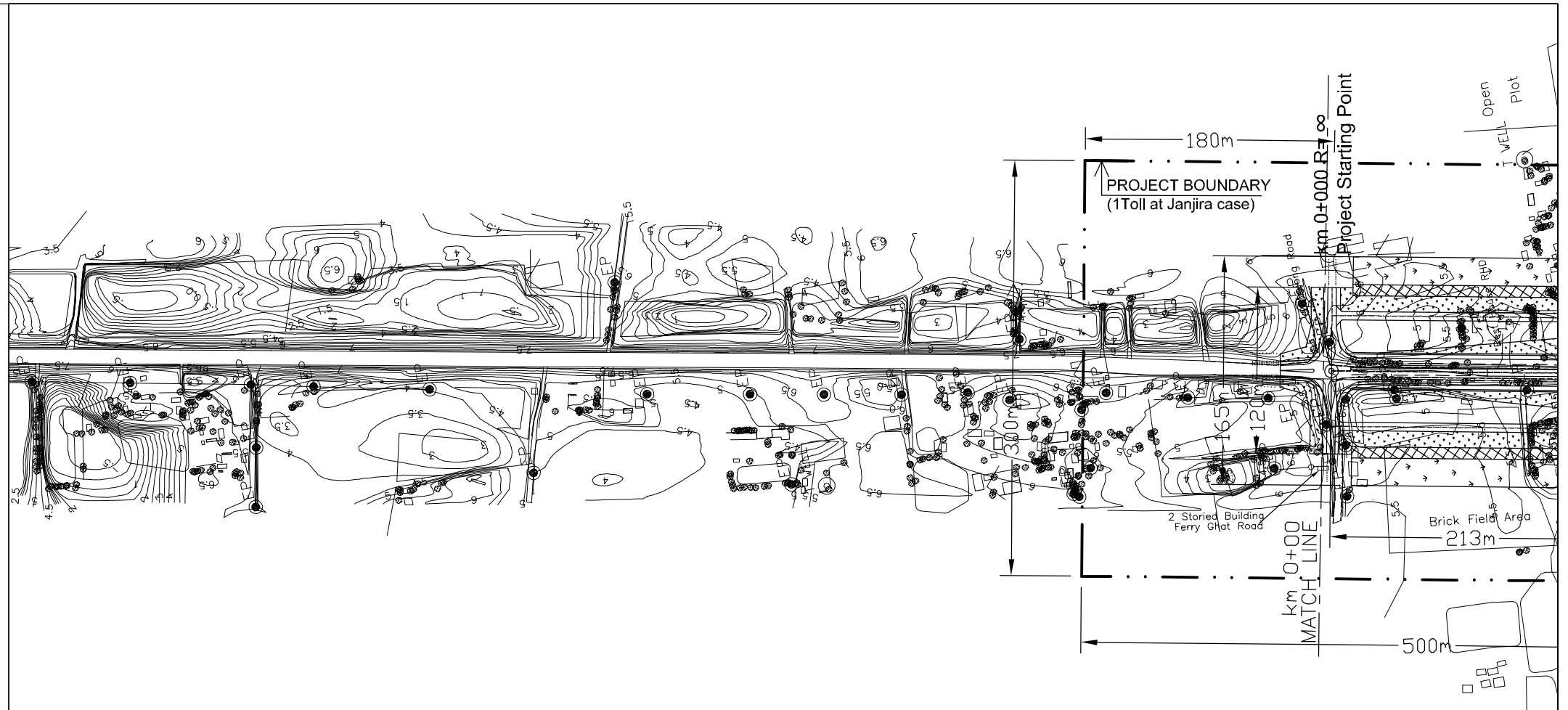

Legend :

- | | | | |
|-----------------|--|---------------------------------------|--|
| Paved Edge | | Tube Well | |
| Earth Road | | Grave Yard | |
| Footpath | | Mosque | |
| Soling Road | | Educational Place | |
| River Bank | | Toilet | |
| Cannel | | Building (Permanent) | |
| Fence | | Semipucca (Semi Permanent) | |
| Electric Line | | Shed (Temporary Building) | |
| Gate | | Wall | |
| Pond | | Ditch | |
| Religious Place | | (Natural Depression) | |
| Paddy Field | | Brick Field Area | |
| Box Culvert | | Petrol Pump | |
| Bridge | | Car Wash | |
| Pipe Culvert | | Homestead | |
| Electric Post | | Bore Hole | |
| Light Post | | (Project Geo.Investigation Bore hole) | |
| Tree | | Property owner | |
| Control Point | | | |

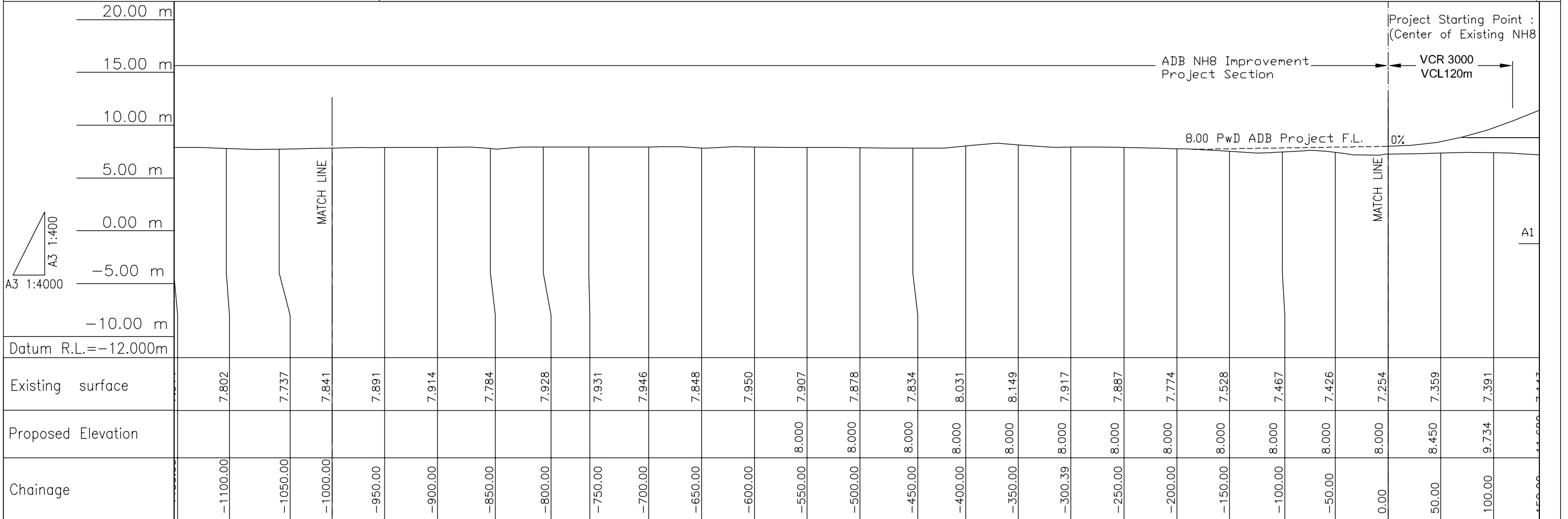
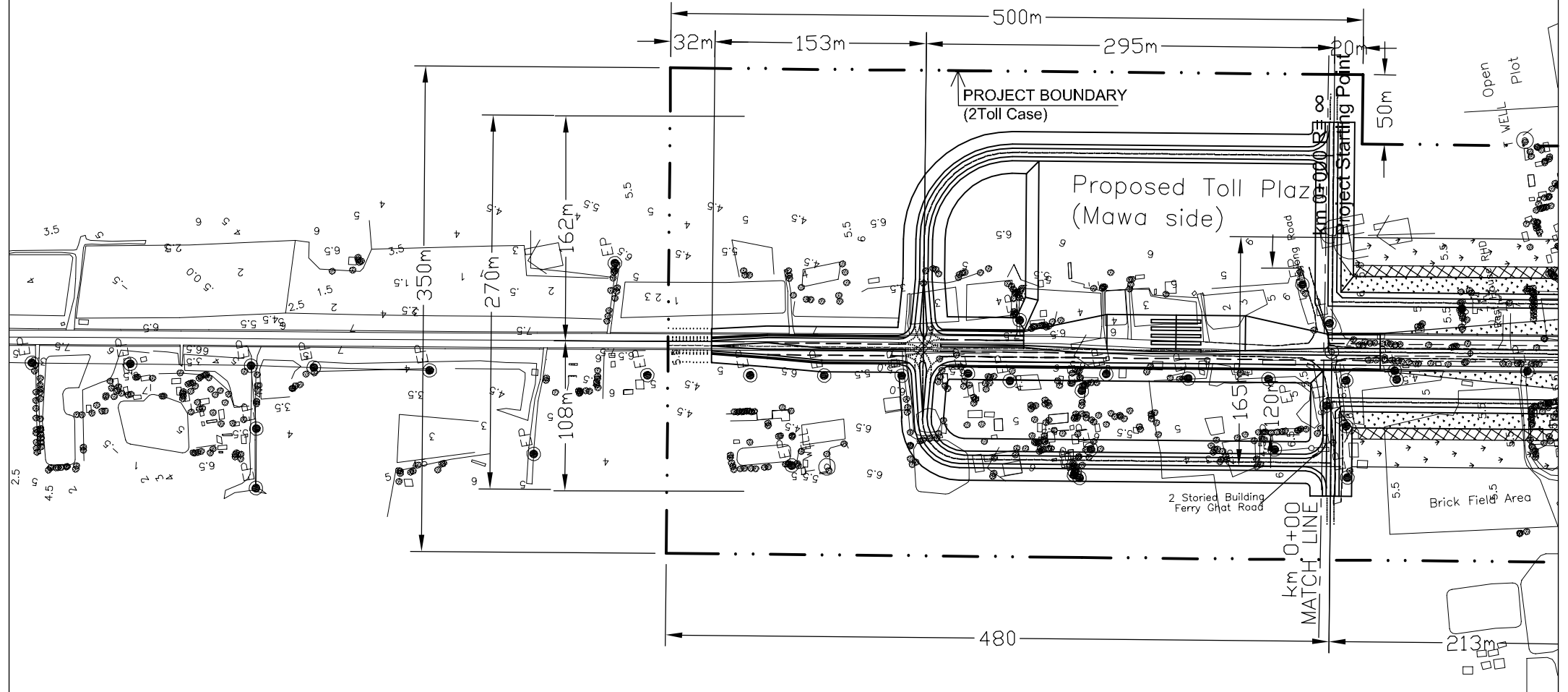

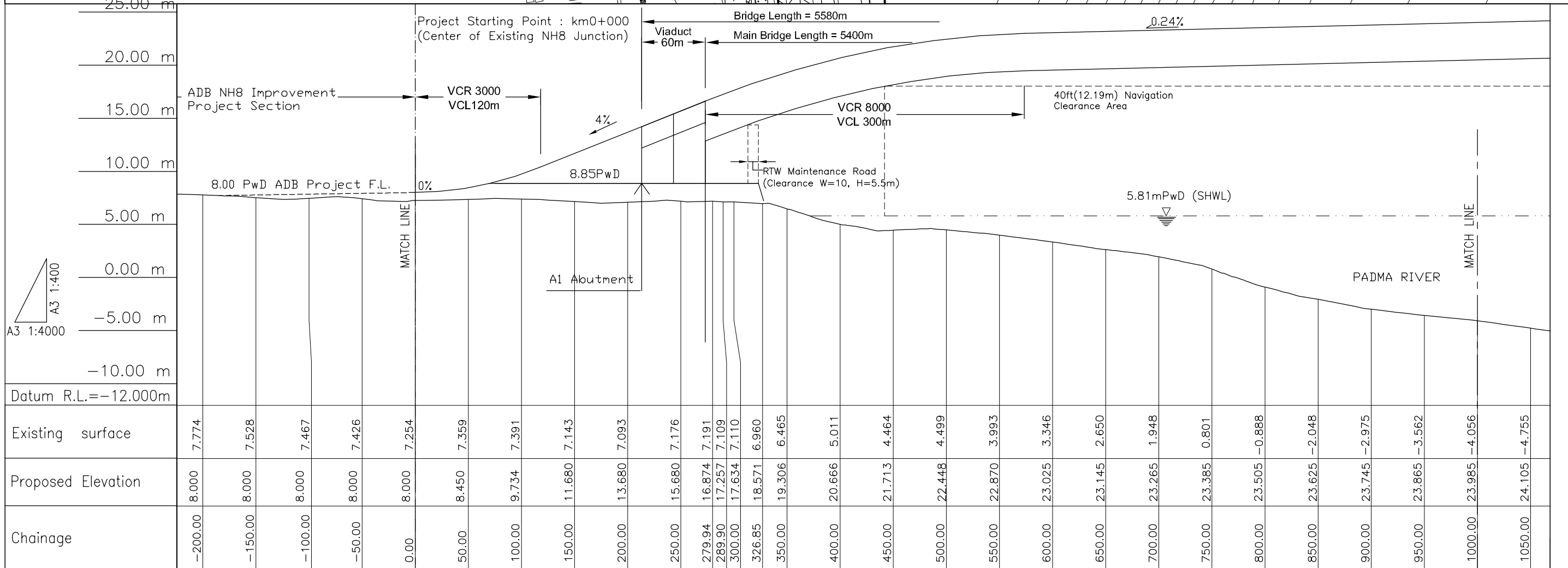
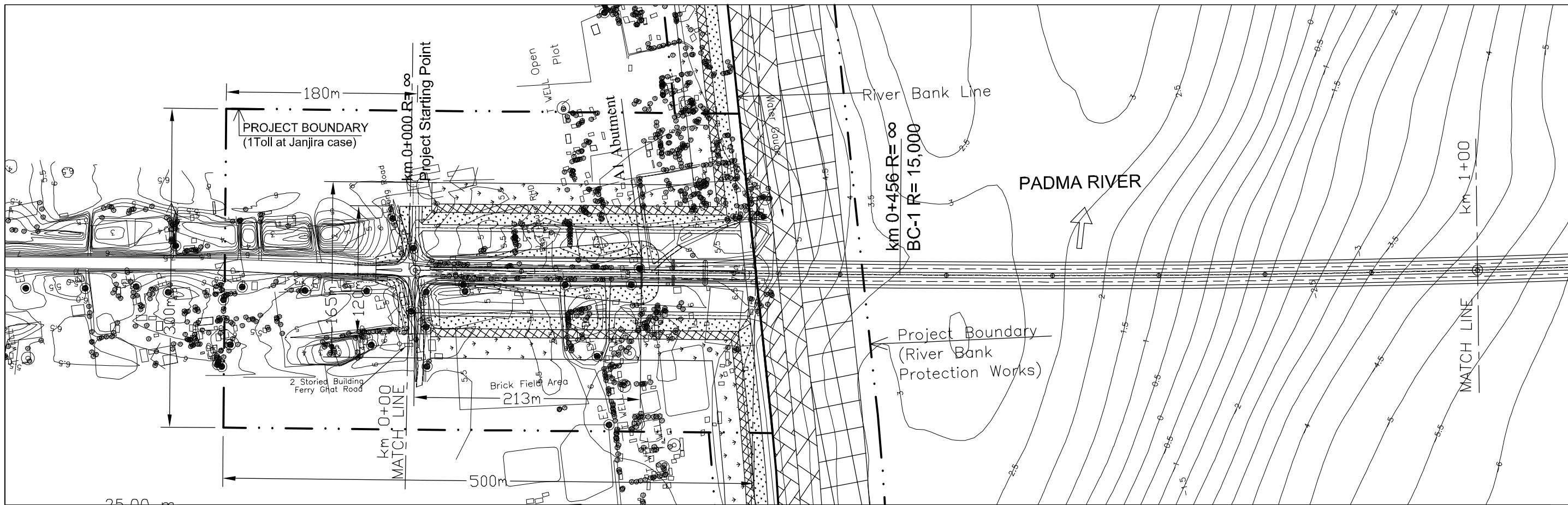

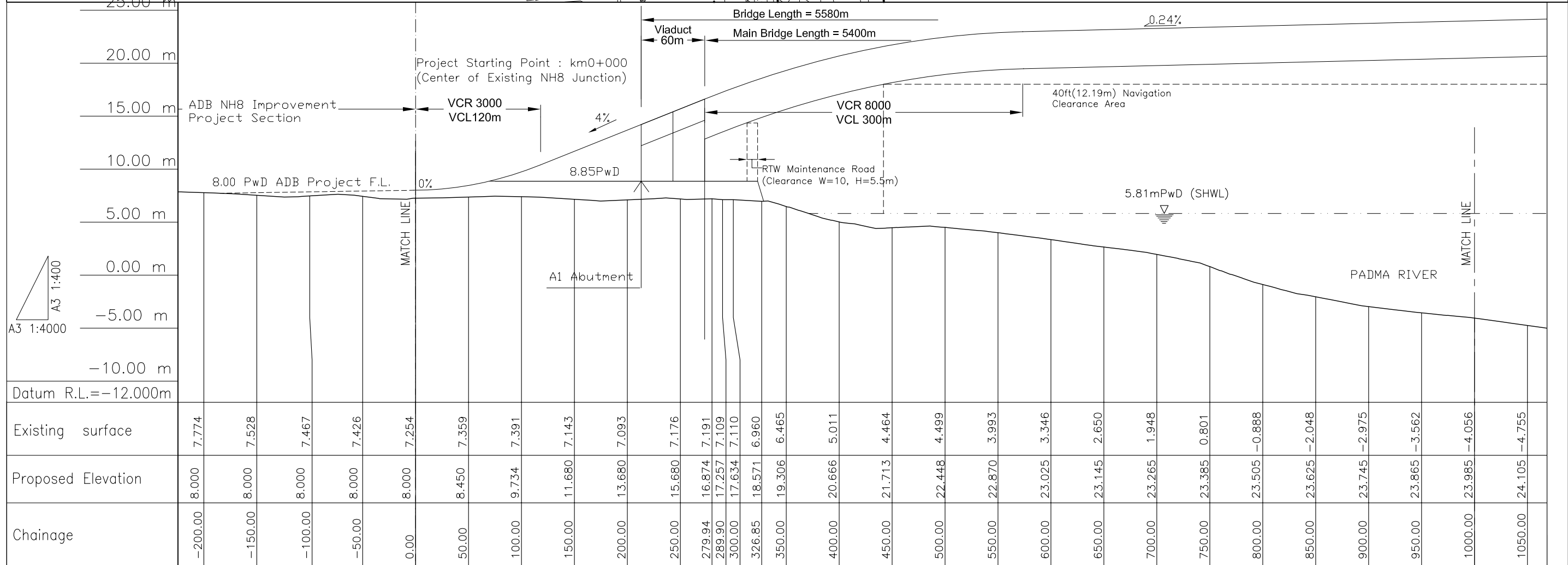
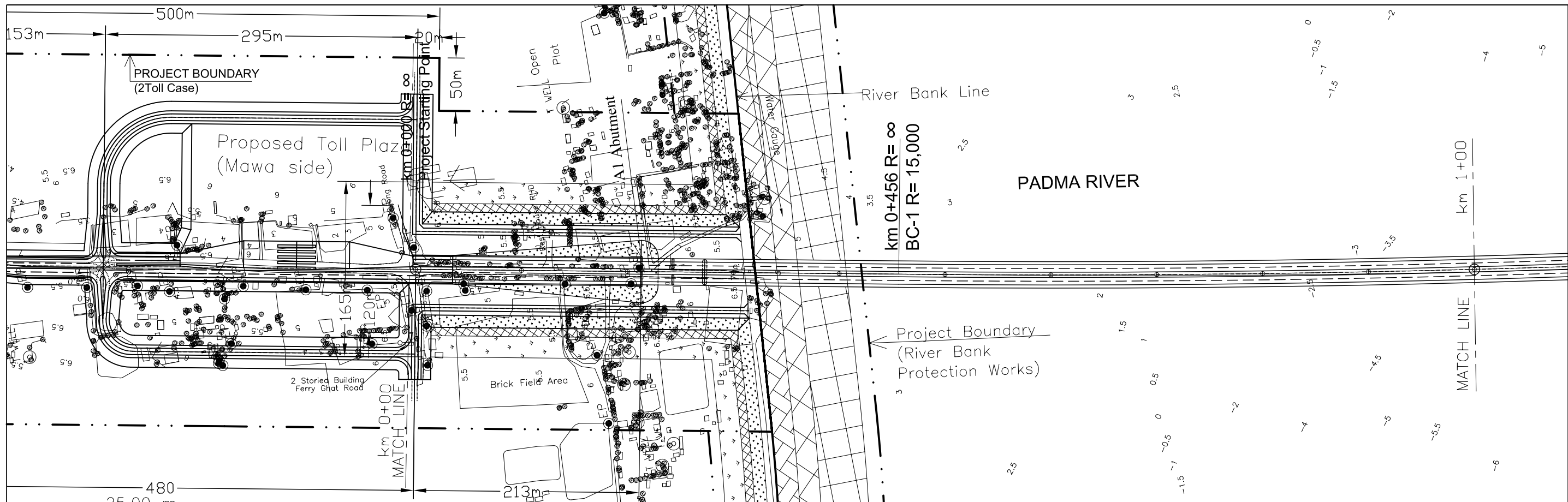

JAMUNA MULTIPURPOSE BRIDGE AUTHORITY THE PEOPLE REPUBLIC OF BANGLADESH	THE FEASIBILITY STUDY ON THE CONSTRUCTION OF THE BRIDGE OVER THE PADMA RIVER IN THE PEOPLE'S REPUBLIC OF BANGLADESH		JAPAN INTERNATIONAL COOPERATION AGENCY (JICA) NIPPON KOIL CO. LTD IN ASSOCIATION WITH CONSTRUCTION PROJECT CONSULTANTS, INC	TITLE Plan and Longitudinal Section of Road Alignment (at Mawa) Scale: Hor= 1:4000 Ver= 1:400	DATE: MARCH-2005	SHEET NO. PDM FS B2(2)

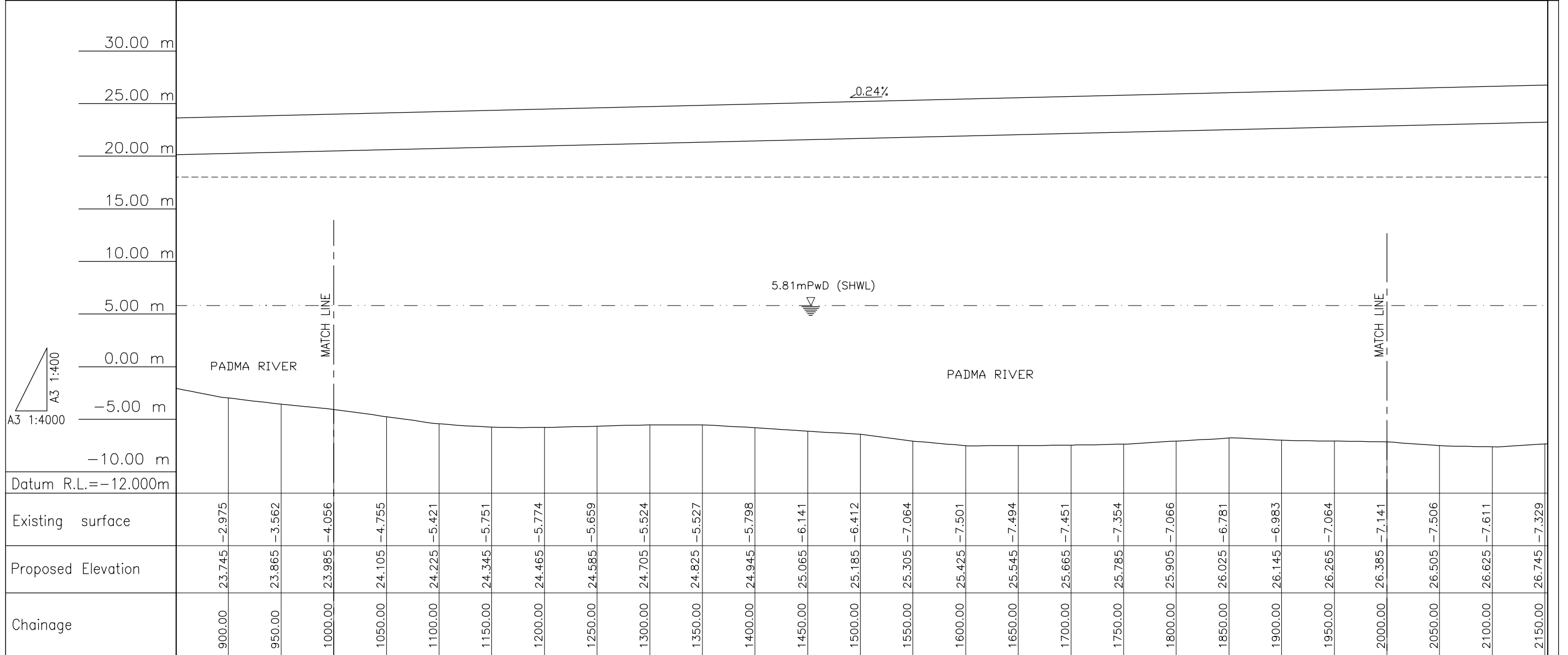
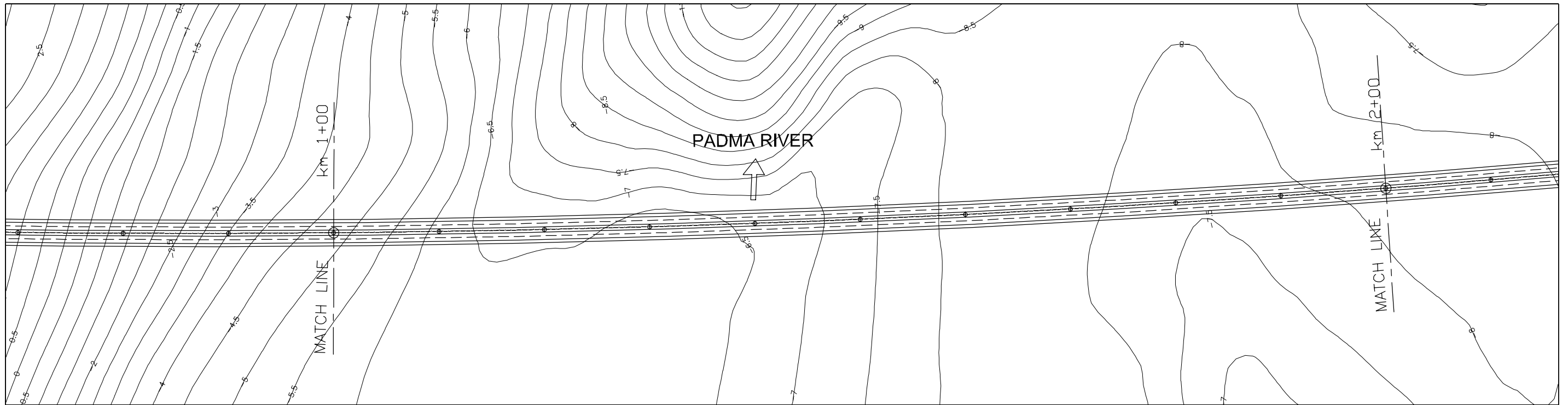

JAMUNA MULTIPURPOSE BRIDGE AUTHORITY THE PEOPLE REPUBLIC OF BANGLADESH	THE FEASIBILITY STUDY OF PADMA BRIDGE IN THE PEOPLE'S REPUBLIC OF BANGLADESH		JAPAN INTERNATIONAL COOPERATION AGENCY (JICA) NIPPON KOEI CO. LTD IN ASSOCIATION WITH CONSTRUCTION PROJECT CONSULTANTS, INC	TITLE	DATE:	SHEET NO.
				Plan and Longitudinal Section of Road Alignment (on the Padma River) Scale: Hor= 1:4000 Ver= 1:400	MARCH-2005	PDM FS B3

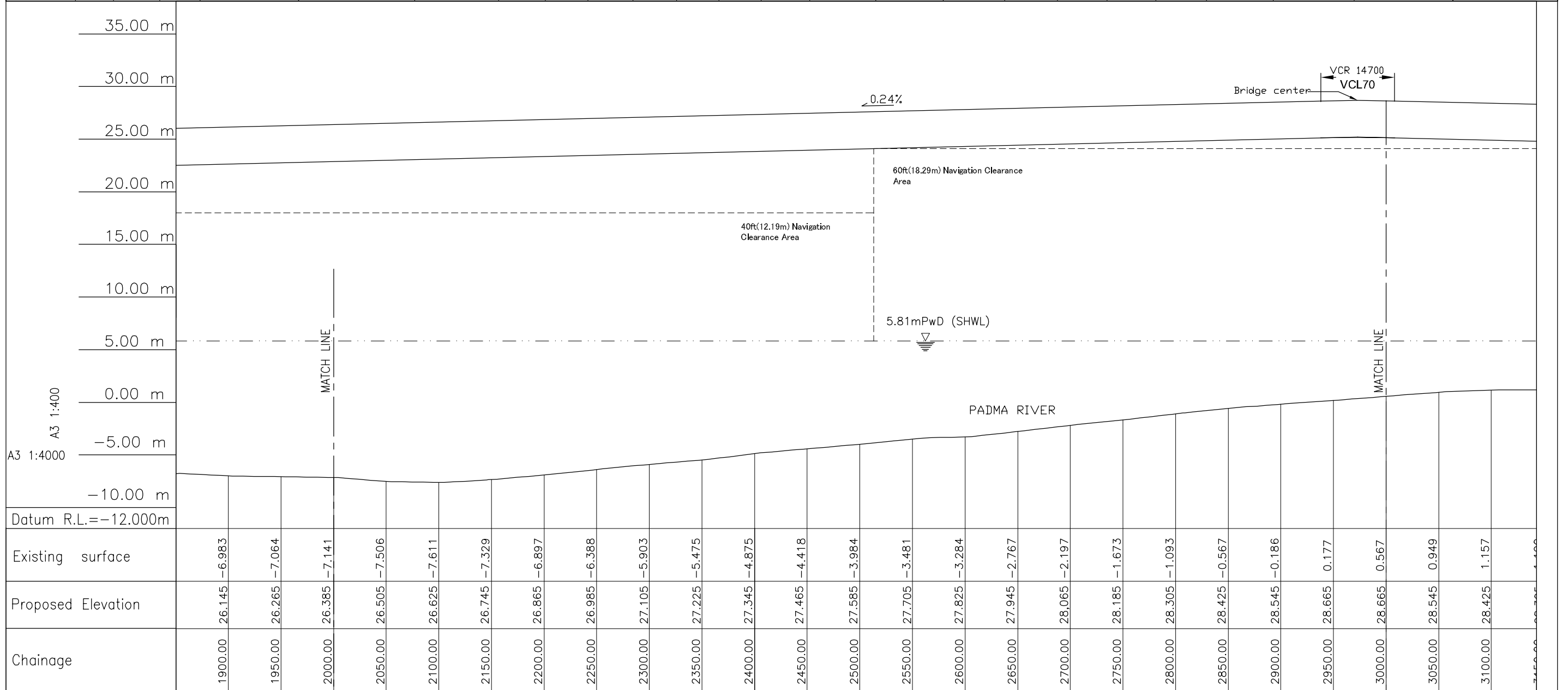
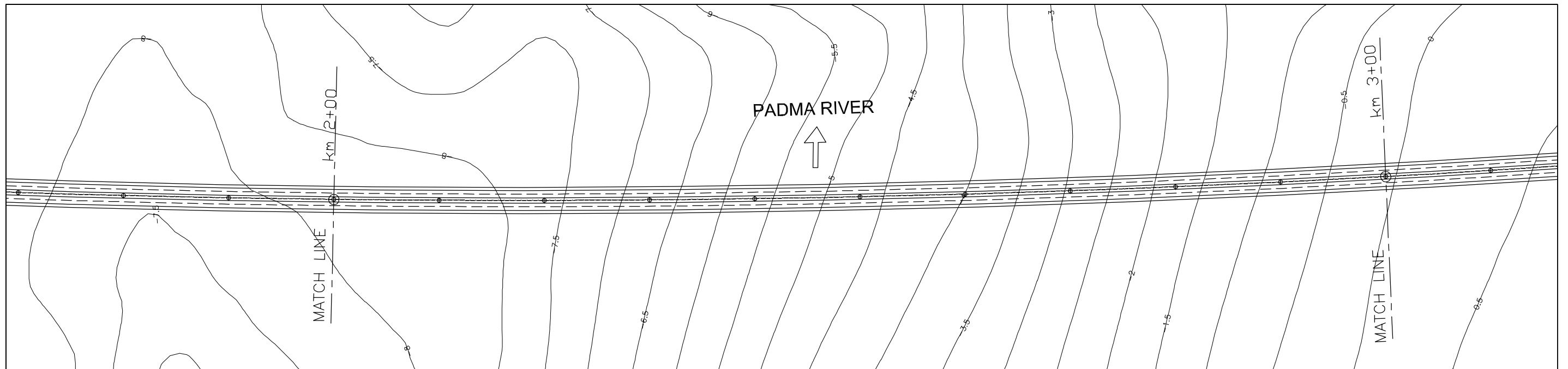

JAMUNA MULTIPURPOSE BRIDGE AUTHORITY THE PEOPLE REPUBLIC OF BANGLADESH	THE FEASIBILITY STUDY OF PADMA BRIDGE IN THE PEOPLE'S REPUBLIC OF BANGLADESH		JAPAN INTERNATIONAL COOPERATION AGENCY (JICA) NIPPON KOEI CO. LTD IN ASSOCIATION WITH CONSTRUCTION PROJECT CONSULTANTS, INC	TITLE	DATE:	SHEET NO.
				Plan and Longitudinal Section of Road Alignment (on the Padma River) Scale: Hor= 1:4000 Ver= 1:400	MARCH-2005	PDM FS B4

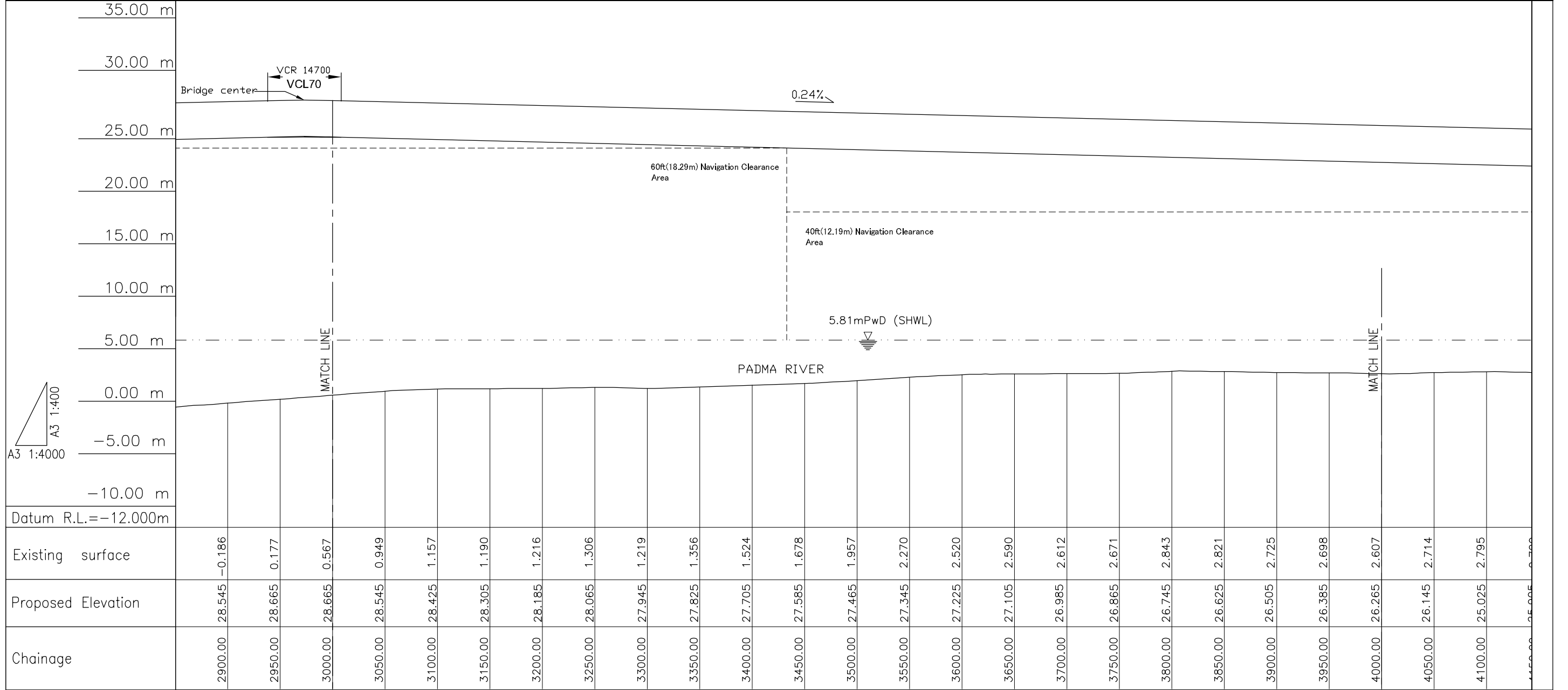
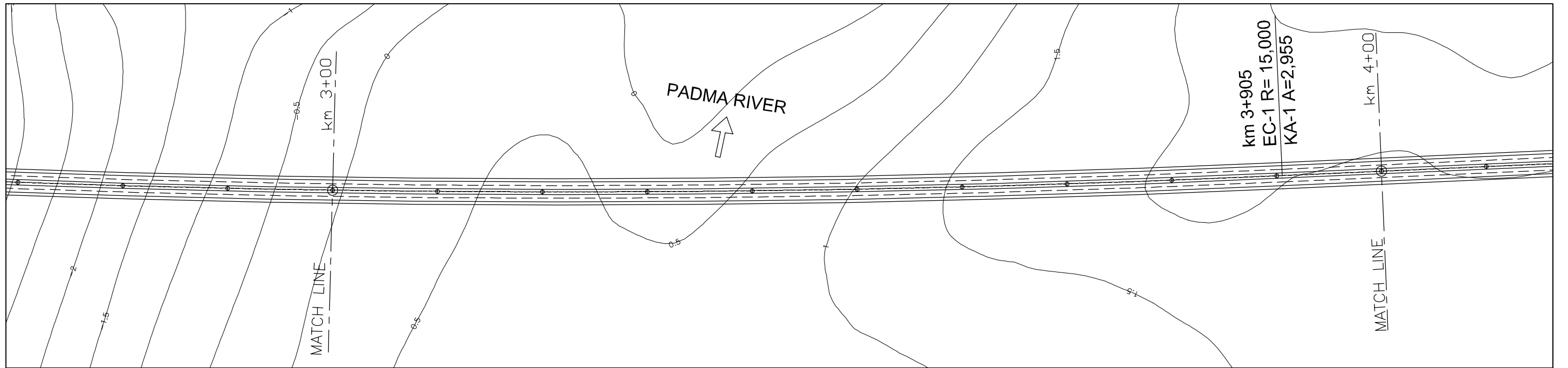

JAMUNA MULTIPURPOSE BRIDGE AUTHORITY THE PEOPLE REPUBLIC OF BANGLADESH	THE FEASIBILITY STUDY OF PADMA BRIDGE IN THE PEOPLE'S REPUBLIC OF BANGLADESH		JAPAN INTERNATIONAL COOPERATION AGENCY (JICA) NIPPON KOEI CO. LTD IN ASSOCIATION WITH CONSTRUCTION PROJECT CONSULTANTS, INC	TITLE	DATE:	SHEET NO.
				Plan and Longitudinal Section of Road Alignment (on the Padma River) Scale: Hor= 1:4000 Ver= 1:400	MARCH-2005	PDM FS B5

