

**ELEMENTS OF CURVE**

PI NO.	STATION	COORDINATES OF P.I.		I (deg)	R (m)	T (m)	E (m)	Lc (m)	e (%)	V (km/h)
		NORTHINGS	EASTINGS							
8	28+711.806	19308737.776	5287120.173	76°55'43"	750.00	595.81	207.86	1006.99	4.00	80.0

STATION	FINISHED GRADE	ORIGINAL GROUND	HORIZONTAL CURVATURE	VERTICAL CURVATURE	SUPERELEVATION
1312.855	1314.064	1312.855			
1312.435	1313.704	1312.435			
1312.011	1313.344	1312.011			
1311.587	1312.983	1311.587			
1311.162	1312.625	1311.162			
1310.738	1312.263	1310.738			
1310.331	1312.029	1310.331			
1309.925	1311.803	1309.925			
1309.518	1311.625	1309.518			
1309.112	1311.496	1309.112			
1308.705	1311.414	1308.705			
1308.297	1311.380	1308.297			
1307.874	1311.394	1307.874			
1307.457	1311.457	1307.457			
1307.030	1311.565	1307.030			
1306.615	1311.685	1306.615			
1306.205	1311.765	1306.205			
1305.799	1311.765	1305.799			
1305.390	1311.774	1305.390			
1304.980	1311.710	1304.980			
1304.571	1311.575	1304.571			
1304.162	1311.367	1304.162			
1303.753	1311.088	1303.753			
1303.344	1310.736	1303.344			
1302.935	1310.313	1302.935			
1302.526	1309.817	1302.526			
1302.117	1309.250	1302.117			
1301.708	1308.630	1301.708			
1301.299	1307.951	1301.299			
1300.890	1307.211	1300.890			
1300.481	1306.411	1300.481			
1300.072	1305.551	1300.072			
1299.663	1304.641	1299.663			
1299.254	1303.681	1299.254			
1298.845	1302.681	1298.845			
1298.436	1301.641	1298.436			
1298.027	1300.561	1298.027			
1297.618	1300.000	1297.618			
1297.209	1300.000	1297.209			
1296.800	1300.000	1296.800			
1296.391	1300.000	1296.391			
1295.982	1300.000	1295.982			
1295.573	1300.000	1295.573			
1295.164	1300.000	1295.164			
1294.755	1300.000	1294.755			
1294.346	1300.000	1294.346			
1293.937	1300.000	1293.937			
1293.528	1300.000	1293.528			
1293.119	1300.000	1293.119			
1292.710	1300.000	1292.710			
1292.301	1300.000	1292.301			
1291.892	1300.000	1291.892			
1291.483	1300.000	1291.483			
1291.074	1300.000	1291.074			
1290.665	1300.000	1290.665			
1290.256	1300.000	1290.256			
1289.847	1300.000	1289.847			
1289.438	1300.000	1289.438			
1289.029	1300.000	1289.029			
1288.620	1300.000	1288.620			
1288.211	1300.000	1288.211			
1287.802	1300.000	1287.802			
1287.393	1300.000	1287.393			
1286.984	1300.000	1286.984			
1286.575	1300.000	1286.575			
1286.166	1300.000	1286.166			
1285.757	1300.000	1285.757			
1285.348	1300.000	1285.348			
1284.939	1300.000	1284.939			
1284.530	1300.000	1284.530			
1284.121	1300.000	1284.121			
1283.712	1300.000	1283.712			
1283.303	1300.000	1283.303			
1282.894	1300.000	1282.894			
1282.485	1300.000	1282.485			
1282.076	1300.000	1282.076			
1281.667	1300.000	1281.667			
1281.258	1300.000	1281.258			
1280.849	1300.000	1280.849			
1280.440	1300.000	1280.440			
1280.031	1300.000	1280.031			
1279.622	1300.000	1279.622			
1279.213	1300.000	1279.213			
1278.804	1300.000	1278.804			
1278.395	1300.000	1278.395			
1277.986	1300.000	1277.986			
1277.577	1300.000	1277.577			
1277.168	1300.000	1277.168			
1276.759	1300.000	1276.759			
1276.350	1300.000	1276.350			
1275.941	1300.000	1275.941			
1275.532	1300.000	1275.532			
1275.123	1300.000	1275.123			
1274.714	1300.000	1274.714			
1274.305	1300.000	1274.305			
1273.896	1300.000	1273.896			
1273.487	1300.000	1273.487			
1273.078	1300.000	1273.078			
1272.669	1300.000	1272.669			
1272.260	1300.000	1272.260			
1271.851	1300.000	1271.851			
1271.442	1300.000	1271.442			
1271.033	1300.000	1271.033			
1270.624	1300.000	1270.624			
1270.215	1300.000	1270.215			
1269.806	1300.000	1269.806			
1269.397	1300.000	1269.397			
1268.988	1300.000	1268.988			
1268.579	1300.000	1268.579			
1268.170	1300.000	1268.170			
1267.761	1300.000	1267.761			
1267.352	1300.000	1267.352			
1266.943	1300.000	1266.943			
1266.534	1300.000	1266.534			
1266.125	1300.000	1266.125			
1265.716	1300.000	1265.716			
1265.307	1300.000	1265.307			
1264.898	1300.000	1264.898			
1264.489	1300.000	1264.489			
1264.080	1300.000	1264.080			
1263.671	1300.000	1263.671			
1263.262	1300.000	1263.262			
1262.853	1300.000	1262.853			
1262.444	1300.000	1262.444			
1262.035	1300.000	1262.035			
1261.626	1300.000	1261.626			
1261.217	1300.000	1261.217			
1260.808	1300.000	1260.808			
1260.399	1300.000	1260.399			
1260.000	1300.000	1260.000			
1259.591	1300.000	1259.591			
1259.182	1300.000	1259.182			
1258.773	1300.000	1258.773			
1258.364	1300.000	1258.364			
1257.955	1300.000	1257.955			
1257.546	1300.000	1257.546			
1257.137	1300.000	1257.137			
1256.728	1300.000	1256.728			
1256.319	1300.000	1256.319			
1255.910	1300.000	1255.910			
1255.501	1300.000	1255.501			
1255.092	1300.000	1255.092			
1254.683	1300.000	1254.683			
1254.274	1300.000	1254.274			
1253.865	1300.000	1253.865			
1253.456	1300.000	1253.456			
1253.047	1300.000	1253.047			
1252.638	1300.000	1252.638			
1252.229	1300.000	1252.229			
1251.820	1300.000	1251.820			
1251.411	1300.000	1251.411			
1251.002	1300.000	1251.002			
1250.593	1300.000	1250.593			
1250.184	1300.000	1250.184			
1249.775	1300.000	1249.775			
1249.366	1300.000	1249.366			
1248.957	1300.000	1248.957			
1248.548	1300.000	1248.548			
1248.139	1300.000	1248.139			
1247.730	1300.000	1247.730			
1247.321	1300.000	1247.321			
1246.912	1300.000	1246.912			
1246.503	1300.000	1246.503			
1246.094	1300.000	1246.094			
1245.685	1300.000	1245.685			
1245.276	1300.000	1245.276			
1244.867	1300.000	1244.867			
1244.458	1300.000	1244.458			
1244.049	1300.000	1244.049			
1243.640	1300.000	1243.640			
1243.231	1300.000	1243.231			
1242.822	1300.000	1242.822			
1242.413	1300.000	1242.413			
1242.004	1300.000	1242.004			
1241.595	1300.000	1241.595			
1241.186	1300.000	1241.186			
1240.777	1300.000	1240.777			
1240.368	1300.000	1240.368			
1239.959	1300.000	1239.959			
1239.550	1300.000	1239.550			
1239.141	1300.000	1239.141			
1238.732	1300.000	1238.732			
1238.323	1300.000	1238.323			
1237.914	1300.000	1237.914			
1237.505	1300.000	1237.505			
1237.096	1300.000	1237.096			
1236.687	1300.000	1236.687			
1236.278	1300.000	1236.278			
1235.869	1300.000	1235.869			
1235.460	1300.000	1235.460			
1235.051	1300.000	1235.051			
1234.642	1300.000	1234.642			
1234.233	1300.000	1234.233			
1233.824	1300.000	1233.824			
1233.415	1300.000	1233.415			
1233.006	1300.000	1233.006			
1232.597	1300.000	1232.597			
1232.188	1300.000	1232.188			
1231.779	1300.000	1231.779			
1231.370	1300.000	1231.370			
1230.961	1300.000	1230.961			
1230.552	1300.000	1230.552			
1230.143	1300.000	1230.143			
1229.734	1300.000	1229.734			
1229.325	1300.000	1229.325			
1228.916	1300.000	1228.916			
1228.507	1300.000	1228.507			
1228.098	1300.000	1228.098			
1227.689	1300.000	1227.689			
1227.280	1300.000	1227.280			
1226.871	1300.000				

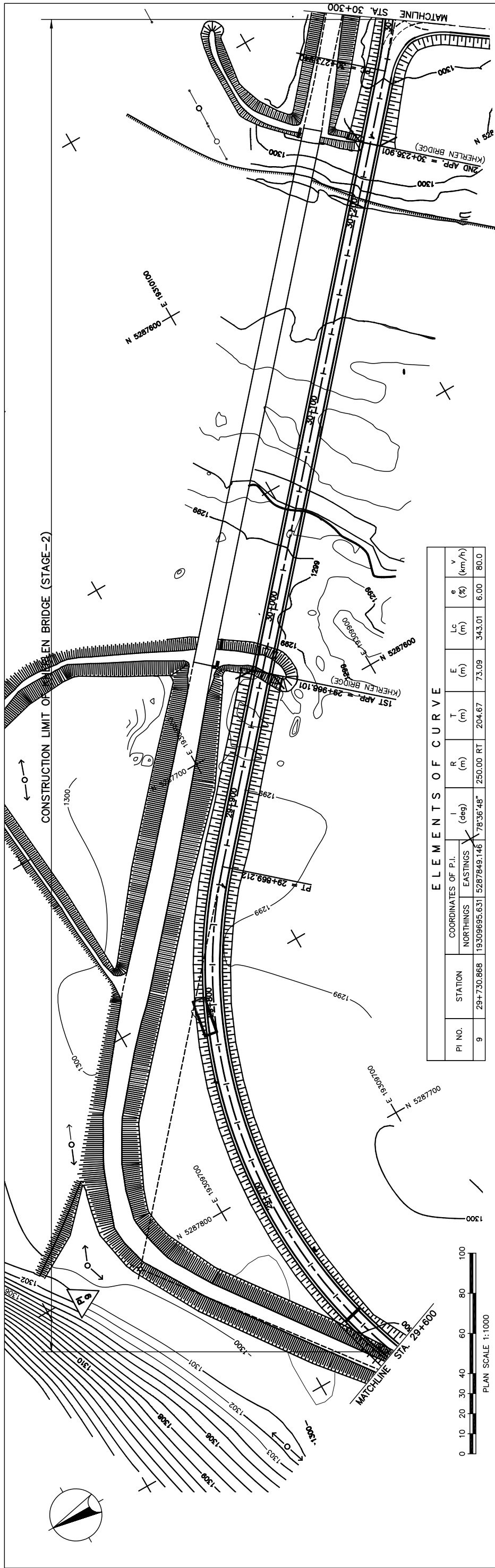



ELEMENTS OF CURVE										
PI NO.	STATION	COORDINATES OF P.I.		I (deg)	R (m)	T (m)	E (m)	Lc (m)	e (%)	V (km/h)
		NORTHINGS	EASTINGS							
9	29+730.888	19309695.631	5287849.146	78°36'48"	250.00	204.67	73.09	343.01	6.00	80.0

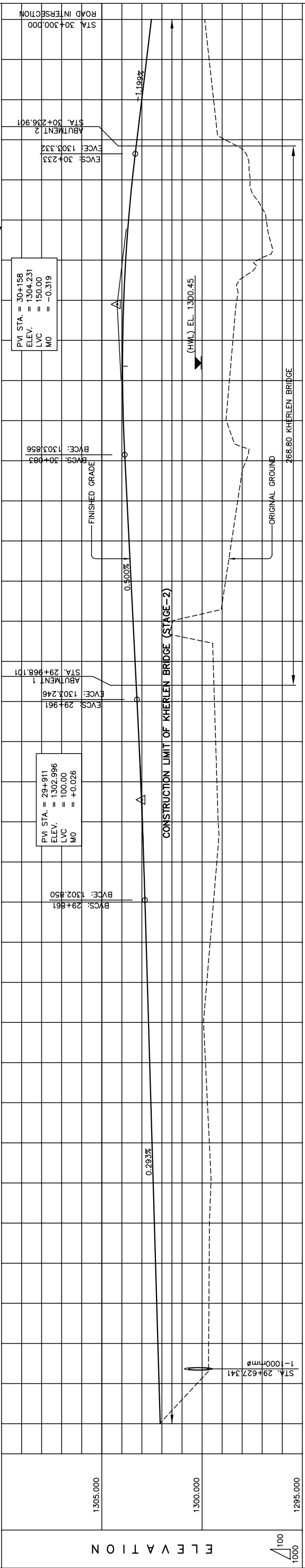

STATION	FINISHED GRADE	ORIGINAL GROUND	HORIZONTAL CURVATURE	VERTICAL CURVATURE	SUPERELEVATION
1300.252	1302.144	1302.202			
1299.671	1302.144	1302.202			
1299.658	1302.261	1302.261			
1299.645	1302.319	1302.319			
1299.632	1302.378	1302.378			
1299.630	1302.612	1302.612			
1299.926	1302.671	1302.671			
1299.764	1302.729	1302.729			
1299.597	1302.788	1302.788			
1299.431	1302.847	1302.847			
1299.264	1302.909	1302.909			
1299.199	1302.980	1302.980			
1299.322	1303.146	1303.146			
1299.383	1303.241	1303.241			
1299.443	1303.341	1303.341			
1301.459	1303.441	1303.441			
1298.829	1303.541	1303.541			
1298.527	1303.641	1303.641			
1298.224	1303.741	1303.741			
1297.805	1303.841	1303.841			
1298.794	1303.925	1303.925			
1298.636	1303.963	1303.963			
1298.462	1303.957	1303.957			
1298.268	1303.905	1303.905			
1297.230	1303.808	1303.808			
1296.797	1303.666	1303.666			
1297.603	1303.478	1303.478			
1298.849	1303.248	1303.248			
1299.425	1303.008	1303.008			
1299.647	1302.768	1302.768			
1299.868	1302.528	1302.528			

THE BASIC DESIGN STUDY ON CONSTRUCTION OF EASTERN ARTERIAL ROAD IN MONGOLIA

JAPAN INTERNATIONAL COOPERATION AGENCY (JICA)

MINISTRY OF INFRASTRUCTURE  
THE GOVERNMENT OF MONGOLIA

PACIFIC CONSULTANTS INTERNATIONAL  
JAPAN OVERSEAS CONSULTANTS

Scale: AS SHOWN

Sheet No.: C-20  
20/21

PLAN AND PROFILE  
(STA.29+600 TO STA.30+300)  
(STAGE-1)

STRAIGHT

LVC = 150.00 m

g = 0.500%

g = -1.199%

LVC = 100.00 m

LVC = 65.212

g = 0.293%

e = 6.00%

Figure 2-2-3-22 Plan and Profile (Section II New Construction Sta.29+600-Sta.30+300)



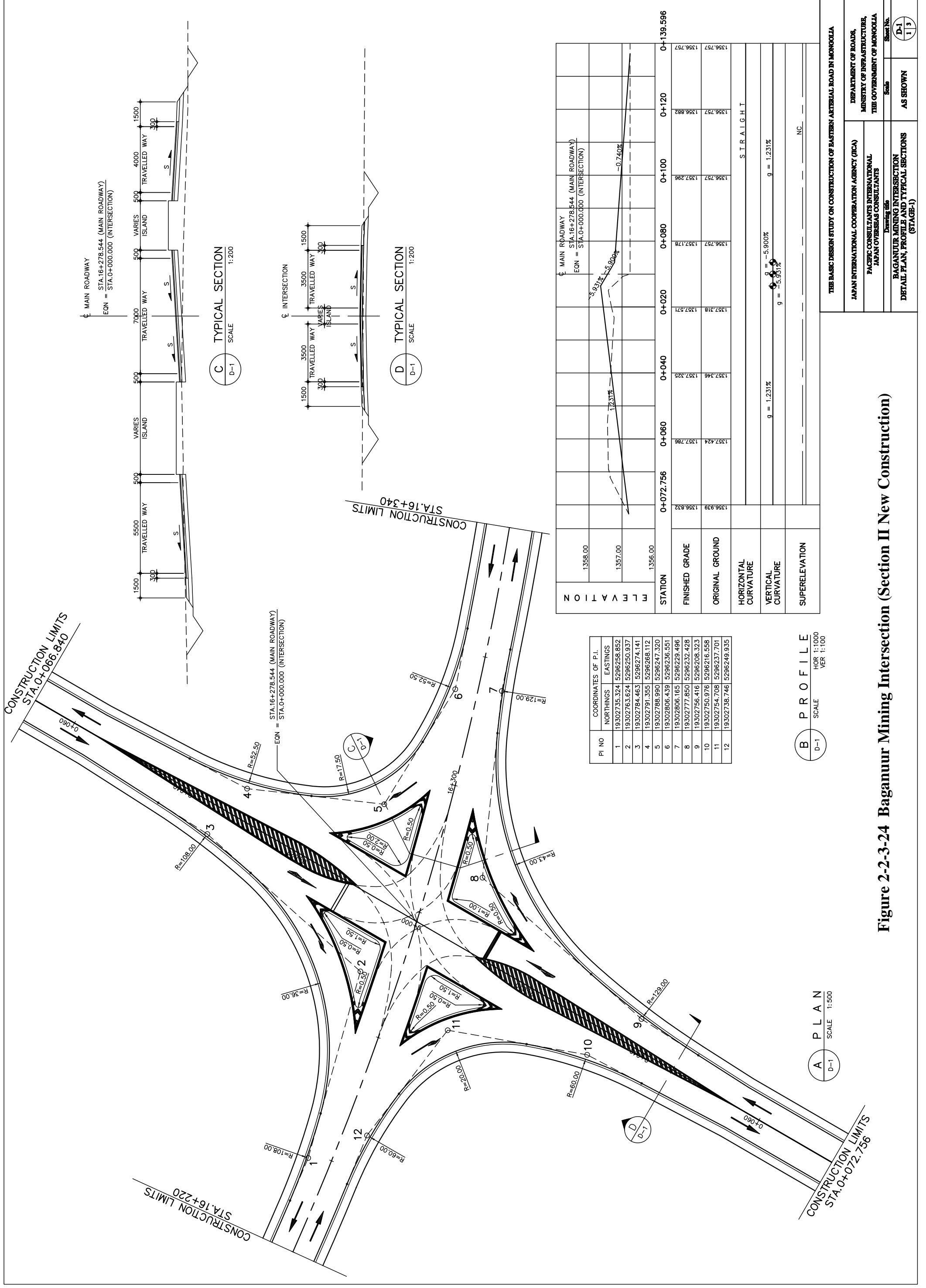
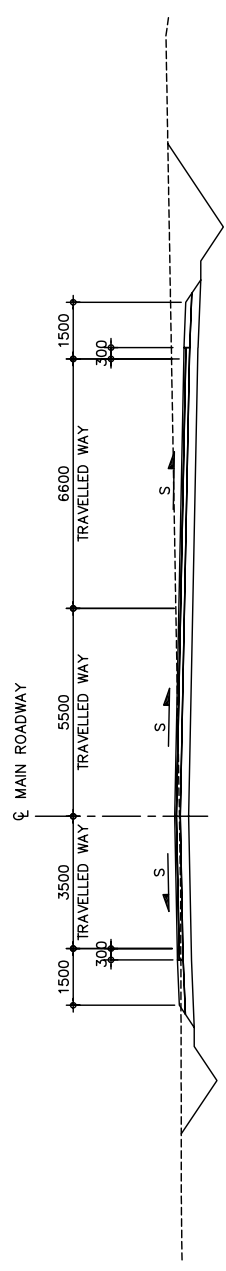
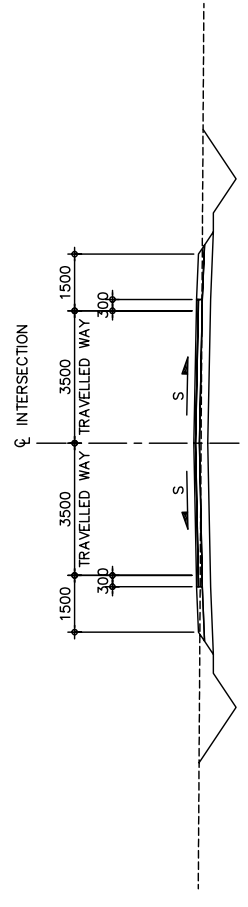

Figure 2-2-3-24 Baganuur Mining Intersection (Section II New Construction)



**C**  
D-2  
SCALE 1:200  
TYPICAL SECTION



**D**  
D-2  
SCALE 1:200  
TYPICAL SECTION

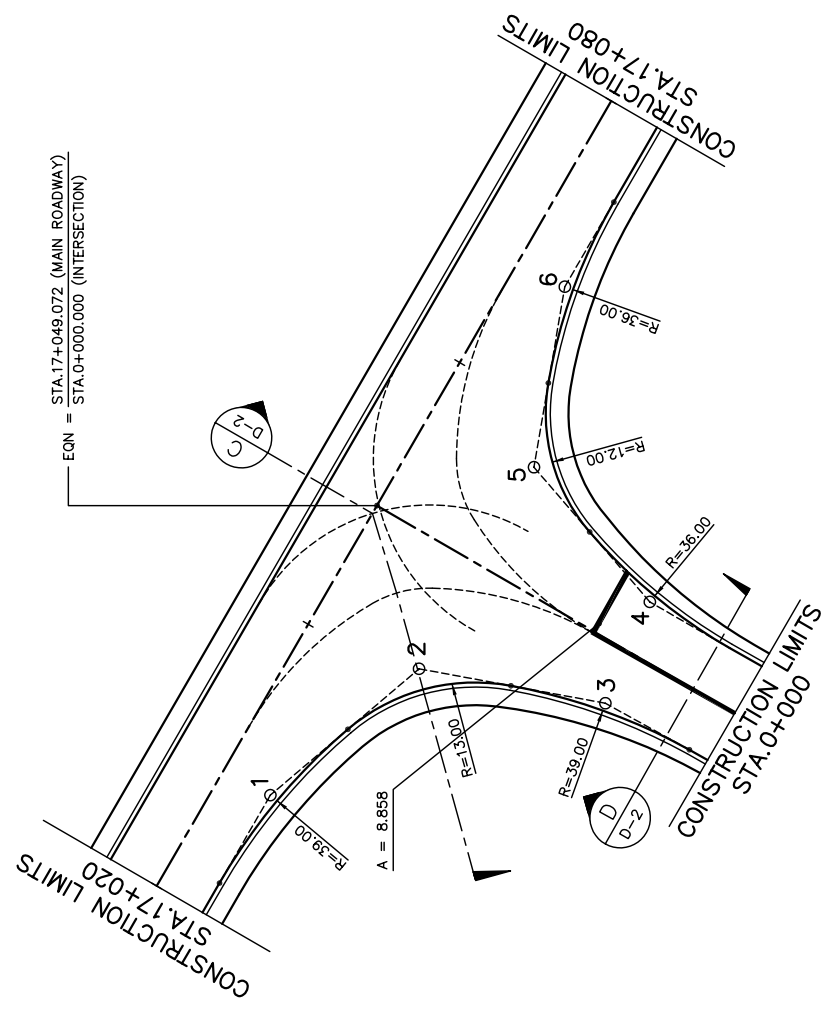

**A**  
D-2  
SCALE 1:500  
P L A N

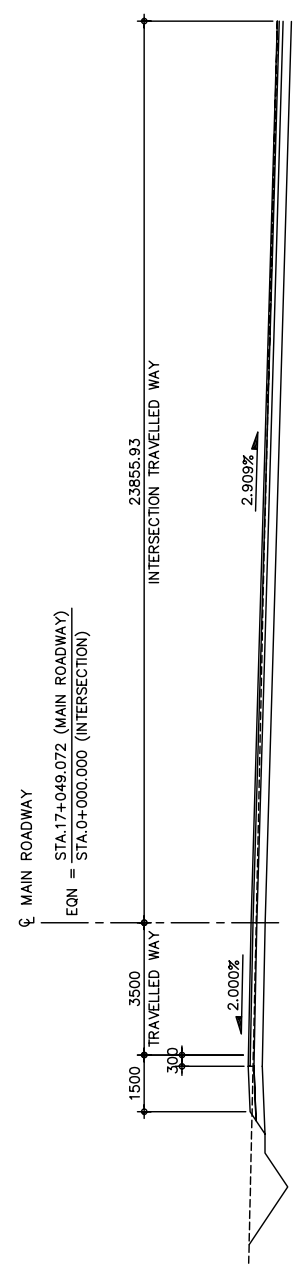

**B**  
D-2  
SCALE 1:200  
SECTION @ INTERSECTION

PI NO	COORDINATES OF P.I.	
	NORTHINGS	EASTINGS
1	19303486.742	5296147.317
2	19303497.100	5296137.488
3	19303494.821	5296125.167
4	19303501.525	5296122.227
5	19303510.433	5296129.888
6	19303522.373	5296127.847

**Figure 2-2-3-25 Baganuur Power Plant Intersection (Section II New Construction)**

THE BASIC DESIGN STUDY ON CONSTRUCTION OF EASTERN ARTERIAL ROAD IN MONGOLIA	
JAPAN INTERNATIONAL COOPERATION AGENCY (JICA)	DEPARTMENT OF ROADS, MINISTRY OF INFRASTRUCTURE, THE GOVERNMENT OF MONGOLIA
PACIFIC CONSULTANTS INTERNATIONAL JAPAN OVERSEAS CONSULTANTS	Scale
BAGAMUUR POWER PLANT INTERSECTION DETAIL PLAN AND TYPICAL SECTIONS (STAGE-1)	
AS SHOWN	Sheet No. D-2 2/3

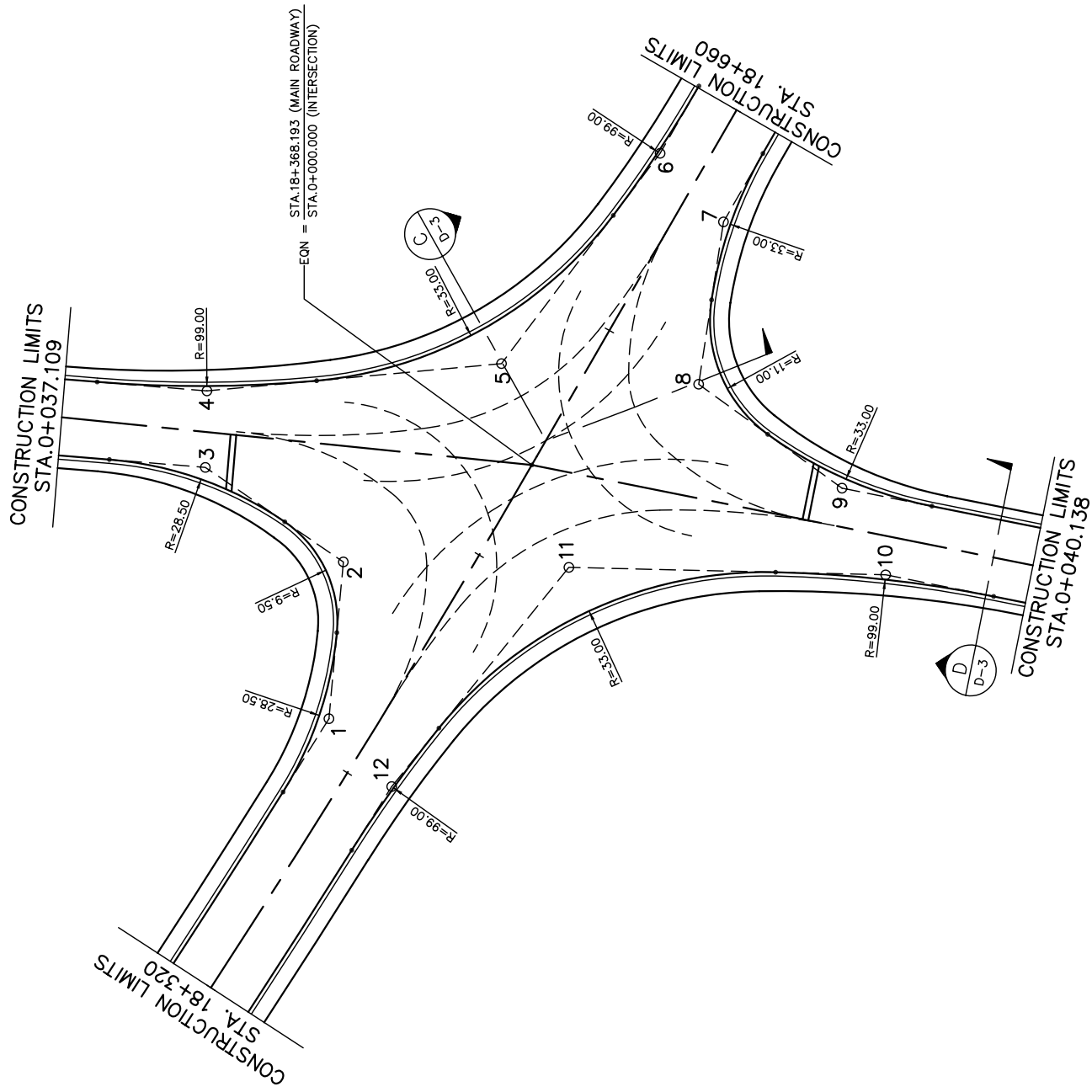

**A** PLAN  
D-3 SCALE 1:500

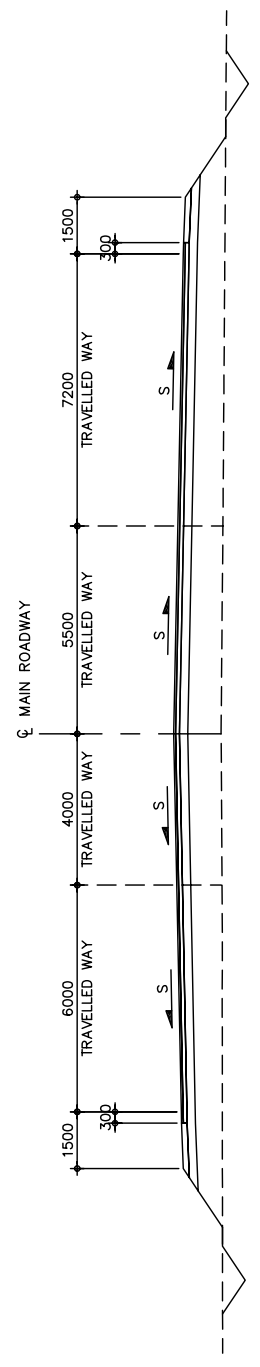

**C** TYPICAL SECTION  
D-3 SCALE 1:200

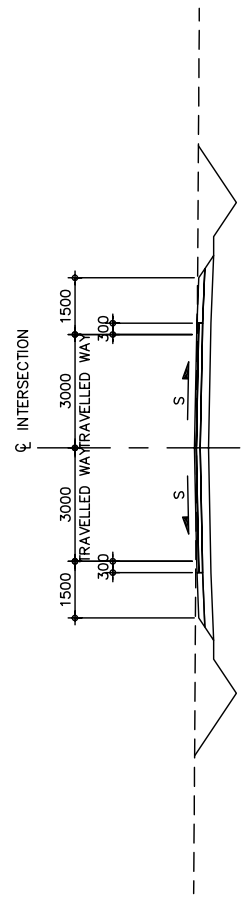

**D** TYPICAL SECTION  
D-3 SCALE 1:200

COORDINATES OF P.I.	
PI NO	EASTINGS
1	19304362.359
2	19304374.675
3	19304382.102
4	19304388.112
5	19304390.256
6	19304406.775
7	19304401.393
8	19304388.635
9	19304380.471
10	19304373.665
11	19304374.248
12	19304357.029

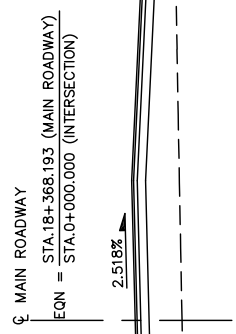

**B** SECTION @ INTERSECTION  
D-3 SCALE 1:200



THE BASIC DESIGN STUDY ON CONSTRUCTION OF EASTERN ARTERIAL ROAD IN MONGOLIA

JAPAN INTERNATIONAL COOPERATION AGENCY (JICA)

PACIFIC CONSULTANTS INTERNATIONAL  
JAPAN OVERSEAS CONSULTANTS  
Drawing title

DEPARTMENT OF ROADS,  
MINISTRY OF INFRASTRUCTURE,  
THE GOVERNMENT OF MONGOLIA  
Scale

BAGANAUR STORAGE INTERSECTION  
DETAIL PLAN AND TYPICAL SECTIONS  
(STAGE-1)

AS SHOWN

Sheet No. **D-3**  
**3/3**

**Figure 2-2-3-26 Baganaur Storage Intersection (Section II New Construction)**