

CROSS SECTION TYPE	TYPE 7
PAVEMENT VERTICAL ALIGNMENT	10.012 10.011 10.010 10.010 10.010 10.009 10.008 10.007 10.007 10.007 10.006 10.005 10.004 10.004 10.004 10.003 10.002 10.001 10.001 9.999 9.998 9.998 9.997 9.996 9.996 9.993 9.993 9.986 9.986 9.982 9.982 9.979 9.979 9.975 9.972 9.972 9.968 9.968 9.965 9.965 9.961 9.961 9.958 9.958 9.954 9.954 9.950 9.950 9.947 9.947 9.943 9.943 9.940 9.940 9.936 9.936 9.933 9.933
GROUND	10.012 10.011 10.010 10.010 10.010 10.009 10.008 10.007 10.007 10.007 10.006 10.005 10.004 10.004 10.004 10.003 10.002 10.001 10.001 9.999 9.998 9.998 9.997 9.996 9.996 9.993 9.993 9.986 9.986 9.982 9.982 9.979 9.979 9.975 9.972 9.972 9.968 9.968 9.965 9.965 9.961 9.961 9.958 9.958 9.954 9.954 9.950 9.950 9.947 9.947 9.943 9.943 9.940 9.940 9.936 9.936 9.933 9.933
STATION	30+800 30+820 30+840 30+860 30+880 30+900 30+920 30+940 30+960 30+980 30+1000 30+1020 30+1040 30+1060 30+1080 30+1100 30+1120 30+1140 30+1160 30+1180 30+1200 30+1220 30+1240 30+1260 30+1280 30+1300 30+1320 30+1340 30+1360 30+1380 30+1400 30+1420 30+1440 30+1460 30+1480 30+1500
HORIZONTAL	Rc=5000 Lc=150.006
CLIMATE	Rc=5000 Lc=150.006
TEMPERATURE	Rc=5000 Lc=150.006
WIND	Rc=5000 Lc=150.006
PRECIPITATION	Rc=5000 Lc=150.006
RELATIVE HUMIDITY	Rc=5000 Lc=150.006
SOIL TYPE	Rc=5000 Lc=150.006
VEGETATION	Rc=5000 Lc=150.006
TOPOGRAPHY	Rc=5000 Lc=150.006
WATER TABLE	Rc=5000 Lc=150.006
ADDITIONAL DATA	Rc=5000 Lc=150.006

MINISTRY OF PUBLIC WORKS AND TRANSPORT (MPWT)

THE PROJECT FOR THE IMPROVEMENT OF NATIONAL ROAD NO.1 (PHNOM PENH-NEAK LOUENG SECTION) IN THE KINGDOM OF CAMBODIA

JAPAN INTERNATIONAL COOPERATION AGENCY KATAHIRA & ENGINEERS INTERNATIONAL CTI ENGINEERING INTERNATIONAL CO.,LTD

TITLE : PLAN AND PROFILE (STA.30+800—STA.31+500)

SCALE H=1/2000 V=1/200

Drawing No. PL-45

Sheet No. PL-45

TYPE 7

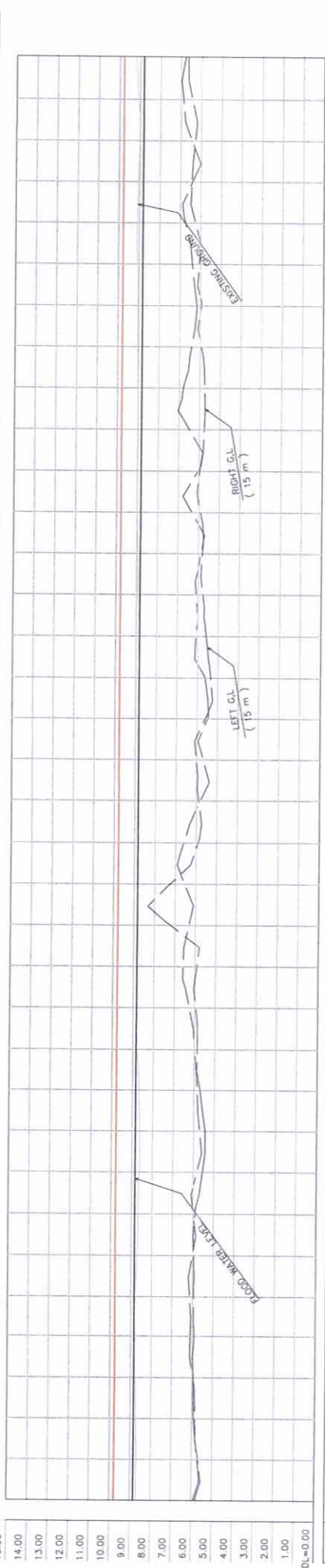
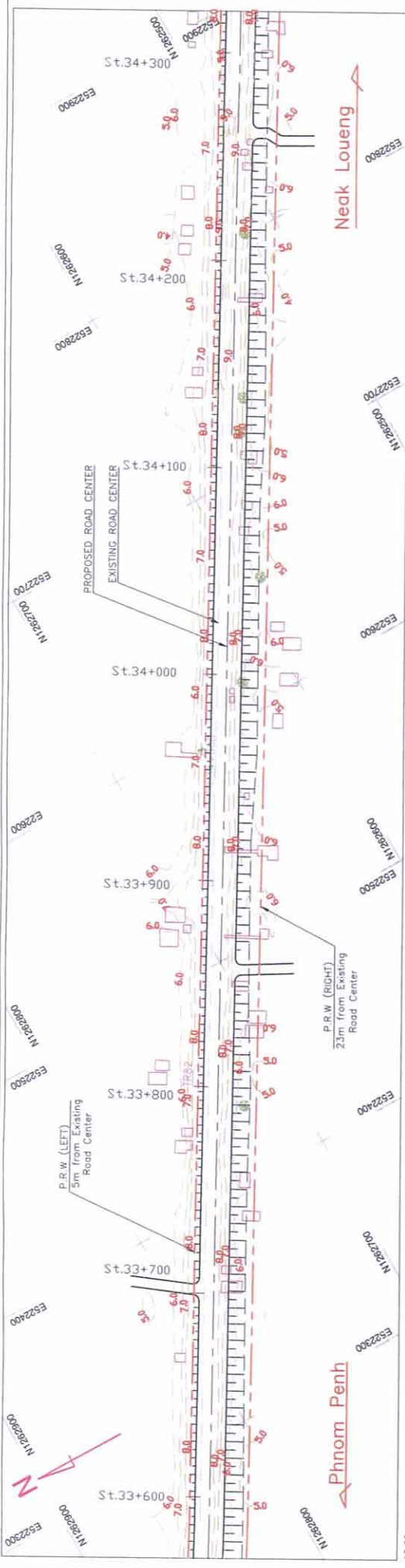

CROSS SECTION TYPE	TYPE-7	
SUPER-ELEVATION	NC	
HORIZONTAL CURVATURE	Rc=∞ L=1268.326	
STATION	GROUND HEIGHT	PAVEMENT HEIGHT
VERTICAL ALIGNMENT	I=0.000% L=4145.00	
33+600	8.69	9.779
33+620	8.71	9.779
33+640	8.72	9.779
33+660	8.76	9.779
33+680	8.79	9.779
33+700	8.77	9.779
33+720	8.70	9.779
33+740	8.66	9.779
33+760	8.63	9.779
33+780	8.62	9.779
33+800	8.68	9.779
33+820	8.77	9.779
33+840	8.80	9.780
33+860	8.82	9.780
33+880	8.83	9.780
33+900	8.84	9.780
33+920	8.87	9.780
33+940	8.85	9.780
33+960	8.86	9.780
33+980	8.88	9.780
34+000	8.86	9.780
34+020	8.87	9.780
34+040	8.90	9.780
34+060	8.94	9.780
34+080	8.97	9.780
34+100	8.98	9.780
34+120	8.98	9.781
34+140	9.01	9.781
34+160	9.04	9.781
34+180	9.04	9.781
34+200	9.07	9.781
34+220	9.09	9.781
34+240	9.05	9.781
34+260	9.01	9.781
34+280	9.07	9.781
34+300	9.19	9.781

MINISTRY OF PUBLIC WORKS AND TRANSPORT (MPWT)

THE PROJECT FOR THE IMPROVEMENT OF NATIONAL ROAD NO.1 (PHNOM PENH-NEAK LOUENG SECTION) IN THE KINGDOM OF CAMBODIA

JAPAN INTERNATIONAL COOPERATION AGENCY
KATAHIRA & ENGINEERS INTERNATIONAL
CTI ENGINEERING INTERNATIONAL CO.,LTD

TITLE : PLAN AND PROFILE
STA. 33+600 - STA. 34+300

SCALE
H=1/2000
V=1/200

Drawing No. _____
Sheet No. PL-49

TYPE-7

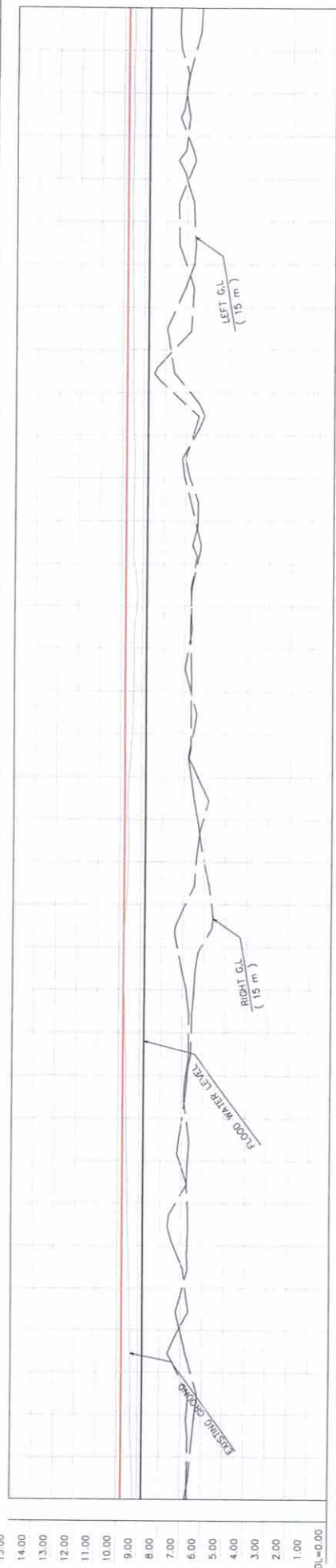
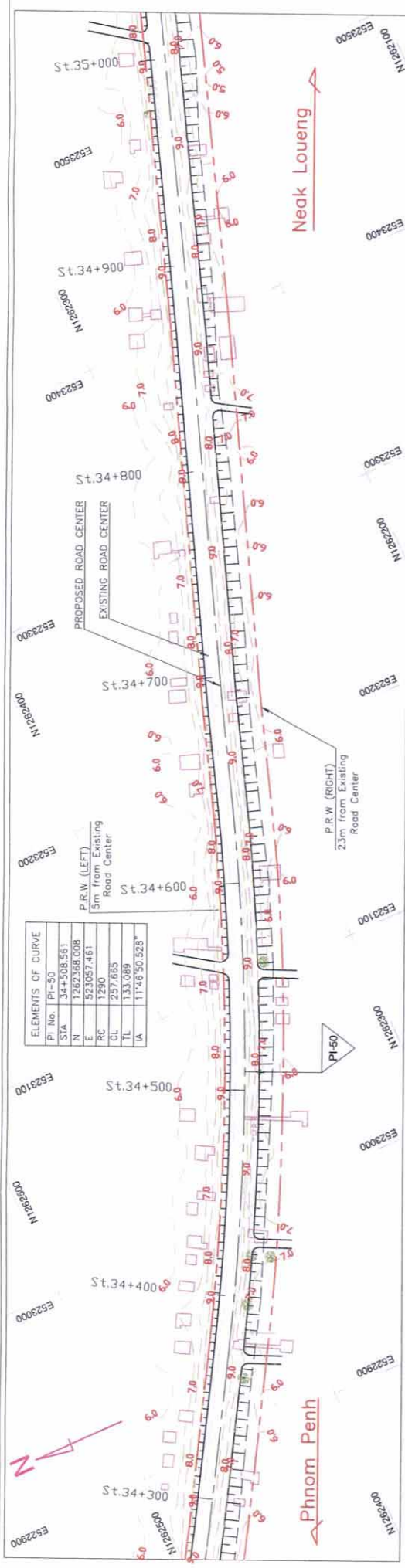

VERTICAL ALIGNMENT	STATION	GROUND ELEVATION	PROPOSED ELEVATION
EC	34+500	9.19	9.781
	34+520	9.29	9.781
	34+540	9.34	9.781
	34+560	9.36	9.781
	34+580	9.39	9.781
	34+600	9.43	9.782
	34+620	9.49	9.782
	34+640	9.53	9.782
	34+660	9.58	9.782
	34+680	9.62	9.782
BC	34+700	9.64	9.782
	34+720	9.66	9.782
	34+740	9.68	9.782
	34+760	9.75	9.782
	34+780	9.77	9.782
	34+800	9.68	9.782
	34+820	9.59	9.782
	34+840	9.51	9.783
	34+860	9.44	9.783
	34+880	9.39	9.783
EC	34+900	9.39	9.783
	34+920	9.41	9.783
	34+940	9.43	9.783
	34+960	9.49	9.783
	34+980	9.51	9.783
	35+000	9.57	9.783
	34+980	9.54	9.784
	34+960	9.54	9.784
	34+940	9.54	9.784
	34+920	9.54	9.784
34+900	9.53	9.784	

Vertical Curve Data:
 EC: $i=0.000\%$, $L=4145.00$
 BC: $Rc=1290$, $Lc=257.665$
 EC: $Rc=600$, $L=610.982$

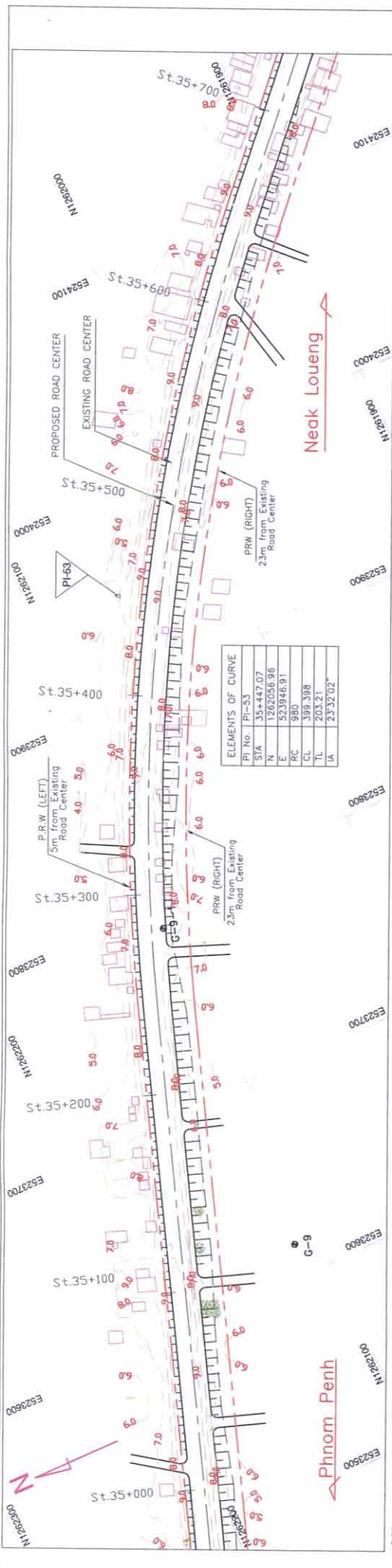

ELEMENTS OF CURVE

PI No	PI-53
STA	35+447.07
N	1262056.96
E	523946.91
RC	990
CL	399.398
TL	203.21
LA	23332'02"

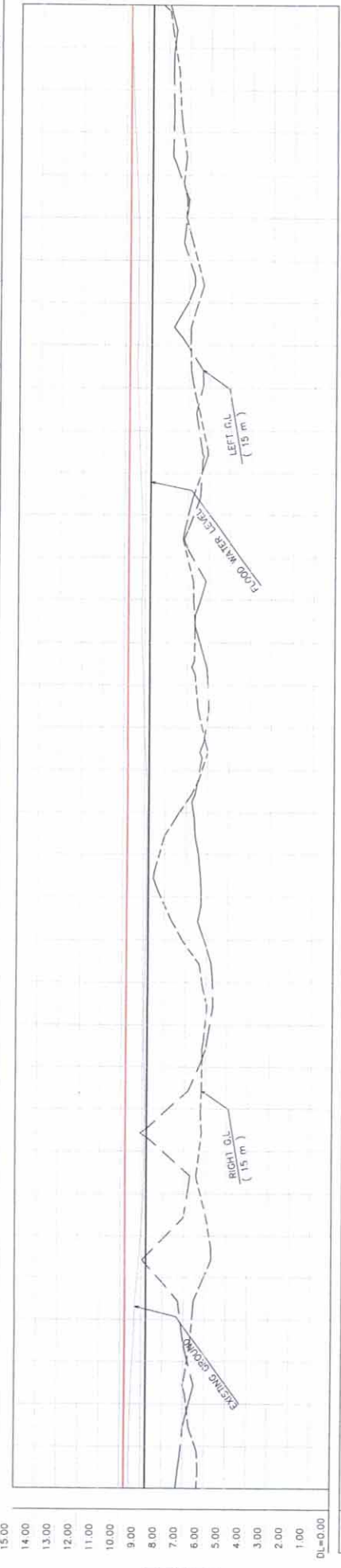

CROSS SECTION TYPE	TYPE-7	TYPE-7
GROUND ELEVATION	9.784	9.784
PAVEMENT HEIGHT	9.784	9.784
STATION	35+000	35+700
HORIZONTAL CURVATURE	Rc=∞ L=610.982	Rc=990 L=399.398
VERTICAL ALIGNMENT	L=0.000%	L=4145.00
SUPER-ELEVATION	NG	e=3%
GRADE	3.00	3.00
START ELEVATION	35+223	35+622
END ELEVATION	35+273	35+672

MINISTRY OF PUBLIC WORKS AND TRANSPORT (MPWT)

JAPAN INTERNATIONAL COOPERATION AGENCY
KATAHIRA & ENGINEERS INTERNATIONAL
CTI ENGINEERING INTERNATIONAL CO.,LTD

TITLE : PLAN AND PROFILE
STA.35+000 — STA.35+700

SCALE
H=1/2000
V=1/200

Drawing No.
Sheet No.
51

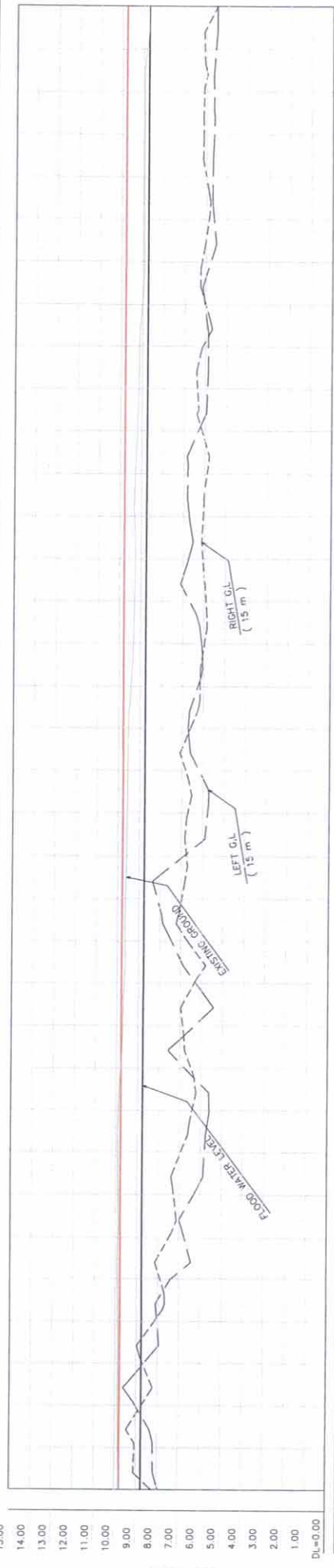
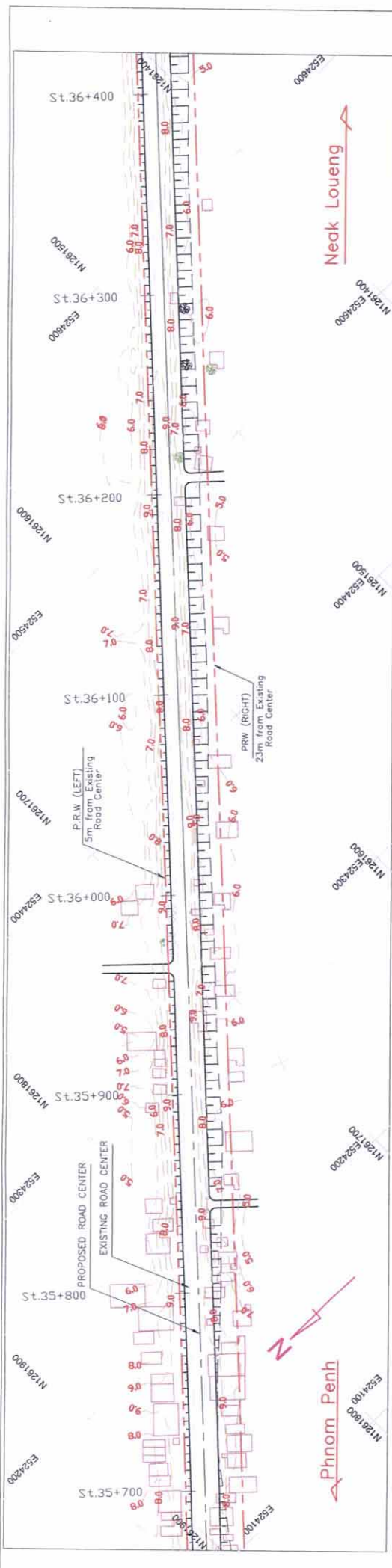

CROSS SECTION TYPE	SUPER-ELEVATION	HORIZONTAL CURVATURE	STATION	GROUND HEIGHT	PROPOSED HEIGHT	VERTICAL ALIGNMENT
TYPE-7	NC	Rc=∞	-35+700	9.786	9.786	0.00
			-35+720	9.83	9.786	0.00
TYPE-7	NC	Rc=∞	-35+740	9.86	9.786	0.00
			-35+760	9.86	9.786	0.00
TYPE-7	NC	Rc=∞	-35+780	9.87	9.787	0.00
			-35+800	9.90	9.787	0.00
TYPE-7	NC	Rc=∞	-35+820	9.88	9.787	0.00
			-35+840	9.88	9.787	0.00
TYPE-7	NC	Rc=∞	-35+860	9.91	9.787	0.00
			-35+880	9.89	9.787	0.00
TYPE-7	NC	Rc=∞	-35+900	9.80	9.787	0.00
			-35+920	9.71	9.787	0.00
TYPE-7	NC	Rc=∞	-35+940	9.66	9.787	0.00
			-35+960	9.64	9.787	0.00
TYPE-7	NC	Rc=∞	-35+980	9.63	9.787	0.00
			-36+000	9.60	9.787	0.00
TYPE-7	NC	Rc=∞	-36+020	9.57	9.787	0.00
			-36+040	9.56	9.787	0.00
TYPE-7	NC	Rc=∞	-36+060	9.54	9.788	0.00
			-36+080	9.43	9.788	0.00
TYPE-7	NC	Rc=∞	-36+100	9.33	9.788	0.00
			-36+120	9.29	9.788	0.00
TYPE-7	NC	Rc=∞	-36+140	9.28	9.788	0.00
			-36+160	9.32	9.788	0.00
TYPE-7	NC	Rc=∞	-36+180	9.29	9.788	0.00
			-36+200	9.21	9.788	0.00
TYPE-7	NC	Rc=∞	-36+220	9.15	9.788	0.00
			-36+240	9.12	9.788	0.00
TYPE-7	NC	Rc=∞	-36+260	9.01	9.788	0.00
			-36+280	8.94	9.788	0.00
TYPE-7	NC	Rc=∞	-36+300	8.94	9.788	0.00
			-36+320	8.95	9.788	0.00
TYPE-7	NC	Rc=∞	-36+340	8.94	9.789	0.00
			-36+360	8.84	9.789	0.00
TYPE-7	NC	Rc=∞	-36+400	8.76	9.789	0.00

MINISTRY OF PUBLIC WORKS AND TRANSPORT (MPWT)

THE PROJECT FOR THE IMPROVEMENT OF NATIONAL ROAD NO.1 (PHNOM PENH-NEAK LOUENG SECTION) IN THE KINGDOM OF CAMBODIA

JAPAN INTERNATIONAL COOPERATION AGENCY
KATAHIRA & ENGINEERS INTERNATIONAL
CTI ENGINEERING INTERNATIONAL CO.,LTD

TITLE : PLAN AND PROFILE
STA.35+700 - STA.36+400

SCALE
H=1/2000
V=1/200

Drawing No. _____
Sheet No. 52

TYPE-7

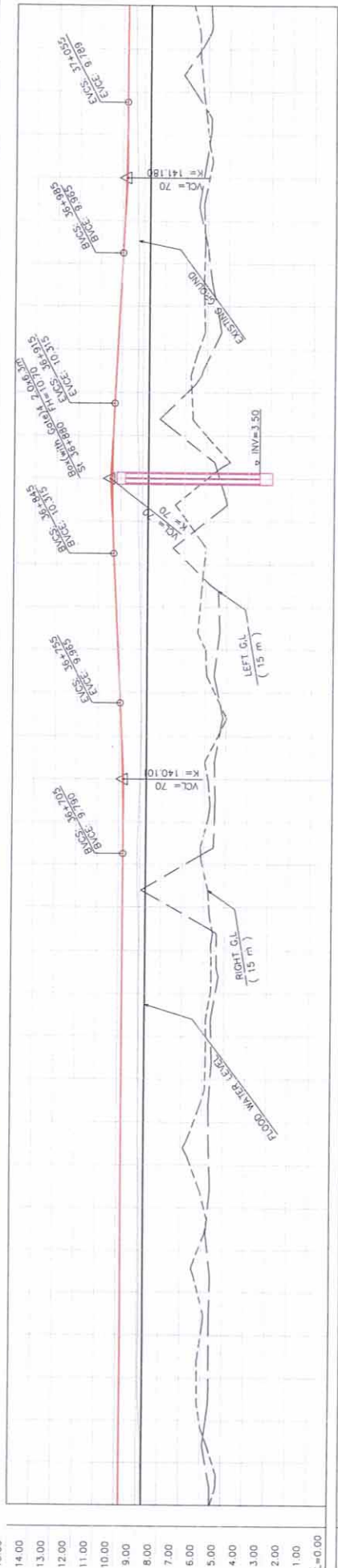
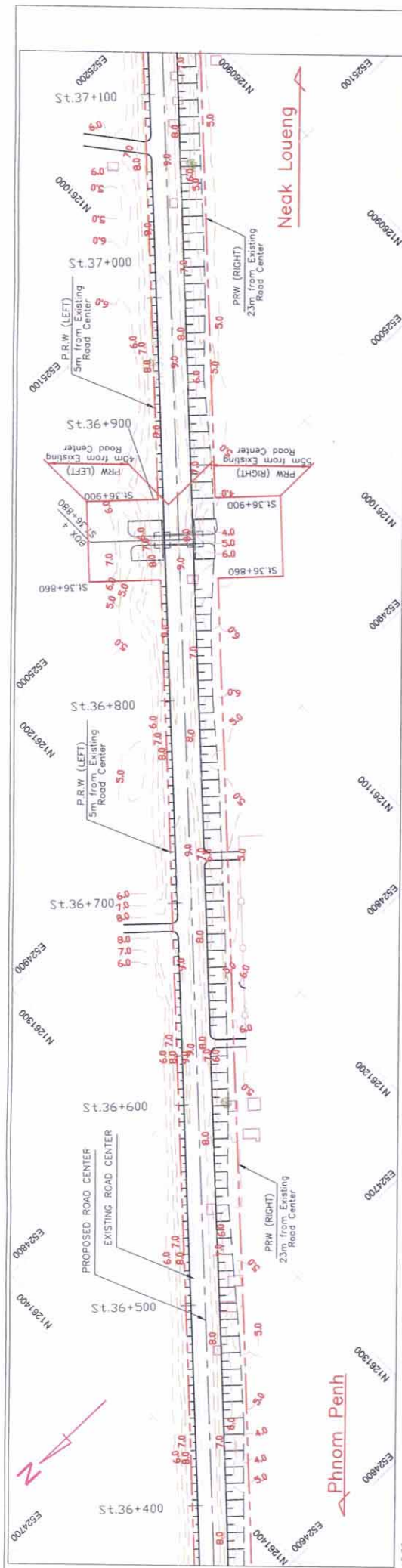

CROSS SECTION TYPE	TYPE-7	
SURF-ELEVATION	NC	
HORIZONTAL CURVATURE	Rc=∞ L=1550.018	
STATION	GROUND HEIGHT	PROPOSED ROAD HEIGHT
36+400	8.76	9.789
36+420	8.78	9.789
36+440	8.85	9.789
36+460	8.93	9.789
36+480	8.92	9.789
36+500	8.92	9.789
36+520	8.93	9.789
36+540	8.93	9.789
36+560	8.96	9.789
36+580	8.99	9.789
36+600	9.02	9.789
36+620	9.02	9.790
36+640	9.04	9.790
36+660	9.03	9.790
36+680	9.07	9.790
36+700	9.12	9.790
36+720	9.08	9.798
36+740	9.01	9.834
36+760	8.96	9.898
36+780	8.98	9.990
36+800	9.02	10.090
36+820	9.06	10.190
36+840	9.11	10.290
36+860	9.17	10.374
36+880	9.18	10.402
36+900	9.23	10.374
36+920	9.25	10.290
36+940	9.22	10.190
36+960	9.23	10.090
36+980	9.24	9.990
37+000	9.28	9.898
37+020	9.31	9.833
37+040	9.35	9.797
37+060	9.38	9.788
37+080	9.40	9.787
37+100	9.42	9.787
L=0.000% L=4145.00 9.790 10.490 9.790		

MINISTRY OF PUBLIC WORKS AND TRANSPORT (MPWT)

THE PROJECT FOR THE IMPROVEMENT OF NATIONAL ROAD NO.1 (PHNOM PENH-NEAK LOUENG SECTION) IN THE KINGDOM OF CAMBODIA

JAPAN INTERNATIONAL COOPERATION AGENCY KATAHIRA & ENGINEERS INTERNATIONAL CTI ENGINEERING INTERNATIONAL CO.,LTD

TITLE : PLAN AND PROFILE STA.36+400 - STA.37+100

SCALE H=1/2000 V=1/200

Drawing No. Sheet No. 53

TYPE-7

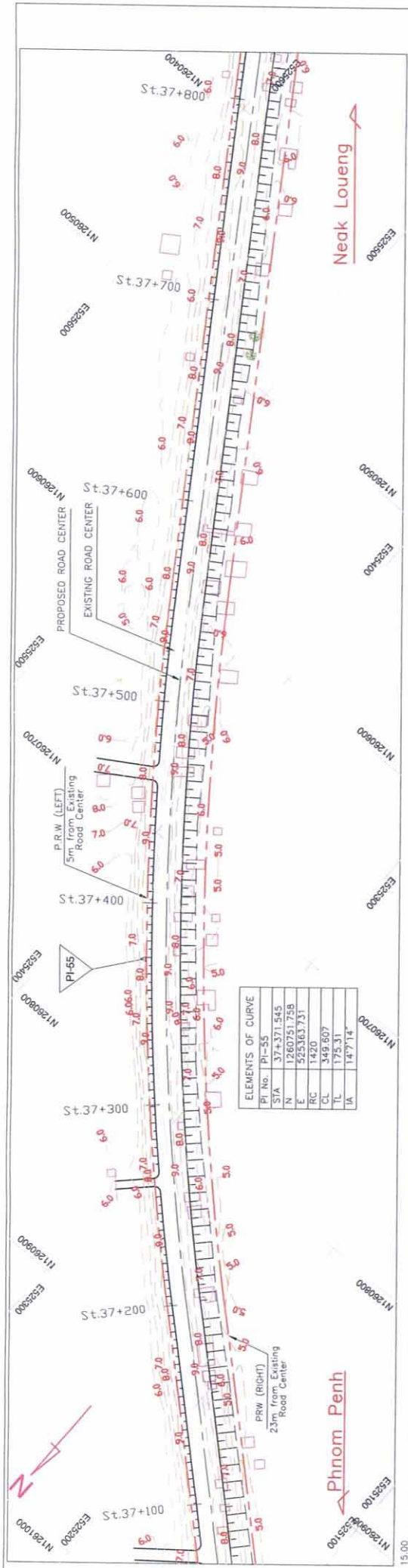

ELEMENTS OF CURVE

PI No.	PI=55
S/A	37+371.545
N	1280751.758
E	523363.731
RC	1420
CL	349.607
TL	175.31
LA	147.714

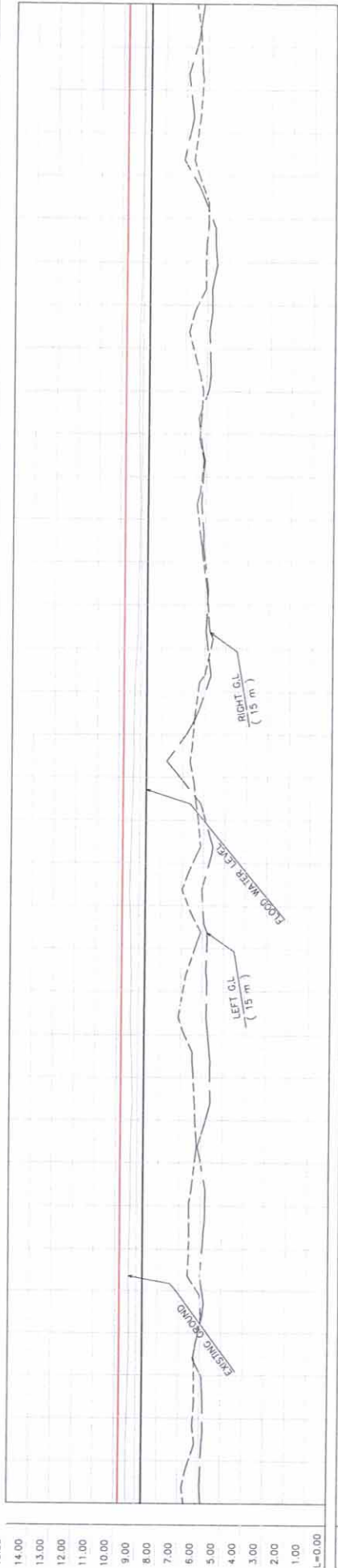

CROSS SECTION TYPE	TYPE-7	TYPE-7
SURF- ELEVATION	3.00 - 3.00	3.00 - 3.00
HORIZONTAL CURVATURE	∞	Rc=1420 Lc=349.607
STATION	37+100, 37+120, 37+140, 37+160, 37+180, 37+200, 37+220, 37+240, 37+260, 37+280, 37+300, 37+320, 37+340, 37+360, 37+380, 37+400, 37+420, 37+440, 37+460, 37+480, 37+500, 37+520, 37+540, 37+560, 37+580, 37+600, 37+620, 37+640, 37+660, 37+680, 37+700, 37+720, 37+740, 37+760, 37+780, 37+800	9.42, 9.44, 9.41, 9.785, 9.784, 9.783, 9.782, 9.782, 9.781, 9.780, 9.779, 9.778, 9.777, 9.777, 9.777, 9.774, 9.775, 9.40, 9.35, 9.35, 9.31, 9.772, 9.772, 9.30, 9.772, 9.26, 9.771, 9.770, 9.770, 9.12, 9.769, 9.768, 9.768, 9.767, 9.767, 9.08, 9.767, 9.13, 9.766, 9.15, 9.765, 9.16, 9.764, 9.11, 9.763, 9.07, 9.762, 9.06, 9.762, 9.03, 9.761, 9.01, 9.760, 9.02, 9.759, 9.01, 9.758, 9.00, 9.757
PAVEMENT VERTICAL ALIGNMENT	0+0.00	0+0.00

MINISTRY OF PUBLIC WORKS AND TRANSPORT (MPWT)

THE PROJECT FOR THE IMPROVEMENT OF NATIONAL ROAD NO.1 (PHNOM PENH-NEAK LOUENG SECTION) IN THE KINGDOM OF CAMBODIA

JAPAN INTERNATIONAL COOPERATION AGENCY KATAHIRA & ENGINEERS INTERNATIONAL CTI ENGINEERING INTERNATIONAL CO.,LTD

TITLE : PLAN AND PROFILE
STA.37+100 - STA.37+800

SCALE
H=1/2000
V=1/200

Drawing No.
Sheet No.
54

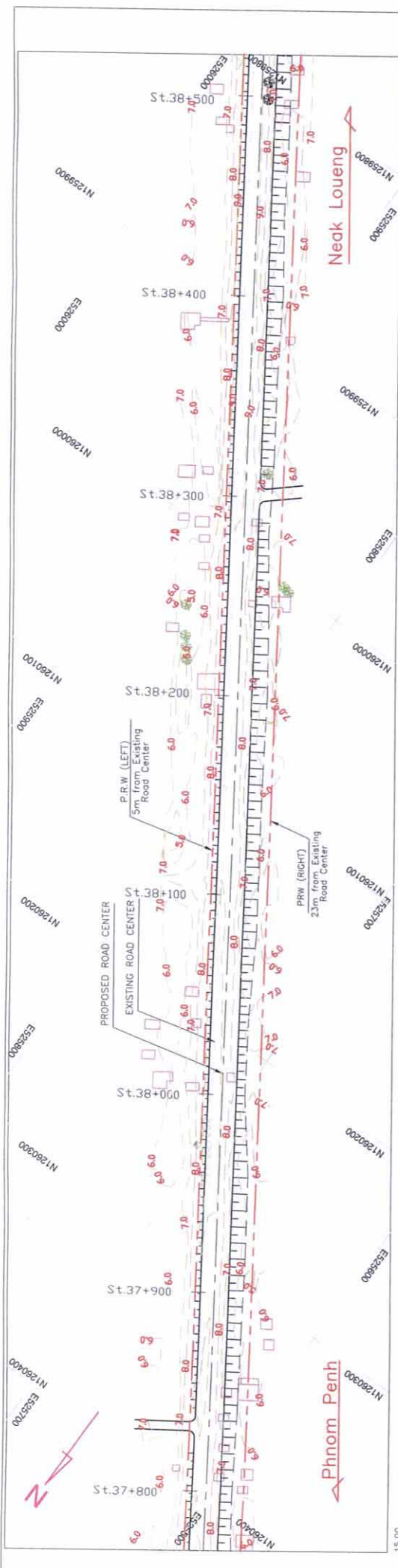

CROSS SECTION TYPE	TYPE-7	
SUPER-ELEVATION	NG	
HORIZONTAL CURVATURE	Rc=∞ L=1211.401	
STATION	GROUND HEIGHT	PAVEMENT HEIGHT
37+800	9.00	9.757
37+820	9.00	9.757
37+840	9.01	9.756
37+860	9.01	9.755
37+880	8.97	9.754
37+900	8.94	9.753
37+920	8.94	9.752
37+940	9.01	9.752
37+960	9.10	9.751
37+980	9.19	9.750
38+000	9.19	9.749
38+020	9.16	9.748
38+040	9.13	9.747
38+060	9.07	9.747
38+080	9.03	9.746
38+100	9.01	9.745
38+120	8.95	9.744
38+140	8.86	9.743
38+160	8.84	9.742
38+180	8.85	9.742
38+200	8.86	9.741
38+220	8.86	9.740
38+240	8.83	9.739
38+260	8.89	9.738
38+280	8.99	9.737
38+300	9.10	9.737
38+320	9.19	9.736
38+340	9.21	9.735
38+360	9.22	9.734
38+380	9.26	9.733
38+400	9.33	9.732
38+420	9.39	9.732
38+440	9.43	9.731
38+460	9.42	9.730
38+480	9.38	9.729
38+500	9.35	9.728

MINISTRY OF PUBLIC WORKS AND TRANSPORT (MPWT)

THE PROJECT FOR THE IMPROVEMENT OF NATIONAL ROAD NO.1 (PHNOM PENH-NEAK LOUENG SECTION) IN THE KINGDOM OF CAMBODIA

JAPAN INTERNATIONAL COOPERATION AGENCY
KATAHIRA & ENGINEERS INTERNATIONAL
CTI ENGINEERING INTERNATIONAL CO.,LTD

TITLE : PLAN AND PROFILE
STA.37+800 - STA.38+500

SCALE
H=1/2000
V=1/200

Drawing No. _____
Sheet No. 55

TYPE-7

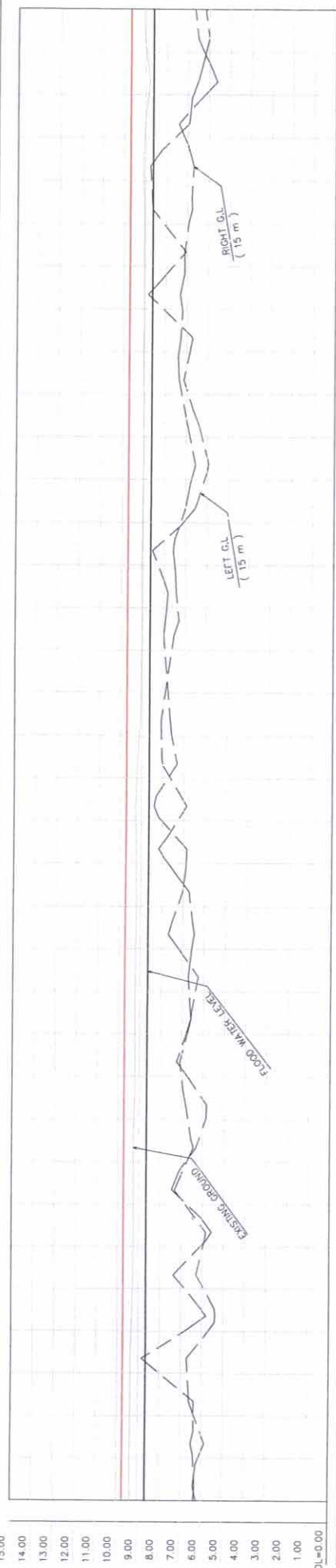
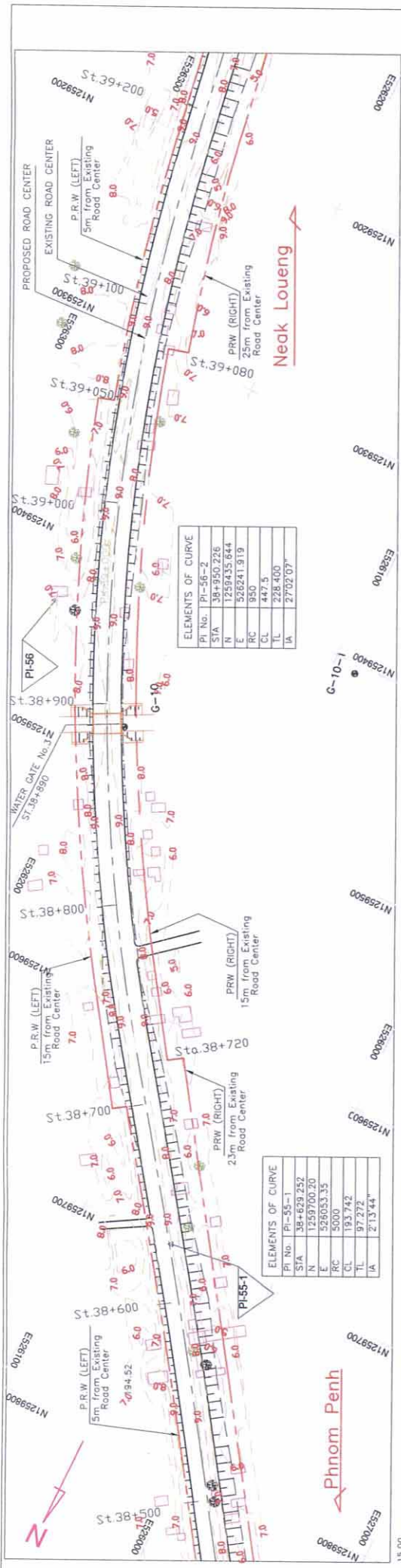

CROSS SECTION TYPE	STATION	GROUND HEIGHT	PAVEMENT HEIGHT	VERTICAL ALIGNMENT
TYPE-6	38+500	9.35	9.28	
	38+520	9.36	9.27	
	38+540	9.37	9.27	
	38+560	9.37	9.26	
	38+580	9.33	9.25	
	38+600	9.28	9.24	
	38+620	9.25	9.23	
	38+640	9.25	9.22	
	38+660	9.27	9.21	
	38+680	9.24	9.21	
	38+700	9.21	9.20	
	38+720	9.22	9.19	
	38+740	9.23	9.18	
	38+760	9.22	9.17	
	38+780	9.21	9.16	
	38+800	9.23	9.16	
	38+820	9.27	9.15	
	38+840	9.24	9.14	
	38+860	9.12	9.13	
	38+880	9.05	9.12	
	38+900	9.03	9.11	
	38+920	9.04	9.11	
	38+940	9.05	9.10	
	38+960	9.03	9.09	
	38+980	9.01	9.08	
	39+000	9.00	9.07	
	39+020	9.00	9.06	
	39+040	9.03	9.06	
	39+060	9.01	9.05	
	39+080	9.02	9.04	
	39+100	9.03	9.03	
	39+120	9.08	9.02	
	39+140	9.04	9.01	
	39+160	8.85	9.01	
	39+180	8.96	9.00	
	39+200	9.09	9.00	

Horizontal Curve Data:

- BC: $R_c=5000$, $L=193.742$
- EC: $R_c=950$, $L_c=447.500$

Vertical Curve Data:

- Vertical Curve: $e=3\%$
- Stationing: $38+701.476$, $38+751.476$, $39+149.425$

MINISTRY OF PUBLIC WORKS AND TRANSPORT (MPWT)	THE PROJECT FOR THE IMPROVEMENT OF NATIONAL ROAD NO.1 (PHNOM PENH-NEAK LOUENG SECTION) IN THE KINGDOM OF CAMBODIA	JAPAN INTERNATIONAL COOPERATION AGENCY KATAHIRA & ENGINEERS INTERNATIONAL CTI ENGINEERING INTERNATIONAL CO.,LTD	TITLE :	PLAN AND PROFILE	SCALE	Drawing No.
				STA.38+500 - STA.39+200	H=1/2000 V=1/200	Sheet No. 56

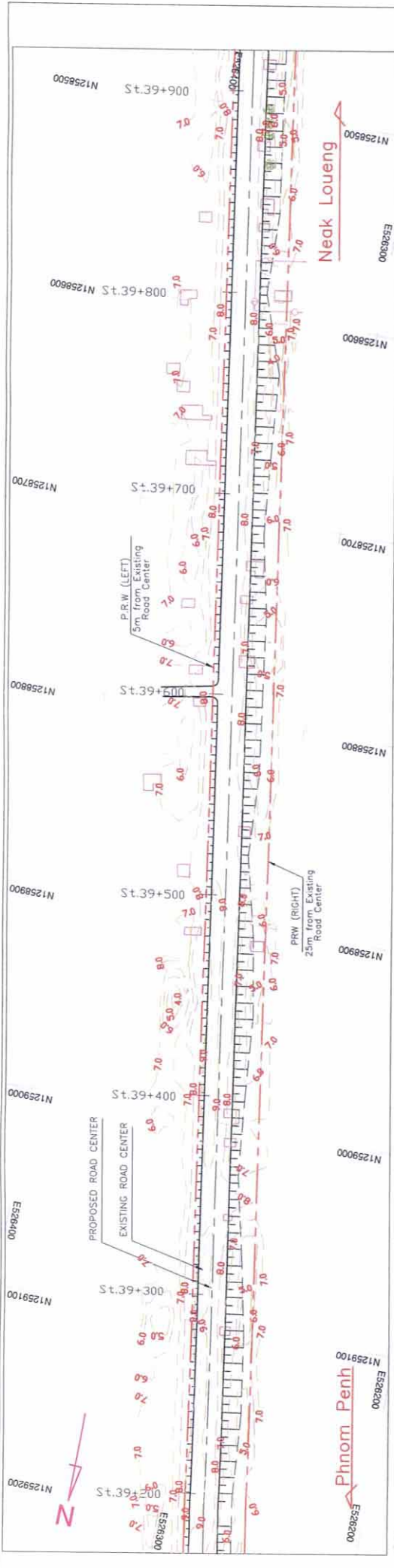

CROSS SECTION TYPE	SURF ELEVATION	HORIZONTAL CURVATURE	STATION	GROUND HEIGHT	PAVEMENT HEIGHT
TYPE-9	3.00		39+200	9.699	9.699
	3.00		39+220	9.698	9.698
TYPE-6	3.00		39+240	9.697	9.697
	3.00		39+260	9.696	9.696
TYPE-9	3.00		39+280	9.696	9.696
	3.00		39+300	9.695	9.695
TYPE-9	3.00		39+320	9.694	9.694
	3.00		39+340	9.693	9.693
TYPE-9	3.00		39+360	9.692	9.692
	3.00		39+380	9.691	9.691
TYPE-9	3.00		39+400	9.691	9.691
	3.00		39+420	9.690	9.690
TYPE-9	3.00		39+440	9.689	9.689
	3.00		39+460	9.688	9.688
TYPE-9	3.00		39+480	9.687	9.687
	3.00		39+500	9.686	9.686
TYPE-9	3.00		39+520	9.685	9.685
	3.00		39+540	9.684	9.684
TYPE-9	3.00		39+560	9.684	9.684
	3.00		39+580	9.683	9.683
TYPE-9	3.00		39+600	9.682	9.682
	3.00		39+620	9.681	9.681
TYPE-9	3.00		39+640	9.681	9.681
	3.00		39+660	9.680	9.680
TYPE-9	3.00		39+680	9.679	9.679
	3.00		39+700	9.678	9.678
TYPE-9	3.00		39+720	9.677	9.677
	3.00		39+740	9.676	9.676
TYPE-9	3.00		39+760	9.676	9.676
	3.00		39+780	9.675	9.675
TYPE-9	3.00		39+800	9.674	9.674
	3.00		39+820	9.673	9.673
TYPE-9	3.00		39+840	9.672	9.672
	3.00		39+860	9.671	9.671
TYPE-9	3.00		39+880	9.671	9.671
	3.00		39+900	9.670	9.670

MINISTRY OF PUBLIC WORKS AND TRANSPORT (MPWT)

THE PROJECT FOR THE IMPROVEMENT OF NATIONAL ROAD NO.1 (PHNOM PENH-NEAK LOUENG SECTION) IN THE KINGDOM OF CAMBODIA

JAPAN INTERNATIONAL COOPERATION AGENCY
KATAHIRA & ENGINEERS INTERNATIONAL
CTI ENGINEERING INTERNATIONAL CO.,LTD

TITLE : PLAN AND PROFILE
STA.39+200 - STA.39+900

SCALE
H=1/2000
V=1/200

Drawing No. _____
Sheet No. 57

TYPE-9
TYPE-6

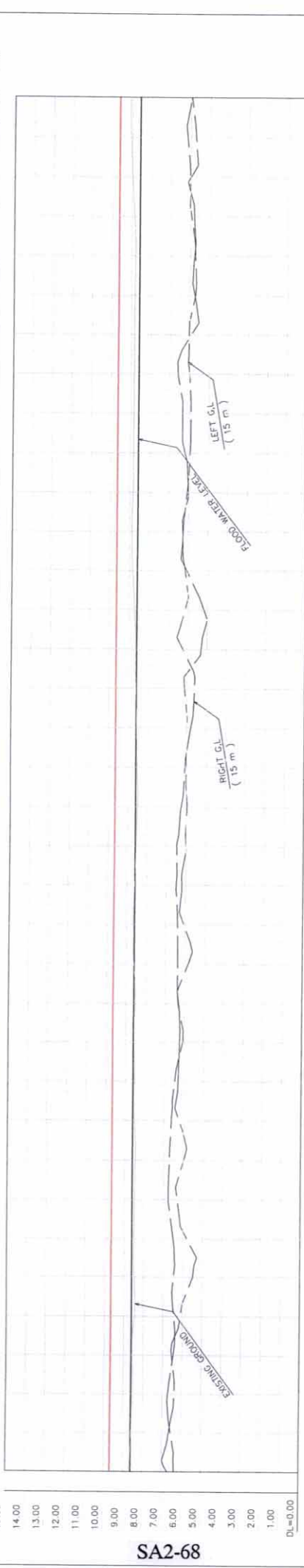
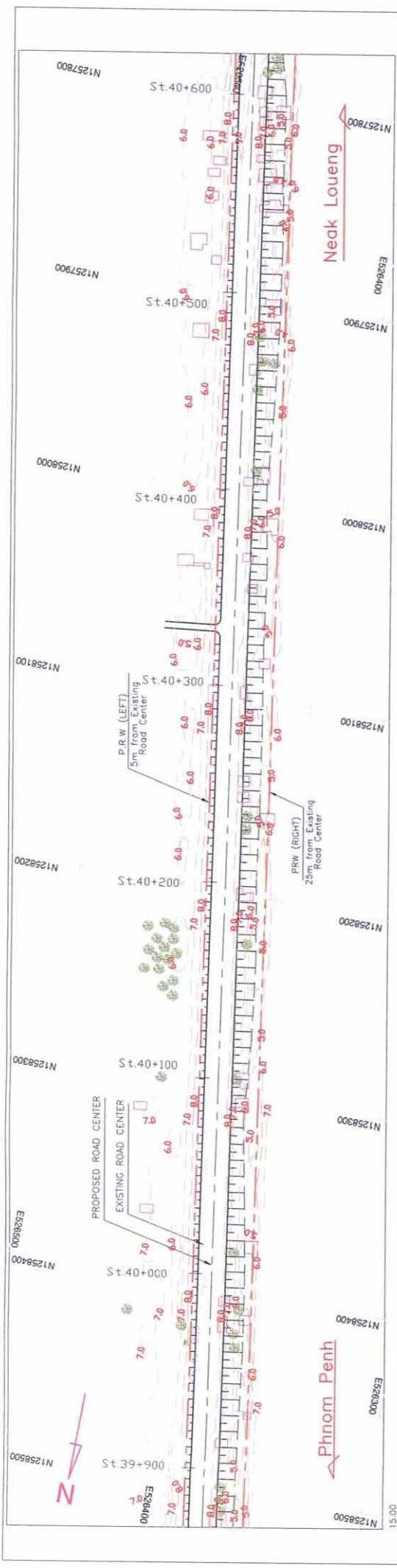

CROSS SECTION TYPE	TYPE-6
VERTICAL ALIGNMENT	TYPE-6
PAVEMENT HEIGHT	9.670, 9.669, 9.668, 9.667, 9.666, 9.665, 9.664, 9.663, 9.662, 9.661, 9.660, 9.659, 9.658, 9.657, 9.656, 9.655, 9.654, 9.653, 9.652, 9.651, 9.650, 9.649, 9.648, 9.647, 9.646, 9.645, 9.644, 9.643, 9.642, 9.641, 9.640
GROUND HEIGHT	9.670, 9.669, 9.668, 9.667, 9.666, 9.665, 9.664, 9.663, 9.662, 9.661, 9.660, 9.659, 9.658, 9.657, 9.656, 9.655, 9.654, 9.653, 9.652, 9.651, 9.650, 9.649, 9.648, 9.647, 9.646, 9.645, 9.644, 9.643, 9.642, 9.641, 9.640
STATION	39+900, 39+920, 39+940, 39+960, 39+980, 40+000, 40+020, 40+040, 40+060, 40+080, 40+100, 40+120, 40+140, 40+160, 40+180, 40+200, 40+220, 40+240, 40+260, 40+280, 40+300, 40+320, 40+340, 40+360, 40+380, 40+400, 40+420, 40+440, 40+460, 40+480, 40+500, 40+520, 40+540, 40+560, 40+580, 40+600
HORIZONTAL CURVATURE	Rc=∞∞∞ L=1790.993
SUPER-ELEVATION	NC

MINISTRY OF PUBLIC WORKS AND TRANSPORT (MPWT)

THE PROJECT FOR THE IMPROVEMENT OF NATIONAL ROAD NO.1 (PHNOM PENH-NEAK LOUENG SECTION) IN THE KINGDOM OF CAMBODIA

JAPAN INTERNATIONAL COOPERATION AGENCY
KATAHIRA & ENGINEERS INTERNATIONAL
CTI ENGINEERING INTERNATIONAL CO.,LTD

TITLE : PLAN AND PROFILE
STA.39+500 - STA.40+600

SCALE
H=1/2000
V=1/200

Drawing No.
Sheet No.
58

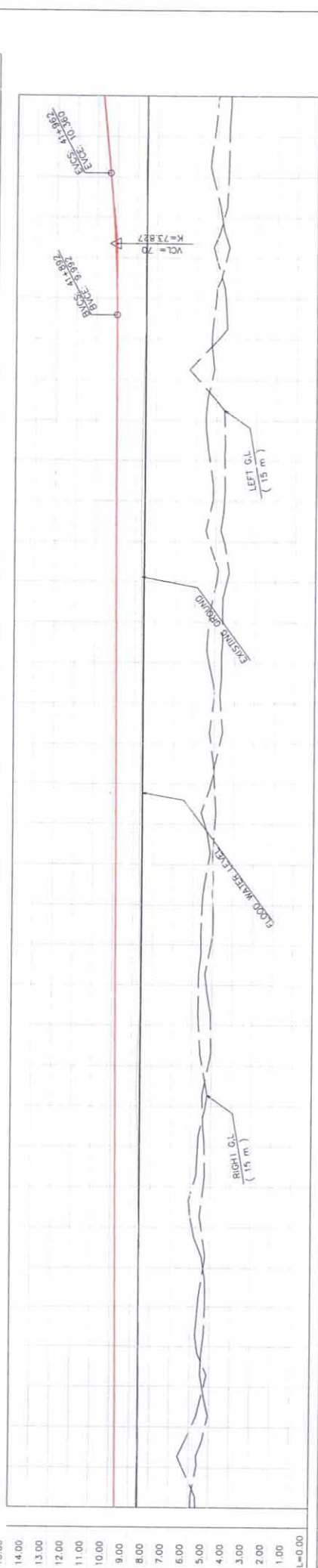
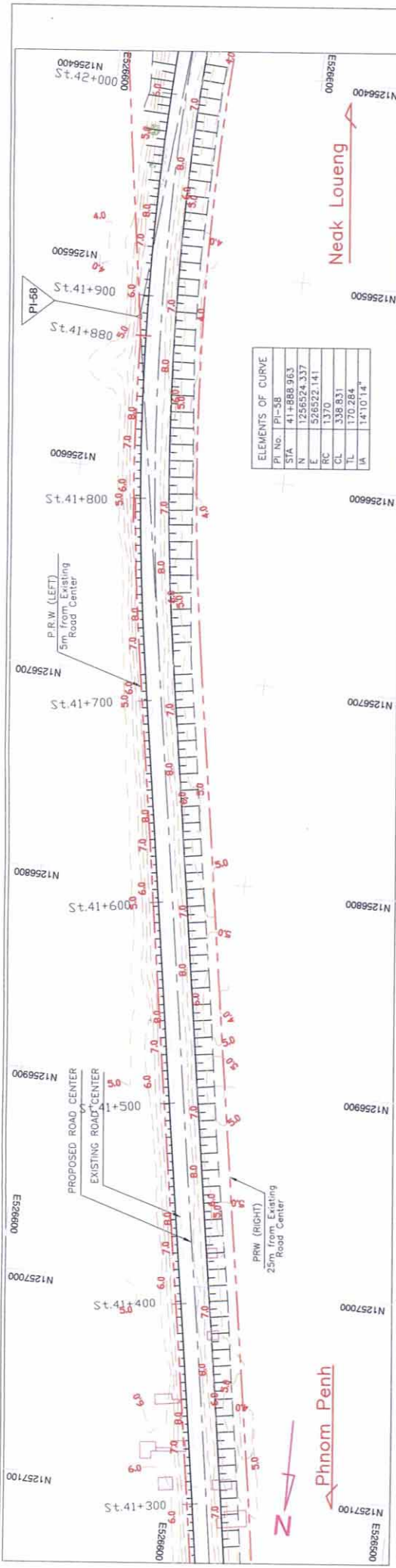

CROSS SECTION TYPE	SUPER-ELEVATION	HORIZONTAL ALIGNMENT	STATION	GROUND HEIGHT	PAVEMENT HEIGHT
TYPE-6	NG	Rc=∞ L=754.258	41+300	8.61	9.685
			41+340	8.54	9.706
			41+360	8.51	9.716
			41+380	8.54	9.726
			41+400	8.53	9.737
			41+420	8.53	9.747
			41+440	8.57	9.758
			41+460	8.61	9.768
			41+480	8.63	9.778
			41+500	8.70	9.789
TYPE-6	e=3%	Rc=1370 Lc=338.830	41+520	8.70	9.799
			41+540	8.62	9.809
			41+560	8.60	9.820
			41+580	8.63	9.830
			41+600	8.64	9.840
			41+620	8.67	9.851
			41+640	8.67	9.861
			41+660	8.66	9.872
			41+680	8.64	9.882
			41+700	8.62	9.892
TYPE-6	e=3%	Rc=1370 Lc=338.830	41+720	8.63	9.903
			41+740	8.64	9.913
			41+760	8.66	9.923
			41+780	8.68	9.934
			41+800	8.70	9.944
			41+820	8.69	9.955
			41+840	8.67	9.965
			41+860	8.63	9.975
			41+880	8.58	9.986
			41+900	8.58	10.000
TYPE-6	e=3%	Rc=1370 Lc=338.830	41+920	8.58	10.059
			41+940	8.55	10.173
			41+960	8.57	10.340
			41+980	8.56	10.540
			42+000	8.54	10.740

MINISTRY OF PUBLIC WORKS AND TRANSPORT (MPWT)	THE PROJECT FOR THE IMPROVEMENT OF NATIONAL ROAD NO.1 (PHNOM PENH-NEAK LOUENG SECTION) IN THE KINGDOM OF CAMBODIA	JAPAN INTERNATIONAL COOPERATION AGENCY KATAHIRA & ENGINEERS INTERNATIONAL CTI ENGINEERING INTERNATIONAL CO.,LTD	TITLE :	PLAN AND PROFILE	SCALE	H=1/2000 V=1/200	Drawing No.	Sheet No.
				STA.41+300 - STA.42+000				60

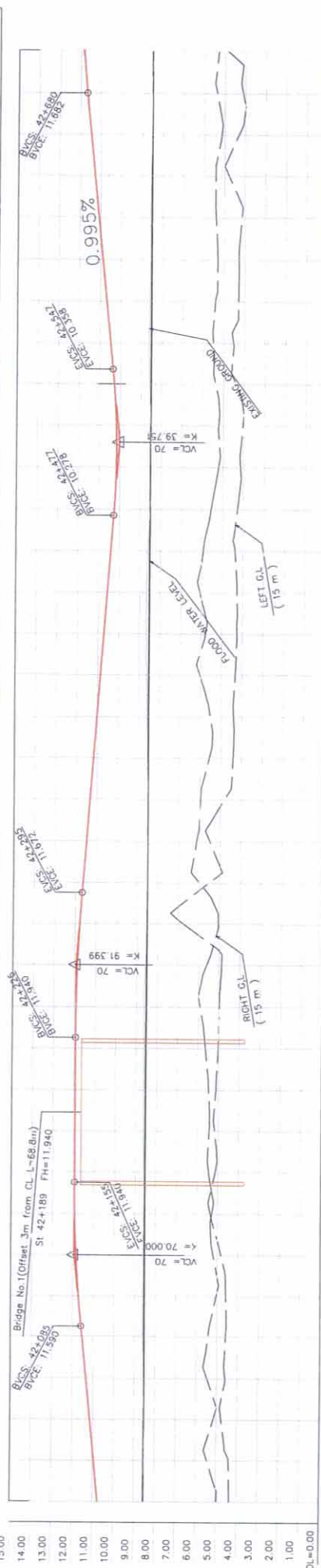
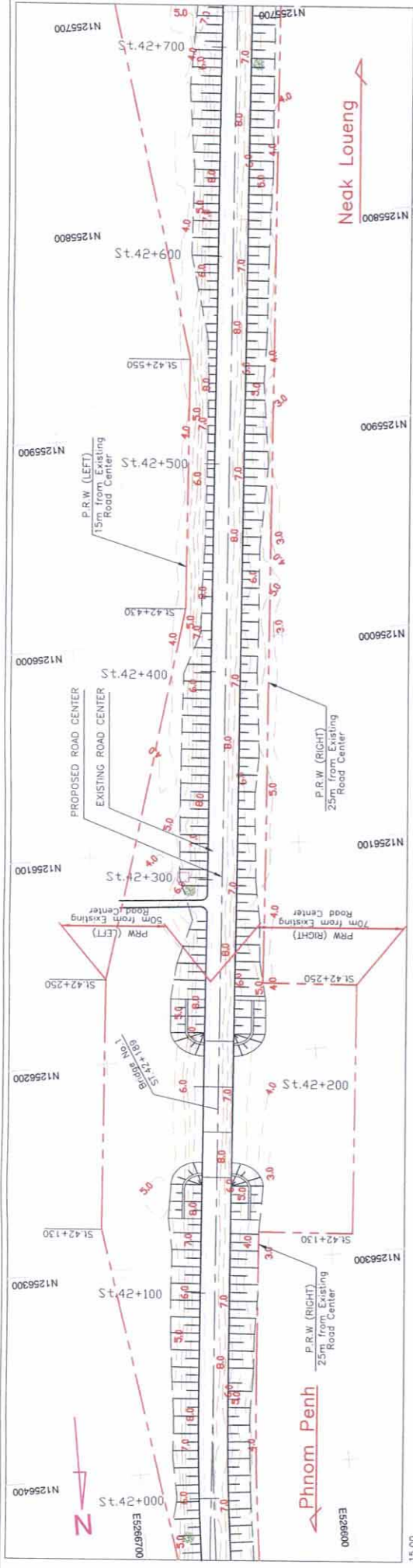

CROSS SECTION TYPE	ELEVATION	STATION	GROUND HEIGHT	PAVEMENT HEIGHT	VERTICAL ALIGNMENT
TYPE-7	3.00	000+00	8.54	10.740	L=140.000 R=0.000
	3.00	000+00	8.51	10.940	
TYPE-7	3.00	000+00	8.53	11.140	L=140.000 R=0.000
	3.00	000+00	8.56	11.340	
TYPE-7	3.00	000+00	8.61	11.540	L=140.000 R=0.000
	3.00	000+00	8.60	11.724	
TYPE-7	3.00	000+00	8.60	11.724	L=140.000 R=0.000
	3.00	000+00	8.59	11.852	
TYPE-7	3.00	000+00	8.57	11.924	L=140.000 R=0.000
	3.00	000+00	8.60	11.940	
TYPE-7	3.00	000+00	8.60	11.940	L=140.000 R=0.000
	3.00	000+00	8.63	11.940	
TYPE-7	3.00	000+00	8.63	11.940	L=140.000 R=0.000
	3.00	000+00	8.62	11.940	
TYPE-7	3.00	000+00	8.63	11.940	L=140.000 R=0.000
	3.00	000+00	8.64	11.928	
TYPE-7	3.00	000+00	8.58	11.873	L=140.000 R=0.000
	3.00	000+00	8.56	11.775	
TYPE-7	3.00	000+00	8.54	11.634	L=140.000 R=0.000
	3.00	000+00	8.54	11.480	
TYPE-7	3.00	000+00	8.54	11.327	L=140.000 R=0.000
	3.00	000+00	8.54	11.174	
TYPE-7	3.00	000+00	8.59	11.021	L=140.000 R=0.000
	3.00	000+00	8.63	10.868	
TYPE-7	3.00	000+00	8.66	10.715	L=140.000 R=0.000
	3.00	000+00	8.66	10.420	
TYPE-7	3.00	000+00	8.66	10.420	L=140.000 R=0.000
	3.00	000+00	8.66	10.561	
TYPE-7	3.00	000+00	8.67	10.408	L=140.000 R=0.000
	3.00	000+00	8.52	10.256	
TYPE-7	3.00	000+00	8.48	10.168	L=140.000 R=0.000
	3.00	000+00	8.52	10.181	
TYPE-7	3.00	000+00	8.59	10.295	L=140.000 R=0.000
	3.00	000+00	8.59	10.488	
TYPE-7	3.00	000+00	8.62	10.488	L=140.000 R=0.000
	3.00	000+00	8.61	10.687	
TYPE-7	3.00	000+00	8.58	10.886	L=140.000 R=0.000
	3.00	000+00	8.59	11.085	
TYPE-7	3.00	000+00	8.56	11.284	L=140.000 R=0.000
	3.00	000+00	8.54	11.483	
TYPE-7	3.00	000+00	8.53	11.682	L=140.000 R=0.000
	3.00	000+00	8.47	11.852	

MINISTRY OF PUBLIC WORKS AND TRANSPORT (MPWT)

THE PROJECT FOR THE IMPROVEMENT OF NATIONAL ROAD NO.1 (PHNOM PENH-NEAK LOUENG SECTION) IN THE KINGDOM OF CAMBODIA

JAPAN INTERNATIONAL COOPERATION AGENCY KATAHIRA & ENGINEERS INTERNATIONAL CTI ENGINEERING INTERNATIONAL CO.,LTD

TITLE: PLAN AND PROFILE STA.42+000 - STA.42+700

SCALE: H=1/2000 V=1/200

Drawing No. 61

Sheet No. 61

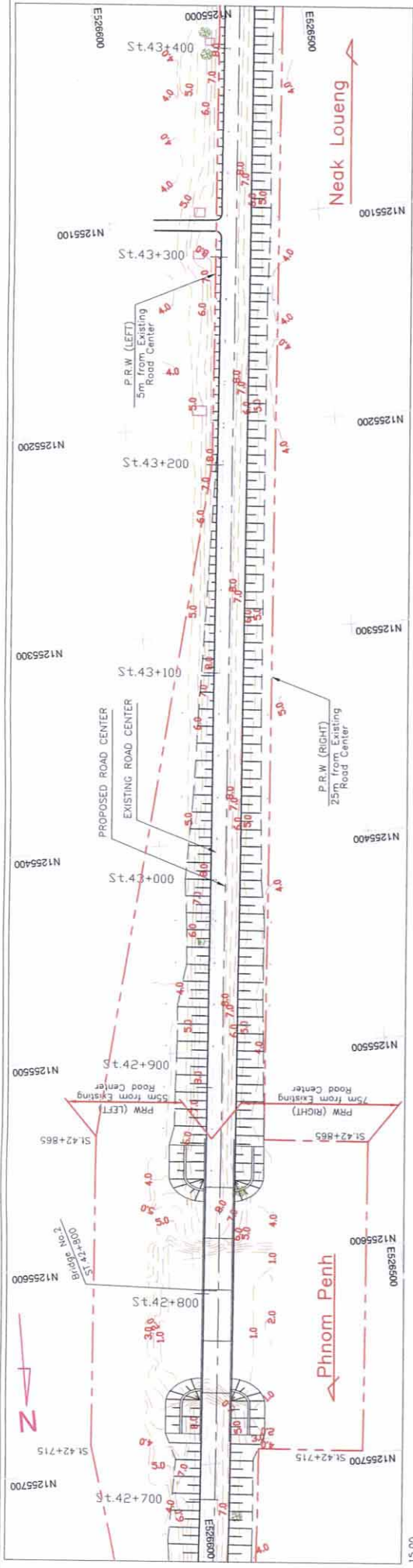

CROSS SECTION TYPE	ELEVATION	STATION	GROUND HEIGHT	PAVEMENT HEIGHT	VERTICAL ALIGNMENT
TYPE-7	11.852	42+700	8.47	11.966	12.030
	8.41	42+720	8.42	12.030	12.030
	0.60	42+760	0.31	12.030	12.030
	0.40	42+800	2.39	12.030	12.030
	8.59	42+840	8.59	12.030	12.030
	8.53	42+860	8.53	12.026	12.026
	8.48	42+900	8.48	11.872	11.872
	8.50	42+920	8.50	11.709	11.709
	8.48	42+940	8.48	11.510	11.510
	8.54	42+960	8.54	11.310	11.310
8.55	42+980	8.55	11.110	11.110	
8.59	43+000	8.59	10.910	10.910	
8.62	43+020	8.62	10.710	10.710	
8.63	43+040	8.63	10.510	10.510	
8.61	43+060	8.61	10.311	10.311	
8.53	43+080	8.53	10.147	10.147	
8.52	43+100	8.52	10.040	10.040	
9.989	43+120	8.53	9.989	9.989	
8.54	43+140	8.54	9.982	9.982	
8.57	43+160	8.57	9.979	9.979	
8.53	43+180	8.53	9.976	9.976	
8.56	43+200	8.56	9.972	9.972	
8.62	43+220	8.62	9.969	9.969	
8.63	43+240	8.63	9.966	9.966	
8.65	43+260	8.65	9.963	9.963	
8.67	43+280	8.67	9.960	9.960	
8.68	43+300	8.68	9.956	9.956	
8.61	43+320	8.61	9.953	9.953	
8.70	43+340	8.70	9.950	9.950	
8.72	43+360	8.72	9.947	9.947	
8.67	43+380	8.67	9.943	9.943	
8.67	43+400	8.67	9.940	9.940	

MINISTRY OF PUBLIC WORKS AND TRANSPORT (MPWT)

THE PROJECT FOR THE IMPROVEMENT OF NATIONAL ROAD NO.1 (PHNOM PENH-NEAK LOUENG SECTION) IN THE KINGDOM OF CAMBODIA

JAPAN INTERNATIONAL COOPERATION AGENCY
KATAHIRA & ENGINEERS INTERNATIONAL
CTI ENGINEERING INTERNATIONAL CO.,LTD

TITLE : PLAN AND PROFILE
STA.42+700 - STA.43+400

SCALE
H=1/2000
V=1/200

Drawing No. _____
Sheet No. 62

TYPE-7

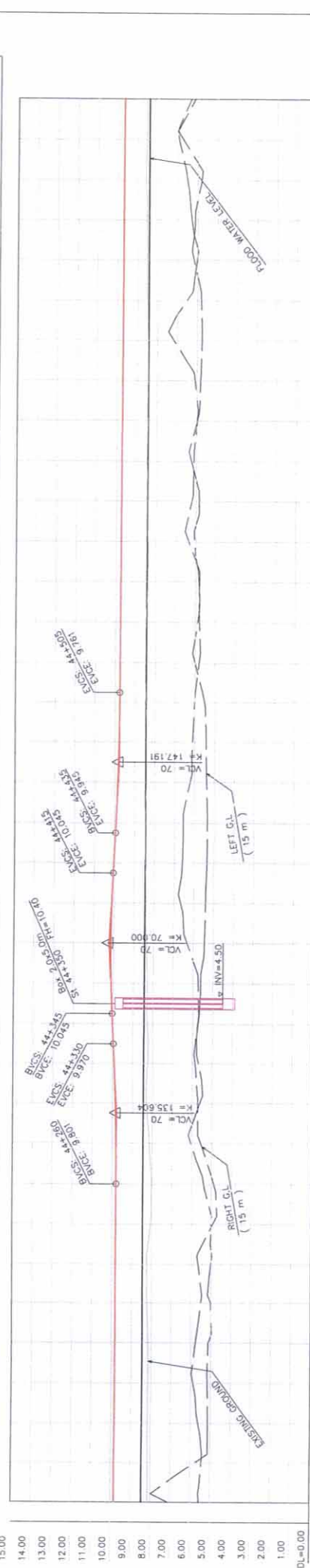
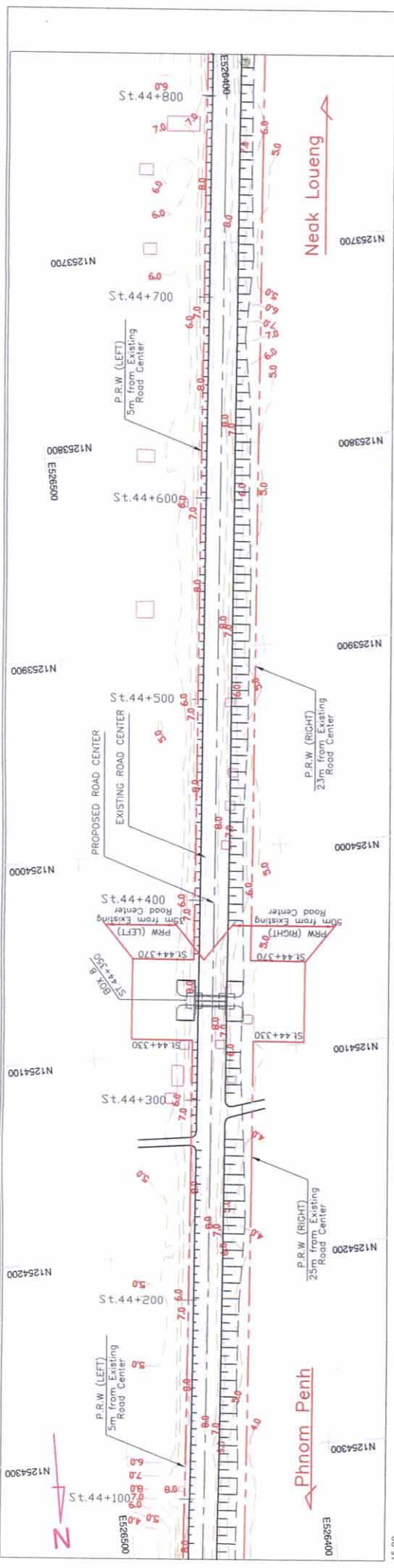

CROSS SECTION TYPE	TYPE-7	
SECTION TYPE	ELEVATION	NG
HORIZONTAL	CURVATURE	L=3881.684 Rc=∞
STATION	GROUND HEIGHT	PROPOSED HEIGHT
44+100	8.14	9.827
44+120	8.14	9.823
44+140	8.16	9.820
44+160	8.15	9.817
44+180	8.17	9.814
44+200	8.22	9.810
44+220	8.23	9.807
44+240	8.06	9.804
44+260	8.04	9.801
44+280	8.14	9.812
44+300	8.29	9.853
44+320	8.24	9.924
44+340	8.28	10.020
44+360	8.29	10.104
44+380	8.36	10.132
44+400	8.40	10.104
44+420	8.44	10.020
44+440	8.46	9.921
44+460	8.40	9.841
44+480	8.41	9.789
44+500	8.45	9.764
44+520	8.49	9.758
44+540	8.48	9.753
44+560	8.39	9.748
44+580	8.40	9.743
44+600	8.42	9.738
44+620	8.48	9.733
44+640	8.44	9.728
44+660	8.45	9.724
44+680	8.47	9.719
44+700	8.52	9.714
44+720	8.53	9.709
44+740	8.55	9.704
44+760	8.60	9.699
44+780	8.57	9.694
44+800	8.59	9.689

MINISTRY OF PUBLIC WORKS AND TRANSPORT (MPWT)

THE PROJECT FOR THE IMPROVEMENT OF NATIONAL ROAD NO.1 (PHNOM PENH-NEAK LOUENG SECTION) IN THE KINGDOM OF CAMBODIA

JAPAN INTERNATIONAL COOPERATION AGENCY KATAHIRA & ENGINEERS INTERNATIONAL CTI ENGINEERING INTERNATIONAL CO.,LTD

TITLE : PLAN AND PROFILE STA.44+100 - STA.44+800

SCALE H=1/2000 V=1/200

Drawing No. Sheet No. 64

TYPE-7

ELEMENTS OF CURVE	
PI No.	PI-61
STA	45+475.566
N	1252954.786
E	526331.106
PC	5000
CL	150.244
TL	25.129
IA	01°43'17.75"

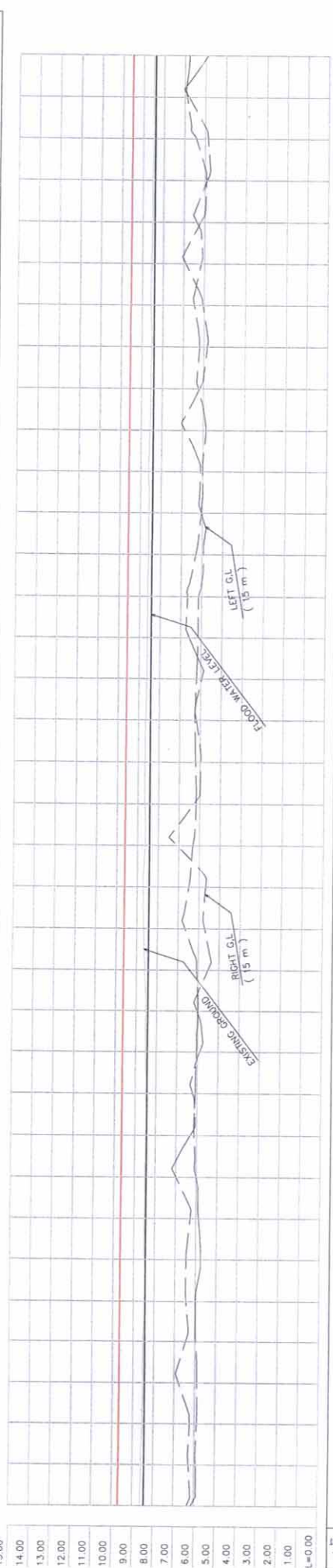
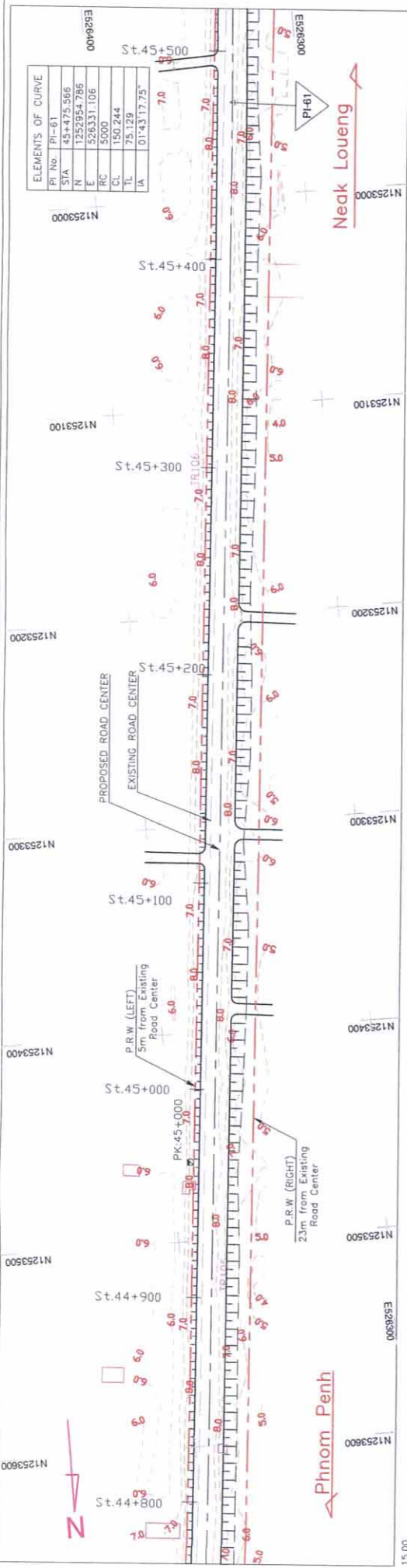

CROSS SECTION TYPE	TYPE 6
STATION	44+800 - 8.59
GROUND HEIGHT	44+820 - 8.58
PAVEMENT HEIGHT	44+840 - 8.54
GROUND HEIGHT	44+860 - 8.52
STATION	44+880 - 8.52
GROUND HEIGHT	44+900 - 8.44
STATION	44+920 - 8.49
GROUND HEIGHT	44+940 - 8.50
STATION	44+960 - 8.50
GROUND HEIGHT	44+980 - 8.47
STATION	45+000 - 8.49
GROUND HEIGHT	45+020 - 8.52
STATION	45+040 - 8.51
GROUND HEIGHT	45+060 - 8.59
STATION	45+080 - 8.66
GROUND HEIGHT	45+100 - 8.71
STATION	45+120 - 8.62
GROUND HEIGHT	45+140 - 8.65
STATION	45+160 - 8.68
GROUND HEIGHT	45+180 - 8.65
STATION	45+200 - 8.61
GROUND HEIGHT	45+220 - 8.61
STATION	45+240 - 8.61
GROUND HEIGHT	45+260 - 8.58
STATION	45+280 - 8.58
GROUND HEIGHT	45+300 - 8.61
STATION	45+320 - 8.57
GROUND HEIGHT	45+340 - 8.56
STATION	45+360 - 8.51
GROUND HEIGHT	45+380 - 8.57
STATION	45+400 - 8.56
GROUND HEIGHT	45+420 - 8.52
STATION	45+440 - 8.52
GROUND HEIGHT	45+460 - 8.49
STATION	45+480 - 8.50
GROUND HEIGHT	45+500 - 8.49

MINISTRY OF PUBLIC WORKS AND TRANSPORT (MPWT)

THE PROJECT FOR THE IMPROVEMENT OF NATIONAL ROAD NO.1 (PHNOM PENH-NEAK LOUENG SECTION) IN THE KINGDOM OF CAMBODIA

JAPAN INTERNATIONAL COOPERATION AGENCY KATAHIRA & ENGINEERS INTERNATIONAL CTI ENGINEERING INTERNATIONAL CO.,LTD

TITLE : PLAN AND PROFILE (STA.44+800—STA.45+500)

SCALE H=1/2000 V=1/200

Drawing No. PL-65

Sheet No. PL-65

TYPE 6

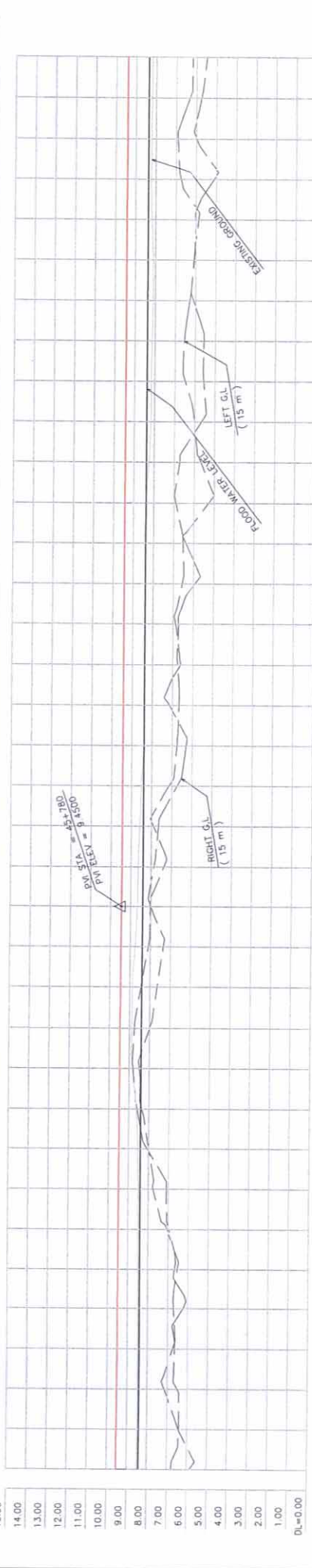
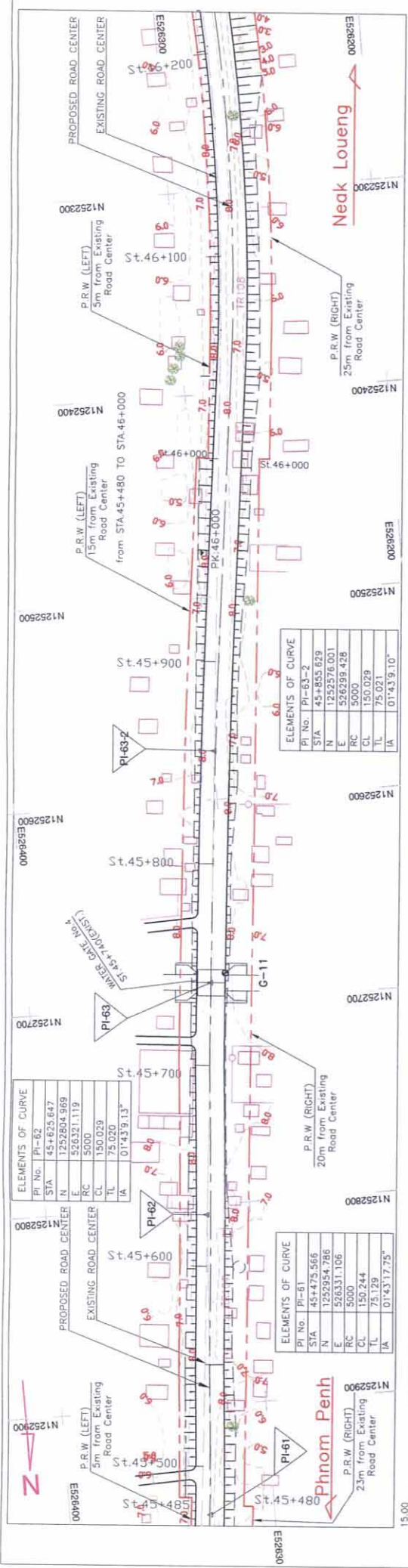

CROSS SECTION TYPE	TYPE 6	TYPE 6
PAVEMENT HEIGHT	0.00 to 1.00	0.00 to 1.00
GROUND HEIGHT	0.49 to 9.518	0.49 to 9.518
STATION	45+500 to 46+200	45+500 to 46+200
HORIZONTAL CURVATURE	Rc=5000, L=150.030	Rc=5000, L=150.028
SURF ELEVATION	3.00 to 3.00	3.00 to 3.00
VERTICAL ALIGNMENT	Vertical Curve: L=1310.00, R=1310.00	Vertical Curve: L=110.328, R=110.328

MINISTRY OF PUBLIC WORKS AND TRANSPORT (MPWT)

THE PROJECT FOR THE IMPROVEMENT OF NATIONAL ROAD NO.1 (PHNOM PENH-NEAK LOUENG SECTION) IN THE KINGDOM OF CAMBODIA

JAPAN INTERNATIONAL COOPERATION AGENCY KATAHIRA & ENGINEERS INTERNATIONAL CTI ENGINEERING INTERNATIONAL CO.,LTD

TITLE : PLAN AND PROFILE (STA.45+500-STA.46+200)

SCALE H=1/2000 V=1/200

Drawing No. PL-66

Sheet No. PL-66