

V. MAHLAH - ISMAIYAH ROAD

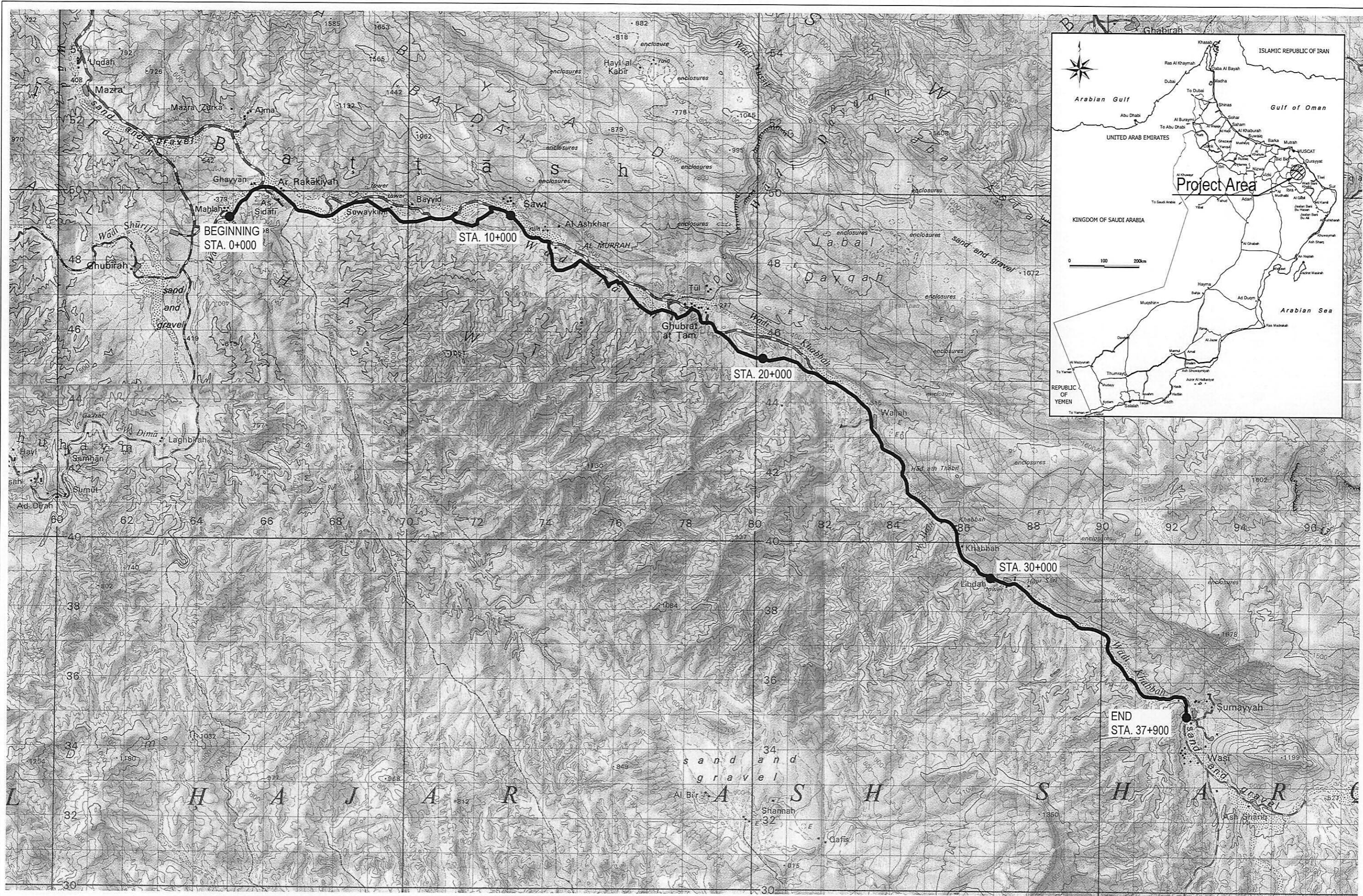

 <p>SULTANATE OF OMAN MINISTRY OF TRANSPORTATION AND COMMUNICATIONS DIRECTORATE GENERAL OF ROADS</p>	<p>JAPAN INTERNATIONAL COOPERATION AGENCY KATAHIRA & ENGINEERS INTERNATIONAL</p>	<p>THE STUDY ON THE ROAD NETWORK DEVELOPMENT IN THE SULTANATE OF OMAN</p>	<p>N36 Mahlah - Ismayyah LOCATION MAP</p>	Dwg No.	N36-1
				Scale	1 : 100000
				Date	Nov. 2004

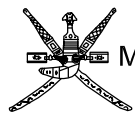
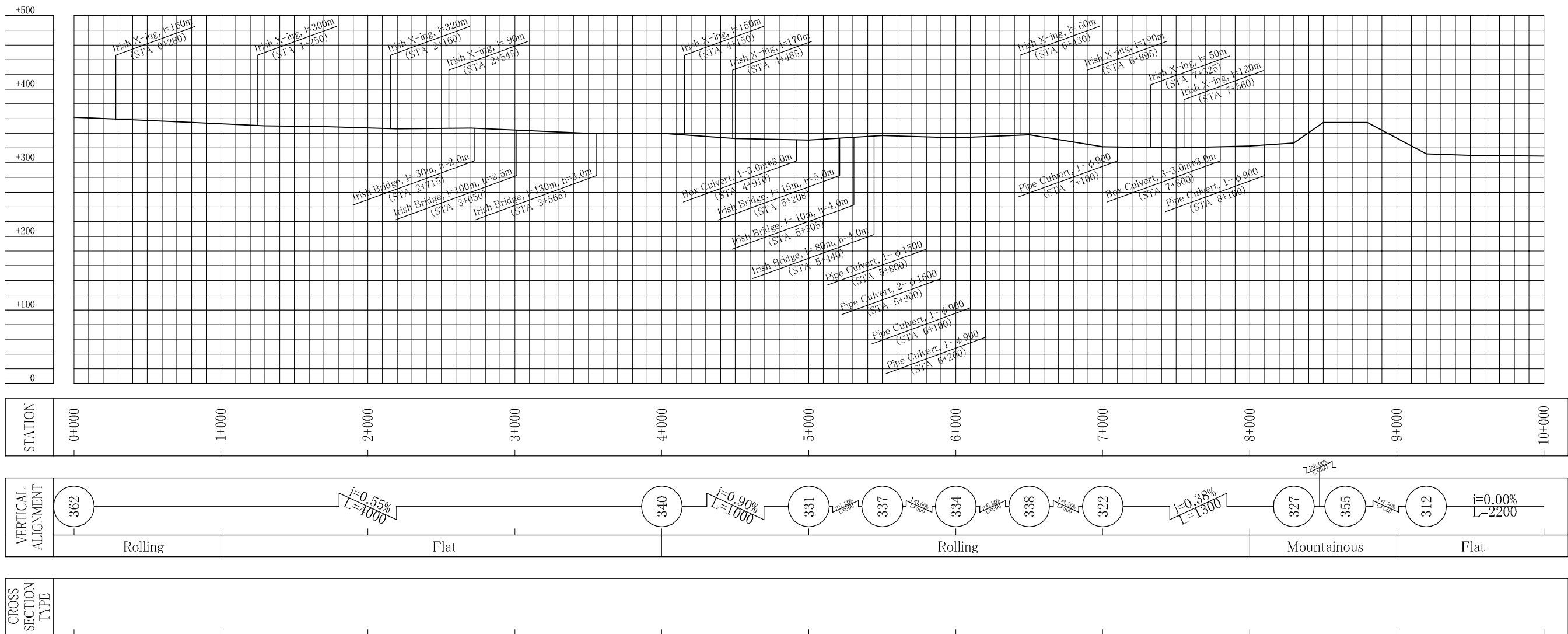
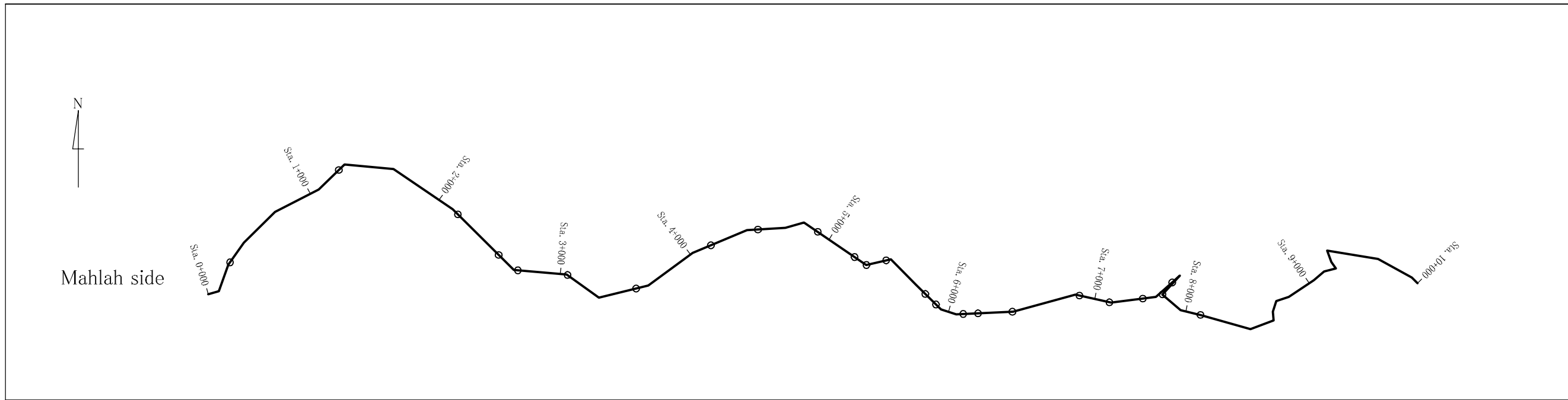

SULTANATE OF OMAN
 MINISTRY OF TRANSPORTATION AND COMMUNICATIONS
 DIRECTORATE GENERAL OF ROADS

JAPAN INTERNATIONAL COOPERATION AGENCY
 KATAHIRA & ENGINEERS INTERNATIONAL

THE STUDY ON
 THE ROAD NETWORK DEVELOPMENT
 IN THE SULTANATE OF OMAN

N36 Mahlah - Ismayyah
 PLAN AND PROFILE
 STA. 0km+000 - 10km+000

Dwg No.	N36-2
Scale	H = 1 : 30000 V = 1 : 6000
Date	Nov. 2004

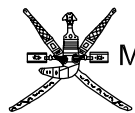
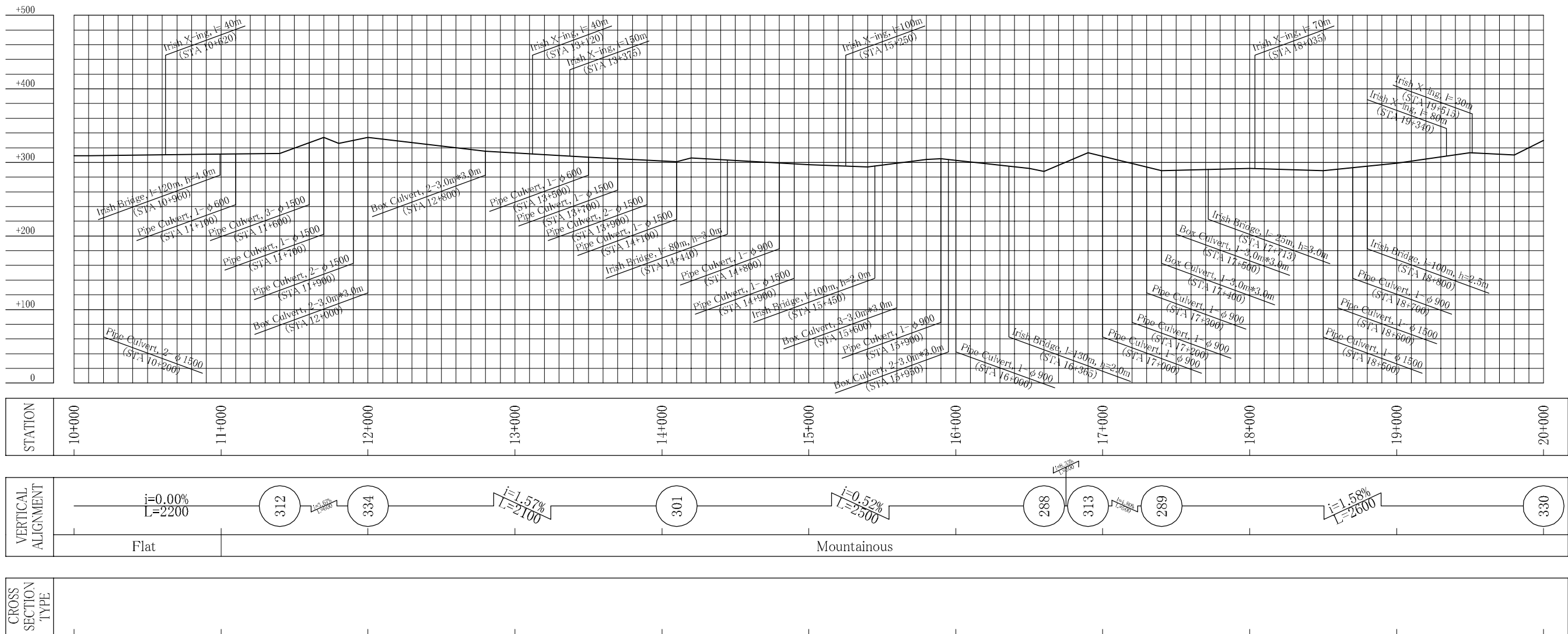
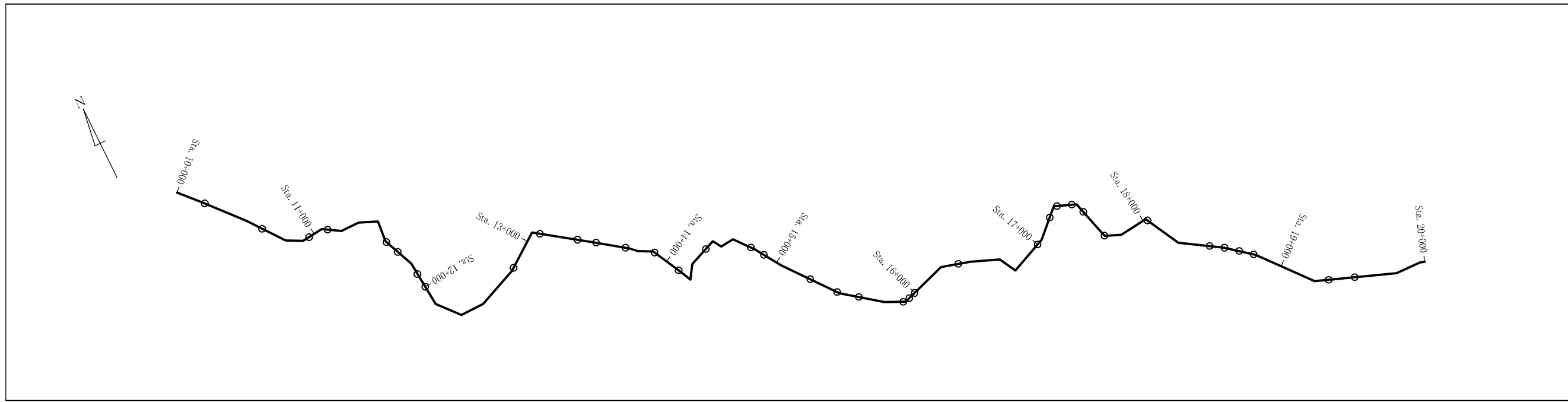

SULTANATE OF OMAN
MINISTRY OF TRANSPORTATION AND COMMUNICATIONS
DIRECTORATE GENERAL OF ROADS

JAPAN INTERNATIONAL COOPERATION AGENCY
KATAHIRA & ENGINEERS INTERNATIONAL

THE STUDY ON
THE ROAD NETWORK DEVELOPMENT
IN THE SULTANATE OF OMAN

N36 Mahlah - Ismaiya
PLAN AND PROFILE
STA. 10km+000 - 20km+000

Dwg No.	N36-3
Scale	H = 1 : 30000 V = 1 : 6000
Date	Nov. 2004

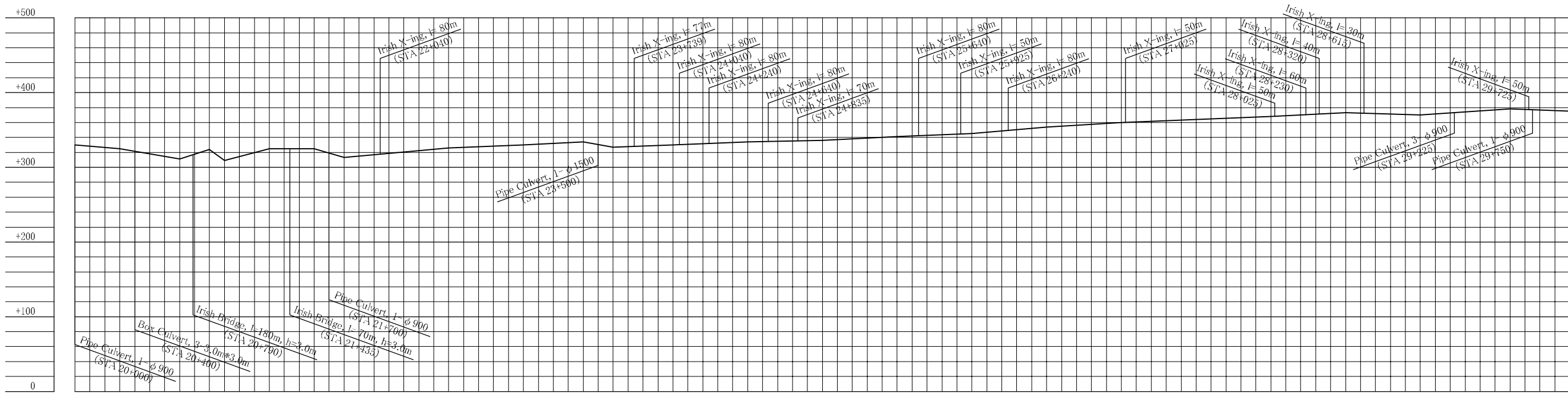
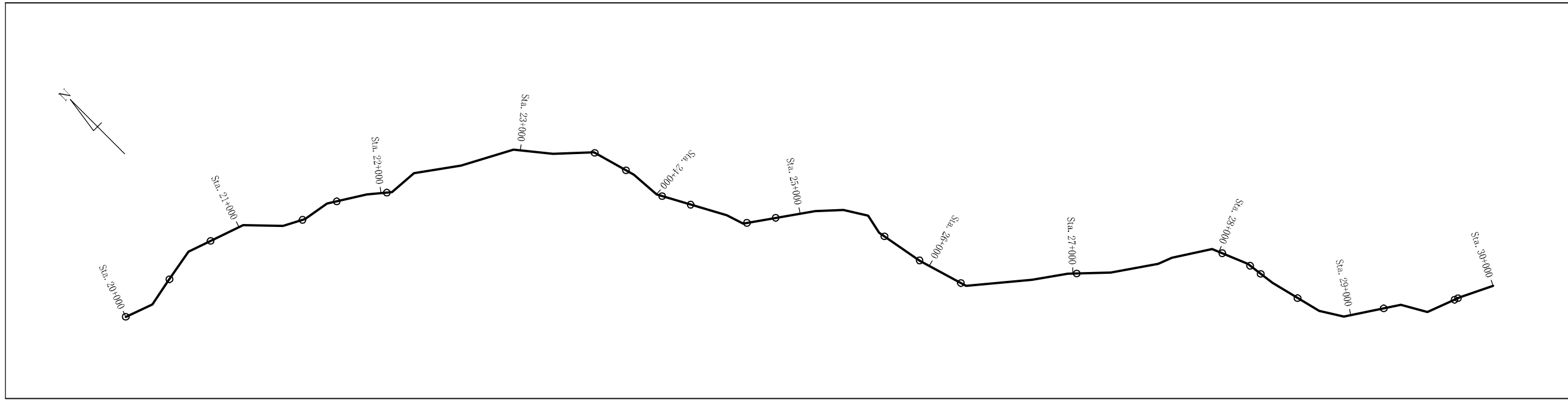

STATION	20+000	21+000	22+000	23+000	24+000	25+000	26+000	27+000	28+000	29+000	30+000
VERTICAL ALIGNMENT			Mountainous								
CROSS SECTION TYPE											

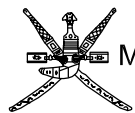

SULTANATE OF OMAN
 MINISTRY OF TRANSPORTATION AND COMMUNICATIONS
 DIRECTORATE GENERAL OF ROADS

JAPAN INTERNATIONAL COOPERATION AGENCY
 KATAHIRA & ENGINEERS INTERNATIONAL

THE STUDY ON
 THE ROAD NETWORK DEVELOPMENT
 IN THE SULTANATE OF OMAN

N36 Mahlah - Ismayyah
 PLAN AND PROFILE
 STA. 20km+000 - 30km+000

Dwg No.	N36-4
Scale	H = 1 : 30000 V = 1 : 6000
Date	Nov. 2004

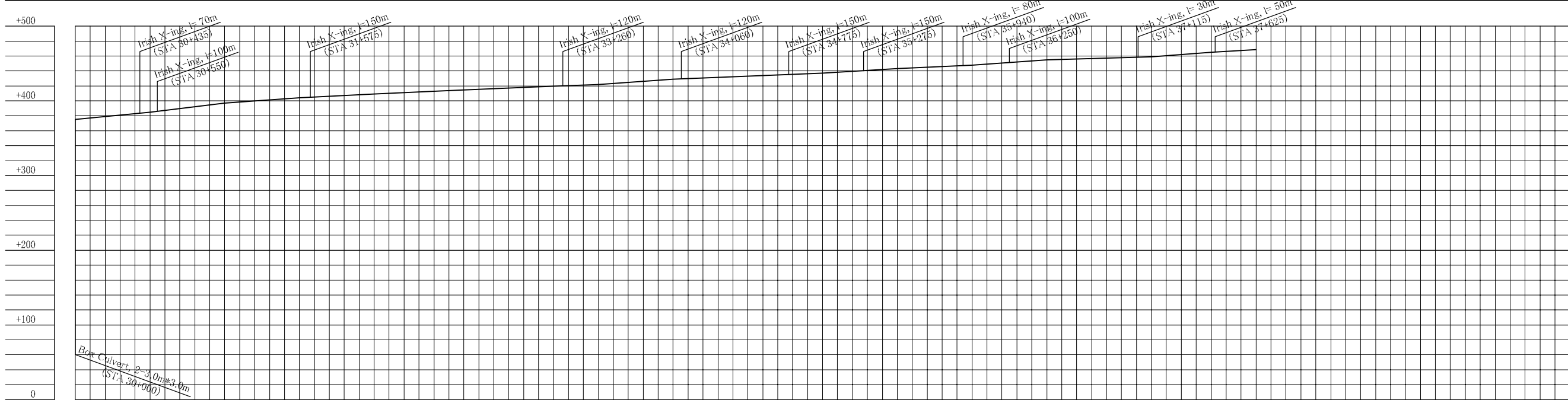
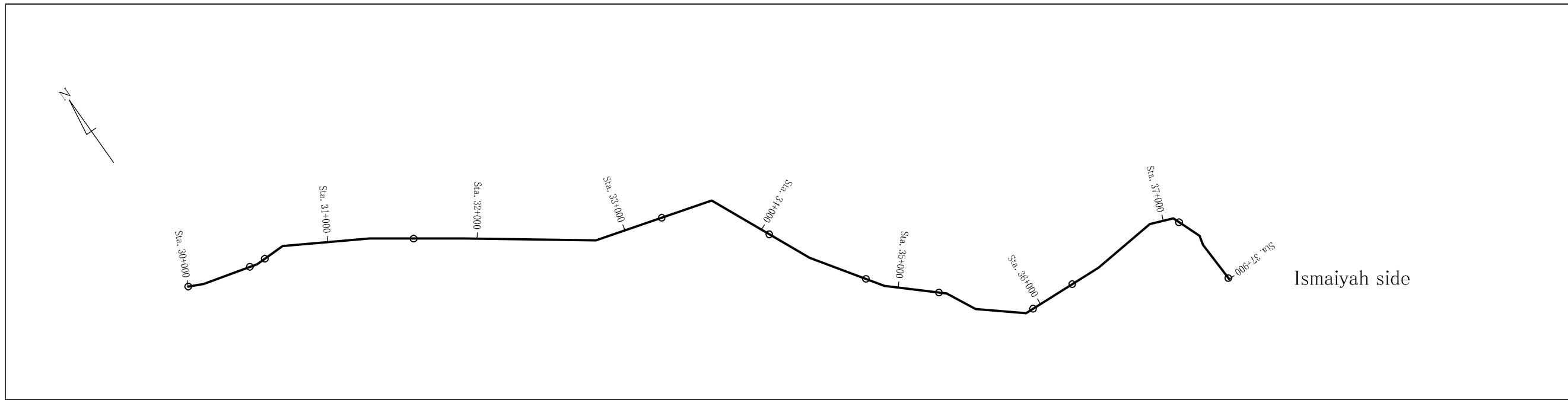

STATION	30+000	31+000	32+000	33+000	34+000	35+000	36+000	37+000	37+900
---------	--------	--------	--------	--------	--------	--------	--------	--------	--------

VERTICAL ALIGNMENT	Flat				$i = 0.98\%$ $L = 16100$				
--------------------	------	--	--	--	-----------------------------	--	--	--	--

CROSS SECTION TYPE									
--------------------	--	--	--	--	--	--	--	--	--

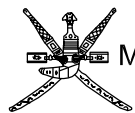

SULTANATE OF OMAN
 MINISTRY OF TRANSPORTATION AND COMMUNICATIONS
 DIRECTORATE GENERAL OF ROADS

JAPAN INTERNATIONAL COOPERATION AGENCY
 KATAHIRA & ENGINEERS INTERNATIONAL

THE STUDY ON
 THE ROAD NETWORK DEVELOPMENT
 IN THE SULTANATE OF OMAN

N36 Mahlah - Ismaiya
 PLAN AND PROFILE
 STA. 30km+000 - 37km+900

Dwg No.	N36-5
Scale	H = 1 : 30000 V = 1 : 6000
Date	Nov. 2004

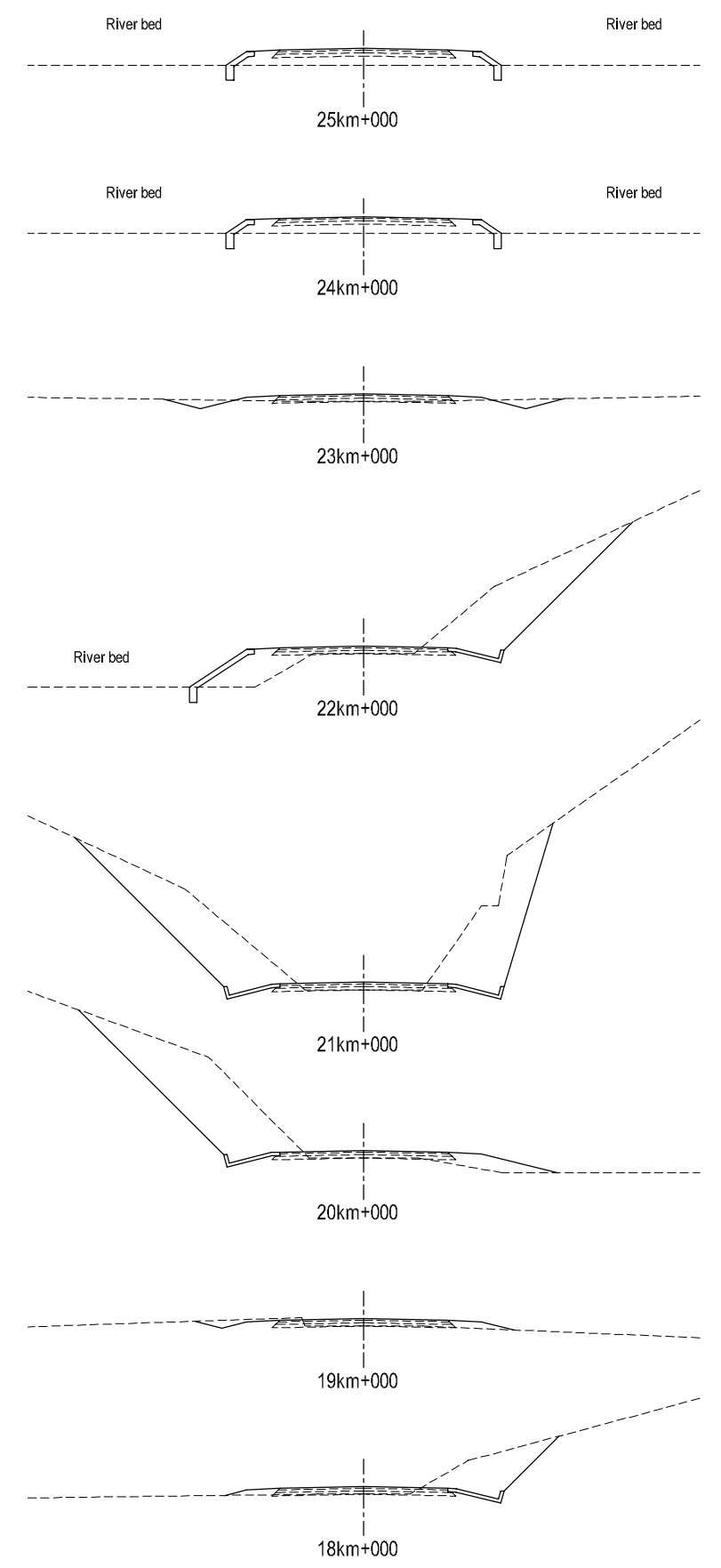
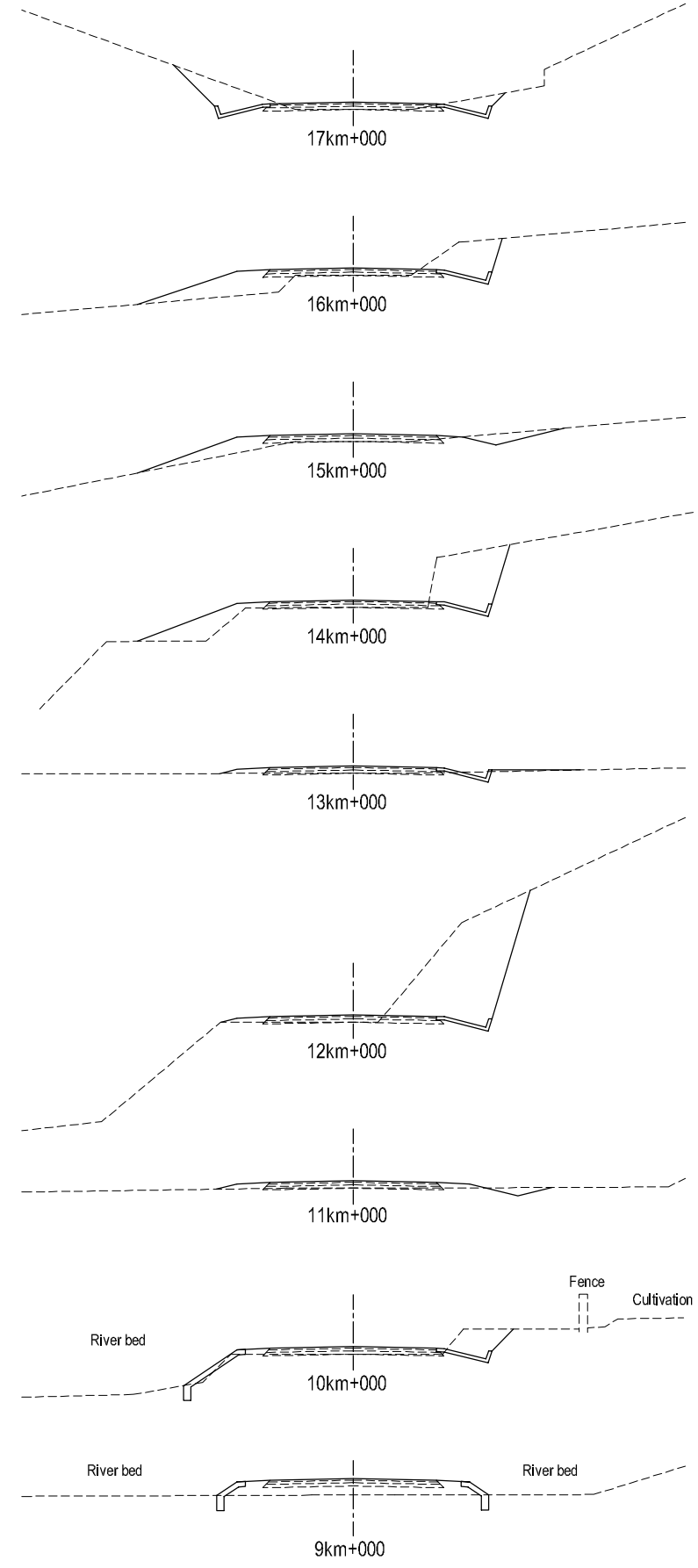
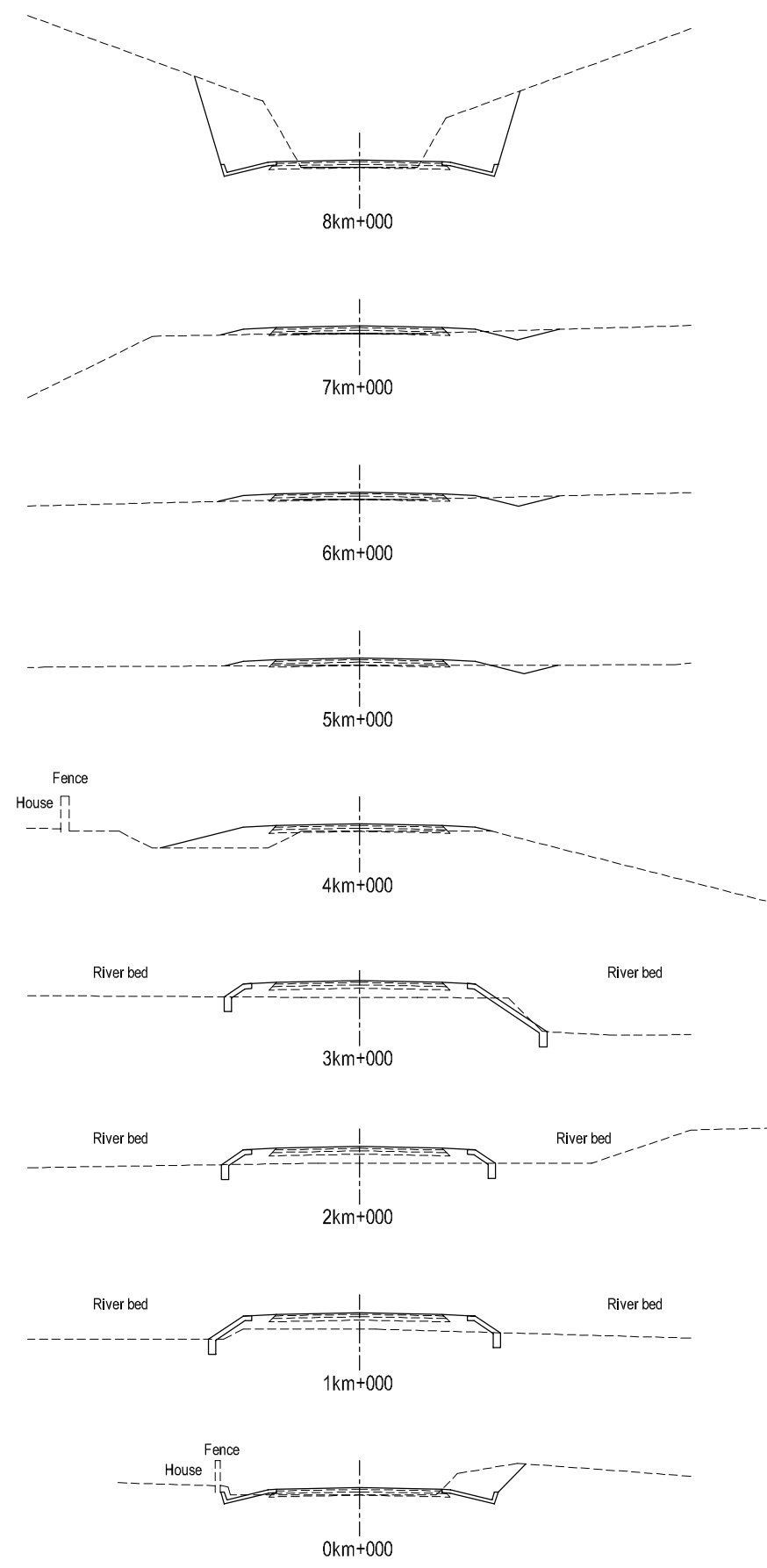

SULTANATE OF OMAN
 MINISTRY OF TRANSPORTATION AND COMMUNICATIONS
 DIRECTORATE GENERAL OF ROADS

JAPAN INTERNATIONAL COOPERATION AGENCY
 KATAHIRA & ENGINEERS INTERNATIONAL

THE STUDY ON
 THE ROAD NETWORK DEVELOPMENT
 IN THE SULTANATE OF OMAN

N36 Mahlah - Ismayiah
 Cross Section
 0km+000 - 25km+000

Dwg No.	N36-6
Scale	1:400
Date	Nov. 2004

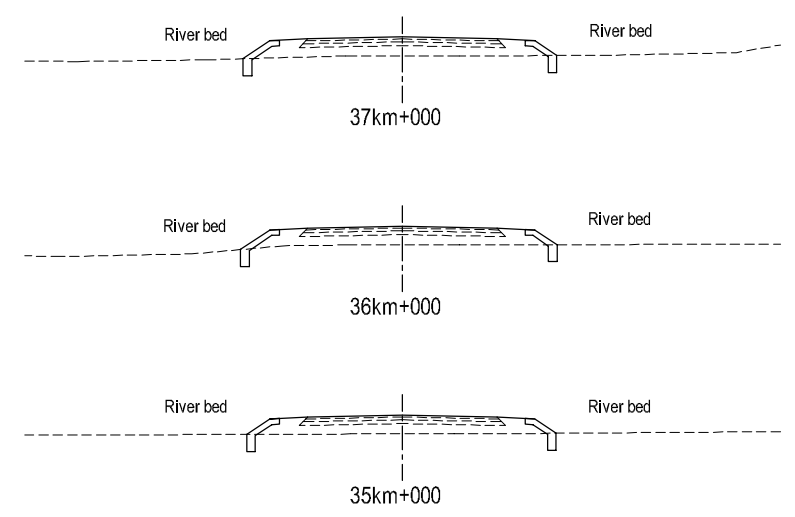
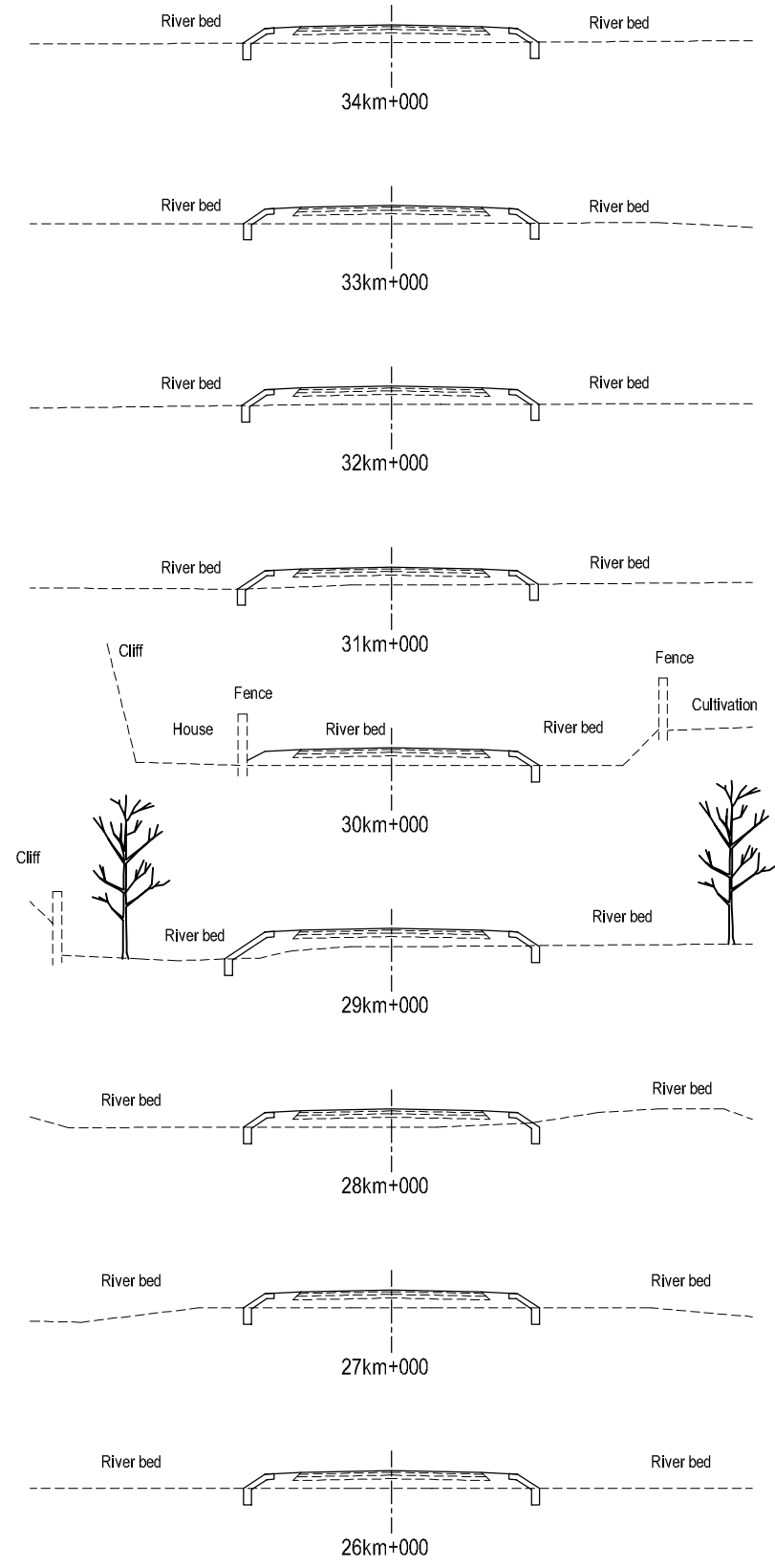

SULTANATE OF OMAN
 MINISTRY OF TRANSPORTATION AND COMMUNICATIONS
 DIRECTORATE GENERAL OF ROADS

JAPAN INTERNATIONAL COOPERATION AGENCY
 KATAHIRA & ENGINEERS INTERNATIONAL

THE STUDY ON
 THE ROAD NETWORK DEVELOPMENT
 IN THE SULTANATE OF OMAN

N36 Mahlah - Ismaiyah
 Cross Section
 26km+000 - 37km+000

Dwg No.	N36-7
Scale	1:400
Date	Nov. 2004

VI. HASIK - SHUWAYMIYAH ROAD

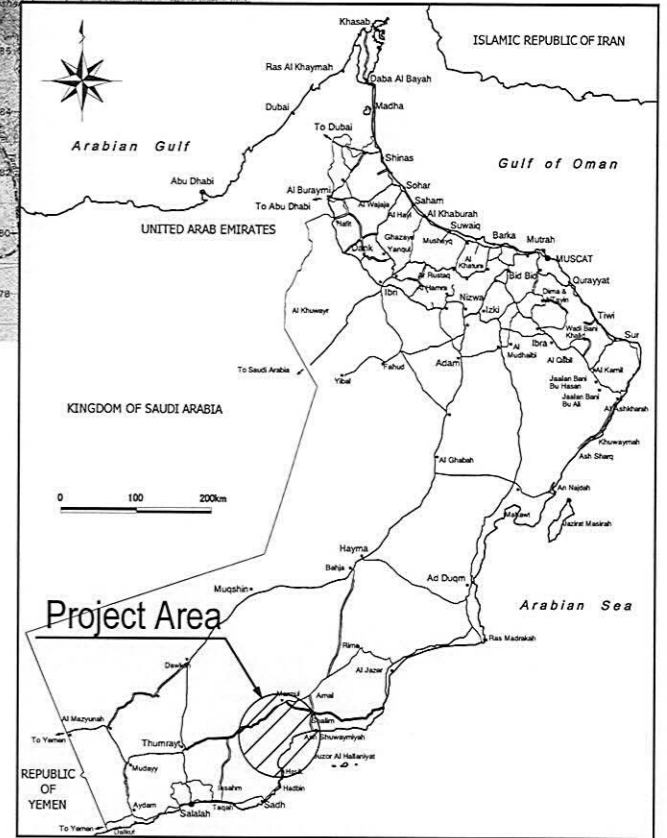
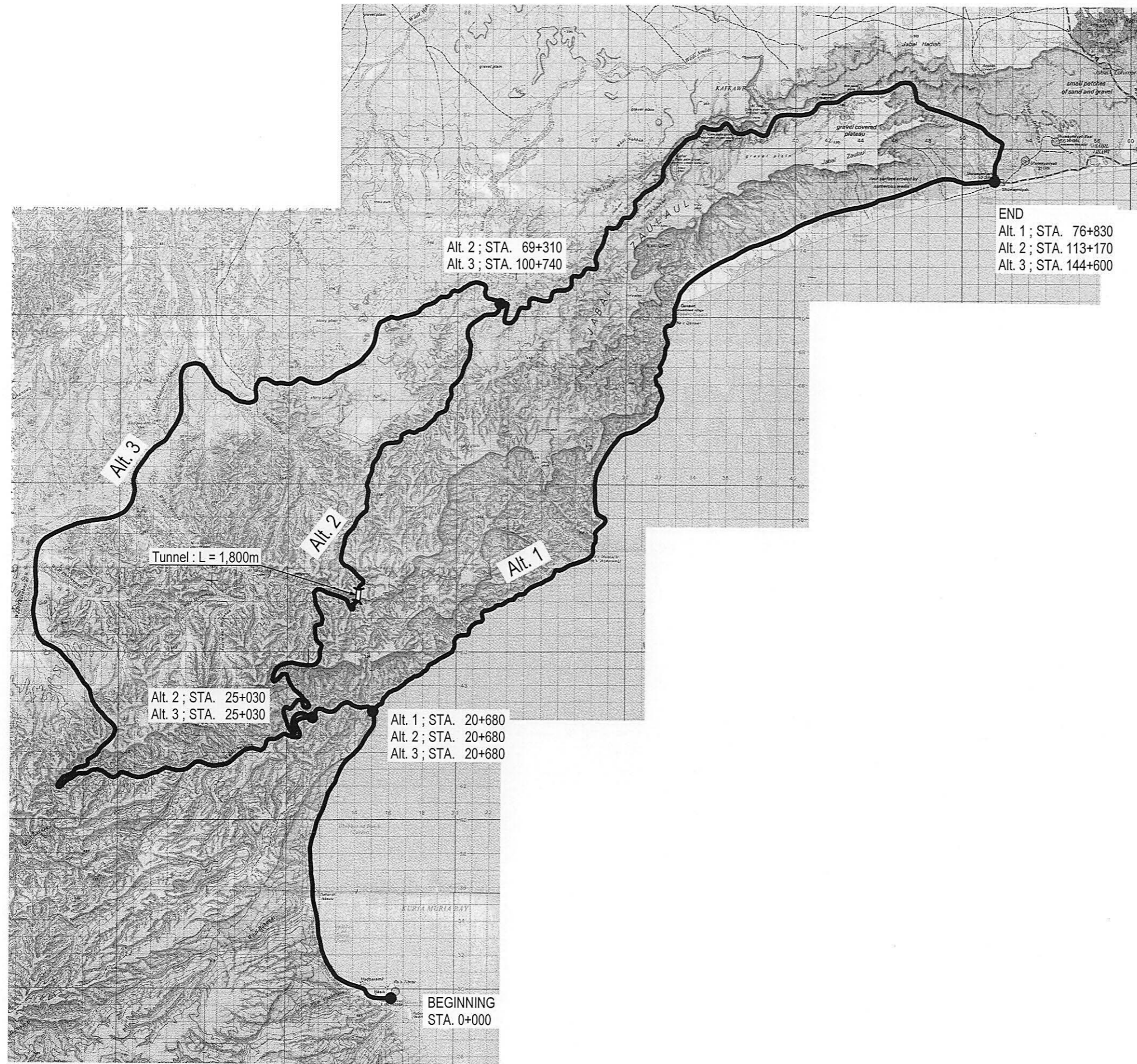

SULTANATE OF OMAN
MINISTRY OF TRANSPORTATION AND COMMUNICATIONS
DIRECTORATE GENERAL OF ROADS

JAPAN INTERNATIONAL COOPERATION AGENCY
KATAHIRA & ENGINEERS INTERNATIONAL

THE STUDY ON
THE ROAD NETWORK DEVELOPMENT
IN THE SULTANATE OF OMAN

N7 Hasik - Shuwaimiyah
LOCATION MAP

Dwg No.	N7-1
Scale	1 : 250000
Date	Nov. 2004

VII. BATINAH HIGHWAY

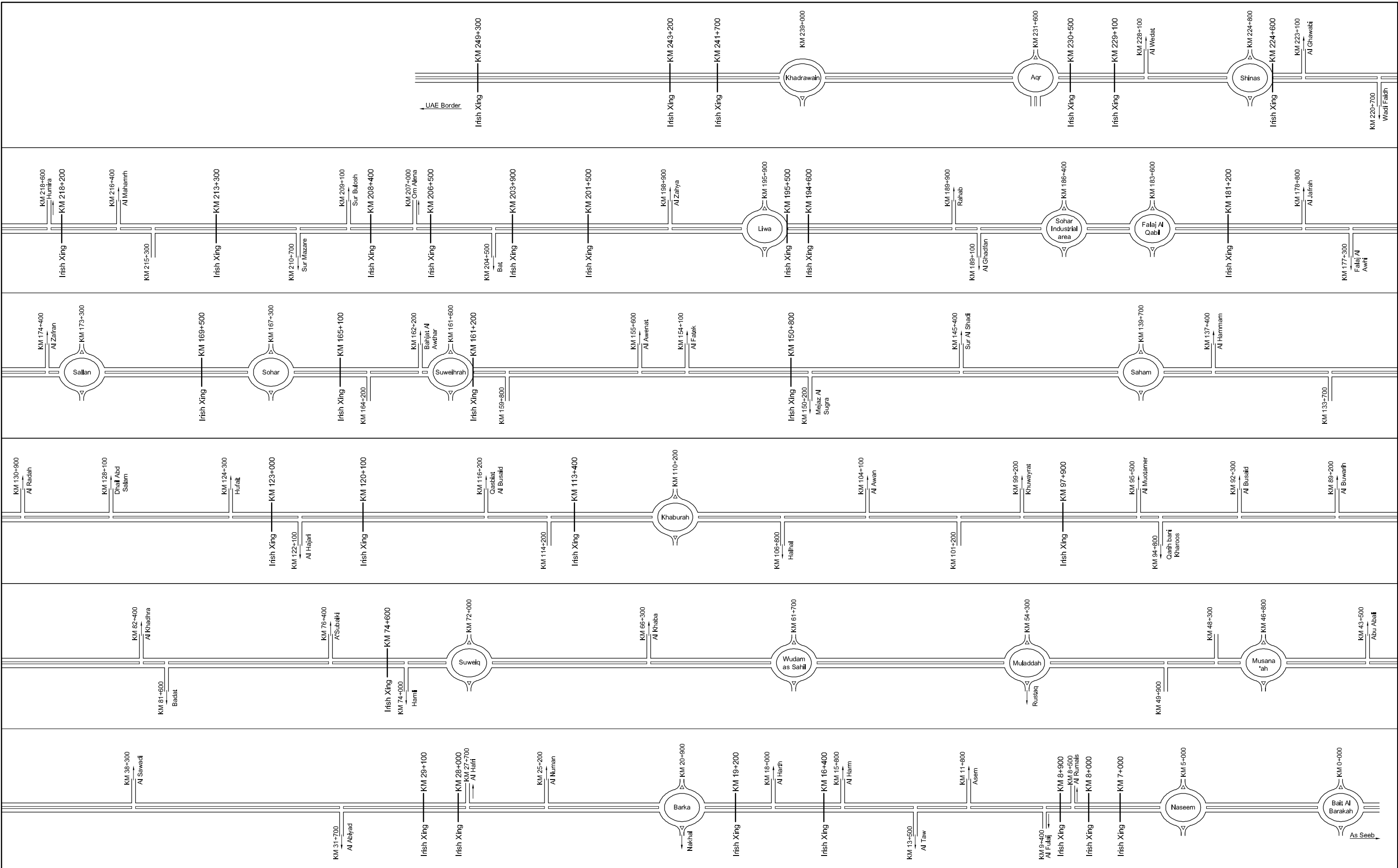

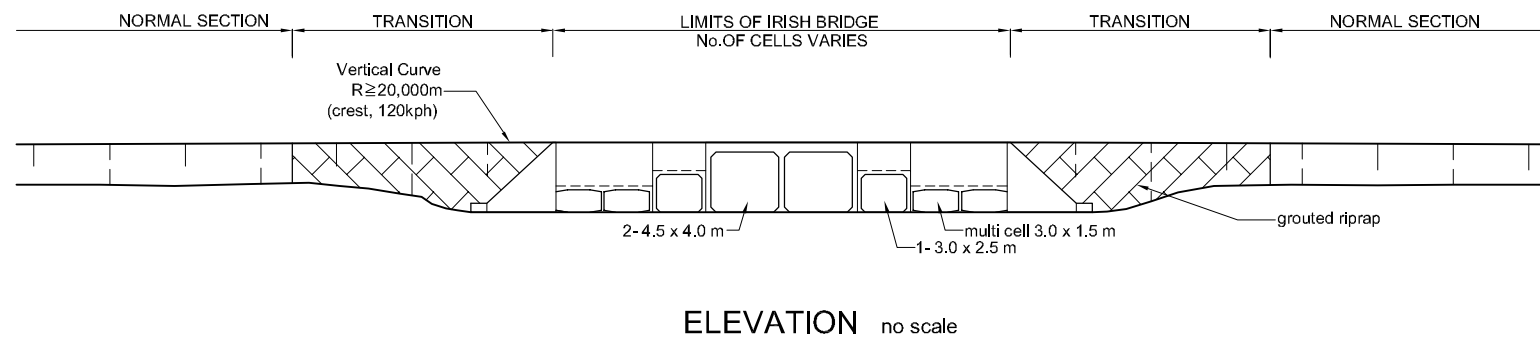
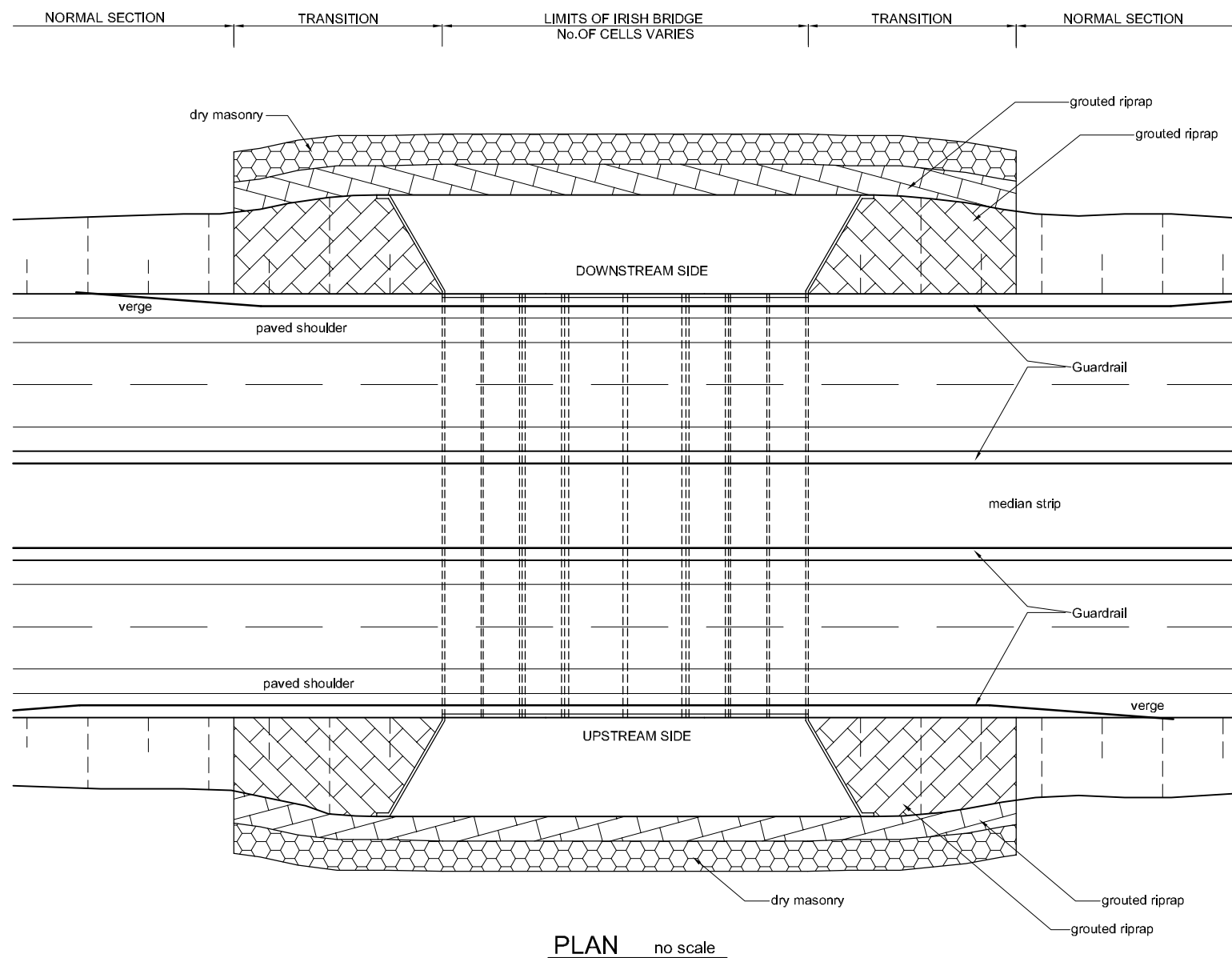

NOTE :

1. FOR THE DETAILS OF MULTI CELL BOX CULVERT REFER TO STANDARD DRAWINGS S-5 STANDARD BOX CULVERTS HEREIN ATTACHED.
2. FOR RIPRAP PROTECTION AT INLET & OUTLET REFER TO STANDARD DRAWINGS S-3 STANDARD IRISH BRIDGE HEREIN ATTACHED.
3. PROPER SIZE OF VERTICAL CURVE SHALL BE PROVIDED BEYOND TRANSITION IN ACCORDANCE WITH DESIGN SPEED AT THE LOCATION.
4. HEIGHT OF HEADWALL & WING WALL SHALL BE ADJUSTED WITH EMBANKMENT HEIGHT.



SULTANATE OF OMAN
 MINISTRY OF TRANSPORTATION AND COMMUNICATIONS
 DIRECTORATE GENERAL OF ROADS

JAPAN INTERNATIONAL COOPERATION AGENCY
 KATAHIRA & ENGINEERS INTERNATIONAL

THE STUDY ON
 THE ROAD NETWORK DEVELOPMENT
 IN THE SULTANATE OF OMAN

U1 Batinah Highway
 Multi - Function Culvert

Dwg No.	U1-2
Scale	no scale
Date	Nov. 2004

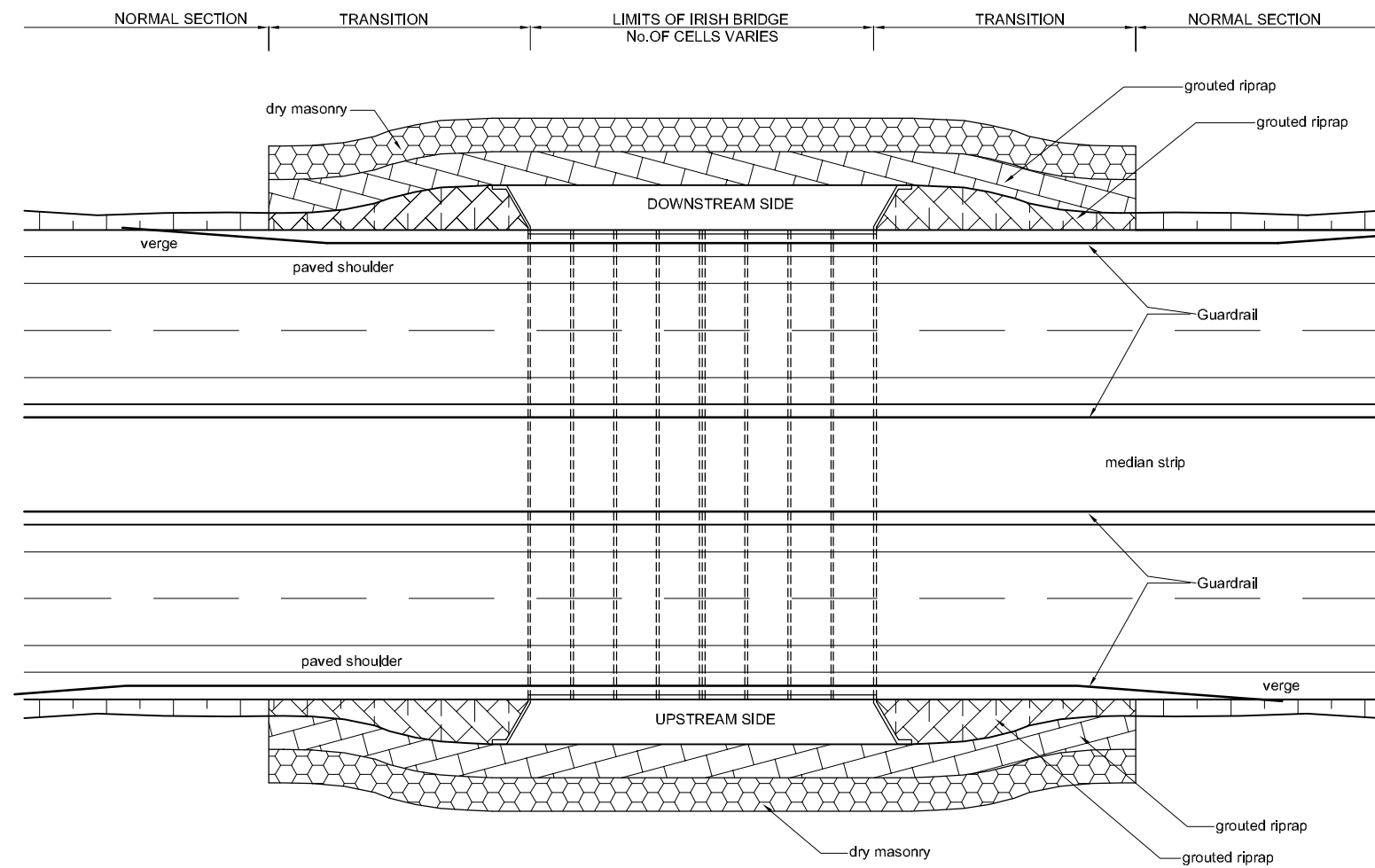

PLAN no scale

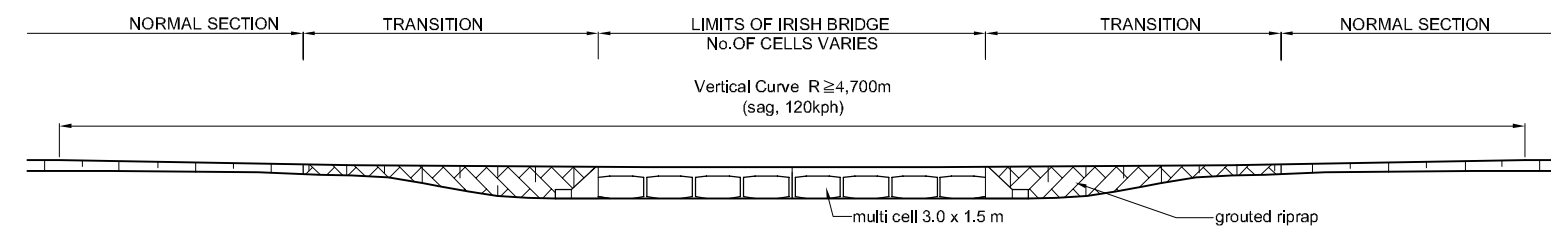

ELEVATION no scale

NOTE :

1. FOR THE DETAILS OF MULTI CELL BOX CULVERT REFER TO STANDARD DRAWINGS S-5 STANDARD BOX CULVERTS HEREIN ATTACHED.
2. FOR RIPRAP PROTECTION AT INLET & OUTLET REFER TO STANDARD DRAWINGS S-3 STANDARD IRISH BRIDGE HEREIN ATTACHED.
3. PROPER SIZE OF VERTICAL CURVE SHALL BE PROVIDED BEYOND TRANSITION IN ACCORDANCE WITH DESIGN SPEED AT THE LOCATION.
4. HEIGHT OF HEADWALL & WING WALL SHALL BE ADJUSTED WITH EMBANKMENT HEIGHT.

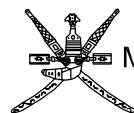

SULTANATE OF OMAN
MINISTRY OF TRANSPORTATION AND COMMUNICATIONS
DIRECTORATE GENERAL OF ROADS

JAPAN INTERNATIONAL COOPERATION AGENCY
KATAHIRA & ENGINEERS INTERNATIONAL

THE STUDY ON
THE ROAD NETWORK DEVELOPMENT
IN THE SULTANATE OF OMAN

U1 Batinah Highway
Irish Bridge

Dwg No.	U1-3
Scale	no scale
Date	Nov. 2004

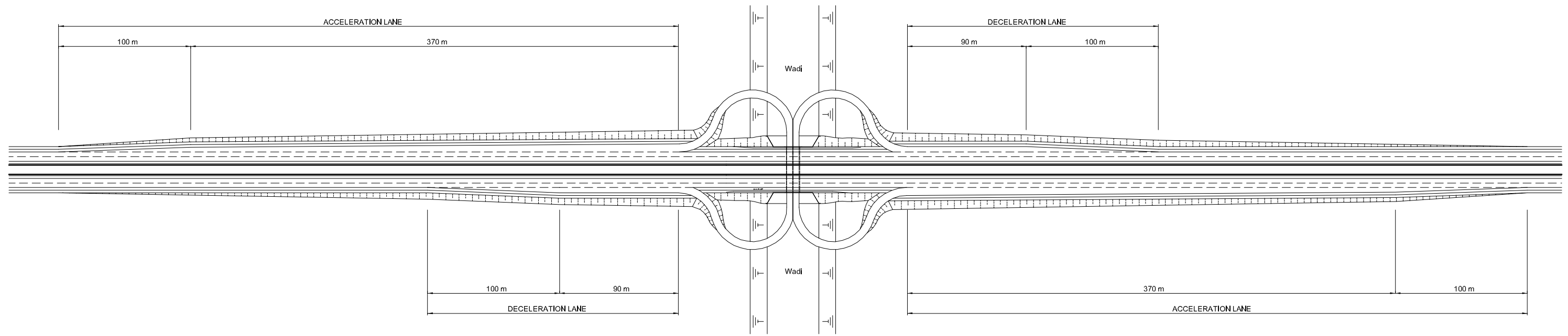

SULTANATE OF OMAN
 MINISTRY OF TRANSPORTATION AND COMMUNICATIONS
 DIRECTORATE GENERAL OF ROADS

JAPAN INTERNATIONAL COOPERATION AGENCY
 KATAHIRA & ENGINEERS INTERNATIONAL

THE STUDY ON
 THE ROAD NETWORK DEVELOPMENT
 IN THE SULTANATE OF OMAN

U1 Batinah Highway
 Irish Bridge
 Plan for Approach road (1)

Dwg No.	U1-4
Scale	1 : 3000
Date	Nov. 2004

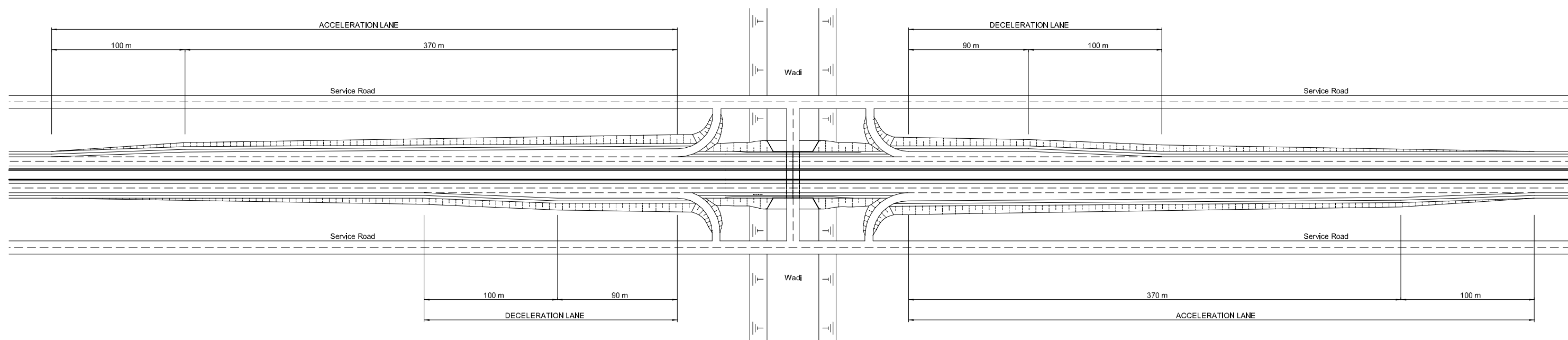

SULTANATE OF OMAN
 MINISTRY OF TRANSPORTATION AND COMMUNICATIONS
 DIRECTORATE GENERAL OF ROADS

JAPAN INTERNATIONAL COOPERATION AGENCY
 KATAHIRA & ENGINEERS INTERNATIONAL

THE STUDY ON
 THE ROAD NETWORK DEVELOPMENT
 IN THE SULTANATE OF OMAN

U1 Batinah Highway
 Irish Bridge
 Plan for Approach road (2)

Dwg No.	U1-5
Scale	1 : 3000
Date	Nov. 2004

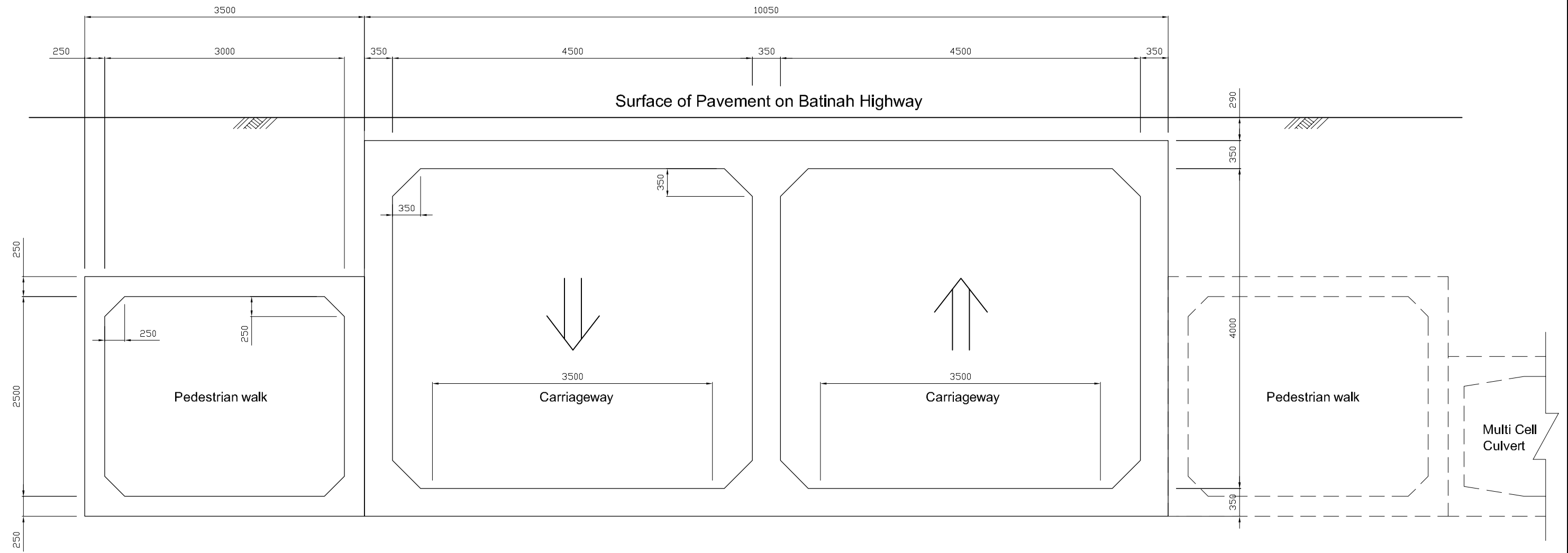

DIMENSIONS OF 1 CELL CULVERT

DIMENSIONS OF 2 CELL CULVERT

NOTES :

1. FOR MULTI CELL CULVERT ON THE SIDE SECTION REFER TO STANDARD DRAWINGS S-5 STANDARD BOX CULVERTS HEREIN ATTACHED.
2. FOR ARRANGEMENT OF REINFORCEMENT REFER TO STANDARD DRAWINGS OF HDM SHEET DS2-20 & DS2-21.
3. FOR BAR SIZE SPACING AND BENDING DIMENSIONS REFER TO STANDARD DRAWINGS OF HDM SHEET DS2-40 TO DS2-83.
4. COVER REINFORCEMENT TO BE 40MM.

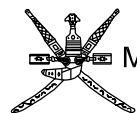

SULTANATE OF OMAN
MINISTRY OF TRANSPORTATION AND COMMUNICATIONS
DIRECTORATE GENERAL OF ROADS

JAPAN INTERNATIONAL COOPERATION AGENCY
KATAHIRA & ENGINEERS INTERNATIONAL

THE STUDY ON
THE ROAD NETWORK DEVELOPMENT
IN THE SULTANATE OF OMAN

U1 Batinah Highway
Details of Box Culvert
for Irish Bridge

Dwg No.	U1-6
Scale	1:50
Date	Nov. 2004