

資料－11 計画施設配置図

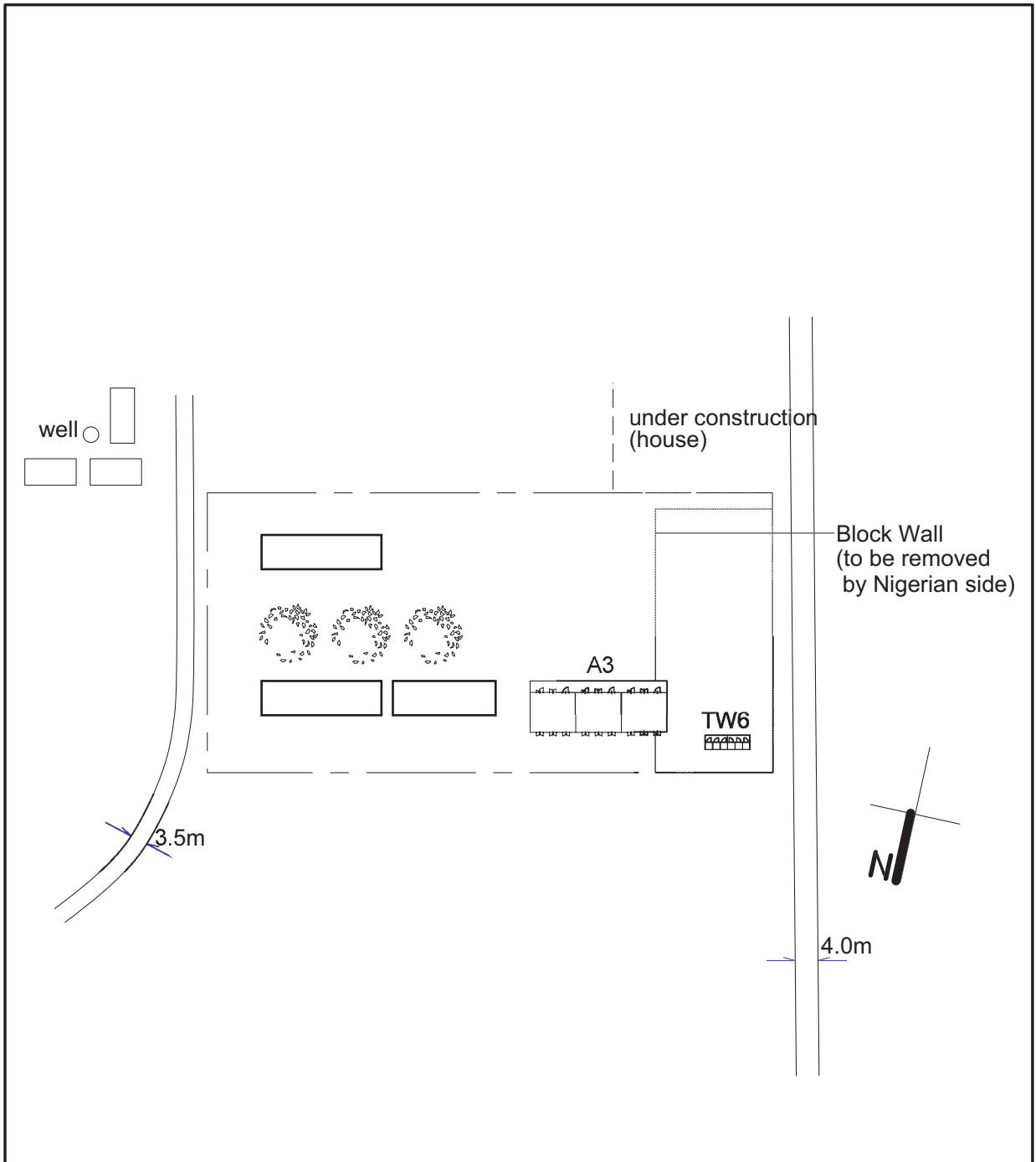

Construction Floor Area	
Classroom Building	216 m ²
Toilet	12 m ²
Total	228 m²

LGA Agai	Name Etsu Nuhu	Original No. N12	Site No. NG-1
--------------------	--------------------------	----------------------------	-------------------------

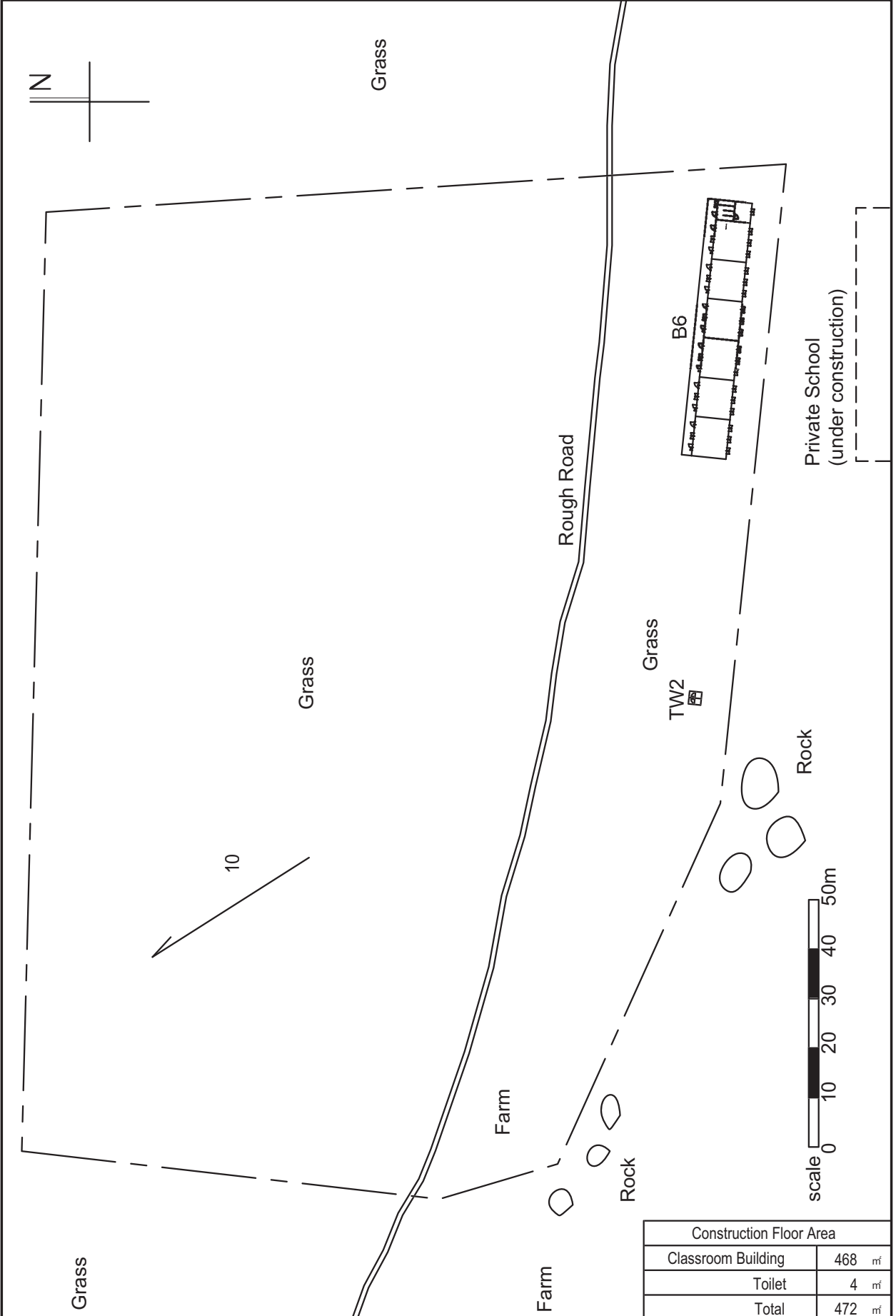

LGA	Name	Original No.	Site No.
Bosso	Tudunfulani Gabas	N15	NG-2

Construction Floor Area	
Classroom Building	468 m ²
Toilet	4 m ²
Total	472 m²

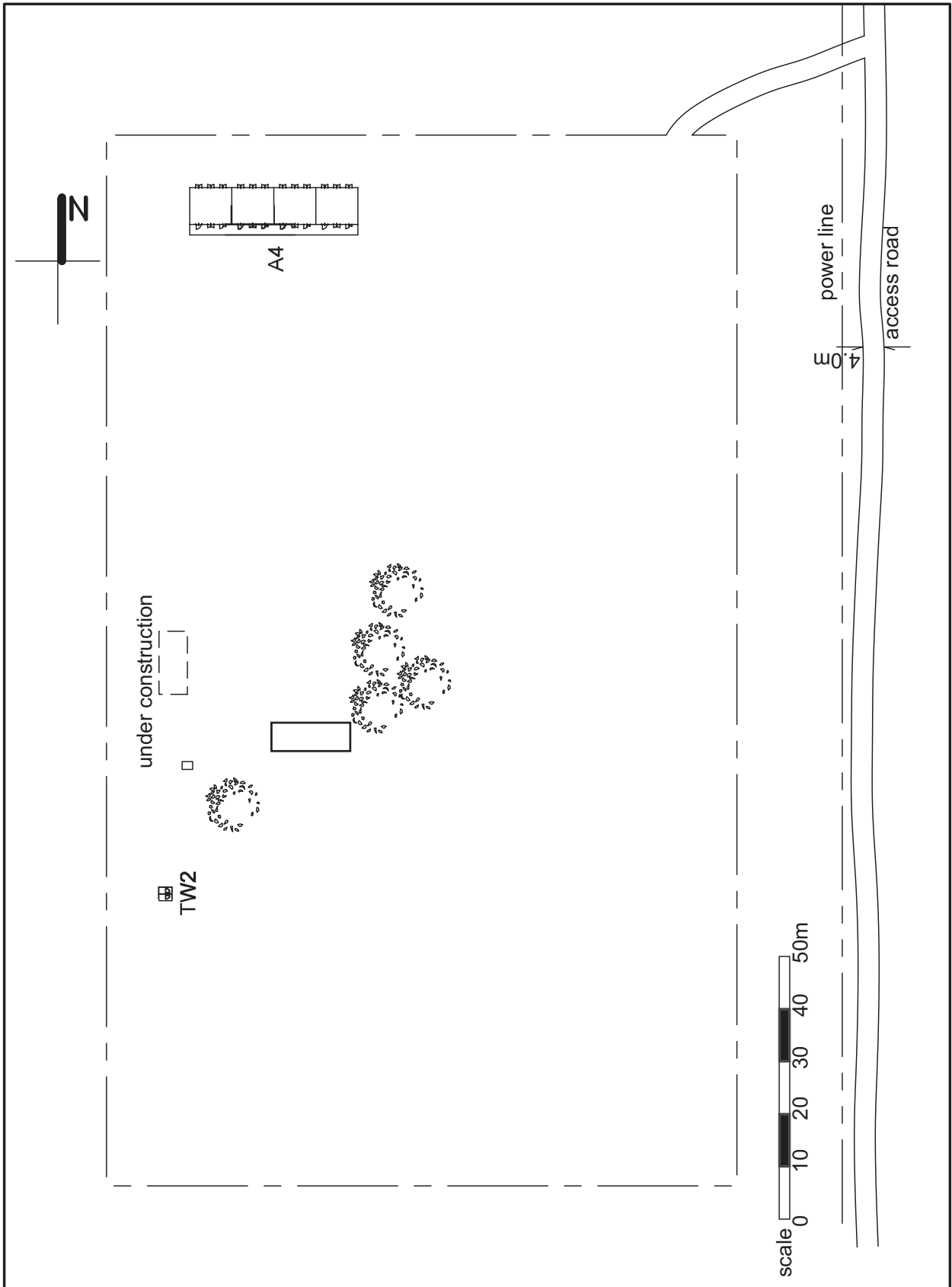

Construction Floor Area	
Classroom Building	288 m ²
Toilet	4 m ²
Total	292 m²

LGA Edati	Name Sangi	Original No. N14	Site No. NG-3
---------------------	----------------------	----------------------------	-------------------------

*Road extension will be easy.

1.0m

Access Road

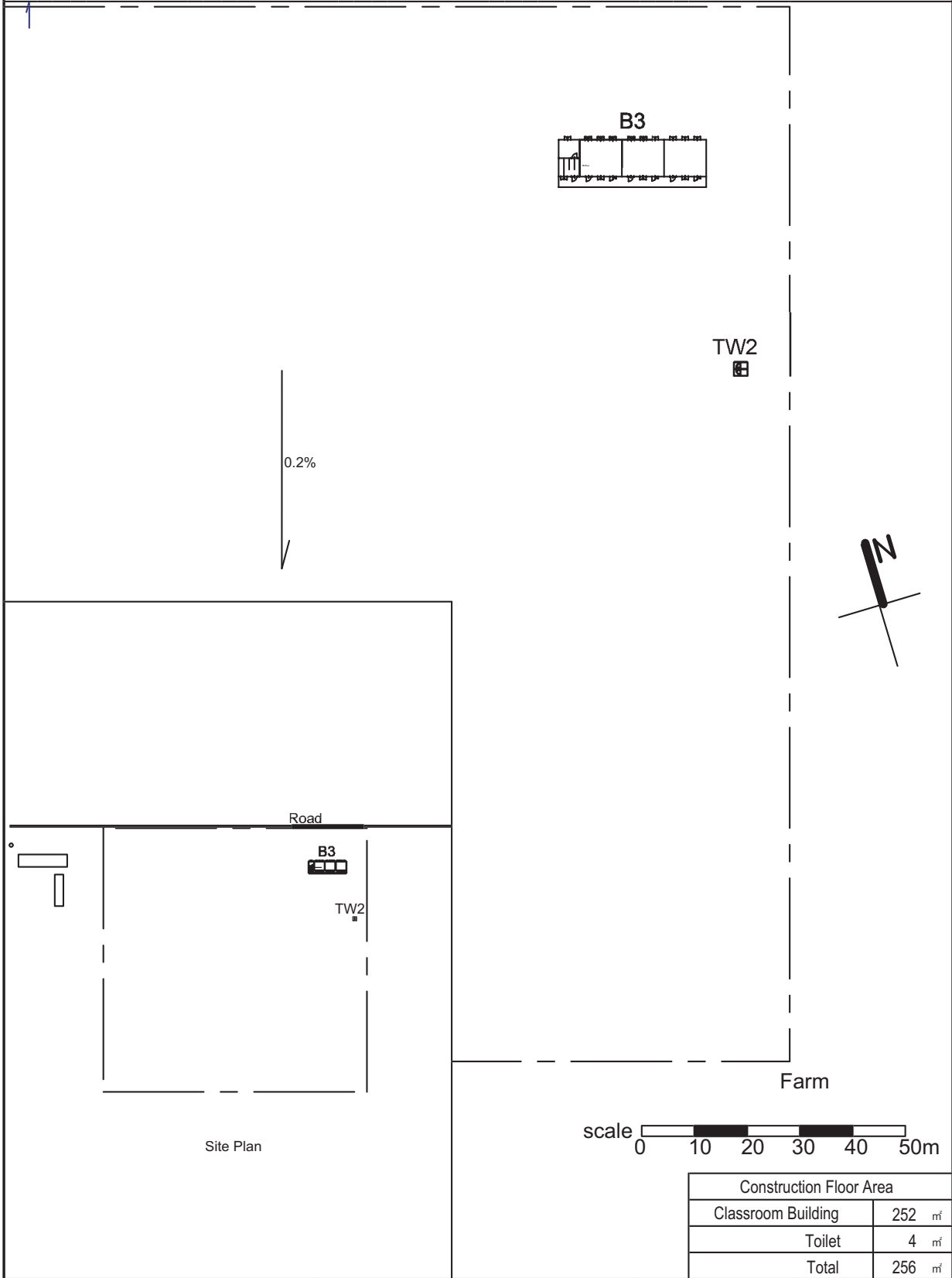

Site Plan



Construction Floor Area	
Classroom Building	252 m ²
Toilet	4 m ²
Total	256 m²

LGA Gbaco	Name Makafu UBE Rrim. Sch	Original No. N13	Site No. NG-4
---------------------	-------------------------------------	----------------------------	-------------------------

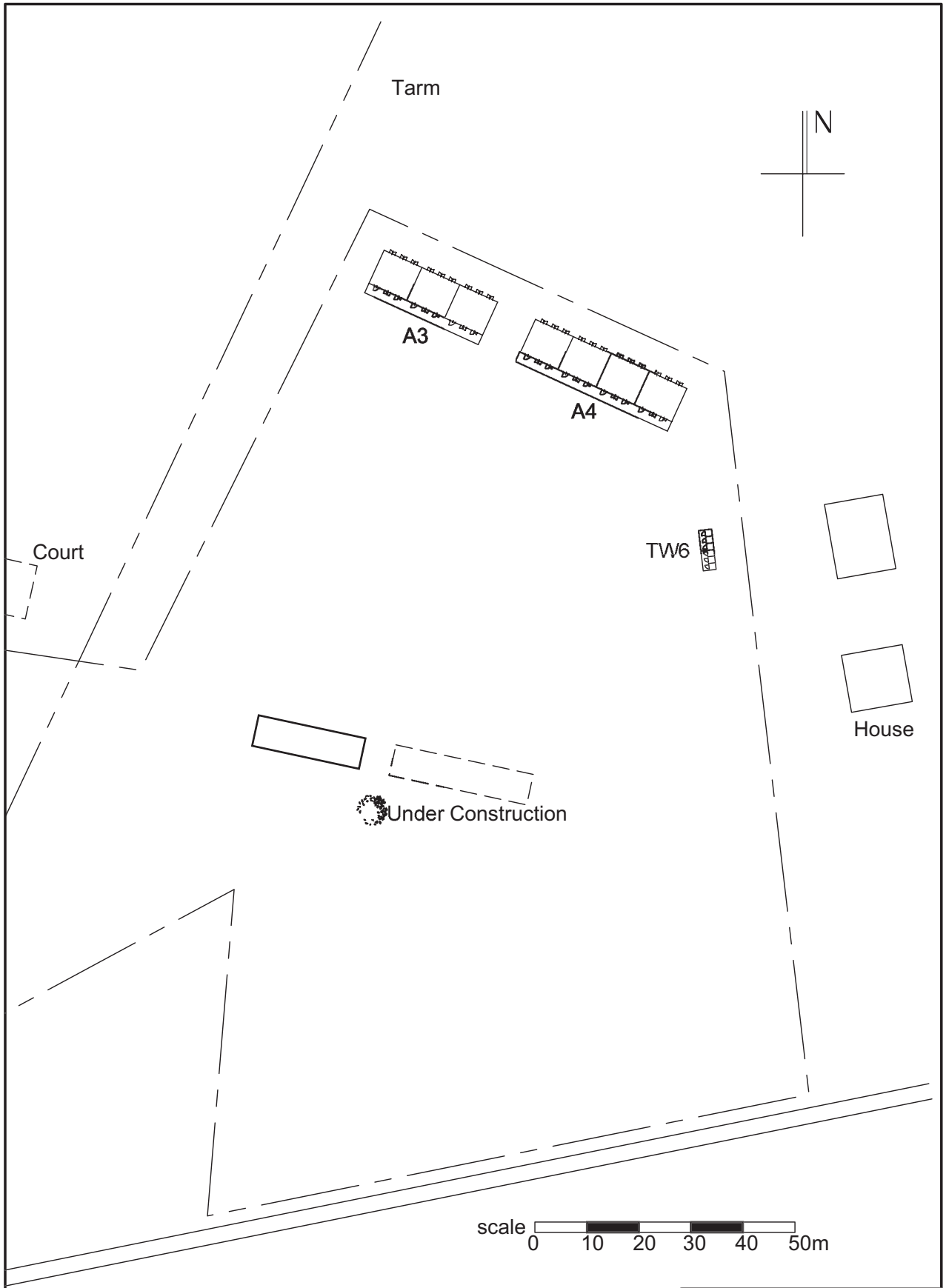

Construction Floor Area	
Classroom Building	504 m ²
Toilet	12 m ²
Total	516 m²

LGA Lavun	Name Bussu	Original No. N20	Site No. NG-5
---------------------	----------------------	----------------------------	-------------------------

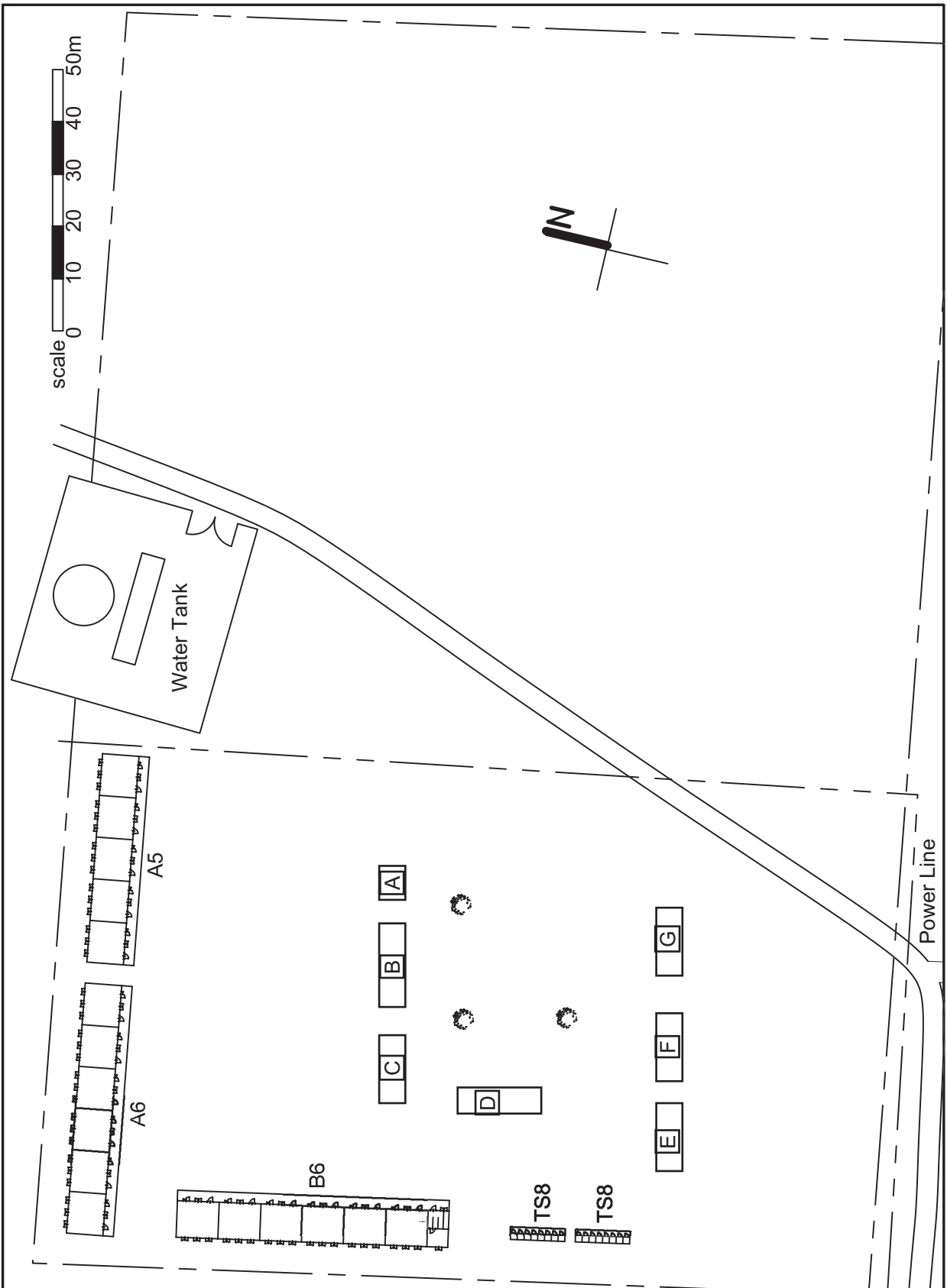

Construction Floor Area	
Classroom Building	1,260 m ²
Toilet	32 m ²
Total	1,292 m²

LGA Magama	Name Salka Cent.	Original No. N17	Site No. NG-6
----------------------	----------------------------	----------------------------	-------------------------

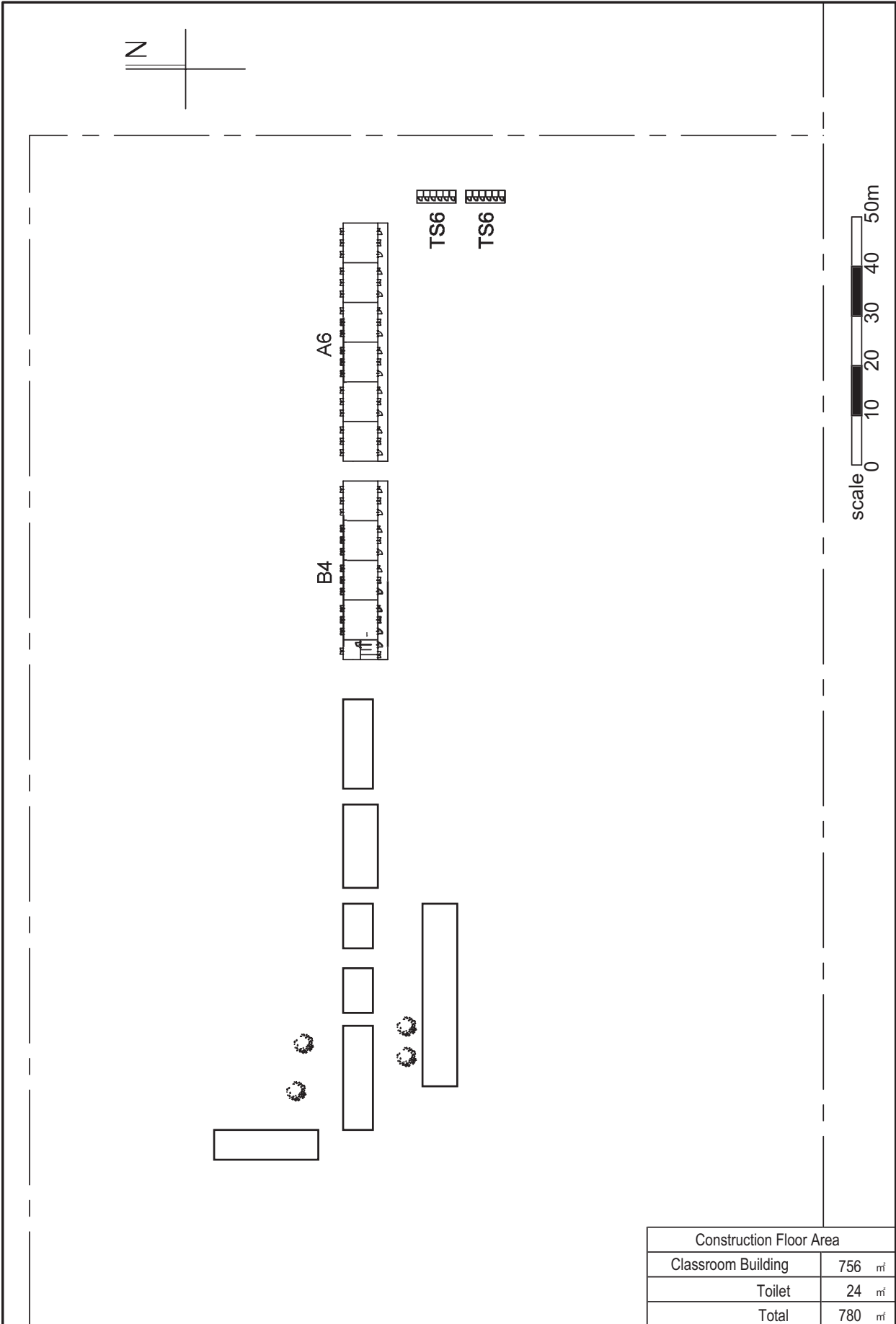
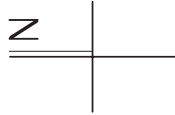

Construction Floor Area	
Classroom Building	756 m ²
Toilet	24 m ²
Total	780 m ²

LGA Mariga	Name Bangi Cent.	Original No. N19	Site No. NG-7
---------------	---------------------	---------------------	------------------

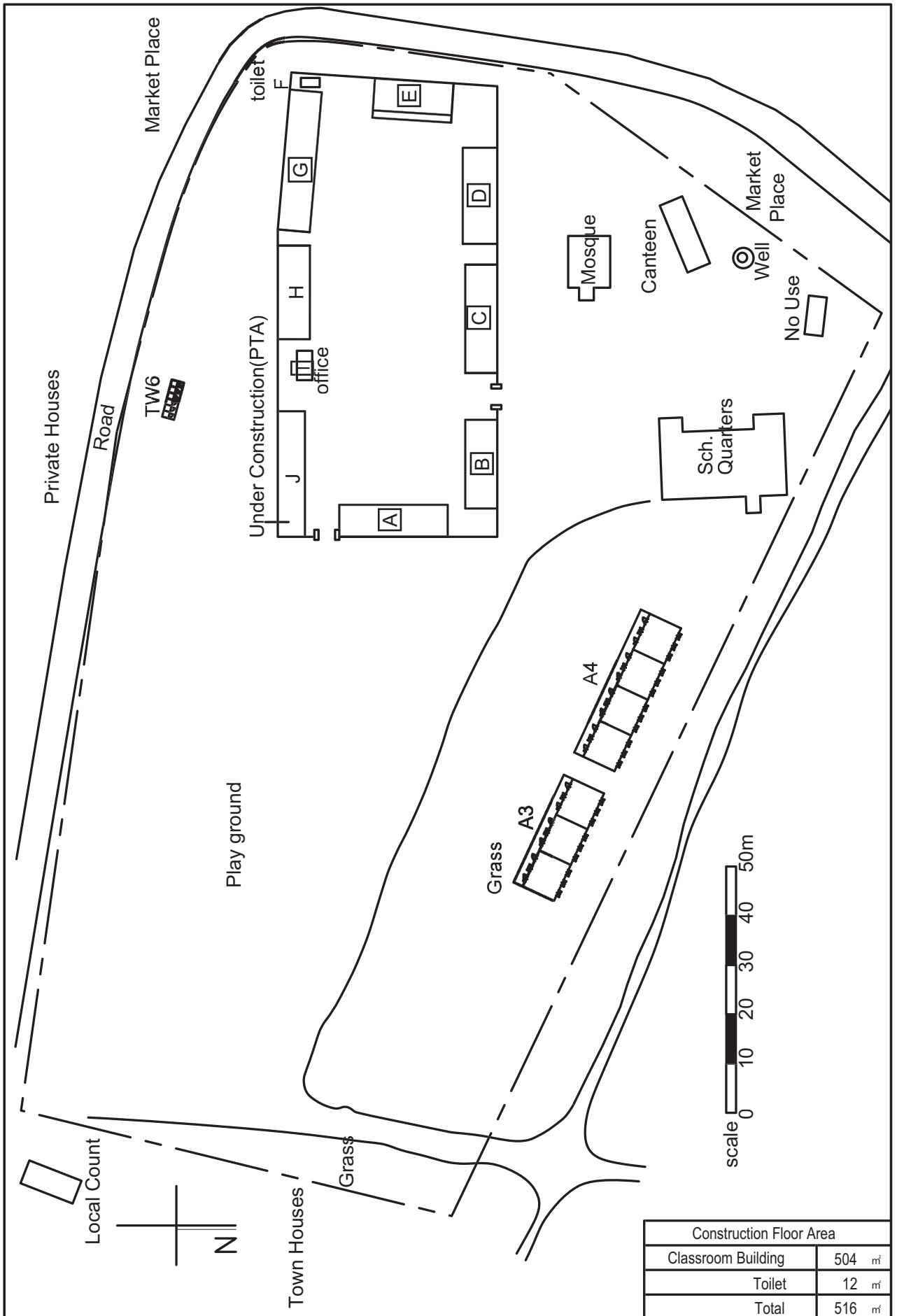

Construction Floor Area	
Classroom Building	504 m ²
Toilet	12 m ²
Total	516 m²

LGA	Name	Original No.	Site No.
Central Sarkipawa	Murya	N8	NG-8

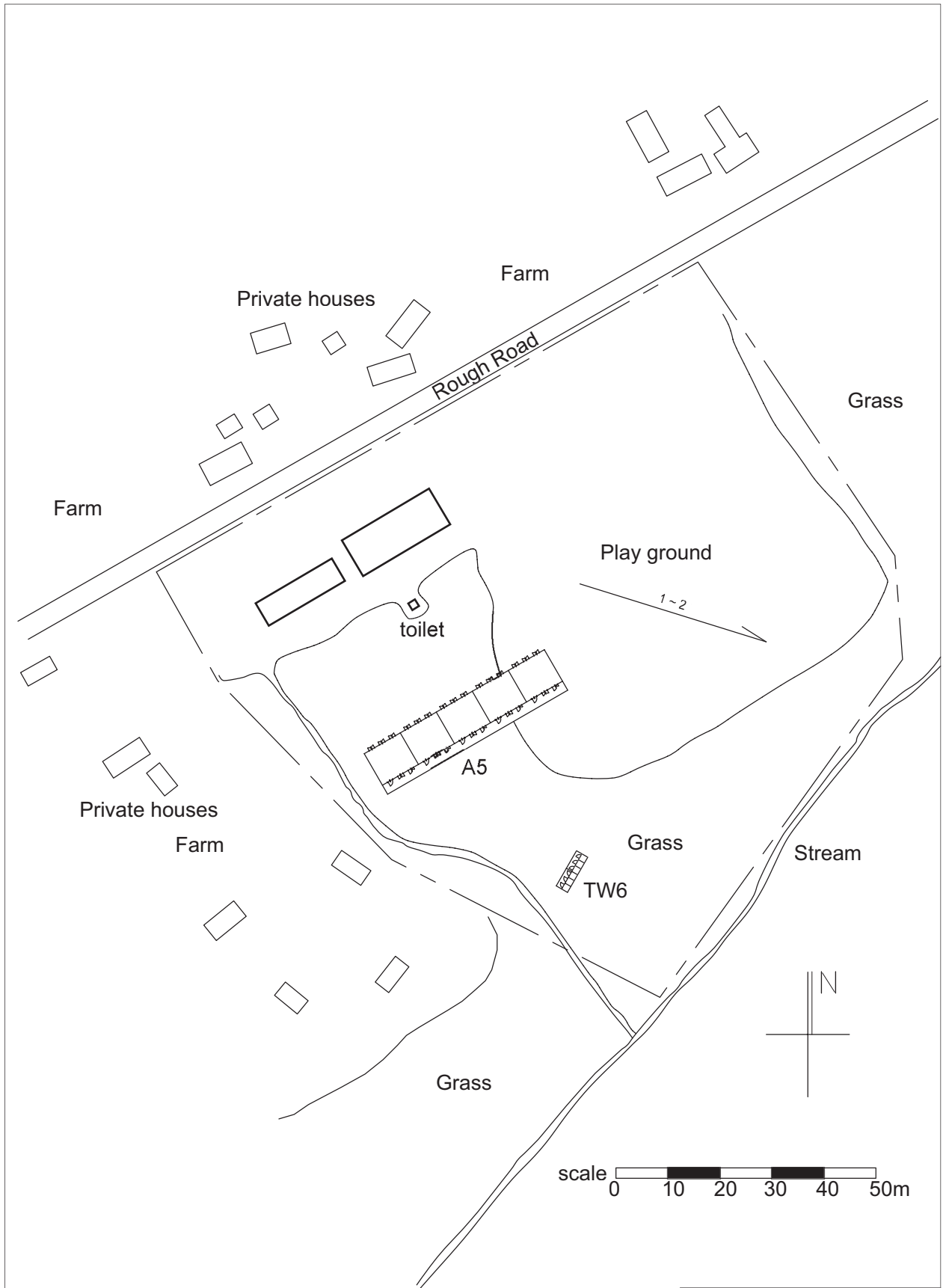

Construction Floor Area	
Classroom Building	360 m ²
Toilet	12 m ²
Total	372 m²

LGA	Paikolo	Name	Korokpa	Original No.	N2	Site No.	NG-9
-----	---------	------	---------	--------------	----	----------	------

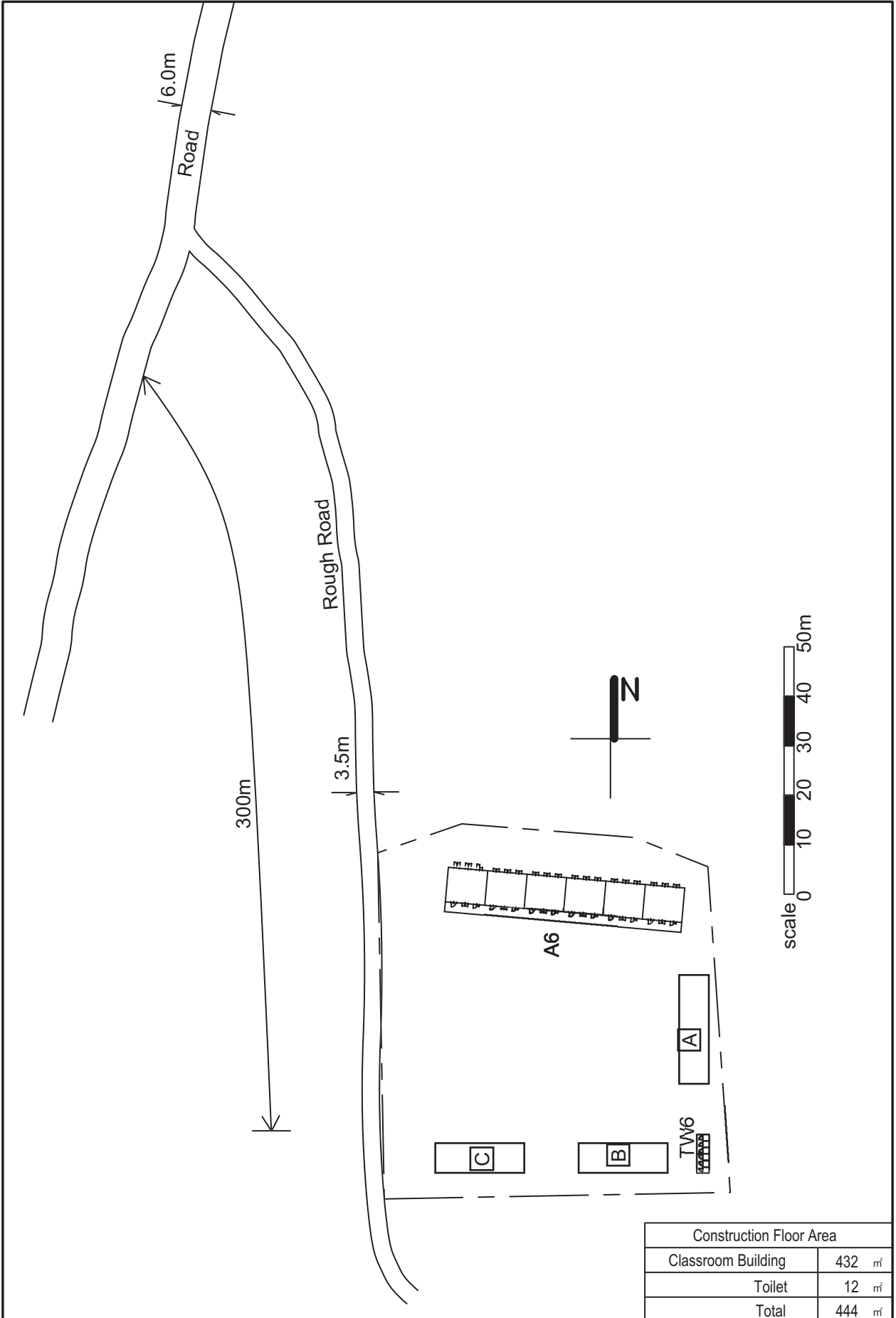

Construction Floor Area	
Classroom Building	432 m ²
Toilet	12 m ²
Total	444 m²

LGA Rijau	Name Rafin Mota	Original No. N11	Site No. NG-10
---------------------	---------------------------	----------------------------	--------------------------

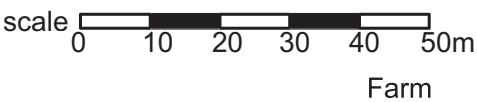
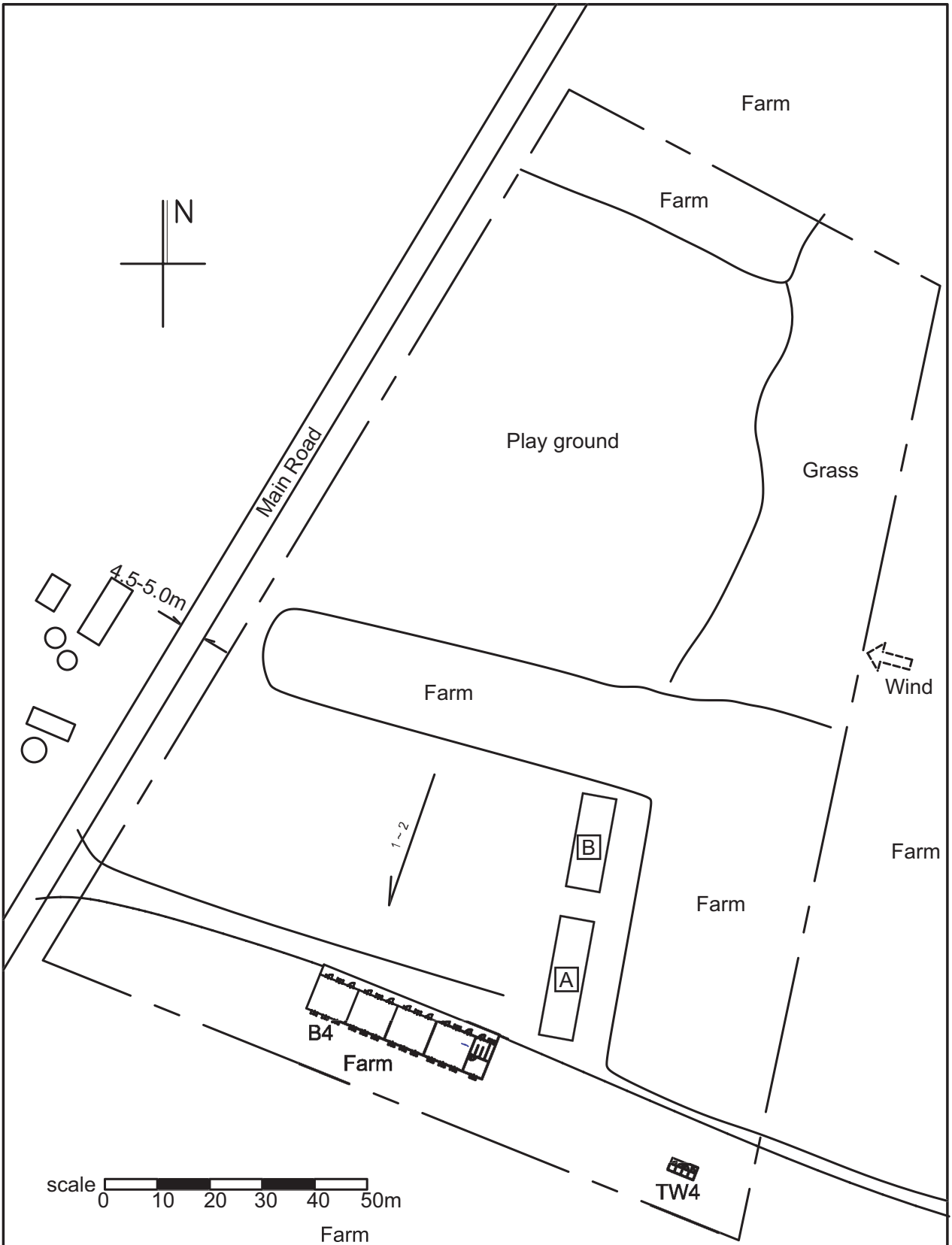

Construction Floor Area	
Classroom Building	324 m ²
Toilet	8 m ²
Total	332 m²

LGA Rafin Kuka	Name Shiroro	Original No. N3	Site No. NG-11
--------------------------	------------------------	---------------------------	--------------------------

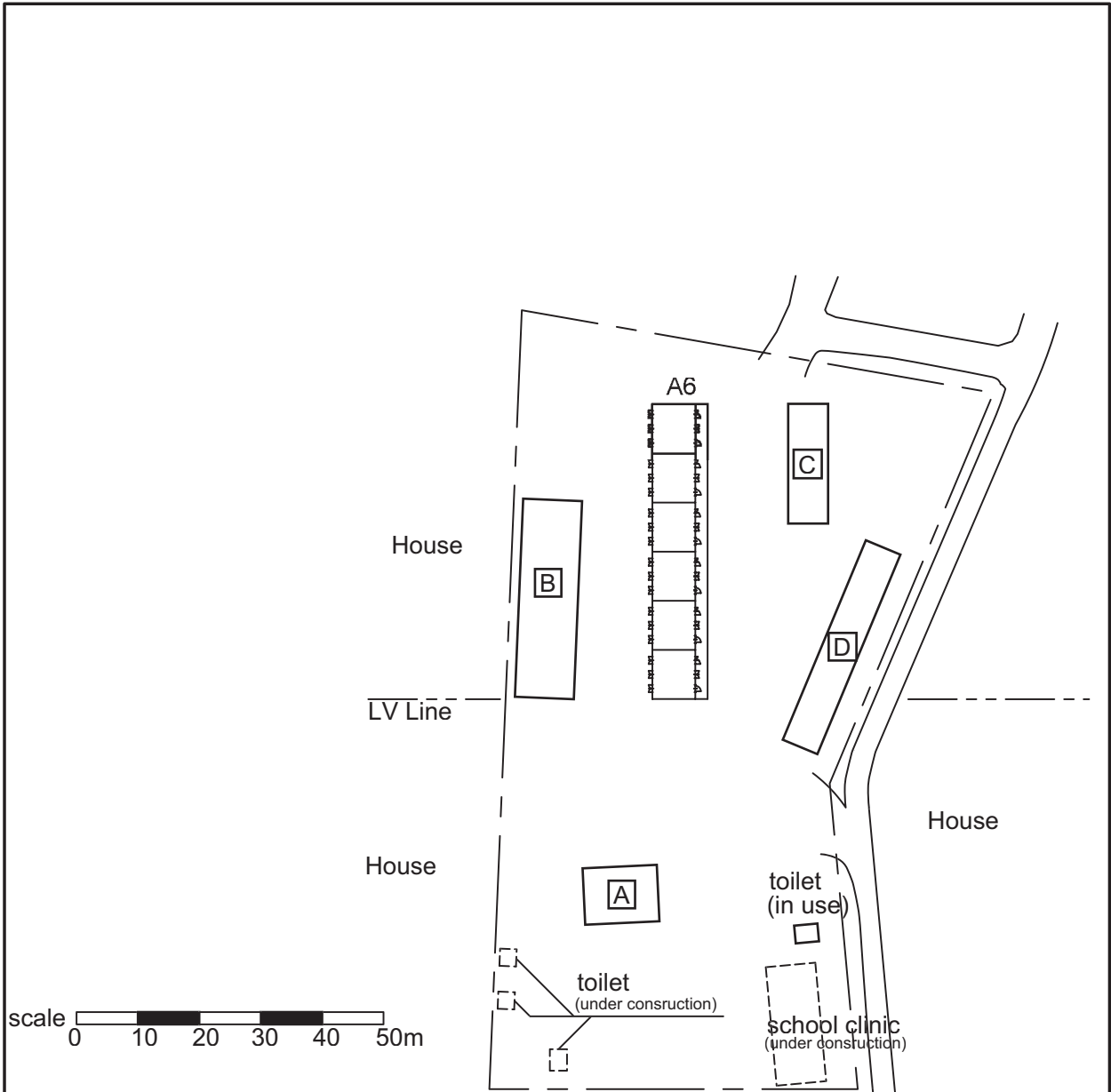

Construction Floor Area	
Classroom Building	432 m ²
Toilet	0 m ²
Total	432 m²

LGA Bakin Iku	Name Suleja	Original No. N5	Site No. NG-12
-------------------------	-----------------------	---------------------------	--------------------------

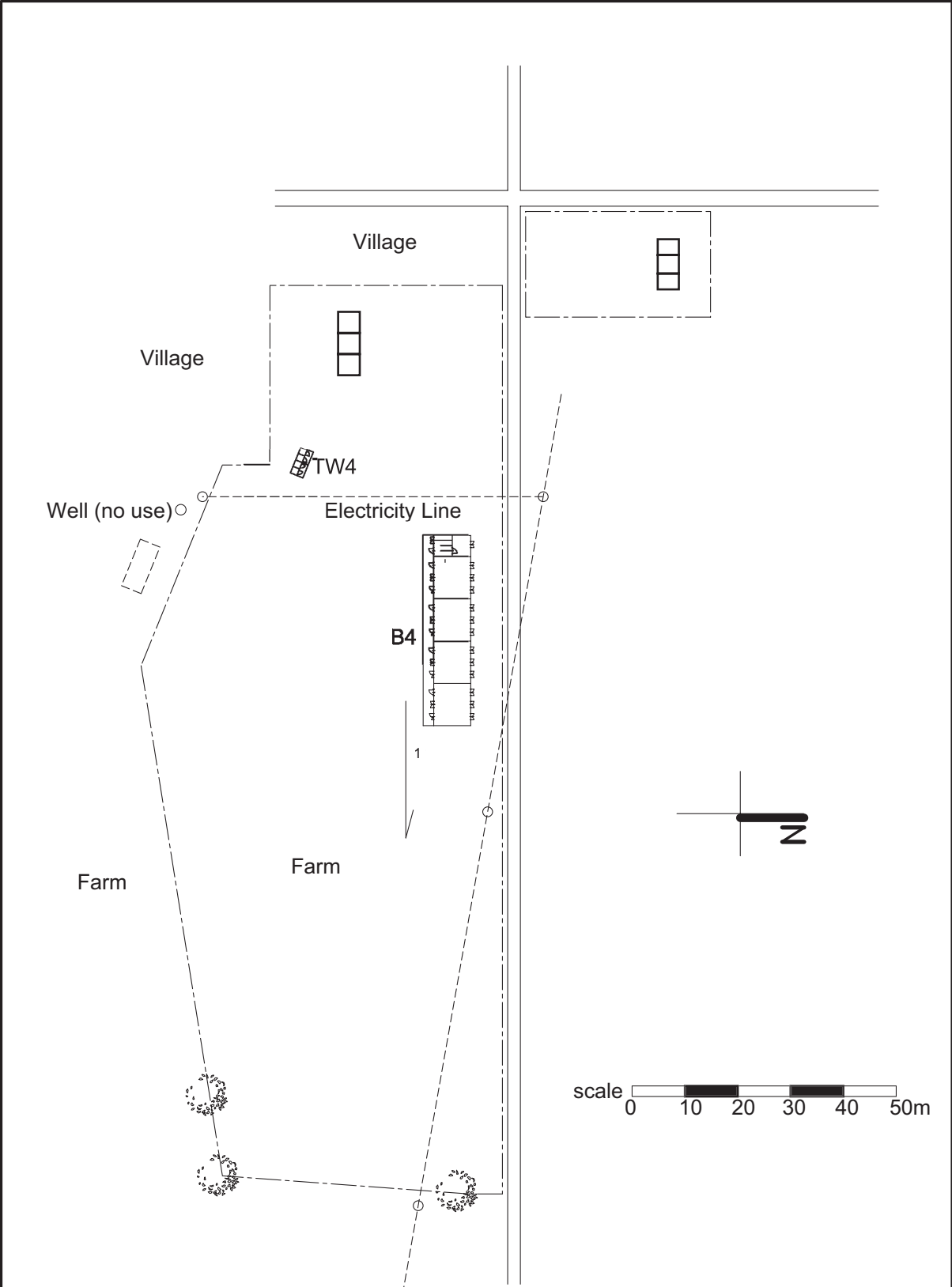

Construction Floor Area	
Classroom Building	324 m ²
Toilet	8 m ²
Total	332 m²

LGA	Barkin Ladi	Name	LEA Wereh	Original No.	P13	Site No.	PL-1
-----	--------------------	------	------------------	--------------	------------	----------	-------------

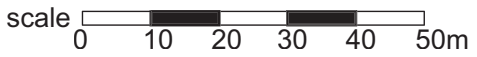
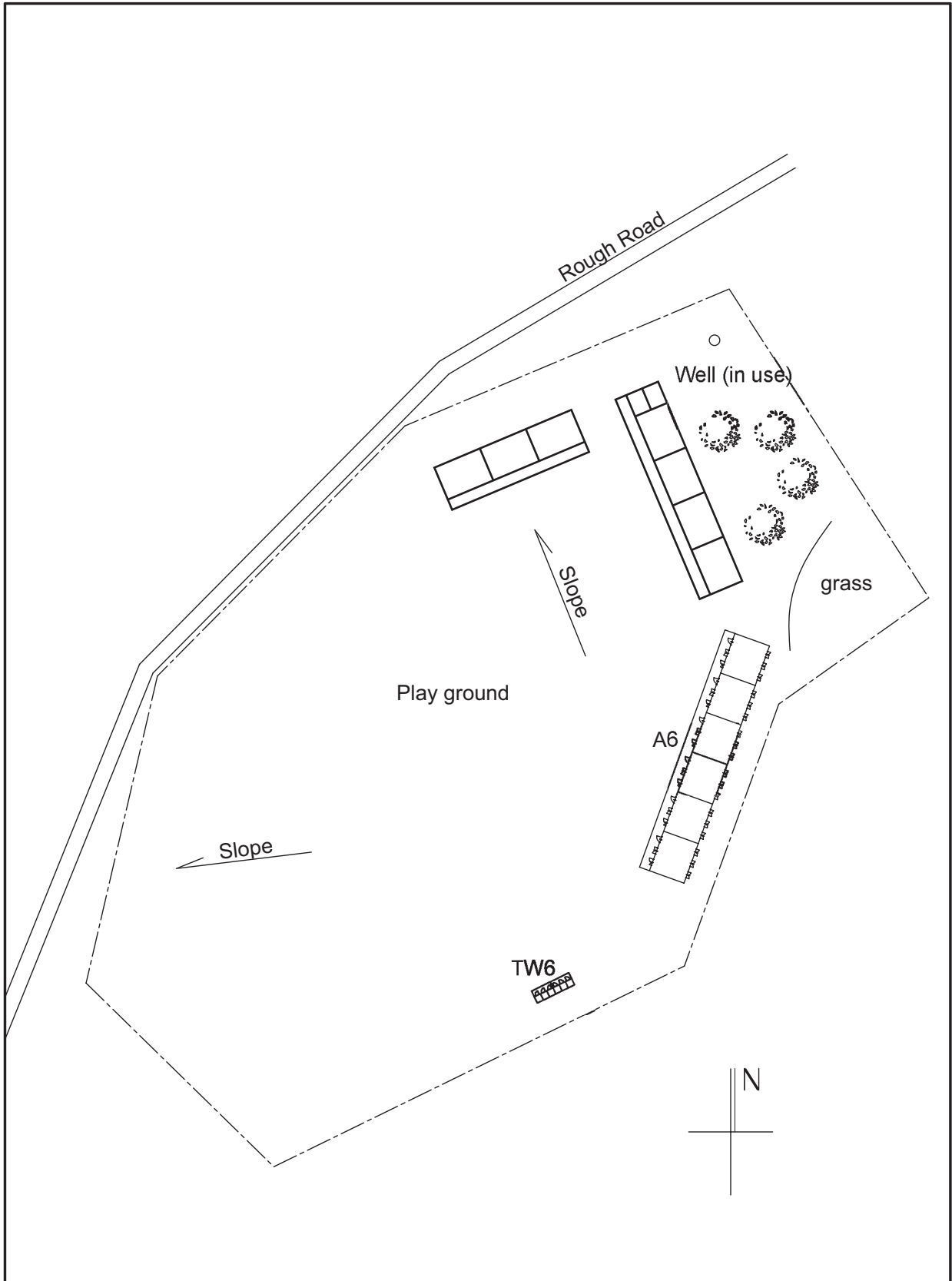

Construction Floor Area	
Classroom Building	432 m ²
Toilet	12 m ²
Total	444 m²

LGA Barkin Ladi	Name St. Philips Gana-Ropp	Original No. P14	Site No. PL-2
---------------------------	--------------------------------------	----------------------------	-------------------------

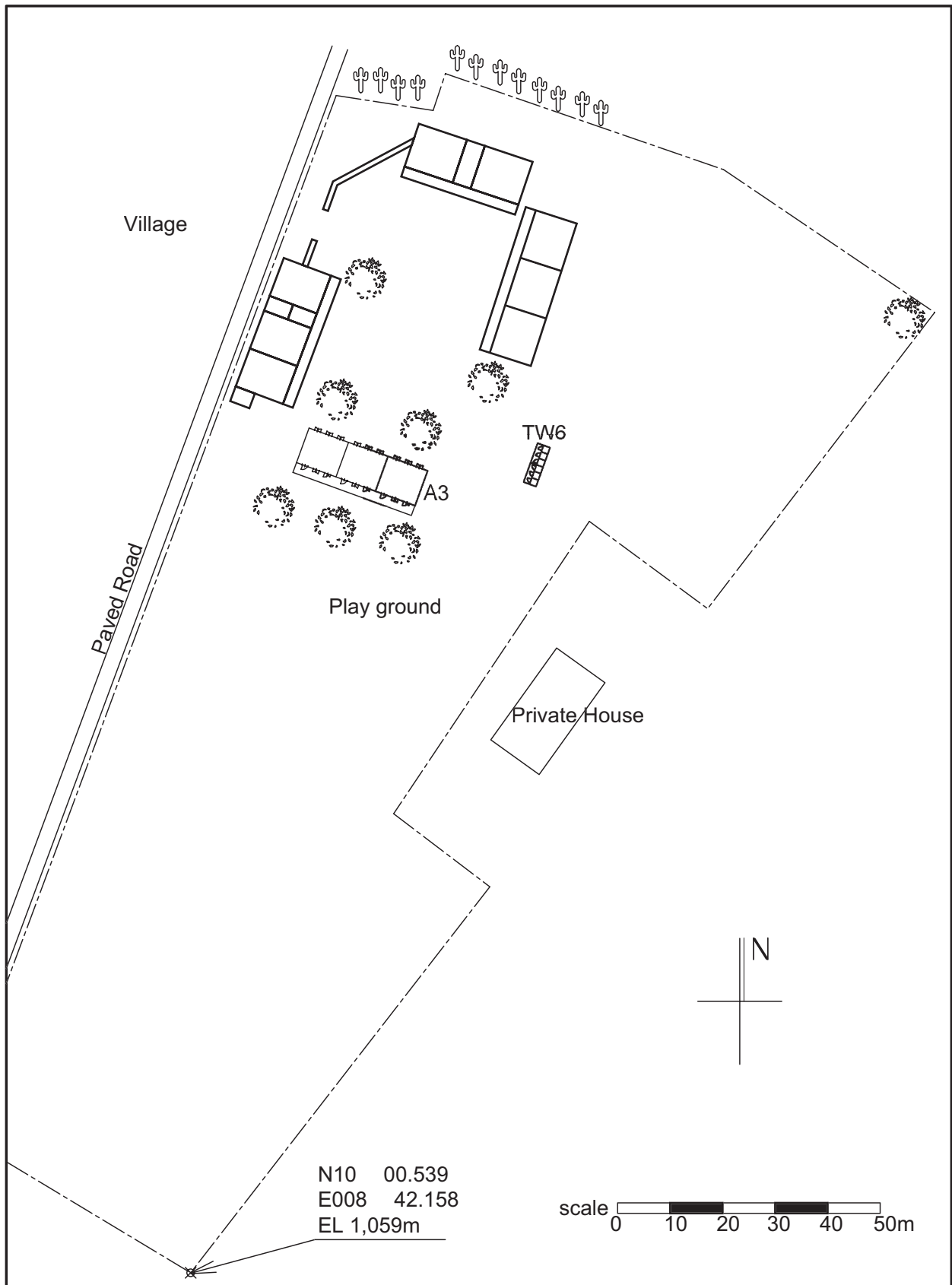

N10 00.539
 E008 42.158
 EL 1,059m



Construction Floor Area	
Classroom Building	216 m ²
Toilet	12 m ²
Total	228 m²

LGA	Bassa	Name	Binchi LEA	Original No.	P32	Site No.	PL-3
-----	-------	------	------------	--------------	-----	----------	------

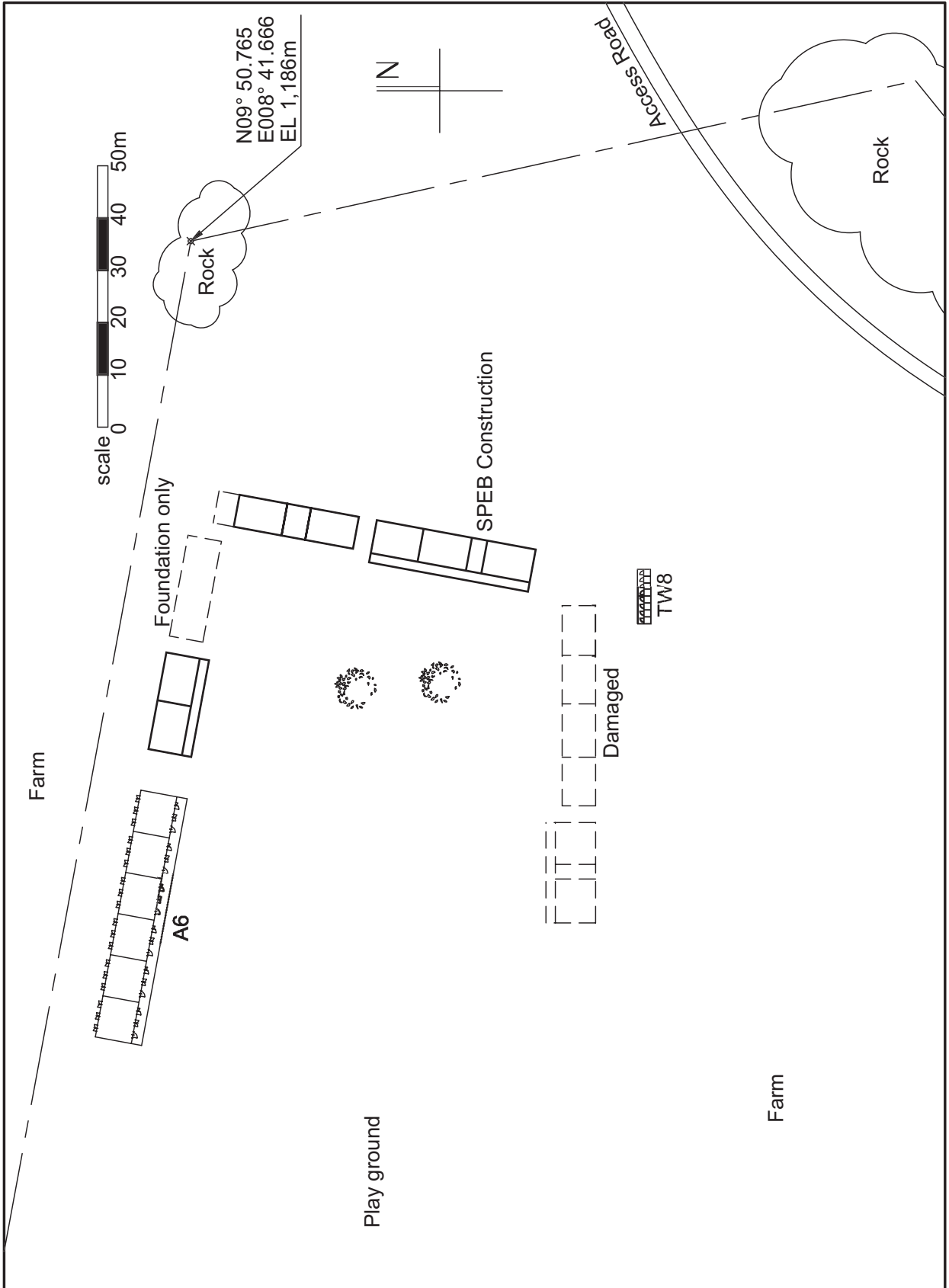

Construction Floor Area	
Classroom Building	432 m ²
Toilet	16 m ²
Total	448 m²

LGA	Name	Original No.	Site No.
Bassa	Ecwa Miango	P17	PL-4

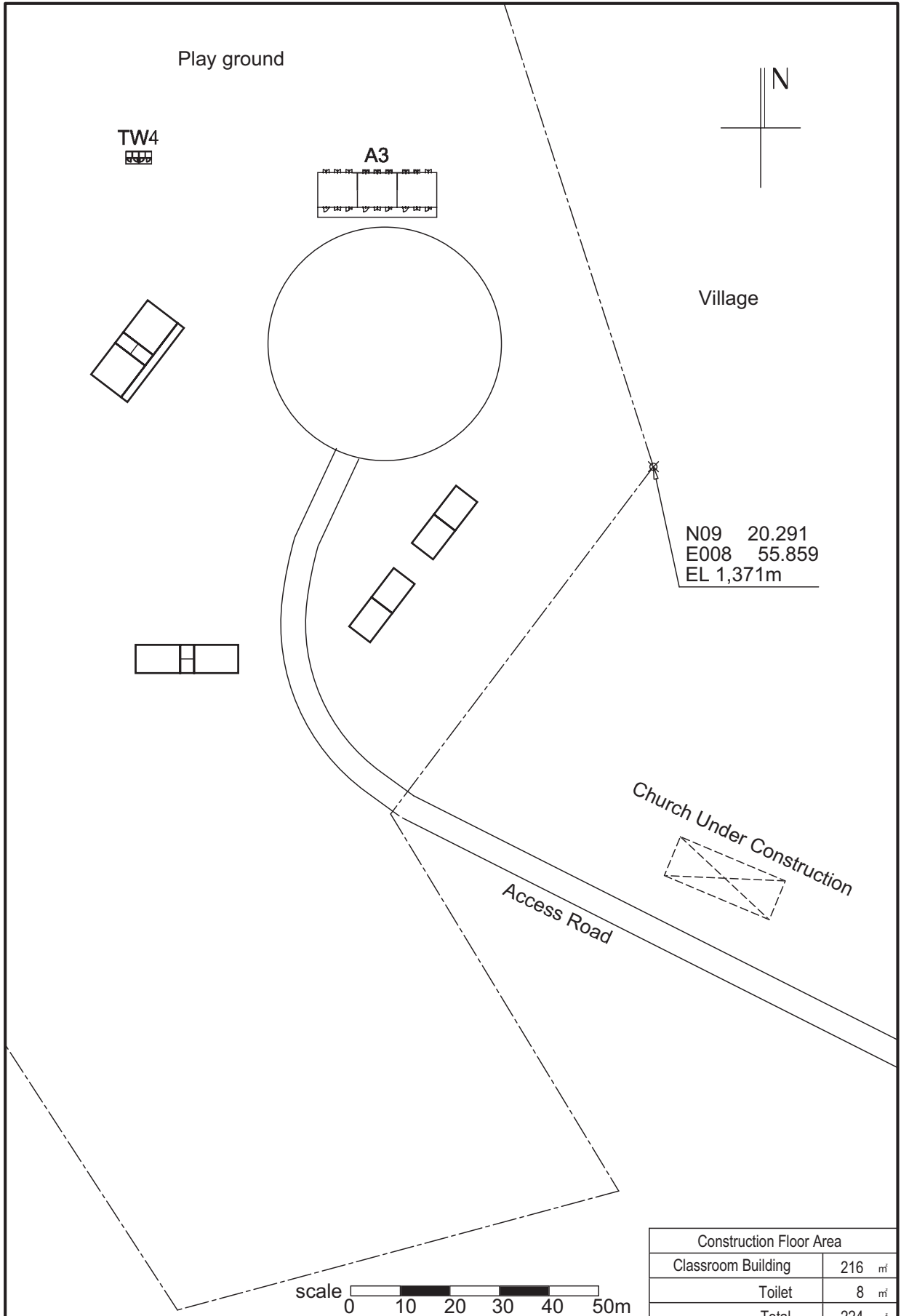

LGA	Name	Original No.	Site No.
Bokkos	Butura Kampani	P15	PL-5

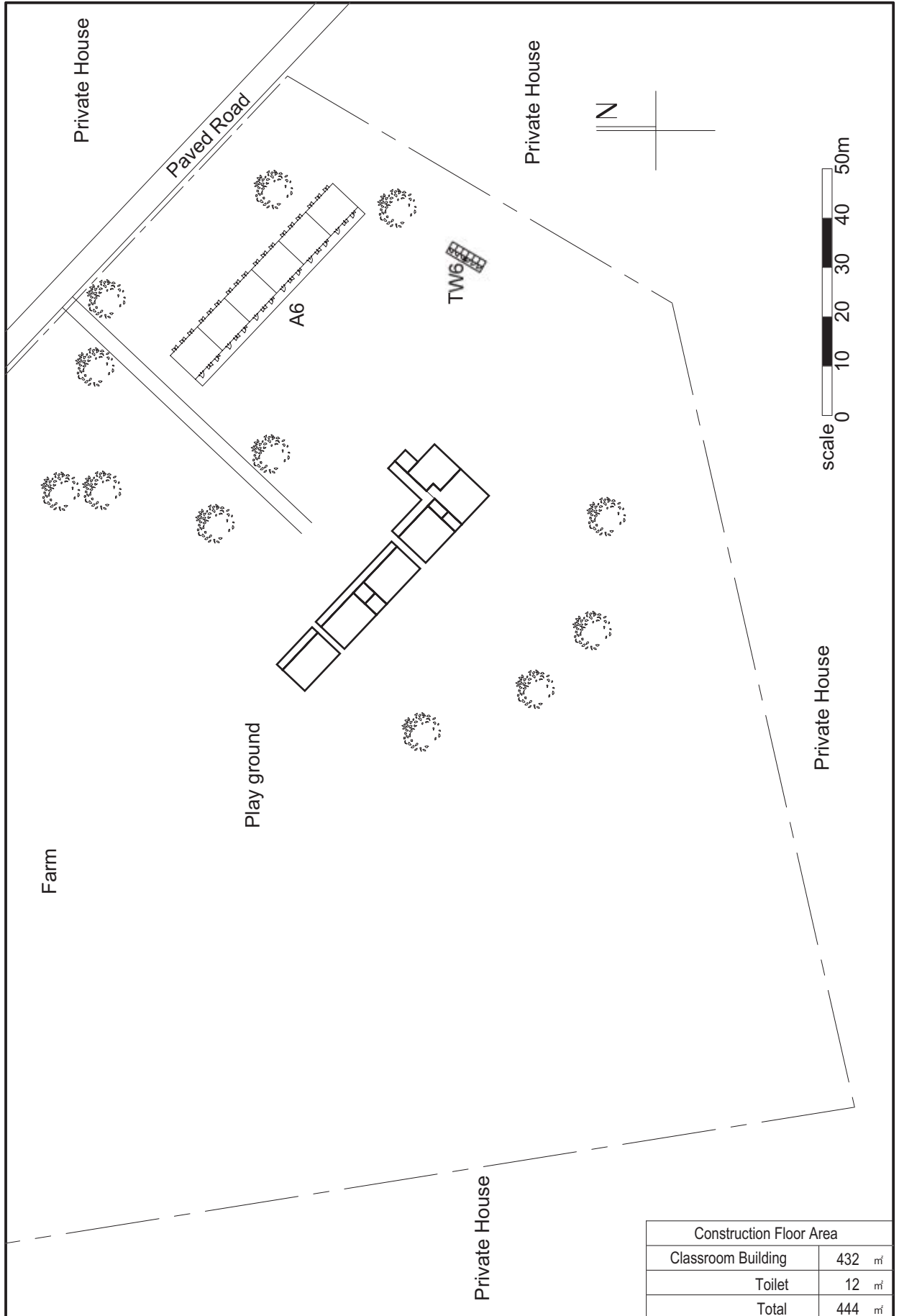

Construction Floor Area	
Classroom Building	432 m ²
Toilet	12 m ²
Total	444 m²

LGA Jos East	Name LEA Gada	Original No. P16	Site No. PL-6
------------------------	-------------------------	----------------------------	-------------------------

N09 56.083
 E008 55.216
 EL 1,221m

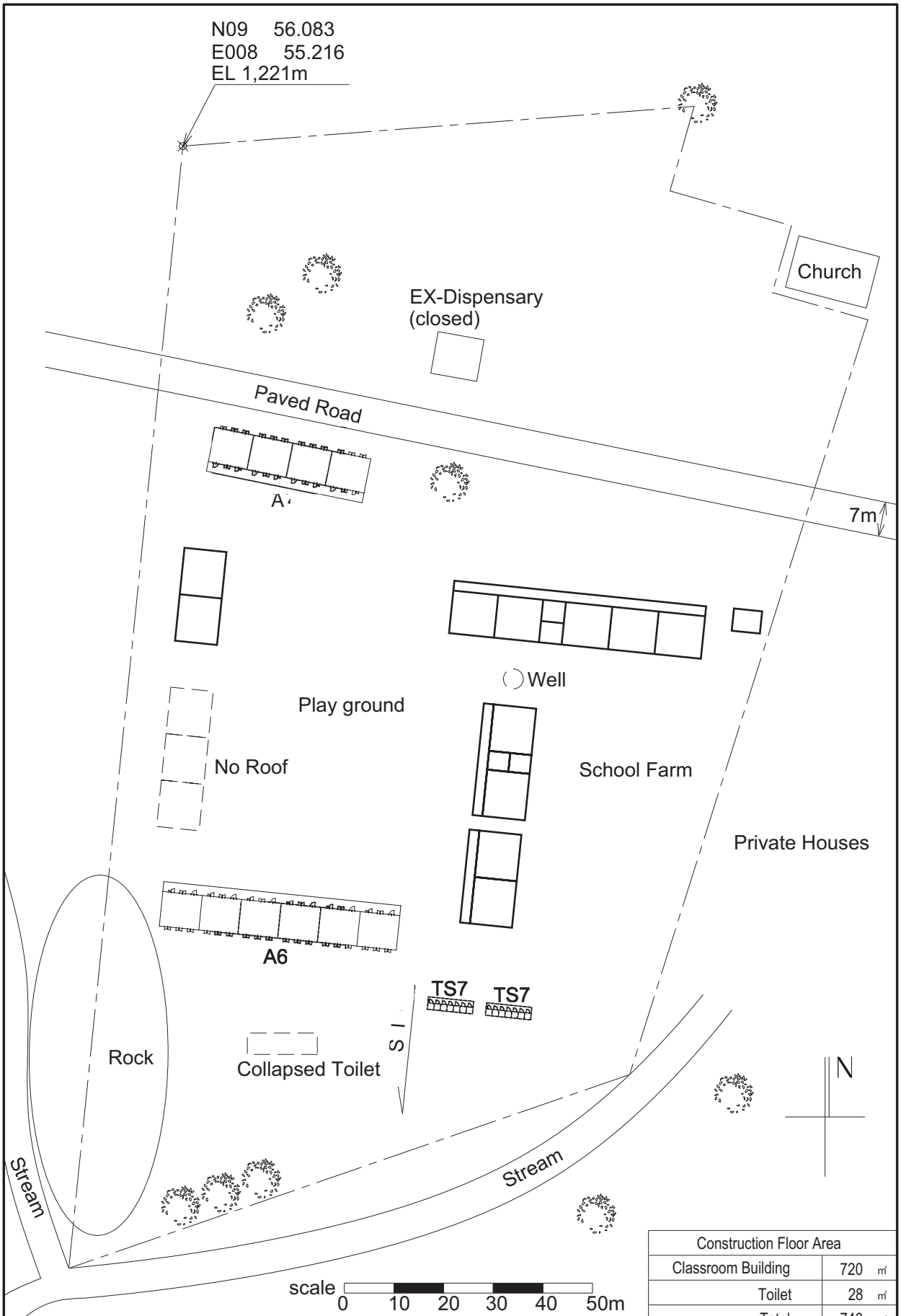

Construction Floor Area	
Classroom Building	720 m ²
Toilet	28 m ²
Total	748 m²

LGA Jos North	Name Gwong LEA	Original No. P20	Site No. PL-7
-------------------------	--------------------------	----------------------------	-------------------------

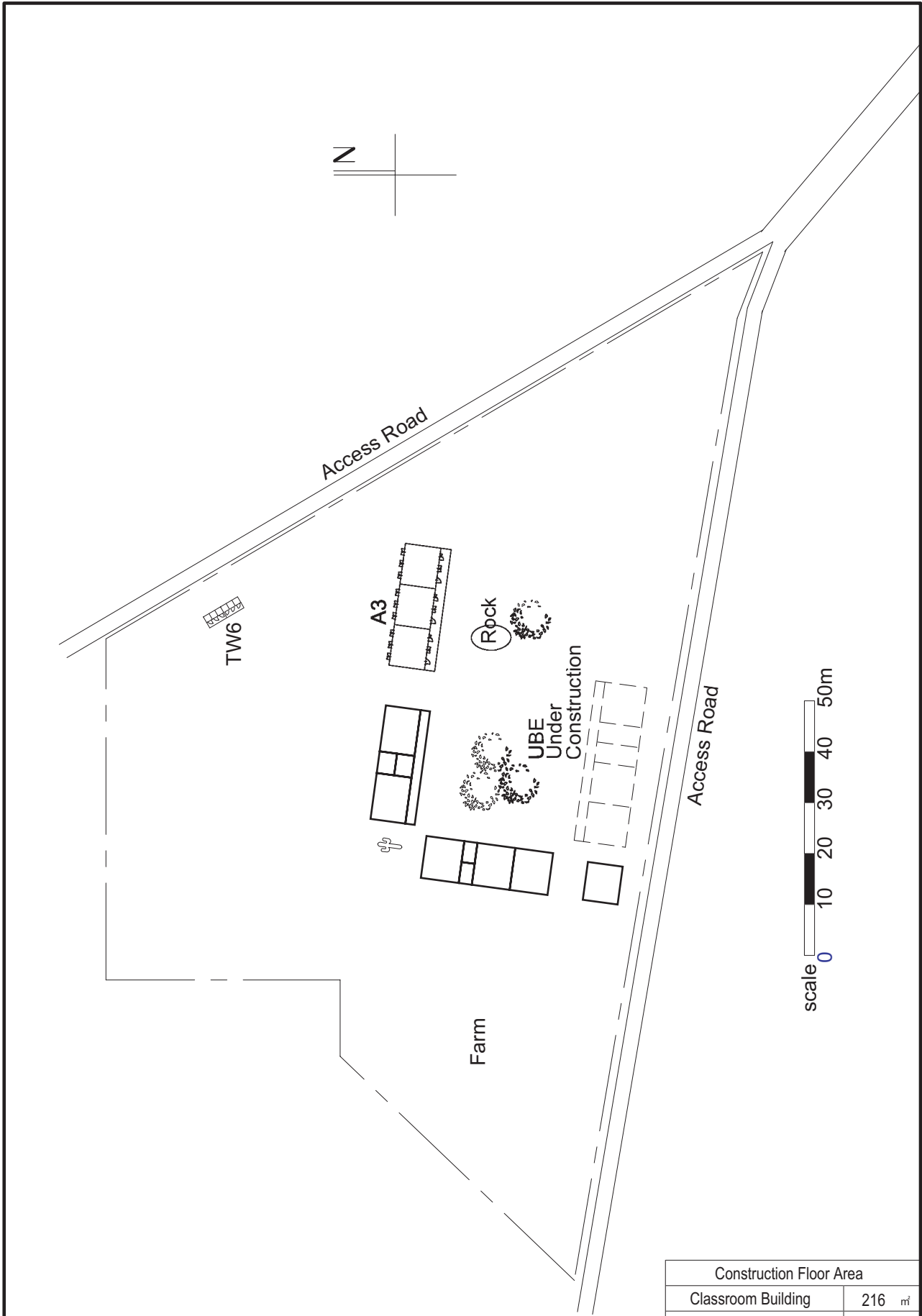

Construction Floor Area	
Classroom Building	216 m ²
Toilet	12 m ²
Total	228 m²

LGA	Name	Original No.	Site No.
Jos South	Ekan Zawan	P45	PL-8

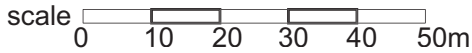
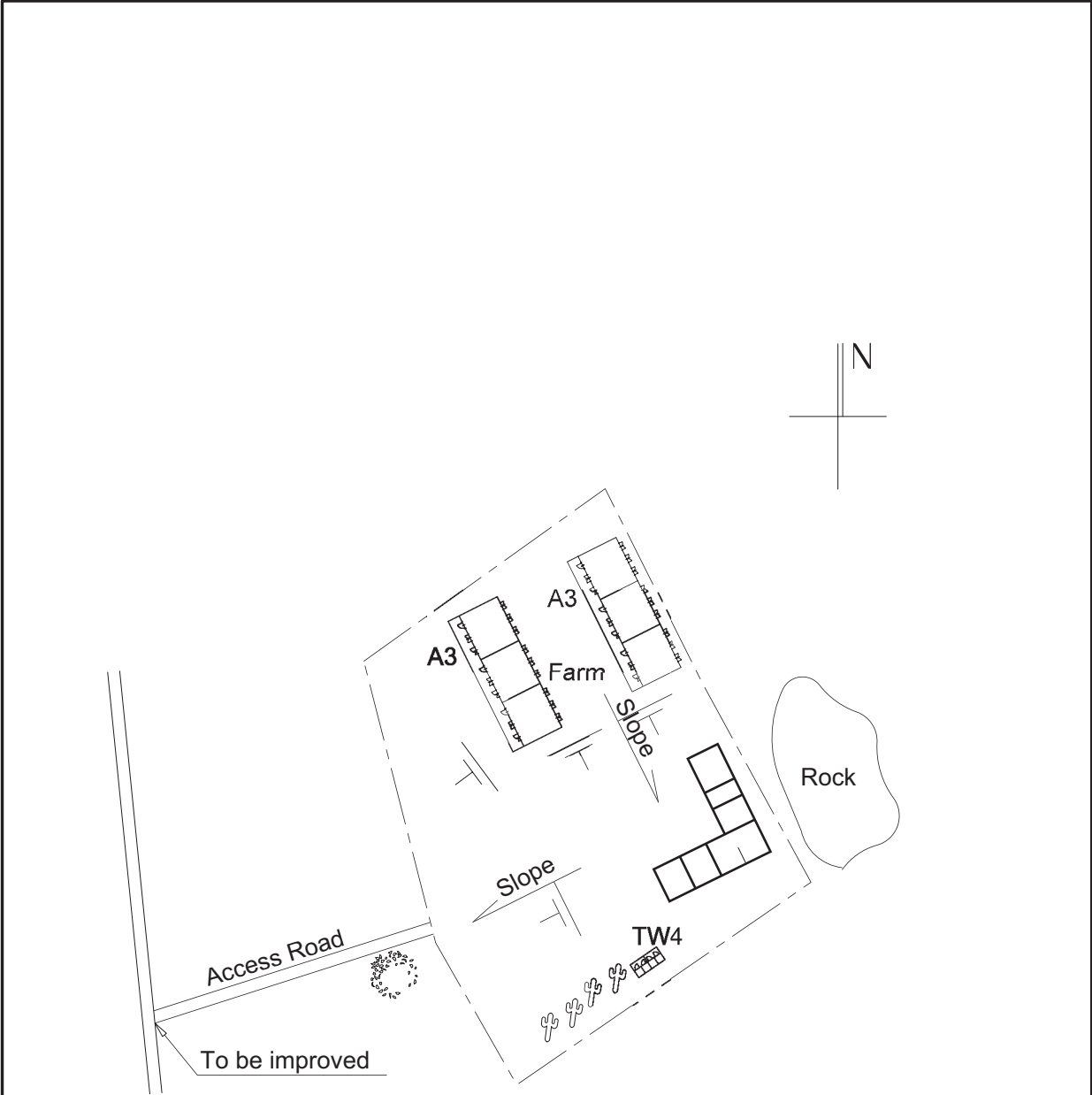

Construction Floor Area	
Classroom Building	432 m ²
Toilet	8 m ²
Total	440 m²

LGA Jos South	Name LEA Kanadap	Original No. P49	Site No. PL-9
-------------------------	----------------------------	----------------------------	-------------------------

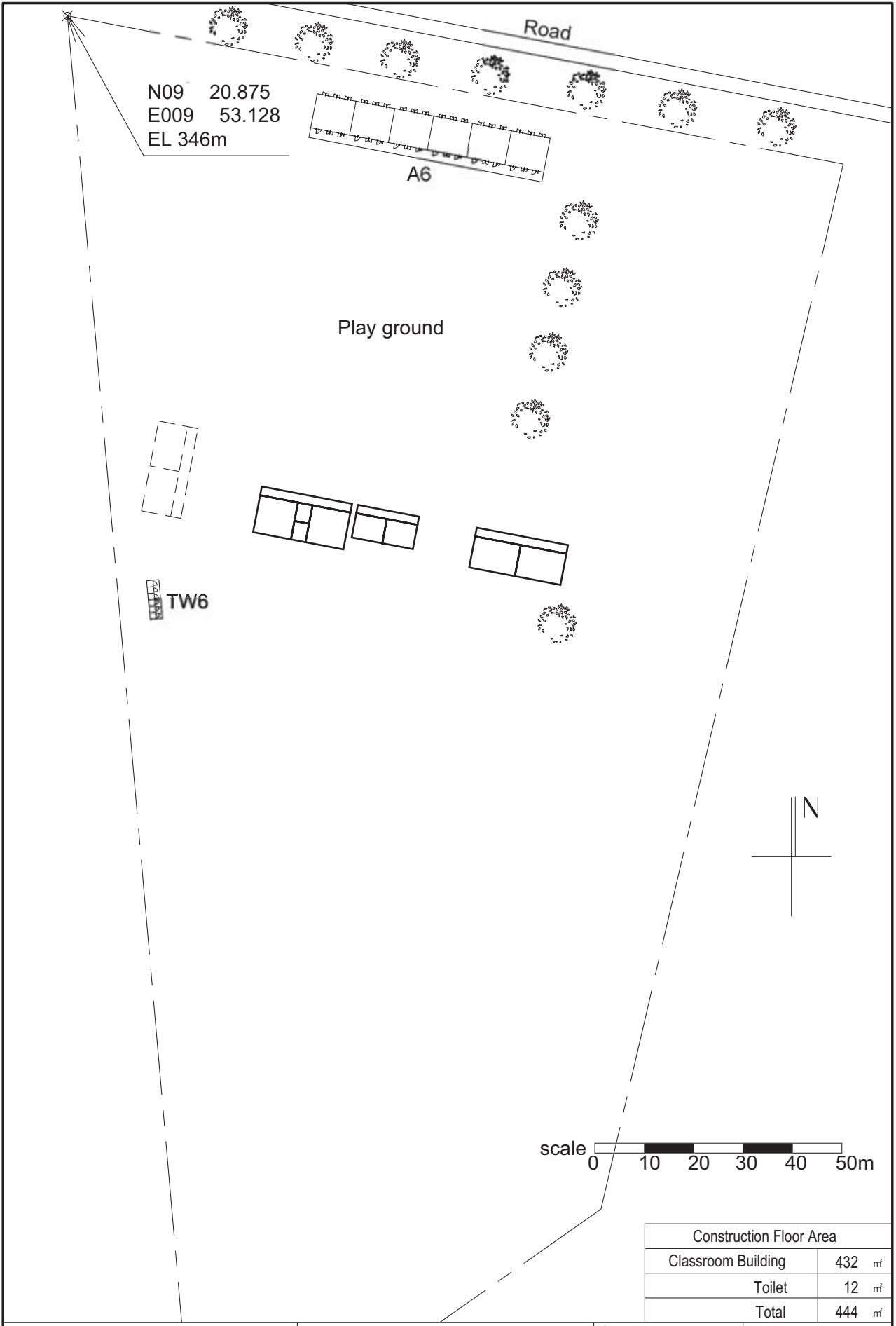

N09 20.875
 E009 53.128
 EL 346m

A6

Play ground

TW6

N

scale 0 10 20 30 40 50m

Construction Floor Area	
Classroom Building	432 m ²
Toilet	12 m ²
Total	444 m²

LGA Kanam	Name Gar Primay School	Original No. P21	Site No. PL-10
---------------------	----------------------------------	----------------------------	--------------------------

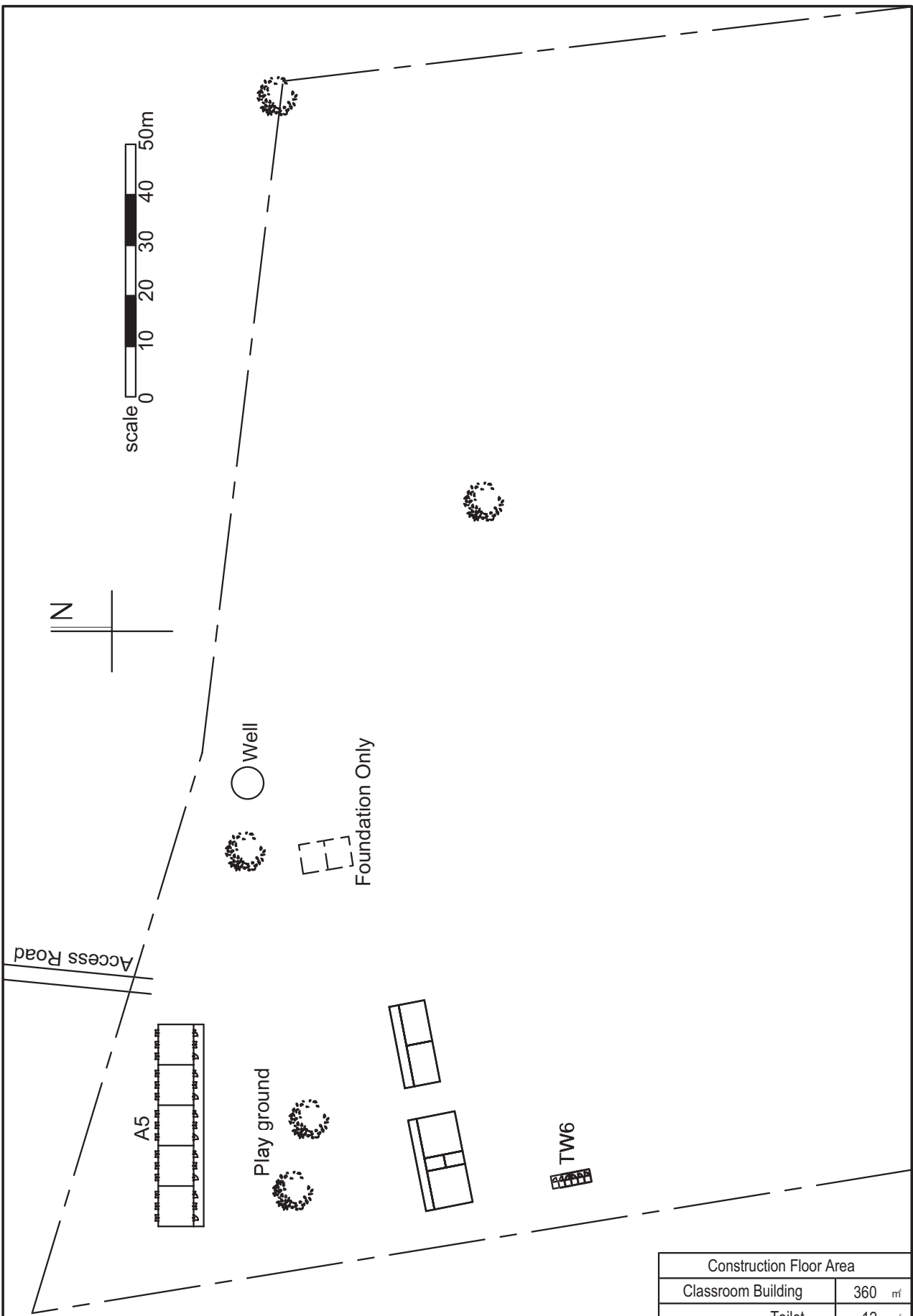

scale 0 10 20 30 40 50m

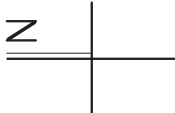

Access Road

Well

Foundation Only

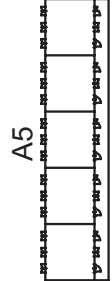

Play ground

TW6

Construction Floor Area	
Classroom Building	360 m ²
Toilet	12 m ²
Total	372 m ²

LGA Kanam	Name Kingyel LEA	Original No. P46	Site No. PL-11
--------------	---------------------	---------------------	-------------------

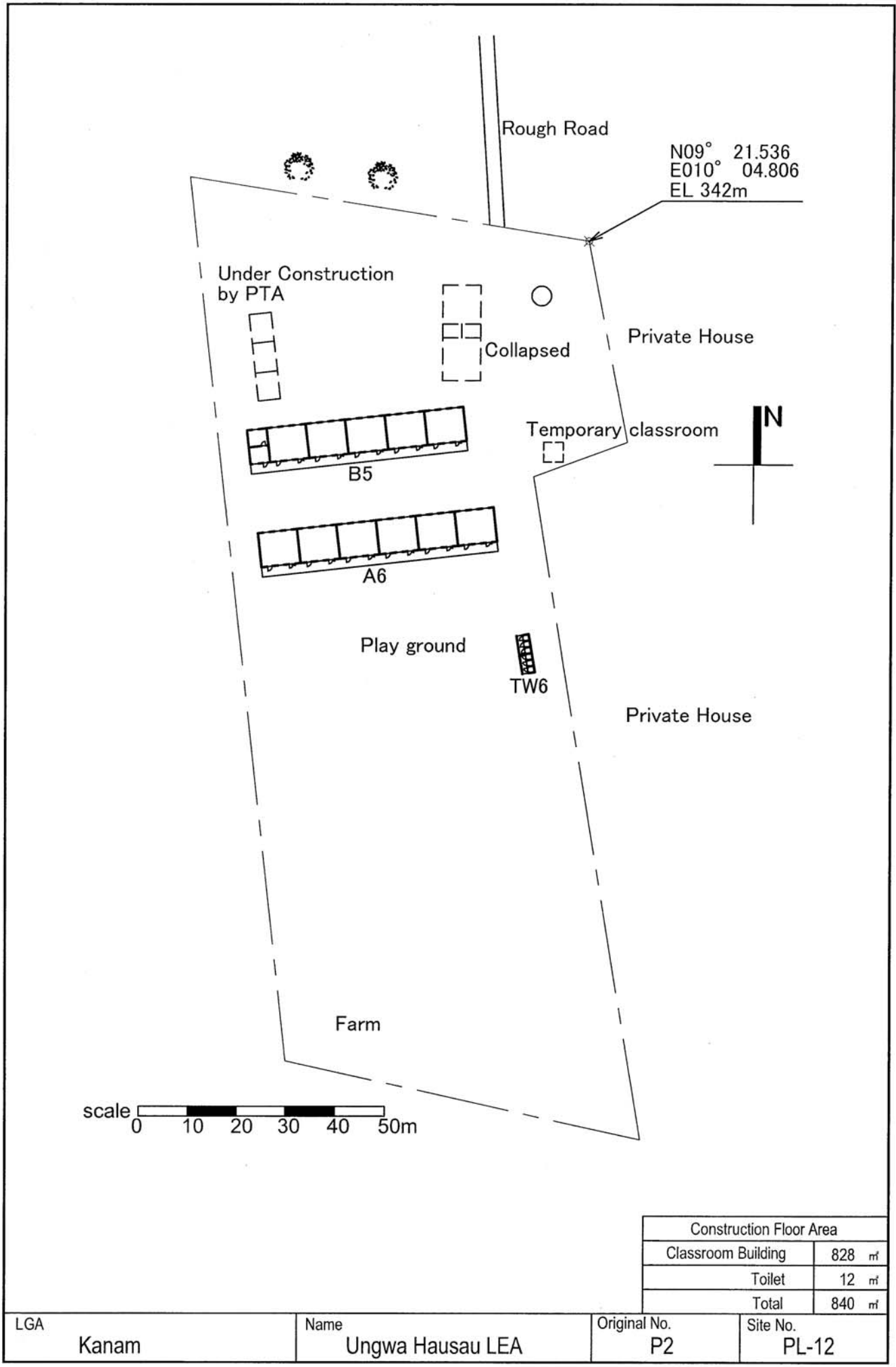

Construction Floor Area	
Classroom Building	828 m ²
Toilet	12 m ²
Total	840 m²

LGA Kanam	Name Ungwa Hausau LEA	Original No. P2	Site No. PL-12
---------------------	---------------------------------	---------------------------	--------------------------

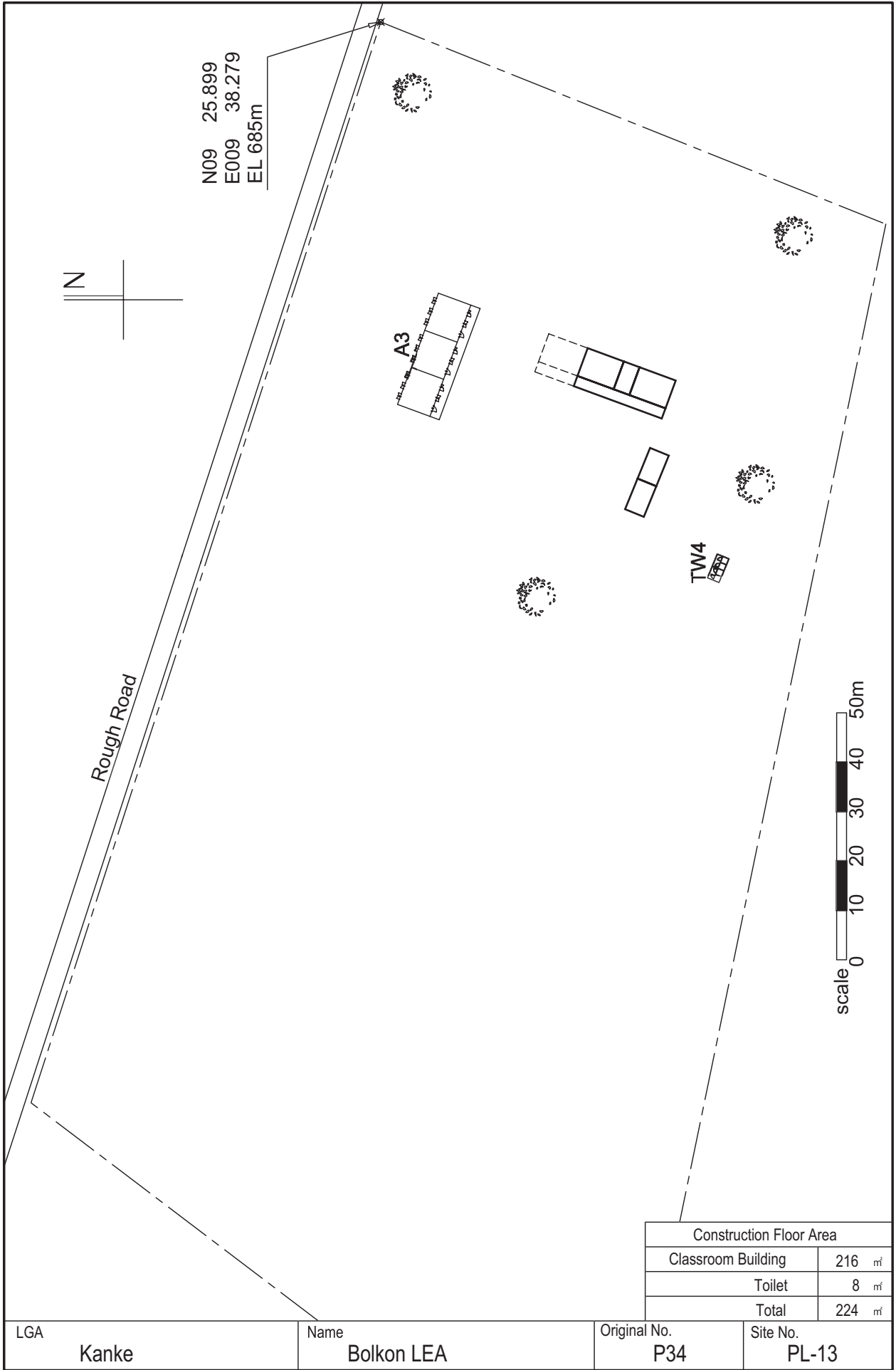

LGA

Kanke

Name

Bolkon LEA

Original No.

P34

Site No.

PL-13