

Annex-2 List of Candidate Schools

Extension

No.	School Name	District	Priority Order
1	No.2 School	Sukhbaatar	3
2	No.3 School		6
3	No.16 School		24
4	No.35 School		15
5	No.5 School	Chingeltei	21
6	No.17 School		23
7	No.39 School		5
8	No.19 School	Bayangol	9
9	No.20 School		20
10	No.40 School		22
11	No.73 School		7
12	Mongeni Complex		27
13	No.12 School	Songinokhairkhan	11
14	No.42 School		25
15	Iredui Complex		10
16	No.52 School	Khan-uul	26
17	No.14 School	Bayanzurkh	8
18	No.21 School		12
19	No.33 School		16
20	No.44 School		19
21	No.48 School		1
22	No.68 School		17
23	No.79 School		18
24	No.87 School		4
25	No.97 School	2	
26	Goromt	Nalaikha	13
27	Borokhslor	Baganor	14

New Construction

No.	School Name	District	Priority Order
1	No.61 School	Chingeltei	1
2	No.112 School	Songinokhairkhan	2
3	No.114 School	Khan-uul	3
4	No.113 School	Bayanzurkh	6
5	No.115 School	Songinokhairkhan	5
6	No.116 School	Sukhbaatar	4

Annex-3 Major Components Requested for the Project

1. Building

- (1) Classroom
- (2) Teacher's room
- (3) Cloak room
- (4) Toilet

2. Equipment

- (1) Basic Educational Furniture
- (2) Basic Teaching Material
 - Geographical map of Mongolia
 - Administrative map of Mongolia
 - Mineral resources map of Mongolia
 - Botanical map of Mongolia
 - Zoological map of Mongolia
 - World geographical map
 - World sectional map
 - Chemical elements chart
 - Unit chart
 - Human body dissection chart
 - Cyrillic alphabet chart for Mongolian
 - Thermometer
 - Compass
 - Tape measure
 - Geometrical blocks
 - Abacus
 - T-shape ruler
 - Ruler set
 - Multiplication Table
 - Overhead Projector
- (3) Maintenance Tools

SA

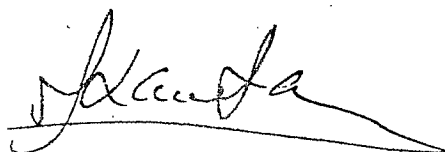

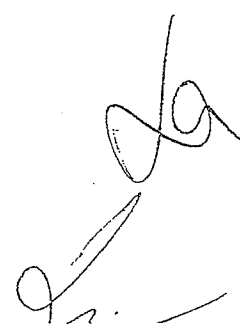

Annex-4 Criteria for the Site Selection

Schools/sites satisfying the following criteria will be given priority

1. Urgently need construction of additional classrooms because of overcrowding even after the introduction of double-shift or multi-grade classes.

Schools /sites to be selected must fulfill the following criteria:

2. Present and future demand can be quantitatively estimated by a set of data such as the number of school-aged children, the rates of population growth, enrollment ratio, etc.
3. Sufficient teachers, budget allocation, and necessary cooperation from concerned people for the proper operation and maintenance of the facilities are secured.
4. No other program or plan for new/undergoing classroom construction by MOSTEC, local government, other donors, NGOs and so forth.
5. Ownership of land for construction is legally secured, and the evidence of land ownership will be provided to the Japanese side by 19 September 2003.
6. Access road for the movement of materials and for the construction works are properly constructed.
7. Topographically safe and appropriate-sized land for construction is secured.
8. No foreseen natural and environmental or social hazard.

Annex-5 The Japan's Grant Aid Scheme

The Grant Aid Program provides a recipient country with non-reimbursable funds to procure the facilities, equipment and services (engineering services and transportation of the products, etc.) for economic and social development of the country under principles in accordance with the relevant laws and regulations of Japan. Grant Aid is not supplied through the donation of materials as such.

(1) Grant Aid Procedure

1) Japan's Grant Aid Program is executed through the following procedures.

Application (Request made by a recipient country)

Study (Basic Design Study conducted by JICA)

Appraisal & Approval

(Appraisal by the Government of Japan and Approval by Cabinet)

Determination of Implementation

(The Notes exchanged between the Governments of Japan and the recipient country)

2) Firstly, the application or request for a Grant Aid project submitted by a recipient country is examined by the Government of Japan (Ministry of Foreign Affairs) to determine whether or not it is eligible for Grant Aid. If the request is deemed appropriate, the Government of Japan assigns JICA to conduct a study on the request. If necessary, JICA send a Preliminary Study Mission to the recipient country to confirm the contents of the request.

Secondly, JICA conducts the study (Basic Design Study), using Japanese consulting firms.

Thirdly, the Government of Japan appraises the project to see whether or not it is suitable for Japan's Grant Aid Programme, based on the Basic Design Study report prepared by JICA, and the results are then submitted to the Cabinet for approval.

Fourthly, the project, once approved by the Cabinet, becomes official with the Exchange of Notes signed by the Governments of Japan and the recipient country.

Finally, for the implementation of the project, JICA assists the recipient country in such matters as preparing tenders, contracts and so on.

(2) Basic Design Study

1) Contents of the Study

The aim of the Basic Design Study (hereinafter referred to as "the Study"), conducted by JICA on a requested project (hereinafter referred to as "the Project"), is to provide a basic document necessary for the appraisal of the Project by the Government of Japan. The contents of the Study are as follows:

a) confirmation of the background, objectives and benefits of the Project and also institutional capacity of agencies concerned of the recipient country necessary for the Project's implementation;

b) evaluation of the appropriateness of the Project to be implemented under the Grant Aid Scheme from the technical, social and economic points of view;

c) confirmation of items agreed on by both parties concerning the basic concept of the Project;

d) preparation of a basic design of the Project; and

e) estimation of costs of the Project.

The contents of the original request are not necessarily approved in their initial form as the contents of the Grant Aid project. The Basic Design of the Project is confirmed considering the guidelines of Japan's Grant Aid Scheme.

The Government of Japan requests the Government of the recipient country to take whatever measures are necessary to ensure its self-reliance in the implementation of the Project. Such measures must be guaranteed even through they may fall outside of the jurisdiction of the organization in the recipient country actually implementing the Project. Therefore, the implementation of the Project is confirmed by all relevant organizations of the recipient country through the Minutes of Discussions.

2) Selection of Consultants

For the smooth implementation of the Study, JICA uses a consulting firm selected through its own procedure (competitive proposal). The selected firm participates in the Study and prepares for a report based upon the terms of reference set by JICA.

At the beginning of implementation after the Exchange of Notes, for the services of the Detailed Design and Construction Supervision of the Project, JICA recommends the same consulting firm which participated in the Study to the recipient country in order to maintain the technical consistency.

(3) Japan's Grant Aid Scheme

1) Exchange of Notes (E/N)

Japan's Grant Aid is extended in accordance with the Notes exchanged by the two Governments concerned, in which the objectives of the project, period of execution, conditions and amount of the Grant Aid, etc., are confirmed.

- 2) "The period of the Grant" means the one fiscal year which the Cabinet approves the project for. Within the fiscal year, all procedure such as exchanging of the Notes, concluding contracts with consulting firms and contractors and final payment to them must be completed.

However, in case of delays in delivery, installation or construction due to unforeseen factors such as weather, the period of the Grant Aid can be further extended for a maximum of one fiscal year at most by mutual agreement between the two Governments.

- 3) Under the Grant, in principle, Japanese products and services including transport or those of the recipient country are to be purchased.

When the two Governments deem it necessary, the Grant Aid may be used for the purchase of the products or services of a third country.

However, the prime contractors, namely consulting, contracting and procurement firms, are limited to "Japanese nationals". (The term "Japanese nationals" means persons of Japanese nationality or Japanese corporations controlled by persons of Japanese nationality.)

4) Necessity of "Verification"

The Government of the recipient country or its designated authority will conclude contracts denominated in Japanese yen with Japanese nationals. Those contracts shall be verified by the Government of Japan. This "Verification" is deemed necessary to secure accountability to Japanese taxpayers.

5) Undertakings required to the Government of the recipient country

- a) to secure land necessary for the sites of the Project and to clear, level and reclaim the land prior to commencement of the construction;
- b) to provide facilities for distribution of electricity, water supply and drainage and other incidental facilities in and around the sites;
- c) to ensure all expenses and prompt execution for unloading and customs clearance at ports of disembarkation in the recipient country and internal transportation therein of the products purchased under the Grant Aid;

- d) to exempt Japanese nationals from customs duties, internal taxes and other fiscal levies which may be imposed in the recipient country with respect to the supply of the products and services under the verified contracts;
- e) to accord Japanese nationals whose services may be required in connection with the supply of the products and services under the verified contracts such as facilities as may be necessary for their entry into the recipient country and stay therein for the performance of their work;

6) "Proper Use"

The recipient country is required to operate and maintain the facilities constructed and equipment purchased under the Grant Aid properly and effectively and to assign the necessary staff for operation and maintenance as well as to bear all the expenses other than those covered by the Grant Aid.

7) "Re-export"

The products purchased under the Grant Aid shall not be re-exported from the recipient country.

8) Banking Arrangement (B/A)

a) The Government of the recipient country or its designated authority should open an account in the name of the Government of the recipient country in a bank in Japan (hereinafter referred to as "the Bank"). The Government of Japan will execute the Grant Aid by making payments in Japanese yen to cover the obligations incurred by the Government of the recipient country or its designated authority under the verified contracts.

b) The payments will be made when payment requests are presented by the Bank to the Government of Japan under an Authorization to Pay (A/P) issued by the Government of recipient country or its designated authority.

9) Authorization to Pay (A/P)

The Government of the recipient country should bear an advising commission of an Authorization to Pay and payment commissions to the Bank.

Annex - 6 Necessary Undertakings to be Taken by Each Government

No	Items	To be covered by Grant Aid	To be covered by Recipient side
1	To secure land		●
2	To clear, level and reclaim the site when needed		●
3	To construct gates and fences in and around the site		●
4	To construct roads		
	1) Within the site	●	
	2) Outside the site		●
5	To construct the building	●	
6	To provide facilities for the distribution of electricity, water supply, drainage and other incidental facilities		
	1) Electricity		
	a. The distributing line to the site		●
	b. The drop wiring and internal wiring within the site	●	
	c. The main circuit breaker and transformer	●	
	2) Water Supply		
	a. The city water distribution main to the site		●
	b. The supply system within the site	●	
	3) Heat		
	a. The public or private heating inlet and outlet pipes to the buildings		●
	b. The heating system inside buildings	●	
	4) Drainage		
	a. The city drainage main (for storm, sewer and others) to the site		●
	b. The drainage system (for toilet sewer, ordinary waste, storm drainage and others) within the site	●	
	5) Telephone System		
	a. The telephone trunk line to the main distribution frame / panel (MDF) of the building		●
	b. The MDF and the extension after the frame / panel	●	
	6) Furniture and Equipment		
	a. General furniture		●
	b. Project equipment	●	
7	To bear the following commissions to a bank of Japan for the banking services based upon the B/A		
	1) Advising commission of A/P		●
	2) Payment commission		●
8	To ensure prompt unloading and customs clearance at the port of disembarkation in recipient country		
	1) Marine(Air) transportation of the products from Japan to the recipient country	●	
	2) Tax exemption and customs clearance of the products at the port of disembarkation		●
	3) Internal transportation from the port of disembarkation to the project site	●	
9	To accord Japanese nationals whose services may be required in connection with the supply of the products and the services under the verified contact such facilities as may be necessary for their entry into the recipient country and stay therein for the performance of their work		●
10	To exempt Japanese nationals from customs duties, internal taxes and other fiscal levies which may be imposed in the recipient country with respect to the supply of the products and services under the verified contracts		●
11	To maintain and use properly and effectively the facilities constructed and equipment provided under the Grant		●
12	To bear all the expenses, other than those to be borne by the Grant, necessary for construction of the facilities as well as for transportation and installation of the equipment		●

Minutes of Discussions
on
the Basic Design Study on the Project for
the Improvement of Primary Education Facilities (Phase III)
in
Mongolia
(EXPLANATION ON DRAFT REPORT)

In August 2003, the Japan International Cooperation Agency (JICA) dispatched a Basic Design Study Team on the Project for the Improvement of Primary Education Facilities (Phase III) (hereinafter referred to as "the Project") to Mongolia, and through discussions, site surveys and technical examination of the results in Japan, JICA prepared a draft report of the study.

In order to explain and to consult the Mongolian side on the components of the draft report, JICA sent to Mongolia the Draft Report Explanation Team (hereinafter referred to as "the Team"), which is headed by Mr. Toshio HIRAI, Resident Representative, JICA Mongolia Office, from January 12 to January 21, 2004.

As a result of discussions, both sides have confirmed the main items described on the attached sheet.

Ulaanbaatar, 16 January, 2004



Mr. Toshio HIRAI
Leader
Basic Design Study Team
Japan International Cooperation Agency

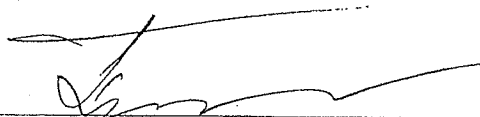

Mr. Purevjav GANSUKH
Director
Department of Finance and Economy
Ministry of Science, Technology
Education and Culture
Mongolia

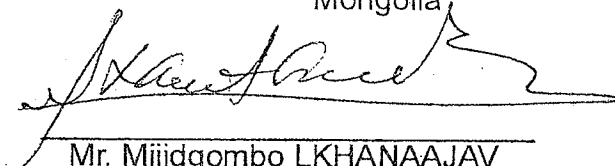

Mr. Mijidgombo LKHANAAJAV
Director
Education Department
Capital City of Ulaanbaatar
Mongolia

(Witness)



Mr. Khosbayar AMARSAIKHAN
Department of Economic Cooperation,
Management and Coordination
Ministry of Finance and Economy
Mongolia

ATTACHMENT

1. Contents of the draft report

The Mongolian side agreed and accepted in principle the contents of the draft report proposed by the Team. The Mongolian side understood that the cost estimate written in the draft report is provisional and would be further examined by the Japanese side.

2. Japan's Grant Aid Scheme

The Mongolian side understood the Japan's Grant Aid Scheme and the necessary measures to be taken by the Mongolian side described in Annex 5-6 of the Minutes of Discussions signed by both parties on September 2, 2003.

3. Final Report

JICA will complete the final report in accordance with the result of discussions and forward it to the Mongolian side around April 2004.

4. Other relevant issues

4-1. Schools and facilities covered by the Project

Both sides agreed on schools and components covered by the Project as shown in Annex-1. The Mongolian side agreed that the Japanese side would make final decision on this matter through further study in Japan.

4-2. Allocation of necessary budget and personnel

The Mongolian side agreed to allocate enough budget and personnel (teachers and general staff) to properly operate and maintain the facilities and equipment covered by the Project.

The Team explained the number of qualified teachers to be necessary for the classrooms to be constructed. The Mongolian side confirmed to select suitable candidates before the completion of Japanese construction.

4-3. School No. 113

The Japanese side identified that there are people currently staying inside the No.113 school site, and explained the due process and procedures to be taken in order to solve the resettlement of those people. After the discussion concerning the matter, the Japanese side and the Mongolian side concluded that it is impossible to solve the resettlement problem within the planned schedule of the study in due process, and agreed to exclude the No.113 School from the Project.

4-4 School No.87 and Goromt Complex School

The Mongolian side originally requested the construction of 8 or 12 classrooms for each existing school. However, the Mongolian side revised such request and newly requested the Japanese side to apply the building TYPE-4 (4 story 18 classrooms) not only to the new schools but also to the existing schools considering the huge number of classroom shortage which could be seen in the School No.87 and Goromt Complex School through the analysis done by the Japanese side. The Japanese side understood the request from the Mongolian side and agreed on it.

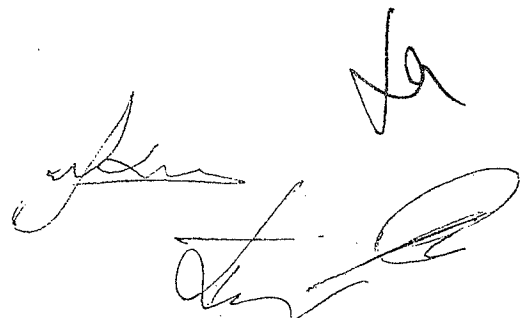

4-5 School No.48

Since the School No.48 and the School No.113 share the same school zone, the classroom shortage for the No.48 has been increased due to the exclusion of the No.113 School from the Project as mentioned in 4-3 above. Therefore, the Mongolian side requested to apply the building TYPE-4 (4 story 18 classrooms) to the School No.48 as well as the existing schools mentioned in 4-4. The Japanese side understood the request from the Mongolian side and agreed on it.

4-6. Schools to be constructed in each construction stage

Due to the article 4-3, 4-4, and 4-5, the Japanese side and the Mongolian side agreed to readjust the schools to be constructed in the 1st, the 2nd and the 3rd construction stage. The Mongolian side agreed that the Japanese side would make final decision on this matter.

4-7. Securing Proposed Building Sites

The Mongolian side confirmed that they would secure the identified building sites in the recipient schools by until the actual construction work starts.

4-8. Proper Use and Maintenance

Both sides understood that proper use and maintenance of the facilities would be indispensable for their lifelong use. The Mongolian side assured the Japanese side that it will facilitate the proper use and maintenance of facilities in the schools covered by the Project with the active involvement of concerned parties such as District education officer, schools, communities and so on.

4-9. Students Transferring Plan for Newly built schools

In order to operate newly built schools properly, the Mongolian side assured the Japanese side to reorganize the student catchment area for new schools before the completion of Japanese construction, and relocate students accordingly after the completion.

4-10. Site preparation works to be covered by the Mongolian side

The Japanese side explained the content of the site preparation works to be covered by the Mongolian side as described in Annex-2. The Mongolian side confirmed to complete the required works before the commencement of Japanese construction.

Handwritten signatures and initials in black ink, including a large signature at the bottom and initials 'Ja' at the top right.

Annex-1 Schools and Components covered by the Project

1 New Schools

No.	Priority order set by the Mongolian side	School name	District name	No. of classrooms to be constructed	Teacher's Room	Cloak Room	Toilet Type	Building Type
1	N1	No. 61 School	Chingeltei	18	●	●	4	4
2	N2	No. 112 School	Songinokhairkhan	18	●	●	4	4
3	N3	No. 114 School	Khan-uul	18	●	●	4	4
4	N4	No. 116 School	Sukhbaatar	18	●	●	4	4
5	N5	No. 115 School	Songinokhairkhan	18	●	●	4	4
Total				90				

2 Existing Schools

No.	Priority order set by the Mongolian side	School name	District name	No. of classrooms to be constructed	Teacher's Room	Cloak Room	Toilet Type	Building Type
1	1	No.48 School	Bayanzurkh	18	●	●	4	4
2	2	No.97 School	Bayanzurkh	6	●	●	1	1
3	4	No.87 School	Bayanzurkh	18	●	●	4	4
4	5	No.39 School	Chingeltei	6	●	●	1	1
5	8	No.14 School	Bayanzurkh	8	●	●	2	2
6	10	Iredui Complex	Songinokhairkhan	8	●	●	2	2
7	13	Goromt	Nalaikha	18	●	●	4	4
8	14	Borovsrol	Baganor	12	●	●	3	3
9	16	No.33 School	Bayanzurkh	8	●	●	2	2
10	17	No.68 School	Bayanzurkh	6	●	●	1	1
11	19	No.44 School	Bayanzurkh	8	●	●	2	2
12	23	No.17 School	Chingeltei	8	●	●	2	2
Total				124				

Annex1 Schools and components covered by the Project (continued)

3 Equipment

(1) Basic Educational Furniture

(2) Basic Teaching Material

- Geographical map of Mongolia
- Administrative map of Mongolia
- Mineral Resources map of Mongolia
- Botanical map of Mongolia
- Zoological map of Mongolia
- World geographical map
- World sectional map
- Chemical elements chart
- Unit chart
- Human body dissection chart
- Cyrillic alphabet chart for Mongolian
- Multiplication table
- Thermometer
- Compass
- Tape measure
- Geometrical blocks
- Abacus
- T-shape ruler
- Ruler set
- Overhead Projector

(3) Maintenance Tools

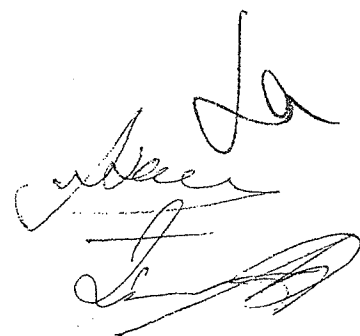
A handwritten signature in black ink, appearing to be 'J. A.', located in the bottom right corner of the page.

Annes-2 Site Preparation Works to be covered by the Mongolian side

Name of School	Site Preparation	Removal/ Transfer of Obstacles	Infrastructure			
			Electricity	Heating	Water supply	Sewerage
Existing School						
No.14 School	None	Playground equipment	None	UBC Company	City water	Public sewerage
No.17 School	Cutting & Filling	Playground equipment		UBC Board	Water supply truck	Dipping up
No.33 School	None	Pavement		UBC Company	City water	Public sewerage
No.39 School	Cutting & Filling	Pavement		Private Company	Private well	Dipping up
No.44 School	None	Pavement		UBC Company	City water	Public sewerage
No.48 School	None	Trees, Cobblestones, Pavement, Lighting Pole, Low Fence		UBC Company	City water	Public sewerage
No.68 School	None	Pavement		National Army	Private well	Public sewerage
No.87 School	None	Concrete lumps		UBC Board	Water supply Truck	Dipping up
No.97 School	None	Heating pipe, Trees, Fence Pavement		UBC Company	City water	Public sewerage
Iredui CS	None	Curb		UBC Company	City water	Public sewerage
Goromt CS	None	None		UBC Board	City water	Public sewerage
Borovsrol CS	None	Playground equipment		UBC Board	City water	Public sewerage
New School						
No.61 School	None	Radio wiring	Extension of electric wires to the site	None	Public water station	Dipping up
No.112 School	Cutting & Filling	Concrete lumps			Water supply Truck	Dipping up
No.113 School	Cutting & Filling, Retaining wall	Wooden deserted house, Concrete lumps			Water supply Truck	Dipping up
No.114 School	None	None			Water supply Truck	Dipping up
No.115 School	Cutting & Filling	None			Water supply Truck	Dipping up
No.116 School	Filling	None			Water supply Truck	Dipping up

cs: complex school ,

UBC Company: Ulanbaatar Transmission Company

UBC Board: Ulaanbaatar Heating Stoves Utilization Board

Work to be done by the Mongolian side

Item	Sub-item	unit	unit cost (1000Tg)	First Stage					Second Stage							Third Stage						grand total								
				No.48	No.61	No.112	No.114	total	No.115	No.116	No.39	No.87	No.97	No.68	total	No.14	No.17	No.33	No.44	Ir	Co		Bo	total						
Cut & Fill	Cut	m ³	5.50			460		2,530	287	0	166										166								913	5,935
	Fill	m ³	8.50			460		11,280	287	10,000	166										166								1,411	101,541
	Retaining Wall	m ²	1.00					0																				0	0	
	Removal of Obstacles	m ²	10.80		1	2		572			90	3	45	45	1,976	1	2	24	5	0	1								1,134	3,683
	City Water	m	40.00					0			10	10	10	10	1,200	10	10	10	10	10									2,400	3,600
	Sewerage	m	40.00					0			10	10	10	10	1,600	10	10	10	10	10									2,400	4,000
	Heating	m	100.00					1,000			10	10	10	10	4,000	10	10	10	10	10									7,000	12,000
	Electricity	m	3.50			10	40	210	60	100					560														0	770
Fence		m	17.28			0	400	10,956	460	300					13,133														0	24,088
Gate		Each	108.00			1	1	324	1	1				216															0	540
B/A/A/P	commission	%	0.035					3,226						3,226															3,226	9,678
Total (1,000Tg)								30,097						117,253															18,484	165,835

* Ir : Iredui Complex School, Go: Goromt Complex School, Bo : Borovsrol Complex School

5. Cost Estimate for the works borne by Mongolian Side

6. Reference

No.	Title	Publisher	Year
1	Education Sector Strategy 2000-2005	MOSTEC	2000
2	Education and Literacy: Analysis Based on the 2000 Census	National Statistical Office of Mongolia	2002
3	EFA 2000 Assessment: Country Reports--- Mongolia	ACCU	2000
4	Mongolian Action Programme for the 21 st Century (MAP-21)	National Council for Sustainable Development of Mongolia	1999
5	Action Program of the Government of Mongolia 2000-2004	Government of Mongolia	2000
6	The public Investment Program and Development Project Proposals 2002-2005	Government of Mongolia (Mongolia Consultative Group Meeting)	July, 2002
7	Economic Growth Support and Poverty Reduction Strategy	Government of Mongolia	July, 2003
8	Foundation of Education Sector in Mongolia and its Development in 80 years	MOSTEC	2001
9	Education Law of Mongolia	MOSTEC	May, 2002
10	Primary and Secondary Education Law of Mongolia	MOSTEC	May, 2002
11	Mongolian Statistical Yearbook 2002	National Statistical Office of Mongolia	2003
12	Mongolian Statistical Yearbook 2001	National Statistical Office of Mongolia	2002
13	Mongolian Statistical Yearbook 2000	National Statistical Office of Mongolia	2001
14	2000 Population and Housing Census: The Main Results	Mongolia National Statistical Office	2001
15	A Pilot Time Use Survey 2000	Mongolia National Statistical Office	2000
16	Report and Recommendation of the Resident to the Board of Director on a Proposed Loan to Mongolia for he Second Education Development Project	Asian Development Bank	July, 2002
17	Education Sector Development Program	Asian Development Bank	---
18	Childe and Development Survey – 2000 (MICS-2)	Mongolia National Statistical Office	2001
19	Earthquake-Resistant Design Standard of Mongolia	RCAC, Mongolia	Aug, 1998
20	Architectural Standards of Educational Facilities (II-66-88) (a part)	Bureau of Architectural Standards, Mongolia	1990

21	School and Dormitory Buildings in Mongolia	MOSTEC	---
22	-Fire Safety Standards for Construction Design and Planning (CNaR21-02-02) -Fire Safety of a Building and Facility (BNbD21-01-02)	Ministry of Infrastructure of Mongolia	2002
23	Mongolian Schools Rehabilitation and Construction Feasibility Study (Final Draft)	CIDA	Jan, 2002

7. Site Plans

SCHOOL ID

NO.14

NAME OF SCHOOL

NO.14 SCHOOL

DISTRICT

Bayanzurkh

SCALE

1:1000

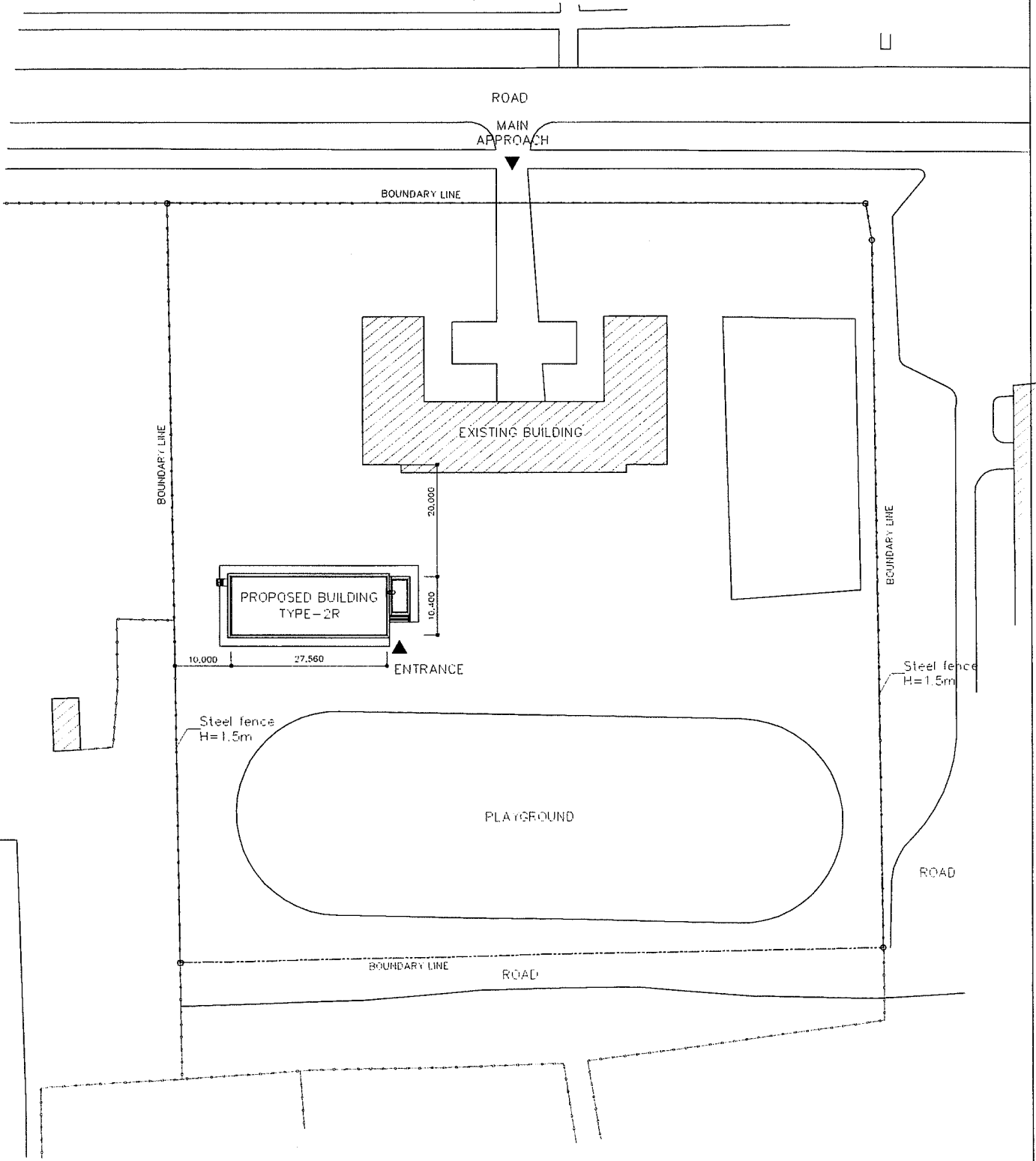
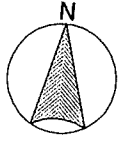

SCHOOL ID

NO.17

NAME OF SCHOOL

NO.17 SCHOOL

DISTRICT

Chingeltei

SCALE

1:1000

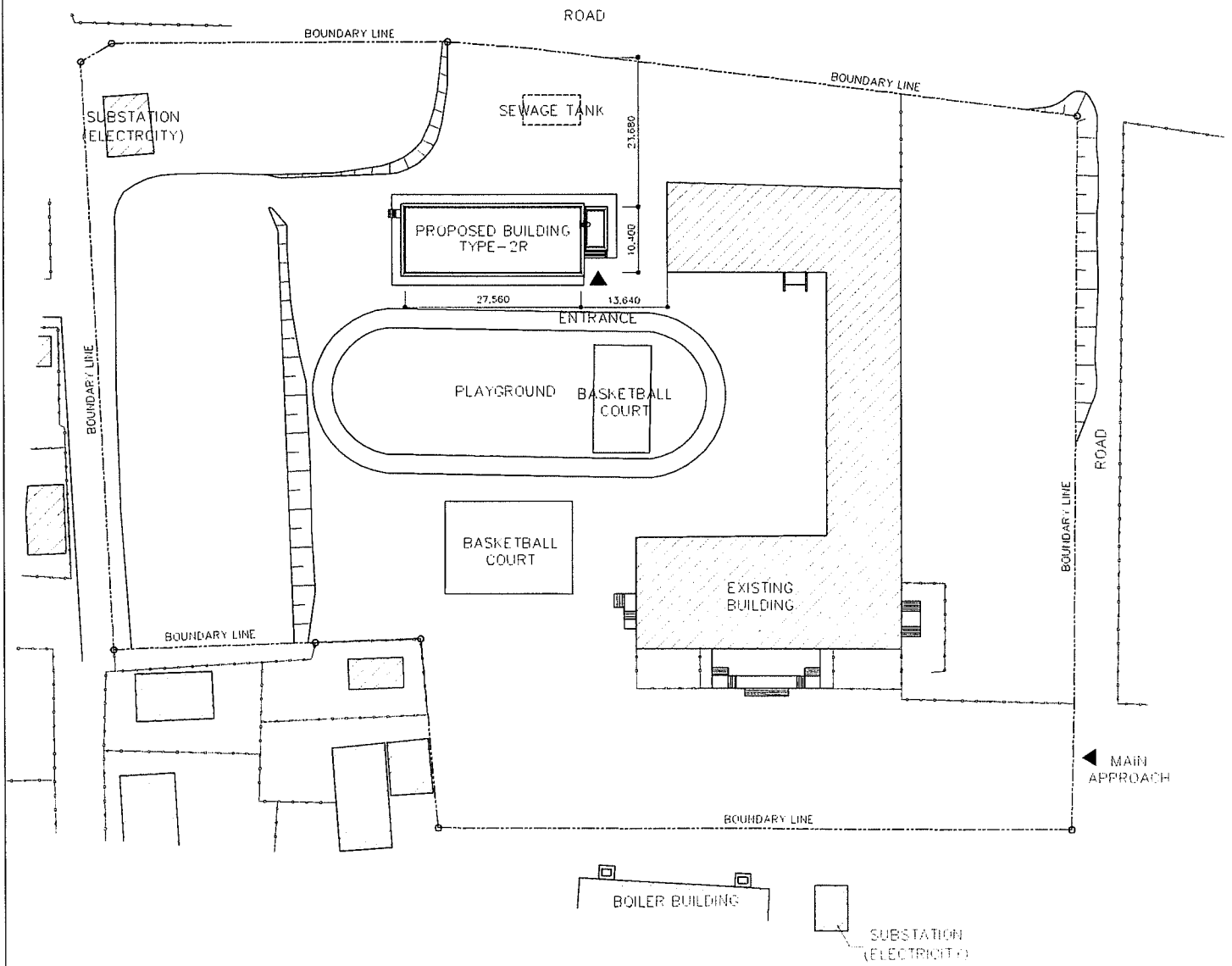
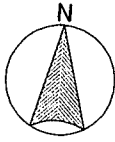

SCHOOL ID

NO.33

NAME OF SCHOOL

NO.33 SCHOOL

DISTRICT

Bayanzurkh

SCALE

1:1000

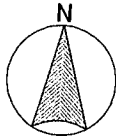

SUB STATION
(ELECTRICITY)

MAIN
APPROACH

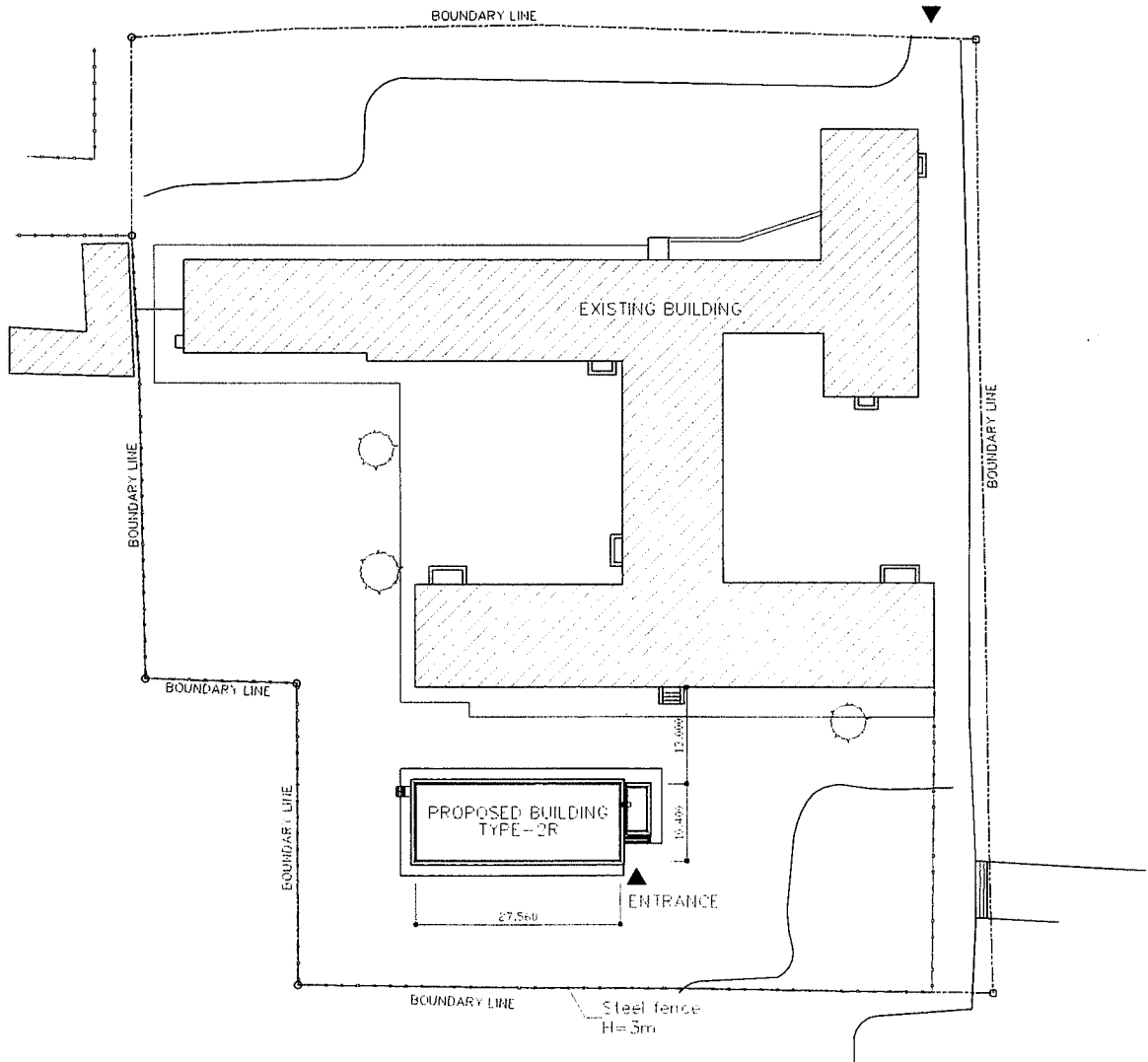

SCHOOL ID NO.39	NAME OF SCHOOL NO.39 SCHOOL	DISTRICT Chingeltei	SCALE 1:1000
--------------------	--------------------------------	------------------------	-----------------

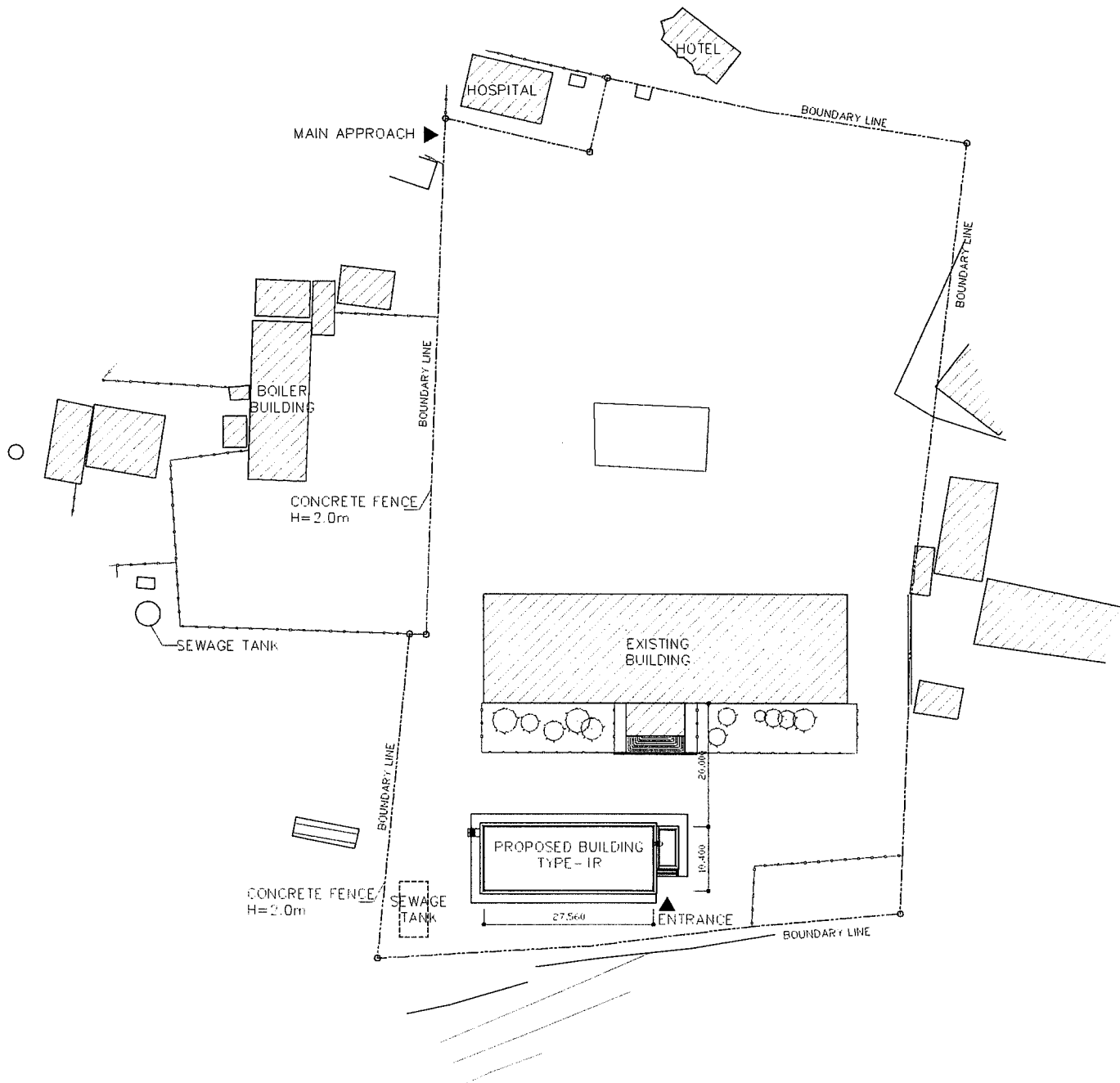
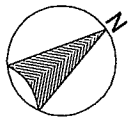

SCHOOL ID
NO.44

NAME OF SCHOOL
NO.44 SCHOOL

DISTRICT
Bayanzurkh

SCALE
1:1000

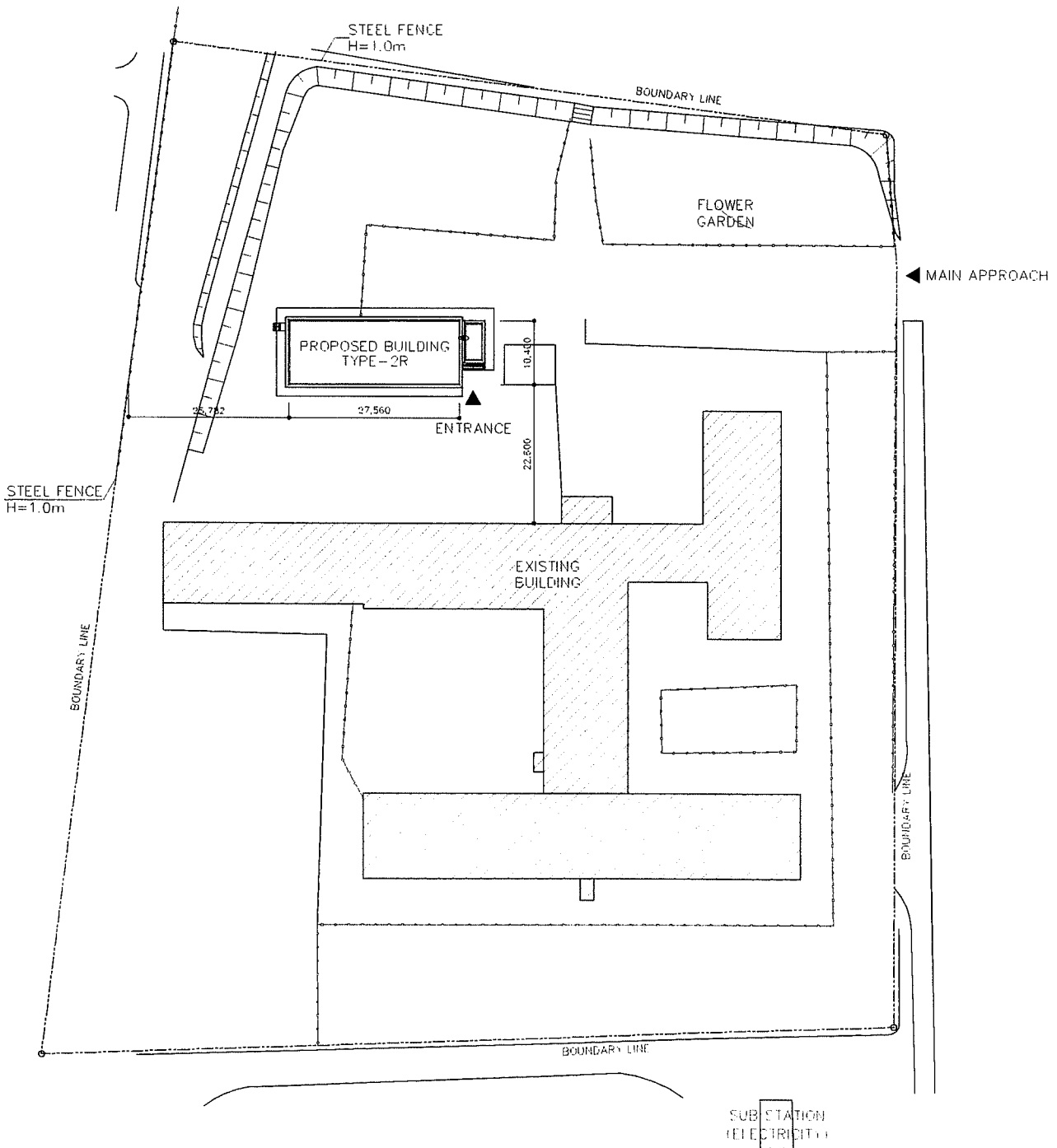
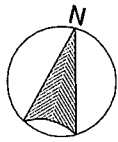

SCHOOL ID

NO.48

NAME OF SCHOOL

NO.48 SCHOOL

DISTRICT

Bayanzurkh

SCALE

1:1000

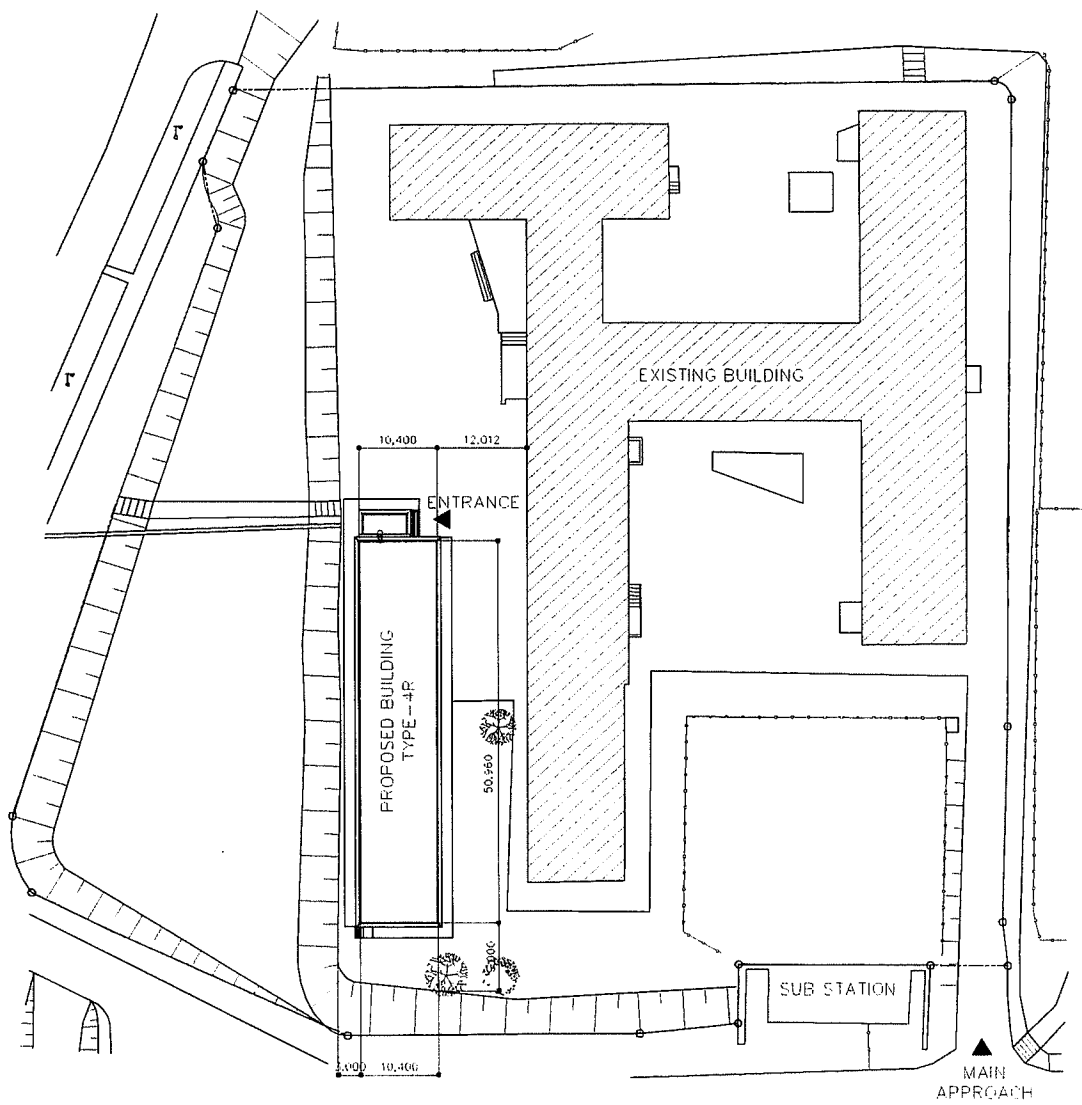
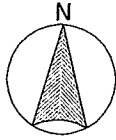

SCHOOL ID

NO.68

NAME OF SCHOOL

NO.68 SCHOOL

DISTRICT

Bayanzurkh

SCALE

1:1000

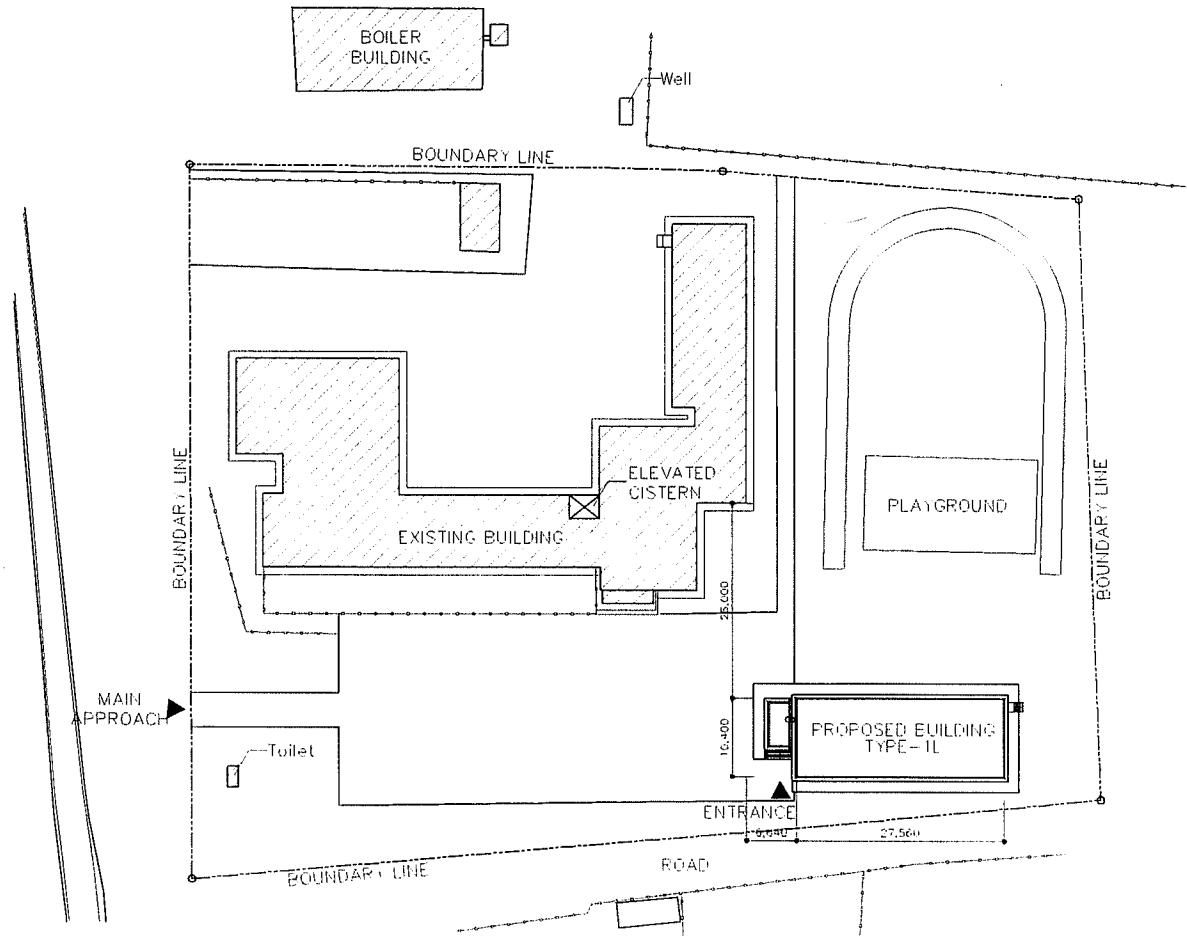
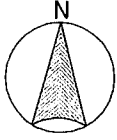

SCHOOL ID NO.87	NAME OF SCHOOL NO.87 SCHOOL	DISTRICT Bayanzurkh	SCALE 1:1500
--------------------	--------------------------------	------------------------	-----------------

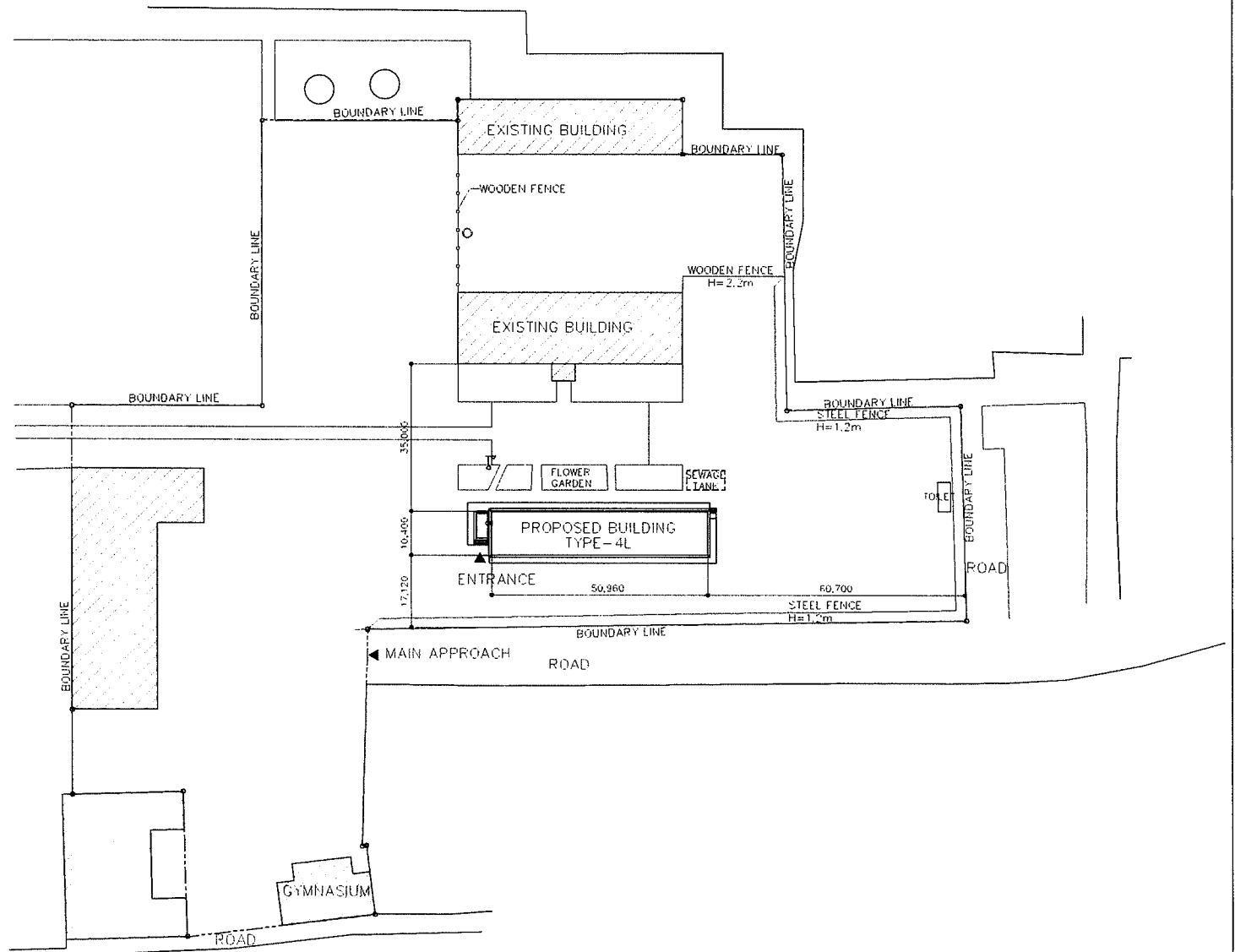
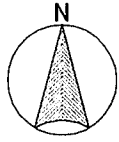

SCHOOL ID

NO.97

NAME OF SCHOOL

NO.97 SCHOOL

DISTRICT

Bayanzurkh

SCALE

1:1000

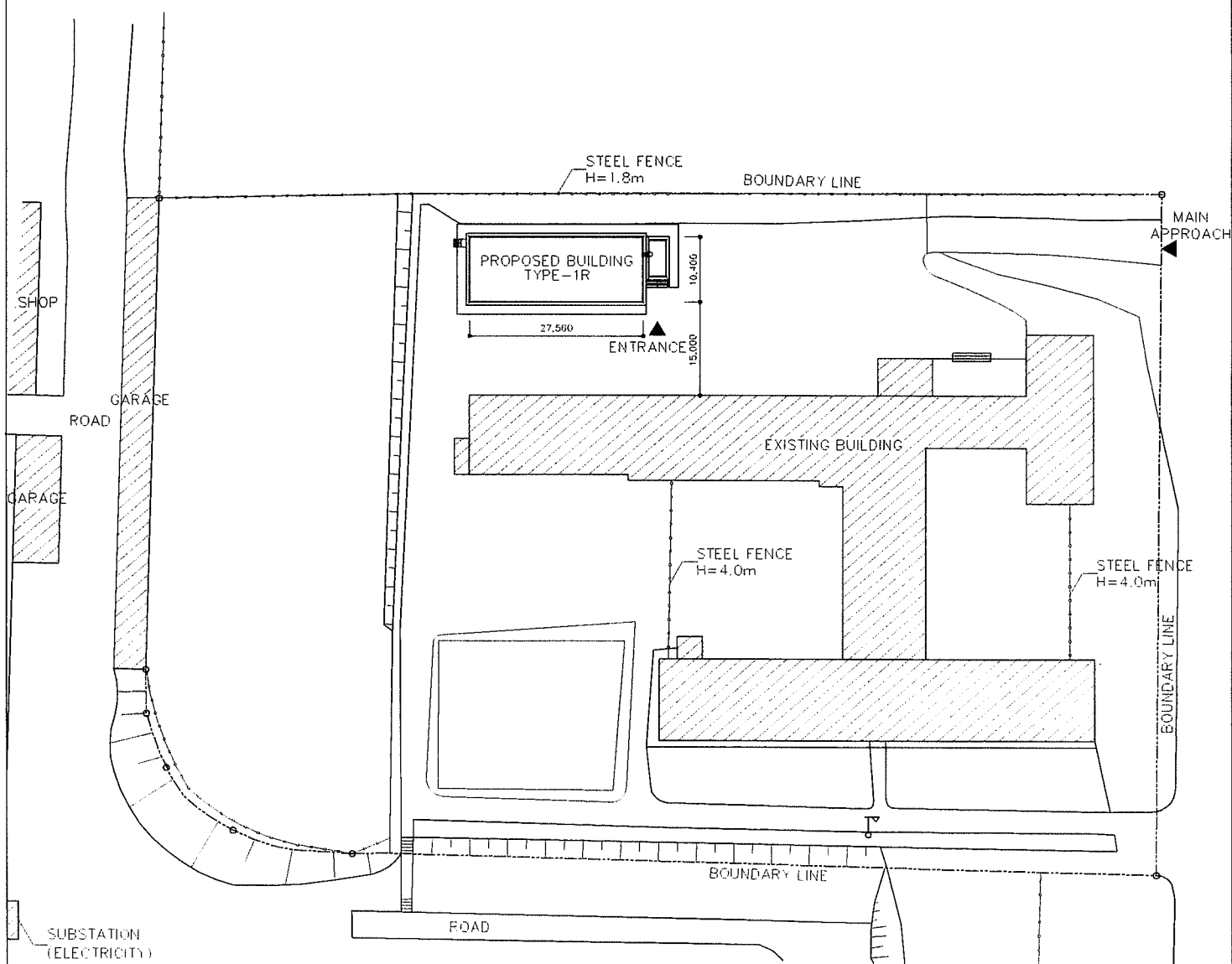
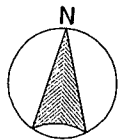

SCHOOL ID

IR

NAME OF SCHOOL

IREDUJ COMPLEX SCHOOL

DISTRICT

Songinokhairkhan

SCALE

1:1000

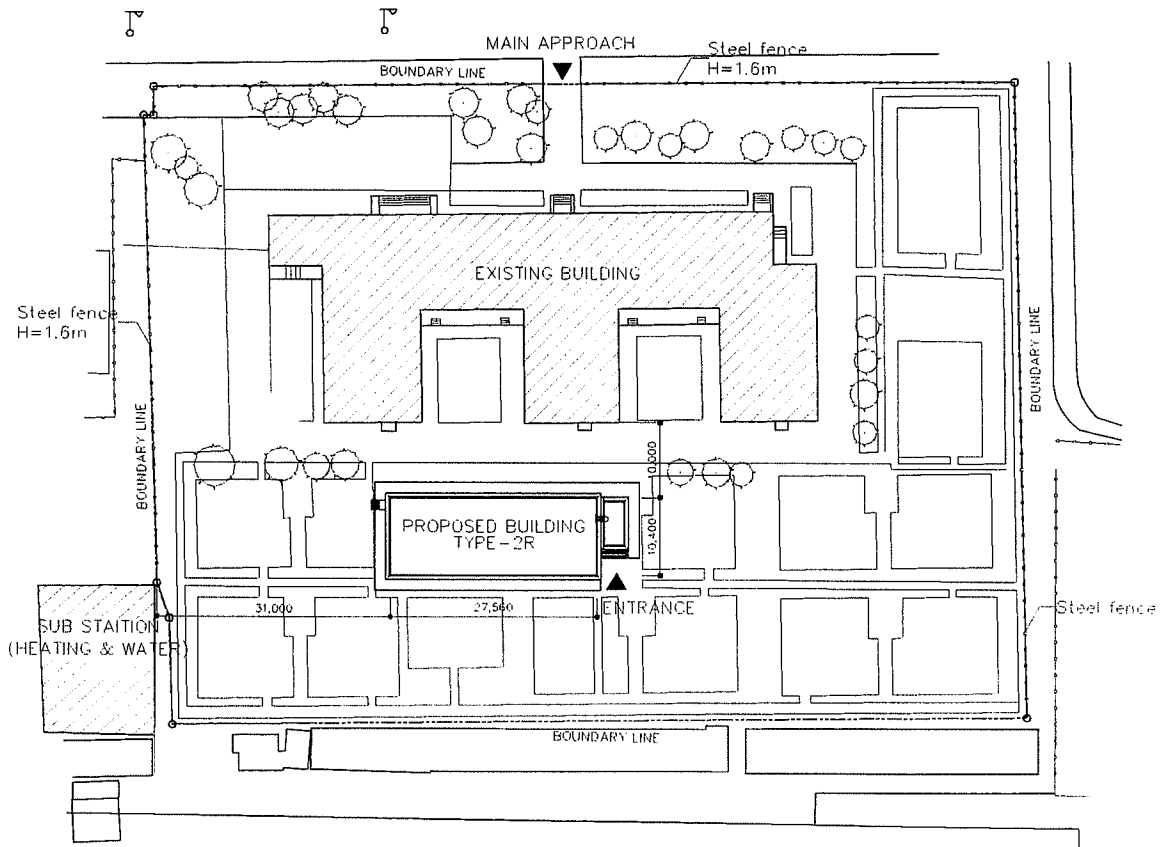
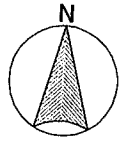

SCHOOL ID

GO

NAME OF SCHOOL

GOROMT COMPLEX SCHOOL

DISTRICT

Nalaikha

SCALE

1:1000

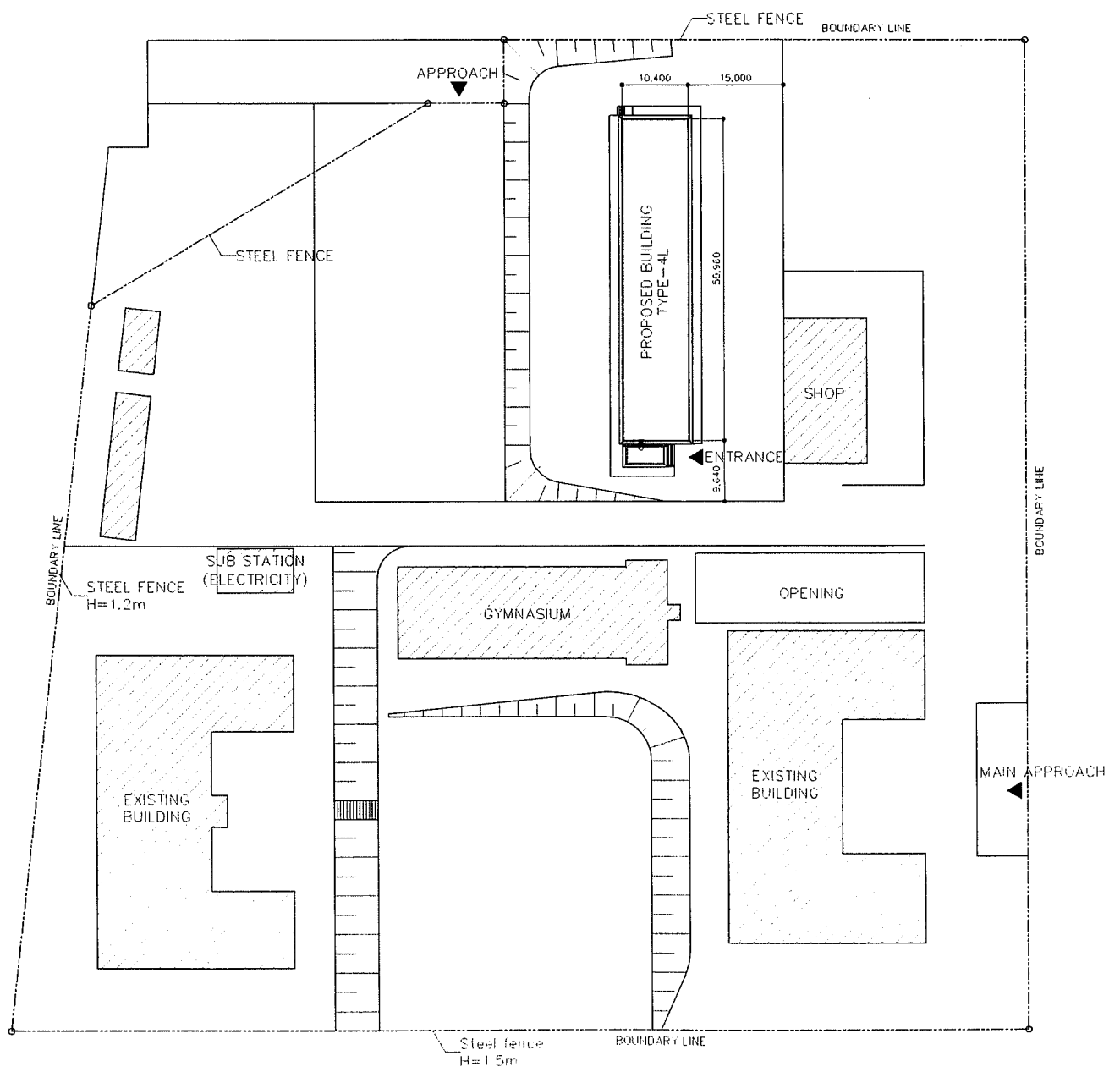
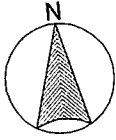

SCHOOL ID

B0

NAME OF SCHOOL

BOROVSROL SCHOOL

DISTRICT

Baganor

SCALE

1:1500

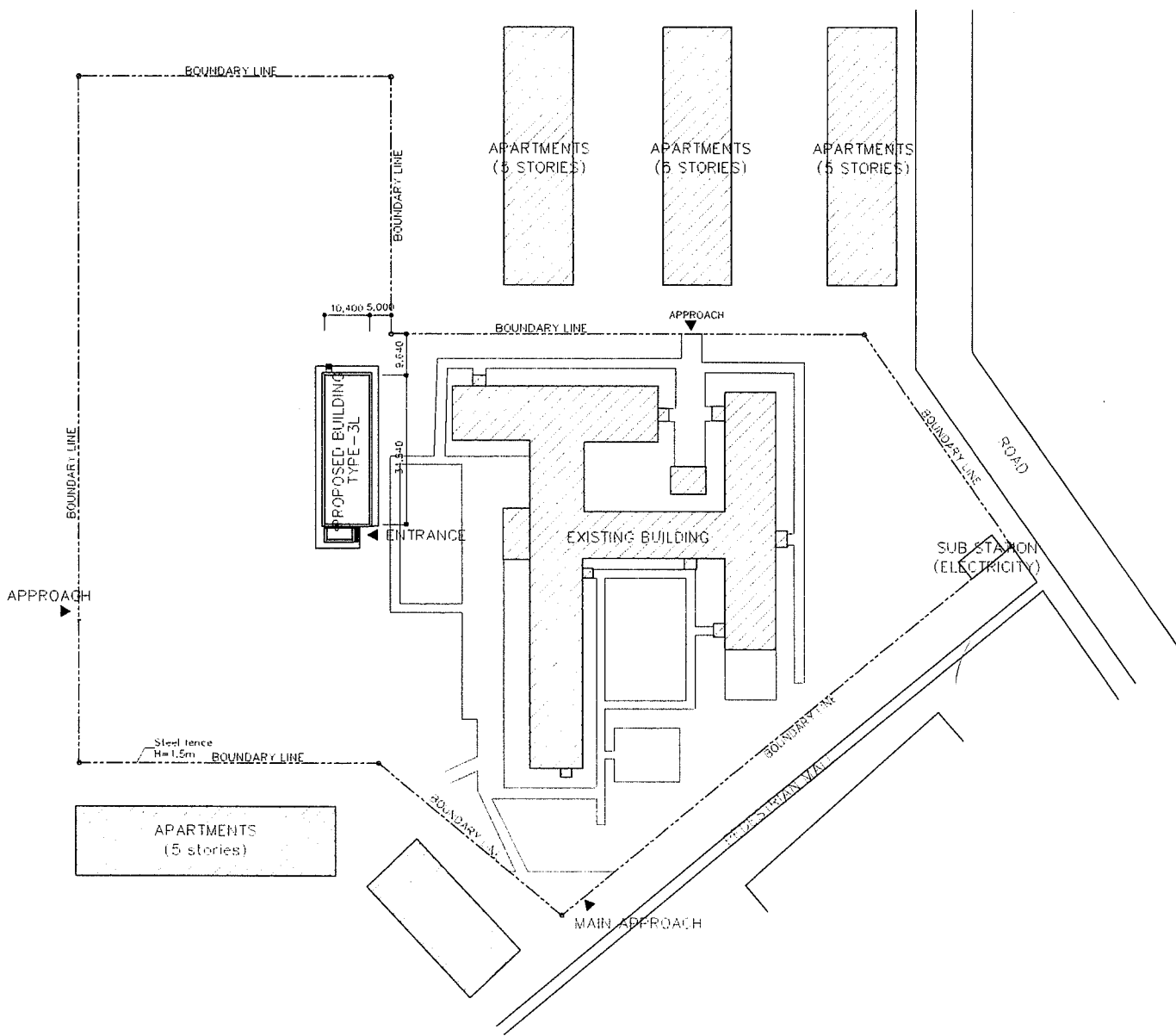
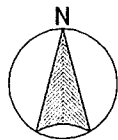

SCHOOL ID

NO.61

NAME OF SCHOOL

NO.61 SCHOOL

DISTRICT

Chingeltei

SCALE

1:1000

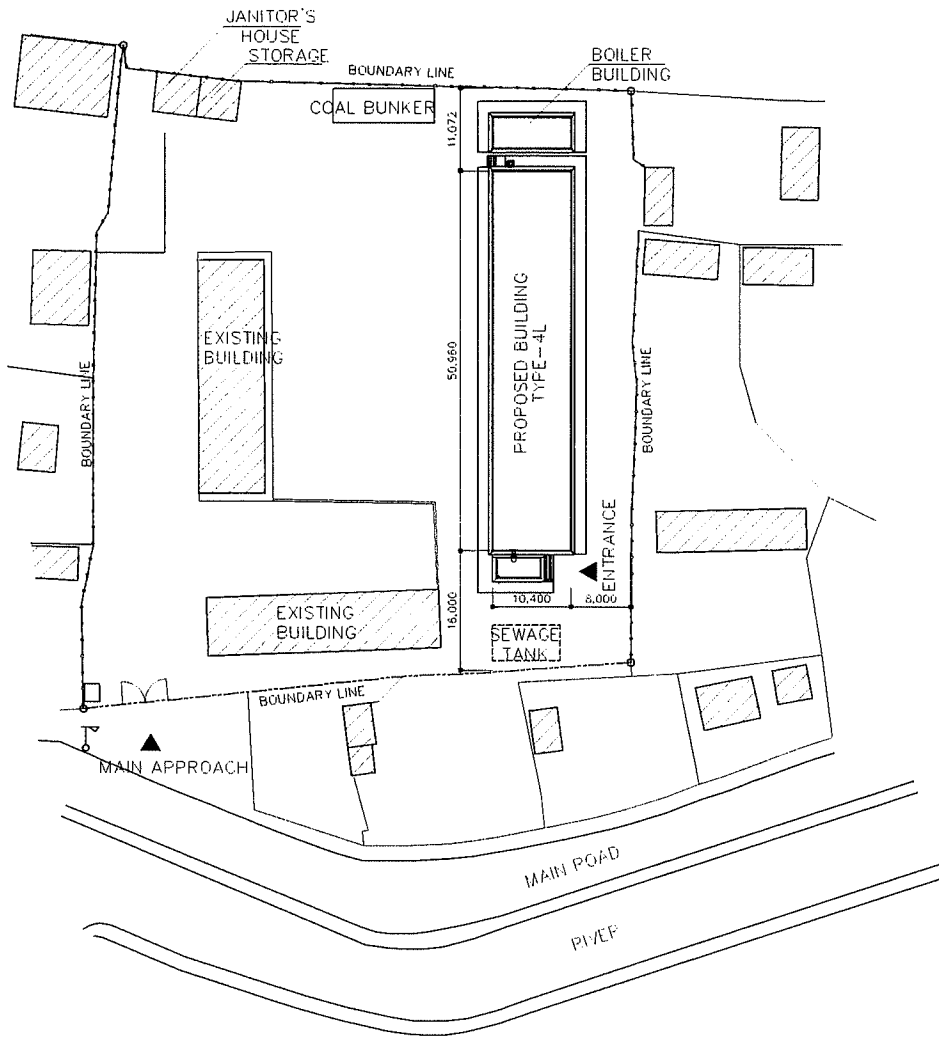
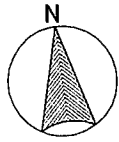

SCHOOL ID

NO.112

NAME OF SCHOOL

NO.112 SCHOOL

DISTRICT

Songinokhairkhan

SCALE

1:1000

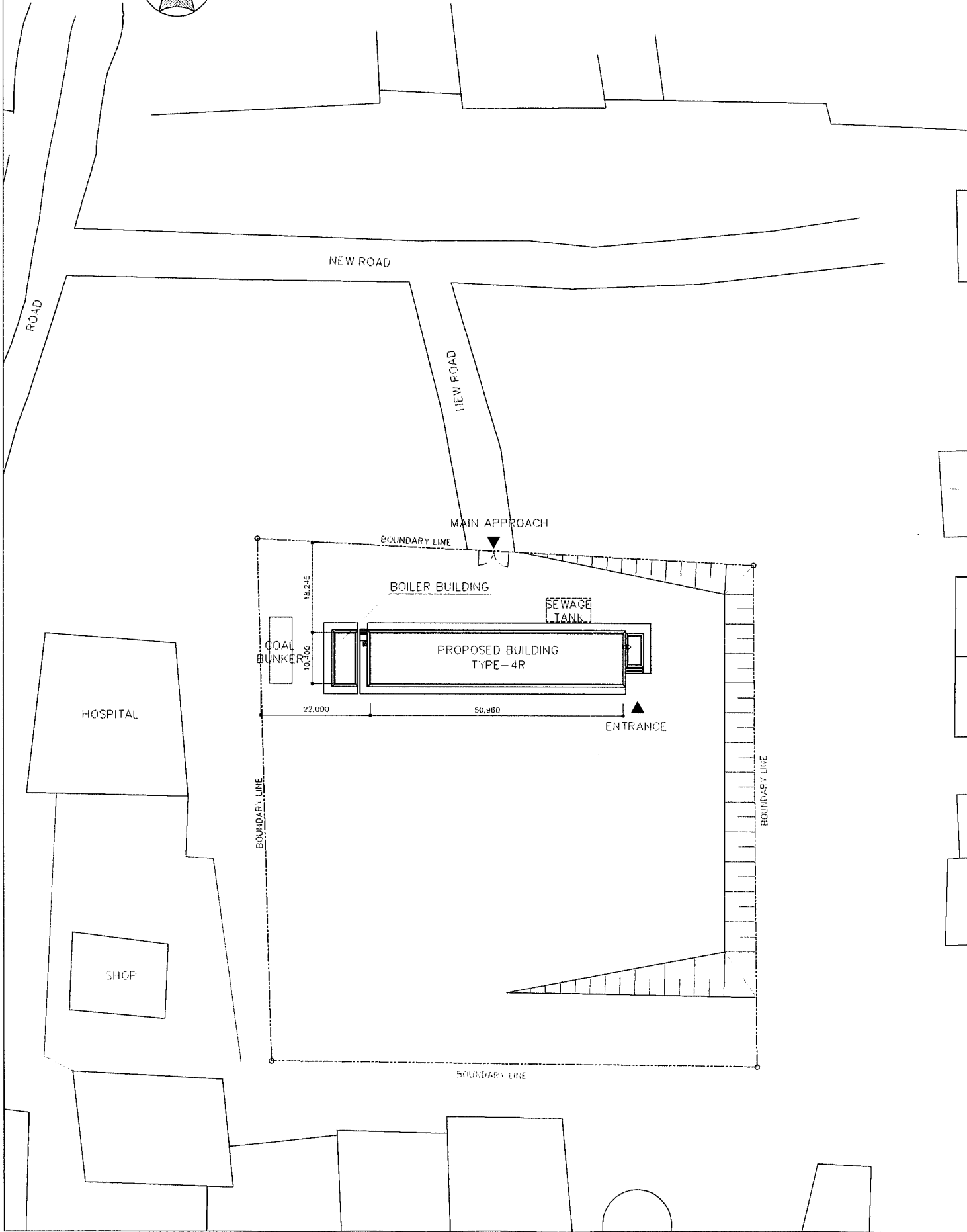
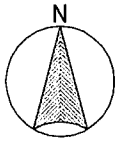

SCHOOL ID

NO.114

NAME OF SCHOOL

NO.114 SCHOOL

DISTRICT

Khan-uul

SCALE

1:1000

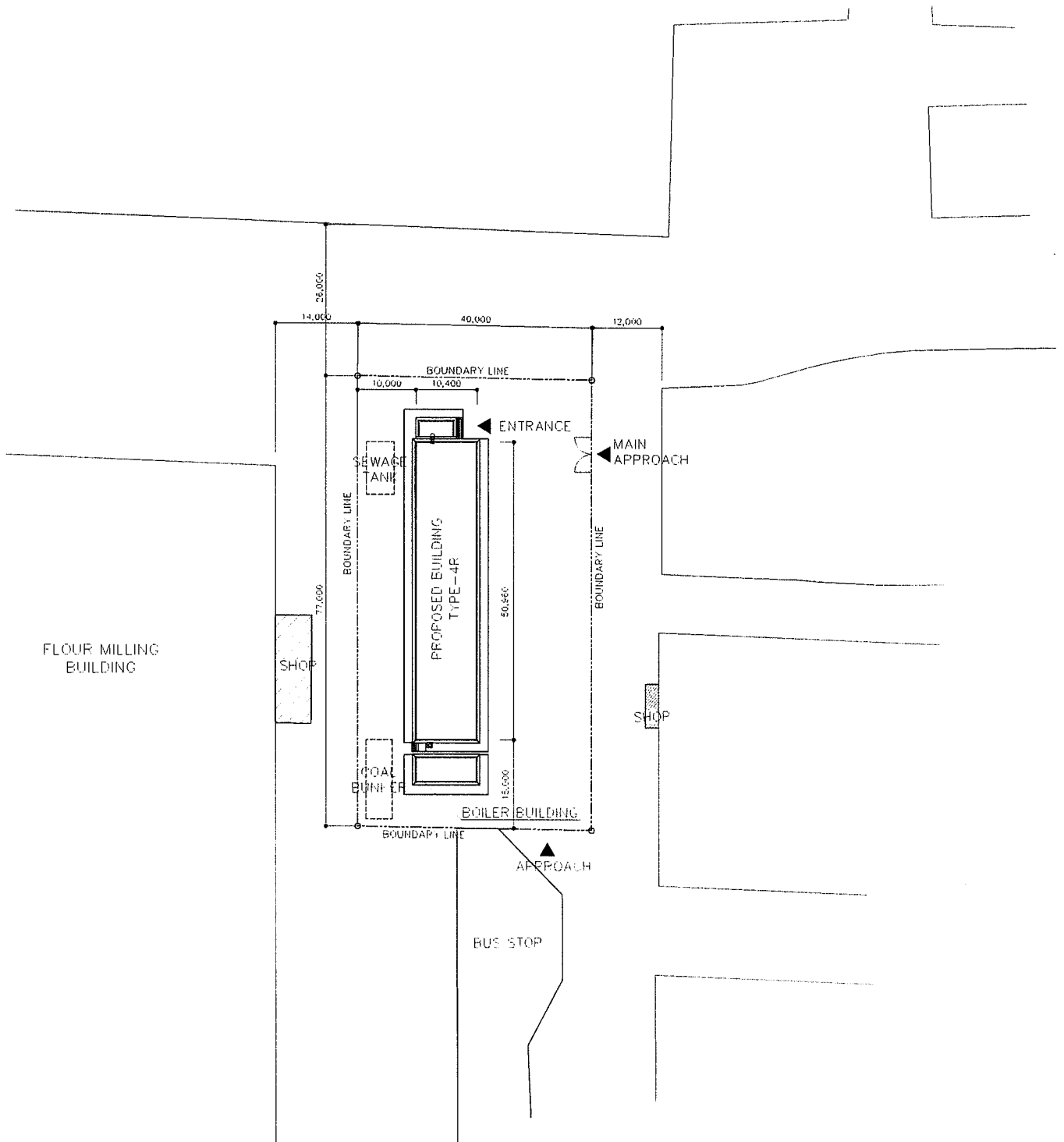
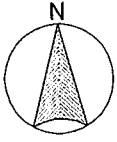

SCHOOL ID

NO.115

NAME OF SCHOOL

NO.115 SCHOOL

DISTRICT

Songinokhairkhan

SCALE

1:1000

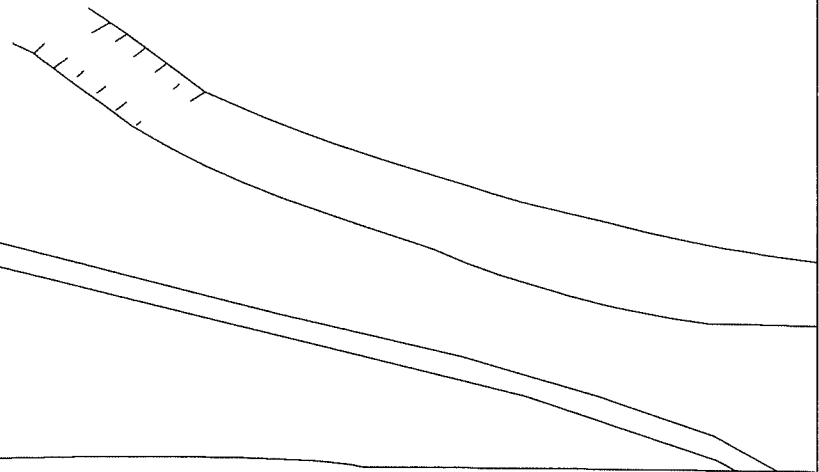
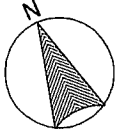

NEW ROAD

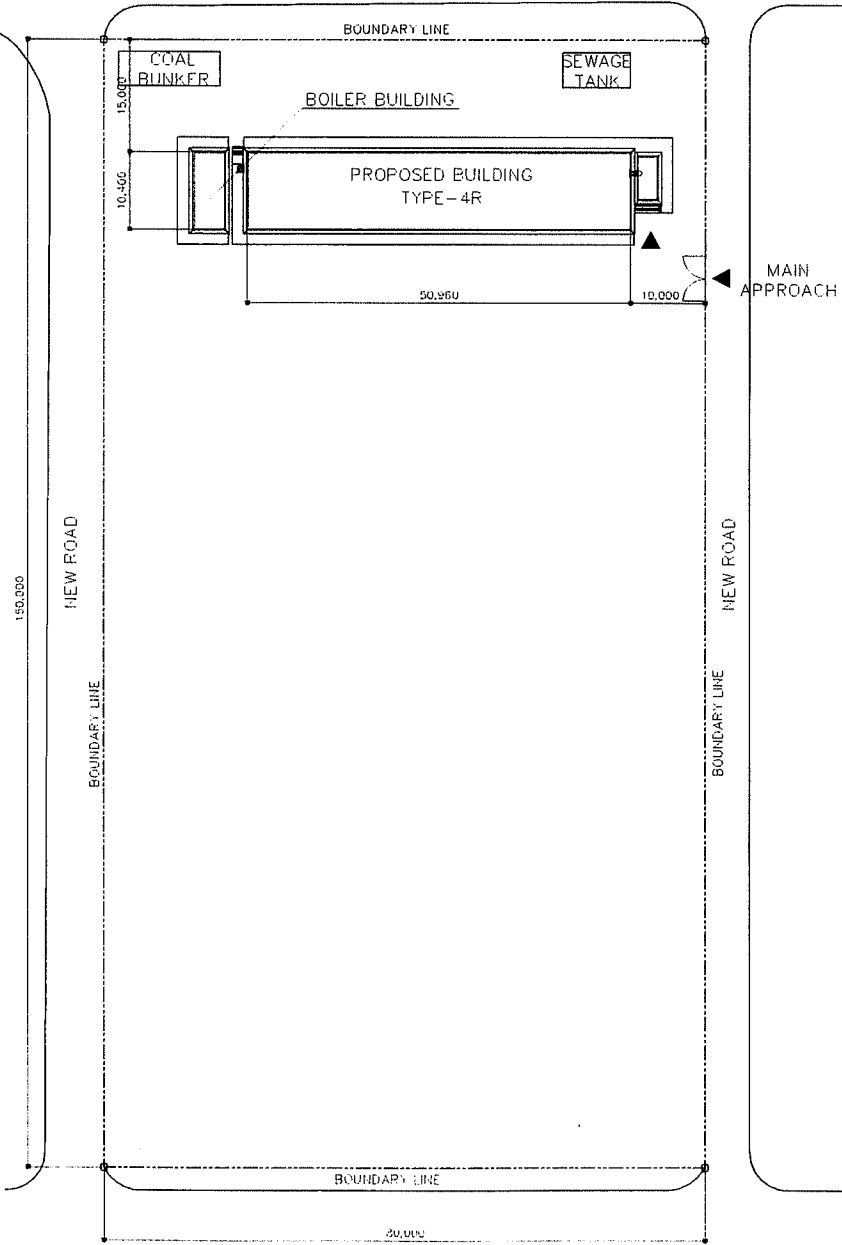

SCHOOL ID

NO.116

NAME OF SCHOOL

NO.116 SCHOOL

DISTRICT

Sukhbaatar

SCALE

1:1000

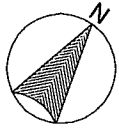

ROAD

MAIN APPROACH

BOUNDARY LINE

SEWAGE TANK

BOILER BUILDING

COAL BUNKER

PROPOSED BUILDING TYPE-4R

ENTRANCE

BOUNDARY LINE

25,000

50,960

10,000

10,400

BOUNDARY LINE

56,000

BOUNDARY LINE

100,000

RAISE THE GROUND LEVEL BY MONGOLIAN SIDE