

2-2-3 Basic Design Drawing

(1) Breakdown list of the planned equipment

The details of the equipment to be procured in this project are as follows in Table 2-10.

As a result of the study, the quantity of equipment to be procured is outlined in the following table.

| Facility | Quantity of the Requested Equipment | | Priority in the Minutes of Basic Design | | | Final Quantity (after analysis in Japan) | |
|------------------------|-------------------------------------|------------|---|----------|----------|--|------------|
| | | | A | B | C | | |
| Canzibe Hospital | 246 items | 547 nos. | 165 items | 8 items | 72 items | 172 items | 277 nos. |
| St. Barnabas Hospital | 246 items | 547 nos. | 144 items | 10 items | 91 items | 150 items | 259 nos. |
| Nessie Knight Hospital | 246 items | 547 nos. | 177 items | 11 items | 57 items | 183 items | 294 nos. |
| St. Lucy's Hospital | 246 items | 547 nos. | 178 items | 8 items | 58 items | 183 items | 293 nos. |
| Zithulele Hospital | 246 items | 547 nos. | 163 items | 10 items | 72 items | 169 items | 273 nos. |
| Hospitals Total | 246 items | 2,735 nos. | 178 items | 11 items | 91 items | 188 items | 1,396 nos. |
| Health Centres | 21 items | 2,053 nos. | 32 items | 1 items | 8 items | 30 items | 564 nos. |
| Clinics | | | 28 items | 2 items | 8 items | 29 items | 2,887 nos. |
| Mobile Clinics | 1 item | 6 nos. | 1 item | - | - | 1 item | 6 nos. |

Table 2—10 Equipment Procurement Plan

District Hospitals

| Item No. | Name of Equipment | Nyandeni District | | Mhlontlo District | | KSD District | Total Qty's |
|----------|--|---------------------|-------------------------|---------------------------|-----------------------|-----------------------|-------------|
| | | 1. Canzibe Hospital | 2. St.Barnabas Hospital | 3. Nessie Knight Hospital | 4. St.Lucy's Hospital | 5. Zithulele Hospital | |
| | | Qty's | Qty's | Qty's | Qty's | Qty's | |
| 1— | [HI-CARE AND RESUSCITATION WARD] | | | | | | |
| 2 | Bedside monitors | 2 | 0 | 2 | 2 | 2 | 8 |
| 3 | Clinical clock wall mounted | 1 | 0 | 1 | 1 | 1 | 4 |
| 5 | Dressing trolley - large | 1 | 1 | 1 | 1 | 1 | 5 |
| 6 | Drip stand - mobile | 4 | 0 | 4 | 4 | 4 | 16 |
| 7 | ECG Machine | 1 | 1 | 1 | 1 | 1 | 5 |
| 8-1 | Emergency trolley | 1 | 1 | 1 | 1 | 1 | 5 |
| 8-2 | Defibrillator | 1 | 1 | 1 | 1 | 1 | 5 |
| 10 | Examination light | 2 | 2 | 2 | 2 | 2 | 10 |
| 11 | Hi-Lo Beds w/Mattress | 4 | 0 | 4 | 4 | 4 | 16 |
| 12 | Infusion pump | 2 | 2 | 2 | 2 | 2 | 10 |
| 13 | Infusion pump - syringe type | 2 | 2 | 2 | 2 | 2 | 10 |
| 14 | Instrument trolley - large | 1 | 1 | 1 | 1 | 1 | 5 |
| 17 | Sphygmomanometer | 2 | 2 | 2 | 2 | 2 | 10 |
| 18 | Suction unit - electric- midium | 2 | 0 | 2 | 2 | 2 | 8 |
| 21 | White board | 1 | 0 | 1 | 1 | 1 | 4 |
| 22 | X-ray viewing box - 4films | 1 | 1 | 1 | 1 | 1 | 5 |
| | | | | | | | |
| 2— | [MEDICAL & SURGICAL WARDS] | | | | | | |
| 2 | Examination light | 2 | 2 | 2 | 2 | 2 | 10 |
| 3 | Basin stand w/Basin - Double mobile | 2 | 2 | 2 | 2 | 2 | 10 |
| 4 | Bedpan - stainless steel | 4 | 4 | 4 | 4 | 4 | 20 |
| 5 | Beds w/adj back rest & mattress - mobile | 14 | 14 | 14 | 14 | 14 | 70 |
| 7 | Bowls stainless steel-set | 2 | 4 | 2 | 2 | 2 | 12 |
| 9 | Sphygmomanometer | 2 | 4 | 2 | 2 | 2 | 12 |
| 10 | Step on sanitary can | 2 | 2 | 2 | 2 | 2 | 10 |
| 11 | Diagnostic set | 2 | 2 | 2 | 2 | 2 | 10 |
| 12 | Drip stand - mobile | 4 | 4 | 4 | 4 | 4 | 20 |
| 13 | ECG Machine | 2 | 2 | 2 | 2 | 2 | 10 |
| 17 | Glucometer | 2 | 2 | 2 | 2 | 2 | 10 |
| 18 | Hemoglobinmeter | 2 | 2 | 2 | 2 | 2 | 10 |
| 19 | Infusion pump | 2 | 2 | 2 | 2 | 2 | 10 |
| 20 | Infusion pump - syringe type | 2 | 2 | 2 | 2 | 2 | 10 |
| 21 | Instrument trolley - large | 2 | 2 | 2 | 2 | 2 | 10 |
| 22 | Instrument trolley - small | 2 | 2 | 2 | 2 | 2 | 10 |
| 23 | Kidney dishes set | 2 | 4 | 2 | 2 | 2 | 12 |
| 25 | Measuring jug S/S | 2 | 2 | 2 | 2 | 2 | 10 |
| 26 | Nebulizer | 2 | 2 | 2 | 2 | 2 | 10 |
| 28 | Oxygen flow meter set | 2 | 2 | 2 | 2 | 2 | 10 |
| 35 | Patient trolley w/Mattress | 2 | 2 | 2 | 2 | 2 | 10 |
| 36 | Pulse oximeter | 2 | 2 | 2 | 2 | 2 | 10 |
| 37 | Refridgerator | 2 | 2 | 2 | 2 | 2 | 10 |
| 38 | Emergency trolley | 1 | 1 | 1 | 1 | 1 | 5 |
| 40 | Suction unit - electric- midium | 2 | 2 | 2 | 2 | 2 | 10 |
| 41 | Urinals - stainless steel | 2 | 2 | 2 | 2 | 2 | 10 |
| 43 | Vital signs monitor | 1 | 1 | 1 | 1 | 1 | 5 |
| 44 | Clinical clock wall mounted | 2 | 2 | 2 | 2 | 2 | 10 |
| 46-1 | Weighing scale | 2 | 2 | 2 | 2 | 2 | 10 |
| 46-2 | Height scale | 2 | 2 | 2 | 2 | 2 | 10 |
| 47 | Wheel chairs - heavy duty | 2 | 2 | 2 | 2 | 2 | 10 |
| 48 | Peak flow meter | 2 | 2 | 2 | 2 | 2 | 10 |
| 49 | X-ray viewing box - 1 film | 2 | 2 | 2 | 2 | 2 | 10 |
| | | | | | | | |
| 3— | [MATERNITY WARD] | | | | | | |
| 2 | Baby weight | 1 | 1 | 1 | 1 | 1 | 5 |

Table 2—10 Equipment Procurement Plan

District Hospitals

| Item No. | Name of Equipment | Nyandeni District | | Mhlontlo District | | KSD District | Total Qty's |
|----------|---------------------------------------|---------------------|-------------------------|---------------------------|-----------------------|-----------------------|-------------|
| | | 1. Canzibe Hospital | 2. St.Barnabas Hospital | 3. Nessie Knight Hospital | 4. St.Lucy's Hospital | 5. Zithulele Hospital | |
| | | Qty's | Qty's | Qty's | Qty's | Qty's | |
| 3 | Bassinets | 4 | 4 | 4 | 4 | 4 | 20 |
| 5 | Clinical clock wall mounted | 1 | 1 | 1 | 1 | 1 | 5 |
| 7 | Delivery bed and mattress | 2 | 2 | 2 | 2 | 2 | 10 |
| 8 | Dressing trolley - large | 2 | 2 | 2 | 2 | 2 | 10 |
| 9 | Examination table for gynecology | 1 | 1 | 1 | 1 | 1 | 5 |
| 10 | Fetal doppler | 1 | 1 | 1 | 1 | 1 | 5 |
| 11 | ICU Resuscitation unit - radiant type | 2 | 2 | 2 | 2 | 2 | 10 |
| 12 | Infant incubator | 2 | 2 | 2 | 2 | 2 | 10 |
| 13 | Infant warmer | 2 | 2 | 2 | 2 | 2 | 10 |
| 14 | Oxygen monitor | 1 | 1 | 1 | 1 | 1 | 5 |
| 15 | Footstool - double | 2 | 2 | 2 | 2 | 2 | 10 |
| 16 | Phototherapy unit | 1 | 2 | 1 | 1 | 1 | 6 |
| 17 | Delivery set | 2 | 2 | 2 | 2 | 2 | 10 |
| 18 | Suction unit - electric- large | 1 | 1 | 1 | 1 | 1 | 5 |
| 20 | Vacuum extractor | 1 | 1 | 1 | 1 | 1 | 5 |
| 21 | Ablution basin | 1 | 1 | 1 | 1 | 1 | 5 |
| 4— | 【PAEDIATRIC WARD】 | | | | | | |
| 1 | Pediatric scales | 1 | 1 | 1 | 1 | 1 | 5 |
| 2 | Basin stand w/Basin - Double mobile | 2 | 2 | 2 | 2 | 2 | 10 |
| 3 | Bedpan - stainless steel | 4 | 4 | 4 | 4 | 4 | 20 |
| 5 | Bilirubin meter | 1 | 1 | 1 | 1 | 1 | 5 |
| 6 | Bowls stainless steel-set | 1 | 1 | 1 | 1 | 1 | 5 |
| 7 | Sphygmomanometer for pediatric | 2 | 2 | 2 | 2 | 2 | 10 |
| 8 | Step on sanitary can | 1 | 1 | 1 | 1 | 1 | 5 |
| 9 | Pediatric bed | 4 | 4 | 4 | 4 | 4 | 20 |
| 10 | Diagnostic set | 1 | 1 | 1 | 1 | 1 | 5 |
| 11 | Dressing trolley - large | 1 | 1 | 1 | 1 | 1 | 5 |
| 12 | Drip stand - mobile | 3 | 3 | 3 | 3 | 3 | 15 |
| 13 | Examination light | 1 | 1 | 1 | 1 | 1 | 5 |
| 15 | Infant transport incubator | 1 | 1 | 1 | 1 | 1 | 5 |
| 16 | ICU Resuscitation unit - radiant type | 0 | 1 | 0 | 0 | 0 | 1 |
| 17 | Infusion pump | 2 | 2 | 2 | 2 | 2 | 10 |
| 18 | Infusion pump - syringe type | 2 | 2 | 2 | 2 | 2 | 10 |
| 19 | Instrument trolley - large | 1 | 1 | 1 | 1 | 1 | 5 |
| 22 | Kidney dishes set | 2 | 2 | 2 | 2 | 2 | 10 |
| 23 | Laryngoscope set for pediatric | 1 | 1 | 1 | 1 | 1 | 5 |
| 24 | Measuring jug s/s | 2 | 2 | 2 | 2 | 2 | 10 |
| 25 | Pediatric monitor | 1 | 1 | 1 | 1 | 1 | 5 |
| 26 | Oxygen flow meter set | 1 | 1 | 1 | 1 | 1 | 5 |
| 28-1 | Oxygen tent | 1 | 1 | 1 | 1 | 1 | 5 |
| 28-2 | Oxygen monitor | 1 | 1 | 1 | 1 | 1 | 5 |
| 30 | Pulse oximeter | 1 | 1 | 1 | 1 | 1 | 5 |
| 31 | Refridgerator for immunisation | 1 | 1 | 1 | 1 | 1 | 5 |
| 32 | Resuscitator set for pediatric | 1 | 1 | 1 | 1 | 1 | 5 |
| 33-1 | Weighing scale | 1 | 1 | 1 | 1 | 1 | 5 |
| 33-2 | Height scale | 1 | 1 | 1 | 1 | 1 | 5 |
| 36 | Suction unit - electric- midium | 1 | 1 | 1 | 1 | 1 | 5 |
| 37 | Nebulizer | 2 | 2 | 2 | 2 | 2 | 10 |
| 40 | X-ray viewing box - 1film | 1 | 1 | 1 | 1 | 1 | 5 |
| 5— | 【OPERATING THEATRE】 | | | | | | |
| 2 | Anaesthetic trolley - large | 1 | 2 | 1 | 1 | 1 | 6 |
| 3 | Basin stand w/Basin - Double mobile | 1 | 2 | 1 | 1 | 1 | 6 |
| 4 | White board | 2 | 4 | 2 | 2 | 2 | 12 |

Table 2—10 Equipment Procurement Plan

District Hospitals

| Item No. | Name of Equipment | Nyandeni District | | Mhlontlo District | | KSD District | Total Qty's |
|----------|---|---------------------|-------------------------|---------------------------|-----------------------|-----------------------|-------------|
| | | 1. Canzibe Hospital | 2. St.Barnabas Hospital | 3. Nessie Knight Hospital | 4. St.Lucy's Hospital | 5. Zithulele Hospital | |
| | | Qty's | Qty's | Qty's | Qty's | Qty's | |
| 5 | Bone saw set | 1 | 1 | 1 | 1 | 1 | 5 |
| 6 | Defibrillator | 0 | 1 | 1 | 1 | 0 | 3 |
| 8 | Operating chair | 2 | 4 | 2 | 2 | 2 | 12 |
| 9 | Drip stand - mobile | 2 | 4 | 2 | 2 | 2 | 12 |
| 10 | Drug cabinet | 1 | 2 | 1 | 1 | 1 | 6 |
| 11 | Electrosurgical unit | 1 | 2 | 1 | 1 | 1 | 6 |
| 13 | Footstool - single | 1 | 2 | 1 | 1 | 1 | 6 |
| 14 | Instrument cabinet | 2 | 2 | 2 | 2 | 2 | 10 |
| 15-1 | Instrument set for general surgery | 2 | 2 | 2 | 2 | 2 | 10 |
| 15-2 | Instrument set for caesarean | 2 | 2 | 2 | 2 | 2 | 10 |
| 16 | Instrument trolley - large | 1 | 0 | 2 | 2 | 1 | 6 |
| 17 | Instrument trolley - small | 1 | 0 | 2 | 2 | 1 | 6 |
| 18 | Kick bucket | 2 | 2 | 2 | 2 | 1 | 9 |
| 20 | Mayo table with s/s tray | 1 | 2 | 1 | 1 | 1 | 6 |
| 21 | Operating light - ceiling type | 1 | 0 | 1 | 1 | 0 | 3 |
| 22 | Operating light - mobile | 1 | 2 | 1 | 1 | 1 | 6 |
| 23 | Operating theatre table and accessories | 0 | 2 | 1 | 0 | 0 | 3 |
| 25 | Patient trolley w/Mattress | 1 | 1 | 1 | 1 | 1 | 5 |
| 29-1 | Suction unit - electric - large | 1 | 2 | 1 | 1 | 1 | 6 |
| 29-2 | Suction unit - electric- small | 1 | 2 | 1 | 1 | 0 | 5 |
| 30 | Swab rack | 0 | 0 | 1 | 0 | 0 | 1 |
| 31 | Clinical clock wall mounted | 1 | 0 | 1 | 1 | 0 | 3 |
| 32 | X-ray viewing box - 3films | 1 | 2 | 1 | 1 | 1 | 6 |
| 6— | 【CSSD】 | | | | | | |
| 1-1 | Autoclave high pressure | 1 | 0 | 1 | 1 | 1 | 4 |
| 1-2 | Autoclave high pressure - vertical type | 0 | 0 | 1 | 0 | 0 | 1 |
| 2 | Drums - sterilizing set | 1 | 1 | 1 | 1 | 1 | 5 |
| 3 | Boiling sterilizer, foot pedal type | 1 | 0 | 2 | 1 | 1 | 5 |
| 7— | 【CASUALTY】 | | | | | | |
| 1 | Ambulance w/first aid equipment | 1 | 1 | 1 | 1 | 1 | 5 |
| 2 | Boiling sterilizer | 1 | 1 | 1 | 1 | 1 | 5 |
| 3 | Baby weight | 1 | 1 | 1 | 1 | 1 | 5 |
| 5 | Basin stand w/Basin - double mobile | 2 | 0 | 2 | 2 | 2 | 8 |
| 6 | Step on sanitary can | 1 | 0 | 1 | 1 | 1 | 4 |
| 7 | Clinical clock wall mounted | 1 | 1 | 1 | 1 | 1 | 5 |
| 8 | Diagnostic set | 2 | 0 | 2 | 2 | 2 | 8 |
| 10 | Drip stand - mobile | 2 | 0 | 2 | 2 | 2 | 8 |
| 11 | Drug cabinet | 1 | 0 | 1 | 1 | 1 | 4 |
| 12 | ECG Machine | 0 | 1 | 1 | 1 | 0 | 3 |
| 13-1 | Emergency trolley | 1 | 1 | 1 | 1 | 1 | 5 |
| 13-2 | Defibrillator | 1 | 1 | 1 | 1 | 1 | 5 |
| 14 | Examination light | 2 | 0 | 2 | 2 | 2 | 8 |
| 16 | Instrument cabinet | 1 | 1 | 1 | 1 | 1 | 5 |
| 17 | Instrument trolley - large | 2 | 0 | 2 | 2 | 0 | 6 |
| 19 | Nebulizer | 2 | 0 | 2 | 2 | 2 | 8 |
| 20-1 | Weighing scale | 1 | 1 | 1 | 1 | 1 | 5 |
| 20-2 | Height scale | 1 | 1 | 1 | 1 | 1 | 5 |
| 22 | Patient trolley w/Mattress | 1 | 0 | 1 | 1 | 1 | 4 |
| 23 | Pulse oximeter | 1 | 1 | 1 | 1 | 1 | 5 |
| 25 | Sphygmomanometer | 2 | 0 | 2 | 2 | 2 | 8 |
| 26 | Suction unit - electric- midium | 1 | 0 | 1 | 1 | 1 | 4 |
| 28 | Vital signs monitor | 1 | 1 | 1 | 1 | 1 | 5 |
| 29 | Wheel chairs - heavy duty | 2 | 2 | 2 | 2 | 2 | 10 |

Table 2—10 Equipment Procurement Plan

District Hospitals

| Item No. | Name of Equipment | Nyandeni District | | Mhlontlo District | | KSD District | Total Qty's |
|----------|--|---------------------|-------------------------|---------------------------|-----------------------|-----------------------|-------------|
| | | 1. Canzibe Hospital | 2. St.Barnabas Hospital | 3. Nessie Knight Hospital | 4. St.Lucy's Hospital | 5. Zithulele Hospital | |
| | | Qty's | Qty's | Qty's | Qty's | Qty's | |
| 30 | Examination Table | 2 | 0 | 2 | 2 | 2 | 8 |
| 8— | 【OUTPATIENTS DEPARTMENT】 | | | | | | |
| 1 | Sphygmomanometer | 2 | 0 | 2 | 2 | 2 | 8 |
| 2 | Pediatric height scale, bed type | 1 | 1 | 1 | 1 | 1 | 5 |
| 3 | Diagnostic set | 2 | 0 | 2 | 2 | 2 | 8 |
| 5 | Ear syringe | 1 | 1 | 1 | 1 | 1 | 5 |
| 6 | ECG Machine | 0 | 1 | 1 | 1 | 1 | 4 |
| 7 | Examination table | 0 | 0 | 2 | 2 | 0 | 4 |
| 9 | Instrument set - treatment | 2 | 2 | 2 | 2 | 2 | 10 |
| 11 | Footstool - double | 0 | 0 | 2 | 2 | 2 | 6 |
| 12-1 | Weighing scale | 1 | 1 | 1 | 1 | 1 | 5 |
| 12-2 | Height scale | 1 | 1 | 1 | 1 | 1 | 5 |
| 13 | Screen mobile 4 section with curtains | 0 | 0 | 2 | 2 | 0 | 4 |
| 14 | Snellen chart | 2 | 0 | 2 | 2 | 2 | 8 |
| 15 | Examination set for Gynecology | 2 | 0 | 2 | 2 | 2 | 8 |
| 16 | Sterilizer boiling type | 1 | 1 | 1 | 1 | 1 | 5 |
| 18 | X-ray viewing box - 1film | 1 | 0 | 1 | 1 | 1 | 4 |
| 19 | Ultrasound scanner | 0 | 1 | 1 | 1 | 1 | 4 |
| 9— | 【RADIOLOGY】 | | | | | | |
| 1 | Accessory for X-ray apparatus | 1 | 1 | 1 | 1 | 1 | 5 |
| 3 | X-ray apparatus | 1 | 1 | 1 | 1 | 1 | 5 |
| 4 | X-ray apparatus - mobile | 1 | 1 | 0 | 1 | 0 | 3 |
| 6 | X-ray viewing box - 3films | 1 | 1 | 1 | 1 | 1 | 5 |
| 10— | 【DENTAL】 | | | | | | |
| 1 | Autoclave - table top | 0 | 1 | 0 | 0 | 0 | 1 |
| 2 | Dental chair w/rotating stool & compressor | 0 | 1 | 1 | 1 | 0 | 3 |
| 3 | Dental X-ray film processor | 0 | 0 | 1 | 1 | 0 | 2 |
| 4 | Dental X-ray unit | 0 | 0 | 1 | 1 | 0 | 2 |
| 5 | Instrument set for dental | 0 | 1 | 1 | 1 | 1 | 4 |
| 11— | 【REHABILITATION】 | | | | | | |
| 1 | Bicycle exerciser | 1 | 1 | 1 | 1 | 1 | 5 |
| 2 | Dumbell set | 1 | 1 | 1 | 1 | 1 | 5 |
| 3 | Exercise hand set | 1 | 1 | 1 | 1 | 1 | 5 |
| 4 | Hot pack unit | 1 | 1 | 1 | 1 | 1 | 5 |
| 5 | Mat for exercise | 1 | 1 | 1 | 1 | 1 | 5 |
| 6 | Traction unit (w/bed) | 1 | 0 | 0 | 1 | 0 | 2 |
| 8-1 | Ultraviolet lamp | 1 | 1 | 1 | 1 | 1 | 5 |
| 8-2 | Infrared lamp | 1 | 1 | 1 | 1 | 1 | 5 |
| 9 | Wall stall bars | 1 | 0 | 0 | 1 | 0 | 2 |
| 10 | Parallel Bars | 1 | 1 | 1 | 1 | 1 | 5 |

Table 2—10 Equipment Procurement Plan

Health Center

| Item No. | Name of Equipment | Basic Qty's for Package | KSD District | | | | Mhlontlo District | | Total Qty's |
|----------|--|-------------------------|----------------|---------------------|--------------------------|------------------|-------------------|------------------|-------------|
| | | | KU01 Baziya HC | KU02 Ngangelizwe HC | KU03 Stanford Terrace HC | KU04 Mbekweni HC | MN01 Gumbu HC | ML01 Mhlakulo HC | |
| | | | Qty's | Qty's | Qty's | Qty's | Qty's | Qty's | |
| 2 | Peak flow meter | 3 | 3 | 3 | 3 | 3 | 3 | 3 | 18 |
| 3 | Weighing scale for Pediatric | 3 | 3 | 3 | 3 | 3 | 3 | 3 | 18 |
| 4-1 | Weighing scale | 3 | 3 | 3 | 3 | 3 | 3 | 3 | 18 |
| 4-2 | Height scale | 3 | 3 | 3 | 3 | 3 | 3 | 3 | 18 |
| 4-3 | Pediatric height scale,bed type | 3 | 3 | 3 | 3 | 3 | 3 | 3 | 18 |
| 5 | Refrigerator | 3 | 3 | 3 | 3 | 3 | 3 | 3 | 18 |
| 7 | Stethoscope | 6 | 6 | 6 | 6 | 6 | 6 | 6 | 36 |
| 8 | Sphygmomanometer | 6 | 6 | 6 | 6 | 6 | 6 | 6 | 36 |
| 9 | Diagnostic set | 6 | 6 | 6 | 6 | 6 | 6 | 6 | 36 |
| 11 | Examination lamp | 3 | 3 | 3 | 3 | 3 | 3 | 3 | 18 |
| 12-1 | Suction unit, manual type | 2 | 2 | 2 | 2 | 2 | 2 | 2 | 12 |
| 12-2 | Suction unit, electric type | 2 | 2 | 2 | 2 | 2 | 2 | 2 | 12 |
| 14 | Fetal doppler | 1 | 1 | 1 | 1 | 1 | 1 | 1 | 6 |
| 15 | Resuscitator for infant & adult | 3 | 3 | 3 | 3 | 3 | 3 | 3 | 18 |
| 16 | O2 flow meter set | 3 | 3 | 3 | 3 | 3 | 3 | 3 | 18 |
| 23 | Boiling sterilizer | 3 | 3 | 3 | 3 | 3 | 3 | 3 | 18 |
| 24 | Dressing instrument set for General | 6 | 6 | 6 | 6 | 6 | 6 | 6 | 36 |
| 25 | Dressing instrument set for Gynecology | 6 | 6 | 6 | 6 | 6 | 6 | 6 | 36 |
| 26 | Delivery instrument set | 3 | 3 | 3 | 3 | 3 | 3 | 3 | 18 |
| 27 | Partition | 6 | 6 | 6 | 6 | 6 | 6 | 6 | 36 |
| 28 | Instrument cabinet | 6 | 6 | 6 | 6 | 6 | 6 | 6 | 36 |
| 29 | Nebulizer | 2 | 2 | 2 | 2 | 2 | 2 | 2 | 12 |
| 31 | Ablution basin | 1 | 1 | 1 | 1 | 1 | 1 | 1 | 6 |
| 32 | Drip stand | 3 | 3 | 3 | 3 | 3 | 3 | 3 | 18 |
| 33 | Hemoglobin meter | 1 | 1 | 1 | 1 | 1 | 1 | 1 | 6 |
| 34 | Gulucose meter | 1 | 1 | 1 | 1 | 1 | 1 | 1 | 6 |
| 35 | Consultation desk & chair | 3 | 3 | 3 | 3 | 3 | 3 | 3 | 18 |
| 36 | Stretcher | 1 | 1 | 1 | 1 | 1 | 1 | 1 | 6 |
| 37 | Wheel chair | 1 | 1 | 1 | 1 | 1 | 1 | 1 | 6 |
| 38 | X-ray viewing box | 1 | 1 | 1 | 1 | 1 | 1 | 1 | 6 |

Table 2— 10 Equipment Procurement Plan

Clinic & Mobile Clinic

Clinic

| Item No. | Name of Equipment | Nyandeni District | | Mhlontlo District | | KSD District | | Total Qty's |
|----------|---|------------------------|----------------------------|------------------------------|--------------------------|-------------------------------|--------------------------|-------------|
| | | Under Canzibe Hospital | Under St.Barnabas Hospital | Under Nessie Knight Hospital | Under St.Lucy's Hospital | Under Umtata General Hospital | Under Zithulele Hospital | |
| | | 10 Clinics Qty's | 16 Clinics Qty's | 13 Clinics Qty's | 10 Clinics Qty's | 21 Clinics Qty's | 13 Clinics Qty's | |
| 1 | Examination table | 10 | 16 | 13 | 10 | 21 | 13 | 83 |
| 2 | Peak flow meter | 10 | 16 | 13 | 10 | 21 | 13 | 83 |
| 3 | Weighing scale for Pediatric | 10 | 16 | 13 | 10 | 21 | 13 | 83 |
| 4-1 | Weighing scale | 10 | 16 | 13 | 10 | 21 | 13 | 83 |
| 4-2 | Height scale | 10 | 16 | 13 | 10 | 21 | 13 | 83 |
| 4-3 | Pediatric height scale, bed type | 10 | 16 | 13 | 10 | 21 | 13 | 83 |
| 5 | Refrigerator | 10 | 16 | 13 | 10 | 21 | 13 | 83 |
| 7 | Stethoscope | 20 | 32 | 26 | 20 | 42 | 26 | 166 |
| 8 | Sphygmomanometer | 20 | 32 | 26 | 20 | 42 | 26 | 166 |
| 9 | Diagnostic set | 20 | 32 | 26 | 20 | 42 | 26 | 166 |
| 11 | Examination lamp | 10 | 16 | 13 | 10 | 21 | 13 | 83 |
| 12 | Suction unit, manual type | 10 | 16 | 13 | 10 | 21 | 13 | 83 |
| 14 | Fetal doppler | 10 | 16 | 13 | 10 | 21 | 13 | 83 |
| 15 | Resuscitator for infant & adult | 10 | 16 | 13 | 10 | 21 | 13 | 83 |
| 16 | O2 flow meter set | 10 | 16 | 13 | 10 | 21 | 13 | 83 |
| 22 | Stand by Generator for examination lamp | 10 | 16 | 13 | 10 | 21 | 13 | 83 |
| 23 | Boiling sterilizer, gas type | 10 | 16 | 13 | 10 | 21 | 13 | 83 |
| 24 | Dressing instrument set for General | 20 | 32 | 26 | 20 | 42 | 26 | 166 |
| 25 | Dressing instrument set for Gynecology | 20 | 32 | 26 | 20 | 42 | 26 | 166 |
| 26 | Delivery instrument set | 9 | 15 | 12 | 9 | 20 | 12 | 77 |
| 27 | Partition | 10 | 16 | 13 | 10 | 21 | 13 | 83 |
| 28 | Instrument cabinet | 20 | 32 | 24 | 20 | 41 | 26 | 163 |
| 29 | Nebulizer, cell battery type | 10 | 16 | 13 | 10 | 21 | 13 | 83 |
| 31 | Ablution basin | 9 | 15 | 12 | 9 | 20 | 12 | 77 |
| 32 | Drip stand | 10 | 16 | 13 | 10 | 21 | 13 | 83 |
| 33 | Hemoglobin meter | 10 | 16 | 13 | 10 | 21 | 13 | 83 |
| 34 | Gulucose meter | 10 | 16 | 13 | 10 | 21 | 13 | 83 |
| 35 | Consulation desk & chair | 10 | 16 | 11 | 10 | 20 | 13 | 80 |
| 36 | Stretcher, holding type | 10 | 16 | 13 | 10 | 21 | 13 | 83 |

(Note): Refer to Next Table " Clinic 1/6 – 6/6 " for each detail.

Mobile Clinic

| Item No. | Name of Equipment | Qty's | Qty's | Qty's | Qty's | Qty's | Qty's | Total Qty's |
|----------|--------------------|-------|-------|-------|-------|-------|-------|-------------|
| 1 | Mobile clinic unit | 1 | 1 | 1 | 1 | 1 | 1 | 6 |

Clinic (1/6)

Nyandeni District (Under Canzibe Hospital)

| Item No. | Name of Equipment | Basic Qty's for Package | Nyandeni District | | | | | | | | | | | Total Qty's | | |
|----------|---|-------------------------|-------------------------------|-----------------------------|-------------------------|--------------------------|-------------------------|---------------------------|-------------------------|--------------------------|----------------------------|--------------------------------|---|-------------|---|----|
| | | | Under Canzibe Hospital | | | | | | | | | | | | | |
| | | | NC01 Buntingville Qty's | NC02 Nkumandeni Qty's | NC03 Nqanda Qty's | NC04 Ntibane Qty's | NC05 Pilani Qty's | NC06 Lwandile Qty's | NC07 Nolita Qty's | NC08 Ntapane Qty's | NC09 Lujizweni Qty's | NC10 Canzibe Gate. Qty's | | | | |
| 1 | Examination table | 1 | 1 | 1 | 1 | 1 | 1 | 1 | 1 | 1 | 1 | 1 | 1 | 1 | 1 | 10 |
| 2 | Peak flow meter | 1 | 1 | 1 | 1 | 1 | 1 | 1 | 1 | 1 | 1 | 1 | 1 | 1 | 1 | 10 |
| 3 | Weighing scale for Pediatric | 1 | 1 | 1 | 1 | 1 | 1 | 1 | 1 | 1 | 1 | 1 | 1 | 1 | 1 | 10 |
| 4-1 | Weighing scale | 1 | 1 | 1 | 1 | 1 | 1 | 1 | 1 | 1 | 1 | 1 | 1 | 1 | 1 | 10 |
| 4-2 | Height scale | 1 | 1 | 1 | 1 | 1 | 1 | 1 | 1 | 1 | 1 | 1 | 1 | 1 | 1 | 10 |
| 4-3 | Pediatric height scale,bed type | 1 | 1 | 1 | 1 | 1 | 1 | 1 | 1 | 1 | 1 | 1 | 1 | 1 | 1 | 10 |
| 5 | Refrigerator | 1 | 1 | 1 | 1 | 1 | 1 | 1 | 1 | 1 | 1 | 1 | 1 | 1 | 1 | 10 |
| 7 | Stethoscope | 2 | 2 | 2 | 2 | 2 | 2 | 2 | 2 | 2 | 2 | 2 | 2 | 2 | 2 | 20 |
| 8 | Sphygmomanometer | 2 | 2 | 2 | 2 | 2 | 2 | 2 | 2 | 2 | 2 | 2 | 2 | 2 | 2 | 20 |
| 9 | Diagnostic set | 2 | 2 | 2 | 2 | 2 | 2 | 2 | 2 | 2 | 2 | 2 | 2 | 2 | 2 | 20 |
| 11 | Examination lamp | 1 | 1 | 1 | 1 | 1 | 1 | 1 | 1 | 1 | 1 | 1 | 1 | 1 | 1 | 10 |
| 12 | Suction unit, manual type | 1 | 1 | 1 | 1 | 1 | 1 | 1 | 1 | 1 | 1 | 1 | 1 | 1 | 1 | 10 |
| 14 | Fetal doppler | 1 | 1 | 1 | 1 | 1 | 1 | 1 | 1 | 1 | 1 | 1 | 1 | 1 | 1 | 10 |
| 15 | Resuscitator for infant & adult | 1 | 1 | 1 | 1 | 1 | 1 | 1 | 1 | 1 | 1 | 1 | 1 | 1 | 1 | 10 |
| 16 | O2 flow meter set | 1 | 1 | 1 | 1 | 1 | 1 | 1 | 1 | 1 | 1 | 1 | 1 | 1 | 1 | 10 |
| 22 | Stand by Generator for examination lamp | 1 | 1 | 1 | 1 | 1 | 1 | 1 | 1 | 1 | 1 | 1 | 1 | 1 | 1 | 10 |
| 23 | Boiling sterilizer, gas type | 1 | 1 | 1 | 1 | 1 | 1 | 1 | 1 | 1 | 1 | 1 | 1 | 1 | 1 | 10 |
| 24 | Dressing instrument set for General | 2 | 2 | 2 | 2 | 2 | 2 | 2 | 2 | 2 | 2 | 2 | 2 | 2 | 2 | 20 |
| 25 | Dressing instrument set for Gynecology | 2 | 2 | 2 | 2 | 2 | 2 | 2 | 2 | 2 | 2 | 2 | 2 | 2 | 2 | 20 |
| 26 | Delivery instrument set | 1 | 1 | 1 | 1 | 1 | 1 | 1 | 1 | 1 | 1 | 1 | 0 | | | 9 |
| 27 | Partition | 1 | 1 | 1 | 1 | 1 | 1 | 1 | 1 | 1 | 1 | 1 | 1 | 1 | 1 | 10 |
| 28 | Instrument cabinet | 2 | 2 | 2 | 2 | 2 | 2 | 2 | 2 | 2 | 2 | 2 | 2 | 2 | 2 | 20 |
| 29 | Nebulizer,cell battery type | 1 | 1 | 1 | 1 | 1 | 1 | 1 | 1 | 1 | 1 | 1 | 1 | 1 | 1 | 10 |
| 31 | Ablution basin | 1 | 1 | 1 | 1 | 1 | 1 | 1 | 1 | 1 | 1 | 1 | 0 | | | 9 |
| 32 | Drip stand | 1 | 1 | 1 | 1 | 1 | 1 | 1 | 1 | 1 | 1 | 1 | 1 | 1 | 1 | 10 |
| 33 | Hemogrobin meter | 1 | 1 | 1 | 1 | 1 | 1 | 1 | 1 | 1 | 1 | 1 | 1 | 1 | 1 | 10 |
| 34 | Gulucose meter | 1 | 1 | 1 | 1 | 1 | 1 | 1 | 1 | 1 | 1 | 1 | 1 | 1 | 1 | 10 |
| 35 | Consulation desk & chair | 1 | 1 | 1 | 1 | 1 | 1 | 1 | 1 | 1 | 1 | 1 | 1 | 1 | 1 | 10 |
| 36 | Stretcher, holding type | 1 | 1 | 1 | 1 | 1 | 1 | 1 | 1 | 1 | 1 | 1 | 1 | 1 | 1 | 10 |

Clinic (2/6)

Nyandeni District (Under St.Barnabas Hospital)

| Item No. | Name of Equipment | Basic Qty's for Package | Nyandeni District | | | | | | | | | | | | | | | Total Qty's |
|----------|---|-------------------------|----------------------------|---------------|-------------|--------------|----------------------|-------------|-------------|---------------|-------------------|-------------|----------------|-------------------|--------------|----------------|------------|-------------|
| | | | Under St.Barnabas Hospital | | | | | | | | | | | | | | | |
| | | | NB01 Libode | NB02 Nyandeni | NB03 Malusi | NB04 D.Falls | NB05 Mangwawanguleni | NB06 Ndanya | NB07 Mevana | NB08 Ngcolora | NB09(*) Makotyana | NB10 Nkanga | NB11 Mgwenyana | NB12 St.Bar.Gate. | NB13 Nkanunu | NB14 O.Bunting | NB15 Owele | |
| Qty's | Qty's | Qty's | Qty's | Qty's | Qty's | Qty's | Qty's | Qty's | Qty's | Qty's | Qty's | Qty's | Qty's | Qty's | Qty's | | | |
| 1 | Examination table | 1 | 1 | 1 | 1 | 1 | 1 | 1 | 1 | 1 | 1 | 1 | 1 | 1 | 1 | 1 | 1 | 16 |
| 2 | Peak flow meter | 1 | 1 | 1 | 1 | 1 | 1 | 1 | 1 | 1 | 1 | 1 | 1 | 1 | 1 | 1 | 1 | 16 |
| 3 | Weighing scale for Pediatric | 1 | 1 | 1 | 1 | 1 | 1 | 1 | 1 | 1 | 1 | 1 | 1 | 1 | 1 | 1 | 1 | 16 |
| 4-1 | Weighing scale | 1 | 1 | 1 | 1 | 1 | 1 | 1 | 1 | 1 | 1 | 1 | 1 | 1 | 1 | 1 | 1 | 16 |
| 4-2 | Height scale | 1 | 1 | 1 | 1 | 1 | 1 | 1 | 1 | 1 | 1 | 1 | 1 | 1 | 1 | 1 | 1 | 16 |
| 4-3 | Pediatric height scale,bed type | 1 | 1 | 1 | 1 | 1 | 1 | 1 | 1 | 1 | 1 | 1 | 1 | 1 | 1 | 1 | 1 | 16 |
| 5 | Refrigerator | 1 | 1 | 1 | 1 | 1 | 1 | 1 | 1 | 1 | 1 | 1 | 1 | 1 | 1 | 1 | 1 | 16 |
| 7 | Stethoscope | 2 | 2 | 2 | 2 | 2 | 2 | 2 | 2 | 2 | 2 | 2 | 2 | 2 | 2 | 2 | 2 | 32 |
| 8 | Sphygmomanometer | 2 | 2 | 2 | 2 | 2 | 2 | 2 | 2 | 2 | 2 | 2 | 2 | 2 | 2 | 2 | 2 | 32 |
| 9 | Diagnostic set | 2 | 2 | 2 | 2 | 2 | 2 | 2 | 2 | 2 | 2 | 2 | 2 | 2 | 2 | 2 | 2 | 32 |
| 11 | Examination lamp | 1 | 1 | 1 | 1 | 1 | 1 | 1 | 1 | 1 | 1 | 1 | 1 | 1 | 1 | 1 | 1 | 16 |
| 12 | Suction unit, manual type | 1 | 1 | 1 | 1 | 1 | 1 | 1 | 1 | 1 | 1 | 1 | 1 | 1 | 1 | 1 | 1 | 16 |
| 14 | Fetal doppler | 1 | 1 | 1 | 1 | 1 | 1 | 1 | 1 | 1 | 1 | 1 | 1 | 1 | 1 | 1 | 1 | 16 |
| 15 | Resuscitator for infant & adult | 1 | 1 | 1 | 1 | 1 | 1 | 1 | 1 | 1 | 1 | 1 | 1 | 1 | 1 | 1 | 1 | 16 |
| 16 | O2 flow meter set | 1 | 1 | 1 | 1 | 1 | 1 | 1 | 1 | 1 | 1 | 1 | 1 | 1 | 1 | 1 | 1 | 16 |
| 22 | Stand by Generator for examination lamp | 1 | 1 | 1 | 1 | 1 | 1 | 1 | 1 | 1 | 1 | 1 | 1 | 1 | 1 | 1 | 1 | 16 |
| 23 | Boiling sterilizer, gas type | 1 | 1 | 1 | 1 | 1 | 1 | 1 | 1 | 1 | 1 | 1 | 1 | 1 | 1 | 1 | 1 | 16 |
| 24 | Dressing instrument set for General | 2 | 2 | 2 | 2 | 2 | 2 | 2 | 2 | 2 | 2 | 2 | 2 | 2 | 2 | 2 | 2 | 32 |
| 25 | Dressing instrument set for Gynecology | 2 | 2 | 2 | 2 | 2 | 2 | 2 | 2 | 2 | 2 | 2 | 2 | 2 | 2 | 2 | 2 | 32 |
| 26 | Delivery instrument set | 1 | 1 | 1 | 1 | 1 | 1 | 1 | 1 | 1 | 1 | 1 | 0 | 1 | 1 | 1 | 1 | 15 |
| 27 | Partition | 1 | 1 | 1 | 1 | 1 | 1 | 1 | 1 | 1 | 1 | 1 | 1 | 1 | 1 | 1 | 1 | 16 |
| 28 | Instrument cabinet | 2 | 2 | 2 | 2 | 2 | 2 | 2 | 2 | 2 | 2 | 2 | 2 | 2 | 2 | 2 | 2 | 32 |
| 29 | Nebulizer,cell bettery type | 1 | 1 | 1 | 1 | 1 | 1 | 1 | 1 | 1 | 1 | 1 | 1 | 1 | 1 | 1 | 1 | 16 |
| 31 | Ablution basin | 1 | 1 | 1 | 1 | 1 | 1 | 1 | 1 | 1 | 1 | 1 | 0 | 1 | 1 | 1 | 1 | 15 |
| 32 | Drip stand | 1 | 1 | 1 | 1 | 1 | 1 | 1 | 1 | 1 | 1 | 1 | 1 | 1 | 1 | 1 | 1 | 16 |
| 33 | Hemogrobin meter | 1 | 1 | 1 | 1 | 1 | 1 | 1 | 1 | 1 | 1 | 1 | 1 | 1 | 1 | 1 | 1 | 16 |
| 34 | Gulucose meter | 1 | 1 | 1 | 1 | 1 | 1 | 1 | 1 | 1 | 1 | 1 | 1 | 1 | 1 | 1 | 1 | 16 |
| 35 | Consulation desk & chair | 1 | 1 | 1 | 1 | 1 | 1 | 1 | 1 | 1 | 1 | 1 | 1 | 1 | 1 | 1 | 1 | 16 |
| 36 | Stretcher, holding type | 1 | 1 | 1 | 1 | 1 | 1 | 1 | 1 | 1 | 1 | 1 | 1 | 1 | 1 | 1 | 1 | 16 |

Clinic (3/6)

Mhlontlo District (Under Nessie Knight Hospital)

| Item No. | Name of Equipment | Basic Qty's for Package | Mhlontlo District | | | | | | | | | | | | | Total Qty's |
|----------|---|-------------------------|------------------------------|-----------|---------------|--------------|----------------|---------------|---------------|---------------|-----------------|------------|-----------------|---------------|-------------|-------------|
| | | | Under Nessie Knight Hospital | | | | | | | | | | | | | |
| | | | MN02 Nxotwe | MN03 Gura | MN04 Tsilitwa | MN05 T.Falls | MN06 Kalankomo | MN07 Shawbury | MN08 Cabavale | MN09 Mahlangu | MN10 Ngwemnyama | MN11 Qanqu | MN12 Mbalisweni | MN13 N.K.Gate | MN14 Mdyobe | |
| Qty's | Qty's | Qty's | Qty's | Qty's | Qty's | Qty's | Qty's | Qty's | Qty's | Qty's | Qty's | Qty's | Qty's | | | |
| 1 | Examination table | 1 | 1 | 1 | 1 | 1 | 1 | 1 | 1 | 1 | 1 | 1 | 1 | 1 | 1 | 13 |
| 2 | Peak flow meter | 1 | 1 | 1 | 1 | 1 | 1 | 1 | 1 | 1 | 1 | 1 | 1 | 1 | 1 | 13 |
| 3 | Weighing scale for Pediatric | 1 | 1 | 1 | 1 | 1 | 1 | 1 | 1 | 1 | 1 | 1 | 1 | 1 | 1 | 13 |
| 4-1 | Weighing scale | 1 | 1 | 1 | 1 | 1 | 1 | 1 | 1 | 1 | 1 | 1 | 1 | 1 | 1 | 13 |
| 4-2 | Height scale | 1 | 1 | 1 | 1 | 1 | 1 | 1 | 1 | 1 | 1 | 1 | 1 | 1 | 1 | 13 |
| 4-3 | Pediatric height scale,bed type | 1 | 1 | 1 | 1 | 1 | 1 | 1 | 1 | 1 | 1 | 1 | 1 | 1 | 1 | 13 |
| 5 | Refrigerator | 1 | 1 | 1 | 1 | 1 | 1 | 1 | 1 | 1 | 1 | 1 | 1 | 1 | 1 | 13 |
| 7 | Stethoscope | 2 | 2 | 2 | 2 | 2 | 2 | 2 | 2 | 2 | 2 | 2 | 2 | 2 | 2 | 26 |
| 8 | Sphygmomanometer | 2 | 2 | 2 | 2 | 2 | 2 | 2 | 2 | 2 | 2 | 2 | 2 | 2 | 2 | 26 |
| 9 | Diagnostic set | 2 | 2 | 2 | 2 | 2 | 2 | 2 | 2 | 2 | 2 | 2 | 2 | 2 | 2 | 26 |
| 11 | Examination lamp | 1 | 1 | 1 | 1 | 1 | 1 | 1 | 1 | 1 | 1 | 1 | 1 | 1 | 1 | 13 |
| 12 | Suction unit, manual type | 1 | 1 | 1 | 1 | 1 | 1 | 1 | 1 | 1 | 1 | 1 | 1 | 1 | 1 | 13 |
| 14 | Fetal doppler | 1 | 1 | 1 | 1 | 1 | 1 | 1 | 1 | 1 | 1 | 1 | 1 | 1 | 1 | 13 |
| 15 | Resuscitator for infant & adult | 1 | 1 | 1 | 1 | 1 | 1 | 1 | 1 | 1 | 1 | 1 | 1 | 1 | 1 | 13 |
| 16 | O2 flow meter set | 1 | 1 | 1 | 1 | 1 | 1 | 1 | 1 | 1 | 1 | 1 | 1 | 1 | 1 | 13 |
| 22 | Stand by Generator for examination lamp | 1 | 1 | 1 | 1 | 1 | 1 | 1 | 1 | 1 | 1 | 1 | 1 | 1 | 1 | 13 |
| 23 | Boiling sterilizer, gas type | 1 | 1 | 1 | 1 | 1 | 1 | 1 | 1 | 1 | 1 | 1 | 1 | 1 | 1 | 13 |
| 24 | Dressing instrument set for General | 2 | 2 | 2 | 2 | 2 | 2 | 2 | 2 | 2 | 2 | 2 | 2 | 2 | 2 | 26 |
| 25 | Dressing instrument set for Gynecology | 2 | 2 | 2 | 2 | 2 | 2 | 2 | 2 | 2 | 2 | 2 | 2 | 2 | 2 | 26 |
| 26 | Delivery instrument set | 1 | 1 | 1 | 1 | 1 | 1 | 1 | 1 | 1 | 1 | 1 | 0 | 1 | 1 | 12 |
| 27 | Partition | 1 | 1 | 1 | 1 | 1 | 1 | 1 | 1 | 1 | 1 | 1 | 1 | 1 | 1 | 13 |
| 28 | Instrument cabinet | 2 | 2 | 2 | 2 | 1 | 2 | 2 | 2 | 2 | 1 | 2 | 2 | 2 | 2 | 24 |
| 29 | Nebulizer,cell bettery type | 1 | 1 | 1 | 1 | 1 | 1 | 1 | 1 | 1 | 1 | 1 | 1 | 1 | 1 | 13 |
| 31 | Ablution basin | 1 | 1 | 1 | 1 | 1 | 1 | 1 | 1 | 1 | 1 | 1 | 0 | 1 | 1 | 12 |
| 32 | Drip stand | 1 | 1 | 1 | 1 | 1 | 1 | 1 | 1 | 1 | 1 | 1 | 1 | 1 | 1 | 13 |
| 33 | Hemogrobin meter | 1 | 1 | 1 | 1 | 1 | 1 | 1 | 1 | 1 | 1 | 1 | 1 | 1 | 1 | 13 |
| 34 | Gulucose meter | 1 | 1 | 1 | 1 | 1 | 1 | 1 | 1 | 1 | 1 | 1 | 1 | 1 | 1 | 13 |
| 35 | Consulation desk & chair | 1 | 1 | 1 | 1 | 0 | 1 | 1 | 1 | 1 | 0 | 1 | 1 | 1 | 1 | 11 |
| 36 | Stretcher, holding type | 1 | 1 | 1 | 1 | 1 | 1 | 1 | 1 | 1 | 1 | 1 | 1 | 1 | 1 | 13 |

Clinic (4/6)

Mhlontlo District (Under St.Lucy's Hospital)

| Item No. | Name of Equipment | Basic Qty's for Package | Mhlontlo District | | | | | | | | | | | Total Qty's |
|----------|---|-------------------------|--------------------------|-----------------|------------|---------------|------------------|-------------|-----------------|----------------|---------------|-----------------|--|-------------|
| | | | Under St.Lucy's Hospital | | | | | | | | | | | |
| | | | ML02 Langeni | ML03 Sidwadweni | ML04 Tsolo | ML05 Up.Mjika | ML06 L.Gungululu | ML07 Lotana | ML08 Mbokotwana | ML09 Mhlahlane | ML10 Beledale | ML11 St.L.Gate. | | |
| Qty's | Qty's | Qty's | Qty's | Qty's | Qty's | Qty's | Qty's | Qty's | Qty's | Qty's | | | | |
| 1 | Examination table | 1 | 1 | 1 | 1 | 1 | 1 | 1 | 1 | 1 | 1 | 1 | | 10 |
| 2 | Peak flow meter | 1 | 1 | 1 | 1 | 1 | 1 | 1 | 1 | 1 | 1 | 1 | | 10 |
| 3 | Weighing scale for Pediatric | 1 | 1 | 1 | 1 | 1 | 1 | 1 | 1 | 1 | 1 | 1 | | 10 |
| 4-1 | Weighing scale | 1 | 1 | 1 | 1 | 1 | 1 | 1 | 1 | 1 | 1 | 1 | | 10 |
| 4-2 | Height scale | 1 | 1 | 1 | 1 | 1 | 1 | 1 | 1 | 1 | 1 | 1 | | 10 |
| 4-3 | Pediatric height scale,bed type | 1 | 1 | 1 | 1 | 1 | 1 | 1 | 1 | 1 | 1 | 1 | | 10 |
| 5 | Refrigerator | 1 | 1 | 1 | 1 | 1 | 1 | 1 | 1 | 1 | 1 | 1 | | 10 |
| 7 | Stethoscope | 2 | 2 | 2 | 2 | 2 | 2 | 2 | 2 | 2 | 2 | 2 | | 20 |
| 8 | Sphygmomanometer | 2 | 2 | 2 | 2 | 2 | 2 | 2 | 2 | 2 | 2 | 2 | | 20 |
| 9 | Diagnostic set | 2 | 2 | 2 | 2 | 2 | 2 | 2 | 2 | 2 | 2 | 2 | | 20 |
| 11 | Examination lamp | 1 | 1 | 1 | 1 | 1 | 1 | 1 | 1 | 1 | 1 | 1 | | 10 |
| 12 | Suction unit, manual type | 1 | 1 | 1 | 1 | 1 | 1 | 1 | 1 | 1 | 1 | 1 | | 10 |
| 14 | Fetal doppler | 1 | 1 | 1 | 1 | 1 | 1 | 1 | 1 | 1 | 1 | 1 | | 10 |
| 15 | Resuscitator for infant & adult | 1 | 1 | 1 | 1 | 1 | 1 | 1 | 1 | 1 | 1 | 1 | | 10 |
| 16 | O2 flow meter set | 1 | 1 | 1 | 1 | 1 | 1 | 1 | 1 | 1 | 1 | 1 | | 10 |
| 22 | Stand by Generator for examination lamp | 1 | 1 | 1 | 1 | 1 | 1 | 1 | 1 | 1 | 1 | 1 | | 10 |
| 23 | Boiling sterilizer, gas type | 1 | 1 | 1 | 1 | 1 | 1 | 1 | 1 | 1 | 1 | 1 | | 10 |
| 24 | Dressing instrument set for General | 2 | 2 | 2 | 2 | 2 | 2 | 2 | 2 | 2 | 2 | 2 | | 20 |
| 25 | Dressing instrument set for Gynecology | 2 | 2 | 2 | 2 | 2 | 2 | 2 | 2 | 2 | 2 | 2 | | 20 |
| 26 | Delivery instrument set | 1 | 1 | 1 | 1 | 1 | 1 | 1 | 1 | 1 | 1 | 0 | | 9 |
| 27 | Partition | 1 | 1 | 1 | 1 | 1 | 1 | 1 | 1 | 1 | 1 | 1 | | 10 |
| 28 | Instrument cabinet | 2 | 2 | 2 | 2 | 2 | 2 | 2 | 2 | 2 | 2 | 2 | | 20 |
| 29 | Nebulizer,cell battery type | 1 | 1 | 1 | 1 | 1 | 1 | 1 | 1 | 1 | 1 | 1 | | 10 |
| 31 | Ablution basin | 1 | 1 | 1 | 1 | 1 | 1 | 1 | 1 | 1 | 1 | 0 | | 9 |
| 32 | Drip stand | 1 | 1 | 1 | 1 | 1 | 1 | 1 | 1 | 1 | 1 | 1 | | 10 |
| 33 | Hemogrobin meter | 1 | 1 | 1 | 1 | 1 | 1 | 1 | 1 | 1 | 1 | 1 | | 10 |
| 34 | Gulucose meter | 1 | 1 | 1 | 1 | 1 | 1 | 1 | 1 | 1 | 1 | 1 | | 10 |
| 35 | Consulation desk & chair | 1 | 1 | 1 | 1 | 1 | 1 | 1 | 1 | 1 | 1 | 1 | | 10 |
| 36 | Stretcher, holding type | 1 | 1 | 1 | 1 | 1 | 1 | 1 | 1 | 1 | 1 | 1 | | 10 |

Clinic (5/6)

KSD District (Under Umtata General Hospital)

| Item No. | Name of Equipment | Basic Qty's for Package | KSD District | | | | | | | | | | | | | | | | | | | Total Qty's | |
|----------|--|-------------------------|-------------------------------|-------------|-------------|-------------|----------------|-----------------|-------------|----------------|-----------|---------------|------------|------------|---------------|----------------|----------------|--------------|-------------|---------------|------------|-------------|-------------|
| | | | Under Umtata General Hospital | | | | | | | | | | | | | | | | | | | | |
| | | | KU05 Ntshale | KU06 Zitale | KU07 Sitebe | KU08 Tabase | KU09 Tyelebana | KU10 Up.Xongora | KU11 Xhwill | KU12 Ngcengane | KU13 Qunu | KU14 C.Center | KU15 Kambi | KU16 Mpeko | KU17 Mpunzana | KU18 Ntshabeni | KU19 Ookolweni | KU20 Sangoni | KU21 NdBela | KU22 Ncambele | KU23 Efata | | KU24 Maxwel |
| Qty's | Qty's | Qty's | Qty's | Qty's | Qty's | Qty's | Qty's | Qty's | Qty's | Qty's | Qty's | Qty's | Qty's | Qty's | Qty's | Qty's | Qty's | Qty's | Qty's | Qty's | | | |
| 1 | Examination table | 1 | 1 | 1 | 1 | 1 | 1 | 1 | 1 | 1 | 1 | 1 | 1 | 1 | 1 | 1 | 1 | 1 | 1 | 1 | 1 | 1 | 21 |
| 2 | Peak flow meter | 1 | 1 | 1 | 1 | 1 | 1 | 1 | 1 | 1 | 1 | 1 | 1 | 1 | 1 | 1 | 1 | 1 | 1 | 1 | 1 | 1 | 21 |
| 3 | Weighing scale for Pediatric | 1 | 1 | 1 | 1 | 1 | 1 | 1 | 1 | 1 | 1 | 1 | 1 | 1 | 1 | 1 | 1 | 1 | 1 | 1 | 1 | 1 | 21 |
| 4-1 | Weighing scale | 1 | 1 | 1 | 1 | 1 | 1 | 1 | 1 | 1 | 1 | 1 | 1 | 1 | 1 | 1 | 1 | 1 | 1 | 1 | 1 | 1 | 21 |
| 4-2 | Height scale | 1 | 1 | 1 | 1 | 1 | 1 | 1 | 1 | 1 | 1 | 1 | 1 | 1 | 1 | 1 | 1 | 1 | 1 | 1 | 1 | 1 | 21 |
| 4-3 | Pediatric height scale,bed type | 1 | 1 | 1 | 1 | 1 | 1 | 1 | 1 | 1 | 1 | 1 | 1 | 1 | 1 | 1 | 1 | 1 | 1 | 1 | 1 | 1 | 21 |
| 5 | Refrigerator | 1 | 1 | 1 | 1 | 1 | 1 | 1 | 1 | 1 | 1 | 1 | 1 | 1 | 1 | 1 | 1 | 1 | 1 | 1 | 1 | 1 | 21 |
| 7 | Stethoscope | 2 | 2 | 2 | 2 | 2 | 2 | 2 | 2 | 2 | 2 | 2 | 2 | 2 | 2 | 2 | 2 | 2 | 2 | 2 | 2 | 2 | 42 |
| 8 | Sphygmomanometer | 2 | 2 | 2 | 2 | 2 | 2 | 2 | 2 | 2 | 2 | 2 | 2 | 2 | 2 | 2 | 2 | 2 | 2 | 2 | 2 | 2 | 42 |
| 9 | Diagnostic set | 2 | 2 | 2 | 2 | 2 | 2 | 2 | 2 | 2 | 2 | 2 | 2 | 2 | 2 | 2 | 2 | 2 | 2 | 2 | 2 | 2 | 42 |
| 11 | Examination lamp | 1 | 1 | 1 | 1 | 1 | 1 | 1 | 1 | 1 | 1 | 1 | 1 | 1 | 1 | 1 | 1 | 1 | 1 | 1 | 1 | 1 | 21 |
| 12 | Suction unit, manual type | 1 | 1 | 1 | 1 | 1 | 1 | 1 | 1 | 1 | 1 | 1 | 1 | 1 | 1 | 1 | 1 | 1 | 1 | 1 | 1 | 1 | 21 |
| 14 | Fetal doppler | 1 | 1 | 1 | 1 | 1 | 1 | 1 | 1 | 1 | 1 | 1 | 1 | 1 | 1 | 1 | 1 | 1 | 1 | 1 | 1 | 1 | 21 |
| 15 | Resuscitator for infant & adult | 1 | 1 | 1 | 1 | 1 | 1 | 1 | 1 | 1 | 1 | 1 | 1 | 1 | 1 | 1 | 1 | 1 | 1 | 1 | 1 | 1 | 21 |
| 16 | O2 flow meter set | 1 | 1 | 1 | 1 | 1 | 1 | 1 | 1 | 1 | 1 | 1 | 1 | 1 | 1 | 1 | 1 | 1 | 1 | 1 | 1 | 1 | 21 |
| 22 | Stand by Generator for examination lan | 1 | 1 | 1 | 1 | 1 | 1 | 1 | 1 | 1 | 1 | 1 | 1 | 1 | 1 | 1 | 1 | 1 | 1 | 1 | 1 | 1 | 21 |
| 23 | Boiling sterilizer, gas type | 1 | 1 | 1 | 1 | 1 | 1 | 1 | 1 | 1 | 1 | 1 | 1 | 1 | 1 | 1 | 1 | 1 | 1 | 1 | 1 | 1 | 21 |
| 24 | Dressing instrument set for General | 2 | 2 | 2 | 2 | 2 | 2 | 2 | 2 | 2 | 2 | 2 | 2 | 2 | 2 | 2 | 2 | 2 | 2 | 2 | 2 | 2 | 42 |
| 25 | Dressing instrument set for Gynecology | 2 | 2 | 2 | 2 | 2 | 2 | 2 | 2 | 2 | 2 | 2 | 2 | 2 | 2 | 2 | 2 | 2 | 2 | 2 | 2 | 2 | 42 |
| 26 | Delivery instrument set | 1 | 1 | 1 | 1 | 1 | 1 | 1 | 1 | 1 | 1 | 1 | 1 | 1 | 1 | 1 | 1 | 1 | 1 | 0 | 1 | 1 | 20 |
| 27 | Partition | 1 | 1 | 1 | 1 | 1 | 1 | 1 | 1 | 1 | 1 | 1 | 1 | 1 | 1 | 1 | 1 | 1 | 1 | 1 | 1 | 1 | 21 |
| 28 | Instrument cabinet | 2 | 2 | 2 | 2 | 2 | 2 | 2 | 2 | 2 | 2 | 2 | 2 | 2 | 2 | 2 | 2 | 2 | 2 | 1 | 2 | 2 | 41 |
| 29 | Nebulizer,cell bettery type | 1 | 1 | 1 | 1 | 1 | 1 | 1 | 1 | 1 | 1 | 1 | 1 | 1 | 1 | 1 | 1 | 1 | 1 | 1 | 1 | 1 | 21 |
| 31 | Ablution basin | 1 | 1 | 1 | 1 | 1 | 1 | 1 | 1 | 1 | 1 | 1 | 1 | 1 | 1 | 1 | 1 | 1 | 1 | 0 | 1 | 1 | 20 |
| 32 | Drip stand | 1 | 1 | 1 | 1 | 1 | 1 | 1 | 1 | 1 | 1 | 1 | 1 | 1 | 1 | 1 | 1 | 1 | 1 | 1 | 1 | 1 | 21 |
| 33 | Hemogrobin meter | 1 | 1 | 1 | 1 | 1 | 1 | 1 | 1 | 1 | 1 | 1 | 1 | 1 | 1 | 1 | 1 | 1 | 1 | 1 | 1 | 1 | 21 |
| 34 | Gulucose meter | 1 | 1 | 1 | 1 | 1 | 1 | 1 | 1 | 1 | 1 | 1 | 1 | 1 | 1 | 1 | 1 | 1 | 1 | 1 | 1 | 1 | 21 |
| 35 | Consulation desk & chair | 1 | 1 | 1 | 1 | 1 | 1 | 1 | 1 | 1 | 1 | 1 | 1 | 1 | 1 | 1 | 1 | 1 | 1 | 0 | 1 | 1 | 20 |
| 36 | Stretcher, holding type | 1 | 1 | 1 | 1 | 1 | 1 | 1 | 1 | 1 | 1 | 1 | 1 | 1 | 1 | 1 | 1 | 1 | 1 | 1 | 1 | 1 | 21 |

Clinic (6/6)

KSD District (Under Zithulele Hospital)

| Item No. | Name of Equipment | Basic Qty's for Package | KSD District | | | | | | | | | | | | | Total Qty's |
|----------|---|-------------------------|--------------------------|------------------|----------------|-------------|-----------------|---------------|----------------|----------------|--------------|-----------|------------------|--------------|---------------|-------------|
| | | | Under Zithulele Hospital | | | | | | | | | | | | | |
| | | | KZ01 Ndzulwini | KZ02(*) Mqanduli | KZ03 Luthubeni | KZ04 Mapuzi | KZ05 Ngcwanguba | KZ06 Ngqungqu | KZ07 Ntlangaza | KZ08 Pumulanga | KZ09 Jalamba | KZ10 Wilo | KZ11 Hlabatshane | KZ12 Ngwenya | KZ13 Pakamile | |
| Qty's | Qty's | Qty's | Qty's | Qty's | Qty's | Qty's | Qty's | Qty's | Qty's | Qty's | Qty's | Qty's | Qty's | | | |
| 1 | Examination table | 1 | 1 | 1 | 1 | 1 | 1 | 1 | 1 | 1 | 1 | 1 | 1 | 1 | 1 | 13 |
| 2 | Peak flow meter | 1 | 1 | 1 | 1 | 1 | 1 | 1 | 1 | 1 | 1 | 1 | 1 | 1 | 1 | 13 |
| 3 | Weighing scale for Pediatric | 1 | 1 | 1 | 1 | 1 | 1 | 1 | 1 | 1 | 1 | 1 | 1 | 1 | 1 | 13 |
| 4-1 | Weighing scale | 1 | 1 | 1 | 1 | 1 | 1 | 1 | 1 | 1 | 1 | 1 | 1 | 1 | 1 | 13 |
| 4-2 | Height scale | 1 | 1 | 1 | 1 | 1 | 1 | 1 | 1 | 1 | 1 | 1 | 1 | 1 | 1 | 13 |
| 4-3 | Pediatric height scale,bed type | 1 | 1 | 1 | 1 | 1 | 1 | 1 | 1 | 1 | 1 | 1 | 1 | 1 | 1 | 13 |
| 5 | Refrigerator | 1 | 1 | 1 | 1 | 1 | 1 | 1 | 1 | 1 | 1 | 1 | 1 | 1 | 1 | 13 |
| 7 | Stethoscope | 2 | 2 | 2 | 2 | 2 | 2 | 2 | 2 | 2 | 2 | 2 | 2 | 2 | 2 | 26 |
| 8 | Sphygmomanometer | 2 | 2 | 2 | 2 | 2 | 2 | 2 | 2 | 2 | 2 | 2 | 2 | 2 | 2 | 26 |
| 9 | Diagnostic set | 2 | 2 | 2 | 2 | 2 | 2 | 2 | 2 | 2 | 2 | 2 | 2 | 2 | 2 | 26 |
| 11 | Examination lamp | 1 | 1 | 1 | 1 | 1 | 1 | 1 | 1 | 1 | 1 | 1 | 1 | 1 | 1 | 13 |
| 12 | Suction unit, manual type | 1 | 1 | 1 | 1 | 1 | 1 | 1 | 1 | 1 | 1 | 1 | 1 | 1 | 1 | 13 |
| 14 | Fetal doppler | 1 | 1 | 1 | 1 | 1 | 1 | 1 | 1 | 1 | 1 | 1 | 1 | 1 | 1 | 13 |
| 15 | Resuscitator for infant & adult | 1 | 1 | 1 | 1 | 1 | 1 | 1 | 1 | 1 | 1 | 1 | 1 | 1 | 1 | 13 |
| 16 | O2 flow meter set | 1 | 1 | 1 | 1 | 1 | 1 | 1 | 1 | 1 | 1 | 1 | 1 | 1 | 1 | 13 |
| 22 | Stand by Generator for examination lamp | 1 | 1 | 1 | 1 | 1 | 1 | 1 | 1 | 1 | 1 | 1 | 1 | 1 | 1 | 13 |
| 23 | Boiling sterilizer, gas type | 1 | 1 | 1 | 1 | 1 | 1 | 1 | 1 | 1 | 1 | 1 | 1 | 1 | 1 | 13 |
| 24 | Dressing instrument set for General | 2 | 2 | 2 | 2 | 2 | 2 | 2 | 2 | 2 | 2 | 2 | 2 | 2 | 2 | 26 |
| 25 | Dressing instrument set for Gynecology | 2 | 2 | 2 | 2 | 2 | 2 | 2 | 2 | 2 | 2 | 2 | 2 | 2 | 2 | 26 |
| 26 | Delivery instrument set | 1 | 1 | 1 | 1 | 1 | 1 | 1 | 1 | 0 | 1 | 1 | 1 | 1 | 1 | 12 |
| 27 | Partition | 1 | 1 | 1 | 1 | 1 | 1 | 1 | 1 | 1 | 1 | 1 | 1 | 1 | 1 | 13 |
| 28 | Instrument cabinet | 2 | 2 | 2 | 2 | 2 | 2 | 2 | 2 | 2 | 2 | 2 | 2 | 2 | 2 | 26 |
| 29 | Nebulizer,cell bettery type | 1 | 1 | 1 | 1 | 1 | 1 | 1 | 1 | 1 | 1 | 1 | 1 | 1 | 1 | 13 |
| 31 | Ablution basin | 1 | 1 | 1 | 1 | 1 | 1 | 1 | 1 | 0 | 1 | 1 | 1 | 1 | 1 | 12 |
| 32 | Drip stand | 1 | 1 | 1 | 1 | 1 | 1 | 1 | 1 | 1 | 1 | 1 | 1 | 1 | 1 | 13 |
| 33 | Hemogrobin meter | 1 | 1 | 1 | 1 | 1 | 1 | 1 | 1 | 1 | 1 | 1 | 1 | 1 | 1 | 13 |
| 34 | Gulucose meter | 1 | 1 | 1 | 1 | 1 | 1 | 1 | 1 | 1 | 1 | 1 | 1 | 1 | 1 | 13 |
| 35 | Consulation desk & chair | 1 | 1 | 1 | 1 | 1 | 1 | 1 | 1 | 1 | 1 | 1 | 1 | 1 | 1 | 13 |
| 36 | Stretcher, holding type | 1 | 1 | 1 | 1 | 1 | 1 | 1 | 1 | 1 | 1 | 1 | 1 | 1 | 1 | 13 |

(2) Specifications of the main equipment

As for the main equipment to be procured in this project, the specifications and applications are mentioned in the Table 2-11 "List of Main Equipment".

Table 2-11 List of Main Equipment

| Name of Equipment | Specifications | Quantity | Applications |
|-----------------------------------|--|----------|---|
| Accessory for X-ray apparatus (A) | Composition: X-ray protective apron and gloves, Film mark set, Dark room lamp, Exhaust fan, etc. | 4 | This is an accessory set necessary for roentgenograph and development of roentgenogram, including X-ray protective supplies and Dark room lamp. |
| Accessory for X-ray apparatus (B) | Composition: X-ray protective apron and gloves, X-ray protective door and screen, Film mark set, Dark room lamp, Exhaust fan, etc. | 1 | This is an accessory set necessary for protect, roentgenograph, and development of roentgenogram, including X-ray protective supplies, door and Dark room lamp. |
| Ambulance | Composition: Sphygmomanometer, Stethoscope, Resuscitator, Oxygen flowmeter, Suction machine, stretcher, etc. | 5 | It is a vehicle mainly used for the referral of patient between a clinic and a hospital. This vehicle carries a basic kit for first aid. |
| Autoclave high pressure | Capacity: 150 L or more Sterilizing temperature: 132 °C or more Provided with steam generator Attachments: feed water filter | 4 | It is used for sterilization of operating gowns and surgical forceps with high-pressure steam. |
| Bedside monitor | Parameter: ECG, respiration rate, temperature, HR, SpO ₂ , NIBP Provided with cart | 18 | It is used to monitor the vital sign of the serious patients, and to record the condition of such patients. In critical condition, it issues the warning to doctors and nurses with alarm. |
| Defibrillator | Output : 2~360J or wider Monitor: 5 inch or more Buttery charger: built-in Power: DC, AC With Paddle for adults and pediatrics | 13 | It is used for resuscitation of the patient in cardiac arrest. This equipment gives countershock with direct current for the ventricular fibrillation, and it stimulates the patient to recover the original rhythm of his heartbeat. |

| Name of Equipment | Specifications | Quantity | Applications |
|------------------------------------|---|----------|---|
| Dental chair unit | Dental unit: hydraulic control Doctor's chair Compressor | 3 | It is used for treatment of the oral diseases, such as dental caries and periodontal disease. |
| Electrosurgical unit | Function: Bipolar Output: Coagulation 100W or more, Cutting 250W or more, Mix 200W or more, Bipolar 18W or more Foot switch | 6 | It is used in the operation, in which hemostatic incision and coagulation are performed on the tissue of patient. It is especially fit to use for the operation on the region with many fine blood vessels. |
| Instrument set for general surgery | Composition: Sponge forceps, scalpel control handle and other instrument set | 10 | This is a set of surgical instruments used for general operation and emergency operation. |
| Operating theatre table | Type: hydraulic and manual operation Table top: 1900(L)×450(W)mm or wider Adjustable height: 720~1,000mm or wider Trendelenburg: ±25° or more Lateral tilting: ±20° or more | 3 | By adjusting the table height and angle according to the operation method and the operation region, the patient can be placed at the most suitable position for ease and safety of the operation. This is essential equipment in the operating theatre. |
| Traction unit | Traction: 900N at the max Traction mode: 3 types or more Safety function: with emergency shut down switch | 2 | This is basic equipment in Physiotherapy, used for traction of cervical vertebra and lumbar vertebra. |

| Name of Equipment | Specifications | Quantity | Applications |
|------------------------|---|----------|---|
| Ultrasound scanner | Method: electronic scanning Display mode: B, M, B/M Monitor: 12-inch/black & white Connection of probe: 2 or more Image Memory: provided Probe: Convex, Linear, Transvaginal | 4 | It enables the doctors to make imaging diagnostic of the patient by detecting and observing the echoes on the abdominal region. |
| X-ray apparatus | X-ray tube voltage: 150KV X-ray tube electric current: 500 mA or more Composition: X-ray generator, X-ray tube, Bucky table, and Bucky stand | 5 | It is a general-purpose apparatus that also enables to take a plain X-ray photograph of the skeleton, chest, abdomen and soft tissues. |
| X-ray apparatus-mobile | Inverter type: high voltage unit Tube voltage range: 40~125kv mAs range: up to 125mAs or more X-ray tube focus size: 0.7~1.0mm | 3 | It is used in serious cases of the patients who are too infirm to move to the X-ray room for examination. The whole body is the subject of X-ray examination. |
| Pediatric monitor | Parameter: ECG, respiration rate, temperature, HR, SpO ₂ , NIBP Provided with cart | 5 | It is used to monitor the vital sign of the Pediatric in a serious condition, and to record the condition of such patients. In critical condition, it issues the warning to doctors and nurses with alarm. |
| Mobile Clinic | Composition: Medical examination table, Refrigerator for drugs, Sphygmomanometer, Stethoscope, Hanger stand, etc. | 6 | It is used to diagnosis and to treatment for the people in remote places that can't be serviced by clinics. It is a 4WD vehicle that is furnished with a medical examination table and a refrigerator for drugs and loaded with the medical equipment such as stethoscope and sphygmomanometer. |

(3) Allocation plan of the equipment

The equipment requiring installation works is such as autoclave high pressure, dental unit and X-ray apparatus.

The layout plan is shown for the project facilities as follows.

Canzibe Hospital

Establishment 1962

Structure of the building Brick

Electricity voltage 3 400V 1 220V 50Hz

Actual 3 383V 1 221V 50Hz

Electricity failure 2~3times/month 4h/time

Emergency power supply Diesel Generator

Capacity 140 KVA

Water supply Water service by water treatment system in the site

Drainage system Sewage treatment in the site

Solid waste disposal Incineration in the site

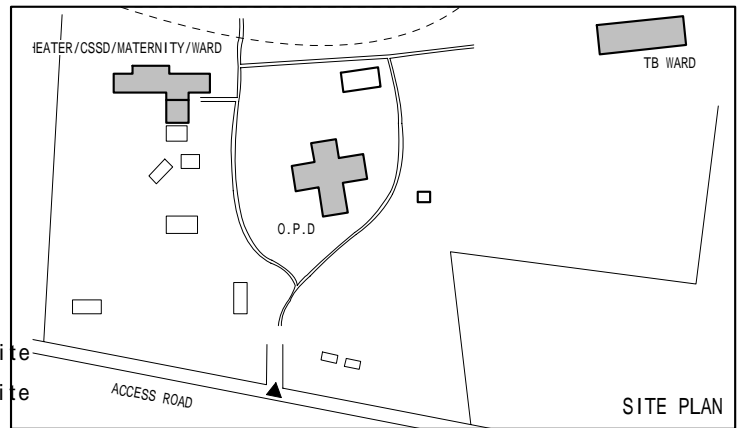
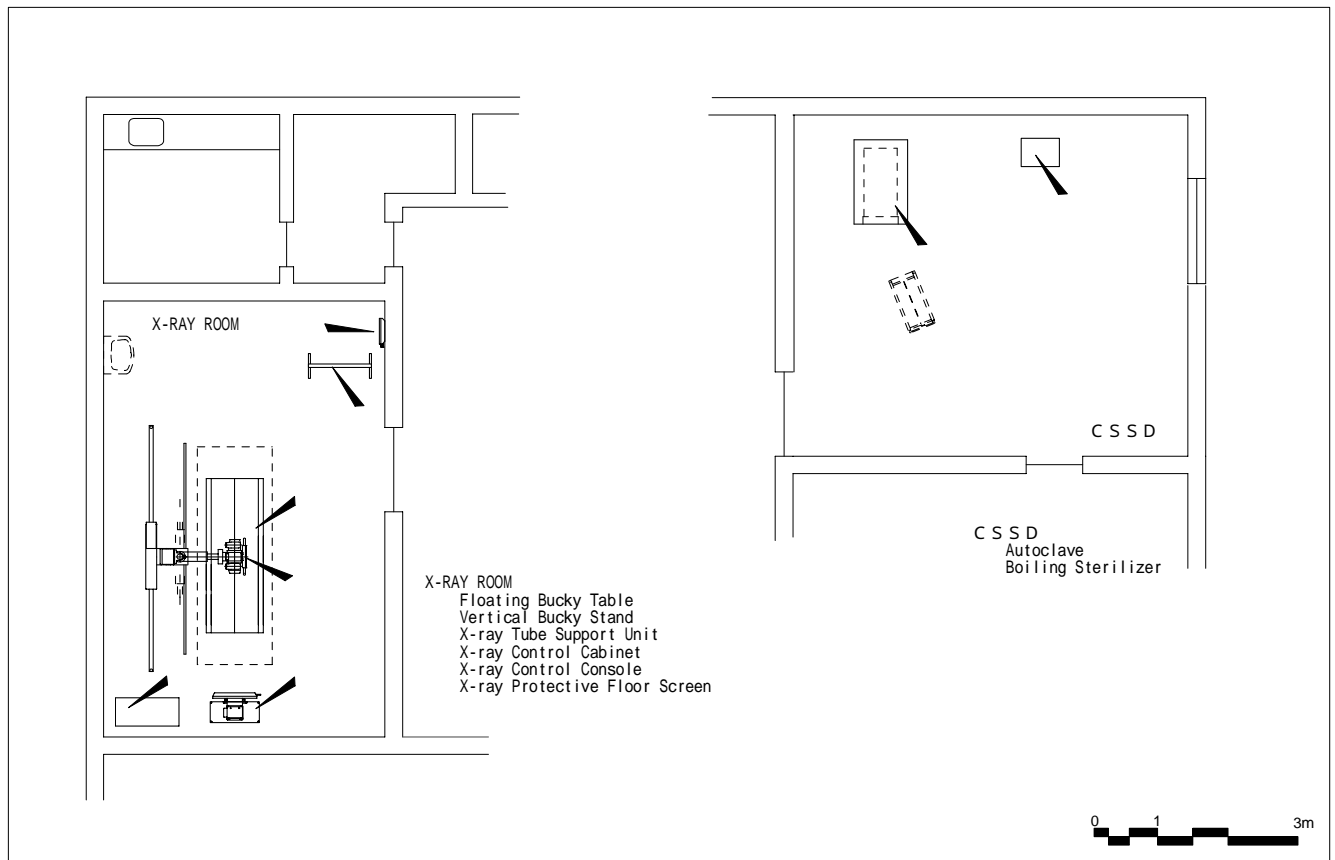

Figure 2-1-1 Layout Drawing for Equipment



St. Barnabas Hospital

Establishment

Structure of the building Brick/RC

Electricity voltage 3 400V 1 220V 50Hz

Actual 3 390V 1 229V 50Hz

Electricity failure 4 times/month 2h/time

Emergency power supply Diesel Generator

Capacity 175 KVA

Water supply Water service by water

treatment system in the site

Drainage system Sewage treatment in the site

Solid waste disposal Incineration in the site

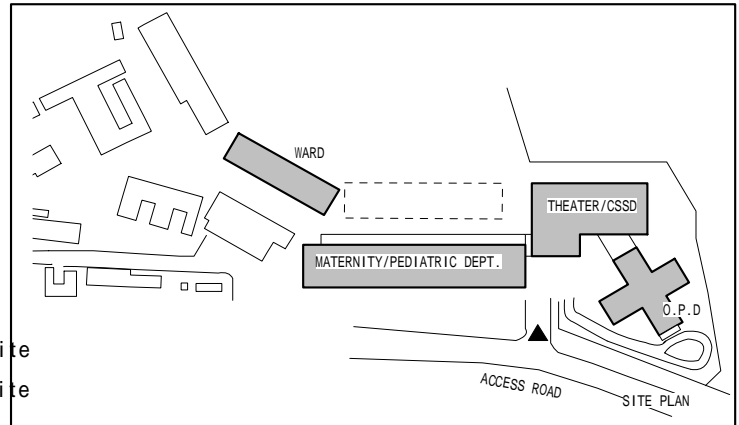
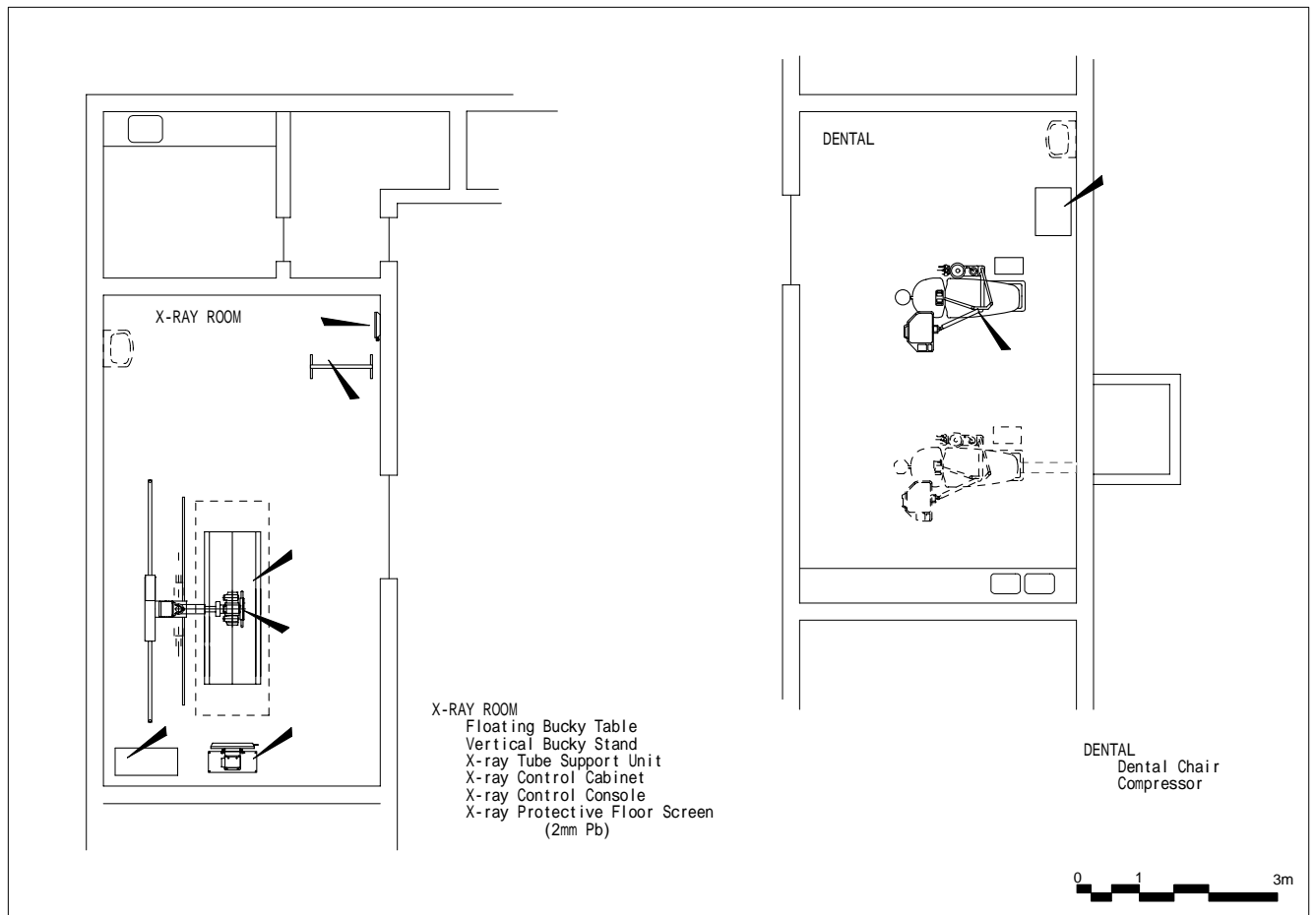

Figure 2-1-2 Layout Drawing for Equipment



Nessie Knight Hospital

Establishment 1928

Structure of the building Brick

Electricity voltage 3 400V 1 220V 50Hz

Actual 3 410V 1 236V 50Hz

Electricity failure 1 times/month 24h/time

Emergency power supply Diesel Generator

Capacity 140 KVA

Water supply Water service by water

treatment system in the site

Drainage system Sewage treatment in the site

Solid waste disposal Incineration in the site

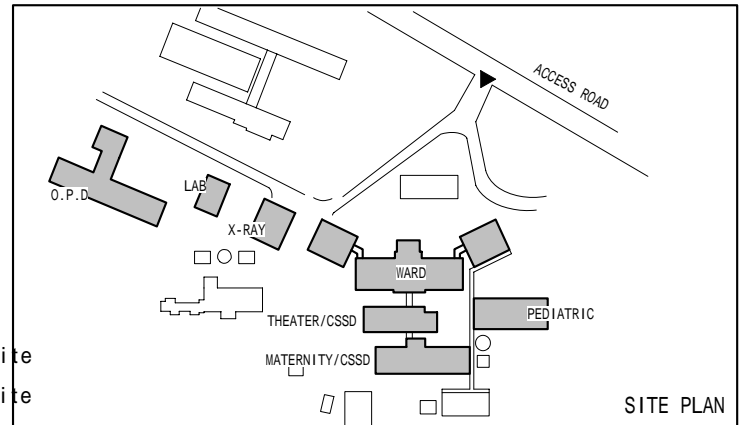
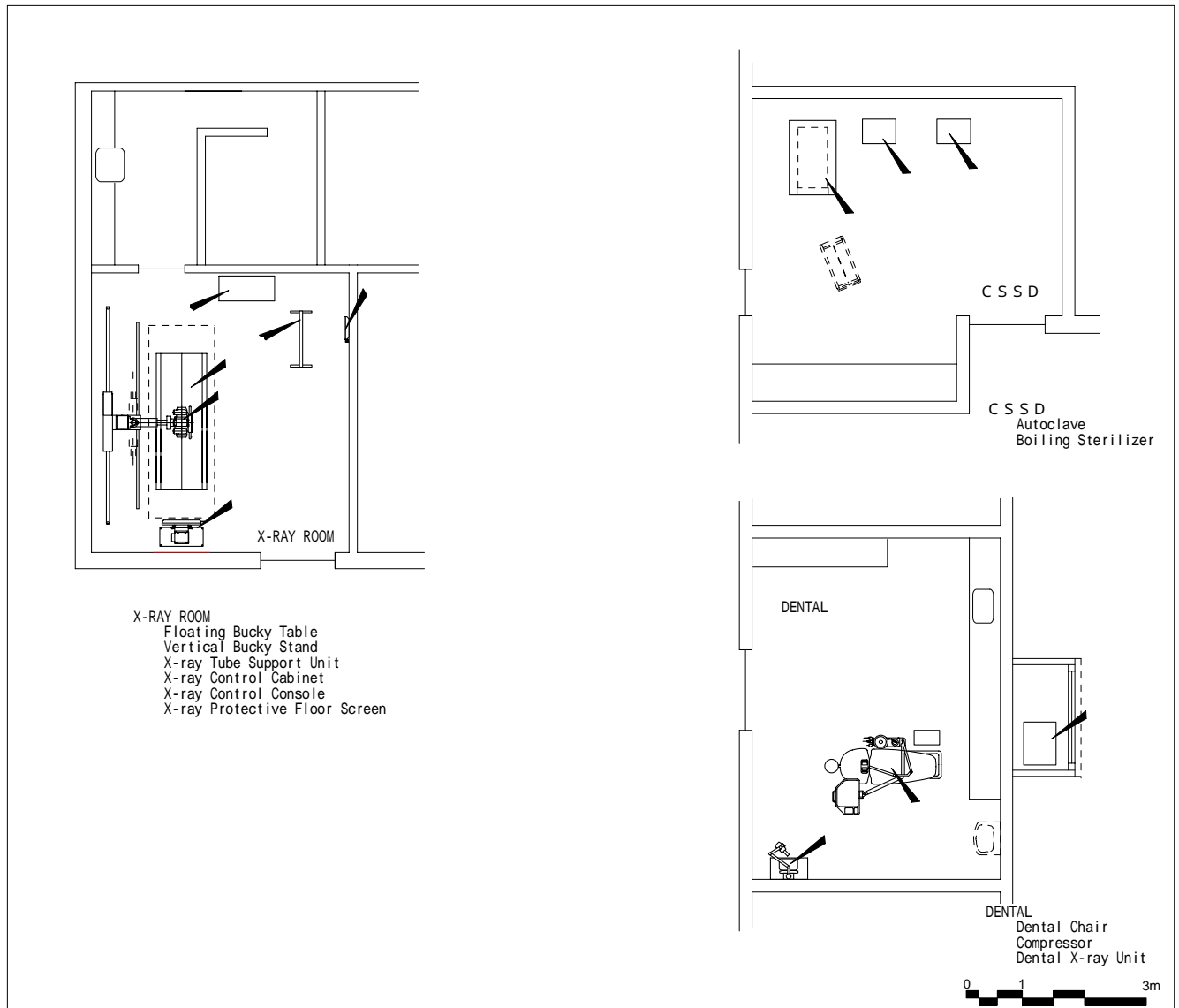

Figure 2-1-3 Layout Drawing for Equipment



St. Lucy's Hospital

Establishment 1906

Structure of the building Brick

Electricity voltage 3 400V 1 220V 50Hz

Actual 3 385V 1 223V 50Hz

Electricity failure 4 times/month 10h/time

Emergency power supply Diesel Generator

Capacity 80 KVA

Water supply Water service by water treatment system in the site

Drainage system Sewage treatment in the site

Solid waste disposal Incineration in the site

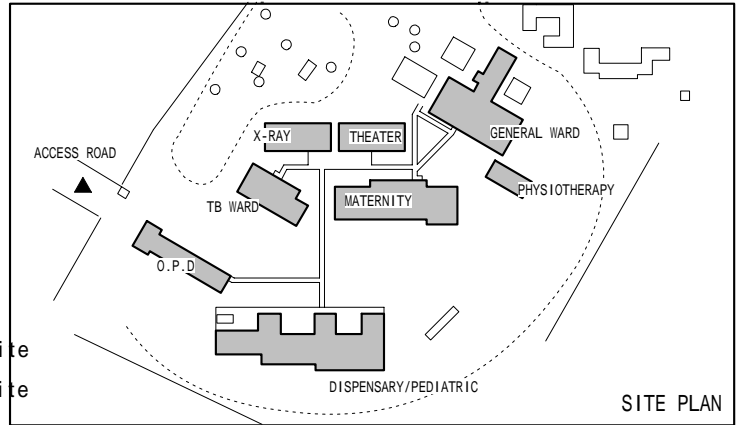
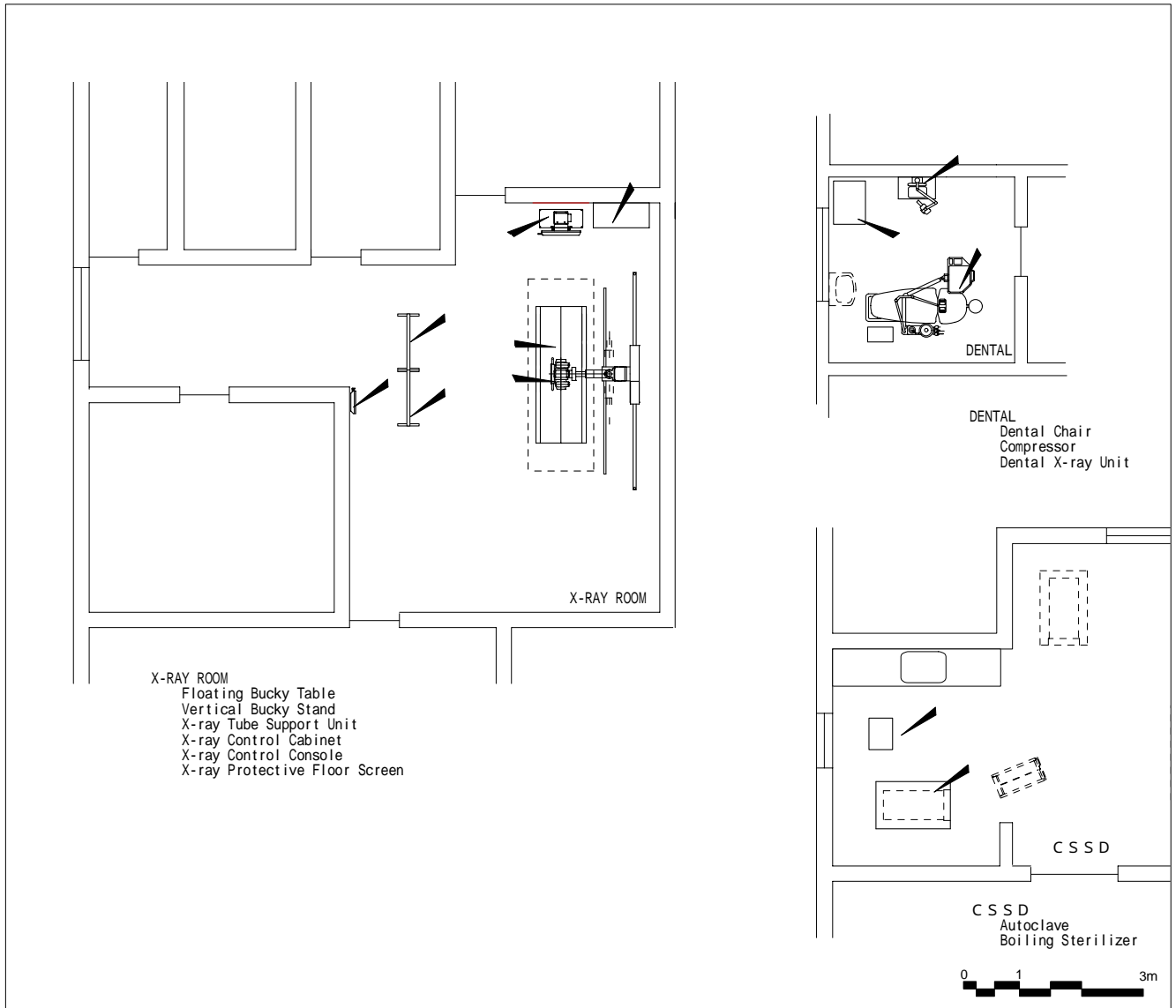

Figure 2-1-4 Layout Drawing for Equipment



Zithulele Hospital

Establishment 1963

Structure of the building Brick

Electricity voltage 3 400V 1 220V 50Hz

Actual 3 390V 1 225V 50Hz

Electricity failure -

Emergency power supply Diesel Generator

Capacity 175 KVA

Water supply Water service by water

treatment system in the site

Drainage system Sewage treatment in the site

Solid waste disposal Incineration in the site

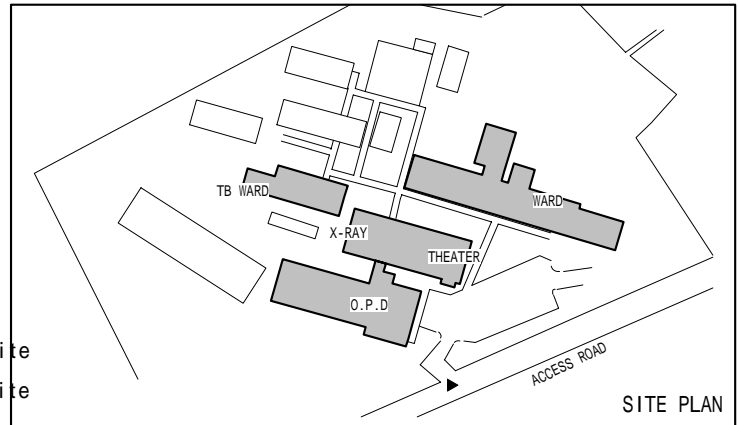
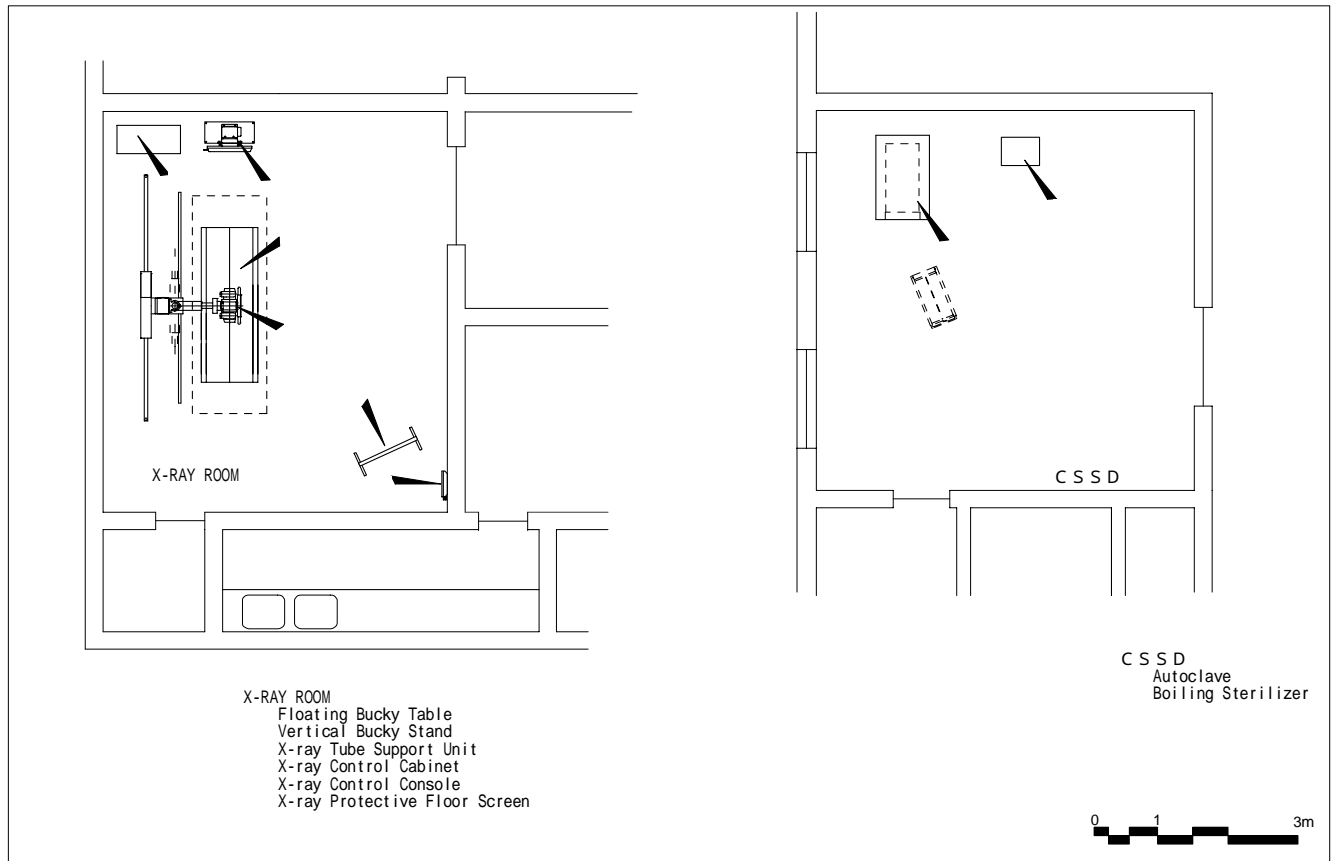

Figure 2-1-5 Layout Drawing for Equipment



2-2-4 Implementation Plan

2-2-4-1 Implementation Policy

This project shall be implemented officially in accordance with the Grant Aid framework of the Government of Japan after approval by both Japanese and South African governments and conclusion of the Exchange of Notes (E/N). Before implementation, a consultant who is a Japanese corporation representative is selected by the South African side, and the consultant shall commence work for approval of tender documents for the equipment procurement. After completion of the tender documents, tenders are invited. A Japanese trading company, selected as a result of the tender, shall implement the actual work of procurement, disposition and installation of the equipment. The consultant agreement and the supply contract shall come into effect after verification by the Government of Japan.

This project should be carried out in accordance with Japan's Grant Aid. The implementation plan of this project is elaborated considering the following points.

- (1) The work schedule should be confirmed by both the Japanese and South African staff in charge. Both sides should clarify the scope of works and the starting and completion dates of each task in order to avoid confusion over mutual tasks.
- (2) In order to shorten the work period as much as possible, the consultant and the supplier should investigate the project facilities by 2 months before installation of the equipment. They should also check the delivery routes, power supply, water supply and drainage, and they should prepare a bring-in schedule.
- (3) It is expected to take about 2 months for installation and hand-over.
- (4) For equipment requiring technical support (X-ray apparatus, Ultrasound apparatus, autoclave high pressure, and other electromedical equipment), instruction for operation shall be given by a sales engineer of each equipment manufacturer or the authorized agent.
- (5) For equipment to be procured from Japan, instruction for operation shall be given by a Japanese engineer or a sales engineer (of the authorized agent) specializing in electric equipment or general medical equipment.
- (6) The competent authority in charge of implementation of this project is the National Department of Health, and the office in charge is the International Health Liaison. The observatory agency is the Eastern Cape Province Department of Health. The project facilities are the medical facilities located in the 3 sub-districts (KSD district, Mhlontlo district and Nyandeni district) in the Oliver Tambo District of the Eastern Cape Province.

The following is the organ responsible to the work execution in each stage.

| Business Outline | Organ Responsible to the Work Execution |
|----------------------------|--|
| Exchange of Notes (E/N) | National Department of Health |
| Authorization to Pay (A/P) | Eastern Cape Province Department of Health |
| Consultant Contract | Eastern Cape Province Department of Health |
| Tendering | Eastern Cape Province Department of Health |
| Supply Contract | Eastern Cape Province Department of Health |
| Work Execution | Eastern Cape Province Department of Health |
| Delivery | Eastern Cape Province Department of Health |

2-2-4-2 Implementation Conditions

The project facilities are the medical facilities currently under operation. Considering this situation, the implementation schedule should not disturb their daily activities. Meeting should be held with the project facilities about the disposition plan of the equipment to confirm the schedule of carrying in, the delivery routes, and the distribution of the equipment.

2-2-4-3 Scope of Works

The scope of responsibility of the Japanese side in accordance with the Grant Aid Scheme of this project covers procurement and subsequent disposition of the medical equipment to the 5 district hospitals, the 6 health centers, the 83 clinics and six 6 mobile units disposed in the district hospitals. The scope is limited to those described below.

- ① The equipment shown in the aforementioned equipment list
- ② The expenses for ocean transport, land transport and inland transport to the project facilities
- ③ The expenses for installation of the equipment (expenses for dispatching engineers, local workers, tools and measuring instruments)
- ④ The expenses for setting-up, the test-run, and the expenses for guidance on operation, inspection and maintenance management, for all the equipment to be procured.

2-2-4-4 Consultant Supervision

(1) Implementation system

This project shall be implemented by the following 3 parties.

① Project implementing bodies

The observatory agency is the Department of Health of the Eastern Cape Province

in South Africa. The responsible agency is the sub-district health offices of Nyandeni, Mhlontlo and KSD in the Oliver Tambo District. The project sites are 94 medical facilities in total.

② Consultant

Since this project is implemented under Japan's Grant Aid Program, it is stipulated by its rule that a Japanese consultant gives instructions, advises and coordinates from a fair standpoint throughout the tender and the implementation, according to the agreement with the responsible agent of South Africa. In addition, the consultant performs necessary work for smooth implementation of the project.

The specific tasks are as follows:

- Approval of tender documents

Preparation of tender documents for procurement of the equipment (documents of tender conditions, equipment specifications, and budget report)

- Promotion of tender and supply contract

Decision about the supply contract system, preparation of a draft of the supply contract, content analysis of the report on equipment installation works, and selection of supplier (public announcement of tender, tender, tender evaluation, contract negotiation, and contract witnessing)

- Inspection and approval of the working plan

Inspection and approval of the equipment specifications and the working procedure submitted by the supplier

- Report on the work progress

Supervision of progress of work execution, and report on the progress to the project-implementing bodies and related organizations

- Cooperation in approval procedures for payment

Content analysis of the bills to the remuneration to be paid after the shipment, and cooperation in these procedures

- Consulting work

Witness to various works from the beginning through the completion of the project

③ Supplier

The Procurement of the equipment shall be implemented by the Japanese supplier (trading company) who makes a successful bid. The supplier, based upon the contract with the South African side, is responsible for manufacture, supply, delivery and set-up of the equipment, and gives instructions for equipment operation and maintenance to the South African side before hand-over.

The following is a flow chart of the implementation system.

Implementation Flow Chart

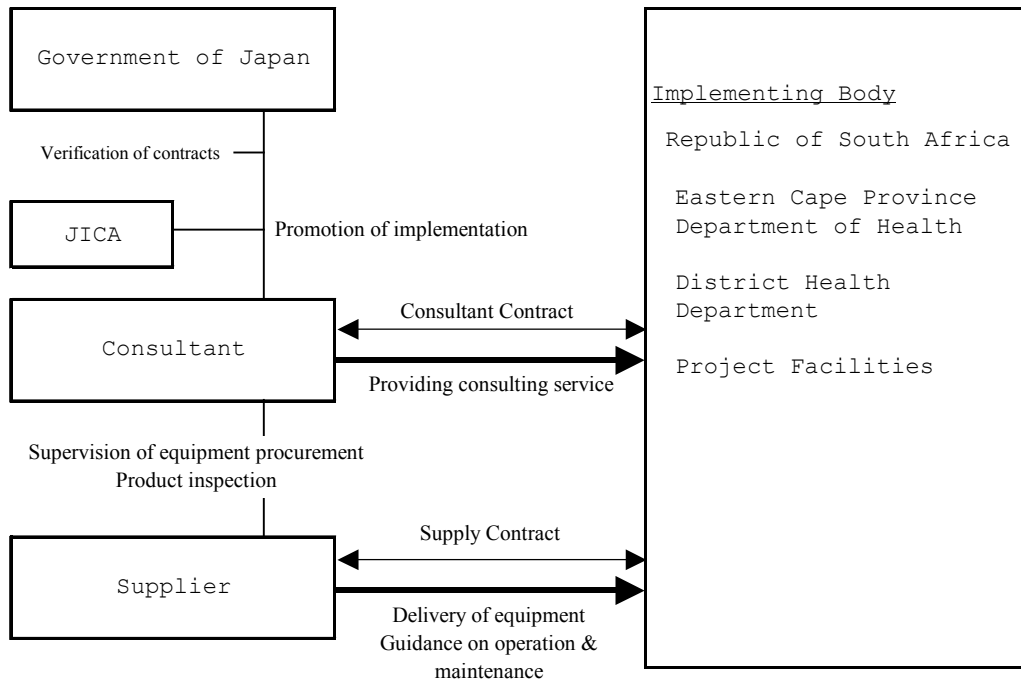

(2) Implementation design and supervision

The consultant, based on the agreement with the South African side, performs implementation design and supervision of the project. In the implementation design, detailed specifications of the equipment are determined based on the basic design study, and the tender documents are prepared comprising these specifications, tender conditions and a draft of the supply contract, etc.

"Supervision" indicates assuring that the work of the supplier is implemented in accordance with the contract, fairly giving instructions and advice, and coordinating to promote the project.

① Stage of implementation design

reparation of tender documents, preparation for tender, and execution of a written contract

② Stage of tender

Prior screening of the qualifications of the prospective tenderer, opening of tender, evaluation of tender, and conclusion of contract

③ Stage of work execution

Supervision of work execution (inspection and approval of the equipment specifications; supervision of shipment, ocean transport and inland transport; instruction and supervision of installation; and supervision of work to be borne by the recipient country), report on the work progress, and issuance of certificates (upon confirming that the equipment installation is completed and the contract conditions are complied with, the consultant witnesses the hand-over of the equipment and completes his/her duty by obtaining acknowledgement of receipt of the equipment from the South African side.)

In addition to the above-mentioned work, the consultant reports on the work progress, payment procedures, completion of delivery, etc., to those concerned of the Government of Japan.

(3) Personnel plan

Those who are engaged in the consulting work as to the implementation design and supervision of the work execution are as follows:

- Project Manager (Japanese consultant): 1 person
- Medical Equipment Planner I (Japanese consultant): 1 person
- Medical Equipment Planner II (Japanese consultant): 1 person

2-2-4-5 Procurement Plan

(1) Procurement of equipment

The equipment to be procured in this project shall be restricted to those to be procured from Japan or South Africa in the E/N. The equipment is selected considering the reliability of the delivery schedule and the appropriateness of procurement costs.

The equipment applied to some of the following conditions shall be procured from a third country.

- ① The equipment to be procured is not manufactured in Japan.
- ② While the equipment is manufactured in Japan, competitiveness is not expected in tender, and fairness of tender may not be secured by restricting the procurement source to Japan.
- ③ If the equipment is restricted to the Japanese product, the transportation costs are very expensive, lessening the effect of aid. Alternatively, the equipment manufacturer and the local agent do not have their own maintenance network, and the equipment cannot be maintained properly. This may lessen the effect of the project.
- ④ There are unavoidable circumstances, such as urgency of procurement.

(2) Transportation of the equipment

The equipment to be procured from a third country shall be transported by sea to the port of Durban in South Africa. After all the shipments pass the custom at this port, then transported to each project facility by land. In order to avoid miscarriage, the equipment shall be packed into a wooden box or a container site by site.

2-2-4-6 Implementation Schedule

(1) Implementing process

When this project is approved in the Cabinet meeting of the Government of Japan and the Exchange of Notes (E/N) is concluded between both countries, the project shall be conducted according to the following procedures:

1. Conclusion of the Exchange of Notes between both relevant governments
2. Conclusion of agreement between the responsible agency and a bank in Japan on payment of the Japan's Grant Aid for implementation of this project (Banking Arrangement; B/A)
3. Conclusion of the consultant agreement between the responsible agency and the consultant of Japanese nationality
4. Issuance of the Authorization to Pay (A/P) by the responsible agency according to the consultant agreement
5. Verification of the above contract by the Government of Japan
6. Preparation of tender documents by the consultant
7. Approval of the tender documents by the responsible agency and preparation for tendering by the consultant
8. Implementation of tender, and assessment of tender
9. Conclusion of supply contract between the responsible agency and the Japanese supplier
10. Verification of the above contract by the Government of Japan.
11. Issuance of the Authorization to Pay (A/P) by the responsible agency according to the supply contract
12. Approval to manufacture of equipment, and approval of the working plan.
(The consultant examines and approves the equipment specifications submitted by the supplier, provides necessary instruction, and coordinates for smooth implementation of the project by maintaining close contact with the Department of Health, the Government of Eastern Cape Province)
13. Witnessing for equipment inspection
(The consultant witnesses factory inspection before shipment, if necessary, and approves the inspection on behalf of the Department of Health, the Government of Eastern Cape Province)

14. Installation conditions, distribution plan of the equipment, and adjustment of the work schedule

15. Supervision of work execution

(In accordance with the contract, the consultant, as the proxy of the Department of Health, the Government of Eastern Cape Province, conducts examination and approval of the equipment specifications, examination and approval of equipment, supervision and instruction of inland-transport, and supervision of the works covered by the recipient country)

16. Progress control

(The consultant supervises work progress and gives necessary instruction to the supplier so that the supply contract may be completed within the period stated in the Exchange of Notes)

17. Complete survey and test run

(The consultant performs a final inspection and test-run to the equipment to be procured, confirms that the performance is as described in the specifications, and submits a certificate of completion of inspection to the Department of Health, the Government of Eastern Cape Province)

18. Hand-over of the equipment

19. Completion of the Project

(2) Period of implementation

After conclusion of the Exchange of Notes, the period required for each task on the Japanese side is as follows:

Table 2-12 Period of Implementation and Content of Work

| Content of Work | Work Period |
|---|-------------|
| 1. Confirmation of a draft of tender documents | 1.0 |
| 2. Approval to tender documents | 0.7 |
| 3. Tendering, conclusion of contract, and approval of supply contract | 2.5 |
| 4. Manufacture of equipment | 4.0 |
| 5. Delivery | 1.8 |
| 6. Installation (including trial operation, adjustment, operator training, guidance on maintenance management, verification of completion of hand-over, etc.) | 2.0 |
| TOTAL | 12.0 months |

The work progress chart is as follows:

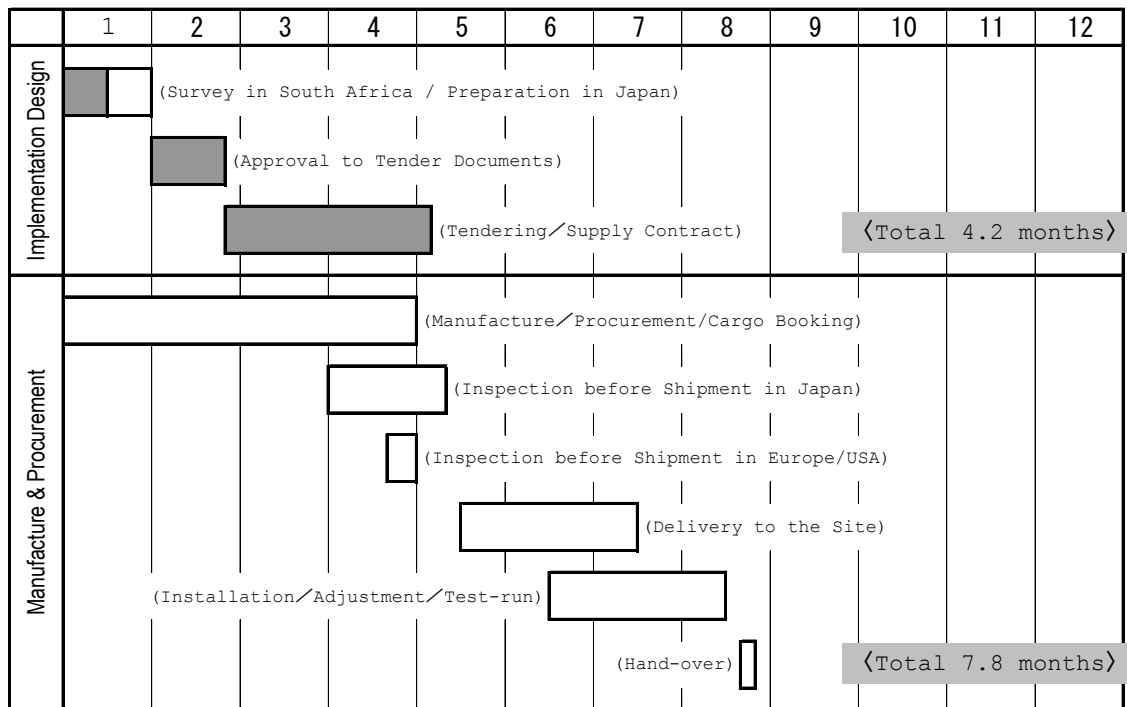

Figure 2-2 Work Execution

2-3 Obligations of Recipient Country

For the implementation of this project, the South African side is required to undertake the following measures:

Items to be covered by the South African side are as follows.

- (1) During the implementation period of the project, the South African side should find a place to be used as a temporary office in each designated facility for this project.
- (2) The peripheral foundations (supply of electricity and water supply, drainage, and other facilities) necessary for this project should be prepared and supplied before distribution of the equipment. In addition, the existing equipment should be removed from places where the new equipment will be installed before the distribution.
- (3) The equipment imported for this project should be unloaded without delay, and necessary measures for customs clearance and inland transportation of the equipment should be taken. Tax exemption certificates should be arranged before arrival of containers at Durban in South Africa.
- (4) Payments of customs duties and other taxes should be exempted for the Japanese nationals who stay in South Africa to fulfill their mission in this project.
- (5) For the Japanese nationals who participate in the supply of the necessary equipment and who participate in implementation of this project, necessary conveniences for their stay in South Africa be provided and sufficient consideration made for their security.
- (6) In accordance with the Banking Arrangement (B/A), the South African side should pay the banking commission and the commission for the issuance of the Authorization to Pay into the authorized bank in Japan.
- (7) The equipment to be procured under the Japan's Grant Aid should be maintained properly and used effectively. For this purpose, necessary budget and personnel should be secured.
- (8) The South African side should bear the cost of preparatory works of strengthening of the floor of the X-ray room, and renovation of the ICU and the dental clinic for Nessie Knight Hospital, St. Lucy's Hospital and Canzibe Hospital before installation of the equipment.
- (9) The equipment to be procured under the Japan's Grant Aid should be maintained properly and used effectively. And confirmation should be made of the utilization and condition of the equipment.
- (10) For implementation of this project, all the expenses other than those covered by Japan's Grant Aid should be borne by the South African side.

2-4 Project Operation Plan

In this project, procurement of all equipment is made as renewal or supplementation of the equipment that is now in service at the project facilities. Therefore, it is judged that there will be no problem in the maintenance management.

Maintenance work is now entrusted to the outsourcing which is used the manufacturer or the authorized agent of the equipment.

Therefore, conclusion of an overall contract on maintenance is compulsory as to the main equipment such as X-ray apparatus, sterilizer, and other electro-medical apparatuses. The Department of Health, the Government of Eastern Cape Province is required to secure the annual budgetary allocation for the expenses for maintenance contract.

In addition, it is desirable that the Department of Health establishes the own maintenance workshops with engineers & artisans in this district.

The equipment to be procured in this project, which is required an annual maintenance service, and such expenses (trial calculation) are as follows.

Table 2-13 Annual Cost for Maintenance Service

Canzibe Hospital

| Equipment | Q'ty | Unit Cost of Maintenance | Condition of Maintenance Service Contract | Annual Contract Cost |
|--------------------------|------|--------------------------|---|----------------------|
| Bedside monitor | 4 | ¥40,000 | On-call services. Engineering fee only. | 160,000 |
| Pediatric monitor | 1 | ¥37,000 | On-call services. Engineering fee only. | 37,000 |
| ECG Machine | 3 | ¥8,000 | On-call services. Engineering fee only. | 24,000 |
| Defibrillator | 2 | ¥37,000 | On-call services. Engineering fee only. | 74,000 |
| Ultrasound apparatus | 0 | ¥400,000 | Periodical maintenance for each 6 months including on-call services. Engineering fee only. | 0 |
| X-ray apparatus | 1 | ¥750,000 | Periodical maintenance for each 6 months including on-call services. Engineering fee only. | 750,000 |
| X-ray apparatus - mobile | 1 | ¥300,000 | Periodical maintenance for each 6 months including on-call services. Engineering fee only. | 300,000 |
| Autoclave high pressure | 1 | ¥183,000 | Periodical maintenance for each 6 months including on-call services. Engineering fee only. | 183,000 |
| TOTAL (JPY) | | | | 1,528,000 |
| TOTAL (ZAR 1 = JPY 15) | | | | 101,867 |

St. Barnabas Hospital

| Equipment | Q'ty | Unit Cost of Maintenance | Condition of Maintenance Service Contract | Annual Contract Cost |
|--------------------------|------|--------------------------|---|----------------------|
| Bedside monitor | 2 | ¥40,000 | On-call services. Engineering fee only. | 80,000 |
| Pediatric monitor | 1 | ¥37,000 | On-call services. Engineering fee only. | 37,000 |
| ECG Machine | 5 | ¥8,000 | On-call services. Engineering fee only. | 40,000 |
| Defibrillator | 3 | ¥37,000 | On-call services. Engineering fee only. | 111,000 |
| Ultrasound apparatus | 1 | ¥400,000 | Periodical maintenance for each 6 months including on-call services. Engineering fee only. | 400,000 |
| X-ray apparatus | 1 | ¥750,000 | Periodical maintenance for each 6 months including on-call services. Engineering fee only. | 750,000 |
| X-ray apparatus - mobile | 1 | ¥300,000 | Periodical maintenance for each 6 months including on-call services. Engineering fee only. | 300,000 |
| Autoclave high pressure | 0 | ¥183,000 | Periodical maintenance for each 6 months including on-call services. Engineering fee only. | 0 |
| TOTAL (JPY) | | | | 1,718,000 |
| TOTAL (ZAR 1 = JPY 15) | | | | 114,533 |

Nessie Knight Hospital

| Equipment | Q'ty | Unit Cost of Maintenance | Condition of Maintenance Service Contract | Annual Contract Cost |
|--------------------------|------|--------------------------|---|----------------------|
| Bedside monitor | 4 | ¥40,000 | On-call services. Engineering fee only. | 160,000 |
| Pediatric monitor | 1 | ¥37,000 | On-call services. Engineering fee only. | 37,000 |
| ECG Machine | 5 | ¥8,000 | On-call services. Engineering fee only. | 40,000 |
| Defibrillator | 3 | ¥37,000 | On-call services. Engineering fee only. | 111,000 |
| Ultrasound apparatus | 1 | ¥400,000 | Periodical maintenance for each 6 months including on-call services. Engineering fee only. | 400,000 |
| X-ray apparatus | 1 | ¥750,000 | Periodical maintenance for each 6 months including on-call services. Engineering fee only. | 750,000 |
| X-ray apparatus - mobile | 0 | ¥300,000 | Periodical maintenance for each 6 months including on-call services. Engineering fee only. | 0 |
| Autoclave high pressure | 1 | ¥183,000 | Periodical maintenance for each 6 months including on-call services. Engineering fee only. | 183,000 |
| TOTAL (JPY) | | | | 1,681,000 |
| TOTAL (ZAR 1 = JPY 15) | | | | 112,067 |

St. Lucy's Hospital

| Equipment | Q'ty | Unit Cost of Maintenance | Condition of Maintenance Service Contract | Annual Contract Cost |
|-------------------|------|--------------------------|--|----------------------|
| Bedside monitor | 4 | ¥40,000 | On-call services. Engineering fee only. | 160,000 |
| Pediatric monitor | 1 | ¥37,000 | On-call services. Engineering fee only. | 37,000 |
| ECG Machine | 5 | ¥8,000 | On-call services. Engineering fee only. | 40,000 |
| Defibrillator | 3 | ¥37,000 | On-call services. Engineering fee only. | 111,000 |

| | | | | |
|--------------------------|---|----------|---|-----------|
| Ultrasound apparatus | 1 | ¥400,000 | Periodical maintenance for each 6 months including on-call services. Engineering fee only. | 400,000 |
| X-ray apparatus | 1 | ¥750,000 | Periodical maintenance for each 6 months including on-call services. Engineering fee only. | 750,000 |
| X-ray apparatus - mobile | 1 | ¥300,000 | Periodical maintenance for each 6 months including on-call services. Engineering fee only. | 300,000 |
| Autoclave high pressure | 1 | ¥183,000 | Periodical maintenance for each 6 months including on-call services. Engineering fee only. | 183,000 |
| TOTAL (JPY) | | | | 1,981,000 |
| TOTAL (ZAR 1 = JPY 15) | | | | 132,067 |

Zithulele Hospital

| Equipment | Q'ty | Unit Cost of Maintenance | Condition of Maintenance Service Contract | Annual Contract Cost |
|--------------------------|------|--------------------------|---|----------------------|
| Bedside monitor | 4 | ¥40,000 | On-call services. Engineering fee only. | 160,000 |
| Pediatric monitor | 1 | ¥37,000 | On-call services. Engineering fee only. | 37,000 |
| ECG Machine | 4 | ¥8,000 | On-call services. Engineering fee only. | 32,000 |
| Defibrillator | 2 | ¥37,000 | On-call services. Engineering fee only. | 74,000 |
| Ultrasound apparatus | 1 | ¥400,000 | Periodical maintenance for each 6 months including on-call services. Engineering fee only. | 400,000 |
| X-ray apparatus | 1 | ¥750,000 | Periodical maintenance for each 6 months including on-call services. Engineering fee only. | 750,000 |
| X-ray apparatus - mobile | 0 | ¥300,000 | Periodical maintenance for each 6 months including on-call services. Engineering fee only. | 0 |
| Autoclave high pressure | 1 | ¥183,000 | Periodical maintenance for each 6 months including on-call services. Engineering fee only. | 183,000 |
| TOTAL (JPY) | | | | 1,636,000 |
| TOTAL (ZAR 1 = JPY 15) | | | | 109,067 |

As the above tables show, it is estimated for the annual budgetary allocation for the maintenance contract in each project facility at 1.5~2 million yen.

2-5 Project Cost Estimate

2-5-1 Project Cost estimate

The project cost necessary for implementation of this project by the Japan's Grant Aid shall be about 1,034 million yen (expenses borne by the Japan's side: 1,033 million yen, expenses borne by the South African side: 1 million yen).

This cost estimate is provisional and would be further examined by the Government of Japan for the approval of the Grant.

(1) Estimating Conditions

1. Estimating Condition : July, 2003
2. Exchange Rate : US\$ 1 = JPY 119.71
ZAR 1 = JPY 16.74
3. Work Period : The work period shall be about twelve (12) months for the implementation design, and procurement and installation of the equipment.
4. Others : This project shall be implemented in accordance with the Grant Aid framework of the Government of Japan.

(2) Expenses borne by the Japan's side

Approximately 1,033 million yen

| Account Description | | Rough Estimate of the Operating Cost (million yen) | | |
|--|-------------------|--|-----|-----|
| Equipment | Hospitals | Canzibe Hospital | 81 | 448 |
| | | Nessie Knight Hospital | 96 | |
| | | St. Barnabas Hospital | 85 | |
| | | St. Lucy's Hospital | 100 | |
| | | Zithulele Hospital | 86 | |
| | Nyndeni District | Health Centres | 0 | 144 |
| | | Clinics | 127 | |
| | | Mobile Clinics | 17 | |
| | Mhlontlo District | Health Centres | 28 | 157 |
| | | Clinics | 112 | |
| | | Mobile Clinics | 17 | |
| | KSD District | Health Centres | 56 | 240 |
| | | Clinics | 167 | |
| | | Mobile Clinics | 17 | |
| Implementation Design, Supervision of Procurement and Technical Guidance | | 44 | | |

(3) Expenses borne by the South African side

Table 2-14 Description of Work and Cost

| Project Facility | Content of Work | Cost (JPY) |
|------------------------|--------------------------------------|----------------------------|
| Nessie Knight Hospital | Rebasing Work for X-ray Room | ¥100,000 |
| St. Lucy's Hospital | Renovation for ICU and Dental Clinic | ¥700,000 |
| Canzibe Hospital | Renovation for ICU | ¥500,000 |
| TOTAL | | ¥1,300,000 (ZAR 82,908) |

2-5-2 Operating and Maintenance Cost

Each project facility is required to secure a budget for procurement cost of necessary consumables and parts for the equipment to be procured in this project. The additional operating and maintenance cost thereby is mentioned below.

Table 2-15 Cost Estimation Additionally Required for Operation and Maintenance

| Hospital | Additionally required Operation and Maintenance Cost for Replaced Equipment under the Project | |
|---------------------------|---|--------------------|
| | J. Yen | South African Rand |
| Canzibe Hospital | 2,961,196 | 188,851 |
| St. Barnabas Hospital | 3,006,316 | 191,729 |
| Nessie Knight Hospital | 2,874,316 | 183,310 |
| St. Lucy's Hospital | 3,191,116 | 203,515 |
| Zithulele Hospital | 2,753,836 | 175,627 |
| Health Centres (6 places) | 858,624 | 54,759 |
| Clinics (83 places) | 13,345,072 | 851,088 |
| Mobile Clinics (6 units) | 2,121,600 | 135,306 |
| Total | 31,112,076 | 1,984,185 |

For the budget for maintenance cost, the details were described in the foregoing paragraph (the budget analysis). The budget for the fiscal year 2003 is estimated at 411 million rand, and the budget for the fiscal year 2002 was 349 million rand. It is increased by 18%. Referring to the above trial calculation, the maintenance cost newly required shall be about 2 million rand, and it is only 0.5% of the budget. The Provincial Department of Health regards this project as important, and it shall ensure an increase in the annual budget for the maintenance cost after implementation of this project.

Chapter 3 Project Evaluation and Recommendations

Chapter 3 Project Evaluation and Recommendations

3-1 Project Effects

(1) Direct Effect

1. The medical services shall be improved in the project facilities by improving medical equipment in district hospitals, health centers and clinics in the Oliver Tambo District of the Eastern Cape Province.

A medical system that enables provision of primary and secondary medical services of a standard appropriate for the residents of the designated area shall thus be established. It shall contribute to improving the activity condition of the project facilities (such as the number of outpatients, the number of operations, the number of X-ray examinations, and the number of initial inspections for patients with chronic diseases) with qualitative improvement of the medical services.

2. The medical services shall be improved for local residents, who do not live within easy access to clinics, by the enhancement of mobile clinics.

This project shall contribute to the intensive implementation of PHC on which the new Government of South Africa has laid emphasis. This project shall also contribute to improving the community health system and establishing such a system that enables the provision of medical services impartially and expeditiously to all residents of the area concerned in this project including the tribes living in remote areas of former Bantu Homelands.

(2) Indirect Effect

The referral system between district hospitals and primary medical facilities (health centers and clinics) shall be improved in the Oliver Tambo District. By improving the medical equipment, this project shall indirectly support the district hospitals in fulfilling their function as referral hospitals from health centers and clinics.

3-2 Recommendations

To implement this project smoothly and make effective and continuous use of the equipment to be procured, the following items are proposed.

(1) Securing medical workers

To improve the medical services at the project facilities, it is necessary to improve the medical equipment and the facilities on the hardware side. The South African side is also required to secure medical workers (doctors, nurses, medical X-ray technicians, pharmacists, hygienists and so forth) so that the project

facilities can provide more appropriate and effective medical services.

(2) Reinforcement of the operation and maintenance system and budgetary appropriation

In implementing this project, it is necessary to reinforce the operation and maintenance system of the medical equipment and the facilities, which will lead to an increase in the maintenance costs. It is necessary to secure a budgetary appropriation for such costs.

The maintenance of the equipment is now entrusted to external personnel. It is necessary in the future to set up a maintenance department that has its own workshops and to establish a maintenance system to enable effective and efficient usage of the existing equipment.

(3) It is necessary to improve the peripheral infrastructure of the project facilities (access roads, electricity, communication fixtures, water supply, and other facilities).

(4) Establishment of community structures for participation in PHC issues

The Provincial Department of Health and the sub-district health offices are expected to make further efforts to prompt the communities to cultivate a sense of participation in health and hygiene issues.

Appendices

1. Member List of the Study Team

MEMBER LIST OF THE STUDY TEAM

At the stage of B/D study :

| | | |
|----------------------|------------------------------------|--|
| Dr. Junichi INABA | Team leader & Technical advisor | Bureau of International Cooperation, International Medical Center of Japan, Ministry of Health, Labour and Welfare |
| Mr. Tatsuro NAKAJIMA | Project manager | Binko Ltd., |
| Ms. Yoko OGAWA | Health sector surveyor | Binko Ltd., |
| Mr. Hiroaki NARITA | Equipment planner I | Binko Ltd., |
| Mr. Hiroshi MURAKAMI | Equipment planner II | Binko Ltd., |
| Mr. Mitsuhiro NASU | Facility planner I | Binko Ltd., |
| Mr. Ichiro NOMURA | Facility planner II | Binko Ltd., |
| Mr. Takashi OGAWA | Cost & Procurement planner | Binko Ltd., |
| Mr. Hiromichi SATO | Coordinator | Binko Ltd., |

At the stage of Draft B/D study :

| | | |
|----------------------|-------------------------------|--|
| Mr. Shinji TOZUKA | Team leader | Japan International Cooperation Agency (JICA) |
| Dr. Junichi INABA | Technical advisor | Bureau of International Cooperation, International Medical Center of Japan, Ministry of Health, Labour and Welfare |
| Mr. Mizuki MATSUZAKI | Project coordinator | Japan International Cooperation Agency (JICA) |
| Mr. Tatsuro NAKAJIMA | Project manager | Binko Ltd., |
| Mr. Hiroaki NARITA | Equipment planner I | Binko Ltd., |
| Mr. Mitsuhiro NASU | Facility planner I | Binko Ltd., |
| Mr. Takashi OGAWA | Cost & Procurement planner | Binko Ltd., |

2. Study Schedule

Schedule of Basic Design Study

| No. | Date | | Officials 9days | (a)Project Manager | (b)Health Sector Surveyor | (c)Equipment Planner I | (d)Equipment Planner II | (e)Facilities Planner I | (f)Facilities Planner II | (g)Procurement &Cost Planner | (h) Coordinator | | |
|-----|------|-----|--|--|--|--|--|---|--------------------------------------|--------------------------------------|--|-----------------------|--|
| | | | | 45days | 28days | 45days | 35days | 35days | 35days | 30days | 14days | | |
| 1 | 3/8 | sat | Tokyo→Singapore (SIN) SIN → Johannesburg (JNB) JICA / Embassy of Japan / DOH in Pretoria JNB → East London (E.L.) E.L. → Bisho (B.H) Provincial DoH Provincial DoH B.H → (Site visit) → Umtata (UMT) KSD & Mhlontlo District DoH Nyandeni District DoH (Site visit) Team meeting Review of study KSD DoH (Clinics u/Umtata Hospital) Clinics u/Umtata Survey of Maintenance System Clinics u/Umtata Clinics u/Umtata Review of study Mhlontlo Distric DoH Clinics u/St.Lucy St.Lucy's Hospital Clinics u/St.Lucy Clinics u/St.Lucy Clinics u/St.Lucy St.Lucy's Hospital Clinics u/St.Lucy Review of study Nyandeni District DoH Clinics u/Canzibe Canzibe Hospital Clinics u/Canzibe Clinics u/Canzibe Canzibe Hospital Canzibe Hospital Review of study Tokyo→(Via) (Via)→JNB→→Pretoria JICA/EoJ JNB→E.L→B.H Provincial DoH B.H→UMT Nyandeni DoH Site survey KSD DoH Mhlontlo District DOH Site Survey Team meeting UMT→B.H Consultation of Minute Signing of Minute E.L→JNB E.L → JNB DOH in Pretria JICA/EoJ study of market JNB→(Paris) Paris→(Tokyo) →Tokyo | Tokyo→Singapore (SIN) | | | | | | | | | |
| 2 | 3/9 | sun | | | | | | | | | | | |
| 3 | 3/10 | mon | | | | | | | | | | Tokyo→SIN | |
| 4 | 3/11 | tue | | | Together with (a) | with (a) | Tokyo → SIN | | | | | SIN →JNB JNB → UMT | |
| 5 | 3/12 | wed | | | Provincial DOH | with (a) | SIN →JNB | | | | | Umtata | |
| 6 | 3/13 | thu | | | Provincial DOH | with (a) | JNB→UMT | JNB→UMT | JNB→UMT | | | | |
| 7 | 3/14 | fri | | | B.H → UMT | with (a) | with (a) | with (a) | with (a) | | | | |
| 8 | 3/15 | sat | | | Team meeting | Team meeting | Team meeting | Team meeting | Team meeting | | | | |
| 9 | 3/16 | sun | | | Review of study | Review of study | Review of study | Review of study | Review of study | Tokyo→SIN | | | |
| 10 | 3/17 | mon | | | KSD DoH (Clinics u/Umtata Hospital) | KSD DoH (Clinics u/Umtata Hospital) | KSD DoH (Clinics u/Zithulele) | KSD DoH (Clinics u/Umtata) | KSD DoH (Clinics u/Zithulele) | KSD DoH (Clinics u/Umtata) | SIN →JNB | | |
| 11 | 3/18 | tue | | | with (a) | Clinics u/Zithulele | Clinics u/Umtata | Clinics u/Zithulele | Clinics u/Umtata | Clinics u/Umtata | Study of market | | |
| 12 | 3/19 | wed | | | with (a) | Clinics u/Zithulele | Clinics u/Umtata | Clinics u/Zithulele | Clinics u/Umtata | Clinics u/Umtata | Study of market | | |
| 13 | 3/20 | thu | | | with (c) | Clinics u/Zithulele | Clinics u/Umtata | Clinics u/Zithulele | Clinics u/Umtata | Clinics u/Umtata | Study of market | | |
| 14 | 3/21 | fri | | | with (a) | Clinics u/Zithulele | Clinics u/Umtata | Clinics u/Zithulele | Clinics u/Umtata | Clinics u/Umtata | JNB→UMT | | |
| 15 | 3/22 | sat | | | with (a) | Clinics u/Zithulele | Clinics u/Umtata | Clinics u/Zithulele | Clinics u/Umtata | Clinics u/Umtata | UMT → JNB | | |
| 16 | 3/23 | sun | | | Review of study | Review of study | Review of study | Review of study | Review of study | Review of study | JNB → SIN | | |
| 17 | 3/24 | mon | | | Mhlontlo Distric DoH Clinics u/St.Lucy | Mhlontlo Distric DoH | Mhlontlo DoH Clinics u/St.Lucy | Mhlontlo DoH Clinics u/St.Lucy | Mhlontlo DoH Clinics u/Nessie K. | Mhlontlo DoH Clinics u/St.Lucy | Mhlontlo Distric DoH Clinics u/St.Lucy | SIN → Tokyo | |
| 18 | 3/25 | tue | | | Nyandeni District DoH | Nessie Knight Hosp. Clinics u/Nessie K. | St.Lucy's Hospital Clinics u/St.Lucy | Nessie Knight Hosp. Clinics u/Nessie K. | St.Lucy's Hospital Clinics u/St.Lucy | St.Lucy's Hospital Clinics u/St.Lucy | St.Lucy's Hospital Clinics u/St.Lucy | | |
| 19 | 3/26 | wed | | | with (a) | Clinics u/St.Lucy | Clinics u/St.Lucy | Clinics u/St.Lucy | Clinics u/Nessie K. | Clinics u/St.Lucy | Clinics u/St.Lucy | | |
| 20 | 3/27 | thu | | | KSD District DoH | Clinics u/Nessie K. | Clinics u/St.Lucy | Clinics u/Nessie K. | Clinics u/St.Lucy | Clinics u/St.Lucy | Clinics u/St.Lucy | | |
| 21 | 3/28 | fri | | | Nessie Knight Hosp. | Nessie Knight Hosp. | St.Lucy's Hospital | Nessie Knight Hosp. | St.Lucy's Hospital | St.Lucy's Hospital | St.Lucy's Hospital | | |
| 22 | 3/29 | sat | | | Review of study | Clinics u/Nessie K. | Clinics u/St.Lucy | Clinics u/Nessie K. | Clinics u/St.Lucy | Clinics u/St.Lucy | Clinics u/St.Lucy | | |
| 23 | 3/30 | sun | | | Review of study | Review of study | Review of study | Review of study | Review of study | Review of study | Review of study | | |
| 24 | 3/31 | mon | | | UMT→JNB | Nyandeni DoH Clinics u/St.Barnabas | Nyandeni DoH Clinics u/Canzibe | Nyandeni DoH Clinics u/St.Barnabas | Nyandeni DoH Clinics u/Canzibe | Nyandeni DoH Clinics u/Canzibe | Nyandeni DoH Clinics u/Canzibe | | |
| 25 | 4/1 | tue | | | DoH in Pretoria | St.Barnabas Hosp. Clinics u/St.Barnabas | Canzibe Hospital Clinics u/Canzibe | St.Barnabas Hosp. Clinics u/St.Barnabas | Canzibe Hospital Clinics u/Canzibe | Canzibe Hospital Clinics u/Canzibe | Canzibe Hospital Clinics u/Canzibe | | |
| 26 | 4/2 | wed | | | DoH in Pretoria | Clinics u/St.Barnabas | Clinics u/Canzibe | Clinics u/St.Barnabas | Clinics u/Canzibe | Clinics u/Canzibe | Clinics u/Canzibe | | |
| 27 | 4/3 | thu | | | JNB→SIN | Clinics u/St.Barnabas | Clinics u/Canzibe | Clinics u/St.Barnabas | Clinics u/Canzibe | Clinics u/Canzibe | Clinics u/Canzibe | | |
| 28 | 4/4 | fri | | | SIN→Tokyo | St.Barnabas Hospital | Canzibe Hospital | St.Barnabas Hospital | Canzibe Hospital | Canzibe Hospital | Canzibe Hospital | | |
| 29 | 4/5 | sat | | | | St.Barnabas Hospital | Canzibe Hospital | St.Barnabas Hospital | Canzibe Hospital | Canzibe Hospital | Canzibe Hospital | | |
| 30 | 4/6 | sun | | | Review of study | Review of study | Review of study | Review of study | Review of study | Review of study | Review of study | | |
| 31 | 4/7 | mon | | Clinics u/Canzibe | Zithulele Hospital Clinics u/Zithulele | Canzibe Hospital | Zithulele Hospital Clinics u/Zithulele | Canzibe Hospital | Canzibe Hospital | Canzibe Hospital | | | |
| 32 | 4/8 | tue | | Review of study | Zithulele Hospital | Clinics u/Canzibe | Zithulele Hospital | Clinics u/Canzibe | Clinics u/Canzibe | Clinics u/Canzibe | | | |
| 33 | 4/9 | wed | | UMT→B.H Provincial DoH | Review of study | Clinics u/Canzibe | Review of study | Clinics u/Canzibe | Clinics u/Canzibe | UMT→JNB | | | |
| 34 | 4/10 | thu | | B.H→UMT Nyandeni DoH Site survey KSD DoH | B.H→UMT Nyandeni DoH Site survey KSD DoH | Nyandeni DoH Site survey KSD DoH | Review of study | Review of study | Nyandeni DoH Site survey KSD DoH | Survey of agent | | | |
| 35 | 4/11 | fri | | Mhlontlo District DOH Site Survey | Mhlontlo District DOH Site Survey | Mhlontlo District DOH Site Survey | Mhlontlo District DOH Site Survey | Mhlontlo District DOH Site Survey | Survey of Health Center & Hospital | Survey of agent | | | |
| 36 | 4/12 | sat | | Team meeting | Team meeting | Team meeting | UMT→JNB | | | Survey of agent | | | |
| 37 | 4/13 | sun | | UMT→B.H | UMT→B.H | UMT→B.H | JNB →SIN | | | | | | |
| 38 | 4/14 | mon | | Consultation of Minute Signing of Minute | Consultation of Minute Signing of Minute | Consultation of Minute Signing of Minute | SIN →Tokyo | | | | | | |
| 39 | 4/15 | tue | | E.L→JNB | Review of study | | | | | | | | |
| 40 | 4/16 | wed | | E.L → JNB | | | | | | | | | |
| 41 | 4/17 | thu | | DOH in Pretria JICA/EoJ | | | | | | | | | |
| 42 | 4/18 | fri | | study of market | | | | Singapore = SIN | | | | | |
| 43 | 4/19 | sat | | JNB→(Paris) | | | | Johannesburg = JNB | | | | | |
| 44 | 4/20 | sun | | Paris→(Tokyo) | | | | East London = E.L. | | | | | |
| 45 | 4/21 | mon | | →Tokyo | | | | Bisho = B.H. | | | | | |
| | | | | | | | | Umtata = UMT | | | | | |

Schedule of Explanation of Draft Report

| No. | Date | | Officials | (a)Project | (c)Equipment | (e)Facilities | (g)Procurement |
|-----|------|-----|--|---|---|---|---|
| | | | | Manager | Planner I | Planner I | &Cost Planner |
| | | | 10days | 22days | 22days | 22days | 20days |
| 1 | 6/30 | mon | | Tokyo (SQ997/12:00) → Singapore (SIN) | | | |
| 2 | 7/1 | tue | | SIN (SQ406/01:35) → Johannesburg (JNB) 06:15 | | | |
| 3 | 7/2 | wed | | JICA / Embassy of Japan | | | |
| 4 | 7/3 | thu | | DOH in Pretoria | | | |
| 5 | 7/4 | fri | | JNB(SA1471) → East London (E.L.) | | | |
| 6 | 7/5 | sat | | Consultation with Eastern Cape Provincial DOH in Bisho (B.H.) | | | |
| 7 | 7/6 | sun | | Documentation / Survey of agent | | | |
| 8 | 7/7 | mon | | B.H → Umtata (UMT) | B.H → Umtata (UMT) | B.H → Umtata (UMT) | B.H → Umtata (UMT) |
| 9 | 7/8 | tue | | KSD District DoH | KSD District DoH | KSD District DoH | KSD District DoH |
| 10 | 7/9 | wed | | Nyandeni District DoH | Nyandeni District DoH | Nyandeni District DoH | Nyandeni District DoH |
| | | | Mhlontlo District DoH | Mhlontlo District DoH | Mhlontlo District DoH | Mhlontlo District DoH | |
| 11 | 7/10 | thu | Tokyo→KUL(01:05)→ | District Hospital | District Hospital | District Hospital | District Hospital |
| 12 | 7/11 | fri | →JNB(05:40) JICA / Embassy of Japan JNB(SA0475/14:45) → E.L.(16:10) | District Hospital | District Hospital | District Hospital | District Hospital |
| 13 | 7/12 | sat | E.L. → Umtata Site survey: District Hospital & Health Center | Join w/Officials District Hospital & Health Center | Join w/Officials District Hospital & Health Center | Join w/Officials District Hospital & Health Center | Join w/Officials District Hospital & Health Center |
| 14 | 7/13 | sun | Site survey UMT→E.L. | Site survey UMT→E.L. | Site survey UMT→E.L. | Site survey UMT→E.L. | Site survey UMT→E.L. |
| 15 | 7/14 | mon | Provincial DoH Consultation of Minutes Signing of Minutes | Provincial DoH Consultation of Minutes Signing of Minutes | ← Ditto | ← Ditto | ← Ditto |
| 16 | 7/15 | tue | Clinics (Site survey) | Clinics (Site survey) | ← Ditto | ← Ditto | ← Ditto |
| 17 | 7/16 | wed | E.L.(SA1408/15:35) → JNB | E.L.(SA1408)→JNB | E.L.(SA1408)→JNB | Survey of agent in E.L. | Survey of agent in E.L. |
| 18 | 7/17 | thu | JICA / Embassy of Japan Signing of Minutes National DoH in Pretoria JNB(19:20)→ | JICA / Embassy of Japan Signing of Minutes National DoH in Pretoria | ← Ditto | Survey of agent in E.L. E.L.(SA1408/15:35)→ JNB | Survey of agent in E.L. E.L.(SA1408/15:35)→ JNB |
| 19 | 7/18 | fri | →BKK(11:20) BKK(22:15)→ | Survey of agent in JNB | | | JNB(SQ405) → (SIN) |
| 20 | 7/19 | sat | →Tokyo(06:15) | Review & Documentation | | | SIN(SQ12)→ Tokyo |
| 21 | 7/20 | sun | | JNB (SQ405/14:15) → (SIN) | | | |
| 22 | 7/21 | mon | | SIN (SQ12/9:45) → Tokyo (17:35) | | | |

3. List of Parties Concerned in the Recipient Country

LIST OF PARTY CONCERNED IN SOUTH AFRICA

| | |
|---|--|
| Embassy of Japan Mr. K. Matsui | First secretary |
| JICA Office Mr. H. Murakami Mr. K. Jitsukawa | Resident representative Assistant resident representative |
| DOH in Pretoria Ms. Catwerine Makwakwa Ms. Nonkonzo T. Molai Mr. Hanief Kander Ms. Tsakani Mnisi Mr. Baset Khlaf | Director, International health liaison Director, Health technology policy Deputy director, Health technology planning Deputy director, Policy & donor coordination Deputy director, Health technology planning |
| DOH in Eastern Cape Province Ms. B. Mzileni Mr. D. Barnard Ms. J. N. Matebese Mr. T. S. Mafu | Project manager Chief engineer Director, Primary health Deputy director, Health facilities planning |
| KSD District DOH Ms. M. S. Thifanyane Dr. R. O. Osigwe Ms. N. C. Bovungana Ms. M. N. Godlwana Ms. N. S. Ntshanga | District manager Chief medical officer Middle manager for health Manager for maternal & child Manager for primary health care |
| [Health Center & Clinic / under Umtata Hospital] | |
| Ms. Nikiwe Mjindi | Ntshela clinic |
| Mr. Dekeda | Baziya health centre |
| Ms. P. K. Mqikwa | Zitatele clinic |
| Ms. Bacela | Sitebe clinic |
| Ms. N. Mabuya | Tabase clinic |
| Ms. M.N. Nokwali | Tyelebana clinic |
| Ms. N. Mpoba | Upper xongora clinic |
| Ms. R.L. Gqosha | Xhwili clinic |
| Ms. Matiyela | Ngangelizwe health centre |
| Ms. N. Mfolombane | Ngcengane clinic |
| Ms. Dastile | Qunu clinic |
| Ms. R. A. Essel | Civic centre clinic |
| Ms. T.S. Soga | Stanford terrace health centre |
| Ms. C. Sinxoto | Kambi clinic |
| Ms. Pantshwa | Mbekweni health centre |
| Ms. Ncokazi | Mpeko clinic |
| Ms. Mtembo | Mpunzana clinic |
| Ms. Ncume | Ntshabeni clinic |
| Ms. M. Sontundu | Qokolweni clinic |
| Ms. Ntshanga | Sangoni clinic |
| (N/A) | Ndibela clinic |
| Ms. Tafa | Ncambele clinic |
| Ms. L.R. Dubeni | Efata clinic |

Ms. R.N. Finca Maxwele clinic
Ms. L.L. Memani Mqekzweni clinic

[Zithulele Hospital]

Ms. N.S. Sentundu Acting hospital manager
Dr. D.R. Chirwa Senior medical superintendent
Ms. N.S. Kela Middle manager

[Health Center & Clinic / under Zithulele Hospital]

Ms. Sityebi Ndzulwini clinic
Ms. T.P. Matebese Mqanduli (H.C.)
Ms. V.X. Ngqeleni Luthubeni clinic
Ms. V.V. Lutholi Mapuzi clinic
Ms. T.P. Qingore Ngcwanguba clinic
Ms. Z.Z. Xhanti Ngqungqu clinic
Ms. N. Sobuwa Ntlangaza clinic
Ms. M.V. Mtolo Pumalanga clinic
Ms. M.S. Mhhawka Jalamba clinic
Ms. Jafta Wilo clinic
Ms. Noah Hlabatshane clinic
Ms. Mnyaika Ngwenya clinic
Ms. N.M. Raziya Pakamile clinic

Mhlontlo District DOH

Ms. Nokwe District manager
Ms. Z.Z. Tilayi PHC Coordinator
Ms. Nandi Human resource officer
Ms. B. Ngcikiza Acting middle manager, Administration
Ms. S.E. Gcisa Clinic supervisor

[Nessie Knight Hospital]

Ms. N.A. Majeke Chief professional nurse
Ms. S.P. Hlongwana Matron
Ms. T.P. Bulabula Acting nursing service manager

[Health Center & Clinic / under Nessie Knight Hospital]

Ms. N.S. Mayengese Nxotwe clinic
Ms. N.I. Matiwane Caba clinic
Ms. P.A. Mnini Nessie knight gateway clinic
Ms. Kiviet Qanqu clinic
Ms. N.P. Mbutuma Kalankomo clinic
Ms. P.N. Madikane Tsilitwa clinic
Ms. B.F. Khali Gura clinic
Ms. S.C. Mandondo Mahlangu clinic
Ms. E.N. Ncikane Mbalisweni clinic
Ms. A.N. Mkula Tina falls clinic
Ms. N.V. Nyembezi Ngwemnyama clinic
Ms. R. Twetwa Shawbury clinic
Ms. A.N. Kumalo Mdyobe clinic
Ms. L. Ndzamela Qumbu health centre

[St. Lucy's Hospital]

Dr. S. Mlenzana Medical superintendent
Ms. T.H. Mabanga Middle manager, Nursing
Ms. J.T. Mbakaza Chief professional nurse

[Health Center & Clinic / under St. Lucy's Hospital]

| | |
|-------------------|---------------------------|
| Ms. N.Q. Nqadala | Langeni clinic |
| Ms. L.M. Tsotso | Sidwadweni clinic |
| Ms. L. Mrenqwa | Tsolo village clinic |
| Ms. B.N. Mapoma | Beledale clinic |
| Ms. N. Gcwabe | Upper mjika clinic |
| Ms. Mesatywa | Lower gungululu clinic |
| Ms. F. Ndzandzeka | Lotana clinic |
| Ms. P.N. Hoza | Mbokotwana clinic |
| Ms. N. Mbokoma | Mhlahlane clinic |
| Ms. N.G. Sodaba | Mhlakulo health centre |
| Ms. A. Madala | St. Lucy's gateway clinic |

Nyandeni District DOH

| | |
|------------------|-----------------------------------|
| Ms. N.V. Mfili | District manager |
| Ms. B. Kumalo | Middle manager |
| Ms. N. Mlokoti | Information manager |
| Ms. N.D. Qougule | Clinic supervisor |
| Ms. B. Ndamase | Provisioning & Logistical support |
| Ms. T.W. Gedu | Nursing middle manager |

[Canzibe Hospital]

| | |
|-----------------|-------------------------------|
| Dr. M.A. Kabir | Acting medical superintendent |
| Ms. T.V. Matoti | Senior administrative officer |
| Ms. M.N. Yakobi | Chief professional nurse |
| Ms. N. Vabaza | Naursing service manager |

[Health Center & Clinic / under Canzibe Hospital]

| | |
|-------------------|------------------------|
| Ms. N. Mcaniba | Buntingville clinic |
| Ms. N.A. Soyamba | Nkumandeni clinic |
| Ms. Mavumengwana | Nqanda clinic |
| Ms. N. Madikizela | Ntibane clinic |
| Ms. Siycau Sen | Pilani clinic |
| Ms. M. Bulwayo | Lwandile clinic |
| Ms. M.N. Bam | Nolita clinic |
| Ms. Mgobozi | Ntapane clinic |
| Ms. Jonga | Lujizweni clinic |
| Ms. Kwaza | Canzibe gateway clinic |

[St. Barnabas Hospital]

| | |
|-------------------------|-------------------------|
| Dr. P.K. Navaratnarajan | Medical superintendent |
| Dr. E.D. Chao | Medical officer |
| Ms. A.T. Gabana | Nursing service manager |

[Health Center & Clinic / under St. Barnabas Hospital]

| | |
|-----------------|----------------------------------|
| Ms. Siyongwana | Libode clinic |
| Ms. O.H. Rozam | Nyandeni clinic |
| Ms. N.H. Genge | Malusi clinic |
| Ms. N. Bokleni | Double falls clinic |
| Ms. Nomqupu | Mangcwanguleni clinic |
| Ms. Sigila | Ndanya clinic |
| Mr. M. Vuyile | Mevana clinic |
| Ms. L.N. Mtwana | Ngcolora clinic |
| Ms. N. Maqungu | Makotyana (H.C.) |
| Ms. P.N. Nhuku | Nkanga clinic |
| Ms. O. Mvubu | Mgwenyane health center (Clinic) |

Ms. M.B. Mbane
Ms. N.L. Vamela
Ms. A.M. Boko
Ms. M.E. Ludidi
Ms. N.R. Mbina

St. Barnabas gateway clinic
Nkanunu clinic
Old Bunting clinic
Cwele clinic
Mampondomiseni clinic