

*The Study on Sabo and Flood Control for Western River Basins of Mount Pinatubo
in the Republic of the Philippines
Final Report
Supporting Report*

Figures

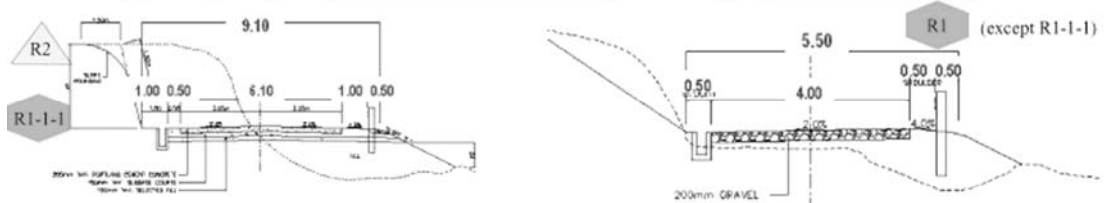
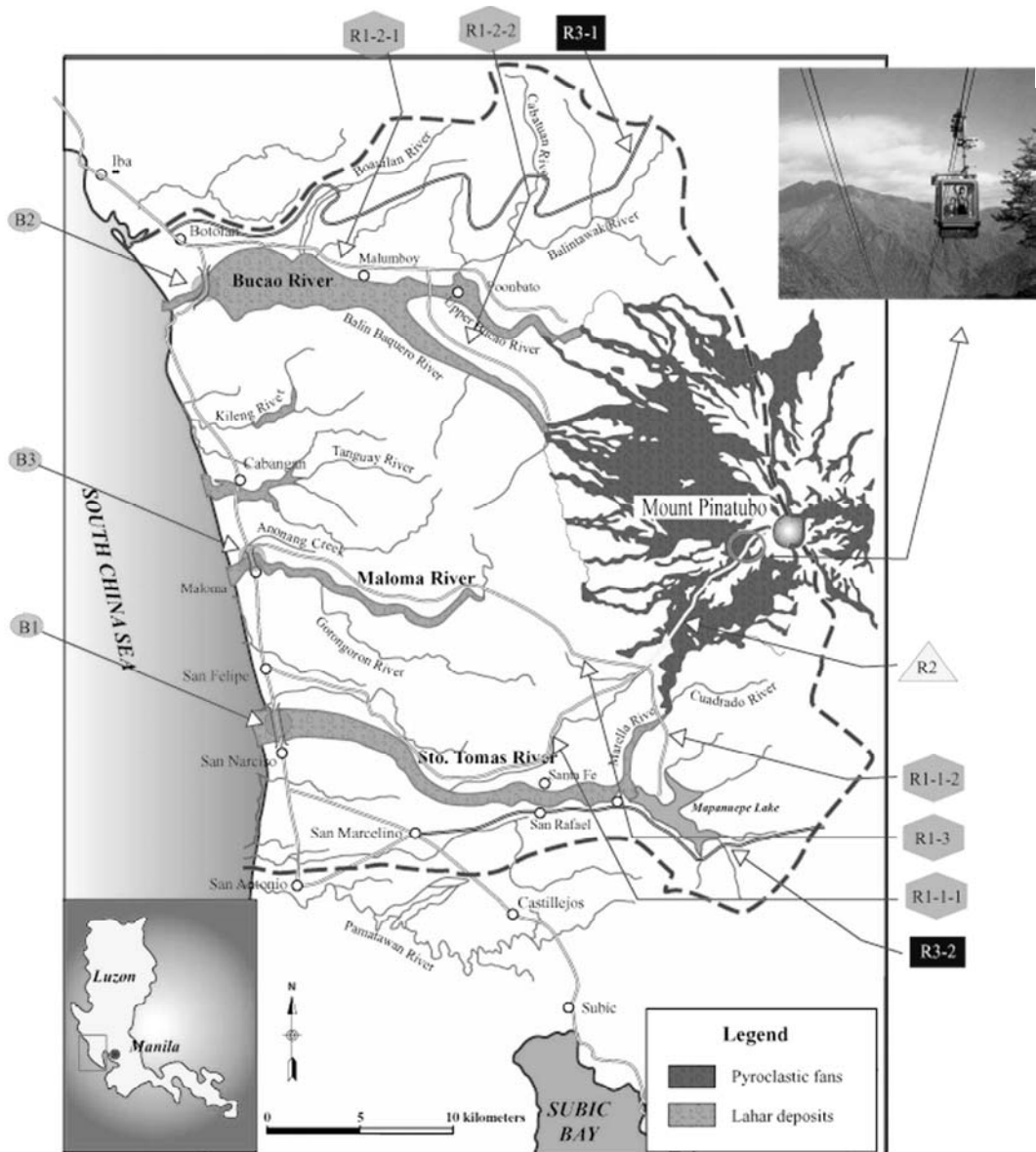

LEGEND			
SYMBOLS	SCOPE OF WORK REQUIRED	PROPOSED PROJECT	LOCATION
	Reconstruction of Bridge	Maculcol Bridge for Reconstruction	Sto. Tomas River
	Reconstruction of Bridge	Bucao Bridge for Reconstruction	Bucao River
	Reconstruction of Bridge	Maloma Bridge for Reconstruction	Maloma River
	Reconstruction of Road	Access Road for Place of Residence at Upper Stream (Community Road)	R1-1-1) along Sto. Tomas River R1-1-2) to Mapanuepe Lake R1-2-1) along Bucao River R1-2-2) along Balin-Baquero River R1-3) along Maloma River
	New Construction of Road	Tourist Road for Crater Lake at Mt. Pinatubo	R2) for R1-1-1 & R1-3
	New Construction Road	Plan of Province of Zambales	R3-1) Zambales-Tarlac Road R3-2) Zambales-Pampanga Road

THE GOVERNMENT OF THE PHILIPPINES
 THE DEPARTMENT OF PUBLIC WORKS AND HIGHWAYS
**The Study on Sabo and Flood Control for
 Western River Basins of Mount Pinatubo in the
 Republic of the Philippines**
 JAPAN INTERNATIONAL COOPERATION AGENCY

Figure 1.1.1
**Location Map of Plan of Province of
 Zambales and Proposed Master Plan for
 Road and Bridge Construction**

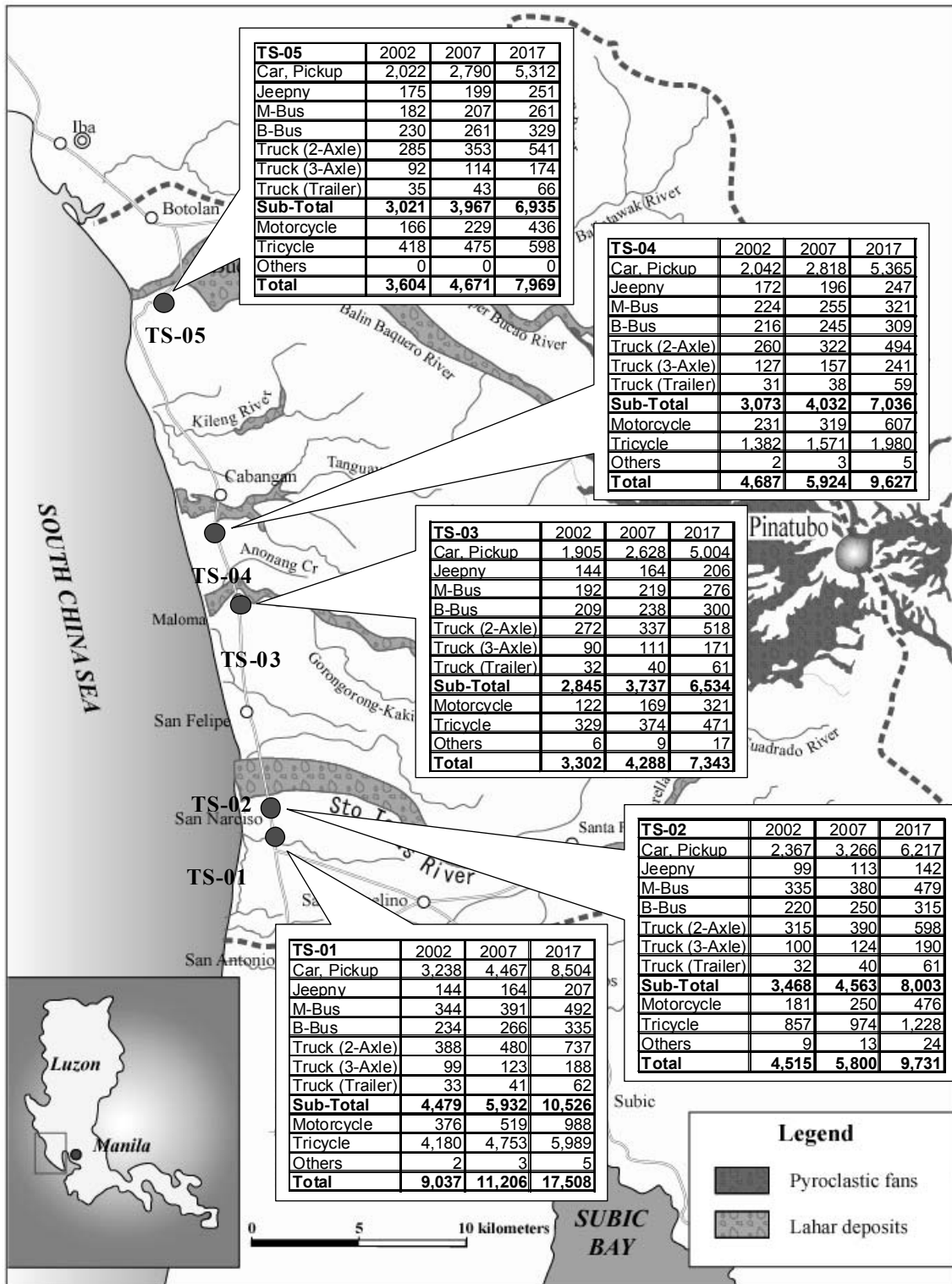

THE GOVERNMENT OF THE PHILIPPINES
THE DEPARTMENT OF PUBLIC WORKS AND HIGHWAYS

**The Study on Sabo and Flood Control for
Western River Basins of Mount Pinatubo in the
Republic of the Philippines**

JAPAN INTERNATIONAL COOPERATION AGENCY

Figure 1.2.1
Traffic Volume

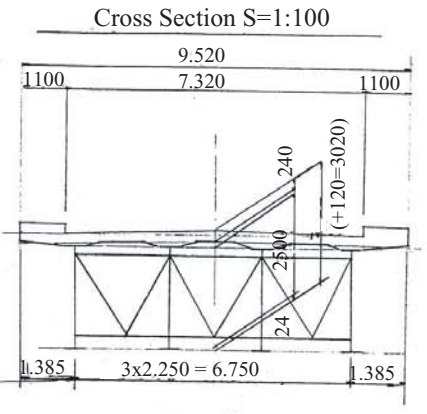
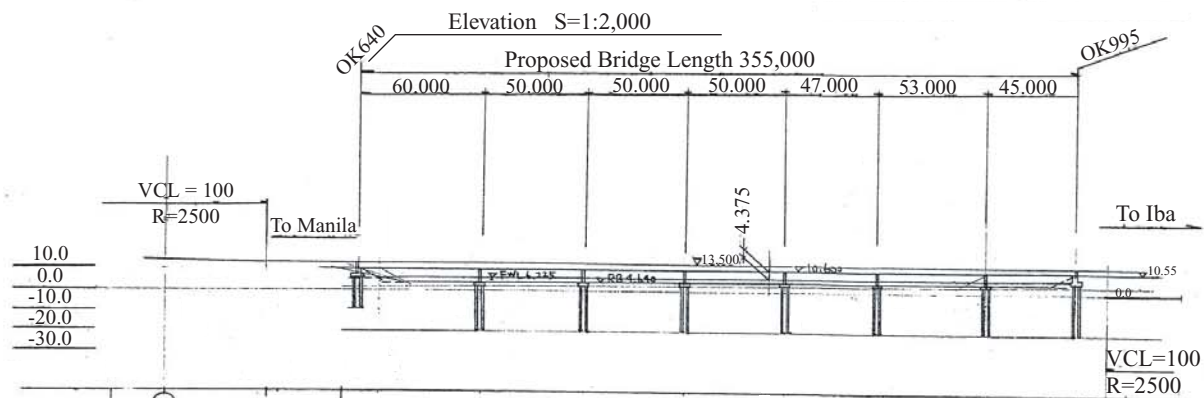

Vertical Curvature	LEVEL									
$R=4.000$ $L=100$ $H=4$ (13.500)	14.500	13.50	13.50	13.50	13.50	13.50	13.50	13.50	13.50	13.50
Finished Grade	14.500	13.50	13.50	13.50	13.50	13.50	13.50	13.50	13.50	13.50
Existing Ground Elevation			10.55	4.64	4.64	4.64	4.64	4.64	10.55	10.55
Horizontal Curvature	$R=112.5$ $L=181.62$								$R=1500$ $L=150$	
Station No.	545	595	OK500	700	800	900	995	000	010	020

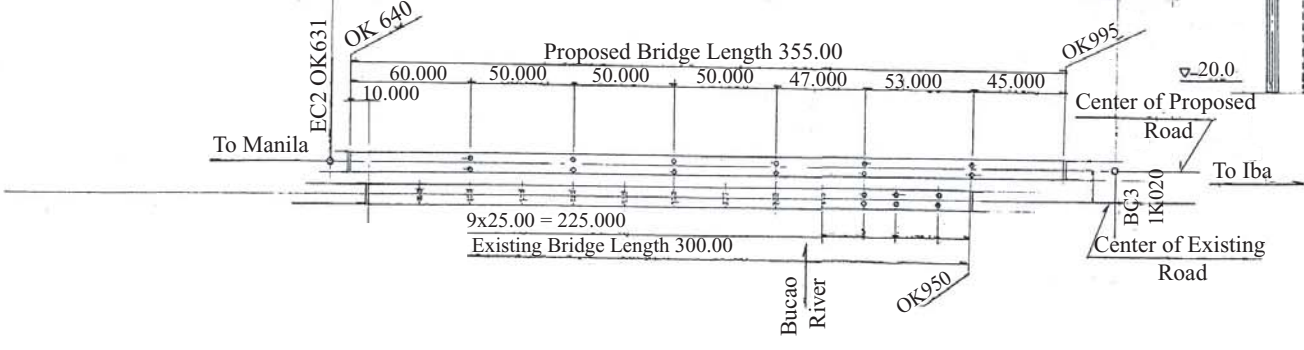
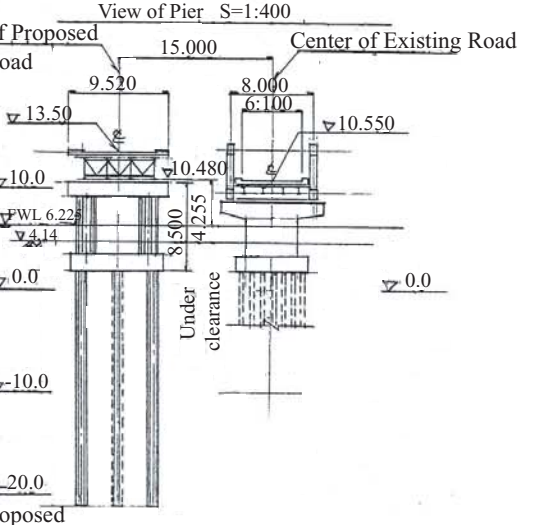

THE GOVERNMENT OF THE PHILIPPINES
THE DEPARTMENT OF PUBLIC WORKS AND HIGHWAYS

The Study on Sabo and Flood Control for
Western River Basins of Mount Pinatubo
in the Republic of the Philippines

JAPAN INTERNATIONAL COOPERATION AGENCY

Figure 1.2.2

General View of the Bucao Bridge for
Reconstruction

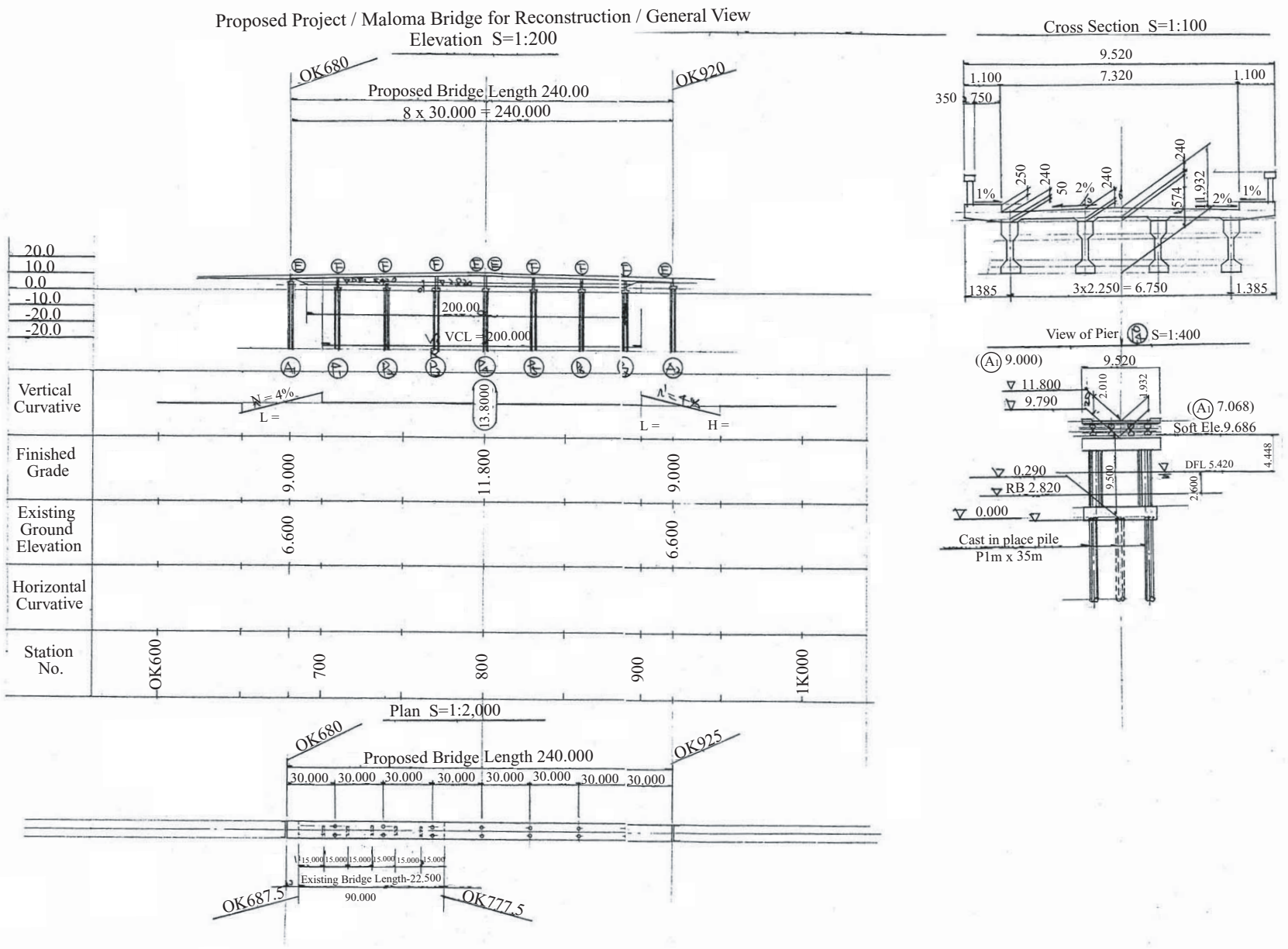

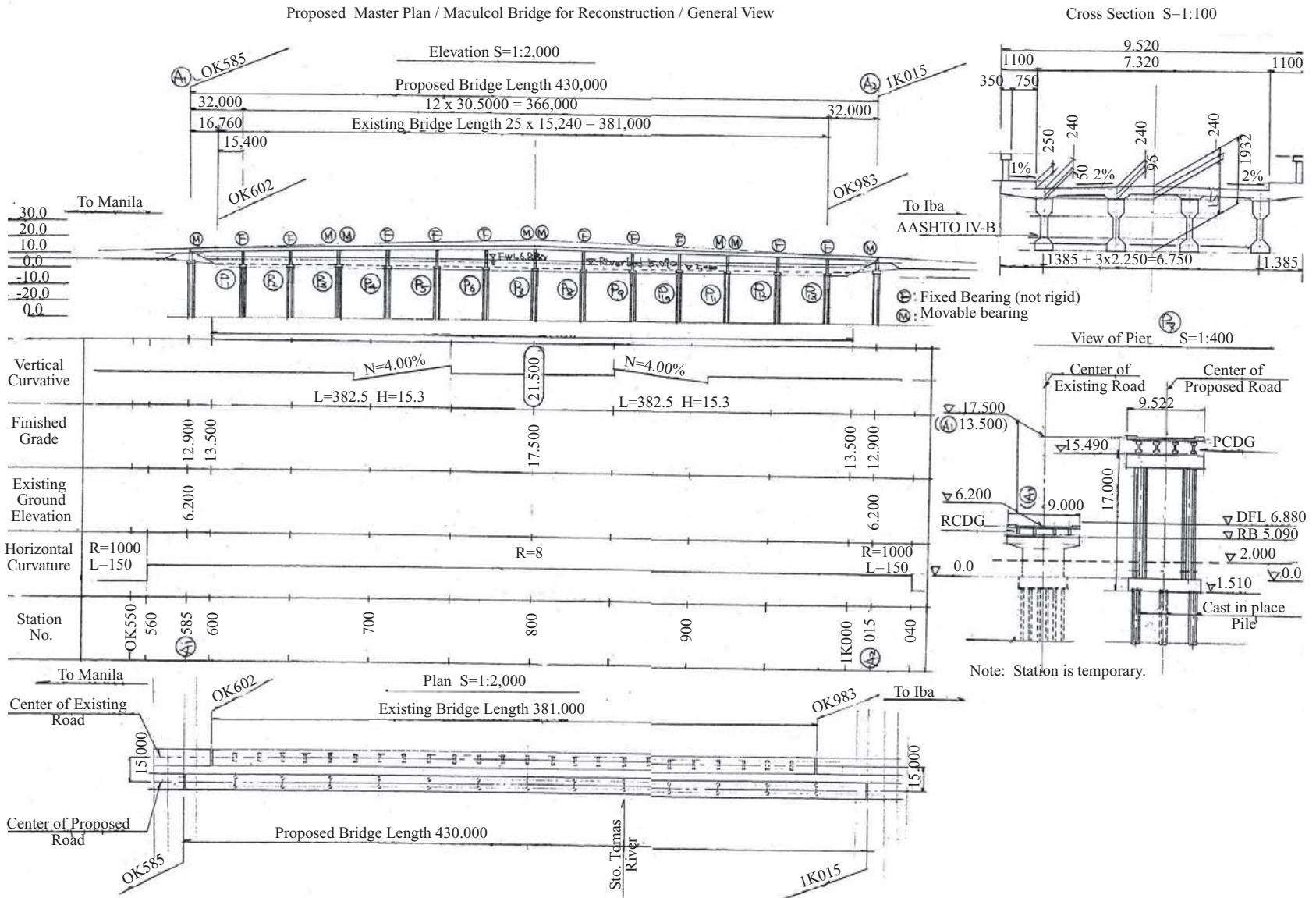

THE GOVERNMENT OF THE PHILIPPINES
 THE DEPARTMENT OF PUBLIC WORKS AND HIGHWAYS

**The Study on Sabo and Flood Control for
 Western River Basins of Mount Pinatubo
 in the Republic of the Philippines**

JAPAN INTERNATIONAL COOPERATION AGENCY

**Figure 1.2.4
 General View of the Maculcol Bridge for
 Reconstruction**

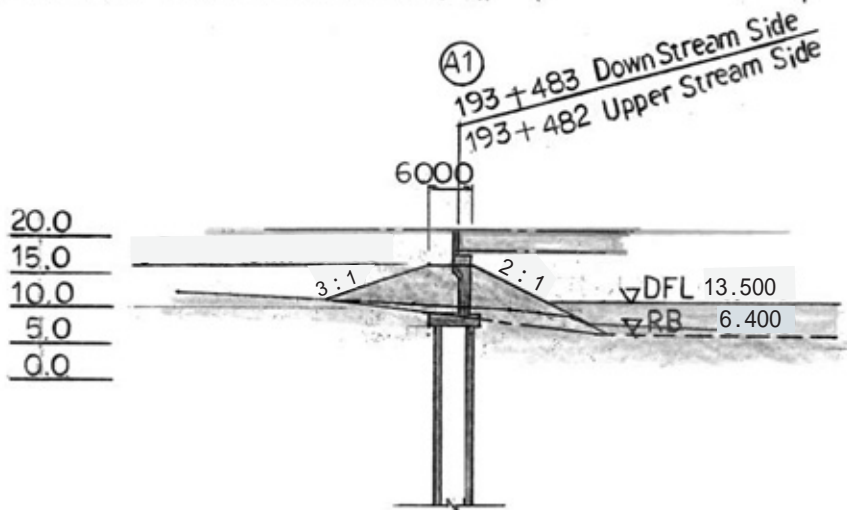
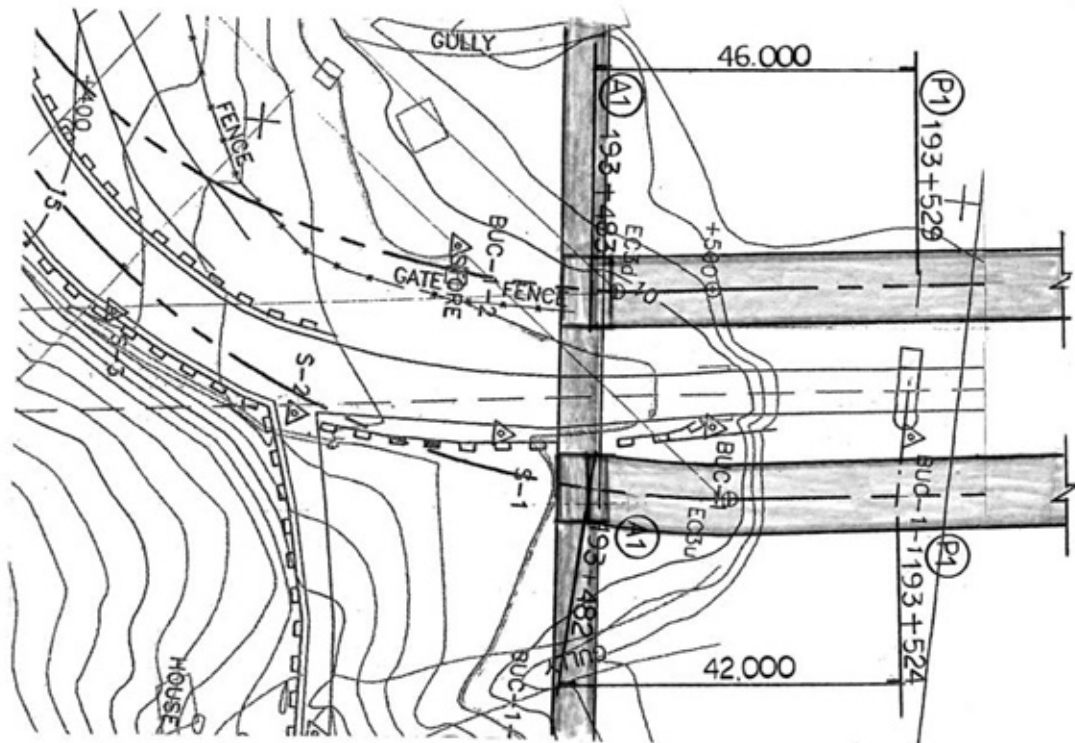

THE GOVERNMENT OF THE PHILIPPINES
THE DEPARTMENT OF PUBLIC WORKS AND HIGHWAYS

**The Study on Sabo and Flood Control for
Western River Basins of Mount Pinatubo
in the Republic of the Philippines**

JAPAN INTERNATIONAL COOPERATION AGENCY

Figure 1.3.1

**Abutment Location of Manila Side of the
Budao Bridge for Reconstruction**