

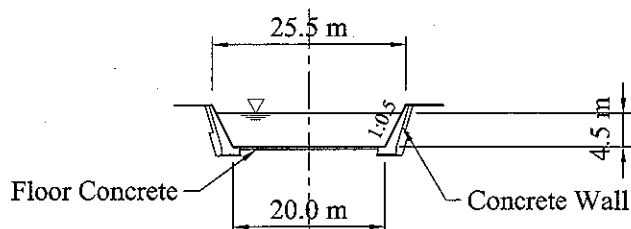

Bedarawali Kas - Tenawali Kas

Long-term Project (100-year Return Period)

Q = 600 m<sup>3</sup>/s



Tenawali Kas - Saidpur Kas

Short-term Project (25-year Return Period)

Q = 70 m<sup>3</sup>/s

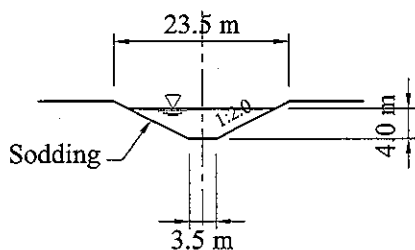

Long-term Project (100-year Return Period)

Q = 980 m<sup>3</sup>/s

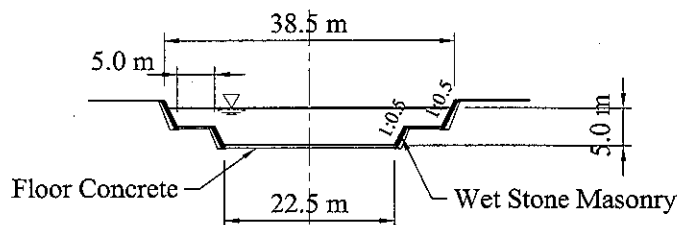

Saidpur Kas - Ojhri Kas

Short-term Project (25-year Return Period)

Q = 320 m<sup>3</sup>/s

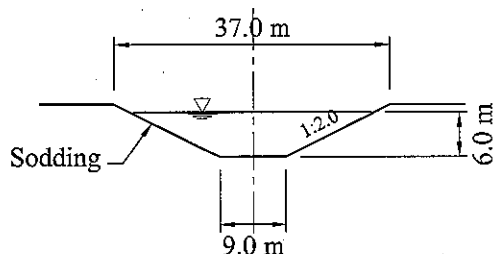

Long-term Project (100-year Return Period)

Q = 1,480 m<sup>3</sup>/s

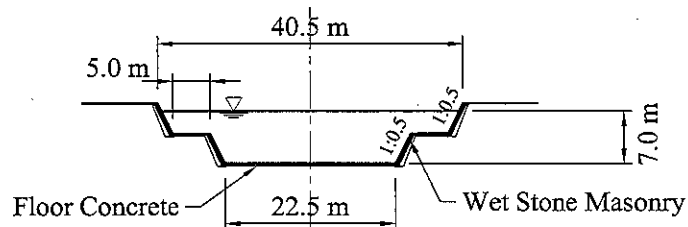

Ojhri Kas - Kurang River

Short-term Project (25-year Return Period)

Q = 470 m<sup>3</sup>/s

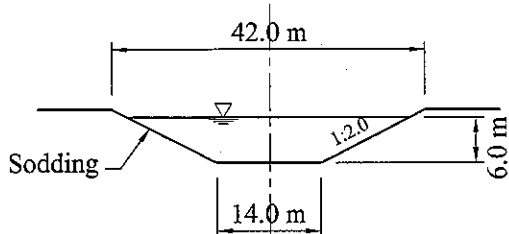

Long-term Project (100-year Return Period)

Q = 1,790 m<sup>3</sup>/s

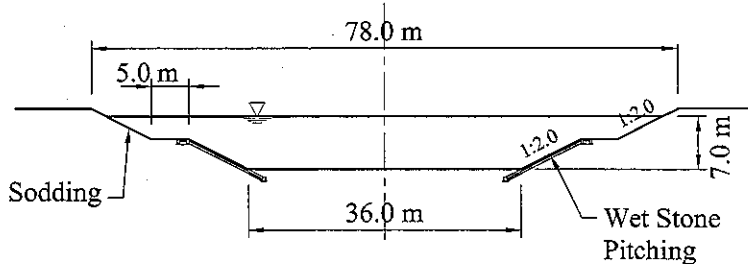

THE STUDY ON COMPREHENSIVE FLOOD MITIGATION  
AND ENVIRONMENTAL IMPROVEMENT PLAN  
OF LAI NULLAH BASIN  
IN THE ISLAMIC REPUBLIC OF PAKISTAN

JAPAN INTERNATIONAL COOPERATION AGENCY

Fig. C.21

Typical Cross Section  
of Flood Diversion Channel