

4. TDFの図面 (BSWM作成)

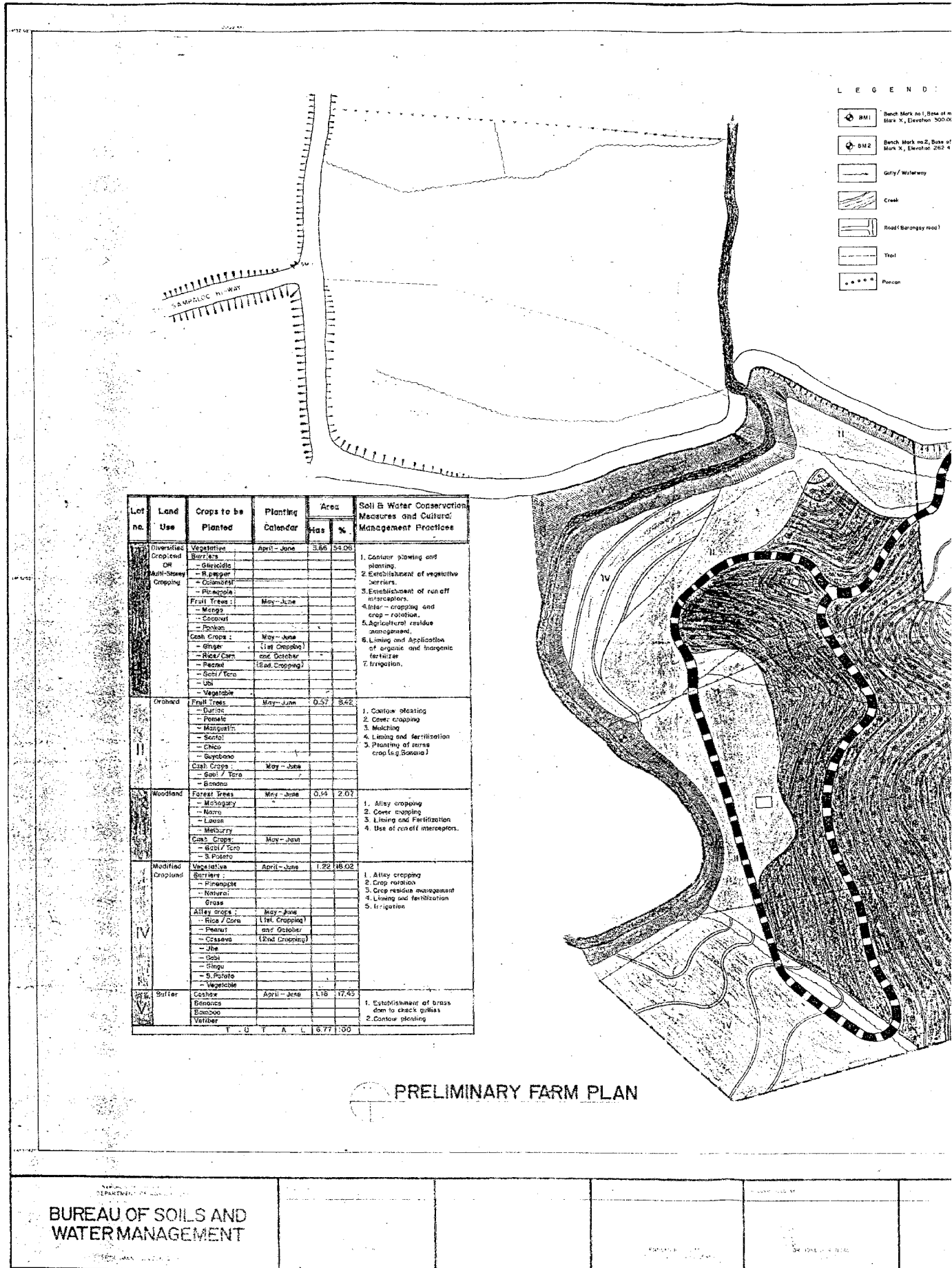

PRELIMINARY FARM PLAN

L E G E N D :

	Bench Mark no. 1, Base of mchre de choup tree Mark X, Elevation 500.00 m. assumed.		Barbed Wire Fence		Farm House
	Bench Mark no. 2, Base of tng tree Mark X, Elevation 292.484 m.		Buffer		Boundary of Area Served
	Gully/Waterway		Hedgerows		Project Boundary
	Creek		Proposed Water System		Land Use Boundary
	Road (Barangay road)		Agrarian Reform Community Monument		Runoff Interceptor
	Trail		Road Cut		Road Network
	Pansion		Marge		

Soil & Water Conservation Measures and Cultural Management Practices	
1. Contour plowing and planting.	
2. Establishment of vegetative barriers.	
3. Establishment of runoff interceptors.	
4. Inter-cropping and crop-rotation.	
5. Agricultural residue management.	
6. Liming and Application of organic and inorganic fertilizer.	
7. Irrigation.	
1. Contour planting	
2. Cover cropping	
3. Mulching	
4. Liming and fertilization	
5. Planting of nurse crop (e.g. Banana)	
1. Alley cropping	
2. Cover cropping	
3. Liming and Fertilization	
4. Use of runoff interceptors.	
1. Alley cropping	
2. Crop rotation	
3. Crop residue management	
4. Liming and fertilization	
5. Irrigation	
1. Establishment of brass dam to check gullies.	
2. Contour planting	

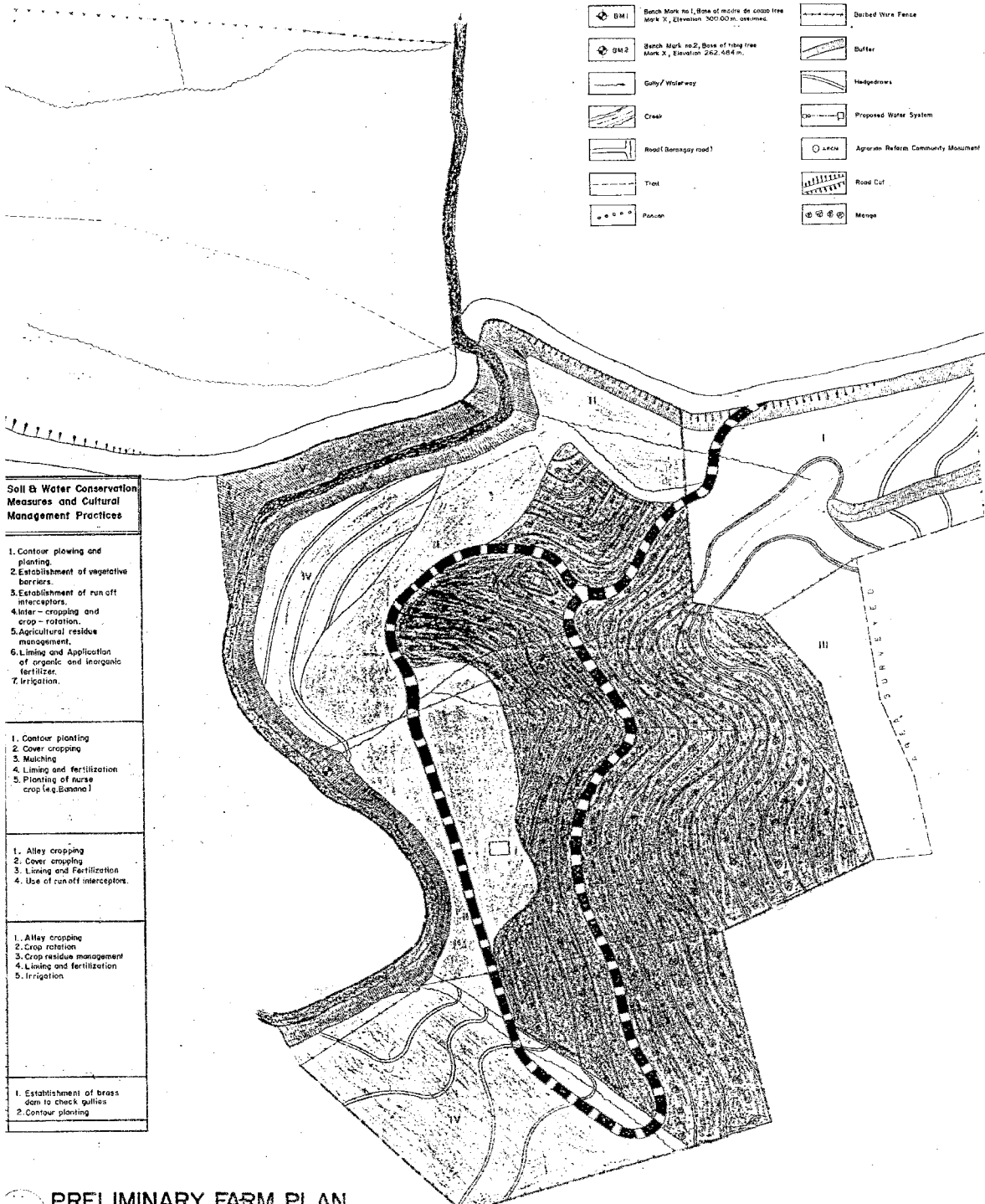

PRELIMINARY FARM PLAN

				TECHNO-FEED FARM P.O. Box 100, Cebu City, Cebu, S.P.	
				ENVIRONMENTAL AND PRODUCTIVITY MANAGEMENT OF MARGINAL SOILS IN THE PHILIPPINES	



# FARM PLAN

SCALE 1 : 1000

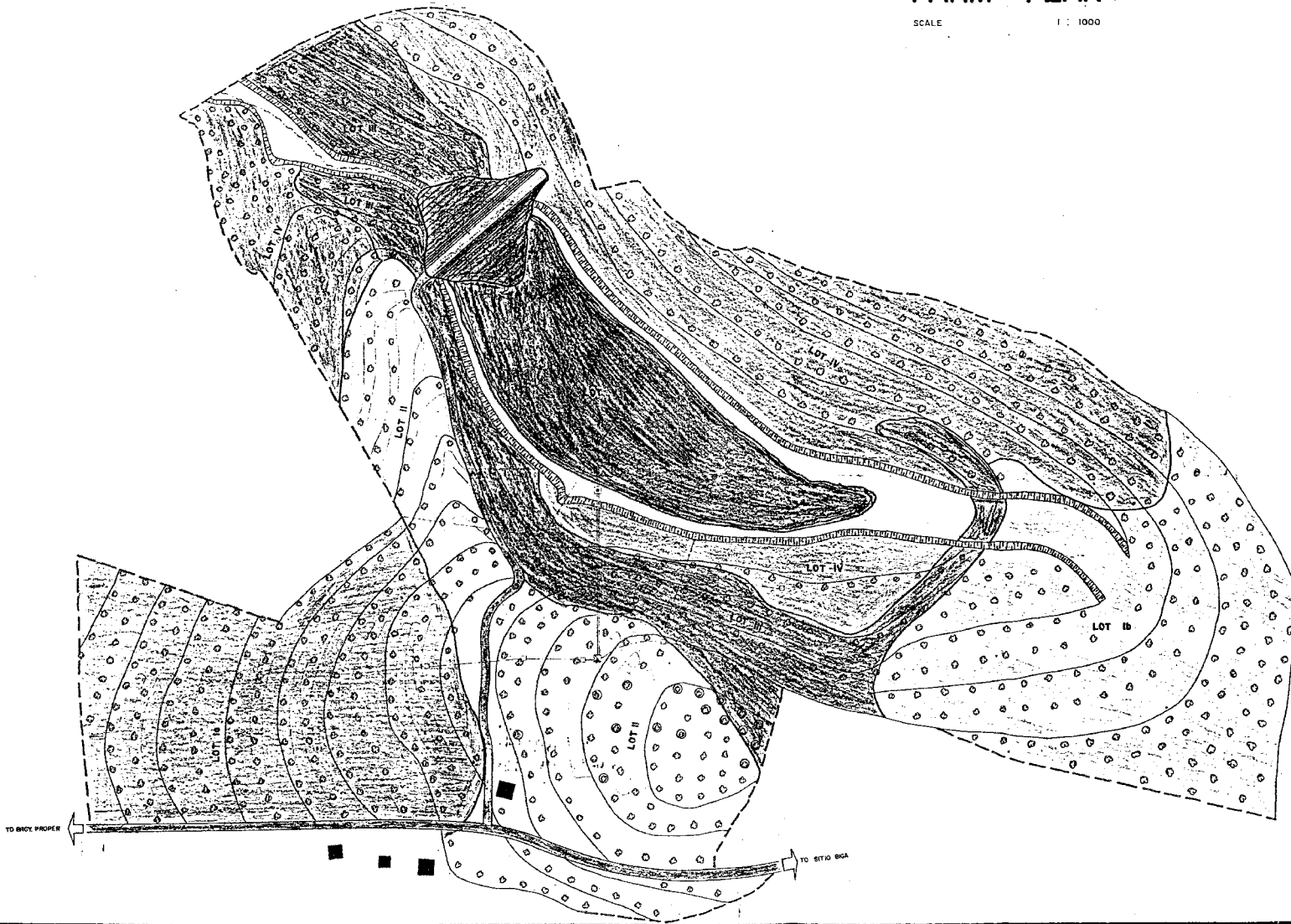

**LEGEND :**

LOT NO.	C R O	
LOT Ia	Ampalaya, Pole Sitoo, Upe w/	
LOT Ib	Diversified alley crops with contour	
LOT II	Pole sitoo, Peanut, Bell pepper, E	
	Diversified alley crops with contour	
	Pole sitoo, Peanut with contour	
	Pond / Reservoir	
	Buffer strip	
	Dam axis	
	Road access	
T	C	T

**CONVENTIONAL SIGN :**

	FARM / BRDY. ROAD
	RESIDENCE
	PUMP & ENGINE
	FARM PLAN BOUNDARY
	BUFFER STRIP / BANANA
	PARCELLARY BOUNDARY
	CONCRETE RESERVOIR
	DAM

REPUBLIC OF THE PHILIPPINES  
DEPARTMENT OF AGRICULTURE  
**BUREAU OF SOILS &  
WATER MANAGEMENT**

QUEZON CITY

PREPARED BY :

DEGRACIAS R. MAGTALAS  
Agric/Burial II

CHECKED BY :

ARNULFO B. GESITE  
Chief, Land-Use Planning Section

RECOMMENDING APPROVAL :

JOSE D. RONDAL, Ph.D.  
Chief, SCMD

APPROVED BY :

ROSELIO N. CONCEPCION, Ph.D.  
Director, BSWM / SRDC

# FARM PLAN



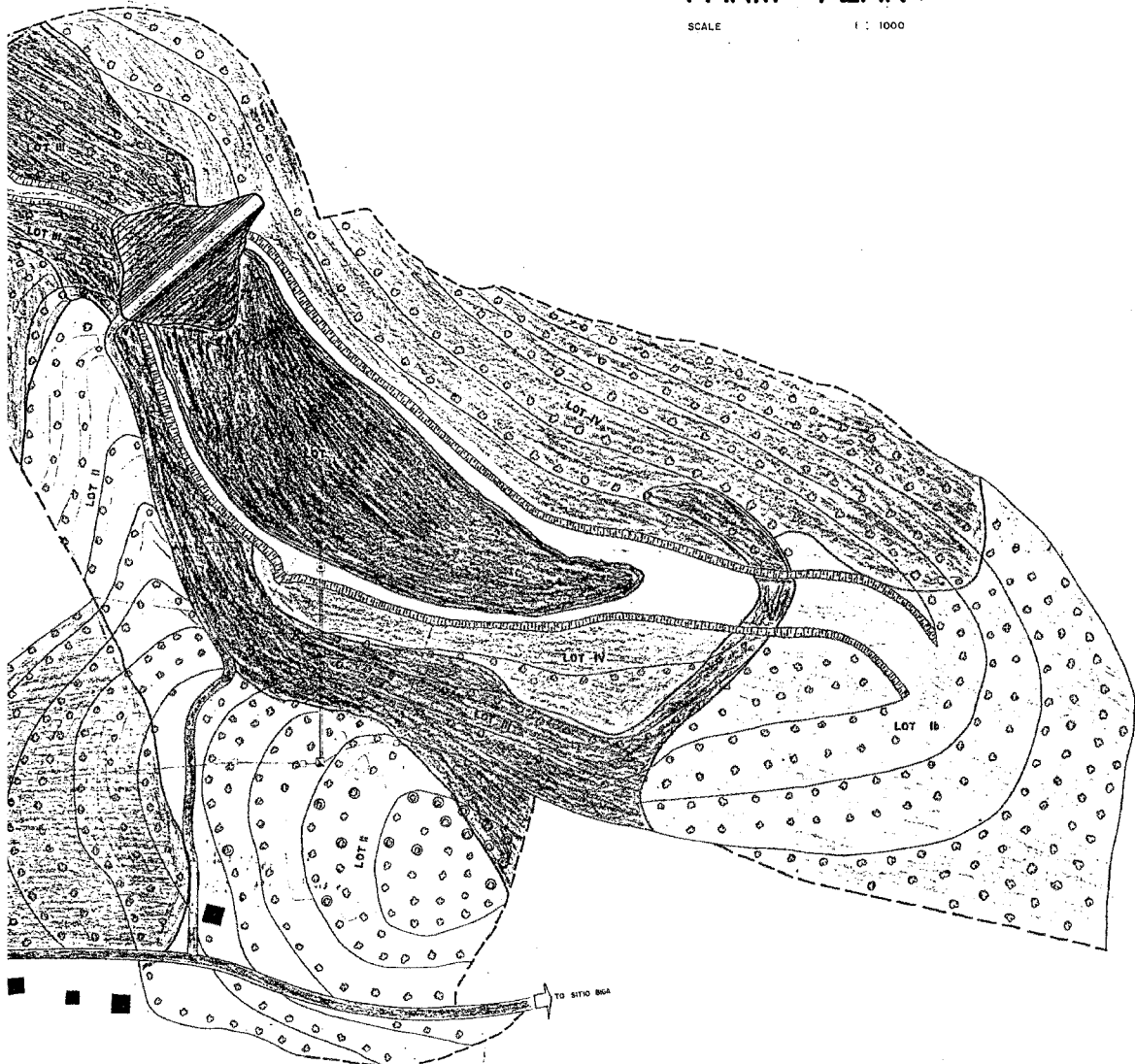









SCALE 1 : 1000



LEGEND :

LOT NO.	CROPS	AREA	
		(Hect.)	( <sup>2</sup> / <sub>100</sub> )
LOT Ia	Ampalaya, Pole Sitoo, Upo w/ Contour Orchard	1.9984	15.49
LOT Ib	Diversified alley crops with contour orchard	2.2416	17.38
LOT II	Pole sitoo, Peanut, Bell pepper, Eggplant w/ contour orchard	2.0000	15.50
	Diversified alley crops with contour orchard	1.5328	11.88
LOT III	Pole sitoo, Peanut with contour orchard	3.1892	24.80
	Pond/ Reservoir	0.9782	7.59
	Buffer strip	0.6512	5.05
	Dam axis	0.2256	1.75
	Road access	0.0720	0.56
T O T A L		12.9000	100.00

CONVENTIONAL SIGN :

-  FARM / BRIDGE ROAD
-  RESIDENCE
-  PUMP & ENGINE
-  FARM PLAN BOUNDARY
-  BUFFER STRIP / BANANA
-  PARCELLARY BOUNDARY
-  CONCRETE RESERVOIR
-  CONCRETE TANK
-  CREEK
-  DAM AXIS
-  POND AREA
-  CONTOUR ORCHARD, HEDGE ROW w/ TRENCH (D=0.70m, W=0.40m.)
-  BOUNDARY OF AREA SURVEYED











D BY:	CHECKED BY:	RECOMMENDING APPROVAL:	APPROVED BY:	<b>TECHNO DEMO FARM (EPMMA)</b> BRGY. BULUSUKAN, SAN ILDEFONSO, B.U.L.A.C.A.N.
DEORACIAS R. MAGTALAS <small>Agricuturist II</small>	ARNULFO B. GESITE <small>Chief, Land-Use Planning Section</small>	JOSE D. RONDAL, Ph.D. <small>Chief, RCMD</small>	ROGELIO M. CONCEPCION, Ph.D. <small>Director, BSWM / BRCC</small>	<b>FARM PLAN</b>



1

2

LEGEND:

-  ASPARGUS HEDGEROWS
-  BANANA (Pineapple, COFFEE, PERMANENT HEDGEROWS)
-  DUFFER STRIP OF FORAGE CROPS (IPIL-IPIL OR BANANA)
-  BRUSH DAM
-  DAM / RESERVOIR (SWP)
-  SERVICE ROAD (PROPOSED)
-  SURVEYED AREA
-  BENCH MARK
-  SCREEN HOUSE OFFICE
-  PROPOSED BUNK HOUSE
-  BARANGAY ROAD

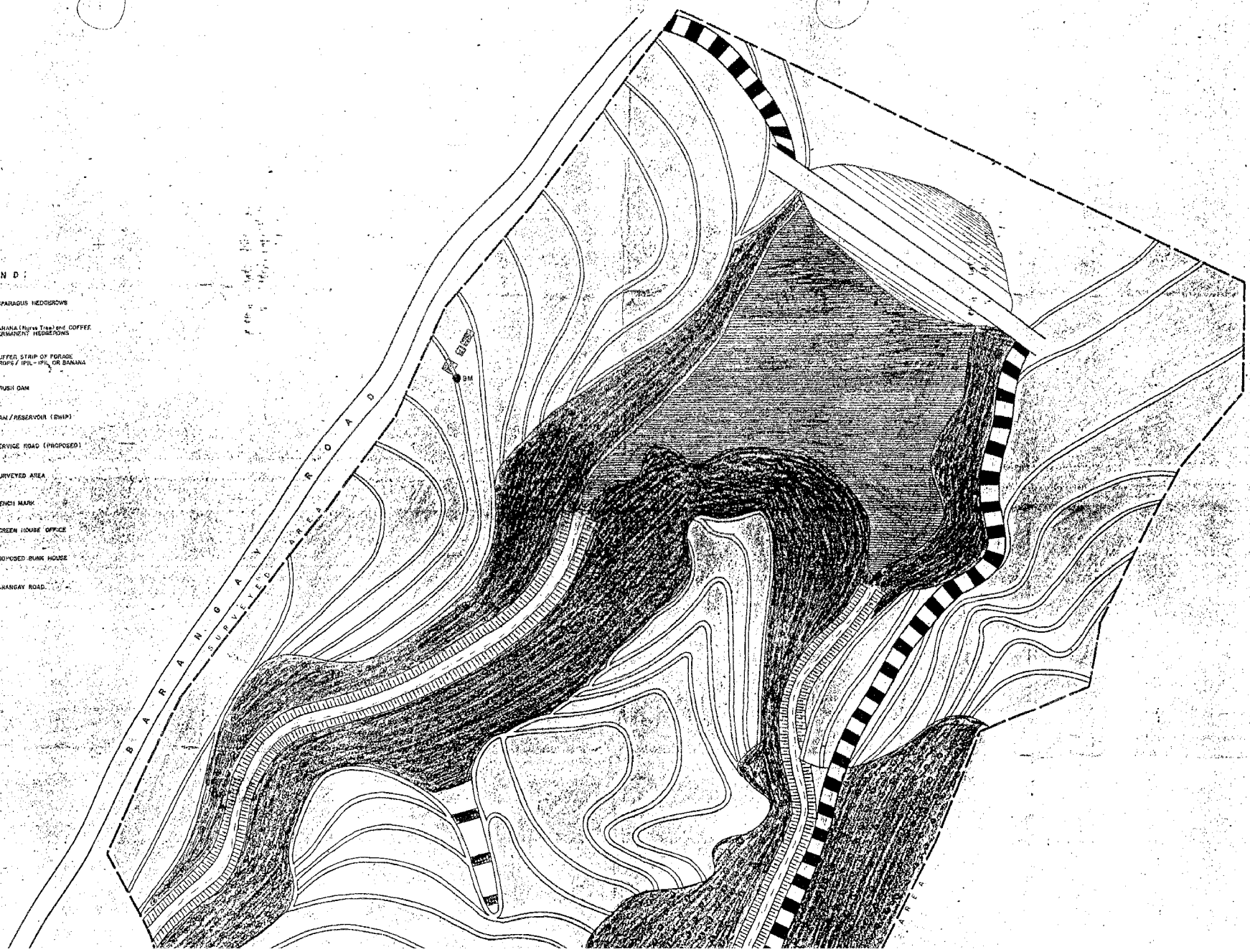

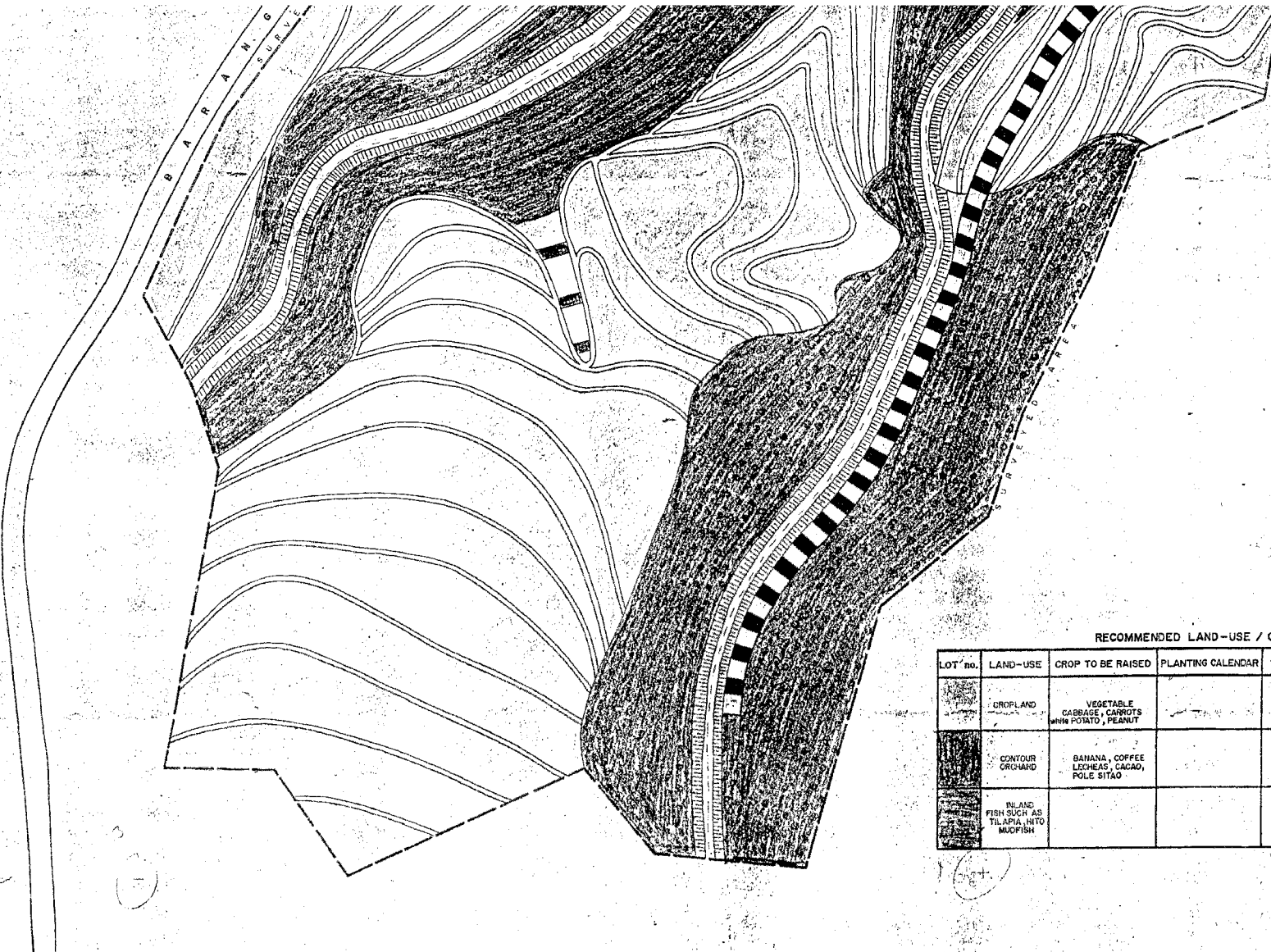

RECOMMENDED LAND-USE / CROPPING SYSTEM

LOT no.	LAND-USE	CROP TO BE RAISED	PLANTING CALENDAR	AREA (ha)	SOIL & WATER CONSERVATION MEASURES AND CULTURAL PRACTICES
1	DROPLAND	VEGETABLE CABBAGE, CARROTS WITH POTATO, PEANUT		3.41	ESTABLISHMENT OF CONTOUR HEDGEROWS (Appropus) 2m. WIDE, APPLICATION OF ORGANIC AND INORGANIC FERTILIZER, INSECTICIDES, OCCASIONAL WEEDING, CROP ROTATION.
2	CONTOUR CROPLAND	BANANA, COFFEE LITCHES, CACAO, POLE SITAO		2.05	CONTOUR PLANTING (4m) APPLICATION OF ORGANIC AND INORGANIC FERTILIZER PERIODIC SPRAYING, OCCASIONAL WEEDING
3	INLAND FISH POND	FISH SUCH AS TILAPIA, NITO MUDFISH		0.77	

FARM DEVELOPMENT PLAN for EPMA TECHNO-DEMO FARM  
SCALE 1:500m

REPUBLIC OF THE PHILIPPINES DEPARTMENT OF AGRICULTURE <b>BUREAU OF SOIL AND WATER MANAGEMENT</b> DILIMAN, QUEZON CITY	DRAWN BY: PATRICIO A. YAMSONT Cartographer	SURVEYED BY: SCMD Staff PAD, Bukidnon	CHECKED BY: NORMIARC STOTT Chief, Land-Use Planning Section	RECOMMENDING APPROPRIAL: DR. JOSE D. RONDA Chief, SCMD	APPROVED BY: DR. ROGELIO N. CONCEPCION Director, BSWM	Sitio Intavas, La Fortuna Impasug-ong, BUKIDNON	SHEET NO.
	(Empty space for additional notes or signatures)						