

GOVERNMENT OF THE REPUBLIC OF GHANA
 MINISTRY OF ROAD AND TRANSPORT GHANA HIGHWAY AUTHORITY
 KATAHIRA & ENGINEERS INTERNATIONAL
 NOTES:
 PROJECT: THE PROJECT FOR REHABILITATION OF TRUNK ROAD
 TITLE: PLAN AND PROFILE (83/83)
 SCALE: V = 1:200 H = 1:2000
 DRAWING No: PL-63

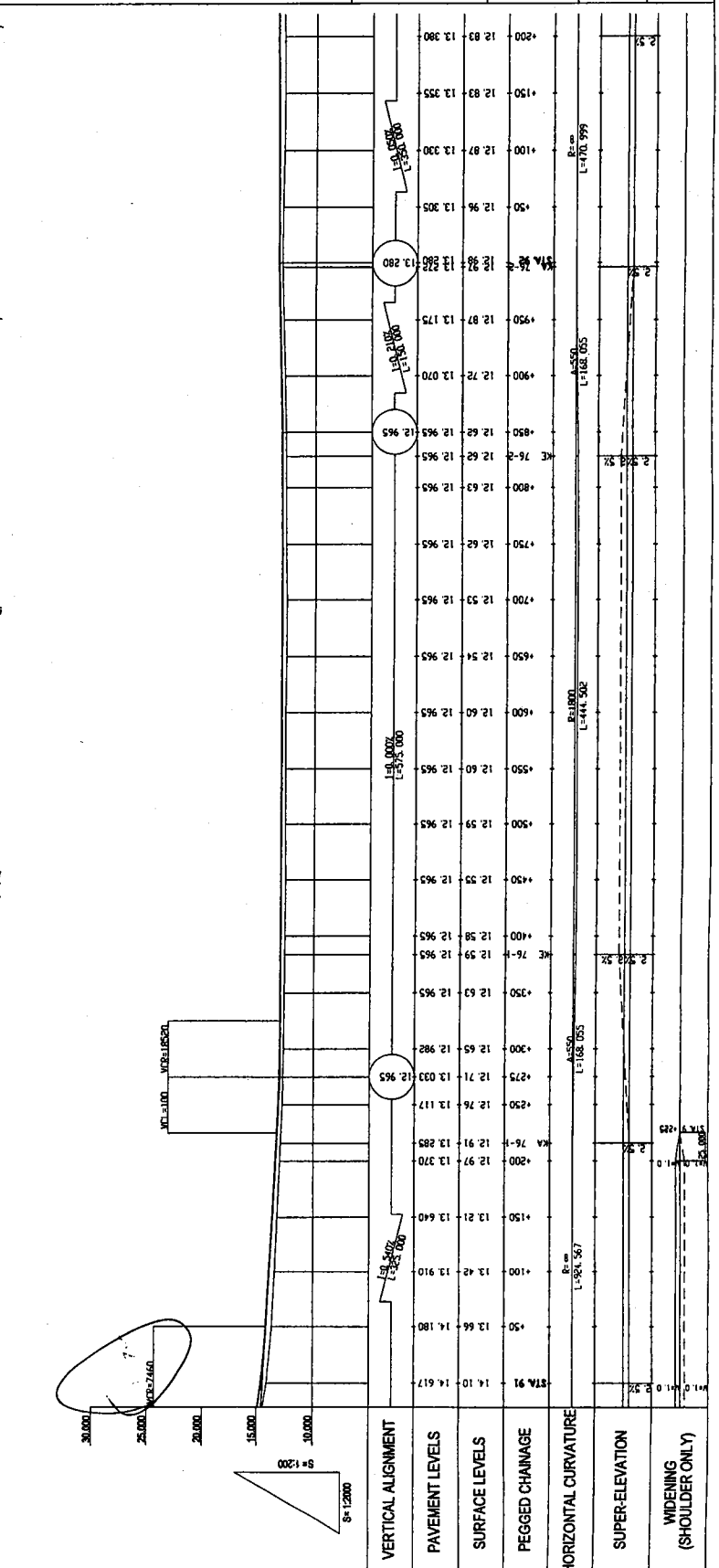

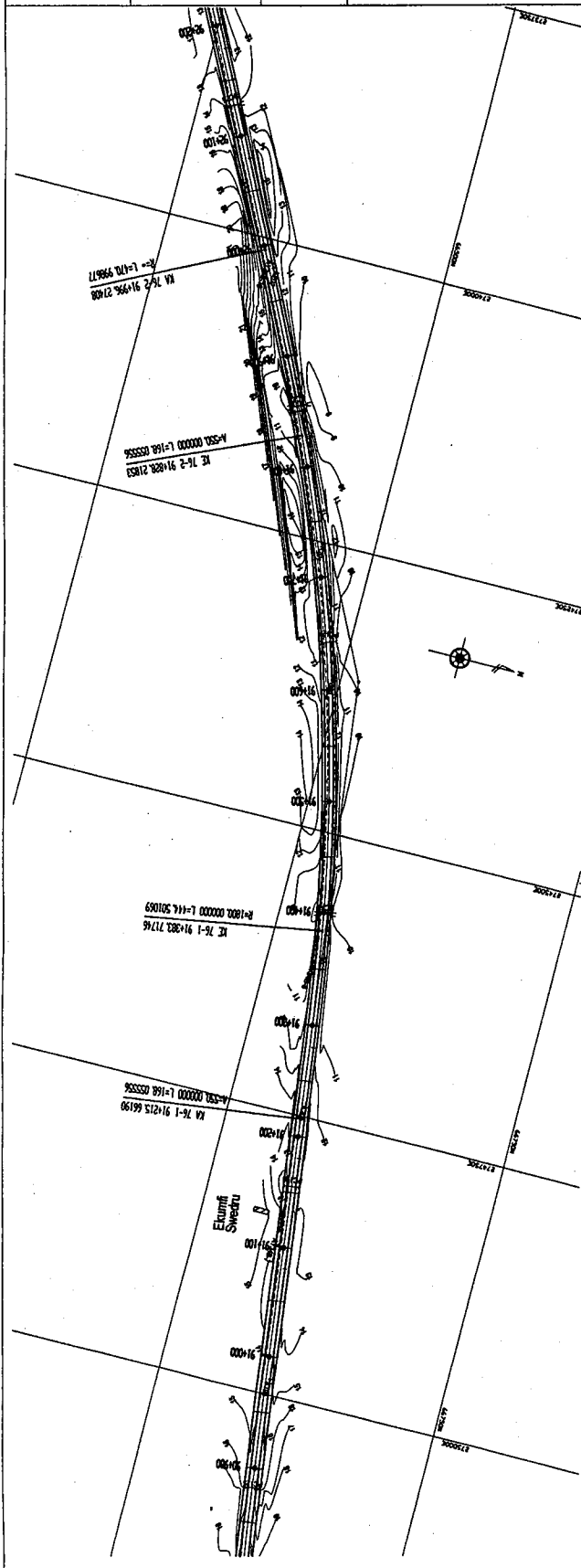

GOVERNMENT OF THE REPUBLIC OF GHANA
 MINISTRY OF ROAD AND TRANSPORT GHANA HIGHWAY AUTHORITY
 KATAHIRA & ENGINEERS INTERNATIONAL
 NOTES:
 PROJECT: THE PROJECT FOR REHABILITATION OF TRUNK ROAD
 TITLE: PLAN AND PROFILE (65/83)
 SCALE: V = 1:200 H = 1:2000
 DRAWING NO: PL-65

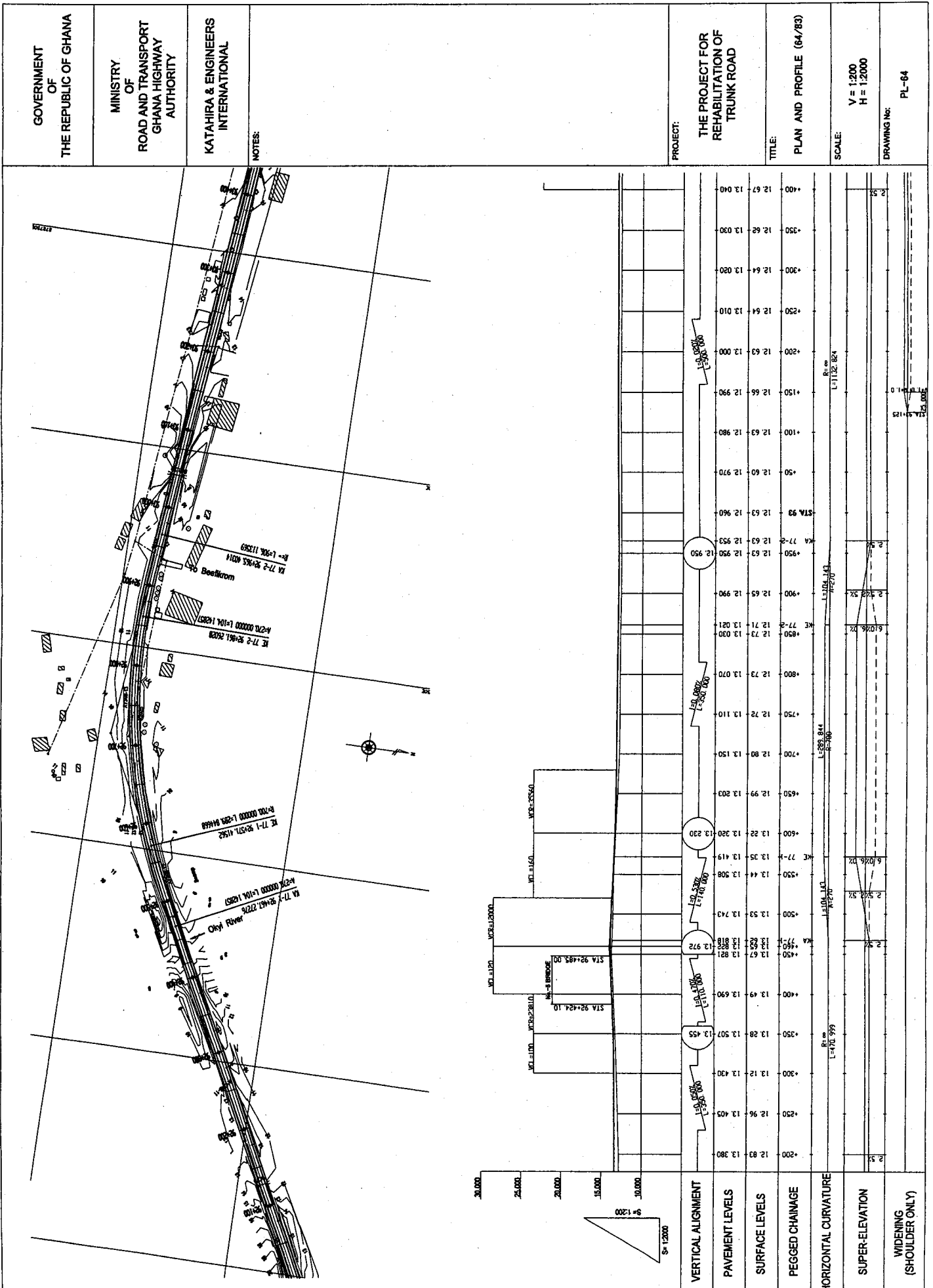
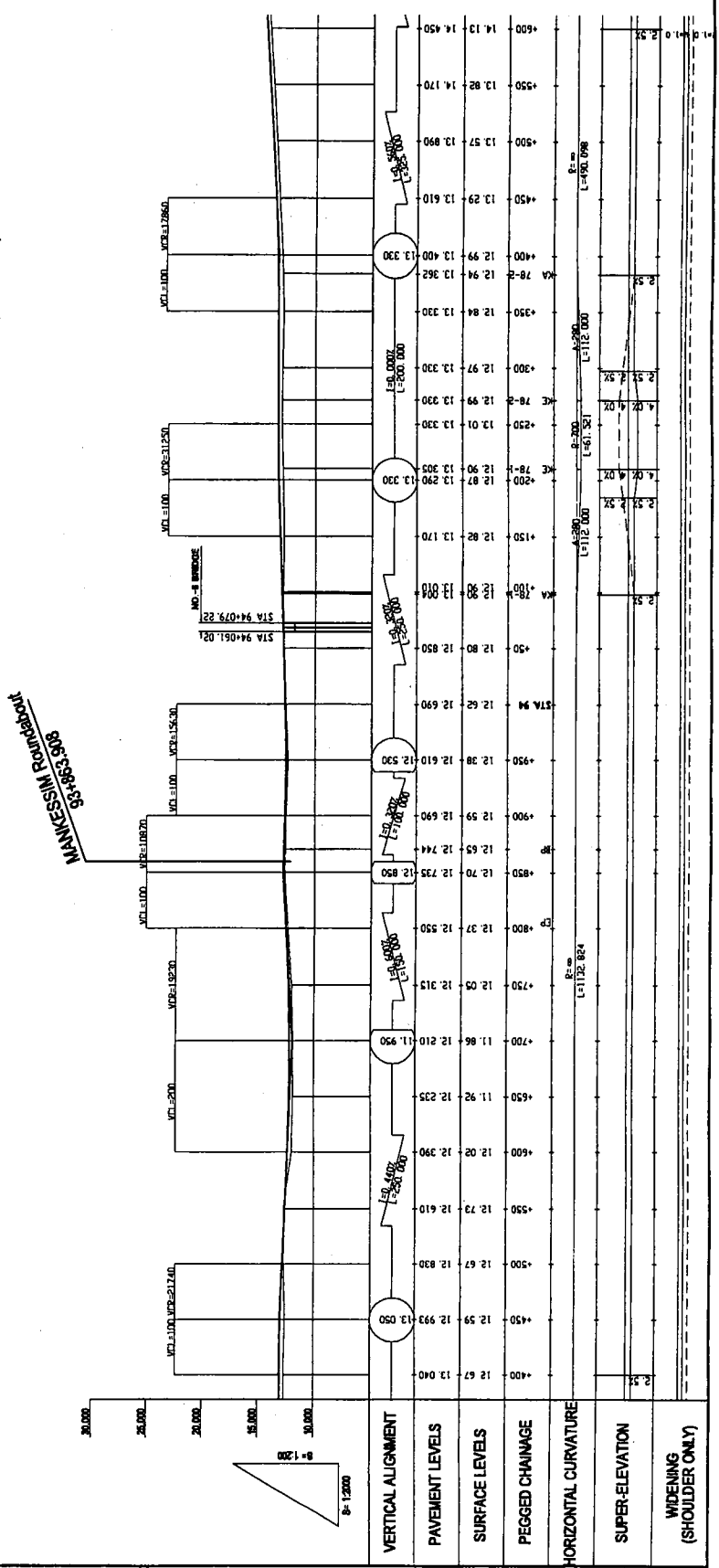
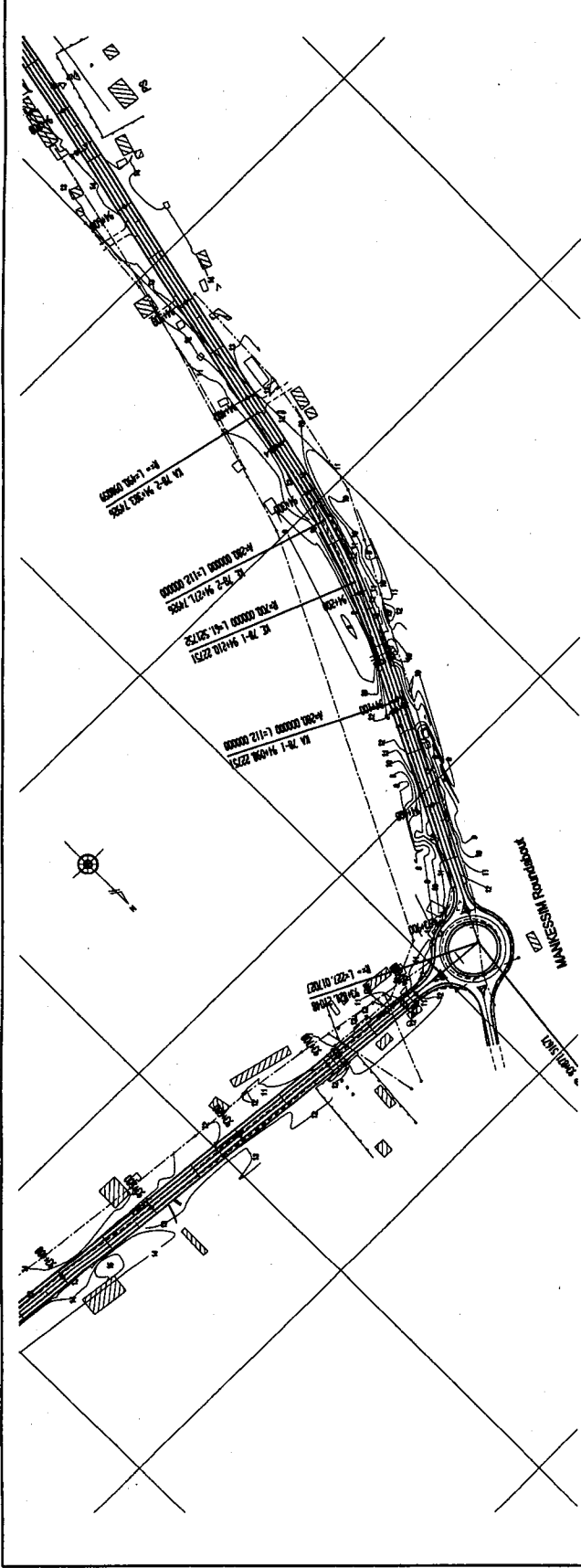

GOVERNMENT
OF
THE REPUBLIC OF GHANA

MINISTRY
OF
ROAD AND TRANSPORT
GHANA HIGHWAY
AUTHORITY

KATAHIRA & ENGINEERS
INTERNATIONAL

NOTES:

PROJECT:

THE PROJECT FOR
REHABILITATION OF
TRUNK ROAD

TITLE:

PLAN AND PROFILE (66/83)

SCALE:

V = 1:200
H = 1:2000

DRAWING NO:

PL-66

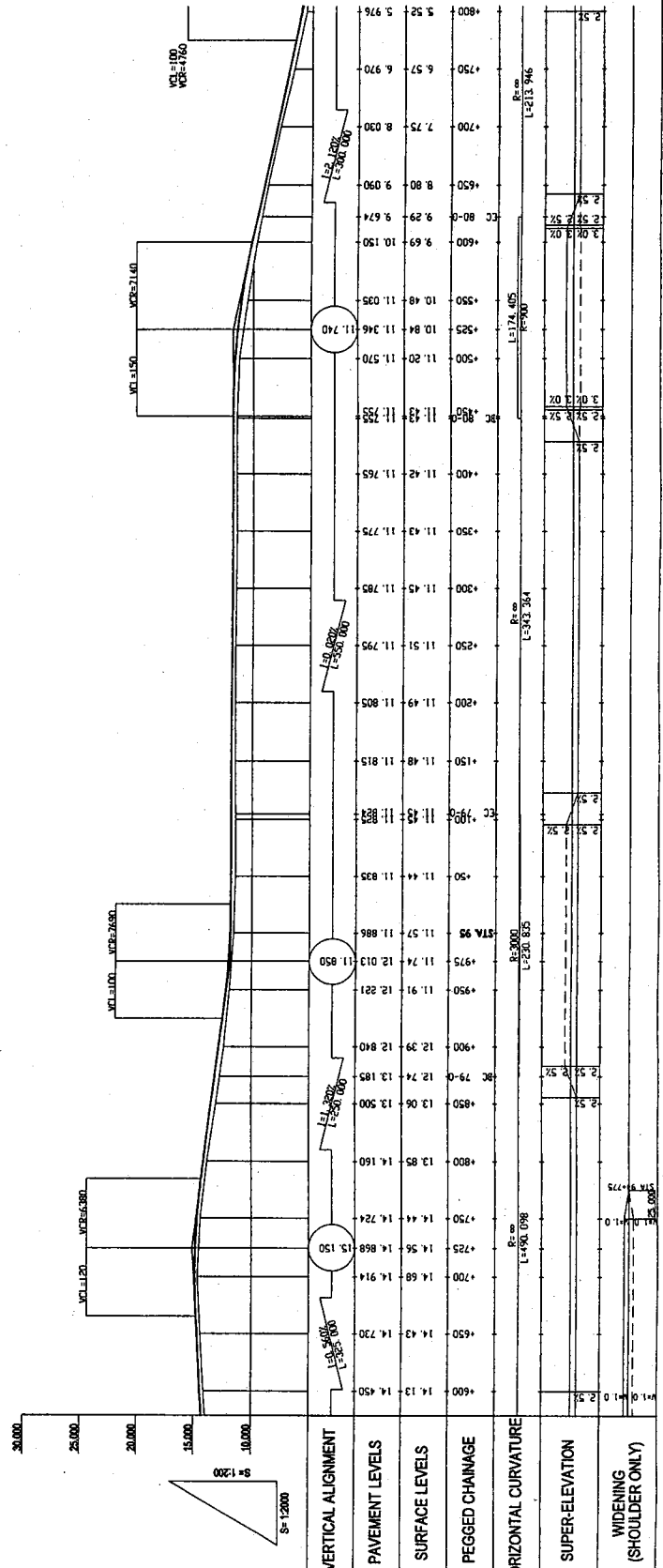
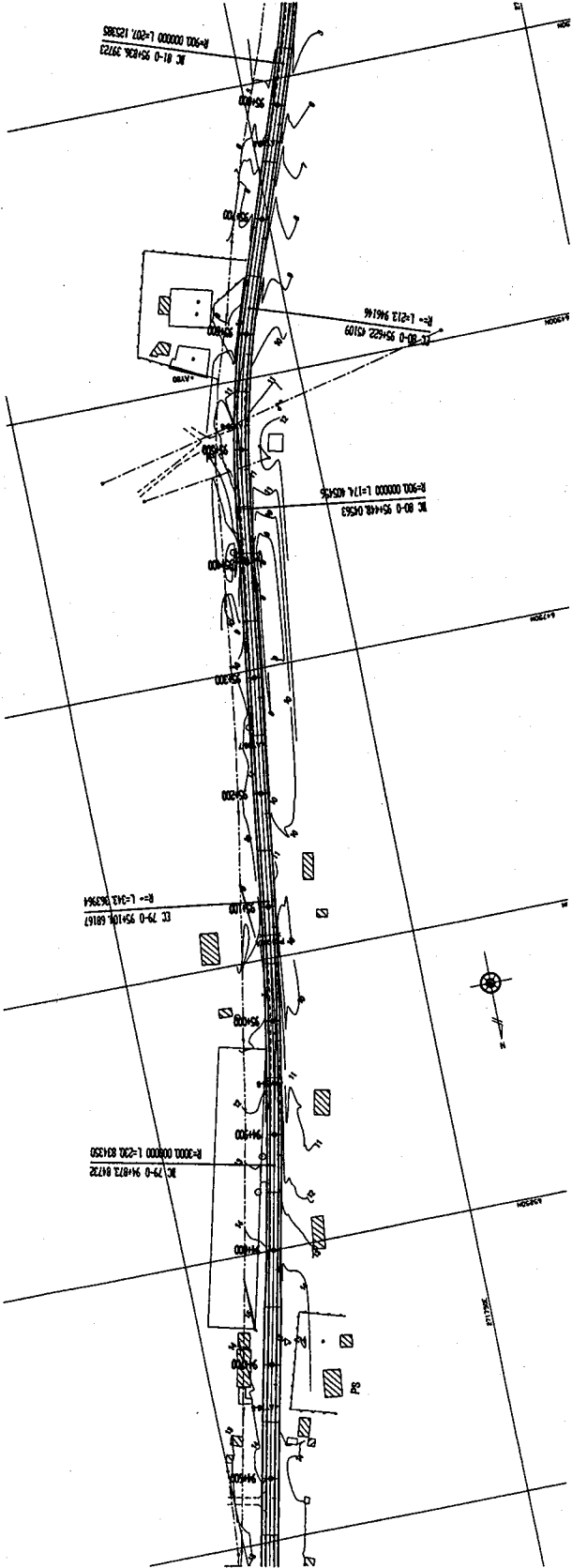

GOVERNMENT OF THE REPUBLIC OF GHANA
 MINISTRY OF ROAD AND TRANSPORT GHANA HIGHWAY AUTHORITY
 KATAHIRA & ENGINEERS INTERNATIONAL
 NOTES:
 PROJECT: THE PROJECT FOR THE REHABILITATION OF TRUNK ROAD
 TITLE: PLAN AND PROFILE (87/83)
 SCALE: V = 1:2000 H = 1:2000
 DRAWING No: PL-67

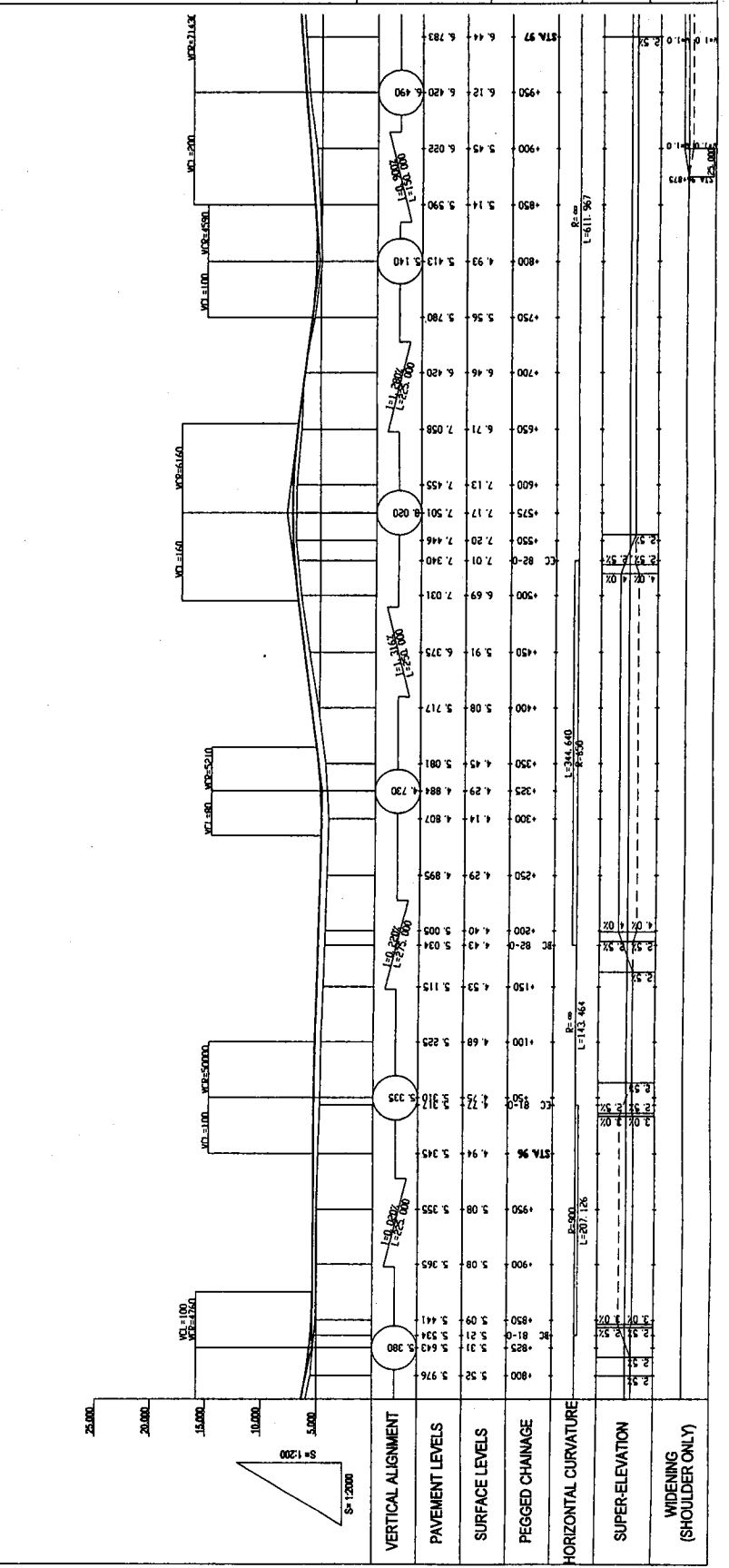
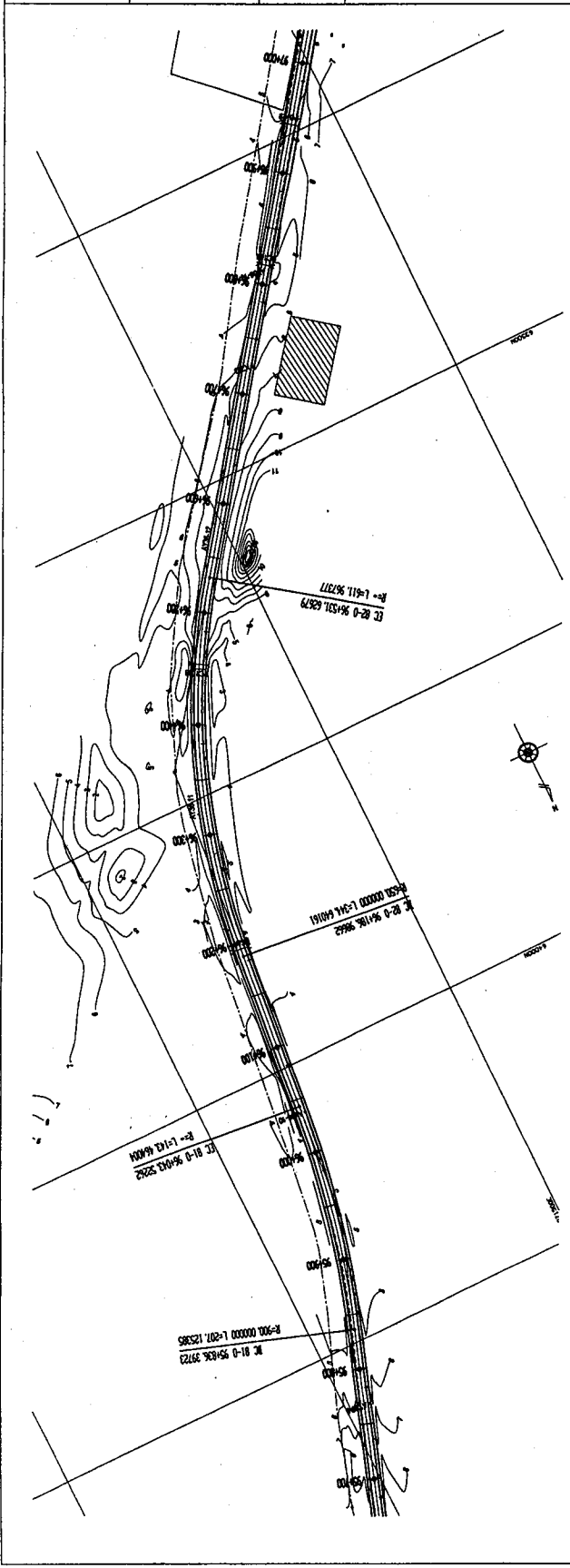

GOVERNMENT OF THE REPUBLIC OF GHANA

MINISTRY OF ROAD AND TRANSPORT GHANA HIGHWAY AUTHORITY

KATAHIRA & ENGINEERS INTERNATIONAL

NOTES:

PROJECT: THE PROJECT FOR REHABILITATION OF TRUNK ROAD

TITLE: PLAN AND PROFILE (88/83)

SCALE: V = 1:200 H = 1:2000

DRAWING No: PL-68

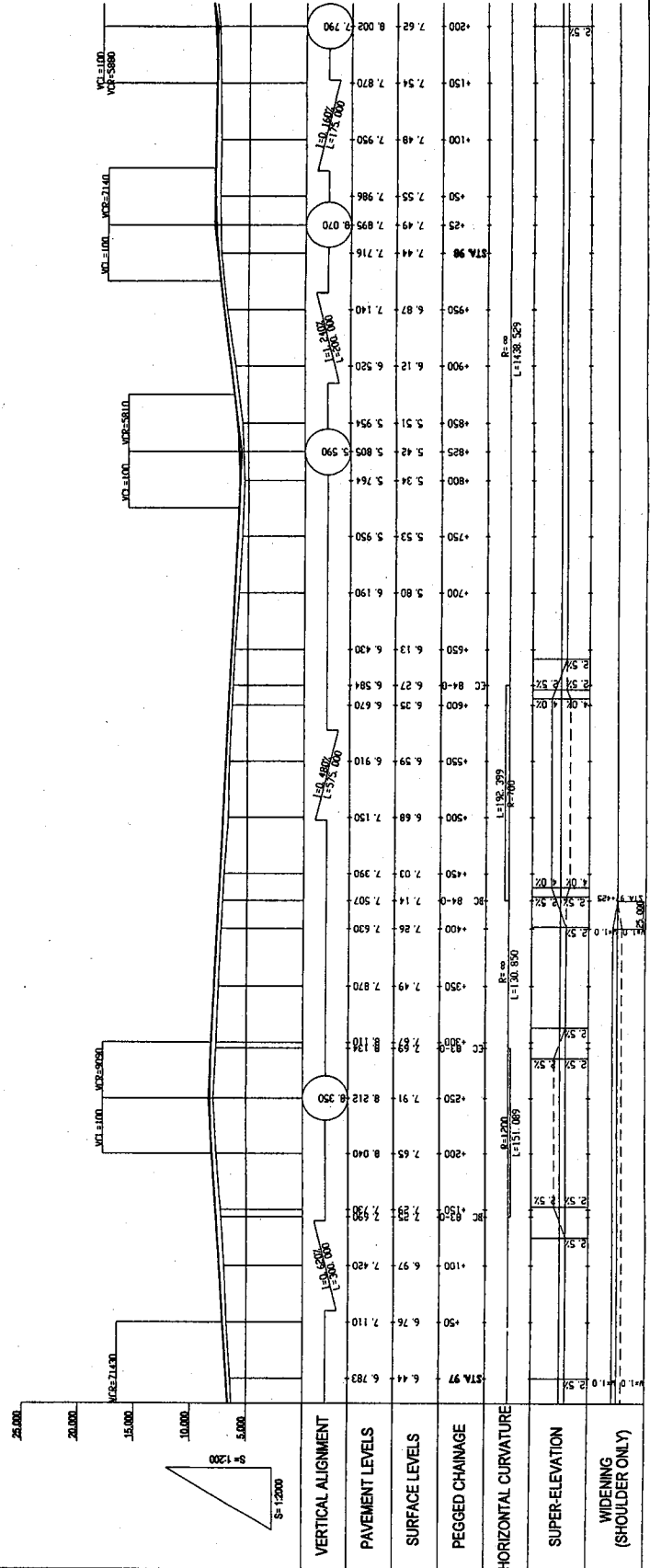
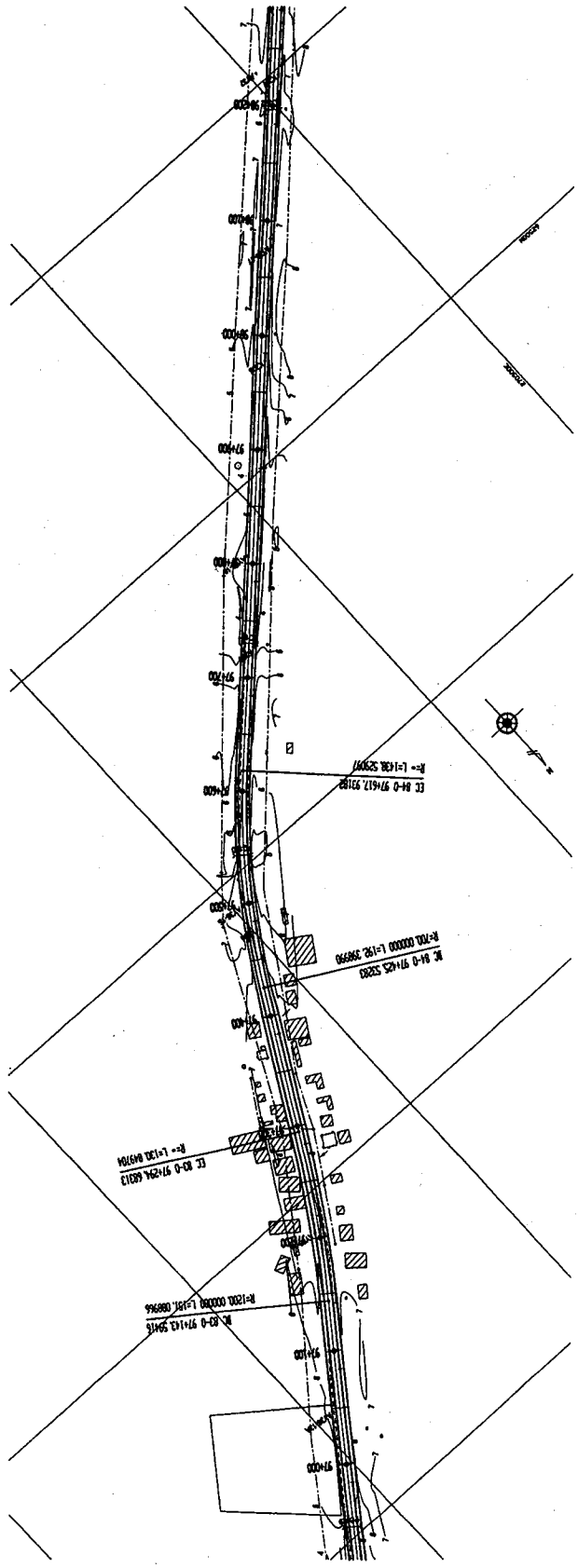

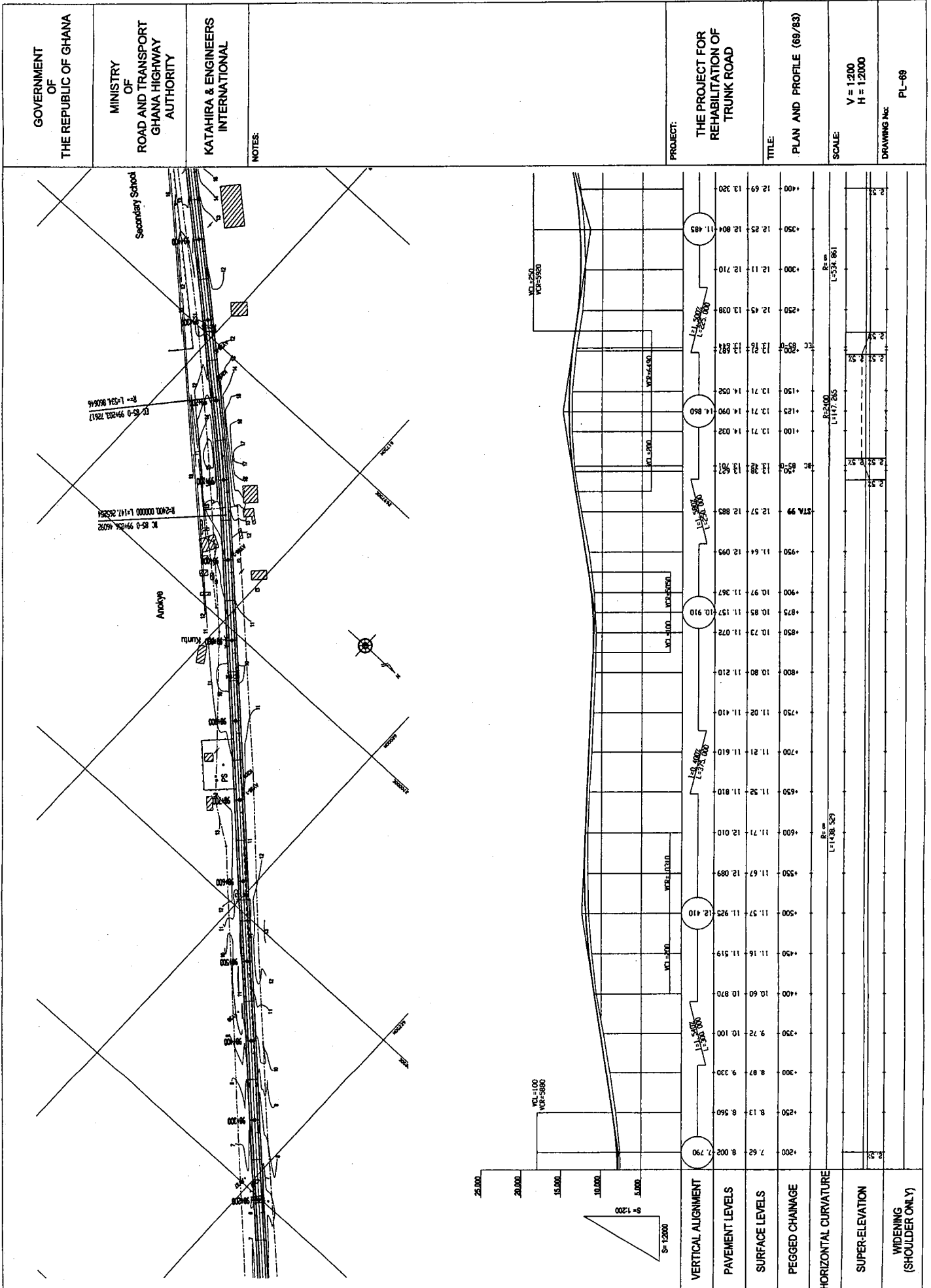

GOVERNMENT OF THE REPUBLIC OF GHANA

MINISTRY OF ROAD AND TRANSPORT GHANA HIGHWAY AUTHORITY

KATAHIRA & ENGINEERS INTERNATIONAL

NOTES:

PROJECT: THE PROJECT FOR REHABILITATION OF TRUNK ROAD

TITLE: PLAN AND PROFILE (70/83)

SCALE: V = 1:200 H = 1:2000

DRAWING No: PL-70

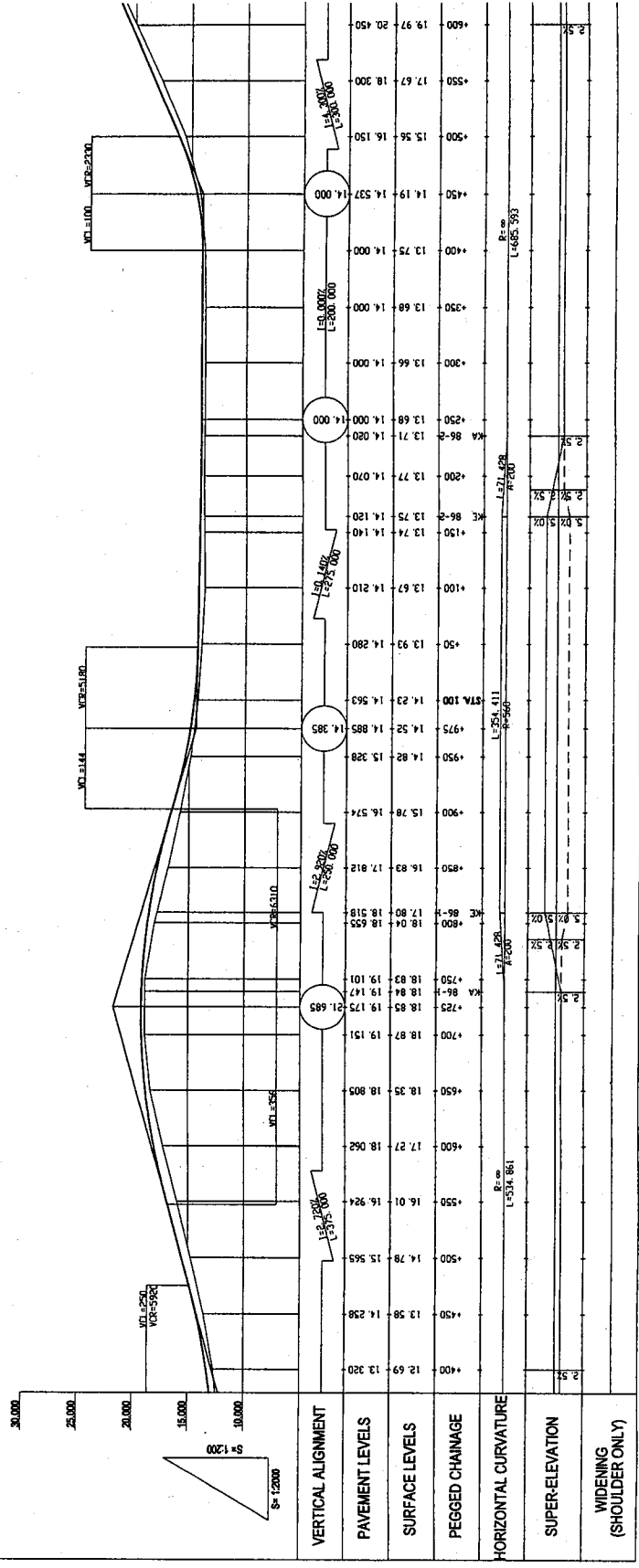
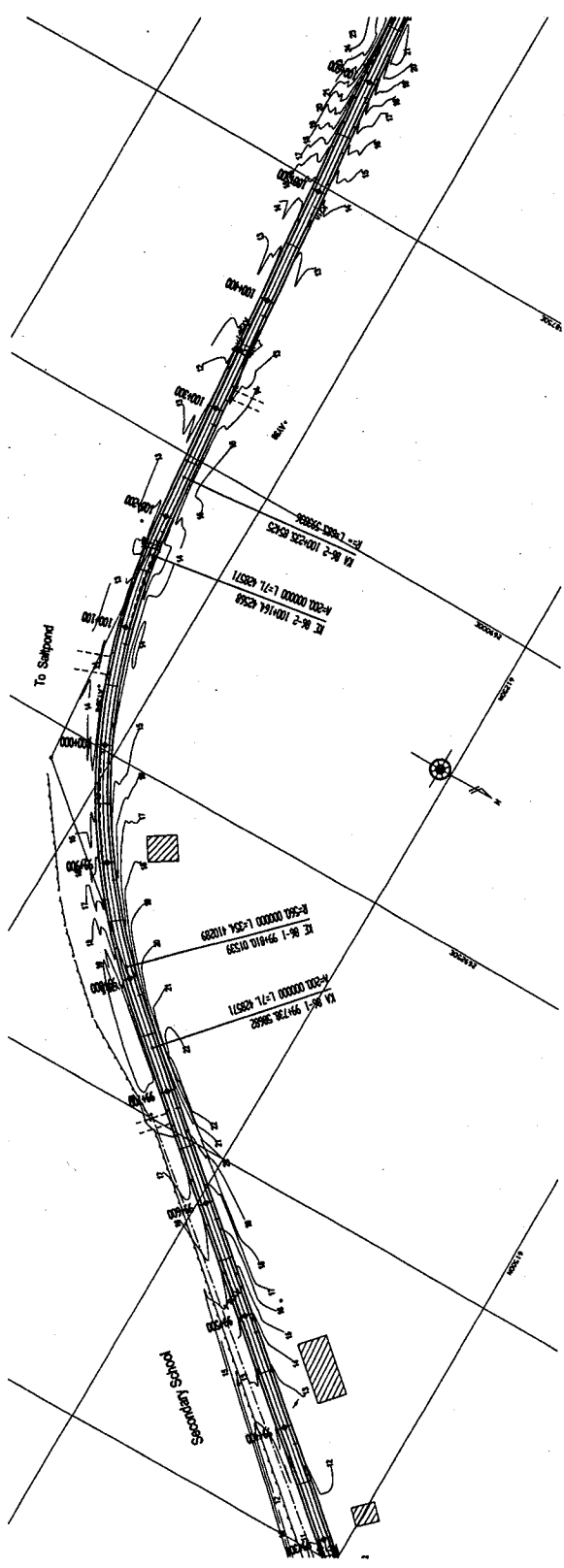

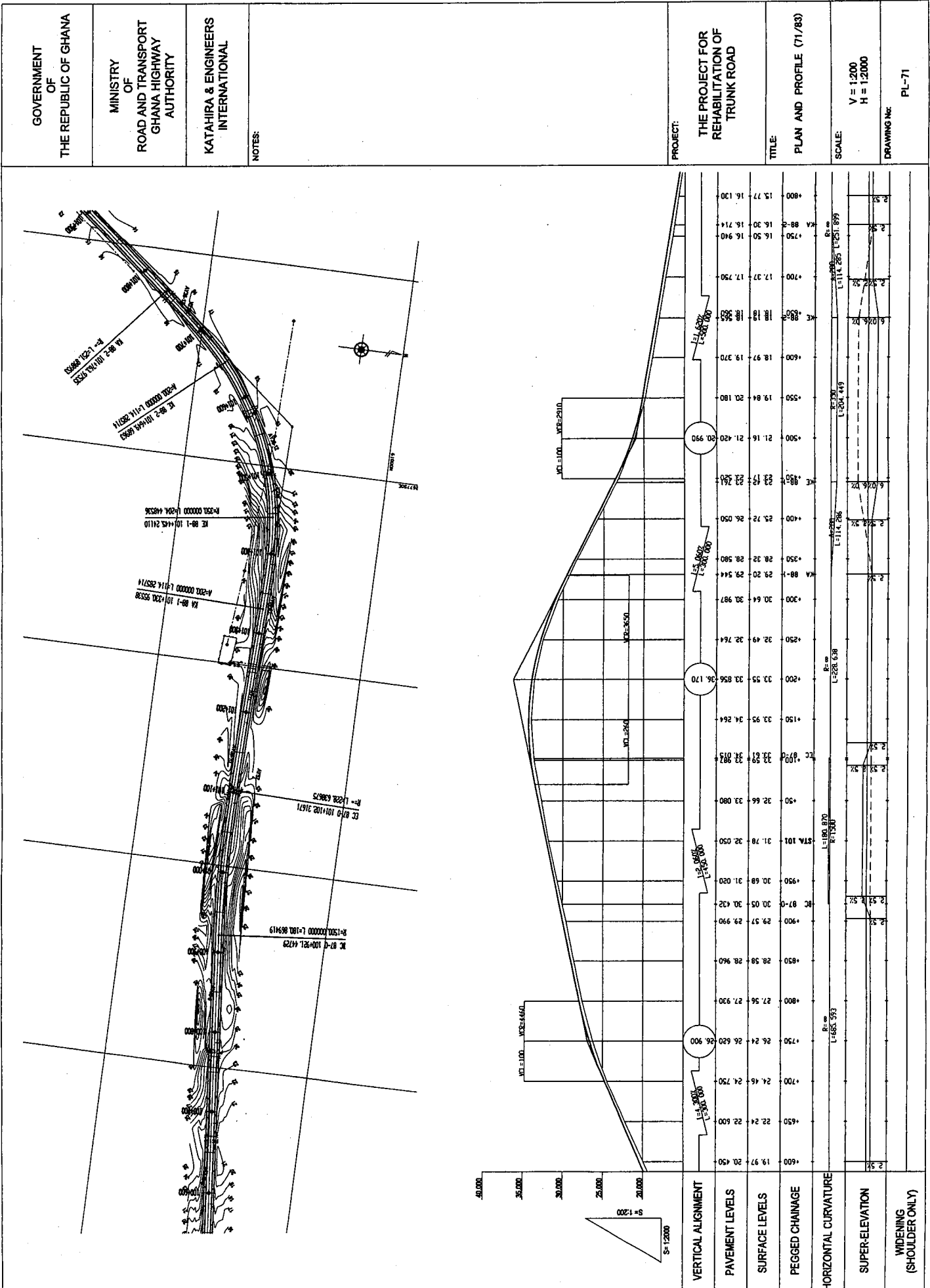

GOVERNMENT
OF
THE REPUBLIC OF GHANA

MINISTRY
OF
ROAD AND TRANSPORT
GHANA HIGHWAY
AUTHORITY

KATAHIRA & ENGINEERS
INTERNATIONAL

NOTES:

PROJECT:
THE PROJECT FOR
REHABILITATION OF
TRUNK ROAD

TITLE:
PLAN AND PROFILE (71/83)

SCALE:
V = 1:200
H = 1:2000

DRAWING NO:
PL-71

VERTICAL ALIGNMENT	PAVEMENT LEVELS	SURFACE LEVELS	PEGGED CHAINAGE	HORIZONTAL CURVATURE	SUPER-ELEVATION	WIDENING (SHOULDER ONLY)
	19.97	20.450			2.5%	
	22.24	22.600			2.5%	
	24.46	24.750			2.5%	
	26.24	26.620	66.900		2.5%	
	27.56	27.930			2.5%	
	28.58	28.960			2.5%	
	29.57	29.990			2.5%	
	30.05	30.432			2.5%	
	30.68	31.020			2.5%	
	31.78	32.050			2.5%	
	32.66	33.080			2.5%	
	33.59	33.987			2.5%	
	33.59	33.987			2.5%	
	33.55	33.956	36.170		2.5%	
	32.49	32.764			2.5%	
	30.64	30.977			2.5%	
	29.20	29.544			2.5%	
	28.32	28.580			2.5%	
	25.72	26.050			2.5%	
	23.17	23.250			2.5%	
	18.97	19.370			2.5%	
	18.18	18.560			2.5%	
	17.37	17.750			2.5%	
	16.50	16.940			2.5%	
	16.30	16.714			2.5%	
	15.77	16.120			2.5%	

GOVERNMENT OF THE REPUBLIC OF GHANA	MINISTRY OF ROAD AND TRANSPORT GHANA HIGHWAY AUTHORITY	KATAHIRA & ENGINEERS INTERNATIONAL	NOTES:	PROJECT: THE PROJECT FOR REHABILITATION OF TRUNK ROAD	TITLE: PLAN AND PROFILE (72/83)	SCALE: V = 1:200 H = 1:2000	DRAWING No: PL-72

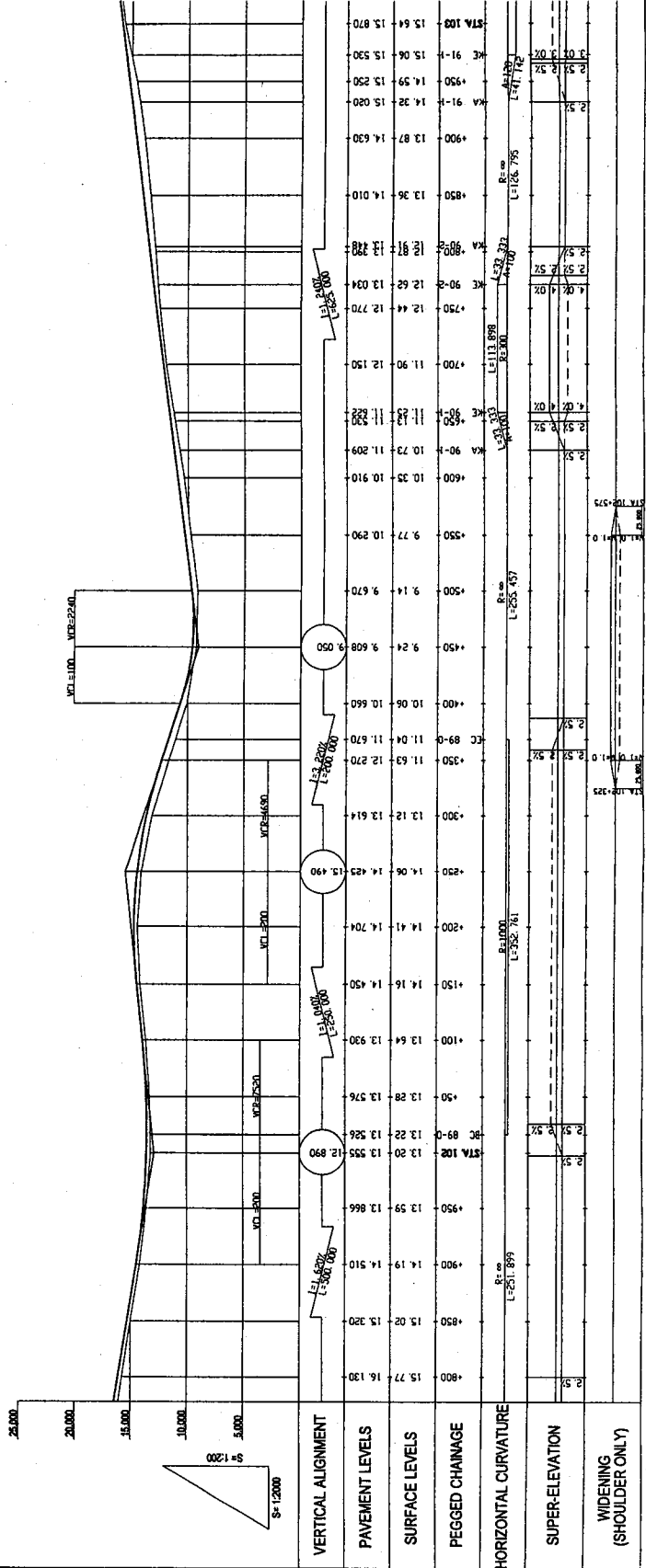
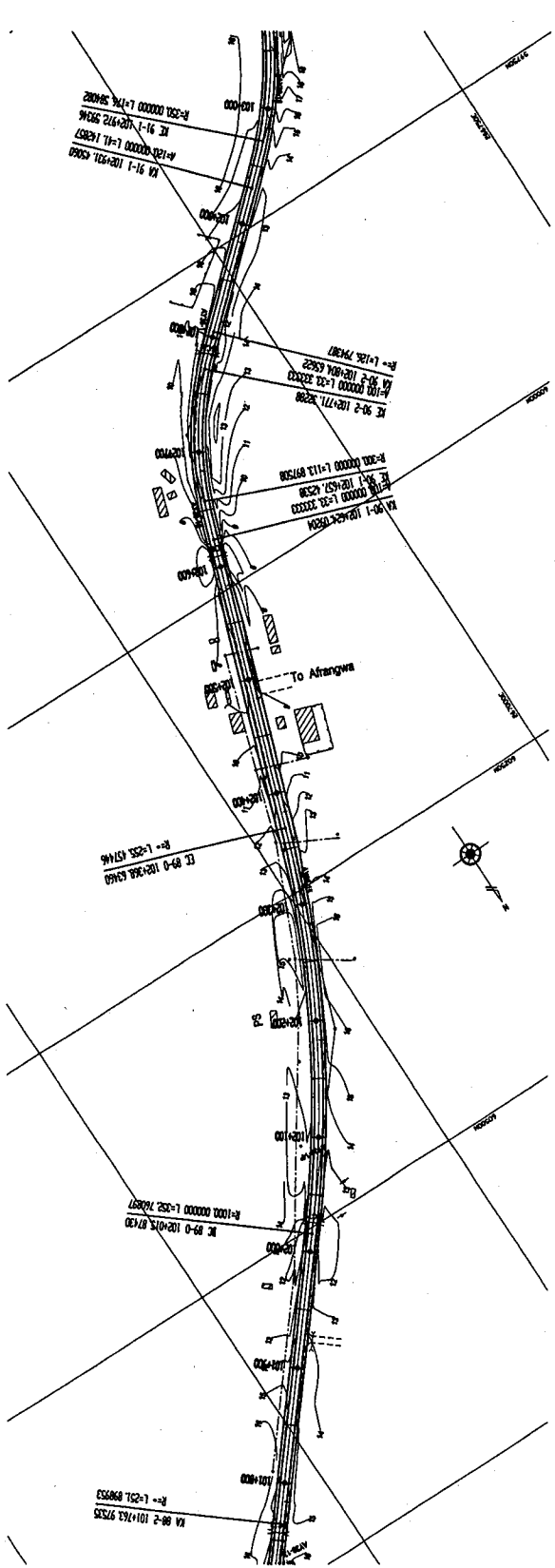

GOVERNMENT OF THE REPUBLIC OF GHANA
 MINISTRY OF ROAD AND TRANSPORT GHANA HIGHWAY AUTHORITY
 KATAHIRA & ENGINEERS INTERNATIONAL
 NOTES:
 PROJECT: THE PROJECT FOR THE REHABILITATION OF TRUNK ROAD
 TITLE: PLAN AND PROFILE (73/83)
 SCALE: V = 1:200 H = 1:2000
 DRAWING No: PL-73

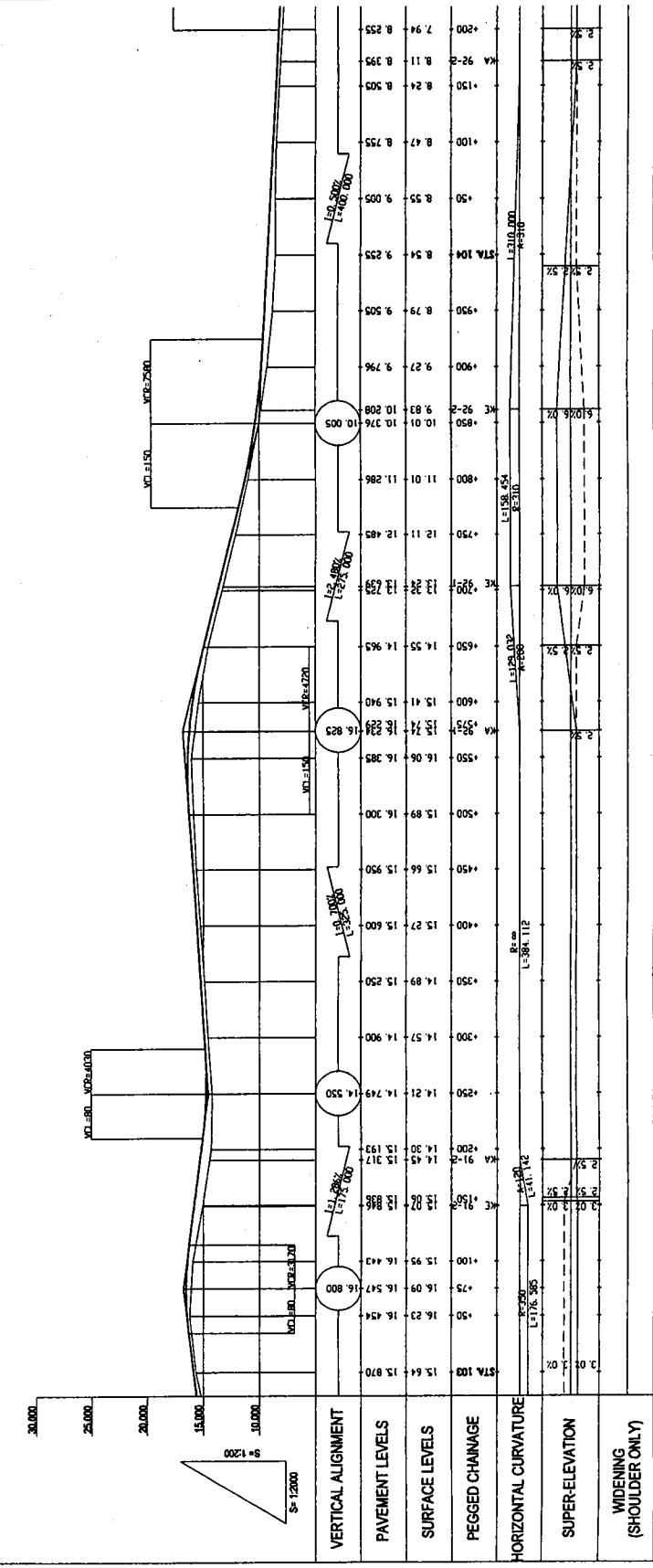
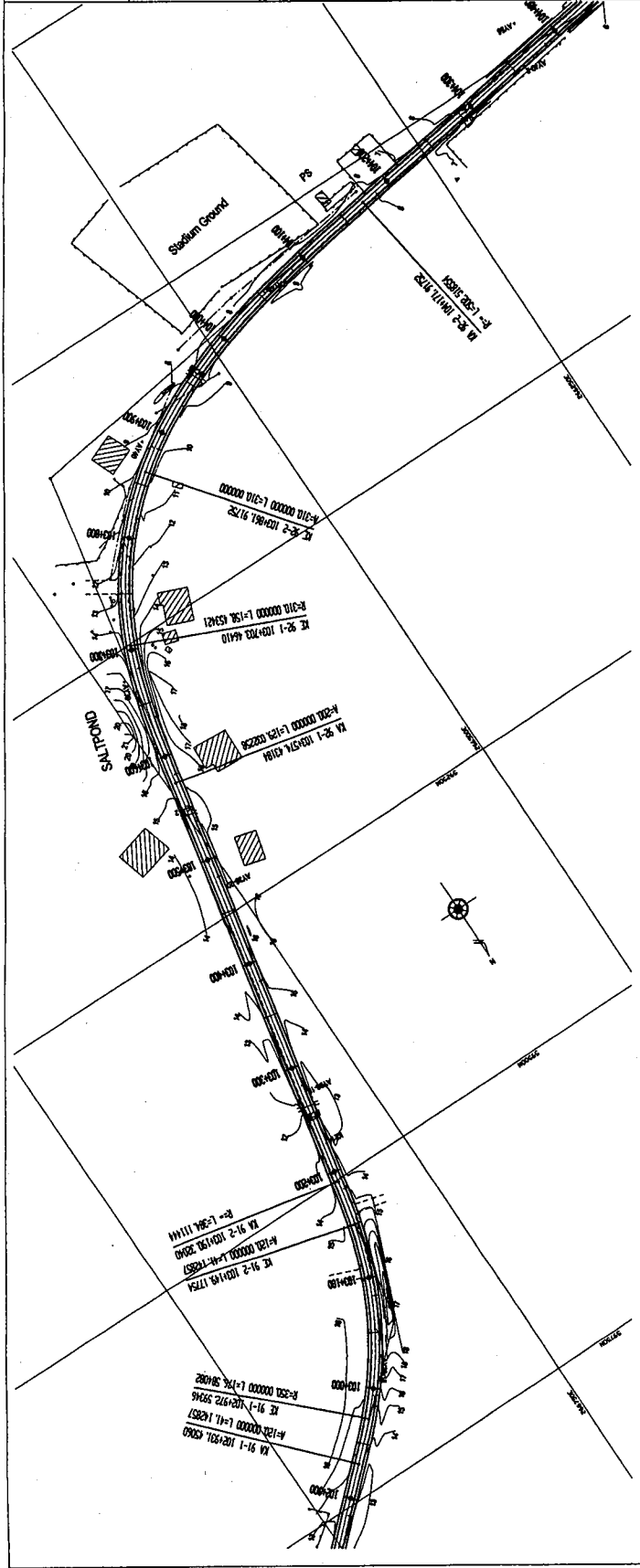

GOVERNMENT OF THE REPUBLIC OF GHANA
 MINISTRY OF ROAD AND TRANSPORT GHANA HIGHWAY AUTHORITY
 KATAHIRA & ENGINEERS INTERNATIONAL
 NOTES:
 PROJECT: THE PROJECT FOR THE REHABILITATION OF TRUNK ROAD
 TITLE: PLAN AND PROFILE (7/4/83)
 SCALE: V = 1:200 H = 1:2000
 DRAWING No: PL-74

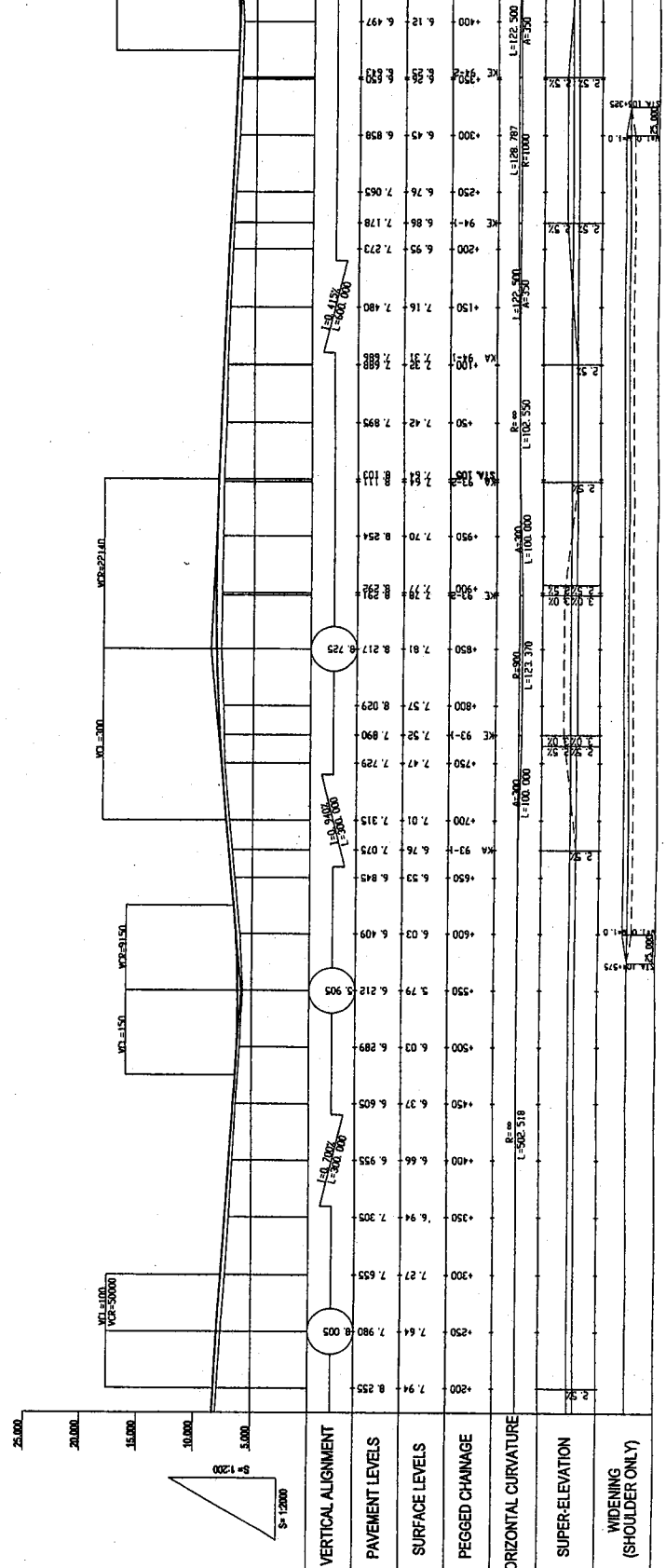
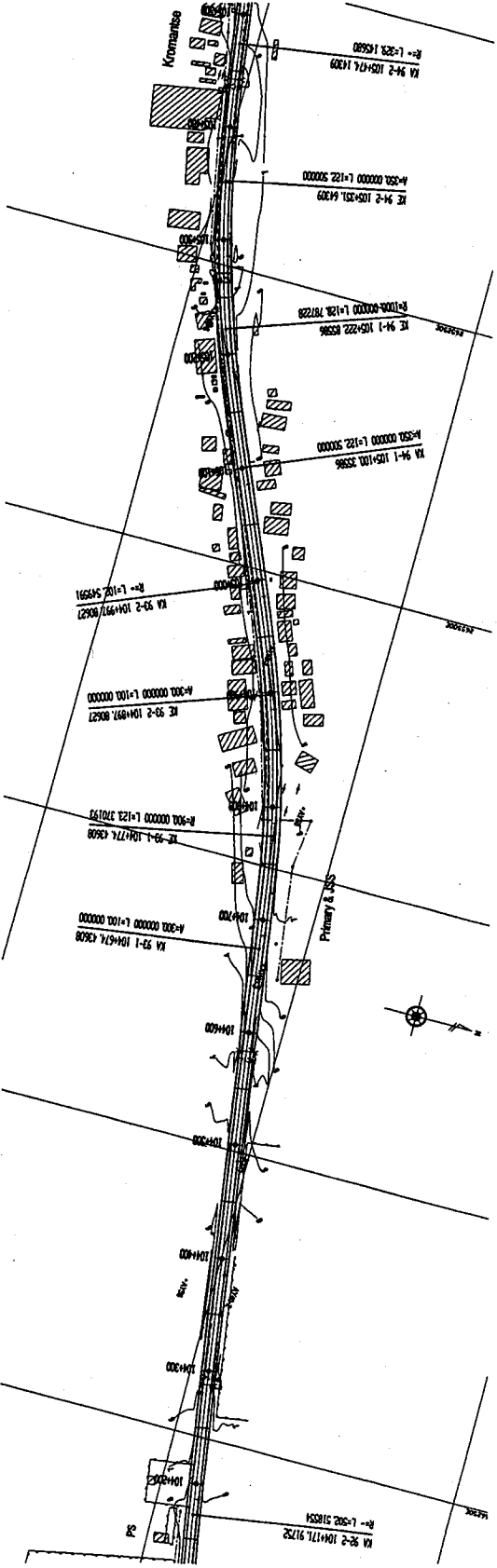

GOVERNMENT OF THE REPUBLIC OF GHANA
 MINISTRY OF ROAD AND TRANSPORT GHANA HIGHWAY AUTHORITY
 KATAHIRA & ENGINEERS INTERNATIONAL
 NOTES:
 PROJECT: THE PROJECT FOR REHABILITATION OF TRUNK ROAD
 TITLE: PLAN AND PROFILE (7563)
 SCALE: V = 1:200 H = 1:2000
 DRAWING No: PL-75

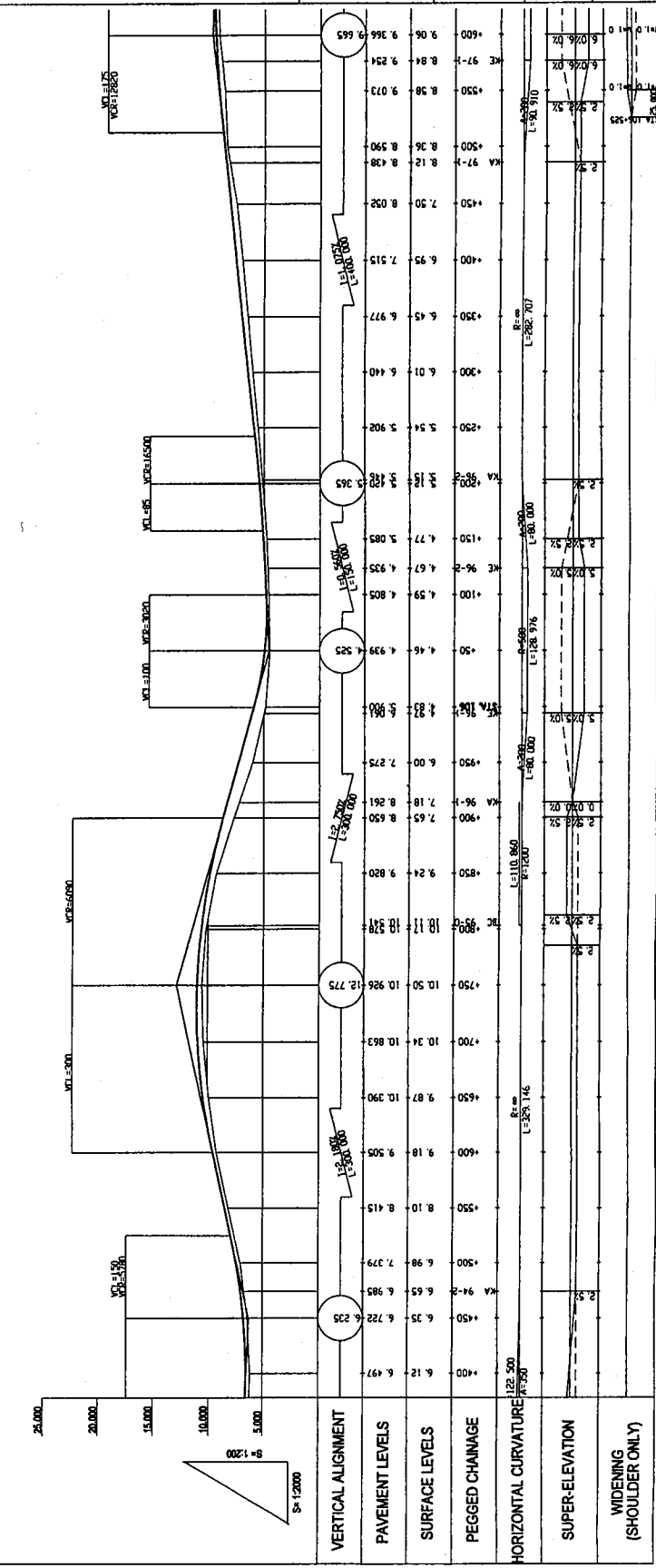
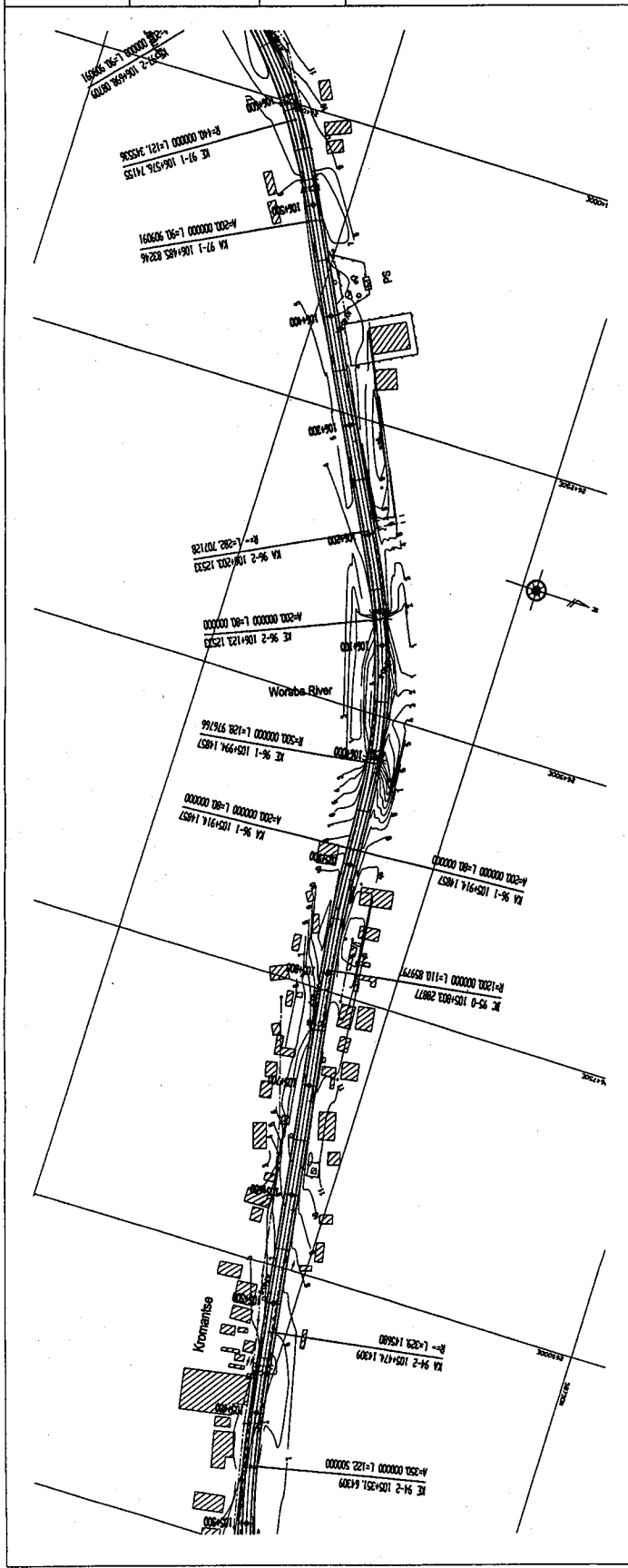

GOVERNMENT OF THE REPUBLIC OF GHANA

MINISTRY OF ROAD AND TRANSPORT GHANA HIGHWAY AUTHORITY

KATAHIRA & ENGINEERS INTERNATIONAL

NOTES:

PROJECT: THE PROJECT FOR REHABILITATION OF TRUNK ROAD

TITLE:

PLAN AND PROFILE (76/83)

SCALE: V = 1:2000 H = 1:2000

DRAWING No: PL-76

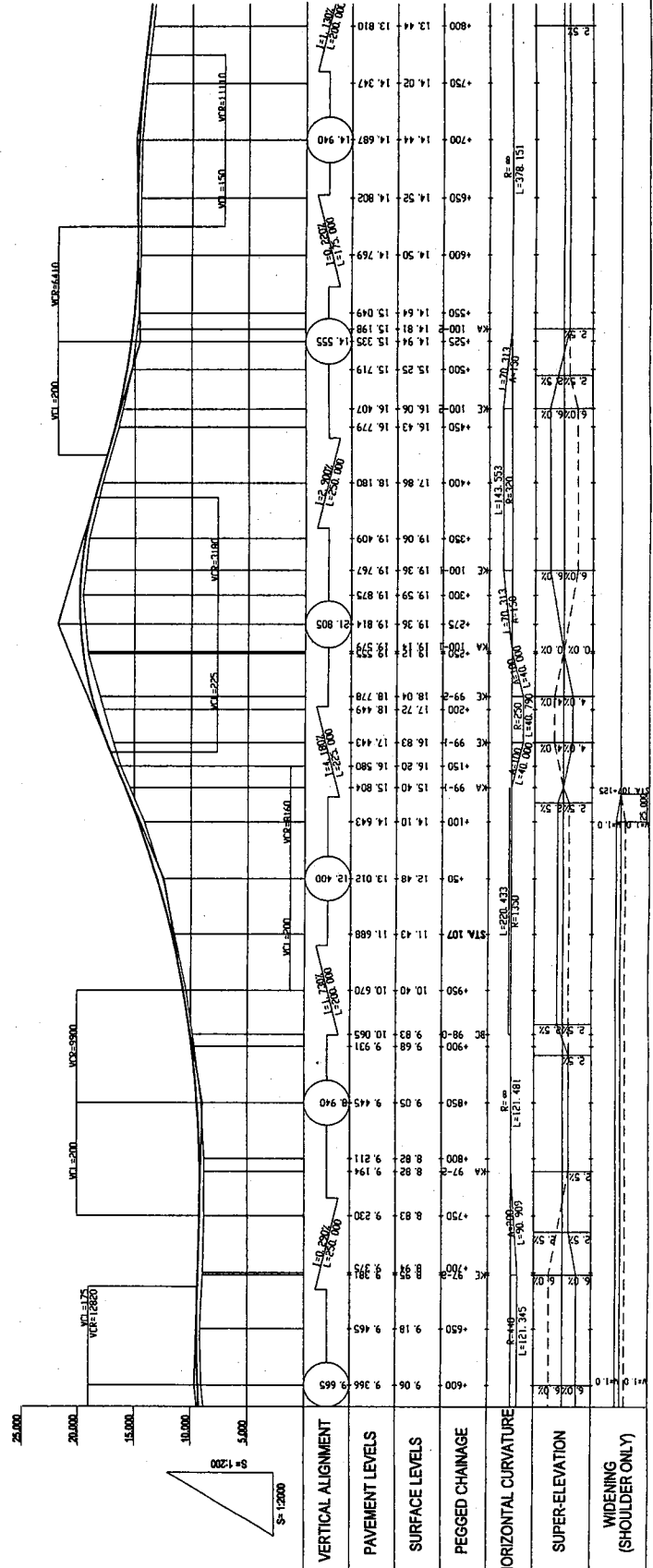
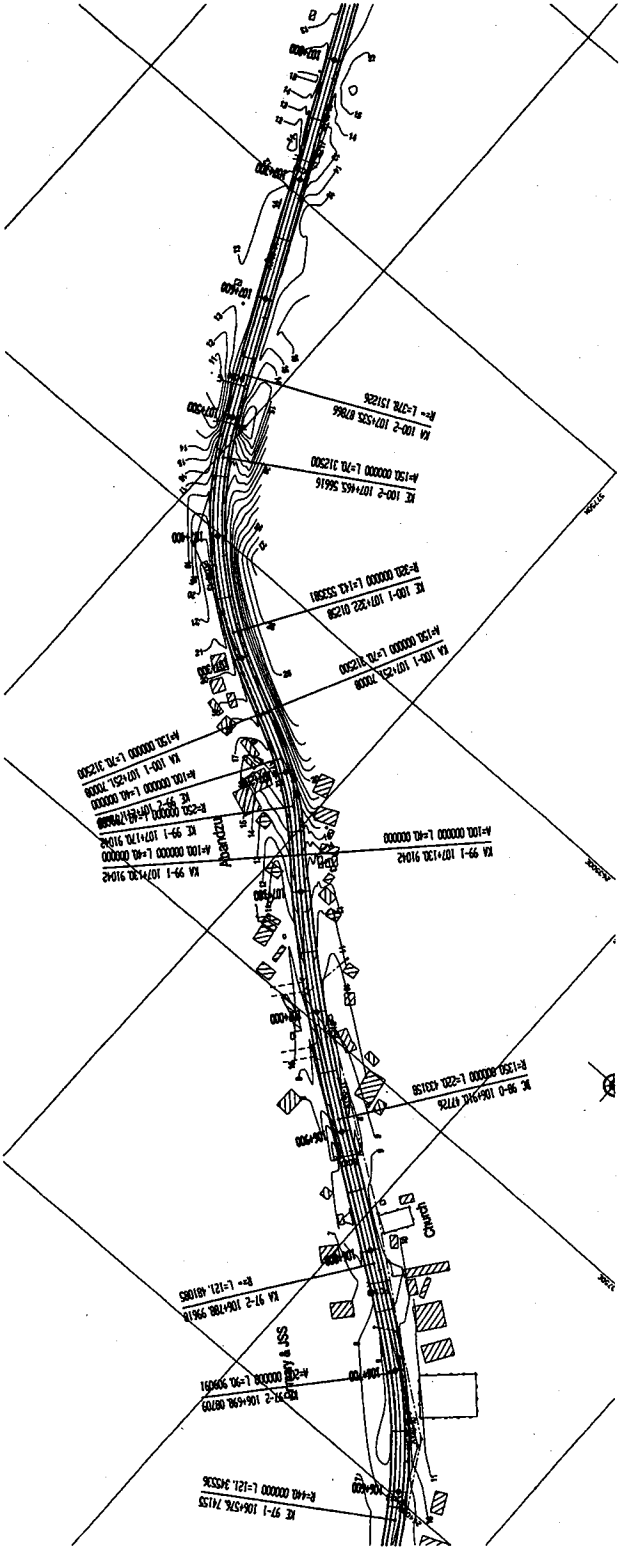

GOVERNMENT OF THE REPUBLIC OF GHANA
 MINISTRY OF ROAD AND TRANSPORT GHANA HIGHWAY AUTHORITY
 KATAHIRA & ENGINEERS INTERNATIONAL
 NOTES:
 PROJECT: THE PROJECT FOR REHABILITATION OF TRUNK ROAD
 TITLE: PLAN AND PROFILE (7783)
 SCALE: V = 1:200 H = 1:2000
 DRAWING No: PL-77

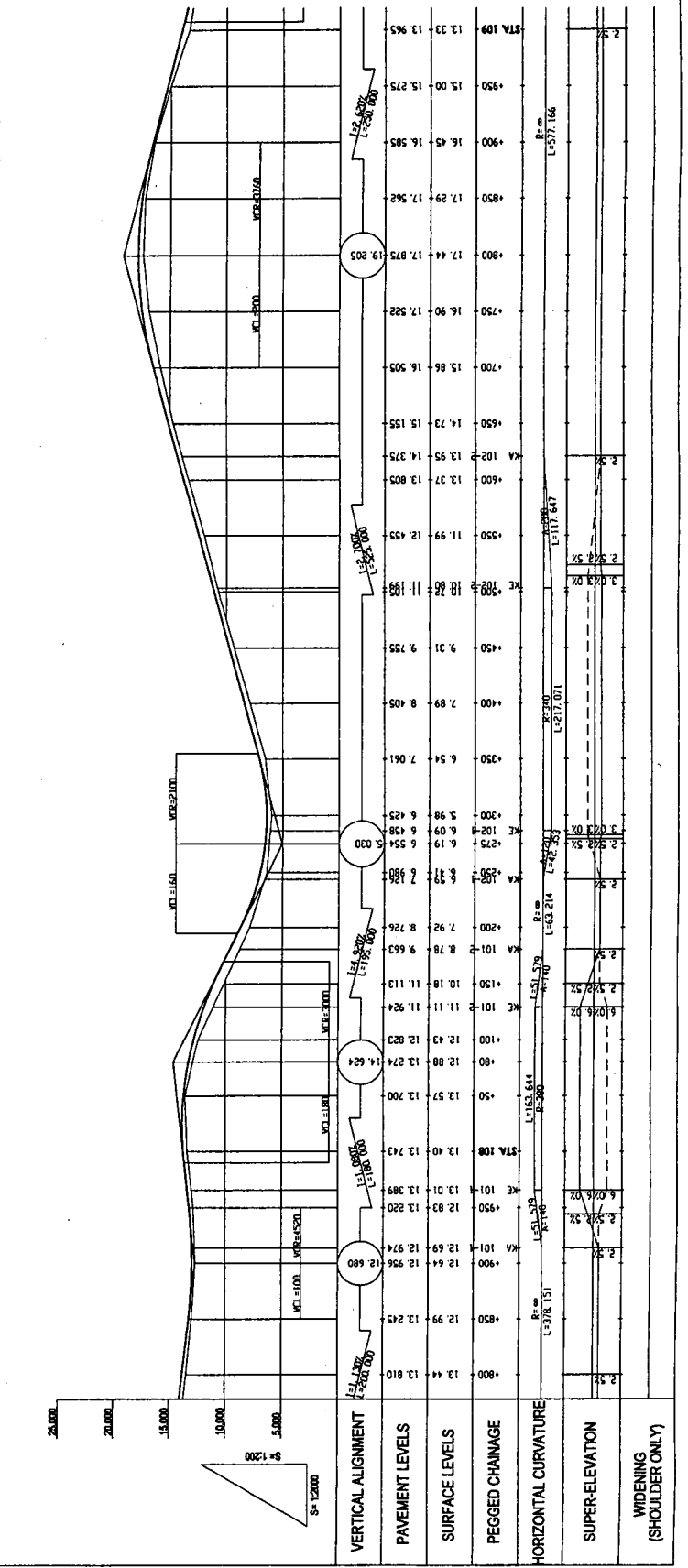
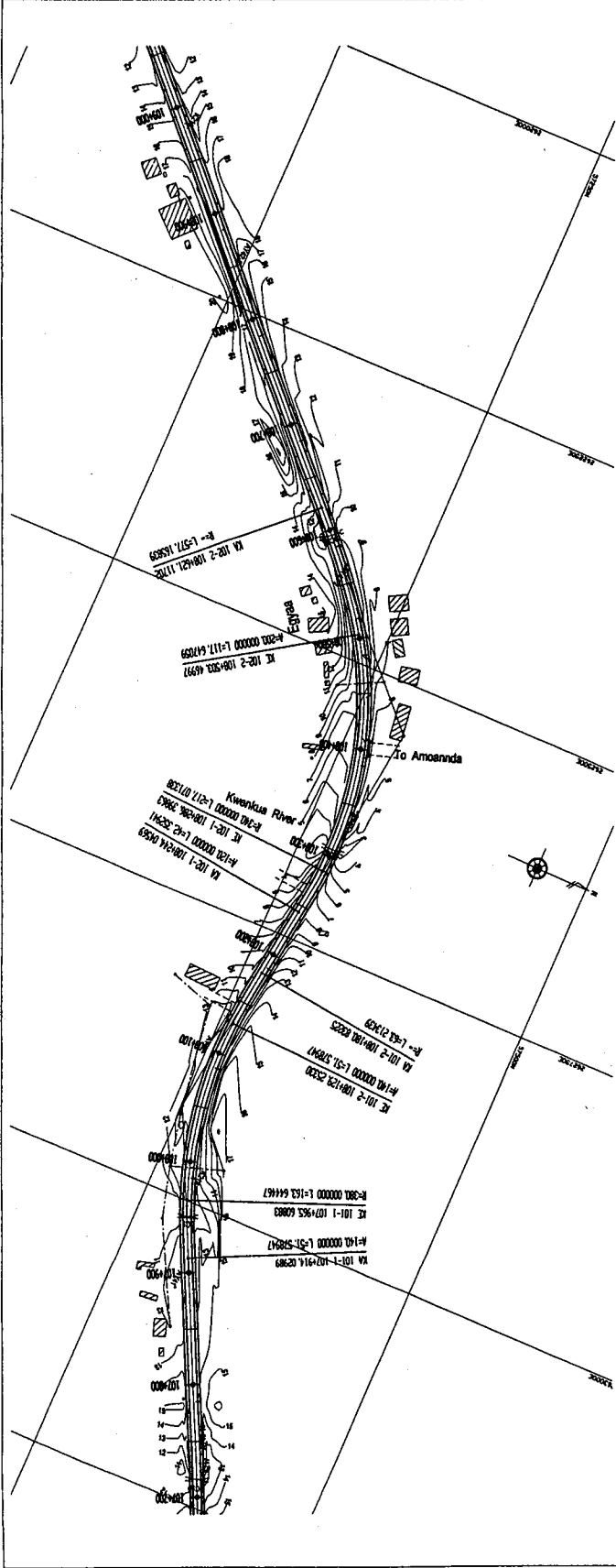

GOVERNMENT OF THE REPUBLIC OF GHANA	MINISTRY OF ROAD AND TRANSPORT GHANA HIGHWAY AUTHORITY	KATAHIRA & ENGINEERS INTERNATIONAL	NOTES:	PROJECT: THE PROJECT FOR REHABILITATION OF TRUNK ROAD	TITLE: PLAN AND PROFILE (78/83)	SCALE: V = 1:200 H = 1:2000	DRAWING No: PL-78
---	--	---------------------------------------	--------	--	--	---------------------------------------	--------------------------

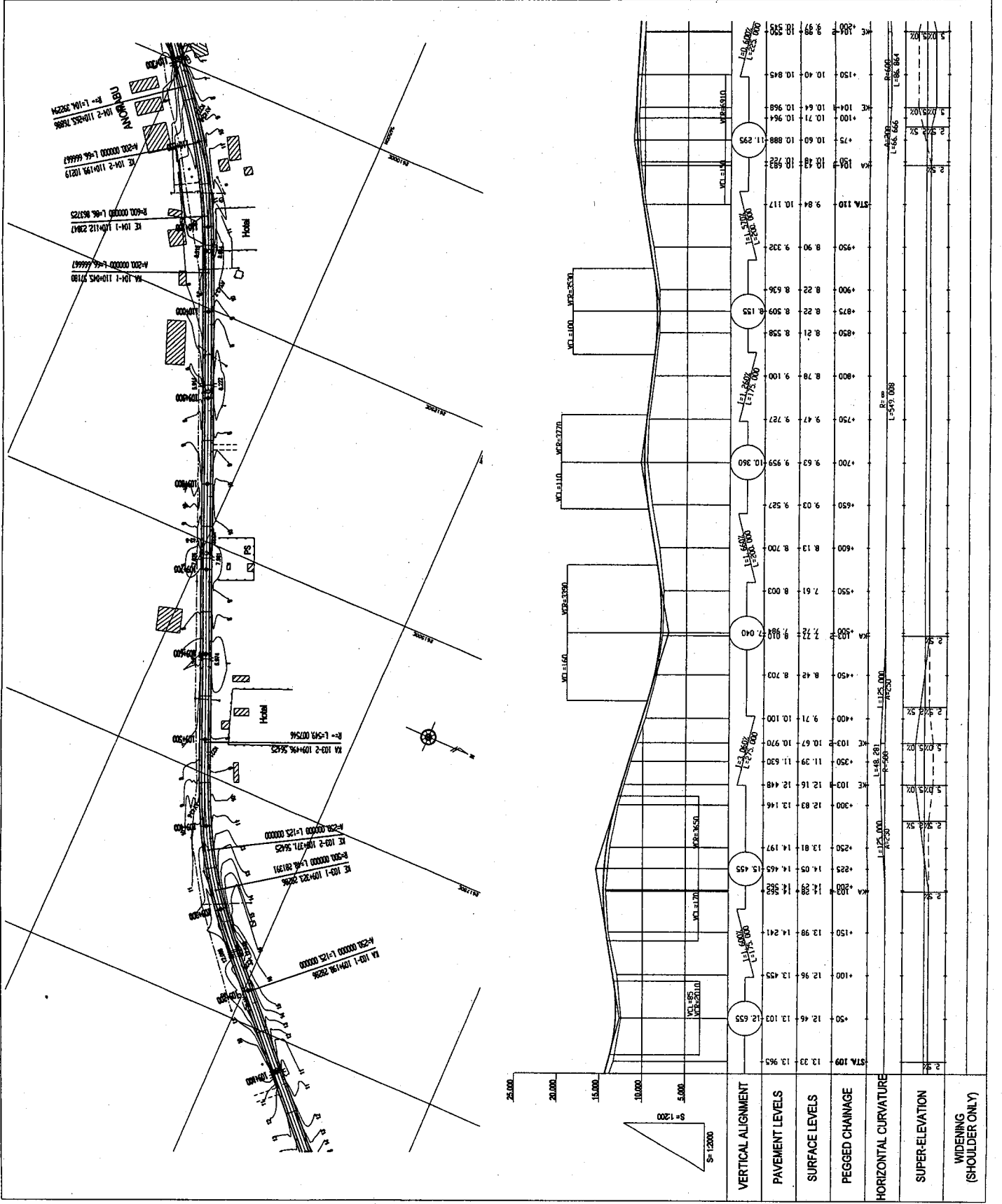

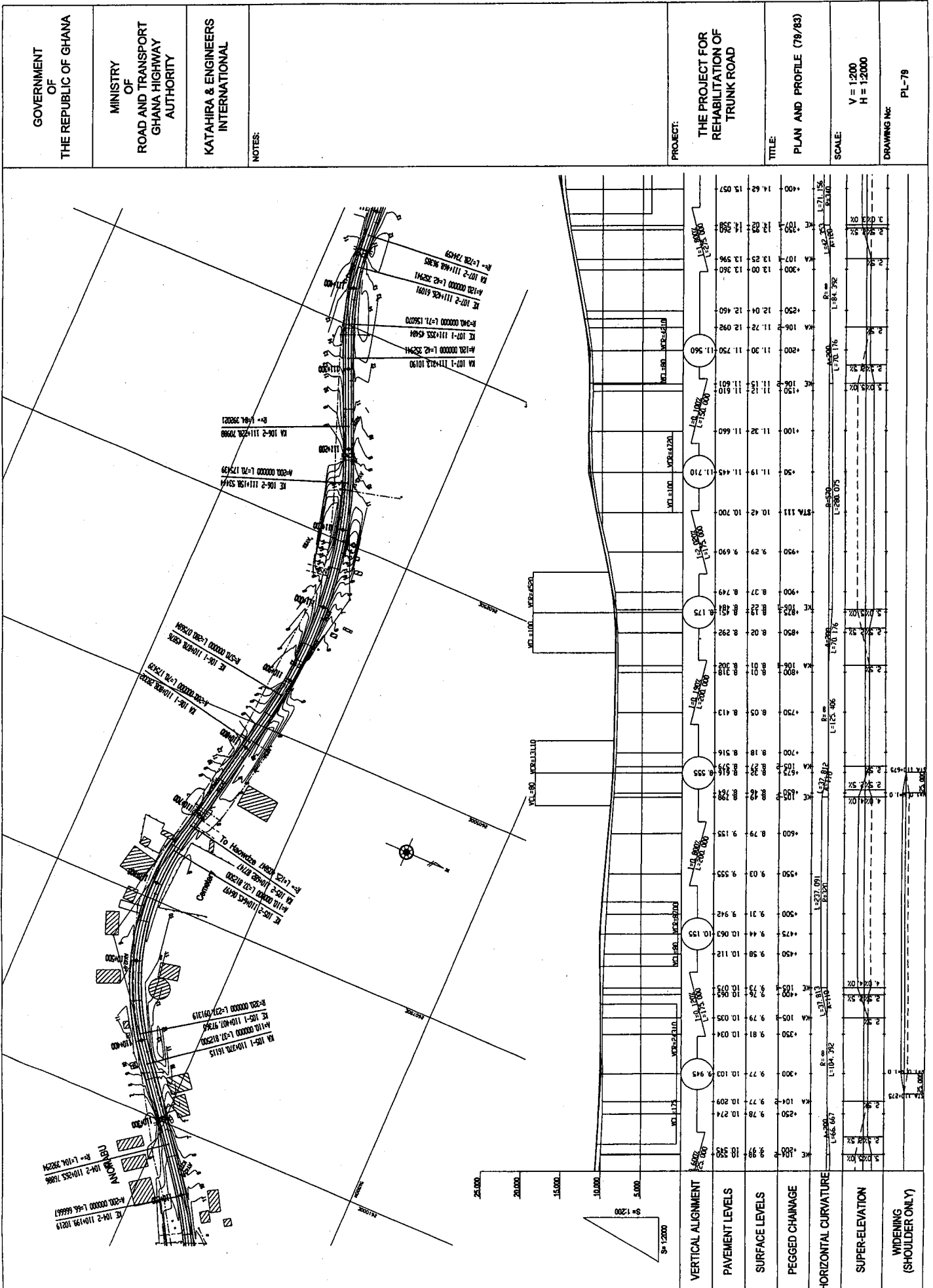

GOVERNMENT OF THE REPUBLIC OF GHANA
 MINISTRY OF ROAD AND TRANSPORT GHANA HIGHWAY AUTHORITY
 KATAHIRA & ENGINEERS INTERNATIONAL
 NOTES:
 PROJECT: THE PROJECT FOR REHABILITATION OF TRUNK ROAD
 TITLE: PLAN AND PROFILE (60/83)
 SCALE: V = 1:200 H = 1:2000
 DRAWING No: PL-80

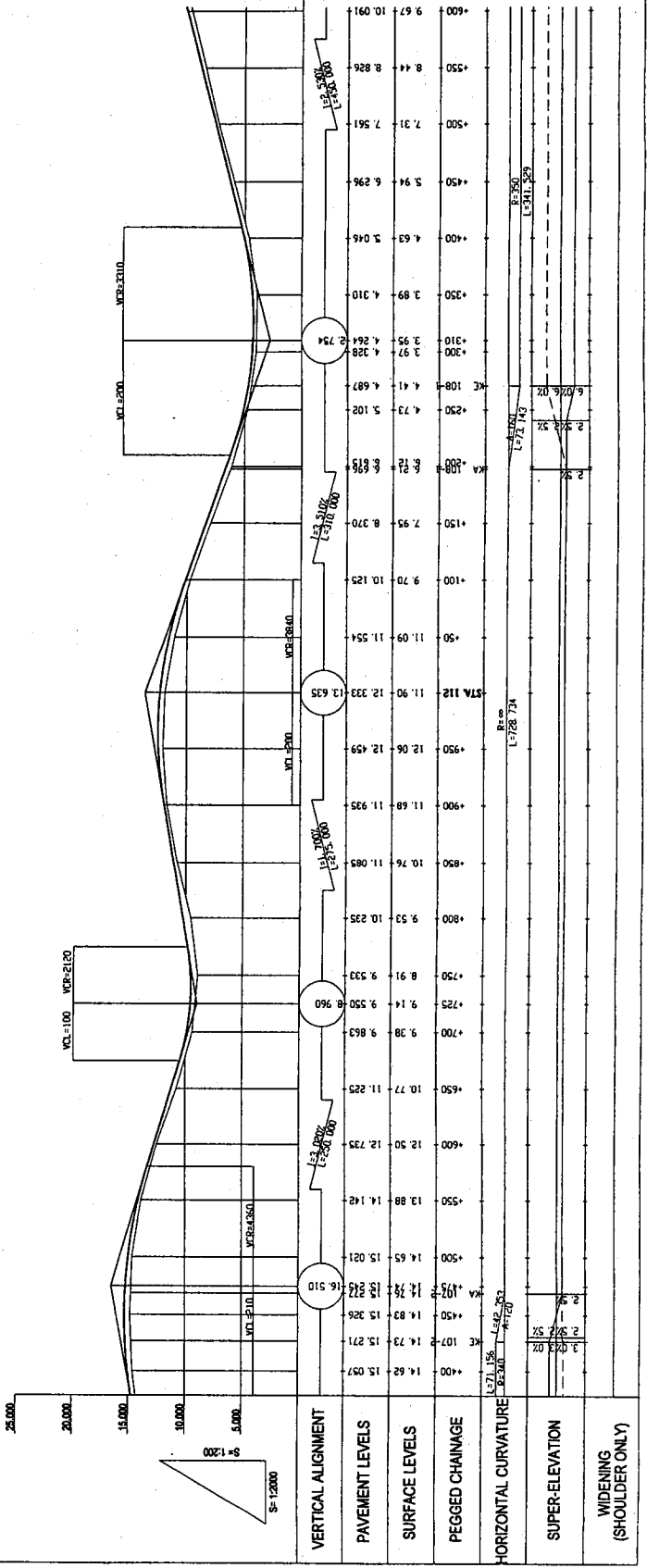
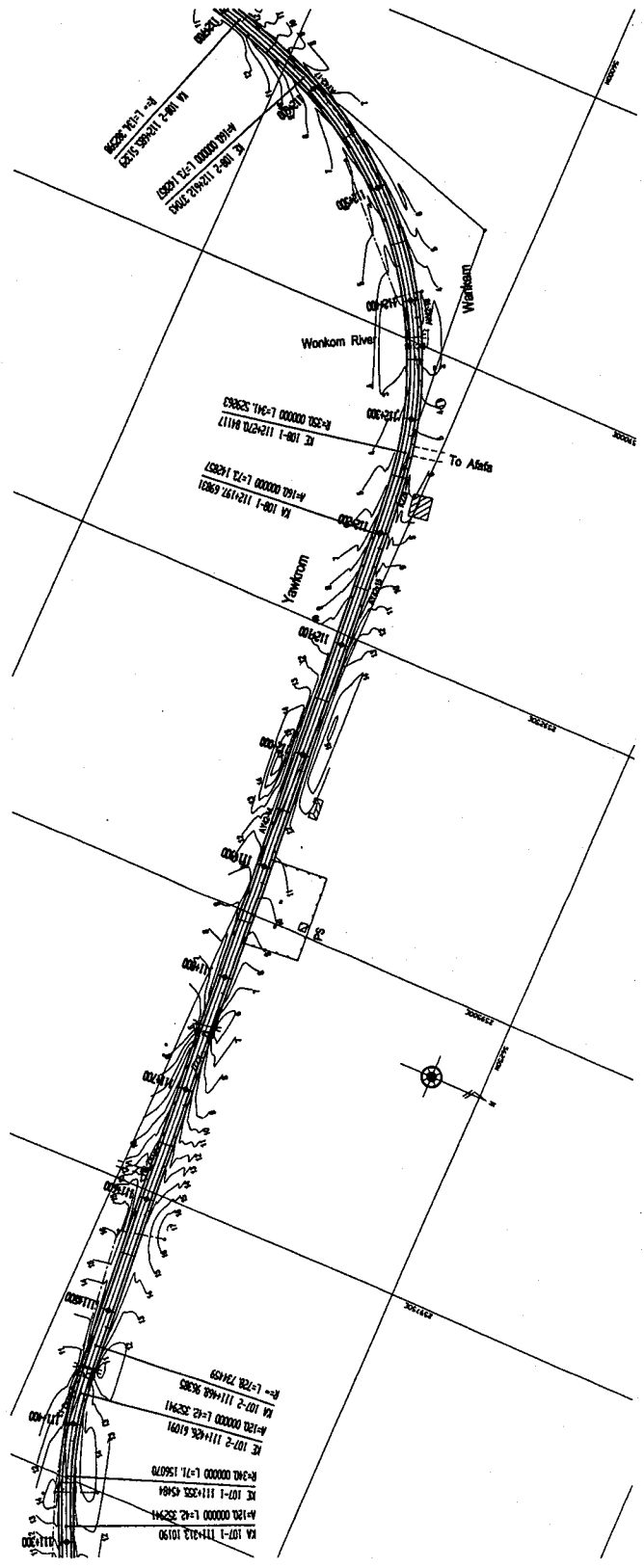

GOVERNMENT OF THE REPUBLIC OF GHANA
 MINISTRY OF ROAD AND TRANSPORT GHANA HIGHWAY AUTHORITY
 KATAHIRA & ENGINEERS INTERNATIONAL
 NOTES:
 PROJECT: THE PROJECT FOR REHABILITATION OF TRUNK ROAD
 TITLE: PLAN AND PROFILE (81/83)
 SCALE: V = 1:200 H = 1:2000
 DRAWING No: PL-81

