

GOVERNMENT OF THE REPUBLIC OF GHANA

MINISTRY OF ROAD AND TRANSPORT GHANA HIGHWAY AUTHORITY

KATAHIRA & ENGINEERS INTERNATIONAL

NOTES:

PROJECT: THE PROJECT FOR REHABILITATION OF TRUNK ROAD

TITLE: PLAN AND PROFILE (36/83)

SCALE: V = 1:2000 H = 1:2000

DRAWING No: PL-36

GOVERNMENT OF THE REPUBLIC OF GHANA

MINISTRY OF ROAD AND TRANSPORT GHANA HIGHWAY AUTHORITY

KATAHIRA & ENGINEERS INTERNATIONAL

NOTES:

PROJECT: THE PROJECT FOR THE REHABILITATION OF TRUNK ROAD

TITLE: PLAN AND PROFILE (37/83)

SCALE: V = 12000, H = 12000

DRAWING No: PL-37

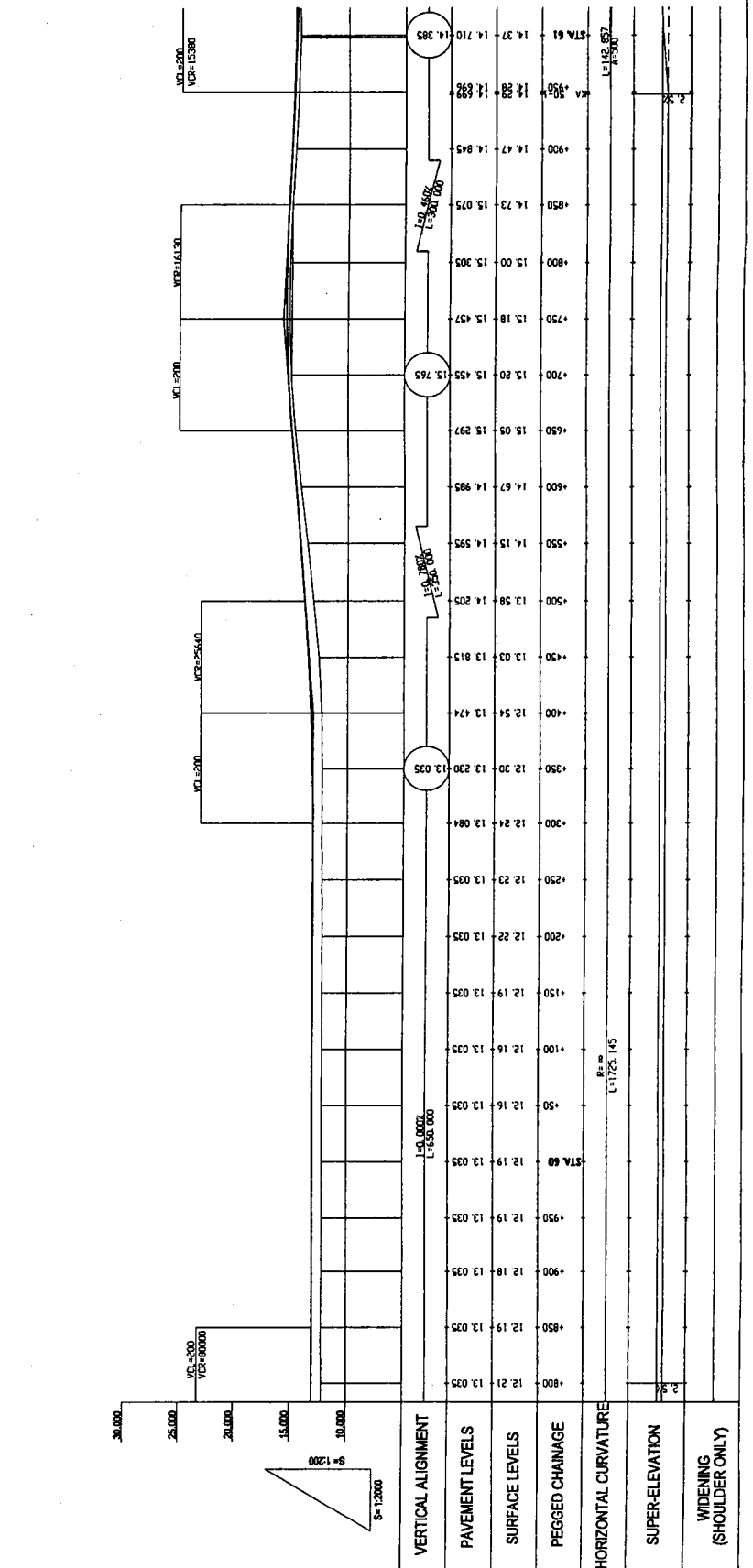
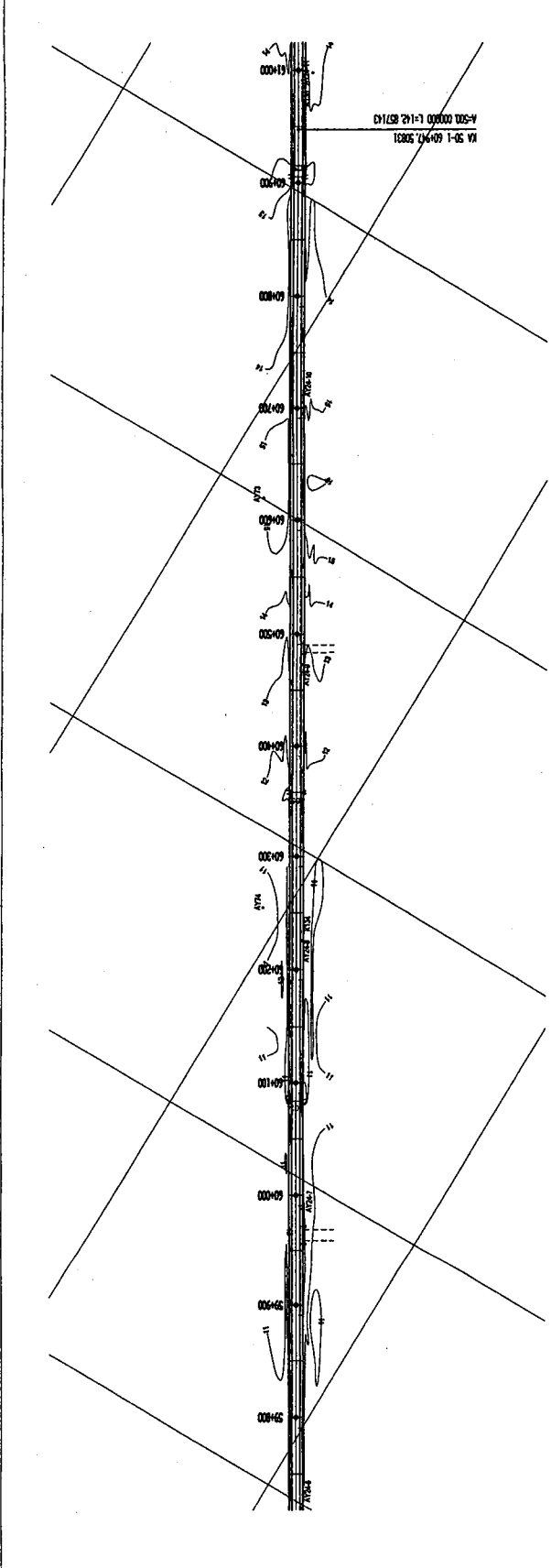

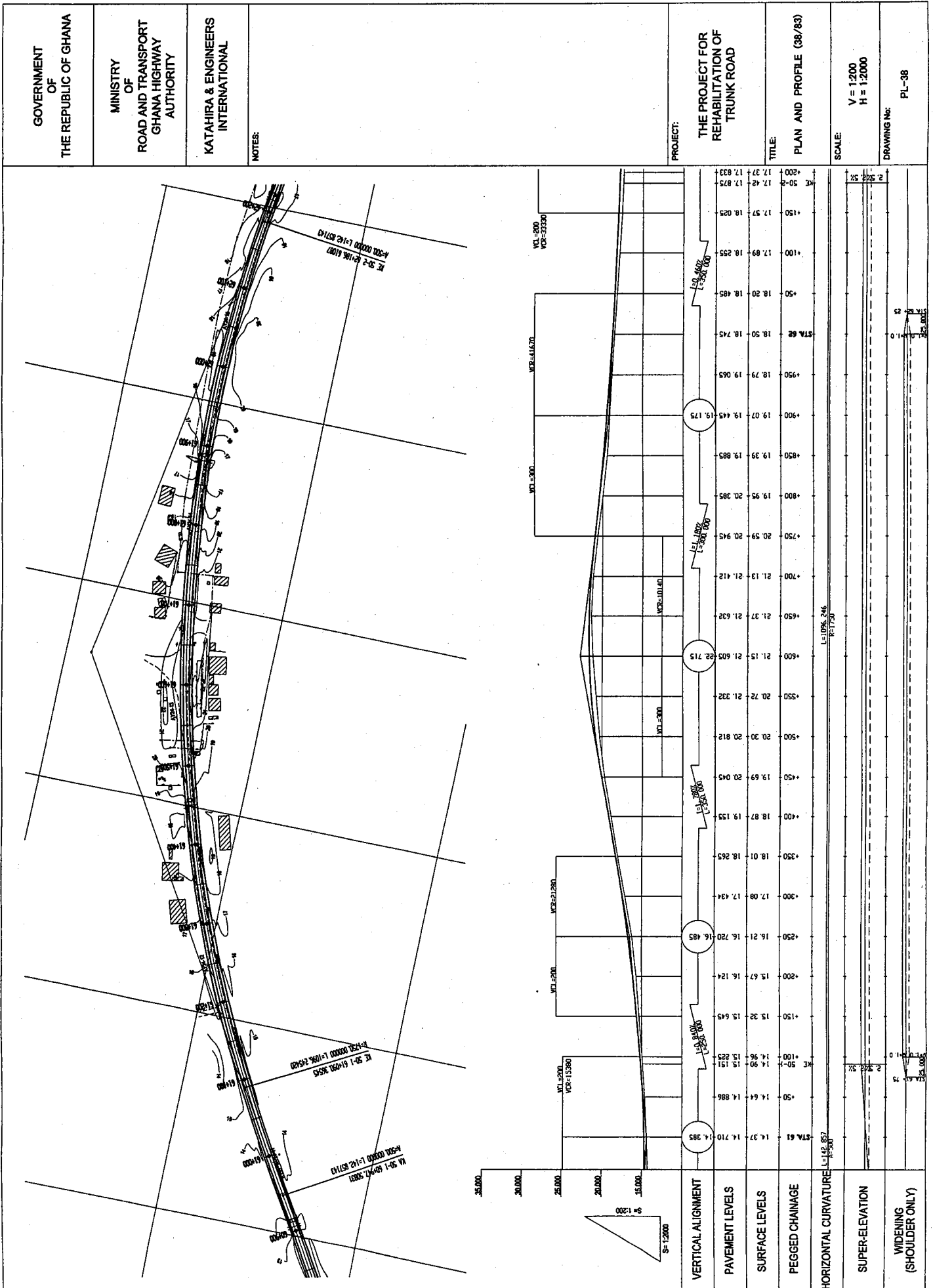

GOVERNMENT OF THE REPUBLIC OF GHANA
 MINISTRY OF ROAD AND TRANSPORT GHANA HIGHWAY AUTHORITY
 KATAHIRA & ENGINEERS INTERNATIONAL
 NOTES:
 PROJECT: THE PROJECT FOR REHABILITATION OF TRUNK ROAD
 TITLE: PLAN AND PROFILE (39/83)
 SCALE: V = 1:2000 H = 1:2000
 DRAWING No: PL-39

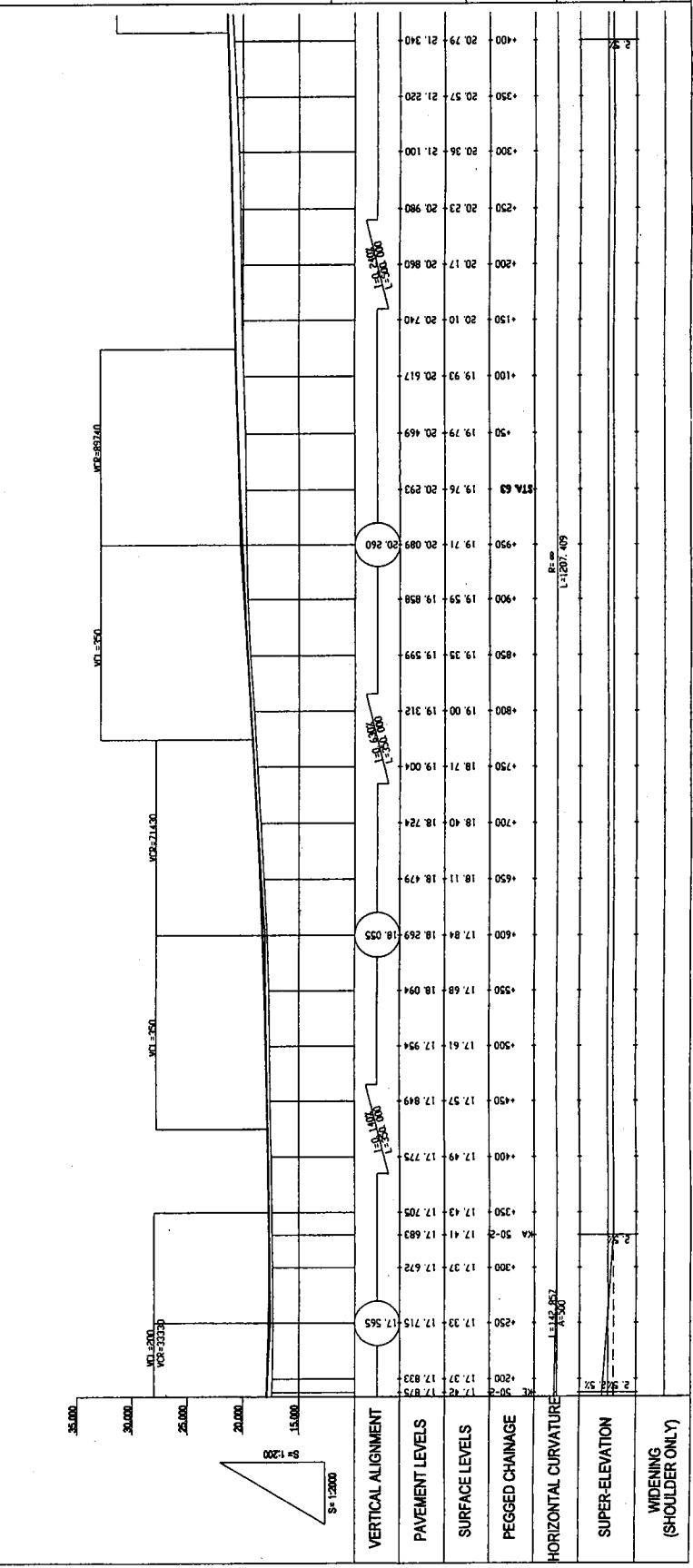
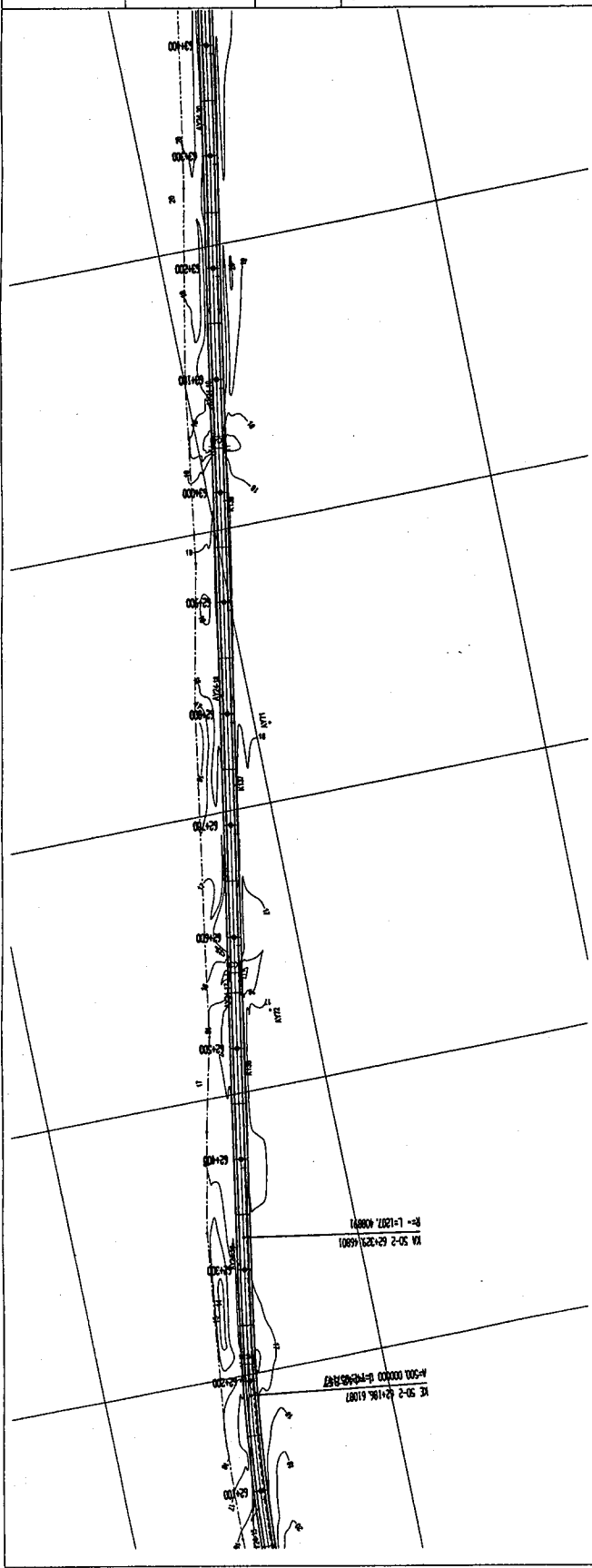

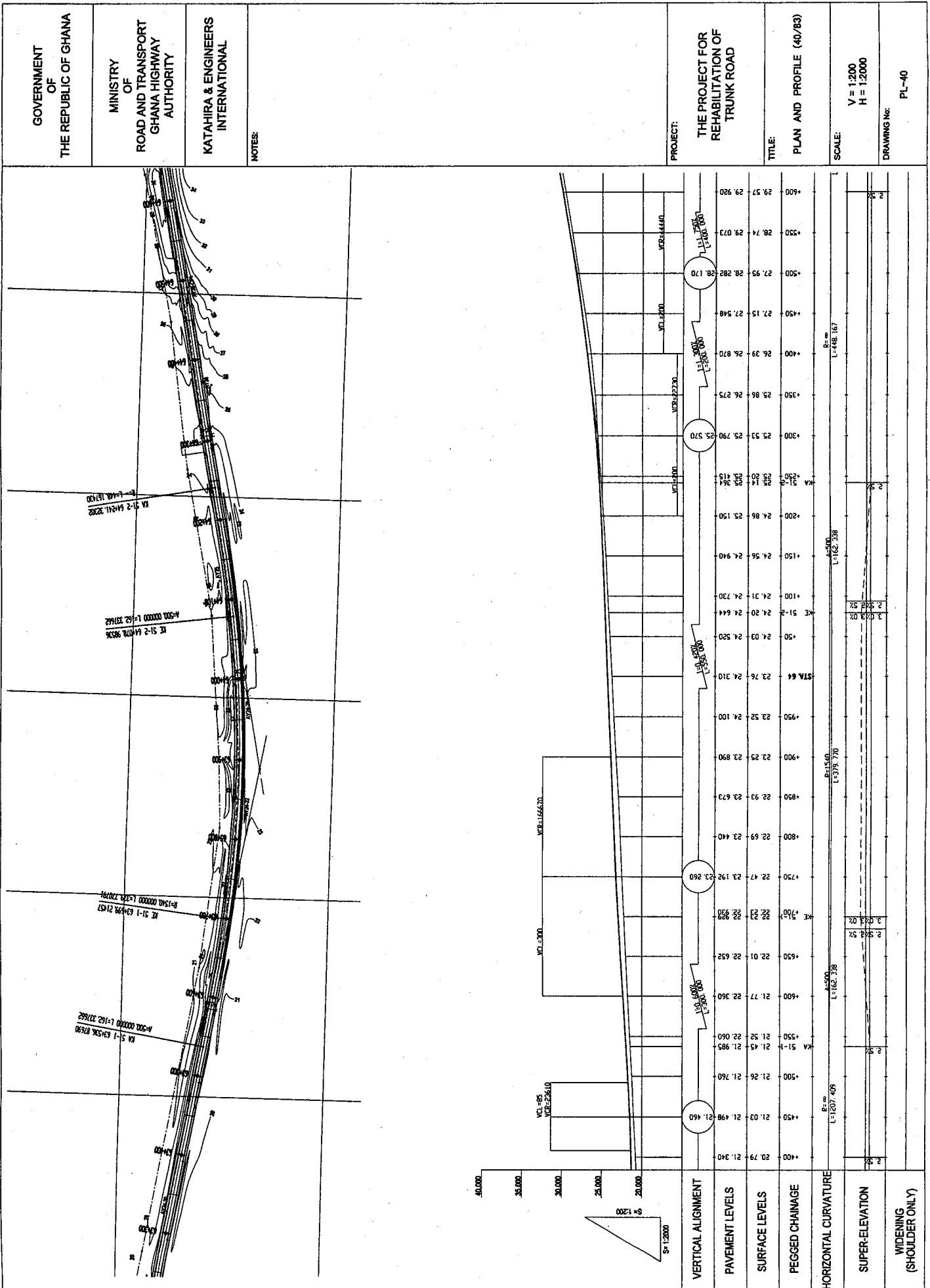

GOVERNMENT OF THE REPUBLIC OF GHANA

MINISTRY OF ROAD AND TRANSPORT GHANA HIGHWAY AUTHORITY

KATAHIRA & ENGINEERS INTERNATIONAL

NOTES:

PROJECT: THE PROJECT FOR REHABILITATION OF TRUNK ROAD

TITLE: PLAN AND PROFILE (41/83)

SCALE: V = 1:200 H = 1:2000

DRAWING No. PL-41

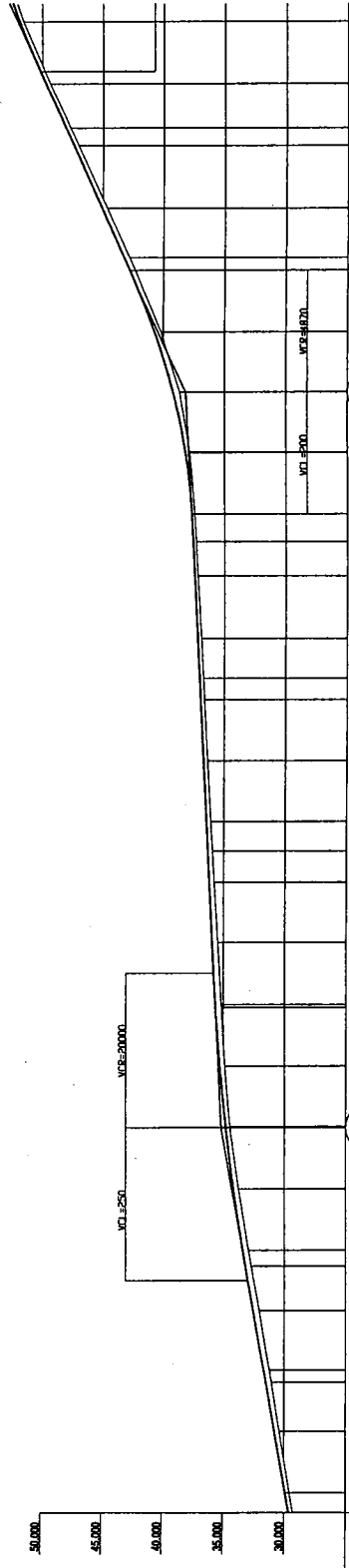
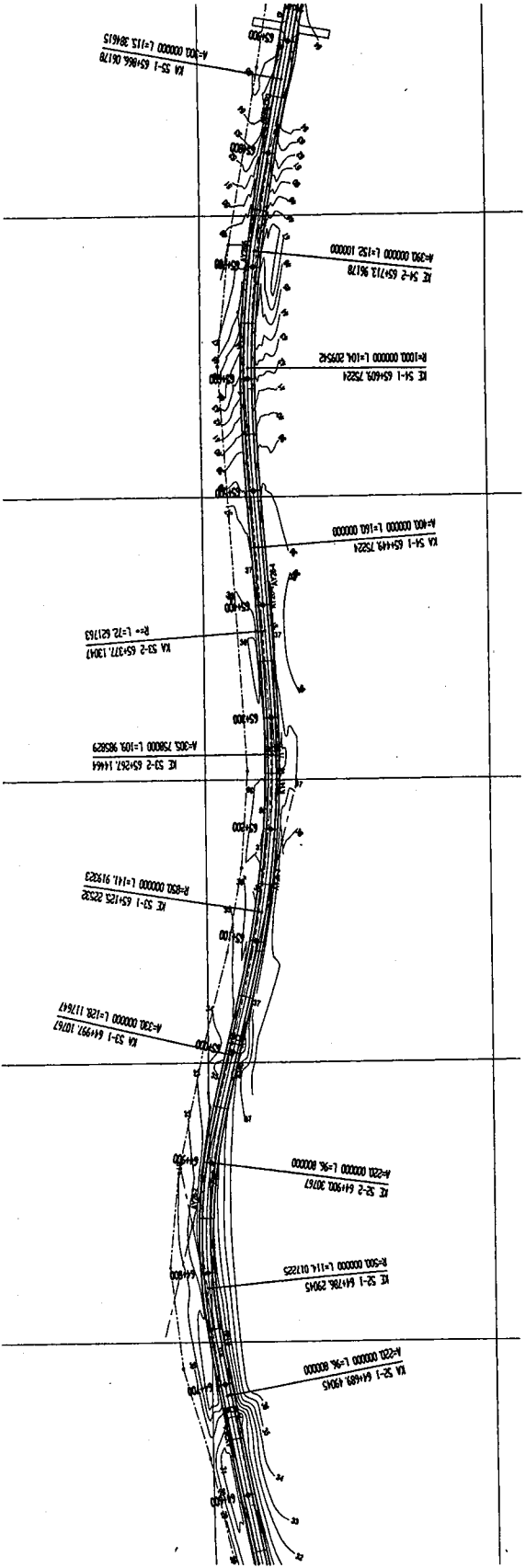

VERTICAL ALIGNMENT	PAVEMENT LEVELS	SURFACE LEVELS	PEGGED CHANGE	HORIZONTAL CURVATURE	SUPER-ELEVATION	WIDENING (SHOULDER ONLY)
64+00	29.57	29.920			2.3%	
64+10	30.4	30.795			2.3%	
64+20	31.05	31.496			2.3%	
64+30	31.81	31.670			2.3%	
64+40	32.04	32.543			2.3%	
64+50	32.70	33.186			2.3%	
64+60	32.93	33.404			2.3%	
64+70	34.41	34.773	35.170		6.0/6.0%	
64+80	34.88	35.279			6.0/6.0%	
64+90	35.17	35.650			6.0/6.0%	
65+00	35.46	35.920			6.0/6.0%	
65+10	35.76	36.170			5.0/5.0%	
65+20	35.92	36.299			5.0/5.0%	
65+30	36.06	36.420			5.0/5.0%	
65+40	36.33	36.670			5.0/5.0%	
65+50	36.60	36.920			5.0/5.0%	
65+60	36.69	37.009			5.0/5.0%	
65+70	36.87	37.170			5.0/5.0%	
65+80	37.16	37.420			5.0/5.0%	
65+90	37.31	37.558			5.0/5.0%	
66+00	37.43	37.670			5.0/5.0%	
66+10	37.87	38.122			5.0/5.0%	
66+20	37.87	38.122			5.0/5.0%	
66+30	38.65	39.197	39.170		5.0/5.0%	
66+40	40.19	40.732			5.0/5.0%	
66+50	42.33	42.780			5.0/5.0%	
66+60	42.81	43.233			5.0/5.0%	
66+70	44.67	45.083			5.0/5.0%	
66+80	47.01	47.390			5.0/5.0%	
66+90	47.69	48.039			5.0/5.0%	
67+00	49.34	49.695			5.0/5.0%	
67+10	51.53	51.840			5.0/5.0%	

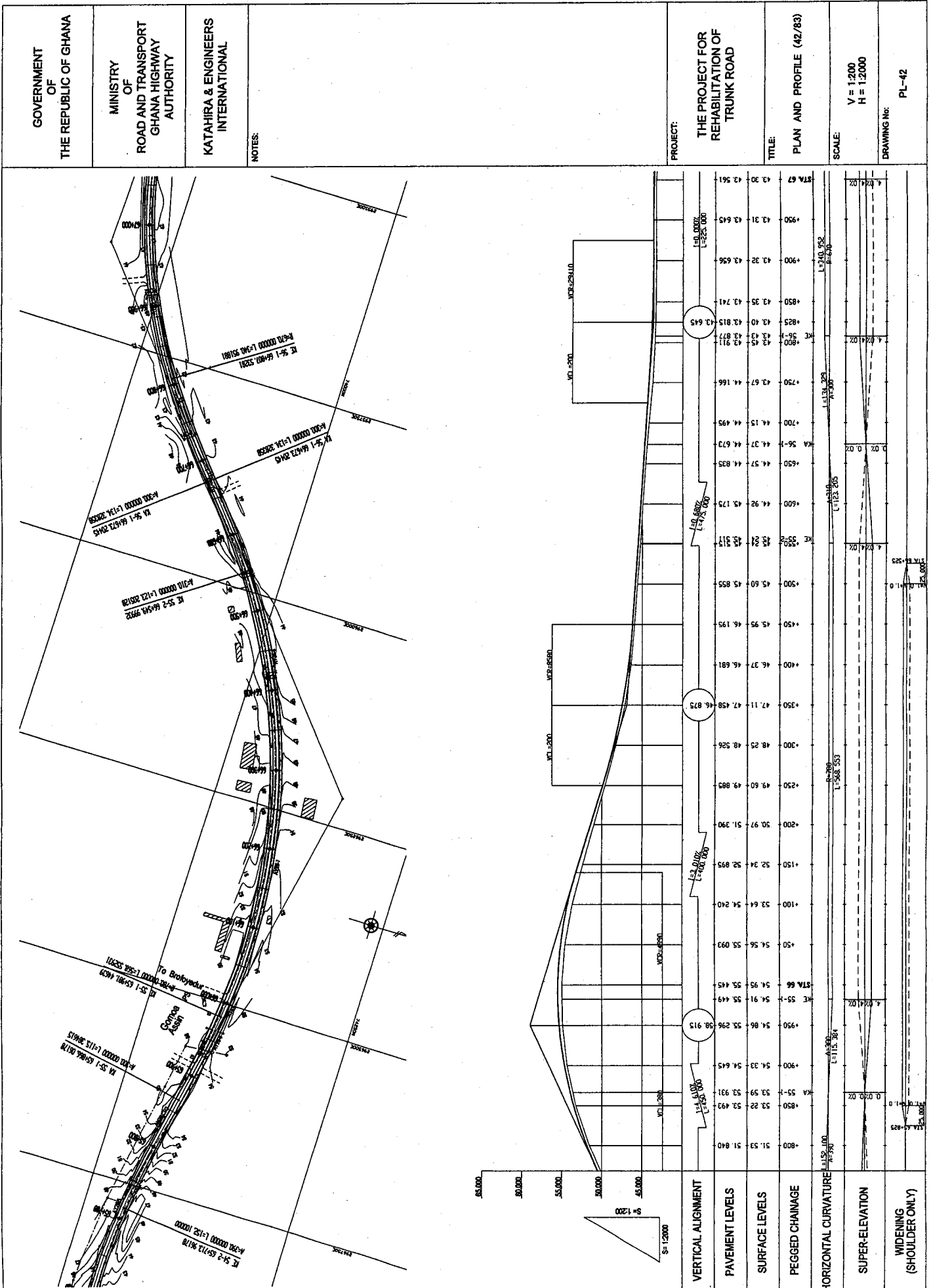

GOVERNMENT OF THE REPUBLIC OF GHANA
 MINISTRY OF ROAD AND TRANSPORT GHANA HIGHWAY AUTHORITY
 KATAHIRA & ENGINEERS INTERNATIONAL
 NOTES:
 PROJECT: THE PROJECT FOR REHABILITATION OF TRUNK ROAD
 TITLE: PLAN AND PROFILE (43/83)
 SCALE: V = 1:200 H = 1:2000
 DRAWING No: PL-43

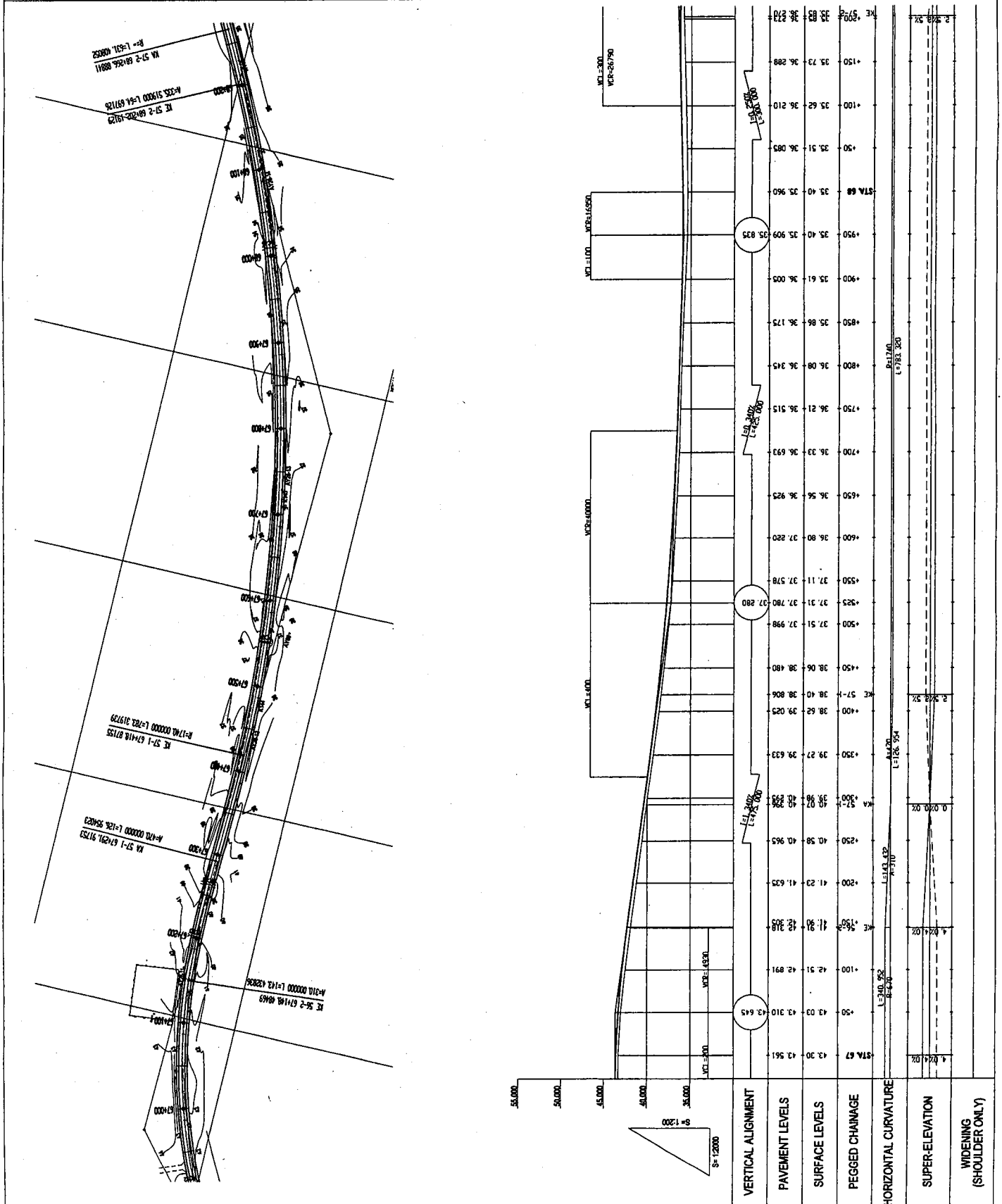

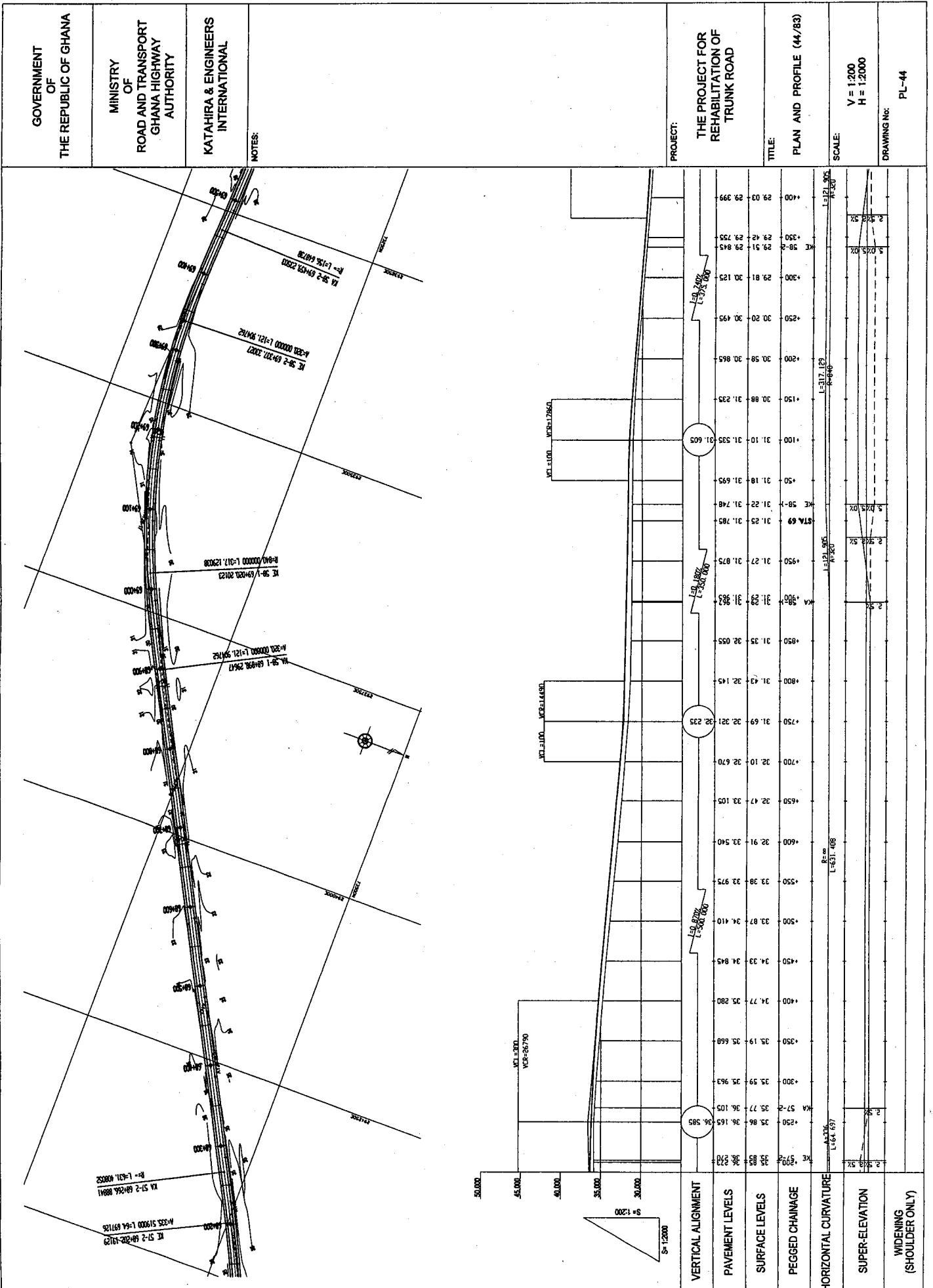

GOVERNMENT OF THE REPUBLIC OF GHANA
 MINISTRY OF ROAD AND TRANSPORT GHANA HIGHWAY AUTHORITY
 KATAHIRA & ENGINEERS INTERNATIONAL
 NOTES:
 PROJECT: THE PROJECT FOR REHABILITATION OF TRUNK ROAD
 TITLE: PLAN AND PROFILE (45/83)
 SCALE: V = 1:200 H = 1:2000
 DRAWING No: PL-45

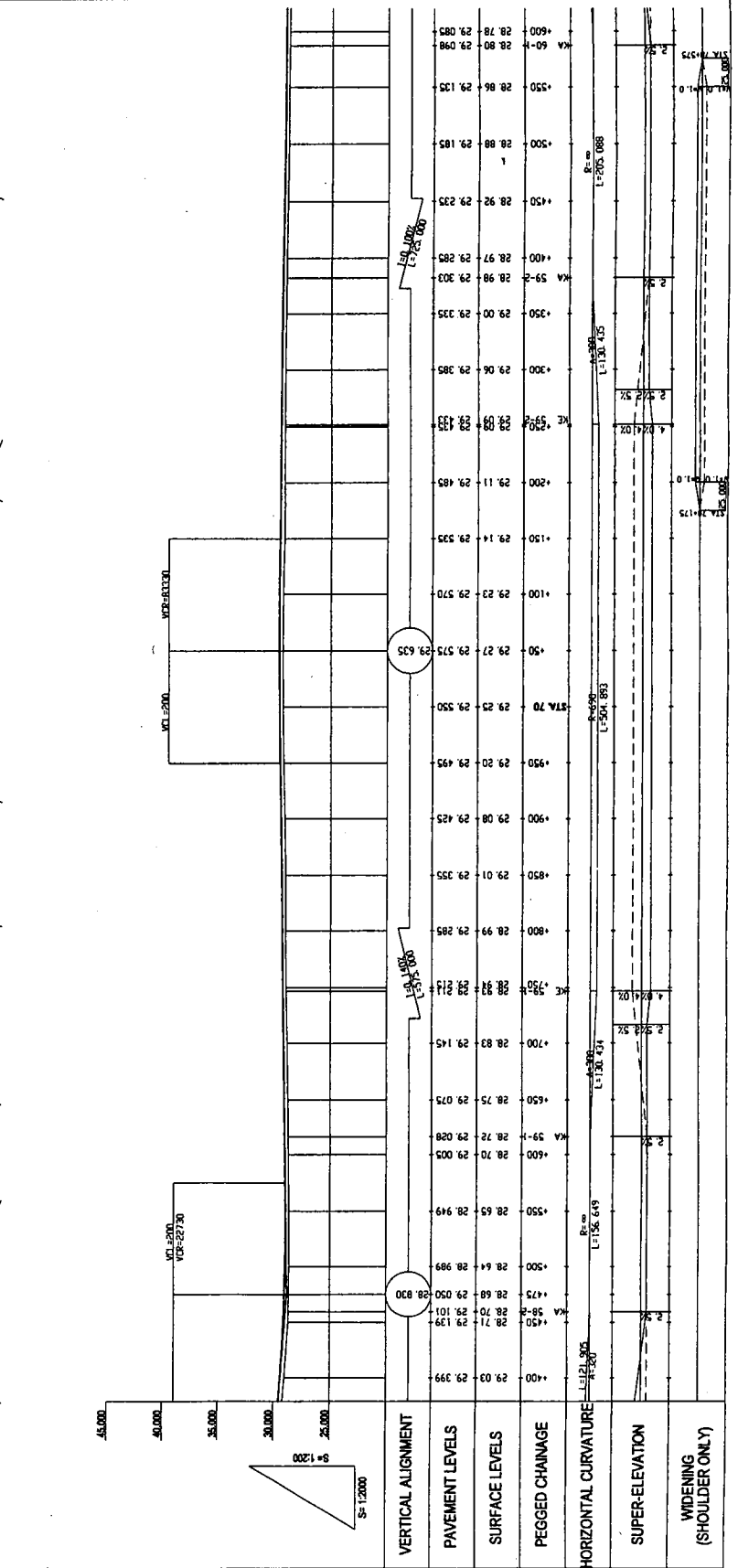
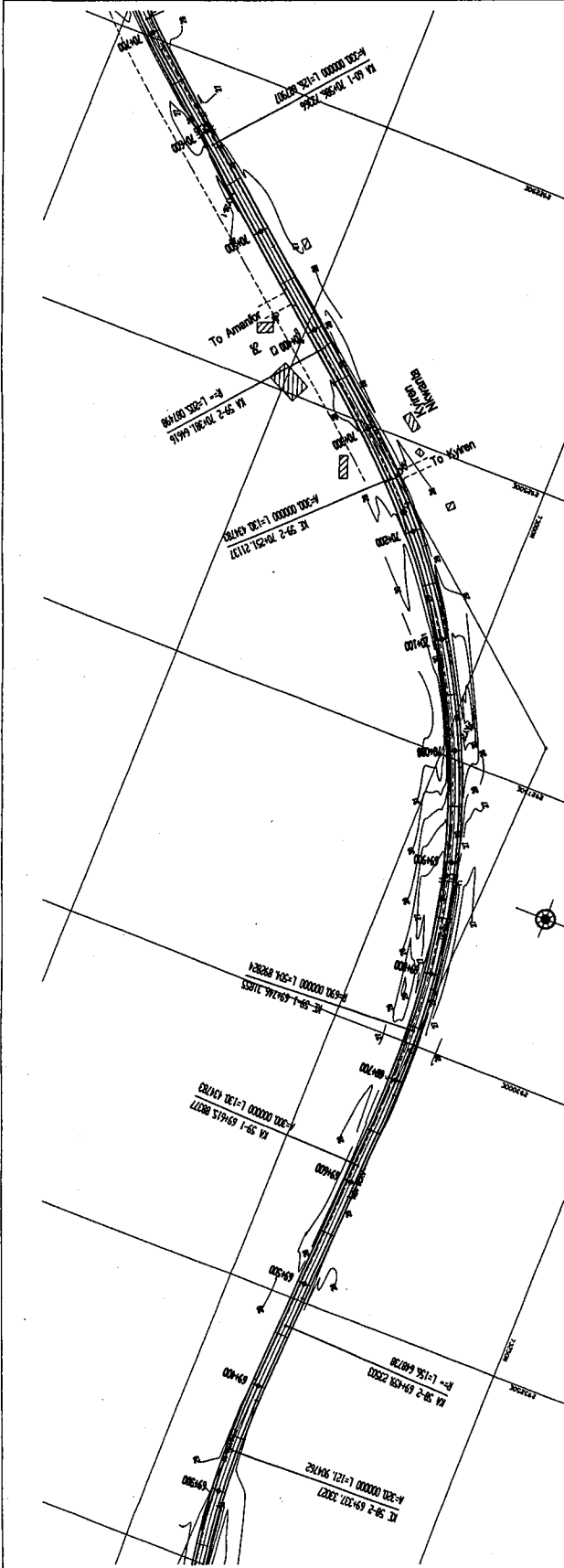

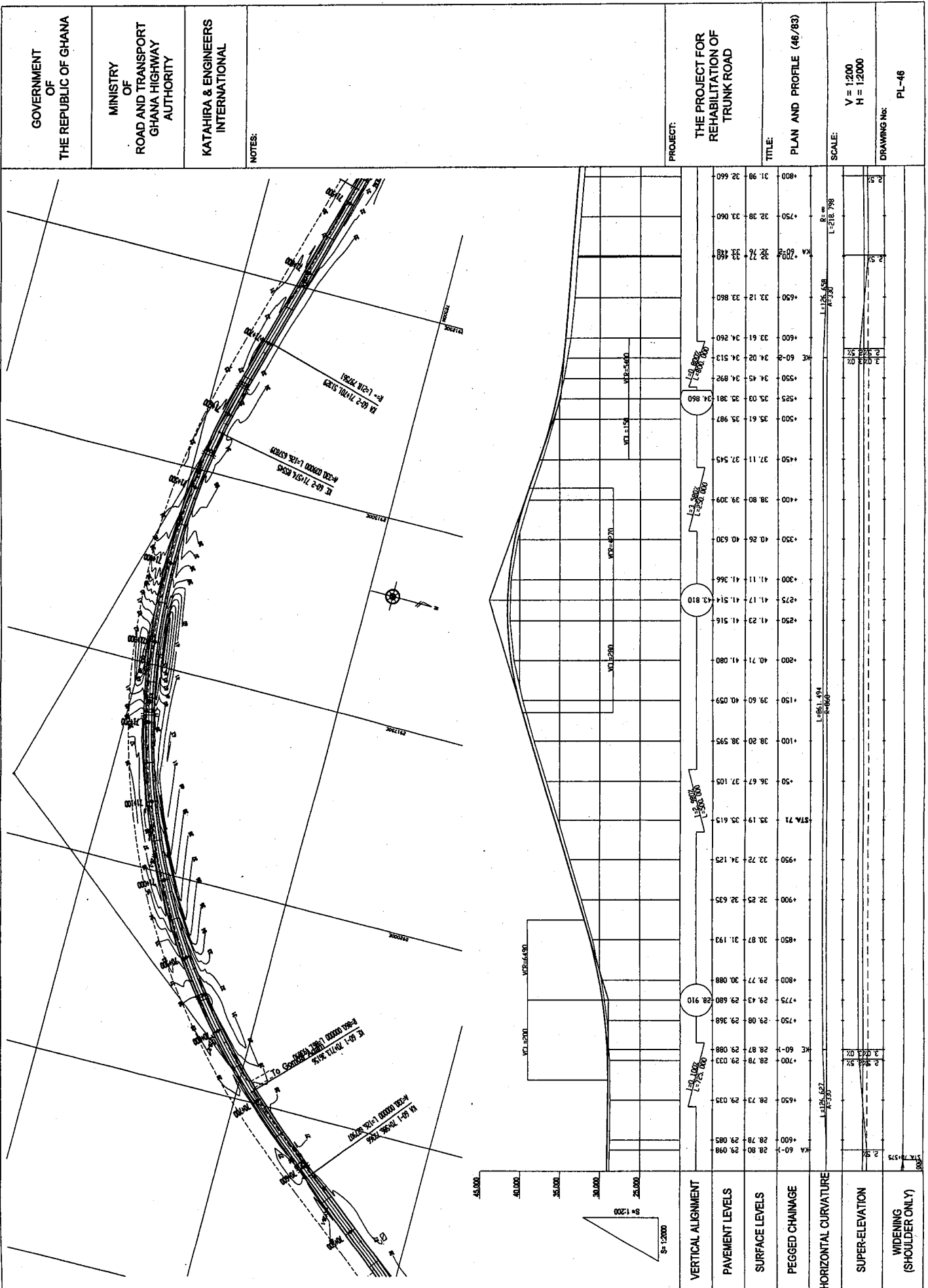

GOVERNMENT OF THE REPUBLIC OF GHANA
 MINISTRY OF ROAD AND TRANSPORT GHANA HIGHWAY AUTHORITY
 KATAHIRA & ENGINEERS INTERNATIONAL
 NOTES
 PROJECT: THE PROJECT FOR THE REHABILITATION OF TRUNK ROAD
 TITLE: PLAN AND PROFILE (47/83)
 SCALE: V = 1:2000 H = 1:2000
 DRAWING No: PL-47

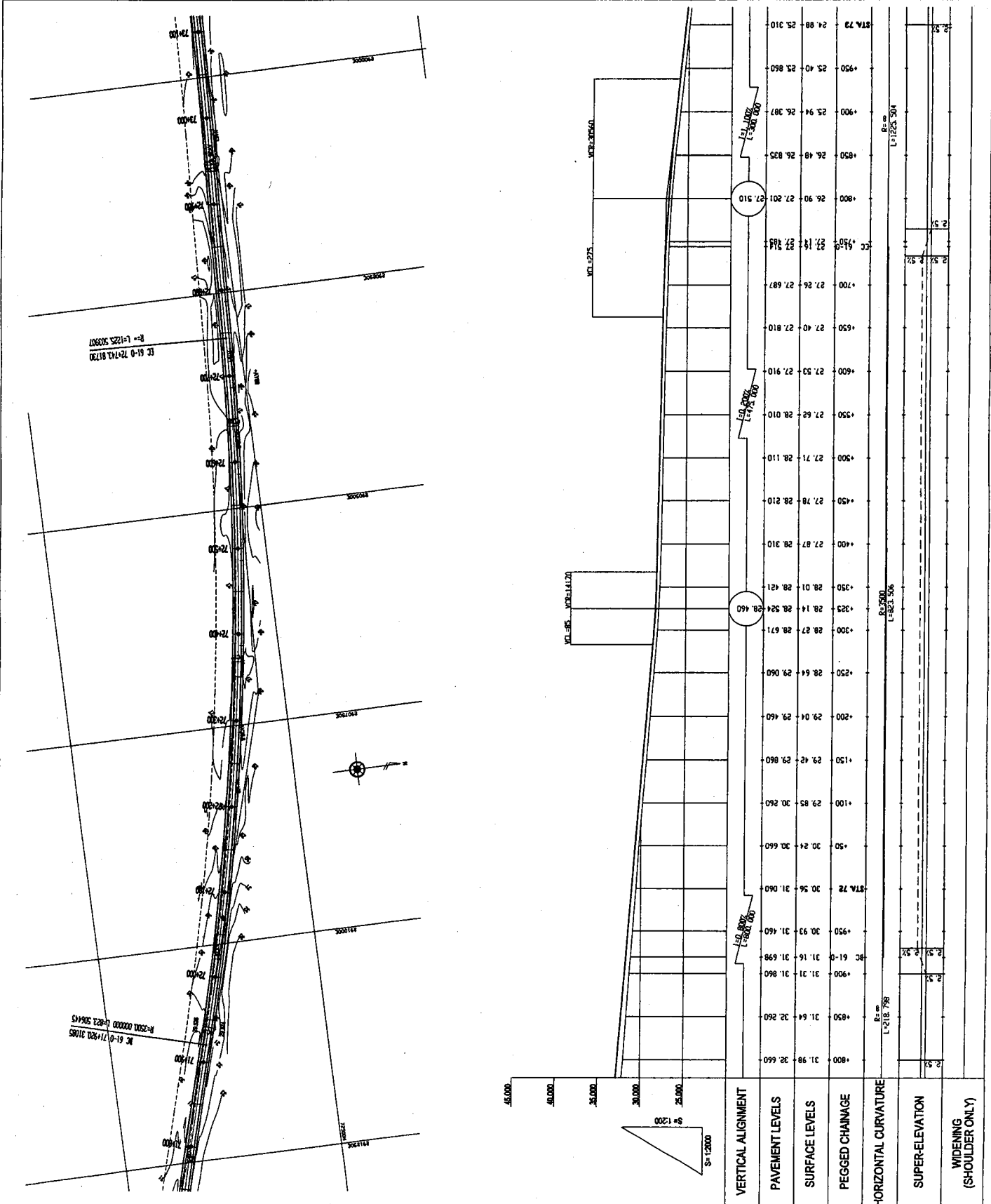

GOVERNMENT OF THE REPUBLIC OF GHANA

MINISTRY OF ROAD AND TRANSPORT GHANA HIGHWAY AUTHORITY

KATAHIRA & ENGINEERS INTERNATIONAL

NOTES:

PROJECT: THE PROJECT FOR REHABILITATION OF TRUNK ROAD

TITLE: PLAN AND PROFILE (48/83)

SCALE: V = 1:200 H = 1:2000

DRAWING No: PL-48

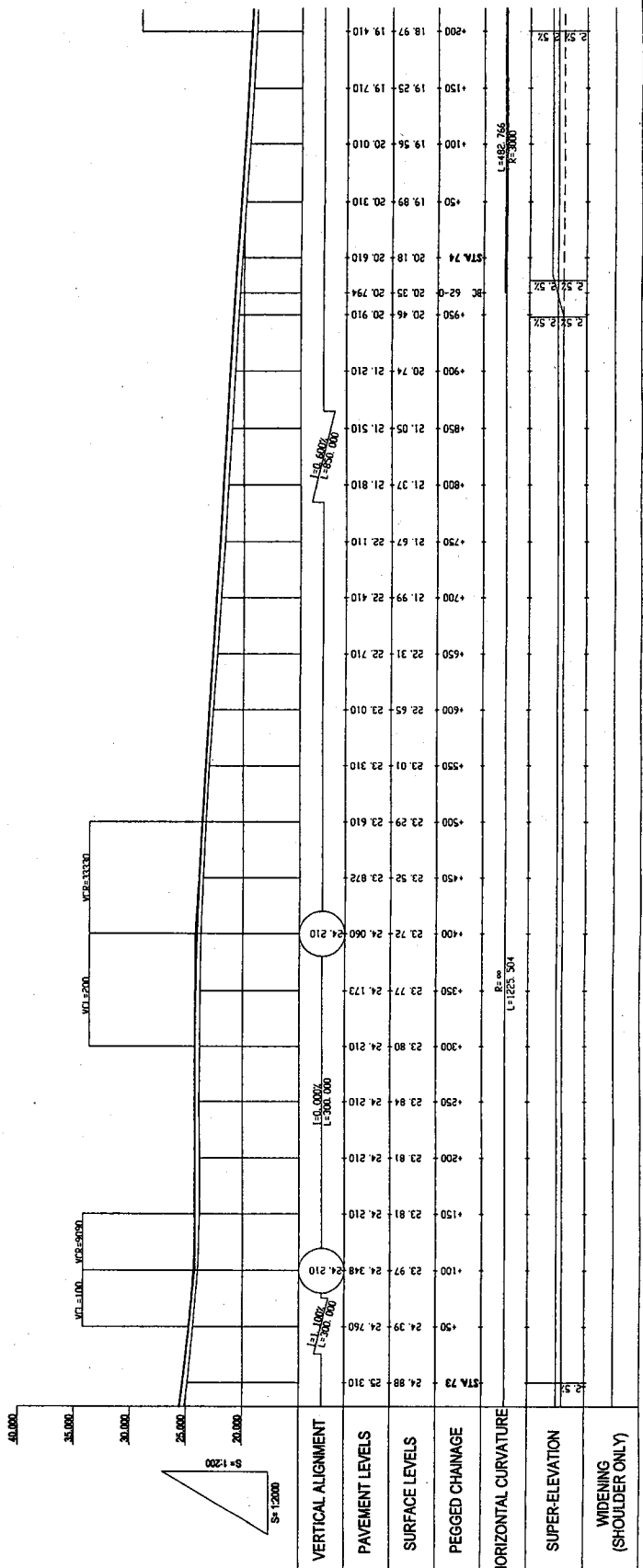
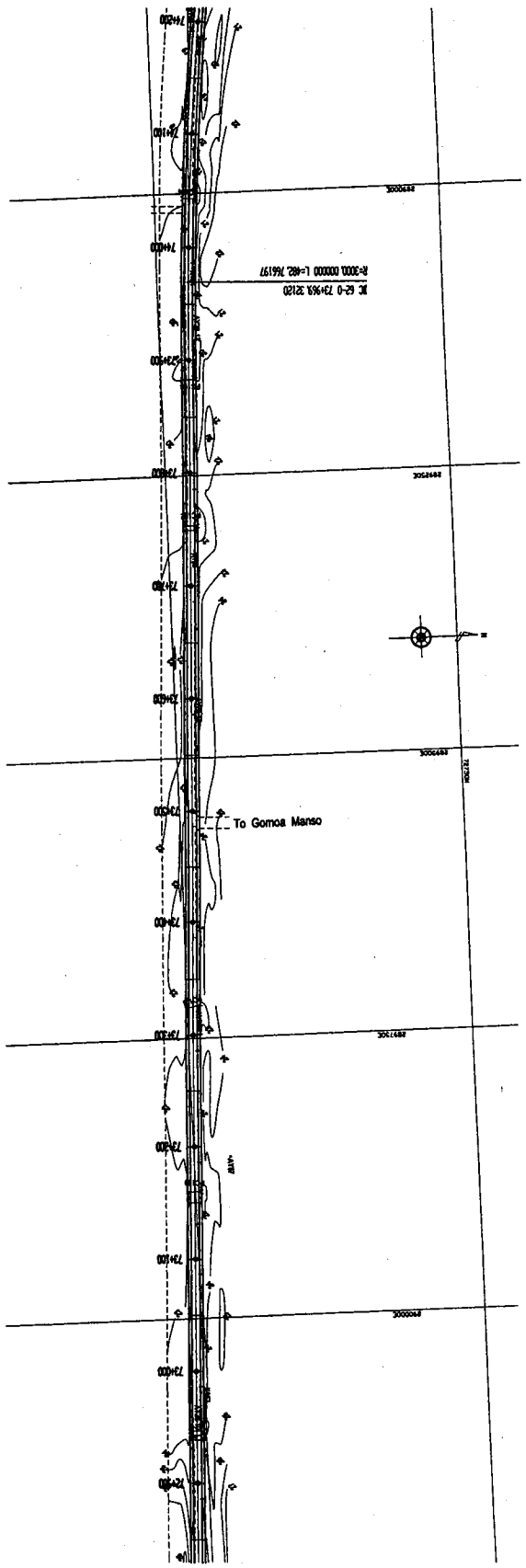

GOVERNMENT OF THE REPUBLIC OF GHANA	MINISTRY OF ROAD AND TRANSPORT GHANA HIGHWAY AUTHORITY	KATAHIRA & ENGINEERS INTERNATIONAL	NOTES:	PROJECT: THE PROJECT FOR THE REHABILITATION OF TRUNK ROAD	TITLE: PLAN AND PROFILE (49/83)	SCALE: V = 1:200 H = 1:2000	DRAWING No: PL-48
-------------------------------------	--	------------------------------------	--------	---	---------------------------------	-----------------------------	-------------------

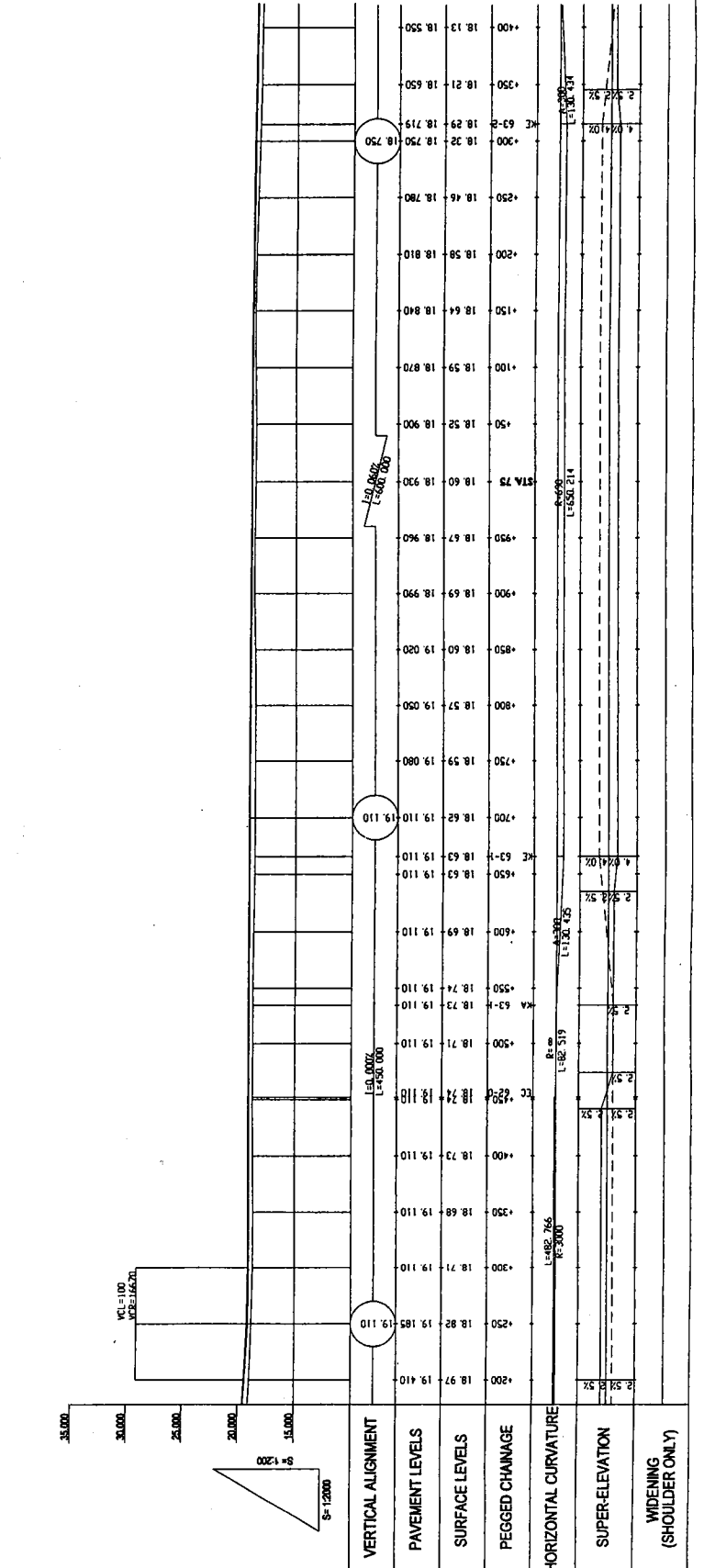
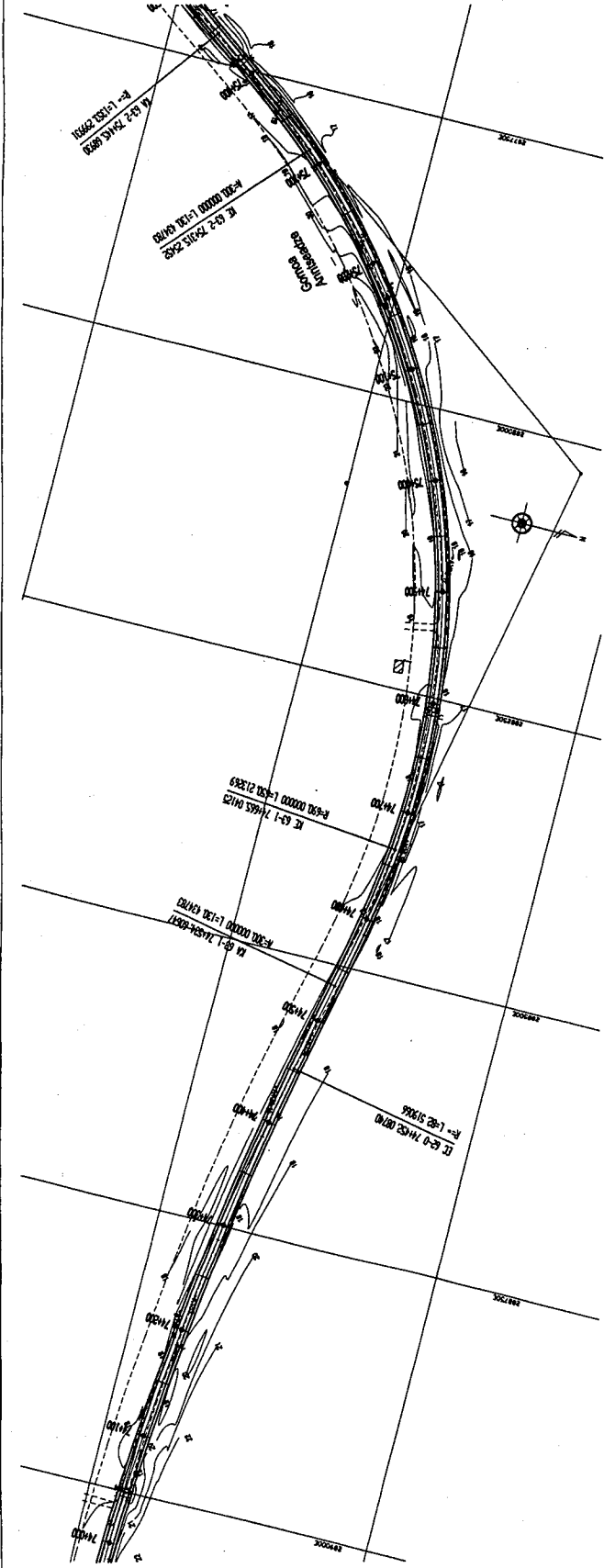

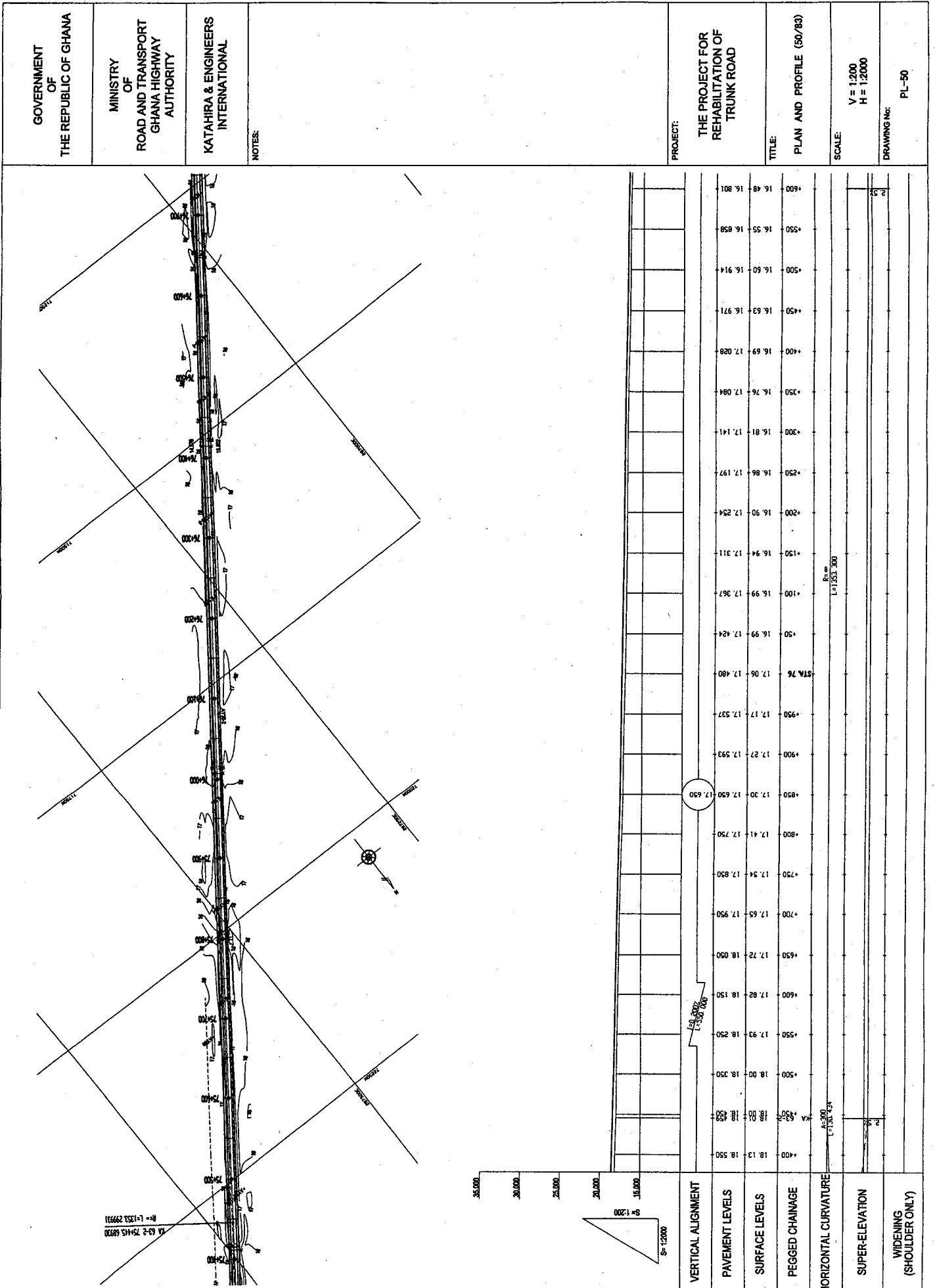

GOVERNMENT OF THE REPUBLIC OF GHANA
 MINISTRY OF ROAD AND TRANSPORT GHANA HIGHWAY AUTHORITY
 KATAHIRA & ENGINEERS INTERNATIONAL
 NOTES:
 PROJECT: THE PROJECT FOR THE REHABILITATION OF TRUNK ROAD
 TITLE: PLAN AND PROFILE (51/83)
 SCALE: V = 1:200, H = 1:2000
 DRAWING No: PL-51

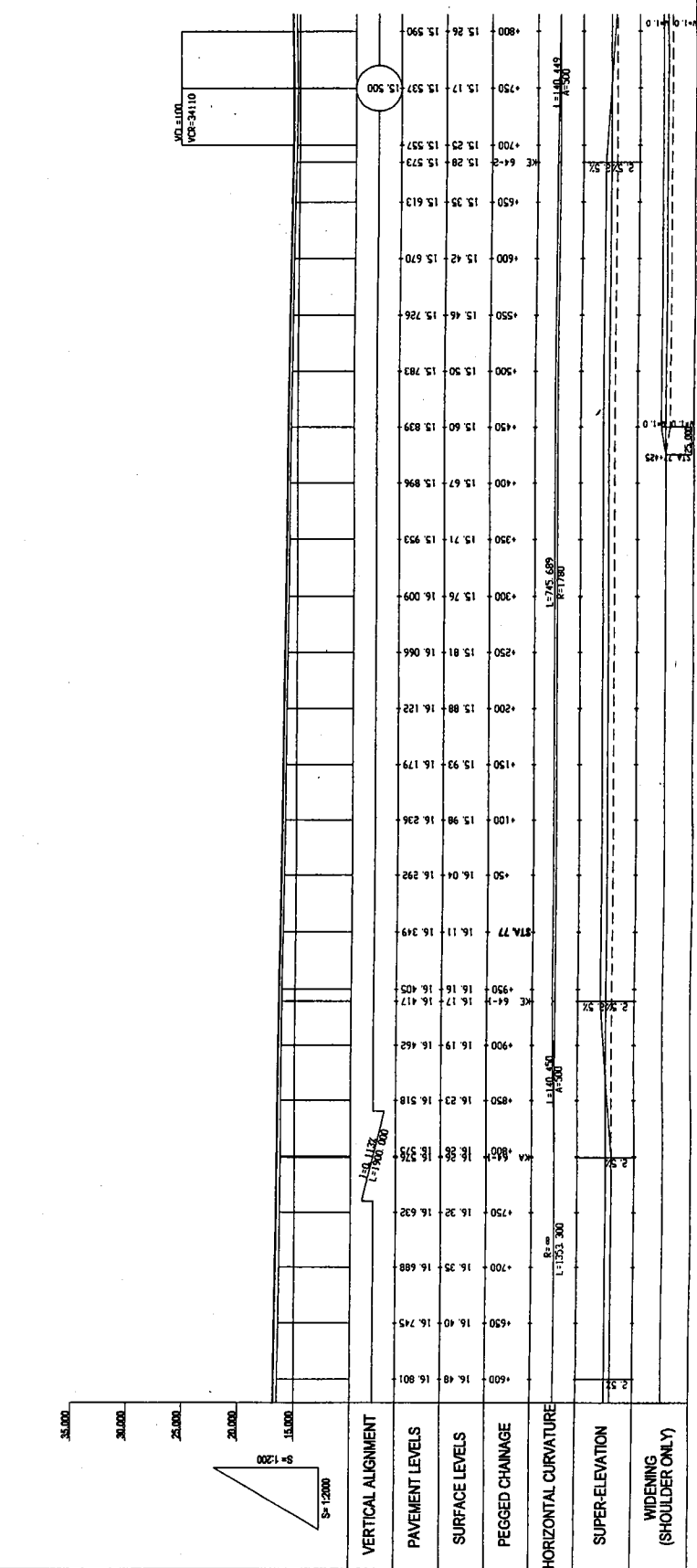
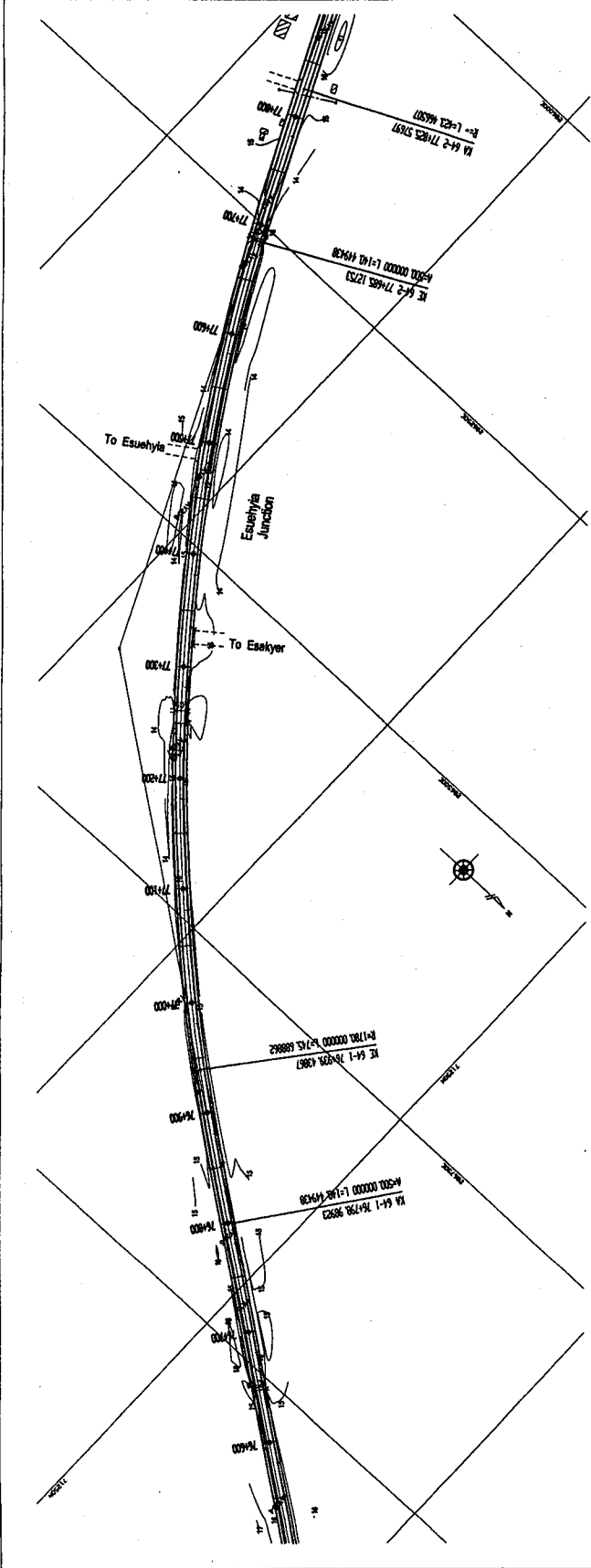

GOVERNMENT OF THE REPUBLIC OF GHANA	MINISTRY OF ROAD AND TRANSPORT GHANA HIGHWAY AUTHORITY	KATAHIRA & ENGINEERS INTERNATIONAL	NOTES:	PROJECT: THE PROJECT FOR REHABILITATION OF TRUNK ROAD	TITLE: PLAN AND PROFILE (52/85)	SCALE: V = 1:200 H = 1:2000	DRAWING No: PL-52
---	--	---------------------------------------	--------	--	--	---------------------------------------	--------------------------

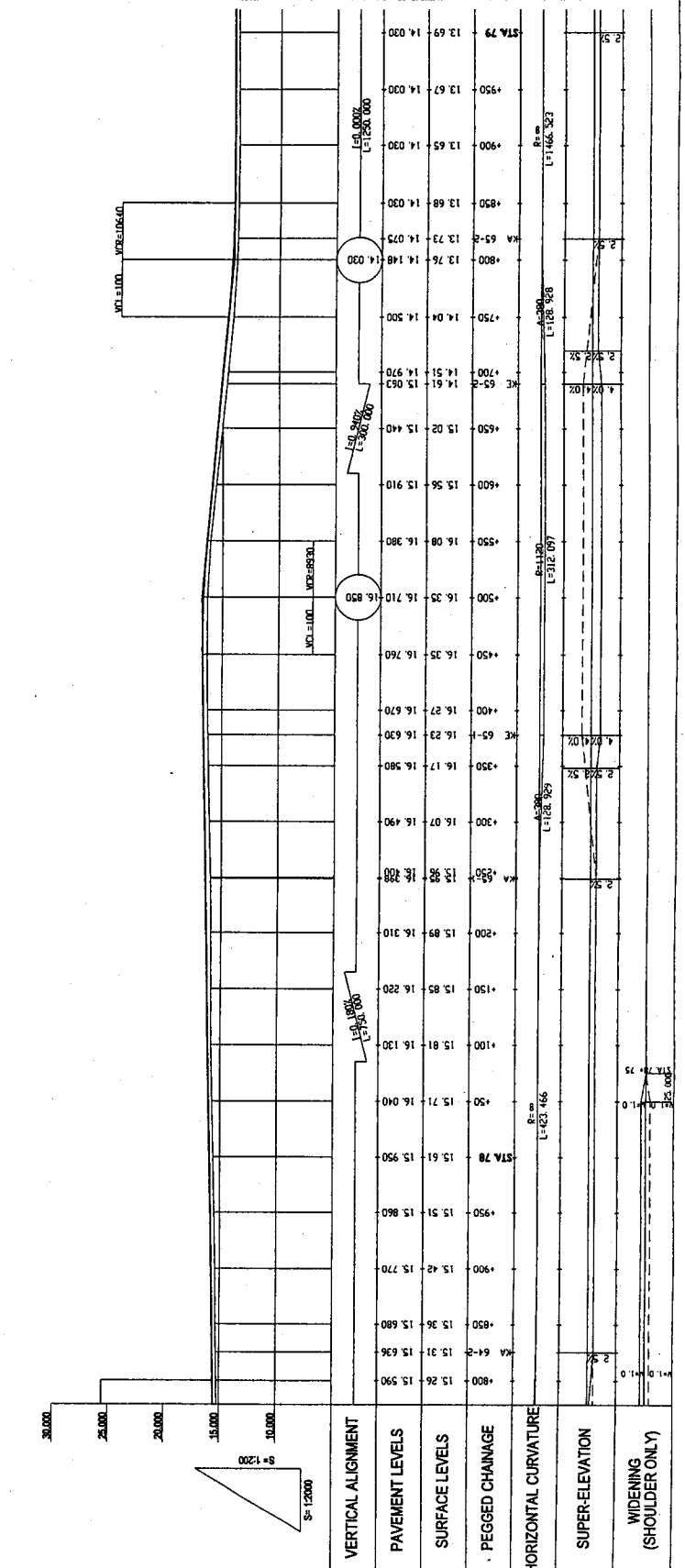
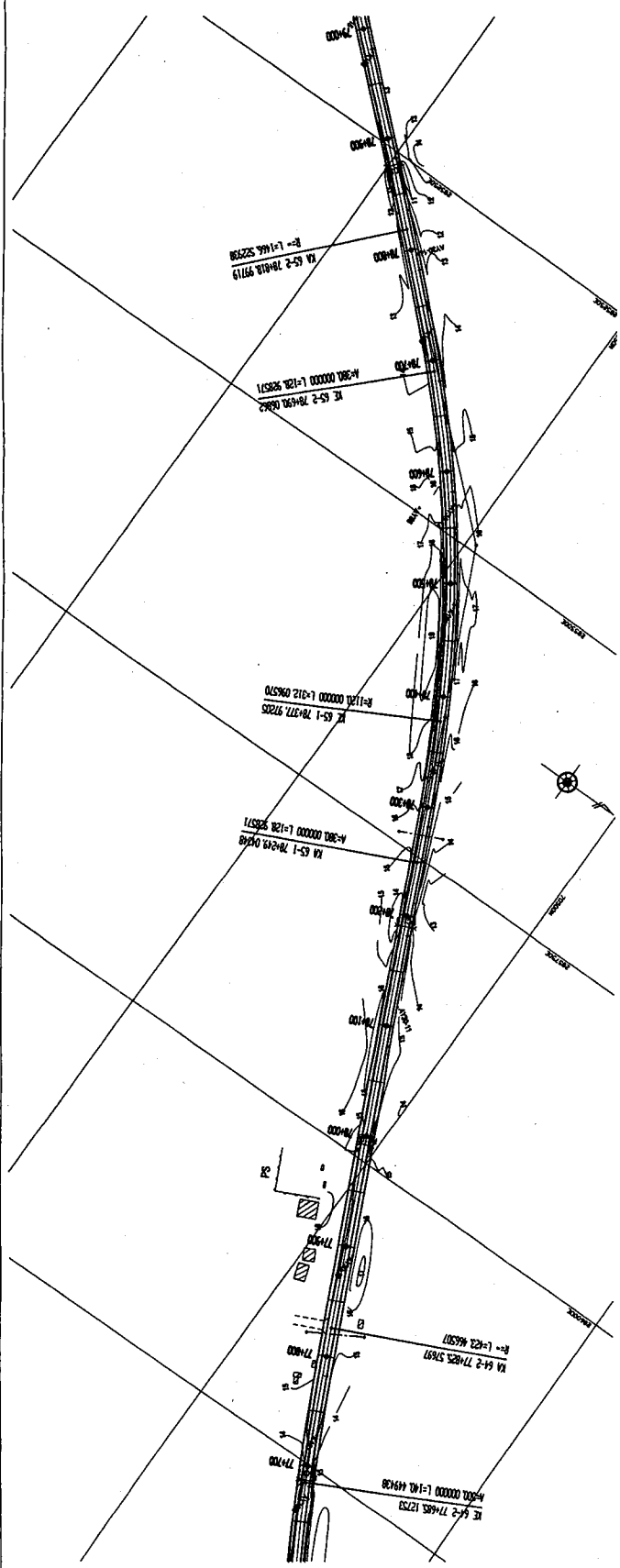

GOVERNMENT OF THE REPUBLIC OF GHANA
 MINISTRY OF ROAD AND TRANSPORT GHANA HIGHWAY AUTHORITY
 KATAHIRA & ENGINEERS INTERNATIONAL
 NOTES:
 PROJECT: THE PROJECT FOR REHABILITATION OF TRUNK ROAD
 TITLE: PLAN AND PROFILE (53/83)
 SCALE: V = 1:200 H = 1:2000
 DRAWING No: PL-53

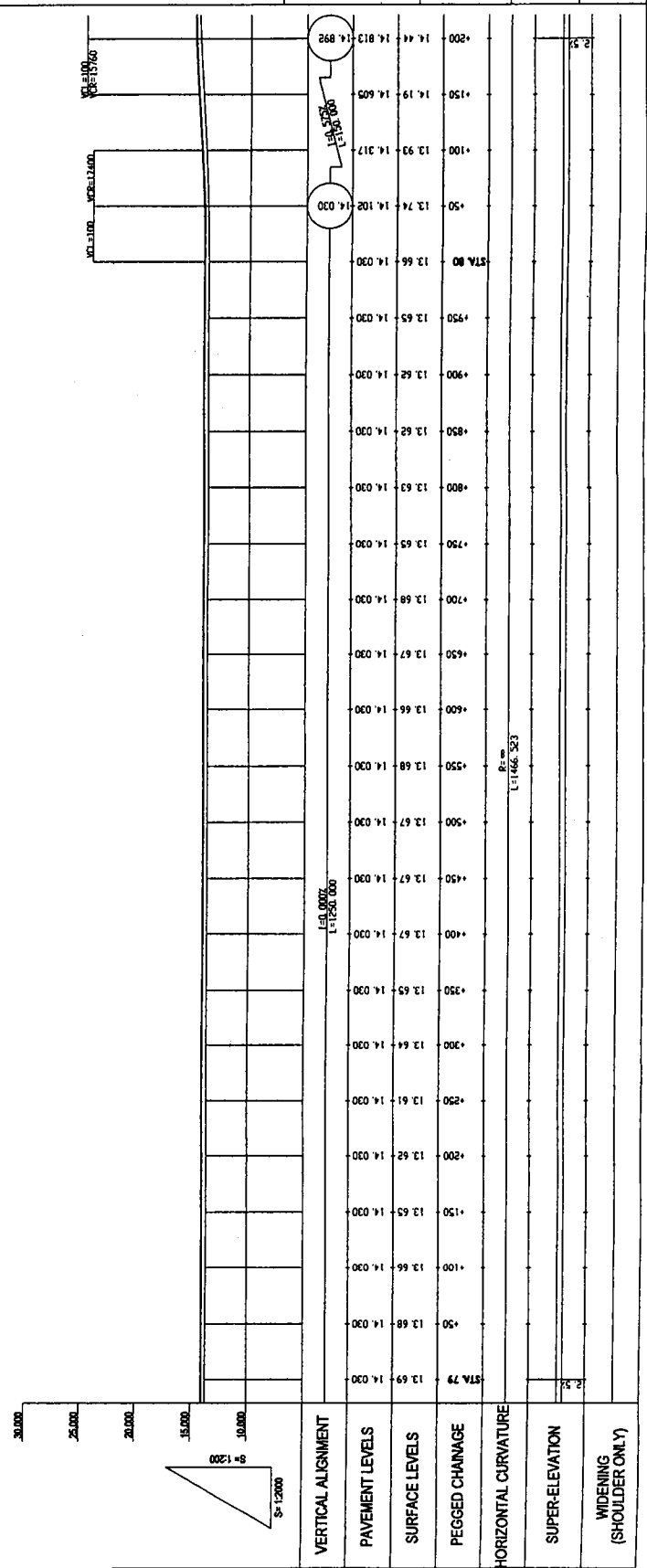
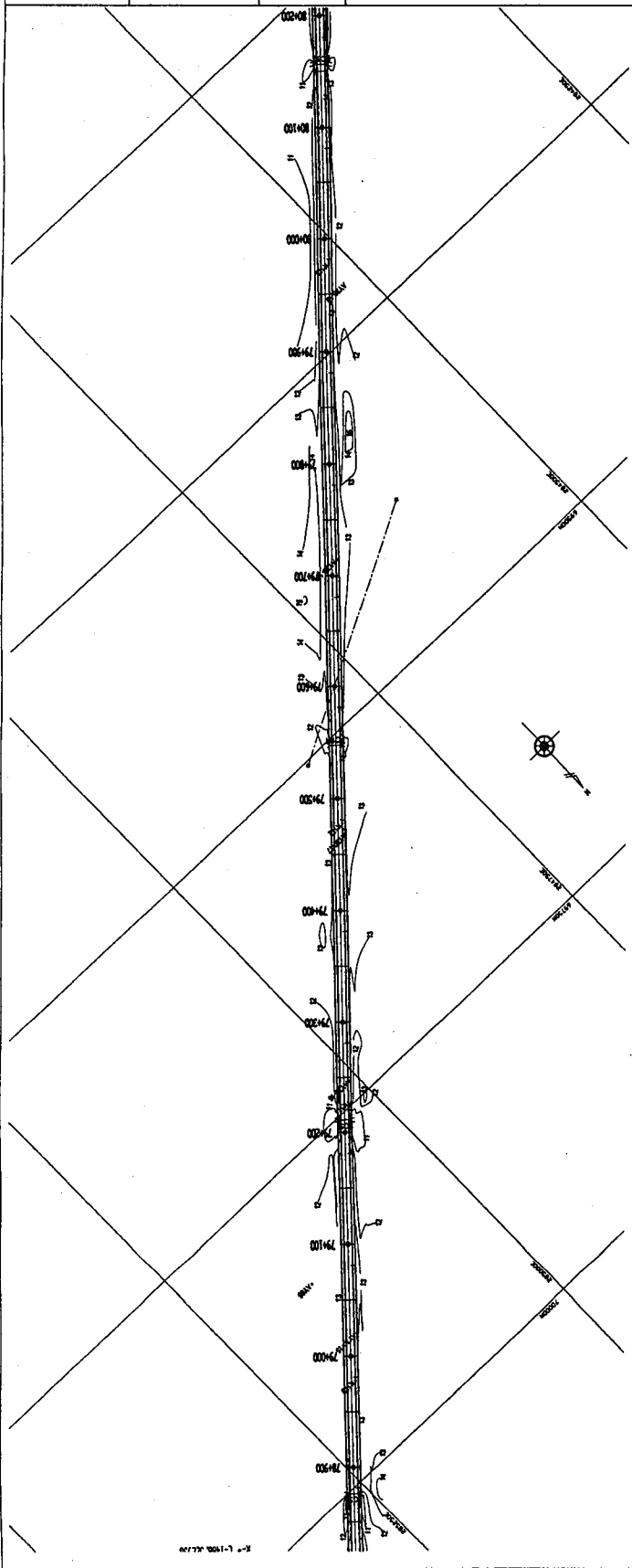

GOVERNMENT OF THE REPUBLIC OF GHANA
MINISTRY OF ROAD AND TRANSPORT GHANA HIGHWAY AUTHORITY
KATAHIRA & ENGINEERS INTERNATIONAL
 NOTES:

PROJECT: THE PROJECT FOR REHABILITATION OF TRUNK ROAD
TITLE: PLAN AND PROFILE (54/83)
SCALE: V = 1:200 H = 1:2000
DRAWING No: PL-54

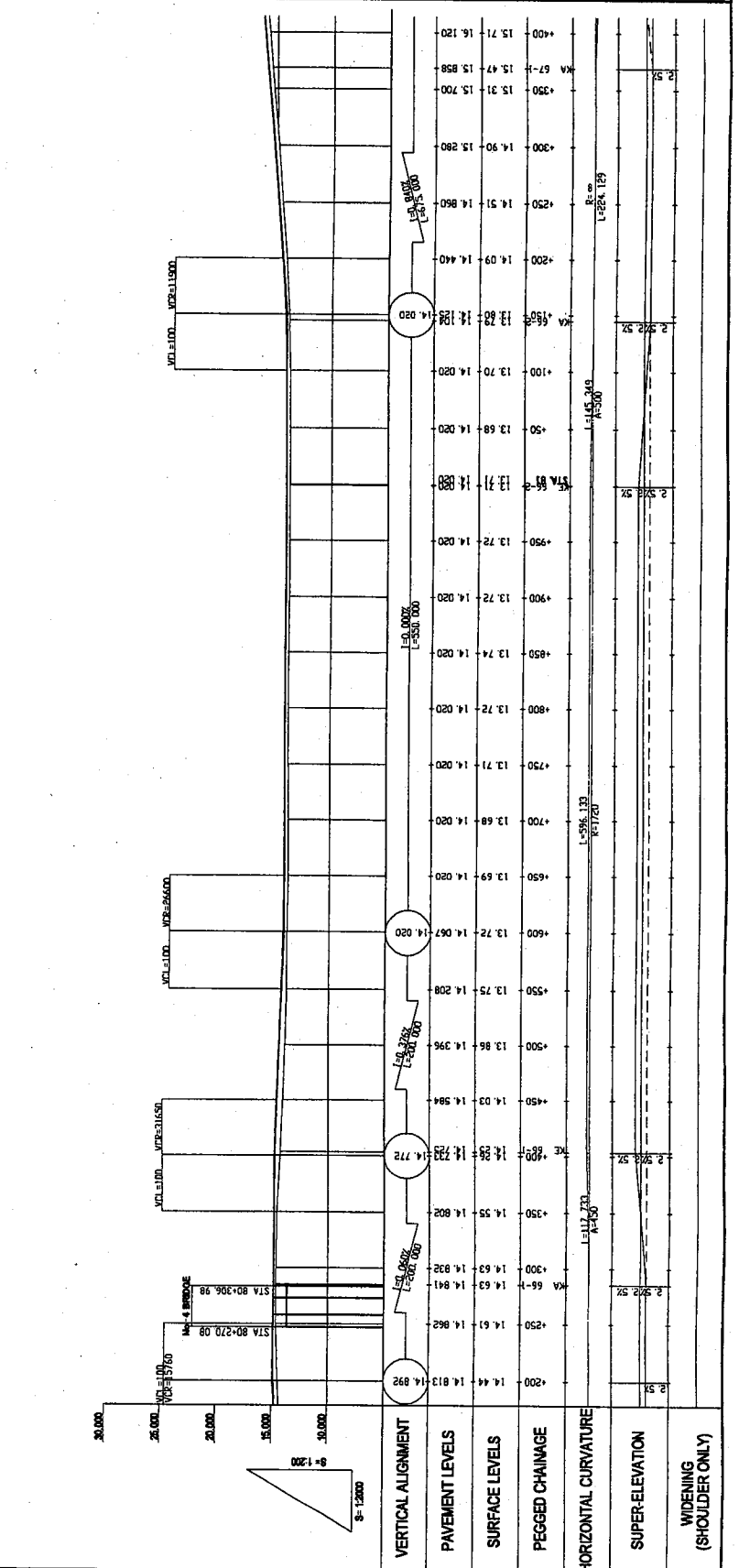
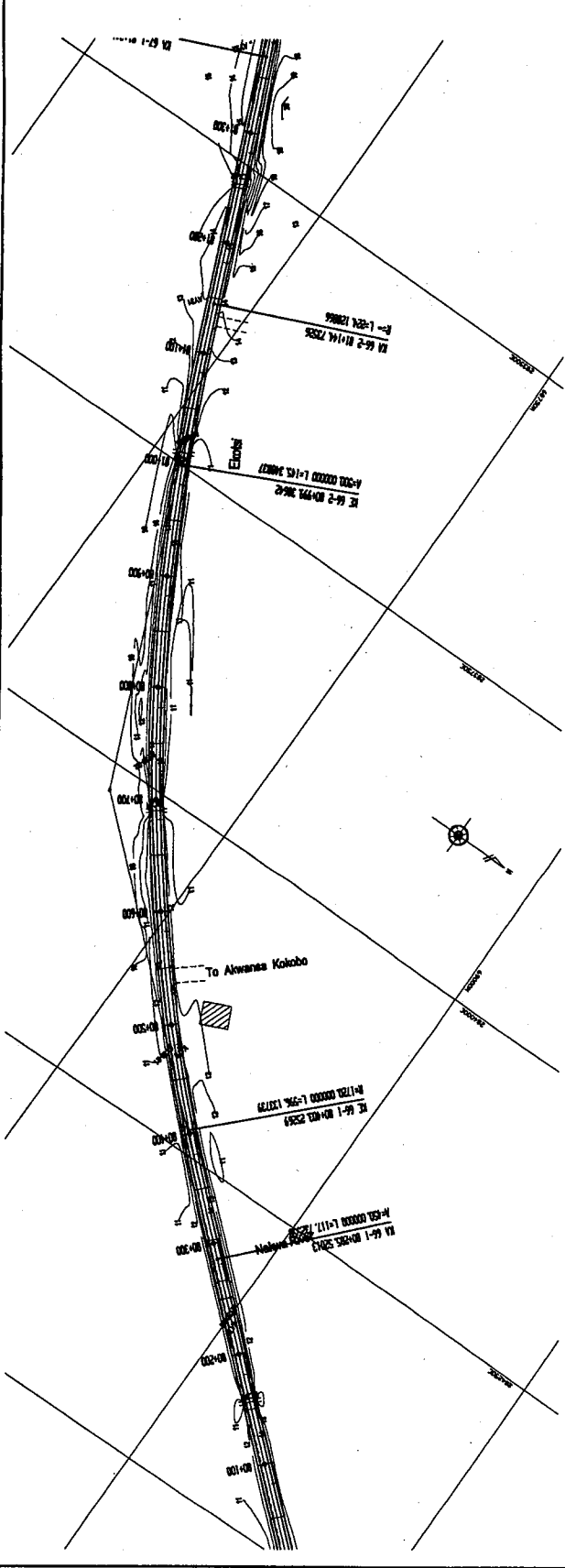

GOVERNMENT
OF
THE REPUBLIC OF GHANA

MINISTRY
OF
ROAD AND TRANSPORT
GHANA HIGHWAY
AUTHORITY

KATAHIRA & ENGINEERS
INTERNATIONAL

NOTES:

PROJECT:

THE PROJECT FOR
REHABILITATION OF
TRUNK ROAD

TITLE:

PLAN AND PROFILE (55/83)

SCALE:

V = 1:200
H = 1:2000

DRAWING No:

PL-55

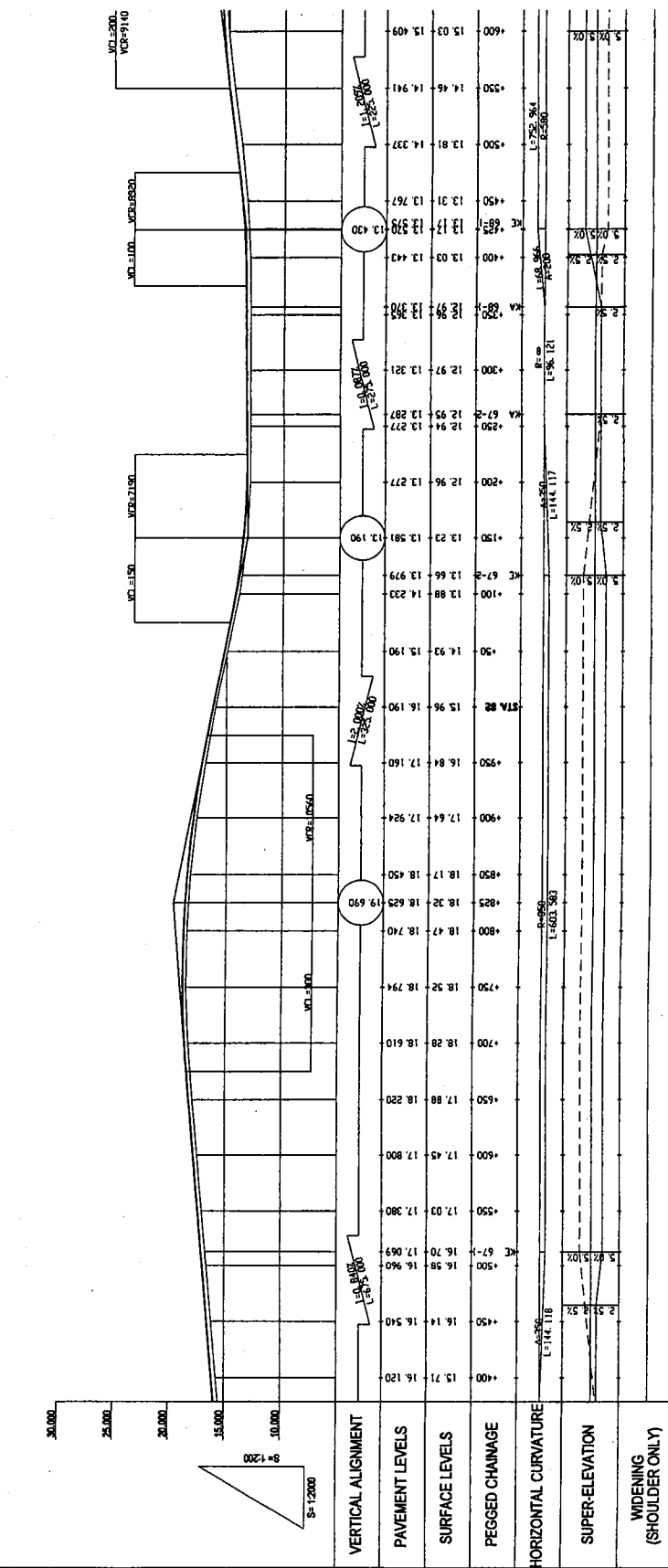
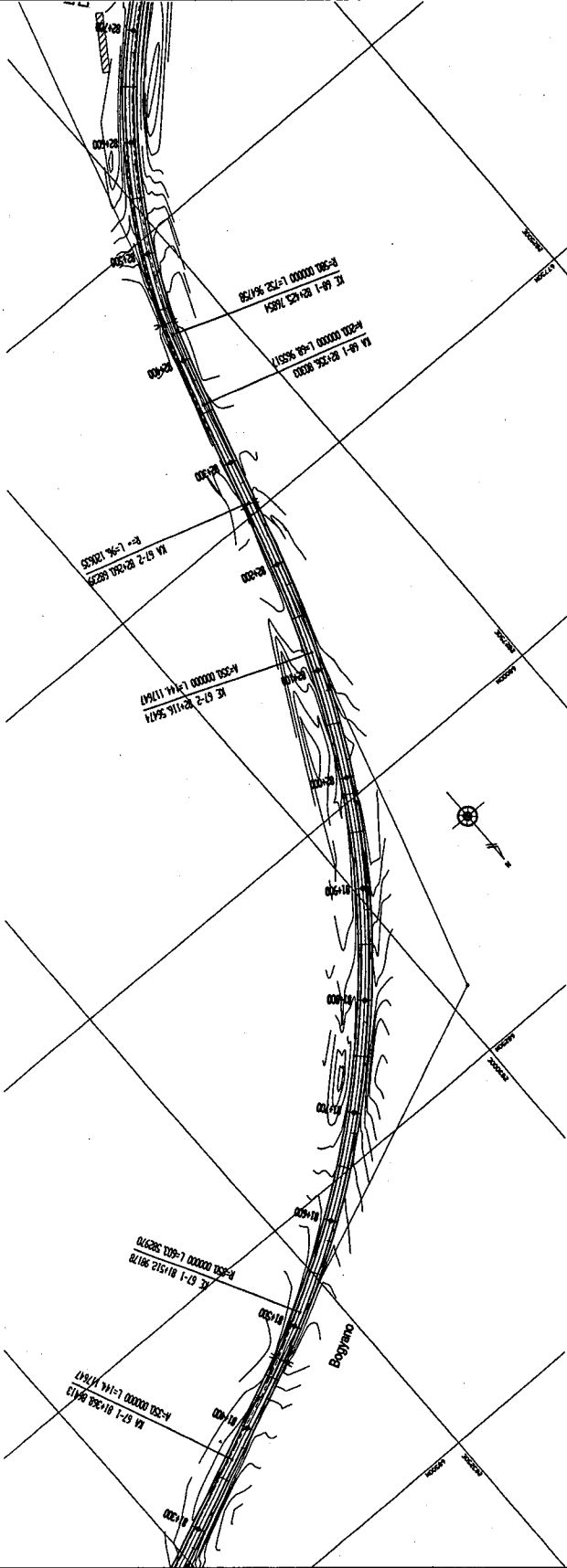

GOVERNMENT OF THE REPUBLIC OF GHANA	MINISTRY OF ROAD AND TRANSPORT GHANA HIGHWAY AUTHORITY	KATAHIRA & ENGINEERS INTERNATIONAL	NOTES:	PROJECT: THE PROJECT FOR REHABILITATION OF TRUNK ROAD	TITLE: PLAN AND PROFILE (58/83)	SCALE: V = 1:2000 H = 1:2000	DRAWING No: PL-58
---	--	---------------------------------------	--------	---	---	------------------------------------	----------------------

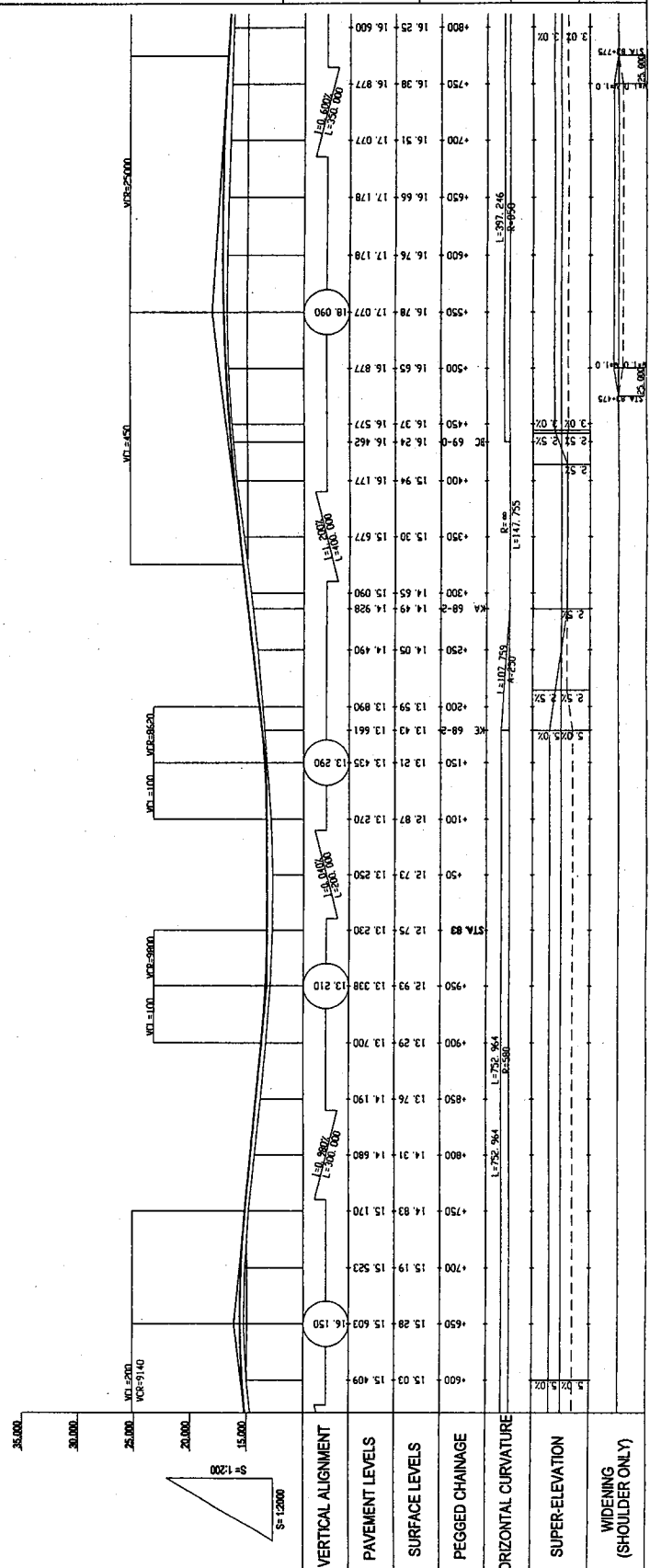
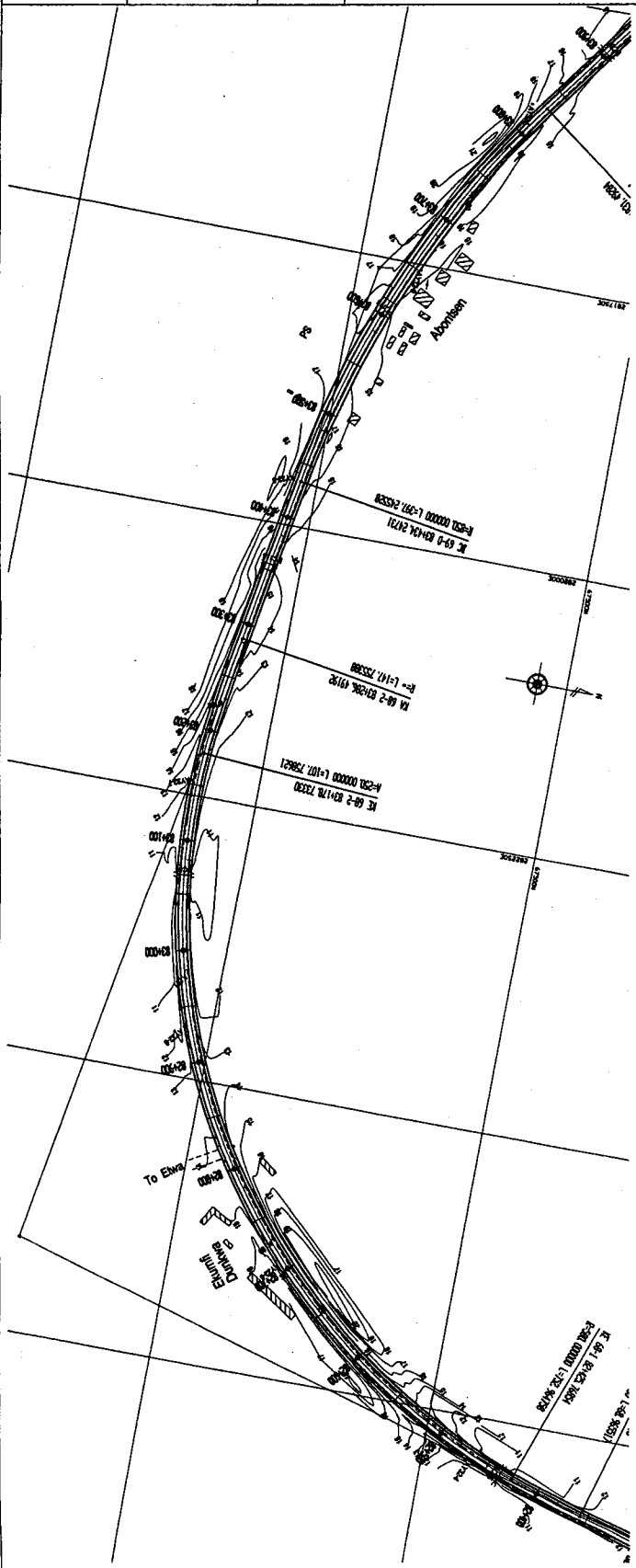

GOVERNMENT OF THE REPUBLIC OF GHANA
 MINISTRY OF ROAD AND TRANSPORT GHANA HIGHWAY AUTHORITY
 KATAHIRA & ENGINEERS INTERNATIONAL
 NOTES:
 PROJECT: THE PROJECT FOR REHABILITATION OF TRUNK ROAD
 TITLE: PLAN AND PROFILE (57/83)
 SCALE: V = 1:200 H = 1:2000
 DRAWING No: PL-57

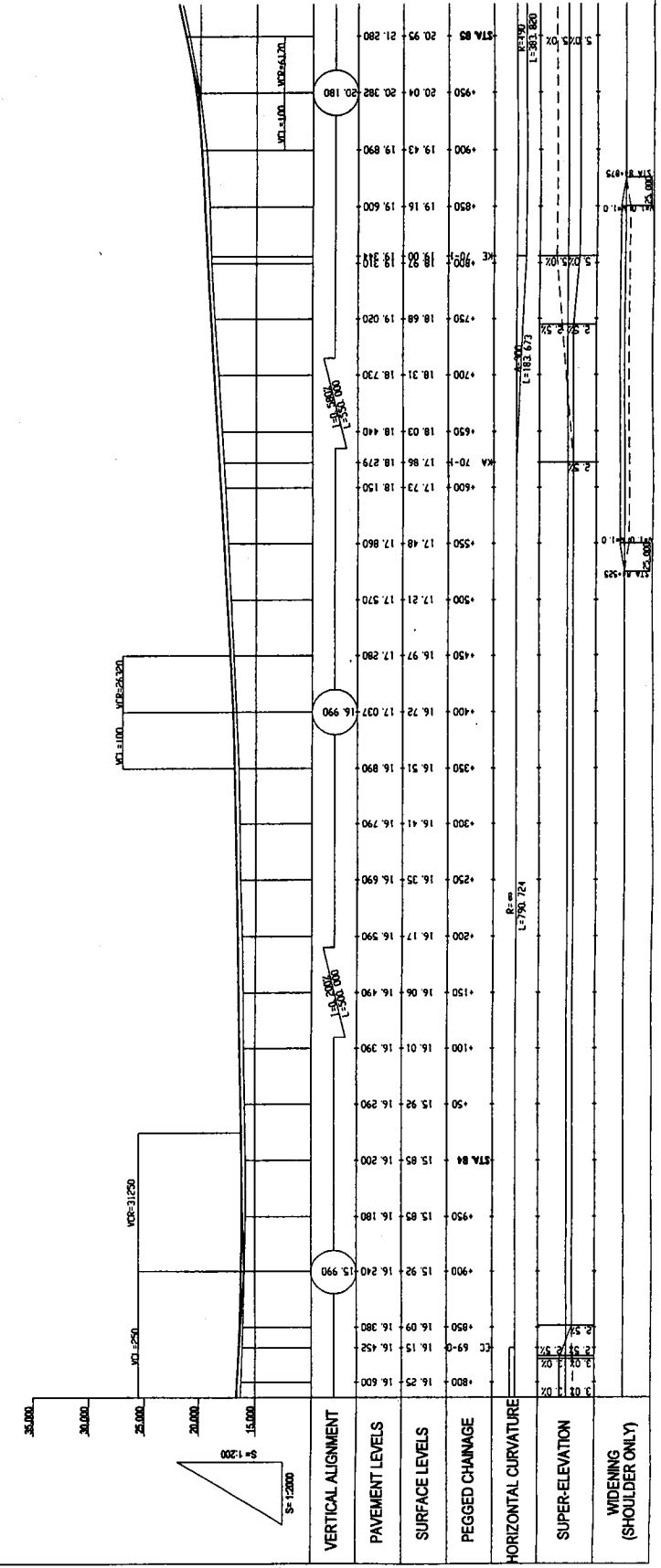
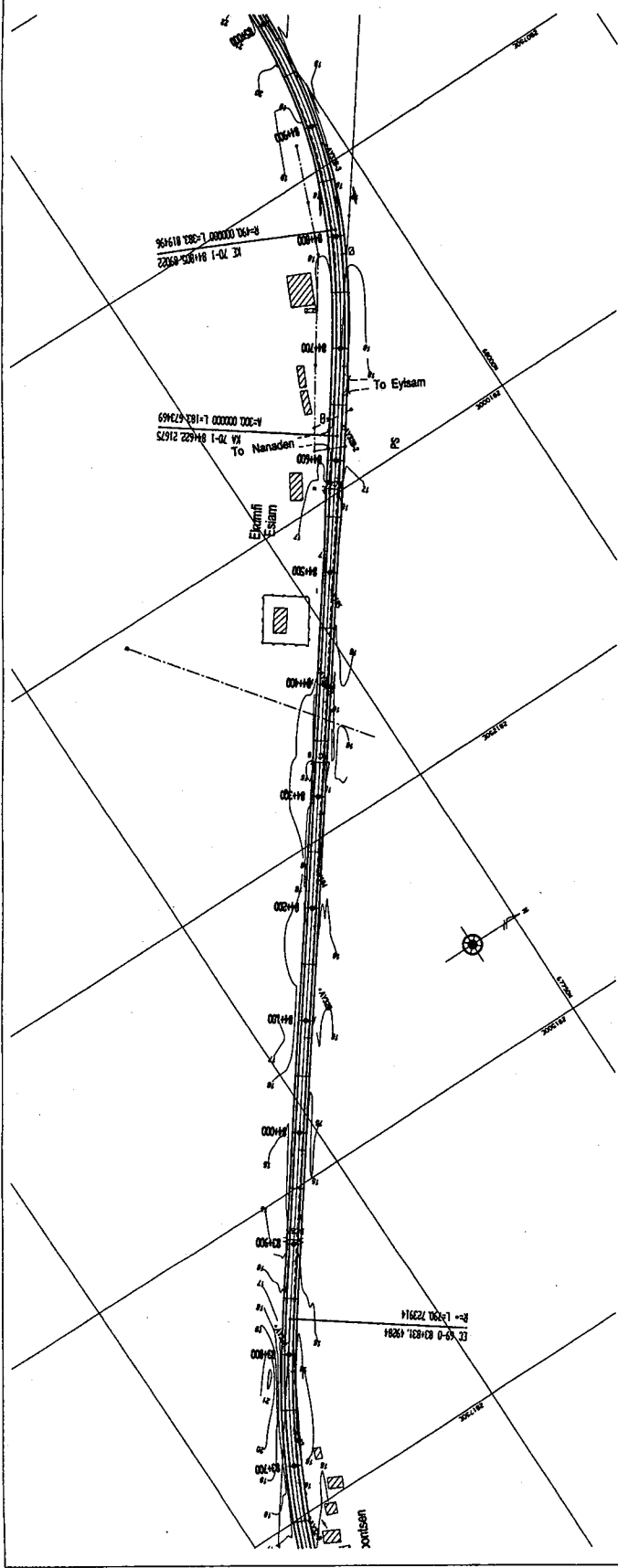

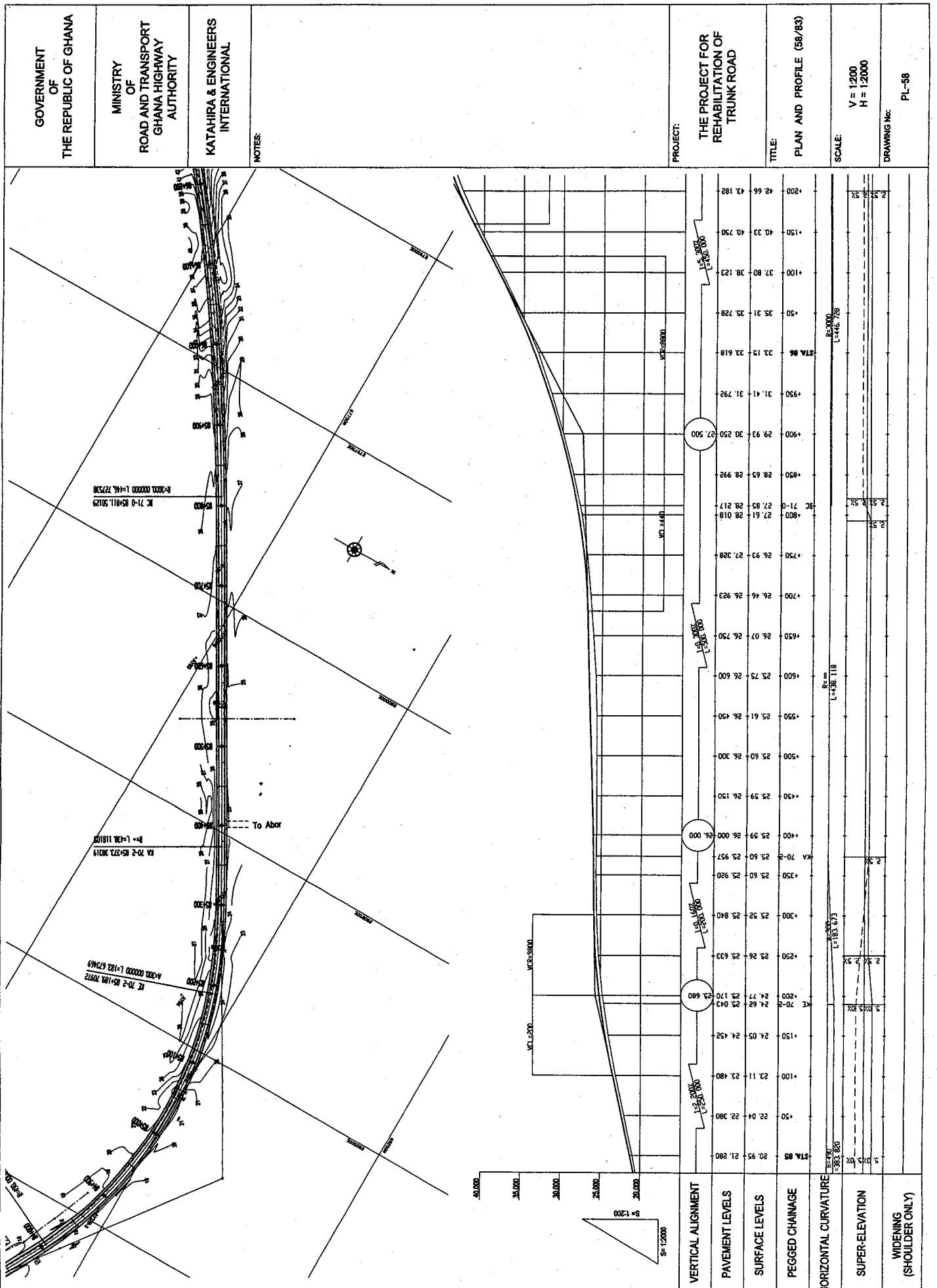

GOVERNMENT OF THE REPUBLIC OF GHANA
 MINISTRY OF ROAD AND TRANSPORT GHANA HIGHWAY AUTHORITY
 KATAHIRA & ENGINEERS INTERNATIONAL
 NOTES:
 PROJECT: THE PROJECT FOR REHABILITATION OF TRUNK ROAD
 TITLE: PLAN AND PROFILE (89/83)
 SCALE: V = 1:2000 H = 1:2000
 DRAWING No: PL-59

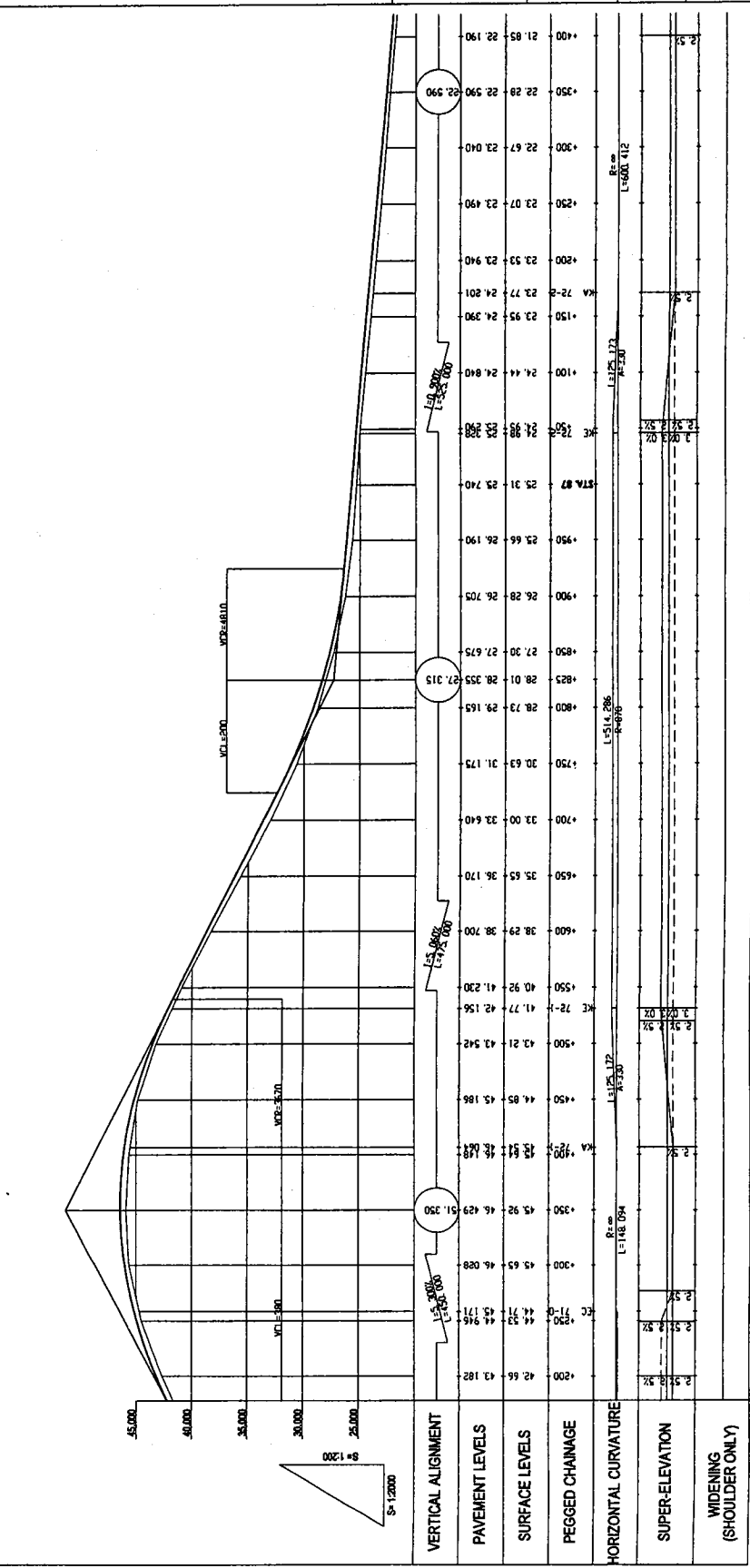
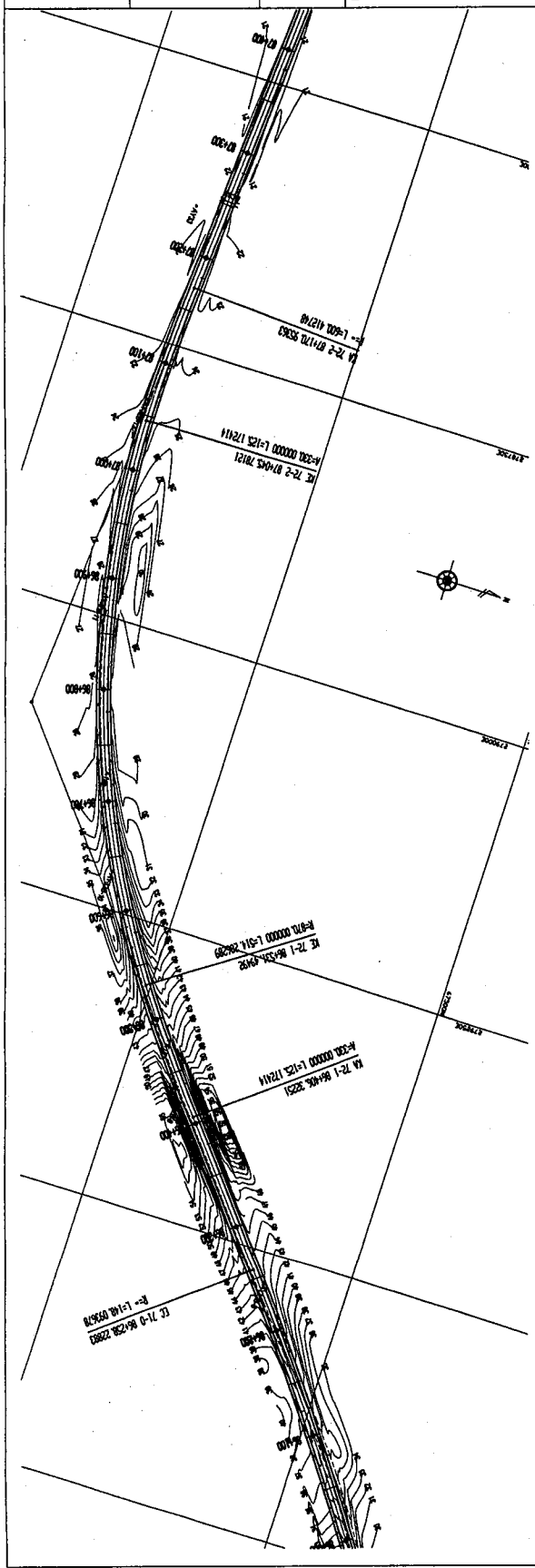

GOVERNMENT
OF
THE REPUBLIC OF GHANA

MINISTRY
OF
ROAD AND TRANSPORT
GHANA HIGHWAY
AUTHORITY

KATAHIRA & ENGINEERS
INTERNATIONAL

NOTES:

PROJECT:

THE PROJECT FOR
REHABILITATION OF
TRUNK ROAD

TITLE:

PLAN AND PROFILE (60/83)

SCALE:

V = 1:200
H = 1:2000

DRAWING No:

PL-60

